

Preconstruction Conference- Contractor's Questions

Question No. 1: *"Do we need to install weed fabric?"*

Answer: Per page 7 of Section 6.2 - General Special Provision, Article 16.2-D -Plantings, items 4 & 5 - weed barrier fabric is specified to be installed in the planting areas of the project in accordance with the Plans. The means of measurement and payment is identified in Article 16.3 (E) and 16.4 (E) on page 8, respectively and Section 1.8 -Schedule of Values, for both Part 1 and Part 2 of the project, accounts for the quantity and unit price costs for weed barrier fabric.

NOTE: At this time, Plan sheet 2 of the Bid Plans has not been changed to reflect the above reference changes in Bid Items, Quantities or Values. It may be revised or updated for the 4 sets of Contract Documents that will be issued as part of the execution of the Contract.

Question No. 2: *"Does the City really want 2 mulchings during the establishment period?"*

Answer: No, the City does not want two mulchings during the establishment period. By means of this response in Addendum # 3 to question #2, it shall be considered for all practical purposes that Note 1.2 on Sheet L3 of the landscaping plans in the Bid Documents is considered to be revised to specify for the requirement for only the initial required singular 3" deep mulching.

Question No. 3: *"I understand that the dividing line between Parts 1 & 2 of the bid is around Burnside St, but what is the specific station number at this dividing line?"*

Answer: For purpose of bidding, the phase line between Part 1 & Part 2 can be considered to be at Sta 19+20. **Of note:** The 24" RCP pipe run (and only the pipe run and not the type 18 structure at Sta 20+48 Rt) from Sta 20+48 Rt +/- to the proposed converted MH at Sta 19+05 Rt should be included in the Part 1 section of the project.

Question No. 4: *"According to the plans and information at the pre-bid meeting, the existing pavement is to remain in place for Part 1 of the bid from Boundary to Burnside. However, there is an item for 1,930 SY of existing asphalt pavement removal in Part 1 Schedule of Values. Where is the 1,930 SY of asphalt removal for Part 1?"*

Answer: The bid quantity of "removal of existing asphalt pavement" for Part 1 should be "0" SY. The bid quantity for the "removal of existing asphalt pavement" for Part 2 should be "3216" SY. The Schedule of Values for Part 1 and Part 2 have been changed accordingly to reflect these amended quantities for the removal of existing asphalt pavement and been re-issued as part of the documentation accompanying this addendum. The amended Schedules of Value are to be submitted in lieu of those same documents in the "original" issued set of contract documents.

Question No. 5: *"Didn't you state in the meeting that you can't bid on just one part of the RFP? If you bid, you have to bid for the entire job, correct?"*

Answer: The project is being processed as a Part 1 and a Part 2, solely for administrative purposes. It would not be viable or physically feasible for two contractors to work on two separate sections of the same roadway at the same time with only one publicly available point of ingress/egress, that being Boundary St.

As a further answer to this question and additional clarification, please note that the RFP clearly identifies that "it is the City's intent to contract with one proposer to provide the services" described within the RFP.

Question No. 6: *“There are two checklists of forms required to be submitted. One in the RFP page 6 and one in the Contract Documents in Section 1.1. Which checklist are we to use when returning the Bid Documents?”*

Answer: Each Bidder is required to submit, in full and fully executed, only the list of Bid Documents as published in Section 1 of the **Contract Documents**, they are as follows:

- Sec. 1.3 - Bid Proposal
- Sec 1.3.1 - Bid Documents - Part I, Part II & Part III
- Sec. 1.4 - Bid Bond
- Sec. 1.5 - Certification by Contractor - Non-Segregated Facilities
- Sec. 1.6 - Non-Collusion Affidavit of Prime Bidder
- Sec. 1.7 - Bid Form - Consent of Surety & Non-Collusion Affidavit
- Sec. 1.8 - Schedule of Values-Part 1 & Part 2
- Sec. 1.9 - Contractors Qualification Statement

The above listing of documents, are a part of the **Contract Documents** as found in referenced **Appendix “B”**, which is available online at www.cityofbeaufort.org, under “Quick Links”-Bid Opportunities-Greenlawn Dr Streetscape.

The **other/additional documents** that the City requires per their RFP which are to be included in the submittal package are:

1. RFP Signature Page which can be found on page 9 of the RFP, the transmittal letter.
2. Transmittal letter -see Proposal Format - Part II (a) [see page 6 of 9] for details concerning the transmittal letter],
3. Executive Summary requested as item iii on page 6 of 9, Proposal Format - Part II (a),
4. Affirmative Statement requested as item iv on page 6 of 9, Proposal Format - Part II (a),
5. Written response addressing – skill sets/capabilities - Proposal Format -Part II (b), ii
6. Non-Resident Taxpayer Affidavit

Summary of Bid Documents in submittal package

<u>Document</u>	<u>Source</u>
Bid Proposal	Sec. 1.3 (Contract Documents-Appendix B)
Bid Documents - Part I, Part II & Part III	Sec 1.3.1 (Contract Documents-Appendix B)
Bid Bond	Sec. 1.4 (Contract Documents-Appendix B)
Certification by Contractor - Non-Segregated Facilities	Sec. 1.5 (Contract Documents-Appendix B)
Non-Collusion Affidavit of Prime Bidder	Sec. 1.6 (Contract Documents-Appendix B)
Bid Form - Consent of Surety & Non-Collusion Affidavit	Sec. 1.7 (Contract Documents-Appendix B)
Schedule of Values-Part 1 & Part 2	Sec. 1.8 (Contract Documents-Appendix B)
Contractors Qualification Statement	Sec. 1.9 (Contract Documents-Appendix B)
RFP Signature Page	page 9 of RFP
Transmittal letter (Proposal Format in RFP)	Drafted by proposed Bidder (see page 6 of 9)
Executive Summary (Proposal Format in RFP)	Drafted by proposed Bidder (see page 6 of 9)
Affirmative Statement (Proposal Format in RFP)	Drafted by proposed Bidder (see page 6 of 9)
Written response – skill sets/capabilities (RFP)	Drafted by proposed Bidder (see page 6 of 9)
Non-Resident Taxpayer Affidavit (RFP)	Available online as a PDF

Question No. 7: *“Contract Documents: Section 1.1 Page 2 of 4, #8 – List all Subcontractors who will perform on the job. This includes anyone who is not a W2 employee for the Bidder including 1099 Subcontractors. List must include name, appropriate state license and city business license numbers. Bidder must complete the “Subcontractors” form found online under Exhibit “A”. Can you provide a link to Exhibit A or a copy of it?”*

Answer: The online link is not available. We have provided a hard copy of Exhibit A as part of this addendum package

Question No. 8: *“Are we and our potential subcontractors required to be registered in SAM?”*

Answer: Because this project is being funded and being administered in whole or in part by a Federal Grant Community Development Block Grant (CDBG), then Federal CDBG requirements will apply to the contract. Yes, all contractors and subcontractors are required to be registered in the federal System Award Management (SAM).

Question No. 9: *“Contract Documents: Section 1.3.1 “Housing & Urban Development-Section 3 Documents: The Section 3 program requires that recipients of **certain financial assistance**, to the greatest extent feasible, provide job training, employment, and contracting opportunities for low-income residents in connection with projects and activities in their neighborhoods.”*

a. Can you provide what the criteria is for **certain financial assistance**?

Answer: Funding, such as that used for Community Development Block Grants, would identify a project as receiving certain financial assistance. The intent is that a contractor make the best possible effort to meet the requirements.

Question No. 9: (Cont'd)

b. *“If we do not “receive” that **certain financial assistance**, are we required to complete any part of the “Section 3”, if so what pages.”*

Answer: If you don't “receive certain financial assistance”, ie you don't meet Section 3 requirements, you still need to complete Part II-SC Illegal Immigration Reform Act paperwork as noted in the Section 1.3.1 reference, below that has been extracted from the answer to Question #10, elsewhere herein.

*Bid Documents - Sec 1.3.1[Contact Documents]
Part I - Housing & Urban Development-Section 3 Documents [If applicable]
Part II - SC Illegal Immigration Reform Act [Required]
Part III - Certification Regarding Disbarment etc. [If applicable]*

Question No.10: *“ I would like to confirm that we are required to return all of the forms listed below (1-8) and all of the Bid Documents (1-6)”*

The Bidder is required to submit only the Bid documents, which include:

- 1) Complete Bid Proposal Form, Section 1.2 through 1.9
- 2) Bid Bond or Certified Check [Sec 1.4]
- 3) Certification by Contractor RE: Non-Segregated Facilities [Sec 1.5]
- 4) Non-Collusion Affidavit of Prime Bidder [Sec 1.6]
- 5) Consent of Surety [Sec 1.7-Bid Form]

- 6) *Bid Form [Sec 1.7]*
- 7) *Completed Schedule of Values, Section 1.8, in its entirety [Sec 1.8]*
- 8) *List of all Subcontractors who will perform on the job. This includes anyone who is not a W2 employee for the Bidder including 1099 Subcontractors. List must include name, appropriate state license and city business license numbers. Bidder must complete the "Subcontractors" form found online under Exhibit "A". [Attachment-Exhibit A -per addendum # 3]*

The Bidding Documents consist of the following, including all addenda issued therewith and forms referenced herein, in addition to the drawings:

- Section 1 - Bid Documents*
- Section 2 - Contract*
- Section 3 - General Conditions*
- Section 4 - Supplemental Conditions*
- Section 5 - General Provisions*
- Section 6 - Special Provisions*
- A set of Construction Drawings consisting of 42 sheets*

Answer:

- A. **Contract Documents:** The following list of documents shall constitute the portion of the bid submittal generated from the Contract Documents that are required to be fully and completely executed and submitted as a part of the bid package.
[The submittal document, its numeric contract designation and the source of the document have been provided in the list where available]

- a) Bid Proposal – Sec 1.3 [Contact Documents]
- b) Bid Documents - Sec 1.3.1[Contact Documents]
 - Part I - Housing & Urban Development-Section 3 Documents [**If applicable**]
 - Part II - SC Illegal Immigration Reform Act [**Required**]
 - Part III - Certification Regarding Disbarment etc. [**If applicable**]
- c) Bid Bond - Sec. 1.4 [Contact Documents]
- d) Certification by Contractor - Non-Segregated Facilities - Sec. 1.5 [Contact Documents]
- e) Non-Collusion Affidavit of Prime Bidder - Sec. 1.6 [Contact Documents]
- f) Bid Form - Sec. 1.7 [Contact Documents]
 - Consent of Surety [**Required**]
 - Non-Collusion Affidavit [**Required**]
- g) Schedule of Values - Sec. 1.8 [Contact Documents]
 - Part 1[**Required**] and Part 2 [**Required**]
- h) Contractors Qualification Statement - Sec. 1.9 [Contact Documents]

(Note that Sec 1.2 -Instructions to Bidders has been removed from the original list of required documents in the submittal package)

- B. **Contract Documents:** With regard to the second set of "Bid Documents" Sections 1 thru 6 and the set of construction drawings, the reference to them is only intended to bring the bidders attention to them in order to allow the bidder to fully understand the contractual terms and conditions of the complete project. They identify the package of documents pertaining to the contract and are not required to be part of the bid submittal.

NOTE: *Only the relevant "Section 1- Bid Documents" (listed above in Answer[A]-Contract Documents constitute the portion of the bid submittal documents from the Contract Documents that are to be submitted.*

C. **City of Beaufort – RFP:** the following list of documents identified in the City’s RFP are required to be submitted as part of the bid submittal package.

- | | |
|---|--|
| a) RFP Signature Page | page 9 of RFP |
| b) Transmittal letter (Proposal Format in RFP) | Drafted by proposed Bidder (see page 6 of 9) |
| c) Executive Summary (Proposal Format in RFP) | Drafted by proposed Bidder (see page 6 of 9) |
| d) Affirmative Statement (Proposal Format in RFP) | Drafted by proposed Bidder (see page 6 of 9) |
| e) Written response – skill sets/capabilities (RFP) | Drafted by proposed Bidder (see page 6 of 9) |
| f) Non-Resident Taxpayer Affidavit (RFP) | Available online as a PDF |

Question No.10: (Cont’d)

a. “How many originals and copies are required to be returned?”

Answer: Per the City of Beaufort RFP (page 2 of 9) – “SUBMIT: **One (1) unbound original and three (3) bound copies** of all requested (sic-required) documentation”. (Documentation being- completed bid submittal package as noted above in [A] Contract Documents and [C] City of Beaufort – RFP)

Question No.11: *“Section 1.2, Pg 5 of 8. Paragraph 6.4 – This paragraph indicates that the entire bid package should be returned (minus drawings), is this correct or can we just submit the bid docs and required forms (ie bonds, insurance, etc)”*

Answer: See answer(s) to question 10, above- Part A -Contract Documents and Part C – City of Beaufort- RFP

Question No.12: *“ Section 3 Contractors – We are not a Section 3 Contractor; however, we will attempt to find Section 3 subcontractors. If we do not, do we just leave these pages blank?”*

Answer: If you are not a qualified Section 3 contractor, there is no need to complete Bid Documents - Sec 1.3.1 of Contact Documents, Part I - Housing & Urban Development-Section 3 Documents or Part III - Certification Regarding Disbarment etc. They can be left blank or marked N/A.

But you must complete Bid Documents - Sec 1.3.1 of Contact Documents, Part II - SC Illegal Immigration Reform Act.

Please note: With regard to the Landscaping Plans in the Contract Drawings, the Owner has enacted some alterations to the landscaping plans. These changes are reflected in the documents being forwarded as part of this addendum.

Below is a narrative of the changes being made. As part of this addendum, we have included mark-ups (in color) of the landscaping sheets and an updated Schedule of Values -Part 1 and Part 2. The updated Schedules of Values provided with addendum shall be used for the bid submittal in lieu of those in the “original” Contract Documents (Section 1.8-Schedule of Values – Part 1 & Part 2). The summary of landscaping changes is as follows:

- Remove bid item of Asiatic Jasmine from Schedules of value
- Replace all Overcup Oaks in bid with Southern Live Oaks
- Replace Sabal Palms in bid with Cabbage Tree Palm (Palmetto)
- Centipede Sod for all areas highlighted in green (Planting areas that were to have Asiatic Jasmine)
- Double -Shredded Hardwood Mulch quantities added to Schedule of Values (Sec 1.8) Pt 1 & Pt 2
- Contactor to revise quantities on sheet L4 to reflect above changes

BID FORM- GREENLAWN DRIVE STREETScape

PART 1 – Boundary Street to Burnside Street

ITEM	DESCRIPTION	QUANTITY	UNITS	UNIT PRICE	ESTIMATE PRICE
1031000	MOBILIZATION	1	UNIT		
1032010	BONDS AND INSURANCE	1	UNIT		
1050800	CONSTRUCTION STAKES, LINES & GRADES	1	EA		
1071000	TRAFFIC CONTROL	1	UNIT		
10890200	AS-BUILT CONSTRUCTION PLANS	1	UNIT		
2011001	CLEARING & GRUBBING WITHIN ROADWAY	1	UNIT		
2023000	REMOVAL & DISPOSAL OF EXISTING ASPHALT PAVEMENT	0	SY		
2031000	UNCLASSIFIED EXCAVATION	302	CY		
2033000	BORROW EXCAVATION	320	CY		
2081001	FINE GRADING	2861	SY		
2103000	FLOWABLE FILL	60	CY		
2021005	REMOVAL & DISPOSAL OF EXISTING CATCH BASIN	1	EA		
20210-10	REMOVAL & DISPOSAL OF EXISTING DROP INLET	2	EA		
3069900	MAINTENANCE STONE	38	TON		
3100320	HOT MIX ASPHALT BASE COURSE – TYPE –' B'	565	TON		
4011004	LIQUID ASPHALT BINDER PG64-22	71	TON		
4013990	MILLING EXISTING ASPHALT PAVEMENT (VARIABLE)	120	SY		
4020320	HOT MIX ASPHALT INTERMEDIATE COURSE TYPE –'B'	421	TON		
4030340	HOT MIX ASPHALT SURFACE COURSE TYPE –'C'	315	TON		
4030360	HOT MIX ASPHALT SURFACE COURSE TYPE –' E'	68	TON		
6020005	PERMANENT CONSTRUCTION SIGNS (GROUND MOUNTED)	148	SF		
6250010	4" WHITE SOLID LINES - (PVT. EDGE LINES) – FAST DRY PAINT	2584	LF		
6250015	8" WHITE SOLID LINES - (CROSSWALKS & CHANNELIZATION) – FAST DRY PAINT	688	LF		
6250025	24" WHITE SOLID LINES - (STOP/DIAGONAL LINES) – FAST DRY PAINT	80	LF		
6250050	HANDICAP SYMBOL – FAST DRY PAINT	2	EA		
6250110	4" YELLOW SOLID LINES - (PVT. EDGE LINES & NO PASSING ZONE) – FAST DRY PAINT	3568			
6271010	4" WHITE SOLID LINES) - THERMOPLASTIC- 90 MIL. (PVT. EDGE LINES)	1292	LF		
6271015	8" WHITE SOLID LINES THERMOPLASTIC - 125 MIL.	344	LF		
6271025	24" WHITE SOLID LINES) -THERMOPLASTIC-125 MIL (STOP/DIAG LINES	40	LF		
6271050	HANDICAP SYMBOL – THERMOPLASTIC – 125 MIL	2	EA		
6271074	4" YELLOW SOLID LINE – THERMOPLASTIC – 90 MIL (PVT EDGE LINES)	1783	LF		
6301100	PERMANENT YELLOW PAVEMENT MARKERS BI-DIR.- 4"X4"	12	EA		
6510105	FLAT SHEET, TYPE III, FIXED SZ. & MSG. SIGN	65	SF		
6531210	U-SECTION POST FOR SIGN SUPPORTS - 3P	96	LF		
6651005	F & I - STREET LIGHT - STANDARD FOUNDATION	17	EA		
6651091	FURNISH & INSTALL – SINGLE DECORATIVE POLE	17	EA		
6750213	2.0" SCHEDULE 40 PVC CONDUIT	1890	LF		
6760060	2.0" SCHEDULE 80 HDPE CONDUIT (TRENCHLESS)	192	LF		
6888110	FURNISH & INSTALL - STREET LIGHT LUMINAIRE	17	LF		

BID FORM- GREENLAWN DRIVE STREETScape

PART 1 – Boundary Street to Burnside Street

ITEM	DESCRIPTION	QUANTITY	UNITS	UNIT PRICE	ESTIMATE PRICE
7141133	18" RC PIPE CULVERT - CL V	69	LF		
7143618	18" SMOOTH WALL PIPE	418	LF		
7143624	24" SMOOTH WALL PIPE	86	LF		
7149999	CLEAN EXISTING PIPE	220	LF		
7191005	CATCH BASIN -TYPE 1	1	EA		
7191605	CATCH BASIN -TYPE 16	7	EA		
7191650	CATCH BASIN -TYPE 18	1	EA		
7192020	DROP INLET (24" X 36")	2	EA		
7192109	MANHOLE WITH STANDARD 6' X 6' BOX	1	EA		
7195551	MANUFACTURED STORMWATER TREATMENT DEVICE - TYPE 1	1	EA		
7196173	CATCH BASIN - TYPE 16 (TOP ONLY)	0	EA		
7198392	JUNCTION BOX – CONVERT CB T-16	1	EA		
7203110	CONCRETE CURB & GUTTER (1'-6") VERTICAL FACE	1933	LF		
7204100	CONCRETE SIDEWALK (4" UNIFORM)	794	SY		
7204900	DETECTABLE WARNING MATERIAL	194	SF		
7205000	CONCRETE DRIVEWAY (6" UNIFORM)	166	SY		
7209000	PEDESTRIAN RAMP CONSTRUCTION	216	SY		
8091010	RIGHT OF WAY MARKER (REBAR&CAP)	9	EA		
8091050	RIGHT OF WAY PLAT	0.60	UNIT		
8100100	PERMANENT COVER	0.15	ACRE		
8100200	TEMPORARY COVER	0.15	ACRE		
8104005	FERTILIZER (NITROGEN)	15	LB		
8104010	FERTILIZER (PHOSPHORIC ACID)	15	LB		
8104015	FERTILIZER (POTASH)	15	LB		
8105005	AGRICULTURAL GRANULAR LIME	300	LB		
8109901	MOWING	0.3	ACRE		
8110000	LANDSCAPING ITENM No. 1 -ROOT BARRIER FABRIC (5 OZ)	3595	SF		
8110220	DOUBLE-SHREDDED HARDWOOD MULCH	3595	SF		
811117H	QUERCUS VIRGINIANA (SOUTHERN LIVE OAK)	15	EA		
8111180	CABBAGE PALM TREE (SABAL PALMETTO)	3	EA		
8111371	LIRIOPE MUSCARI 'MAJESTIC' (MAJESTIC LIRIOPE)	392	EA		
8111445	MULHENBERGIA CAPILLARIS (PINK MUHLY GRASS)	35	EA		
8115500	TREE WATERING BAG SYSTEM	18	EA		
8132000	CENTIPEDE GRASSING (SOD)	3438	SF		
8151203	HYDRAULIC EROSION CONTROL PRODUCT (HECP) - Type 3	0.15	ACRE		
8152004	INLET STRUCTURE FILTER - TYPE F (WEIGHTED)	111	LF		
8152006	INLET STRUCTURE FILTER - TYPE F (NON-WEIGHTED)	111	LF		
8153000	SILT FENCE	1298	LF		
8153090	REPLACE/REPAIR SILT FENCE	130	LF		
8154050	REMOVAL OF SILT RETAINED BY SILT FENCE	325	LF		
8156200	CLEANING INLET STRUCTURE FILTERS	10	EA		
8156215	INLET STRUCTURE FILTER – TYPE D2	2	EA		
8156217	FILTER MATERIAL FOR INLET STRUCTURE FILTER -Type-D2	2	EA		

BID FORM- GREENLAWN DRIVE STREETScape

Part 2 – Burnside Street to Greenlawn Circle (North)

ITEM	DESCRIPTION	QUANTITY	UNITS	UNIT PRICE	ESTIMATE PRICE
1031000	MOBILIZATION	1	UNIT		
1032010	BONDS AND INSURANCE	1	UNIT		
1050800	CONSTRUCTION STAKES, LINES & GRADES	1	EA		
1071000	TRAFFIC CONTROL	1	UNIT		
10890200	AS-BUILT CONSTRUCTION PLANS	1	UNIT		
2011001	CLEARING & GRUBBING WITHIN ROADWAY	1	UNIT		
2023000	REMOVAL & DISPOSAL OF EXISTING ASPHALT PAVEMENT	3216	SY		
2031000	UNCLASSIFIED EXCAVATION	201	CY		
2033000	BORROW EXCAVATION	212	CY		
2081001	FINE GRADING	1906	SY		
2103000	FLOWABLE FILL	40	CY		
2021005	REMOVAL & DISPOSAL OF EXISTING CATCH BASIN	1	EA		
20210-10	REMOVAL & DISPOSAL OF EXISTING DROP INLET	0	EA		
3069900	MAINTENANCE STONE	24	TON		
3100320	HOT MIX ASPHALT BASE COURSE – TYPE – ' B'	376	TON		
4011004	LIQUID ASPHALT BINDER PG64-22	46	TON		
4013990	MILLING EXISTING ASPHALT PAVEMENT (VARIABLE)	80	SY		
4020320	HOT MIX ASPHALT INTERMEDIATE COURSE TYPE –'B'	280	TON		
4030340	HOT MIX ASPHALT SURFACE COURSE TYPE –'C'	210	TON		
4030360	HOT MIX ASPHALT SURFACE COURSE TYPE – ' E'	44	TON		
6020005	PERMANENT CONSTRUCTION SIGNS (GROUND MOUNTED)	100	SF		
6250010	4" WHITE SOLID LINES - (PVT. EDGE LINES) – FAST DRY PAINT	1720	LF		
6250015	8" WHITE SOLID LINES - (CROSSWALKS & CHANNELIZATION) – FAST DRY PAINT	460	LF		
6250025	24" WHITE SOLID LINES - (STOP/DIAGONAL LINES) – FAST DRY PAINT	52	LF		
6250050	HANDICAP SYMBOL – FAST DRY PAINT	2	EA		
6250110	4" YELLOW SOLID LINES - (PVT. EDGE LINES & NO PASSING ZONE) – FAST DRY PAINT				
6271010	4" WHITE SOLID LINES) - THERMOPLASTIC- 90 MIL. (PVT. EDGE LINES)	860	LF		
6271015	8" WHITE SOLID LINES THERMOPLASTIC - 125 MIL.	230	LF		
6271025	24" WHITE SOLID LINES) -THERMOPLASTIC-125 MIL (STOP/DIAG LINES	26	LF		
6271050	HANDICAP SYMBOL – THERMOPLASTIC – 125 MIL	2	EA		
6271074	4" YELLOW SOLID LINE – THERMOPLASTIC – 90 MIL (PVT EDGE LINES)	1190	LF		
6301100	PERMANENT YELLOW PAVEMENT MARKERS BI-DIR.- 4"X4"	8	EA		
6510105	FLAT SHEET, TYPE III, FIXED SZ. & MSG. SIGN	44	SF		
6531210	U-SECTION POST FOR SIGN SUPPORTS - 3P	64	LF		
6651005	F & I - STREET LIGHT - STANDARD FOUNDATION	10	EA		
6651091	FURNISH & INSTALL – SINGLE DECORATIVE POLE	10	EA		
6750213	2.0" SCHEDULE 40 PVC CONDUIT	1260	LF		
6760060	2.0" SCHEDULE 80 HDPE CONDUIT (TRENCHLESS)	128	LF		
6888110	FURNISH & INSTALL - STREET LIGHT LUMINAIRE	10	LF		

BID FORM- GREENLAWN DRIVE STREETScape
PART 2 - Burnside Street to Greenlawn Circle (North)

ITEM	DESCRIPTION	QUANTITY	UNITS	UNIT PRICE	ESTIMATE PRICE
7141133	18" RC PIPE CULVERT - CL V	46	LF		
7143618	18" SMOOTH WALL PIPE	278	LF		
7143624	24" SMOOTH WALL PIPE	56	LF		
7149999	CLEAN EXISTING PIPE	146	LF		
7191005	CATCH BASIN -TYPE 1	0	EA		
7191605	CATCH BASIN -TYPE 16	4	EA		
7191650	CATCH BASIN -TYPE 18	1	EA		
7192020	DROP INLET (24" X 36")	1	EA		
7192109	MANHOLE WITH STANDARD 6' X 6' BOX	0	EA		
7195551	MANUFACTURED STORMWATER TREATMENT DEVICE - TYPE 1	0	EA		
7196173	CATCH BASIN - TYPE 16 (TOP ONLY)	1	EA		
7198392	JUNCTION BOX – CONVERT CB T-16	0	EA		
7203110	CONCRETE CURB & GUTTER (1'-6") VERTICAL FACE	1288	LF		
7204100	CONCRETE SIDEWALK (4" UNIFORM)	529	SY		
7204900	DETECTABLE WARNING MATERIAL	128	SF		
7205000	CONCRETE DRIVEWAY (6" UNIFORM)	110	SY		
7209000	PEDESTRIAN RAMP CONSTRUCTION	150	SY		
8091010	RIGHT OF WAY MARKER (REBAR&CAP)	6	EA		
8091050	RIGHT OF WAY PLAT	0.40	UNIT		
8100100	PERMANENT COVER	0.1	ACRE		
8100200	TEMPORARY COVER	0.1	ACRE		
8104005	FERTILIZER (NITROGEN)	10	LB		
8104010	FERTILIZER (PHOSPHORIC ACID)	10	LB		
8104015	FERTILIZER (POTASH)	10	LB		
8105005	AGRICULTURAL GRANULAR LIME	200	LB		
8109901	MOWING	0.2	ACRE		
8110000	LANDSCAPING ITEM No. 1- ROOT BARRIER FABRIC (5 OZ)	3104	SF		
8110220	DOUBLE-SHREDDED HARDWOOD MULCH (3" deep)	3104	SF		
811117H	QUERCUS VIRGINIANA (SOUTHERN LIVE OAK)	10	EA		
8111180	CABBAGE PALM TREE (SABAL PALMETTO)	2	EA		
8111371	LIRIOPE MUSCARI 'MAJESTIC' (MAJESTIC LIRIOPE)	262	EA		
8111445	MULHENBERGIA CAPILLARIS (PINK MUHLY GRASS)	23	EA		
8115500	TREE WATERING BAG SYSTEM	12	EA		
8132000	CENTIPEDE GRASSING (SOD)	3290	SF		
8151203	HYDRAULIC EROSION CONTROL PRODUCT (HECP) - TYPE 3	0.1	ACRE		
8152004	INLET STRUCTURE FILTER - TYPE F (WEIGHTED)	74	LF		
8152006	INLET STRUCTURE FILTER - TYPE F (NON-WEIGHTED)	74	LF		
8153000	SILT FENCE	864	LF		
8153090	REPLACE/REPAIR SILT FENCE	86	LF		
8154050	REMOVAL OF SILT RETAINED BY SILT FENCE	216	LF		
8156200	CLEANING INLET STRUCTURE FILTERS	7	EA		
8156217	FILTER MATERIAL FOR INLET STRUCTURE FILTER – TYPE D2	2	EA		

Section 1.8 - Bid Proposal Documents

SCHEDULE of VALUES

BID FORM - GREENLAWN DRIVE - STREETSCAPE

PART 2 - Burnside Street to Greenlawn Circle (North)

ITEM	DESCRIPTION	QUANTITY	UNITS	UNIT PRICE	ESTIMATE PRICE
8110225	ROOT BARRIER (18" HIGH)	480	LF		
8990097	UTILITY DUCT BANK SYSTEM	816	LF		
9800200	UTILITY DUCT BANK TURNOUT - ELECTRIC (GROUTED)	4	EA		
9800205	UTILITY DUCT BANK TURNOUT - COMMUNICATION (NON-GROUTED)	8	EA		
	PART 2 - PROJECT COST (Grand total, inclusive of all above items)			\$	
	PART 1 - PROJECT COST (Total from preceding bid tab)			\$	
	PROJECT COST (Grand total, Part 1 plus Part 2 totals, above)			\$	

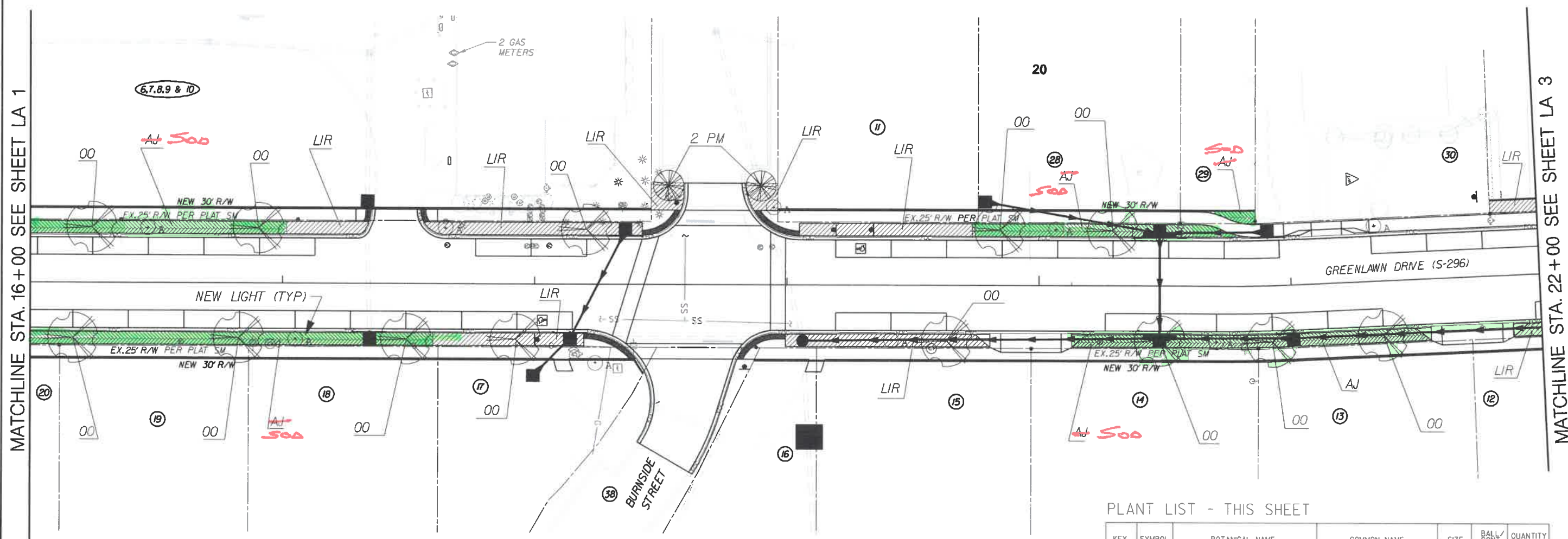
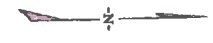

MATCHLINE STA. 16+00 SEE SHEET LA 1

MATCHLINE STA. 22+00 SEE SHEET LA 3

PLANT LIST - THIS SHEET

KEY	SYMBOL	BOTANICAL NAME	COMMON NAME	SIZE	BALL/CONT.	QUANTITY EACH
00		QUERCUS LYRATA <i>QUERCUS LYRATA</i>	Southern Live Oak SOUTHERN LIVE OAK	14'-16'	B & B	13
PM		SABAL PALMETTO	Cabbage Palm Tree	10'-12'	BARE ROOT	2
			Centipede Sod	SF		2545
MG		MUHLENBERGIA CAPILLARIS	PINK MUHLY GRASS	3' O. C.	CONT. 12" X 18"	0
AJ		TRACHELOSPERMUM ASIATICUM	ASIATIC JASMINE	3' O. C.	CONT. 8" X 12"	266
LIR		LIRIOPE MUSCARI	LIRIOPE	3' O. C.	CONT. 8" X 12"	280

NOTE: PLANTING OF TREES, SHRUBS, AND GROUNDCOVERS TO BE DONE FOLLOWING COMPLETION OF CURB AND GUTTER AND SIDEWALK

JE INFRASTRUCTURE CONSULTING & ENGINEERING

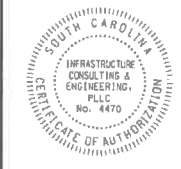

4			
3			
2			
1			
REV. NO.	BY	DATE	DESCRIPTION OF REVISION
DESIGNED BY:	JES	DATE 06/13/2018	
DRAWN BY:	JES	DATE 06/13/2018	
CHECKED BY:	AOL	DATE	

BEAUFORT COUNTY
CITY OF BEAUFORT

GREENLAWN DRIVE (S-296)
LANDSCAPE PLANS

SHEET LA 2 SCALE: 1" = 20'

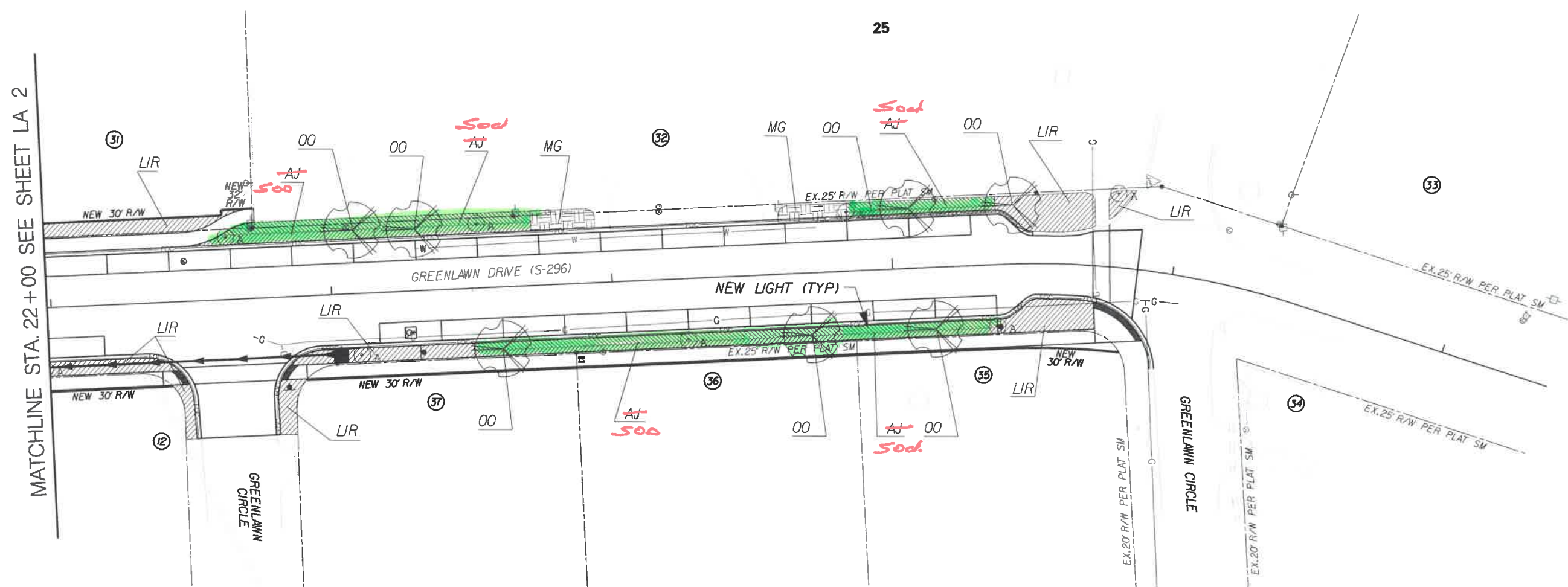

MATCHLINE STA. 22+00 SEE SHEET LA 2

PLANT LIST - THIS SHEET

KEY	SYMBOL	BOTANICAL NAME	COMMON NAME	SIZE	BALL/CONT.	QUANTITY EACH
OO		QUERCUS LYRATA QUERCUS VIRGINIANA	Southern Live Oak Live Oak	14'-16'	B & B	7
PM		SABAL PALMETTO	Cabbage Palm Tree SABAL PALM	10'-12'	BARE ROOT	0
			Certipede Sod	SF		2050
MG		MUHLENBERGIA CAPILLARIS	PINK MUHLY GRASS	3' O. C.	CONT. 12' X 18'	36
AJ		TRACHELOSPERMUM ASIATICUM	ASIATIC JASMINE	3' O. C.	CONT. 8' X 12'	244
LIR		LIRIOPE MUSCARI	LIRIOPE	3' O. C.	CONT. 8' X 12'	163

NOTE: PLANTING OF TREES, SHRUBS, AND GROUNDCOVERS TO BE DONE FOLLOWING COMPLETION OF CURB AND GUTTER AND SIDEWALK

JE INFRASTRUCTURE CONSULTING & ENGINEERING

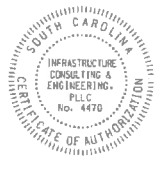

4			
3			
2			
1			
REV. NO.	BY	DATE	DESCRIPTION OF REVISION
DESIGNED BY:	JES	DATE 06/13/2018	
DRAWN BY:	JES	DATE 06/13/2018	
CHECKED BY:	AOL	DATE	

BEAUFORT COUNTY
CITY OF BEAUFORT

GREENLAWN DRIVE (S-296)
LANDSCAPE PLANS

SHEET LA 3 SCALE: 1" = 20'

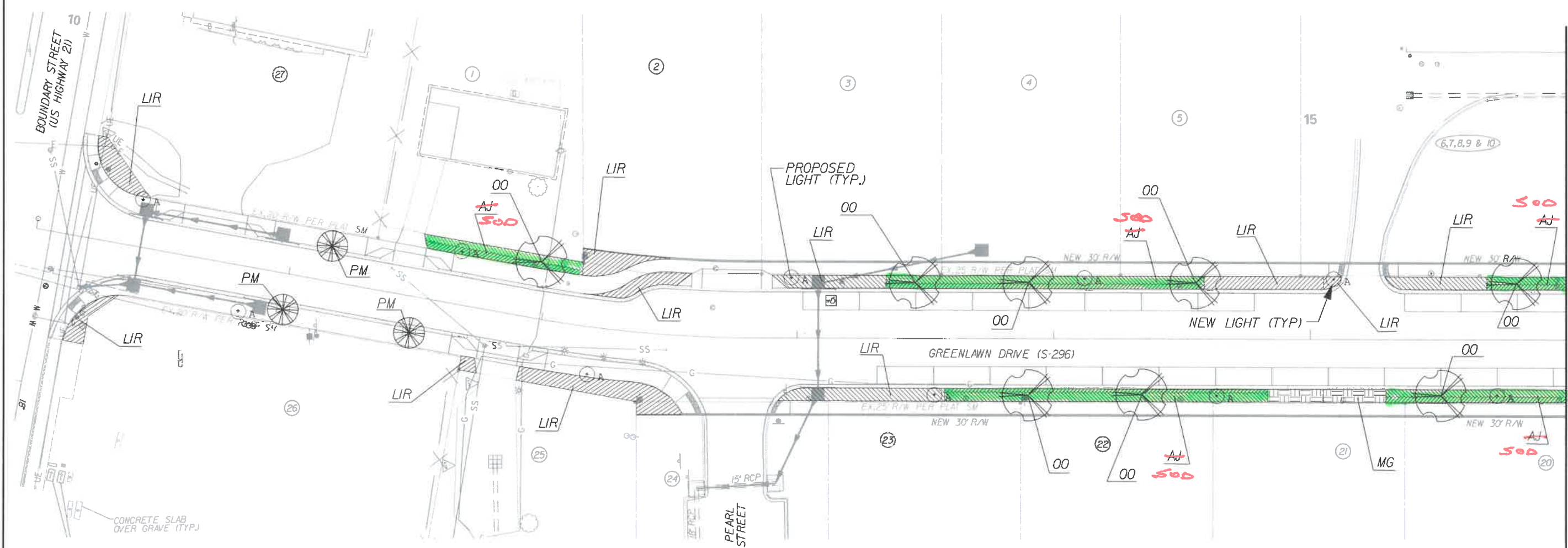
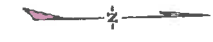

MATCHLINE STA. 16+00 SEE SHEET LA 2

PLANT LIST - THIS SHEET

KEY	SYMBOL	BOTANICAL NAME	COMMON NAME	SIZE	BALL/CONT.	QUANTITY EACH
OO		QUERCUS LYRATA	Southern Live Oak	14'-16'	B & B	8
PM		SABAL PALMETTO	Cabbage Palm Tree	10'-12'	BARE ROOT	3
			SOD	SF		2133
MG		MUHLENBERGIA CAPILLARIS	PINK MUHLY GRASS	3' O. C.	CONT. 12" X 18"	22
AJ		TRACHELOSPERMUM ASIATICUM	ASIATIC JASMINE	3' O. C.	CONT. 8" X 12"	185
LIR		LIRIOPE MUSCARI	LIRIOPE	3' O. C.	CONT. 8" X 12"	211

NOTE: PLANTING OF TREES, SHRUBS, AND GROUNDCOVERS TO BE DONE FOLLOWING COMPLETION OF CURB AND GUTTER AND SIDEWALK

JE INFRASTRUCTURE CONSULTING & ENGINEERING



4			
3			
2			
1			
REV. NO.	BY	DATE	DESCRIPTION OF REVISION
DESIGNED BY:	JES	DATE 06/13/2018	
DRAWN BY:	JES	DATE 06/13/2018	
CHECKED BY:	ACL	DATE	

BEAUFORT COUNTY
CITY OF BEAUFORT

GREENLAWN DRIVE (S-296)
LANDSCAPE PLANS

SHEET LA 1 SCALE: 1" = 20'

SECTION 6.2 - GENERAL SPECIAL PROVISIONS (Cont'd)

during the progress of the work. Upon completion of the work, leave all ditches, channels, drains, pipes, structures, and work, etc in clean and neat conditions.

C. On or before the completion of the work, unless otherwise directed or permitted in writing, tear down all temporary buildings and structures built by the Contractor for his own use. Remove all temporary works, tools, and machinery or other construction equipment furnished by Contractor. Remove all rubbish from any grounds which have been occupied by the Contractor; leave the roads and all parts of the premises and adjacent property affected by Contractor's operations in a neat and satisfactory condition.

D. Remove, acceptably disinfect, and cover all organic matter and materials containing organic matter in, under and around all privies, houses, and other buildings used.

E. Restore or replace, when and as directed, any public or private property damaged by Contractor's work, equipment, or employees, to a condition at least equal to that existing immediately prior to the beginning of the operations. Perform, as required, all necessary highway or driveway reshaping of shoulders and ditches, walks and landscaping work. Use suitable materials, equipment and methods for such restoration. The Contractor shall be responsible for obtaining releases from the various property owners, stating that all restoration work is satisfactory.

16. Landscaping – Trees & Plants

16.1 Landscape Specifications - Trees

A. General

1. All specified trees to be B&B. Any trees displaying girdling or circling roots, poor branching structure, recent pruning cuts, wounds, etc. will be rejected on site. Awarded Contractor to provide nursery source information to City Landscape Architect prior to digging of trees. Photos of trees selected provided at time of bid submittal are appreciated.
2. Soil to be removed from top of rootball as needed to expose root flare **prior** to digging of tree pit.
3. Tree pit to be excavated to a depth not exceeding depth of measured rootball, less 2 inches. Bottom of tree pit must remain undisturbed.
4. Trees to be planted 2" above finish grade.
5. Berm, forming tree saucer to be formed at outer edge of rootball. Saucer and berm to be mulched with 3" layer double shredded hardwood mulch.
6. All trees to be staked following installation.

16.2 Installation-Trees

A. General-Trees

1. All trees to meet or exceed ANSI Z60.1 standards for caliper, height, spread and quality.
2. Trees to be **Quercus Virginiana (Southern Live Oak)**, unless otherwise specified elsewhere herein, with a minimum 2.5" caliper thickness at DBH. All trees to match in height of clear trunk from grade to lowest branching point.
3. Excavate planting hole for trees at least two times the diameter of the rootball and 2" shallower than the root ball. Contractor responsible to contact City Landscape Architect for inspection of tree planting holes prior to actual tree planting.
4. Each tree to receive 3 bags mushroom compost (approximately 3 cubic feet total) incorporated into existing excavated soil from tree pit. This material to be utilized in the top half of root ball area.
5. Handle tree only by root ball. After placement of tree in planting hole and backfilling to no more than ½ the depth of the root ball, saturate the planting hole with water to aid removal of air from backfill. Remove all wire and burlap from top 50% of ball and any circling roots. Complete the backfill and thoroughly saturate with water.

**SECTION 6.2 - GENERAL SPECIAL PROVISIONS
(Cont'd)**

6. Trees to display a 4' x 5' rectangle of 3" depth double shredded hardwood mulch. No mulch shall be placed within 2" of tree trunk. All tree and plant bed areas to be mulched with a 3" layer of double shredded hardwood mulch. Total quantity of mulch required shall be based upon the area of plantings as measured in square feet (SF)
 7. Tree lawn: Remove all rubble, debris, trash, etc. as found in top 12" of tree lawn area. Incorporate and till to a 6" depth, a 2" layer of topsoil, removing existing soil as needed to allow topsoil addition. Grade to a consistent 1" below top of sidewalk and roll. Topsoil to be approved by City Landscape Architect prior to delivery to site.
- B. Tree Planting Specifications
1. Plantings shall be installed to current industry standards (ANSI A300 Part 6) and the published Best Management Practices of the International Society of Arboriculture.
 2. These specifications are guided by the American National Standard for Tree Care Operations, ANSI A300 Part 6: *Tree, Shrub and Other Woody Plant Maintenance— Standard Practices (Transplanting)* and Part 3 (*Supplemental Support Systems*).
 3. The "planting area" includes the root ball, hole, backfill, and outside rim of the berm (if applicable) to a minimum diameter of three times the root ball diameter.
 4. The soil in the planting area will be tilled or otherwise aerated to a depth of at least 12 inches to a diameter at least two times the diameter of the root ball or container and amended with mushroom compost as specified elsewhere herein. Amended soil to be restricted to top 1/3 of root ball.
 5. The planting hole shall be dug no deeper than two inches less than the depth of the root ball, defined as the distance from the topmost primary roots to the bottom of the rooted area with the container or root ball.
Note: Contractor shall inspect and reveal tree root flare, if necessary, prior to depth determination of root ball and resulting depth of planting hole.
 6. Any circling roots or kinked roots will be cut smoothly using a sharp knife or pruner. The root system shall be inspected for kinked, circling or girdling roots and root defects shall be corrected prior to planting. If significant root pruning must be done to correct such problems, the tree shall be rejected.
 7. The tree shall be placed in the hole two inches higher than the depth of the root ball, as defined above. Under no circumstances should the trees be planted any deeper than the depth of the root ball.
 8. Fertilizer will not be used at planting time.
 9. The tree shall be set on undisturbed or compacted soil, to reduce settling.
 10. Maintain the tree with forks in a straight and plumb position while backfilling to no more than ½ the depth of the root ball.
 11. Saturate the planting hole with water after backfill is ½ complete to aid removal of air from the backfill.
 12. After initial backfill, watering and the tree is plumb, then add backfill as specified to just below the top horizontal ring of the wire basket, completely saturating planting hole.
 13. Remove all trunk wraps, labels, supporting stakes, ties, twine, etc. and top portion of the wire basket down to and including the first horizontal ring and the burlap from the top portion of the root ball.
 14. Immediately after backfill has settled and the tree is straight and plumb, stake tree using soft strapping material such as Arbor-tie.

**SECTION 6.2 - GENERAL SPECIAL PROVISIONS
(Cont'd)**

15. Berms shall be constructed around the perimeter of the root ball, to a compacted height of 3 to 4 inches and covered with mulch.
16. A three-inch layer of shredded double shredded hardwood mulch shall be placed over the planting area from the outside of the berm to just outside of the base of the trunk. Do not place mulch against the trunk.

C. Palm Trees

1. All palm trees shall be nursery grown or farm cultivated and be accompanied by a shipping invoice clearly stating their location of origin.
2. Plantings provided for project shall conform as to size and shape indicated in the plant list in the contract documents.
3. Installation of all plantings shall be consistent with the requirements provided in the contract documents. (Details and General Notes on Sheet L4 of the Plans) and shall be done in accordance with minimum accepted industry standards and practices.

D. Plantings

1. All plantings shall be nursery grown and be accompanied by a shipping invoice clearly stating their location of origin.
2. Plantings provided for project shall conform as to size and shape indicated in the plant list in the contract documents.
3. Installation of all plantings shall be consistent with the requirements provided in the contract documents. (Details and General Notes on Sheet L4 of the Plans) and shall be done in accordance with minimum accepted industry standards and practices.
4. Per Article 19 of the General Notes on sheet L4 of the plans in the contract documents, all plant beds shall receive a weed barrier fabric of no less than 5 oz weight per square foot prior to the placement of plantings, unless otherwise directed or amended in writing by the Owner's Landscape Architect or Representative.
5. The weed barrier fabric shall be DeWitt Pro 5 Weed Barrier or approved equal, consisting of a 5.0 oz. woven, needle-punched polypropylene fabric.

E. Grass/Sod

1. Install Centipede sod, as shown, in areas on landscaping plans in the contract documents as and where noted.
2. Soil surface to be thoroughly raked and removal of all stones, loose debris and deleterious materials completed prior to the placement of sod. Owner or Owner's representative reserves the right to inspect and sign-off on prepared sod beds prior to the placement of sod.
3. As part of preparing the bedding area for sod, it shall be uniformly level in all directions, free of high or low areas, provide for positive drainage and it shall be rolled to remove all depressions prior to the placement of sod.
4. Sod is to be thoroughly soaked and rolled following installation. Any depressions following initial rolling are to be repaired through removal of sod, filling with topsoil to grade and restoration of sod. Reroll repaired/remediated areas immediately upon their being addressed.
5. Joints: Apply clean Builders sand in sufficient quantities following installation and complete rolling process to completely fill joints and seams.

**SECTION 6.2 - GENERAL SPECIAL PROVISIONS
(Cont'd)**

16.3 MEASUREMENT

- A. The quantity for **Quercus Virginiana (Southern Live Oak)** is measured by Each (EA), as noted in the Schedule of Values [Section 1.8], complete, in place and accepted in accordance with the Contract Documents which include by reference the Project's Plans and Specifications.
- B. The quantity for **Cabbage Palm Tree (Sabal Palmetto)** is measured by Each (EA), as noted in the Schedule of Values [Section 1.8], complete, in place and accepted in accordance with the Contract Documents which include by reference the Project's Plans and Specifications.
- C. The quantity for **Liriope Muscari "Majestic" (Majestic Liriope)** is measured by Each (EA), as noted in the Schedule of Values [Section 1.8], complete, in place and accepted in accordance with the Contract Documents which include by reference the Project's Plans and Specifications.
- D. The quantity for **Muhlenbergia Capillaris (Pink Muhly Grass)** is measured by Each (EA), as noted in the Schedule of Values [Section 1.8], complete, in place and accepted in accordance with the Contract Documents which include by reference the Project's Plans and Specifications.
- E. The quantity for approved **Weed Barrier Fabric** is measured by the **Square Foot (SF)**, as noted in the Schedule of Values [Section 1.8], complete, in place and accepted in accordance with the Contract Documents which include by reference the Project's Plans and Specifications.
- F. The quantity for **Centipede Sod** is measured by the **Square Foot (SF)**, as noted in the Schedule of Values [Section 1.8], complete, in place and accepted in accordance with the Contract Documents which included by reference the Project's Plans and Specifications.

16.4 PAYMENT

- A. Payment for the accepted quantity for **Quercus Virginiana (Southern Live Oak)**, measured in accordance with Subsection 16.3 (above), is determined using the contract unit price, as bid, for such items of the size and type specified, or;
- B. Payment for the accepted quantity for **Cabbage Palm Tree (Sabal Palmetto)**, measured in accordance with Subsection 16.3 (above), is determined using the contract unit price, as bid, for such items of the size and type specified, or as;
- C. Payment for the accepted quantity for **Liriope Muscari "Majestic" (Majestic Liriope)**, measured in accordance with Subsection 16.3 (above), is determined using the contract unit price, as bid, for such items of the size and type specified, or as;
- D. Payment for the accepted quantity for **Muhlenbergia Capillaris (Pink Muhly Grass)**, measured in accordance with Subsection 16.3 (above), is determined using the contract unit price, as bid, for such items of the size and type specified, or as;
- E. Payment for the accepted quantity for **Weed Fabric Barrier**, measured in accordance with Subsection 16.3 (above), is determined using the contract unit price, as bid, for such items of the size and type specified, or as;
- F. Payment for the accepted quantity for **Centipede Sod**, measured in accordance with Subsection 16.3 (above), is determined using the contract unit price, as bid, for such items of the size and type specified, or as;
- G. As may be specified elsewhere in the contract documents.
- H. Payment for items A through F above is full compensation for procuring, delivery, site preparation, installation and maintenance (until final contract payment has been completed) as specified or as directed and includes furnishing and placing specified materials, excavating; providing and placing bedding material and backfilling; disposing of surplus material; and all other materials, labor, equipment, tools, supplies, transportation, and incidentals necessary to fulfill the requirements of the pay item in accordance with the Project's Plans, the Specifications, in accordance with Industry Standards and other terms of the Contract.

BID FORM- GREENLAWN DRIVE STREETScape

PART 1 – Boundary Street to Burnside Street

ITEM	DESCRIPTION	QUANTITY	UNITS	UNIT PRICE	ESTIMATE PRICE
1031000	MOBILIZATION	1	UNIT		
1032010	BONDS AND INSURANCE	1	UNIT		
1050800	CONSTRUCTION STAKES, LINES & GRADES	1	EA		
1071000	TRAFFIC CONTROL	1	UNIT		
10890200	AS-BUILT CONSTRUCTION PLANS	1	UNIT		
2011001	CLEARING & GRUBBING WITHIN ROADWAY	1	UNIT		
2023000	REMOVAL & DISPOSAL OF EXISTING ASPHALT PAVEMENT	0	SY		
2031000	UNCLASSIFIED EXCAVATION	302	CY		
2033000	BORROW EXCAVATION	320	CY		
2081001	FINE GRADING	2861	SY		
2103000	FLOWABLE FILL	60	CY		
2021005	REMOVAL & DISPOSAL OF EXISTING CATCH BASIN	1	EA		
20210-10	REMOVAL & DISPOSAL OF EXISTING DROP INLET	2	EA		
3069900	MAINTENANCE STONE	38	TON		
3100320	HOT MIX ASPHALT BASE COURSE – TYPE –' B'	565	TON		
4011004	LIQUID ASPHALT BINDER PG64-22	71	TON		
4013990	MILLING EXISTING ASPHALT PAVEMENT (VARIABLE)	120	SY		
4020320	HOT MIX ASPHALT INTERMEDIATE COURSE TYPE –'B'	421	TON		
4030340	HOT MIX ASPHALT SURFACE COURSE TYPE –'C'	315	TON		
4030360	HOT MIX ASPHALT SURFACE COURSE TYPE –' E'	68	TON		
6020005	PERMANENT CONSTRUCTION SIGNS (GROUND MOUNTED)	148	SF		
6250010	4" WHITE SOLID LINES - (PVT. EDGE LINES) – FAST DRY PAINT	2584	LF		
6250015	8" WHITE SOLID LINES - (CROSSWALKS & CHANNELIZATION) – FAST DRY PAINT	688	LF		
6250025	24" WHITE SOLID LINES - (STOP/DIAGONAL LINES) – FAST DRY PAINT	80	LF		
6250050	HANDICAP SYMBOL – FAST DRY PAINT	2	EA		
6250110	4" YELLOW SOLID LINES - (PVT. EDGE LINES & NO PASSING ZONE) – FAST DRY PAINT	3568			
6271010	4" WHITE SOLID LINES) - THERMOPLASTIC- 90 MIL. (PVT. EDGE LINES)	1292	LF		
6271015	8" WHITE SOLID LINES THERMOPLASTIC - 125 MIL.	344	LF		
6271025	24" WHITE SOLID LINES) -THERMOPLASTIC-125 MIL (STOP/DIAG LINES	40	LF		
6271050	HANDICAP SYMBOL – THERMOPLASTIC – 125 MIL	2	EA		
6271074	4" YELLOW SOLID LINE – THERMOPLASTIC – 90 MIL (PVT EDGE LINES)	1783	LF		
6301100	PERMANENT YELLOW PAVEMENT MARKERS BI-DIR.- 4"X4"	12	EA		
6510105	FLAT SHEET, TYPE III, FIXED SZ. & MSG. SIGN	65	SF		
6531210	U-SECTION POST FOR SIGN SUPPORTS - 3P	96	LF		
6651005	F & I - STREET LIGHT - STANDARD FOUNDATION	17	EA		
6651091	FURNISH & INSTALL – SINGLE DECORATIVE POLE	17	EA		
6750213	2.0" SCHEDULE 40 PVC CONDUIT	1890	LF		
6760060	2.0" SCHEDULE 80 HDPE CONDUIT (TRENCHLESS)	192	LF		
6888110	FURNISH & INSTALL - STREET LIGHT LUMINAIRE	17	LF		

BID FORM- GREENLAWN DRIVE STREETScape

PART 1 – Boundary Street to Burnside Street

ITEM	DESCRIPTION	QUANTITY	UNITS	UNIT PRICE	ESTIMATE PRICE
7141133	18" RC PIPE CULVERT - CL V	69	LF		
7143618	18" SMOOTH WALL PIPE	418	LF		
7143624	24" SMOOTH WALL PIPE	86	LF		
7149999	CLEAN EXISTING PIPE	220	LF		
7191005	CATCH BASIN -TYPE 1	1	EA		
7191605	CATCH BASIN -TYPE 16	7	EA		
7191650	CATCH BASIN -TYPE 18	1	EA		
7192020	DROP INLET (24" X 36")	2	EA		
7192109	MANHOLE WITH STANDARD 6' X 6' BOX	1	EA		
7195551	MANUFACTURED STORMWATER TREATMENT DEVICE - TYPE 1	1	EA		
7196173	CATCH BASIN - TYPE 16 (TOP ONLY)	0	EA		
7198392	JUNCTION BOX – CONVERT CB T-16	1	EA		
7203110	CONCRETE CURB & GUTTER (1'-6") VERTICAL FACE	1933	LF		
7204100	CONCRETE SIDEWALK (4" UNIFORM)	794	SY		
7204900	DETECTABLE WARNING MATERIAL	194	SF		
7205000	CONCRETE DRIVEWAY (6" UNIFORM)	166	SY		
7209000	PEDESTRIAN RAMP CONSTRUCTION	216	SY		
8091010	RIGHT OF WAY MARKER (REBAR&CAP)	9	EA		
8091050	RIGHT OF WAY PLAT	0.60	UNIT		
8100100	PERMANENT COVER	0.15	ACRE		
8100200	TEMPORARY COVER	0.15	ACRE		
8104005	FERTILIZER (NITROGEN)	15	LB		
8104010	FERTILIZER (PHOSPHORIC ACID)	15	LB		
8104015	FERTILIZER (POTASH)	15	LB		
8105005	AGRICULTURAL GRANULAR LIME	300	LB		
8109901	MOWING	0.3	ACRE		
8110000	LANDSCAPING ITENM No. 1 -ROOT BARRIER FABRIC (5 OZ)	3595	SF		
8110220	DOUBLE-SHREDEDDED HARDWOOD MULCH	3595	SF		
811117H	QUERCUS VIRGINIANA (SOUTHERN LIVE OAK)	15	EA		
8111180	CABBAGE PALM TREE (SABAL PALMETTO)	3	EA		
8111371	LIRIOPE MUSCARI 'MAJESTIC' (MAJESTIC LIRIOPE)	392	EA		
8111445	MULHENBERGIA CAPILLARIS (PINK MUHLY GRASS)	35	EA		
8115500	TREE WATERING BAG SYSTEM	18	EA		
8132000	CENTIPEDE GRASSING (SOD)	3438	SF		
8151203	HYDRAULIC EROSION CONTROL PRODUCT (HECP) - Type 3	0.15	ACRE		
8152004	INLET STRUCTURE FILTER - TYPE F (WEIGHTED)	111	LF		
8152006	INLET STRUCTURE FILTER - TYPE F (NON-WEIGHTED)	111	LF		
8153000	SILT FENCE	1298	LF		
8153090	REPLACE/REPAIR SILT FENCE	130	LF		
8154050	REMOVAL OF SILT RETAINED BY SILT FENCE	325	LF		
8156200	CLEANING INLET STRUCTURE FILTERS	10	EA		
8156215	INLET STRUCTURE FILTER – TYPE D2	2	EA		
8156217	FILTER MATERIAL FOR INLET STRUCTURE FILTER -Type-D2	2	EA		

BID FORM- GREENLAWN DRIVE STREETScape

Part 2 – Burnside Street to Greenlawn Circle (North)

ITEM	DESCRIPTION	QUANTITY	UNITS	UNIT PRICE	ESTIMATE PRICE
1031000	MOBILIZATION	1	UNIT		
1032010	BONDS AND INSURANCE	1	UNIT		
1050800	CONSTRUCTION STAKES, LINES & GRADES	1	EA		
1071000	TRAFFIC CONTROL	1	UNIT		
10890200	AS-BUILT CONSTRUCTION PLANS	1	UNIT		
2011001	CLEARING & GRUBBING WITHIN ROADWAY	1	UNIT		
2023000	REMOVAL & DISPOSAL OF EXISTING ASPHALT PAVEMENT	3216	SY		
2031000	UNCLASSIFIED EXCAVATION	201	CY		
2033000	BORROW EXCAVATION	212	CY		
2081001	FINE GRADING	1906	SY		
2103000	FLOWABLE FILL	40	CY		
2021005	REMOVAL & DISPOSAL OF EXISTING CATCH BASIN	1	EA		
20210-10	REMOVAL & DISPOSAL OF EXISTING DROP INLET	0	EA		
3069900	MAINTENANCE STONE	24	TON		
3100320	HOT MIX ASPHALT BASE COURSE – TYPE –‘ B’	376	TON		
4011004	LIQUID ASPHALT BINDER PG64-22	46	TON		
4013990	MILLING EXISTING ASPHALT PAVEMENT (VARIABLE)	80	SY		
4020320	HOT MIX ASPHALT INTERMEDIATE COURSE TYPE –‘B’	280	TON		
4030340	HOT MIX ASPHALT SURFACE COURSE TYPE –‘C’	210	TON		
4030360	HOT MIX ASPHALT SURFACE COURSE TYPE –‘ E’	44	TON		
6020005	PERMANENT CONSTRUCTION SIGNS (GROUND MOUNTED)	100	SF		
6250010	4" WHITE SOLID LINES - (PVT. EDGE LINES) – FAST DRY PAINT	1720	LF		
6250015	8" WHITE SOLID LINES - (CROSSWALKS & CHANNELIZATION) – FAST DRY PAINT	460	LF		
6250025	24" WHITE SOLID LINES - (STOP/DIAGONAL LINES) – FAST DRY PAINT	52	LF		
6250050	HANDICAP SYMBOL – FAST DRY PAINT	2	EA		
6250110	4" YELLOW SOLID LINES - (PVT. EDGE LINES & NO PASSING ZONE) – FAST DRY PAINT				
6271010	4" WHITE SOLID LINES) - THERMOPLASTIC- 90 MIL. (PVT. EDGE LINES)	860	LF		
6271015	8" WHITE SOLID LINES THERMOPLASTIC - 125 MIL.	230	LF		
6271025	24" WHITE SOLID LINES) -THERMOPLASTIC-125 MIL (STOP/DIAG LINES	26	LF		
6271050	HANDICAP SYMBOL – THERMOPLASTIC – 125 MIL	2	EA		
6271074	4" YELLOW SOLID LINE – THERMOPLASTIC – 90 MIL (PVT EDGE LINES)	1190	LF		
6301100	PERMANENT YELLOW PAVEMENT MARKERS BI-DIR. - 4"X4"	8	EA		
6510105	FLAT SHEET, TYPE III, FIXED SZ. & MSG. SIGN	44	SF		
6531210	U-SECTION POST FOR SIGN SUPPORTS - 3P	64	LF		
6651005	F & I - STREET LIGHT - STANDARD FOUNDATION	10	EA		
6651091	FURNISH & INSTALL – SINGLE DECORATIVE POLE	10	EA		
6750213	2.0" SCHEDULE 40 PVC CONDUIT	1260	LF		
6760060	2.0" SCHEDULE 80 HDPE CONDUIT (TRENCHLESS)	128	LF		
6888110	FURNISH & INSTALL - STREET LIGHT LUMINAIRE	10	LF		

BID FORM- GREENLAWN DRIVE STREETScape

PART 2 - Burnside Street to Greenlawn Circle (North)

ITEM	DESCRIPTION	QUANTITY	UNITS	UNIT PRICE	ESTIMATE PRICE
7141133	18" RC PIPE CULVERT - CL V	46	LF		
7143618	18" SMOOTH WALL PIPE	278	LF		
7143624	24" SMOOTH WALL PIPE	56	LF		
7149999	CLEAN EXISTING PIPE	146	LF		
7191005	CATCH BASIN -TYPE 1	0	EA		
7191605	CATCH BASIN -TYPE 16	4	EA		
7191650	CATCH BASIN -TYPE 18	1	EA		
7192020	DROP INLET (24" X 36")	1	EA		
7192109	MANHOLE WITH STANDARD 6' X 6' BOX	0	EA		
7195551	MANUFACTURED STORMWATER TREATMENT DEVICE - TYPE 1	0	EA		
7196173	CATCH BASIN - TYPE 16 (TOP ONLY)	1	EA		
7198392	JUNCTION BOX – CONVERT CB T-16	0	EA		
7203110	CONCRETE CURB & GUTTER (1'-6") VERTICAL FACE	1288	LF		
7204100	CONCRETE SIDEWALK (4" UNIFORM)	529	SY		
7204900	DETECTABLE WARNING MATERIAL	128	SF		
7205000	CONCRETE DRIVEWAY (6" UNIFORM)	110	SY		
7209000	PEDESTRIAN RAMP CONSTRUCTION	150	SY		
8091010	RIGHT OF WAY MARKER (REBAR&CAP)	6	EA		
8091050	RIGHT OF WAY PLAT	0.40	UNIT		
8100100	PERMANENT COVER	0.1	ACRE		
8100200	TEMPORARY COVER	0.1	ACRE		
8104005	FERTILIZER (NITROGEN)	10	LB		
8104010	FERTILIZER (PHOSPHORIC ACID)	10	LB		
8104015	FERTILIZER (POTASH)	10	LB		
8105005	AGRICULTURAL GRANULAR LIME	200	LB		
8109901	MOWING	0.2	ACRE		
8110000	LANDSCAPING ITEM No. 1- ROOT BARRIER FABRIC (5 OZ)	3104	SF		
8110220	DOUBLE-SHREDDED HARDWOOD MULCH (3" deep)	3104	SF		
811117H	QUERCUS VIRGINIANA (SOUTHERN LIVE OAK)	10	EA		
8111180	CABBAGE PALM TREE (SABAL PALMETTO)	2	EA		
8111371	LIRIOPE MUSCARI 'MAJESTIC' (MAJESTIC LIRIOPE)	262	EA		
8111445	MULHENBERGIA CAPILLARIS (PINK MUHLY GRASS)	23	EA		
8115500	TREE WATERING BAG SYSTEM	12	EA		
8132000	CENTIPEDE GRASSING (SOD)	3290	SF		
8151203	HYDRAULIC EROSION CONTROL PRODUCT (HECP) - TYPE 3	0.1	ACRE		
8152004	INLET STRUCTURE FILTER - TYPE F (WEIGHTED)	74	LF		
8152006	INLET STRUCTURE FILTER - TYPE F (NON-WEIGHTED)	74	LF		
8153000	SILT FENCE	864	LF		
8153090	REPLACE/REPAIR SILT FENCE	86	LF		
8154050	REMOVAL OF SILT RETAINED BY SILT FENCE	216	LF		
8156200	CLEANING INLET STRUCTURE FILTERS	7	EA		
8156217	FILTER MATERIAL FOR INLET STRUCTURE FILTER – TYPE D2	2	EA		

Section 1.8 - Bid Proposal Documents

SCHEDULE of VALUES

BID FORM - GREENLAWN DRIVE - STREETScape

PART 2 - Burnside Street to Greenlawn Circle (North)

ITEM	DESCRIPTION	QUANTITY	UNITS	UNIT PRICE	ESTIMATE PRICE
8110225	ROOT BARRIER (18" HIGH)	480	LF		
8990097	UTILITY DUCT BANK SYSTEM	816	LF		
9800200	UTILITY DUCT BANK TURNOUT - ELECTRIC (GROUTED)	4	EA		
9800205	UTILITY DUCT BANK TURNOUT - COMMUNICATION (NON-GROUTED)	8	EA		
	PART 2 - PROJECT COST (Grand total, inclusive of all above items)			\$	
	PART 1 - PROJECT COST (Total from preceding bid tab)			\$	
	PROJECT COST (Grand total, Part 1 plus Part 2 totals, above)			\$	

