

KEY PLAN

- GYPSUM DECK SECTIONS
- STEEL DECK SECTIONS
- ASPHALT SHINGLE SECTIONS
- STANDING SEAM METAL SECTIONS
- EXTERIOR CANOPIES

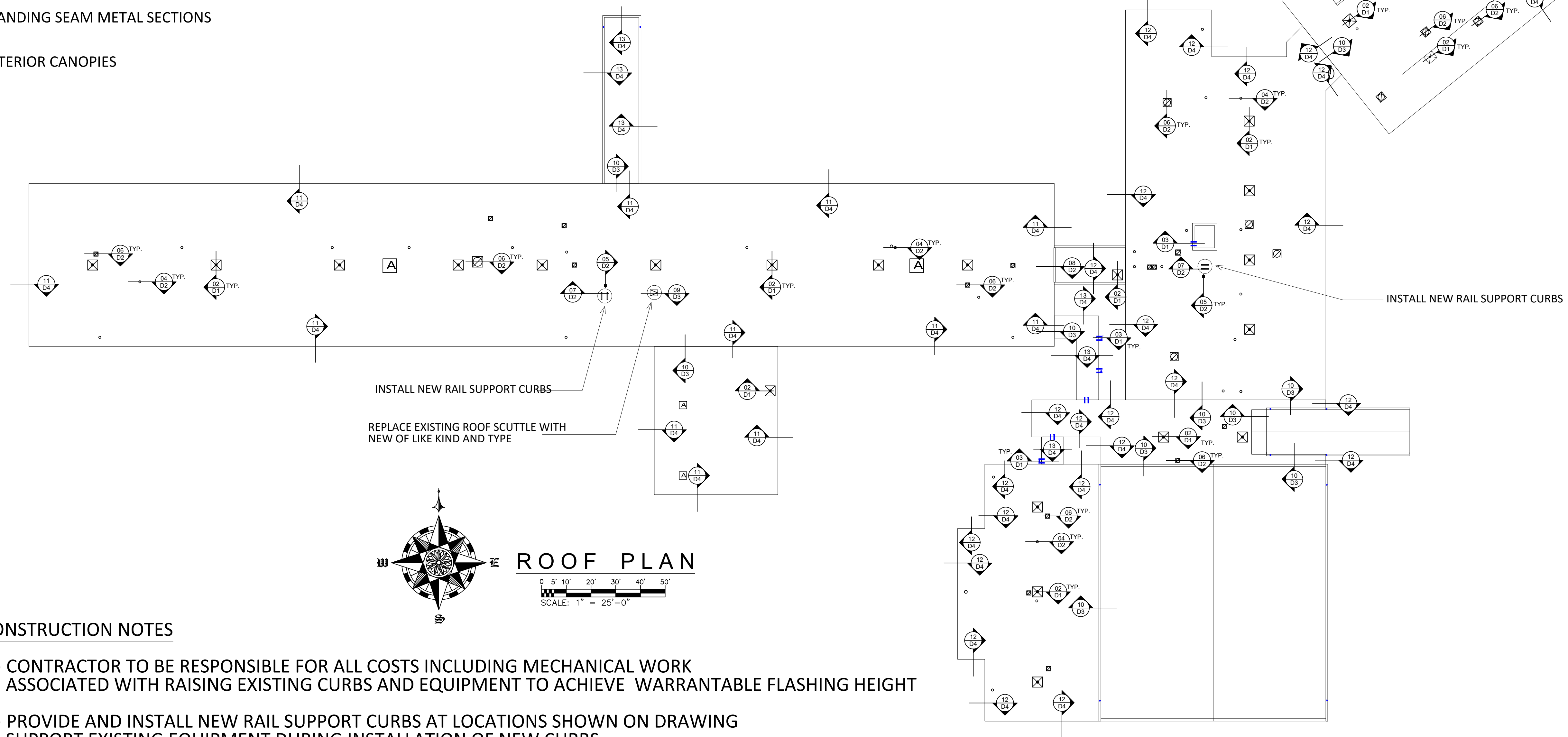

ROOF PLAN

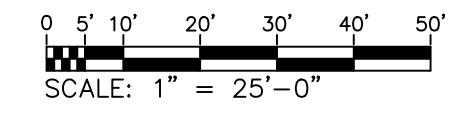

CONSTRUCTION NOTES

- 1.) CONTRACTOR TO BE RESPONSIBLE FOR ALL COSTS INCLUDING MECHANICAL WORK ASSOCIATED WITH RAISING EXISTING CURBS AND EQUIPMENT TO ACHIEVE WARRANTABLE FLASHING HEIGHT
- 2.) PROVIDE AND INSTALL NEW RAIL SUPPORT CURBS AT LOCATIONS SHOWN ON DRAWING SUPPORT EXISTING EQUIPMENT DURING INSTALLATION OF NEW CURBS
- 3.) PROVIDE AND INSTALL NEW 4" CAST IRON DRAIN AT LOCATION SHOWN ON DRAWING TIE INTO ADJACENT DRAIN PIPING
- 4.) PROVIDE AND INSTALL PROTECTIVE NEW WALKPADS UNDER SATELLITE DISHES AND AT ALL ROOF ACCESS POINTS
- 5.) CONSTRUCT CRICKETS BEHIND VENTILATORS ON SHINGLE ROOF SECTION

SYMBOL LEGEND

	PLUMBING VENT (SOIL STACK)	A	ABANDONED		ROOF DRAIN
	PITCH PANS		ROOF HATCH		EXHAUST FAN
	EQUIPMENT SUPPORT		EXPANSION/CONTROL JOINT		PARAPET
	SATELLITE DISH		DETAIL No.		

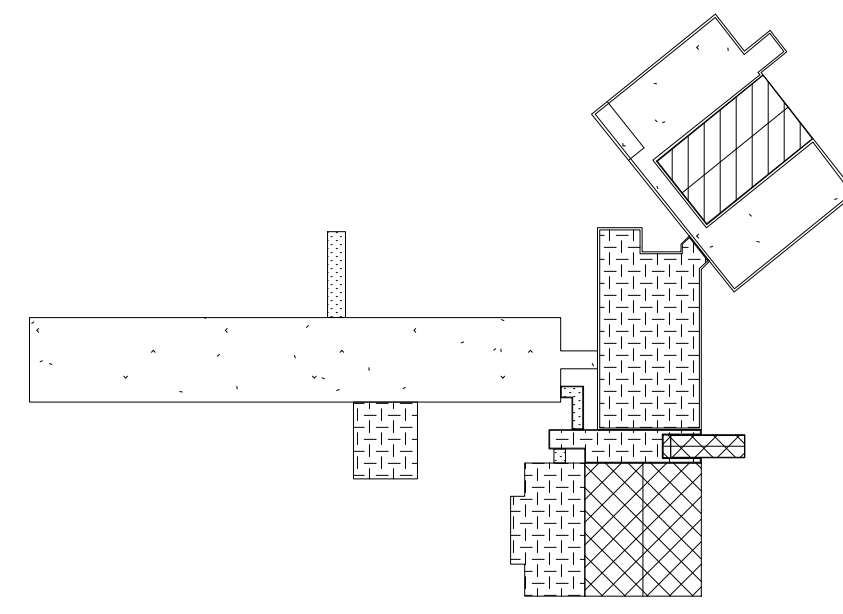

KEY PLAN

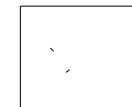
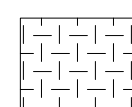
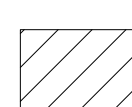
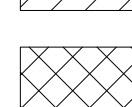
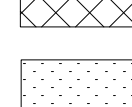
-  GYPSUM DECK SECTIONS
-  STEEL DECK SECTIONS
-  ASPHALT SHINGLE SECTIONS
-  STANDING SEAM METAL SECTIONS
-  EXTERIOR CANOPIES

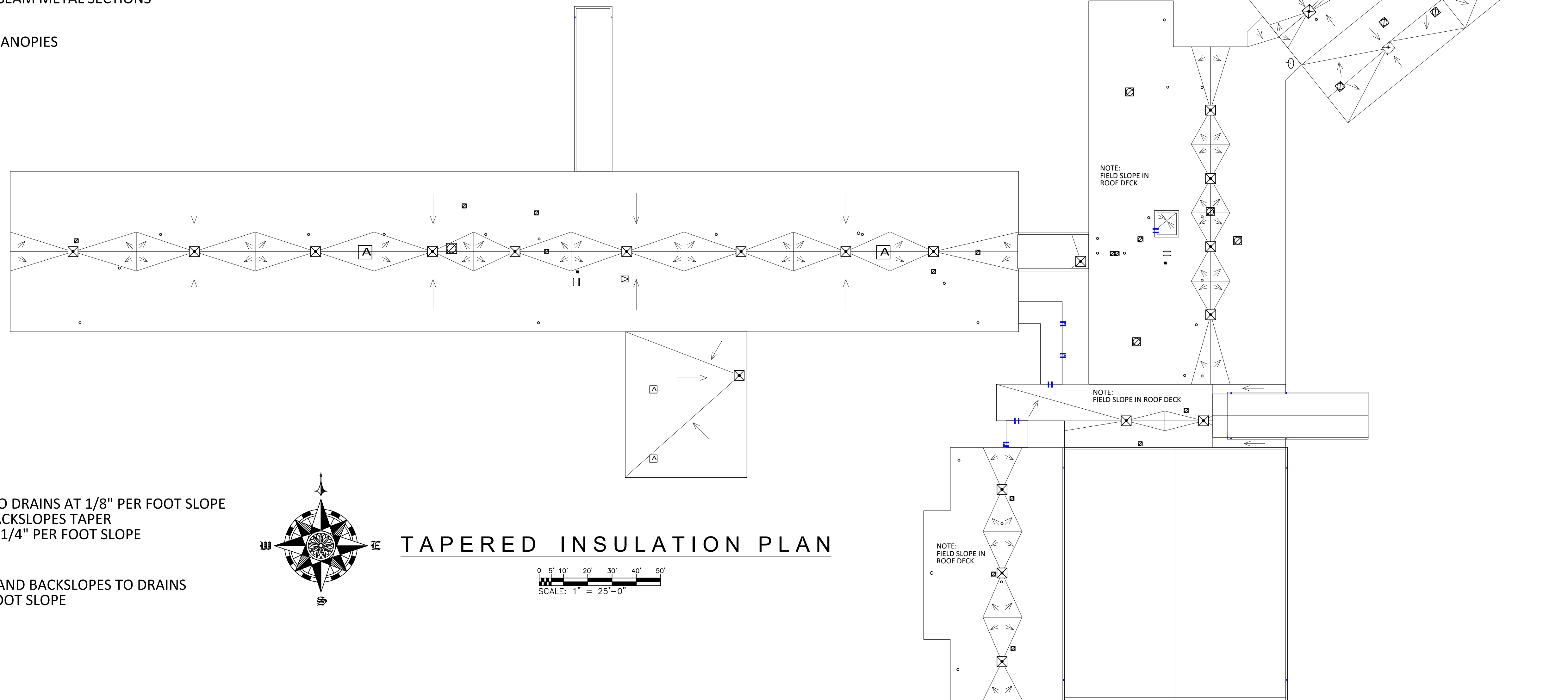

GYPSUM DECK SECTIONS;
FIELD TAPER INSULATION TO DRAINS AT 1/8" PER FOOT SLOPE
CRICKETS, SADDLES AND BACKSLOPES TAPER
INSULATION TO DRAINS AT 1/4" PER FOOT SLOPE

STEEL DECK SECTIONS;
TAPER CRICKETS, SADDLES AND BACKSLOPES TO DRAINS
INSULATION AT 1/2" PER FOOT SLOPE
(FIELD SLOPE IS IN DECK)

EXTERIOR CANOPIES;
NO TAPERED INSULATION

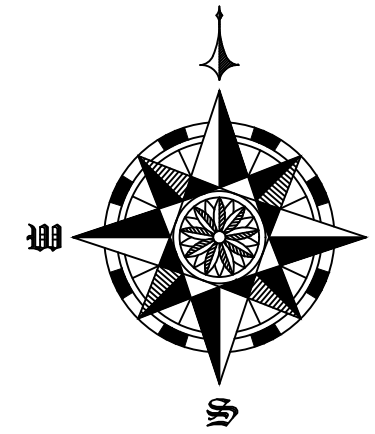



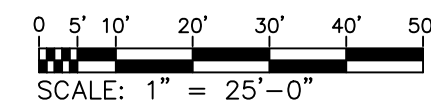





TAPERED INSULATION PLAN



- NOTES:**
- 1.) BASE LAYER OF INSULATION ON GYPSUM AND STEEL DECKS TO BE 2-LAYERS OF 2.5" POLYISOCYANURATE INSULATION.
 - 2.) BASE LAYER OF INSULATION ON EXTERIOR CANOPIES TO BE 1-LAYER OF 1-1/2" POLYISOCYANURATE FOAM INSULATION.
 - 3.) PROVIDE TAPERED CRICKETS AT CURBS AND RAIL SUPPORTS AS REQUIRED TO FACILITATE DRAINAGE.
 - 4.) PROVIDE TAPERED INSULATION SLOPE IN SECTIONS AS IDENTIFIED ON KEYPLAN.
 - 5.) FIELD MODIFICATIONS AND ADJUSTMENTS OF TAPERED INSULATION MAY BE REQUIRED TO FACILITATE PROPER DRAINAGE.
 - 6.) INSTALL WOOD CRICKETS BEHIND VENTILATOR CURBS ON SHINGLE ROOF.

SYMBOL LEGEND

	PLUMBING VENT (SOIL STACK)	A	ABANDONED		ROOF DRAIN
	PITCH PANS		ROOF HATCH		EXHAUST FAN
	EQUIPMENT SUPPORT		EXPANSION/CONTROL JOINT		PARAPET
	SATELLITE DISH				

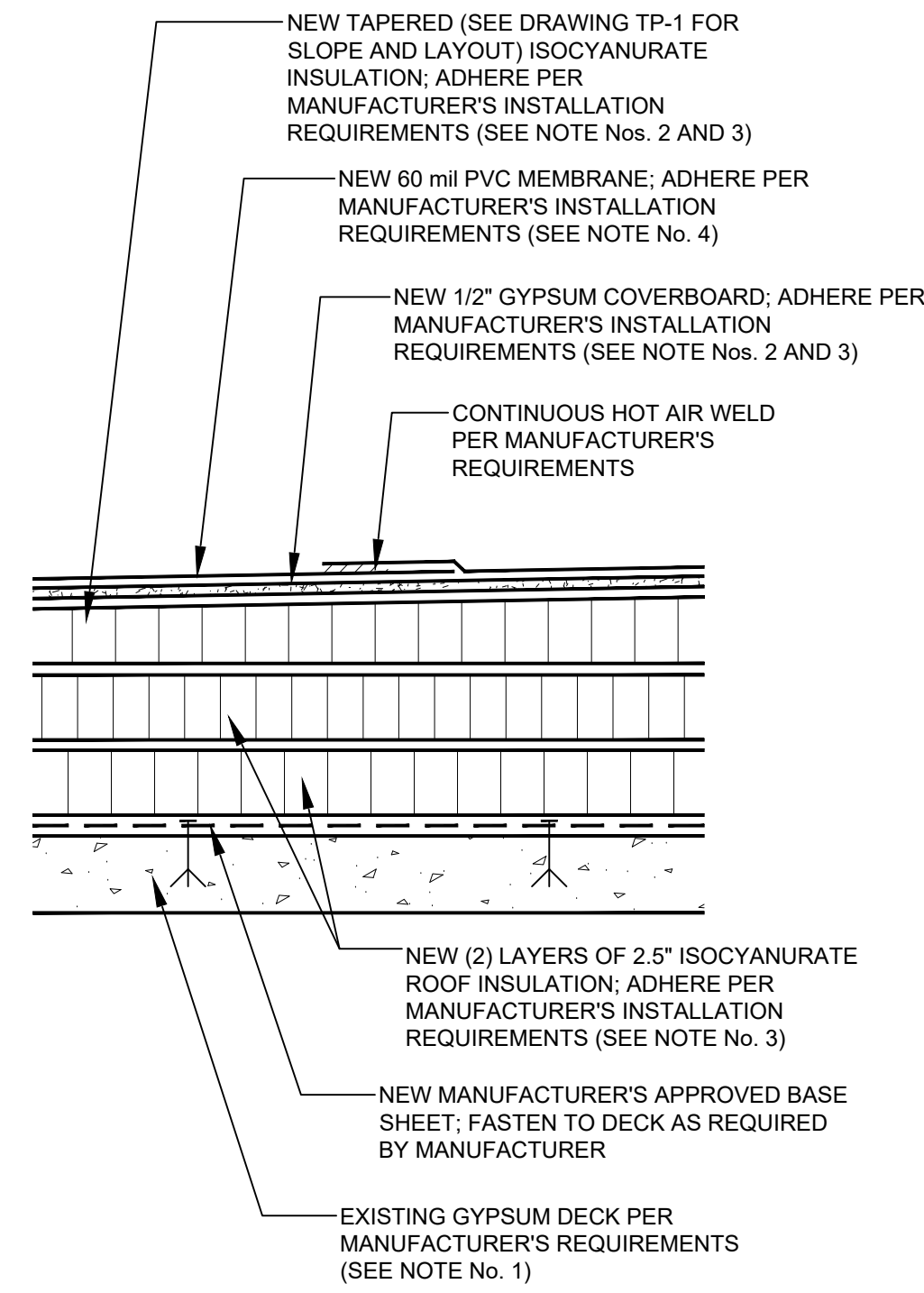

NEW CONSTRUCTION PROFILE

01A
DI

- SCALE: N.T.S.
- NOTES**
- 1.) REPORT ANY STRUCTURAL DAMAGE TO OWNER'S REPRESENTATIVE IMMEDIATELY.
 - 2.) STAGGER BOARD JOINTS 12" MINIMUM WHEN POSSIBLE.
 - 3.) PROVIDE BALLAST TO PROMOTE FULL ADHESION OF BOARD TO SUBSTRATE.
 - 4.) LAP FIELD SHEETS TO PREVENT BACKWATER LAPS.

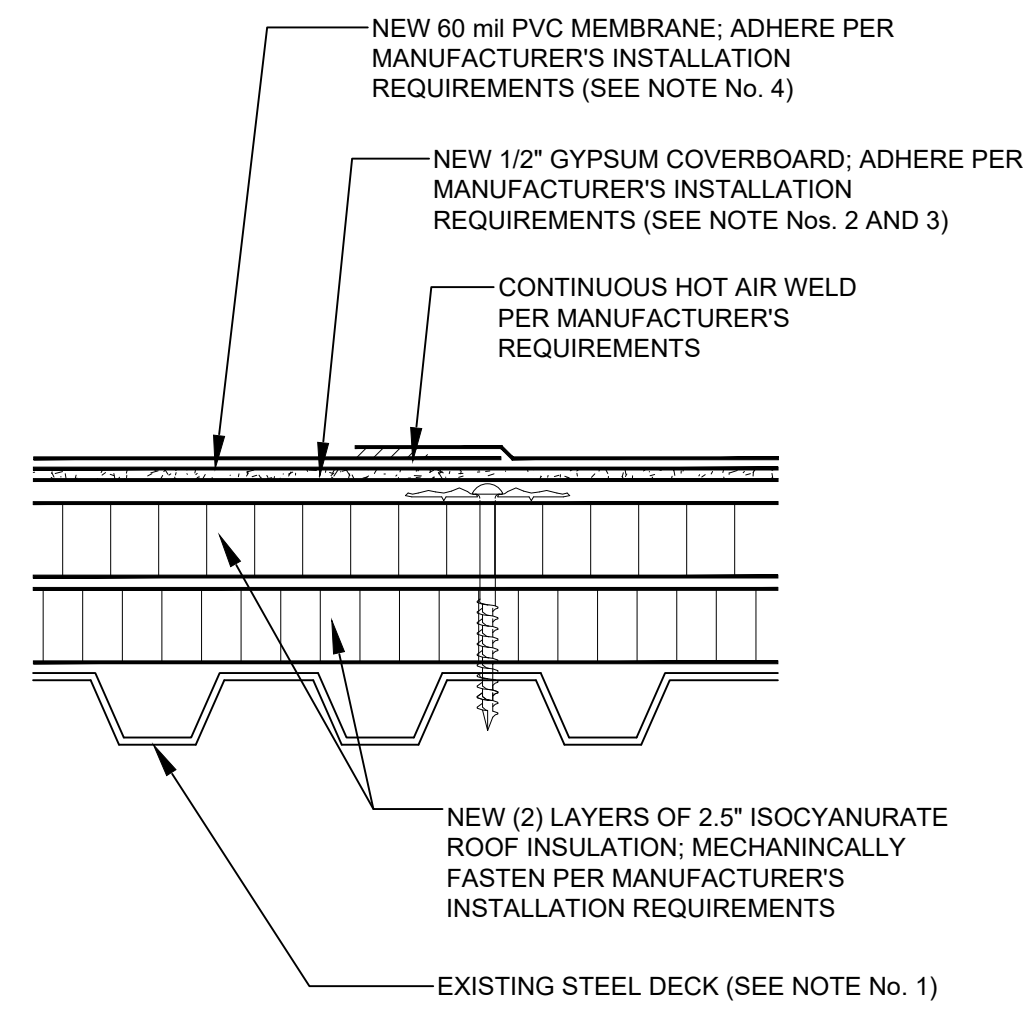

NEW CONSTRUCTION PROFILE AT STEEL DECKS

01B
DI

- SCALE: N.T.S.
- NOTES**
- 1.) REPORT ANY STRUCTURAL DAMAGE TO OWNER'S REPRESENTATIVE IMMEDIATELY.
 - 2.) STAGGER BOARD JOINTS 12" MINIMUM WHEN POSSIBLE.
 - 3.) PROVIDE BALLAST TO PROMOTE FULL ADHESION OF BOARD TO SUBSTRATE.
 - 4.) LAP FIELD SHEETS TO PREVENT BACKWATER LAPS.

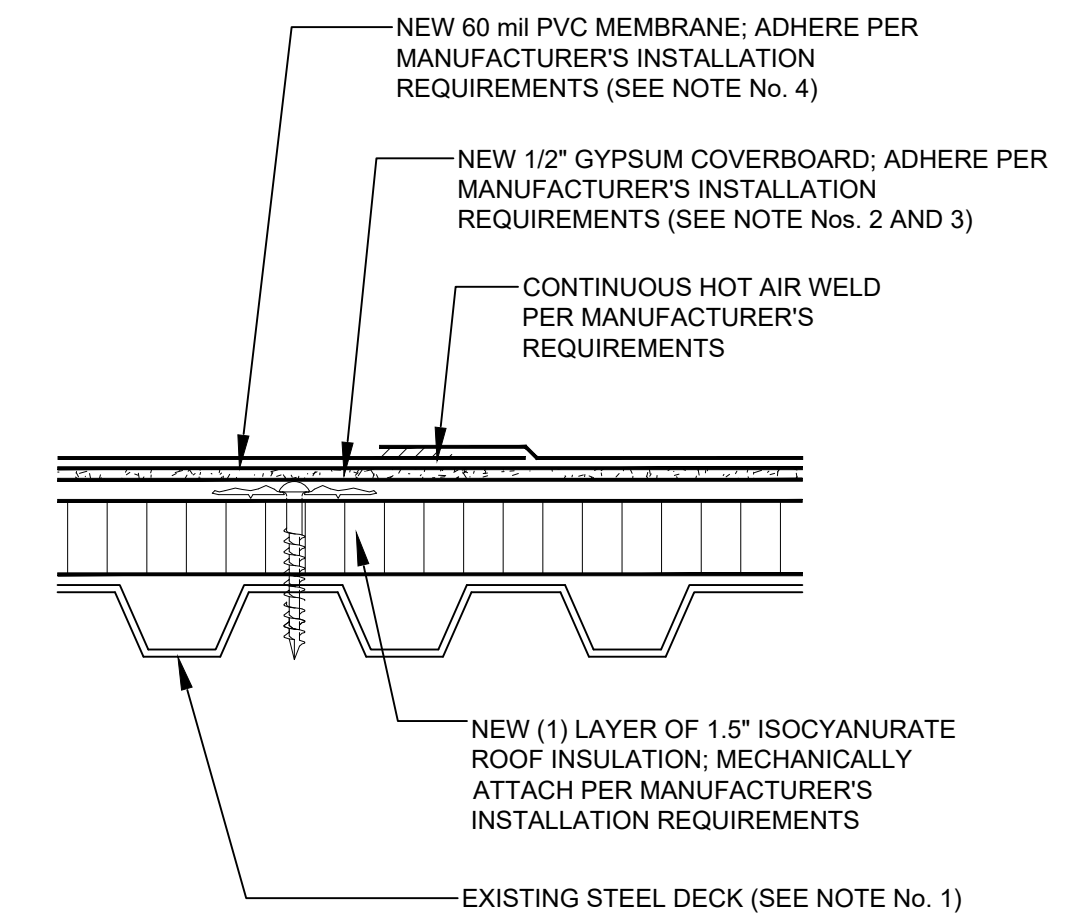

NEW CONSTRUCTION PROFILE AT ENTRANCE CANOPIES

01C
DI

- SCALE: N.T.S.
- NOTES**
- 1.) REPORT ANY STRUCTURAL DAMAGE TO OWNER'S REPRESENTATIVE IMMEDIATELY.
 - 2.) STAGGER BOARD JOINTS 12" MINIMUM WHEN POSSIBLE.
 - 3.) PROVIDE BALLAST TO PROMOTE FULL ADHESION OF BOARD TO SUBSTRATE.
 - 4.) LAP FIELD SHEETS TO PREVENT BACKWATER LAPS.

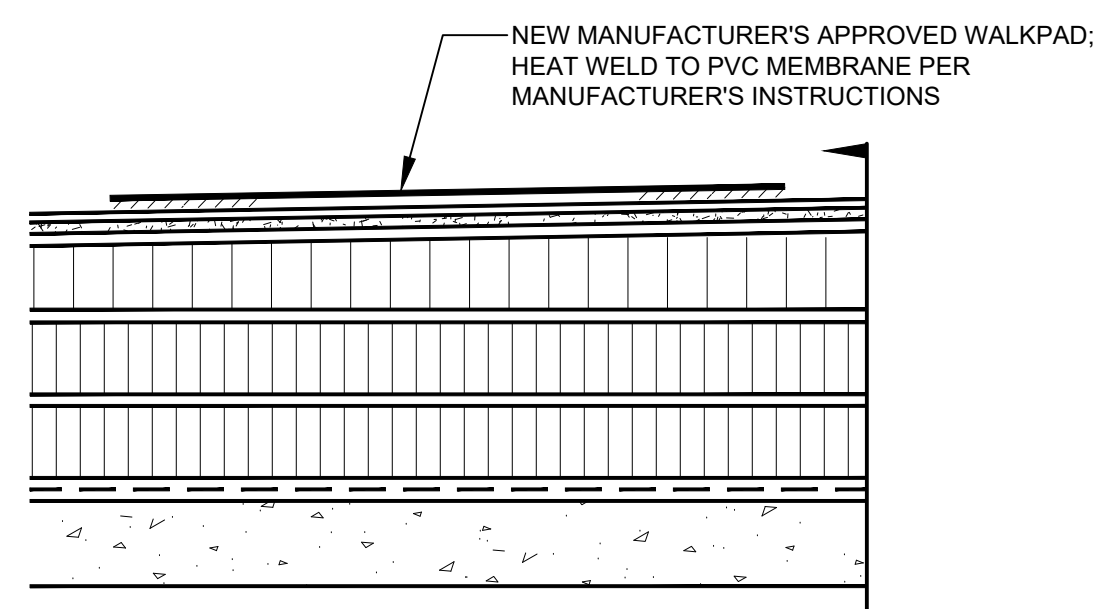

WALKPAD PROFILE

01W
DI

SCALE: N.T.S.

FOR ROOF CONSTRUCTION COMPONENTS SEE DETAIL

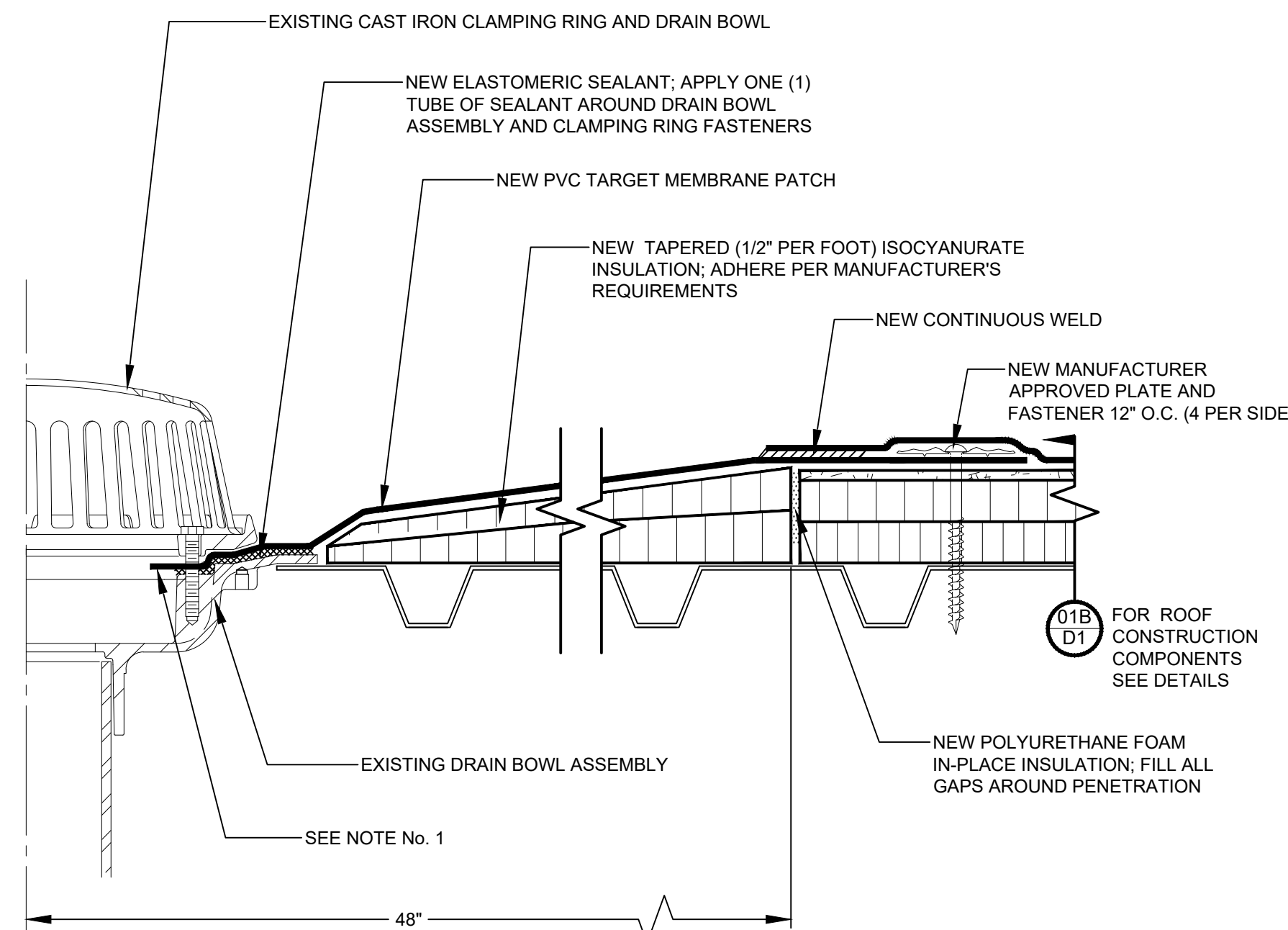

DRAIN FLASHING - TYPICAL

02
DI

SCALE: N.T.S.

- NOTES**
- 1.) EXTEND MEMBRANE UNDER CLAMPING RING MIN. 1" BEYOND DRAIN BOLTS.

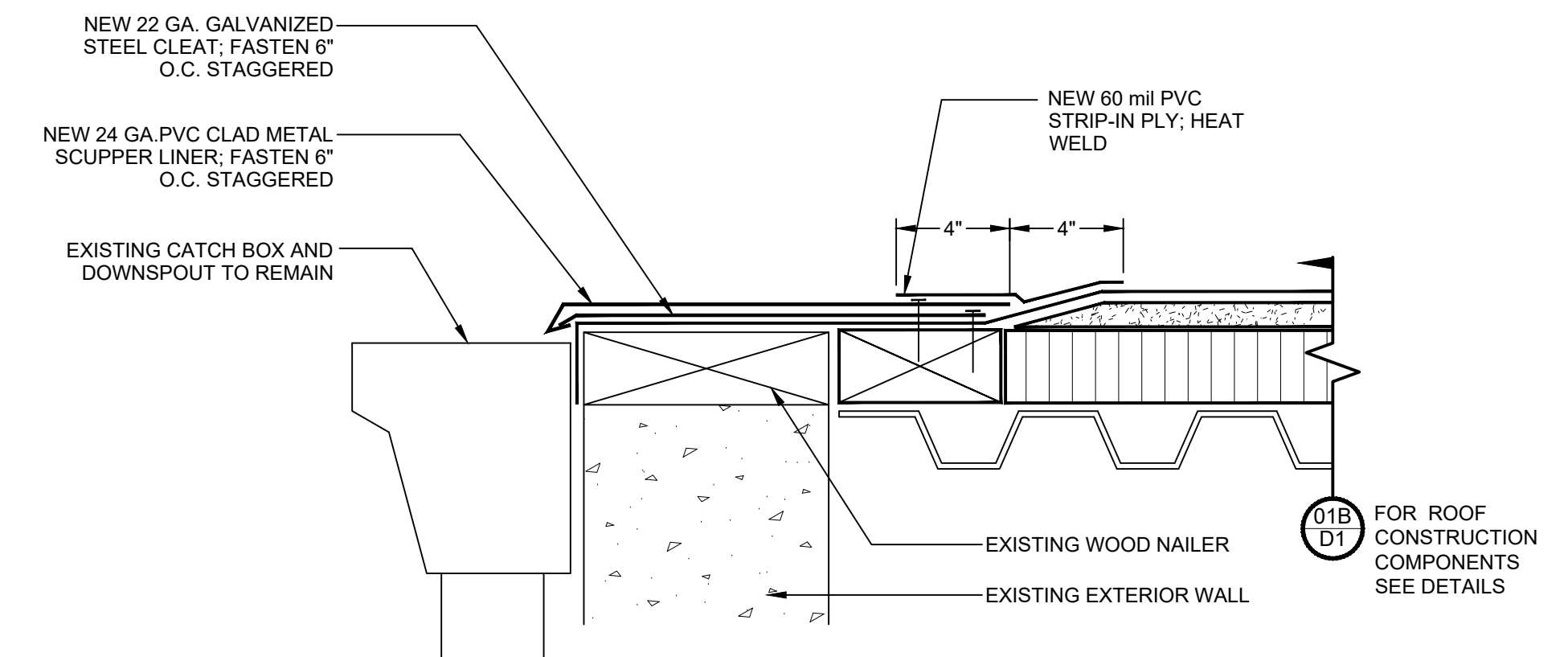

EXTERIOR CANOPY SCUPPER

03
DI

SCALE: N.T.S.

- NOTES**
- 1.) PROPERLY CLEAN ALL SURFACES BEFORE INSTALLING NEW MATERIALS.
 - 2.) MATCH EXISTING SCUPPER LINER IN SIZE AND SHAPE.

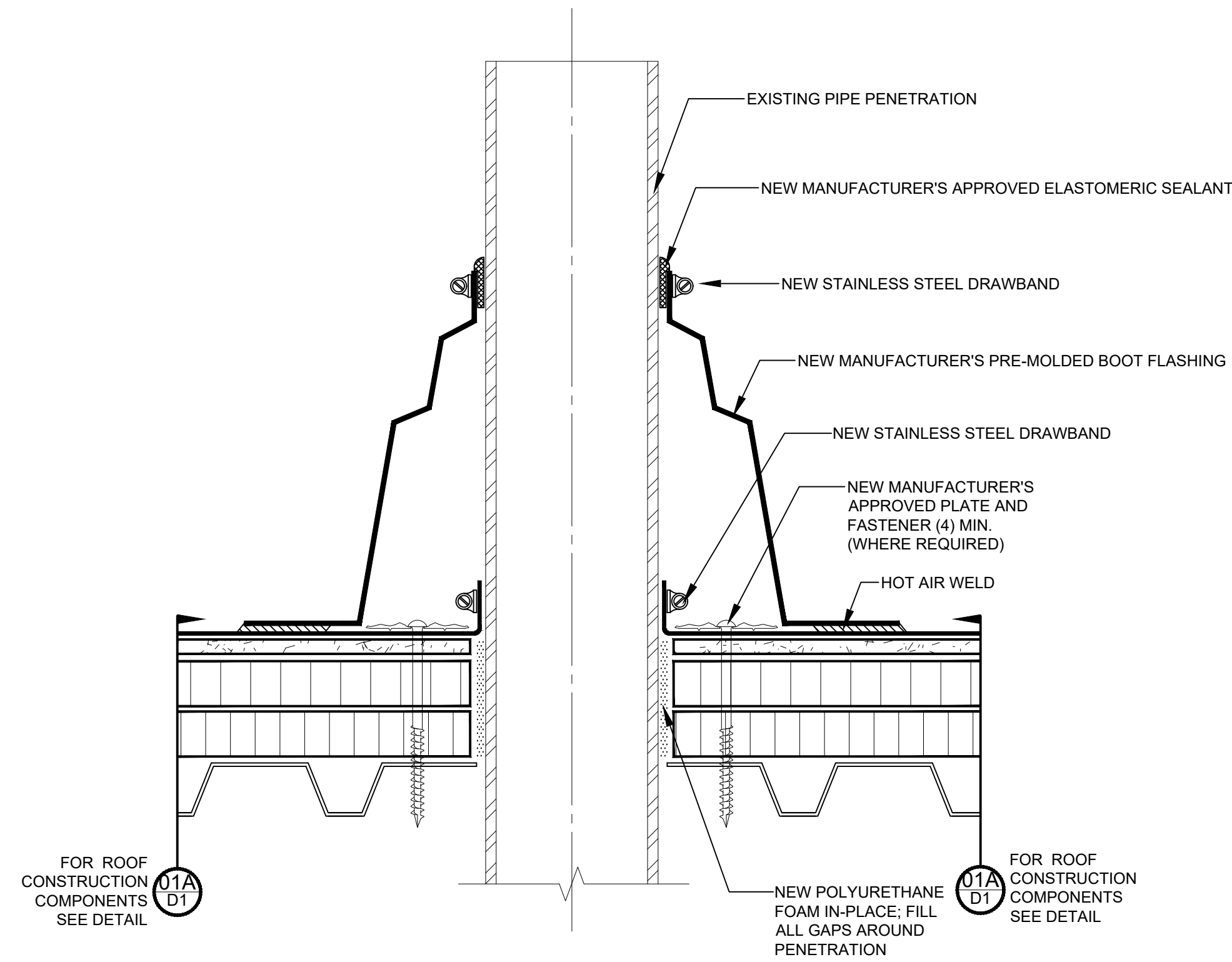

04
D2 **ROUND VENT FLASHING - TYP.**
SCALE: N.T.S.

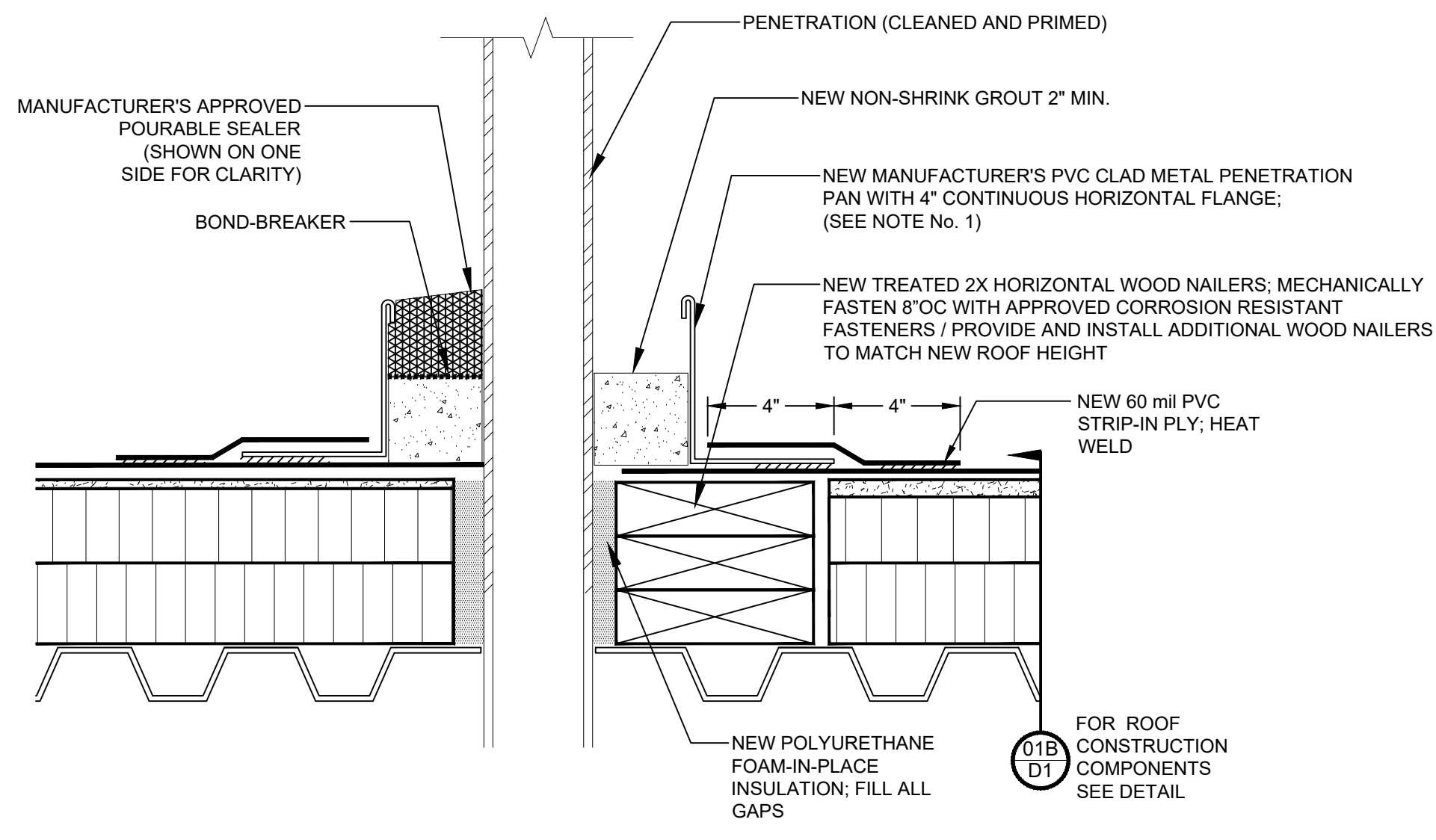

05
D2 **TYPICAL PENETRATION PAN FLASHING**
SCALE: N.T.S.

NOTES

- 1.) CONTINUOUSLY HEAT WELD ALL JOINTS WATERTIGHT.
- 2.) PROVIDE AND INSTALL NEW 16oz. COPPER RAIN COLLAR (NOT SHOWN FOR CLARITY); SOLDER ALL JOINTS WATERTIGHT.

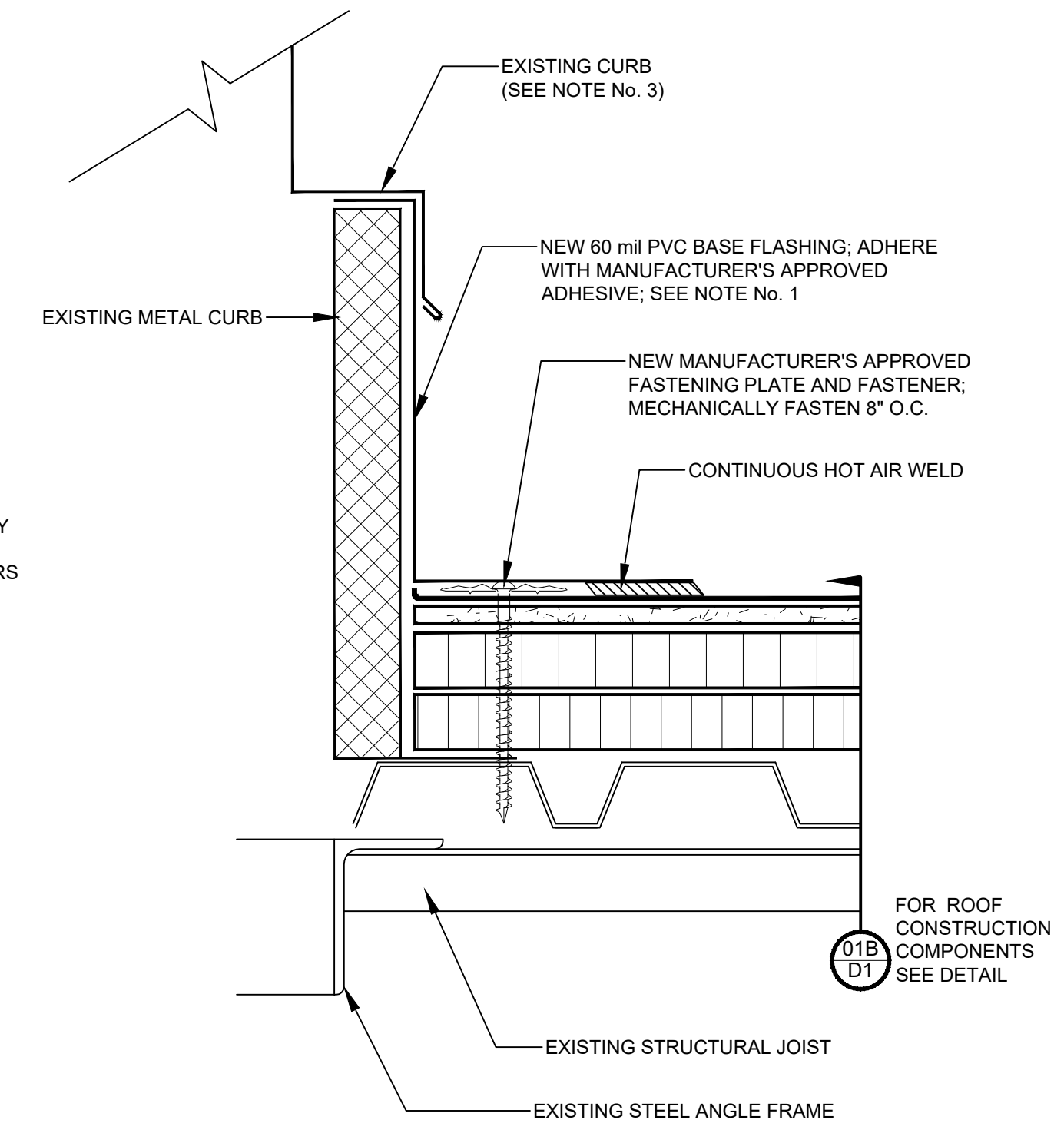

06
D2 **SQUARE CURB FLASHING**
SCALE: N.T.S.

NOTES

- 1.) EXTEND BASE FLASHING ONTO TOP OF METAL CURB.
- 2.) CONTRACTOR SHALL INCLUDE IN CONTRACT SUM ALL COSTS FOR DISCONNECTING AND RECONNECTING MECHANICAL EQUIPMENT TO ALLOW FOR INSTALLATION OF NEW ROOF COMPONENTS.
- 3.) RAISE EXISTING CURBS TO A MINIMUM FLASHING HEIGHT OF 8".

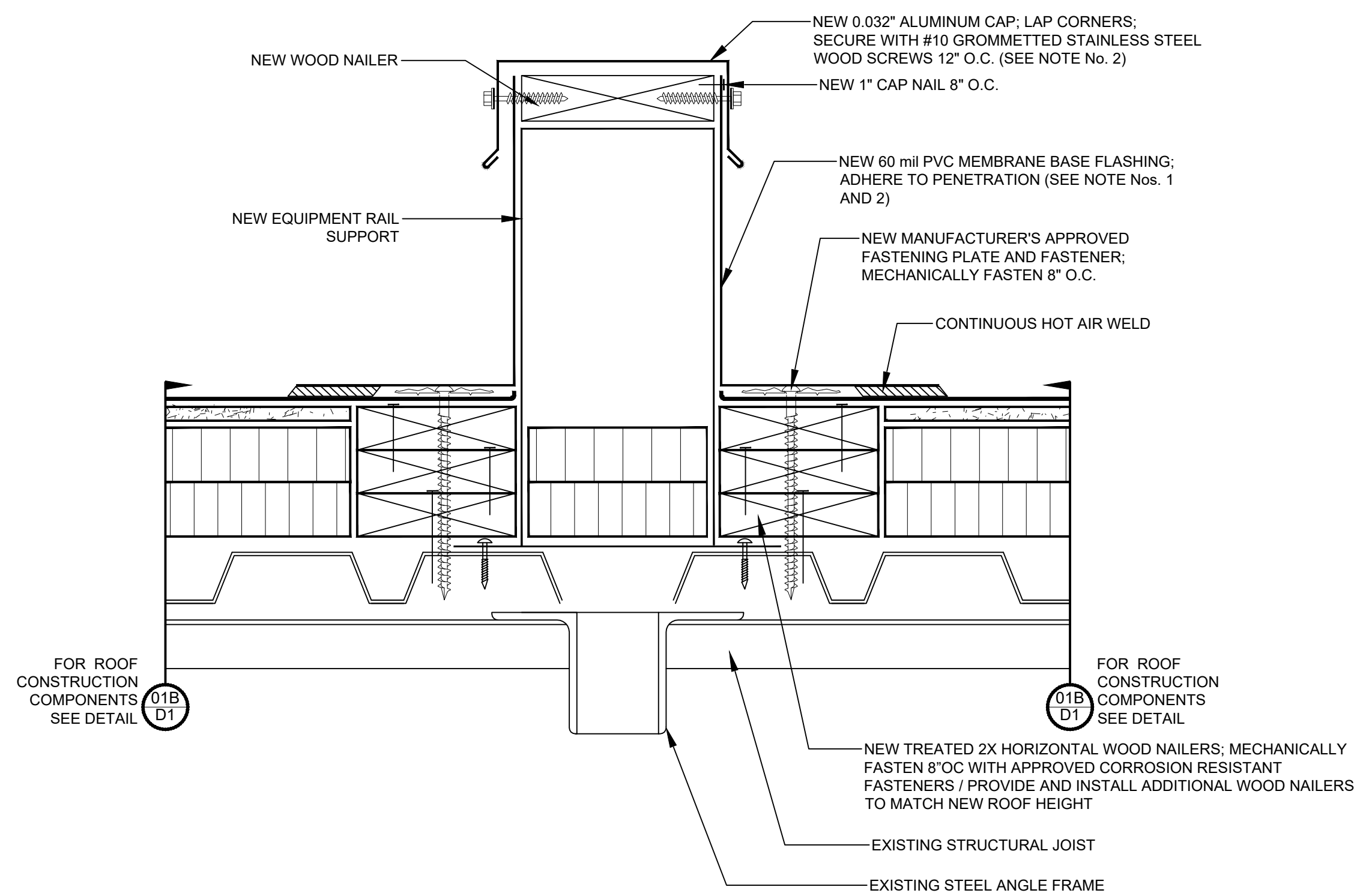

07
D2 **TYPICAL RAIL SUPPORT FLASHING**
SCALE: N.T.S.

NOTES

- 1.) CONTRACTOR SHALL INCLUDE IN CONTRACT SUM ALL COSTS FOR DISCONNECTING AND RECONNECTING MECHANICAL EQUIPMENT TO ALLOW FOR INSTALLATION OF NEW ROOF COMPONENTS.
- 2.) PROVIDE AND INSTALL NEW WOOD NAILER SUPPORTS AT RAILS CURRENTLY MOUNTED ON ROOF SURFACE.

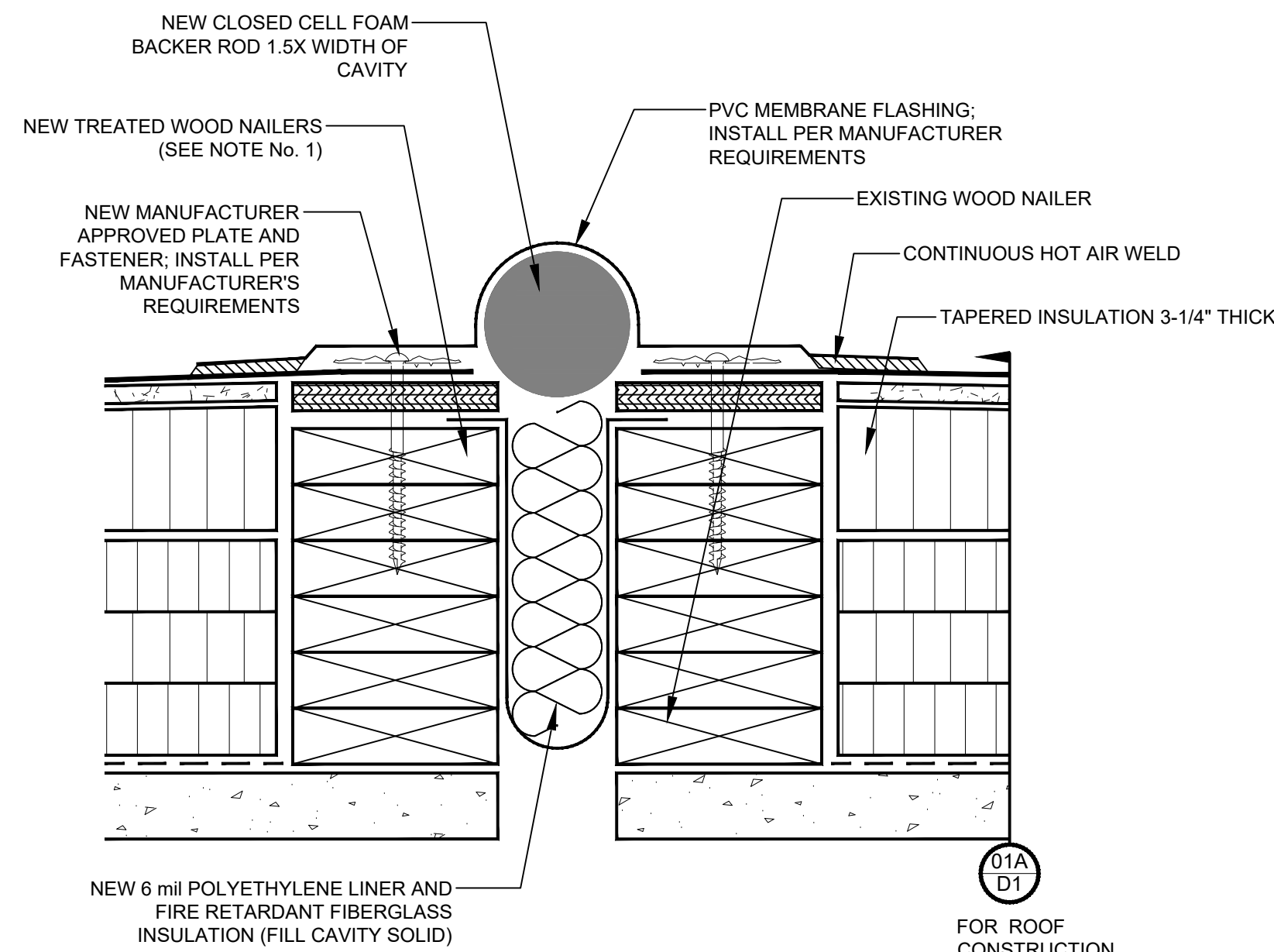

08
D2 **EXPANSION JOINT**
SCALE: N.T.S.

NOTES

- 1.) PROVIDE AND INSTALL NEW ADDITIONAL WOOD BLOCKING TO MATCH NEW ROOF HEIGHT.

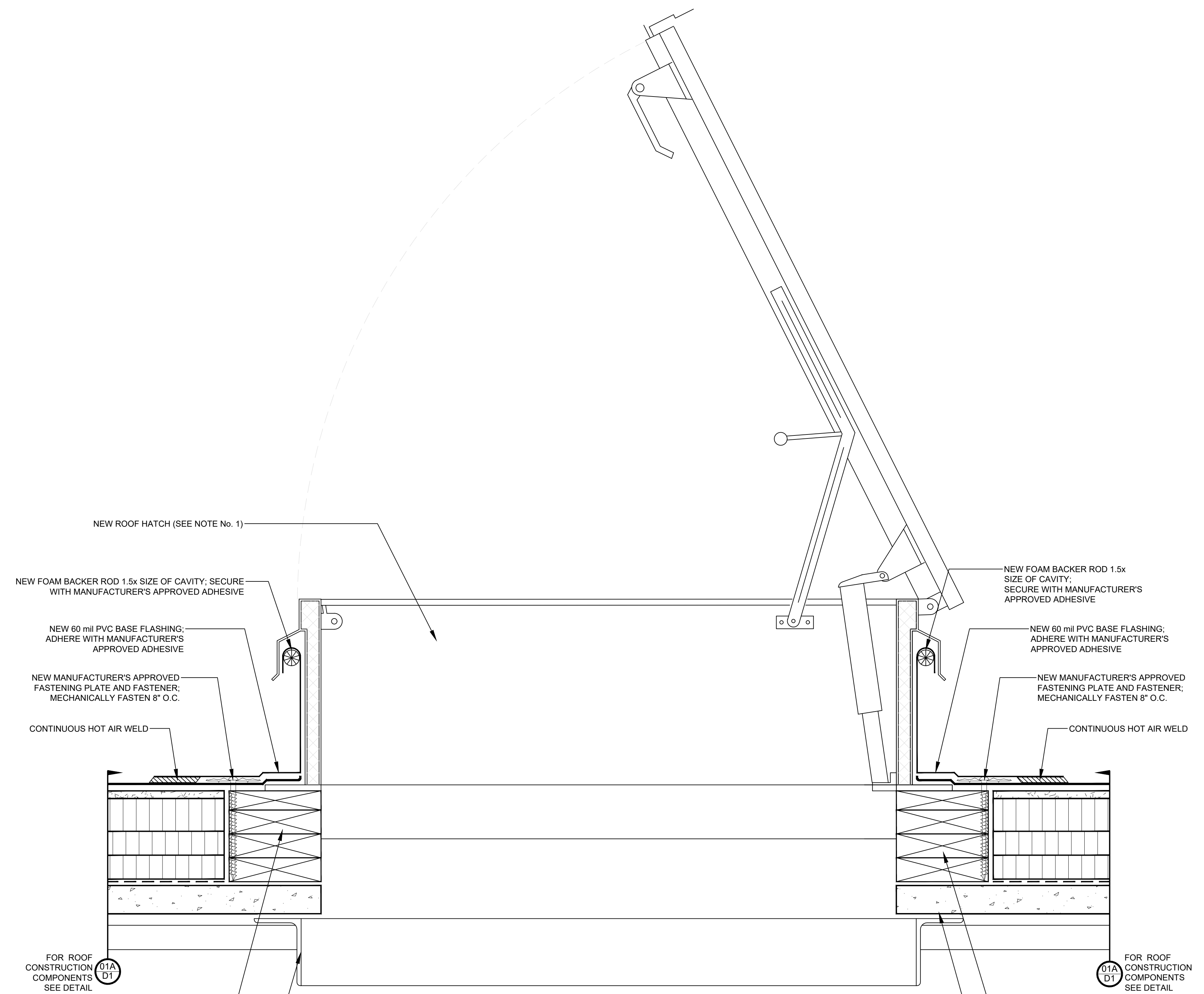

09
D3 **ROOF HATCH**
SCALE: N.T.S.

NOTES
1) NEW ROOF HATCH TO MATCH EXISTING IN SIZE, TYPE AND SHAPE.

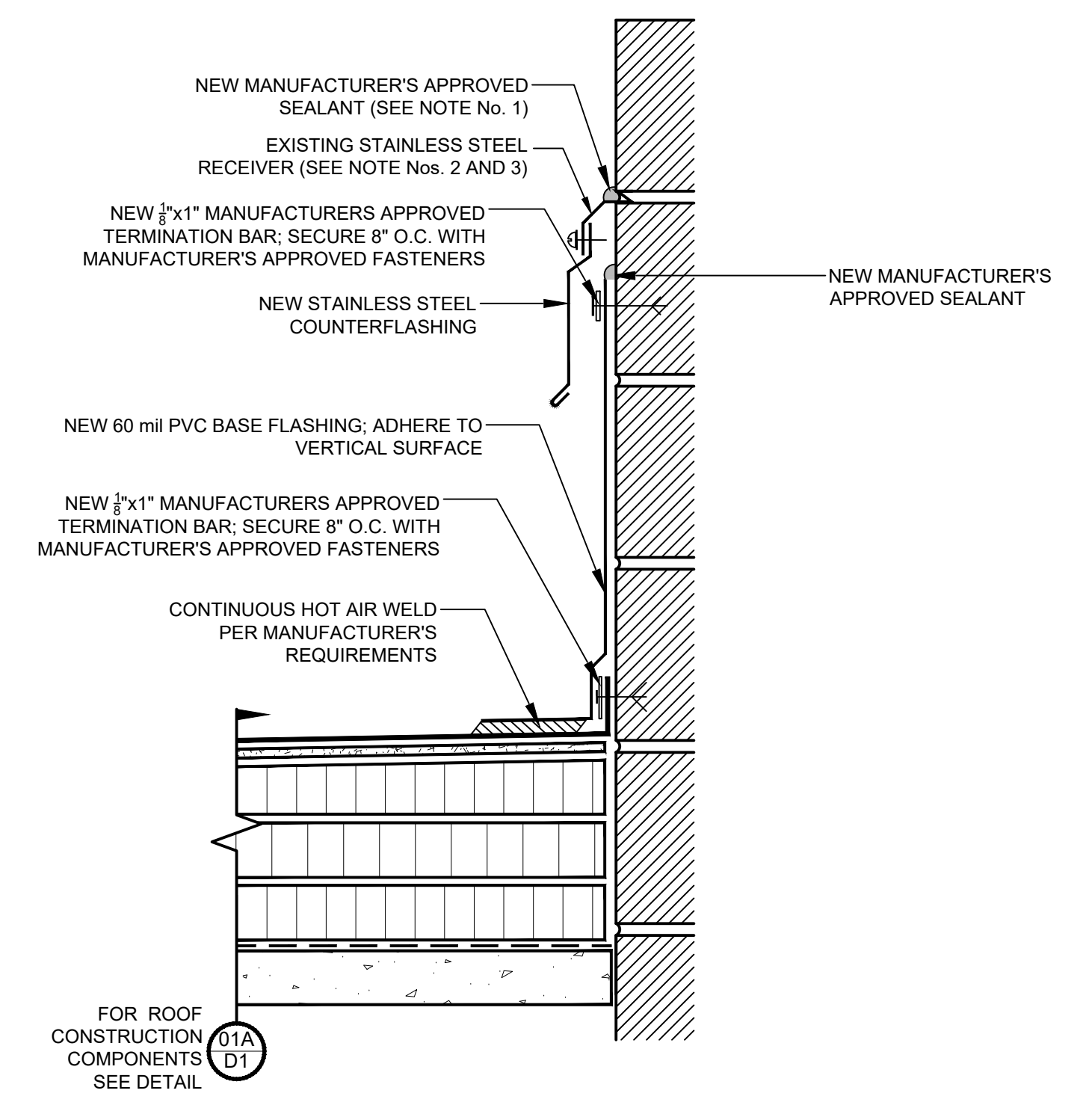

10
D3 **TYP. PARAPET AND WALL FLASHING**
SCALE: N.T.S.

NOTES
1) RAKE CLEAN EXISTING SEALANT.
2) RESECURE EXISTING METAL; PROVIDE AND INSTALL NEW METAL AS NEEDED.
3) PROVIDE AND INSTALL NEW FLASHING TO REPLACE DAMAGED FLASHING.
4) ASSURE ALL EXISTING WALL WEEP OPENINGS ARE CLEAR.

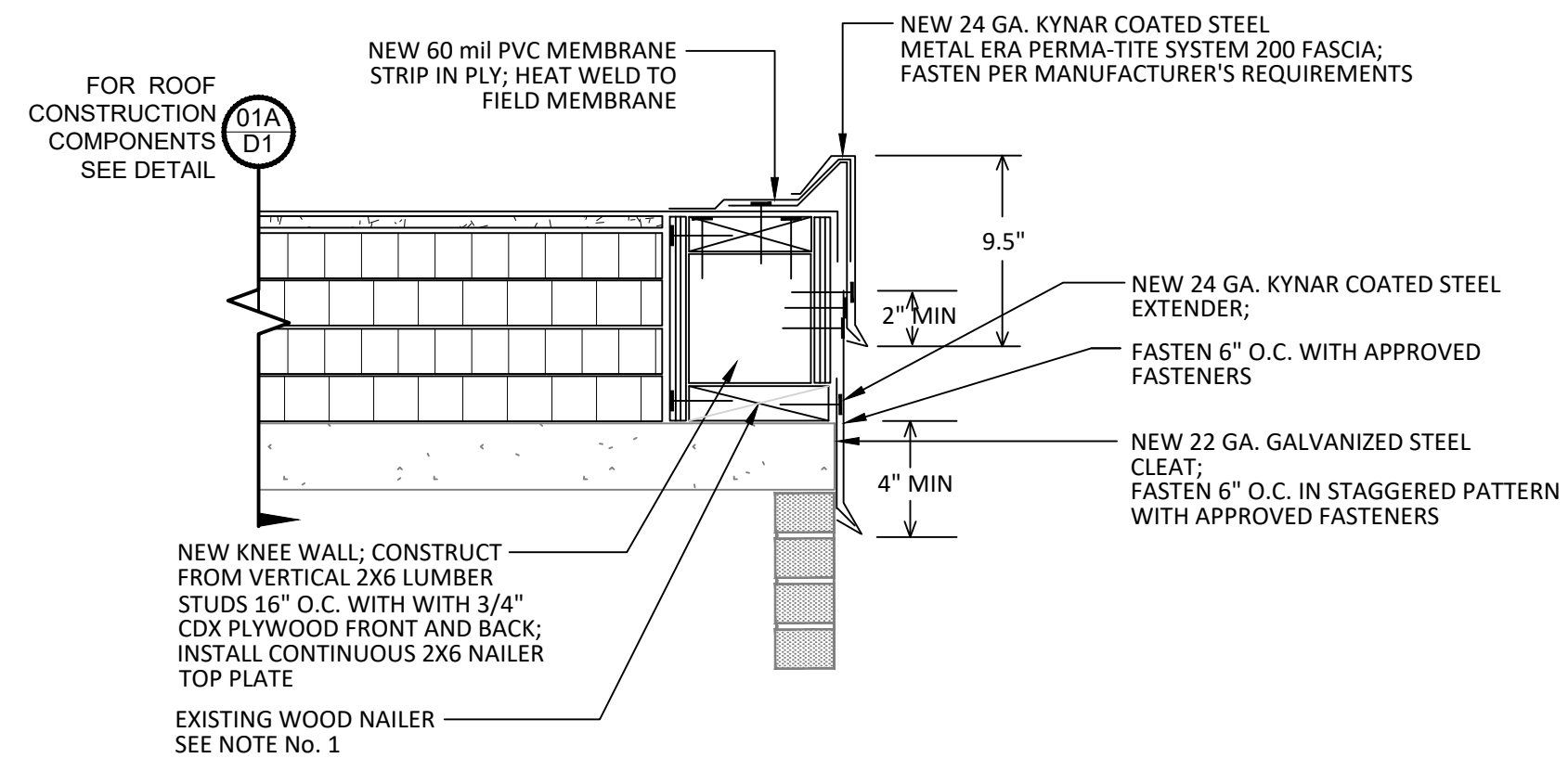

11
D4

TYP. FASCIA EDGE AT GYPSUM DECK SECTIONS
SCALE: N.T.S.

NOTES
1.) ASSURE THAT EXISTING WOOD NAILER IS SECURELY ATTACHED THE EXISTING STRUCTURE IN ACCORDANCE WITH FM 1-49 REQUIREMENTS.

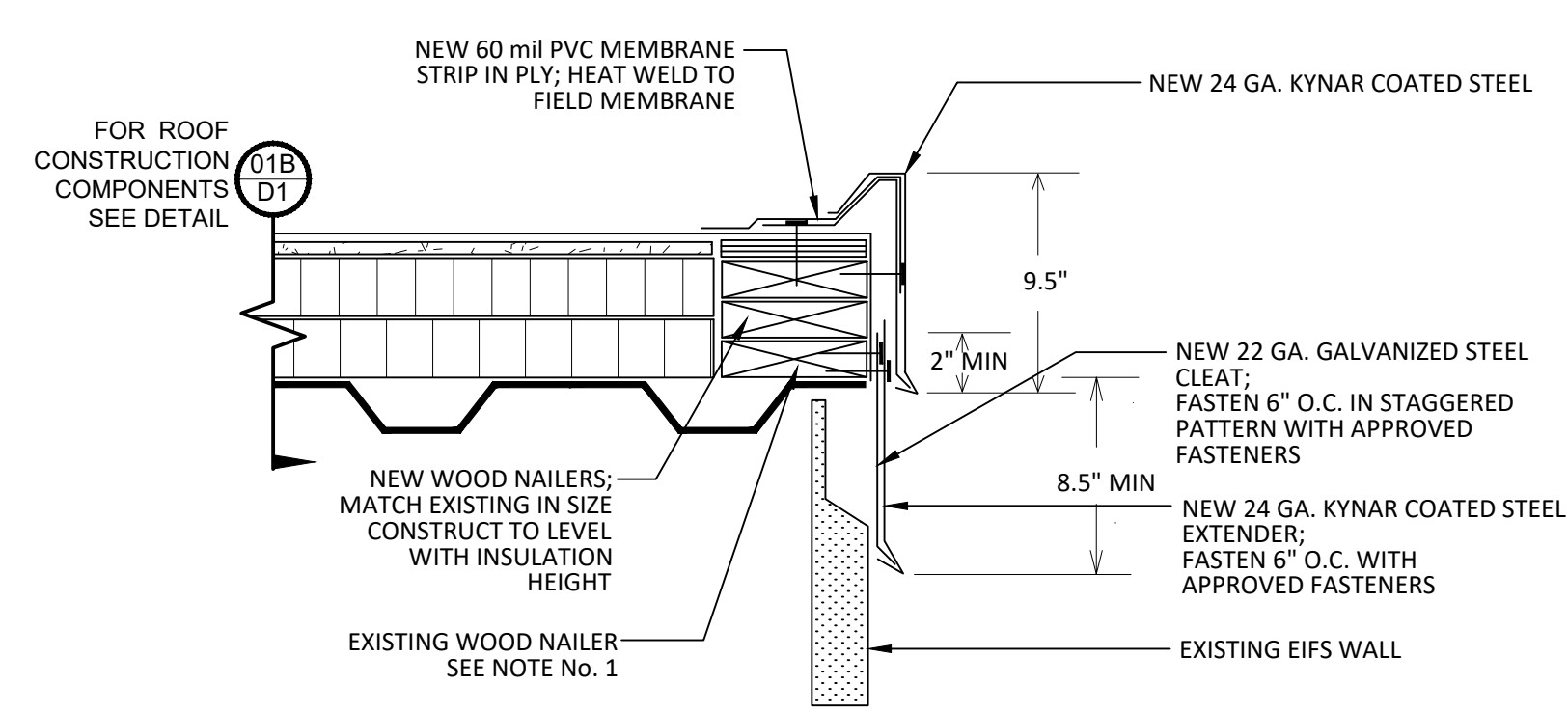

12
D4

TYP. FASCIA EDGE AT STEEL DECK SECTIONS
SCALE: N.T.S.

NOTES
1.) ASSURE THAT EXISTING WOOD NAILER IS SECURELY ATTACHED THE EXISTING STRUCTURE IN ACCORDANCE WITH FM 1-49 REQUIREMENTS.

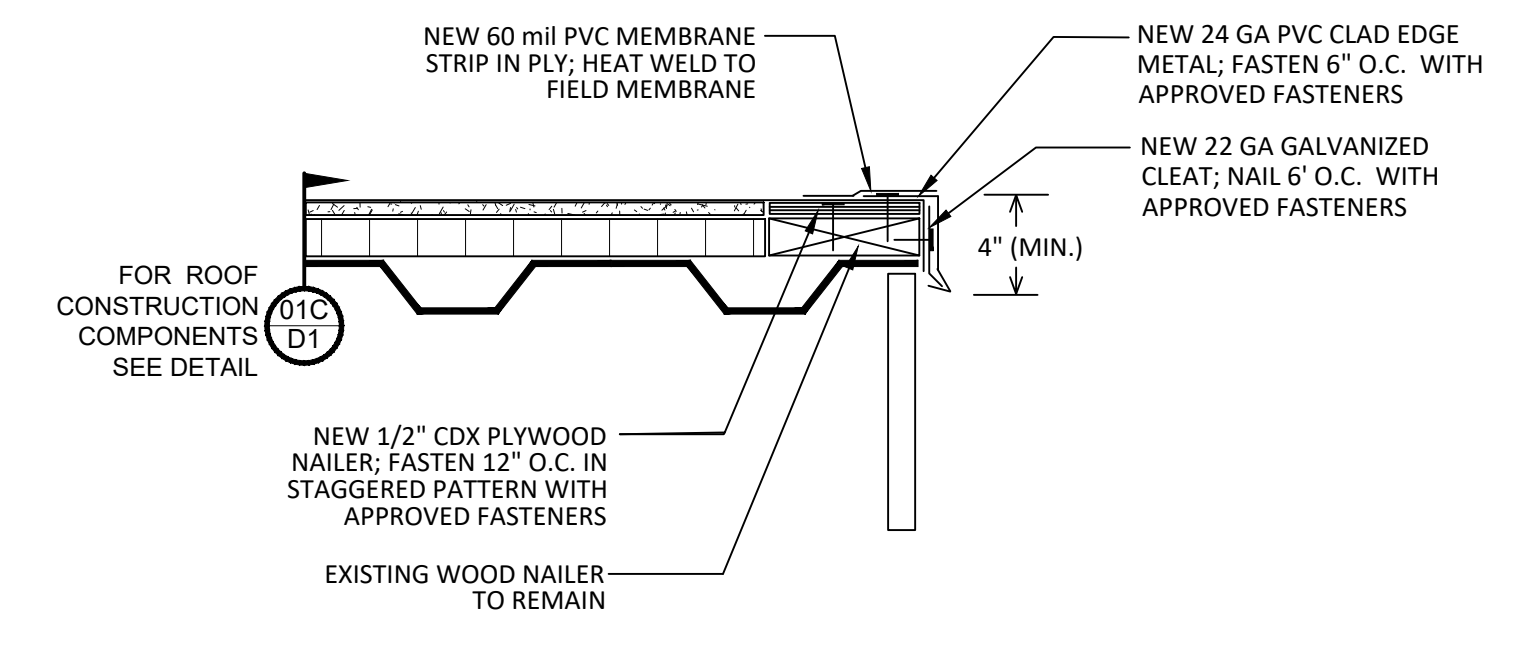

13
D4

FASCIA EDGE AT FRONT ENTRANCE CANOPY
SCALE: N.T.S.

NOTES
1.) EXISTING GUTTER TO REMAIN IN PLACE.

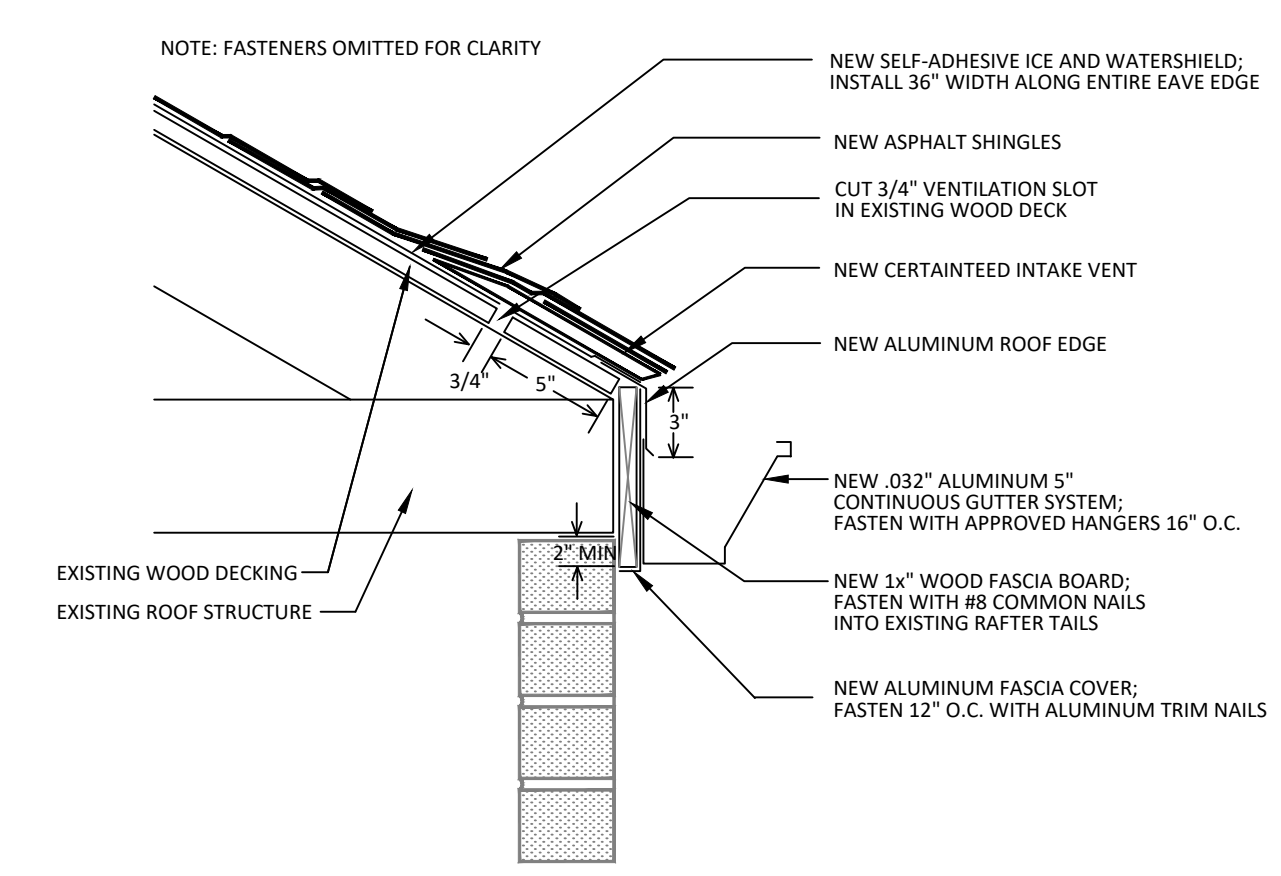

14
D4

SHINGLE ROOF EAVE EDGE
SCALE: N.T.S.

NOTES
1.) INSTALL ALL ROOFING COMPONENTS IN ACCORDANCE WITH MANUFACTURERS INSTRUCTIONS.
2.) SLOPE GUTTER TO DRAIN TO EAST END.
3.) EXTEND NEW DOWNSPOUTS TO GROUND LEVEL.

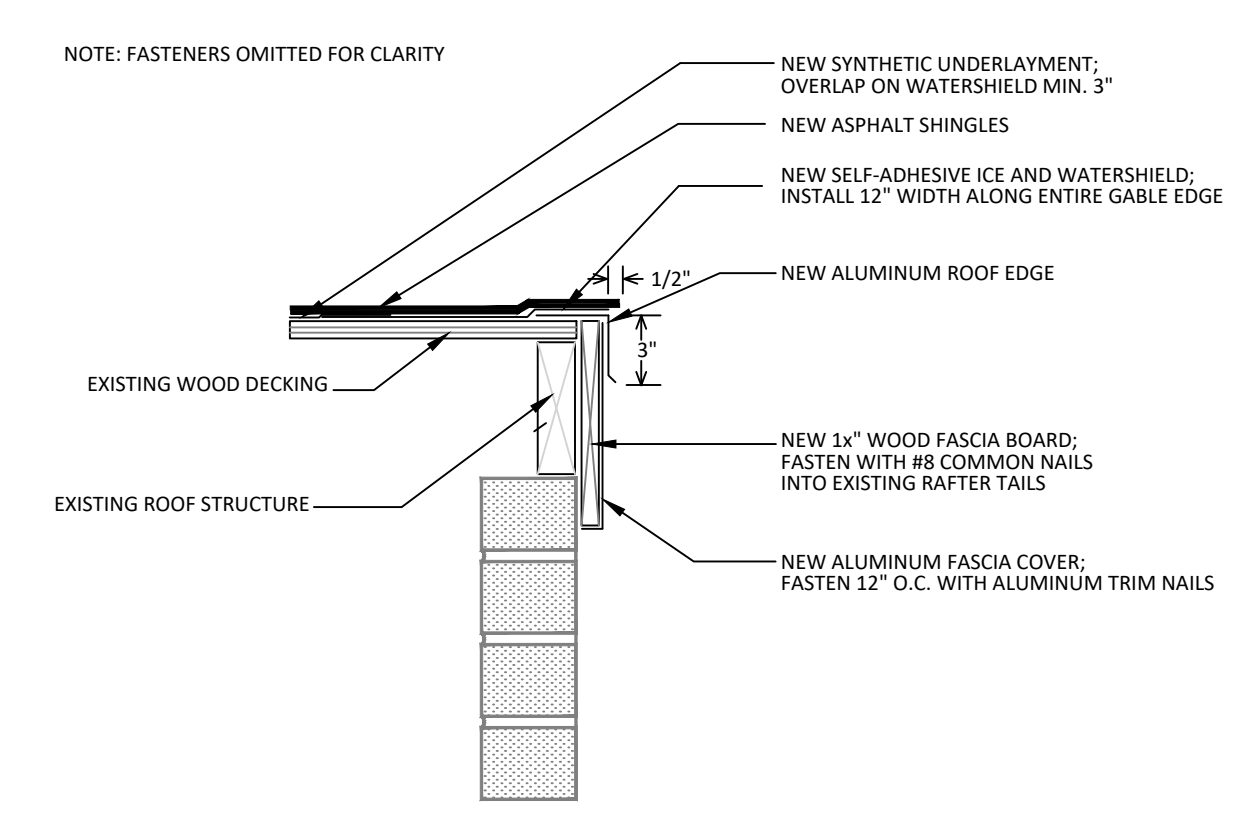

15
D4

SHINGLE ROOF GABLE EDGE
SCALE: N.T.S.

NOTES
1.) INSTALL ALL ROOFING COMPONENTS IN ACCORDANCE WITH MANUFACTURERS INSTRUCTIONS.

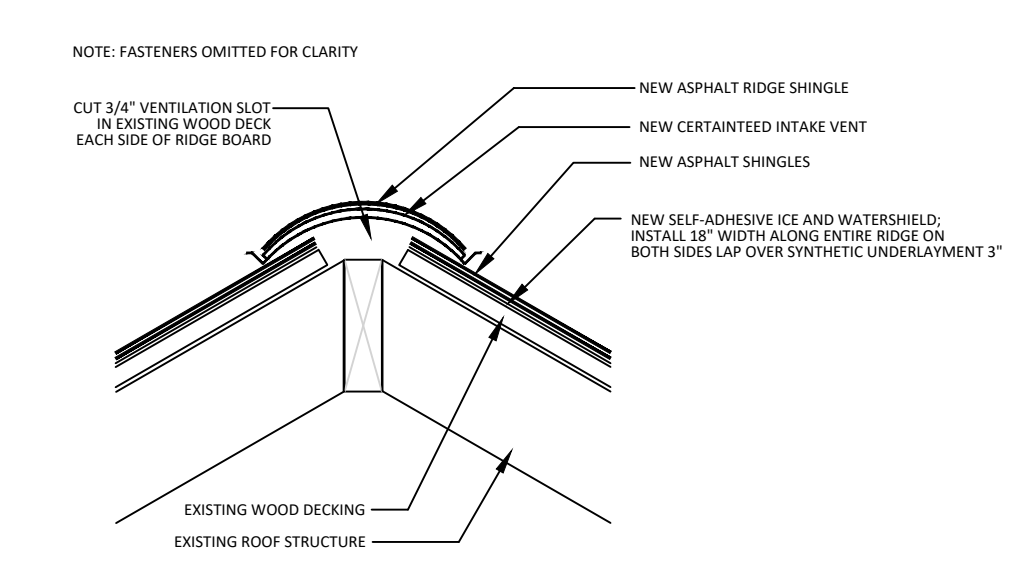

16
D4

SHINGLE ROOF RIDGE VENT
SCALE: N.T.S.

NOTES
1.) INSTALL ALL ROOFING COMPONENTS IN ACCORDANCE WITH MANUFACTURERS INSTRUCTIONS.