

- TAG NOTES:**
- 1 WELDING BOOTHS - FABRICATED AND INSTALLED BY FCPS SOUTHSIDE VOTEC.
  - 2 WALK-IN COOLER, SS 11 40.00, RECESSED SLAB REQUIRED. REFER TO STRUCTURAL SHEETS.
  - 3 WALK-IN PREFABRICATED PAINT BOOTH - BY OWNER.
  - 4 DISPLAY CASE. REFER TO DRAWING 3/A3.1b.
  - 5 METAL LOCKERS ON CMU BASE. REFER TO DRAWING 2/A1.3b.
  - 6 CMU WALL TO EXTEND TO 8'-0" AFF.
  - 7 EYEWASH. REFER TO PLUMBING SHEETS.
  - 8 RUBBER FLOORING. REFER TO SS 09 65.00.
  - 9 WATER SERVICE AREA WITH 6" x 6" CAST IN PLACE CURB AND SLOPED SLAB FLOOR TO DRAIN. REFER TO PLUMBING SHEETS.

- SYMBOLS LEGEND**
- |  |   |  |   |
|--|---|--|---|
|  | ENLARGED PLAN IDENTIFICATION                            |  | ELEVATION DESIGNATION                     |
|  | SECTION DESIGNATION                                     |  | DETAIL DESIGNATION                        |
|  | ELEVATION BENCHMARK: SECTION / ELEV.                    |  | ELEVATION BENCHMARK: PLAN                 |
|  | WINDOW TYPE DESIGNATION. SEE LEGEND ON A3.3A            |  | ROOM DESIGNATION. SEE SCHEDULE ON A3.1a   |
|  | DOOR DESIGNATION. SEE SCHEDULE ON A3.2a                 |  | MASONRY CONTROL JOINT. SS 048100          |
|  | TAG NOTE. SEE LEGEND THIS SHEET.                        |  | FIRE EXTINGUISHER & CABINET. SS 105230    |
|  | WALL TYPE DESIGNATION. SEE WALL TYPE SCHEDULE, ON A3.1b |  | WALL MOUNTED FIRE EXTINGUISHER, SS 105230 |

- PLAN - GENERAL NOTES:**
- ALL DIMENSIONS ARE REFERENCED FROM FINISH FACE OF MASONRY OR FACE OF METAL FRAMING UNLESS OTHERWISE INDICATED. CONTRACTOR SHALL FIELD VERIFY ALL DIMENSIONS PRIOR TO COMMENCEMENT OF ANY WORK. NOTIFY ARCHITECT OF SIGNIFICANT DISCREPANCIES IMMEDIATELY. DO NOT SCALE DRAWINGS.
  - ARCHITECTURAL FLOOR ELEVATION FOR EACH BUILDING:
    - ACADEMIC BLDG: 100'-0" IS EQUIVALENT TO SITE ELEVATION 889.10'
    - GREENHOUSE: 100'-0" IS EQUIVALENT TO SITE ELEVATION 889.10'
    - ARENA: 100'-0" IS EQUIVALENT TO SITE ELEVATION 894.10'
  - IT IS THE INTENT OF THE DRAWINGS TO IDENTIFY ALL LINTEL REQUIREMENTS ON THE DRAWINGS. HOWEVER IT IS THE CONTRACTOR'S RESPONSIBILITY TO PROVIDE ALL LINTELS NECESSARY TO COMPLETE THE CONSTRUCTION. IF THE DRAWINGS DO NOT IDENTIFY THE TYPE OF LINTEL TO BE USED AT A LOCATION WHERE ONE IS REQUIRED, REFER TO THE LINTEL SCHEDULE PROVIDED ON THE STRUCTURAL DRAWINGS.
  - REFER TO FURNISHING DRAWINGS ON SHEETS F1.0 THROUGH F1.5 FOR CASEWORK & EQUIPMENT BOTH INCLUDED & NOT INCLUDED IN THIS CONTRACT. IT IS THE CONTRACTOR'S RESPONSIBILITY TO COORDINATE WORK OF ALL TRADES WITH FINAL FURNISHINGS REQUIREMENTS, INCLUDING, BUT NOT LIMITED TO PREVENTING CONFLICTS BETWEEN SERVICES & DISPLAY BOARDS AS WELL AS OTHER EQUIPMENT SHOWN BUT NOT IN CONTRACT.
  - REFER TO LANDSCAPE, STRUCTURAL, MECHANICAL, ELECTRICAL & GREENHOUSE DRAWINGS FOR ADDITIONAL WORK.
  - CONSTRUCTION SHALL COVER ALL WORK AS SHOWN ON THESE DRAWINGS. CONTRACTOR HAS THE RESPONSIBILITY TO REFER TO ALL DRAWINGS, SITE INFORMATION, SPECIFICATIONS AND IS TO VERIFY ALL CONDITIONS IN FIELD BEFORE COMMENCING WORK. COMMENCING WORK MEANS ACCEPTANCE OF ALL CONDITIONS.

**1 ACADEMIC CLASSROOM BUILDING - FLOOR PLAN**  
 Scale: 1/8" = 1'-0"  
 SOUTH

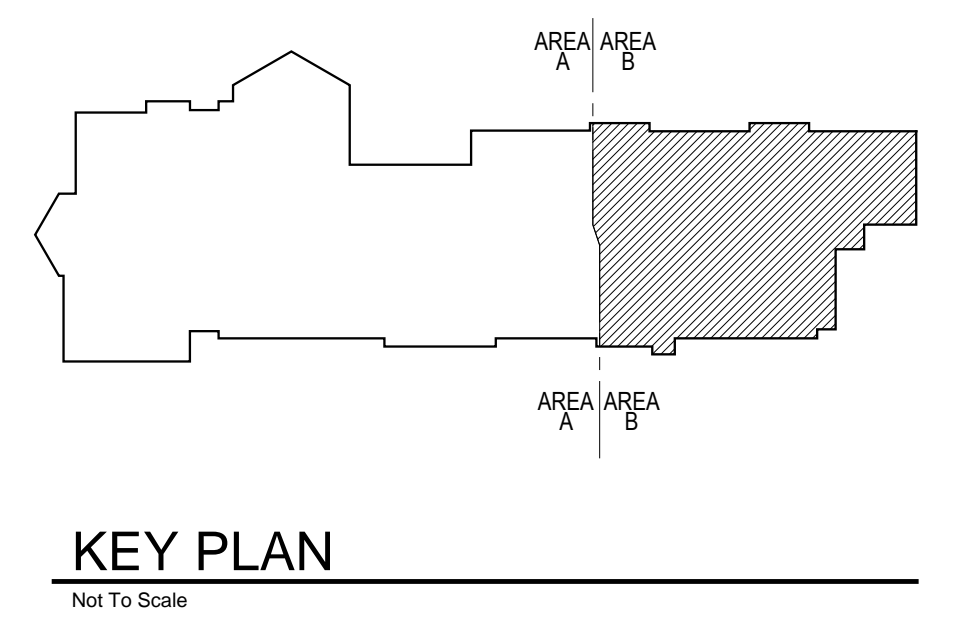

**Tate Hill Jacobs Architects**  
 346 East Main Street • Lexington • Kentucky • 40507  
 Telephone 859 • 252 • 5994 Facsimile 859 • 253 • 1607

THESE RECORD DRAWINGS HAVE BEEN PREPARED BY THE CONTRACTOR OR TATE HILL JACOBS ARCHITECTS, INC. AND ARE NOT RESPONSIBLE FOR ANY ERRORS OR OMISSIONS WHICH MAY HAVE BEEN INCORPORATED INTO THE CONSTRUCTION. THE CONTRACTOR ASSUMES COMPLETE RESPONSIBILITY FOR ANY INCOMPLETE OR ERRONEOUS INFORMATION.  
**RECORD DRAWINGS**

**Academic Classroom Building Floor Plan Area "B"**  
 FAYETTE COUNTY PUBLIC SCHOOLS  
 Locust Trace Agriculture Farm  
 3591 Leestown Road Lexington, KY 40511

Proj. #: 0801  
 Date: 06/03/2012  
 Drawn: JEF, MFI  
 Checked: BSH  
 Revised:  
**A1.1b**