

A  
B  
C  
D  
E  
F  
G  
H  
I  
J  
K  
L  
M  
N

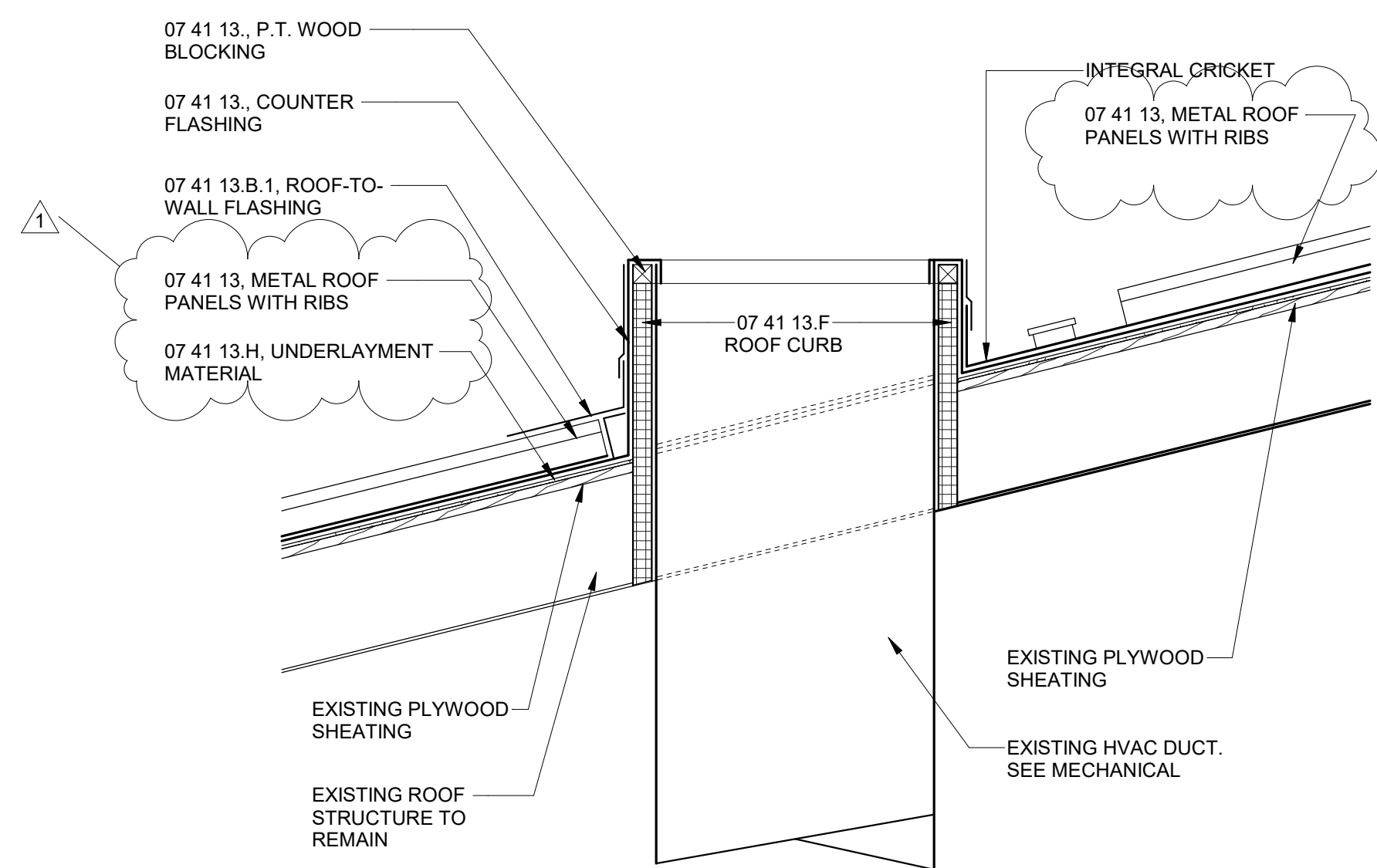

1 DETAIL - TYPICAL ROOF PENETRATIONS - ROOF CURB  
A101 1" = 1'-0"

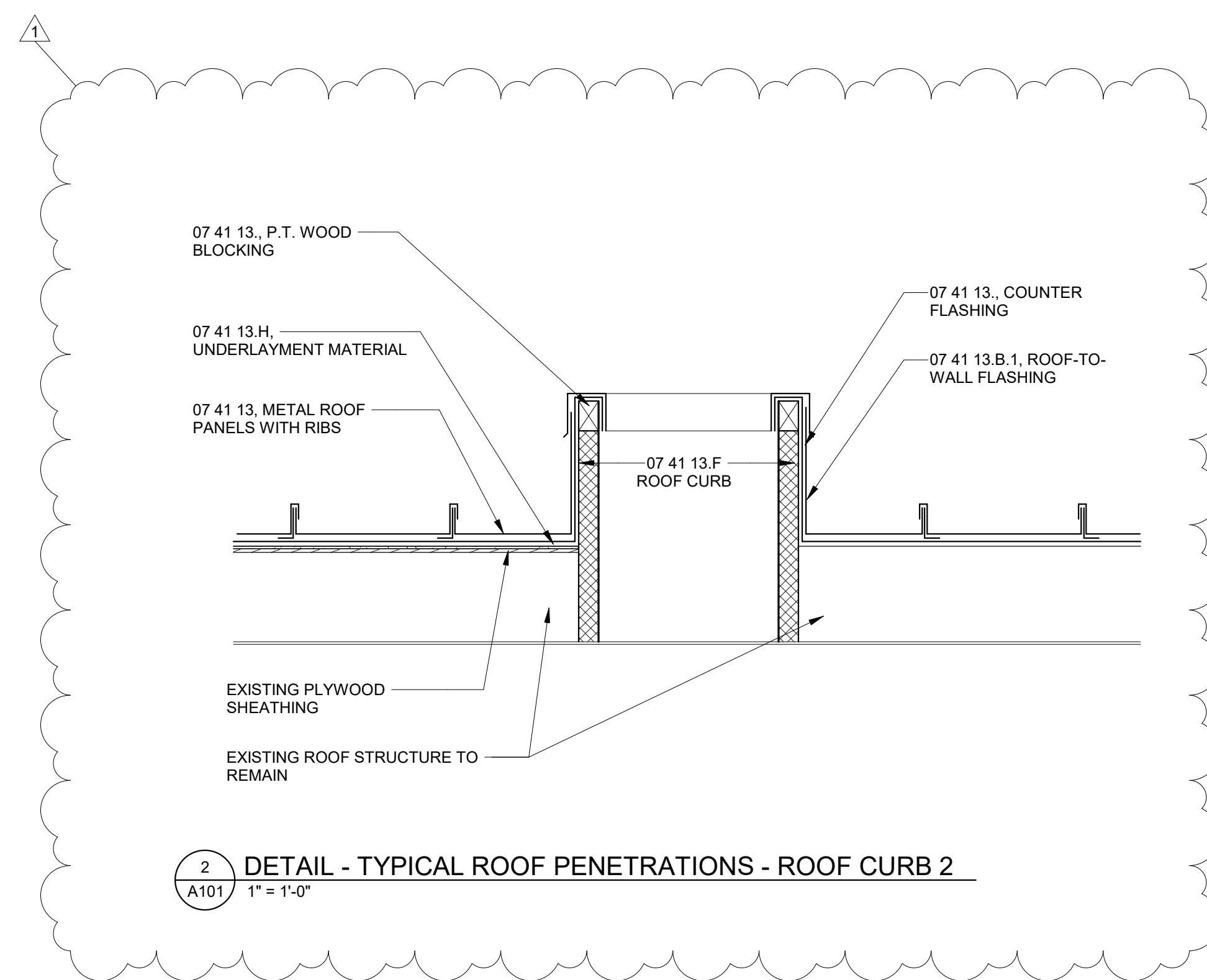

2 DETAIL - TYPICAL ROOF PENETRATIONS - ROOF CURB 2  
A101 1" = 1'-0"

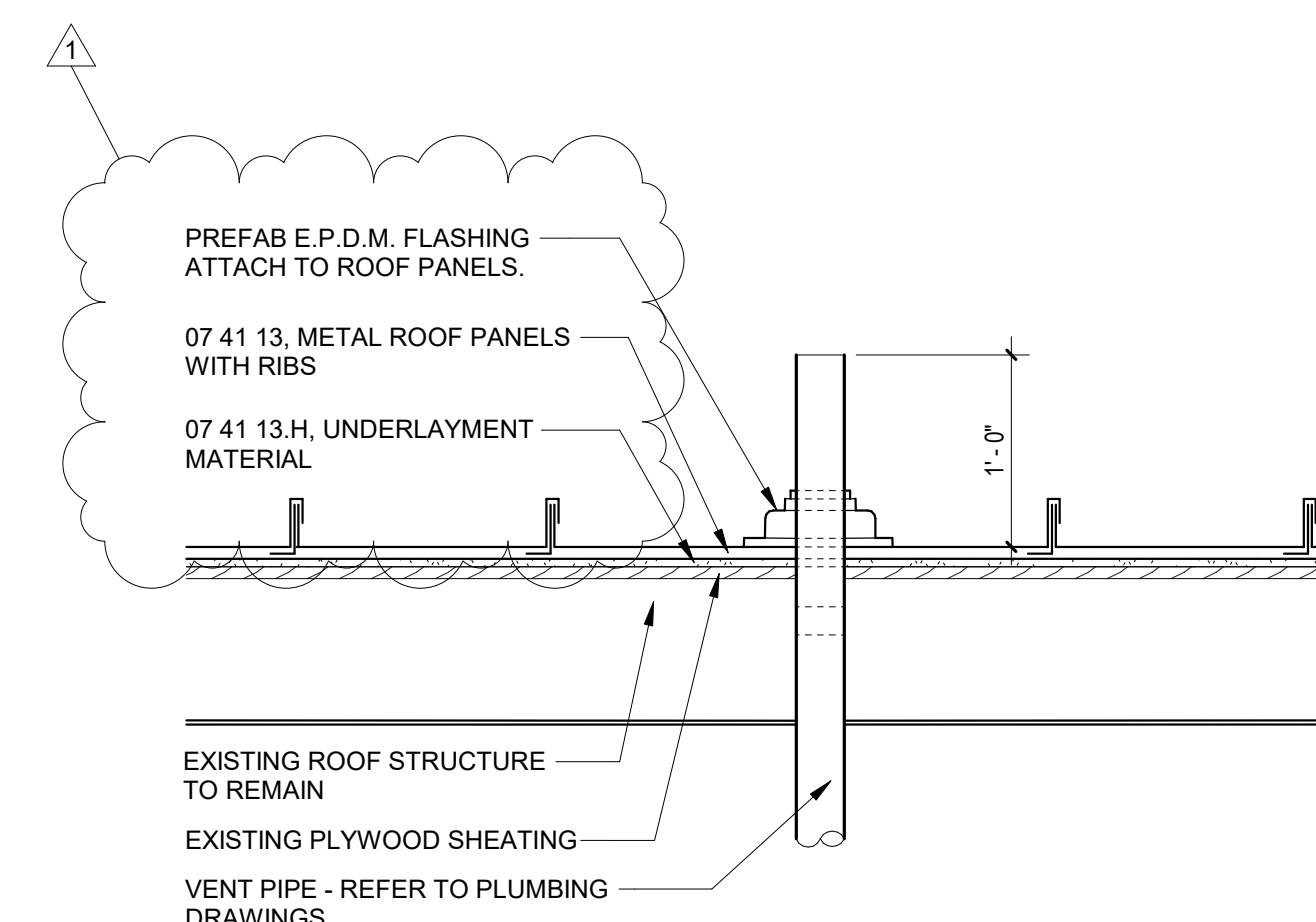

3 DETAIL - TYPICAL VENT THRU ROOF  
A101 1" = 1'-0"

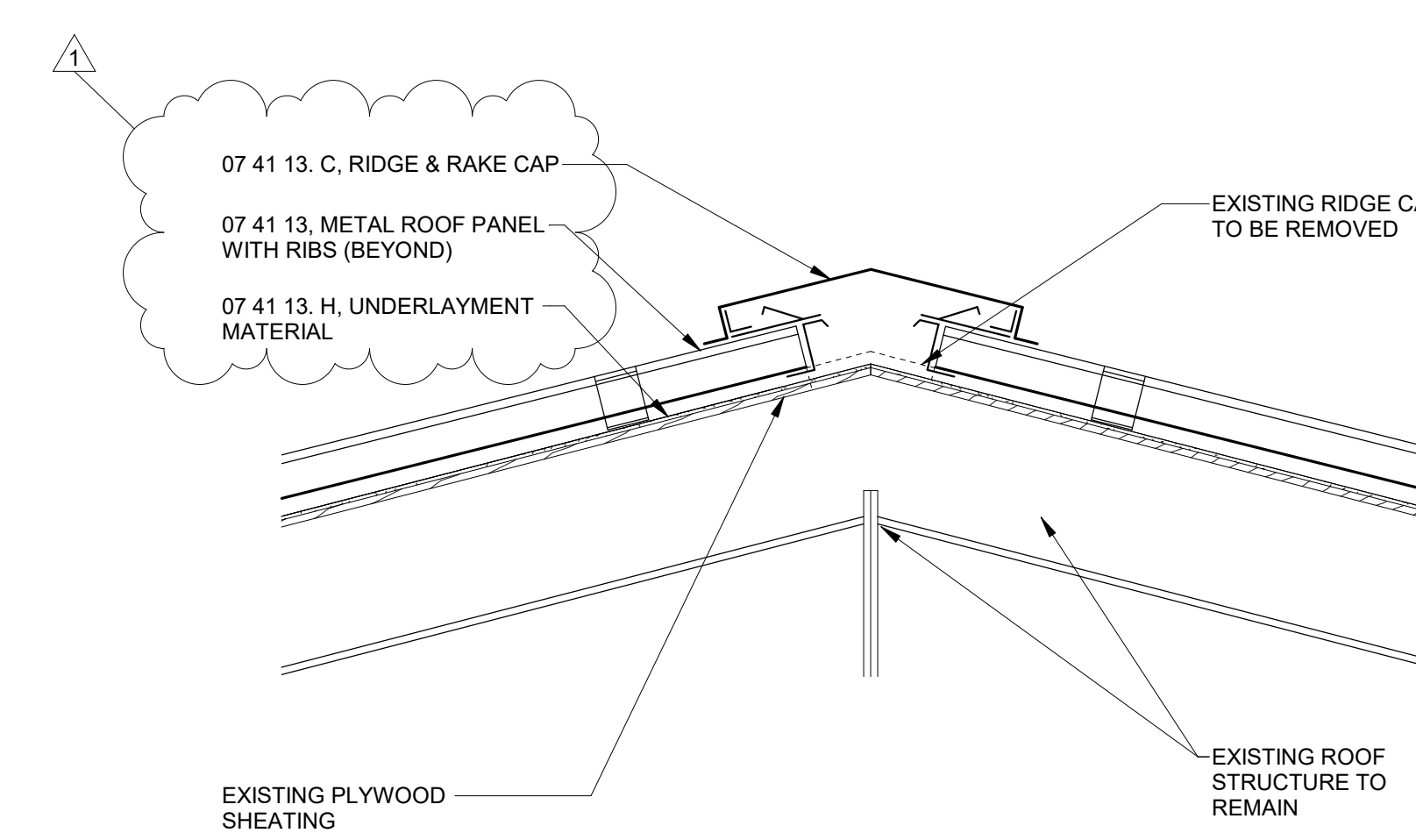

4 DETAIL - TYPICAL NON-VENTED RIDGE CAP  
A101 1" = 1'-0"

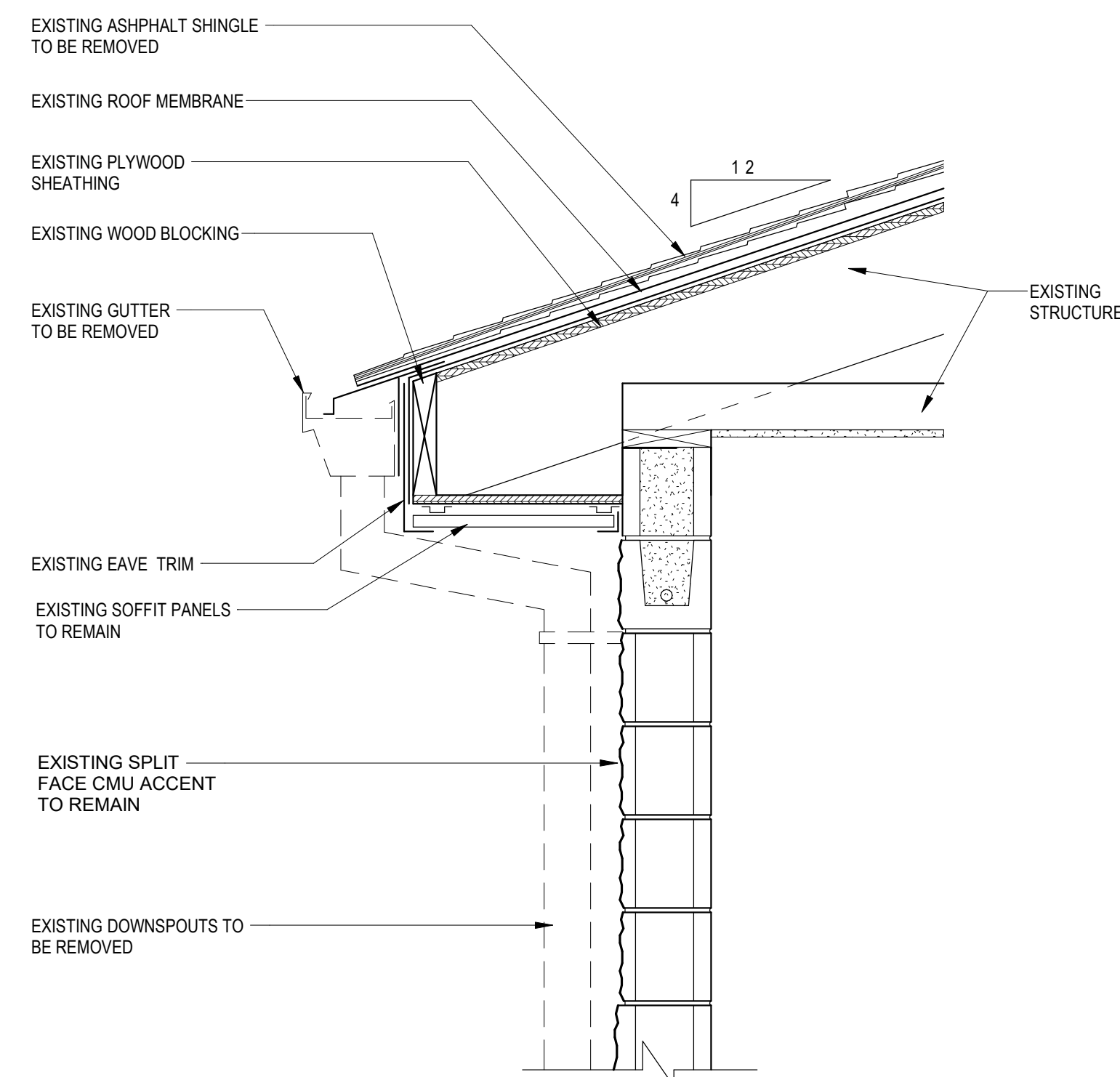

5 SECTION - TYPICAL DEMOLITION EAVE WALL SECTION  
A101 1" = 1'-0"

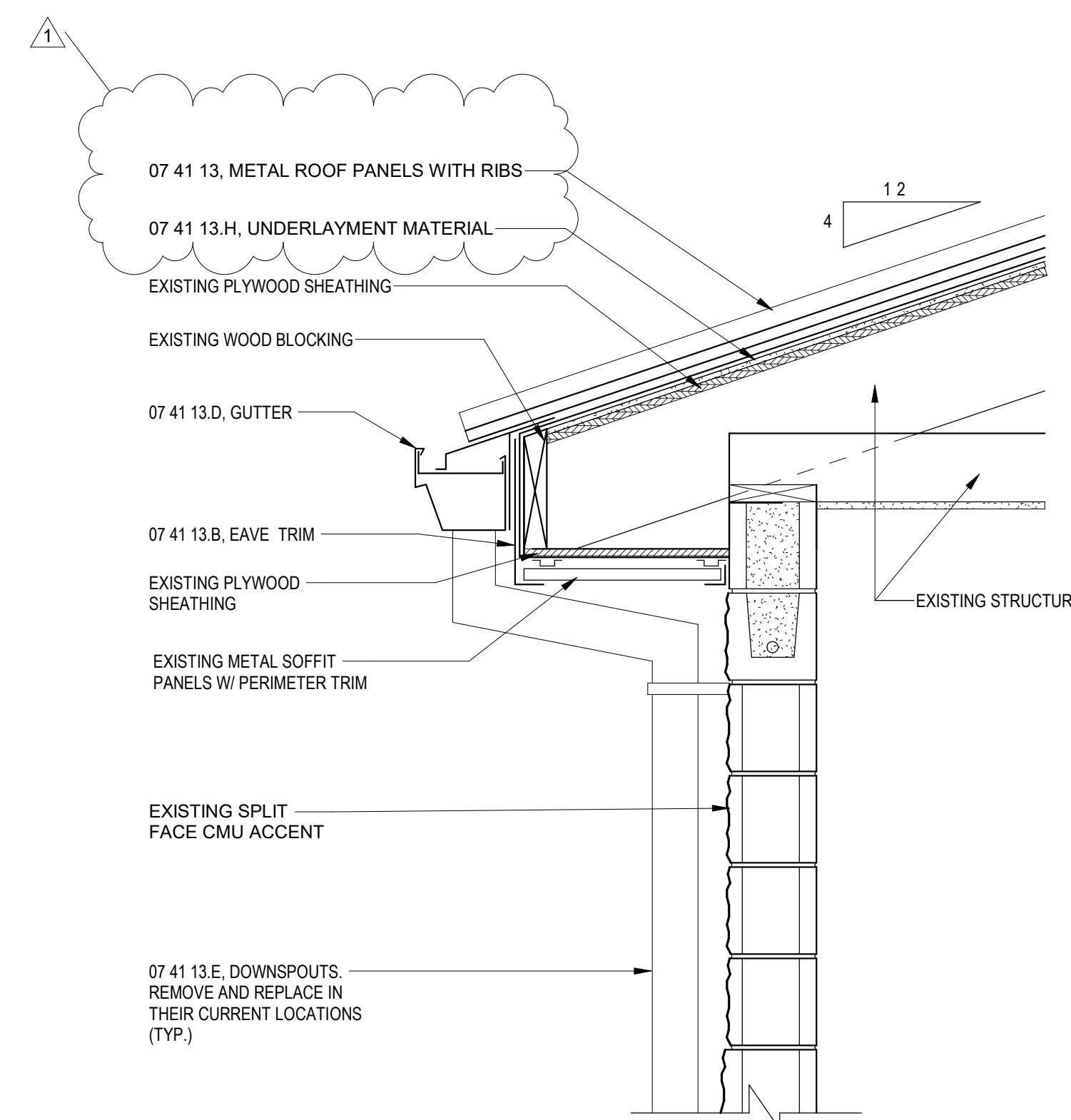

6 SECTION - TYPICAL NEW EAVE WALL SECTION  
A101 1" = 1'-0"

SA&E PROJECT NUMBER	01-920-029
BID PACKAGE	BP-1
ISSUED FOR CONSTRUCTION	04-01-2022
REVISIONS	
R #	Doc # Date
1	AD2 05-20-2022
SCHOOL CODE NUMBER:	
Reroof & Gutter Replacement to:	
<b>LAFAYETTE HIGH SCHOOL</b>	
<b>CONCESSION BUILDINGS</b>	
5178 ROUND POND RD, LaFayette, GA 30728	
<b>WALKER COUNTY SCHOOL DISTRICT</b>	
201 S DUKE ST, LAFAYETTE, GA 30728	

**Southern A&E**  
LLC  
architects & engineers  
7951 Troon Circle  
Austell, Ga 30168  
(770) 819-7777  
© COPYRIGHT 2022 BY SOUTHERN A&E, LLC. ALL RIGHTS RESERVED.  
THIS DOCUMENT IS THE PROPERTY OF SOUTHERN A&E, LLC AND SHALL NOT BE COPIED OR REPRODUCED IN WHOLE OR IN PART WITHOUT EXPRESSED WRITTEN CONSENT FROM SOUTHERN A&E, LLC.

DETAILS	
DRAWING NUMBER	A101

