

PROJECT SUMMARY OF PAY ITEMS			
HIGHLANDS COUNTY PROJECT NO. 436642-1-54-01			
BASE BID			
ITEM NO.	ITEM DESCRIPTION	QUANTITY	UNIT
1	MOBILIZATION	1	LS
2	BONDS & INSURANCE	1	LS
3	CONSTRUCTION SURVEY STAKING INCLUDING AS-BUILT	1	LS
4	TESTING (DENSITY, ROADWAY THICKNESS & CONCRETE)	1	LS
5	MAINTENANCE OF TRAFFIC	1	LS
6	SEDIMENT BARRIER TEMPORARY	18,156	LF
7	CLEARING AND GRUBBING INCLUDING TREE & CONCRETE REMOVAL	1	LS
8	MILLING EXISTING ASPHALT PAVEMENT 1 1/2" AVG. DEPTH (SIDE STREETS)	1,683	SY
9	ASPHALT REMOVAL 2.4" AVG. DEPTH (ROADWAY)	23,218	SY
10	REGULAR EXCAVATION	5,535	CY
11	EMBANKMENT	3,955	CY
12	TYPE B STABILIZATION, LBR 40 (12" COMPACTED THICKNESS) (ROADWAY)	16,609	SY
13	OPTIONAL BASE, BASE GROUP 04, (6" COMPACTED THICKNESS) (DRIVEWAY)	724	SY
14	OPTIONAL BASE, BASE GROUP 9, (10" COMPACTED THICKNESS) (ROADWAY)	23,218	SY
15	SHELL ROCK BASE OUTSIDE EXISTING TRAVEL LANES, (15.5" THICK COMPACTED THICKNESS)	5,429	SY
16	SUPERPAVE ASPHALTIC CONC, SP-9.5 (PLACED IN ONE LIFT-1.5" THICK) ROADWAY	2,579	TN
17	SUPERPAVE ASPHALTIC CONC, SP-12.5 (PLACED IN ONE LIFT-1.5" THICK) ROADWAY	2,579	TN
18	SUPERPAVE ASPHALTIC CONCRETE, SP-9.5 (1.5" THICK, PLACED IN ONE LIFT) SIDE STREETS	179	TN
19	CONCRETE DRIVEWAYS, 6" THICK, (3,500 PSI MIN.)	630	SY
20	PERFORMANCE TURF (SOD)	43,450	SY
21	SINGLE POST SIGN, F & I, GROUND MOUNT, <12 SF	21	AS
22	SINGLE POST SIGN, REMOVE	22	AS
23	TEMPORARY PAINTED PAVEMENT MARKINGS, STD, WHITE, SOLID, 6"	3.49	GM
24	TEMPORARY PAINTED PAVEMENT MARKINGS, STD, WHITE, SOLID, 24" STOP BAR	214	LF
25	TEMPORARY PAINTED PAVEMENT MARKINGS, STD, YELLOW, SOLID, 6"	2.58	GM
26	TEMPORARY PAINTED PAVEMENT MARKINGS, STD, YELLOW, SKIP, 6" (10'/30')	0.37	GM
27	THERMOPLASTIC, STANDARD, WHITE, SOLID, 6"	3.49	GM
28	THERMOPLASTIC, STANDARD, WHITE, SOLID, 6", RUMBLE STRIP SET - PERMANENT	4.00	EA
29	THERMOPLASTIC, STANDARD, WHITE, SOLID, 24" FOR STOP BAR	214	LF
30	THERMOPLASTIC, STANDARD, YELLOW, SOLID, 6"	2.58	GM
31	THERMOPLASTIC, STANDARD, YELLOW, SKIP, 6" (10'/30')	0.37	GM
32	RETRO-REFLECTIVE / PAVEMENT MARKERS, YELLOW/YELLOW	397	EA
33	MAILBOXES, REMOVE AND RELOCATE	22	EA

PAY ITEM FOOTNOTE

1. ITEM NO. 5, THE CONTRACTOR WILL PREPARE A TRAFFIC CONTROL PLAN UTILIZING M.U.T.C.D. AND FDOT INDEXES. COUNTY APPROVAL IS REQUIRED PRIOR TO THE BEGINNING OF CONSTRUCTION. PROVIDE AND MAINTAIN ADEQUATE ACCESS TO ALL INTERSECTING STREETS. ALL COSTS INVOLVED IN PLAN PREPARATION, FURNISHING, INSTALLING AND MAINTAINING EQUIPMENT NECESSARY TO SAFELY MAINTAIN TRAFFIC THROUGHOUT THE LIFE OF THE PROJECT IS INCLUDED IN THE ITEM NO. 5 TOTAL.

2. ITEM NO. 10, INCLUDES ALL EXCAVATION, INCLUDING SUBSOIL AND EMBANKMENT REQUIRED FOR COMPLETE CONSTRUCTION AND TREE AND SHRUB REMOVAL.

△ 3. ITEMS NO. 27 THROUGH 31, MATERIAL MUST BE A RESILIENT THERMOPLASTIC PRODUCT WHICH IS CAPABLE OF BEING AFFIXED TO BITUMINOUS AND/OR PORTLAND CEMENT CONCRETE PAVEMENTS WITHOUT THE USE OF MECHANICAL FASTENERS.

4. CONTRACTOR TO VERIFY ALL QUANTITIES.

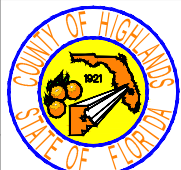
REVISIONS				STATUS	DESIGNED BY: J.D. LANGFORD, JR., P.E.	DRAWN BY: BRUCE DOREY	CHECKED BY: CLINTON HOWERTON, P.E.	IN CHARGE: J.D. LANGFORD, JR., P.E.	DATE: 2/17/2022	HIGHLANDS COUNTY ENGINEERING DEPARTMENT 505 S. COMMERCE AVENUE SEBRING, FLORIDA 33870	APPROVED BY: JAMES D. LANGFORD, JR., P.E. FLORIDA REGISTRATION NO.: 78402	DATE:	SCALE: HORIZ. N/A VERT. N/A	PROJECT NO. 18008	REV. 0
DATE	BY	REV. #	DESCRIPTION												
2-17-22	BWD	△	REVISED PAY ITEM FOOTNOTE - NOTE #3 ITEM NO.	<b>FOR BID</b>	<div style="display: flex; justify-content: space-between; align-items: center;">  <div style="text-align: center;"> <p>WEST STRYKER ROAD ROADWAY IMPROVEMENTS SUMMARY OF PAY ITEMS</p> </div> </div>										

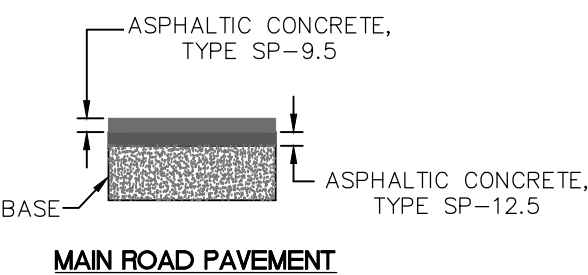
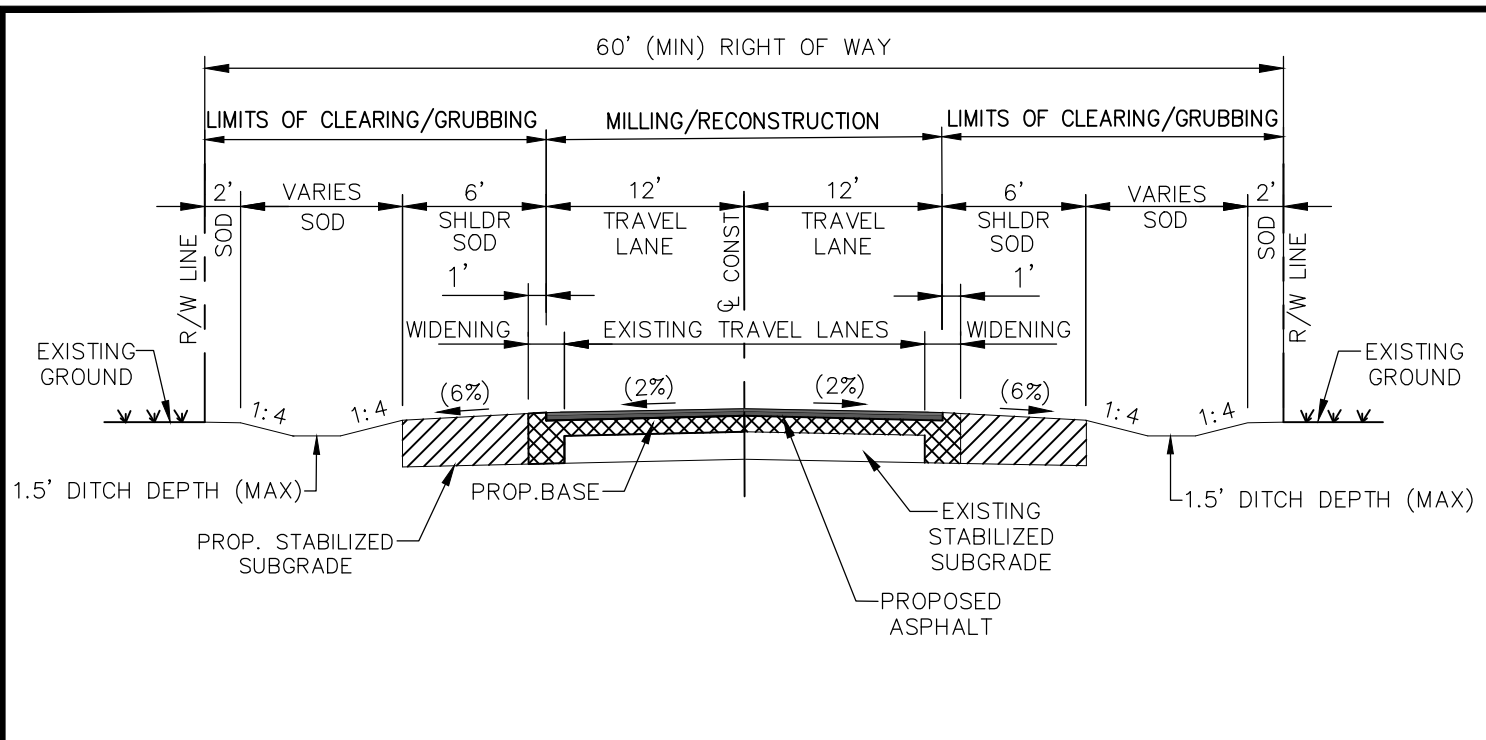

**TYPICAL SECTION**  
**STA. 2+12.43 TO STA. 39+40.47,**  
**STA. 43+53.16 TO STA. 79+78.46,**  
**STA. 85+40.19 TO STA. 100+69.72**

**ASPHALT REMOVAL**  
MILL AVERAGE 2.4" EXISTING ASPHALT

**PAVEMENT RECONSTRUCTION (EXISTING TRAVEL LANE)**  
3" THICK SUPERPAVE ASPHALTIC CONCRETE, 1-1/2" TYPE SP-9.5,  
1-1/2" TYPE SP-12.5  
OPTIONAL BASE GROUP 9 (10" COMPACTED THICKNESS), EXISTING BASE 8" THICK AVERAGE.

**PAVEMENT WIDENING**  
3" THICK SUPERPAVE ASPHALTIC CONCRETE, 1-1/2" TYPE SP-9.5  
1-1/2" TYPE SP-12.5  
15.5" THICK SHELLROCK BASE OR EQUIVALENT

**STABILIZED SHOULDER**  
TYPE B STABILIZATION (LBR 40)  
12" COMPACTED THICKNESS (TYP.)

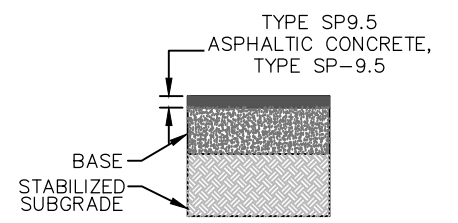

**SIDE ROAD PAVEMENT**  
MILL 1.5" EXISTING ASPHALT  
OVERBUILD SP9.5 TO MEET PROPOSED GRADES. RESURFACE 1.5" SP9.5 ASPHALTIC CONCRETE

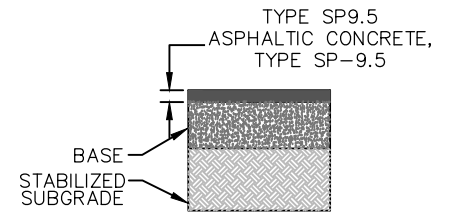

**SIDE ROAD UNPAVED**  
1.5" THICK SUPERPAVE ASPHALTIC CONCRETE, TYPE SP 9.5  
OPTIONAL BASE GROUP 9 (10" COMPACTED THICKNESS)  
TYPE B STABILIZATION (LBR 40) 12" COMPACTED THICKNESS (TYP.) MIX EXISTING BASE INTO SUBGRADE

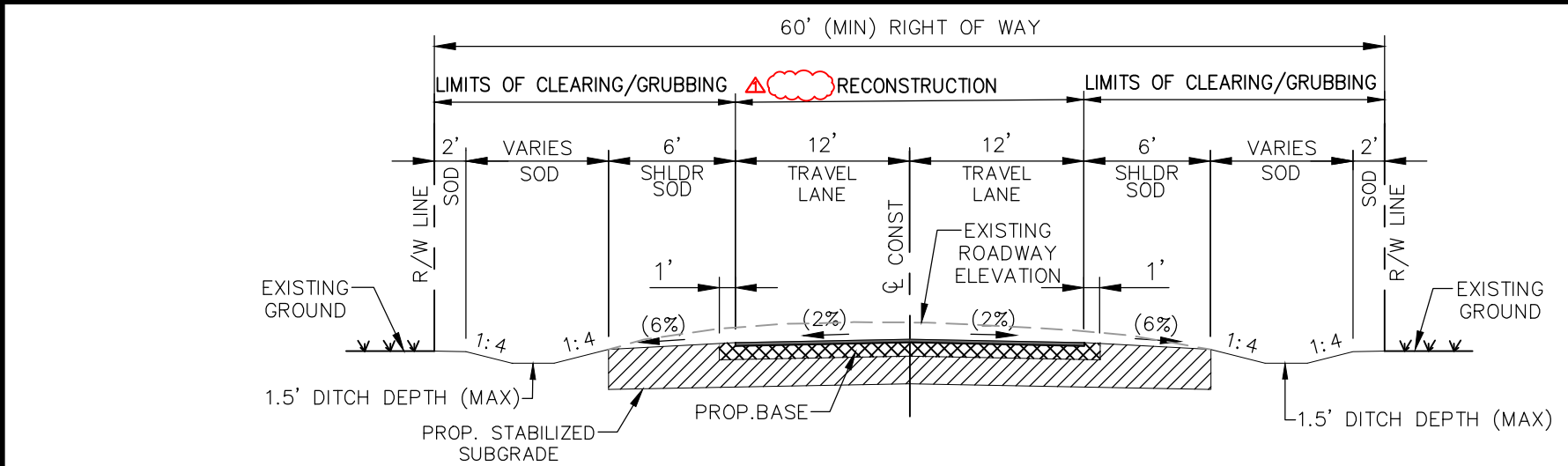

**TYPICAL SECTION**  
**STA. 39+40.47 TO STA. 43+53.16,**  
**STA. 79+78.46 TO STA. 85+40.19**

**ROADWAY VERTICAL CURVE REALIGNMENT**  
REMOVE EXISTING ASPHALT BASE & SUBGRADE MATERIAL. EXCAVATE VERTICAL CURVE TO ELEVATIONS SHOWN ON PLAN SET.

**PAVEMENT RECONSTRUCTION**  
3" THICK SUPERPAVE ASPHALTIC CONCRETE, 1-1/2" TYPE SP-9.5,  
1-1/2" TYPE SP-12.5  
OPTIONAL BASE GROUP 9 (10" COMPACTED THICKNESS), EXISTING BASE 8" THICK AVERAGE. TYPE B STABILIZATION (LBR 40) 12" COMPACTED THICKNESS (TYP.) MIX EXISTING BASE INTO SUBGRADE

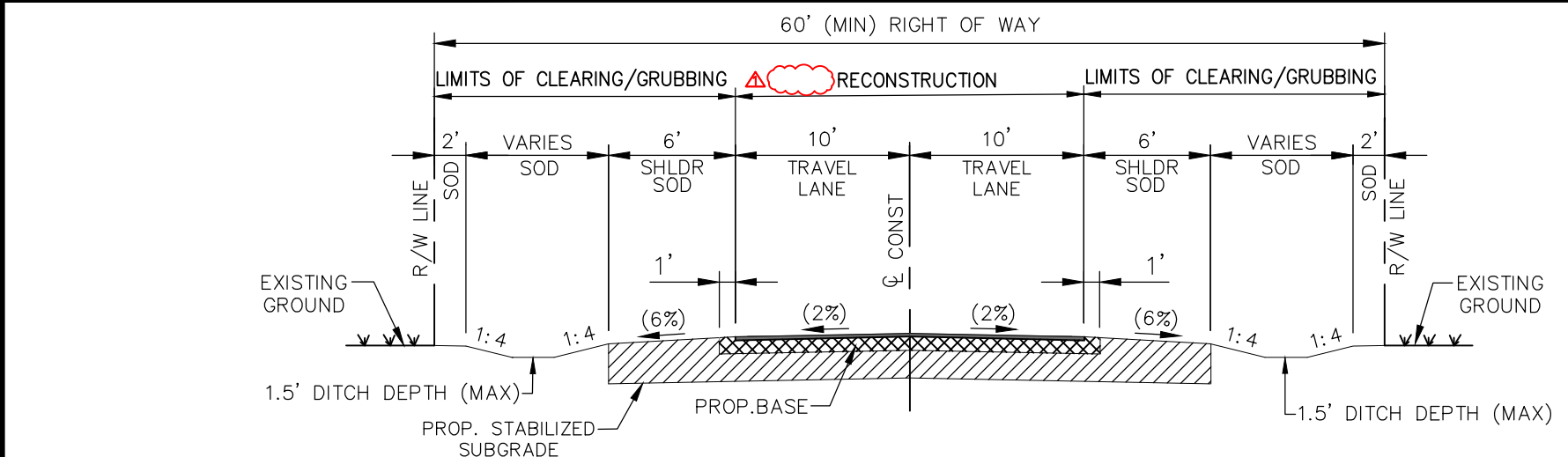

**TYPICAL SECTION N. OLEANDER DRIVE**  
**STA. 3+3.34 TO STA. 3+88.06**  
**STA. 4+12.06 TO STA. 5+70.11**

**PAVEMENT RECONSTRUCTION**  
1.5" THICK SUPERPAVE ASPHALTIC CONCRETE, TYPE SP-9.5.  
OPTIONAL BASE GROUP 9 (10" COMPACTED THICKNESS)  
(12" COMPACTED THICKNESS) TYPE B STABILIZATION, LBR 40

REVISIONS		
DATE	BY	DESCRIPTION
4-06-21	BWD	ADDED TYPE B STABILIZATION NOTE
10-7-21	DMN	REVISE BASE AND DIMENSIONS
2-17-22	BWD	ADDED TYPE B STABILIZATION NOTE TO PAVEMENT RECONSTRUCTION NOTE AND REMOVED "MILLING"

STATUS	
<b>FOR BID</b>	

**HIGHLANDS COUNTY ENGINEERING DEPARTMENT**  
505 S. COMMERCE AVENUE  
SEBRING, FLORIDA 33870

DESIGNED BY: J.D. LANGFORD, JR., P.E.  
DRAWN BY: BRUCE DOREY  
CHECKED BY: CLINTON HOWERTON, P.E.  
IN CHARGE: J.D. LANGFORD, JR., P.E.  
DATE: 2/17/2022

APPROVED BY: JAMES D. LANGFORD, JR., P.E.  
FLORIDA REGISTRATION NO.: 78402



**WEST STRYKER ROAD ROADWAY IMPROVEMENTS**

TYPICAL SECTION

SCALE:  
HORIZ. N/A  
VERT. N/A

PROJECT NO. 18008  
REV. 0

SHEET 4 OF 59

G:\PROJECTS\2018\18008 W. Stryker Road Roadway Improvements\Design\Drawings\W.Stryker Rd Cover Notes Typ Sec.dwg. West Stryker Road Resurface - 11x17 TYP SEC, Dorey, Bruce Colors As Black Except Gray Colors.ctb

# GENERAL NOTES AND SPECIFICATIONS

## GENERAL CONSTRUCTION NOTES

- The Contractor shall be responsible for furnishing all material and labor to construct the facility as shown and described in the construction documents.
- The Contractor shall be responsible for obtaining all required construction bonds prior to construction.
- The Contractor shall have available at the job site at all times one copy of the construction documents including plans, specifications, and special conditions and copies of any required construction permits.
- Any discrepancies on the drawings shall be immediately brought to the attention of the Highlands County Project Manager before commencing work. No field changes or deviations from design are to be made without prior approval of the Highlands County Project Manager.
- Contractor shall submit a construction schedule MOT Plan, Lines of Authority, Subcontractors List to the Highlands County Project Manager prior to commencement of construction. The MOT Plan shall also be provided to the governing railroad agency by the Contractor, prior to construction.
- Contractor shall coordinate proposed construction with affected property owners.
- Contractor shall repair and/or replace all disturbed irrigation. Contractor shall coordinate this activity with affected property owners.

## EROSION CONTROL

- The Contractor shall grade the site to the elevations indicated and shall regrade washouts where they occur after every rainfall event until sod is well established or adequate stabilization occurs.
- Contractor shall denote on plan the temporary parking and storage area which shall also be used as the equipment maintenance and cleaning area, employee parking area, and area for locating toilet facilities. Contractor shall be responsible for all coordination and expenses related to securing the area stated in the said area.
- All wash water (concrete trucks, vehicle cleaning, equipment cleaning, etc.) shall be detained and properly treated and disposed.
- The Contractor shall be responsible for the control of dust and dirt rising and scattering in the air during construction and shall provide water sprinkling or other suitable methods of control. The Contractor shall comply with all governing regulations pertaining to environmental protection.
- The use of motor oils and other petroleum based or toxic liquids for dust suppression operations is prohibited.
- Sod must be installed and maintained on exposed slopes within 48 hours of completing final grading, and at any other time as necessary, to prevent erosion, sedimentation or turbid discharges.
- Stabilization practices should be initiated as soon as practical, but in no case more than 7 days where construction has temporarily ceased.
- All materials spilled, dropped, washed or tracked from vehicles onto roadways or into storm drains must be removed as soon as possible.
- On-site & off-site soil stockpile and borrow areas shall be protected from erosion and sedimentation through implementation of best management practices.
- Slopes shall be left in a roughened condition during the grading phase to reduce runoff velocities and erosion.
- Due to grade changes during the development of the project, the Contractor shall be responsible for adjusting the erosion control measures (silt fence, etc.) to prevent erosion.
- All construction shall be stabilized at the end of each working day, this includes back filling of trenches for utility construction and placement of gravel or bituminous paving for road construction.
- The contractor shall install sediment barrier as shown on plans within the perimeter of the project site.

## SURVEY AND STAKEOUT

- Existing section corners and 1/4 Section corners, and other land markers or monuments located within proposed construction area to be referenced prior to construction and reset after construction. The Contractor shall have this work done by a registered Professional Land Surveyor at the Contractor's expense (Florida Registration). Any public land corner within the limits of construction is to be protected. If a corner monument is in danger of being destroyed and has not been properly referenced, the Contractor should notify the County Surveyor, without delay, by telephone (863-402-6877).
- Benchmark data is North American Vertical Datum of 1988 (NAVD 88).
- Any NGVD-29 monument within the limits of construction is to be protected. If in danger of damage, the Contractor should notify: Geodetic Information Center, Attn: Mark Maintenance Section N/CG-162, 6001 Executive Boulevard, Rockville, Maryland 20852. Telephone (301) 443-8319.
- Grades shown are the finished grades, unless otherwise indicated.
- The Contractor shall remove survey stakes and erosion control items prior to the completion of the contract.
- The Contractor shall be responsible for submitting to the Highlands County Project Manager a certified record survey signed and sealed by a Professional Land Surveyor registered in the state of Florida depicting the actual field location of all constructed improvements that are required by the jurisdictional agencies for the certification process. All survey costs will be the Contractor's responsibility.

## UTILITIES

- It is the Contractor's responsibility to contact the various utility companies which may have buried or aerial utilities within or near the construction area before commencing work. The Contractor shall provide 48 hours minimum notice to all utility companies in advance of any excavation involving their utilities so that a company representative can be present. A list of the utility companies which the Contractor MUST call before commencing work is provided in these construction plans. This list serves as a guide only and is not intended to limit the utility companies which the contractor may wish to notify.
- Existing utilities shown are located according to the information available to the Engineer at the time of the topographic survey and have not been independently verified by the Owner or the Engineer. Guarantee is not made that all existing underground utilities are shown or that the location of those shown are entirely accurate. Finding the actual location of any existing utilities is the Contractor's responsibility and shall be done before he/she commences any work in the vicinity. Furthermore, the Contractor shall be fully responsible for any and all damages due to the Contractor's failure to exactly locate and preserve any and all underground utilities. The Owner or Engineer will assume no liability for any damages sustained or cost incurred because of the operations in the vicinity of existing utilities or structures, nor for temporary bracing and shoring of same. If it is necessary to shore, brace, swing or relocate a utility, the utility company or department affected shall be contacted and their permission obtained regarding the method to use for such work. In addition, the Contractor shall be responsible to verify if "other" utilities (Not shown in the plans) exist within the area of construction. Should there be utility conflicts, the Contractor shall inform the Engineer and notify the respective utility owners to resolve utility conflicts and utility adjustments as required.
- The Contractor is to use caution when working in or around areas of overhead transmission lines or underground utilities.
- The Contractor is responsible for the protection of all utilities to remain in place.
- The Contractor shall call 811 for field locations no less than 48 hours in advance of digging near underground utilities.
- Prior to commencement of any excavation, the contractor shall comply with Florida Statute 553.851 for the protection of underground gas pipelines.
- All valves within area of construction or disturbed by construction to be adjusted to finished grade. Replace valve collars and boxes as necessary.

## CLEARING AND GRUBBING

- Contractor shall clear and grub all areas as per the typical section, removing trees, stumps, roots, muck, existing pavement, existing concrete and all other deleterious material.

## PAVING, GRADING AND DRAINAGE

- Where new pavements meets the existing pavement, the Contractor shall saw cut the existing pavement a minimum 2" deep for a smooth and straight joint and match the existing pavement elevation with the proposed pavement unless otherwise indicated.
- All cut or fill slopes shall be 4 (horizontal): 1 (vertical) or flatter unless otherwise shown.
- Existing drainage structures within construction limits shall remain unless noted otherwise.
- Contractor is responsible for repairing any existing concrete or asphalt areas that are disturbed during construction.
- All roadway millings shall be transported to the Highlands County Asphalt Plant located at 12700 Arbuckle Creek Rd., Sebring, FL 33870.

## PAVEMENT MARKING AND SIGNAGE

- Stop bars shall be 24" white stripes.
- Temporary pavement markings shall be provided by the end of each day's operation.
- All pavement markings and signage shall be installed in accordance with the Manual on Uniform Traffic Control Devices (MUTCD), Latest Edition.
- Temporary pavement markings and thermoplastic pavement markings shall be installed via truck mounted spray truck.
- Retro-reflective material shall be 3M brand Diamond Grade material.
- Sign substrate shall be aluminum.
- Traffic signs shall be mounted on 3" diameter post with "Z" bar brackets.
- Sign post underground support shall be 6" aluminum "Z" bar brackets (no concrete).
- All removed sign assemblies shall be brought by The Contractor to the Highlands County Traffic Operations Office located at 4300 George Blvd., Sebring, FL 33875.

## SOD

- All disturbed areas within the project limits shall be sodded with "like kind" sod. The areas on which sod is to be placed shall be thoroughly wetted prior to and after placement is complete. No addition of top soil material is required prior to placement unless otherwise directed by the Engineer.
- All sod materials shall be subject to inspection by the Highlands County Project Manager prior to placement. Any sod with noxious weeds and grasses including tropical soda apple, shall be rejected for use on the spot.
- All areas within the project site shall be sodded unless otherwise directed in these construction plans.
- Contractor shall guarantee a year on the sod placed.
- Contractor shall provide irrigation to newly installed sod per FDOT Spec. 570 & 983 Latest Edition.

## TESTING

- Contractor shall perform, at his own expense, any and all tests required by the specifications and/or any agency having jurisdiction. A copy of the test results shall be provided to the Highlands County Project Manager.
- The Highlands County Project Manager shall inspect all construction and is authorized to call to the attention of the Contractor any failure of work or materials to conform with the plans and specifications.
- All copies of compaction, concrete and other required test results are to be sent to the Highlands County Project Manager directly from the testing agency.
- Contractor shall perform Pavement Smoothness Testing: The Contractor shall furnish a 15 foot manual and a 15 foot rolling straightedge and construct a smooth pavement meeting the requirements of the Florida Method of Test for Measurement of Pavement Smoothness with the 15-Foot Rolling and Manual Straightedges (Designation: FM 5-509, May 16, 2002, Revised: March 17, 2008).

Straightedge Testing: The Contractor shall test the final (top) layer of all pavement where the width is constant using a rolling straightedge either behind the final roller of the paving train or as a separate operation. The Contractor shall correct all deficiencies in excess of 3/16 inch by removing and replacing the full depth of the layer, extending a minimum of 50 feet on both sides of the defective area for the full width of the paving lane, at no additional cost, unless waived by the County Engineer. The Contractor shall retest all corrected areas. The Contractor shall test all pavement lanes and document all deficiencies on a form approved by the Highlands County Project Manager. The Contractor shall notify the Highlands County Project Manager of the location and time of all straightedge testing a minimum of 48 hours before beginning testing.

Straightedge Exceptions: Straightedge testing will not be required in the following areas: shoulders, intersections, tapers, crossovers, sidewalks, bicycle/shared use paths, parking lots and similar areas, or in the following areas when they are less than 250 feet in length: turn lanes, acceleration/deceleration lanes and side streets. In the event the Highlands County Project Manager identifies a surface irregularity in the above areas that is determined to be objectionable, the Contractor shall straightedge and address all deficiencies in excess of 3/8 inch in accordance by removing and replacing the full depth of the layer, extending a minimum of 50 feet on both sides of the defective area for the full width of the paving lane, at no additional cost.

## BASE MATERIALS METHOD:

- When the specified compacted thickness of the base is greater than 6 inches, the contractor shall construct the base in multiple courses of equal thickness. Individual course shall not be less than 3 inches. If through field tests, the contractor can demonstrate that the compaction equipment can achieve density for the full depth of a thicker lift, and if approved by the county engineer's office, the base may be constructed in successive courses of not more than 10 inches compacted thickness.

2. The contractor shall conduct testing for base materials per FDOT Specifications. 

## ASPHALT:

- The amount of reclaimed asphalt pavement (rap) material shall not exceed 30% by weight of total aggregate for the asphalt.

PROJECT CONTROL POINTS						
Number	Northing	Easting	Elevation	Station	Off-Set	Description
1	1193997.2070	479043.0440	142.27'	2+42.62	27.82' Right	Set 5/8" Iron and Cap stamped "Highlands County"
2	1193987.7140	482962.5430	162.63'	41+75.01	19.52' Right	Set 5/8" Iron and Cap stamped "Highlands County"

LINE LEGEND	
---OHW---	OVERHEAD WIRES
---BE---	BURIED ELECTRIC
---CAS---	CONDUIT & CASEMENTS
---BFO---	BURIED FIBER OPTIC
---BT---	BURIED TELEPHONE
---FM---	FORCE MAIN
---G---	GAS LINE
---W---	WATER LINE
---CTV---	CABLE TELEVISION
---X---	WIRE FENCE
---O---	CHAIN LINK FENCE
---□---	WOOD FENCE
---	EXISTING TOP OF BANK
---	EXISTING TOE OF SLOPE
---	EXISTING EDGE OF SHELL ROCK
---	EXISTING RIGHT OF WAY LINE
---	PROPOSED RIGHT OF WAY LINE
---	EXISTING GRADE AT RW RT (PROFILE VIEW)
---	EXISTING GRADE AT RW LT (PROFILE VIEW)
---	EXISTING GRADE AT CONST BL (PROFILE VIEW)
---	EXISTING CONTOURS WITH ELEVATIONS
---	PROPOSED CONTOURS WITH ELEVATIONS
---	EXISTING GUARDRAIL
---	EXISTING EASEMENT
---	GOVERNMENT FRACTIONAL LINES
---	LOT LINES
---	PROPOSED SOD SHOULDER LINE
---	PROPOSED BACK OF DITCH
---	PROFILE GRADE LINE (PROFILE VIEW)
---	PROPOSED CURVE RETURN
---	PROPOSED CENTERLINE OR BASELINE

## SYMBOL LEGEND

	BENCHMARK
	CONCRETE MONUMENT
	IRON ROD OR IRON PIPE
	NAIL AND DISK
	CLEANOUT
	ELECTRIC METER
	FLAG CABLE TELEVISION
	FLAG ELECTRIC
	FLAG FIBER OPTIC
	FLAG GAS
	FLAG SEWER
	FLAG TELEPHONE
	FLAG WATER
	FIRE HYDRANT
	GAS VALVE
	ELECTRIC BOX
	TELEPHONE BOX
	TELEVISION BOX
	TRAFFIC SIGNAL BOX
	PEDESTRIAN CROSSWALK
	LIGHT POLE
	MANHOLE DRAINAGE
	MANHOLE OTHER
	MANHOLE SEWER
	MANHOLE TELEPHONE
	MONITORING WELL
	UTILITY POLE
	WATER METER
	WATER VALVE
	WELL
	EXISTING GRADE SHOT
	PROPOSED ELEVATIONS
	BOLLARD
	MAIL BOX
	SIGN
	MITERED END SECTION
	GUY ANCHOR

## ABBREVIATIONS

A.D.	ALGEBRAIC DIFFERENCE
BFS	BEGIN FULL SUPER
BL	BASELINE
BNC	BEGIN NORMAL CROWN
CMP	CORRUGATED METAL PIPE
CONC.	CONCRETE
CONST.	CONSTRUCTION
EFS	END FULL SUPER
ELEV	ELEVATION
ENC	END NORMAL CROWN
EXIST.	EXISTING
HDPE	HIGH DENSITY POLYETHYLENE PIPE
LC	LONG CHORD
LT	LEFT
MES	MITERED END SECTION
PAVT	PAVEMENT
PC	POINT OF CURVATURE
PGL	PROFILE GRADE LINE
PROP.	PROPOSED
PT	POINT OF TANGENCY
PVC	POINT OF VERTICAL CURVE
PVI	POINT OF VERTICAL INTERSECTION
PVT	POINT OF VERTICAL TANGENCY
RW	RIGHT OF WAY
RC	REVERSE CROWN
RCP	REINFORCED CONCRETE PIPE
RT	RIGHT
STA	STATION
TYP	TYPICAL

## TREE LEGEND

	CEDAR TREE
	CITRUS TREE
	CYPRESS TREE
	MAGNOLIA TREE
	MAPLE TREE
	OAK TREE
	PALM TREE
	PINE TREE
	TREE
	TREE A
	TREE B
	TREE C
	TREE D

REVISIONS				STATUS	
DATE	BY	REV. #	DESCRIPTION		
2-17-22	BWD	△	REVISED BASE MATERIALS METHOD -- NOTE #2 AND ADDED SYMBOL IN LEGEND	<b>FOR BID</b>	

DESIGNED BY: J.D. LANGFORD, JR., P.E.	<b>HIGHLANDS COUNTY ENGINEERING DEPARTMENT</b> 505 S. COMMERCE AVENUE SEBRING, FLORIDA 33870
DRAWN BY: BRUCE DOREY	
CHECKED BY: CLINTON HOWERTON, P.E.	
IN CHARGE: J.D. LANGFORD, JR., P.E.	
DATE: 2/17/2022	

APPROVED BY: JAMES D. LANGFORD, JR., P.E.	DATE:
FLORIDA REGISTRATION NO.: 78402	

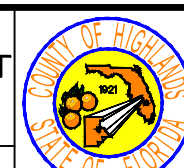

SCALE:  
HORIZ. N/A  
VERT. N/A

WEST STRYKER ROAD  
ROADWAY IMPROVEMENTS

GENERAL NOTES

PROJECT NO. 18008	REV. 0
SHEET 5 OF 59	



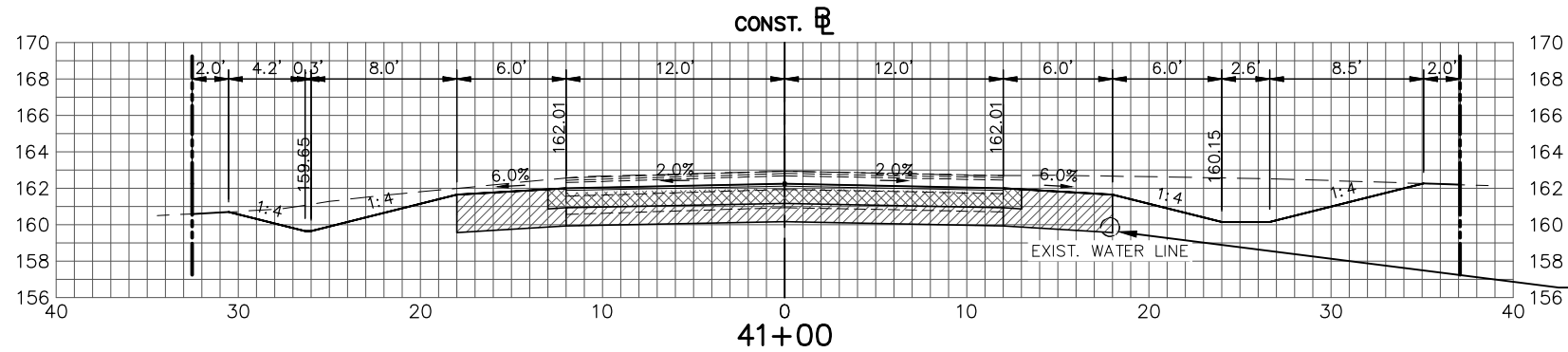

CONTRACTOR TO LOCATE AND PROTECT EXISTING WATER LINE (TYP.)

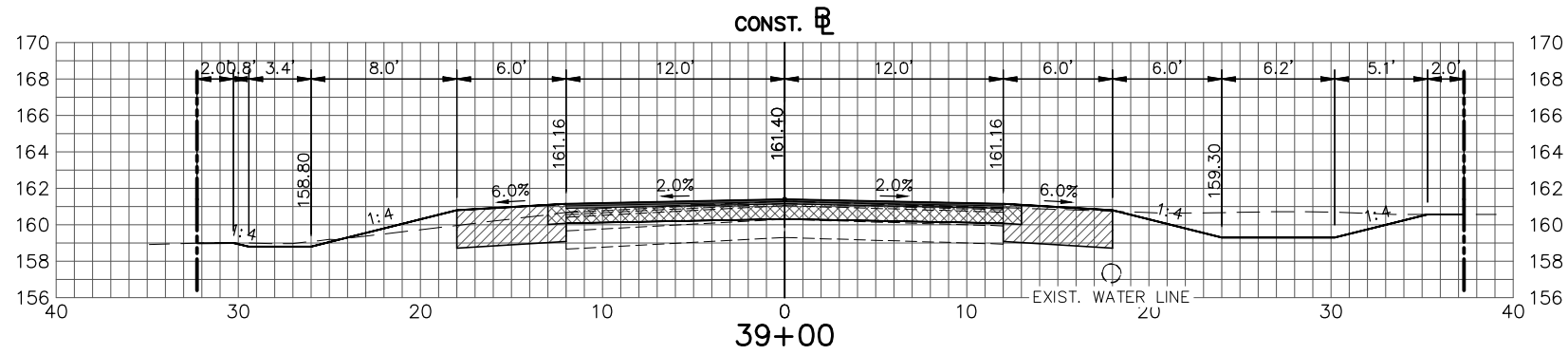
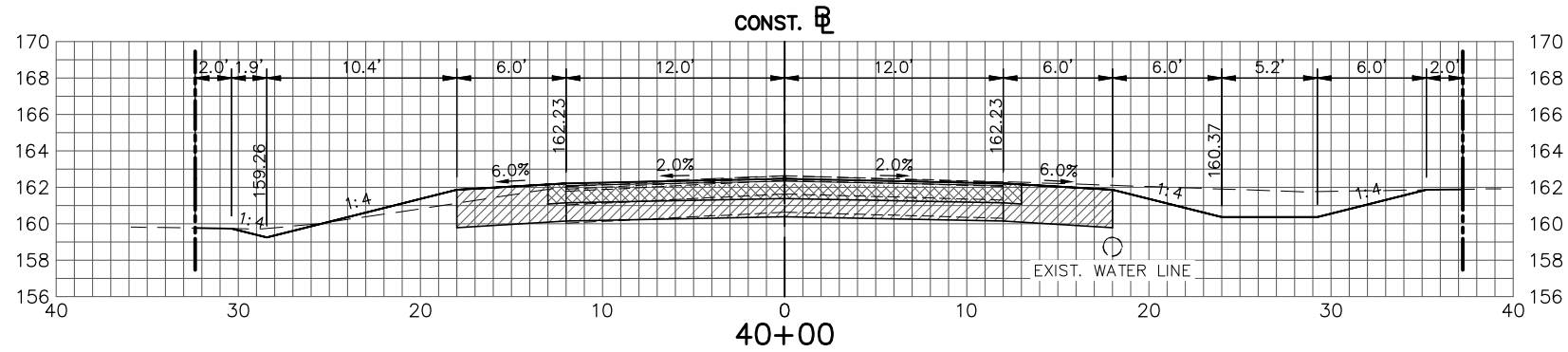
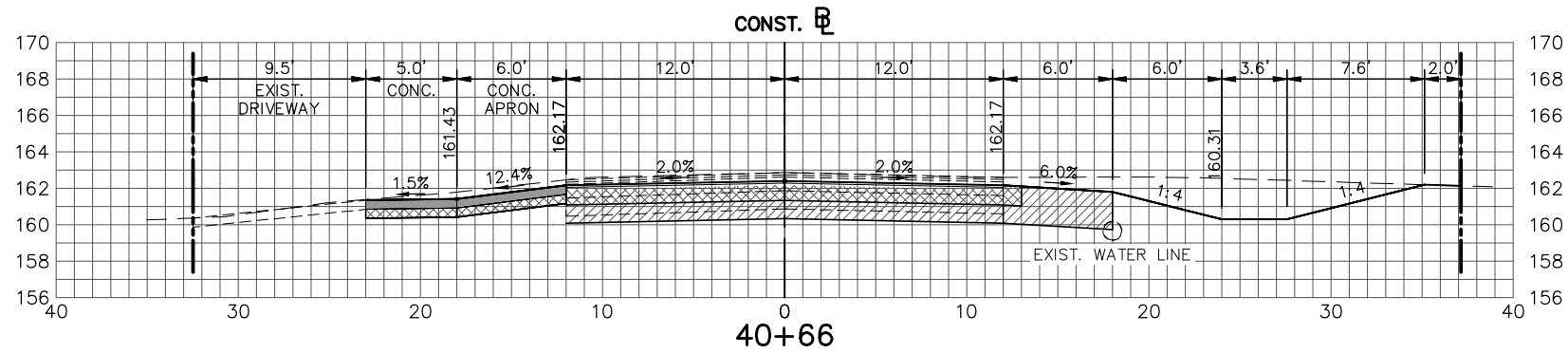

REVISIONS			
DATE	BY	REV. #	DESCRIPTION
2-17-22	BWD	△	ADDED NOTE

STATUS

**FOR BID**

DESIGNED BY: J.D. LANGFORD, P.E.  
 DRAWN BY: DOUG NIETUBICZ  
 CHECKED BY: J.D. LANGFORD, P.E.  
 IN CHARGE: J.D. LANGFORD, P.E.  
 DATE: 2/17/2022

**HIGHLANDS COUNTY ENGINEERING DEPARTMENT**  
 505 S. COMMERCE AVENUE  
 SEBRING, FLORIDA 33870

APPROVED BY: JAMES D. LANGFORD, JR., P.E.  
 FLORIDA REGISTRATION NO.: 78402

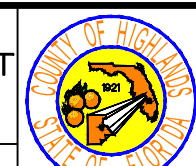

WEST STRYKER ROAD ROADWAY IMPROVEMENTS

CROSS SECTIONS

SCALE:  
 HORIZ. 1"=10'  
 VERT. 1"=10'

PROJECT NO. 18008 REV. 0

SHEET 41 OF 59

G:\PROJECTS\2018\18008 W. Stryker Road Roadway Improvements\Design\Drawings\West Stryker Road Resurface Corridors.dwg, Section Sheet - (12), Dorey, Bruce Colors As Black Except Gray Colors.ctb

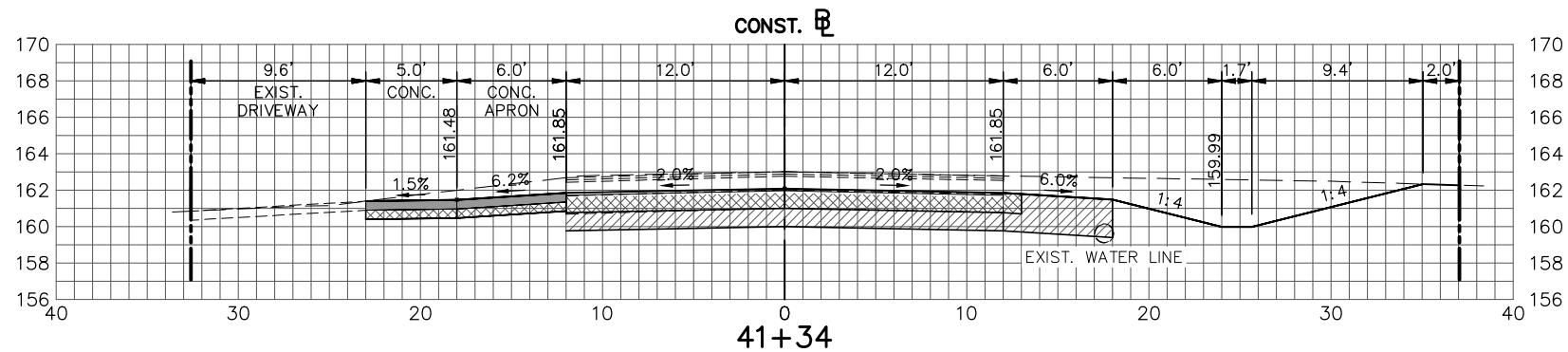
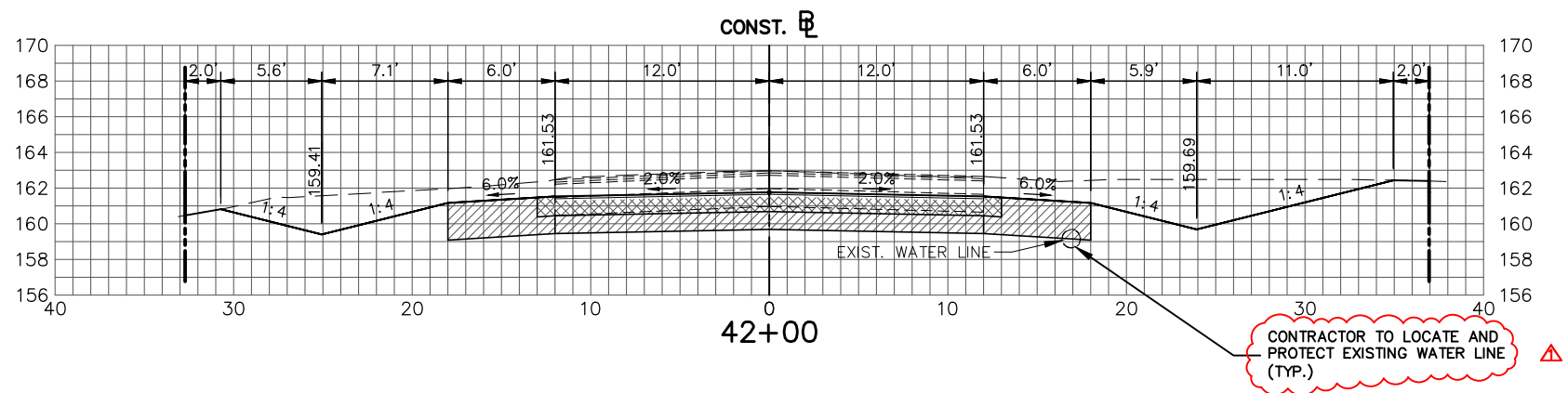
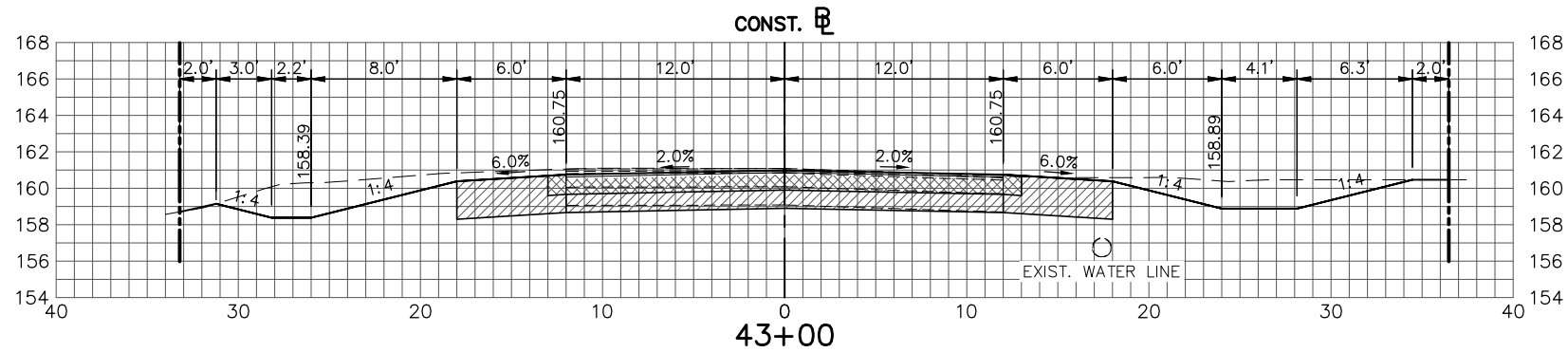

REVISIONS			
DATE	BY	REV. #	DESCRIPTION
2-17-22	BWD	△	ADDED NOTE

FOR BID

DESIGNED BY:  
J.D. LANGFORD, P.E.  
DRAWN BY:  
DOUG NIETUBICZ  
CHECKED BY:  
J.D. LANGFORD, P.E.  
IN CHARGE:  
J.D. LANGFORD, P.E.  
DATE:  
2/17/2022

**HIGHLANDS COUNTY  
ENGINEERING DEPARTMENT**  
505 S. COMMERCE AVENUE  
SEBRING, FLORIDA 33870

APPROVED BY: JAMES D. LANGFORD, JR., P.E.  
FLORIDA REGISTRATION NO.: 78402

DATE:



**WEST STRYKER ROAD  
ROADWAY IMPROVEMENTS**

CROSS SECTIONS

SCALE: HORIZ. 1"=10' VERT. 1"=10'	
PROJECT NO. 18008	REV. 0
SHEET 42 OF 59	