



**Lancaster County School District**  
**Amendment #1**

Solicitation Number	202312
Amendment Issue Date	12/7/2022
Solicitation Issue Date	11/18/2022
Procurement Officer	Trevor Hammond, NIGP-CPP, CPPB
Phone	(803) 416-8828
E-Mail Address	Procurement@lcsd.k12.sc.us

**DESCRIPTION: Custom Bally Walk-In Cooler & Freezer Units for Multiple School Locations**

*The Term "Offer" Means Your "Bid" or "Proposal".*

SUBMIT OFFER BY (Opening Date/Time): **12/15/22 at 2:00 PM – EST**

See "Deadline for Submission of Offer" provision

QUESTIONS MUST BE RECEIVED BY: **11/30/22 at 2:00 PM - EST**

See "Questions from Offerors" provision

NUMBER OF COPIES TO BE SUBMITTED: **One (1) original**

Offers must be submitted in a sealed package. Solicitation Number & Opening Date must appear on package exterior.

**SUBMIT YOUR OFFER TO THE FOLLOWING ADDRESS:**

<b>PHYSICAL &amp; MAILING ADDRESS:</b>
Lancaster County School District Attn: Melinda Adams 300 South Catawba Street Lancaster, SC 29720 <small>See "Submitting Your Offer" provision</small>

CONFERENCE TYPE: <b>N/A</b> DATE & TIME: <small>(As appropriate, see "Conferences - Pre-Bid/Proposal" &amp; "Site Visit" provisions)</small>		PRE-BID LOCATION: <b>N/A</b>	
AWARD & AMENDMENTS	Notice of Intent to Award will be posted on or about 12/16/2022 at the physical address stated above and at the following web address: <a href="https://sites.google.com/lcsd.k12.sc.us/lcsd-procurement/solicitations-awards">https://sites.google.com/lcsd.k12.sc.us/lcsd-procurement/solicitations-awards</a> .		
You must submit a signed copy of this form with your offer. By submitting a bid or proposal, you agree to be bound by the terms of the solicitation. You agree to hold your offer open for a minimum of sixty (60) calendar days after the opening date.			
NAME OF OFFEROR <small>(Full legal name of business submitting the offer)</small>		OFFEROR'S TYPE OF ENTITY: <small>(Check one)</small>	
AUTHORIZED SIGNATURE <small>(Person signing must be authorized to submit binding offer to enter contract on behalf of Offeror named above.)</small>		<input type="checkbox"/> Sole Proprietorship <input type="checkbox"/> Partnership <input type="checkbox"/> Corporate entity (not tax-exempt) <input type="checkbox"/> Tax exempt corporate entity <input type="checkbox"/> Government entity (federal, state, or local) <input type="checkbox"/> Other _____	
TITLE <small>(Business title of person signing above)</small>		<small>(See "Signing your Offer" provision)</small>	
PRINTED NAME <small>(Printed name of person signing above)</small>	DATE SIGNED		
Instructions regarding Offeror's name: Any award issued will be issued to, and the contract will be formed with, the entity identified as the offeror above. An offer may be submitted by only one legal entity. The entity named as the offeror must be a single and distinct legal entity. Do not use the name of a branch office or a division of a larger entity if the branch or division is not a separate legal entity, <i>i.e.</i> , a separate corporation, partnership, sole proprietorship, etc.			
STATE OF INCORPORATION		<small>(If offeror is a corporation, identify the State of Incorporation.)</small>	
TAXPAYER IDENTIFICATION NO.		<small>(See "Taxpayer Identification Number" provision)</small>	

**PAGE TWO**

(Return Page Two with Your Offer)

HOME OFFICE ADDRESS (Address for offeror's home office / principal place of business)	NOTICE ADDRESS (Address to which all procurement and contract related notices should be sent.) (See "Notice" clause)
	Area Code - Number - Extension                      Facsimile
	E-mail Address

PAYMENT ADDRESS (Address to which payments will be sent.) (See "Payment" clause)	ORDER ADDRESS (Address to which purchase orders will be sent) (See "Purchase Orders and "Contract Documents" clauses)
___ Payment Address same as Home Office Address ___ Payment Address same as Notice Address (check only one)	___ Order Address same as Home Office Address ___ Order Address same as Notice Address (check only one)

ACKNOWLEDGMENT OF AMENDMENTS Offeror acknowledges receipt of amendments by indicating amendment number and its date of issue. (See "Amendments to Solicitation" Provision)							
Amendment No.	Amendment Issue Date	Amendment No.	Amendment Issue Date	Amendment No.	Amendment Issue Date	Amendment No.	Amendment Issue Date

DISCOUNT FOR PROMPT PAYMENT (See "Discount for Prompt Payment" clause)	10 Calendar Days (%)	20 Calendar Days (%)	30 Calendar Days (%)	___ Calendar Days (%)
---	----------------------	----------------------	----------------------	-----------------------

Minority Participation: Are you a SC Certified Minority Vendor: Yes  No ; If yes, SC Certification # \_\_\_\_\_  
 Are you a Non SC Certified Minority Vendor - Yes  No

**PREFERENCES - A NOTICE TO VENDORS (SEP. 2009):** On June 16, 2009, the South Carolina General Assembly rewrote the law governing preferences available to in-state vendors, vendors using in-state subcontractors, and vendors selling in-state or US end products. This law appears in Section 11-35-1524 of the South Carolina Code of Laws. A summary of the new preferences is available at [www.procurement.sc.gov/preferences](http://www.procurement.sc.gov/preferences). **ALL THE PREFERENCES MUST BE CLAIMED AND ARE APPLIED BY LINE ITEM, REGARDLESS OF WHETHER AWARD IS MADE BY ITEM OR LOT. VENDORS ARE CAUTIONED TO CAREFULLY REVIEW THE STATUTE BEFORE CLAIMING ANY PREFERENCES. THE REQUIREMENTS TO QUALIFY HAVE CHANGED. IF YOU REQUEST A PREFERENCE, YOU ARE CERTIFYING THAT YOUR OFFER QUALIFIES FOR THE PREFERENCE YOU'VE CLAIMED. IMPROPERLY REQUESTING A PREFERENCE CAN HAVE SERIOUS CONSEQUENCES.**

**PREFERENCES - ADDRESS AND PHONE OF IN-STATE OFFICE:** Please provide the address and phone number for your in-state office in the space provided below. An in-state office is necessary to claim either the Resident Vendor Preference (11-35-1524(C)(1)(i)&(ii)) or the Resident Contractor Preference (11-35-1524(C)(1)(iii)). Accordingly, you must provide this information to qualify for the preference. An in-state office is not required, but can be beneficial, if you are claiming the Resident Subcontractor Preference (11-35-1524(D)).

\_\_\_ In-State Office Address same as Home Office Address  
 \_\_\_ In-State Office Address same as Notice Address

***Effective this date, this amendment forms part of the contract documents and modifies the original IFB.***

**Questions From Offerors - Amendment**

The solicitation is amended as provided herein. Information or changes resulting from questions will be shown in a question-and-answer format. All questions received have been reprinted below. The “state’s response” should be read without reference to the questions. The questions are included solely to provide a cross-reference to the potential offeror that submitted the question. Questions do not form a part of the contract; the “state’s response” does. Any restatement of part or all of an existing provision of the solicitation in an answer does not modify the original provision except as follows: underlined text is added to the original provision. Stricken text is deleted.

**The following questions have been submitted for responses and/or clarification:**

**Question #1:** Clinton elementary- Condenser unit should be 208/1ph not 208v 3ph

**Answer #1:** The solicitation shall now be amended as follows:  
The condenser unit for all coolers and freezers shall be 208/1ph.

**Question #2:** South Middle School-The small box needs the floor removed and the door needs to shrink to a 30” wide door. Shelving may need to be adjusted.

**Answer #2:** The solicitation shall now be amended as follows:

**The specifications of the Single Compartment Indoor Cooler Unit at South Middle School shall now be amended to remove the floor of the unit and change the dimensions of the door to 30” wide. The shelving specifications shall remain the same for this unit.**

**Revision 1:** Attachment E-5 has been amended to reflect the removal of the floor and the change to the door dimensions. Attachment E-5 shall be replaced with “Attachment E-5, Amended.” Attachment E-5, Amended is attached to this Amendment document for reference.

**Revision 2:** (pages 25 -26), **Section VIII., Bid Schedule, pages 1 & 2:** the line items for each unit have now been amended to include an alternate line for demolition and removal of the cooler and freezer units which are being replaced as a result of this solicitation. Bidders who wish to bid on the demolition and removal of old units should use this alternate line item to include their pricing for that alternate project.

**The revised bid schedule is incorporated as pages 4 - 6 of this amendment document. Bidders must submit the Revised Bid Schedule when submitting their bid.**

***All other requirements of the solicitation remain unchanged.***

<b>Lot 1: Buford Middle School</b> 1890 N. Rocky River Road, Lancaster, SC 29720					
Item #	Description	Preferences	Lead Time	Quantity	Unit Price
1	<i>Bally Outdoor 2 Compartment Walk-In Cooler/Freezer Unit with Metro Shelving Units, including delivery.</i>			1	\$
2	<i>Installation</i>			1	\$
<b>Subtotal: Lot 1 - Buford Middle School (2 Compartment Unit with Delivery &amp; Installation)</b> 1					\$
<b>Alternate for Lot 1: Demolition and Removal of old unit(s)</b>					\$
<b>Lot 2: Clinton Elementary School</b> 110 Clinton School Road, Lancaster, SC 29720					
Item #	Description	Preferences	Lead Time	Quantity	Unit Price
3	<i>Bally Indoor Single Compartment Walk-In Freezer Unit with Metro Shelving Units, including delivery.</i>			1	\$
4	<i>Installation</i>			1	\$
<b>Subtotal: Lot 2 - Clinton Elementary School (Single Unit with Delivery &amp; Installation)</b>					\$
<b>Alternate for Lot 2: Demolition and Removal of old unit(s)</b>					\$
<b>Lot 3: Erwin Elementary School</b> 1477 Locustwood Ave, Lancaster, SC 29720					
Item #	Description	Preferences	Lead Time	Quantity	Unit Price
5	<i>Bally Outdoor 2 Compartment Walk-In Cooler/Freezer Unit with Metro Shelving Units, including delivery.</i>			1	\$
6	<i>Installation</i>			1	\$
<b>Subtotal: Lot 3 - Erwin Elementary School (2 Compartment Unit with Delivery &amp; Installation)</b>					\$
<b>Alternate for Lot 3: Demolition and Removal of old unit(s)</b>					\$

<b>Lot 4: McDonald Green Elementary School</b> <i>2763 Lynwood Drive, Lancaster, SC 29720</i>					
Item #	Description	Preferences	Lead Time	Quantity	Unit Price
7	<i>Bally Indoor 2 Compartment Walk-In Cooler/Freezer Unit with Metro Shelving Units, including delivery.</i>			1	\$
8	<i>Installation</i>			1	\$
<b>Subtotal: Lot 4 - McDonald Green Elementary School (2 Compartment Unit with Delivery &amp; Installation)</b>					\$
<i>Alternate for Lot 4: Demolition and Removal of old unit(s)</i>					\$
<b>Lot 5: South Middle School</b> <i>1551 Billings Drive, Lancaster, SC 29720</i>					
Item #	Description	Preferences	Lead Time	Quantity	Unit Price
9	<i>Bally Indoor 2 Compartment Walk-In Cooler/Freezer Unit with Metro Shelving Units, including delivery.</i>			1	\$
10	<i>Installation</i>			1	\$
11	<i>Bally Indoor Single Compartment Walk-In Cooler Unit with Metro Shelving Units, including delivery.</i>			1	\$
12	<i>Installation</i>			1	\$
<b>Subtotal: Lot 5 - South Middle School (2 Compartment Unit &amp; Single Unit with Delivery &amp; Installation)</b>					\$
<i>Alternate for Lot 5: Demolition and Removal of old unit(s)</i>					\$
<b>Total Base Bid</b>				<b>\$</b>	

Vendor Name: \_\_\_\_\_

**List of all Subcontractors by specialty who are expected to perform work to the Prime Contractor:**

(1) All subcontractors' bids shall be included in the base bid amount. (2) A prime contractor whose bid is accepted may not substitute a person as subcontractor in place of a subcontractor listed in the original bid, except for showing a satisfactory reason to the District. Request for substitution must be made to the District in writing. (3) If the bidder determines to use his own employees to perform a portion of the work for which he would otherwise be required to list a subcontractor and if the bidder is qualified to perform that work under the terms of the invitation for bids, the bidder shall list himself in the appropriate place in the bid and not subcontract that work except with the approval of the District for good cause shown.

**Sub-Contractors:**

**If you use more than one subcontractor for any trade, please list each individually.**

\_\_\_\_\_ : \_\_\_\_\_ Bid Amount: \$ \_\_\_\_\_  
Trade Subcontractor's Name – SC License #

\_\_\_\_\_ : \_\_\_\_\_ Bid Amount: \$ \_\_\_\_\_  
Trade Subcontractor's Name – SC License #

\_\_\_\_\_ : \_\_\_\_\_ Bid Amount: \$ \_\_\_\_\_  
Trade Subcontractor's Name – SC License #

Company Name \_\_\_\_\_ Date \_\_\_\_\_



**Bally Refrigerated Boxes, Inc.**  
**Morehead City, NC 28557 (800) 242-2559**

**Last Update:** 12/5/2022  
**Revisor:** Laura Craig  
**To:** All Bidders

**Quote No:** 2751-002-R05-LC  
**Item No:**  
**Job Name:** South Middle School  
**Date:** 12/5/2022 **PVD:** 10/31/2022  
**From:** Laura Craig  
 Swanson-Girard & Associates  
 10420 Southern Loop Blvd  
 Pineville, NC 28134

**Attn:**

**Phone:** **Fax:** (704)521-8801

**Box Shape**

**Indoor Structure**

**NSF APPROVED**

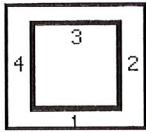

**Bally Prefabricated Exterior Dimensions:**

9'-8"(l) x 6'-9½"(w) x 7'-2"(h)

1 Compartments 1 Tiers Less Floor w/ Anchor Clips 4" Floor

Ceiling: Single Span

**Panel Thickness:**

4 in. Exterior Vertical Used (6'-10") with 4 in. Ceiling

**Details on Following Page(s)**

**NOTE:** Freight shown is an estimate based on current published rates. A fuel surcharge will be added and changes continuously.

**Walk-in Price:**

**Refrigeration Price:**

**Total Price (FOB Plant)** (Less Refrig. Warranties):

**Estimated Freight:**

**Optional Warranties:** (not included in Total Price)

(1) 00 1/2 HP System (5 yr. Parts , 1 yr. Labor)

**Payment terms and conditions are available upon request.**

*This quotation was based on information supplied to us which may or may not have been complete. Customer is responsible for reviewing this quotation for exclusions, deviations, and any improper information supplied to us.*

**Signature:** \_\_\_\_\_

Laura Craig

**Date:** \_\_\_\_\_

*We are not responsible for the selection or recommendation of the panel finish for any building or walk-in application.*

**NOTE: Quoting Bally standard specifications, sizes, and finishes.**

***This quotation is good through 1/19/2023***

Act of 2007 (Public Law 110-140) Title III; Section 312, regarding Walk-In Coolers and Walk-In Freezers.



**Bally Refrigerated Boxes, Inc.**  
**Morehead City, NC 28557 (800) 242-2559**

*Last Update:* 12/5/2022  
*Revisor:* Laura Craig  
*To:* All Bidders

*Quote No:* 2751-002-R05-LC  
*Item No:*  
*Job Name:* South Middle School  
*Date:* 12/5/2022 *PVD:* 10/31/2022  
*From:* Laura Craig  
 Swanson-Girard & Associates  
 10420 Southern Loop Blvd  
 Pineville, NC 28134  
*Phone:* *Fax:* (704)521-8801

*Attn:*

**Indoor Structure**

**NSF APPROVED**

***Bally Prefabricated Exterior Dimensions:***

9'-8"(l) x 6'-9½"(w) x 7'-2"(h)  
 1 Compartments 1 Tiers Less Floor w/ Anchor Clips 4" Floor  
 Ceiling: Single Span

***Panel Thickness:***

4 in. Exterior Vertical Used (6'-10") with 4 in. Ceiling

***Details and specifications for Quote No:*** 2751-002-R05-LC

***Comments:***

***Base Finish***

Vertical and Ceiling Panels: Embossed Galvalume (26 GA)

***Doors/Opening:***

Wall 2 Door 1 (1) 30" x 78" Hinged Door In a 46"  
 Wall 2 Door 1 (1) Door(s) Cut For Quarry Tile (Each)  
 Wall 2 Door 1 (1) Super Door 36" Wide and Under, 30" High

***Accessories and Extras:***

(1) 48" LED KEIL 48x754-CL-N Light  
 - 40° F to 100° F(Range)

***Floor Options:***

(70) S/F 1/2" Plywood Foamed in Panel

***Refrigeration:***

(1) An insulated Concrete Slab to be provided by others.  
 (1) BEHA-006-M8-HS2D 208-230/1/60  
 R448A & R404A - 6200 BTU/h  
 (1) BLP107-MA-S1D 115/1/60  
 1 Fan 7000 BTU/h  
 (1) Refrigeration is calculated for standard use at a box temperature of  
 35° F. with a condensing unit ambient of 105° F.  
 (1) The refrigeration is calculated for a line run of less than 50'  
 (1) Time Clock 8145 (shipped loose) 115/1/60

***Estimated Shipping:***

Weight: 1,797.71  
 Destination: Lancaster, SC, 29720





**Bally Refrigerated Boxes, Inc.**  
**Morehead City, NC 28557 (800) 242-2559**

**Last Update:** 12/5/2022  
**Revisor:** Laura Craig  
**To:** All Bidders

**Quote No:** 2751-002-R05-LC  
**Item No:**  
**Job Name:** South Middle School  
**Date:** 12/5/2022 **PVD:** 10/31/2022  
**From:** Laura Craig  
 Swanson-Girard & Associates  
 10420 Southern Loop Blvd  
 Pineville, NC 28134

**Attn:**

**Phone:** **Fax:** (704)521-8801

**Deviations (Alternates, Remarks, Clarifications, Etc.):**

Quoting Bally Standard Pre-assembled Remote Refrigeration.

Bally Floor Panels are capable of supporting up to 800 lbs. Per Sq/Ft uniformly distributed stationary loading. Bally does not recommend the use rolling loads of heavy carts, pallet jacks or fork lifts on top of the floors. Warranty for floors subjected to this type of use would not be covered by Bally.

**Exclusions (Items Not Supplied by Bally):**

- |   |  |
|---|--|
| <input checked="" type="checkbox"/> Shelving, Racks, Interior Accessories | <input checked="" type="checkbox"/> Caulking and Sealants                    |
| <input type="checkbox"/> Labor on Warranties                              | <input type="checkbox"/> Refrigeration Systems                               |
| <input checked="" type="checkbox"/> Alarm Systems                         | <input checked="" type="checkbox"/> Refrigeration Accessories                |
| <input checked="" type="checkbox"/> Supervision                           | <input checked="" type="checkbox"/> Closure Panel and Trim                   |
| <input checked="" type="checkbox"/> Tubing, Wiring for Rfg. Equipment     | <input checked="" type="checkbox"/> Sleeves, Penetrations, Escutcheon Plates |
| <input checked="" type="checkbox"/> Compressor Rack                       | <input checked="" type="checkbox"/> Floor Insulation and Vapor Barrier       |

**Cancelled Orders:** Cancelled unshipped standard walk-ins will be charged a 30% restocking fee plus the cost of special panels. Cancelled refrigeration systems will be charged a 30% restocking fee and the cost of any freight accrued. Buy-out items will be charged a 25% restocking fee plus any freight accrued.

**Agency Ratings:** Bally units comply or surpass applicable Flame Spread-25, UL, UL 723, & NSF standards in a manner conforming to ASTM E-84, and Factory Mutual standards.

**Quotation Limitations:** This quotation was based upon the specifications given to Bally which may possibly be incomplete. Bally is not responsible for items missing from the quotation due to incomplete or excluded items in the specifications received from the customer. The customer is responsible for reviewing the quotation for omissions or deviations from the specifications given to Bally. All portions of the quotation are subject to revision upon receipt of detailed specifications or if changes are made following the delivery of the original quotation. Quotations expire on the date indicated on Page 1 of the Quote. Approval drawings must be returned within 60 days of receipt of the purchase order. The order must ship within the agreed upon time frames or current lead times, but no later than 7 months. Any deviations to this quotation (dimensions or specification changes) will require updated pricing.

**Panel Construction:** Bally Panels are manufactured with environmentally friendly HFC 245-FA polyurethane foam. This polyurethane foam offers the highest thermal insulation value and the most energy efficiency per cubic inch in comparison to similar foams. It has a zero Ozone Depletion Potential (ODP) and a low Global Warming Potential (GWP). It is not considered a Volatile Organic Compound (VOC) in the US. Standard 4" Bally panels meet the 2009 Federal Energy Standards.

**Refrigerants:** Unless otherwise specified, refrigeration systems are quoted with environmentally friendly HFO R448A refrigerant. It has a Low Global Warming Potential (GWP) and the EPA lists it as an acceptable substitute for R404A and other high GWP refrigerants.

**Automatic Door Closers:** Bally includes automatic door closers and spring loaded hinges on all doors 42" wide and smaller as a standard feature with no additional charge that meet the 2009 Federal Energy Standards.

**Motors:** Bally units are quoted with EC and PSC motors in compliance with federal energy standards, for increased energy savings.

**Lighting:** Bally units are quoted with lighting in compliance with federal Energy Standards for increased energy savings.

**Optional Features:** Bally offers additional optional energy-saving features such as Walk-In Alarm & Light Management systems that comply or surpass the 2009 Federal energy regulations.



**Bally Refrigerated Boxes, Inc.**  
**Morehead City, NC 28557 (800) 242-2559**

*Last Update:* 12/5/2022  
*Revisor:* Laura Craig  
*To:* All Bidders

*Quote No:* 2751-002-R05-LC  
*Item No:*  
*Job Name:* South Middle School  
*Date:* 12/5/2022 *PVD:* 10/31/2022  
*From:* Laura Craig  
 Swanson-Girard & Associates  
 10420 Southern Loop Blvd  
 Pineville, NC 28134

*Attn:*

*Phone:* *Fax:* (704)521-8801

This drawing is for reference purposes only and it not intended to be a formal scale model.

w3: 9'-8"

w4: 6'-9½"

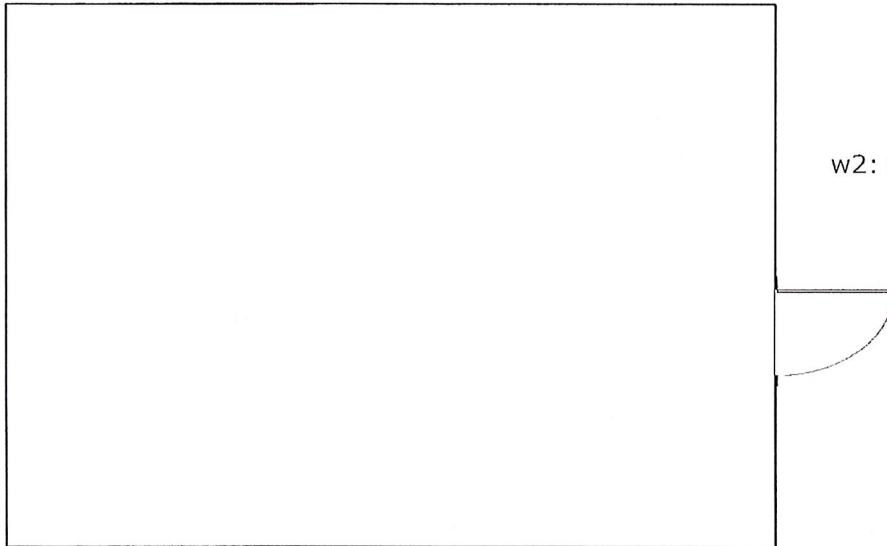

w2: 6'-9½"

w1: 9'-8"

DOOR 1: Wall2 30" x 78" Hinged Door In a 46" Centered Hinge:Right Orientaion:Regular

## Single Cooler LOAD CALCULATION

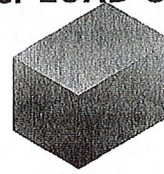

COOLING REQUIREMENTS									
Application	General Walk-in Cooler			Location		Indoor			
Internal Temp	35 °F	Internal RH	84%	External Temp	85 °F	External RH	55%		
Wall Load	801 BTUH	Infiltration	1,491 BTUH	Products	322 BTUH	Miscellaneous	433 BTUH		
	26%		49%		11%		14%		
WALL, FLOOR AND CEILING LOADS									
Section	Construction	Thickness (in)	K Factor	R Value	Ext Temp (°F)	Dim 1 (ft)	Dim 2 (ft)	Area (ft²)	Load (BTUH)
Rear	Urethane, Standard panels	4.000	0.14	28.57	85.0	9.70	7.50	73	127
Right End	Urethane, Standard panels	4.000	0.14	28.57	85.0	6.90	7.50	32	56
	Door			15.00	85.0	3.00	6.50	20	65
Front	Urethane, Standard panels	4.000	0.14	28.57	85.0	9.70	7.50	73	127
Left End	Urethane, Standard panels	4.000	0.14	28.57	85.0	6.90	7.50	52	91
Floor	Insulated Floor - Concrete On Foam On Grade	12.000	0.54	22.31		9.70	6.90	67	218
Ceiling	Urethane, Standard panels	4.000	0.14	28.57	85.0	9.70	6.90	67	117
<b>VOLUME (ft³)</b>		<b>502</b>	<b>TOTAL WALL, FLOOR AND CEILING LOAD</b>						<b>801</b>
INFILTRATION LOAD : ESTIMATED BY VOLUME AND USAGE									
Box Usage	Internal Temp (°F)	Internal Rh (%)	External Temp (°F)	External Rh (%)	Ventilation (CFM)	Load (BTUH)			
Heavy	35	84	85	55		1,491			
PRODUCT LOADS									
Type			Weight (lb)	Enter Temp (°F)	Final Temp (°F)	Pull Down (hrs)	Load (BTUH)		
General, Mixed Products, Approximation			1,004	45.0	35.0	24	322		
<b>TOTAL PRODUCT WEIGHT (lbs)</b>			<b>1,004</b>	<b>TOTAL PRODUCT LOAD</b>			<b>322</b>		
MISCELLANEOUS LOADS									
Quantity	Description			Power	Units	Run Time (hrs)	Load (BTUH)		
	LIGHTING			1	W/ft²	24	228		
1	EVAPORATOR MOTORS			60	W	24	205		
<b>TOTAL MISCELLANEOUS LOAD</b>							<b>433</b>		
SYSTEM DESIGN SUMMARY									
Design Load (BTUH)	Safety Factor	Safety Load (BTUH)	Run Time (Hours)	Capacity Required (BTUH)	Refrigerant	Line Frequency (Hz)	Design TD (°F)	Line Loss (°F)	Condenser Ambient (°F)
3,048	10%	3,353	16	5,029	R448A	60	10.1	0.5	105
SYSTEM EQUIPMENT SELECTION									
Equipment Type	Quantity	Model Number	Description			Voltage	Rating (BTUH)		
Condensing Unit	1	BEHA006M8-HS2D	EH-Line Hermetic Condensing Units-Air			208-230/1/60	5,363		
Evaporator	1	BLP107MA-S1D	Low Profile Evaporator			115/1/60	7,106		
SYSTEM BALANCE									
Fan Load (BTUH)		Suction Temp (°F)		Evaporator TD (°F)		System Capacity (BTUH)			
		26.5		8		5,610			



**NATIONAL REFRIGERATION AND  
AIR CONDITIONING CANADA CORP.**  
159 ROY BLVD, PO BOX 2020  
BRANTFORD, ON  
CANADA N3T 5Y6

**BEHA006M8-HS2D**

**EH-LINE HERMETIC  
CONDENSING UNITS-AIR**

PURCHASER :

SUBMITTED BY : **Laura Craig**

PROJECT : **South Middle School Lancaster SC**

DATE : **05 Dec 2022**

ORDER # : **06338.58290.00469-A00**

ITEM # : **6**

QUOTE # : **Q10EULCB-A**

ID # :

PURCHASER'S PO # :

TAGGING :

**MODEL FEATURES**

- Copper tubing secured with cushion clamps
- Crankcase heater
- High efficiency PSC fan motor with internal overload protection
- Outdoor weather-resistant housing made from G90 galvanized steel
- Pre-formed piping
- Receiver with fusible plug and liquid shut off valve
- Suction Service valve
- Adjustable flooded head pressure control (unless otherwise indicated)
- Units are shipped with Helium holding charge
- Weatherproof electrical control box with compressor contactor and fused control circuit
- Adjustable low pressure control with flex hose / fixed high pressure control
- ECM with SmartSpeed Technology
- High efficiency enhanced copper tube and aluminium fin coil design
- Outdoor weatherproof pre-painted steel cabinet
- AWEF = 7.6 FOR  
R404A/R507/R448A/R449A ONLY

**MODEL OPTIONS ( \* = Shipped Loose )**

- OPTION PACKAGES**
- 1** Small B (Good@Warm/Moderate)  
 Small N (Better@Warm/Moderate)  
 Small P (Best@Warm/Moderate)  
 Small D (Good@Moderate/Cold)  
 Small J (Better@Moderate/Cold)  
 Small Q (Best@Moderate/Cold)  
 Small K  
 Small H
- 115V Control Circuit**
- ADJUSTABLE PRESSURE CONTROLS**
- Johnson Dual with flex hose  
 Separate High/Low
- BALL VALVE**
- \*Liquid Line  
 \*Suction Line
- CAPACITY CONTROL - HOT GAS BYPASS**
- To Inlet of Evaporator  
 To Suction Line
- Compressor Circuit Breaker**  
 **Compressor Time Delay Relay**
- CONDENSING UNIT PRISON PACKAGE**
- Tamper Proof Screws  
 **Crankcase Pressure Regulator**  
 **Discharge Air Hood**
- DISCONNECT SWITCH**
- Fused
- DISCONNECT SWITCH Continued**
- Non-Fused
- EC FAN MOTORS + SPEED CONTROLLER**
- All Motors Variable Speed - 230V Units
- Export Crating**
- EXTENDED 4-YEAR COMPRESSOR WARRANTY**
- Copeland  
 **Extended Leg Kit**
- COIL COATING**
- E-Coat
- FIN MATERIAL**
- Gold Coat Fins  
 Copper Fins
- Hail Guard for Condenser**  
 **Heated and Insulated Receiver**
- HOUSING MATERIAL**
- Stainless Steel  
 **Insulated Suction Line**
- LIQUID LINE FILTER + SIGHT GLASS**
- 1** Sealed
- Liquid Line Lock-Out Relay**  
**LIQUID LINE SOLENOID VALVE**
- \*Standard 230V Coil  
 \*Standard 115V Coil
- Oversized Receiver**
- Pump Down Toggle Switch**  
 **QuickVac Valves**  
 **Receiver Inlet Ball Valve**  
 **Single Point Electrical SUCTION ACCUMULATOR**
- With Heat Exchanger  
 Without Heat Exchanger
- SUCTION FILTER**
- Sealed Type
- TIME CLOCK**
- Paragon 8145 Style  
 \*230V Paragon 8145 Style  
 **1** \*115V Paragon 8145 Style
- Wind Guard**  
 **Less Flooding Valve(s)**

VOLTAGE		SYSTEM REFRIGERANT			RATING	SUCTION TEMP	AMBIENT TEMP	CAPACITY		
208-230/1/60		R448A			0.6Hp	26.5 °F	105 °F	5610 BTUH		
FANS			COMPRESSOR			CIRCUIT TOTAL				
QTY	POWER	FLA/FAN	TYPE	QTY	RLA	LRA	AMPS	WATTS	MCA†	MOP‡
1	100W	1	RST45C2E-CFV	1	4.4	30	5.4		6.5	15
LIQUID	3/8 in	SOUND	-	REC CAPACITY	5 lb		APPROVALS			
SUCTION	5/8 in	WEIGHT	149 lb	REF CHARGE	3 lb					

**NOTES:**

† MCA.. Minimum Circuit Ampacity, ‡ MOP.. Maximum Overcurrent Protection  
MCA & MOP are for the condensing unit ONLY. Single point connections WILL show different on dataplate.



**APPROVED BY :**

**DATE :**

Approval of this drawing signifies that the equipment is acceptable under the provision of the job specifications. Any change made hereon by any person whomsoever subject to acceptance by NATIONAL REFRIGERATION at its home office.



**NATIONAL REFRIGERATION AND  
AIR CONDITIONING CANADA CORP.**

159 ROY BLVD, PO BOX 2020  
BRANTFORD, ON  
CANADA N3T 5Y6

**BEHA006M8-HS2D**

**EH-LINE HERMETIC  
CONDENSING UNITS-AIR**

PURCHASER :

SUBMITTED BY : **Laura Craig**

PROJECT : **South Middle School Lancaster SC**

DATE : **05 Dec 2022**

ORDER # : **06338.58290.00469-A00**

ITEM # : **6**

QUOTE # : **Q10EULCB-A**

ID # :

PURCHASER'S PO # :

TAGGING :

**SELECTED OPTION DESCRIPTIONS**

**Liquid Line Filter + Sight Glass - Sealed**

Sporlan C Series with ODF solder connections and Sporlan SA moisture indicator factory installed in liquid line.

**Option Packages - Small B (Good@Warm/Moderate)**

LLFD+SG

**Time Clock - 115V Paragon 8145 Style**

115V Defrost timer is time initiated, temperature or pressure terminated with a timed failsafe. Timer is shipped loose in a box for field installation.

Approval of this drawing signifies that the equipment is acceptable under the provision of the job specifications. Any change made hereon by any person whomsoever subject to acceptance by NATIONAL REFRIGERATION at its home office.



**NATIONAL REFRIGERATION AND  
AIR CONDITIONING CANADA CORP.**  
159 ROY BLVD, PO BOX 2020  
BRANTFORD, ON  
CANADA N3T 5Y6

**Order Item No: 6  
BEHA006M8-HS2D  
EH-LINE HERMETIC  
CONDENSING UNITS-AIR**

NATIONAL REFRIGERATION will furnish equipment in accordance with this drawing and specifications, and subject to its published warranty. Approval of this drawing signifies that the equipment is acceptable under the provision of the job specifications. Any change made hereon by any person whomsoever subject to acceptance by NATIONAL REFRIGERATION at its home office.

DATE : 05 Dec 2022

PURCHASER :

PROJECT : South Middle School Lancaster SC

SUBMITTED BY : Laura Craig

Dimensions shown are for standard unit less options.

DIMENSIONS	
DIMENSION A	19 3/8 in
DIMENSION B	24 7/8 in
DIMENSION C	30 3/8 in
DIMENSION D	4 in
DIMENSION E	
DIMENSION F	
DIMENSION G	0 in
DIMENSION H	

CONNECTIONS	
LIQUID	3/8 in
SUCTION	5/8 in
DRAIN	
WATER	
DISCHARGE	
PAN LOOP	
HOT GAS SIDE PORT	
HOT GAS INLET	
HOT GAS OUTLET	
OTHER	
SHIPPING WEIGHT	149 lb
REFRIGERANT CHARGE	3 lb
RECEIVER CAPACITY	5 lb

APPROVALS	

NOTES:

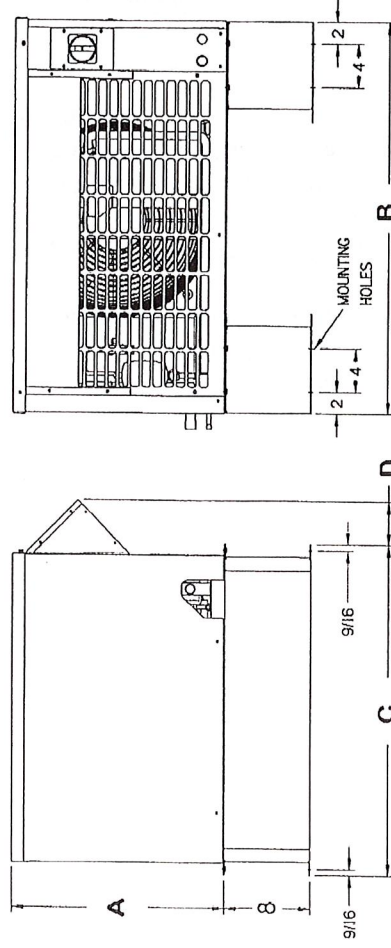
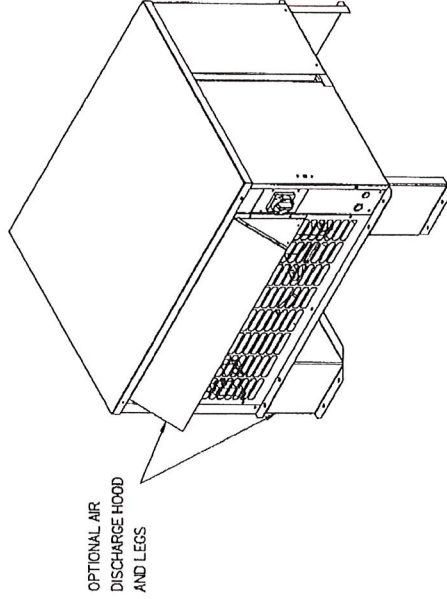



**NATIONAL REFRIGERATION AND  
AIR CONDITIONING CANADA CORP.**

159 ROY BLVD, PO BOX 2020  
BRANTFORD, ON  
CANADA N3T 5Y6

**BLP107MA-S1D**

**LOW PROFILE  
EVAPORATOR**

PURCHASER :

SUBMITTED BY : **Laura Craig**

PROJECT : **South Middle School Lancaster SC**

DATE : **05 Dec 2022**

ORDER # : **06338.58290.00469-A00**

ITEM # : **8**

QUOTE # : **Q10EULCB-A**

ID # :

PURCHASER'S PO # :

TAGGING :

**MODEL FEATURES**

- 3/8" Tubing coil construction (reduces refrigerant operating charge)
- Factory installed solenoid valve wire harness
- Heavy gauge textured aluminum cabinet construction resists scratches/corrosion
- Spacious piping end compartment allows for easy assembly

- Hinged drain pan with central universal drain connection (3/4" drain)
- Front access to spacious electrical and header compartments
- Schrader connection on suction header
- Attractive and durable high density polyethylene fan guards
- Ultra efficient Electronically Commutated Motor (ECM)

- ECM with SmartSpeed Technology
- High efficiency enhanced copper tube and aluminium fin coil design
- 6 FPI
- AWEF = 9.0
- Unit Cooler is AWEF/NRCAN compliant with R404A/R507/R448A/R449A/R407A/R407C

**MODEL OPTIONS ( \* = Shipped Loose )**

**PRE-ASSEMBLED EVAP**

- SmartVap+ with EEV + Solvlv
- Sporlan TXV, LLSV, T-stat
- KE2 Evap Efficiency w/Sporlan EEV
- \*KE2 Evap Efficiency w/Sporlan EEV

**Aux Sideport Connector**

**CABINET FINISH**

- Painted White
- Stainless Steel

**SENSORS FOR CPC BOARDS**

- Coil Temp Sensor
- Return Air Temp Sensor

**DEMAND DEFROST ELECTRONIC CONTROLLER**

- KE2 Therm Evaporator Efficiency
- \*KE2 Therm Evaporator Efficiency

**Dual Circuit**

- ELECTRONIC CONTROLLER**
- KE2 Temp+Defrost
- SmartVap+ Control Board and Display

**EXPANSION VALVE**

- Sporlan TXV
- Sporlan EEV
- EEV for SmartVap+

**Evaporator Disconnect Switch**

- Tamper Proof Screws

**EVAPORATOR PRISON PACKAGE**

**Export Crating**

**COIL COATING**

- E-Coat

**FIN MATERIAL**

- Gold Coat Fins
- Copper Fins

**Insulated Drain Pan**

**KE2 THERM**

- \*CAT5e Shielded Cable - 50ft w/connectors
- 40' Leads on Sensors + Transducers
- Ethernet Adapter Kit
- \*Remote Combo Display
- \*Liquid / Suction Heat Exchanger

**LIQUID LINE SOLENOID VALVE**

- Sporlan
- Dual Voltage Coil 120-230V Field Wired**

**Nitrogen Charged and Sealed ROOM THERMOSTATS**

- Mechanical
- \*Mechanical
- \*Johnson A19ABC
- \*Johnson A421ABC-02C
- Johnson A421ABC-02



**Wire Fan Guards**

**REMOTE DEFROST PANEL**

- \*230V Control
- \*115V Control

**INSTALLATION REQUIREMENTS**

- Minimum slope of 1" per foot on all drain lines
- P-trap per evap required outside of box

VOLTAGE		SYSTEM REFRIGERANT		AIR FLOW		EVAP. TEMP		BOX TEMP		CAPACITY	
115/1/60		R448A		680 CFM		27 °F		35 °F		5610 BTUH	
FANS			HEATERS			CIRCUIT TOTAL					
QTY	POWER	FLA/FAN	TYPE	QTY	AMPS	AMPS	WATTS	MCA†	MOP‡		
1	0.07HP	1				1	60	1.3	15		
DISTRIBUTOR		3/8 in	SOUND	-	REC CAPACITY						APPROVALS
SUCTION		5/8 in	WEIGHT	48 lb	REF CHARGE	1 lb					 
NOTES:											
† MCA.. Minimum Circuit Ampacity, ‡ MOP.. Maximum Overcurrent Protection											

APPROVED BY :

DATE :

Approval of this drawing signifies that the equipment is acceptable under the provision of the job specifications. Any change made hereon by any person whomsoever subject to acceptance by NATIONAL REFRIGERATION at its home office.



**NATIONAL REFRIGERATION AND  
AIR CONDITIONING CANADA CORP.**  
159 ROY BLVD, PO BOX 2020  
BRANTFORD, ON  
CANADA N3T 5Y6

**BLP107MA-S1D**

**LOW PROFILE  
EVAPORATOR**

PURCHASER :

SUBMITTED BY : **Laura Craig**

PROJECT : **South Middle School Lancaster SC**

DATE : **05 Dec 2022**

ORDER # : **06338.58290.00469-A00**

ITEM # : **8**

QUOTE # : **Q10EULCB-A**

ID # :

PURCHASER'S PO # :

TAGGING :

**SELECTED OPTION DESCRIPTIONS**

**Expansion Valve - Sporlan TXV**

May be Type EBQ, S, SBF, O externally equalized thermostatic expansion valve. Valves are selected using the specified capacity and operating conditions of the refrigeration system as specified on the accompanying Certified Prints.

**Installation Requirements - Minimum slope of 1" per foot on all drain lines**

Bally recommends a minimum slope of 1" per foot on all drain lines.

**Installation Requirements - P-trap per evap required outside of box**

All evaporators must be trapped individually outside of the box to prevent vapor migration back to coil surface.

**Liquid Line Solenoid Valve - Sporlan**

Sporlan solenoid coil voltage matches evaporator voltage except when evaporator is 460V, then 230V solenoid coil is used. Exceptions must be clearly explained in the Notes of the option.

**Pre-assembled Evap - Sporlan TXV, LLSV, T-stat**

Option Package consists of factory installed Sporlan balance port TXV, Sporlan liquid line solenoid valve and Johnson Controls A19 Room thermostat.

**Room Thermostats - Mechanical**

Single stage temperature control with Single-Pole, Double-Throw (SPDT) mechanical switch. May be Johnson A19 or equal, Operating range of -30°F to +100°F. Adjustable differential of 3°F to 12°F. Factory installed and wired.

Approval of this drawing signifies that the equipment is acceptable under the provision of the job specifications. Any change made hereon by any person whomsoever subject to acceptance by NATIONAL REFRIGERATION at its home office.





**NATIONAL REFRIGERATION AND  
AIR CONDITIONING CANADA CORP.**  
159 ROY BLVD, PO BOX 2020  
BRANTFORD, ON  
CANADA N3T 5Y6

**Order Item No: 8  
BLP107MA-S1D  
LOW PROFILE  
EVAPORATOR**

NATIONAL REFRIGERATION will furnish equipment in accordance with this drawing and specifications, and subject to its published warranty. Approval of this drawing signifies that the equipment is acceptable under the provision of the job specifications. Any change made hereon by any person whomsoever subject to acceptance by NATIONAL REFRIGERATION at its home office.

DATE : 05 Dec 2022

PURCHASER :

PROJECT : South Middle School Lancaster SC

SUBMITTED BY : Laura Craig

Dimensions shown are for standard unit less options.

DIMENSIONS	
DIMENSION A	30 1/4 in
DIMENSION B	17 1/4 in
DIMENSION C	
DIMENSION D	
DIMENSION E	
DIMENSION F	
DIMENSION G	0 in
DIMENSION H	

CONNECTIONS	
DISTRIBUTOR	3/8 in
SUCTION	5/8 in
DRAIN	3/4 in
WATER	
DISCHARGE	
PAN LOOP	
HOT GAS SIDE PORT	
HOT GAS INLET	
HOT GAS OUTLET	
OTHER	
SHIPPING WEIGHT	48 lb
REFRIGERANT CHARGE	1 lb
RECEIVER CAPACITY	

APPROVALS	

NOTES:

