

ADDENDUM No. 3

**MBWWTP SOLIDS PROCESS OPTIMIZATION IMPLEMENTATION
PHASE 2 THICKENER UPGRADES
CONTRACT NUMBER W-16-017-201**

CITY OF CHATTANOOGA, TENNESSEE

The following changes shall be made to the Contract Documents, Specifications, and Drawings:

1. A secondary Pre-Bid Site Meeting will occur on Wednesday, February 21, 2018 at 2:00 PM. Attendees will enter MBWWTP site through the contractor entrance and go straight back to the Training Center where the group will meet in the parking lot. From there, the group will be escorted to the Thickener site area.
2. Deadline for bidder questions is 4:00 PM, Friday, February 23, 2018.
3. Contract Drawing 01C-02

Replace drawing 01C-02 with the attached revised drawing. The scale of this drawing is now set to 1" = 5'. No other changes were made.

February 16, 2018

/s/ Justin C. Holland, Administrator
City of Chattanooga
Department of Public Works

CREATED: 2/12/2018 LAST SAVED: 2/12/2018 BY: CLUTTREL PLOT DATE: 2/16/2018

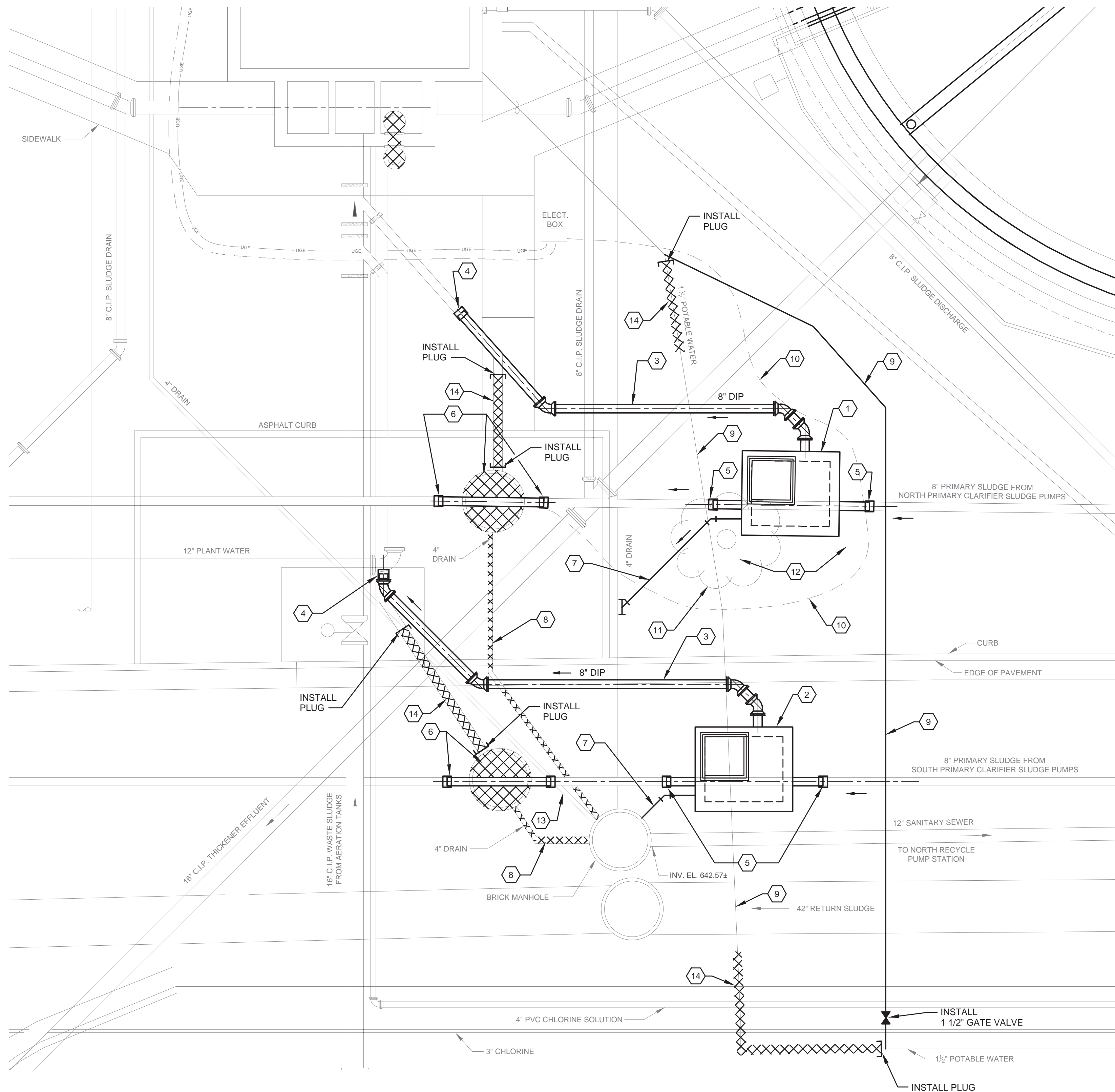
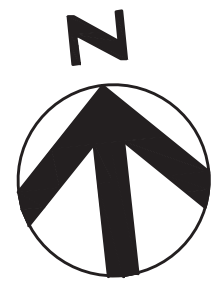

ENLARGED SITE PLAN
1" = 5'

KEY NOTES:

- 1 NORTH PRIMARY SLUDGE DIVERSION VALVE VAULT (SEE DETAIL SHEET 01C-03)
- 2 SOUTH PRIMARY SLUDGE DIVERSION VALVE VAULT (SEE DETAIL SHEET 01C-03) CONTRACTOR SHALL PROVIDE TRAFFIC CONTROL AS NECESSARY DURING THIS CONSTRUCTION. SUBMIT TRAFFIC CONTROL PLAN FOR APPROVAL.
- 3 8" DI PRIMARY SLUDGE LINE TO THICKENED SLUDGE PUMP STATION NO. 1
- 4 TIE TO EXISTING 8" DI SLUDGE LINE W/COUPLING ADAPTER
- 5 8" DI SLUDGE LINE THROUGH NEW VALVE VAULT TIE TO EXISTING 8" DI SLUDGE LINE W/COUPLING ADAPTER
- 6 REMOVE EXISTING 3-WAY VALVE VAULT AND REPLACE WITH 8" DI SLUDGE LINE W/COUPLING ADAPTER
- 7 4" DI DRAIN LINE FROM SUMP PUMP, CONNECT TO EXISTING MANHOLE AND/OR EXISTING DRAIN LINE
- 8 CUT AND CAP EXISTING 4" DI DRAIN LINES, PLUG EXISTING OPENINGS IN EXISTING BRICK MANHOLE
- 9 EXIST. 1 1/2" POTABLE WATER LINE TO BE RELOCATED PRIOR TO START OF VALVE VAULT CONSTRUCTION. COORDINATE WITH OWNER TO DETERMINE MAXIMUM SHUTDOWN PERIOD AND SUBMIT WORK PLAN, WITH DIMENSIONED DRAWING OF NEW WATER LINE TO ENGINEER FOR APPROVAL.
- 10 EXIST. SIGNAL WIRING TO BE REROUTED TO NEW NORTH AND SOUTH PRIMARY SLUDGE DIVERSION VALVE VAULTS
- 11 REMOVE SHRUB
- 12 SMOOTHLY GRADE SLOPE AROUND NEW VALVE VAULT TO MAINTAIN ABILITY FOR MOWING
- 13 DO NOT DISTURB 4" DRAIN FROM 8" SLUDGE VALVE VAULT
- 14 ABANDON PIPE IN PLACE. TWO 6" AND 1/2" WATER.



1201 Market St., Suite C
Chattanooga, TN 37402 (423) 414-3351

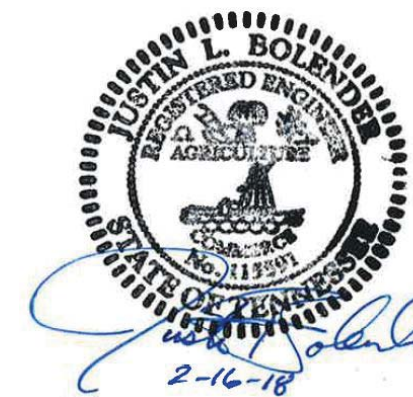

MBWWTP SOLIDS PROCESS OPTIMIZATION
IMPLEMENTATION - PHASE 2 THICKENER UPGRADES
CITY OF CHATTANOOGA, TN
CAPITAL IMPROVEMENT PROGRAM



REV	DATE	REVISION DESCRIPTION
B	2/16/18	ISSUED FOR ADDENDUM NO. 3
A	8/31/17	ISSUED FOR BID

THIS LINE IS ONE INCH LONG WHEN PLOTTED FULL SCALE
THIS DRAWING MUST BE USED IN CONJUNCTION WITH THE APPLICABLE OR GOVERNING TECHNICAL SPECIFICATIONS AND OTHER CONTRACT DOCUMENTS.
PROJ #: COC-W-16-017-201 HDR:10052174
DATE: AUGUST 2017
DISC. LEAD: BD DESIGNER: CP CHECKER: JB

SHEET TITLE

NORTH AND SOUTH
PRIMARY SLUDGE
DIVERSION VALVE VAULT
PLAN

SHEET 01C-02