

**ADDENDUM #1**  
**October 19, 2021**

**PROJECT:**     **Center Elementary School Entrance Improvements**

**OWNER:**     City of Waycross

**BID DATE:**     Bid Date – Thursday, October 28, 2021 at 2:00 P.M.

Please be advised the following has changed:

**1.     CLARIFICATIONS & MISCELLANEOUS INFORMATION**

- a.   The general Contractor or subcontractor performing utility/sub-surface storm drainage work under this contract shall have an active Georgia Utility Contractor's License. The general Contractor is not required to have a Georgia Utility Contractor's license provided that his/her subcontractor performing the utility work does have an active Georgia Utility Contractor's License. If the general Contractor does not have an active Georgia Utility Contractor's License, the subcontractor's Georgia Utility Contractor's License number must be included on the front of the sealed envelope in which the Bidder submits his/her bid (in addition to the general Contractor's license number).
- b.   Burning of removed/demolished/cleared vegetation is not allowed on site.
- c.   The depth of the Class 3 rip-rap (to be placed between the handrail and existing wingwalls) shall be 18".
- d.   The grade/cross-slope of the proposed sidewalk is shown correctly in the Typical Section on Sheet C2.0. This grade/cross-slope shall be 2% away from the road.

**2.     TECHNICAL SPECIFICATIONS, SECTION 01025**

- a.   Per Section 01025, the graded aggregate base to be constructed beneath the new sidewalk (both standard sidewalk and turn-down edge) shall be included in the sidewalk bid items.
- b.   Per Sheet C1.0, the Contractor shall clear and grub all existing vegetation within the existing right-of-way. Payment for Vegetation Removal shall be as in Section 01025 – Measurement & Payment.
- c.   Costs for connection of existing storm pipe to new storm structures shall be included in the cost of the storm structure pay item.

**3. CONSTRUCTION PLANS, SHEET C3.0**

- a. All new storm structures shall be precast structures in accordance with the construction details. A detail for the conversion/modification of existing catch basins to manholes has been included on the details sheet.

All bidders shall acknowledge receipt of all addenda issued where indicated on the bid sheets. (SECTION 00410 – Bid Form, Page 2)

**ATTENTION**

**ALL BIDDERS SHALL SIGN IN THE SPACE PROVIDED ON THE ENCLOSED REVISED BID SHEET(S) TO INDICATE RECEIPT OF THIS ADDENDUM.**

**BIDDERS ARE ADVISED THAT IT IS THEIR RESPONSIBILITY TO VERIFY THAT ANY AND ALL ADDENDA HAVE BEEN RECEIVED PRIOR TO SUBMISSION OF THE BID. IN THE CASE ANY BIDDER FAILS TO ACKNOWLEDGE RECEIPT OF ANY SUCH ADDENDA IN THE SPACE PROVIDED ON THE BID FORM, THE BID WILL NEVERTHELESS BE CONSTRUED AS THOUGH THE BIDDER HAS RECEIVED AND ACKNOWLEDGED ALL SUCH ADDENDA, AND THE SUBMISSION OF THE BID WILL CONSTITUTE ACKNOWLEDGEMENT AND RECEIPT OF SAME.**

**END ADDENDUM**

Last Saved By: ESG-GIS  
Drawing Path: Z:\Engineer Projects\W3000 - WAYCROSS, CITY OF\W3000.101 - General Consulting\City Engineer Projects\2021.06 - Center Elementary Turn Lane\CAD\BASE\C-PROP-BASE (Center Elem).dwg  
Plotted: 10/19/2021 8:30 AM  
Drawing Path: Z:\Engineer Projects\W3000 - WAYCROSS, CITY OF\W3000.101 - General Consulting\City Engineer Projects\2021.06 - Center Elementary Turn Lane\CAD\BASE\C-PROP-BASE (Center Elem).dwg

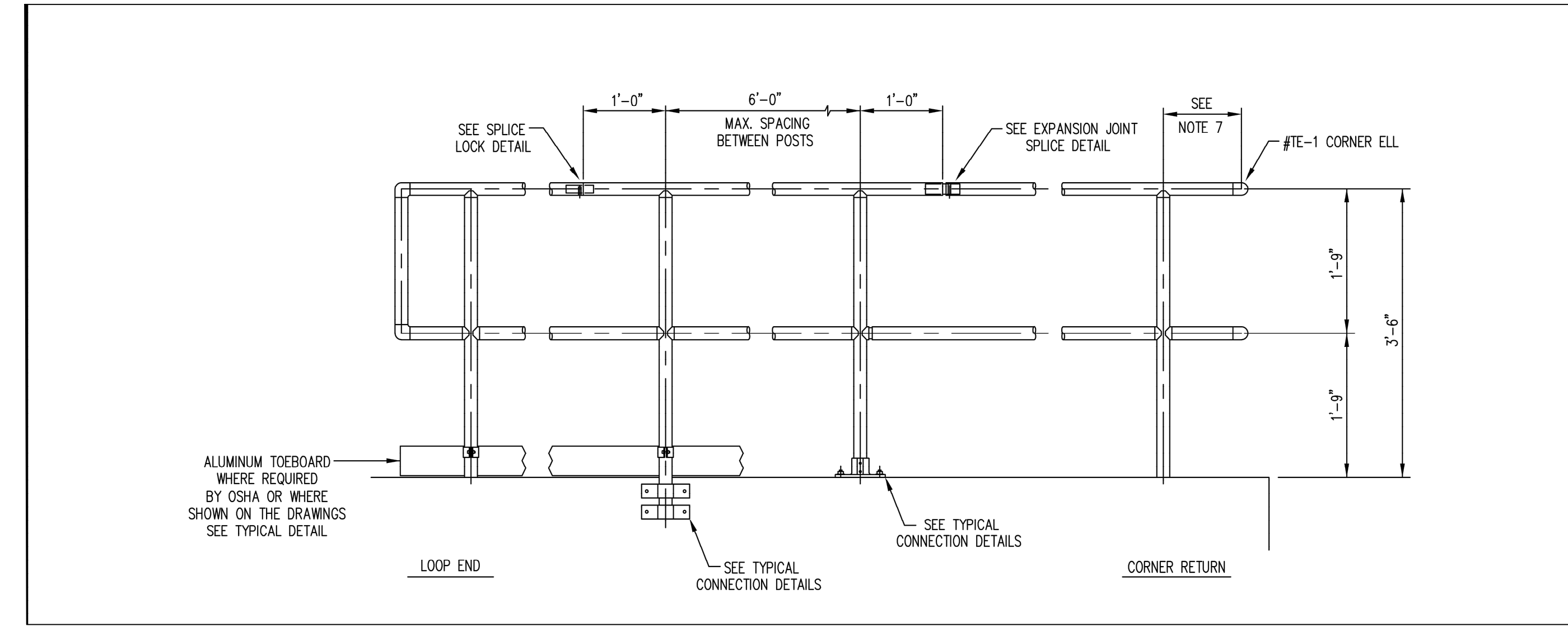

TOP-MOUNT HANDRAIL DETAIL  
NTS

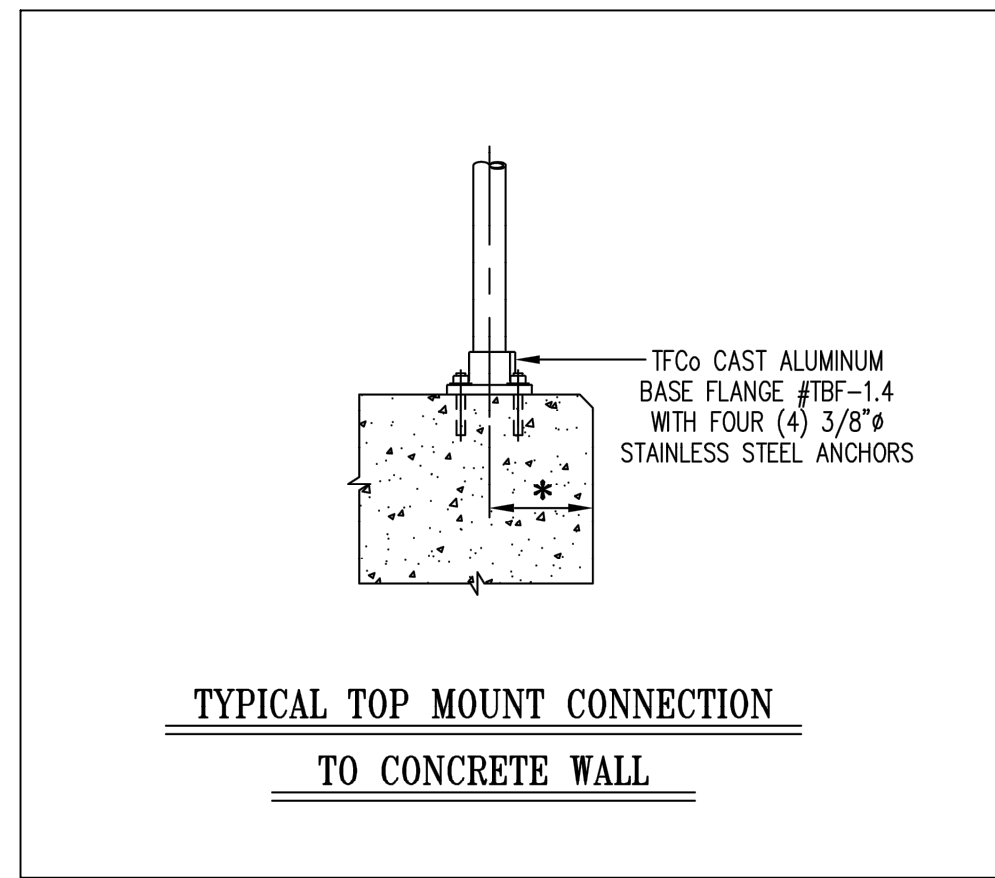

TYPICAL TOP MOUNT CONNECTION  
TO CONCRETE WALL

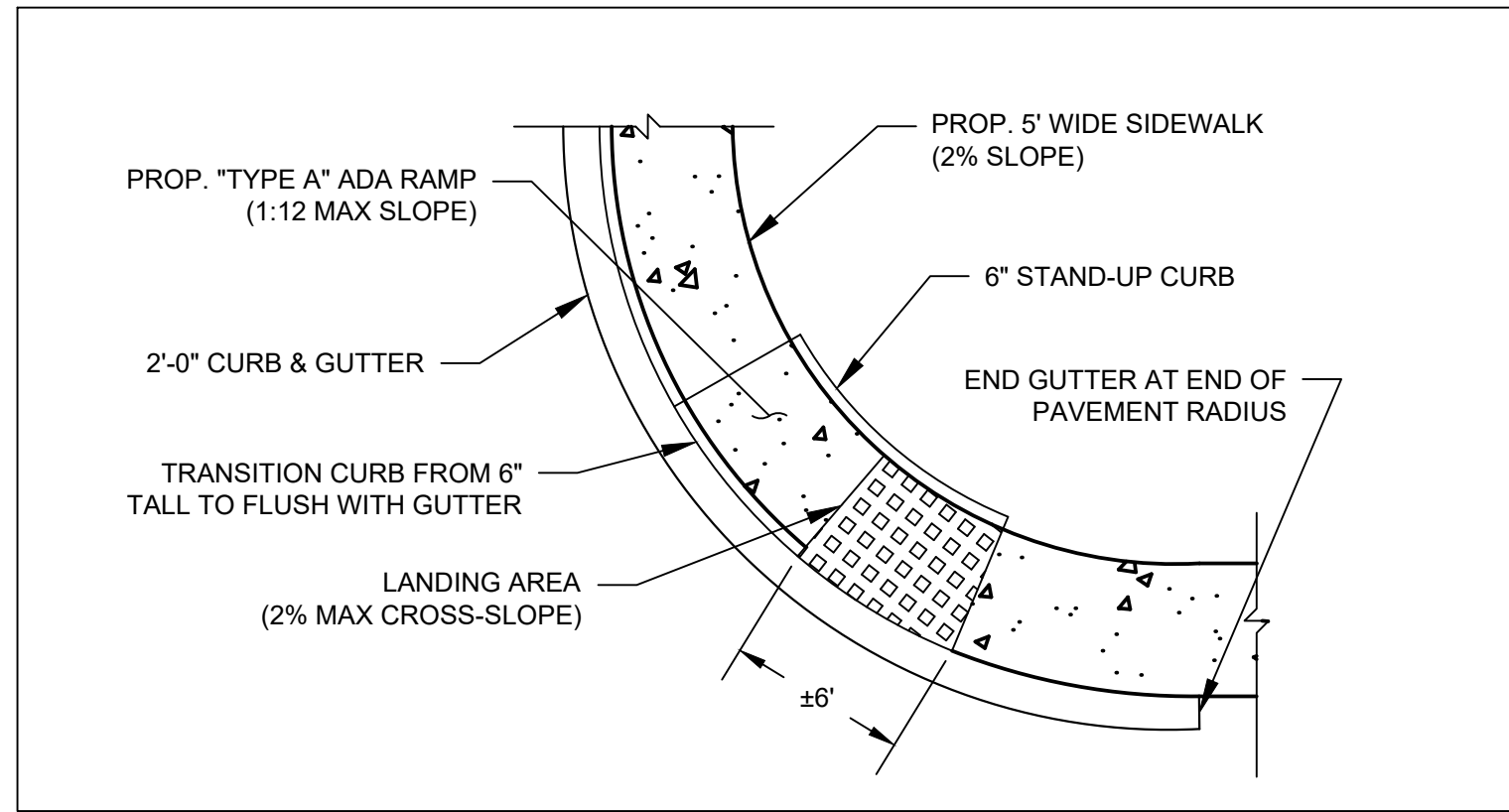

SIDEWALK RAMP DETAIL  
NTS

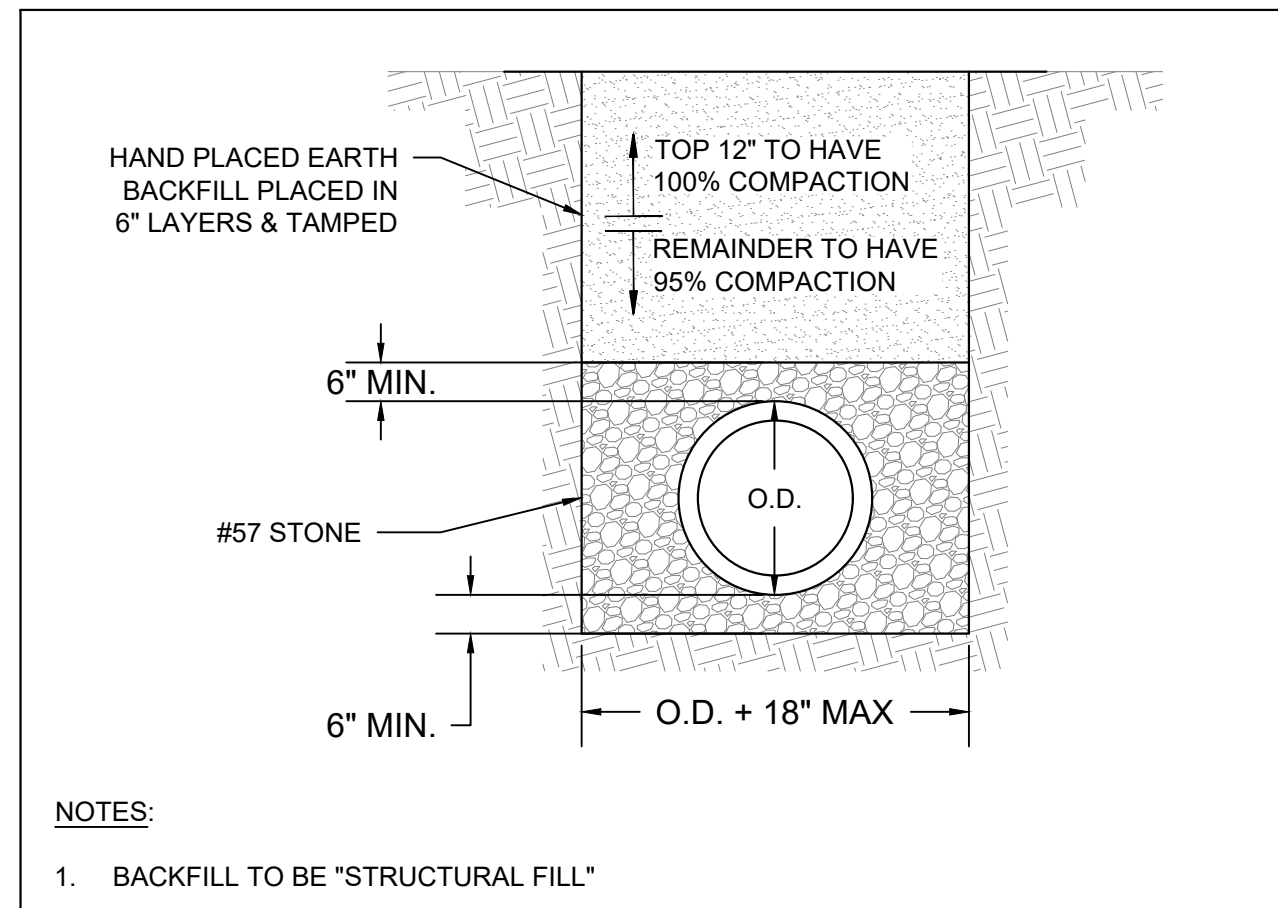

PIPE BEDDING AND PAVEMENT SECTION  
NTS

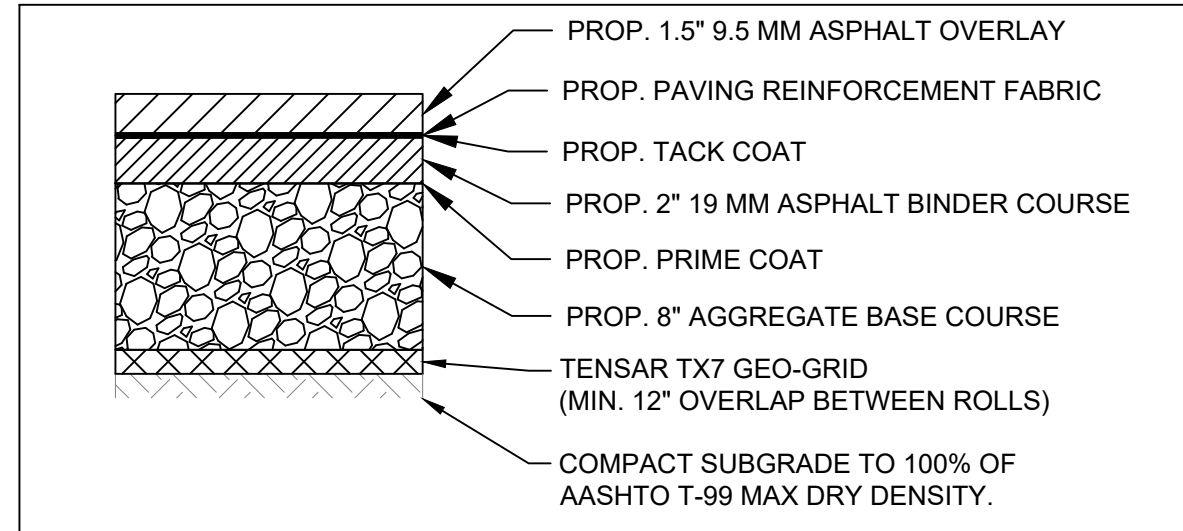

FULL-DEPTH ASPHALT DETAIL  
NTS

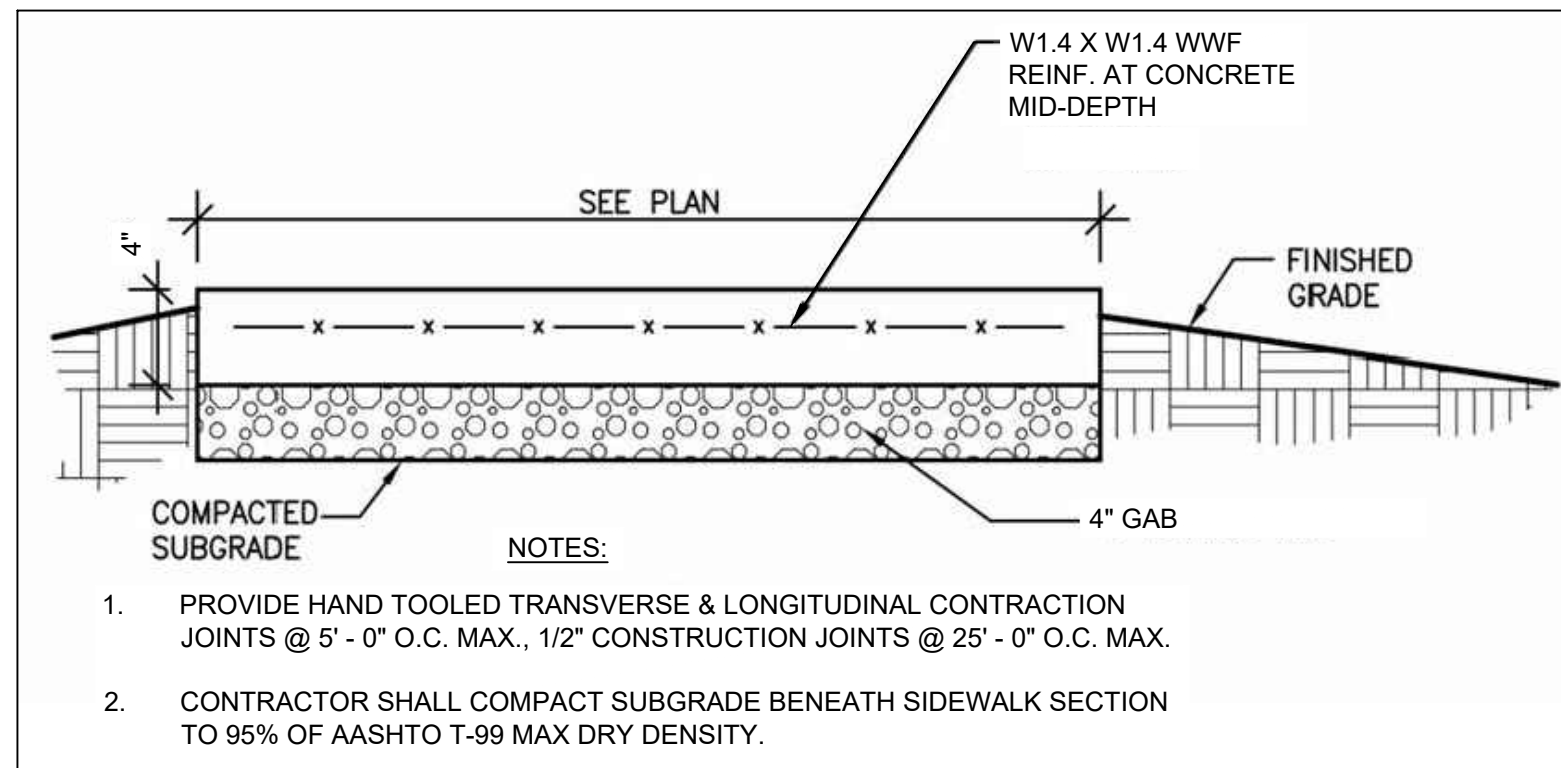

TYPICAL SIDEWALK DETAIL  
NTS

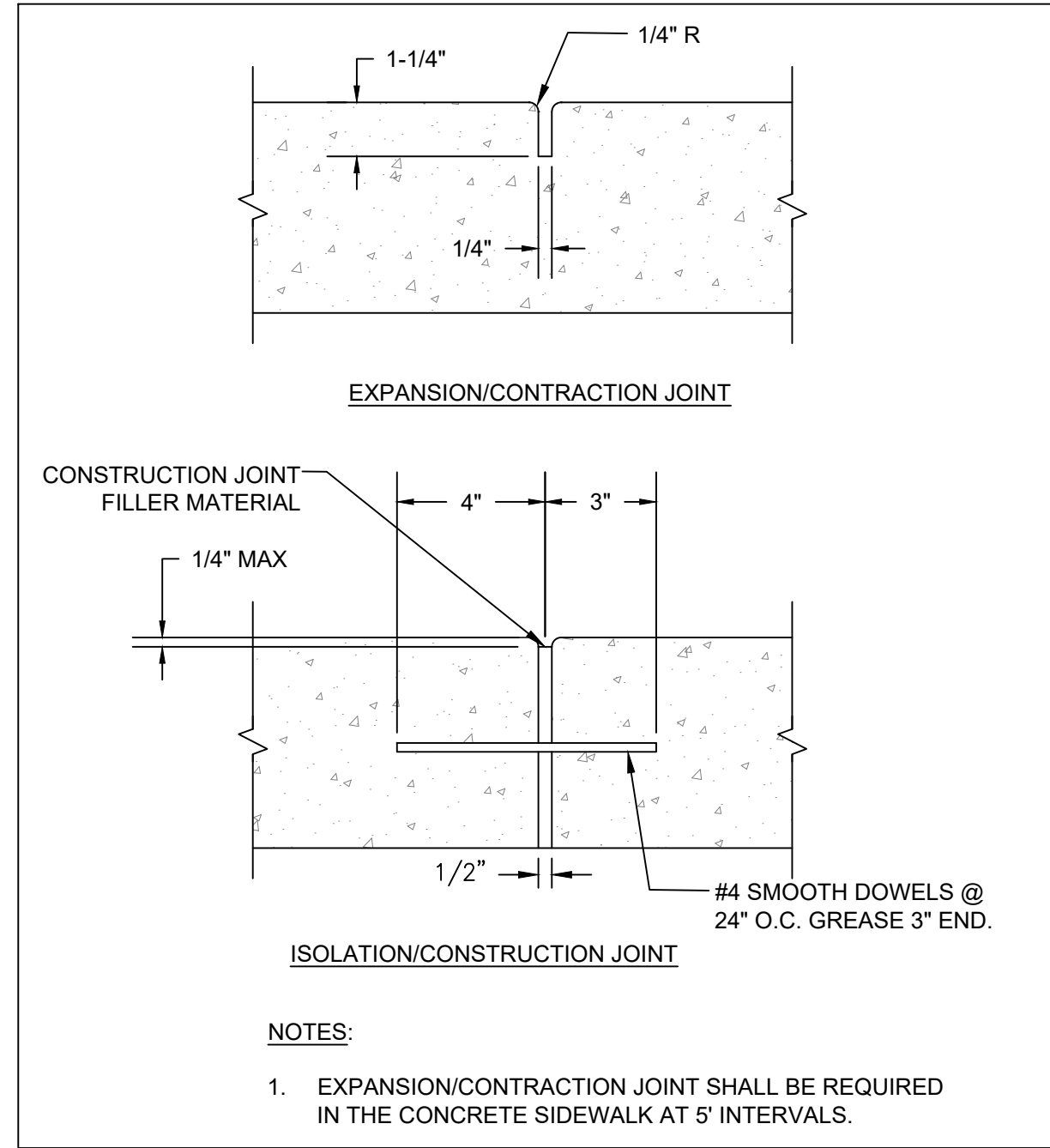

CONCRETE SIDEWALK JOINT DETAIL  
NTS

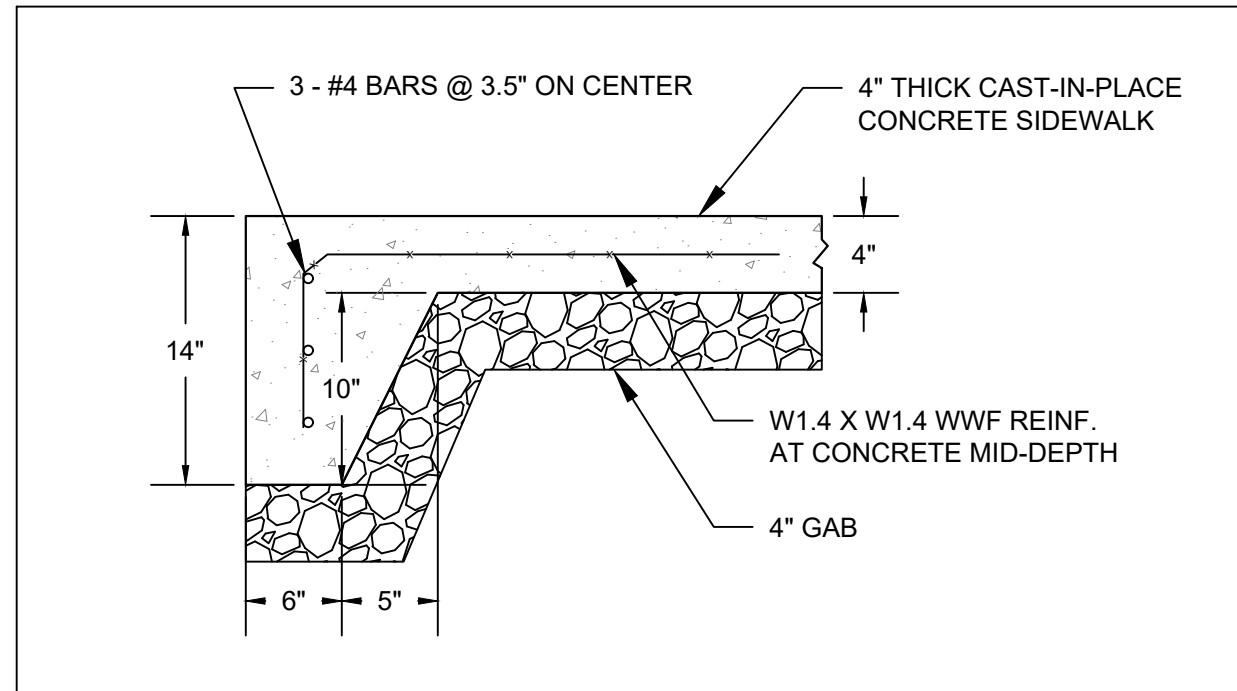

TURN-DOWN EDGE SIDEWALK DETAIL  
NTS

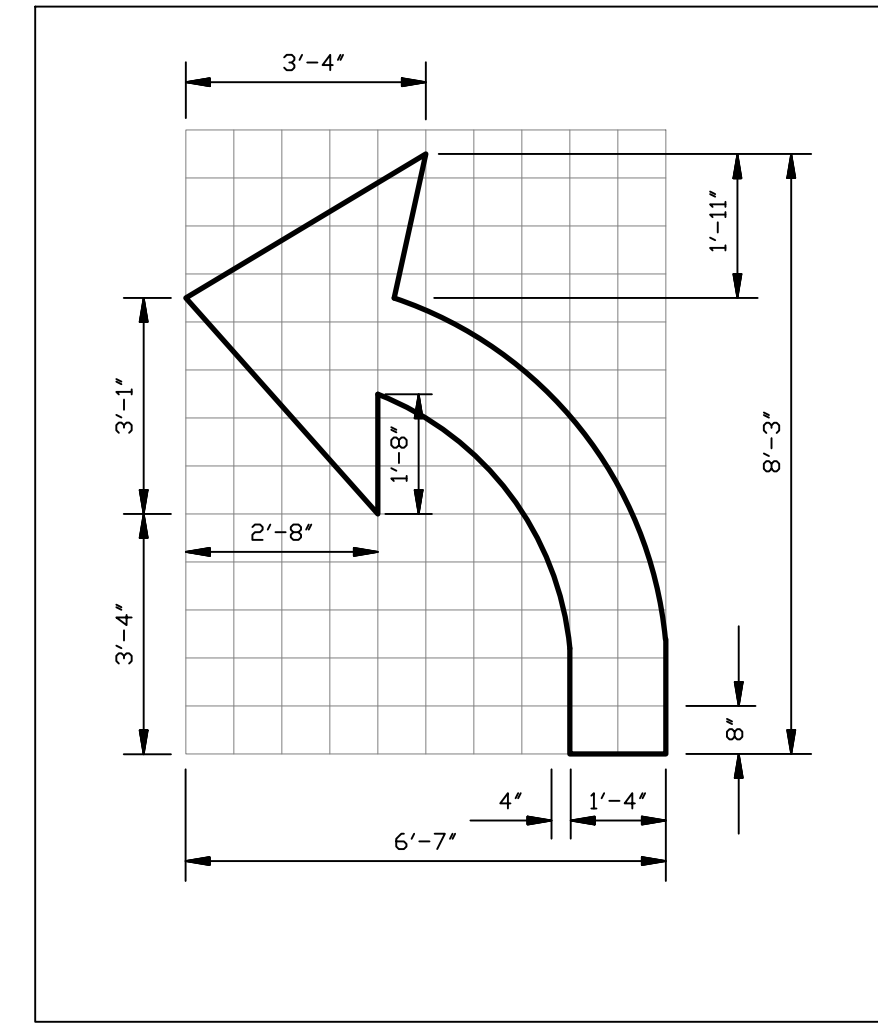

PAVEMENT MARKING ARROW - TYPE 2  
NTS

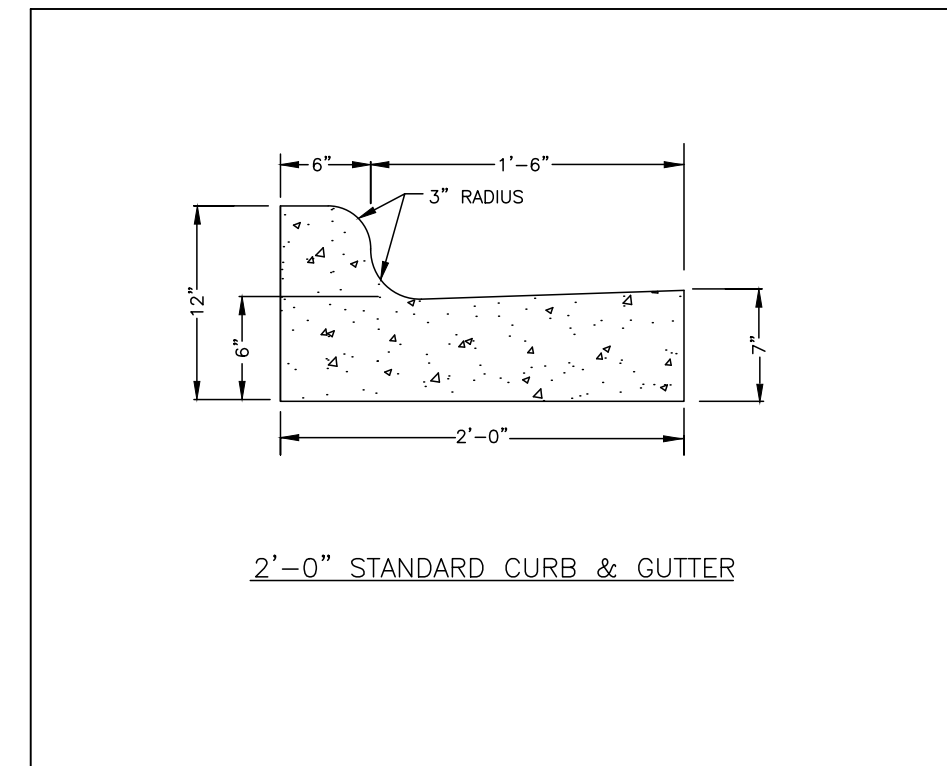

CURB AND GUTTER DETAIL (TYP.)  
NTS

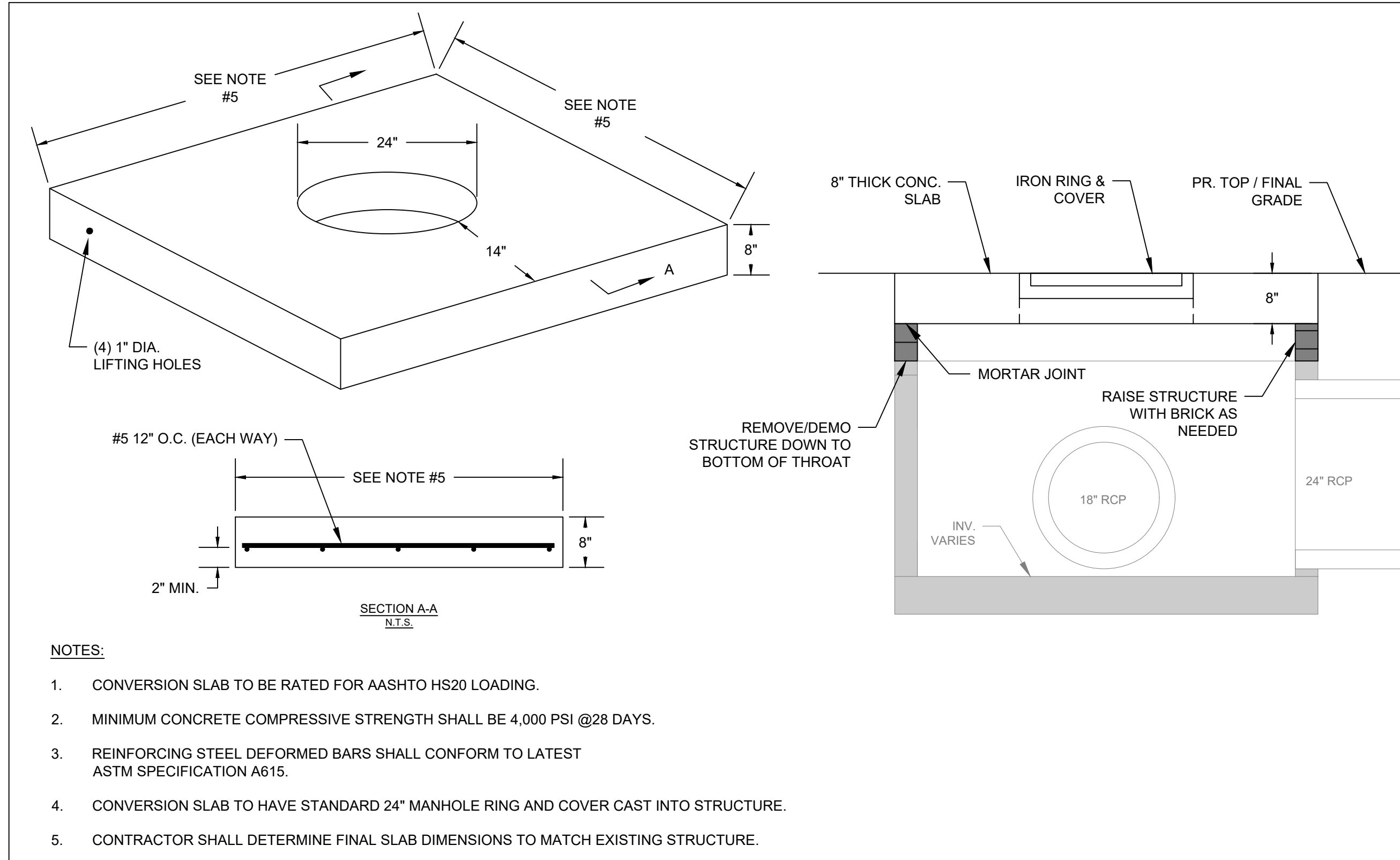

CONVERT CATCH BASIN TO MANHOLE DETAIL  
NTS

REVISIONS	NO.	DESCRIPTION	DATE
1	ADDENDUM #1 - ADDED CATCH BASIN CONVERSION DETAIL	10/19/21	

BID SET



DRAWN BY: EML  
CHECKED BY: ADS  
DATE: OCT 2021  
SCALE: N.T.S.

CONTENT:  
CONSTRUCTION  
DETAILS

SHEET NO:

C3.0