

NOTES TO CONTRACTOR:

REMOVE AND REPLACE INTERIOR AND EXTERIOR LIGHTING FIXTURES AS INDICATED ON ELECTRICAL DRAWINGS.

INSTALL J-HOOKS, SUPPORTED FROM OVERHEAD STRUCTURE OR WALLS, AND RELOCATE CABLING CURRENTLY SUPPORTED BY ACOUSTICAL CEILING GRID TO J-HOOKS. ANY AND ALL ABANDONED CABLING ENCOUNTERED DURING THE REMOVAL OF CEILING SHALL BE REMOVED IN ACCORDANCE WITH NEC ARTICLE 800.25.

REFER TO MECHANICAL DRAWINGS FOR DEMOLITION AND REPLACEMENT OF MECHANICAL SYSTEMS.

BASE BID: REPLACEMENT OF EXISTING 2'X4' CEILING TILES TO NEW 2'X2' TILES:
 PROVIDE ALL LABOR AND MATERIAL REQUIRED TO REPLACE EXISTING 2' X 4' CEILING TILE WITH NEW 2'X2' CEILING TILE AS INDICATED ON REFLECTED CEILING PLANS. CONTRACTOR TO REMOVE EXISTING 2' X 4' CEILING TILE. MODIFY EXISTING CEILING GRID BY ADDING NEW MATCHING GRIDS TO ACCOMMODATE NEW 2'X2' CEILING TILES.

REPLACE WITH SAME TYPE OF PANEL (STANDARD OR MOISTURE RESISTANT PANEL). THE CONTRACTOR SHALL PATCH AND RE-PAINT ANY PARTITIONS OR SOFFITS DAMAGED DURING CONSTRUCTION OPERATIONS.

DURING DEMOLITION OF THE EXISTING ACOUSTICAL CEILING ALL ELECTRICAL DEVICES THAT ARE TO REMAIN SHALL BE SUPPORTED FROM THE STRUCTURE AND RE-INSTALLED INTO THE NEW ACOUSTICAL CEILING.

ALTERNATE # 1: REPLACEMENT OF EXISTING 2'X4' CEILING TILES TO NEW 2'X2' TILES:
 PROVIDE ALL LABOR AND MATERIAL REQUIRED TO REPLACE EXISTING 2' X 4' CEILING TILE WITH NEW 2'X2' CEILING TILE AS INDICATED ON REFLECTED CEILING PLANS. CONTRACTOR TO REMOVE EXISTING 2' X 4' CEILING TILE. MODIFY EXISTING CEILING GRID BY ADDING NEW MATCHING GRIDS TO ACCOMMODATE NEW 2'X2' CEILING TILES.

REPLACE WITH SAME TYPE OF PANEL (STANDARD OR MOISTURE RESISTANT PANEL). THE CONTRACTOR SHALL PATCH AND RE-PAINT ANY PARTITIONS OR SOFFITS DAMAGED DURING CONSTRUCTION OPERATIONS.

DURING DEMOLITION OF THE EXISTING ACOUSTICAL CEILING ALL ELECTRICAL DEVICES THAT ARE TO REMAIN SHALL BE SUPPORTED FROM THE STRUCTURE AND RE-INSTALLED INTO THE NEW ACOUSTICAL CEILING.

ALTERNATE # 2:
 REPAIR EXISTING EIFS WHERE INDICATED ON CONTRACT DOCUMENTS. CONTRACTOR SHALL FIELD VERIFY THE EXTENT OF REPAIRS AND PATCH AND REPAINT TO MATCH THE EXISTING CONSTRUCTION.

ARCHITECTURAL DEMOLITION - GENERAL NOTES:

ARCHITECTURAL DEMOLITION PLANS SHOW ONLY ARCHITECTURAL SELECTIVE DEMOLITION SCOPE OF WORK. CONTRACTOR SHALL REFER TO OTHER ARCHITECTURAL FLOOR PLANS, ELEVATIONS, SECTIONS AND DETAILS FOR ADDITIONAL ARCHITECTURAL DEMOLITION WORK NOT SHOWN ON DEMOLITION PLANS. CONTRACTOR SHALL REFER TO PLUMBING, MECHANICAL AND ELECTRICAL DRAWINGS FOR COMPLETE DEMOLITION SCOPE OF WORK. CONTRACTOR SHALL REFER TO SPECIFICATIONS SECTION 02 41 19 SELECTIVE STRUCTURAL DEMOLITION FOR ADDITIONAL INFORMATION.

CONTRACTOR SHALL FIELD VERIFY EXISTING CONDITIONS, DIMENSIONS, QUANTITY, ETC. AND TO COORDINATE DEMOLITION WORK WITH NEW WORK PRIOR TO BEGINNING DEMOLITION WORK. EXISTING STRUCTURES, BUILDING COMPONENTS, SPECIALTIES, EQUIPMENT, CABINETS AND FINISHES MUST REMAIN IN PLACE IF NO WORK IS SHOWN OR OTHERWISE NOTED ON PLANS. UNLESS OTHERWISE NOTED ALL REMOVED MATERIAL AND DEBRIS ARE TO BECOME PROPERTY OF CONTRACTOR AND REMOVED FROM SITE.

CONTRACTOR SHALL PATCH AND REPAIR ALL EXISTING WALLS DISTURBED BY DEMOLITION. CONTRACTOR SHALL PATCH AND REPAIR NEW OPENINGS. CONTRACTOR SHALL PATCH AND REPAIR ALL NEW HOLES FROM REMOVAL OF EQUIPMENT, WALL MOUNTED MILLWORK, WALL MOUNTED ACCESSORIES, DUCTWORK, CIRCUITS, CONDUITS, PIPING, ETC. CONTRACTOR SHALL PATCH AND REPAIR ALL NEW HOLES/PENETRATIONS REQUIRED FOR INSTALLATION OF NEW DUCTWORK, EQUIPMENT, PIPING, ETC. CONTRACTOR SHALL PATCH AND REPAIR WALLS WITH SAME MATERIALS FOR COHESIVE LOOK. CONTRACTOR SHALL MAINTAIN EXISTING FIRE RATING OF WALLS AND/OR SPACE SEPARATION AND SEAL ALL PENETRATIONS AND WALLS TO DECK.

CONTRACTOR SHALL COORDINATE ENTIRE DEMOLITION WORK FOR ALL REQUIRED PATCHING AND REPAIRS, WALLS AND OTHER STRUCTURES AFTER REMOVAL OF PLUMBING, MECHANICAL, AND ELECTRICAL EQUIPMENT NOT SHOWN ON ARCHITECTURAL DRAWINGS.

CONTRACTOR SHALL ENGAGE PROFESSIONAL MOVING MANAGEMENT COMPANY FOR MOVING OUT AND MOVING BACK IN ALL FURNISHING AND INVENTORY FROM AND INTO RENOVATED ROOMS PRIOR TO BEGINNING OF CONSTRUCTION. CONTRACTOR SHALL CONFIRM CONSTRUCTION SCHEDULE, PHASING AND MOVING WITH OWNER. ALL ADDITIONAL TEMPORARY STORAGE SPACE, IF REQUIRED, IS RESPONSIBILITY OF CONTRACTOR. REFER TO SPECIFICATIONS SECTION 01783 SPECIAL PROCEDURES FOR MOVE MANAGEMENT.

LEGEND TO REFLECTED CEILING PLAN:

- 2' x 2' ACOUSTICAL PANEL CEILING
- 2' x 4' RECESSED FLAT PANEL LIGHT FIXTURE
- 2' x 4' PENDANT MOUNTED LIGHT FIXTURE
- 2' x 4' RECESSED CEILING MOUNTED EMERGENCY LIGHT FIXTURE
- 1' x 4' RECESSED FLAT PANEL LIGHT FIXTURE
- 2' x 2' RECESSED FLAT PANEL LIGHT FIXTURE
- PENDANT MOUNTED LIGHT FIXTURE
- 2' x 2' HVAC RETURN AIR GRILLE
- 2' x 2' HVAC SUPPLY AIR GRILLE
- EXHAUST RETURN
- HVAC FAN COIL UNIT ON CEILING
- HVAC CEILING MOUNTED EXHAUST FAN

LEGEND TO WALL TYPES & WALL RATING:

LEGEND TO WALL TYPES AND WALL RATING PROVIDES SPECIFIC INFORMATION ON TYPE OF CONSTRUCTION OF INTERIOR WALLS AS INDICATED ON REFLECTED CEILING PLANS WITH INFORMATION SHOWN ON FLOOR PLANS. CONTRACTOR SHALL CONSTRUCT ALL WALLS AS INDICATED ON DRAWINGS. CHANGES TO WALL DESIGN IS NOT ALLOWED WITHOUT APPROVAL OF ARCHITECT. REFER TO FLOOR PLANS FOR INFORMATION ON WALL DETAILS, WALL SECTIONS, DOORS, WINDOWS, AND SPECIALTIES AND EQUIPMENT MOUNTED IN WALLS. REFER TO ENLARGED PLANS ON DRAWING A401 FOR ADDITIONAL WALL INFORMATION AND DIMENSIONS. REFER TO STRUCTURAL DRAWINGS FOR FURTHER WALL DETAILS. REFER TO DRAWING A701 FOR TYPICAL FIRESTOPPING DETAILS. REFER TO DRAWING A702 & A703 FOR TYPICAL U.L. DESIGN DETAILS.

1B - 1 HOUR FIRE RATED BARRIER (CMU)

1 HOUR FIRE-RATED CONCRETE BLOCK WALL UP TO UNDERSIDE OF FLOOR OR ROOF DECK. WALL THICKNESS AS INDICATED ON FLOOR PLAN. FIRESTOP TOP OF WALL TIGHT TO UNDERSIDE OF DECK. FIRESTOP TIGHT AROUND ALL WALL PENETRATIONS ON BOTH SIDERS OF WALL. (U.L. DESIGN NO. U419 AND U906.)

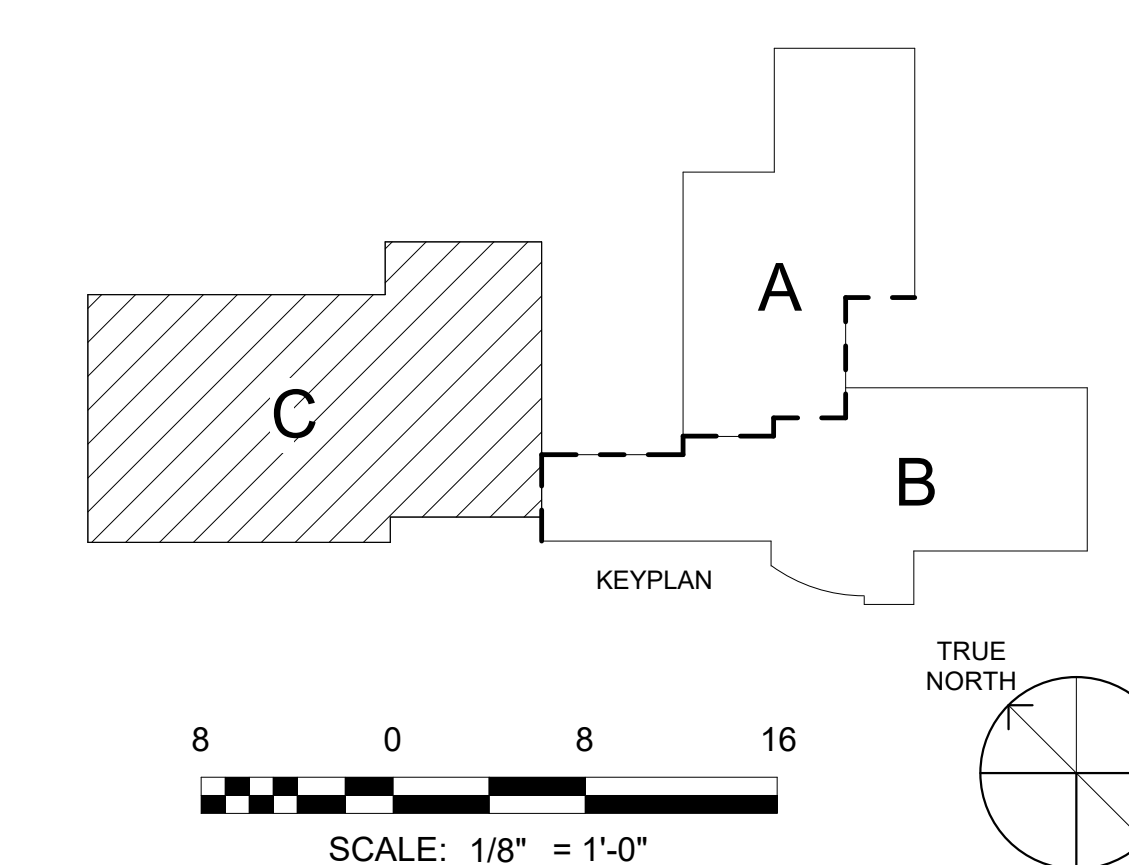
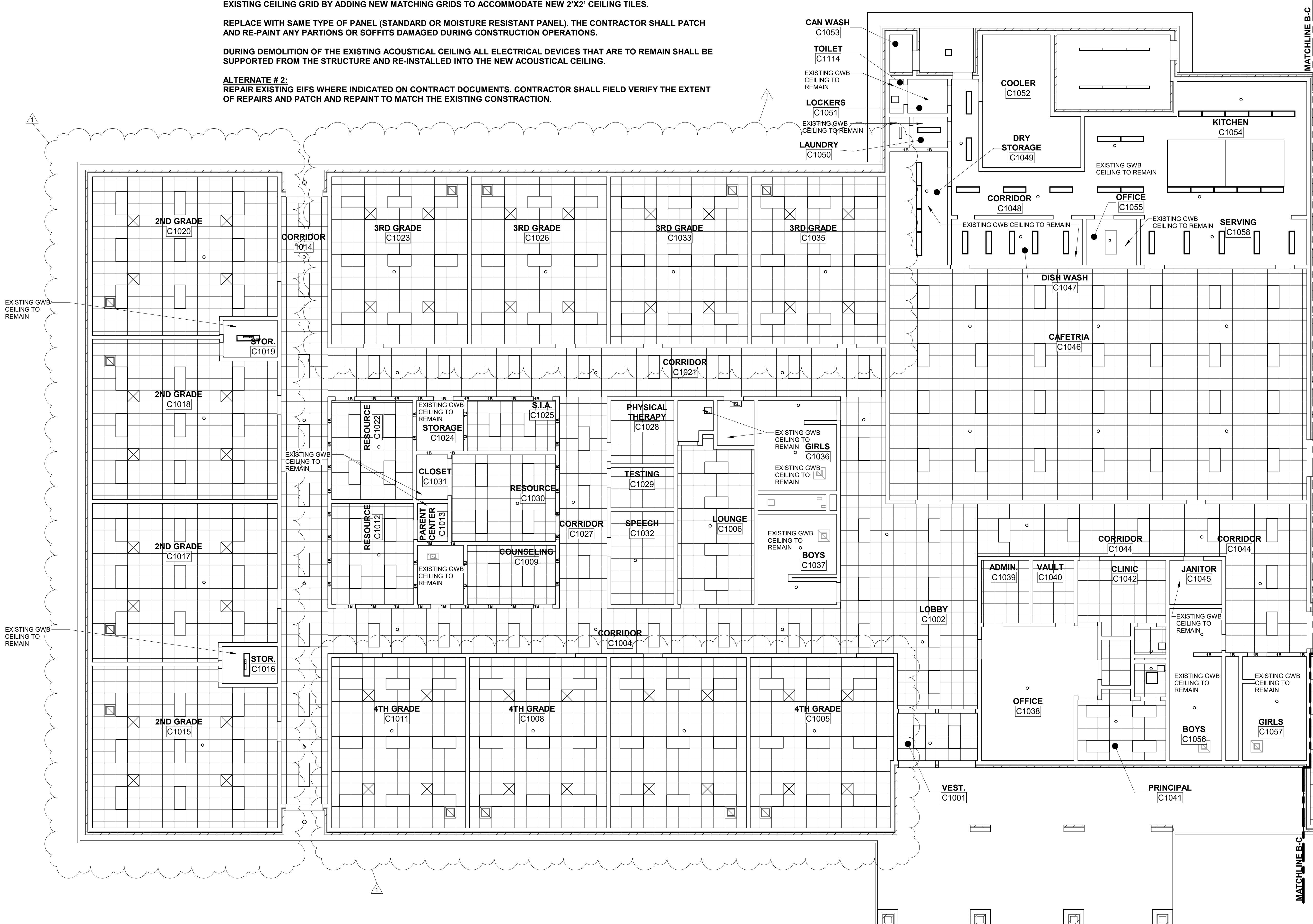

SA&E PROJECT NUMBER	01-920-016
BID PACKAGE	BP-1
ISSUED FOR CONSTRUCTION	08-24-2022
Southern A&E	
7951 Troon Circle Austell, Ga 30168 (770) 819-7777	R # 1 Doc # AD3 Date 10-06-2022
architects & engineers LLC	
© COPYRIGHT 2022 BY SOUTHERN A&E, LLC. ALL RIGHTS RESERVED. THIS DOCUMENT IS THE PROPERTY OF SOUTHERN A&E, LLC AND SHALL NOT BE COPIED OR REPRODUCED IN WHOLE OR IN PART WITHOUT EXPRESSED WRITTEN CONSENT FROM SOUTHERN A&E, LLC.	
School Code: 746-5052 HVAC & Lighting Replacement to:	

STONE CREEK ELEMENTARY
 1600 HAPPY VALLEY RD, ROSSVILLE, GA 30741
WALKER COUNTY SCHOOL DISTRICT
 201 S DUKE ST, LAFAYETTE, GA 30728

RCP PLAN - WING C

	DRAWING NUMBER
	A104

1 REFLECTED CEILING PLAN - WING C
 A104 1/8" = 1'-0"