

KEYNOTE SCHEDULE	
#	KEYNOTE DESCRIPTION
D7	EXISTING ROOFTOP AC UNIT TO REMAIN.
D9	EXISTING KITCHEN HOOD VENTILATION SYSTEM TO REMAIN ALONG WITH ASSOCIATED DUCTWORK, CONTROLS, SWITCHES, AND FANS ON ROOF.
M1	THE NEW CEILING-MOUNTED EXHAUST FAN INTO EXISTING EXHAUST DUCTWORK ABOVE CEILING.
M4	EXISTING ROOF VENT TO REMAIN. THE NEW EXHAUST FAN DUCTWORK INTO EXISTING ROOF CAP.
M5	EXISTING DUCTWORK AND DIFFUSERS FOR RTU SHALL REMAIN. REFER TO SPECIFICATION FOR DUCT CLEANING. CONTRACTOR TO PERFORM A DUCT TRACING AND BALANCE AIRFLOW TO QUANTITIES ON SCHEDULE.

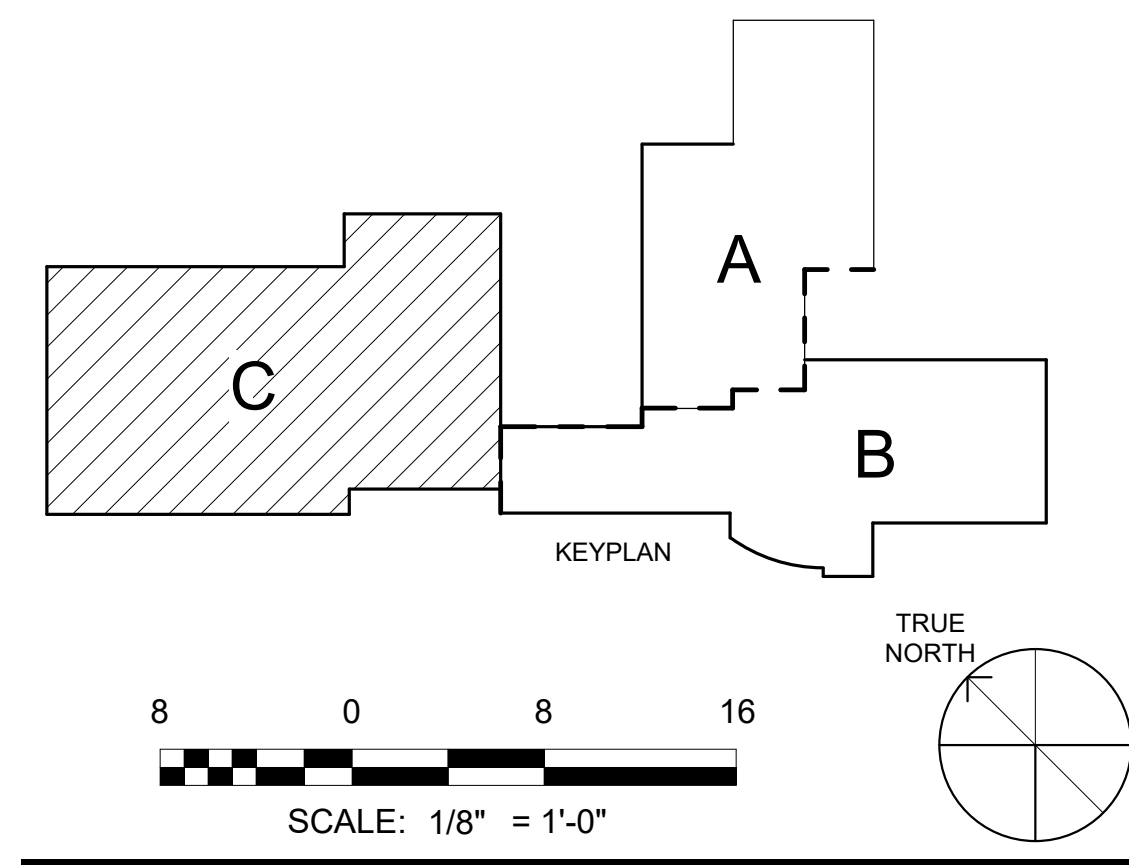

1 MECHANICAL RENOVATION PLAN - WING C  
1/8" = 1'-0"

SA&E PROJECT NUMBER	01-920-016
BID PACKAGE	BP-1
ISSUED FOR CONSTRUCTION	08-24-2022
	REVISIONS
	R # Doc # Date
1 AD4 10-06-2022	
© COPYRIGHT 2022 BY SOUTHERN A&E, LLC. ALL RIGHTS RESERVED. THIS DOCUMENT IS THE PROPERTY OF SOUTHERN A&E, LLC AND SHALL NOT BE COPIED OR REPRODUCED IN WHOLE OR IN PART WITHOUT EXPRESSED WRITTEN CONSENT FROM SOUTHERN A&E, LLC.	
School Code: 746-5052 HVAC & Lighting Replacement to: <b>STONE CREEK ELEMENTARY</b> 1600 HAPPY VALLEY RD, ROSSVILLE, GA 30741 <b>WALKER COUNTY SCHOOL DISTRICT</b> 201 S DUKE ST, LAFAYETTE, GA 30728	
MECHANICAL RENOVATION PLAN - WING C	
DRAWING NUMBER	M104