



## **Addendum No. 4**

**Date of Addendum Issuance:** October 25, 2019

**Project:** Old Phoenix Road Auxiliary Lane Construction

**Bid Item #:** 19-42001-003

The following are modifications (revised Bid Schedule of Items & Project Plan Set) to the ITB package and shall be utilized when submitting a bid on the referenced project:

(corrected 10/25/2019)

**(BIDDERS MUST RETURN THIS FORM WITH BID RESPONSE)**  
**BID SCHEDULE OF ITEMS – OLD PHOENIX ROAD AUXILIARY LANE CONSTRUCTION**

<b>PAY ITEM</b>	<b>ITEM DESCRIPTION</b>	<b>UNITS</b>	<b>QUANTITY</b>	<b>UNIT PRICE</b>	<b>TOTAL AMOUNT</b>
150-1000	TRAFFIC CONTROL	LS	LS		
210-0100	GRADING COMPLETE	LS	LS		
163-0232	TEMPORARY GRASSING	AC	0.20		
163-0240	MULCH	TN	1.00		
163-0550	CONSTRUCT AND REMOVE INLET SEDIMENT TRAP	EA	10		
165-0010	MAINTENANCE OF TEMPORARY SILT FENCE - TYPE A	LF	200		
165-0105	MAINTENANCE OF INLET SEDIMENT TRAP	EA	10		
171-0010	TEMPORARY SILT FENCE, TYPE A	LF	400		
310-5060	GR AGGR BASE CRS, 6 IN, INCL MATL	SY	133		
310-5120	GR AGGR BASE CRS, 12 IN, INCL MATL	SY	506		
402-3121	RECYCLED ASPH CONC 25 MM SUPERPAVE, GP 1 OR 2, INCL BITUM MATL & H LIME	TN	82		
402-3130	RECYCLED ASPH CONC 12.5 MM SUPERPAVE, GP 1 OR 2, INCL BITUM MATL & H LIME	TN	41		
402-3190	RECYCLED ASPH CONC 19 MM SUPERPAVE, GP 1 OR 2, INCL BITUM MATL & H LIME	TN	55		
413-0750	TACK COAT	GAL	98		
441-0018	DRIVEWAY CONCRETE, 8 IN TK	SY	198		
441-0754	CONC MEDIAN, 7 1/2 IN	SY	23		
441-4030	CONC VALLEY GUTER, 8 IN	SY	35		
441-6216	CONC CURB & GUTTER, 8" X 24", TYPE 2	LF	504		
446-1100	PVMT REINF FABRIC STRIPS, TP 2, 18 INCH WIDTH	LF	345		
500-9999	CLASS B CONCRETE, PVMT WIDENING	CY	15		
550-1150	STORM DRAIN PIPE, 15 IN, H 1-10	LF	8		
550-1180	STORM DRAIN PIPE, 18 IN, H 1-10	LF	8		
550-1240	STORM DRAIN PIPE, 24 IN, H 1-10	LF	8		
611-3000	RECONSTRUCT CATCH BASIN	EA	1		
611-3100	RECONSTRUCT JUNCTION BOX	EA	4		
611-8040	ADJUST DROP INLET TO GRADE	EA	1		

636-1033	HIGHWAY SIGNS, TP 1 MATL, REFL SHEETING, TP 9	SF	13		
636-2070	GALV STEEL POSTS, TP 7	LF	25		
641-1200	GUARDRAIL, TYPE W	LF	96		
641-5001	GUARDRAIL ANCHORAGE, TP 1	EA	2		
641-5015A	GUARDRAIL TERMINAL, TP 12A, 31 IN, NON-FLARED, ENERGY-ABSORBING	EA	1		
647-2120	PULL BOX, PB-2	EA	1		
647-6300	LOOP DETECTOR, 6 FT X 40 FT, QUADRUPOLE	EA	2		
653-0120	THERMOPLASTIC PVMT MARKING, ARROW, TP 2	EA	3		
653-1501	THERMOPLASTIC SOLID TRAFFIC STRIPE, 5 IN, WHITE	LF	385		
653-1704	THERMOPLASTIC SOLID TRAF STRIPE, 24 IN, WHITE	LF	15		
653-3501	THERMOPLASTIC SKIP TRAFFIC STRIPE, 5IN, WHITE	GLF	80		
682-6233	CONDUIT, NONMETL, TP 3, 2 IN	LF	20		
668-1100	CATCH BASIN, GP 1	EA	1		
668-2100	DROP INLET, GP 1	EA	2		
700-6910	PERMANENT GRASSING	AC	0.20		
700-7000	AGRICULTURAL LIME	TN	1.00		
700-8000	FERTILIZER MIXED GRADE	TN	1.00		
700-8100	FERTILIZER NITROGEN CONTENT	LB	10		
700-9300	SOD	SY	500		
				<b>TOTAL BID</b>	\$

**Print Total Bid Price: (print)** \_\_\_\_\_

In compliance with the attached Specification, the undersigned offers and agrees that if this Bid is accepted, by the Putnam County Board of Commissioners within Ninety (90) days of the date of Bid opening, that he will furnish any or all of the Items upon which Prices are quoted, at the Price set opposite each Item, delivered to the designated point(s) within the time specified in the Bid Schedule.

COMPANY \_\_\_\_\_

ADDRESS \_\_\_\_\_

AUTHORIZED SIGNATURE \_\_\_\_\_

PRINT / TYPE NAME \_\_\_\_\_

TITLE \_\_\_\_\_

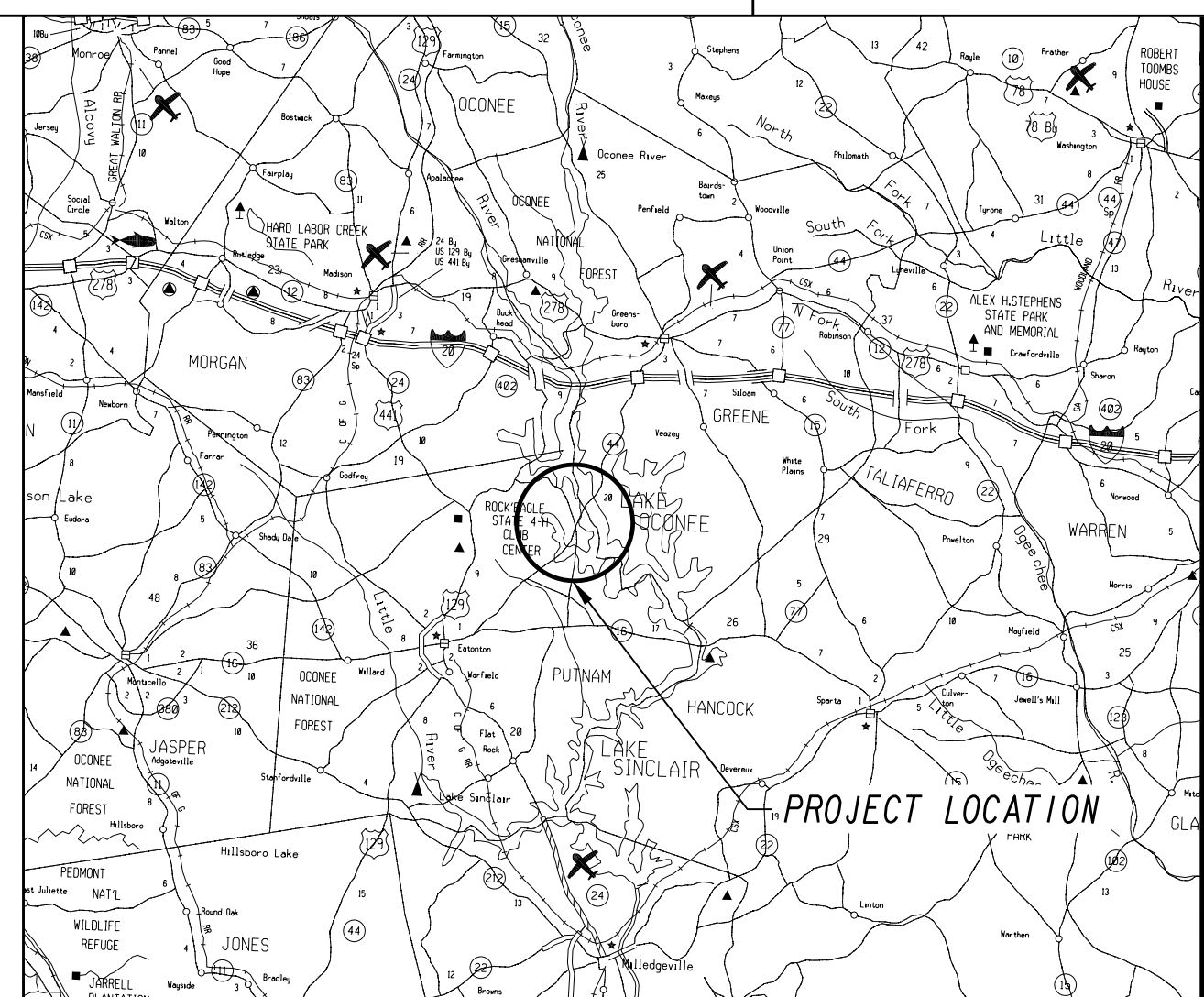

LOCATION SKETCH

# PUTNAM COUNTY BOARD OF COMMISSIONERS

## PLAN AND PROFILE OF PROPOSED OLD PHOENIX ROAD AUXILIARY LANE

### FEDERAL AID PROJECT

FEDERAL ROUTE \* N/A  
STATE ROUTE \* SR 44  
P.I. NO. 4619118

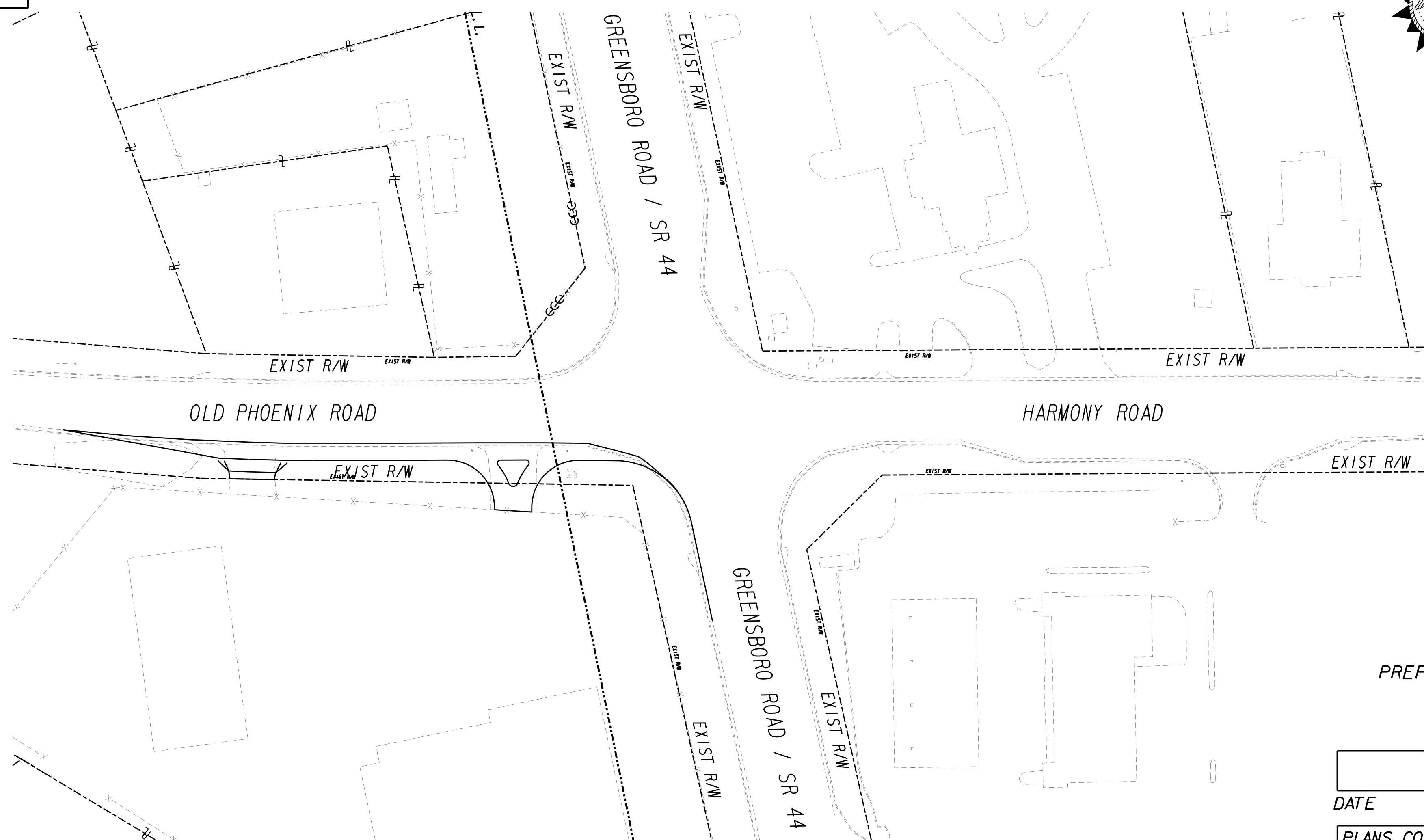
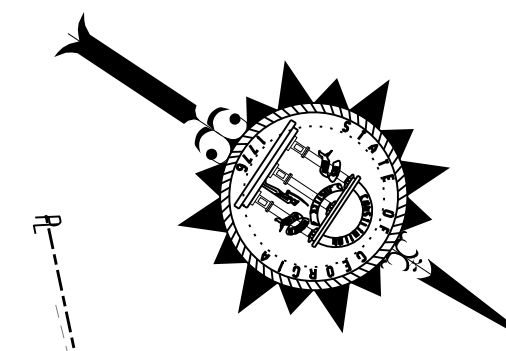

THIS PROJECT HAS BEEN PREPARED USING THE HORIZONTAL GEORGIA COORDINATE SYSTEM OF 1984 (NAD 1983/94 WEST ZONE, AND THE NORTH AMERICAN VERTICAL DATUM (NAVD) OF 1988.

LENGTH OF PROJECT	COUNTY No. 237
	Project No. 4619118
	MILES
NET LENGTH OF ROADWAY	
NET LENGTH OF BRIDGES	
NET LENGTH OF PROJECT	
NET LENGTH OF EXCEPTIONS	
GROSS LENGTH OF PROJECT	

THE DATA TOGETHER WITH ALL OTHER INFORMATION SHOWN ON THESE PLANS OR IN ANYWAY INDICATED THEREBY, WHETHER BY DRAWINGS OR NOTES, OR IN ANY OTHER MANNER, ARE BASED UPON FIELD INVESTIGATIONS AND ARE BELIEVED TO BE INDICATIVE OF ACTUAL CONDITIONS. HOWEVER, THE SAME ARE SHOWN AS INFORMATION ONLY, ARE NOT GUARANTEED, AND DO NOT BIND THE DEPARTMENT OF TRANSPORTATION IN ANY WAY. THE ATTENTION OF BIDDER IS SPECIFICALLY DIRECTED TO SUBSECTIONS 102.04, 102.05, AND 104.03 OF THE SPECIFICATIONS.

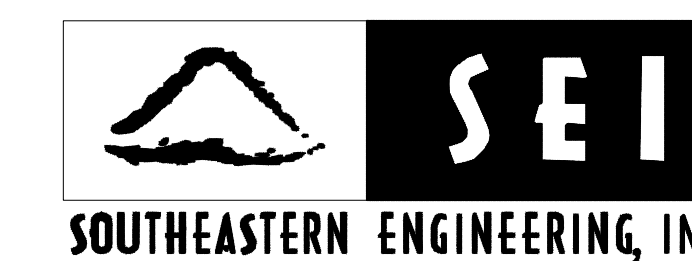
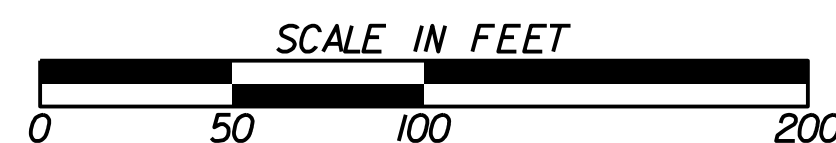

PREPARED BY: \_\_\_\_\_  
DESIGN

DATE	CHIEF ENGINEER
PLANS COMPLETED	--
REVISIONS	

DRAWING No. 01-0001



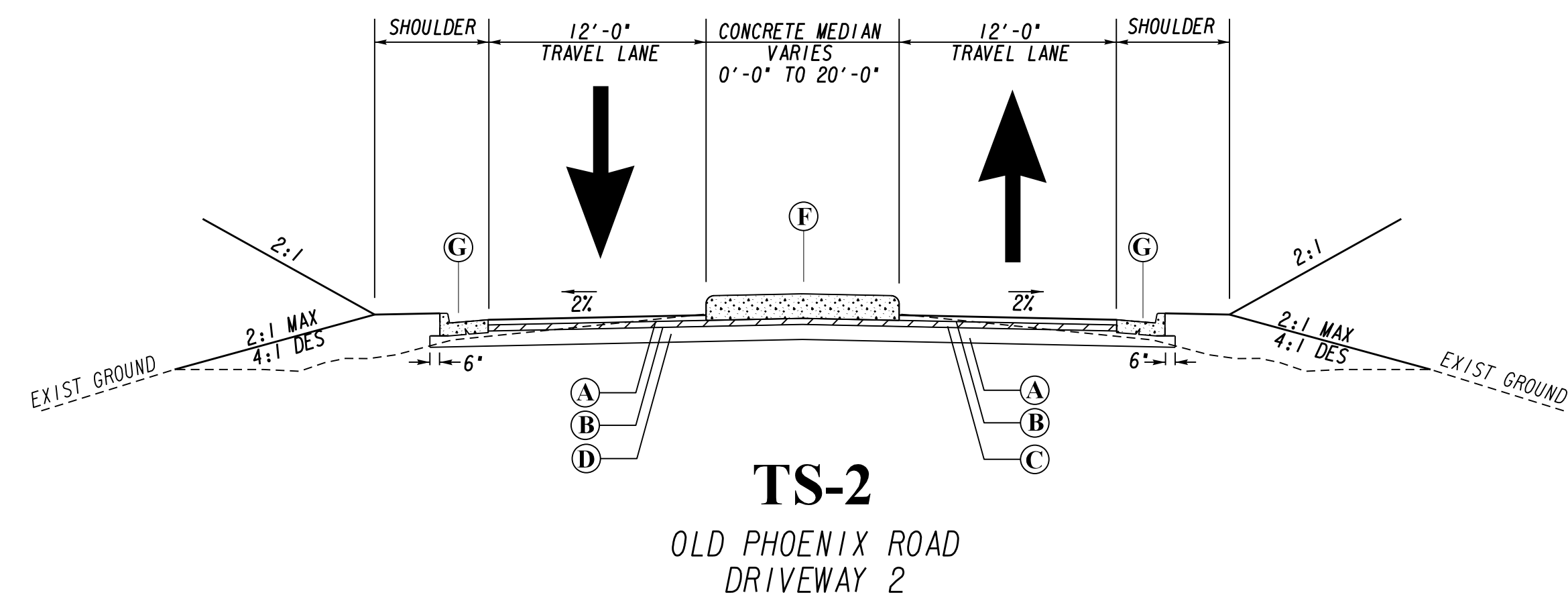
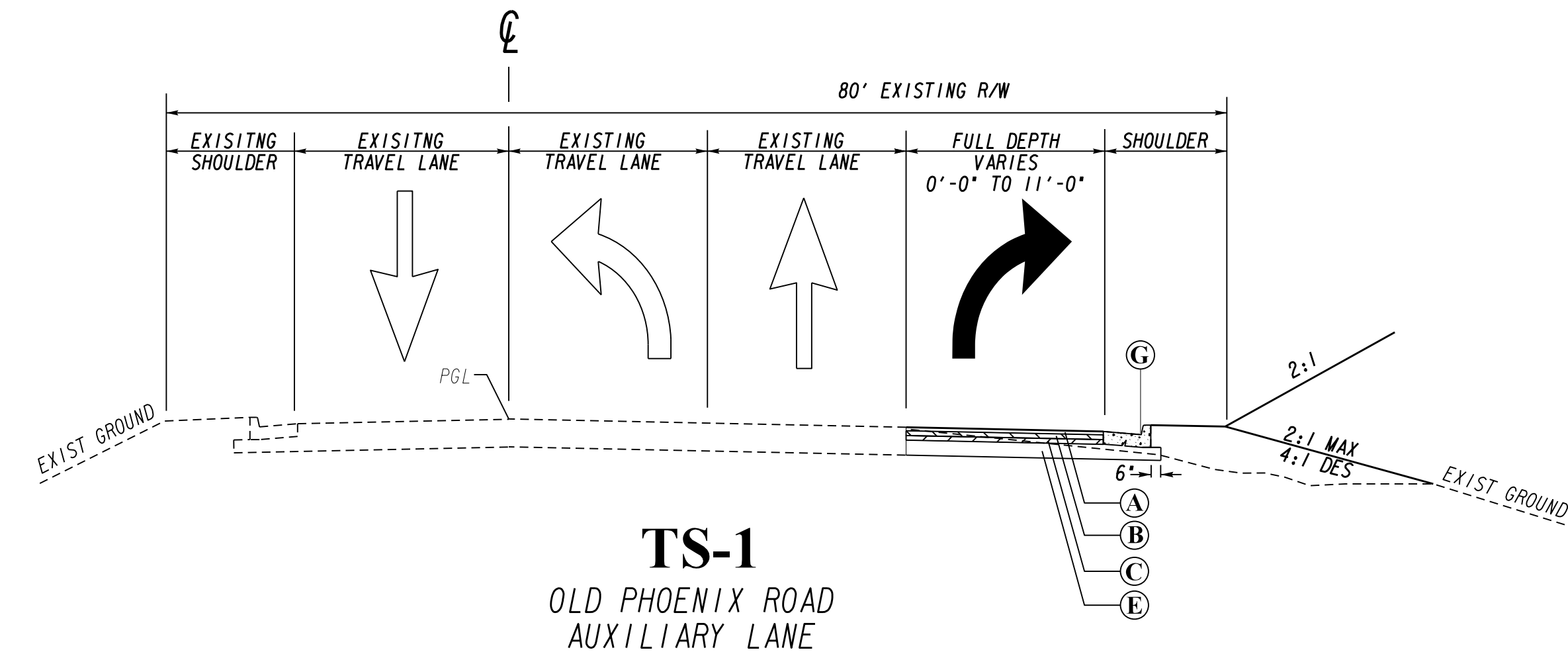

**TYPICAL SECTION LEGEND**

- Ⓐ RECYCLED ASPH CONC 12.5 MM SUPERPAVE, GP 2 ONLY, INCL BITUM MATL & H LIME 165 LBS./SY (402-3130)
- Ⓑ RECYCLED ASPH. CONC. 19 MM SUPERPAVE, GP 1 OR 2, INCL BITUM MATL & H LIME, 220 LBS./SY (402-3190)
- Ⓒ RECYCLED ASPH. CONC. 25 MM SUPERPAVE, GP 1 OR 2, INCL BITUM MATL & H LIME, 440 LBS./SY (402-3121)
- Ⓓ GRADED AGGREGATE BASE COURSE, 6 INCH, INCL MATL (310-5060)
- Ⓔ GRADED AGGREGATE BASE COURSE, 12 INCH, INCL MATL (310-5120)
- Ⓕ CONCRETE MEDIAN, 7½IN (441-0754)
- Ⓖ CONC CURB & GUTTER, 8 IN X 24 IN, TP 2 (441-6216)

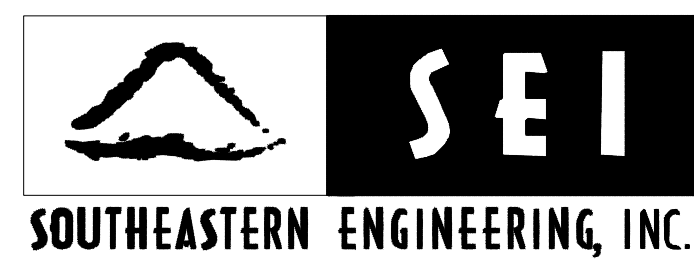

NTS

REVISION DATES	

PUTNAM COUNTY  
BOARD OF COMMISSIONERS  
COLLABORATIVE INFRASTRUCTURES SERVICES  
**TYPICAL SECTIONS**

OLD PHOENIX RD AUXILIARY LANE

DRAWING No.	05-0001
-------------	---------

# DETAILED ESTIMATE

## OLD PHOENIX ROAD AUXILIARY LANE DETAILED ESTIMATE

ITEM NO.	ITEM DESCRIPTION	UNIT	QUANTITY
<b>ROADWAY ITEMS</b>			
150-1000	TRAFFIC CONTROL	LS	LS
210-0100	GRADING COMPLETE	LS	LS
310-5060	GR AGGR BASE CRS, 6 IN, INCL MATL	SY	133
310-5120	GR AGGR BASE CRS, 12 IN, INCL MATL	SY	506
402-3121	RECYCLED ASPH CONC 25 MM SUPERPAVE, GP 1 OR 2, INCL BITUM MATL & H LIME	TN	82
402-3130	RECYCLED ASPH CONC 12.5 MM SUPERPAVE, GP 1 OR 2, INCL BITUM MATL & H LIME	TN	41
402-3190	RECYCLED ASPH CONC 19 MM SUPERPAVE, GP 1 OR 2, INCL BITUM MATL & H LIME	TN	55
413-0750	TACK COAT	GAL	98
441-0018	DRIVEWAY CONCRETE, 8 IN TK	SY	198
441-0754	CONC MEDIAN, 7 1/2 IN	SY	23
441-4030	CONC VALLEY GUTER, 8 IN	SY	35
441-6216	CONC CURB & GUTTER, 8" X 24", TYPE 2	LF	504
446-1100	PVMT REINF FABRIC STRIPS, TP 2, 18 INCH WIDTH	LF	345
500-9999	CLASS B CONCRETE, PVMT WIDENING	CY	15
641-1200	GUARDRAIL, TYPE W	LF	96
641-5001	GUARDRAIL ANCHORAGE, TP 1	EA	2
641-5015A	GUARDRAIL TERMINAL, TP 12A, 31 IN, NON-FLARED, ENERGY-ABSORBING	EA	1
<b>SIGING &amp; MARKING ITEMS</b>			
636-1033	HIGHWAY SIGNS, TP 1 MATL, REFL SHEETING, TP 9	SF	13
636-2070	GALV STEEL POSTS, TP 7	LF	25
653-0120	THERMOPLASTIC PVMT MARKING, ARROW, TP 2	EA	3
653-1501	THERMOPLASTIC SOLID TRAFFIC STRIPE, 5 IN, WHITE	LF	385
653-1704	THERMOPLASTIC SOLID TRAF STRIPE, 24 IN, WHITE	LF	15
653-3501	THERMOPLASTIC SKIP TRAFFIC STRIPE, 5IN, WHITE	GLF	80
<b>SIGNAL ITEMS</b>			
647-2120	PULL BOX, PB-2	EA	1
647-6300	LOOP DETECTOR, 6 FT X 40 FT, QUADRUPOLE	EA	2
682-6233	CONDUIT, NONMETL, TP 3, 2 IN	LF	20
<b>DRAINAGE ITEMS</b>			
550-1150	STORM DRAIN PIPE, 15 IN, H 1-10	LF	8
550-1180	STORM DRAIN PIPE, 18 IN, H 1-10	LF	8
550-1240	STORM DRAIN PIPE, 24 IN, H 1-10	LF	8
611-3000	RECONSTRUCT CATCH BASIN	EA	1
611-3100	RECONSTRUCT JUNCTION BOX	EA	4
611-8040	ADJUST DROP INLET TO GRADE	EA	1
668-1100	CATCH BASIN, GP 1	EA	1
668-2100	DROP INLET, GP 1	EA	2
<b>TEMPORARY EROSION CONTROL ITEMS</b>			
163-0232	TEMPORARY GRASSING	AC	0.20
163-0240	MULCH	TN	1.00
163-0550	CONSTRUCT AND REMOVE INLET SEDIMENT TRAP	EA	10
165-0010	MAINTENANCE OF TEMPORARY SILT FENCE - TYPE A	LF	200
165-0105	MAINTENANCE OF INLET SEDIMENT TRAP	EA	10
171-0010	TEMPORARY SILT FENCE, TYPE A	LF	400
<b>PERMANENT EROSION CONTROL ITEMS</b>			
700-6910	PERMANENT GRASSING	AC	0.20
700-7000	AGRICULTURAL LIME	TN	1.00
700-8000	FERTILIZER MIXED GRADE	TN	1.00
700-8100	FERTILIZER NITROGEN CONTENT	LB	10
700-9300	SOD	SY	500

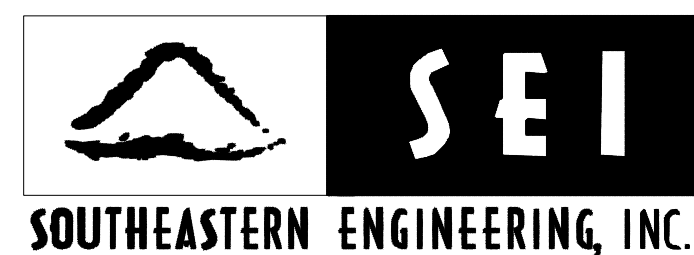

SOUTHEASTERN ENGINEERING, INC.

REVISION DATES

PUTNAM COUNTY  
BOARD OF COMMISSIONERS  
COLLABORATIVE INFRASTRUCTURES SERVICES  
**DETAILED ESTIMATE**

OLD PHOENIX ROAD AUXILIARY LANE

DRAWING No.  
**09-0001**



**DRAINAGE LEGEND**

- A-1 CATCH BASIN, GP 1, GA STD. 1033D
- A-2 RECONSTRUCT CATCH BASIN TO JUNCTION BOX, GA STD. 9031U
- B-1 DROP INLET, GP 1, GA STD 1019A
- B-2 RECONSTRUCT DROP INLET TO JUNCTION BOX, GA STD. 9031U
- B-3 RECONSTRUCT MANHOLE TO JUNCTION BOX, GA STD. 9031U
- B-4 RECONSTRUCT MANHOLE TO JUNCTION BOX, GA STD. 9031U
- B-5 ADJUST DROP INLET TO GRADE
- B-6 DROP INLET, GP 1, GA STD. 1019A
- B-7 REMOVE DROP INLET
- B-8 RECONSTRUCT CATCH BASIN, GA STD. 1034D

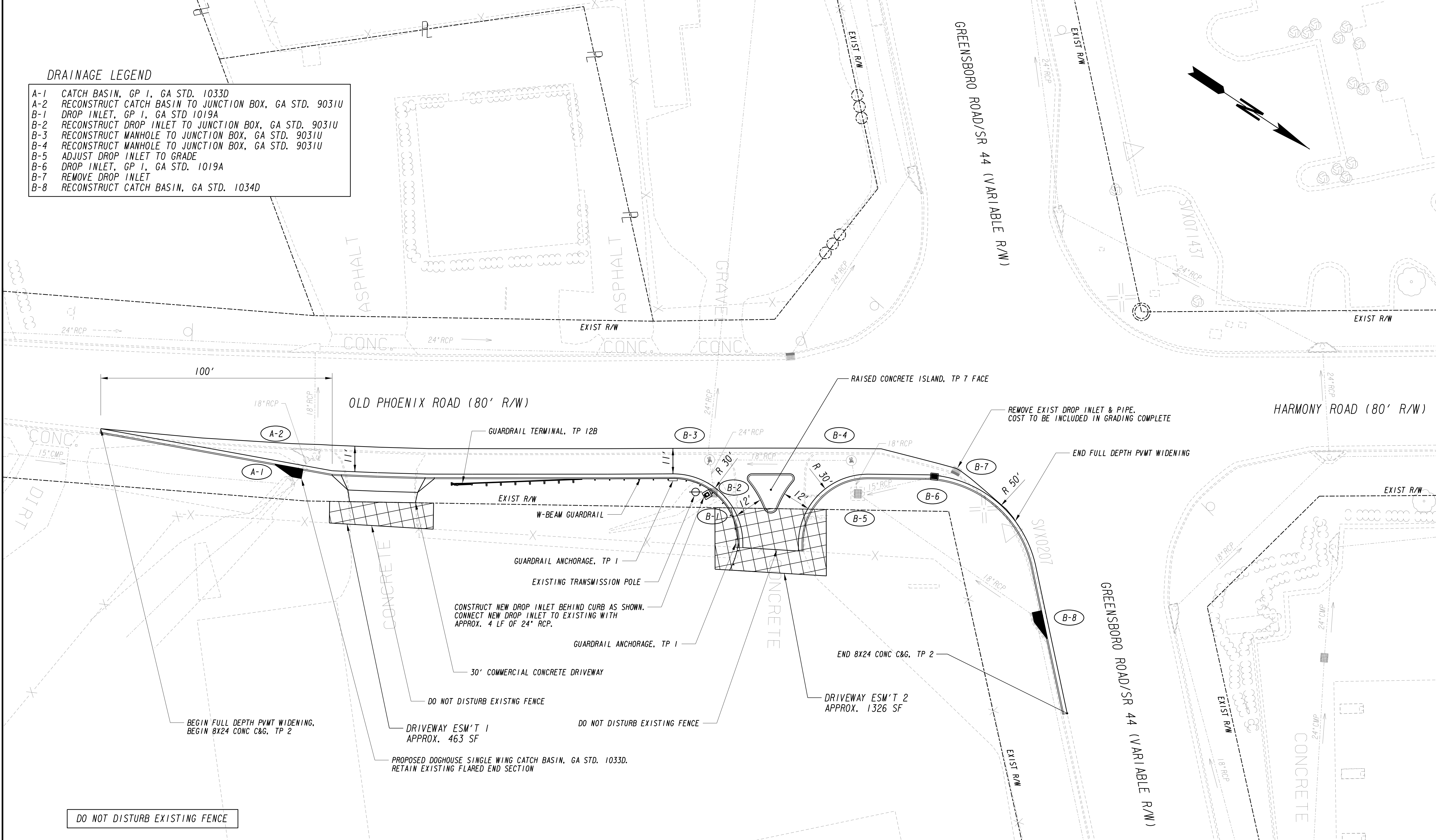

PROPERTY AND EXISTING R/W LINE	---
REQUIRED R/W LINE	---
CONSTRUCTION LIMITS	---
EASEMENT FOR CONSTR & MAINTENANCE OF SLOPES	---
EASEMENT FOR CONSTR OF SLOPES	---
EASEMENT FOR CONSTR OF DRIVES	---

BEGIN LIMIT OF ACCESS.....BLA	---
END LIMIT OF ACCESS.....ELA	---
REQ'D LIMIT OF ACCESS	---
REQ'D LIMIT OF ACCESS & R/W	---
ORANGE BARRIER FENCE	---
ESA - ENV. SENSITIVE AREA (SEE ERIT TABLE)	---

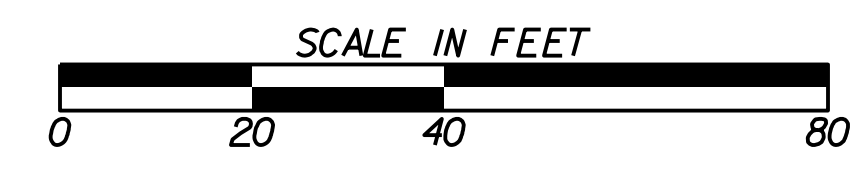
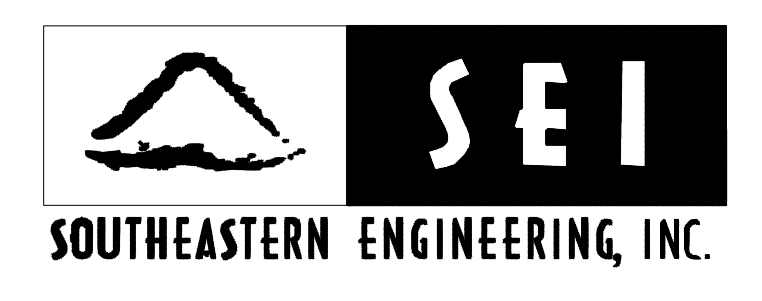

REVISION DATES		

**PUTNAM COUNTY BOARD OF COMMISSIONERS**  
**COLLABORATIVE INFRASTRUCTURES SERVICES**  
**MAINLINE PLAN**  
 OLD PHOENIX ROAD AUXILIARY LANE

DRAWING No. **13-0001**



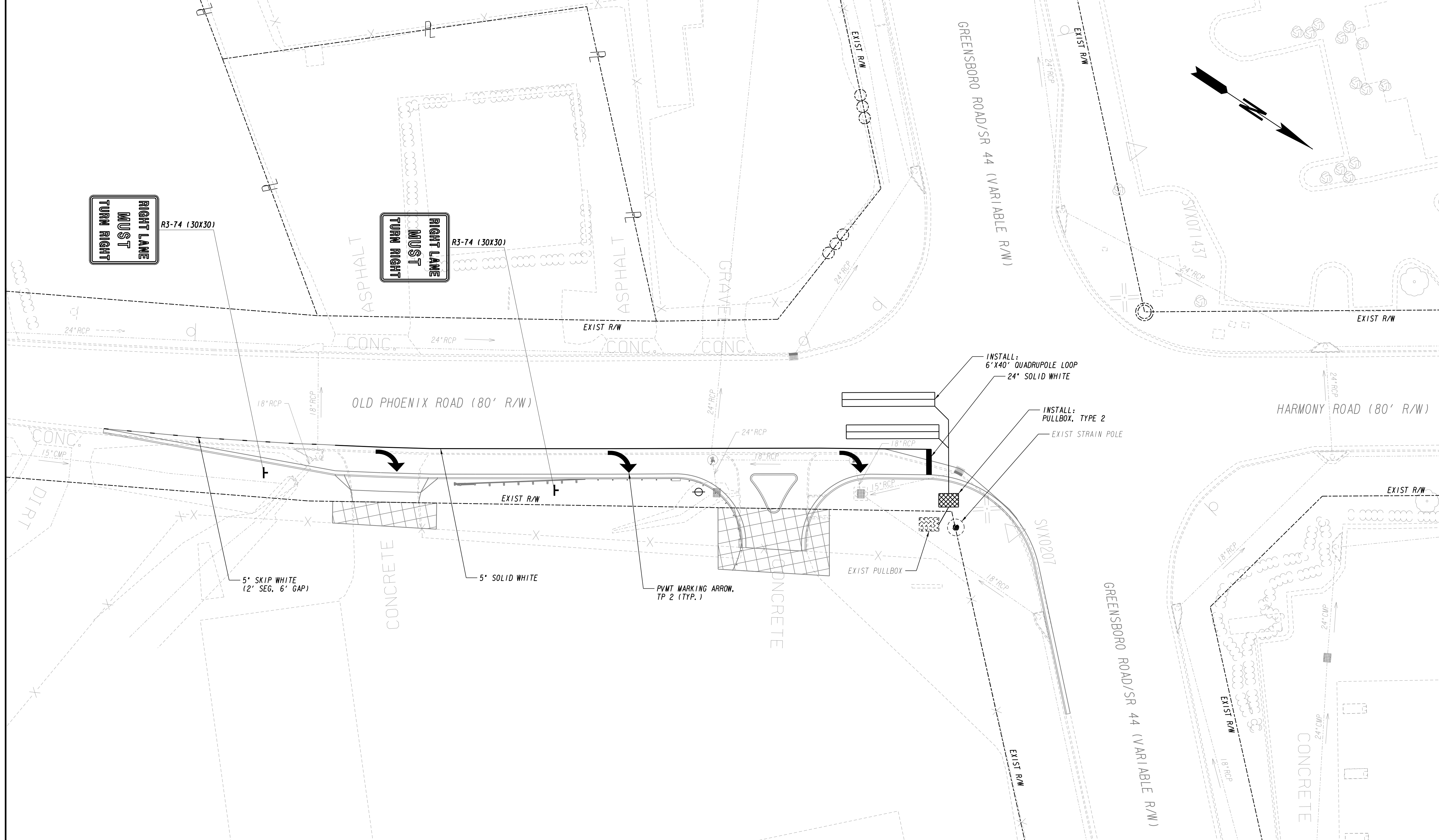

PROPERTY AND EXISTING R/W LINE  
 REQUIRED R/W LINE  
 CONSTRUCTION LIMITS  
 EASEMENT FOR CONSTR  
 & MAINTENANCE OF SLOPES  
 EASEMENT FOR CONSTR OF SLOPES  
 EASEMENT FOR CONSTR OF DRIVES

---@--- BEGIN LIMIT OF ACCESS.....BLA  
 --- END LIMIT OF ACCESS.....ELA  
 ---C---F--- REQ'D LIMIT OF ACCESS  
 ---||--- REQ'D LIMIT OF ACCESS & R/W  
 [Hatched Box] ORANGE BARRIER FENCE  
 [Cross-hatched Box] ESA - ENV. SENSITIVE AREA  
 (SEE ERIT TABLE)

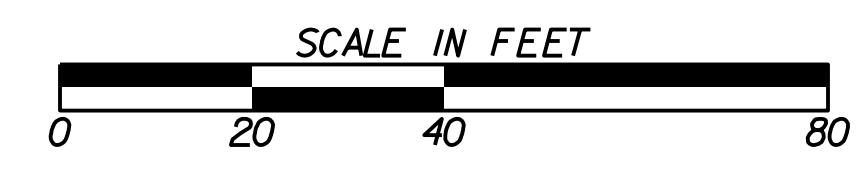
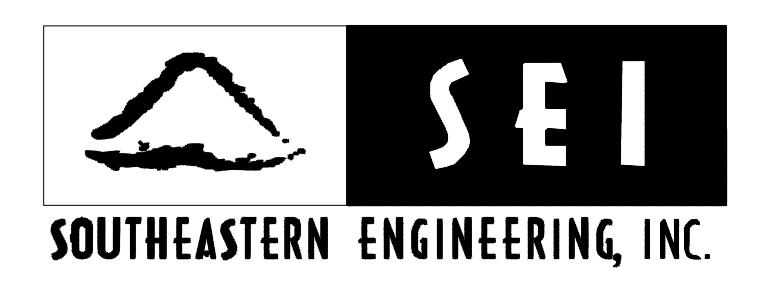

REVISION DATES	

PUTNAM COUNTY  
 BOARD OF COMMISSIONERS  
 COLLABORATIVE INFRASTRUCTURES SERVICES  
**SIGNING AND MARKING PLANS**  
 OLD PHOENIX ROAD AUXILIARY LANE  
 DRAWING No. 26-0001