

**LANEY CHILDCARE
CENTER IMPROVEMENTS – PHASE II**

ADDENDA

BID NO. 20-21/01

Peralta Community College District

**Laney Childcare Center Improvements – Phase II
900 Fallon Street Oakland, CA 94607**

August 13, 2020

ADDENDA No. 2

This addendum supersedes items of the original Bid documents wherein it is inconsistent with it. All other conditions remain unchanged. The following changes, modifications, corrections, additions or clarifications shall apply to the contract documents and shall be made a part of and subject to all of the requirements thereof as if originally specified or shown. It is the responsibility of the bidder to review the list of attachments to ensure that the addendum is full and complete. This Addendum modifies the original Bid Documents for the above project. **Acknowledge receipt of this addendum in the space provided on Acknowledgement and Signature Form. Failure to do so may subject Bidder to disqualification.**

Revisions to Bid documents:

- Peralta Community College District (PCCD) gives a 5% preference for Small Local Business Enterprise (SLBE).

Questions:

1. Does this project require PLA (Project Labor Agreement) or PSA (Project Stabilization Agreement)?

Response: Yes. This is a Public Works project and requires payment of prevailing wage.

2. How much is the engineering estimate and liquidated damage?

Response: \$206,000 and \$500 respectively.

3. May I bid for this project as prime painting contractor or should I bid for a GC as a sub-contractor?

Response: We cannot make decisions for you. The project's scope of work contains more than painting.

4. Is a hazardous material testing report available for this building? a. If so, can you please provide it? b. If not, will awarded contractor be responsible for providing one?

Response: We do not have a Hazardous Material Testing Report for the building. However, we will get a sample of the existing paint tested and make results available prior to start of construction.

5. Will awarded contractor be responsible for electrical design/engineering?

Response: Electrical design/engineering is not required.

6. Note 2 on A1.00 calls for areas of concrete to be ground down where tree roots have caused the concrete to heave. Per A0.10, this area is within the accessible path of travel.

- a. Is the awarded contractor responsible for verifying that all existing concrete pathways meet all slope requirements to meet State and Federal accessibility requirements?

Response: Please refer to attachment

- b. Is awarded contractor responsible for removing and replacing any non-conforming concrete pathways?

Response: Please refer to attachment

- c. For areas where non-conformance is caused by tree roots, what are the requirements for cutting or working around said roots?

Response: Please refer to attachment

END OF DOCUMENT

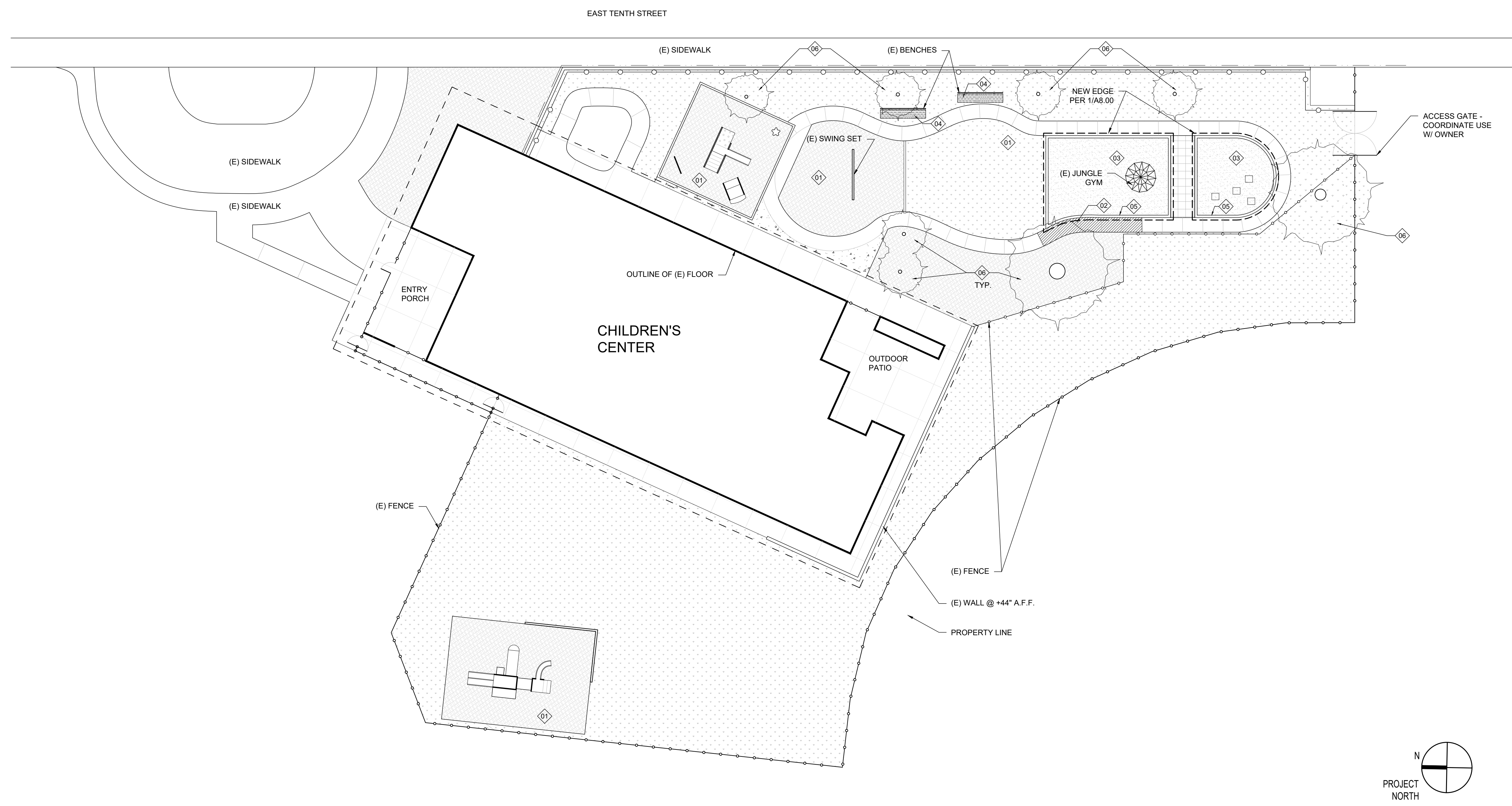

OWNER:
LANEY COLLEGE
 CHILDREN'S CENTER

ARCHITECT:
CA ARCHITECTS
 475 Gate Five Road, Suite 107
 Sausalito, CA 94965
 T 415.331.7655
 F 415.331.7656

PROJECT:
 LANEY COLLEGE
 CHILDREN'S CENTER
 EAST 10TH ST.
 OAKLAND, CA, 94607

CONSULTANT TEAM:

STAMP

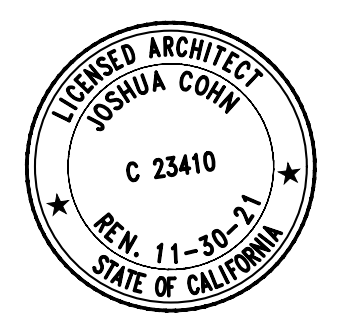

SHEET LEGEND:

ISSUE/REVISION:
 NO: DATE: DESCRIPTION:
 ISSUE FOR PERMIT 12/16/19
 PRE-BID CLARIFICATION 8/13/20

KEY PLAN:

11 SITE PLAN

SCALE: 1/16"=1'-0"

LEGEND	SHEET NOTES	GENERAL NOTES
<p>WOOD CHIPS TO BE ENGINEERED WOOD FILL (EWF)</p> <p>CONCRETE</p> <p>GRASS</p> <p>SAND TO BE PLAYSAND (QUIKRETE #1113 OR APPROVED EQUAL)</p> <p>CONCRETE TO BE GRIND, PATCH AND CASE ALL CONCRETE EDGES THAT EXCEED 1/4" DIFFERENTIAL (MAX.)</p> <p>DASHED OUTLINE OF ROOF OVERHANG</p>	<p>01 REMOVE (E) WOOD CHIPS IN PLAYGROUNDS AND REPLACE W/ EWF. (E) BORDER TO REMAIN</p> <p>02 HATCHED AREA AT CONCRETE WALK: GRIND AND/OR PATCH CONCRETE EDGES THAT EXCEED 1/4" VERTICAL DIFFERENTIAL (MAX.) TO CONFORM TO ACCESSIBLE STANDARDS - DO NOT EXPOSE ANY REINFORCED STEEL</p> <p>03 REMOVE (E) SAND, PREP PER TYP. SECTION DETAIL AND FILL W/ PLAY SAND</p> <p>04 PREP AND SEAL ALL WOOD BENCHES (TYP.) - SEE PAINT SPECIFICATIONS FOR ADDITIONAL REQUIREMENTS</p> <p>05 DEMO (E) WOOD BORDER AND INSTALL NEW CONT. BORDER AS SHOWN (TYP.)</p> <p>06 TRIM AND PRUNE ALL TREES IN ALL YARDS EVEN IF NOT SHOWN IN PLAN (V.I.F.). LANDSCAPE ARBORIST WILL INSPECT AND REMOVE WEAKENED BRANCHES. CERTIFIED ARBORIST SHALL INSPECT AND PROVIDE DIRECTION FOR OVERALL TREE PRUNING AND BRANCH REMOVAL FOR ANY SAFETY CONCERNS (TYP.) - SEE SPECIFICATIONS FOR ADDITIONAL REQUIREMENTS</p> <p>07 SEE A8.00 FOR ADDITIONAL INFORMATION REGARDING ENTRY GATE</p>	

SCALE:
 DATE:
 PROJECT NO:
 PERMIT APPLICATION NO.:

SITE PLAN
A1.00