



Jackson County Board of Commissioners

67 Athens Street
Jefferson, Georgia 30549
Phone: (706) 367-6309
Fax: (706) 708-2505

Email: myarbrough@jacksoncountygov.com

Date: August 12, 2021

To: General Contractors

From: Myrna Yarbrough, Purchasing Manager

RE: Addendum 1 to Jackson County ITB 210015, Renovations and Additions to the Animal Shelter, Jackson County

1. Any inquiries concerning Addendum 1 should be made to Myrna Yarbrough, Purchasing Manager, (706) 367-6309 or via email at myarbrough@jacksoncountygov.com
2. Jackson County reserves the right to reject any and all proposals, to waive any technicalities or irregularities and to award the offer based upon the most responsive, responsible submission.
3. Bidders must acknowledge receipt of addenda, by either signing and attaching this copy, or by writing "Acknowledge Addenda #2" at bottom of the proposal.
4. Attached, please find the list of those who attended the pre-bid conference.
5. Attached, please find updated Civil drawings showing the sand sediment trap location.
6. The generator is part of the Phase II work.
7. Existing rear wall metal panels, exhaust fans, doors, etc. are to remain in place until Phase II. Phase I includes the front addition, roof replacement, and metal panels on the existing front and sides.
8. Metal panels to be Butler VSR II or equal.
9. Downspout collector system to discharge into the drainage ditch at the front of the site between the driveways.
10. Fencing directly behind phase II addition (2 large runs) at rear of building is not to be included in this phase. All fencing on the side (as shown on A-402) is included in Phase I.

11. No lighting, floor coating, or other finish work is to occur in the existing Kennel area (120) or Cat Intake (119).
12. Other Fire providers, equal to that specified, will be acceptable (Honeywell, Fahrenheit, etc.).
13. New windows are to be fixed storefront.
14. Interior stud walls can be 20 gauge studs.
15. Existing textured ceilings are to be covered with ¼" gypsum board, taped, mudded, and painted.
16. All data cabling is to be routed to the Director's Office for the Phase I work.

Renovations & Addition to Animal Shelter, 210015

Pre Bid Meeting: August 3, 2021 at 2:00 PM

Company Name	Representative	Telephone	E Mail
Charles Hill Electrical	Kim Muel	706-757-2536	kmuel@charleshillelectrical.com
Crown Service Contractors	Take Ritzer	404- 504 -5993	jr.ritzer@csconsc.net
SubBELT Builders	Doug MURDAUGH	770-786-3031	ESTIMATE@SUBBELTBUILDERS.COM
C3 Communications	Scott Mandel	678-777-3957	SCOTT.MANDEL@C3COMMUNICATIONS.NET
John W. Spratkin, P.S.C.	John Spratkin	706-353-4635	Jim@spratkinandson.com
DeRales Inc. P.C.	Anthony Valbey	706-790-1445	derales@belkouthand.net
Magnum Contracting	Mike Murcowski	478-505-8606	MURCOWSKI@MAGNUMCONTRACTING.NET
TOMA Construction	Carley Reeves	706-372-8861	Carley@TOMAConstruction.com

Renovations & Addition to Animal Shelter, 210015



Pre Bid Meeting: August 3, 2021 at 2:00 PM

Company Name	Representative	Telephone	E Mail
Keith Hayes Construction	Trey Barnett 25 4038	706-367-9464	Trey@keithhayesconstruction.com
SERRAO PIRROTTA	STAVENSON BOSS O'NEIL	770-241-9448	bob@stavo.com
Hunter Builders B&B	Hunter Bicknell	770-572-5944	hunterbuilders@bicknell.com
Kalyani Construction	MATTHEW SPERA	770-355-0441	MATTHEW@KALYANI.CONSTRUCTION.COM
Presley Inc	John McCarty	770-482-6530	presley@presleyconstruction.com
COTZ HOWARD CONSTRUCTION	Zane Power	478-833-2004	Z.Power@cotzhoward.com

SITE DEVELOPMENT PLANS FOR JACKSON COUNTY ANIMAL CONTROL SHELTER

29 GALILEE CHURCH ROAD
JEFFERSON, GEORGIA 30549

DESIGNED BY:
CIVIL SOLUTIONS, INC.
ENGINEERING - PLANNING
750 BELMONT ROAD
ATHENS, GA 30605
PHONE: 706-255-2443

TOPOGRAPHIC INFORMATION BY:
WOOD BROTHERS LAND SURVEYORS, INC.
P.O. BOX 477
JEFFERSON, GA 30549
PHONE: 706-387-0075

GPS LOCATION OF THE SITE:
34.69576°N
83.57230°W

DISTURBED ACREAGE = 0.96 ACRES

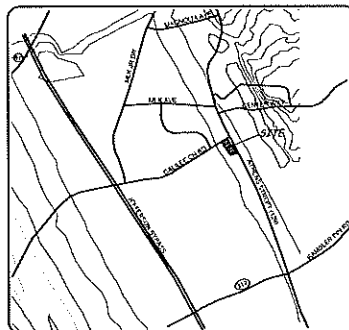

LOCATION MAP
N.T.S.

SHEET INDEX

C1	COVER SHEET
C2	EXISTING CONDITIONS & DEMOLITION PLAN
C3	SITE PLAN
C4	GRADING AND DRAINAGE PLAN
C5	ES&DC PLAN PLAN
C6	EROSION CONTROL DETAILS & NOTES
C7	EROSION CONTROL DETAILS
C8	CONSTRUCTION DETAILS



For more info, visit www.Georgia811.com
Call 1-800-900-6666

CIVIL SOLUTIONS, INC.
 ENGINEERS - PLANNERS
 750 BELMONT ROAD
 ATHENS, GA 30605
 PHONE: 706-255-2443

JAMES A. SCHNEIDER
 JACKSON COUNTY, GEORGIA
 PROFESSIONAL ENGINEER
 LICENSE NO. 10049
 (P) 706-387-0075

 SITE DEVELOPMENT PLANS FOR:
JACKSON COUNTY
ANIMAL CONTROL SHELTER
 JEFFERSON, GEORGIA

 This drawing and any permitted reproduction, in whole or in part, are not to be used for any project or purpose without the written consent of the author. © 2021
 GMD COUNTY CITY
 243 JACKSON JEFFERSON

REVISION	DATE	BAR
ADD SEWER SERVICE LINE AND DOWNSLOPE COLLECTORS	5-18-21	03/18/21
		SHEET
		C1



*NOTE: EXISTING UNDERGROUND UTILITIES LOCATIONS AS SHOWN SHOULD BE CONSIDERED APPROXIMATE AND MAY NOT BE COMPLETE. UNDERGROUND UTILITIES AS SHOWN ARE BASED ON INFORMATION PROVIDED BY UTILITY OWNERS. THE CONTRACTOR SHALL FIELD VERIFY ALL UTILITY LOCATIONS PRIOR TO ANY CONSTRUCTION. ANY DAMAGE TO SUCH UTILITIES SHALL BE REPAIRED AT THE CONTRACTOR'S EXPENSE.

2.346 ACRES

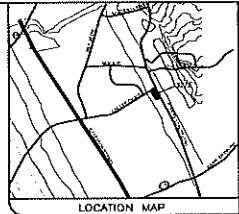
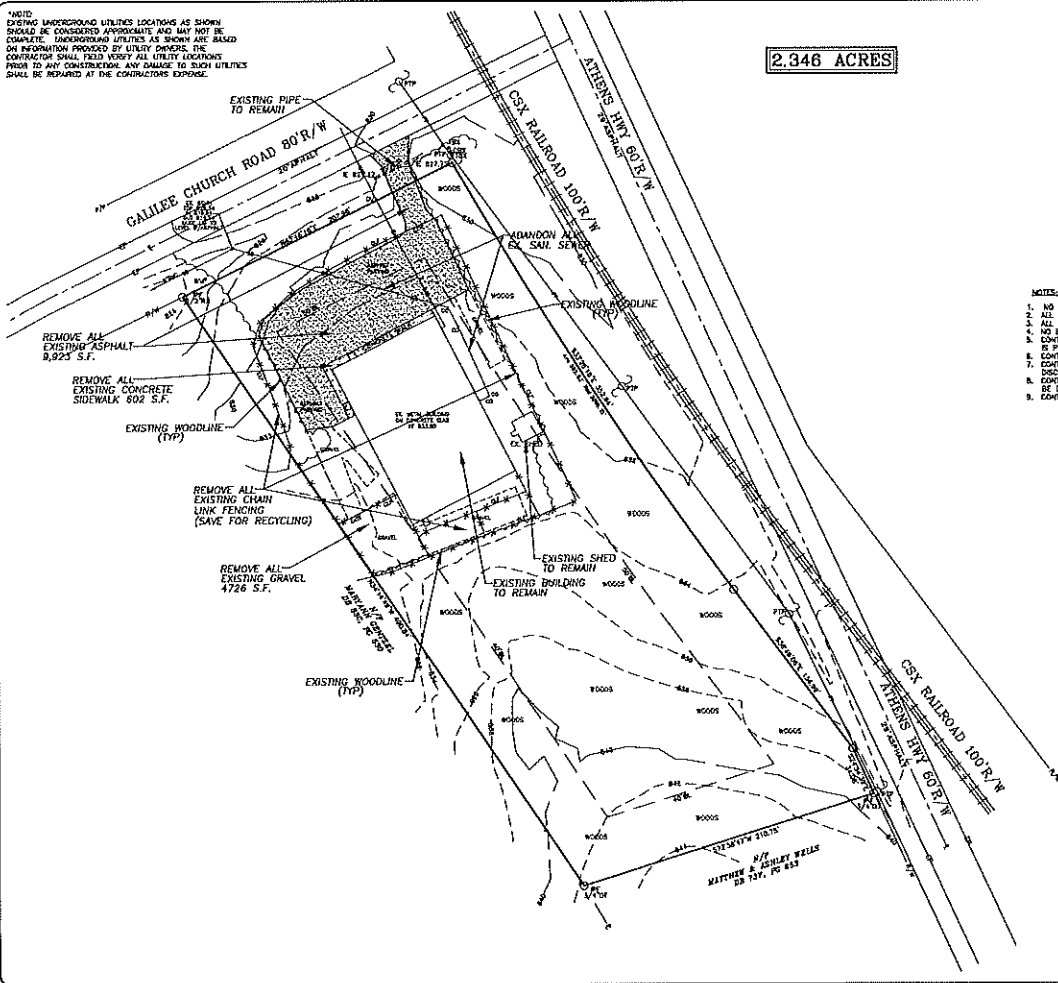

NOTES:

1. NO ON-SITE DISPOSAL AND NO MATERIAL TO BE BURIED ON-SITE.
2. ALL DEMO MATERIAL TO BE HAULLED OFF.
3. ALL DEMO MATERIAL TO BE DISPOSED IN A CERTIFIED LANDFILL.
4. NO BURNING ON-SITE WITHOUT A PERMIT.
5. CONTRACTOR RESPONSIBLE FOR MAKING SURE ALL DEMO MATERIAL IS PROPERLY DISPOSED OF.
6. CONTRACTOR RESPONSIBLE FOR ANY REQUIRED PERMITS.
7. CONTRACTOR RESPONSIBLE FOR CONTACTING ALL UTILITIES FOR DISCONNECT.
8. CONTRACTOR TO NOTIFY LOCAL LAW ENFORCEMENT ANY WORK IS TO BE DONE WITHIN THE DOT RIGHT-OF-WAY.
9. CONTRACTOR RESPONSIBLE FOR ALL TRAFFIC CONTROL.



Utility Protection Center, Inc.
www.georgia811.com
Call before you dig 800-452-8373

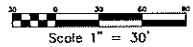

REVISIONS	DATE

CIVIL SOLUTIONS, INC.
ENGINEERS - PLANNERS

CHAS. A. SHELLEY
JACKSON COUNTY, GEORGIA
REGISTERED PROFESSIONAL ENGINEER
JEFFERSON, GA 30549
F00838-6072

EXISTING CONDITIONS & DEMOLITION PLAN FOR JACKSON COUNTY ANIMAL CONTROL SHELTER
JEFFERSON, GEORGIA

This drawing and any permitted reproduction, in whole or in part, may not be removed, altered, or changed in any way without the written consent of the owner.

DWG	COUNTY	CITY
243	JACKSON	JEFFERSON

DATE: 03/16/21
SHEET: C2

NOTES:
EXISTING UNDERGROUND UTILITIES LOCATIONS AS SHOWN SHOULD BE CONSIDERED APPROXIMATE AND MAY NOT BE COMPLETE. UNDERGROUND UTILITIES AS SHOWN ARE BASED ON INFORMATION PROVIDED BY UTILITY OWNERS. THE CONTRACTOR SHALL FIELD VERIFY ALL UTILITY LOCATIONS PRIOR TO ANY CONSTRUCTION. ANY DAMAGE TO SUCH UTILITIES SHALL BE REPAIRED AT THE CONTRACTOR'S EXPENSE.

2.346 ACRES

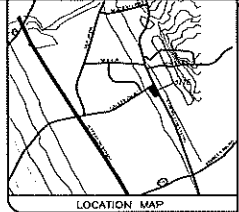

CIVIL SOLUTIONS, INC.
ENGINEERS - PLANNERS
1000 W. BROADWAY
ATLANTA, GA 30334
(404) 525-1100

JACKSON COUNTY, GEORGIA
1000 W. BROADWAY
ATLANTA, GA 30334
(404) 525-1100

SITE PLAN FOR
JACKSON COUNTY
ANIMAL CONTROL SHELTER
JEFFERSON, GEORGIA

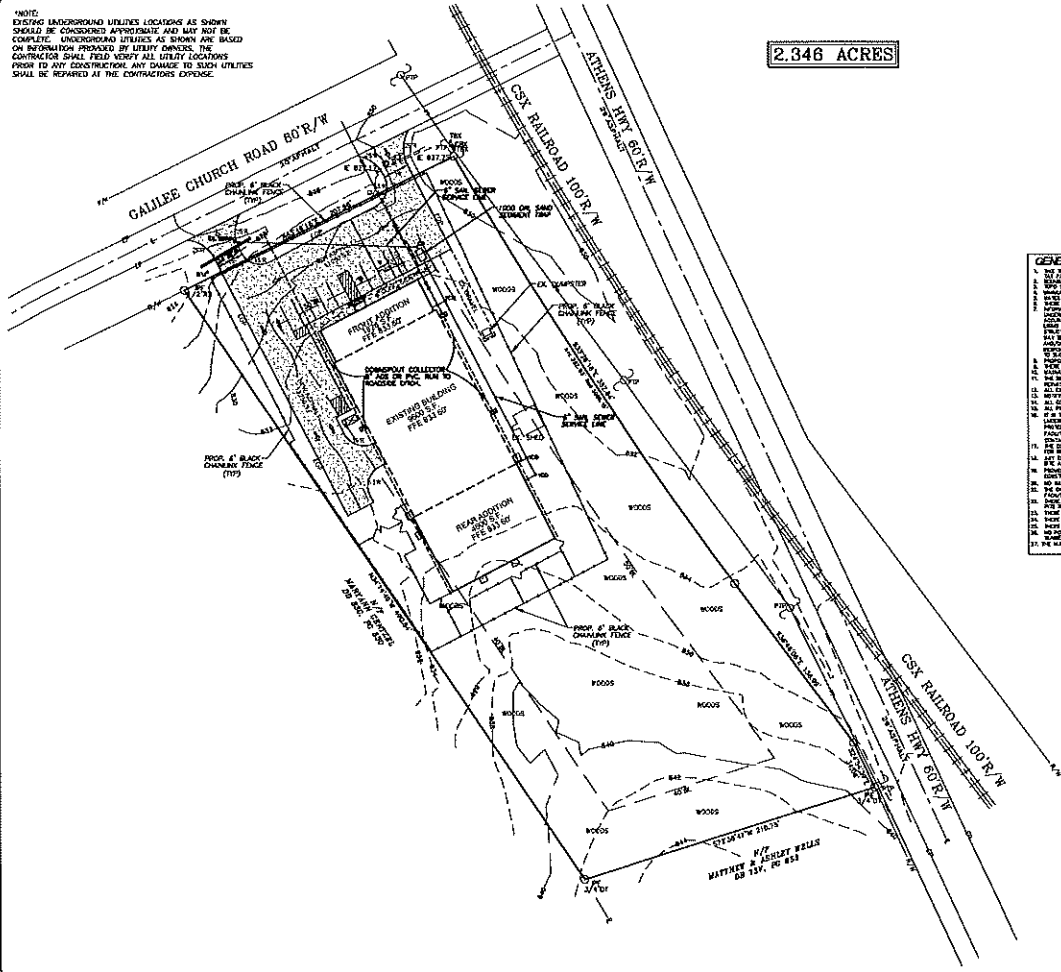

- GENERAL NOTES:**
1. THE TOTAL AREA IS 2.346 ACRES.
 2. THE TOTAL AREA IS 2.346 ACRES.
 3. THE TOTAL AREA IS 2.346 ACRES.
 4. THE TOTAL AREA IS 2.346 ACRES.
 5. THE TOTAL AREA IS 2.346 ACRES.
 6. THE TOTAL AREA IS 2.346 ACRES.
 7. THE TOTAL AREA IS 2.346 ACRES.
 8. THE TOTAL AREA IS 2.346 ACRES.
 9. THE TOTAL AREA IS 2.346 ACRES.
 10. THE TOTAL AREA IS 2.346 ACRES.
 11. THE TOTAL AREA IS 2.346 ACRES.
 12. THE TOTAL AREA IS 2.346 ACRES.
 13. THE TOTAL AREA IS 2.346 ACRES.
 14. THE TOTAL AREA IS 2.346 ACRES.
 15. THE TOTAL AREA IS 2.346 ACRES.
 16. THE TOTAL AREA IS 2.346 ACRES.
 17. THE TOTAL AREA IS 2.346 ACRES.
 18. THE TOTAL AREA IS 2.346 ACRES.
 19. THE TOTAL AREA IS 2.346 ACRES.
 20. THE TOTAL AREA IS 2.346 ACRES.
 21. THE TOTAL AREA IS 2.346 ACRES.
 22. THE TOTAL AREA IS 2.346 ACRES.
 23. THE TOTAL AREA IS 2.346 ACRES.
 24. THE TOTAL AREA IS 2.346 ACRES.
 25. THE TOTAL AREA IS 2.346 ACRES.
 26. THE TOTAL AREA IS 2.346 ACRES.
 27. THE TOTAL AREA IS 2.346 ACRES.
 28. THE TOTAL AREA IS 2.346 ACRES.
 29. THE TOTAL AREA IS 2.346 ACRES.
 30. THE TOTAL AREA IS 2.346 ACRES.
 31. THE TOTAL AREA IS 2.346 ACRES.
 32. THE TOTAL AREA IS 2.346 ACRES.
 33. THE TOTAL AREA IS 2.346 ACRES.
 34. THE TOTAL AREA IS 2.346 ACRES.
 35. THE TOTAL AREA IS 2.346 ACRES.
 36. THE TOTAL AREA IS 2.346 ACRES.
 37. THE TOTAL AREA IS 2.346 ACRES.
 38. THE TOTAL AREA IS 2.346 ACRES.
 39. THE TOTAL AREA IS 2.346 ACRES.
 40. THE TOTAL AREA IS 2.346 ACRES.
 41. THE TOTAL AREA IS 2.346 ACRES.
 42. THE TOTAL AREA IS 2.346 ACRES.
 43. THE TOTAL AREA IS 2.346 ACRES.
 44. THE TOTAL AREA IS 2.346 ACRES.
 45. THE TOTAL AREA IS 2.346 ACRES.
 46. THE TOTAL AREA IS 2.346 ACRES.
 47. THE TOTAL AREA IS 2.346 ACRES.
 48. THE TOTAL AREA IS 2.346 ACRES.
 49. THE TOTAL AREA IS 2.346 ACRES.
 50. THE TOTAL AREA IS 2.346 ACRES.
 51. THE TOTAL AREA IS 2.346 ACRES.
 52. THE TOTAL AREA IS 2.346 ACRES.
 53. THE TOTAL AREA IS 2.346 ACRES.
 54. THE TOTAL AREA IS 2.346 ACRES.
 55. THE TOTAL AREA IS 2.346 ACRES.
 56. THE TOTAL AREA IS 2.346 ACRES.
 57. THE TOTAL AREA IS 2.346 ACRES.
 58. THE TOTAL AREA IS 2.346 ACRES.
 59. THE TOTAL AREA IS 2.346 ACRES.
 60. THE TOTAL AREA IS 2.346 ACRES.
 61. THE TOTAL AREA IS 2.346 ACRES.
 62. THE TOTAL AREA IS 2.346 ACRES.
 63. THE TOTAL AREA IS 2.346 ACRES.
 64. THE TOTAL AREA IS 2.346 ACRES.
 65. THE TOTAL AREA IS 2.346 ACRES.
 66. THE TOTAL AREA IS 2.346 ACRES.
 67. THE TOTAL AREA IS 2.346 ACRES.
 68. THE TOTAL AREA IS 2.346 ACRES.
 69. THE TOTAL AREA IS 2.346 ACRES.
 70. THE TOTAL AREA IS 2.346 ACRES.
 71. THE TOTAL AREA IS 2.346 ACRES.
 72. THE TOTAL AREA IS 2.346 ACRES.
 73. THE TOTAL AREA IS 2.346 ACRES.
 74. THE TOTAL AREA IS 2.346 ACRES.
 75. THE TOTAL AREA IS 2.346 ACRES.
 76. THE TOTAL AREA IS 2.346 ACRES.
 77. THE TOTAL AREA IS 2.346 ACRES.
 78. THE TOTAL AREA IS 2.346 ACRES.
 79. THE TOTAL AREA IS 2.346 ACRES.
 80. THE TOTAL AREA IS 2.346 ACRES.
 81. THE TOTAL AREA IS 2.346 ACRES.
 82. THE TOTAL AREA IS 2.346 ACRES.
 83. THE TOTAL AREA IS 2.346 ACRES.
 84. THE TOTAL AREA IS 2.346 ACRES.
 85. THE TOTAL AREA IS 2.346 ACRES.
 86. THE TOTAL AREA IS 2.346 ACRES.
 87. THE TOTAL AREA IS 2.346 ACRES.
 88. THE TOTAL AREA IS 2.346 ACRES.
 89. THE TOTAL AREA IS 2.346 ACRES.
 90. THE TOTAL AREA IS 2.346 ACRES.
 91. THE TOTAL AREA IS 2.346 ACRES.
 92. THE TOTAL AREA IS 2.346 ACRES.
 93. THE TOTAL AREA IS 2.346 ACRES.
 94. THE TOTAL AREA IS 2.346 ACRES.
 95. THE TOTAL AREA IS 2.346 ACRES.
 96. THE TOTAL AREA IS 2.346 ACRES.
 97. THE TOTAL AREA IS 2.346 ACRES.
 98. THE TOTAL AREA IS 2.346 ACRES.
 99. THE TOTAL AREA IS 2.346 ACRES.
 100. THE TOTAL AREA IS 2.346 ACRES.

NO.	REVISIONS	DATE

CD	245	JACKSON	JEFFERSON
----	-----	---------	-----------

DATE: 03/18/21
SHEET: C3



UTMS 8 COORDINATE SYSTEM

NOTE: EXISTING UNDERGROUND UTILITIES LOCATIONS AS SHOWN SHOULD BE CONSIDERED APPROXIMATE AND MAY NOT BE COMPLETE. UNDERGROUND UTILITIES AS SHOWN ARE BASED ON INFORMATION PROVIDED BY UTILITY OWNERS. THE CONTRACTOR SHALL FIELD VERIFY ALL UTILITY LOCATIONS PRIOR TO ANY CONSTRUCTION, AND DAMAGE TO SUCH UTILITIES SHALL BE REPAIRED AT THE CONTRACTOR'S EXPENSE.

EXISTING UNDERGROUND UTILITIES
 ALL EXISTING UTILITIES SHOWN ON THIS PLAN ARE BASED ON INFORMATION PROVIDED BY UTILITY OWNERS. THE CONTRACTOR SHALL FIELD VERIFY ALL UTILITY LOCATIONS PRIOR TO ANY CONSTRUCTION, AND DAMAGE TO SUCH UTILITIES SHALL BE REPAIRED AT THE CONTRACTOR'S EXPENSE.

- GENERAL NOTES:**
1. FOR SLOPES 2:1 OR STEEPER, EXPOSED SOIL SHOULD BE PROTECTED AGAINST EROSION BY MEANS OF A PROTECTIVE COVER OR OTHER MEASURES AS APPROVED BY THE ENGINEER.
 2. ALL EXISTING UTILITIES SHOWN ON THIS PLAN ARE BASED ON INFORMATION PROVIDED BY UTILITY OWNERS. THE CONTRACTOR SHALL FIELD VERIFY ALL UTILITY LOCATIONS PRIOR TO ANY CONSTRUCTION, AND DAMAGE TO SUCH UTILITIES SHALL BE REPAIRED AT THE CONTRACTOR'S EXPENSE.
 3. ALL EXISTING UTILITIES SHOWN ON THIS PLAN ARE BASED ON INFORMATION PROVIDED BY UTILITY OWNERS. THE CONTRACTOR SHALL FIELD VERIFY ALL UTILITY LOCATIONS PRIOR TO ANY CONSTRUCTION, AND DAMAGE TO SUCH UTILITIES SHALL BE REPAIRED AT THE CONTRACTOR'S EXPENSE.
 4. ALL EXISTING UTILITIES SHOWN ON THIS PLAN ARE BASED ON INFORMATION PROVIDED BY UTILITY OWNERS. THE CONTRACTOR SHALL FIELD VERIFY ALL UTILITY LOCATIONS PRIOR TO ANY CONSTRUCTION, AND DAMAGE TO SUCH UTILITIES SHALL BE REPAIRED AT THE CONTRACTOR'S EXPENSE.
 5. ALL EXISTING UTILITIES SHOWN ON THIS PLAN ARE BASED ON INFORMATION PROVIDED BY UTILITY OWNERS. THE CONTRACTOR SHALL FIELD VERIFY ALL UTILITY LOCATIONS PRIOR TO ANY CONSTRUCTION, AND DAMAGE TO SUCH UTILITIES SHALL BE REPAIRED AT THE CONTRACTOR'S EXPENSE.
 6. ALL EXISTING UTILITIES SHOWN ON THIS PLAN ARE BASED ON INFORMATION PROVIDED BY UTILITY OWNERS. THE CONTRACTOR SHALL FIELD VERIFY ALL UTILITY LOCATIONS PRIOR TO ANY CONSTRUCTION, AND DAMAGE TO SUCH UTILITIES SHALL BE REPAIRED AT THE CONTRACTOR'S EXPENSE.
 7. ALL EXISTING UTILITIES SHOWN ON THIS PLAN ARE BASED ON INFORMATION PROVIDED BY UTILITY OWNERS. THE CONTRACTOR SHALL FIELD VERIFY ALL UTILITY LOCATIONS PRIOR TO ANY CONSTRUCTION, AND DAMAGE TO SUCH UTILITIES SHALL BE REPAIRED AT THE CONTRACTOR'S EXPENSE.
 8. ALL EXISTING UTILITIES SHOWN ON THIS PLAN ARE BASED ON INFORMATION PROVIDED BY UTILITY OWNERS. THE CONTRACTOR SHALL FIELD VERIFY ALL UTILITY LOCATIONS PRIOR TO ANY CONSTRUCTION, AND DAMAGE TO SUCH UTILITIES SHALL BE REPAIRED AT THE CONTRACTOR'S EXPENSE.
 9. ALL EXISTING UTILITIES SHOWN ON THIS PLAN ARE BASED ON INFORMATION PROVIDED BY UTILITY OWNERS. THE CONTRACTOR SHALL FIELD VERIFY ALL UTILITY LOCATIONS PRIOR TO ANY CONSTRUCTION, AND DAMAGE TO SUCH UTILITIES SHALL BE REPAIRED AT THE CONTRACTOR'S EXPENSE.
 10. ALL EXISTING UTILITIES SHOWN ON THIS PLAN ARE BASED ON INFORMATION PROVIDED BY UTILITY OWNERS. THE CONTRACTOR SHALL FIELD VERIFY ALL UTILITY LOCATIONS PRIOR TO ANY CONSTRUCTION, AND DAMAGE TO SUCH UTILITIES SHALL BE REPAIRED AT THE CONTRACTOR'S EXPENSE.
 11. ALL EXISTING UTILITIES SHOWN ON THIS PLAN ARE BASED ON INFORMATION PROVIDED BY UTILITY OWNERS. THE CONTRACTOR SHALL FIELD VERIFY ALL UTILITY LOCATIONS PRIOR TO ANY CONSTRUCTION, AND DAMAGE TO SUCH UTILITIES SHALL BE REPAIRED AT THE CONTRACTOR'S EXPENSE.
 12. ALL EXISTING UTILITIES SHOWN ON THIS PLAN ARE BASED ON INFORMATION PROVIDED BY UTILITY OWNERS. THE CONTRACTOR SHALL FIELD VERIFY ALL UTILITY LOCATIONS PRIOR TO ANY CONSTRUCTION, AND DAMAGE TO SUCH UTILITIES SHALL BE REPAIRED AT THE CONTRACTOR'S EXPENSE.
 13. ALL EXISTING UTILITIES SHOWN ON THIS PLAN ARE BASED ON INFORMATION PROVIDED BY UTILITY OWNERS. THE CONTRACTOR SHALL FIELD VERIFY ALL UTILITY LOCATIONS PRIOR TO ANY CONSTRUCTION, AND DAMAGE TO SUCH UTILITIES SHALL BE REPAIRED AT THE CONTRACTOR'S EXPENSE.
 14. ALL EXISTING UTILITIES SHOWN ON THIS PLAN ARE BASED ON INFORMATION PROVIDED BY UTILITY OWNERS. THE CONTRACTOR SHALL FIELD VERIFY ALL UTILITY LOCATIONS PRIOR TO ANY CONSTRUCTION, AND DAMAGE TO SUCH UTILITIES SHALL BE REPAIRED AT THE CONTRACTOR'S EXPENSE.
 15. ALL EXISTING UTILITIES SHOWN ON THIS PLAN ARE BASED ON INFORMATION PROVIDED BY UTILITY OWNERS. THE CONTRACTOR SHALL FIELD VERIFY ALL UTILITY LOCATIONS PRIOR TO ANY CONSTRUCTION, AND DAMAGE TO SUCH UTILITIES SHALL BE REPAIRED AT THE CONTRACTOR'S EXPENSE.
 16. ALL EXISTING UTILITIES SHOWN ON THIS PLAN ARE BASED ON INFORMATION PROVIDED BY UTILITY OWNERS. THE CONTRACTOR SHALL FIELD VERIFY ALL UTILITY LOCATIONS PRIOR TO ANY CONSTRUCTION, AND DAMAGE TO SUCH UTILITIES SHALL BE REPAIRED AT THE CONTRACTOR'S EXPENSE.
 17. ALL EXISTING UTILITIES SHOWN ON THIS PLAN ARE BASED ON INFORMATION PROVIDED BY UTILITY OWNERS. THE CONTRACTOR SHALL FIELD VERIFY ALL UTILITY LOCATIONS PRIOR TO ANY CONSTRUCTION, AND DAMAGE TO SUCH UTILITIES SHALL BE REPAIRED AT THE CONTRACTOR'S EXPENSE.
 18. ALL EXISTING UTILITIES SHOWN ON THIS PLAN ARE BASED ON INFORMATION PROVIDED BY UTILITY OWNERS. THE CONTRACTOR SHALL FIELD VERIFY ALL UTILITY LOCATIONS PRIOR TO ANY CONSTRUCTION, AND DAMAGE TO SUCH UTILITIES SHALL BE REPAIRED AT THE CONTRACTOR'S EXPENSE.
 19. ALL EXISTING UTILITIES SHOWN ON THIS PLAN ARE BASED ON INFORMATION PROVIDED BY UTILITY OWNERS. THE CONTRACTOR SHALL FIELD VERIFY ALL UTILITY LOCATIONS PRIOR TO ANY CONSTRUCTION, AND DAMAGE TO SUCH UTILITIES SHALL BE REPAIRED AT THE CONTRACTOR'S EXPENSE.
 20. ALL EXISTING UTILITIES SHOWN ON THIS PLAN ARE BASED ON INFORMATION PROVIDED BY UTILITY OWNERS. THE CONTRACTOR SHALL FIELD VERIFY ALL UTILITY LOCATIONS PRIOR TO ANY CONSTRUCTION, AND DAMAGE TO SUCH UTILITIES SHALL BE REPAIRED AT THE CONTRACTOR'S EXPENSE.

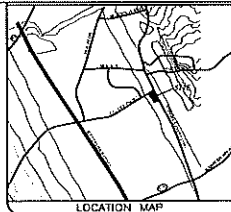

CIVIL SOLUTIONS, INC.
 ENGINEERS - PLANNERS
 2714 N. W. 10TH AVENUE
 SUITE 100
 JACKSONVILLE, FLORIDA 32217
 PHONE: 904.744.1111
 FAX: 904.744.1112

NOTE: LIGHTS OF DUTY SHALL BE 4.00 AC.
 NOTE: SEASONS SHALL BE 6.00 IN ACCORDANCE WITH THE SEASON AND GRADE DRIVE ON THE APPROVED GRADING PLAN.
 NOTE: EXISTING UNDERGROUND UTILITIES SHOWN SHALL BE FIELD VERIFIED BY THE CONTRACTOR PRIOR TO ANY CONSTRUCTION.
 NOTE: THERE IS NO FIRM PLACE FOR THE FIRM PANEL NUMBER INDICATED, DATED SEPTEMBER 17, 2019.

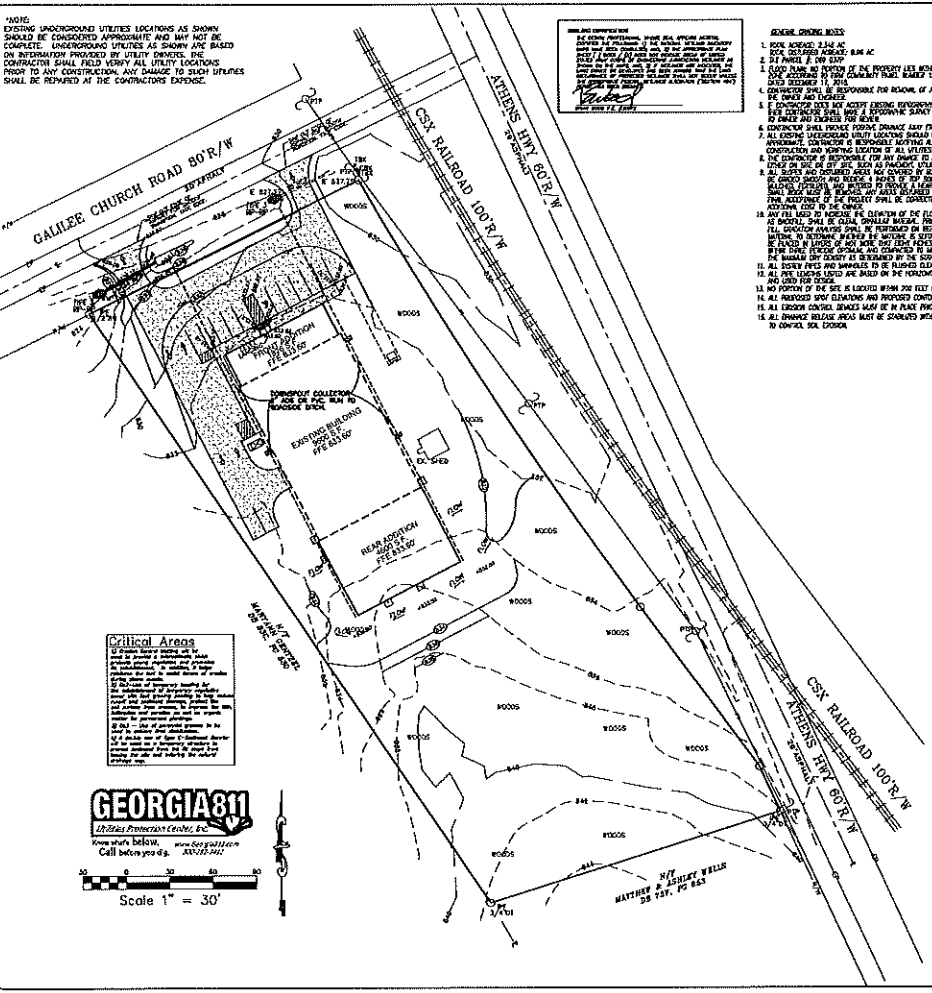

Critical Areas
 The following areas are identified as critical areas on this plan. The contractor shall take appropriate measures to protect these areas during construction. Critical areas include wetlands, floodplains, and environmentally sensitive areas.

GEORGIA811
 1-800-4-A-FLORIDA
 www.georgia811.com
 Call before you dig.
 800-4-A-FLORIDA

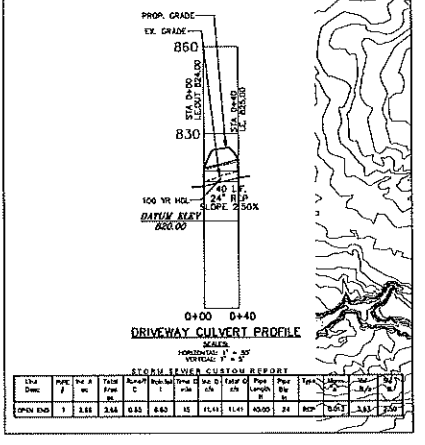
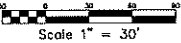

STORM SEWER CUSTOM REPORT

Sta	Pipe	Mat	Total	Recept	Time of	Rate of	Flow	Per	Flow	Per	Flow	Per
Open End	1	24	24	0.00	15	1.00	1.00	1.00	1.00	1.00	1.00	1.00
1	24	24	0.00	0.00	15	1.00	1.00	1.00	1.00	1.00	1.00	1.00



REVISIONS	DATE

GRADING AND DRAINAGE PLAN FOR:
JACKSON COUNTY
ANIMAL CONTROL SHELTER
 JACKSON, GEORGIA

DATE: 03/18/21
 SHEET: C4

5
SHEET

03/19/21
DATE

240
COUNT

JACKSON
COUNTY

JACKSON COUNTY
ANIMAL CONTROL SHELTER
JEFFERSON, GEORGIA

ES&PC PLAN FOR
JACKSON COUNTY
ANIMAL CONTROL SHELTER
JEFFERSON, GEORGIA

JACKSON COUNTY, GEORGIA
JEFFERSON, GA. 30549
PROJECT NO. 240

CIVIL SOLUTIONS, INC.
ANIMATED MODEL
ENGINEERS - PLANNERS
4000 PINEBROOK
CUMMINGS, GA. 30629

UNIFORM CODING SYSTEM
FOR SOIL EROSION AND SEDIMENT CONTROL PRACTICES
GEORGIA SOIL AND WATER CONSERVATION COMMISSION

VEGETATIVE PRACTICES

Symbol	Practice Name	Notes
(Symbol)	Grass	...
(Symbol)	Legume	...
(Symbol)	Woody	...
(Symbol)

STRUCTURAL PRACTICES

Symbol	Practice Name	Notes
(Symbol)
(Symbol)
(Symbol)

CRITICAL AREAS

...

GEORGIA 811
Call before you dig
1-800-4-A-DAWG

Scale 1" = 30'

CRITICAL AREAS

...

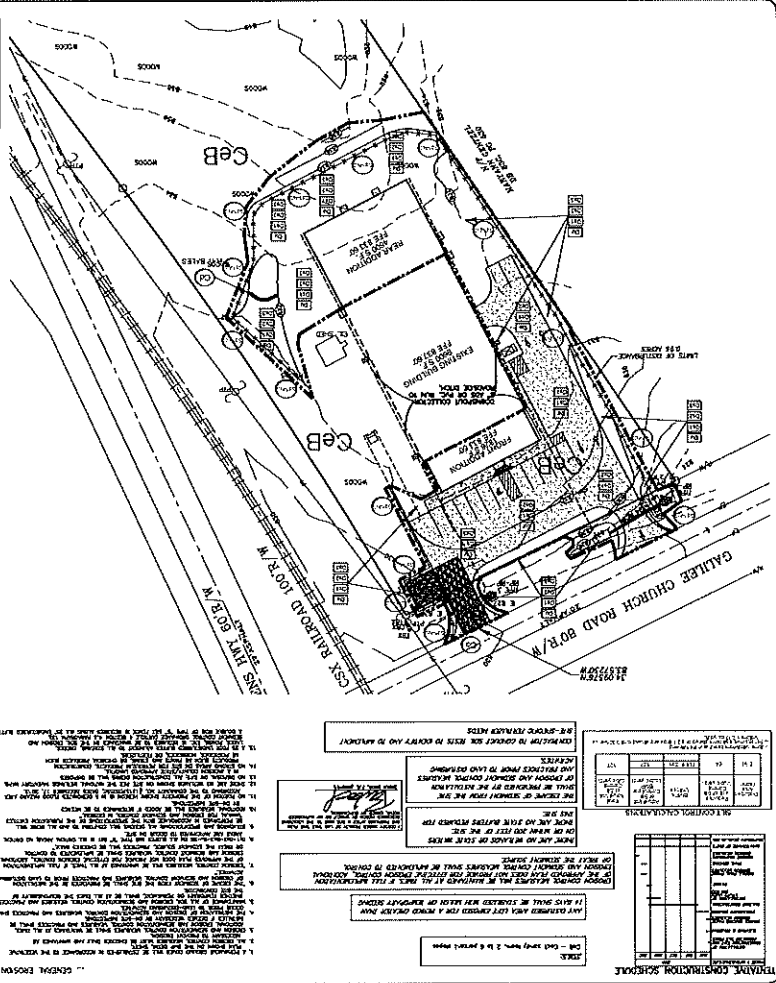

TABLE

...

TABLE

...

TABLE

...

...

...

...



DATE: 03/19/21
 SHEET: C6
 PROJECT: ANIMAL CONTROL SHELTER

THESE DRAWINGS AND ANY GENERAL NOTES HEREON, SHALL BE THE PROPERTY OF CIVIL SOLUTIONS, INC. AND SHALL NOT BE REPRODUCED, COPIED, OR TRANSMITTED IN ANY FORM OR BY ANY MEANS, WITHOUT THE WRITTEN PERMISSION OF CIVIL SOLUTIONS, INC.

EROSION CONTROL DETAILS & NOTES FOR:
JACKSON COUNTY ANIMAL CONTROL SHELTER
 JEFFERSON, GEORGIA

JACKSON COUNTY, GEORGIA
 JEFFERSON, GA. 30549
 CIVIL SOLUTIONS, INC.

CIVIL SOLUTIONS, INC.
 ENGINEERS - PLANNERS
 1000 W. BROADWAY
 ATLANTA, GEORGIA 30334
 (404) 525-1100

NO.	DESCRIPTION	DATE	BY
1	ISSUED FOR PERMIT	03/19/21	JM
2	REVISED PER PERMIT COMMENTS	03/19/21	JM

NO.	DESCRIPTION	DATE	BY
3	REVISED PER PERMIT COMMENTS	03/19/21	JM
4	REVISED PER PERMIT COMMENTS	03/19/21	JM

NO.	DESCRIPTION	DATE	BY
5	REVISED PER PERMIT COMMENTS	03/19/21	JM
6	REVISED PER PERMIT COMMENTS	03/19/21	JM

NO.	DESCRIPTION	DATE	BY
7	REVISED PER PERMIT COMMENTS	03/19/21	JM
8	REVISED PER PERMIT COMMENTS	03/19/21	JM

NO.	DESCRIPTION	DATE	BY
9	REVISED PER PERMIT COMMENTS	03/19/21	JM
10	REVISED PER PERMIT COMMENTS	03/19/21	JM

NO.	DESCRIPTION	DATE	BY
11	REVISED PER PERMIT COMMENTS	03/19/21	JM
12	REVISED PER PERMIT COMMENTS	03/19/21	JM

NO.	DESCRIPTION	DATE	BY
13	REVISED PER PERMIT COMMENTS	03/19/21	JM
14	REVISED PER PERMIT COMMENTS	03/19/21	JM

NOTED PER PERMIT:
 1. THE SLOPE OF THE EROSION CONTROL MEASURES SHALL BE AS SHOWN ON THE DRAWINGS.
 2. THE SLOPE SHALL BE MAINTAINED THROUGHOUT THE CONSTRUCTION AND MAINTENANCE PERIOD.
 3. THE SLOPE SHALL BE PROTECTED BY THE EROSION CONTROL MEASURES THROUGHOUT THE CONSTRUCTION AND MAINTENANCE PERIOD.
 4. THE SLOPE SHALL BE PROTECTED BY THE EROSION CONTROL MEASURES THROUGHOUT THE CONSTRUCTION AND MAINTENANCE PERIOD.

GENERAL NOTES:
 1. THE SLOPE OF THE EROSION CONTROL MEASURES SHALL BE AS SHOWN ON THE DRAWINGS.
 2. THE SLOPE SHALL BE MAINTAINED THROUGHOUT THE CONSTRUCTION AND MAINTENANCE PERIOD.
 3. THE SLOPE SHALL BE PROTECTED BY THE EROSION CONTROL MEASURES THROUGHOUT THE CONSTRUCTION AND MAINTENANCE PERIOD.
 4. THE SLOPE SHALL BE PROTECTED BY THE EROSION CONTROL MEASURES THROUGHOUT THE CONSTRUCTION AND MAINTENANCE PERIOD.

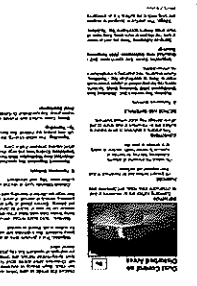
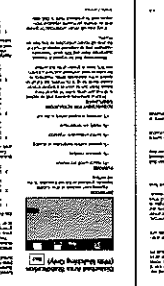
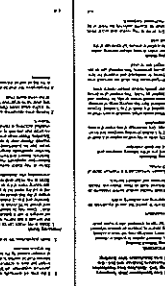
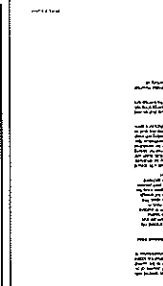
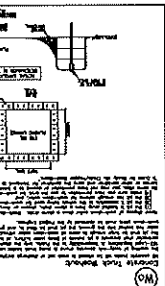
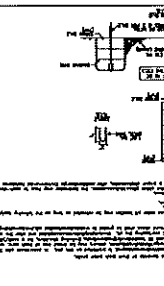
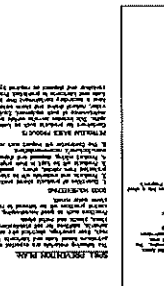

NOTED PER PERMIT:
 1. THE SLOPE OF THE EROSION CONTROL MEASURES SHALL BE AS SHOWN ON THE DRAWINGS.
 2. THE SLOPE SHALL BE MAINTAINED THROUGHOUT THE CONSTRUCTION AND MAINTENANCE PERIOD.
 3. THE SLOPE SHALL BE PROTECTED BY THE EROSION CONTROL MEASURES THROUGHOUT THE CONSTRUCTION AND MAINTENANCE PERIOD.
 4. THE SLOPE SHALL BE PROTECTED BY THE EROSION CONTROL MEASURES THROUGHOUT THE CONSTRUCTION AND MAINTENANCE PERIOD.

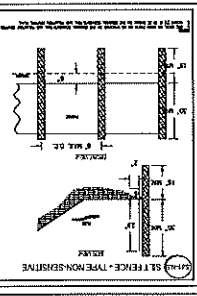
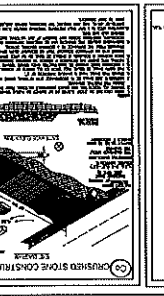
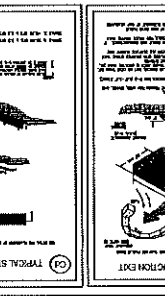
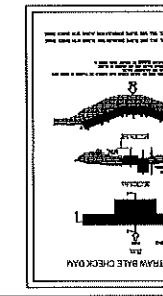
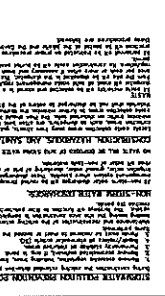
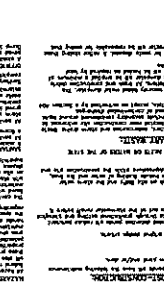
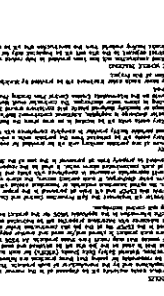

NOTED PER PERMIT:
 1. THE SLOPE OF THE EROSION CONTROL MEASURES SHALL BE AS SHOWN ON THE DRAWINGS.
 2. THE SLOPE SHALL BE MAINTAINED THROUGHOUT THE CONSTRUCTION AND MAINTENANCE PERIOD.
 3. THE SLOPE SHALL BE PROTECTED BY THE EROSION CONTROL MEASURES THROUGHOUT THE CONSTRUCTION AND MAINTENANCE PERIOD.
 4. THE SLOPE SHALL BE PROTECTED BY THE EROSION CONTROL MEASURES THROUGHOUT THE CONSTRUCTION AND MAINTENANCE PERIOD.

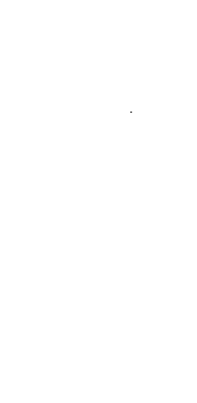

SHEET
 07
 12/11/11
 DATE
 11/11/11
 PROJECT
 JACKSON COUNTY
 CITY
 JACKSON

THE UNITED STATES OF AMERICA
 DEPARTMENT OF THE ARMY
 WASHINGTON, D.C. 20315-5000
 11/11/11



NO.	DESCRIPTION	DATE	BY	CHECKED
1	DESIGN	11/11/11	JAC	JAC
2	REVISION			
3	REVISION			

NO.	DESCRIPTION	DATE	BY	CHECKED
4	DESIGN	11/11/11	JAC	JAC
5	REVISION			
6	REVISION			

NO.	DESCRIPTION	DATE	BY	CHECKED
7	DESIGN	11/11/11	JAC	JAC
8	REVISION			
9	REVISION			

EROSION CONTROL DETAILS FOR
 JACKSON COUNTY
 ANIMAL CONTROL SHELTER
 JEFFERSON, GEORGIA

JACKSON COUNTY GEORGIA
 JEFFERSON, GA 30548
 PROJECT NO. 11/11/11

CIVIL SOLUTIONS, INC.
 ENGINEERS - PLANNERS
 11/11/11

NO.	DESCRIPTION	DATE	BY	CHECKED
10	DESIGN	11/11/11	JAC	JAC
11	REVISION			
12	REVISION			

1. The purpose of this document is to provide detailed specifications for the erosion control measures to be installed at the Jackson County Animal Control Shelter. The measures shall be designed to prevent soil erosion and sedimentation during construction and operation of the facility.

2. The erosion control measures shall be installed in accordance with the following specifications:

- 2.1. All areas of exposed soil shall be protected with erosion control blankets or straw mulch within 14 days of construction.
- 2.2. Sedimentation basins shall be installed at all points where runoff enters a waterway or stormwater system.
- 2.3. Silt fences shall be installed along the perimeter of the construction site to prevent sediment from leaving the site.
- 2.4. All areas of exposed soil shall be stabilized with vegetation as soon as possible after construction.

3. The contractor shall be responsible for the design, installation, and maintenance of all erosion control measures. The contractor shall provide a detailed plan of the erosion control measures to be installed, including the location, type, and quantity of materials to be used.

4. The contractor shall be responsible for the inspection and maintenance of all erosion control measures. The contractor shall provide a detailed log of the inspection and maintenance activities, including the date, time, and results of each inspection.

5. The contractor shall be responsible for the removal and disposal of all erosion control materials at the end of the project. The contractor shall provide a detailed plan of the removal and disposal activities, including the location, type, and quantity of materials to be removed and disposed of.

6. The contractor shall be responsible for the replacement of all erosion control materials that are damaged or destroyed during the project. The contractor shall provide a detailed plan of the replacement activities, including the location, type, and quantity of materials to be replaced.

7. The contractor shall be responsible for the training of all personnel involved in the installation and maintenance of the erosion control measures. The contractor shall provide a detailed plan of the training activities, including the location, type, and quantity of materials to be used.

8. The contractor shall be responsible for the documentation of all erosion control measures. The contractor shall provide a detailed log of the installation and maintenance activities, including the date, time, and results of each activity.

9. The contractor shall be responsible for the coordination of all erosion control measures with other construction activities. The contractor shall provide a detailed plan of the coordination activities, including the location, type, and quantity of materials to be used.

10. The contractor shall be responsible for the compliance of all erosion control measures with applicable regulations. The contractor shall provide a detailed plan of the compliance activities, including the location, type, and quantity of materials to be used.





DATE	03/19/21
SHEET	C8
PROJECT	ANIMAL CONTROL SHELTER
LOCATION	JEFFERSON, GEORGIA

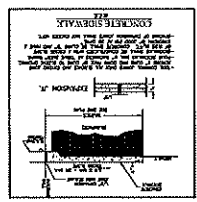
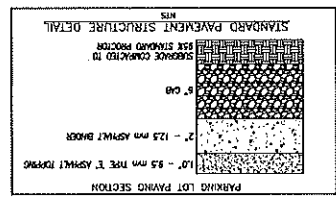
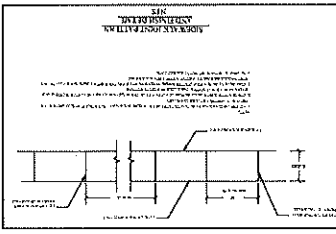
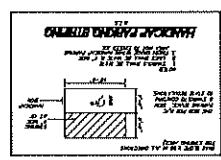
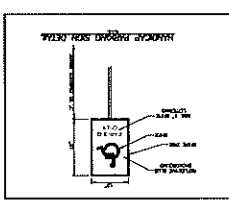
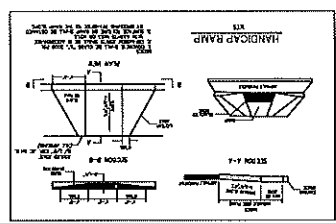
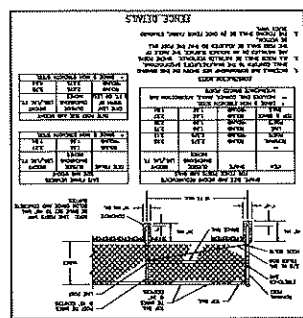

C8

CONSTRUCTION DETAILS FOR:
JACKSON COUNTY ANIMAL CONTROL SHELTER
 JEFFERSON, GEORGIA

CIVIL SOLUTIONS, INC.
 ENGINEERS - PLANNERS

JAMES A. ANDERSON
 JACKSON COUNTY, GEORGIA
 JEFFERSON, GA 30547
 770-962-4022

DATE: 03/19/21
 SHEET: C8

PROJECT: ANIMAL CONTROL SHELTER
 LOCATION: JEFFERSON, GEORGIA

THIS DRAWING AND ANY SPECIFIC REVISIONS, NOTATIONS, OR COMMENTS ARE THE PROPERTY OF CIVIL SOLUTIONS, INC. AND SHALL REMAIN THE PROPERTY OF CIVIL SOLUTIONS, INC. IF COPIED OR REPRODUCED IN ANY MANNER WITHOUT THE WRITTEN PERMISSION OF CIVIL SOLUTIONS, INC.