

ASBUILT, TREE AND TOPOGRAPHIC,
BATHYMETRIC SURVEY OF:
CALHOUN STREET DOCK, TOWN OF BLUFFTON,
BEAUFORT COUNTY, SOUTH CAROLINA
PREPARED FOR: THE TOWN OF BLUFFTON

DATE: 6/07/17 SCALE: 1" = 20'



SIS Sea Island Land Survey, LLC.
4D Mathews Court,
Hilton Head Island,
SC 29926
Tel (843) 681-3248
Fax (843) 689-3871
E-mail: sis@sprynet.com
FILE No: 17099 DWG No.: 9-1661

COPYRIGHT © BY SEA ISLAND LAND SURVEY, LLC. CAD: BA, FLD: VRO

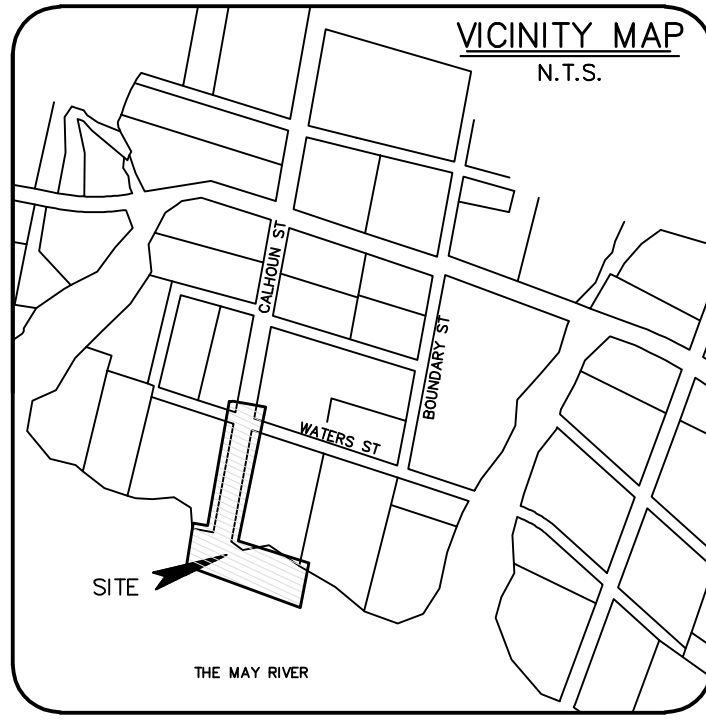

LINE	LENGTH	BEARING
L1	12.40	N 65°11'13" W
L2	39.76	N 58°38'14" W
L3	52.22	N 74°48'59" W
L4	30.23	N 88°03'49" W
L5	30.85	N 59°35'29" W
L6	26.90	N 79°51'02" W
L7	21.04	N 32°18'26" W
L8	20.40	S 81°24'18" W
L9	22.84	S 30°29'43" W
L10	24.99	N 62°23'20" W
L11	19.46	N 08°05'18" W
L12	31.56	N 05°04'25" E
L13	18.73	N 76°02'05" W
L14	9.03	N 74°19'42" W
L15	8.36	S 89°21'17" W
L16	28.86	N 03°14'04" W
L17	23.59	N 34°30'02" E
L18	50.84	S 73°58'10" E

DISTRICT: 610, MAP: 39A, PARCELS: 0111 & 0112

THIS PROPERTY LIES IN F.E.M.A. ZONE A6
BASE FLOOD ELEVATION = 14.0'

COMMUNITY NO. 450251, PANEL 0001A, DATED: 9/29/86

CHURCH OF THE CROSS
R610 039 00A 0112 0000

TOWN OF BLUFFTON
R610 039 00A 0111 0000

- NOTES:
- 1) UNDERGROUND UTILITIES NOT LOCATED EXCEPT AS SHOWN.
 - 2) SEA ISLAND LAND SURVEY, LLC. CERTIFIES TO THE BOUNDARY, TOPOGRAPHIC AND ASBUILT INFORMATION PROVIDED HEREON AS THE DATE OF THE SURVEY. THIS SURVEY MAY BE USED IN DIGITAL FORMAT AS A BASE FOR OTHERS AND ANY REVISIONS OR ADDITIONS MADE HEREAFTER IS NOT THE RESPONSIBILITY OF SEA ISLAND LAND SURVEY, LLC. A HARD COPY AVAILABLE FROM SEA ISLAND LAND SURVEY, LLC. WILL BE THE ONLY OFFICIAL DOCUMENT.
 - 3) HORIZONTAL DATUM IS S.C. STATE PLANE NAD 83.
 - 4) VERTICAL DATUM IS NAVD88.
 - 5) CONTOUR INTERVAL IS 1'.
 - 6) THIS SURVEY HAS BEEN PREPARED WITHOUT BENEFIT OF A COMPLETE TITLE SEARCH AND IS SUBJECT TO EASEMENTS AND RESTRICTIONS OF RECORD.
 - 7) IF IDENTIFICATION OF TREES IS CRITICAL TO DEVELOPMENT, AN ARBORIST SHOULD BE CONSULTED TO VERIFY SUCH TREE IDENTIFICATION.

REFERENCE PLATS

- 1) BOUNDARY, ASBUILT, TREE & TOPOGRAPHIC SURVEY OF THE SQUIRE POPE CARRIAGE HOUSE, TOWN OF BLUFFTON, BEAUFORT COUNTY, SOUTH CAROLINA.
DRAWN: 4/12/17
ROD: BEAUFORT COUNTY, SC
BY: TERRY G. HATCHELL S.C.R.L.S. # 11059
- 2) AN ASBUILT SURVEY OF PARCEL 112 & 115, DISTRICT 610, MAP 39-A, TOWN OF BLUFFTON, BEAUFORT COUNTY, SOUTH CAROLINA.
DRAWN: 6/19/01
RECORDED IN BOOK 87, PAGE 174, DATED 6/25/02
ROD: BEAUFORT COUNTY, SC
BY: FORREST F. BAUGHMAN S.C.R.L.S. # 4922

LEGEND & SYMBOLS:

- TREE SIZES ARE INCHES IN DIAMETER
- SPOT ELEVATION
 - CONTOUR
 - 3" CONCRETE MONUMENT FOUND
 - 3/4" IRON PIPE FOUND
 - TEMPORARY BENCH MARK
 - INVERT ELEVATION
 - POLYVINYL CHLORIDE
 - LIVE OAK
 - LAUREL OAK
 - MAGNOLIA
 - FINE
 - PALM
 - WATER OAK
 - SUGAR BERRY
 - HICKORY
 - CEDAR
 - WILD CHERRY
 - ELECTRIC SERVICE
 - ELECTRIC TRANSFORMER
 - TELEPHONE SERVICE
 - TELEVISION SERVICE
 - WATER METER
 - VALVE BOX
 - UTILITY POLE
 - GUY
 - SIGN
 - FIRE HYDRANT
 - LP TANK (UNDERGROUND)

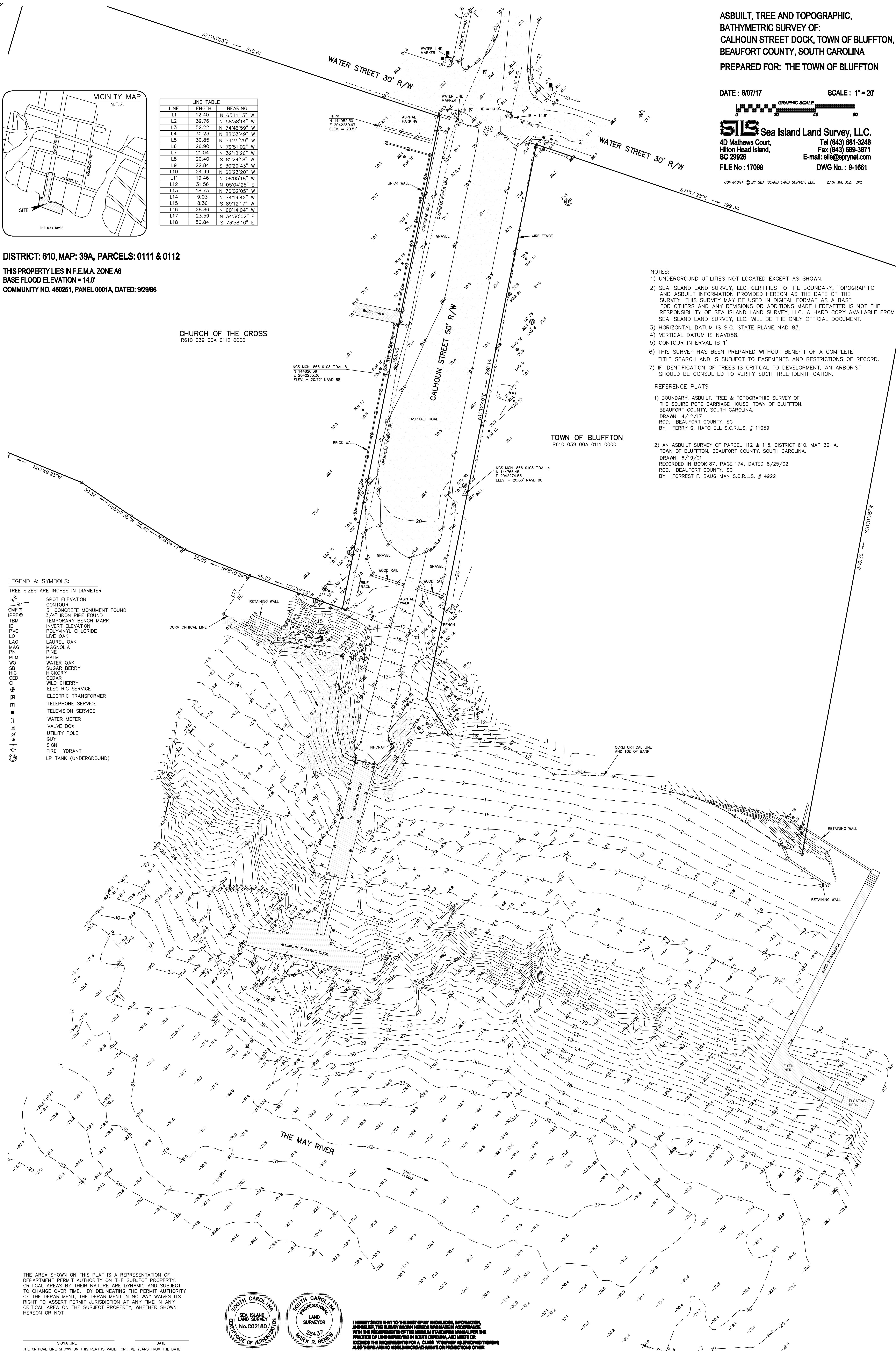

THE AREA SHOWN ON THIS PLAT IS A REPRESENTATION OF DEPARTMENT PERMIT AUTHORITY ON THE SUBJECT PROPERTY. CRITICAL AREAS BY THEIR NATURE ARE DYNAMIC AND SUBJECT TO CHANGE OVER TIME. BY DELINEATING THE PERMIT AUTHORITY OF THE DEPARTMENT, THE DEPARTMENT IN NO WAY WAIVES ITS RIGHT TO ASSERT PERMIT JURISDICTION AT ANY TIME IN ANY CRITICAL AREA ON THE SUBJECT PROPERTY, WHETHER SHOWN HEREON OR NOT.



I HEREBY STATE THAT TO THE BEST OF MY KNOWLEDGE, INFORMATION, AND BELIEF, THE SURVEY SHOWN HEREON WAS MADE IN ACCORDANCE WITH THE REQUIREMENTS OF THE SURVEYING AND MAPPING ACT, FOR THE PRACTICE OF LAND SURVEYING IN SOUTH CAROLINA, AND MEETS OR EXCEEDS THE REQUIREMENTS FOR A CLASS "B" SURVEY AS SPECIFIED THEREIN. ALSO THERE ARE NO VISIBLE ENCUMBRANCES OR PROJECTIONS OTHER THAN SHOWN.

SIGNATURE DATE
THE CRITICAL LINE SHOWN ON THIS PLAT IS VALID FOR FIVE YEARS FROM THE DATE OF THIS SIGNATURE, SUBJECT TO THE CAUTIONARY LANGUAGE ABOVE.

NOT VALID UNLESS EMBOSSED.