

**STATE OF FLORIDA
DEPARTMENT OF TRANSPORTATION**

CONTRACT PLANS

FINANCIAL PROJECT ID. 436643-1-54-01
HIGHLANDS COUNTY PROJECT No. 18009
CR 623 (KENILWORTH BOULEVARD) MILL & RESURFACING
BETWEEN HAYWOOD TAYLOR BLVD. & MINI RANCH ROAD WEST

HIGHLANDS COUNTY

SIGNING AND PAVEMENT MARKING PLANS

**INDEX OF SIGNING AND
PAVEMENT MARKING PLANS**

SHEET NO.	SHEET DESCRIPTION
S-1	KEY SHEET
S-2	TABULATION OF QUANTITIES
S-3	GENERAL NOTES
S-4 - S-10	SIGNING AND PAVEMENT MARKING

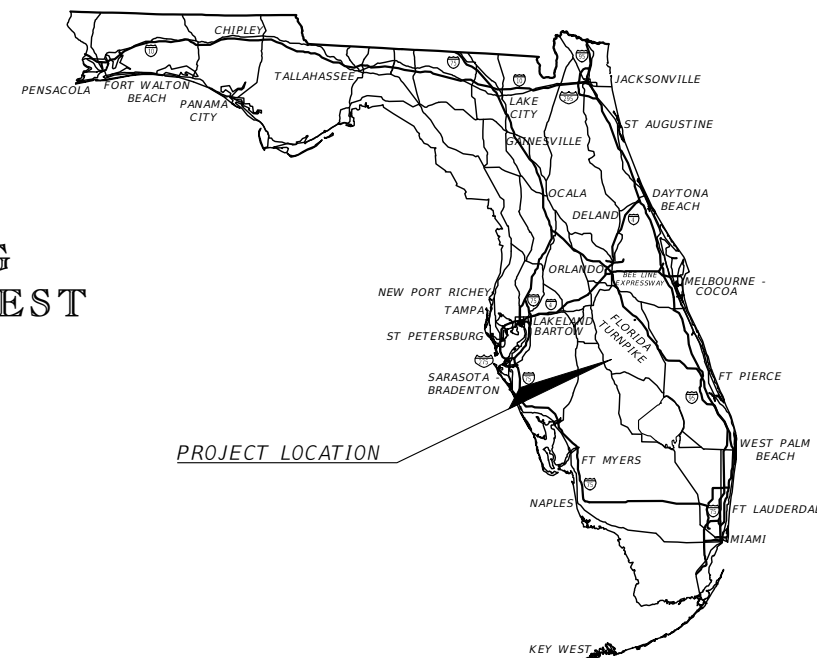

Begin Signing and Pavement Marking
STA. 11+00.00

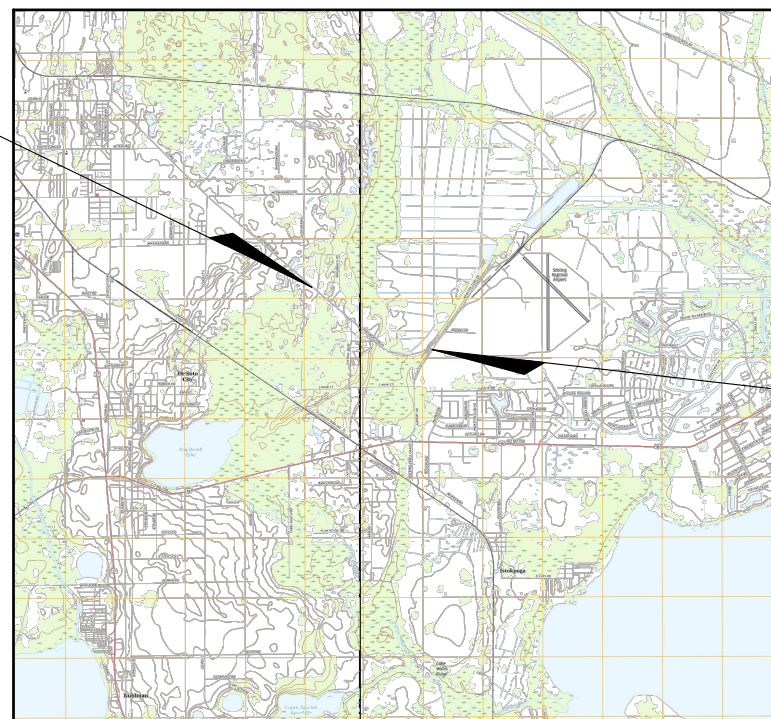

T-34-S
T-35-S

End Signing and Pavement Marking
STA. 530+40.00

R-29-E
R-30-E

ROADWAY PLANS
ENGINEER OF RECORD:

DANIEL W. SCHROEDER, P.E. 78646
AIM ENGINEERING & SURVEYING
2161 FOWLER ST
FORT MYERS, FL 33901
CERTIFICATE OF AUTHORIZATION NO.: 3114

GOVERNING STANDARD PLANS:
Florida Department of Transportation, FY2019-20
Standard Plans for Road and Bridge Construction
and applicable Interim Revisions (IRs).

Standard Plans for Road Construction and
associated IRs are available at the following
website:
<http://www.fdot.gov/design/standardplans>

GOVERNING STANDARD SPECIFICATIONS:
Florida Department of Transportation, January, 2019
Standard Specifications for Road and Bridge
Construction at the following website:
<http://www.fdot.gov/programmanagement/implemented/specbooks>

THIS ITEM HAS BEEN DIGITALLY
SIGNED AND SEALED BY:

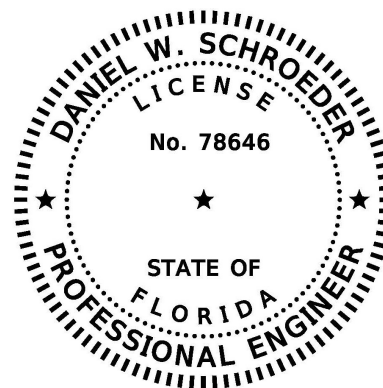

ON THE DATE ADJACENT TO THE SEAL

PRINTED COPIES OF THIS DOCUMENT ARE
NOT CONSIDERED SIGNED AND SEALED
AND THE SIGNATURE MUST BE VERIFIED
ON ANY ELECTRONIC COPIES.

AIM ENGINEERING & SURVEYING, INC.
2161 FOWLER ST., STE. 100
FORT MYERS, FL. 33901
CERTIFICATE OF AUTHORIZATION NO.: 3114
DANIEL W. SCHROEDER, P.E. NO. 78646

CONSTRUCTION CONTRACT NO.	FISCAL YEAR	SHEET NO.
	19	S-1

TABULATION OF QUANTITIES

PAY ITEM NO.	DESCRIPTION	UNIT	SHEET NUMBERS														TOTAL THIS SHEET		GRAND TOTAL	
			S-4		S-5		S-6		S-7		S-8		S-9		S-10		PLAN	FINAL	PLAN	FINAL
			PLAN	FINAL	PLAN	FINAL	PLAN	FINAL	PLAN	FINAL	PLAN	FINAL	PLAN	FINAL						
700-1-11	SINGLE POST SIGN, F & I GROUND MOUNT, UP TO 12SF	AS			2.00												2.00		2.00	
700-1-11-1	SINGLE POST SIGN, F & I GROUND MOUNT, UP TO 12SF (45 MPH WARNING SIGN MOUNTED ON EXISTING POLE)	AS								1.00		1.00					2.00		2.00	
706-3	RETRO REFLECTIVE PAVEMENT MARKERS	EA	30.0		34.0		60.0		60.0		60.0		60.0		78.0		382.0		400.0	
710-11-101	PAINT PAVE. MARKING, STD. WHITE, SOLID 6"	GM	0.26		0.41		0.43		0.43		0.45		0.46		0.40		2.85		2.85	
710-11-170	PAINT PAVEMENT MARKING, STD. WHITE, ARROWS	EA	2.00														2.00		2.00	
711-11-170	THERMO, STD. WHITE, ARROWS	EA	2.00														2.00		2.00	
710-11-224	PAINT PAVE. MARKING, STD. YELLOW, SOLID/DIAG./CHEVRON, 18"	LF													29.0		29.0		29.0	
710-11-125	PAINT PAVE. MARKING, STD. WHITE, SOLID 24"	LF	45.0		28.0		16.0		24.0						46.0		159.0		160.0	
710-11-201	PAINT PAVE. MARKING, STD. YELLOW, SOLID 6"	GM			0.04		0.23		0.38		0.47		0.44		0.44		1.99		1.95	
710-11-231	PAINT PAVE. MARKING, STD. YELLOW, SKIP 6" (10/30)	GM	0.19		0.23		0.23		0.06								0.71		0.71	
711-11-224	THERMO, STD. YELLOW, SOLID, 18" FOR DIAG./ CHEVRON	LF													29.00		29.00		29.00	
711-11-125	THERMO, STD. WHITE, SOLID, 24" FOR STOP LINE AND CROSSWALK	LF	45.0		28.0		16.0		24.0						46.0		159.0		160.0	
711-16-101	THERMO, STD., OTHER SURFACES, WHITE, SOLID 6"	GM	0.26		0.41		0.43		0.43		0.45		0.46		0.40		2.85		2.85	
711-16-201	THERMO, STD., OTHER SURFACES, YELLOW, SOLID 6"	GM			0.04		0.23		0.38		0.47		0.44		0.40		1.95		1.95	
711-16-231	PAINT PAVE. MARKING, STD. YELLOW, SOLID 6"	GM	0.19		0.23		0.23		0.06								0.71		0.71	
* THESE QUANTITIES ARE PAID FOR UNDER PAINTED PAVEMENT MARKINGS (FINAL SURFACE), LUMP SUM - ITEM NO. 710-90. THE QUANTITIES SHOWN ARE FOR ONE APPLICATION; SEE SPECIFICATION 710 FOR THE NUMBER OF APPLICATIONS REQUIRED.																				

REVISIONS				AIM ENGINEERING & SURVEYING, INC. DANIEL W. SCHROEDER, P.E. P.E. LICENSE NUMBER 78646 2161 FOWLER ST. FORT MEYRS, FL. 33901 CERTIFICATE OF AUTHORIZATION 3114	CR 623 (KENILWORTH BLVD) MILL & RESURFACING			TABULATION OF QUANTITIES				SHEET NO.
DATE	DESCRIPTION	DATE	DESCRIPTION		AIM PROJECT NO.	COUNTY	FINANCIAL PROJECT ID					S-2
					19-1014	HIGHLANDS						

SIGNING AND PAVEMENT MARKING NOTES

=====

1. PAVEMENT MARKINGS SHOULD BE PLACED AS SHOWN IN THE TRAFFIC DESIGN STANDARDS AND THESE PLANS.
2. PROPOSED SIGNS AND SUPPORTS SHALL BE FURNISHED AND INSTALLED IN ACCORDANCE WITH FDOT STANDARDS PLANS No. 700-010 AND No. 700-101, EXCEPT OTHERWISE NOTED IN PLANS.
3. THE SIGN LOCATIONS SHOWN ARE APPROXIMATE AND MAY REQUIRE FIELD ADJUSTMENT AS DIRECTED BY THE ENGINEER.
4. CONTRACTOR SHALL USE SQUARE GALVANIZED PERFORATED STEEL POSTS FOR ALL SIGNS AS SHOWN IN SIGNING AND PAVEMENT MARKING DETAILS, UNLESS OTHERWISE SPECIFIED BY HIGHLANDS COUNTY.
5. SIZES FOR ALL PROPOSED SIGNS SHALL CONFIRM TO SIZE SHOWN IN MUTCD, LATEST EDITION.
6. IT IS THE RESPONSIBILITY OF THE CONTRACTOR TO DETERMINE THE SIGN COLOR, SIZE AND TEXT HEIGHT, SPACING AND COLOR OF THE "SPECIAL" SIGNS AT LOCATIONS SHOWN IN THE PLANS, PRIOR TO FABRICATION.
7. THE CONTRACTOR SHALL MATCH EXISTING PAVEMENT MARKINGS AT THE BEGINNING AND END OF THE PROJECT AND AT ALL SIDE STREETS WITHOUT JOGS AND OFFSETS.
8. THE RETRO REFLECTIVE PAVEMENT MARKERS ADHESIVE USED SHALL BE ON THE CURRENT FDOT APPROVED PRODUCT LIST (APL).
9. REFER TO FDOT STANDARD PLANS NO. 706-001 FOR RPM PLACEMENT DETAILS.
10. IT SHALL BE THE RESPONSIBILITY OF THE CONTRACTOR TO VERIFY THE LENGTH OF SIGN COLUMN SUPPORTS IN THE FIELD PRIOR TO FABRICATION.
11. FOR MARKING PLACEMENT REQUIREMENTS SEE FDOT STANDARD PLANS NO. 711-001.
12. SIZES FOR OBJECT MARKER SIGNS SHALL CONFORM TO SIZE SHOWN IN MUTCD, LATEST EDITION.
13. PERMANENT THERMOPLASTIC PAVEMENT MARKINGS SHALL NOT BE INSTALLED UNTIL 30 DAYS AFTER FINAL PLACEMENT OF ASPHALT CONCRETE. TEMPORARY PAINTED PAVEMENT MARKINGS SHALL BE UTILIZED FOR ALL PAVEMENT OPEN TO TRAFFIC.
14. FINAL PAVEMENT MARKINGS SHALL BE THERMOPLASTIC, UNLESS OTHERWISE NOTED IN THE PLANS.

REVISIONS				AIM ENGINEERING & SURVEYING, INC. DANIEL W. SCHROEDER, P.E. P.E. LICENSE NUMBER 78646 2161 FOWLER ST. FORT MEYRS, FL. 33901 CERTIFICATE OF AUTHORIZATION 3114	CR 623 (KENILWORTH BLVD) MILL & RESURFACING			GENERAL NOTES	SHEET NO.
DATE	DESCRIPTION	DATE	DESCRIPTION		AIM PROJECT NO.	COUNTY	FINANCIAL PROJECT ID		
						19-1014	HIGHLANDS		

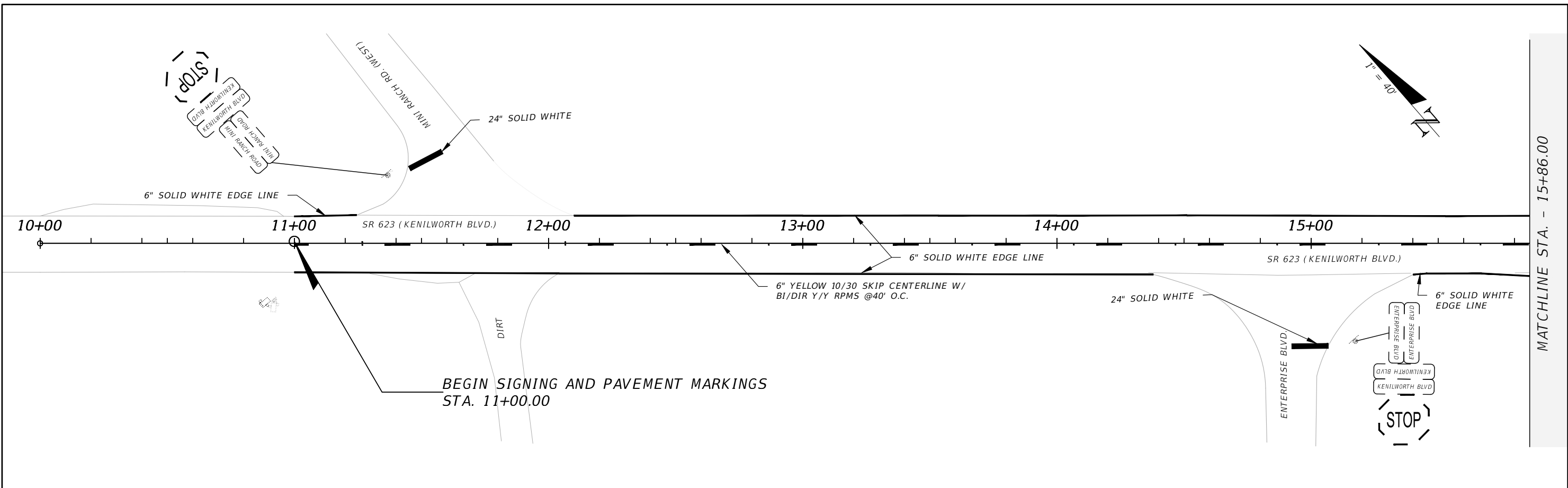

MATCHLINE STA. - 15+86.00

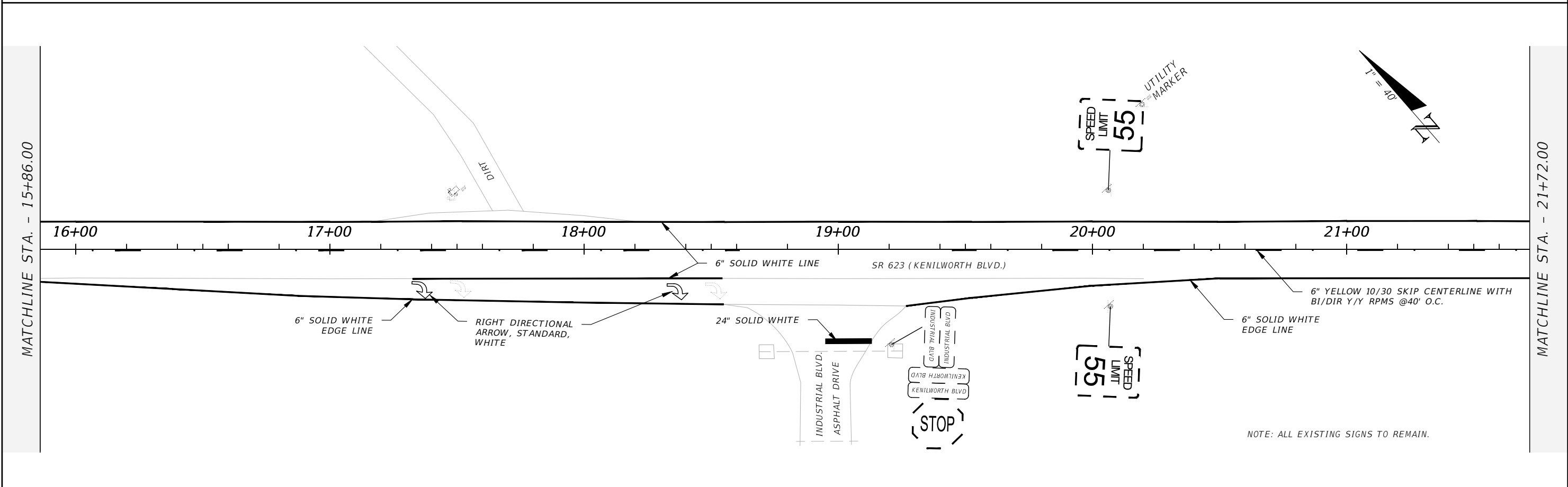

MATCHLINE STA. - 15+86.00

MATCHLINE STA. - 21+72.00

REVISIONS				AIM ENGINEERING & SURVEYING, INC. DANIEL W. SCHROEDER, P.E. P.E. LICENSE NUMBER 78646 2161 FOWLER ST. FORT MEYRS, FL. 33901 CERTIFICATE OF AUTHORIZATION 3114	CR 623 (KENILWORTH BLVD) MILL & RESURFACING			SIGNING AND PAVEMENT MARKING	SHEET NO. S-4
DATE	DESCRIPTION	DATE	DESCRIPTION		AIM PROJECT NO.	COUNTY	FINANCIAL PROJECT ID		
					19-1014	HIGHLANDS			

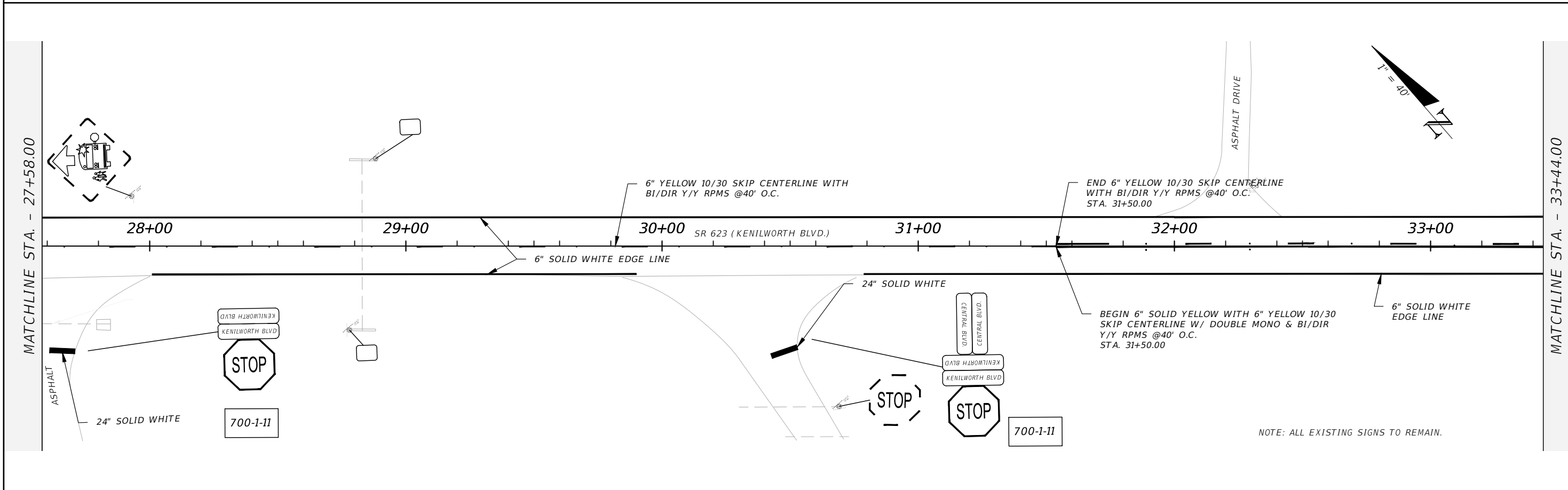
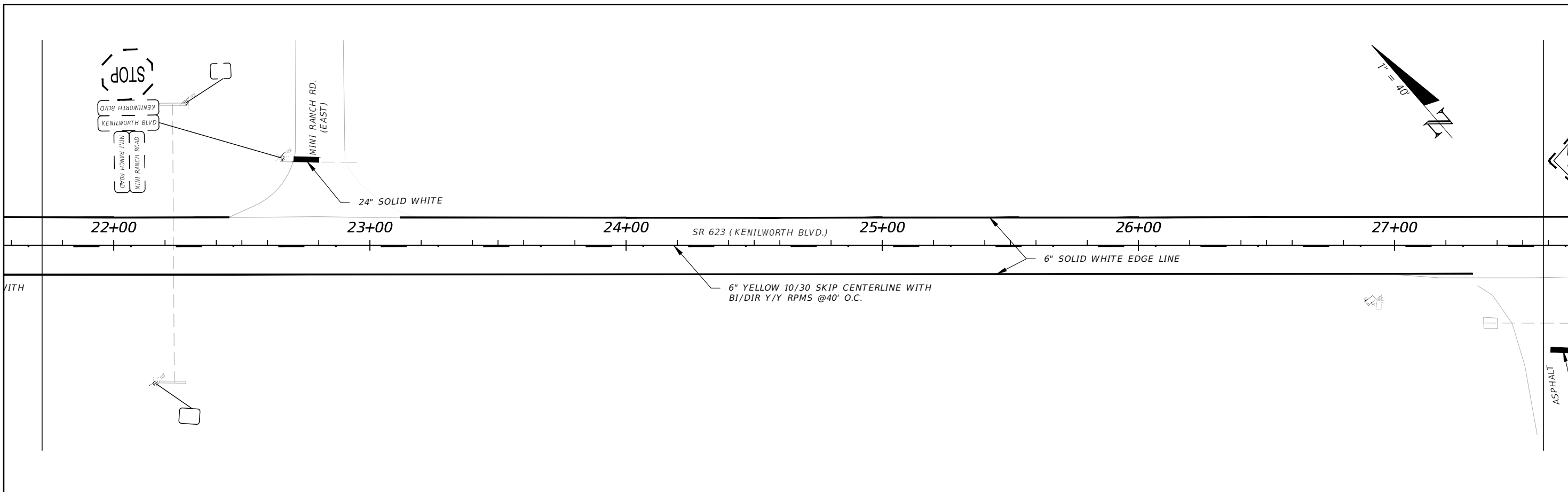

REVISIONS				AIM ENGINEERING & SURVEYING, INC. DANIEL W. SCHROEDER, P.E. P.E. LICENSE NUMBER 78646 2161 FOWLER ST. FORT MEYRS, FL. 33901 CERTIFICATE OF AUTHORIZATION 3114	CR 623 (KENILWORTH BLVD) MILL & RESURFACING			SIGNING AND PAVEMENT MARKING	SHEET NO. S-5
DATE	DESCRIPTION	DATE	DESCRIPTION		AIM PROJECT NO.	COUNTY	FINANCIAL PROJECT ID		
					19-1014	HIGHLANDS			

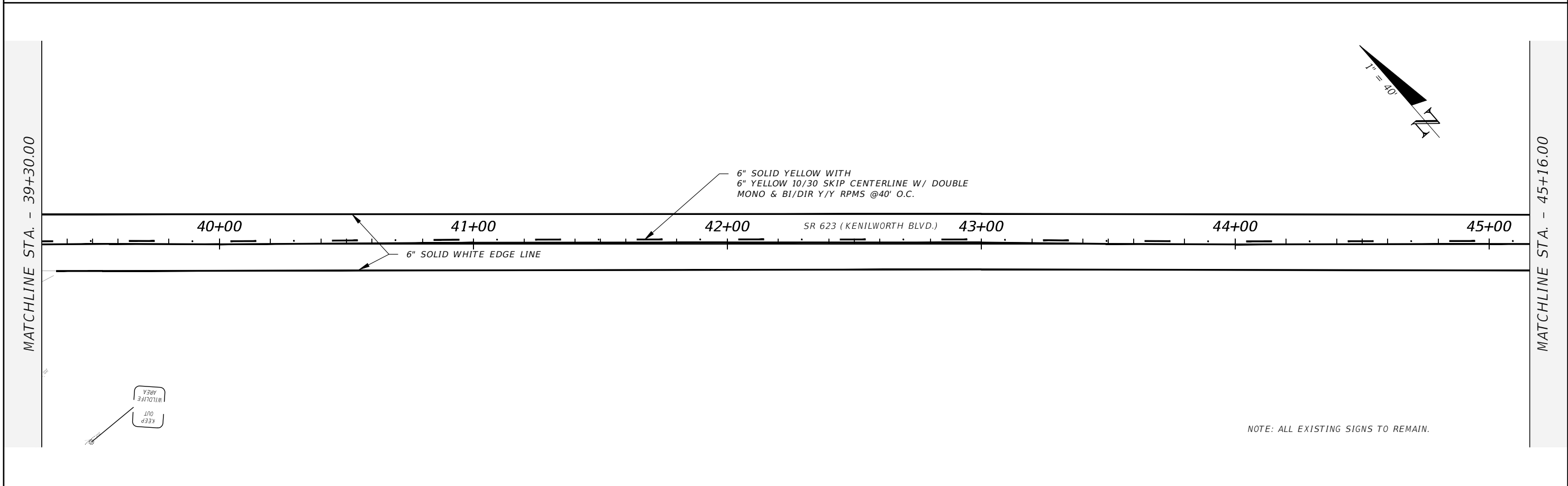
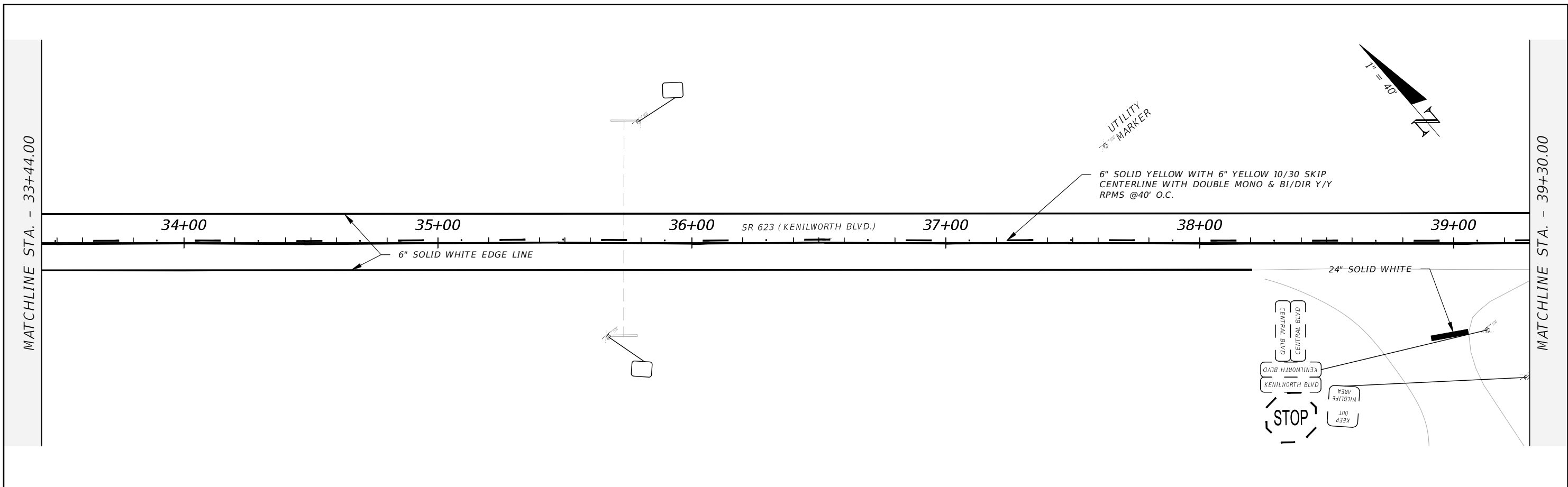

NOTE: ALL EXISTING SIGNS TO REMAIN.

REVISIONS				AIM ENGINEERING & SURVEYING, INC. DANIEL W. SCHROEDER, P.E. P.E. LICENSE NUMBER 78646 2161 FOWLER ST. FORT MEYRS, FL. 33901 CERTIFICATE OF AUTHORIZATION 3114	CR 623 (KENILWORTH BLVD) MILL & RESURFACING			SIGNING AND PAVEMENT MARKING	SHEET NO. 5-6
DATE	DESCRIPTION	DATE	DESCRIPTION		AIM PROJECT NO.	COUNTY	FINANCIAL PROJECT ID		
					19-1014	HIGHLANDS			

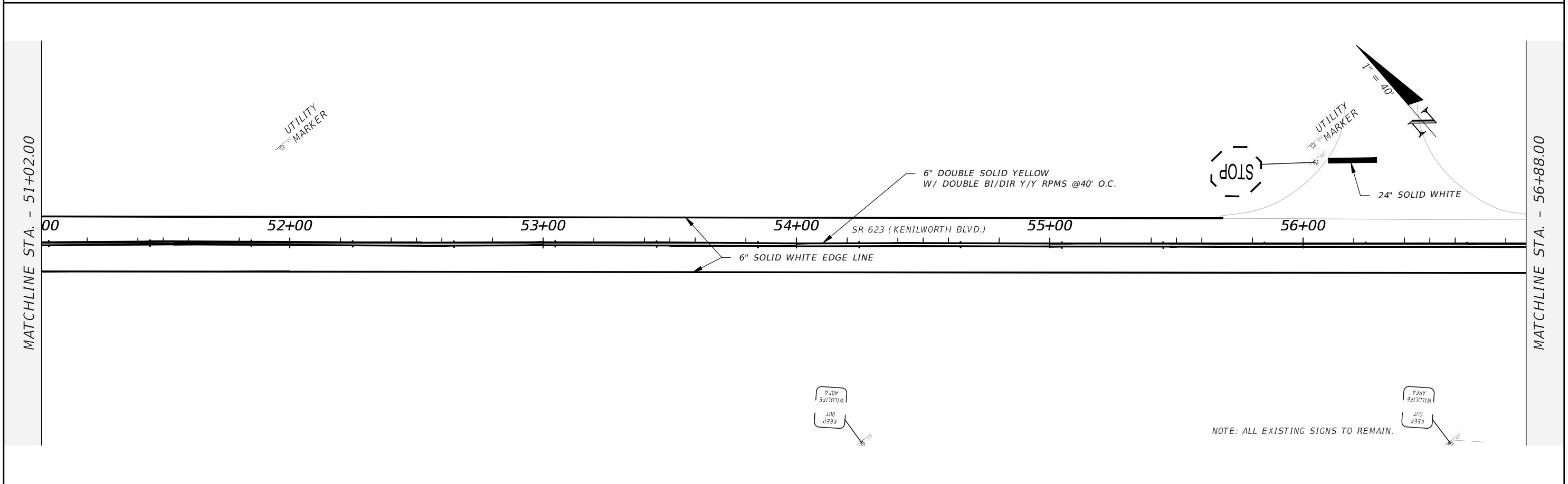
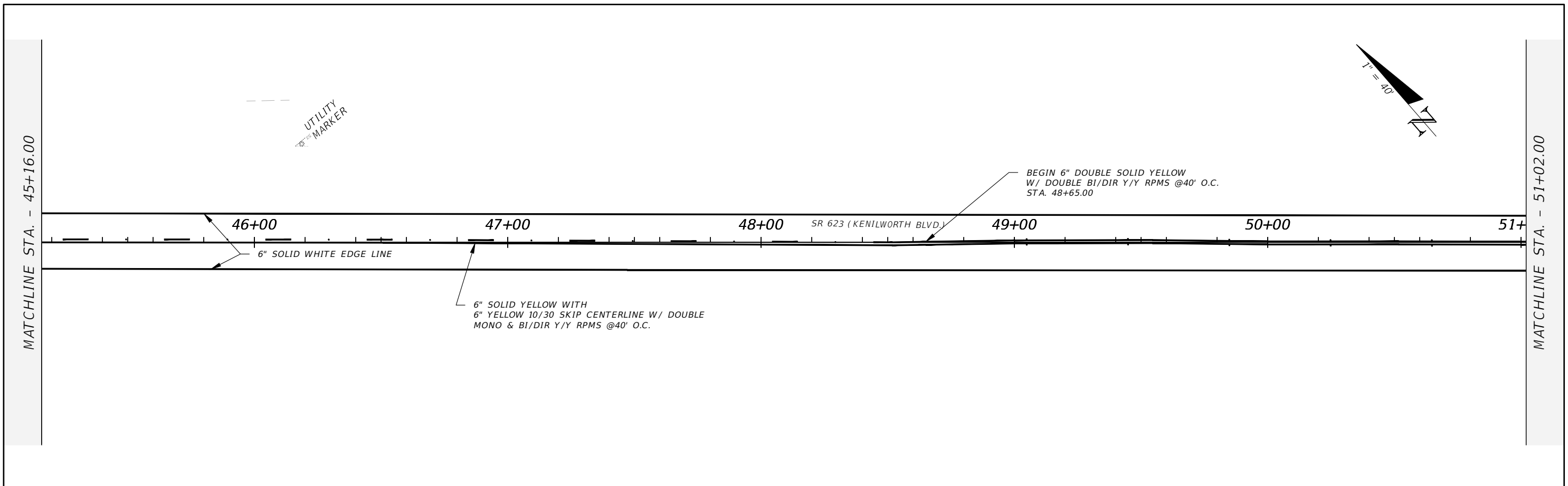

REVISIONS				AIM ENGINEERING & SURVEYING, INC. DANIEL W. SCHROEDER, P.E. P.E. LICENSE NUMBER 78646 2161 FOWLER ST. FORT MEYRS, FL. 33901 CERTIFICATE OF AUTHORIZATION 3114	CR 623 (KENILWORTH BLVD) MILL & RESURFACING			SIGNING AND PAVEMENT MARKING	SHEET NO. S-7
DATE	DESCRIPTION	DATE	DESCRIPTION		AIM PROJECT NO.	COUNTY	FINANCIAL PROJECT ID		
					19-1014	HIGHLANDS			

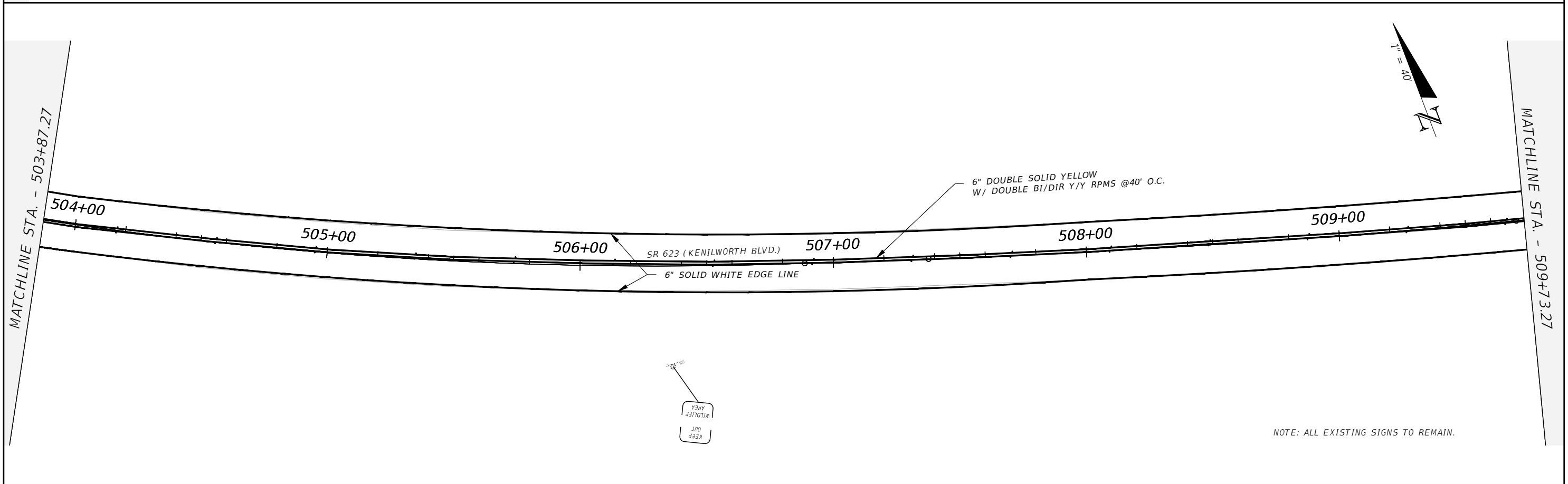
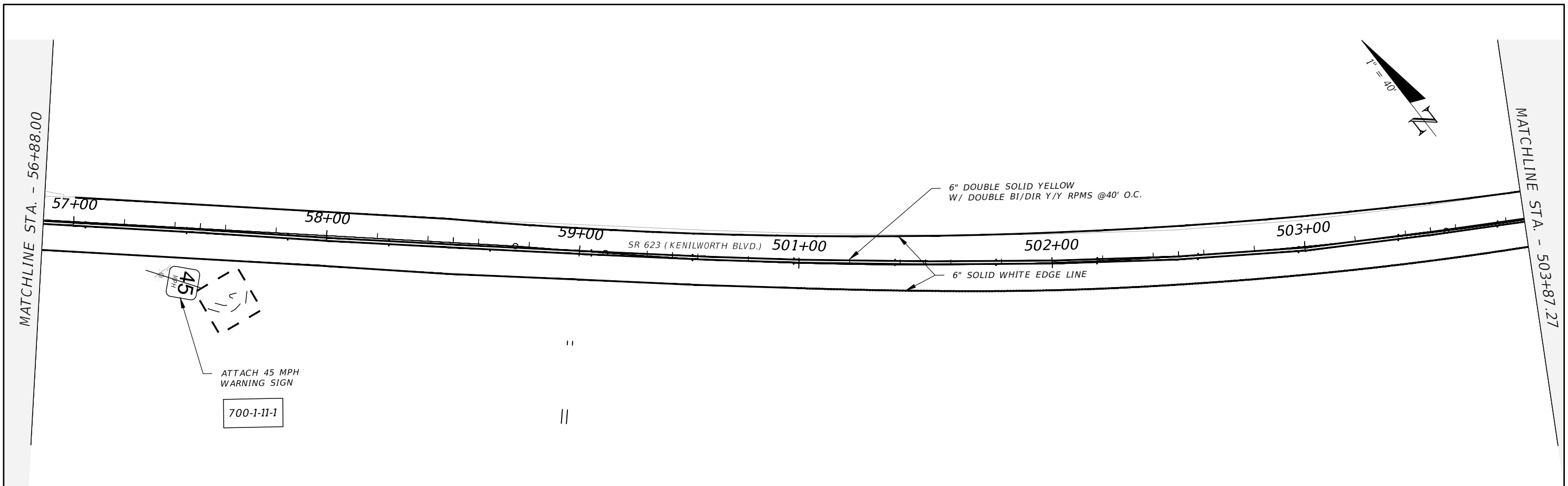

NOTE: ALL EXISTING SIGNS TO REMAIN.

REVISIONS				AIM ENGINEERING & SURVEYING, INC. DANIEL W. SCHROEDER, P.E. P.E. LICENSE NUMBER 78646 2161 FOWLER ST. FORT MEYRS, FL. 33901 CERTIFICATE OF AUTHORIZATION 3114	CR 623 (KENILWORTH BLVD) MILL & RESURFACING			SIGNING AND PAVEMENT MARKING	SHEET NO. S-8
DATE	DESCRIPTION	DATE	DESCRIPTION		AIM PROJECT NO.	COUNTY	FINANCIAL PROJECT ID		
					19-1014	HIGHLANDS			

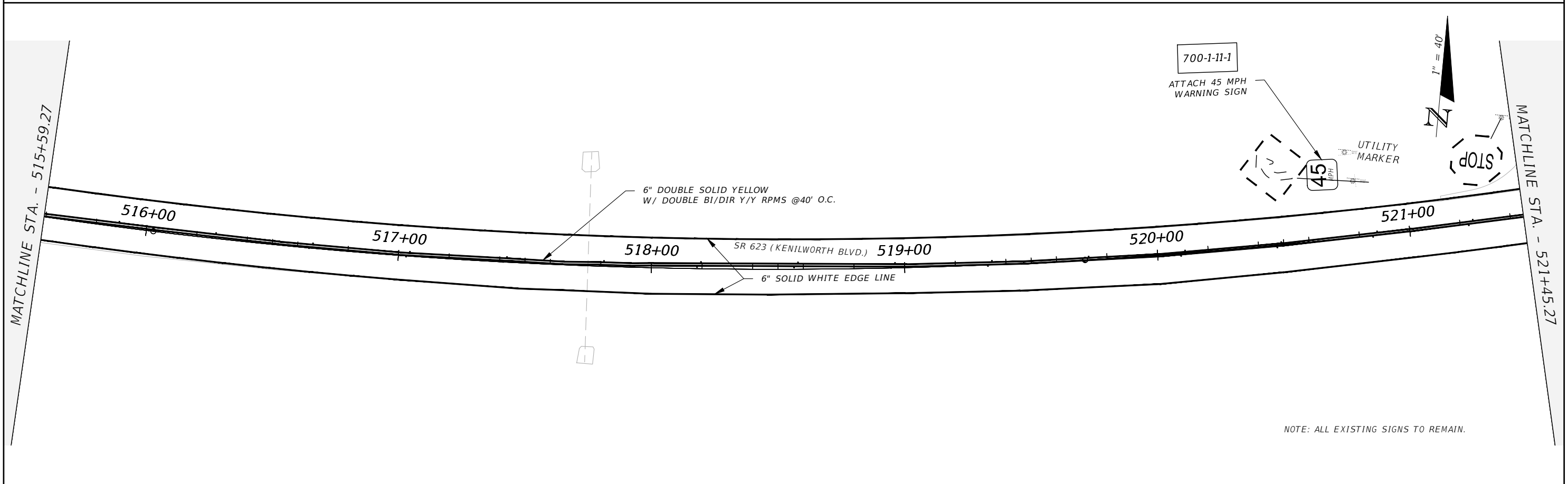
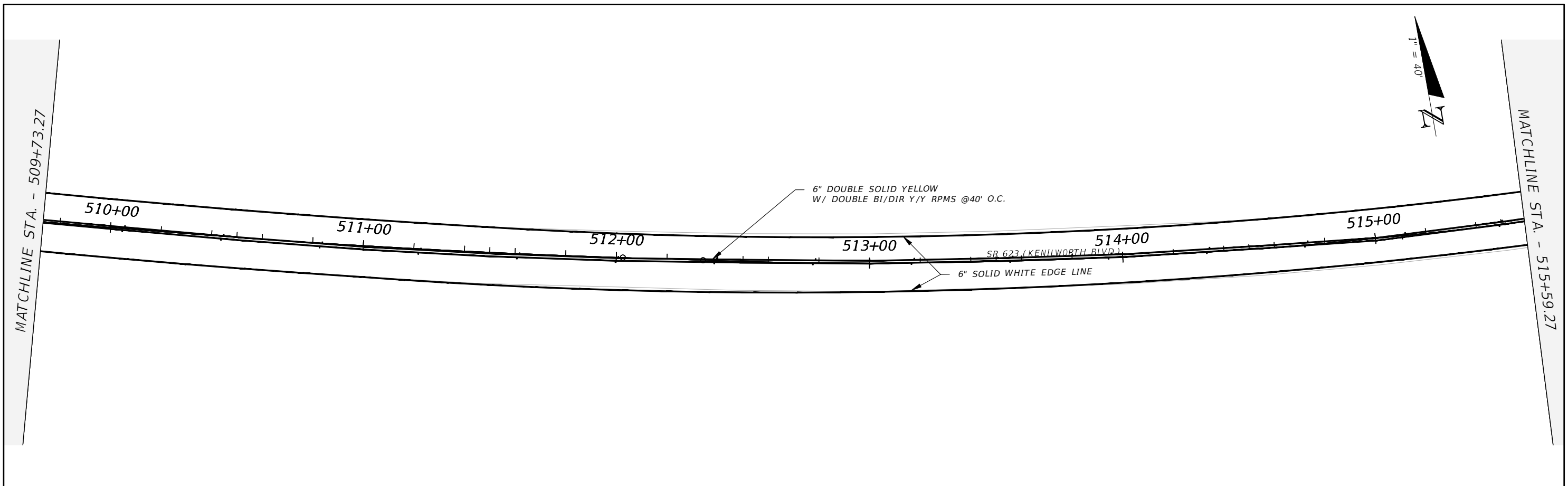

NOTE: ALL EXISTING SIGNS TO REMAIN.

REVISIONS				AIM ENGINEERING & SURVEYING, INC. DANIEL W. SCHROEDER, P.E. P.E. LICENSE NUMBER 78646 2161 FOWLER ST. FORT MEYRS, FL. 33901 CERTIFICATE OF AUTHORIZATION 3114	CR 623 (KENILWORTH BLVD) MILL & RESURFACING			SIGNING AND PAVEMENT MARKING	SHEET NO. S-9
DATE	DESCRIPTION	DATE	DESCRIPTION		AIM PROJECT NO.	COUNTY	FINANCIAL PROJECT ID		
					19-1014	HIGHLANDS			

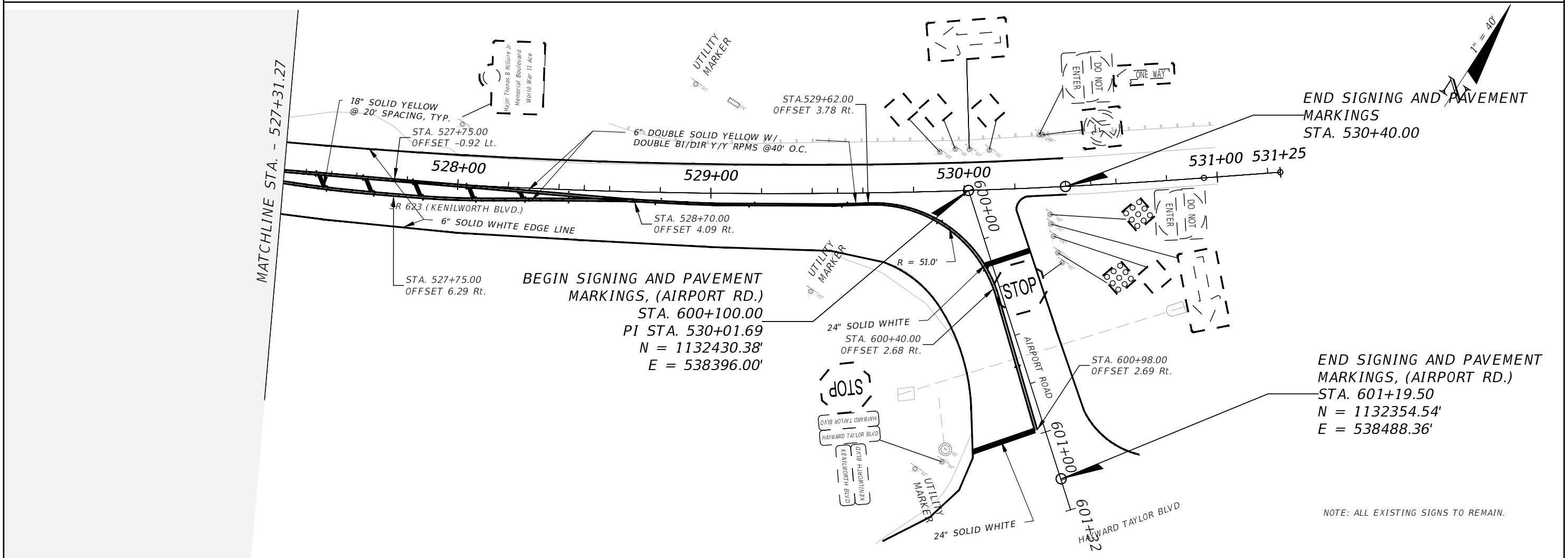
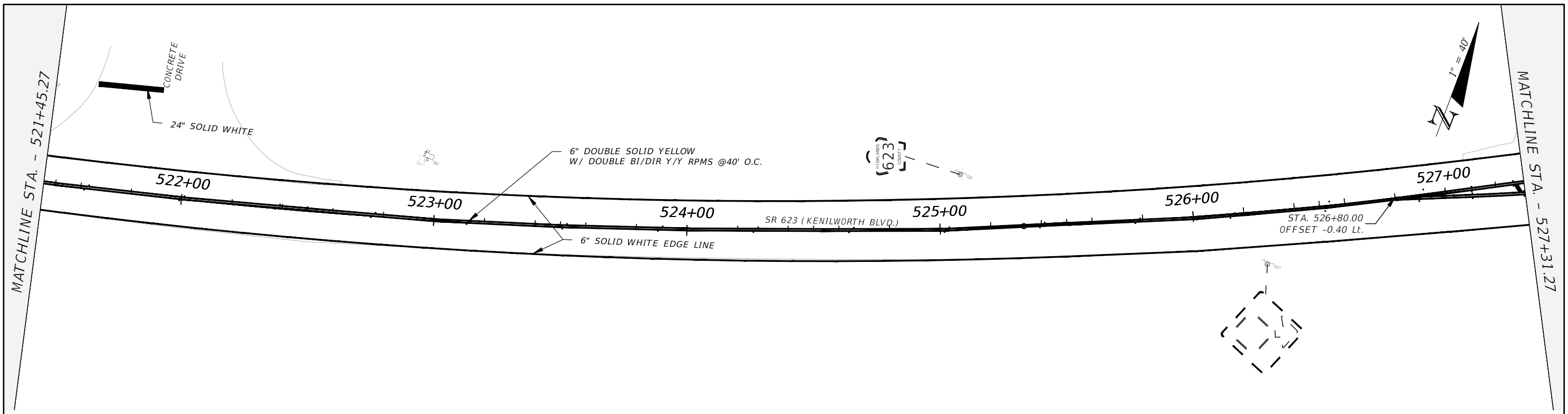

REVISIONS				AIM ENGINEERING & SURVEYING, INC. DANIEL W. SCHROEDER, P.E. P.E. LICENSE NUMBER 78646 2161 FOWLER ST. FORT MEYRS, FL. 33901 CERTIFICATE OF AUTHORIZATION 3114	CR 623 (KENILWORTH BLVD) MILL & RESURFACING			SIGNING AND PAVEMENT MARKING	SHEET NO. S-10
DATE	DESCRIPTION	DATE	DESCRIPTION		AIM PROJECT NO.	COUNTY	FINANCIAL PROJECT ID		
					19-1014	HIGHLANDS			

NOTE: ALL EXISTING SIGNS TO REMAIN.