

ADDENDUM #1
May 24, 2021

PROJECT: *Morningside Drive & Coral Road Pavement Replacement*

OWNER: City of Waycross

BID DATE: Bid Date – Thursday, May 27, 2021 at 2:00 PM

Please be advised of the following:

- 1. CLARIFICATIONS & MISCELLANEOUS INFORMATION**
 - a. Contractor shall be responsible for replacing and adjusting to final grade all ex. manhole rings & covers. (See revised Specification Sections 00410 & 01025)
 - b. Contractor shall be responsible for adjusting to final grade all ex. valve boxes. (See revised Specification Sections 00410 & 01025)
 - c. Proposed asphalt surface course shall be 12.5 mm design mix. (See revised Specification Sections 00410 & 01025 and revised sheet C2.0)
 - d. Ex. asphalt section is average 2" depth. (See revised sheet C2.0)
- 2. SPECIFICATIONS, SECTION 00410 – BID FORM, SEE ATTACHED REVISION.**
- 3. SPECIFICATIONS, SECTION 01025 – MEASUREMENT & PAYMENT, SEE ATTACHED REVISION**
- 4. CONSTRUCTION DRAWINGS, SHEET C2.0, SEE ATTACHED REVISION**

All bidders shall acknowledge receipt of all addenda issued where indicated on the bid sheets. (SECTION 00410 – Bid Form, Page 2)

ATTENTION

BIDDERS ARE ADVISED THAT IT IS THEIR RESPONSIBILITY TO VERIFY THAT ANY AND ALL ADDENDA HAVE BEEN RECEIVED PROPR TO SUBMISSION OF THE BID. IN CASE ANY BIDDER FAILS TO ACKNOWLEDGE RECEIPT OF ANY SUCH ADDENDA IN THE SPACE PROVIDED ON THE BID FORM, THE BID WILL NEVERTHELESS BE CONSTURED AS THOUGH THE BIDDER HAS RECEIVED AND ACKNOWLEDGED ALL SUCH ADDENDA, AND THE SUBMISSION OF THE BID WILL CONSTITUTE ACKNOWLEDGEMENT AND RECEIPT OF SAME.

END ADDENDUM

**SECTION 00410
BID FORM**

PROJECT IDENTIFICATION:

Morningside Drive & Coral Road Pavement Replacement

CONTRACT IDENTIFICATION AND NUMBER:

W3000.101

THIS BID IS SUBMITTED TO:

City of Waycross
417 Pendleton St.
Waycross, GA 31501

THIS BID IS SUBMITTED FROM:

Bidder: _____

Address: _____

Phone: _____

State of Georgia Utility Contractor's License No.: _____

1. The undersigned Bidder proposes and agrees, if this Bid is accepted, to enter into an agreement with Owner in the form included in the Contract Documents to perform and furnish all Work as specified or indicated in the Contract Documents for the Contract Price and within the Contract Time indicated in this Bid and in accordance with the other terms and conditions of the Contract Documents.
2. Bidder accepts all of the terms and conditions of the Advertisement or Invitation to Bid and Instructions to Bidders, including without limitation those dealing with the disposition of Bid security. This Bid will remain subject to acceptance for 60 days after the day of Bid opening. Bidder will sign and submit the Agreement with the Bonds and other documents required by the Bidding Requirements within fifteen days after the date of Owner's Notice of Award.
3. In submitting this Bid, Bidder represents, as more fully set forth in the Agreement, that:

(a) Bidder has examined copies of all the Bidding Documents and of the following Addenda (receipt of all which is hereby acknowledged):

Date	Addendum Number

(b) Bidder has familiarized itself with the nature and extent of the Contract Documents, Work, site, locality, and all local conditions and Laws and Regulations that in any manner may affect cost, progress, performance or furnishing of the Work.

(c) Bidder has studied carefully all reports and drawings of subsurface conditions and drawings of physical conditions which are identified in the Supplementary Conditions as provided in paragraph 4.2 of the General Conditions, and accepts the determination set forth in paragraph 4.2.1 of the Supplementary Conditions of the extent of the technical data contained in such reports and drawings upon which Bidder is entitled to rely.

(d) Bidder has obtained and carefully studied (or assumes responsibility for obtaining and carefully studying) all such examinations, investigations, explorations, tests and studies (in addition to or to supplement those referred to in (c) above) which pertain to the subsurface or physical conditions at the site or otherwise may affect the cost, progress, performance or furnishing of the Work as Bidder considers necessary for the performance or furnishing of the Work at the Contract Price, within the Contract Time and in accordance with the other terms and conditions of the Contract Documents, including specifically the provisions of paragraph 4.2 of the General Conditions; and no additional examinations, investigations, explorations, tests, reports or similar information or data are or will be required by Bidder for such purposes.

(e) Bidder has reviewed and checked all information and data shown or indicated on the Contract Documents with respect to existing Underground Facilities at or contiguous to the site and assumes responsibility for the accurate location of said Underground Facilities. No additional examinations, investigations, explorations, tests, reports or similar information or data in respect of said Underground Facilities are or will be required by Bidder in order to perform and furnish the Work at the Contract Price, within the Contract Time and in accordance

with the other terms and conditions of the Contract Documents, including specifically the provisions of paragraph 4.3 of the General Conditions.

(f) Bidder has correlated the results of all such observations, examinations, investigations, explorations, tests, reports and studies with the terms and conditions of the Contract Documents.

Bidder has given Engineer written notice of all conflicts, errors or discrepancies that it has discovered in the Contract Documents and the written resolution thereof by Engineer is acceptable to Bidder.

(g) This Bid is genuine and not made in the interest of or on behalf of any undisclosed person, firm or corporation and is not submitted in conformity with an agreement or rules of any group, association, organization or corporation; Bidder has not directly or indirectly induced or solicited any other corporation to refrain from bidding; and Bidder has not sought by collusion to obtain for itself any advantage over any other Bidder or over Owner.

(h) Bidder agrees to commence work under this Agreement on or before a date to be specified in a written "Notice to Proceed" of the Owner.

(i) Bidder accepts the provisions of the Agreement as to liquidated damages in the event of failure to complete the Work on time.

4. Bidder will complete the Work in accordance with the Contract Documents for the following price(s), and the Contractor is directed to Section 01025 "Measurement and Payment" for the methods and limits for payments to the Contractor for the pay items listed below:

BID FORM BEGINS ON PAGE 4

(a) BASE BID: Morningside Drive & Coral Road Pavement Replacement

BASE BID					
SECTION 100 MORNINGSIDE DRIVE CONSTRUCTION					
ITEM				UNIT	TOTAL
NO.	QTY.	UNIT	DESCRIPTION	PRICE	PRICE
101	3540	SY	Mill Variable Depth	\$	\$
102	390	TN	12.5 mm SuperPave RAC	\$	\$
103	2505	LF	5" Solid Yellow Traffic Stripe w/ Raised Pavement Markers	\$	\$
104	2665	LF	5" Solid White Traffic Stripe	\$	\$
105	20	LF	24" Solid White Traffic Stripe	\$	\$
106	1	LS	Curb Inlet Complete	\$	\$
107	290	LF	24" Stand Up Curb & Gutter	\$	\$
108	20	LF	24" Roll Over Curb & Gutter	\$	\$
109	3	EA	Replace Manhole Ring & Cover	\$	\$
110	2	EA	Adjust Existing Valve Box to Grade	\$	\$
SECTION 100 MORNINGSIDE DRIVE SUBTOTAL (A)					\$

SECTION 200 CORAL ROAD CONSTRUCTION					
201	1270	SY	Mill Variable Depth	\$	\$
202	140	TN	12.5 mm SuperPave RAC	\$	\$
203	980	LF	5" Solid Yellow Traffic Stripe w/ Raised Pavement Markers	\$	\$
204	920	LF	5" Solid White Traffic Stripe	\$	\$
205	12	LF	24" Solid White Traffic Stripe	\$	\$
206	1	EA	Replace Manhole Ring & Cover	\$	\$
SECTION 200 CORAL ROAD SUBTOTAL (B)					\$

SECTION 300 GENERAL					
301	1	LS	Erosion & Sediment Control Complete	\$	\$
302	1	LS	Traffic Control	\$	\$
303	1	LS	Mobilization/Demobilization	\$	\$
304	1	LS	Supplementary Work Agreement (SWA)	\$ 10,000.00	\$ 10,000.00
SECTION 300 GENERAL SUBTOTAL (C)					\$

SECTION 100 MORNINGSIDE DRIVE SUBTOTAL (A)					
SECTION 200 CORAL ROAD SUBTOTAL (B)					
SECTION 300 GENERAL SUBTOTAL (C)					
TOTAL BASE BID (A+B+C)					\$

Bidder agrees to furnish all labor, materials, and equipment necessary to construct the Morningside Drive & Coral Road Pavement Replacement for the City of Waycross for the sum of _____ Dollars (\$_____).

6. Bidder agrees that the Work will be complete and ready for final payment in accordance with paragraph 14.07 of the General Conditions within 90 calendar days after the date when the Contract Times commence to run.
7. Bidder accepts the provisions of the Agreement as to liquidated damages in the event of failure to complete the Work within the times specified in the Agreement.
8. The following documents are attached to and made a condition of this Bid:
 - a. Required Bid Security in the form of 5% of the Bid Total Price.
9. The undersigned further agrees that in case of failure on his part to execute the said contract and the Bond within fifteen (15) consecutive calendar days after written notice being given of the award of the contract, the check or bid bond accompanying this bid, and the monies payable thereon shall be paid into the funds of the Owner as liquidated damages for such failure, otherwise, the check or bid bond accompanying this proposal shall be returned to the undersigned.
10. Communications concerning this Bid shall be addressed to:

ESG Engineering, Inc.
6400 Peake Rd
Macon, GA 31210
Attn: Margaret Hildebrand
mHildebrand@esgengineering.com
11. Terms used in this Bid which are defined in the General Conditions or Instructions to Bidders will have the meanings indicated in the General Conditions of Instructions.

SUBMITTED on _____, 20____.

BIDDER: _____

BY: _____

TITLE: _____

STATE CONTRACTOR
LICENSE NO. _____

ADDRESS:

PHONE:

Seal: (if bid by a Corporation)

END OF SECTION

**SECTION 01025
MEASUREMENT AND PAYMENT**

PART 1 – GENERAL

1.01 SCOPE OF WORK

- A. This Section describes the methods by which measurement will be made of the quantities for which payment will be made for the Project.
- B. The Bid lists each item of the Project for which payment will be made. No payment will be made for any items other than those listed in the Bid.
- C. Required items of work and incidentals necessary for the satisfactory completion of the work which are not specifically listed in the Bid, and which are not specified in this Section to be measured or to be included in one of the items listed in the Bid, shall be considered as incidental to the work and whose cost shall be included in the item of the bidder's choice. All costs thereof, including Contractor's overhead costs and profit, shall be considered as included in the lump sum or unit prices bid for the various Bid items. The Contractor shall prepare the Bid accordingly.
- D. Work includes furnishing all labor, equipment, tools and materials, which are not furnished by the Owner and performing all operations required to complete the work satisfactorily, in place, as specified and as indicated on the Drawings.

1.02 MEASUREMENT OF WORK

- A. Measurement methods delineated in the individual specification sections complement the criteria of this section. In the event of conflict, the requirements of the individual specification section govern.
- B. Work shall be measured by the Engineer or his representative with assistance from the Contractor prior to preparation of a payment request by the Contractor.
- C. Unit quantities that are measured in place shall be measured as they are placed. The Contractor shall give the Engineer a minimum of two days' notice for making all required measurements.
- D. Materials that must be measured as delivered shall be measured at the time of delivery by the Engineer or his representative; the Contractor shall provide sufficient advance notice so that such measurements can be made.
- E. Work necessary for a complete and operational job, such as relocation of mail

boxes or fences, removal of trees, relocation of utilities, graveling / maintaining driveways and driving lanes, field engineering, clearing and grubbing, traffic control, etc., not specifically identified as a pay item shall be included in the unit price bid of the bidder's choosing. No additional payments will be made for such activities.

1.03 ESTIMATED QUANTITIES

All estimated quantities for unit price items, stipulated in the BID FORM, or other Contract Documents, are approximate and are to be used as a basis for comparing the bids submitted for the Project. The actual amounts of work done and materials furnished under unit price items may differ from the estimated quantities. The basis of payment for work and materials will be the actual amount of work done and materials furnished. The Contractor agrees to make no claim for damages, anticipated profits or otherwise on account of any difference between the amounts of work actually furnished and the estimated amounts included in the BID FORM. The Contractor will not be paid for any work which exceeds the quantity set forth in the BID FORM without a change order issued before the work is performed unless specifically ordered in writing by the Engineer. The Contractor will provide assistance to the Engineer to check quantities and elevations when so requested.

1.04 MEASUREMENT OF QUANTITIES

- A. Measurement by Weight – Concrete reinforcing steel, rolled or formed steel or other metal shapes will be measured by handbook weights. Welded assemblies will be measured by handbook or scale weight.
- B. Measurement by Volume – Measured by cubic dimension using mean length, width and height or thickness.
- C. Measurement by Area – Measured by square dimension using mean length and width or radius.
- D. Linear Measurement – Measured by linear dimension, at the item centerline or mean chord.
- E. Stipulated Sum/Price Measurement – Items measured by weight, volume, area, or linear means or combination, as appropriate, as a completed item or unit of the Work.

1.05 PROGRESS PAYMENTS

- A. Progress payments shall be based on percentage of work complete for lump sum pay items and units installed for unit price pay items.
- B. All items of Work not specifically listed in the Bid Schedule shall be considered

incidental to the construction, and the cost of all such work and material shall be included in the item of the Contractors choice.

- C. All items listed for measurement and payment shall include all materials, labor, and equipment necessary to successfully and satisfactorily complete Work specified.
- D. Payment – The Contractor will receive payment only for the items listed in the Bid Schedule of his contract, and no separate payments will be made for the work under any section of the Contract Documents except as provided for in the Bid Form. Where measurements are required to be made by the Engineer, for the payment of a pay item, the failure of the Contractor to give the adequate notification or failure of the Contractor to give the engineer assistance for the measurement shall result in the forfeiture of payment for the work or item which was not measured.

1.06 SUPPLEMENTAL WORK ALLOWANCE

- A. Supplemental Work Allowances (SWA's) shall be utilized to incorporate cost changes for any additional authorized work into the scope of work up to the amount budgeted in the BID FORM. Contract change orders shall be enforced for contract changes over and above the amount budgeted as SWA. SWA's shall authorize the Contractor to perform additions to work, but the Contractor shall perform no work until written authorization has been delivered to the Contractor by the Engineer or Owner. Contractor should not expect that any SWA's will be issued; SWA's shall be issued at the discretion of the Owner only.

The value of any work covered by a SWA shall be determined in one of the following ways:

1. Where the work involved is covered by unit prices contained in the Contract Documents, by application of unit prices to the quantities of the item involved (subject to the provisions of General Conditions, Article 11, paragraph 11.3 inclusive).
2. By mutual acceptance of a lump sum by Contractor and the Owner.
3. On the basis of the cost of the work plus a Contractor's Fee for overhead and profit. This basis shall be as established for Change Orders in General Conditions.

PART 2 – PRODUCTS

2.01 STORED MATERIALS

- A. Partial payment shall be made for approved materials stored at the project site, provided invoices for said materials are furnished in accordance with payment request submittal and shop drawings for said materials have been approved.

PART 3 – EXECUTION

3.01 DEMOLITION

- A. Measurement: Measurement for Demolition shall be on a lump sum basis.
- B. Payment: Payment for Demolition shall be on the basis of the unit price provided in the BID FORM and shall include the cost of removing, hauling, and disposing of the specified site features, and all labor, materials, and equipment required.

3.02 CURB INLET COMPLETE

- A. Measurement: Measurement for CURB INLET COMPLETE shall be on a lump sum basis.
- B. Payment: Payment for CURB INLET COMPLETE shall be on the basis of the lump sum price provided in the BID FORM and shall include the cost of the inlet, junction box, 15" reinforced concrete pipe, structure and pipe bedding & backfill, rip rap for protection of the receiving ditch, and all labor, materials, and equipment required.

3.03 ASPHALT MILLING

- A. Measurement: Measurement for Asphalt Milling shall be on a per square yard basis.
- B. Payment: Payment for Asphalt Milling shall be on the basis of the unit price provided in the BID FORM for actual yards of asphalt milled during construction and shall include all labor, materials, and equipment required. Payment shall also include milling of asphalt to provide for smooth and even transitions where proposed overlay meets existing asphalt.

3.04 ASPHALT

- A. Measurement: Measurement for Asphalt shall be on a per ton basis.
- B. Payment: Payment for Asphalt shall be on the basis of the unit price provided in the BID FORM for various mix designs and shall include the asphalt, crack treatment, reinforcing fabric, the tack coat, and all labor, materials, and equipment required.

3.05 24" STAND-UP CURB AND GUTTER

- A. Measurement: Measurement for 24" Stand-Up Curb & Gutter shall be on a per linear foot basis.
- B. Payment: Payment for 24" Stand-Up Curb & Gutter shall be on the basis of the unit price provided in the BID FORM and shall include the cost of concrete, forms and all labor, materials, and equipment required to properly install the 24" Stand-Up Curb & Gutter.

3.06 24" ROLL OVER CURB AND GUTTER

- C. Measurement: Measurement for 24" Roll Over Curb & Gutter shall be on a per linear foot basis.
- D. Payment: Payment for 24" Roll Over Curb & Gutter shall be on the basis of the unit price provided in the BID FORM and shall include the cost of concrete, forms and all labor, materials, and equipment required to properly install the 24" Roll Over Curb & Gutter.

3.07 WHITE 5" PAVEMENT STRIPING (PAINT)

- A. Measurement: Measurement for White 5" Pavement Striping shall be on a per linear foot basis.
- B. Payment: Payment for White 5" Pavement Striping shall be on the basis of the unit price provided in the BID FORM and shall include parking striping, ADA striping, miscellaneous striping, (NOT stop bar striping) all labor, materials, and equipment required.

3.08 YELLOW 5" PAVEMENT STRIPING WITH RAISED PAVEMENT MARKERS

- C. Measurement: Measurement for Yellow 5" Pavement Striping shall be on a per linear foot basis.
- D. Payment: Payment for Yellow 5" Pavement Striping shall be on the basis of the unit price provided in the BID FORM and shall include parking striping, ADA striping, miscellaneous striping, raised pavement markers, all labor, materials, and equipment required.

3.09 WHITE 24" PAVEMENT STRIPING

- A. Measurement: Measurement for White 24" Pavement Striping shall be on a per linear foot basis.
- B. Payment: Payment for White 24" Pavement Striping shall be on the basis of the unit price provided in the BID FORM and shall include all labor, materials, and equipment required.

3.10 TRAFFIC CONTROL

Payment for traffic control shall be at the lump sum price given in the BID FORM and shall include all labor, materials, and equipment required to adhere to the latest MUTCD standards published by the FHWA during construction and city standards and recommendations.

3.11 MOBILIZATION/DEMobilIZATION

Payment for Mobilization/Demobilization shall be at the lump sum price given in the bid form and should include any cost incurred by the contractor to move equipment to and from the job site(s).

3.12 EROSION & SEDIMENTATION CONTROL COMPLETE

Payment for Erosion & Sedimentation Control Complete shall be at the lump sum price given in the bid form and should include the cost of silt fence, inlet protection, check dams, construction entrance/exit, temporary & permanent seeding and any cost incurred by the contractor to provide erosion & sedimentation control in accordance with local, state, and federal regulations.

3.13 TESTING SERVICES

Payment for Testing Services shall be included in the item for which it pertains and shall include all labor, equipment and materials required to properly perform testing services as described in the Plans & Specifications.

3.14 REPLACE MANHOLE AND ADJUST TO GRADE

- A. Measurement: Measurement for replacing manholes and adjusting to grade shall be on a per each basis.
- B. Payment: Payment for replacing manholes and adjusting to grade will include all materials, labor, and equipment necessary to furnish and install new manhole rings and covers as well as adjust manhole lids as required to match the final grade of the finished asphalt.

3.15 ADJUST VALVE BOX TO GRADE

- A. Measurement: Measurement for adjusting valve boxes to grade shall be on a per each basis.
- B. Payment: Payment for adjusting valve boxes to grade will include all materials, labor, and equipment necessary to adjust existing valve box lids as required to match the final grade of the finished asphalt.

END OF SECTION

NO.	DESCRIPTION	DATE
1	ADDENDUM #1	05-24-2021

BID SET



DRAWN BY: JDM
CHECKED BY: WLN
DATE: APR 2021
SCALE: N.T.S.

CONTENT:
 DETAILS

SHEET NO:

C2.0

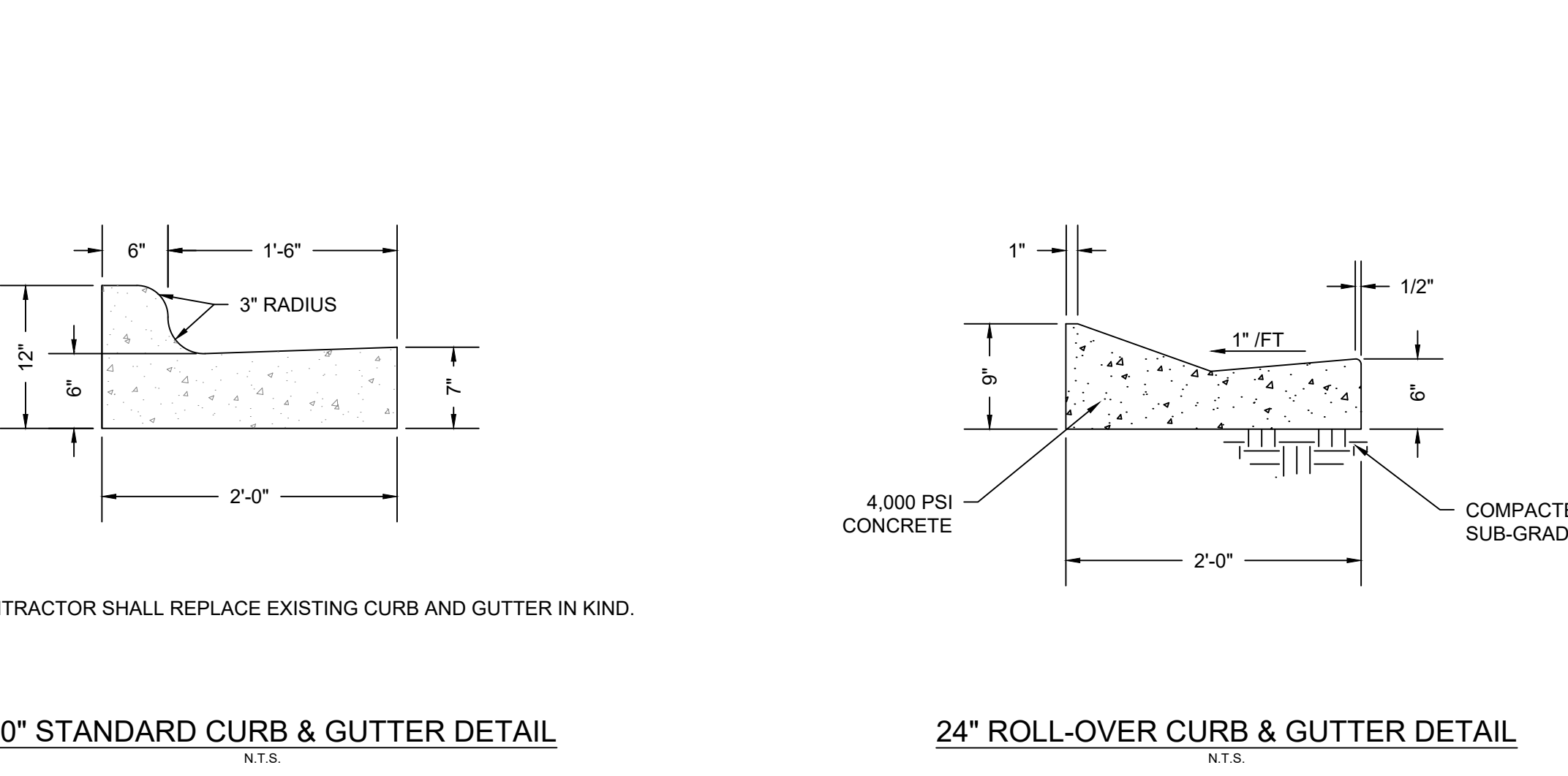
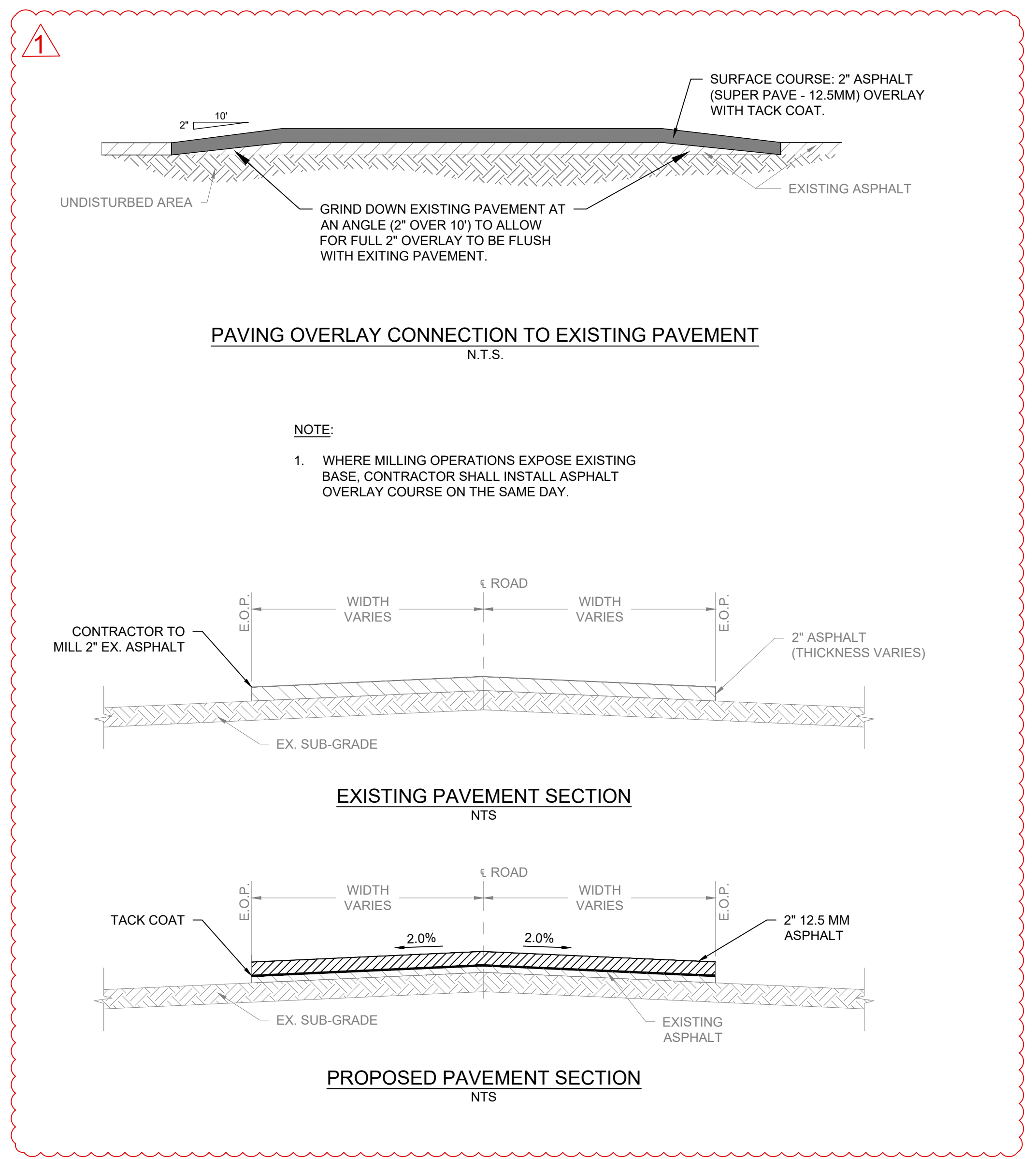
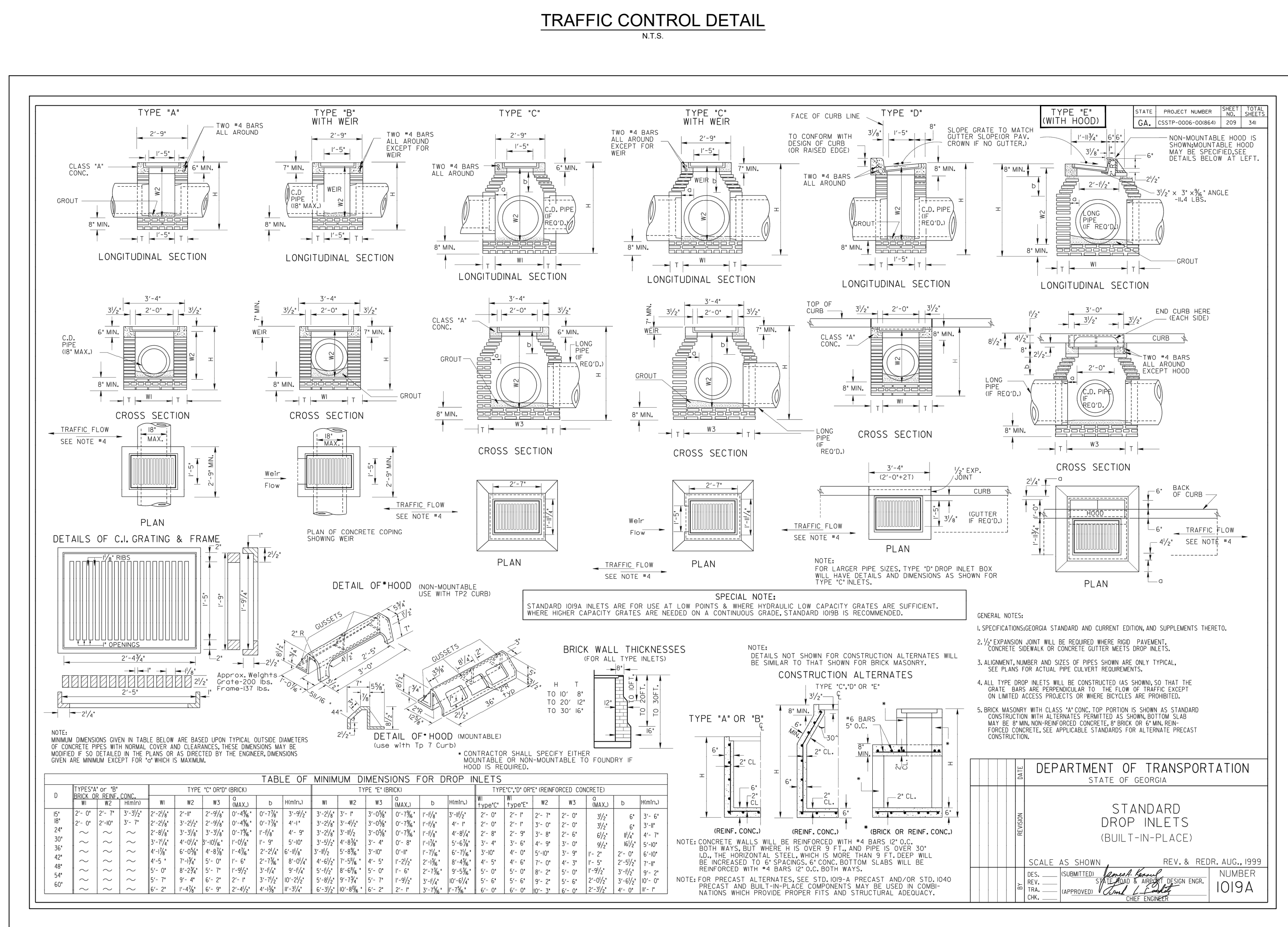
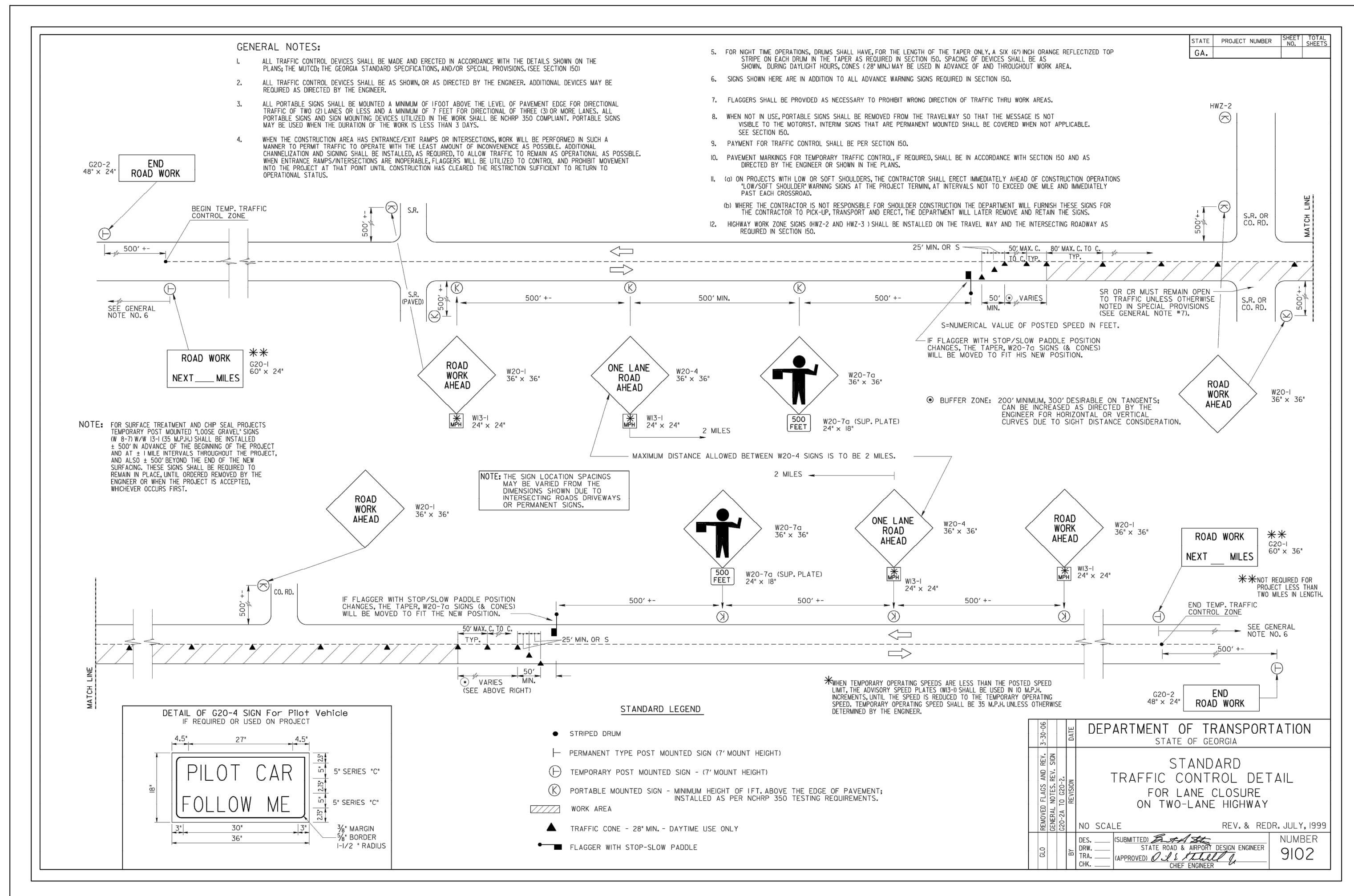

Last Saved By: 03/21/21
 Drawing Path: Z:\Engineer Projects\W3000 - Waycross, City of\W3000.107 - Morningside & Coral Rd\CAD\BASE\C2 DETAILS.dwg
 Plotter: 5/24/2021 1:47 PM
 www.Georgia811.com

