

EDG

ENGINEERING DESIGN GROUP
PELHAM, AL
120 BISHOP CIRCLE SUITE 300
PELHAM, AL 35124
(205) 403-8158
FOLEY, AL
1000 E. LAUREL STREET
FOLEY, AL 36555
(251) 943-8960

ISSUE FOR BID-03/01/2023
REVISIONS

PROJECT ADDRESS:
CITY OF FOLEY
FOLEY, ALABAMA

SHEET TITLE:
GRADING AND DRAINAGE PLAN

PROJECT NAME:
C.R. 12 STORM
DRAIN
REPLACEMENT

DRAWN BY:
CAW
CHECKED BY:
DAD
PROJECT No.:
F_FOLEO010
DATE:
March 1, 2023

SHEET NO.
C2.0

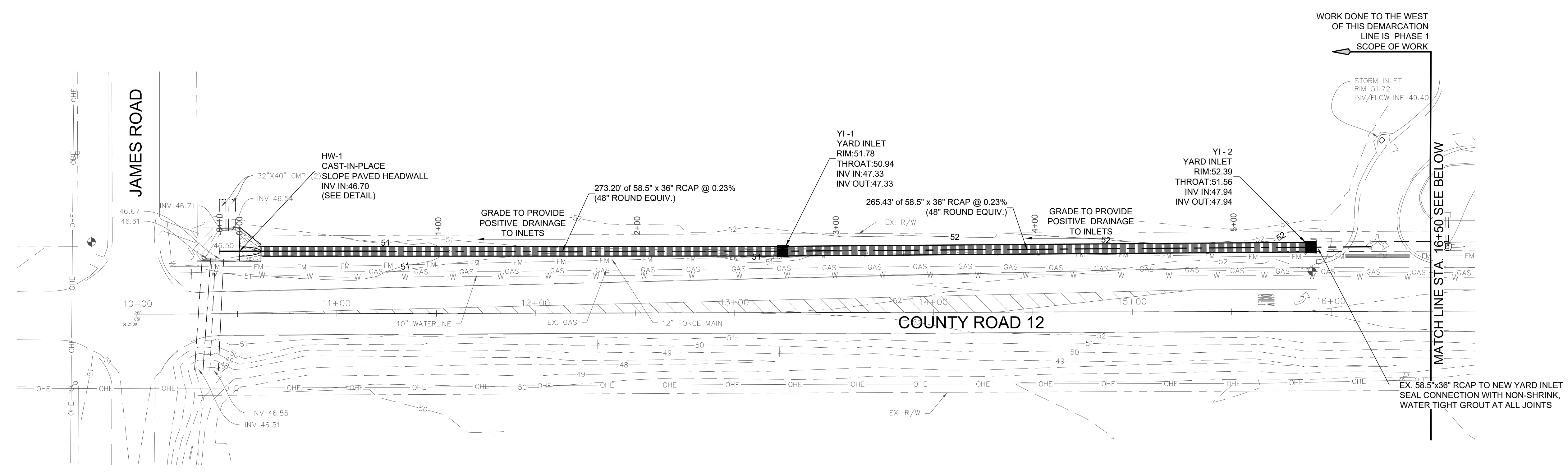

COUNTY ROAD 12
STA 10+00 TO STA 16+50
SCALE: 1" = 30'

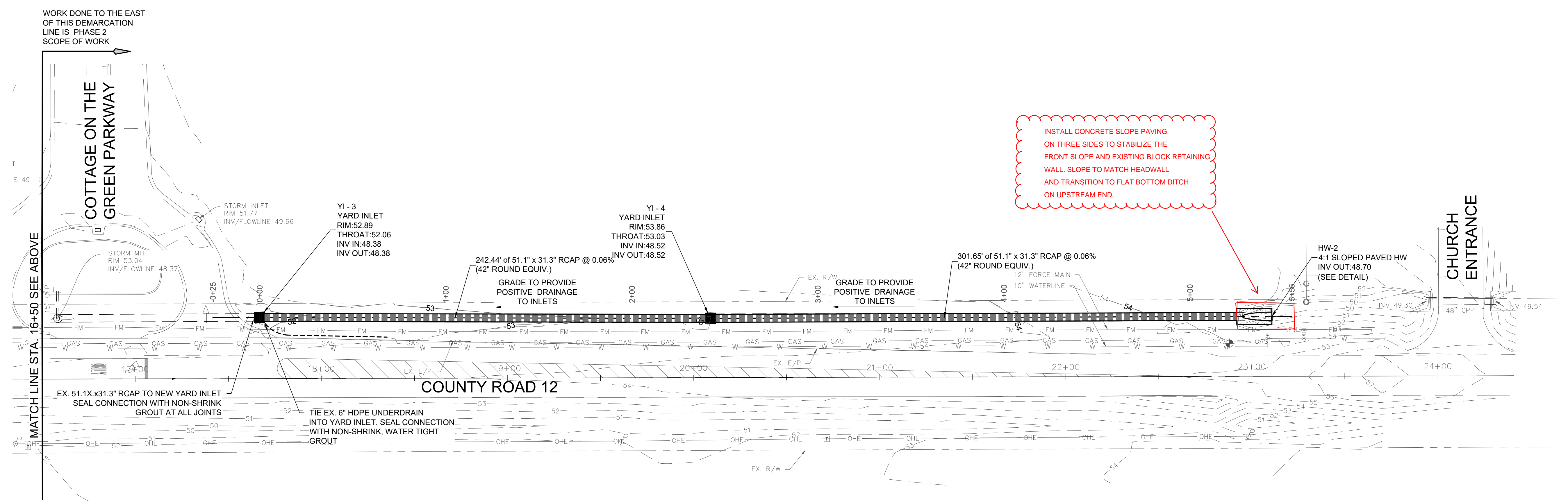

COUNTY ROAD 12
STA 16+50 TO STA 24+00
SCALE: 1" = 30'

INSTALL CONCRETE SLOPE PAVING
ON THREE SIDES TO STABILIZE THE
FRONT SLOPE AND EXISTING BLOCK RETAINING
WALL. SLOPE TO MATCH HEADWALL
AND TRANSITION TO FLAT BOTTOM DITCH
ON UPSTREAM END.

- NOTES:
- SEE SHEET C0.2 FOR GENERAL STORM & GRADING NOTES.
 - SEE SHEET C2.1 FOR STORM PROFILES & ADDITIONAL INFORMATION.
 - ALL NEW STORM PIPE JOINTS SHALL BE FULLY WRAPPED WITH FILTER FABRIC. OVERLAP FABRIC ON ITSELF A MINIMUM OF 24" AND EXTEND FABRIC 18" BEYOND JOINT ON BOTH SIDES OF JOINT.

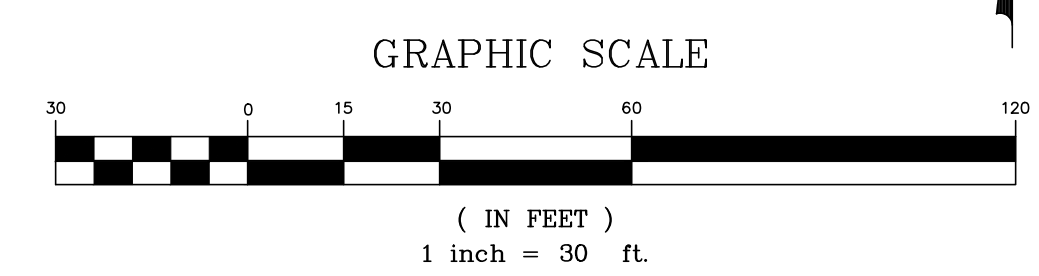

T:_F_01E0010 - COUNTY ROAD 12 STORM DRAIN REPLACEMENT\ENGINEERING\DWG\PLAN.DWG - last plotted 3/1/23 by CHRIS WALLIS