

**PURCHASING
AND MATERIALS
MANAGEMENT**



**City of Myrtle Beach
SOUTH CAROLINA**

**(843) 918-2170
FAX: (843) 918-2182
www.cityofmyrtlebeach.com**

**Addendum #3
April 24, 2017**

**Proposal #17-B0046
Wither Swash Trail Project**

Attached is the approved SCDOT Encroachment permit and the Modified Plans.

The following changes have been made to the Plans:

- 1) Bollards have been moved out of the R/W.
- 2) A note was added to the Site Plan, C4: ****Notes: 1) No work shall be done in R/W until the Pre-Construction meeting is Complete. 2) All pavement marking in the SCDOT R/W SHALL be thermoplastic and installed according to current SCDOT Standards and Specifications.**

The following changes have been made to the Specifications:

Engineer's Supplementary Conditions
Page 0650-2, Line Item 1.14

(OLD)

1.14 LIST OF DRAWINGS: The following drawings are included as part of this contract:

Sheet: C1- Cover Sheet
Sheet: C2- Notes Sheet
Sheet: C3- Existing Conditions & Demolition Plan
Sheet: C4- Initial Sediment & Erosion Control Plan
Sheet: C5- Site Plan
Sheet: C6- Grading & Drainage Plan
Sheet: C7- Plan & Profile Main Trail
Sheet: C8- Plan & Profile Boardwalk
Sheet: C9- Intermediate Sediment & Erosion Control Plan
Sheet: C10- Final Stabilization
Sheet: C11- Boardwalk Details (Sheet 1 of 2)
Sheet: C12- Boardwalk Details (Sheet 2 of 2)
Sheet: C13- SCDOT Details
Sheet: C14- Construction Details
Sheet: E1- Site Electrical Plan (Rast Dallery)
Sheet: E2- Boardwalk Electrical Plan (Rast Dallery)

**PURCHASING
AND MATERIALS
MANAGEMENT**



**City of Myrtle Beach
SOUTH CAROLINA**

**(843) 918-2170
FAX: (843) 918-2182
www.cityofmyrtlebeach.com**

Addendum #3 Continued

(NEW)

1.14 LIST OF DRAWINGS: The following drawings are included as part of this contract:

- Sheet: C1- Cover Sheet**
- Sheet: C2- Notes Sheet**
- Sheet: C3- Existing Conditions & Demolition Plan**
- Sheet: C4- Initial Sediment & Erosion Control Plan**
- Sheet: C5- Site Plan**
- Sheet: C6- Grading & Drainage Plan**
- Sheet: C7- Plan & Profile Main Trail**
- Sheet: C8- Plan & Profile Boardwalk**
- Sheet: C9- Intermediate Sediment & Erosion Control Plan**
- Sheet: C10- Final Stabilization**
- Sheet: C11- Boardwalk Details (Sheet 1 of 2)**
- Sheet: C12- Boardwalk Details (Sheet 2 of 2)**
- Sheet: C13- SCDOT Details (Sheet 1 of 2)**
- Sheet: C14- SCDOT Details (Sheet 2 of 2)**
- Sheet: C15- Construction Details**
- Sheet: E1- Site Electrical Plan (Rast Dallery)**
- Sheet: E2- Boardwalk Electrical Plan (Rast Dallery)**

**SOUTH CAROLINA DEPARTMENT OF TRANSPORTATION
Encroachment Permit**

Permit No : 202085

Permit Decision Date :
4/21/2017

Expiration Date : 4/21/2018

Type Permit :ROAD
CONNECTION (NON
DRIVEWAY)

Location:

<u>District</u>	<u>Work County</u>	<u>Type</u>	<u>Route</u>	<u>Aux</u>	<u>Begin MP</u>	<u>End MP</u>
5	Horry, SC	S-	293	None	0.010	0.010

Contact Information

Applicant: CityofMyrtleBeach

Phone:

Contact: Chris Mill

Address: PO BOX 2468,

City: Myrtle Beach

State: SC

Zip: 99577

Comments

This work will be done at the intersection of Withers Swash Dr and 2nd Ave S.

Special Provisions:

0005 - APPLICANT SHALL PROVIDE TO THE DEPARTMENT THE OPPORTUNITY OF ATTENDING ANY PRE-CONSTRUCTION MEETING PRIOR TO THE BEGINNING OF WORK.

0123 - ALL WORK PERFORMED IN CONNECTION WITH THIS PERMIT SHALL CONFORM TO THE SCDOT "A POLICY FOR ACCOMODATING UTILITIES ON HIGHWAY RIGHT-OF-WAY" MOST CURRENT EDITION.

0203 - ENTIRE WIDTH OF SIDEWALK TO BE REMOVED AND DISPOSED OF OFF RIGHT-OF-WAY. SIDEWALK TO BE REPLACED USING CLASS 2500 CONCRETE, 4" THICK, AND FINISHED TO SCDOT SPECIFICAIONS.

0204 - SIDEWALK OR CURB AND GUTTER REMOVAL SHALL BE REPLACED FROM JOINT TO JOINT.

0210 - ALL SIDEWALKS TO INCLUDE AT DRIVEWAY RADIUS SHALL MEET (ADAAG) AMERICANS WITH DISABILITIES ACT ACCESSIBILITY GUIDELINES.

0301 - THE DITCHES AND/OR SHOULDERS DISTURBED DURING THE INSTALLATION SHALL BE RE-ESTABLISHED TO PROPER GRADE, ORIGINAL CROSS SECTION, STABILIZED, AND ALL DRAIN PIPES CLEARED.

0307 - NO PART OF THE TRAVEL-WAY IS TO BE BLOCKED DURING CONSTRUCTION AND MAINTENANCE.

0306 - TRAFFIC CONTROL, LIGHTS, SIGNS AND FLAG-MEN WILL BE FURNISHED BY APPLICANT AND WILL CONFORM TO PART VI OF THE

MANUAL ON UNIFORM TRAFFIC CONTROL DEVICES.

0312 - THE PERMITTEE SHALL HOLD THE DEPARTMENT HARMLESS FOR DAMAGES TO BOTH UPSTREAM AND DOWNSTREAM PROPERTIES.

0318 - THE APPLICANT SHALL BE RESPONSIBLE FOR IMMEDIATE REMOVAL OF SUCH TRAFFIC HAZARDS AS MUD, DEBRIS, LOOSE STONE, AND TRASH AS MAY BE WASHED OR SPILLED ON THE TRAVELED ROADWAY AS A RESULT OF THE PROPOSED WORK.

0004 - SCDOT SHALL BE NOTIFIED WHEN WORK DEFINED IN THE PERMIT STARTS AS WELL AS WHEN THE WORK IS COMPLETED. REFERENCE SHALL BE MADE BY PERMIT NUMBER.

NOT BE USED AS A BASIS FOR ANY OTHER PROJECTS OR FOR ANY OTHER PURPOSES WITHOUT THE WRITTEN CONSENT OF 4D ENGINEERING, LLC.



SITE IMPROVEMENTS FOR WITHERS SWASH TRAIL LOCATED IN MYRTLE BEACH, SC

PREPARED FOR
CITY OF MYRTLE BEACH

PREPARED BY
4D ENGINEERING



REVISIONS		
#	DESCRIPTION	DATE

4D ENGINEERING
CIVIL ENGINEERING
WWW.4DENGR.COM

PROJECT
WITHERS SWASH TRAIL
MYRTLE BEACH, SC

SCALE: NTS
PROJ NO: 18048
C1
FEBRUARY 17, 2017

LOCATION MAP

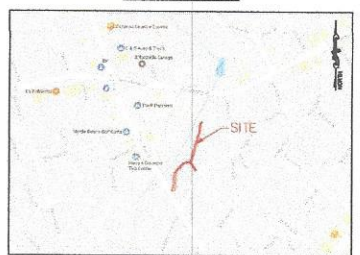

SCALE: 1"=400'

DRAWING INDEX

- C1 - COVER
- C2 - NOTES SHEET
- C3 - EXISTING CONDITIONS & DEMOLITION PLAN
- C4 - INITIAL SEDIMENT & EROSION CONTROL PLAN
- C5 - SITE PLAN
- C6 - GRADING & DRAINAGE PLAN
- C7 - PLAN & PROFILE MAIN TRAIL
- C8 - PLAN & PROFILE BOARDWALK
- C9 - INTERMEDIATE SEDIMENT & EROSION CONTROL PLAN
- C10 - FINAL STABILIZATION PLAN
- C11 - BOARDWALK DETAILS (SHEET 1 OF 2)
- C12 - BOARDWALK DETAILS (SHEET 2 OF 2)
- C13 - SCDOT DETAILS (SHEET 1 OF 2)
- C14 - SCDOT DETAILS (SHEET 2 OF 2)
- C15 - CONSTRUCTION DETAILS
- E1 - SITE ELECTRICAL PLAN
- E2 - BOARDWALK ELECTRICAL PLAN

3 DAYS BEFORE OCCUPANCY IN
SOUTH CAROLINA
CALL 1-888-721-7877
Permit's Library Protection Service

OWNER/DEVELOPER
CITY OF MYRTLE BEACH
P.O. BOX 2488
MYRTLE BEACH, SC 29576
(843) 919-2000

ENGINEER
4D ENGINEERING, LLC
602 S LAKE DRIVE
LINDSEY PARK, SC 29517
(843) 538-0500
4DENGR@4DENGR.COM

NOTES:

1. ALL ITEMS NOT SHOWN TO BE REMOVED SHALL BE PROTECTED IN PLACE.
2. TREES TO BE REMOVED IN THE VICINITY OF THE WETLAND AREA SHALL BE CUT FLUSH WITH GRADE.

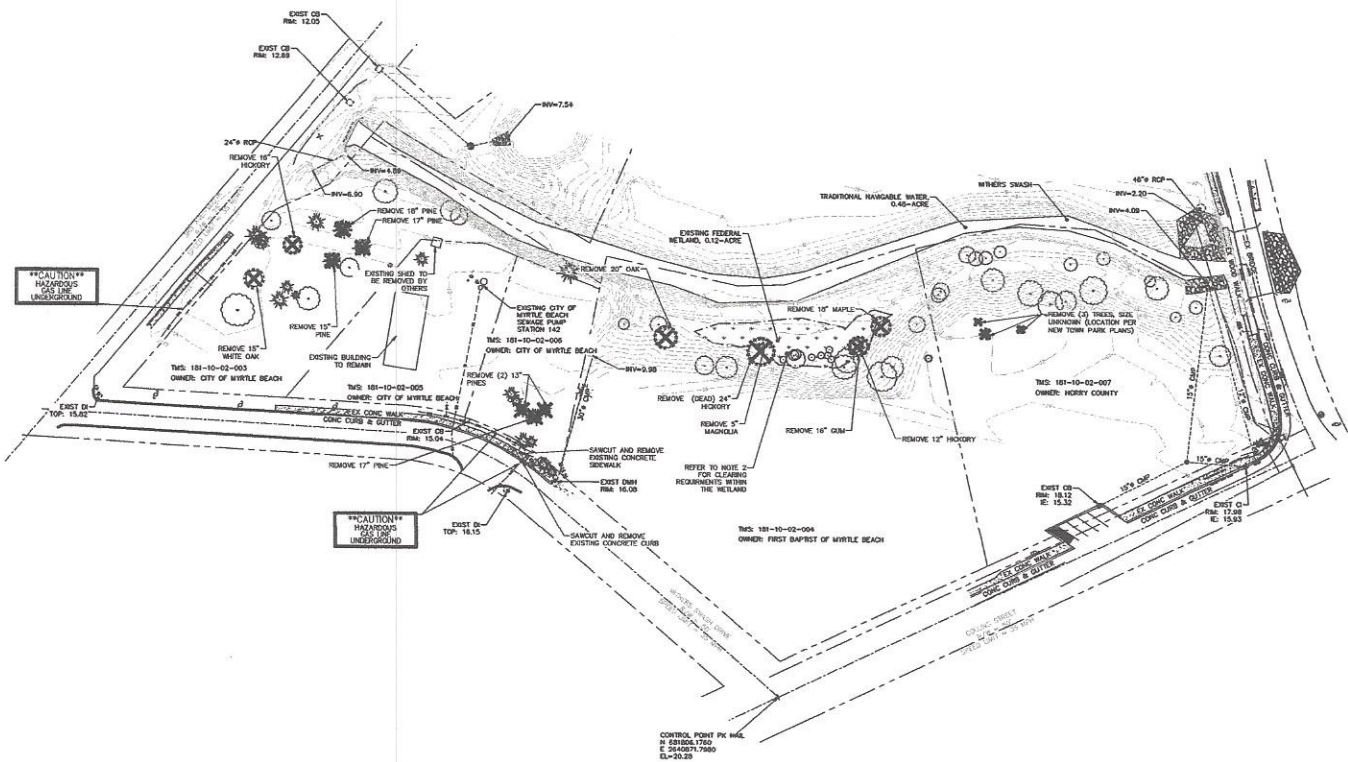

3 DAYS BEFORE DIGGING IN SOUTH CAROLINA
CALL 1-888-721-7877
Myrtle Utility Protection Service

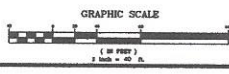

4D
ENGINEERING
"SUPERIOR COMPREHENSIVE
ENGINEERING SOLUTIONS"
WWW.4DENGR.COM
CIVIL ENGINEERING



NO.	DESCRIPTION	DATE

SHEET
EXISTING CONDITIONS &
DEMOLITION PLAN

PROJECT
WITHERS SWASH TRAIL
MYRTLE BEACH, SC

SCALE: 1"=40'
PROJ. NO: 10045
C3
FEBRUARY 17, 2017

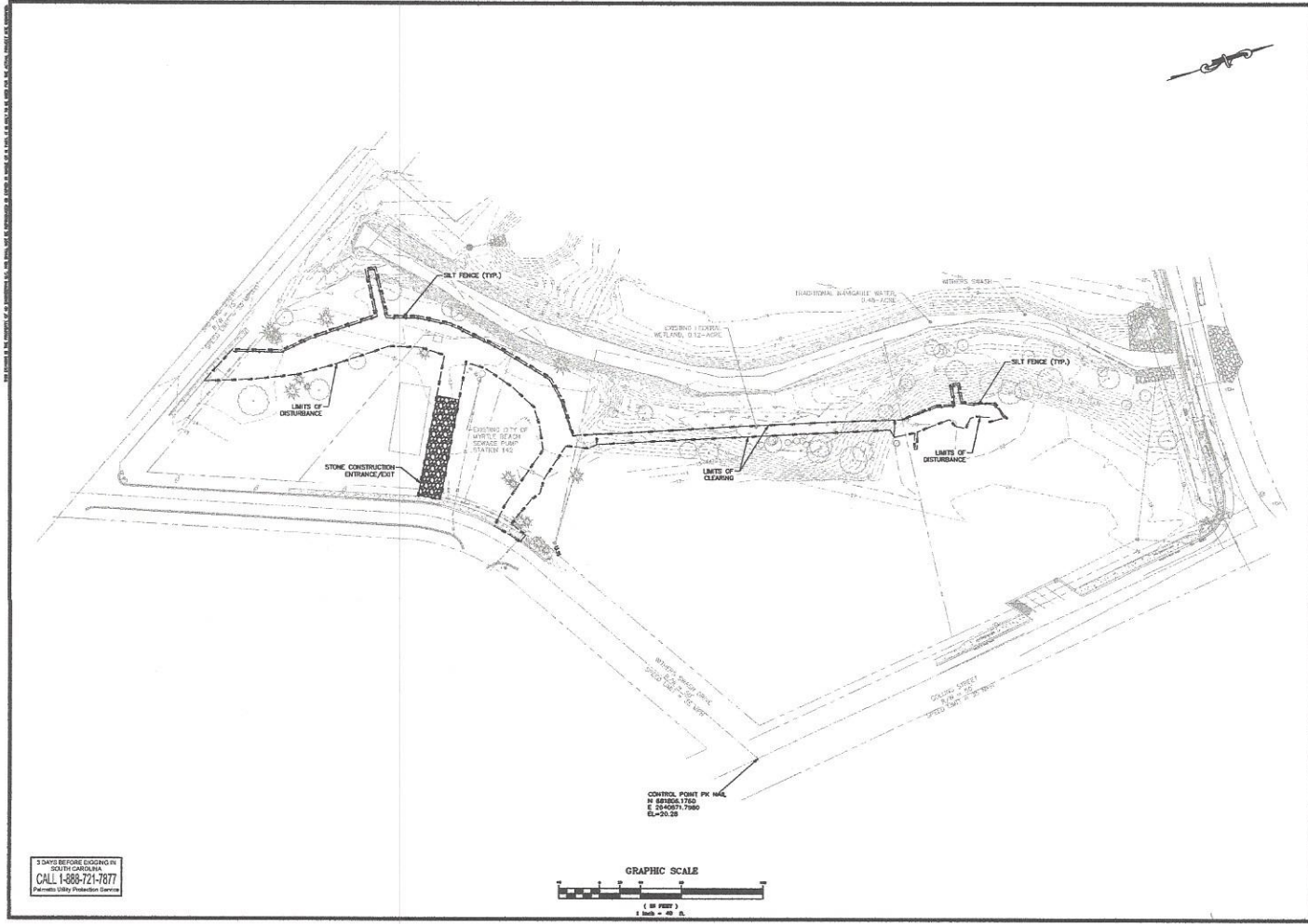

4D ENGINEERING
 "SUPERIOR COMPREHENSIVE ENGINEERING SOLUTIONS"
 WWW.4DENGR.COM
 CIVIL ENGINEERING

Professional Engineer Seal: State of South Carolina, License No. 4311

Professional Engineer Seal: State of South Carolina, License No. 4311

REVISIONS		
#	DESCRIPTION	DATE

SHEET: INITIAL SEDIMENT & EROSION CONTROL PLAN

PROJECT: WITHERS SWASH TRAIL MYRTLE BEACH, SC

SCALE: 1"=40'

PROJ. NO: 16048

C4

FEBRUARY 17, 2017

3 DAYS BEFORE DIGGING IN
 SOUTH CAROLINA
 CALL 1-800-721-7877
 Permitting Utility Professionals Services

ALL DIMENSIONS ARE UNLESS OTHERWISE SPECIFIED IN FEET AND INCHES. DIMENSIONS SHALL BE TO FACE UNLESS OTHERWISE NOTED. DIMENSIONS SHALL BE TO FACE UNLESS OTHERWISE NOTED. DIMENSIONS SHALL BE TO FACE UNLESS OTHERWISE NOTED.

- BID DEDUCTS**
1. BID DEDUCT 1- DOWNSIZE THE BOARDWALK, BOARDWALK RAMP, AND CONCRETE LANDING FROM 8' WIDE TO 6' WIDE.
 2. BID DEDUCT 2- IN ADDITION TO THE ABOVE DEDUCT REDUCE SHARED USE PATHWAY NORTH FROM 8' WIDE TO 6' WIDE.
 3. BID DEDUCT 3- ELIMINATE THE TRAIL NORTH OF THE BOARDWALK.
 4. BID DEDUCT 4- ELIMINATE THE BOARDWALK, BOARDWALK RAMP, AND CONCRETE LANDING. SEE DEDUCT 4 AREA BELOW.
 5. BID DEDUCT 5- USE ALL GALVANIZED HARDWARE INSTEAD OF STAINLESS STEEL HARDWARE.

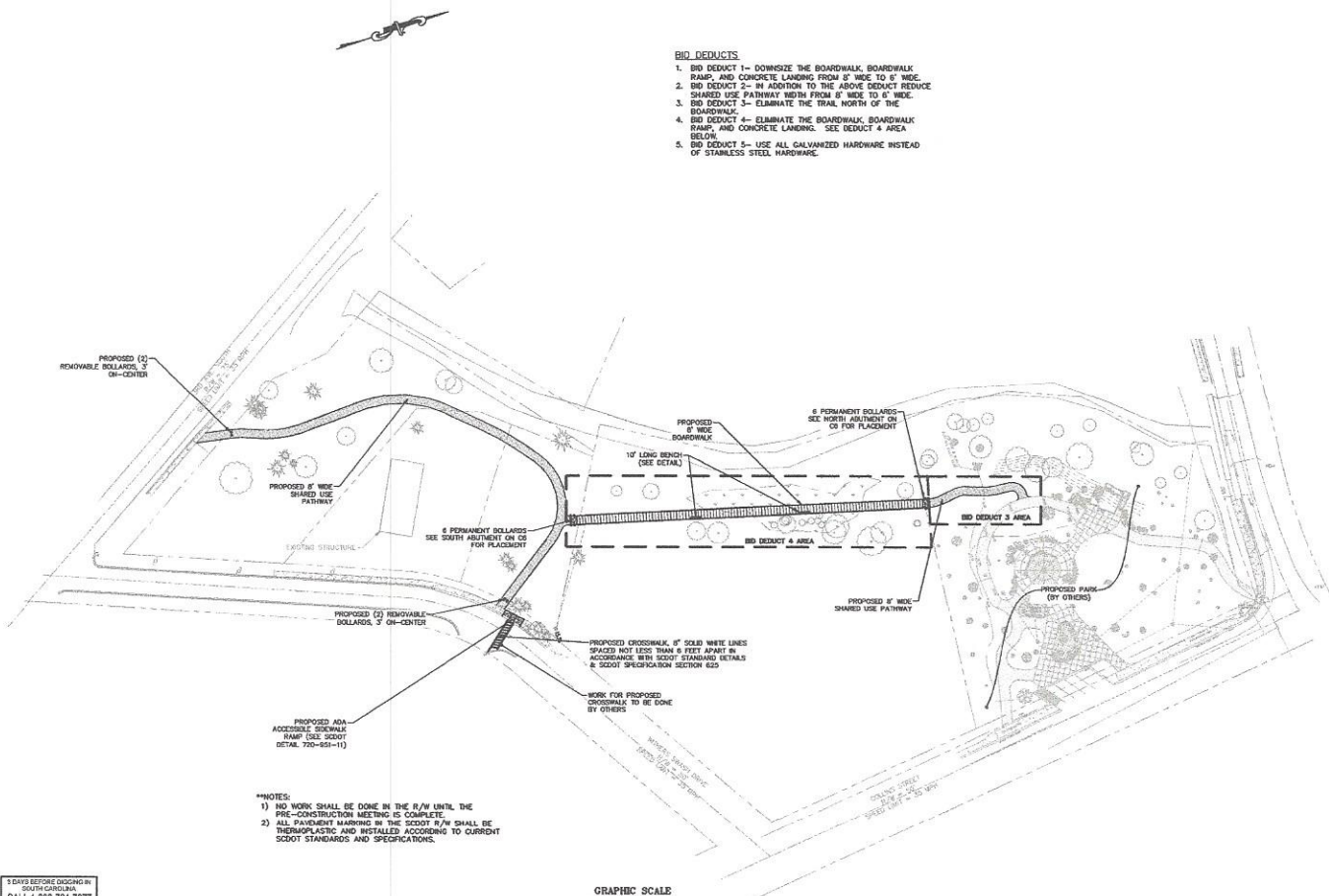

- NOTES:**
- 1) NO WORK SHALL BE DONE IN THE R/W UNTIL THE PRE-CONSTRUCTION MEETING IS COMPLETE.
 - 2) ALL PAVERS/PAVING IN THE SCOOT R/W SHALL BE THERMOPLASTIC AND INSTALLED ACCORDING TO CURRENT SCOOT STANDARDS AND SPECIFICATIONS.

3 DAYS BEFORE BIDDING IN
 SOUTH CAROLINA
 CALL 1-800-721-7877
 Professional Engineering Services

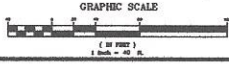

4D
ENGINEERING
 "SUPERIOR CONSTRUCTION ENGINEERING SOLUTIONS"
 WWW.4DENGR.COM
 CIVIL ENGINEERING



REVISIONS		
#	DESCRIPTION	DATE

SHEET
SITE PLAN

PROJECT
**WITHERS SWASH TRAIL
 MYRTLE BEACH, SC**

SCALE: 1"=40'
 PROJ NO: 16068
C5
 FEBRUARY 17, 2017

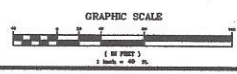
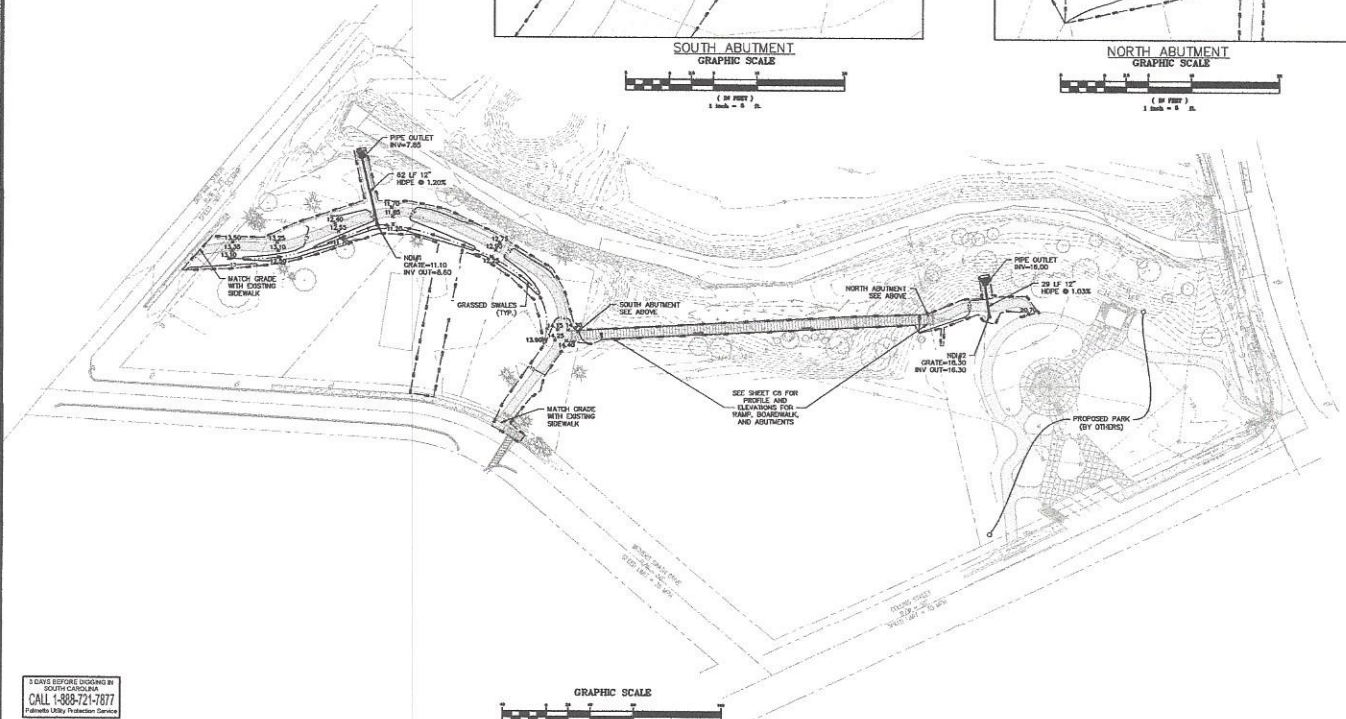
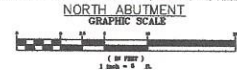
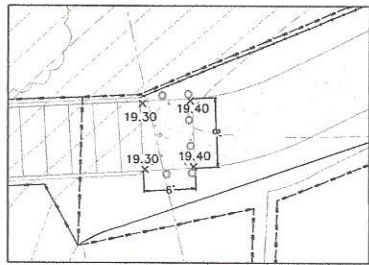
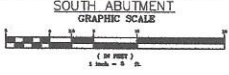
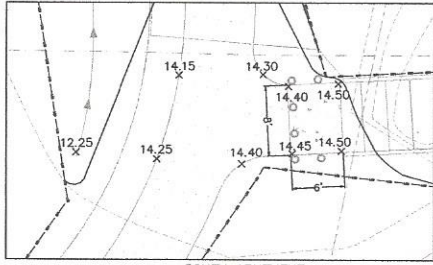

4D
ENGINEERING
"SUPERIOR CONSERVATIVE
ENGINEERING SOLUTIONS"
WWW.4DENGINEER.COM
CIVIL ENGINEERING



REVISIONS		
#	DESCRIPTION	DATE
1	PROPOSED CONCEPT	02/17/17

SHEET
GRADING & DRAINAGE PLAN

PROJECT
WITHERS SWASH TRAIL
MYRTLE BEACH, SC

SCALE AS SHOWN
PROJECT NO. 16048
C6
FEBRUARY 17, 2017

5 DAYS BEFORE DRAINING IN
SOUTH CAROLINA
CALL 1-888-721-7877
Palmetto Utility Television Service

1. THE INFORMATION CONTAINED HEREIN IS THE PROPERTY OF 4D ENGINEERING, INC. AND SHALL NOT BE REPRODUCED, COPIED, OR TRANSMITTED IN ANY FORM OR BY ANY MEANS, ELECTRONIC OR MECHANICAL, WITHOUT THE WRITTEN PERMISSION OF 4D ENGINEERING, INC.

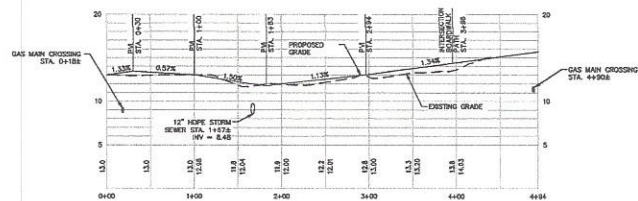
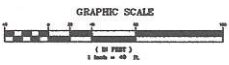
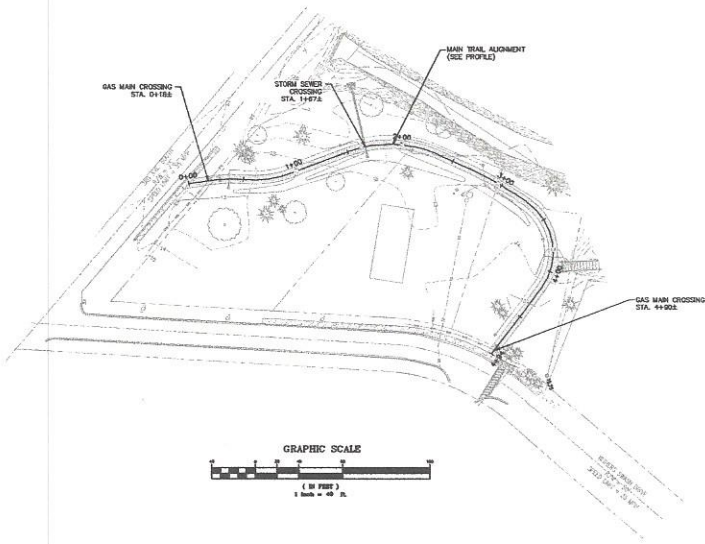

MAIN TRAIL PROFILE
 SCALE: HORIZONTAL: 1"=20'
 VERTICAL: 1"=5'

4D
ENGINEERING
 "SUPERIOR QUALITY ENGINEERING SOLUTIONS"
 WWW.4DENGINE.COM
 CIVIL ENGINEERING



REVISIONS		
NO.	DESCRIPTION	DATE
1	PREPARED FOR SUBMITTAL	02/17/17

SHEET
**PLAN & PROFILE
 MAIN TRAIL**

PROJECT
**WITHERS SWASH TRAIL
 MYRTLE BEACH, SC**

SCALE: AS SHOWN
 PROJ NO: 16940

C7
 FEBRUARY 17, 2017

3 DAYS BEFORE DEDING IN
 SOUTH CAROLINA
 CALL 1-888-724-7877
 Professional Liability Protection Services

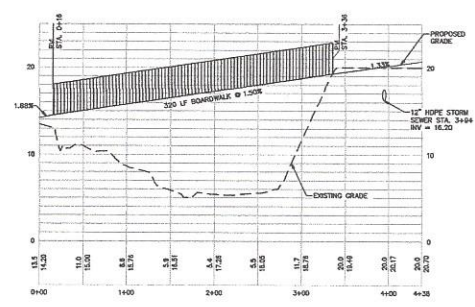
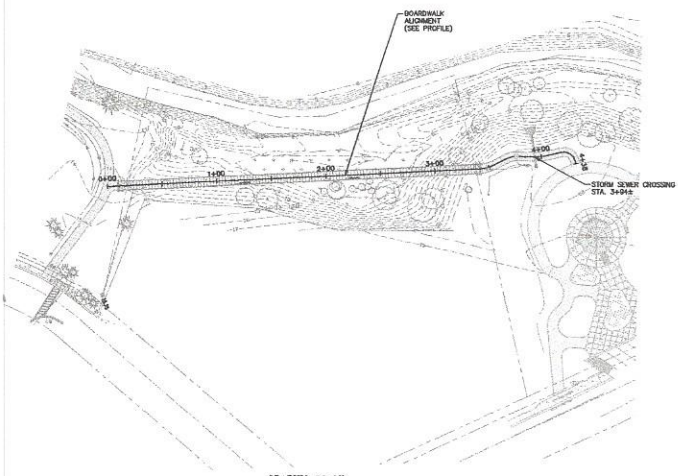

BOARDWALK PROFILE
SCALE: HORIZONTAL 1"=50'
VERTICAL 1"=5'

NOTES:
1. FOR BOARDWALK HEIGHTS GREATER THAN 5', USE CROSS BRACING BETWEEN PILES. SEE POST CROSS GRADE DETAIL ON SHEET C11.

4D
ENGINEERING
"SUSTAINABLE COURTESY. RESOLVE
ENGINEERING SOLUTIONS"
WWW.4DENG.COM
CIVIL ENGINEERING



REVISIONS		
#	DESCRIPTION	DATE

SHEET
**PLAN & PROFILE
BOARDWALK**

PROJECT
**WITHERS SWASH TRAIL
MYRTLE BEACH, SC**

SCALE: AS SHOWN
PRJ# NO: 16048
C8
FEBRUARY 17, 2017

3 DAYS BEFORE DIGGING IN
SCAFFOLDING
CALL 1-888-721-7877
Palmetto Utility Protection Service

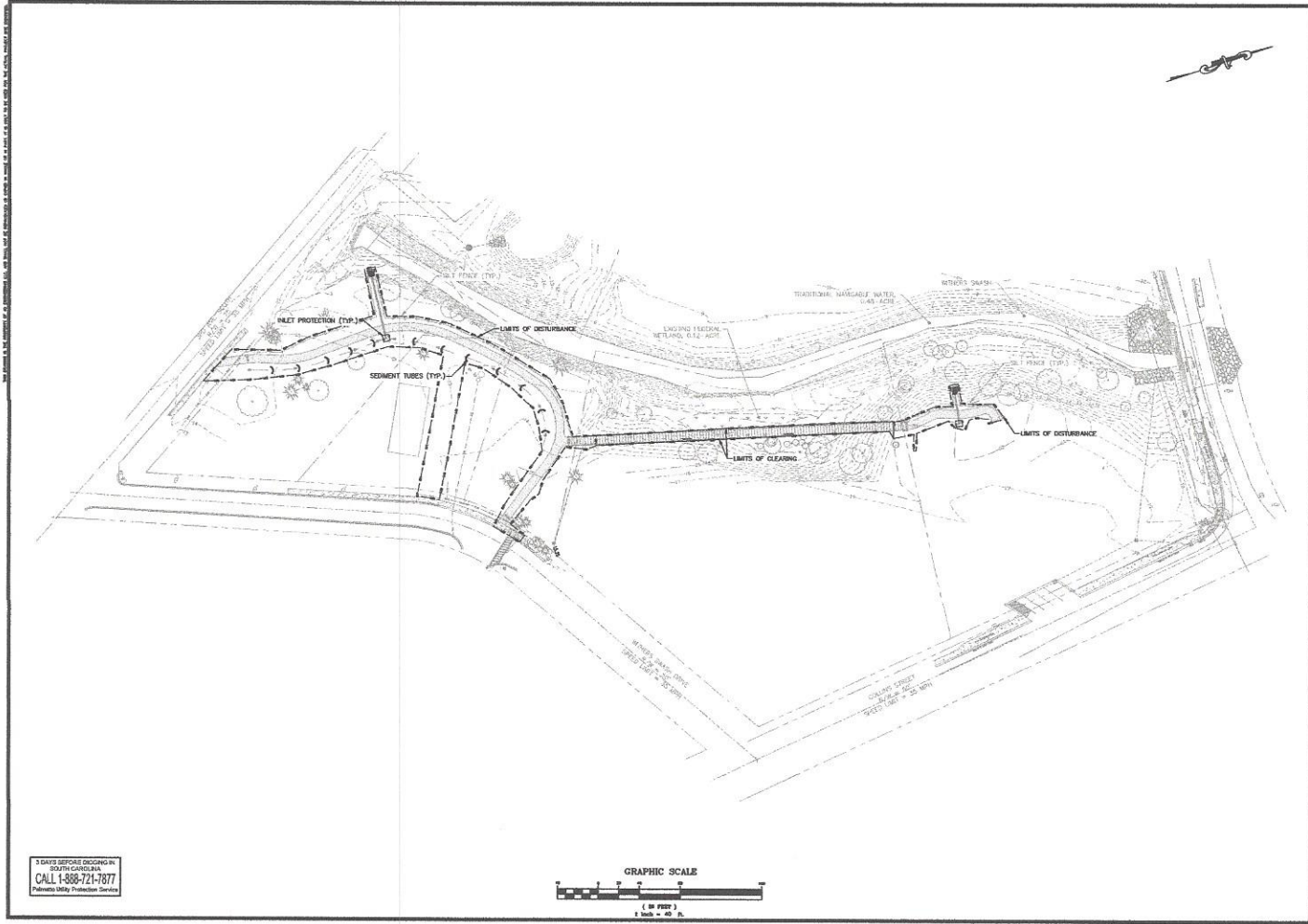

4D
ENGINEERING
 "SUPERIOR COMPREHENSIVE
 ENGINEERING SOLUTIONS"
 WWW.4DENFOR.COM
 CIVIL ENGINEERING



REVISIONS		
#	DESCRIPTION	DATE

SHEET
**INTERMEDIATE SEDIMENT &
 EROSION CONTROL PLAN**

PROJECT
**WITHERS SWASH TRAIL
 MYRTLE BEACH, SC**

SCALE: 1"=40'
 PROJ NO: 19048
C9
 FEBRUARY 17, 2017

3 DAYS BEFORE DECING IN
 SOUTH CAROLINA
 CALL 1-800-721-1877
 Professional Firm Registration Services

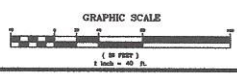

NOTE:

1. ALL DISTURBED AREAS SHALL BE GRASSED WITH PERMANENT STABILIZATION.

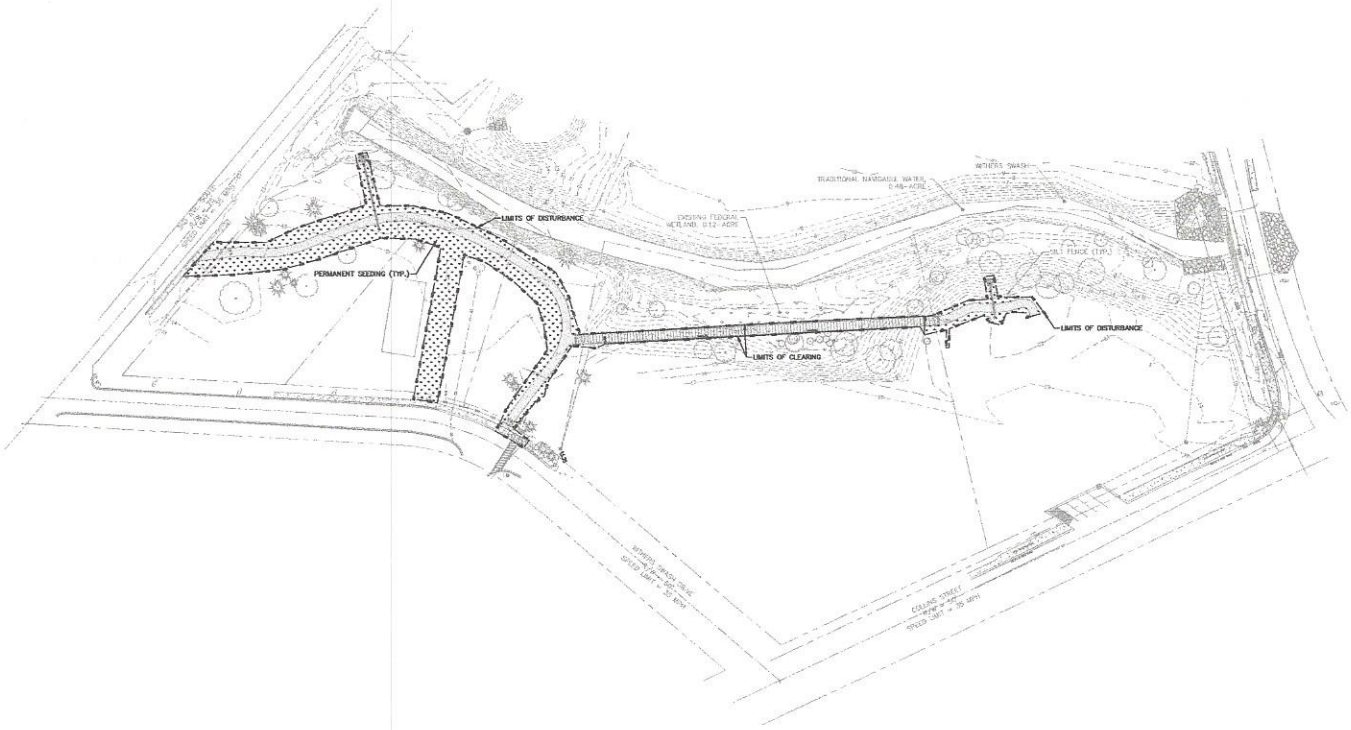

3 DAYS BEFORE CONSTRUCTION IN SOUTH CAROLINA
 CALL 1-868-721-7877
 Palmetto Utility Protection Services

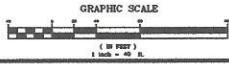

4D
ENGINEERING
 "SUPERIOR COMPREHENSIVE
 ENGINEERING SOLUTIONS"
 WWW.4DENG.COM
 CIVIL ENGINEERING



REVISIONS		
NO.	DESCRIPTION	DATE
1	PROPOSED ENGINEERING	02/17/17

SHEET
FINAL STABILIZATION PLAN

PROJECT
**WITHERS SWASH TRAIL
 MYRTLE BEACH, SC**

SCALE: 1"=40'
 PROJ NO: 10248
C10
 FEBRUARY 17, 2017

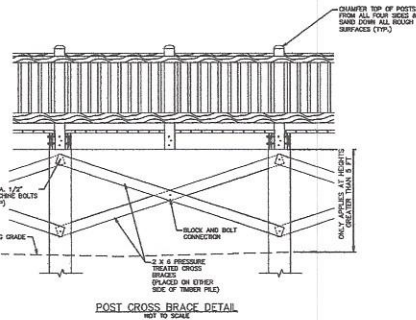

*CROSS BRACING DETAIL ONLY APPLIES AT HEIGHTS GREATER THAN 5 FEET.

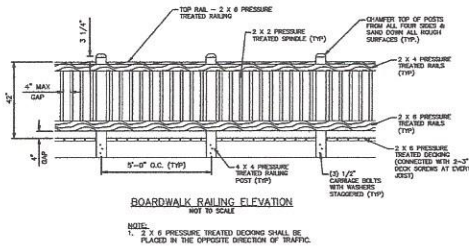

NOTE: 2 x 6 PRESSURE TREATED BEAM SHALL BE PLACED IN THE OPPOSITE DIRECTION OF BRACING.

- BOARDWALK NOTES:**
1. ALL WORK AND MATERIALS REQUIRED TO INSTALL TIMBER PILES, TIMBER BOARDWALKS, AND TIMBER BENCH AS SHOWN, WILL BE PAID FOR AS BOARDWALK PAY ITEM.
 2. PAYMENT FOR ALL CROSS BRACING BASED ON EXPOSED HEIGHT INCLUDED IN BOARDWALK PAY ITEM.
 3. ALL LUMBER MATERIALS SHALL BE PRESSURE TREATED WITH AN APPROVED PROCESS AND PRESERVATION BY ACCORDANCE WITH AMERICAN WOOD PROTECTION ASSOCIATION STANDARDS, SUITABLE FOR GROUND CONTACT.
 4. ALL LUMBER SHALL BE IDENTIFIED BY THE GRADE MARK OF OR CERTIFICATE OF INSPECTING AGENCY.
 5. ALL LUMBER SHALL BE SOUTHERN YELLOW PINE, GRADE OF LUMBER AS INDICATED IN THE SPECIAL PROVISIONS WITH PRESERVATION TREATMENT WITH RETENTION LEVEL OF 0.4 (LB/DU.F.T.) OF A0-C-B.
 6. ALL SCREWS, BOLTS, AND NAILS SHALL BE GALVANIZED STEEL.
 7. ALL METAL HARDWARE INCLUDING JOIST HANGERS SHALL BE GALVANIZED STEEL.
 8. ALL NAILS SHALL MEET THE REQUIREMENTS OF ASTM 1067. WOOD SCREWS SHALL MEET THE REQUIREMENTS OF ANSI/APA W1.2.1. TREATED NAILS SHALL INCLUDE HELICAL (SPIRAL) AND ANNULAR (RING-SHANK) NAILS.

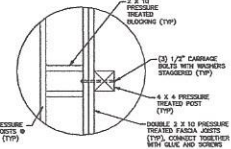

NOTE: 1. CARTRIDGE BOLTS SHALL HAVE A MINIMUM OF 2.0" OF SPACE BETWEEN THE BOLT AND ANY EDGE OF WOOD.

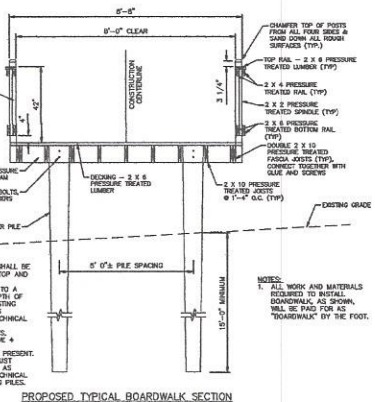

NOTE: 1. ALL WORK AND MATERIALS REQUIRED TO INSTALL, DEMONSTRATE, AS SHOWN, WILL BE PAID FOR AS "BOARDWALK" BY THE FOOT.

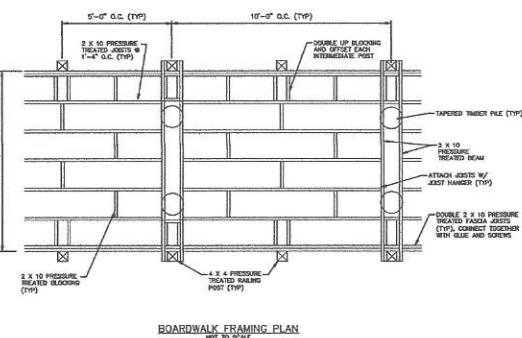

NOTE: 1. CARTRIDGE BOLTS SHALL HAVE A MINIMUM OF 2.0" OF SPACE BETWEEN THE BOLT AND ANY EDGE OF WOOD.

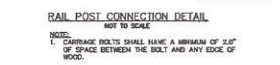

NOTE: 1. CARTRIDGE BOLTS SHALL HAVE A MINIMUM OF 2.0" OF SPACE BETWEEN THE BOLT AND ANY EDGE OF WOOD.

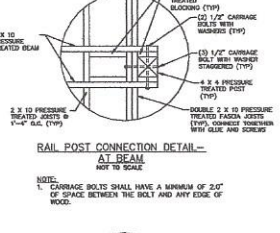

NOTE: 1. CARTRIDGE BOLTS SHALL HAVE A MINIMUM OF 2.0" OF SPACE BETWEEN THE BOLT AND ANY EDGE OF WOOD.

4D ENGINEERING
 "SUPERIOR COMPREHENSIVE ENGINEERING SOLUTIONS"
 WWW.4DENG.COM
 CIVIL ENGINEERING



REVISIONS		
#	DESCRIPTION	DATE
1	FOR BOARDWALK	02/17/2017

PROJECT: BOARDWALK DETAILS (SHEET 1 OF 2)

PROJECT: WITHERS SMASH TRAIL MYRTLE BEACH, SC

SCALE: NTS
 PROJ NO: 16048
C11
 FEBRUARY 17, 2017

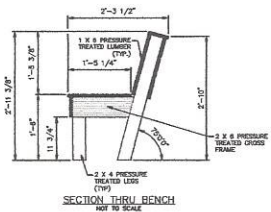
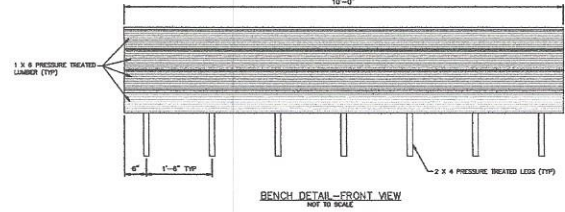
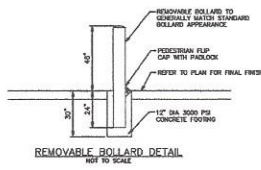
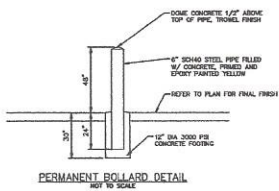
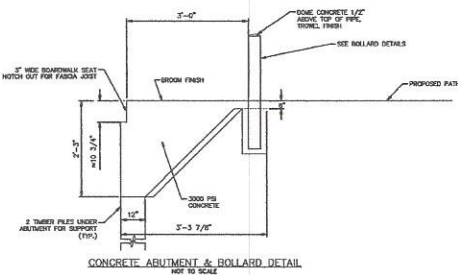

4D

ENGINEERING
 "SUPERIOR CONSTRUCTION
 ENGINEERING SOLUTIONS"
 WWW.4DENGR.COM
 CIVIL.ENG@4D.COM

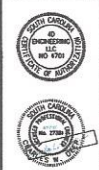

REVISIONS		
#	DESCRIPTION	DATE
1	ISSUED FOR PERMITS	01/28/17

SHEET
BOARDWALK DETAILS
 (SHEET 2 OF 2)

PRODUCT
WITHERS SMASH TRAIL
 MYRTLE BEACH, SC

SCALE: NTS
 PROJ. NO. 16048
C12
 FEBRUARY 17, 2017

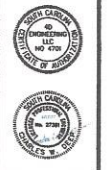
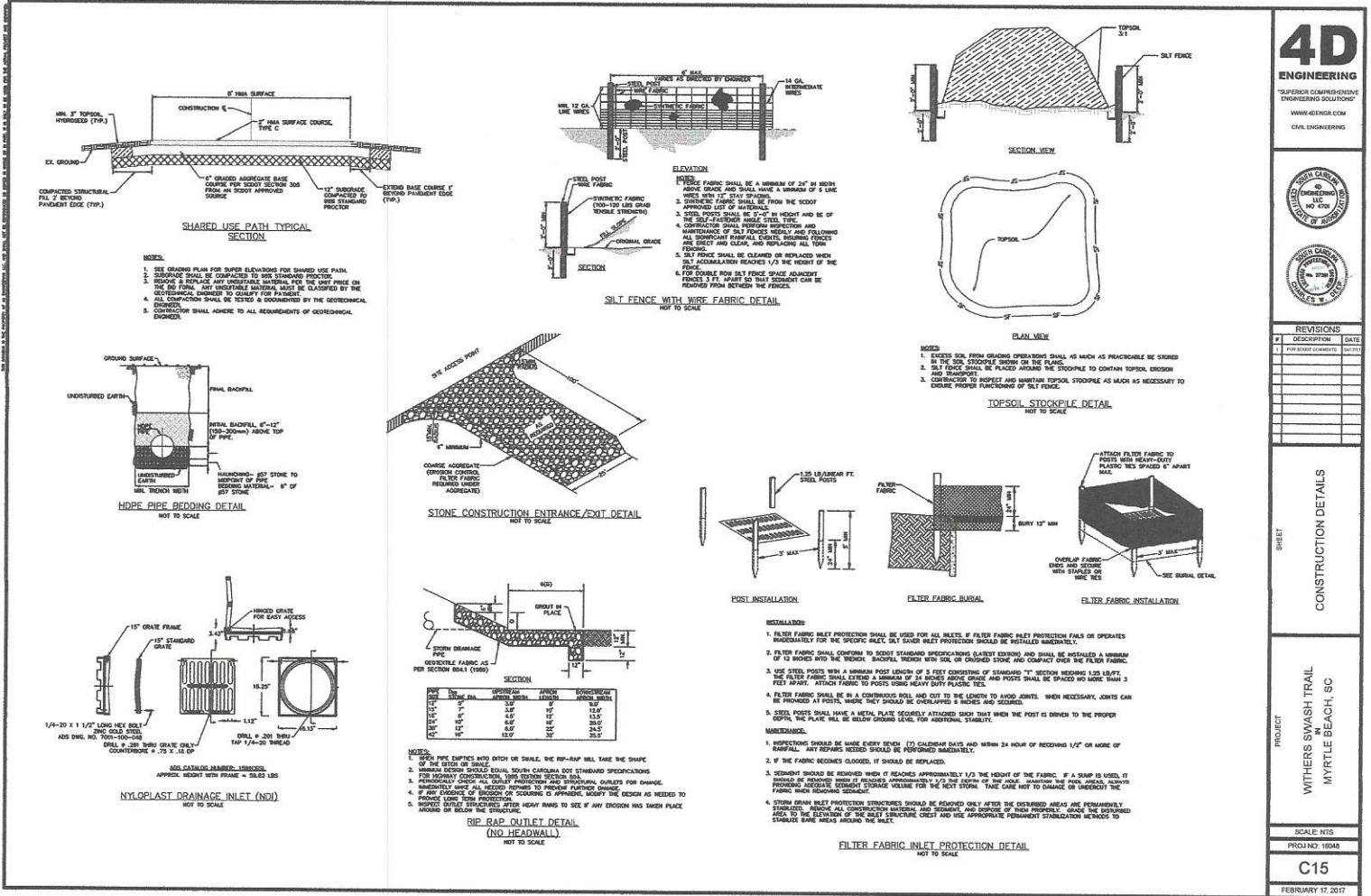

REVISIONS		
#	DESCRIPTION	DATE
1	FOR EXIST COMMENTS	10/1/17

PROJECT: WITHERS SWASH TRAIL
 MYRTLE BEACH, SC