



**HIGHLANDS COUNTY  
BOARD OF COUNTY COMMISSIONERS  
(HCBCC)  
PURCHASING DIVISION**

DATE: 8/30/17

BID NO. ITB 17-039 ADDENDUM No. 1

Project.: MARTIN LUTHER KING JR. BOULEVARD SIDEWALK EXTENSION  
HIGHLANDS COUNTY PROJECT NO. 15005

Owner: Highlands County BCC  
Attn: Purchasing Department  
4320 George Blvd; Sebring, FL 33875-5803

---

The purpose of this addendum is to release a revised set of plans.

This document contains 16 pages.

# CONSTRUCTION PLANS

FOR  
**MARTIN LUTHER KING JR. BOULEVARD SIDEWALK EXTENSION**  
 FROM  
**BOSSIE WATSON AVENUE TO INSPIRATION DRIVE**  
 HIGHLANDS COUNTY PROJECT NO. 15005

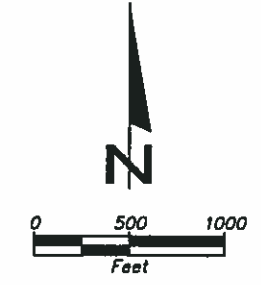
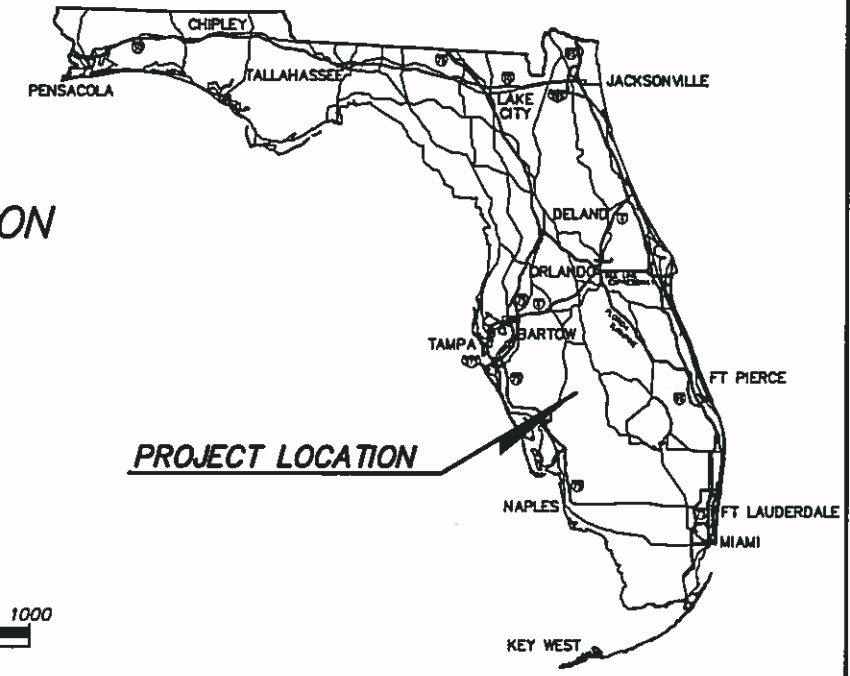

## INDEX OF SIDEWALK PLANS

SHEET NO.	SHEET DESCRIPTION
G-1	COVER SHEET
G-2	GENERAL NOTES
G-3	SUMMARY OF QUANTITIES
G-4	PLAN VIEW - KEY
D-1	SIDEWALK DESIGN PLAN (STA. 112+20 TO STA. 116+60)
D-2	SIDEWALK DESIGN PLAN (STA. 116+60 TO STA. 121+00)
D-3	SIDEWALK DESIGN PLAN (STA. 121+00 TO STA. 125+40)
D-4	SIDEWALK DESIGN PLAN (STA. 125+40 TO STA. 129+80)
D-5	SIDEWALK DESIGN PLAN (STA. 129+80 TO STA. 134+20)
D-6	SIDEWALK DESIGN PLAN (STA. 134+20 TO STA. 138+60)
D-7	SIDEWALK STAKEOUT DATA
D-8	SIDEWALK DETAIL AND NOTES
D-9	SIDEWALK DETAILS
D-10	DRIVEWAY REPLACEMENT CROSS SECTIONS
BMP-1	BEST MANAGEMENT PRACTICES PLAN AND DETAILS



**PROJECT SITE**  
 MARTIN LUTHER KING JR. BLVD.  
 SIDEWALK EXTENSION

LENGTH OF PROJECT		
	LINEAR FEET	MILES
SIDEWALK	2584	0.4894
NET LENGTH OF PROJECT	2584	0.4894
EXCEPTIONS	0	0
GROSS LENGTH OF PROJECT	2584	0.4894

NOTE:  
 THE SCALE OF THESE PLANS MAY HAVE  
 CHANGED DUE TO REPRODUCTION.

PLANS PREPARED BY:  
 WEILER ENGINEERING CORPORATION  
  
 201 WEST MARION AVENUE, SUITE 1306  
 PUNTA GORDA, FLORIDA 33950  
 (941) 505-1700  
 EB NO. 6656

RECEIVED  
 BOARD OF COUNTY COMMISSIONER  
**JUN 22 2017**  
 ENGINEERING DEPT.  
 HIGHLANDS COUNTY, FLORIDA

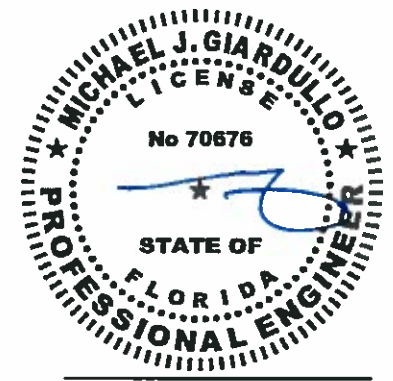

Michael J. Giardullo  
 Professional Engineer  
 State of Florida  
 Registration No. 70676  
 ENGINEER OF RECORD  
 DATE OF SIGNATURE:  
 June 19, 2017

KEY SHEET REVISIONS	
DATE	DESCRIPTION

SHEET  
 NO.  
**G-1**

**GENERAL NOTES**

1. THE CONTRACTOR SHALL REMOVE ALL SILT AND DEBRIS FROM THE INTERIOR OF THE EXISTING STORM PIPES (TO REMAIN) AND SHALL ALSO CLEAN ALL DEBRIS, SILT, TALL GRASS, ETC. A DISTANCE OF 15' EACH SIDE OF THE OPENINGS OF EXISTING STORM PIPES (TO REMAIN).
2. PRIOR TO ALL OVERBUILD PAVEMENT ALL EXPOSED SURFACES SHALL RECEIVE TACK COAT WHICH SHALL BE INCIDENTAL TO THE OVERBUILD. THE CONTRACTOR SHALL ANTICIPATE THE POSSIBILITY OF ISOLATED AREAS WHERE THE BASE WILL BE EXPOSED DURING THE MILLING OPERATION. THESE AREAS WILL NEED TO BE WEATHER PRIMED OR RECEIVE TACK COAT PRIOR TO PAVING. COST OF THIS OPERATION IS CONSIDERED INCIDENTAL TO THE ASPHALT OVERBUILD.
3. BENCHMARK NO. 1 - STA. 115+37.59, 31.79' RT., IRON ROD, ELEV. 135.14 (NAVD 88)  
BENCHMARK NO. 2 - STA. 128+10.46, 32.55' RT., NGS U768, ELEV. 138.16 (NAVD 88)  
BENCHMARK NO. 3 - STA. 135+59.63, 31.46' LT., IRON ROD, ELEV. 139.22 (NAVD 88)
4. ANY PUBLIC LAND CORNER WITHIN THE LIMITS OF CONSTRUCTION IS TO BE PROTECTED. IF A CORNER MONUMENT IS IN DANGER OF BEING DESTROYED AND HAS NOT BEEN PROPERLY REFERENCED, THE CONTRACTOR SHALL NOTIFY THE HIGHLANDS COUNTY ENGINEER.
5. ALL MATERIALS AND INSTALLATION PROCEDURES SHALL BE IN ACCORDANCE WITH THE CURRENT EDITION OF THE FOLLOWING; THE HIGHLANDS COUNTY TECHNICAL STANDARDS MANUAL, THE FLORIDA DEPARTMENT OF TRANSPORTATION STANDARD SPECIFICATIONS FOR ROAD AND BRIDGE CONSTRUCTION AND THE AMERICANS WITH DISABILITIES ACT (ADA).

**TRAFFIC CONTROL NOTES**

1. THE CONTRACTOR SHALL SUBMIT, TO THE HIGHLANDS COUNTY ENGINEER, MAINTENANCE OF TRAFFIC PLANS FOR APPROVAL PRIOR TO THE START OF ANY CONSTRUCTION. ALL APPROVED SIGNAGE, BARRIERS, ETC. SHALL BE IN PLACE PRIOR TO THE START OF CONSTRUCTION.
2. ALL TRAFFIC CONTROLS SHALL BE IN ACCORDANCE WITH THE LATEST EDITION OF THE F.D.O.T. DESIGN STANDARDS (INDEX 600 SERIES), THE LATEST EDITION SPECIFICATIONS OF HIGHLANDS COUNTY AND THE LATEST EDITION STANDARD SPECIFICATIONS FOR ROAD AND BRIDGE CONSTRUCTION AND THE MANUAL ON UNIFORM TRAFFIC CONTROL DEVICES (MUTCD) AS MINIMUM CRITERIA.
3. ROAD CLOSURES SHALL NOT BE PERMITTED. THE CONTRACTOR SHALL USE SINGLE LANE CLOSURES IN ORDER TO PERFORM THE WORK. ANY SINGLE LANE CLOSURES SHALL BE APPROVED BY THE COUNTY ENGINEER. PRIOR TO ANY SINGLE LANE CLOSURES THE HIGHLANDS COUNTY SHERIFF'S DEPARTMENT, CITY OF SEBRING POLICE DEPARTMENT, HIGHLANDS COUNTY AND CITY OF SEBRING FIRE DEPARTMENTS, EMERGENCY SERVICES, HIGHLANDS COUNTY SCHOOL BOARD, U. S. POST OFFICE AND THE MENTIONED UTILITY COMPANIES SHALL BE NOTIFIED.
4. THE TRAFFIC AND TRAVEL WAYS SHALL NOT BE ALTERED BY THE CONTRACTOR TO CREATE A WORK ZONE UNTIL ALL LABOR AND MATERIALS ARE AVAILABLE FOR THE CONSTRUCTION IN THAT AREA.
5. AS DETERMINED BY THE ENGINEER, THE CONTRACTOR SHALL COVER WORK ZONE SIGNS WHEN CONDITIONS NO LONGER WARRANT THERE USE.
6. THE CONTRACTOR SHALL REMOVE, RELOCATE OR COVER ANY EXISTING OR PROPOSED SIGNS THAT CONFLICT WITH THE TRAFFIC CONTROL PLANS. WHEN THE CONFLICT NO LONGER EXIST, THE CONTRACTOR SHALL RESTORE THE SIGNS TO THEIR ORIGINAL POSITION.
7. THE CONTRACTOR SHALL SUPPLY A 24 HOUR CONTACT NAME AND PHONE NUMBER FOR ON-CALL ASSIGNMENTS AS THEY MAY ARISE.

**CLEARING, GRUBBING & LANDSCAPING NOTES**

1. CONTRACTOR SHALL BE RESPONSIBLE FOR CLEARING BRUSH & VEGETATION WITHIN THE RIGHT-OF-WAY.
2. ALL DISTURBED AREA WITHIN THE RIGHT-OF-WAY SHALL BE SODDED WITH "LIKE KIND" SOD. THE AREAS ON WHICH SOD IS TO BE PLACED SHALL BE THOROUGHLY WETTED PRIOR TO AND AFTER PLACEMENT IS COMPLETE. NO ADDITIONAL TOP SOIL MATERIAL IS REQUIRED PRIOR TO PLACEMENT.
3. ALL SOD MATERIALS SHALL BE SUBJECT TO INSPECTION BY THE ENGINEER PRIOR TO PLACEMENT. ANY SOD WITH NOXIOUS WEEDS AND GRASSES, INCLUDING TROPICAL SODA APPL SHALL BE REJECTED FOR USE ON THIS PROJECT.
4. TREES WITHIN THE LIMIT OF THIS PROJECT, UNLESS OTHERWISE SHOWN, THAT ARE ADJACENT TO THE PROPOSED SIDEWALK ARE TO REMAIN AND SHALL BE TRIMMED TO CONFORM TO SECTION 110 OF THE SPECIFICATIONS AND APPLICABLE ADA REQUIREMENTS.

**MISCELLANEOUS NOTES**

1. CONTRACTOR SHALL SUBMIT A CONSTRUCTION SCHEDULE TO THE ENGINEER, IN CONJUNCTION WITH THE HIGHLANDS COUNTY ENGINEERING DEPARTMENT PRIOR TO COMMENCEMENT OF CONSTRUCTION.
2. ALL SIDEWALKS SHALL BE CONSTRUCTED PER FDOT INDEX 310.
3. CONSTRUCTION DETAILS SHALL BE IN ACCORDANCE WITH THE LATEST EDITION OF THE STATE OF FLORIDA DEPARTMENT OF TRANSPORTATION DESIGN STANDARDS AT THE TIME OF LETTING THE BID DOCUMENTS.
4. EXISTING DRIVEWAYS WITHIN THE LIMITS OF THIS PROJECT ARE TO BE REPLACED AT THE SAME LOCATION AND WIDTH UNLESS OTHERWISE SHOWN ON THE PLANS.
5. CONCRETE DRIVEWAYS SHALL BE CONSTRUCTED IN ACCORDANCE WITH FDOT INDEX 515.
6. THE CONTRACTOR SHALL REMOVE SURVEY STAKES AT COMPLETION OF THE CONTRACT.
7. CONTRACTOR SHALL REPAIR ALL DISTURBED IRRIGATION INCLUDING SPRINKLER HEADS AT THE CONTRACTOR'S EXPENSE. THE CONTRACTOR SHALL COORDINATE THIS ACTIVITY WITH AFFECTED PROPERTY OWNERS.

**SURVEY & STAKEOUT NOTES**

1. EXISTING SECTION CORNER AND 1/4 SECTION CORNERS, AND OTHER LAND MARKERS OR MONUMENTS LOCATED WITHIN PROPOSED CONSTRUCTION ARE TO BE REFERENCED PRIOR TO CONSTRUCTION AND RESET AFTER CONSTRUCTION. THE CONTRACTOR SHALL HAVE THIS WORK DONE BY A REGISTERED PROFESSIONAL LAND SURVEYOR AT THE CONTRACTOR'S EXPENSE (FLORIDA REGISTRATION). ANY PUBLIC LAND CORNER WITHIN THE LIMITS OF CONSTRUCTION IS TO BE PROTECTED. IF A CORNER MONUMENT IS IN DANGER OF BEING DESTROYED AND HAS NOT BEEN PROPERLY REFERENCED, THE CONTRACTOR SHOULD NOTIFY THE COUNTY SURVEYOR, WITHOUT DELAY, BY TELEPHONE.
2. BENCHMARK DATA IS NOTH AMERICA VERTICAL DATUM OF 1988 (NAVD 88).
3. ANY NGVD-29 MONUMENT WITHIN THE LIMITS OF CONSTRUCTION IS TO BE PROTECTED. IF DANGER OF DAMAGE, THE CONTRACTOR SHOULD NOTIFY: GEODETIC INFORMATION CENTER, ATTN: MARK MAINTENACE SECTION N/CG-162, 6001 EXECUTIVE BOULEVARD, ROCKVILLE, MARYLAND 20852. TELEPHONE: (301) 443-8319

**UTILITY & DRAINAGE NOTES**

1. THE EXACT LOCATION OF UTILITIES SHALL BE DETERMINED BY THE CONTRACTOR PRIOR TO CONSTRUCTION. IN ADDITION, THE CONTRACTOR SHALL BE RESPONSIBLE TO VERIFY IF "OTHER" UTILITIES (NOT SHOWN IN THE PLANS) EXIST WITHIN THE AREA OF CONSTRUCTION. RESOLVE UTILITY CONFLICTS AND UTILITY ADJUSTMENTS AS REQUIRED.
2. EXISTING DRAINAGE STRUCTURES WITHIN CONSTRUCTION LIMITS SHALL REMAIN UNLESS NOTED OTHERWISE.
3. THE CONTRACTOR IS TO USE CAUTION WHEN WORKING IN OR AROUND AREAS OF OVERHEAD TRANSMISSION LINES OR UNDERGROUND UTILITIES.
4. THE CONTRACTOR IS RESPONSIBLE FOR THE PROTECTION OF ALL UTILITIES TO REMAIN INPLACE.
5. PRIOR TO COMMENCEMENT OF ANY EXCAVATION, THE CONTRACTOR SHALL COMPLY WITH FLORIDA STATUE 553.851 FOR THE PROTECTION OF UNDERGROUND GAS PIPELINES.
6. ALL VALVES WITHIN THE AREA OF CONSTRUCTION OR DISTURBED BY CONSTRUCTION SHALL BE ADJUSTED TO FINISHED GRADE. REPLACE VALVE COLLARS AND BOXES AS NECESSARY.

**UTILITY NOTES**

1. THE LOCATION(S) OF THE UTILITIES SHOWN IN THE PLANS ARE BASED ON LIMITED INVESTIGATION TECHNIQUES AND SHOULD BE CONSIDERED APPROXIMATE ONLY.
2. EXISTING UTILITIES ARE TO REMAIN IN PLACE UNLESS OTHERWISE NOTED.
3. THE CONTRACTOR SHALL NOTIFY UTILITY OWNERS OF ANY EXCAVATION OR DEMOLITION ACTIVITY THROUGH SUNSHINE ONE-CALL OF FLORIDA, INC. (1-800-432-4770) AND SHALL ALSO NOTIFY THOSE UTILITY OWNERS/AGENCIES LISTED WITHIN OR IMPACTED BY THESE PLANS, NOT LESS THAN TWO (2) FULL BUSINESS DAYS IN ADVANCE OF THE BEGINNING OF CONSTRUCTION ON THE JOB SITE.
4. UPON CONSTRUCTION STAKEOUT, THE CONTRACTOR SHALL NOTIFY THE CITY OF SEBRING WATER DEPARTMENT FOR WATER METER ADJUSTMENTS. THESE ADJUSTMENTS SHALL CONFORM TO THE CITY OF SEBRING WATER STANDARDS AND SHALL ALSO CONFORM TO THE AMERICAN WITH DISABILITIES ACT (ADA).

UTILITY OWNER	TELEPHONE NUMBER	CONTACT PERSON
DUKE ENERGY FLORIDA	(863) 678-4476	MARK MANNER
COMCAST CABLE	(863) 273-8556	TIMOTHY HINEFELT
CITY OF SEBRING	(864) 471-5100	BOB BOGGUS
CITY OF SEBRING - WASTEWATER	(864) 471-5100	JIM ABLES
CITY OF SEBRING - WATER	(864) 471-5100	GARVIN ELKHILL
CENTURYLINK	(863) 452-3185	KEN LUTZ
SEBRING GAS SYSTEM, INC.	(863) 385-0194	JERRY MELENDY OR JIM CORRELL

**EXISTING CONDITIONS LEGEND**

	Project Control Point Set 5/8" Rod & Cap (Highlands County - Traverse)		Oak Tree (Trunk Diameter in inches)
	Fire Hydrant		Palm Tree
	Gas Valve		Black Gum Tree
	Water Gate/Blowoff Valve		Arborvitae Tree
	Wood Power Pole		Chain Link Fence
	Metal Light Pole		Shell/Clay/Sand Areas
	Concrete Light Pole		Hedge
	Guy Anchor		Gas Line Marker
	Mailbox/Newspaper Box (Multiple Boxes)		Bollard/Post
	Water Meter		Sign
	Backflow Preventer/F.D. Connection		
	Telephone Junction Box		
	Cable Junction Box		
	Electric Junction Box		
	Catch Basin		
	Sanitary Sewer Manhole		
	Sanitary Sewer Cleanout		

**PROPOSED CONDITIONS LEGEND**

	PROPOSED 4" CONCRETE SIDEWALK
	PROPOSED ELEVATION
	PROPOSED DRAINAGE SHEET FLOW
	PROPOSED 6" REINFORCED CONCRETE SIDEWALK OR DRIVEWAY
	PROPOSED ASPHALT OVERBUILD
	PROPOSED SWALE
	PROPOSED PERFORMANCE TURF - SOD
	PROPOSED DETECTABLE WARNING SURFACE

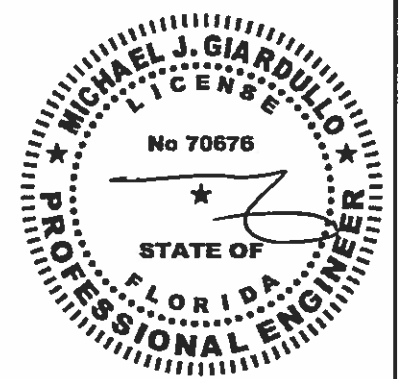

Michael J. Giardullo  
Professional Engineer  
State of Florida  
Registration No. 70676  
ENGINEER OF RECORD  
DATE OF SIGNATURE:  
June 19, 2017

REVISIONS			
DATE	DESCRIPTION	DATE	DESCRIPTION

**WEC** *excellence in engineering*  
WELER ENGINEERING CORPORATION  
201 WEST MARION AVENUE, SUITE 1308  
PUNTA GORDA, FLORIDA 33950  
OFFICE (941) 505-1700  
FAX (941) 505-1702 EB # 6656

**MARTIN L. KING JR. BOULEVARD  
SIDEWALK EXTENSION**

**GENERAL NOTES**

SHEET NO.  
**G-2**

## SUMMARY OF QUANTITIES

MARTIN LUTHER KING JR. BLVD.  
SIDEWALK IMPROVEMENTS – EASTERLY SIDE

DATE: FEBRUARY 27, 2016

CITY OF SEBRING & HIGHLANDS COUNTY

### BASE BID

ITEM NUMBER	ITEM DESCRIPTION	QUANTITY TOTAL	UNIT
S-1	MOBILIZATION	1	LS
S-2	BONDS AND INSURANCE	1	LS
S-3	MAINTENANCE OF TRAFFIC	1	LS
S-4	SEDIMENT BARRIER – STAKED SILT FENCE	1759	LF
S-5	CONSTRUCTION SURVEY STAKEOUT AND AS-BUILT DRAWINGS	1	LS
S-6	CLEARING AND GRUBBING	0.95	AC
S-7	REMOVAL OF CONCRETE PAVEMENT (SIDEWALK)	33	SY
S-8	REGULAR EXCAVATION	350	CY
S-9	EMBANKMENT	392	CY
S-10	OPTIONAL BASE GROUP NO. 1 (4" THICK)	1567	SY
S-11	MILL EXISTING ASPHALT PAVEMENT – 3/4" AVERAGE DEPTH	36	SY
S-12	FDOT TYPE 'C' INLET W/ GALVANIZED STEEL GRATE	1	EA
S-13	DESILT STORM PIPE – 12"X18" ERCP	193	LF
S-14	4" CONCRETE SIDEWALK	1287	SY
S-15	6" CONCRETE SIDEWALK	32	SY
S-16	6" CONCRETE DRIVEWAY	230	SY
S-17	DETECTABLE WARNING SURFACE (EMBEDDED)	18	SY
S-18	PERFORMANCE TURF – SOD	2408	SY
S-19	TEMPORARY 12" SOLID WHITE PAINT STRIPE – CROSSWALK	397	LF
S-20	TEMPORARY 24" SOLID WHITE PAINT STRIPE – STOP BAR	35	LF
S-21	12" SOLID WHITE THERMOPLASTIC STRIPE – CROSSWALK	360	LF
S-22	24" SOLID WHITE THERMOPLASTIC STRIPE – STOP BAR	52	LF
S-23	RELOCATE EXISTING SIGNS	7	EA
S-24	RELOCATE EXISTING MAIL BOXES	7	EA
S-25	TESTING	1	LS

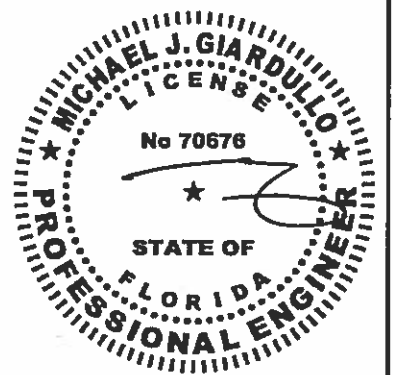

Michael J. Giardullo  
Professional Engineer  
State of Florida  
Registration No. 70676  
ENGINEER OF RECORD  
DATE OF SIGNATURE:  
June 19, 2017

REVISIONS		DATE	DESCRIPTION		<b>MARTIN L. KING JR. BOULEVARD SIDEWALK EXTENSION</b>	<b>SUMMARY OF QUANTITIES</b>	SHEET NO.
DATE	DESCRIPTION						G-3
2-27-17	DELETED COMMERCIAL ASPHALT DRIVEWAYS AT STA. 117+62 (R) & 119+34 (R) AND REPLACE WITH CONCRETE DRIVEWAYS						

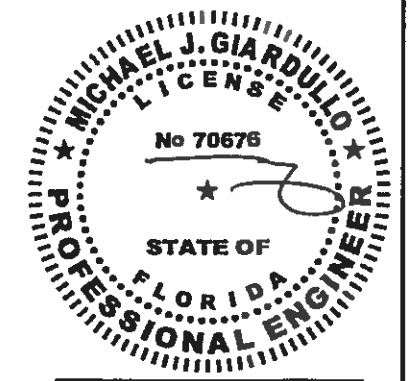
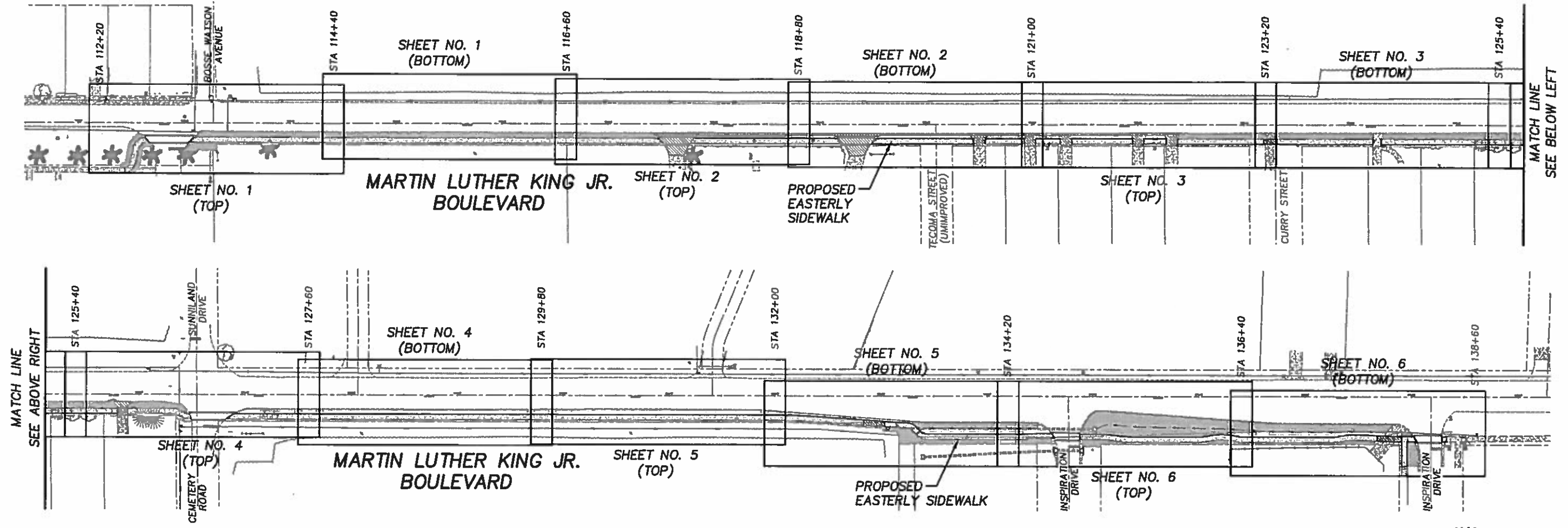

Michael J. Giardullo  
 Professional Engineer  
 State of Florida  
 Registration No. 70676  
 ENGINEER OF RECORD  
 DATE OF SIGNATURE:  
 June 19, 2017

REVISIONS			
DATE	DESCRIPTION	DATE	DESCRIPTION
2-27-17	DELETED COMMERCIAL ASPHALT DRIVEWAYS AT STA. 117+62 (R) & 119+34 (R) AND REPLACE WITH CONCRETE DRIVEWAYS		
6-2-17	DELETED MAINTAINED RIGHT-OF-WAY (WEST SIDE)		

**WEC** *ellence in engineering*  
 WELER ENGINEERING CORPORATION  
 201 WEST MARION AVENUE, SUITE 1306  
 PUNTA GORDA, FLORIDA 33950  
 OFFICE: (841) 505-1700  
 FAX: (841) 505-1702  
 EB # 0656

**MARTIN L. KING JR. BOULEVARD  
 SIDEWALK EXTENSION**

**PLAN VIEW - KEY**

SHEET NO.  
**G-4**

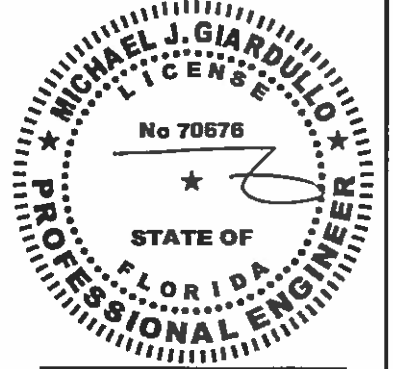
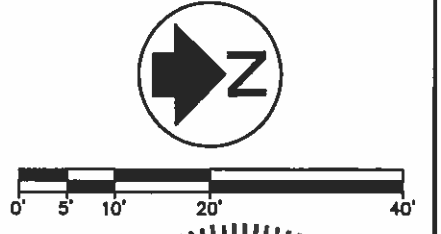
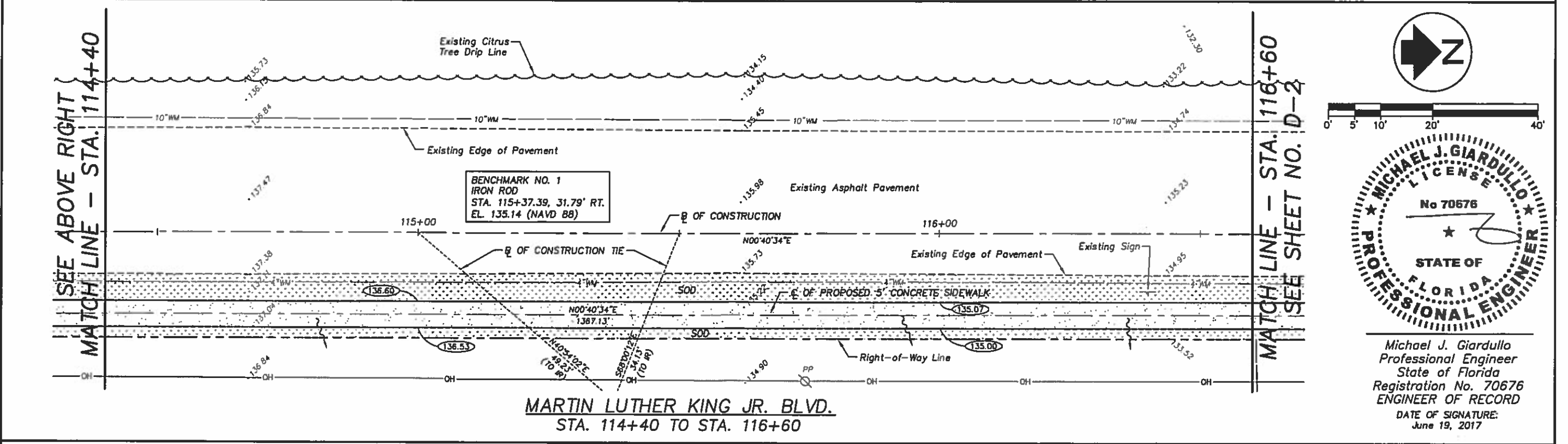
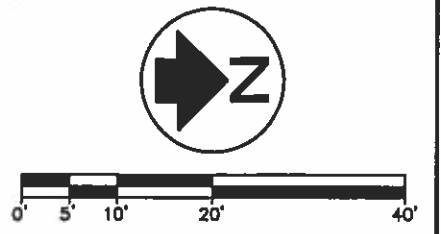
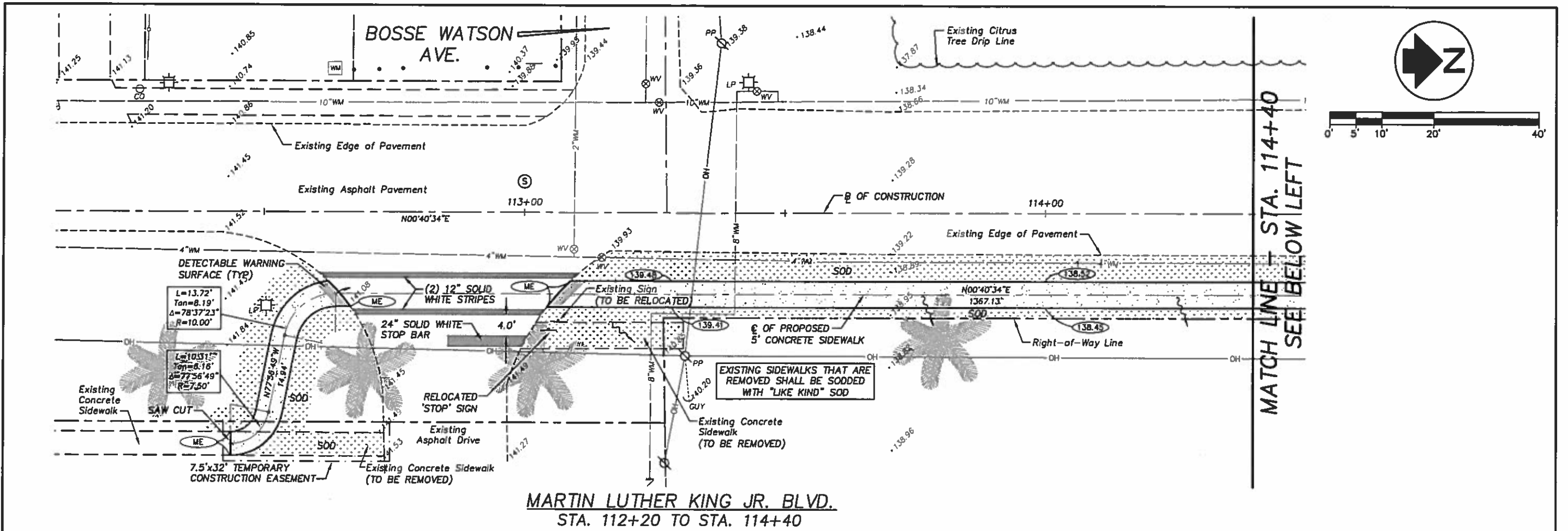

Michael J. Giardullo  
 Professional Engineer  
 State of Florida  
 Registration No. 70676  
 ENGINEER OF RECORD  
 DATE OF SIGNATURE:  
 June 19, 2017

REVISIONS			
DATE	DESCRIPTION	DATE	DESCRIPTION
6-2-17	DELETED MAINTAINED RIGHT-OF-WAY (WEST SIDE)		

**WEC** *excellence in engineering*  
 WELER ENGINEERING CORPORATION  
 201 WEST MARION AVENUE, SUITE 1306  
 PUNTA GORDA, FLORIDA 33950  
 OFFICE (941) 505-1700  
 FAX (941) 505-1702  
 EB # 6656

**MARTIN L. KING JR. BOULEVARD  
 SIDEWALK EXTENSION**

**SIDEWALK DESIGN  
 STA. 112+20 TO STA. 116+60**

SHEET NO.  
**D-1**

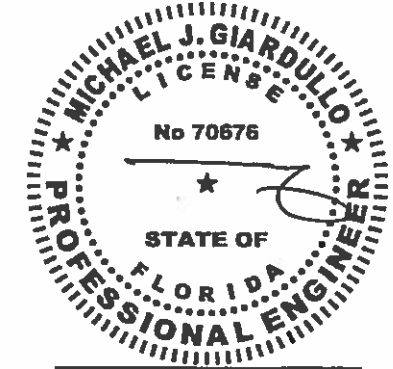
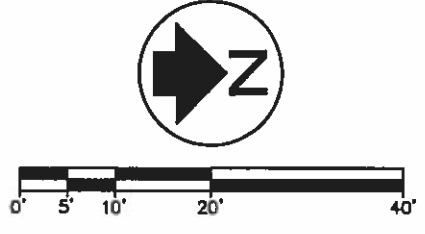
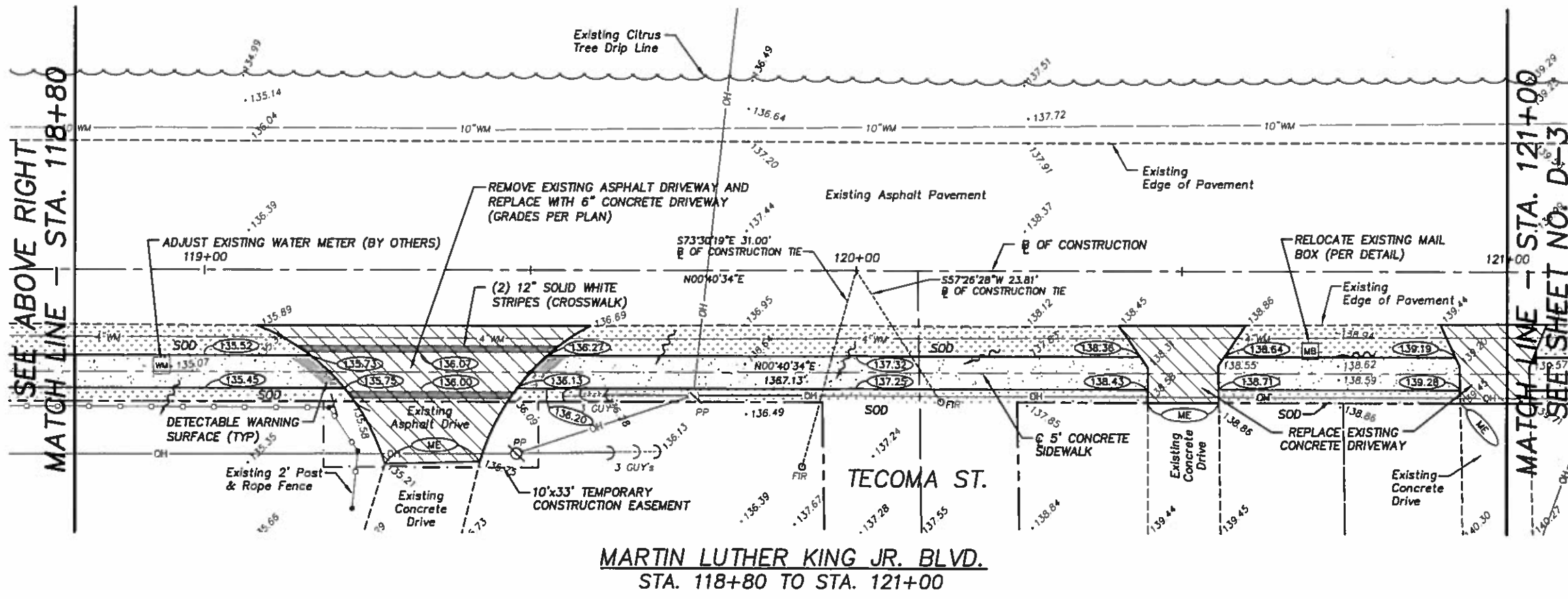
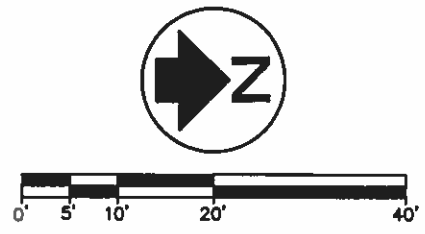
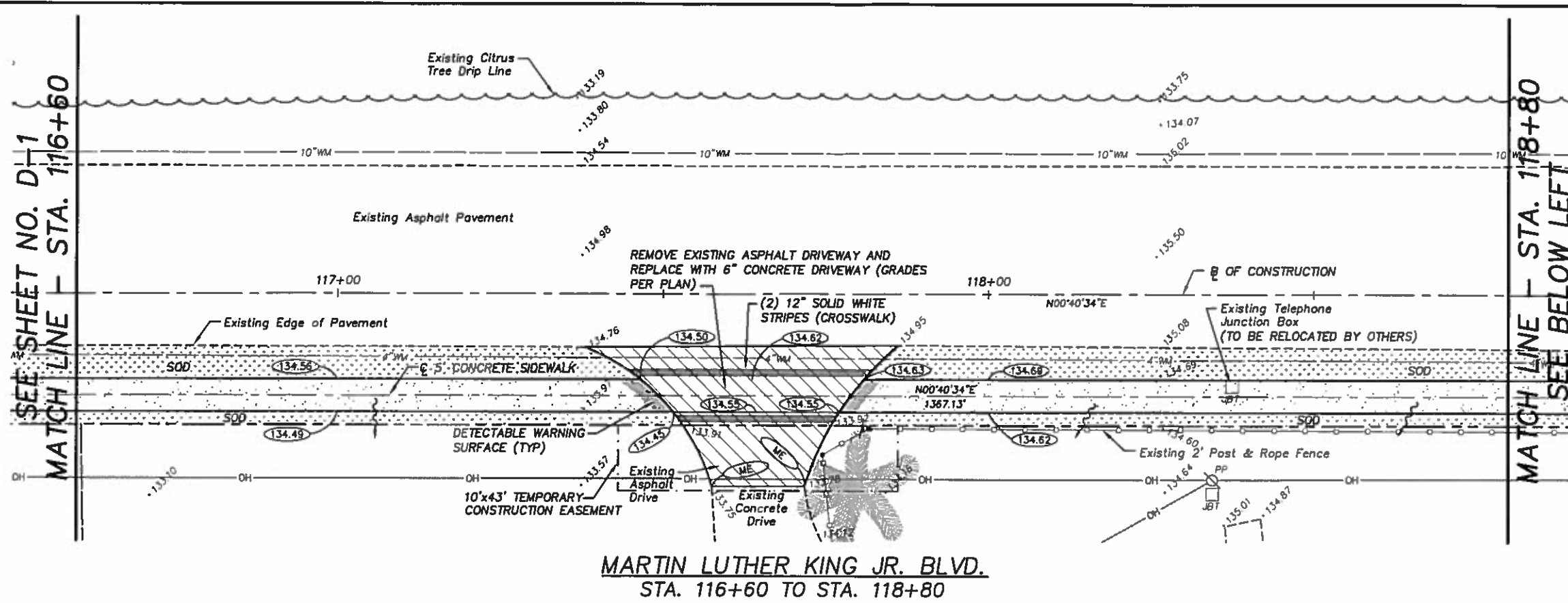

Michael J. Giardullo  
 Professional Engineer  
 State of Florida  
 Registration No. 70676  
 ENGINEER OF RECORD  
 DATE OF SIGNATURE:  
 June 19, 2017

REVISIONS	
DATE	DESCRIPTION
2-27-17	DELETED COMMERCIAL ASPHALT DRIVEWAYS AT STA. 117+62 (R) & 119+34 (R) AND REPLACE WITH CONCRETE DRIVEWAYS
6-2-17	DELETED MAINTAINED RIGHT-OF-WAY (WEST SIDE)

**WEC** *ellence in engineering*  
 WELER ENGINEERING CORPORATION  
 201 WEST MARION AVENUE, SUITE 1308  
 PUNTA GORDA, FLORIDA 33950  
 OFFICE: (941) 505-1700  
 FAX: (941) 505-1702  
 EB # 0656

**MARTIN L. KING JR. BOULEVARD  
 SIDEWALK EXTENSION**

**SIDEWALK DESIGN  
 STA. 116+60 TO STA. 121+00**

SHEET NO.  
**D-2**

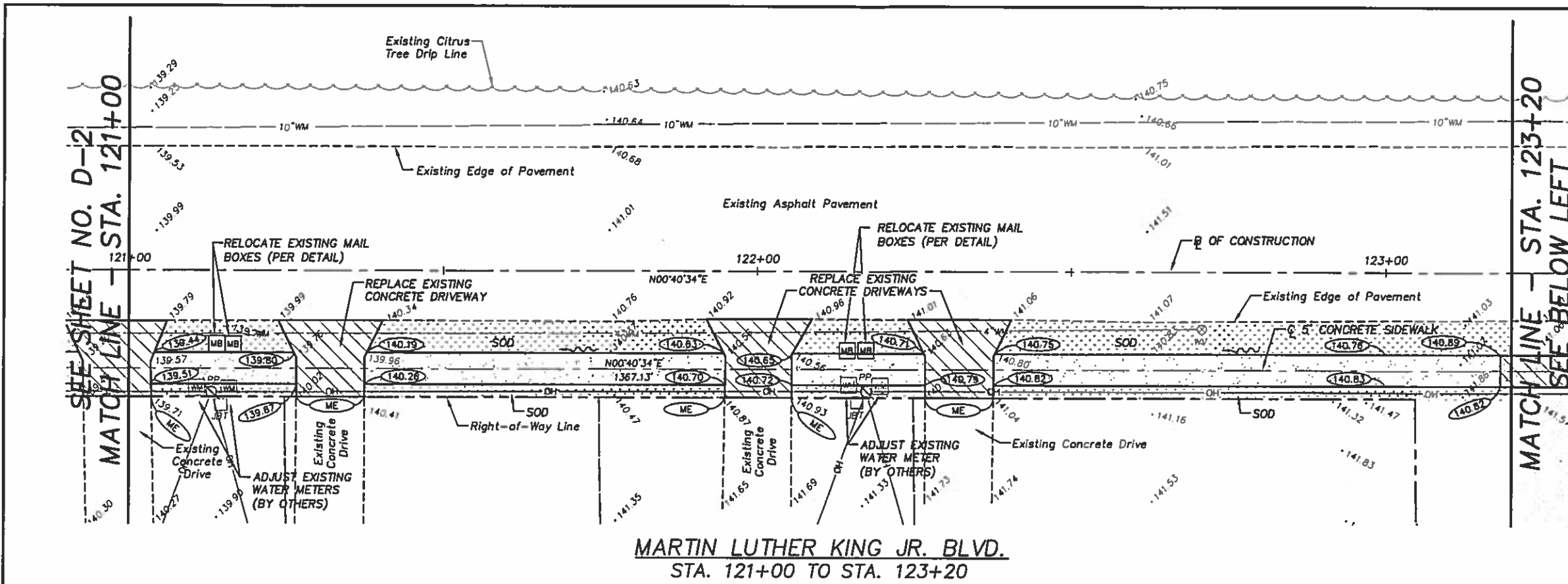

MARTIN LUTHER KING JR. BLVD.  
STA. 121+00 TO STA. 123+20

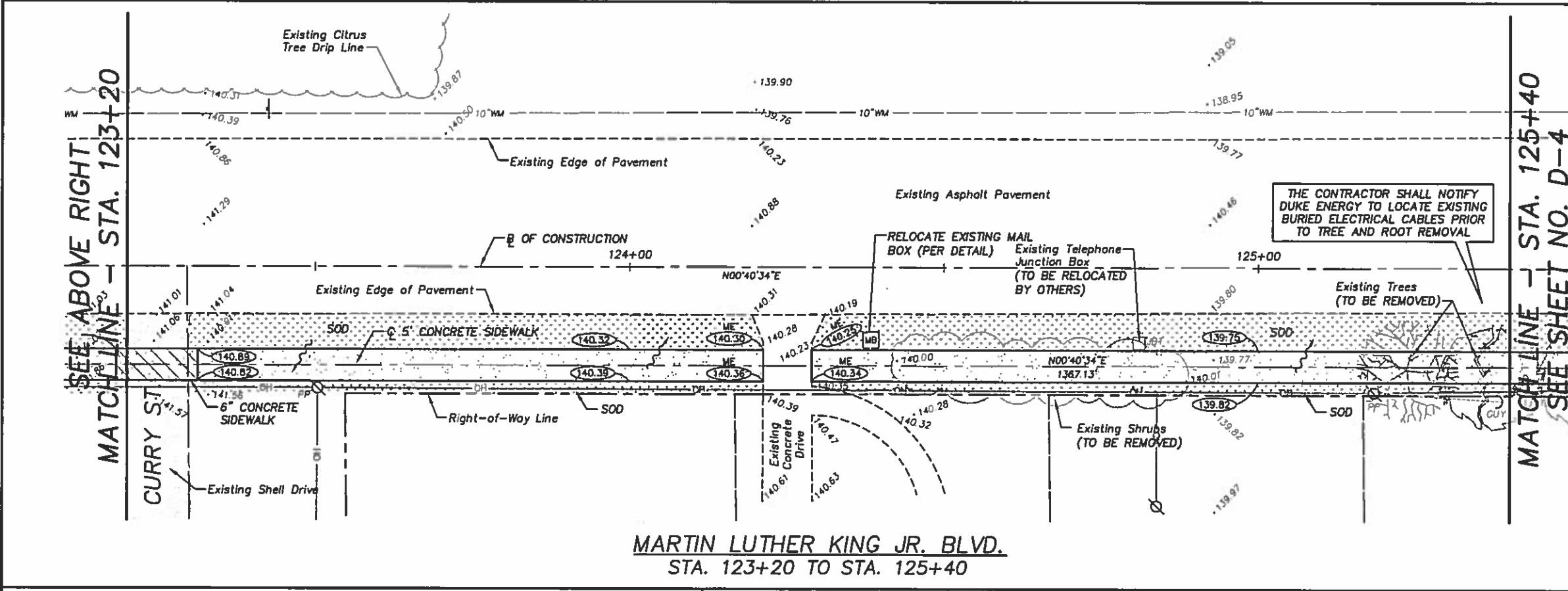
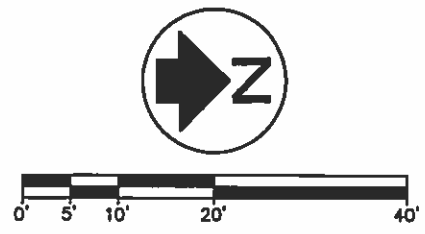

MARTIN LUTHER KING JR. BLVD.  
STA. 123+20 TO STA. 125+40

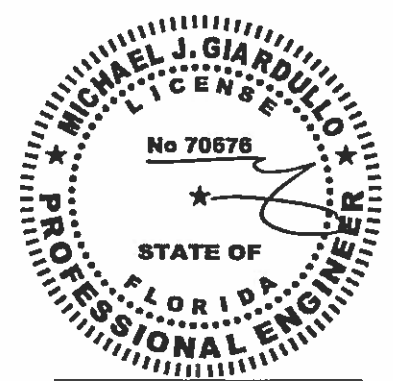
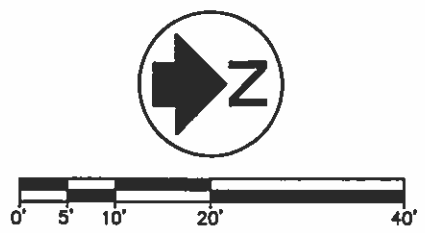

Michael J. Giardullo  
Professional Engineer  
State of Florida  
Registration No. 70676  
ENGINEER OF RECORD  
DATE OF SIGNATURE:  
June 19, 2017

REVISIONS			
DATE	DESCRIPTION	DATE	DESCRIPTION
6-2-17	DELETED MAINTAINED RIGHT-OF-WAY (WEST SIDE)		

**WEC** *excellence in engineering*  
WEHLER ENGINEERING CORPORATION  
201 WEST MARION AVENUE, SUITE 1306  
PUNTA GORDA, FLORIDA 33950  
OFFICE: (941) 505-1700  
FAX: (941) 505-1702 EB # 6656

MARTIN L. KING JR. BOULEVARD  
SIDEWALK EXTENSION

SIDEWALK DESIGN  
STA. 121+00 TO STA. 125+40

SHEET NO.  
D-3



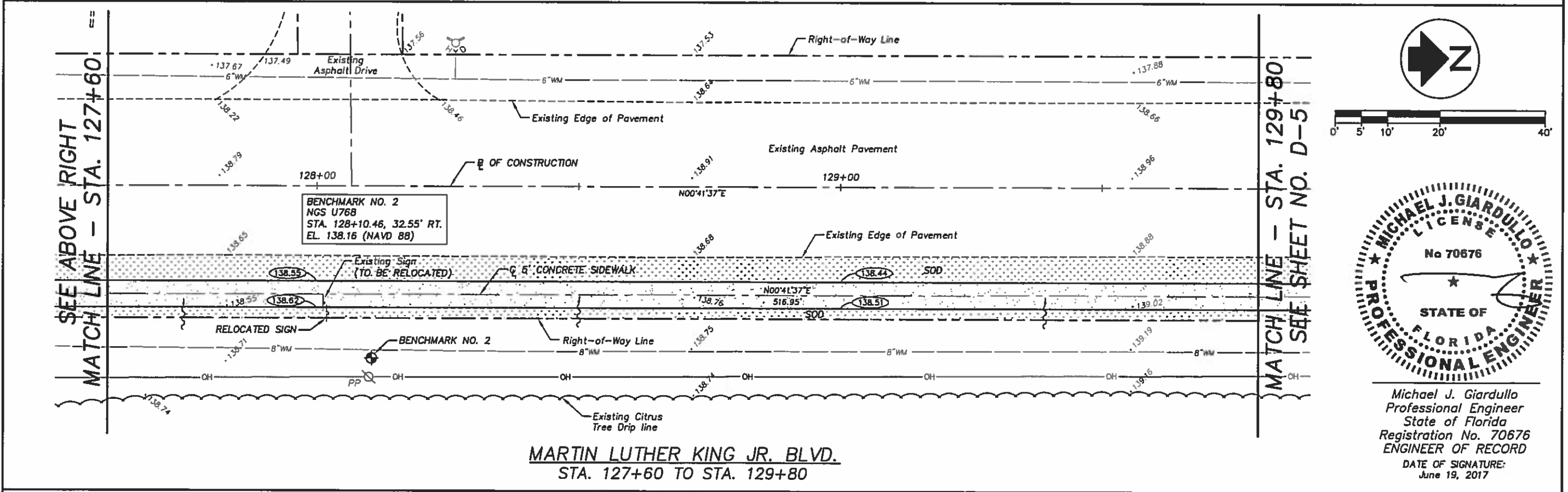
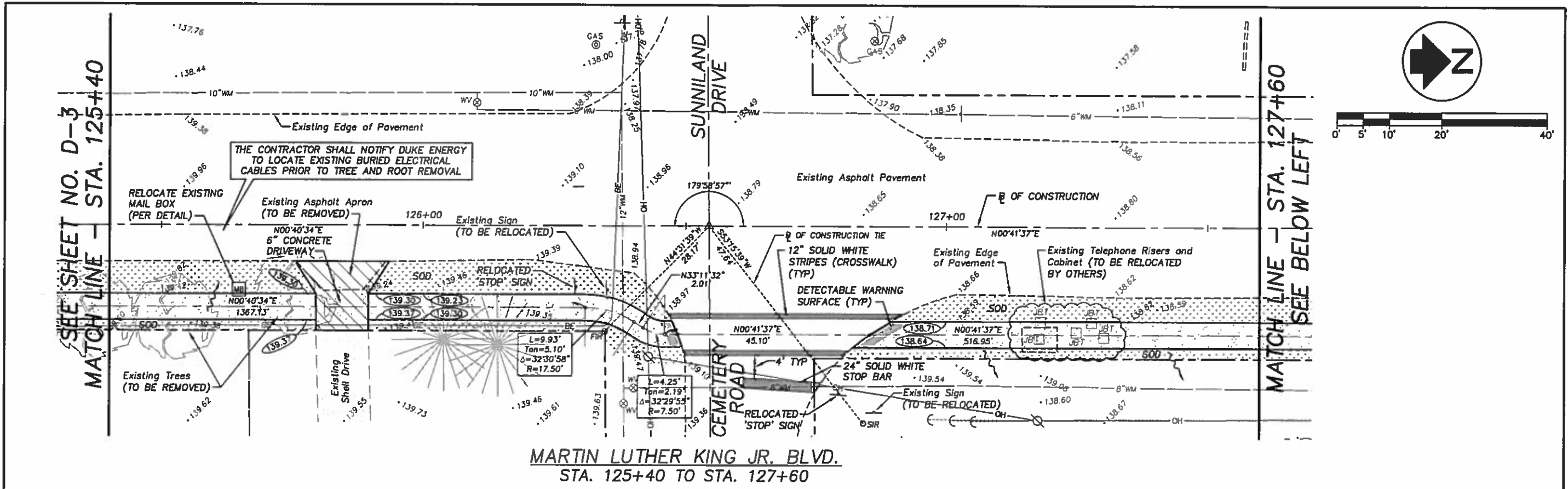

REVISIONS			
DATE	DESCRIPTION	DATE	DESCRIPTION
6-2-17	DELETED MAINTAINED RIGHT-OF-WAY (WEST SIDE)		

**WEC** WELER ENGINEERING CORPORATION  
**ellence in engineering**  
 201 WEST MARION AVENUE, SUITE 1306  
 PUNTA GORDA, FLORIDA 33950  
 OFFICE: (941) 505-1700  
 FAX: (941) 505-1702  
 EB # 6656

**MARTIN L. KING JR. BOULEVARD**  
**SIDEWALK EXTENSION**

**SIDEWALK DESIGN**  
**STA. 125+40 TO STA. 129+80**

SHEET NO.  
**D-4**

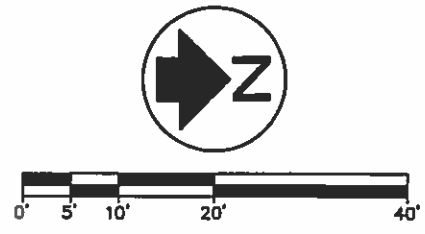
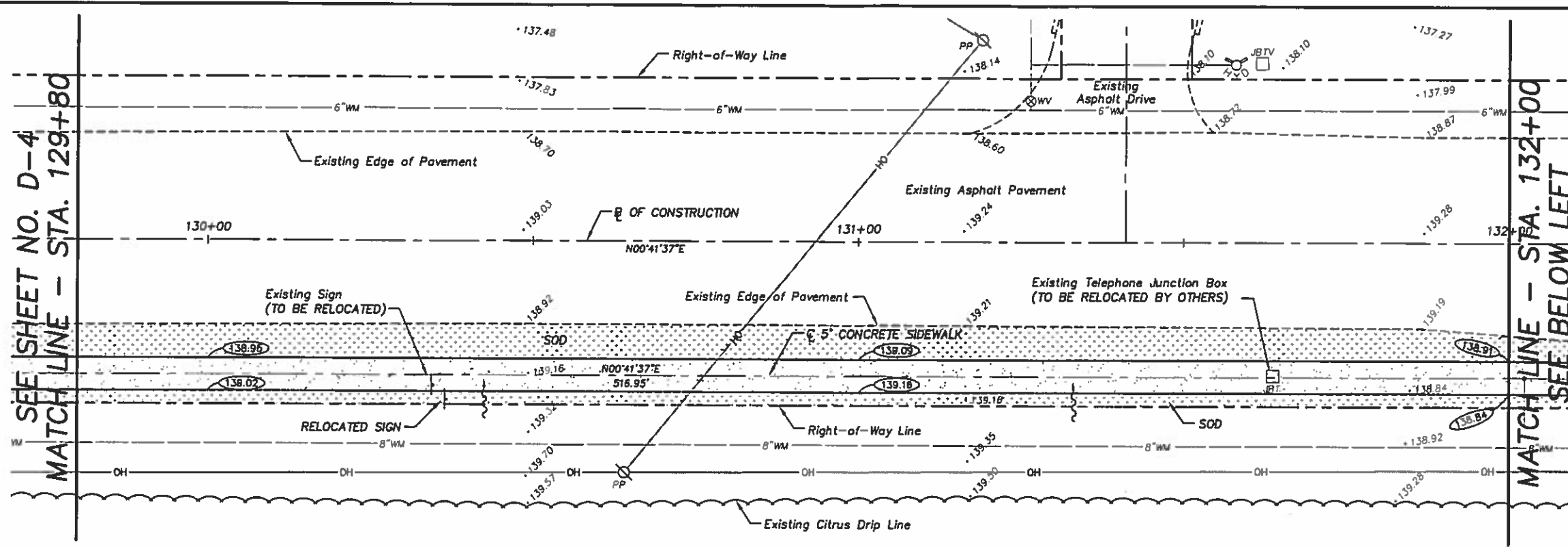

**MARTIN LUTHER KING JR. BLVD.**  
STA. 129+80 TO STA. 132+00

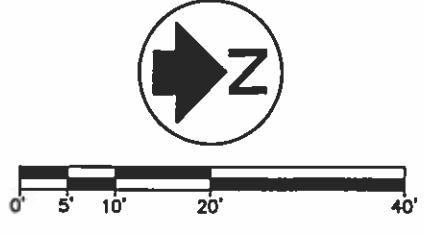
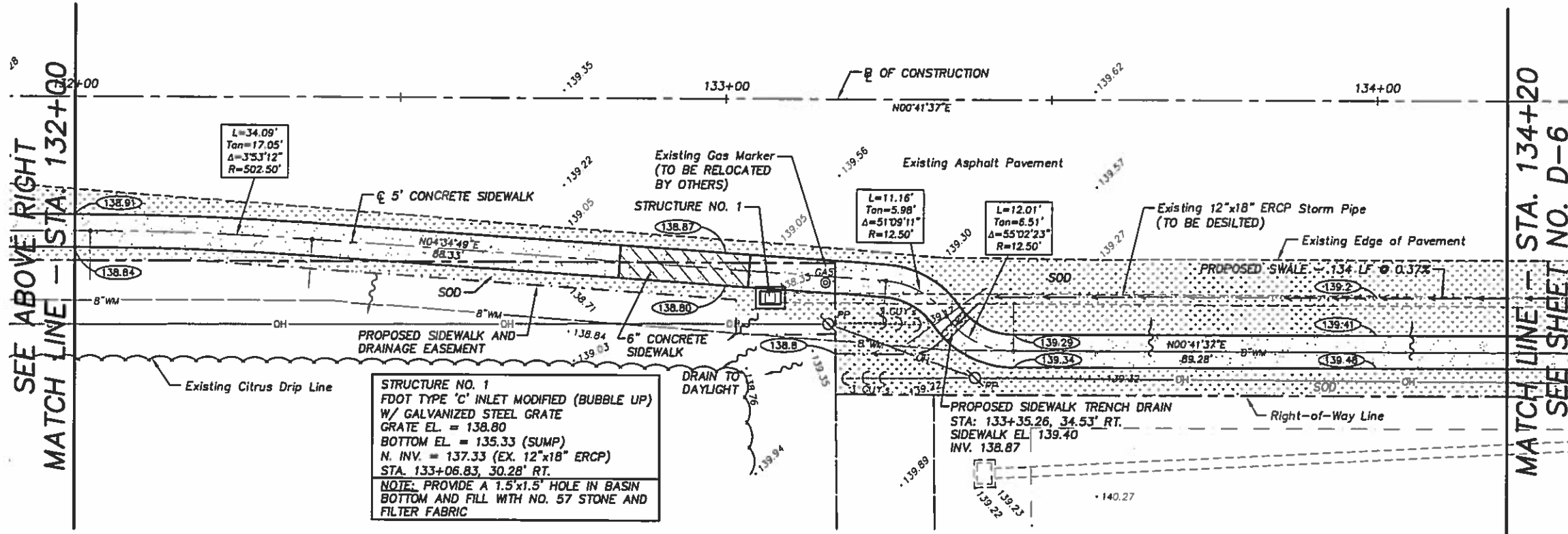

**MARTIN LUTHER KING JR. BLVD.**  
STA. 132+00 TO STA. 134+20

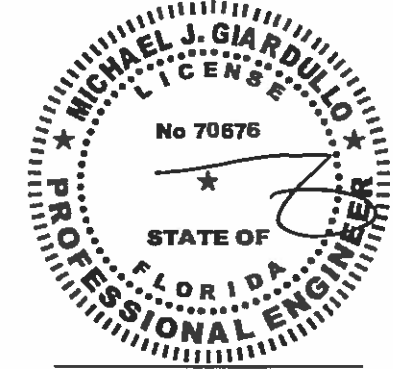

Michael J. Giardullo  
Professional Engineer  
State of Florida  
Registration No. 70676  
ENGINEER OF RECORD  
DATE OF SIGNATURE:  
June 19, 2017

REVISIONS			
DATE	DESCRIPTION	DATE	DESCRIPTION

**WEC** *excellence in engineering*  
WEILER ENGINEERING CORPORATION  
201 WEST MARION AVENUE, SUITE 1306  
PUNTA GORDA, FLORIDA 33950  
OFFICE (941) 505-1700  
FAX (941) 505-1702  
EB # 0056

**MARTIN L. KING JR. BOULEVARD**  
**SIDEWALK EXTENSION**

**SIDEWALK DESIGN**  
**STA. 129+80 TO STA. 134+20**

SHEET NO.  
**D-5**

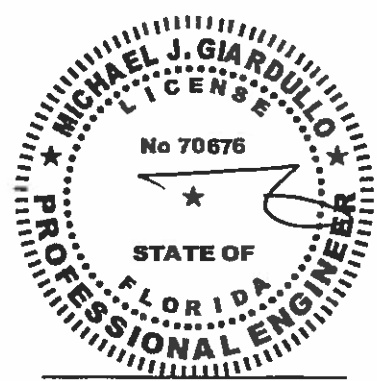
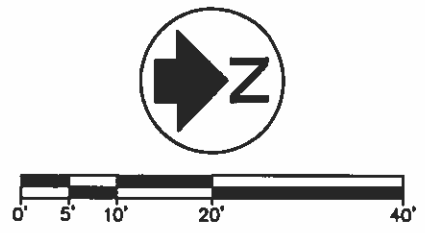
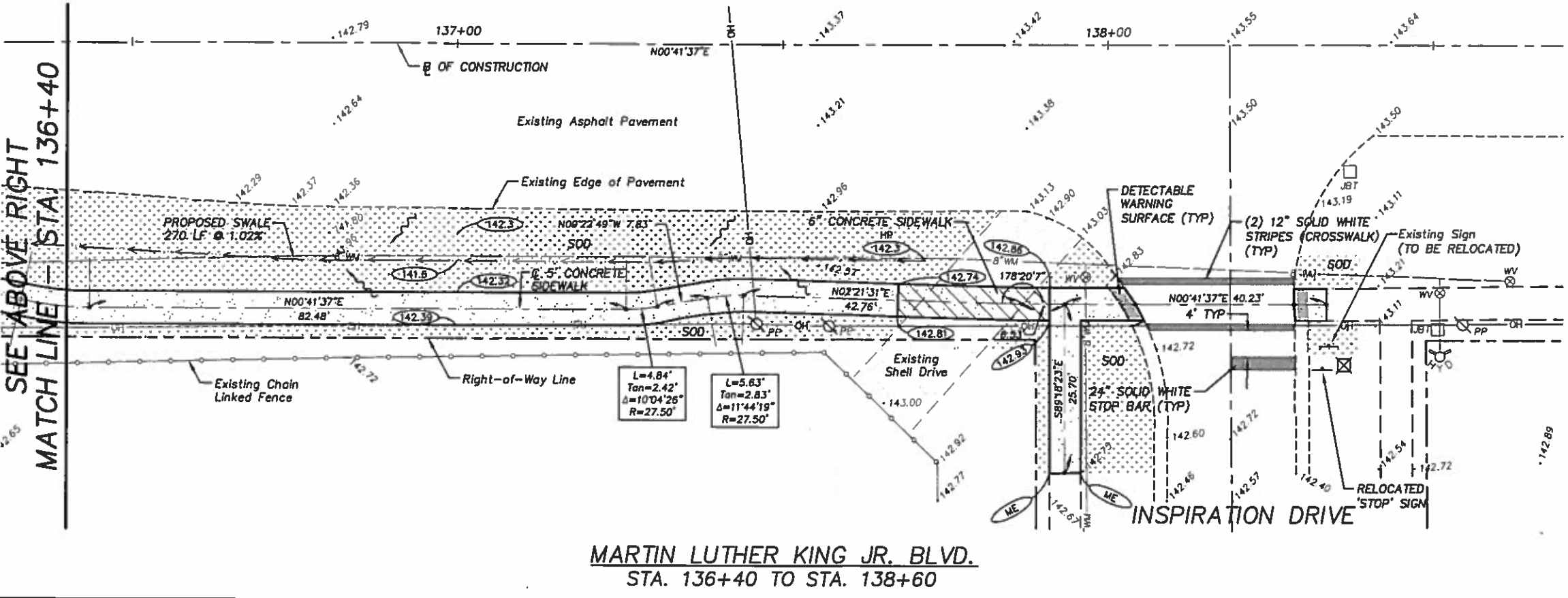
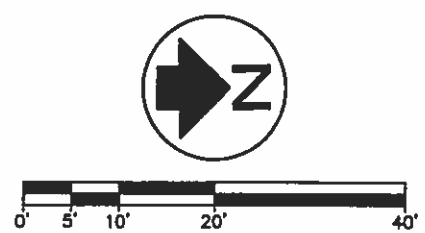
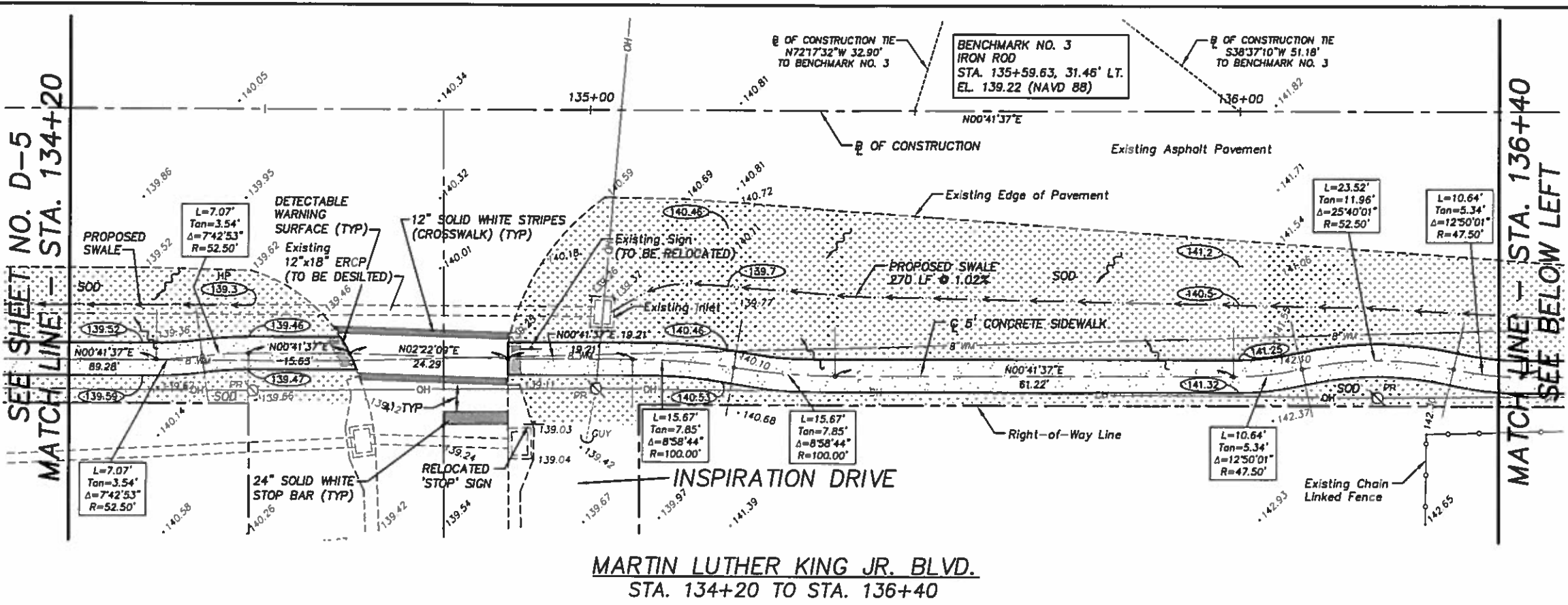

Michael J. Giardullo  
 Professional Engineer  
 State of Florida  
 Registration No. 70676  
 ENGINEER OF RECORD  
 DATE OF SIGNATURE:  
 June 19, 2017

REVISIONS			
DATE	DESCRIPTION	DATE	DESCRIPTION

**WEC** *alliance in engineering*  
 WEILER ENGINEERING CORPORATION  
 201 WEST MARION AVENUE, SUITE 1308  
 PUNTA GORDA, FLORIDA 33950  
 OFFICE: (941) 505-1700  
 FAX: (941) 505-1702 EB # 6656

**MARTIN L. KING JR. BOULEVARD  
 SIDEWALK EXTENSION**

**SIDEWALK DESIGN  
 STA. 134+20 TO STA. 138+60**

SHEET NO.  
**D-6**

**EASTERLY SIDEWALK – STATION/OFFSET DATA  
BASE BID**

STATION	FEATURE	STATION	FEATURE
STA: 112+50.03, 44.21' RT.	BEGIN EASTERLY SIDEWALK	STA: 134+33.48, 38.29' RT.	POINT OF CURVE
STA: 112+50.03, 31.71' RT.	CENTER POINT OF CURVE	STA: 134+33.48, 14.21' LT.	CENTER POINT OF CURVE
STA: 112+58.87, 40.55' RT.	POINT OF TANGENT	STA: 134+40.53, 37.81' RT.	POINT OF REVERSE CURVE
STA: 112+61.72, 37.70' RT.	POINT OF CURVE	STA: 134+47.58, 89.84' RT.	CENTER POINT OF CURVE
STA: 112+67.03, 43.00' RT.	CENTER POINT OF CURVE	STA: 134+47.58, 37.34' RT.	POINT OF TANGENT
STA: 112+67.03, 35.50' RT.	POINT OF TANGENT	STA: 134+63.20, 37.34' RT.	EDGE OF PAVEMENT
STA: 112+73.01, 35.50' RT.	EDGE OF PAVEMENT	STA: 134+87.49, 38.05' RT.	EDGE OF PAVEMENT
STA: 112+96.74, 35.50' RT.	EDGE OF PAVEMENT	STA: 135+06.69, 38.05' RT.	POINT OF CURVE
STA: 112+99.78, 35.50' RT.	POINT OF CURVE	STA: 135+06.69, 138.05' RT.	CENTER POINT OF CURVE
STA: 112+99.78, 23.00' RT.	CENTER POINT OF CURVE	STA: 135+22.30, 39.27' RT.	POINT OF REVERSE CURVE
STA: 113+09.31, 31.09' RT.	POINT OF TANGENT	STA: 135+37.91, 59.50' LT.	CENTER POINT OF CURVE
STA: 113+18.81, 19.91' RT.	POINT OF CURVE	STA: 135+37.91, 40.50' RT.	POINT OF TANGENT
STA: 113+28.34, 28.00' RT.	CENTER POINT OF CURVE	STA: 135+59.63, 31.46' LT.	BM NO. 3 (EL. 139.22)
STA: 113+28.34, 15.50' RT.	POINT OF TANGENT	STA: 135+99.13, 40.50' RT.	POINT OF CURVE
STA: 115+37.59, 31.79' RT.	BM NO. 1 (EL. 135.14)	STA: 135+99.13, 7.00' LT.	CENTER POINT OF CURVE
STA: 117+49.41, 15.50' RT.	EDGE OF PAVEMENT	STA: 136+09.68, 39.31' RT.	POINT OF REVERSE CURVE
STA: 117+78.84, 15.50' RT.	EDGE OF PAVEMENT	STA: 136+21.34, 90.50' RT.	CENTER POINT OF CURVE
STA: 119+19.15, 15.50' RT.	EDGE OF PAVEMENT	STA: 136+33.00, 39.31' RT.	POINT OF REVERSE CURVE
STA: 119+49.97, 15.50' RT.	EDGE OF PAVEMENT	STA: 136+43.55, 7.00' LT.	CENTER POINT OF CURVE
STA: 123+18.21, 15.50' RT.	BEGIN 6" CONC. SIDEWALK	STA: 136+43.55, 40.50' RT.	POINT OF TANGENT
STA: 123+31.24, 15.50' RT.	END 6" CONC. SIDEWALK	STA: 137+26.04, 40.50' RT.	POINT OF CURVE
STA: 125+77.78, 15.50' RT.	BEGIN 6" CONC. SIDEWALK	STA: 137+26.04, 13.00' RT.	CENTER POINT OF CURVE
STA: 125+90.93, 15.50' RT.	END 6" CONC. SIDEWALK	STA: 137+30.85, 40.08' RT.	POINT OF TANGENT
STA: 126+30.95, 15.50' RT.	POINT OF CURVE	STA: 137+38.56, 38.71' RT.	POINT OF CURVE
STA: 126+30.95, 33.00' RT.	CENTER POINT OF CURVE	STA: 137+43.37, 65.78' RT.	CENTER POINT OF CURVE
STA: 126+40.36, 18.24' RT.	POINT OF TANGENT	STA: 137+44.16, 38.29' RT.	POINT OF TANGENT
STA: 126+42.05, 19.32' RT.	POINT OF CURVE	STA: 137+67.87, 38.94' RT.	BEGIN 6" CONC. SIDEWALK
STA: 126+46.08, 13.00' RT.	CENTER POINT OF CURVE	STA: 137+86.91, 39.54' RT.	ANGLE BREAK
STA: 126+46.08, 20.50' RT.	POINT OF TANGENT	STA: 137+91.19, 39.54' RT.	END 6" CONC. SIDEWALK
STA: 126+48.57, 20.50' RT.	EDGE OF PAVEMENT	STA: 137+93.43, 39.54' RT.	SIDEWALK INTERSECTION
STA: 126+85.42, 20.50' RT.	EDGE OF PAVEMENT	STA: 137+93.43, 65.24' RT.	MATCH EXISTING SIDEWALK EAST
STA: 128+10.46, 32.55' RT.	BM NO. 2 (EL. 138.16)	STA: 138+04.30, 39.54' RT.	EDGE OF PAVEMENT
STA: 132+02.37, 20.50' RT.	POINT OF CURVE	STA: 138+28.68, 39.54' RT.	EDGE OF PAVEMENT
STA: 132+02.37, 523.00' RT.	CENTER POINT OF CURVE	STA: 138+33.66, 39.54' RT.	END EASTERLY SIDEWALK
STA: 132+36.43, 21.66' RT.	POINT OF TANGENT		
STA: 132+83.68, 24.87' RT.	BEGIN 6" CONC. SIDEWALK		
STA: 133+03.63, 26.22' RT.	END 6" CONC. SIDEWALK		
STA: 133+24.56, 27.64' RT.	POINT OF CURVE		
STA: 133+23.71, 40.11' RT.	CENTER POINT OF CURVE		
STA: 133+33.96, 32.95' RT.	POINT OF REVERSE CURVE		
STA: 133+44.20, 25.79' RT.	CENTER POINT OF CURVE		
STA: 133+44.20, 38.29' RT.	POINT OF TANGENT		

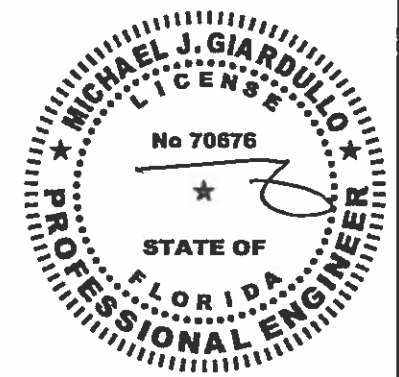

Michael J. Giardullo  
Professional Engineer  
State of Florida  
Registration No. 70676  
ENGINEER OF RECORD  
DATE OF SIGNATURE:  
June 19, 2017

REVISIONS			
DATE	DESCRIPTION	DATE	DESCRIPTION

**WEC** *excellence in engineering*  
WELER ENGINEERING CORPORATION  
201 WEST MARION AVENUE, SUITE 1308  
PUNTA GORDA, FLORIDA 33950  
OFFICE (941) 505-1700  
FAX (941) 505-1702      EB # 8858

**MARTIN L. KING JR. BOULEVARD  
SIDEWALK EXTENSION**

**SIDEWALK  
STAKEOUT DATA**

SHEET  
NO.

D-7

**SIDEWALK SPECIFICATIONS**

- EXCAVATION:** EXCAVATE TO THE REQUIRED DEPTH, AND COMPACT THE FOUNDATION MATERIAL UPON WHICH THE CONCRETE SIDEWALK IS TO BE PLACED. THE CONTRACTOR IS RESPONSIBLE FOR DISPOSAL OF EXCESS MATERIALS.
- BASE MATERIAL:** SHALL BE 4" OF F.D.O.T. OPTIONAL BASE GROUP NO. 1 (LBR 100)
- COMPACTION:** COMPACT FILL AREAS, INCLUDING CUT AREAS UNDER THE SIDEWALK THAT HAVE BEEN EXCAVATED MORE THAN 6 INCHES BELOW THE BOTTOM OF SIDEWALK, TO A MINIMUM OF 95% OF AASHTO T-99 DENSITY. THE AREA TO BE COMPACTED IS DEFINED AS THAT AREA DIRECTLY UNDER THE SIDEWALK AND 1 FOOT BEYOND EACH SIDE OF THE SIDEWALK WHEN RIGHT-OF-WAY ALLOWS.
- CONCRETE MATERIALS:** USE PORTLAND CEMENT CONCRETE- CLASS NON STRUCTURAL (NS). THE MINIMUM 28 DAY COMPRESSIVE STRENGTH REQUIREMENT FOR THIS CONCRETE IS 3,000 PSI.
- CONCRETE MIX DESIGN:** BEFORE PRODUCING ANY CONCRETE, SUBMIT THE PROPOSED MIX DESIGN TO THE HIGHLANDS COUNTY PROJECT MANAGER FOR REVIEW AND APPROVAL. THE PROJECT MANAGER MAY DISQUALIFY ANY CONCRETE PRODUCTION FACILITY FOR NON-COMPLIANCE WITH SPECIFICATION REQUIREMENTS.
- PLACEMENT:** CONCRETE SIDEWALKS SHALL BE A MINIMUM OF 2 1/2" FROM ANY POWER POLE OR TELEPHONE RISER.
- TESTING:** CONTRACTOR SHALL PERFORM, AT HIS OWN EXPENSE, ANY AND ALL TESTS REQUIRED BY THE SPECIFICATIONS. A COPY OF THE TEST RESULTS SHALL BE PROVIDED TO THE HIGHLANDS COUNTY PROJECT MANAGER (PM). THE PM SHALL INSPECT ALL CONSTRUCTION AND IS AUTHORIZED TO CALL TO THE ATTENTION OF THE CONTRACTOR ANY FAILURE OF WORK OR MATERIALS TO CONFORM WITH THE PLANS AND SPECIFICATIONS. ALL COPIES OF DENSITY, CONCRETE STRENGTH, AND OTHER REQUIRED TEST RESULTS ARE TO BE SENT TO THE PROJECT MANAGER DIRECTLY FROM THE TESTING AGENCY. DENSITY TESTS SHALL BE TAKEN EVERY 200 FEET IN A ZIG-ZAG PATTERN WITHIN THE AREA TO BE COVERED BY THE CONCRETE SIDEWALK. A MINIMUM ACCEPTABLE VALUE IS 95% DENSITY AS PER AASHTO T-180. THERE SHALL BE A MINIMUM OF TWO (2) RANDOM CONCRETE CYLINDER TEST PERFORMED.

**FORMS**

- FORM MATERIALS:** CONSTRUCT FORMS SHALL BE EITHER WOOD OR METAL. PROVIDE FORMS THAT ARE STRAIGHT, FREE FROM WARP OR BENDS, AND OF SUFFICIENT STRENGTH, WHEN STAKED, TO RESIST THE PRESSURE OF THE CONCRETE WITHOUT DEVIATION FROM LINE AND GRADE. FOR ALL ITEMS CONSTRUCTED ON A RADIUS, USE FLEXIBLE FORMS.
- DEPTH OF FORMS:** ENSURE THAT FORMS HAVE A DEPTH EQUAL TO THE PLAN DIMENSIONS FOR THE DEPTH OF CONCRETE BEING DEPOSITED AGAINST THEM.
- PLACING CONCRETE:** PLACE THE CONCRETE IN THE FORMS, AND TAMP AND SPADE IT TO PREVENT HONEYCOMBING, AND UNTIL THE TOP OF THE STRUCTURE CAN BE FLOATED SMOOTH AND THE EDGES ROUNDED TO THE RADIUS OF 1/2 INCH.

**JOINTS**

- 3/16" SAW CUT JOINT, 1-1/2" DEEP (WITHIN 96 HOURS) MAX. 5' CENTERS. MAXIMUM SPACING FOR 1/2" EXPANSION JOINT SHALL BE 120 FEET. INTERMEDIATE LOCATIONS WHEN CALLED FOR IN THE PLANS OR AT LOCATIONS AS DIRECTED BY THE ENGINEER.
- EXPANSION JOINTS SHALL BE PLACED AT THE END OF ALL RETURNS, FIXED OBJECTS (DRIVEWAYS, CURBS ETC.) AND INTERVALS NOT TO EXCEED 50' IN LENGTH. THE EXPANSION JOINTS SHALL BE CONSTRUCTED WITH 1/2" PREMOLDED EXPANSION JOINT MATERIAL.

**SURFACE REQUIREMENTS**

- PROVIDE THE CONCRETE WITH A BROOM FINISH. ENSURE THAT THE SURFACE VARIATIONS ARE NOT MORE THAN 1/4" INCH UNDER A 10 FOOT STRAIGHTEDGE OR MORE THAN 1/8" INCH ON A 5 FOOT TRANSVERSE SECTION. FINISH THE EDGE OF THE SIDEWALK WITH AN EDGING TOOL HAVING A RADIUS OF 1/2 INCH.
- CONCRETE MIX DESIGN: BEFORE PRODUCING ANY CONCRETE, SUBMIT THE PROPOSED MIX DESIGN TO THE ENGINEER. THE ENGINEER MAY DISQUALIFY ANY CONCRETE PRODUCTION FACILITY FOR NON-COMPLIANCE WITH SPECIFICATION REQUIREMENTS.

**SIDEWALK GENERAL NOTES**

- SIDEWALK SLOPES:** THE RUNNING SLOPE OF THE SIDEWALK SHALL NOT EXCEED 5%. THE CROSS SLOPE OF THE SIDEWALK SHALL BE 1.5%.
- ALL SIDEWALKS AND SIDEWALK CROSSING SHALL BE CONSTRUCTED IN ACCORDANCE WITH THE AMERICANS WITH DISABILITIES ACT (ADA).
- THE PERFORMANCE TURF (SOD) MAT SHALL BE PLACED 0.10'-0.20' BELOW THE NEW EDGE OF SIDEWALK, PAVEMENT OR DRIVEWAY TO ENSURE POSITIVE DRAINAGE.
- THE CONTRACTOR SHALL PROVIDE AN EMBEDDED DETECTABLE WARNING SURFACE WHERE THE CONCRETE SIDEWALK MEETS ROADWAYS, COMMERCIAL DRIVEWAYS AND AS NOTED ON THE PLANS. THE EMBEDDED DETECTABLE WARNING SURFACE SHALL BE ON THE F.D.O.T. APPROVED PRODUCTS LIST AND SHALL BE CONSTRUCTED IN ACCORDANCE WITH THE AMERICANS WITH DISABILITIES ACT (ADA). THE ROWS OF TRUNCATED DOMES IN THE DETECTABLE WARNING SURFACE SHALL BE ALIGNED TO BE PERPENDICULAR OR RADIAL TO THE STREET, ROADWAY, OR DRIVEWAY, AS APPLICABLE.
- ALL SIDEWALKS SHALL BE 4" THICK. WHERE A SIDEWALK IS CONSTRUCTED THROUGH AN EXISTING SHELL, MARL OR EARTHEN DRIVEWAY THE SIDEWALK SHALL BE 6" THICK WITH ONE LAYER OF 6"x6"-W1.4xW1.4 W.W.M. OR FIBER MESH AND SHALL EXTEND 1'-6" BEYOND OF THE SHELL, MARL OR EARTHEN DRIVEWAY.

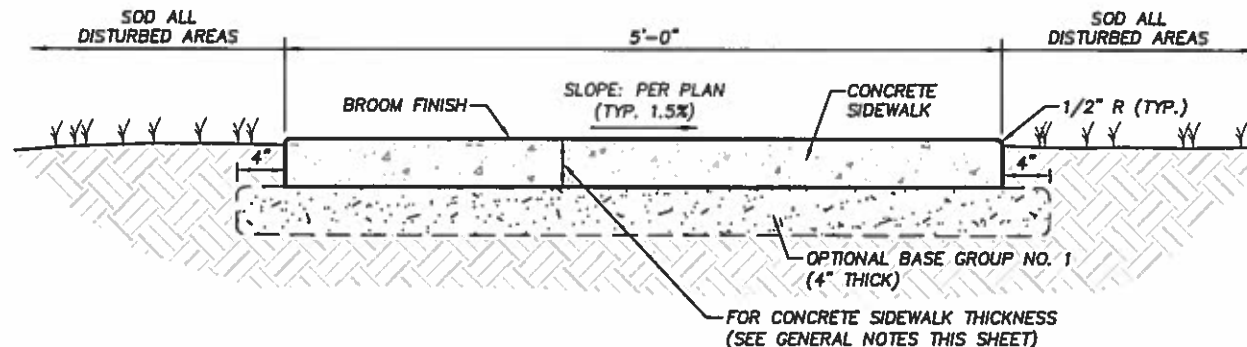

**TYPICAL CONCRETE SIDEWALK DETAIL**  
NOT TO SCALE

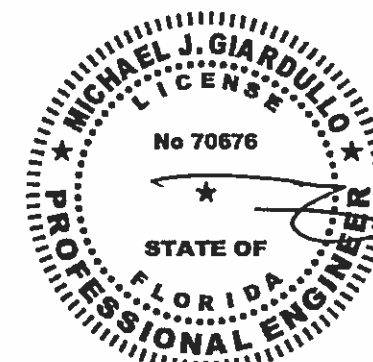

Michael J. Giardullo  
Professional Engineer  
State of Florida  
Registration No. 70676  
ENGINEER OF RECORD  
DATE OF SIGNATURE:  
June 19, 2017

REVISIONS			
DATE	DESCRIPTION	DATE	DESCRIPTION

**WEC** *excellence in engineering*  
WEILER ENGINEERING CORPORATION  
201 WEST MARION AVENUE, SUITE 1306  
PUNTA GORDA, FLORIDA 33950  
OFFICE (941) 505-1700  
FAX (941) 505-1702 EB # 6656

**MARTIN L. KING JR. BOULEVARD  
SIDEWALK EXTENSION**

**SIDEWALK  
DETAIL AND NOTES**

SHEET  
NO.

D-8

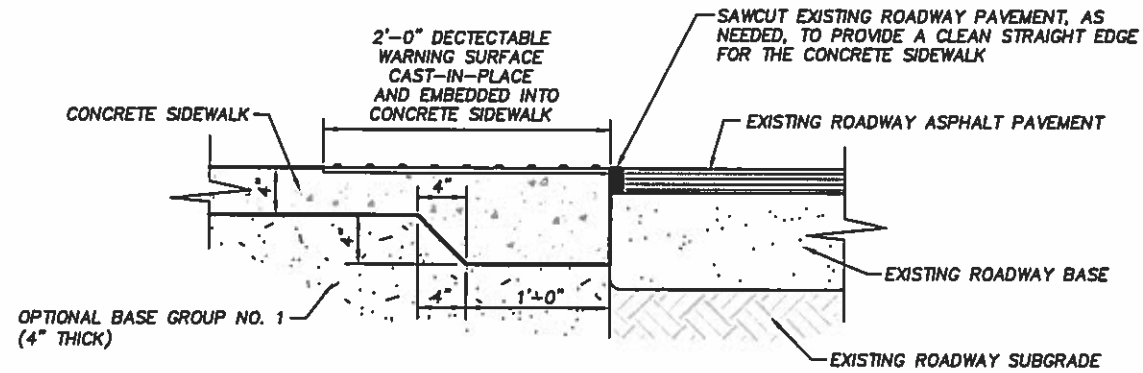

**TYPICAL CONCRETE SIDEWALK DETAIL  
AT ASPHALT ROADWAY & COMMERCIAL DRIVEWAY**  
NOT TO SCALE

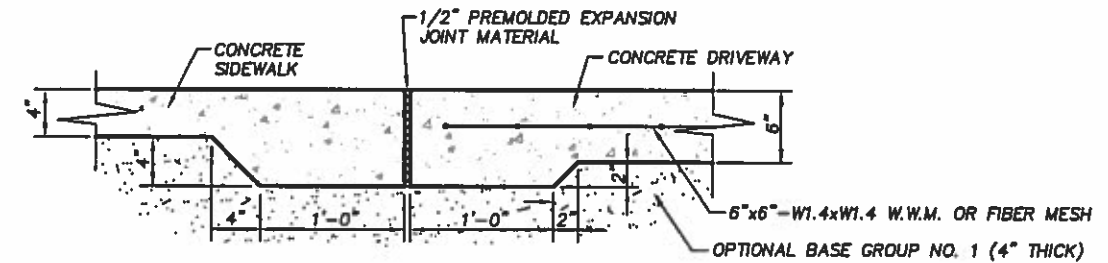

**TYPICAL 4" CONCRETE SIDEWALK AND  
6" CONCRETE DRIVEWAY REPLACEMENT DETAIL**  
NOT TO SCALE

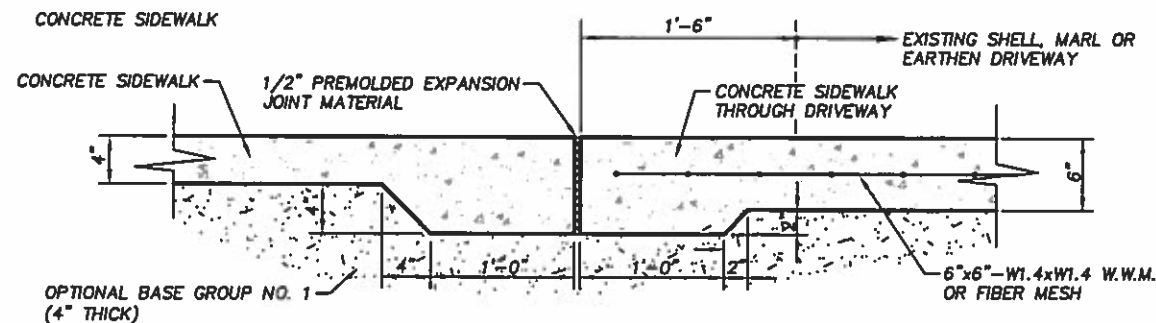

**NOTE:**  
A 1'-0" THICKENED EDGE SHALL BE ON ALL SIDES OF THE  
SIDEWALK THRU THE SHELL, MARL OR EARTHEN DRIVEWAY

**TYPICAL CONCRETE SIDEWALK DETAIL  
AT EXISTING SHELL, MARL OR EARTHEN DRIVEWAY**  
NOT TO SCALE

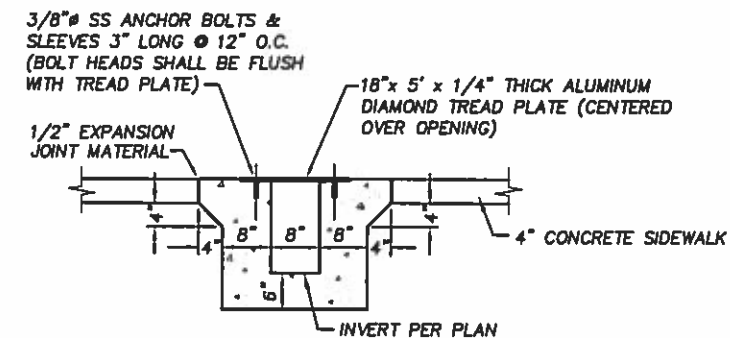

**SIDEWALK TRENCH DRAIN DETAIL**  
NOT TO SCALE

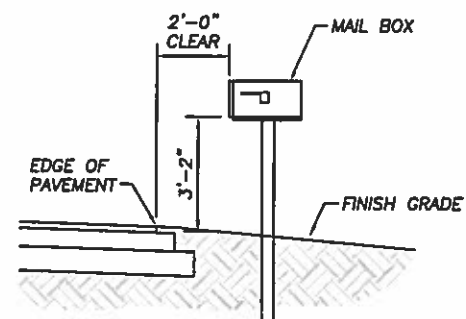

**NOTE:**  
1. WHEN AN EXISTING MAIL BOX IS BEING RELOCATED, THE  
NEW LOCATION SHALL BE WITHIN ONE FOOT OF THE  
EXISTING LOCATION PARALLEL WITH THE ROADWAY.  
2. CONSTRUCTION SHALL CONFORM TO THE REQUIREMENTS  
OF THE U. S. POSTAL SERVICE

**TYPICAL MAIL BOX DETAIL**  
NOT TO SCALE

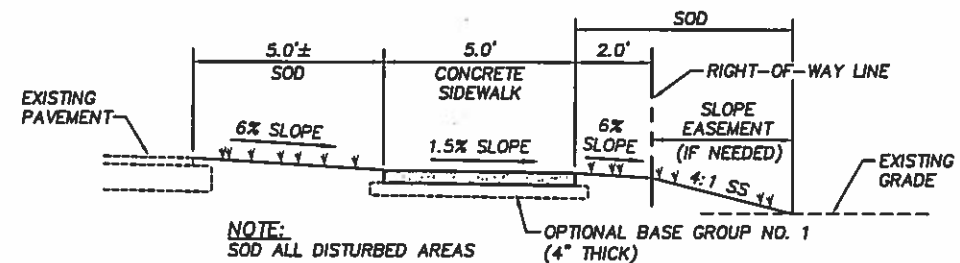

**NOTE:**  
SOD ALL DISTURBED AREAS  
OPTIONAL BASE GROUP NO. 1  
(4" THICK)

**TYPICAL SIDEWALK SECTION**  
NOT TO SCALE

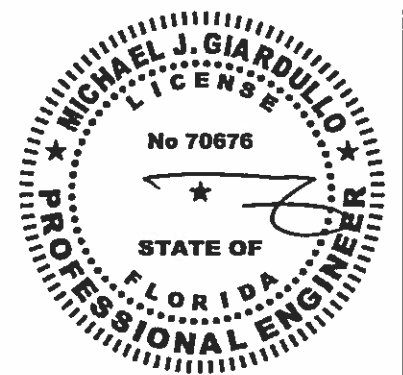

Michael J. Giardullo  
Professional Engineer  
State of Florida  
Registration No. 70676  
ENGINEER OF RECORD  
DATE OF SIGNATURE:  
June 19, 2017

REVISIONS			
DATE	DESCRIPTION	DATE	DESCRIPTION

**WEC** *ellence in engineering*  
WEILER ENGINEERING CORPORATION  
201 WEST MARION AVENUE, SUITE 1306  
PUNTA GORDA, FLORIDA 33950  
OFFICE: (941) 505-1700  
FAX: (941) 505-1702 EB # 0056

**MARTIN L. KING JR. BOULEVARD  
SIDEWALK EXTENSION**

**SIDEWALK DETAILS**

SHEET  
NO.

D-9

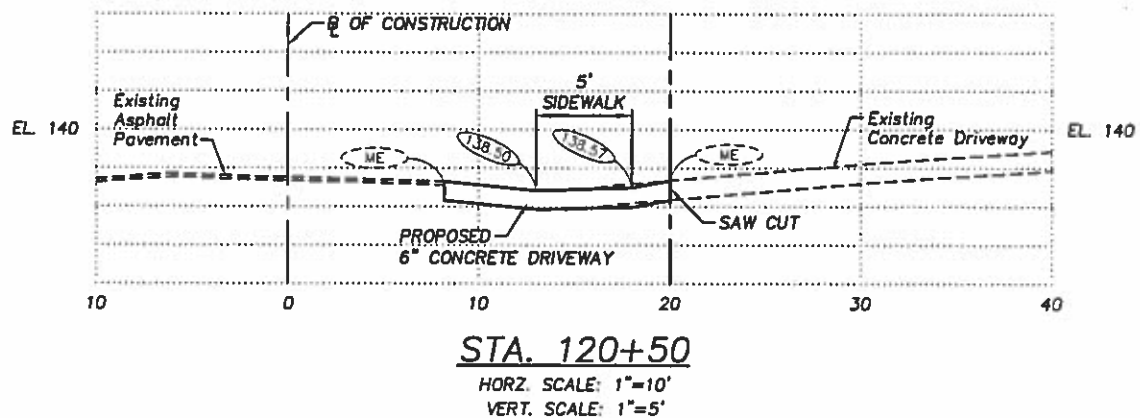
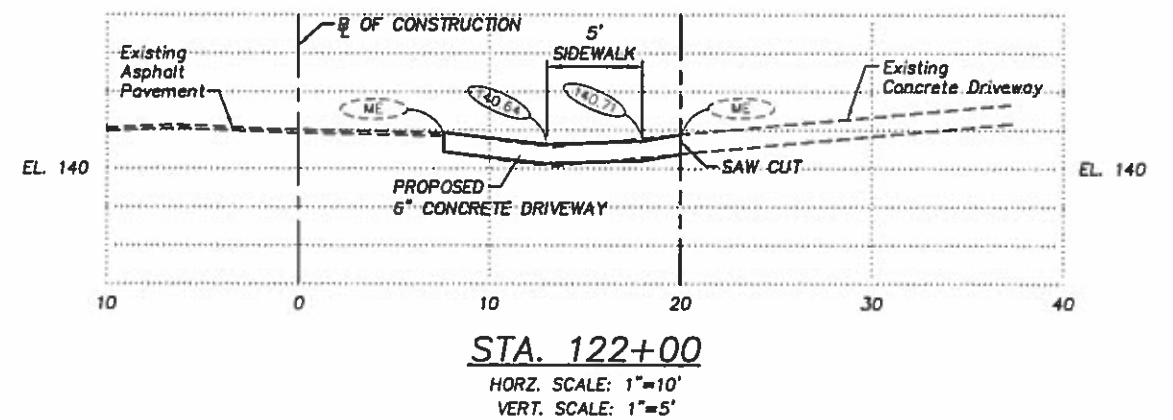
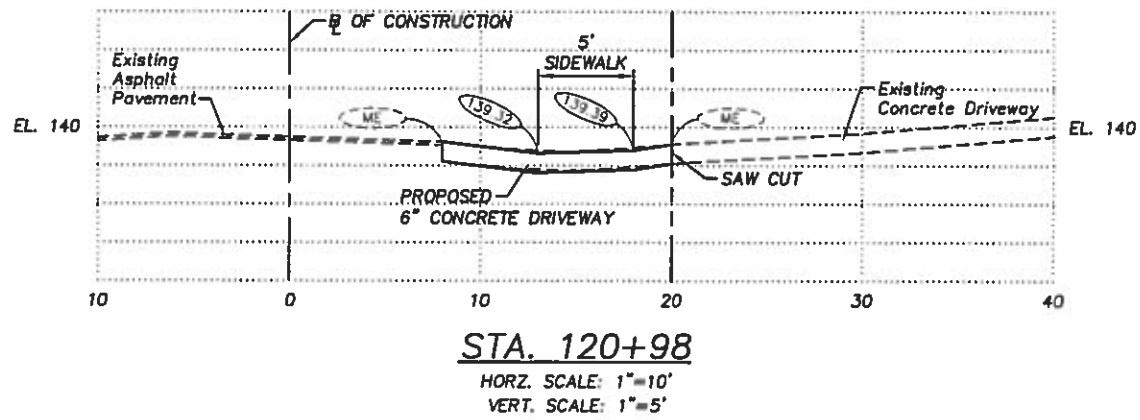
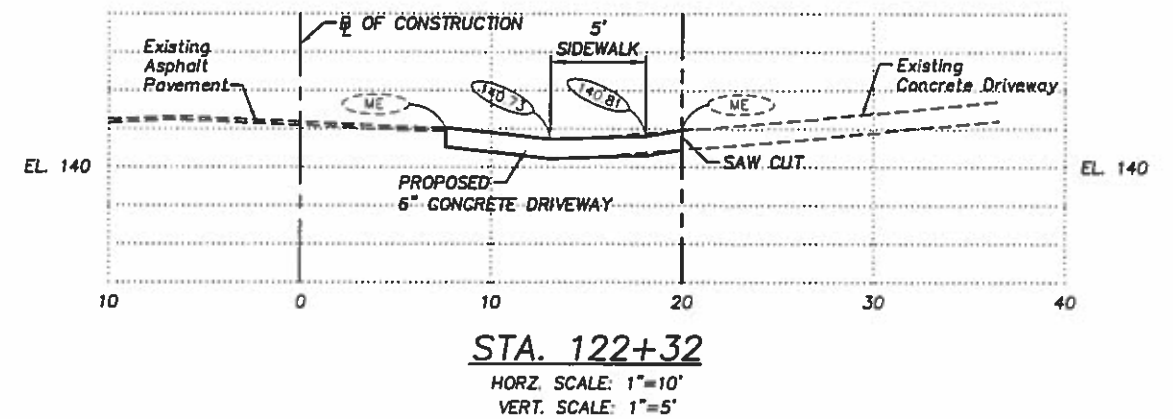
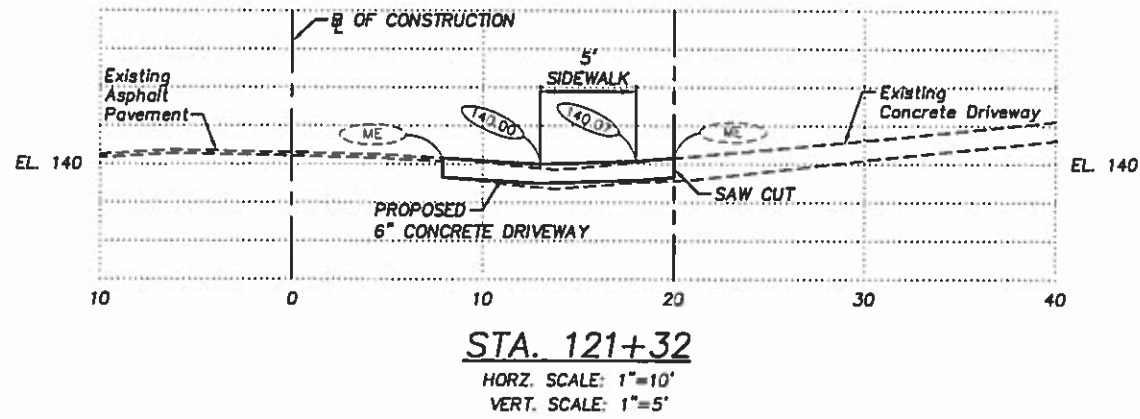

Michael J. Giardullo  
 Professional Engineer  
 State of Florida  
 Registration No. 70676  
 ENGINEER OF RECORD  
 DATE OF SIGNATURE:  
 June 19, 2017

REVISIONS			
DATE	DESCRIPTION	DATE	DESCRIPTION

**WEC** *excellence in engineering*  
 WEILER ENGINEERING CORPORATION  
 201 WEST MARION AVENUE, SUITE 1306  
 PUNTA GORDA, FLORIDA 33950  
 OFFICE: (941) 505-1700  
 FAX: (941) 505-1702  
 EB # 6656

**MARTIN L. KING JR. BOULEVARD**  
**SIDEWALK EXTENSION**

**DRIVEWAY REPLACEMENT**  
**CROSS SECTIONS**

SHEET NO.  
**D-10**



**EROSION AND SEDIMENT CONTROL NOTES**

1. STAKED SILT FENCE SHALL BE INSPECTED AND MAINTAINED ON A DAILY BASIS DURING CONSTRUCTION.
2. ALL STAKED SILT FENCE SHALL CONFORM TO THE LATEST EDITION OF THE F.D.O.T. MANUAL FOR EROSION AND SEDIMENT CONTROL MANUAL.

**EROSION CONTROL MAINTENANCE SCHEDULE**

THE CONTRACTOR SHALL INSTALL SILT FENCE, STAKED HAY BALES, AND OTHER EROSION CONTROL DEVICES AS SHOWN ON THE DRAWINGS PRIOR TO BEGINNING CONSTRUCTION. THESE INSTALLATIONS AS SHOWN ON THE DRAWINGS SHALL BE CONSIDERED THE MINIMUM EROSION/SILTATION PROTECTION REQUIRED FOR THE SITE. IN ADDITION THE ENGINEER, OWNER, OR OWNER'S REPRESENTATIVE MAY DEEM IT NECESSARY TO INSTALL PROTECTIVE FACILITIES ELSEWHERE ON THE SITE.

THE CONTRACTOR SHALL BE RESPONSIBLE FOR MAINTAINING THE EROSION PROTECTION FACILITIES THROUGH COMPLETION OF CONSTRUCTION. THE CONTRACTOR SHALL PERFORM DAILY INSPECTIONS OF THE FACILITIES TO ENSURE THAT THE EROSION PROTECTION FACILITIES ARE MAINTAINING THEIR PROTECTION FUNCTIONS AND INTEGRITY.

ALL EROSION PROTECTION FACILITIES SHALL BE REMOVED AFTER CONSTRUCTION COMPLETION, AND WHEN A VEGETATIVE COVER HAS BEEN WELL ESTABLISHED OVER THE CONSTRUCTED AREAS, PER THE PLANS: THE CONTRACTOR SHALL REMOVE PROTECTION FACILITIES ONLY UPON APPROVAL BY THE ENGINEER, OWNER, OR OWNER'S REPRESENTATIVE.

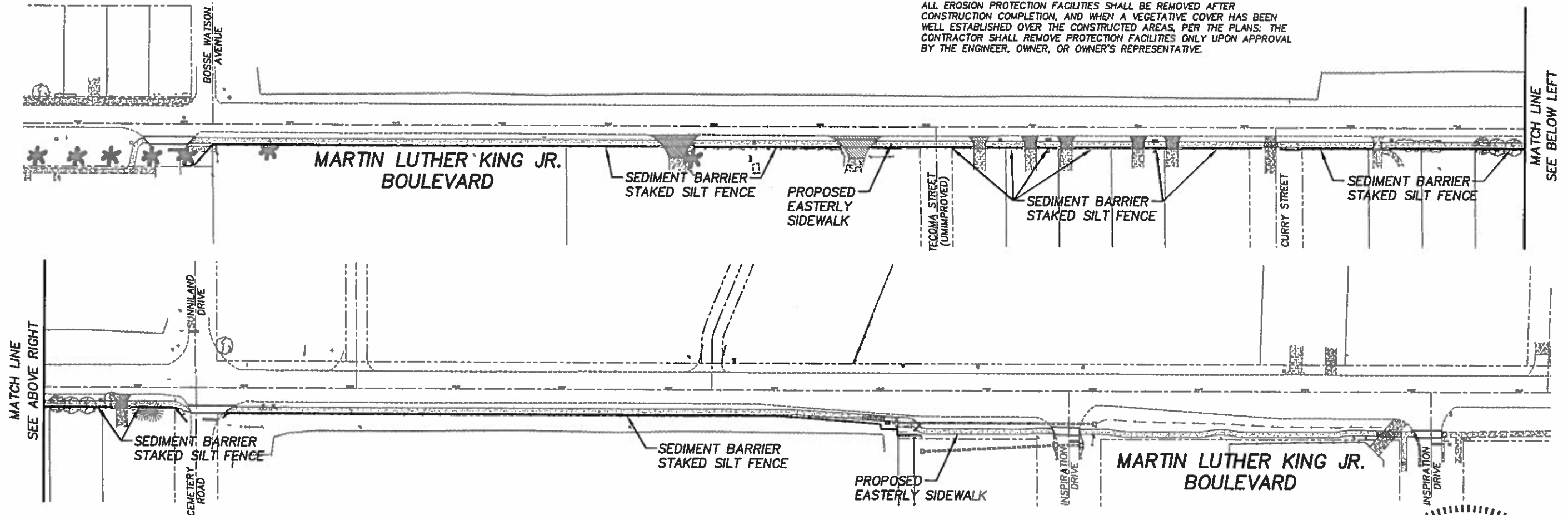

MATCH LINE  
SEE ABOVE RIGHT

MATCH LINE  
SEE BELOW LEFT

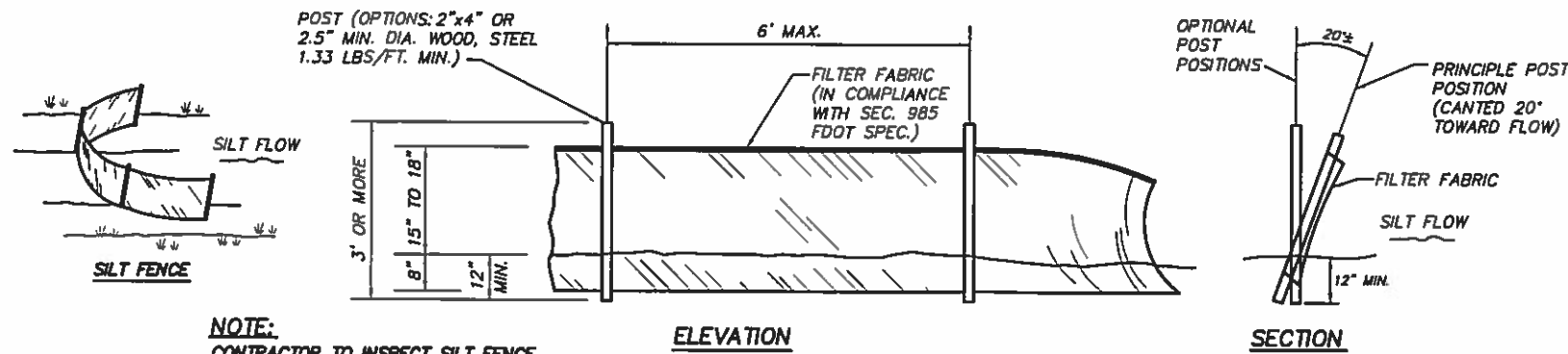

**NOTE:**  
CONTRACTOR TO INSPECT SILT FENCE DAILY AND REPAIR IMMEDIATELY IF DAMAGED.

**ELEVATION**

**SECTION**

**TYPICAL SILT FENCE**

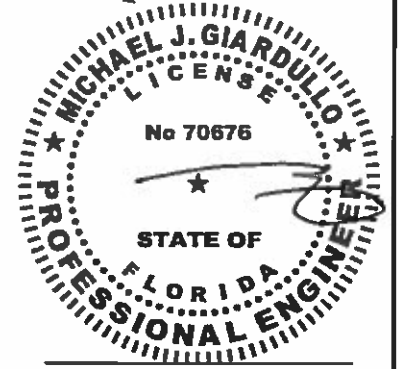

Michael J. Giardullo  
Professional Engineer  
State of Florida  
Registration No. 70676  
ENGINEER OF RECORD  
DATE OF SIGNATURE:  
June 19, 2017

REVISIONS		DATE	DESCRIPTION
2-27-17	DELETED COMMERCIAL ASPHALT DRIVEWAYS AT STA. 117+62 (R) & 119+34 (R) AND REPLACE WITH CONCRETE DRIVEWAYS		
6-2-17	DELETED MAINTAINED RIGHT-OF-WAY (WEST SIDE)		

**WEC** *excellence in engineering*  
WEILER ENGINEERING CORPORATION  
201 WEST MARION AVENUE, SUITE 1306  
PUNTA GORDA, FLORIDA 33950  
OFFICE: (841) 505-1700  
FAX: (841) 505-1702  
EB # 6856

**MARTIN L. KING JR. BOULEVARD  
SIDEWALK EXTENSION**

**BEST MANAGEMENT PRACTICES  
PLAN AND DETAILS**

SHEET NO.  
**BMP-1**