

1 SHAFT WALL PLAN - LEVEL 00  
1 1/2" = 1'-0"

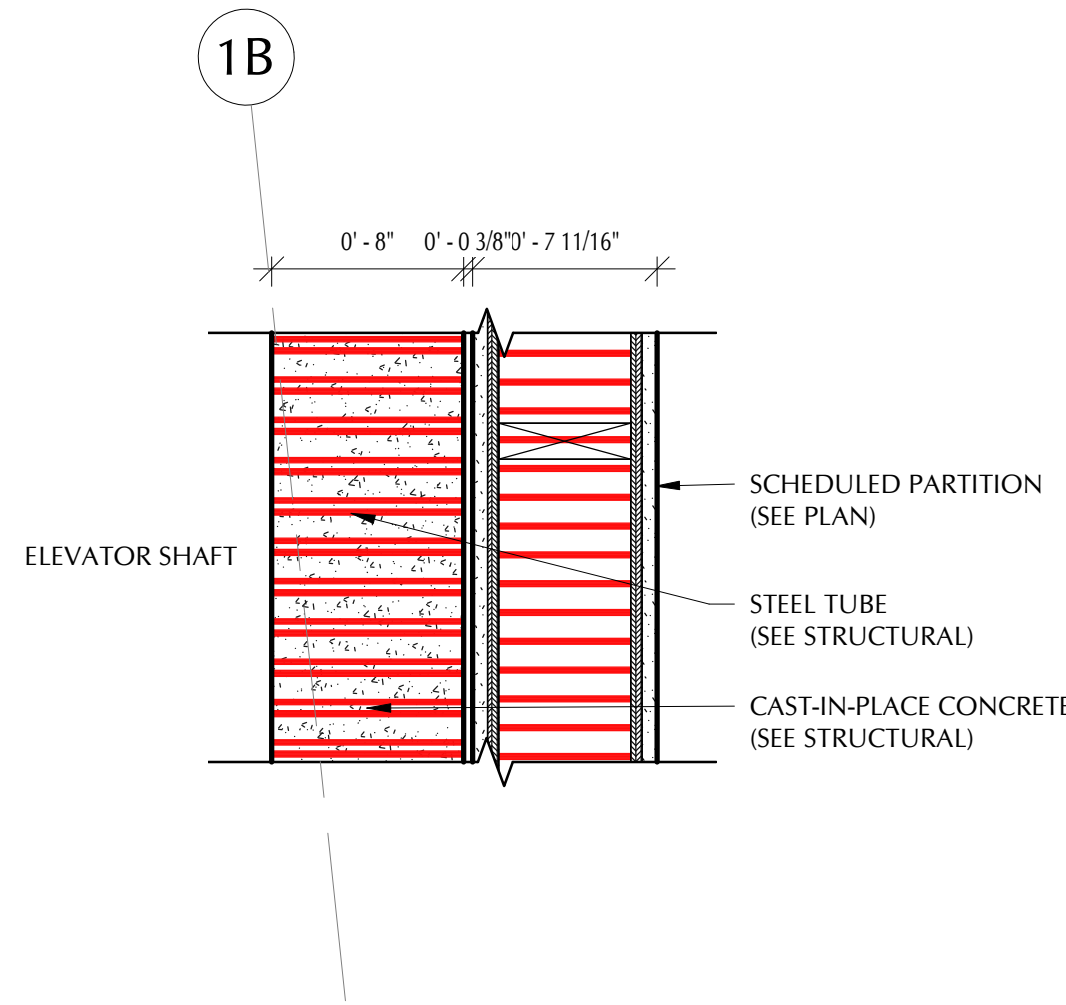

2 SHAFT WALL PLAN - LEVEL 3-5  
1 1/2" = 1'-0"

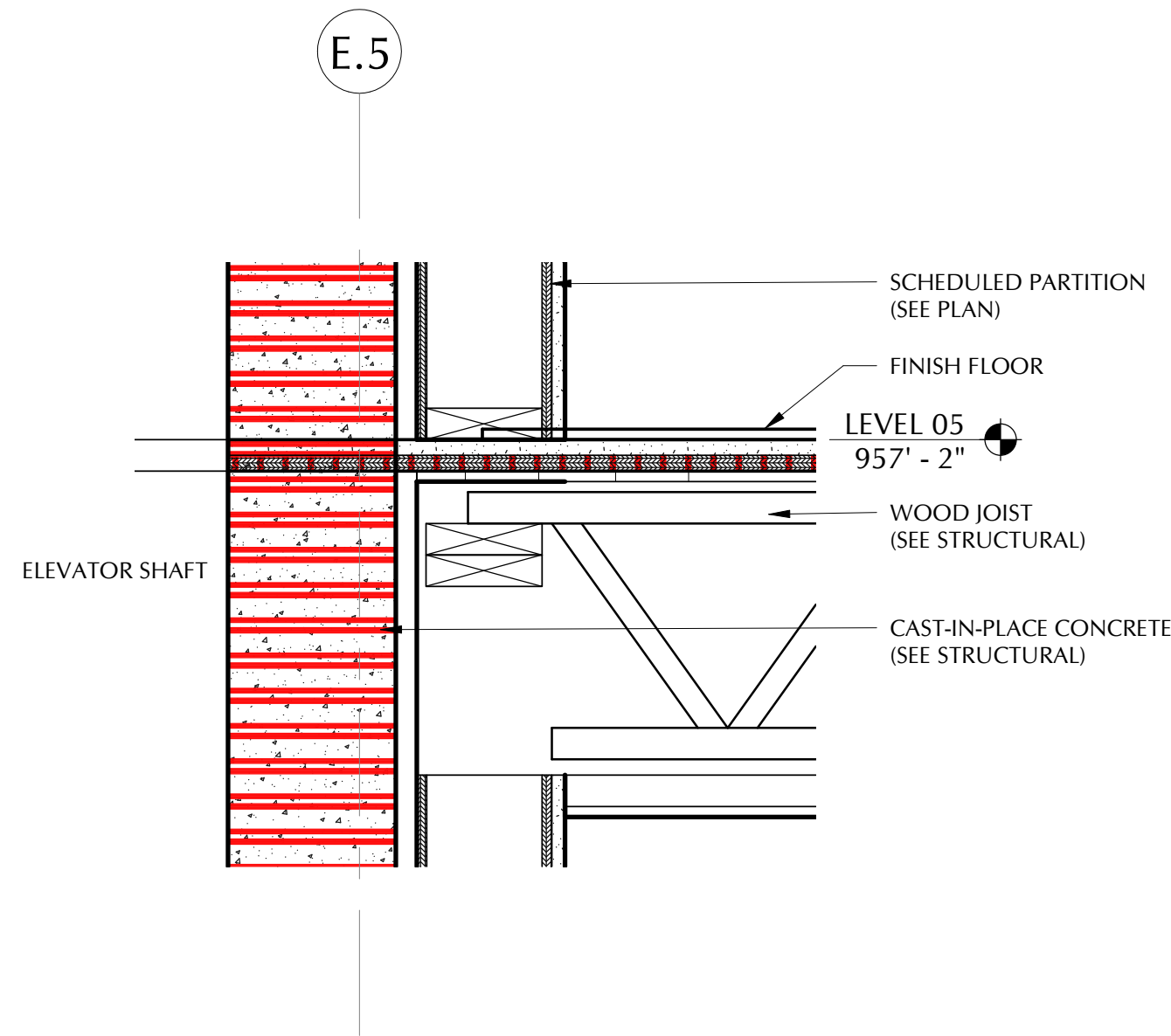

3 SHAFT WALL SECTION  
1 1/2" = 1'-0"

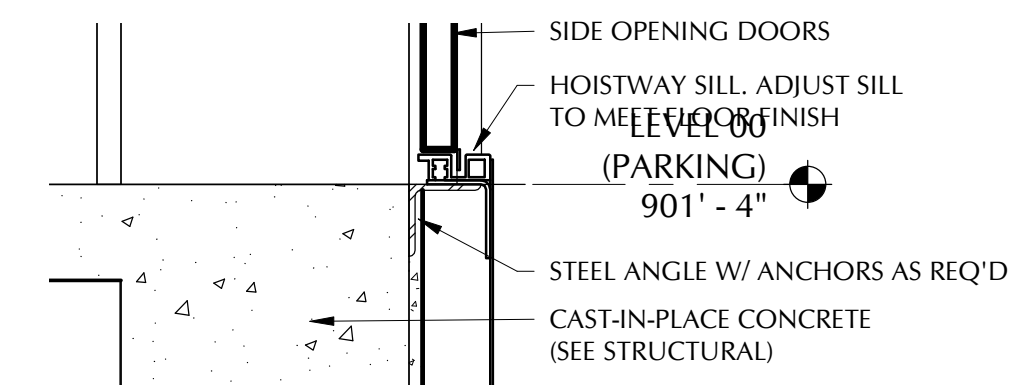

4 ELEV. SILL DETAIL @ LEVEL 00  
1 1/2" = 1'-0"

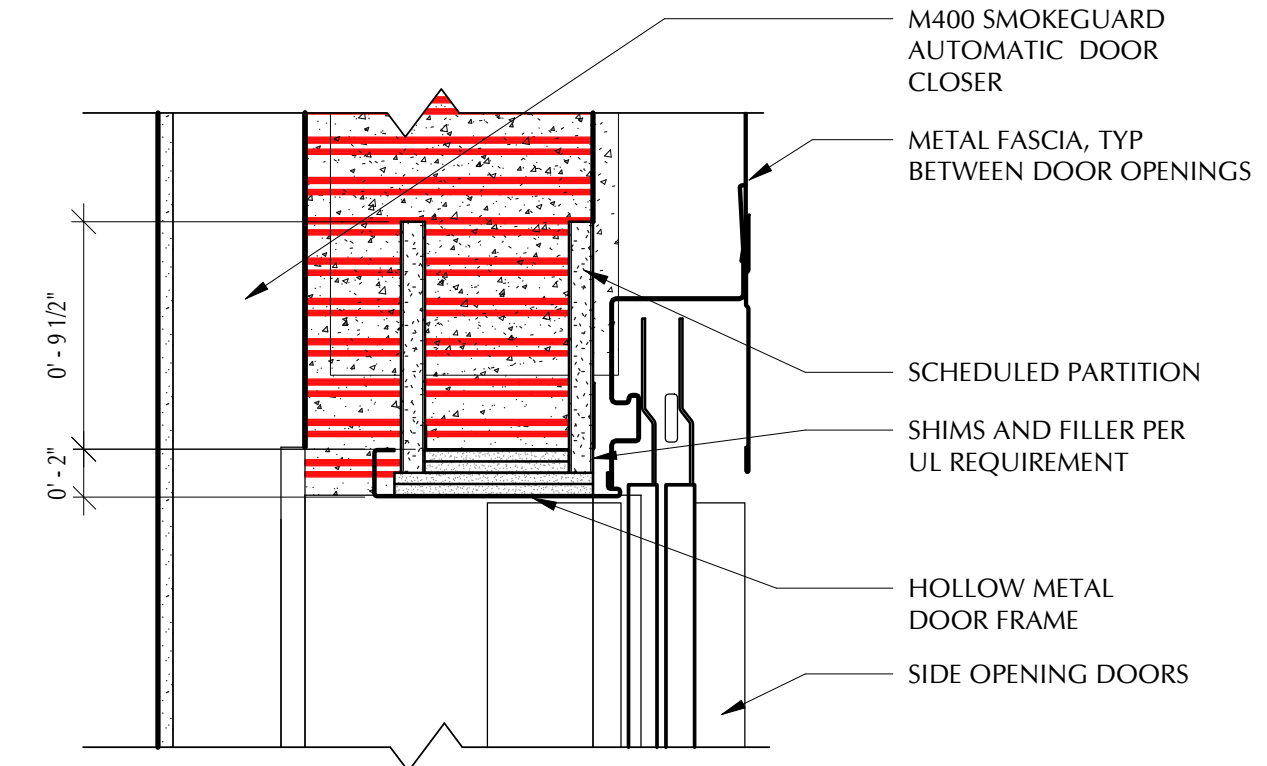

5 HEAD DETAIL AT ELEV. 1  
1 1/2" = 1'-0"

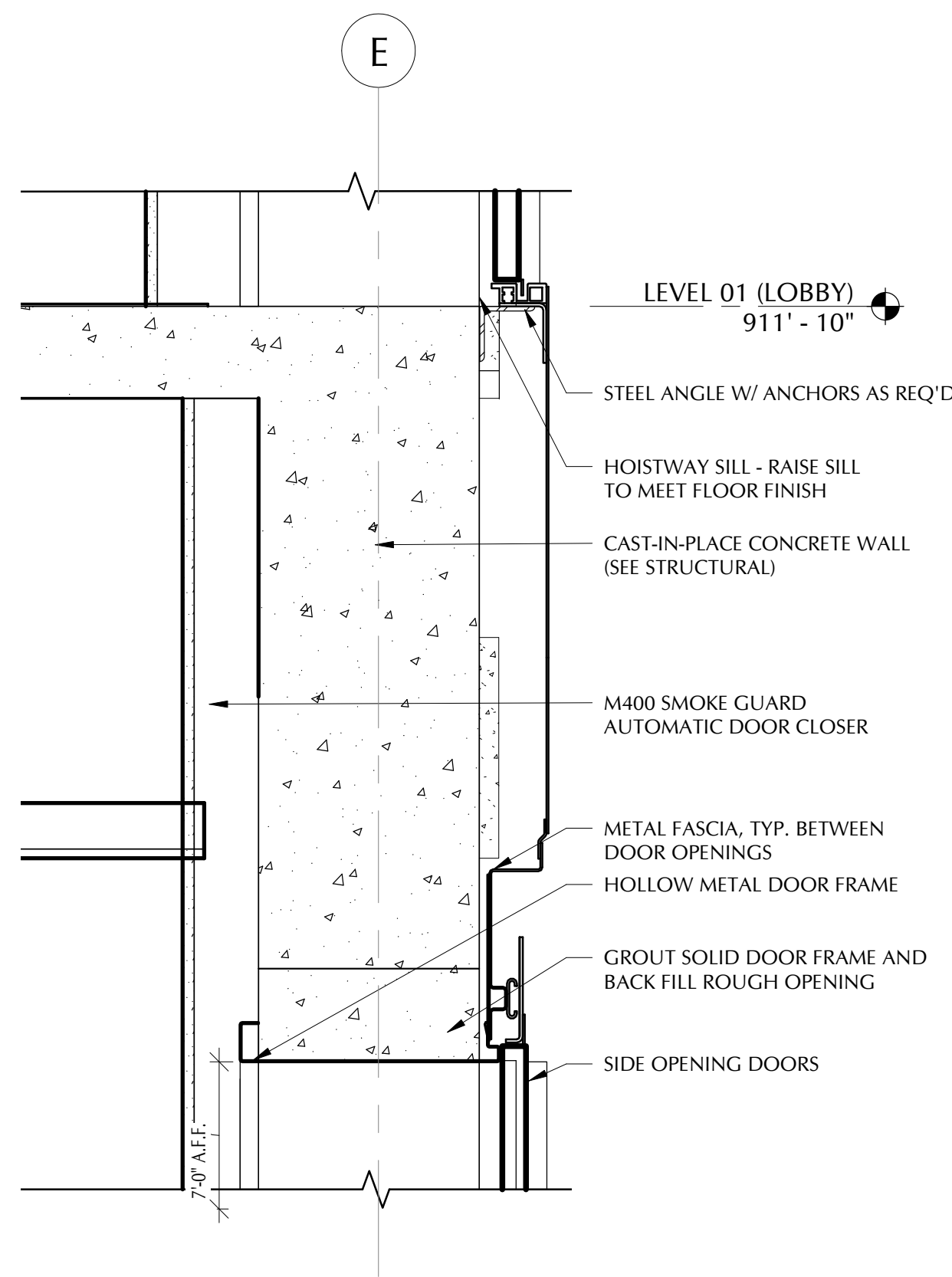

6 ELEV. HEAD AND SILL DETAIL @ LVL. 00  
1 1/2" = 1'-0"

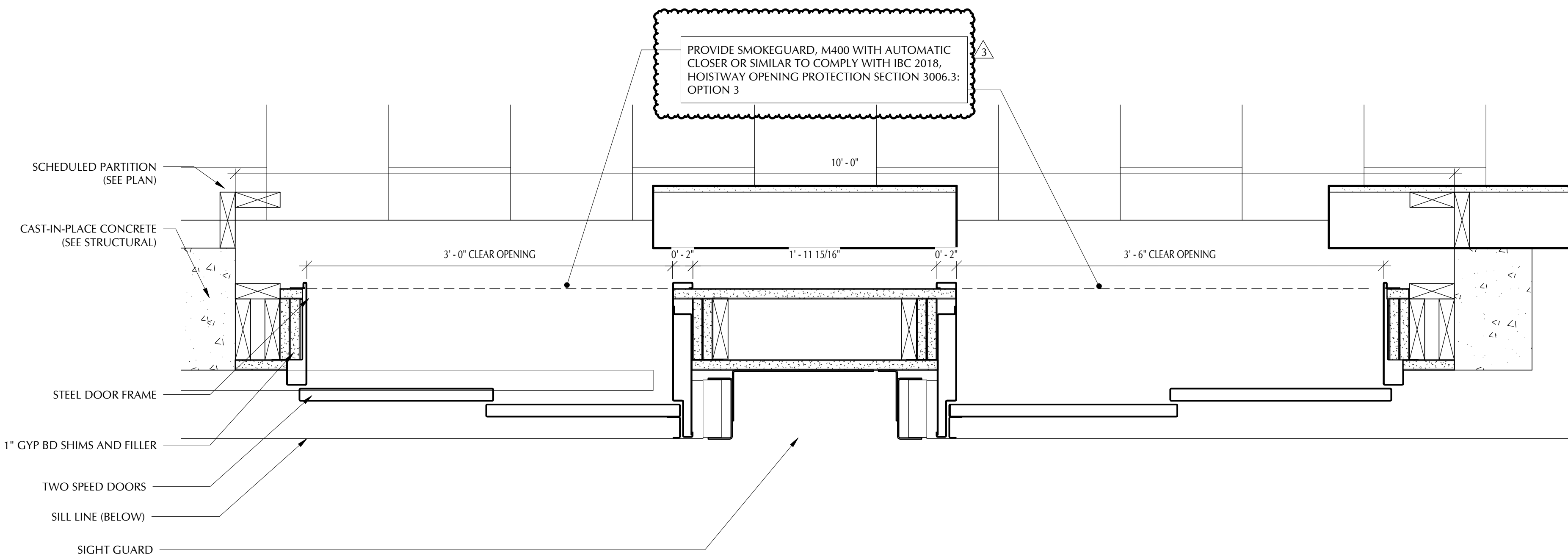

9 DETAIL - ELEV. JAMB LEVEL 00 - 02  
1 1/2" = 1'-0"

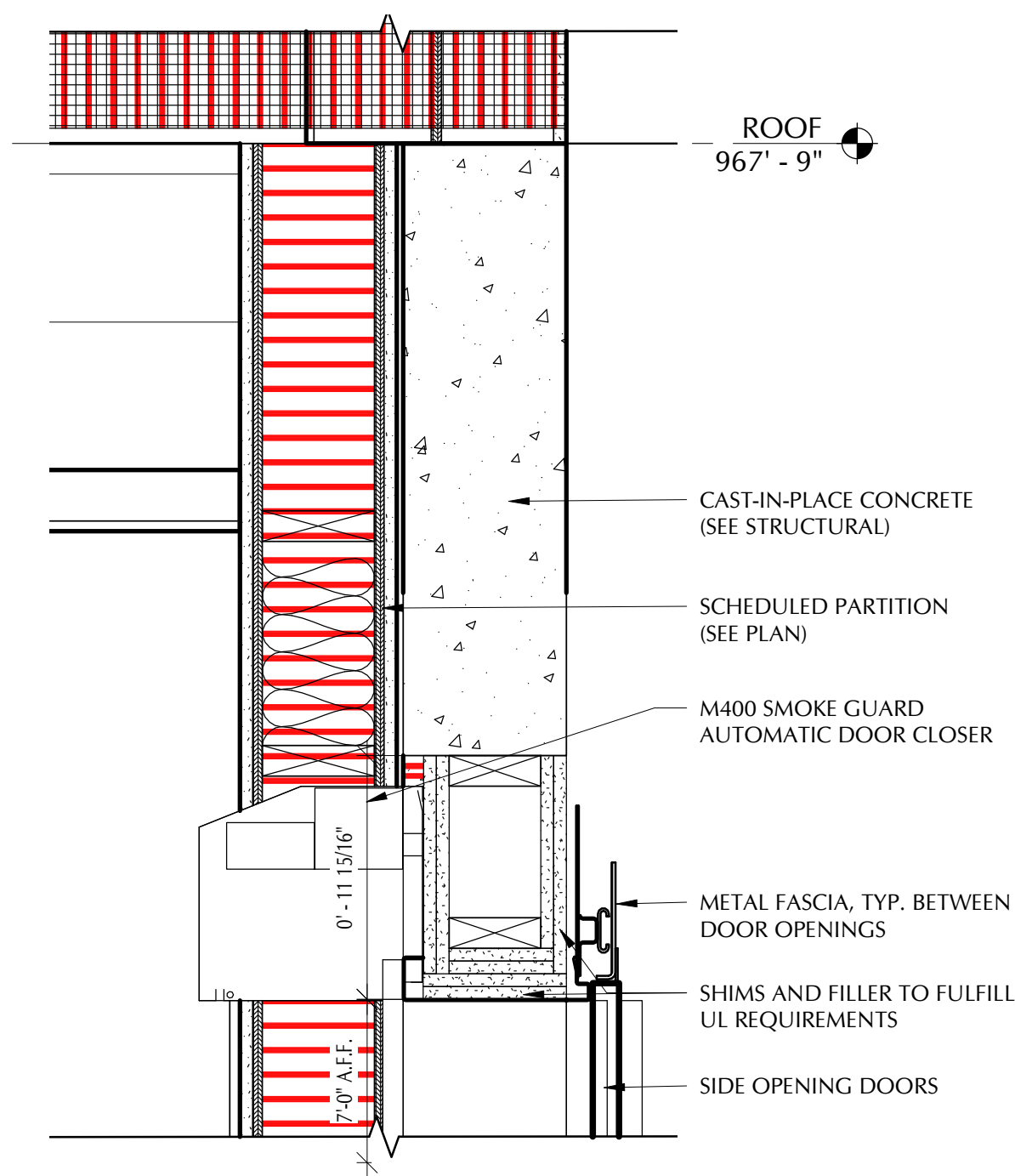

7 ELEV. HEAD DETAIL @ LVL. 05  
1 1/2" = 1'-0"

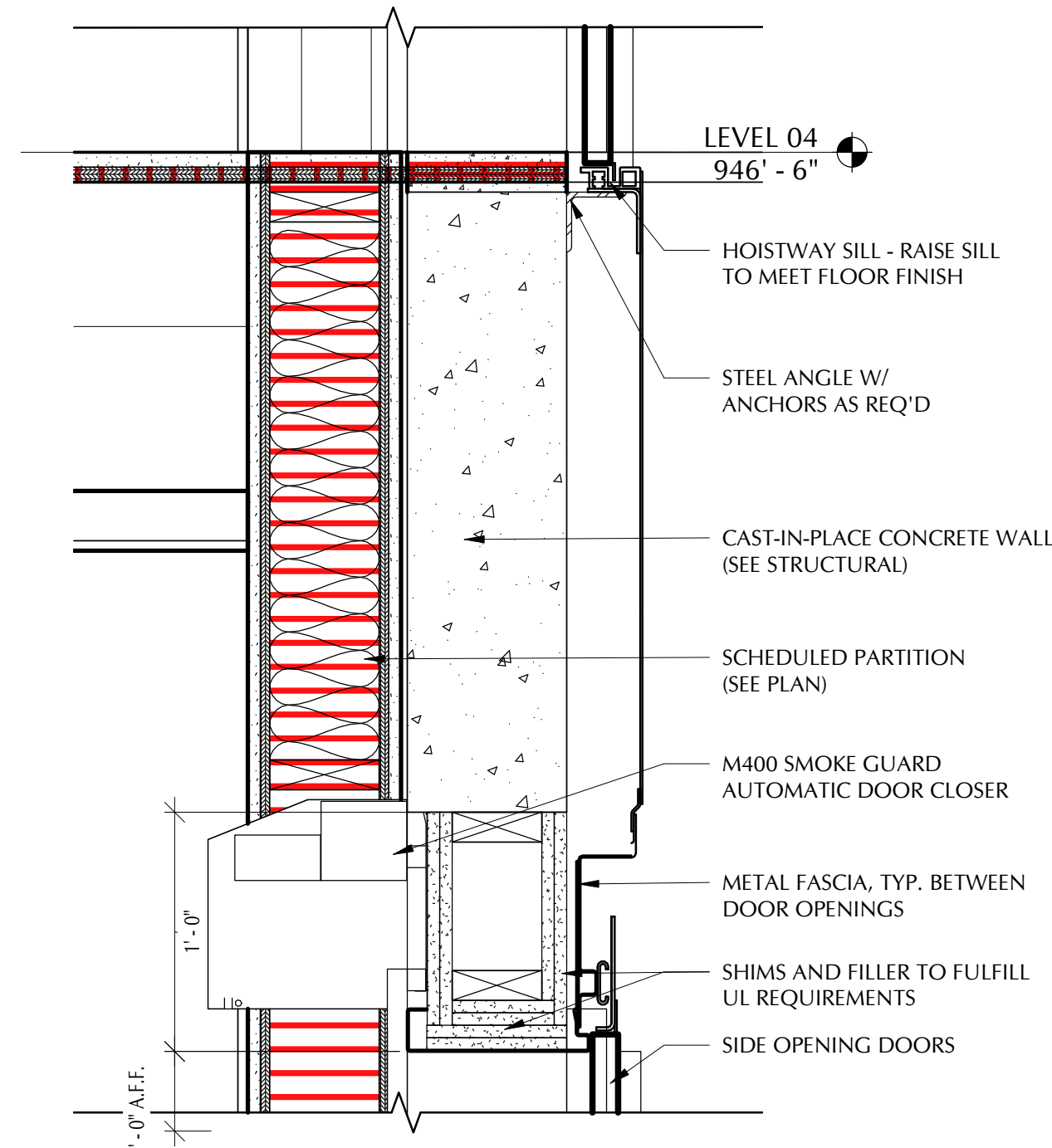

8 ELEV. HEAD AND SILL DETAIL @ LVL. 02-04  
1 1/2" = 1'-0"

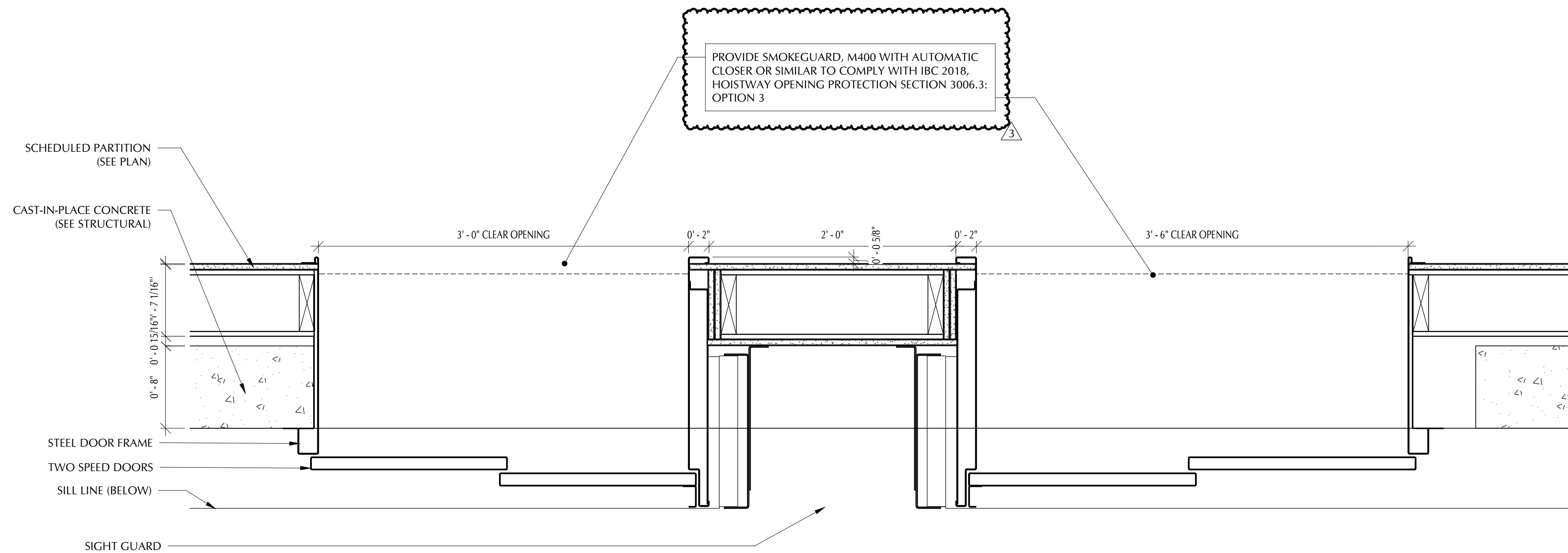

10 DETAIL - ELEV. JAMB LEVEL 03-05  
1 1/2" = 1'-0"

Date	Description
05/06/2020	PLANS REVIEW COMMENTS
06/02/2020	ADDENDUM 2



Seal / Signature



Project Name 05.06.2020

AUSTIN HOMES

Project Number

193076

Description

DETAILS - ELEVATOR

Scale

1 1/2" = 1'-0"

MF-A5.5



DOOR SCHEDULE LEVEL 00											
Number	Elev	Material	Door Dimensions			Thickness	Frame		Fire Rating	HARDWARE SET	NOTES
			Finish	Width	Height		Material	Finish			
001A	D-G/L	ALUM/CL	AL1	6'-0"	7'-0"	0'-1 3/4"	ALUM	AL1		A	INTERCHANGABLE CORE, PANIC DEVICE
002	F	HM	PTD	3'-0"	7'-0"	0'-1 3/4"	HM	PTD		E	
003	F	SCW	PTD	3'-0"	7'-0"	0'-1 3/4"	HM	PTD		C	
004	F	HM	PTD	3'-0"	7'-0"	0'-1 3/4"	HM	PTD		C	
005	F	SCW	PTD	3'-0"	7'-0"	0'-1 3/4"	HM	PTD		E	
001B	G	ALUM/CL	AL1	3'-0"	7'-0"	0'-1 3/4"	ALUM	AL1		A	INTERCHANGABLE CORE, PANIC DEVICE
007	F	SCW	PTD	3'-0"	7'-0"	0'-1 3/4"	HM	PTD		A	ACCESS CONTROL BY OTHERS
008	G-SL	WD/GL	PTD	3'-0"	7'-0"	0'-2"	HM	PTD		A	
009	F	SCW	PTD	3'-0"	7'-0"	0'-1 3/4"	HM	PTD		E	
010	NL	SCW	PTD	3'-0"	7'-0"	0'-2"	HM	PTD	1-1/2 HR		
011	G-SL	WD/GL	PTD	3'-0"	7'-0"	0'-2"	HM	PTD		E	
012	OH	ALUM	AL1	10'-0"	7'-6"	0'-1"	ALUM	AL1			
013	OH	ALUM	AL1	10'-0"	7'-6"	0'-1"	ALUM	AL1			

DOOR SCHEDULE LEVEL 01											
Number	Elev.	Material	Door Dimensions			Thickness	Frame		Fire Rating	HARDWARE SET	NOTES
			Finish	Width	Height		Material	Finish			
100	D-G	ALUM/CL	AL1	6'-0"	7'-0"	0'-1 3/4"	ALUM	AL1		D	ACCESS CONTROL BY OTHERS
100B	E2	SCW	PTD	3'-0"	7'-0"	0'-1 3/4"	HM	PTD	20 MIN.	B	INTERCHANGABLE CORE
101	E2	SCW	PTD	3'-0"	6'-8"	0'-1 3/4"	HM	PTD	20 MIN.	B	INTERCHANGABLE CORE
102	E2	SCW	PTD	3'-0"	6'-8"	0'-1 3/4"	HM	PTD	20 MIN.	B	INTERCHANGABLE CORE
103	E2	SCW	PTD	3'-0"	6'-8"	0'-1 3/4"	HM	PTD	20 MIN.	B	INTERCHANGABLE CORE
104	E2	SCW	PTD	3'-0"	6'-8"	0'-1 3/4"	HM	PTD	20 MIN.	B	INTERCHANGABLE CORE
105	NL	SCW	PTD	3'-0"	7'-0"	0'-2"	HM	PTD	3/4 HR		ACCESS CONTROL BY OTHERS
106	E2	SCW	PTD	3'-0"	6'-8"	0'-1 3/4"	HM	PTD		C	
107	E2	SCW	PTD	3'-0"	6'-8"	0'-1 3/4"	HM	PTD		C	
108	FG	ALUM/CL	AL1	3'-0"	7'-0"	0'-1 3/4"	ALUM	AL1			INTERCHANGABLE CORE
109	G-SL	WD/GL	PTD	3'-0"	7'-0"	0'-2"	HM	PTD			ACCESS CONTROL BY OTHERS
110	D-E2	SCW	PTD	3'-0"	7'-0"	0'-1 3/4"	HM	PTD		A	
111A	D-G	ALUM/CL	AL1	6'-0"	7'-0"	0'-1 3/4"	ALUM	AL1			ACCESS CONTROL BY OTHERS
111B	D-G	ALUM/CL	AL1	6'-0"	7'-0"	0'-1 3/4"	ALUM	AL1			ACCESS CONTROL BY OTHERS
111C	D-G	ALUM/CL	AL1	6'-0"	7'-0"	0'-1 3/4"	ALUM	AL1			ACCESS CONTROL BY OTHERS
111D	D-G	ALUM/CL	AL1	6'-0"	7'-0"	0'-1 3/4"	ALUM	AL1			ACCESS CONTROL BY OTHERS
111E	D-G	ALUM/CL	AL1	6'-0"	7'-0"	0'-1 3/4"	ALUM	AL1			ACCESS CONTROL BY OTHERS
112	G-SL	WD/GL	PTD	3'-0"	7'-0"	0'-2"	HM	PTD			ACCESS CONTROL BY OTHERS
113	E2	SCW	PTD	3'-0"	7'-0"	0'-1 3/4"	HM	PTD			INTERCHANGABLE CORE
114A	D-F	HM	PTD	6'-0"	7'-0"	0'-1 3/4"	HM	PTD			INTERCHANGABLE CORE
114B	F	HM	PTD	3'-0"	7'-0"	0'-1 3/4"	HM	PTD			INTERCHANGABLE CORE
115	F	HM	PTD	3'-0"	7'-0"	0'-1 3/4"	HM	PTD	45 MIN.	A	INTERCHANGABLE CORE
116	F	HM	PTD	3'-0"	8'-0"	0'-1 3/4"	HM	PTD		A	INTERCHANGABLE CORE
117	F	HM	PTD	3'-0"	7'-0"	0'-1 3/4"	HM	PTD		A	ACCESS CONTROL BY OTHERS
118A	FG	ALUM/CL	AL1	3'-0"	7'-0"	0'-1 3/4"	ALUM	AL1			ACCESS CONTROL BY OTHERS
118B	FG	ALUM/CL	AL1	3'-0"	7'-0"	0'-1 3/4"	ALUM	AL1			ACCESS CONTROL BY OTHERS
118C	D-F	HM	PTD	6'-0"	7'-0"	0'-1 3/4"	HM	PTD			ACCESS CONTROL BY OTHERS
119	E2	HM	PTD	3'-0"	7'-0"	0'-1 3/4"	HM	PTD	1-1/2 HR	A	INTERCHANGABLE CORE
120A				3'-0"	7'-0"	0'-2"	HM	PTD			
120B	D-F	HM	PTD	6'-0"	7'-0"	0'-1 3/4"	HM	PTD	1-1/2 HR		
120C	D-F	HM	PTD	6'-0"	7'-0"	0'-1 3/4"	HM	PTD			
121A	D-F	HM	PTD	6'-0"	7'-0"	0'-1 3/4"	HM	PTD			
121B	D-F	HM	PTD	3'-0"	7'-0"	0'-1 3/4"	HM	PTD	1-1/2 HR		
121C	F	HM	PTD	3'-0"	7'-0"	0'-1 3/4"	HM	PTD			
122	F	HM	PTD	3'-0"	7'-0"	0'-1 3/4"	HM	PTD		A	INTERCHANGABLE CORE
123A	NL	SCW	PTD	3'-0"	7'-0"	0'-2"	HM	PTD	1-1/2 HR		
123B		SCW	PTD	3'-0"	7'-0"	0'-1 3/4"	HM	PTD			
124	NL	SCW	PTD	3'-0"	7'-0"	0'-2"	HM	PTD	1-1/2 HR		
125	F	HM	PTD	3'-0"	7'-0"	0'-1 3/4"	HM	PTD			
126	F	HM	PTD	3'-0"	7'-0"	0'-1 3/4"	HM	PTD		A	ACCESS CONTROL BY OTHERS
128	F	HM	PTD	3'-0"	7'-0"	0'-1 3/4"	HM	PTD		C	

DOOR SCHEDULE LEVEL 02											
Number	Elev.	Material	Door Dimensions			Thickness	Frame		Fire Rating	HARDWARE SET	NOTES
			Finish	Width	Height		Material	Finish			
201	E2	SCW	PTD	3'-0"	7'-0"	0'-1 3/4"	HM	PTD	20 MIN.	B	INTERCHANGABLE CORE
202	E2	SCW	PTD	3'-0"	7'-0"	0'-1 3/4"	HM	PTD	20 MIN.	B	INTERCHANGABLE CORE
203	E2	SCW	PTD	3'-0"	7'-0"	0'-1 3/4"	HM	PTD	20 MIN.	B	INTERCHANGABLE CORE
204	E2	SCW	PTD	3'-0"	7'-0"	0'-1 3/4"	HM	PTD	20 MIN.	B	INTERCHANGABLE CORE
205	E2	SCW	PTD	3'-0"	7'-0"	0'-1 3/4"	HM	PTD	20 MIN.	B	INTERCHANGABLE CORE
206	E2	SCW	PTD	3'-0"	7'-0"	0'-1 3/4"	HM	PTD	20 MIN.	B	INTERCHANGABLE CORE
207	E2	SCW	PTD	3'-0"	7'-0"	0'-1 3/4"	HM	PTD	20 MIN.	B	INTERCHANGABLE CORE
208	E2	SCW	PTD	3'-0"	7'-0"	0'-1 3/4"	HM	PTD	45 MIN.	B	INTERCHANGABLE CORE
209	E2	SCW	PTD	3'-0"	7'-0"	0'-1 3/4"	HM	PTD	20 MIN.	B	INTERCHANGABLE CORE
210	E2	SCW	PTD	3'-0"	7'-0"	0'-1 3/4"	HM	PTD	20 MIN.	B	INTERCHANGABLE CORE
211	E2	SCW	PTD	3'-0"	7'-0"	0'-1 3/4"	HM	PTD	20 MIN.	B	INTERCHANGABLE CORE
212	E2	SCW	PTD	3'-0"	7'-0"	0'-1 3/4"	HM	PTD	20 MIN.	B	INTERCHANGABLE CORE
213	E2	SCW	PTD	3'-0"	7'-0"	0'-1 3/4"	HM	PTD	20 MIN.	B	INTERCHANGABLE CORE
214	E2	SCW	PTD	3'-0"	7'-0"	0'-1 3/4"	HM	PTD	20 MIN.	B	INTERCHANGABLE CORE
215	E2	SCW	PTD	3'-0"	7'-0"	0'-2"	HM	PTD	1-1/2 HR		
216	E2	SCW	PTD	3'-0"	7'-0"	0'-1 3/4"	HM	PTD	1-1/2 HR		
217	D-E2	SCW	PTD	6'-0"	7'-0"	0'-1 3/4"	HM	PTD	20 MIN.	D	
218	E2	SCW	PTD	3'-0"	7'-0"	0'-1 3/4"	HM	PTD	20 MIN.	B	INTERCHANGABLE CORE

DOOR SCHEDULE LEVEL 03											
Number	Elev.	Material	Door Dimensions			Thickness	Frame		Fire Rating	HARDWARE SET	NOTES
			Finish	Width	Height		Material	Finish			
301	E2	SCW	PTD	3'-0"	7'-0"	0'-1 3/4"	HM	PTD	20 MIN.	B	INTERCHANGABLE CORE
302	E2	SCW	PTD	3'-0"	7'-0"	0'-1 3/4"	HM	PTD	20 MIN.	B	INTERCHANGABLE CORE
303	E2	SCW	PTD	3'-0"	7'-0"	0'-1 3/4"	HM	PTD	20 MIN.	B	INTERCHANGABLE CORE
304	E2	SCW	PTD	3'-0"	7'-0"	0'-1 3/4"	HM	PTD	20 MIN.	B	INTERCHANGABLE CORE
305	E2	SCW	PTD	3'-0"	7'-0"	0'-1 3/4"	HM	PTD	20 MIN.	B	INTERCHANGABLE CORE
306	E2	SCW	PTD	3'-0"	7'-0"	0'-1 3/4"	HM	PTD	20 MIN.	B	INTERCHANGABLE CORE
307	E2	SCW	PTD	3'-0"	7'-0"	0'-1 3/4"	HM	PTD	20 MIN.	B	INTERCHANGABLE CORE
308	E2	SCW	PTD	3'-0"	7'-0"	0'-1 3/4"	HM	PTD	20 MIN.	B	INTERCHANGABLE CORE
309	E2	SCW	PTD	3'-0"	7'-0"	0'-1 3/4"	HM	PTD	20 MIN.	B	INTERCHANGABLE CORE
310	E2	SCW	PTD	3'-0"	7'-0"	0'-1 3/4"	HM	PTD	20 MIN.	B	INTERCHANGABLE CORE
311	E2	SCW	PTD	3'-0"	7'-0"	0'-1 3/4"	HM	PTD	20 MIN.	B	INTERCHANGABLE CORE
312	E2	SCW	PTD	3'-0"	7'-0"	0'-1 3/4"	HM	PTD	20 MIN.	B	INTERCHANGABLE CORE
313	E2	SCW	PTD	3'-0"	7'-0"	0'-1 3/4"	HM	PTD	20 MIN.	B	INTERCHANGABLE CORE
314	E2	SCW	PTD	3'-0"	7'-0"	0'-1 3/4"	HM	PTD	20 MIN.	B	INTERCHANGABLE CORE
315	E2	SCW	PTD	3'-0"	7'-0"	0'-1 3/4"	HM	PTD	1-1/2 HR		
316	E2	SCW	PTD	3'-0"	7'-0"	0'-1 3/4"	HM	PTD	1-1/2 HR		
317	E2	SCW	PTD	3'-0"	7'-0"	0'-1 3/4"	HM	PTD	20 MIN.	B	INTERCHANGABLE CORE
318	D-E2	SCW	PTD	6'-0"	7'-0"	0'-1 3/4"	HM	PTD	20 MIN.	D	

DOOR SCHEDULE LEVEL 04											
Number	Elev.	Material	Door Dimensions			Thickness	Frame		Fire Rating	HARDWARE SET	NOTES
			Finish	Width	Height		Material	Finish			
401	E2	SCW	PTD	3'-0"	7'-0"	0'-1 3/4"	HM	PTD	20 MIN.	B	INTERCHANGABLE CORE
402	E2	SCW	PTD	3'-0"	7'-0"	0'-1 3/4"	HM	PTD	20 MIN.	B	INTERCHANGABLE CORE
403	E2	SCW	PTD	3'-0"	7'-0"	0'-1 3/4"	HM	PTD	20 MIN.	B	INTERCHANGABLE CORE
404	E2	SCW	PTD	3'-0"	7'-0"	0'-1 3/4"	HM	PTD	20 MIN.	B	INTERCHANGABLE CORE
405	E2	SCW	PTD	3'-0"	7'-0"	0'-1 3/4"	HM	PTD	20 MIN.	B	INTERCHANGABLE CORE
406	E2	SCW	PTD	3'-0"	7'-0"	0'-1 3/4"	HM	PTD	20 MIN.	B	INTERCHANGABLE CORE
407	E2	SCW	PTD	3'-0"	7'-0"	0'-1 3/4"	HM	PTD	20 MIN.	B	INTERCHANGABLE CORE
408	E2	SCW	PTD	3'-0"	7'-0"	0'-1 3/4"	HM	PTD	20 MIN.	B	INTERCHANGABLE CORE
409	E2	SCW	PTD	3'-0"	7'-0"	0'-1 3/4"	HM	PTD	20 MIN.	B	INTERCHANGABLE CORE
410	E2	SCW	PTD	3'-0"	7'-0"	0'-1 3/4"	HM	PTD	20 MIN.	B	INTERCHANGABLE CORE
411	E2	SCW	PTD	3'-0"	7'-0"	0'-1 3/4"	HM	PTD	20 MIN.	B	INTERCHANGABLE CORE
412	E2	SCW	PTD	3'-0"	7'-0"	0'-1 3/4"	HM	PTD	20 MIN.	B	INTERCHANGABLE CORE
413	E2	SCW	PTD	3'-0"	7'-0"	0'-1 3/4"	HM	PTD	20 MIN.	B	INTERCHANGABLE CORE
414	E2	SCW	PTD	3'-0"	7'-0"	0'-1 3/4"	HM	PTD	20 MIN.	B	INTERCHANGABLE CORE
415	E2	SCW	PTD	3'-0"	7'-0"	0'-1 3/4"	HM	PTD	1-1/2 HR		
416	E2	SCW	PTD	3'-0"	7'-0"	0'-1 3/4"	HM	PTD	1-1/2 HR		
417	E2	SCW	PTD	3'-0"	7'-0"	0'-1 3/4"	HM	PTD	20 MIN.	B	INTERCHANGABLE CORE
418	D-E2	SCW	PTD	6'-0"	7'-0"	0'-1 3/4"	HM	PTD	20 MIN.	D	

DOOR SCHEDULE LEVEL 05											
Number	Elev.	Material	Door			Thickness	Frame		Fire Rating	HARDWARE SET	NOTES
			Finish	Dimensions							
				Width	Height		Material	Finish			
501	E2	SCW	PTD	3'-0"	7'-0"	0' - 1 3/4"	HM	PTD	20 MIN.	B	INTERCHANGABLE CORE
502	E2	SCW	PTD	3'-0"	7'-0"	0' - 1 3/4"	HM	PTD	20 MIN.	B	INTERCHANGABLE CORE
503	E2	SCW	PTD	3'-0"	7'-0"	0' - 1 3/4"	HM	PTD	20 MIN.	B	INTERCHANGABLE CORE
504	E2	SCW	PTD	3'-0"	7'-0"	0' - 1 3/4"	HM	PTD	20 MIN.	B	INTERCHANGABLE CORE
505	E2	SCW	PTD	3'-0"	7'-0"	0' - 1 3/4"	HM	PTD	20 MIN.	B	INTERCHANGABLE CORE
506	E2	SCW	PTD	3'-0"	7'-0"	0' - 1 3/4"	HM	PTD	20 MIN.	B	INTERCHANGABLE CORE
507	E2	SCW	PTD	3'-0"	7'-0"	0' - 1 3/4"	HM	PTD	20 MIN.	B	INTERCHANGABLE CORE
508	E2	SCW	PTD	3'-0"	7'-0"	0' - 1 3/4"	HM	PTD	20 MIN.	B	INTERCHANGABLE CORE
509	E2	SCW	PTD	3'-0"	7'-0"	0' - 1 3/4"	HM	PTD	20 MIN.	B	INTERCHANGABLE CORE
513	E2	SCW	PTD	3'-0"	7'-0"	0' - 1 3/4"	HM	PTD	20 MIN.	B	INTERCHANGABLE CORE
514	E2	SCW	PTD	3'-0"	7'-0"	0' - 1 3/4"	HM	PTD	20 MIN.	B	INTERCHANGABLE CORE
515	E2	SCW	PTD	3'-0"	7'-0"	0' - 1 3/4"	HM	PTD	1-1/2 HR		
516	E2	SCW	PTD	3'-0"	7'-0"	0' - 1 3/4"	HM	PTD	1-1/2 HR		
517	E2	SCW	PTD	3'-0"	7'-0"	0' - 1 3/4"	HM	PTD	20 MIN.	E	INTERCHANGABLE CORE
518	D+E2	SCW	PTD	6'-0"	7'-0"	0' - 1 3/4"	HM	PTD	20 MIN.	D	
519	E2	SCW	PTD	3'-0"	7'-0"	0' - 1 3/4"	HM	PTD	20 MIN.	A	



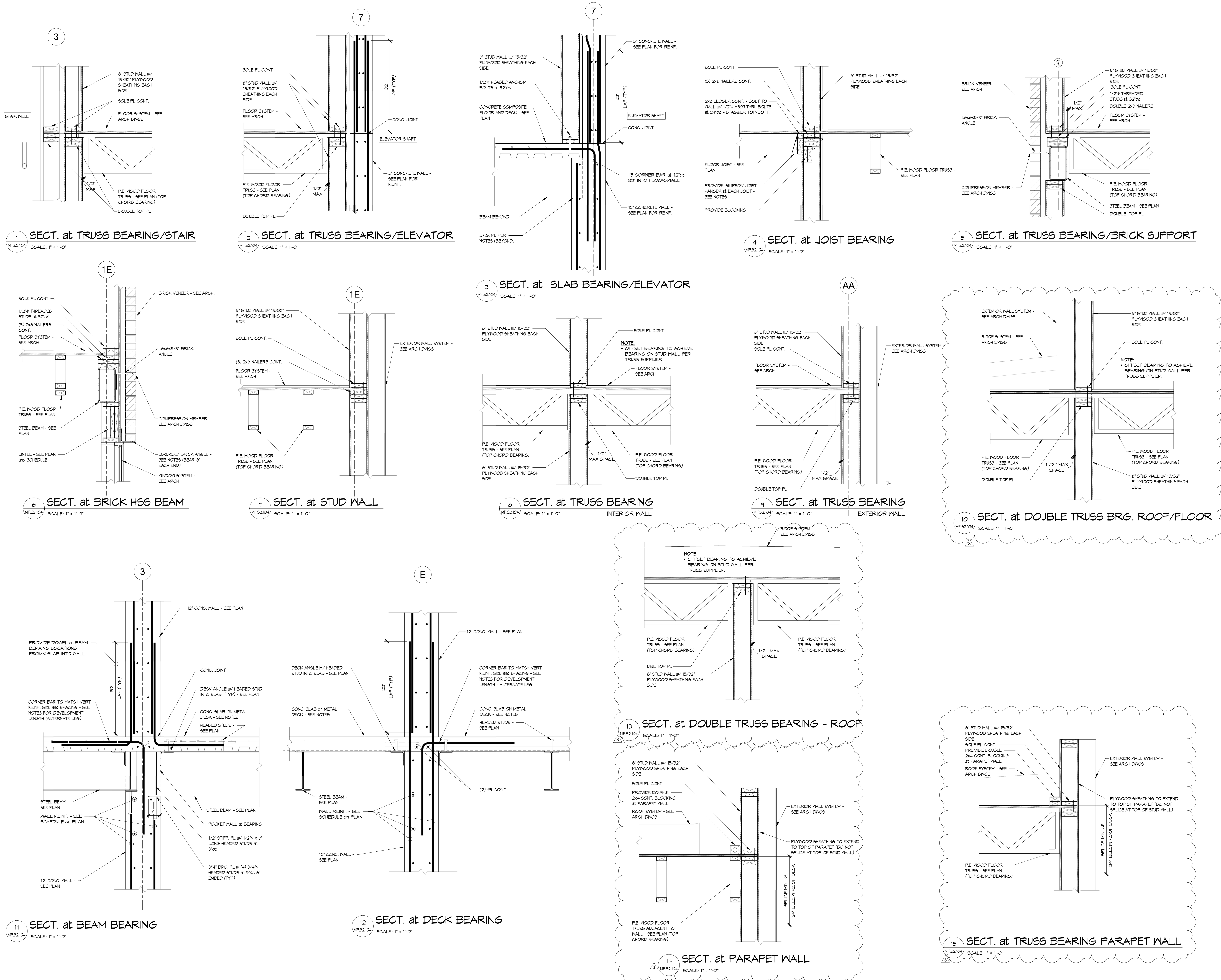

Date	Description
3/06/2020	Addendum 2

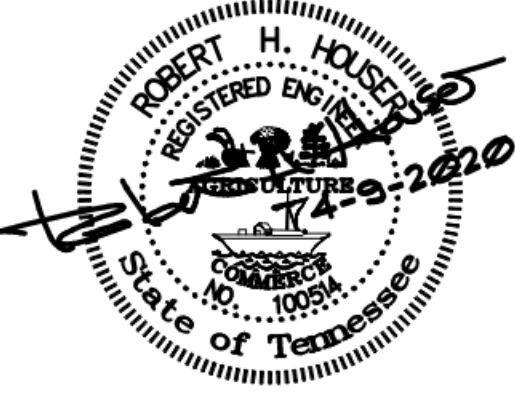

Seal / Signature

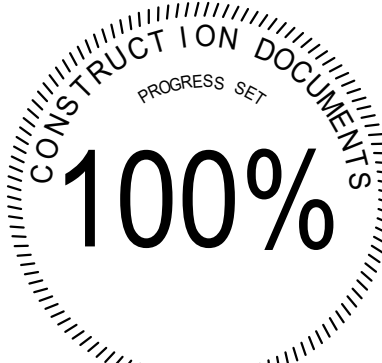

Project Name 05/06/2020

AUSTIN HOMES

Project Number

21.0488.000

Description

STRUCTURAL DETAILS

Scale

1" = 1'-0"

MF.S2.104