

NOTES:
REFER TO SHEET L-101 FOR LAYOUT & MATERIALS NOTES.

LAYOUT & MATERIALS LEGEND

	LIMIT OF WORK
	LIMIT OF DISTURBANCE
	RIGHT-OF-WAY BOUNDARY
	MILE MARKER PAVER
	SIGNAGE
	BOLLARD
	WALL
	METAL SAFETY RAIL
	CHAIN LINK FENCE
	METAL FENCE SCREEN
	LANDSCAPE UPLIGHT
	MULTI-USE TRAIL - PEDESTRIAN (DECORATIVE CONCRETE PAVING)
	MULTI-USE TRAIL - VEHICULAR (DECORATIVE CONCRETE PAVING)
	TACTILE WARNING PAVERS (UNIT PAVING)
	DETECTABLE WARNING PAVERS
	ASPHALT PAVING
	CONCRETE PAVING
	CRUSHED STONE SURFACING, TYPE A1/A2
	CRUSHED STONE SURFACING, TYPE B
	CRUSHED STONE SURFACING, TYPE C
	GRANITE PAVING
	PLANTED AREA
	RIP RAP



Atlanta BeltLine, Inc.
86 Pryor Street, SW, Suite 200
Atlanta, GA 30303
t: 404.880.4100
f: 404.840.0616

Perkins + Will
1315 Peachtree Street, NE
Atlanta, GA 30309
t: 404.873.2300
f: 404.892.5823

James Corner Field Operations
475 Tenth Avenue, 10th Floor
New York, New York 10018
t: 212.433.1450
f: 212.433.1451

Revisions

NO.	ISSUE	DATE	NO.	ISSUE	DATE

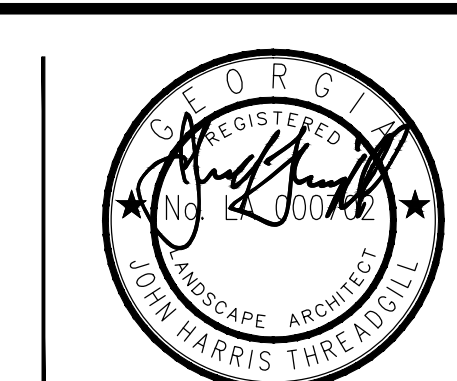

Sheet Information

Date	05/06/2011
Job Number	800911.007
Drawn	KB/MM
Checked	VZ
Approved	JT

Title
LAYOUT & MATERIALS
PLAN
STA. T19+40 TO
T29+60

Sheet
L-102
ISSUED FOR CONSTRUCTION
Copyright © 2011, Atlanta BeltLine, Inc.

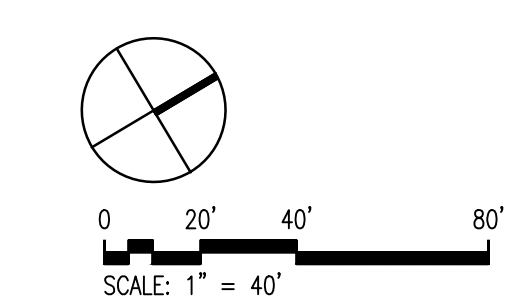
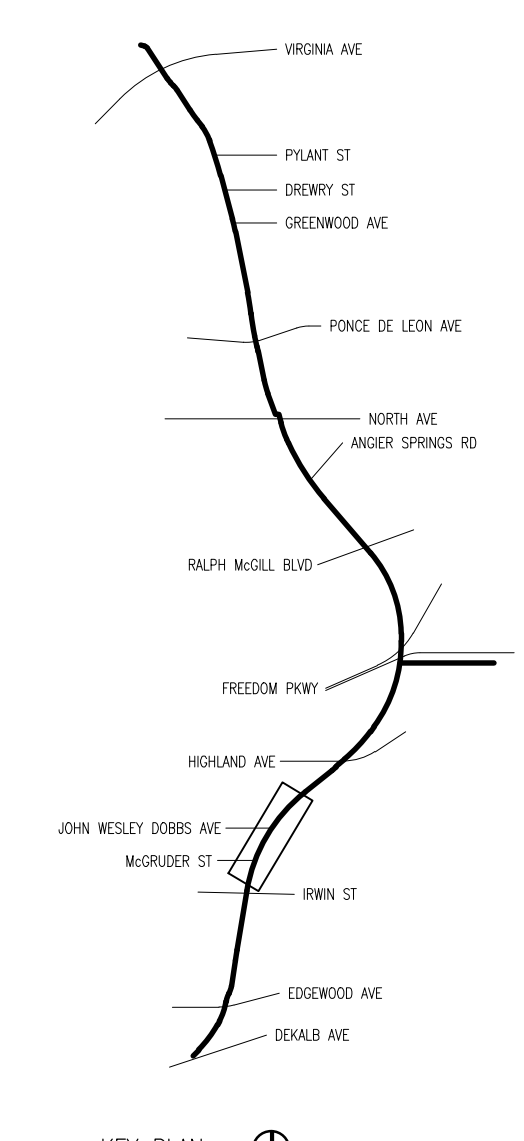
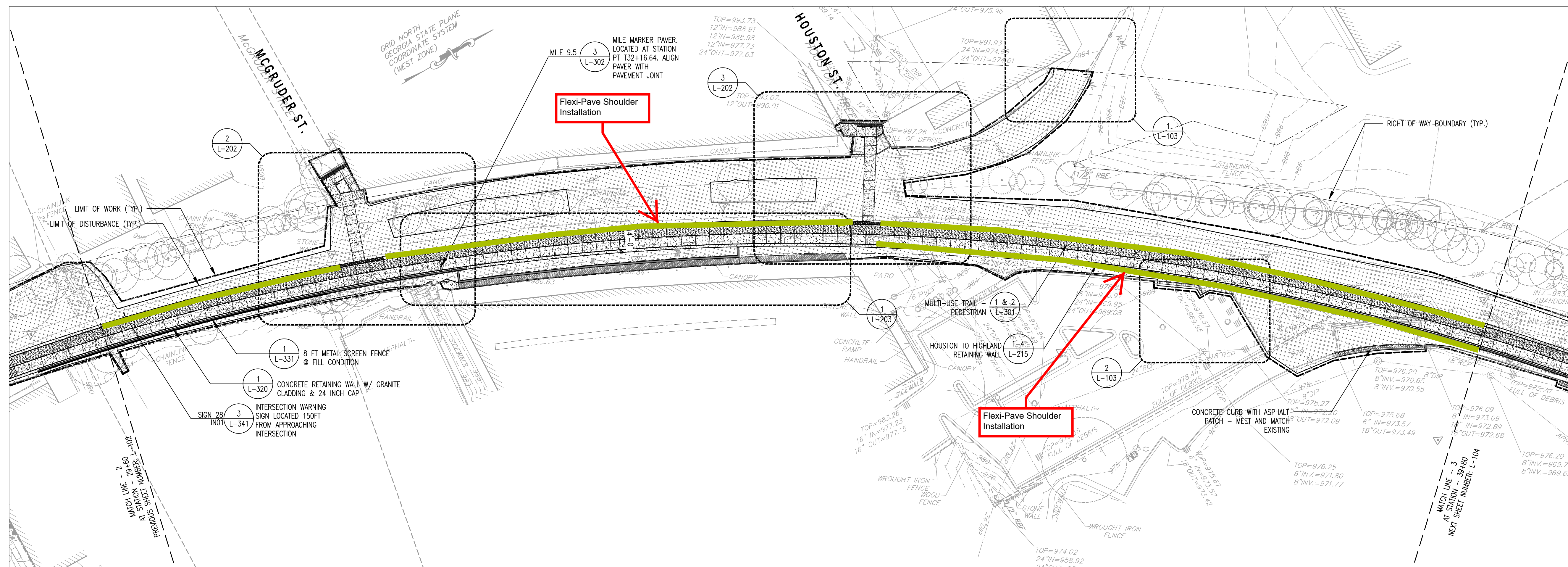

NOTES:
REFER TO SHEET L-101 FOR LAYOUT & MATERIALS NOTES.

LAYOUT & MATERIALS LEGEND

- LIMIT OF WORK
- LIMIT OF DISTURBANCE
- RIGHT-OF-WAY BOUNDARY
- MILE MARKER PAVER
- SIGNAGE
- BOLLARD
- WALL
- METAL SAFETY RAIL
- CHAIN LINK FENCE
- METAL FENCE SCREEN
- LANDSCAPE UPLIGHT
- MULTI-USE TRAIL - PEDESTRIAN (DECORATIVE CONCRETE PAVING)
- MULTI-USE TRAIL - VEHICULAR (DECORATIVE CONCRETE PAVING)
- TACTILE WARNING PAVERS (UNIT PAVING)
- DETECTABLE WARNING PAVERS
- ASPHALT PAVING
- CONCRETE PAVING
- CRUSHED STONE SURFACING, TYPE A1/A2
- CRUSHED STONE SURFACING, TYPE B
- CRUSHED STONE SURFACING, TYPE C
- GRANITE PAVING
- PLANTED AREA
- RIP RAP

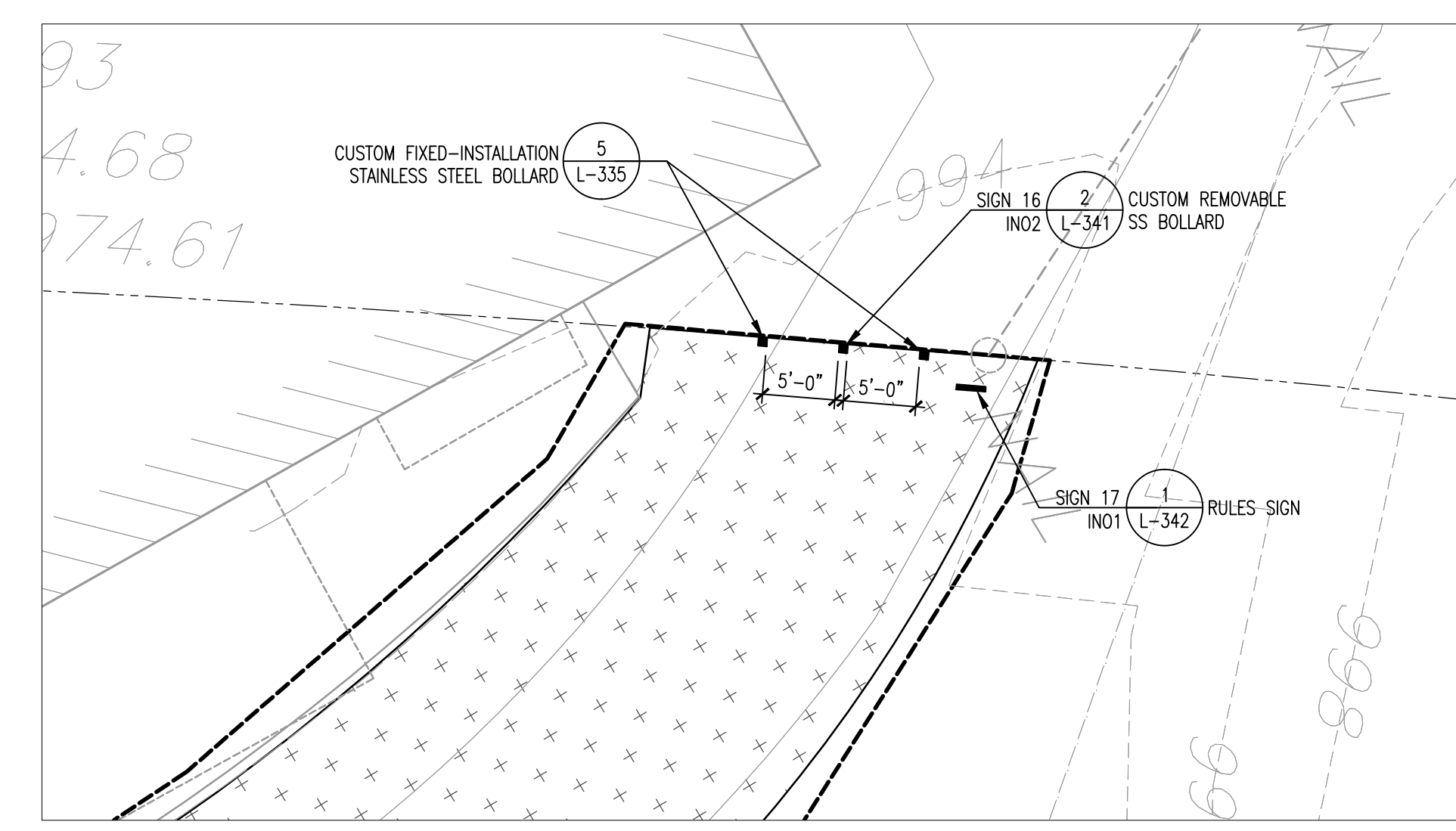

1 PLAN ENLARGEMENT - BOLLARD LOCATION
1" = 10'

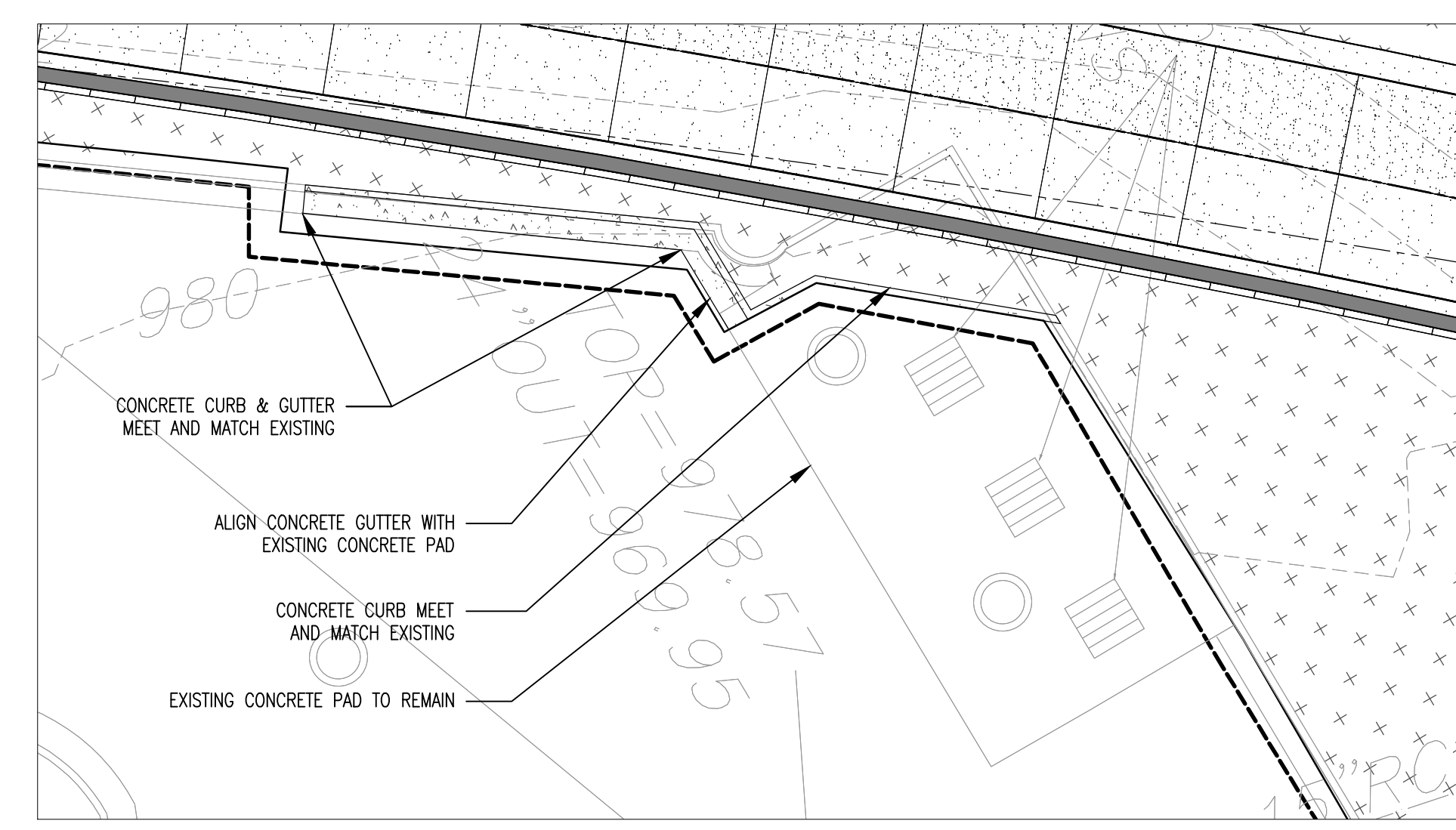

2 PLAN ENLARGEMENT - CURB REALIGNMENT
1" = 10'



Atlanta BeltLine, Inc.
86 Pryor Street, SW, Suite 200
Atlanta, GA 30303
t: 404.880.4100
f: 404.840.0616

Perkins + Will
1315 Peachtree Street, NE
Atlanta, GA 30309
t: 404.873.2300
f: 404.892.5823

James Corner Field Operations
475 Tenth Avenue, 10th Floor
New York, New York 10018
t: 212.433.1450
f: 212.433.1451

Revisions					
NO.	ISSUE	DATE	NO.	ISSUE	DATE

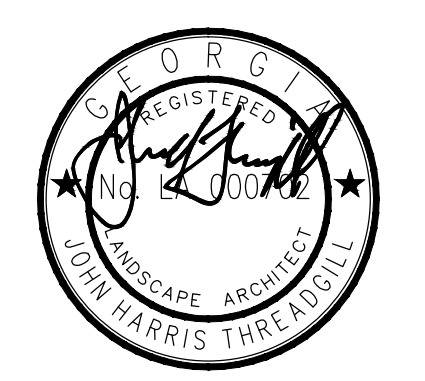

Sheet Information	
Date	05/06/2011
Job Number	800911.007
Drawn	KB/MM
Checked	VZ
Approved	JT

Title
LAYOUT & MATERIALS
PLAN
STA. T29+60 TO
T39+80

Sheet
L-103
ISSUED FOR CONSTRUCTION
Copyright © 2011, Atlanta BeltLine, Inc.

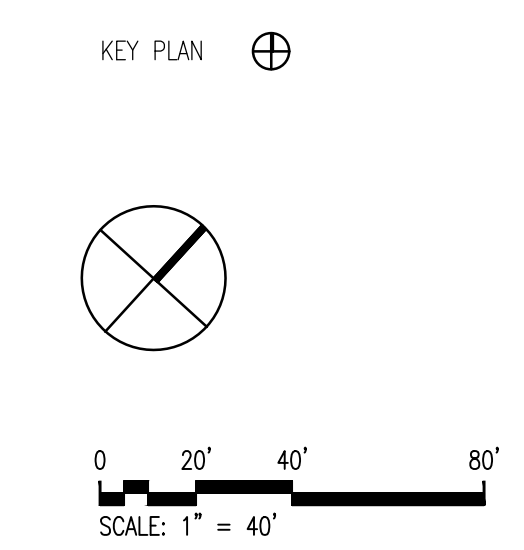
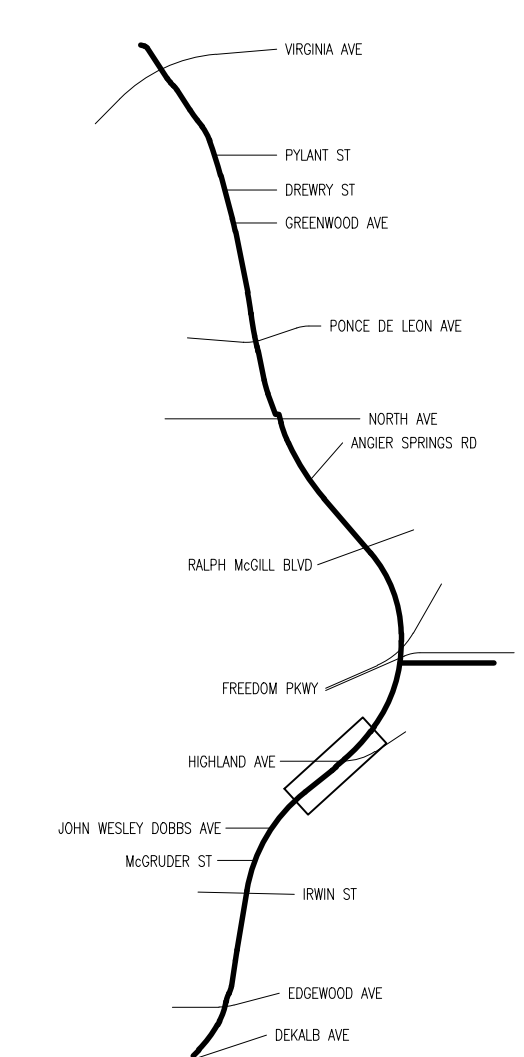
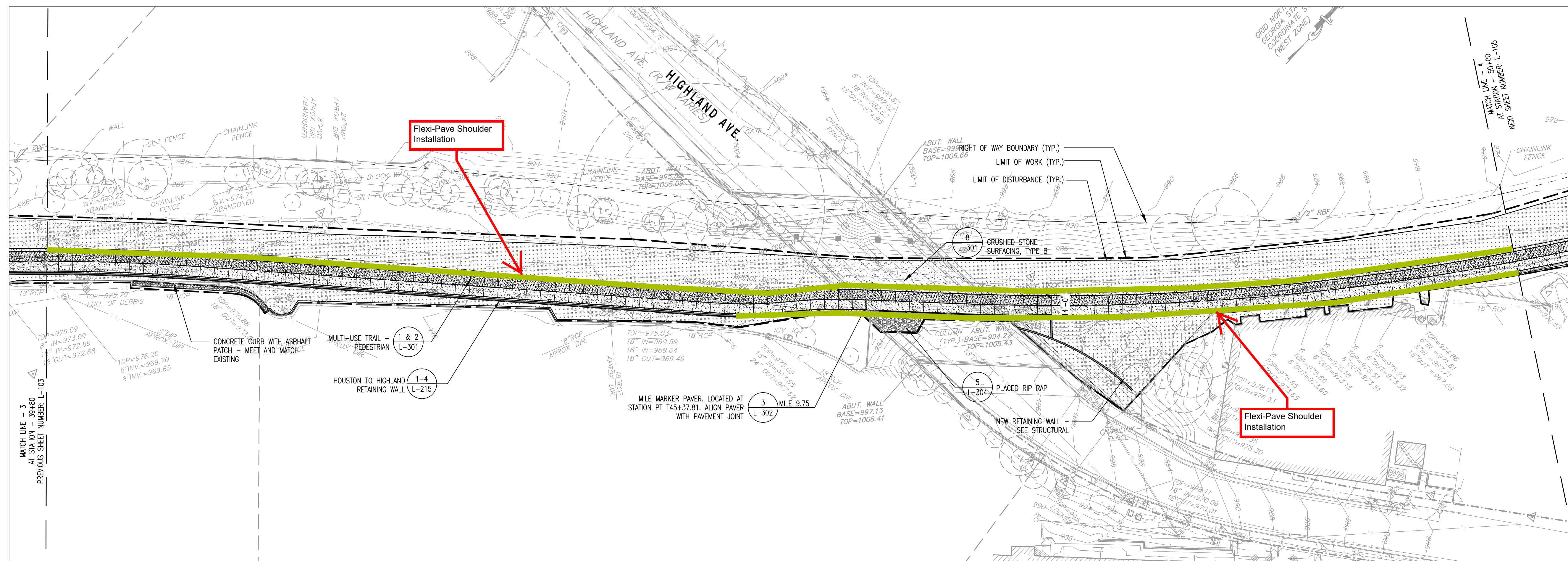

NOTES:
REFER TO SHEET L-101 FOR LAYOUT & MATERIALS NOTES.

- LAYOUT & MATERIALS LEGEND**
- LIMIT OF WORK
 - LIMIT OF DISTURBANCE
 - - - RIGHT-OF-WAY BOUNDARY
 - MILE MARKER PAVER
 - SIGNAGE
 - BOLLARD
 - WALL
 - - - METAL SAFETY RAIL
 - CHAIN LINK FENCE
 - METAL FENCE SCREEN
 - △ LANDSCAPE UPLIGHT
 - MULTI-USE TRAIL - PEDESTRIAN (DECORATIVE CONCRETE PAVING)
 - MULTI-USE TRAIL - VEHICULAR (DECORATIVE CONCRETE PAVING)
 - TACTILE WARNING PAVERS (UNIT PAVING)
 - DETECTABLE WARNING PAVERS
 - ASPHALT PAVING
 - CONCRETE PAVING
 - CRUSHED STONE SURFACING, TYPE A1/A2
 - CRUSHED STONE SURFACING, TYPE B
 - CRUSHED STONE SURFACING, TYPE C
 - GRANITE PAVING
 - PLANTED AREA
 - RIP RAP



Atlanta BeltLine, Inc.
86 Pryor Street, SW, Suite 200
Atlanta, GA 30303
t: 404.880.4100
f: 404.840.0616

Perkins + Will
1315 Peachtree Street, NE
Atlanta, GA 30309
t: 404.873.2300
f: 404.892.5823

James Corner Field Operations
475 Tenth Avenue, 10th Floor
New York, New York 10018
t: 212.433.1450
f: 212.433.1451

Revisions

NO.	ISSUE	DATE	NO.	ISSUE	DATE



Sheet Information

Date	05/06/2011
Job Number	800911.007
Drawn	KB
Checked	VZ
Approved	JT

Title
LAYOUT & MATERIALS
PLAN
STA. T39+80 TO
T50+00

Sheet
L-104
ISSUED FOR CONSTRUCTION
Copyright © 2011, Atlanta BeltLine, Inc.

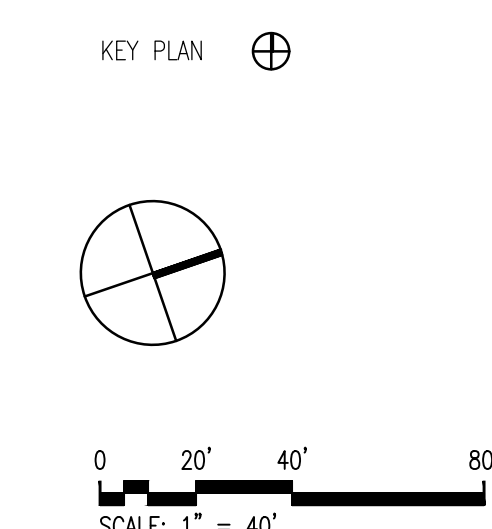
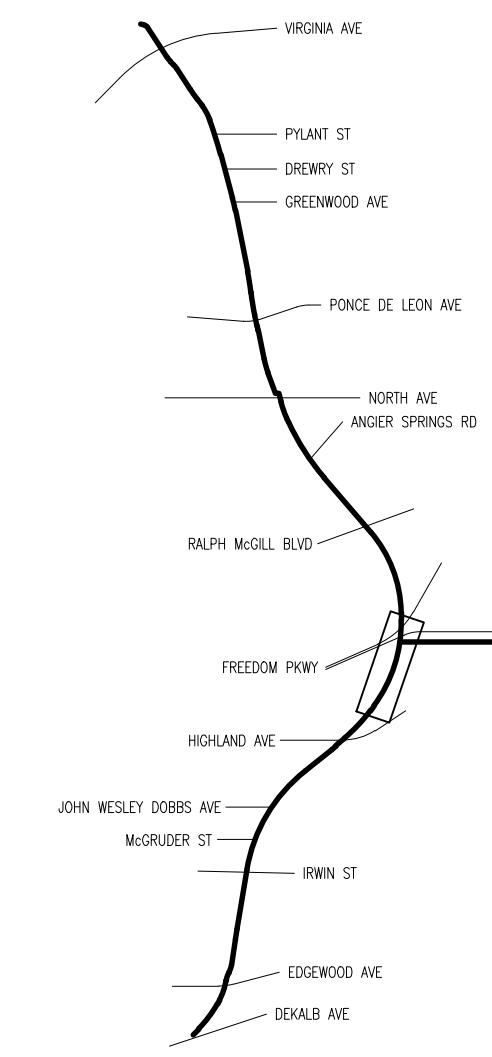
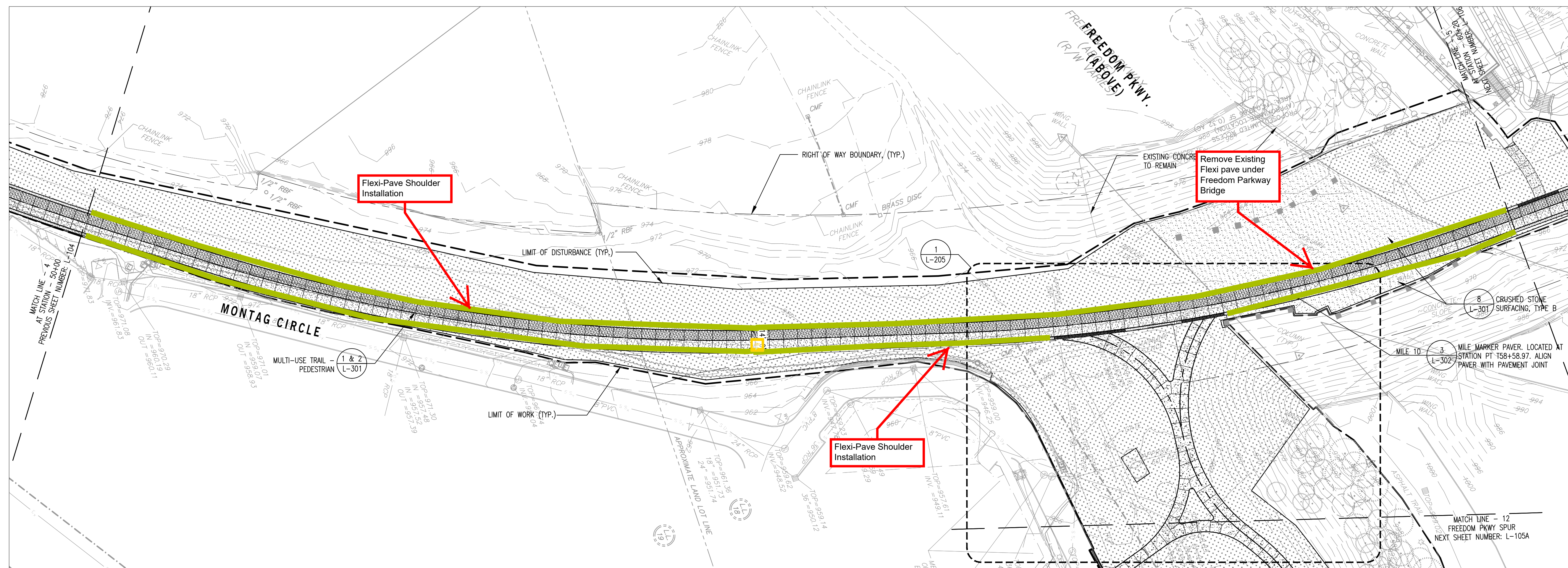

NOTES:
REFER TO SHEET L-101 FOR LAYOUT & MATERIALS NOTES.

LAYOUT & MATERIALS LEGEND

- LIMIT OF WORK
- LIMIT OF DISTURBANCE
- RIGHT-OF-WAY BOUNDARY
- MILE MARKER PAVEMENT
- SIGNAGE
- BOLLARD
- WALL
- METAL SAFETY RAIL
- CHAIN LINK FENCE
- METAL FENCE SCREEN
- LANDSCAPE UPLIGHT
- MULTI-USE TRAIL - PEDESTRIAN (DECORATIVE CONCRETE PAVING)
- MULTI-USE TRAIL - VEHICULAR (DECORATIVE CONCRETE PAVING)
- TACTILE WARNING PAVERS (UNIT PAVING)
- DETECTABLE WARNING PAVERS
- ASPHALT PAVING
- CONCRETE PAVING
- CRUSHED STONE SURFACING, TYPE A1/A2
- CRUSHED STONE SURFACING, TYPE B
- CRUSHED STONE SURFACING, TYPE C
- GRANITE PAVING
- PLANTED AREA
- RIP RAP



Atlanta BeltLine, Inc.
86 Pryor Street, SW, Suite 200
Atlanta, GA 30303
t: 404.880.4100
f: 404.840.0616

Perkins + Will
1315 Peachtree Street, NE
Atlanta, GA 30309
t: 404.873.2300
f: 404.892.5823

James Corner Field Operations
475 Tenth Avenue, 10th Floor
New York, New York 10018
t: 212.433.1450
f: 212.433.1451

Revisions

NO.	ISSUE	DATE	NO.	ISSUE	DATE

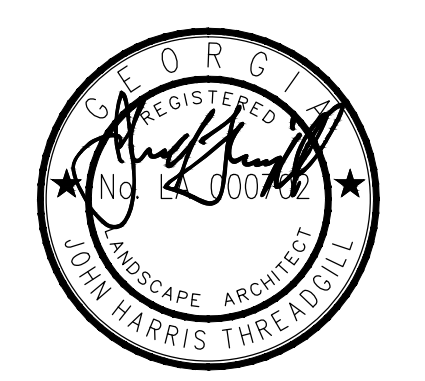

Sheet Information

Date	05/06/2011
Job Number	800911.007
Drawn	KB/MM
Checked	VZ
Approved	JT

Title
LAYOUT & MATERIALS PLAN
STA. T50+00 TO T60+20

Sheet
L-105
ISSUED FOR CONSTRUCTION

Copyright © 2011, Atlanta BeltLine, Inc.

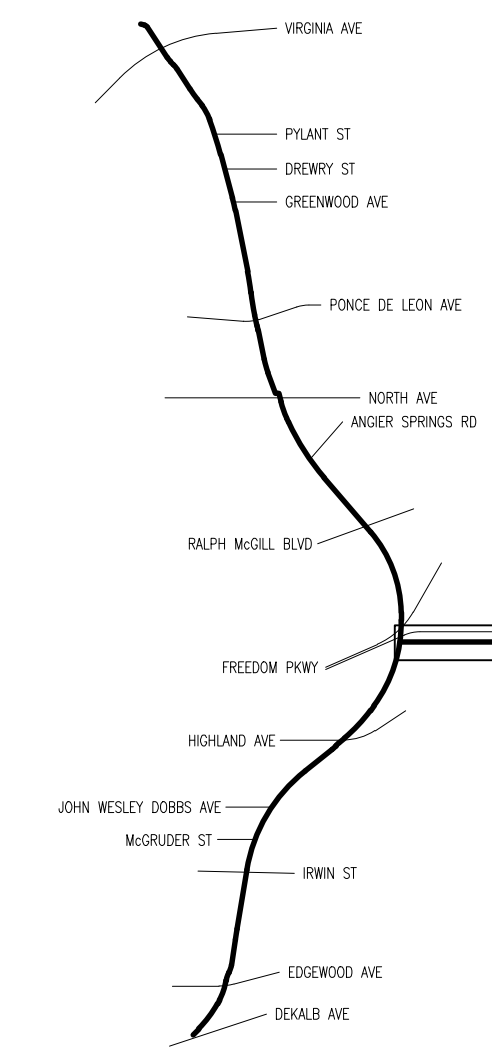
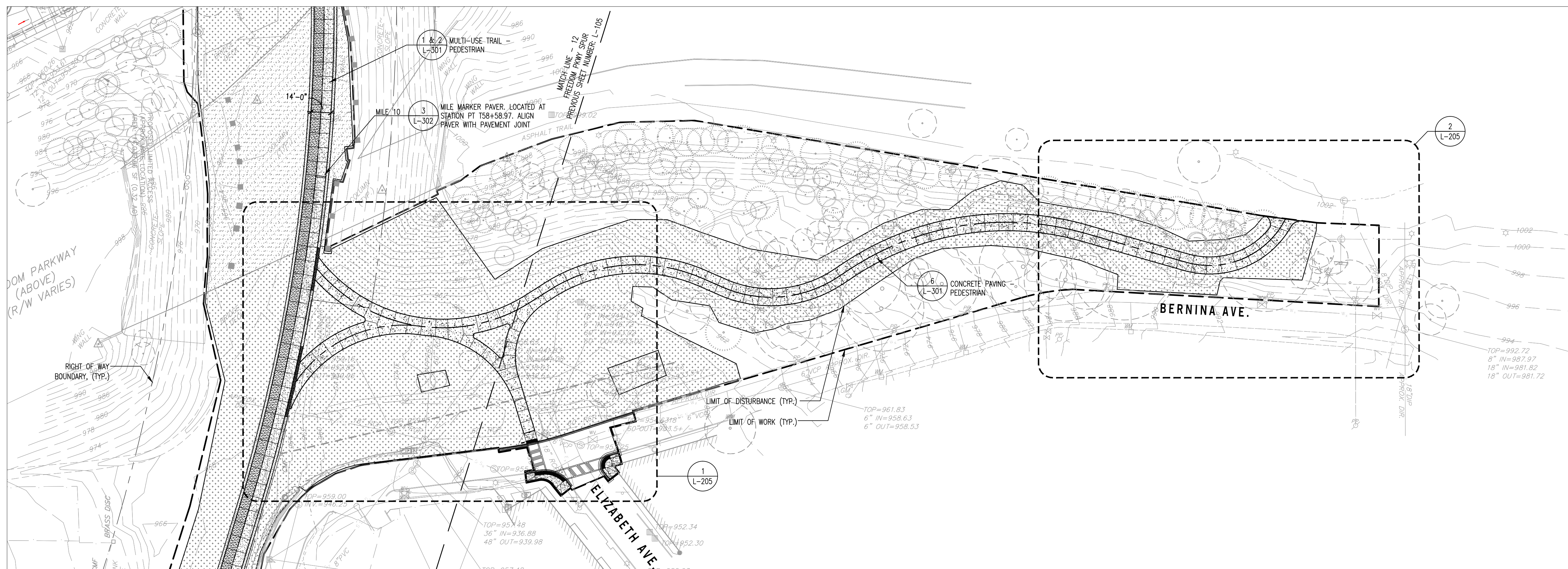

KEY PLAN

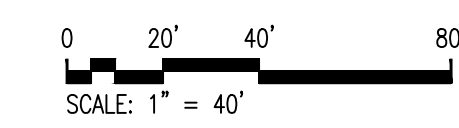
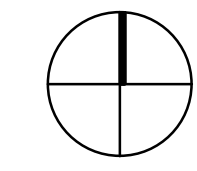

NOTES:
REFER TO SHEET L-101 FOR LAYOUT & MATERIALS NOTES.

LAYOUT & MATERIALS LEGEND

- LIMIT OF WORK
- LIMIT OF DISTURBANCE
- RIGHT-OF-WAY BOUNDARY
- MILE MARKER PAVER
- SIGNAGE
- BOLLARD
- WALL
- METAL SAFETY RAIL
- CHAIN LINK FENCE
- METAL FENCE SCREEN
- LANDSCAPE UPLIGHT
- MULTI-USE TRAIL - PEDESTRIAN (DECORATIVE CONCRETE PAVING)
- MULTI-USE TRAIL - VEHICULAR (DECORATIVE CONCRETE PAVING)
- TACTILE WARNINGS PAVERS (UNIT PAVING)
- DETECTABLE WARNING PAVERS
- ASPHALT PAVING
- CONCRETE PAVING
- CRUSHED STONE SURFACING, TYPE A1/A2
- CRUSHED STONE SURFACING, TYPE B
- CRUSHED STONE SURFACING, TYPE C
- GRANITE PAVING
- PLANTED AREA
- RIP RAP

Eastside Trail - North Section



Atlanta BeltLine, Inc.
86 Pryor Street, SW, Suite 200
Atlanta, GA 30303
t: 404.880.4100
f: 404.840.0616

Perkins + Will
1315 Peachtree Street, NE
Atlanta, GA 30309
t: 404.873.2300
f: 404.892.5823

James Corner Field Operations
475 Tenth Avenue, 10th Floor
New York, New York 10018
t: 212.433.1450
f: 212.433.1451

Revisions

NO.	ISSUE	DATE	NO.	ISSUE	DATE



Sheet Information

Date 05/06/2011
Job Number 800911.007
Drawn KB/MM
Checked VZ
Approved JT

Title
LAYOUT & MATERIALS
PLAN
FREEDOM PKWY SPUR

Sheet
L-105A
ISSUED FOR CONSTRUCTION

Copyright © 2011, Atlanta BeltLine, Inc.

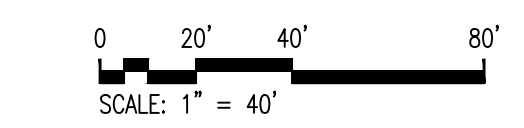
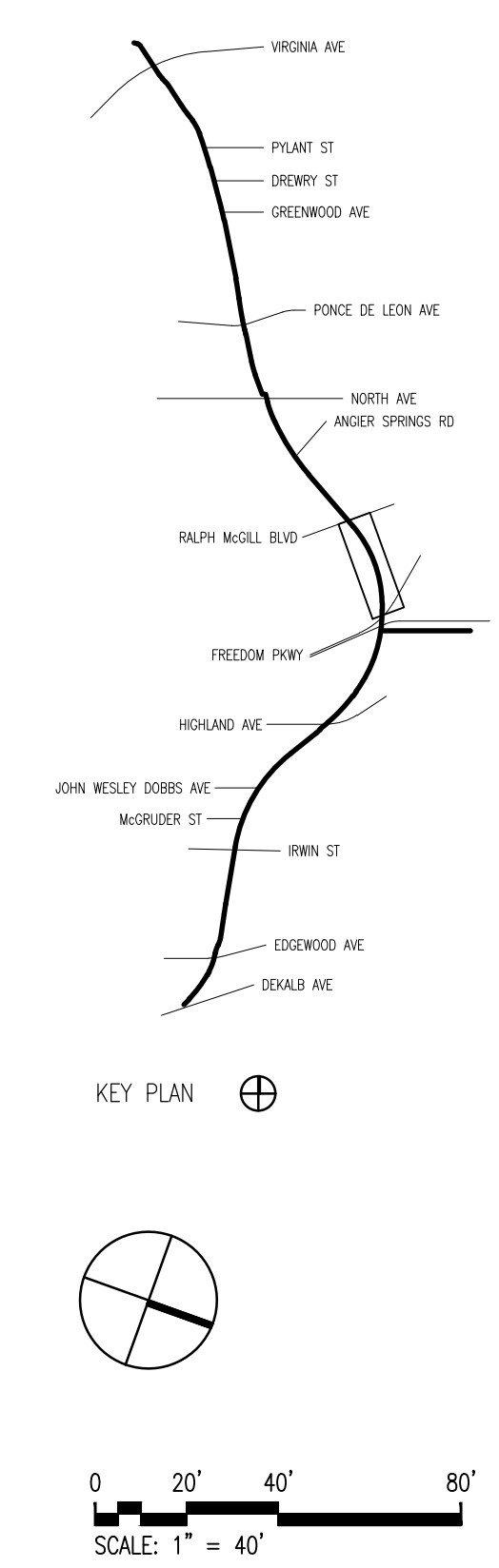
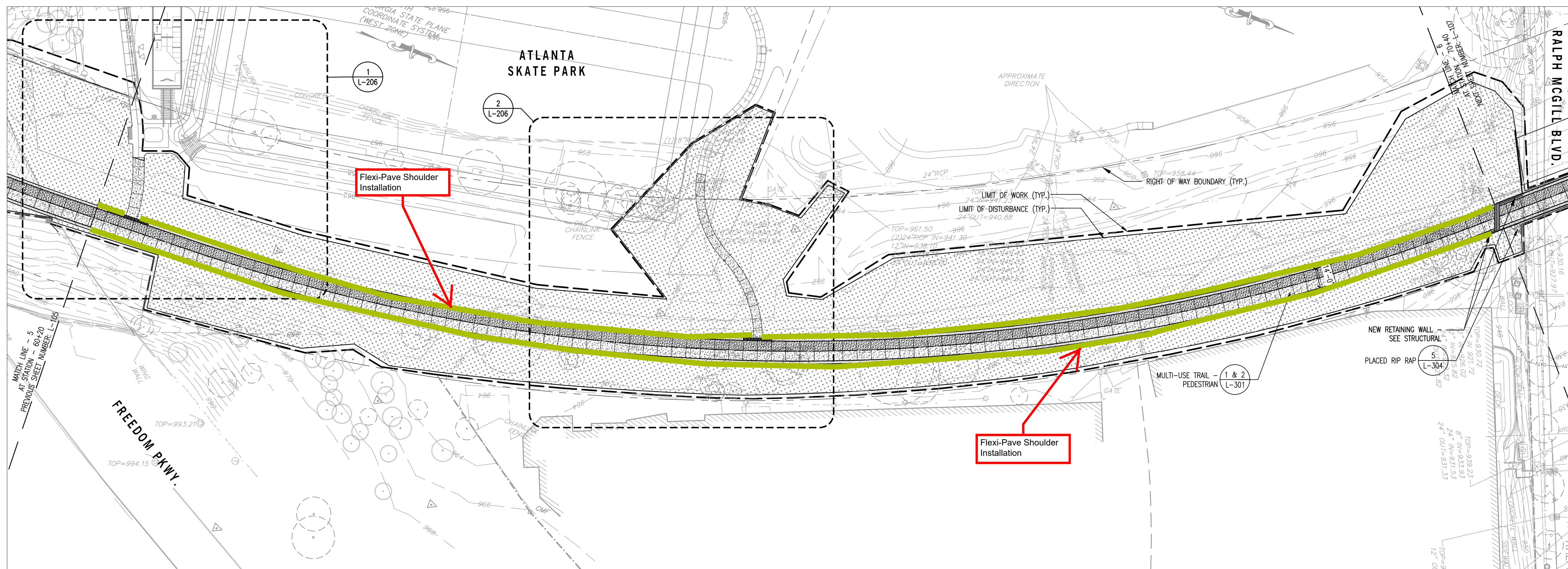

NOTES:
REFER TO SHEET L-101 FOR LAYOUT & MATERIALS NOTES.

- LAYOUT & MATERIALS LEGEND**
- LIMIT OF WORK
 - LIMIT OF DISTURBANCE
 - RIGHT-OF-WAY BOUNDARY
 - MILE MARKER PAVEMENT
 - SIGNAGE
 - BOLLARD
 - WALL
 - METAL SAFETY RAIL
 - CHAIN LINK FENCE
 - METAL FENCE SCREEN
 - LANDSCAPE UPLIGHT
 - MULTI-USE TRAIL - PEDESTRIAN (DECORATIVE CONCRETE PAVING)
 - MULTI-USE TRAIL - VEHICULAR (DECORATIVE CONCRETE PAVING)
 - TACTILE WARNING PAVERS (UNIT PAVING)
 - DETECTABLE WARNING PAVERS
 - ASPHALT PAVING
 - CONCRETE PAVING
 - CRUSHED STONE SURFACING, TYPE A1/A2
 - CRUSHED STONE SURFACING, TYPE B
 - CRUSHED STONE SURFACING, TYPE C
 - GRANITE PAVING
 - PLANTED AREA
 - RIP RAP



Atlanta BeltLine, Inc.
86 Pryor Street, SW, Suite 200
Atlanta, GA 30303
t: 404.880.4100
f: 404.840.0616

Perkins + Will
1315 Peachtree Street, NE
Atlanta, GA 30309
t: 404.873.2300
f: 404.892.5823

James Corner Field Operations
475 Tenth Avenue, 10th Floor
New York, New York 10018
t: 212.433.1450
f: 212.433.1451

Revisions

NO.	ISSUE	DATE	NO.	ISSUE	DATE



Sheet Information

Date	05/06/2011
Job Number	800911.007
Drawn	KB
Checked	VZ
Approved	JT

Title
LAYOUT & MATERIALS
PLAN
STA. T60+20 TO
T70+40

Sheet
L-106
ISSUED FOR CONSTRUCTION

Copyright © 2011, Atlanta BeltLine, Inc.

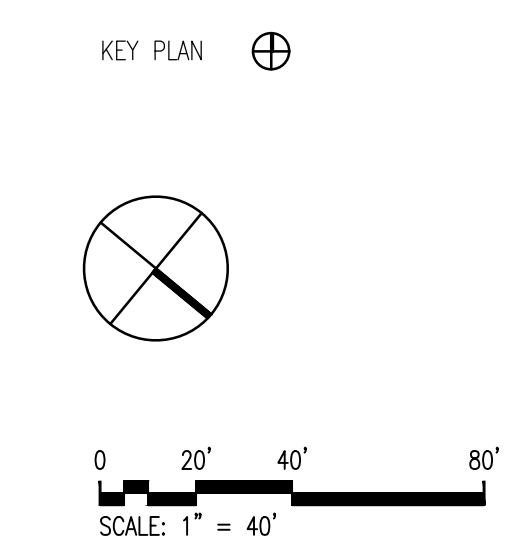
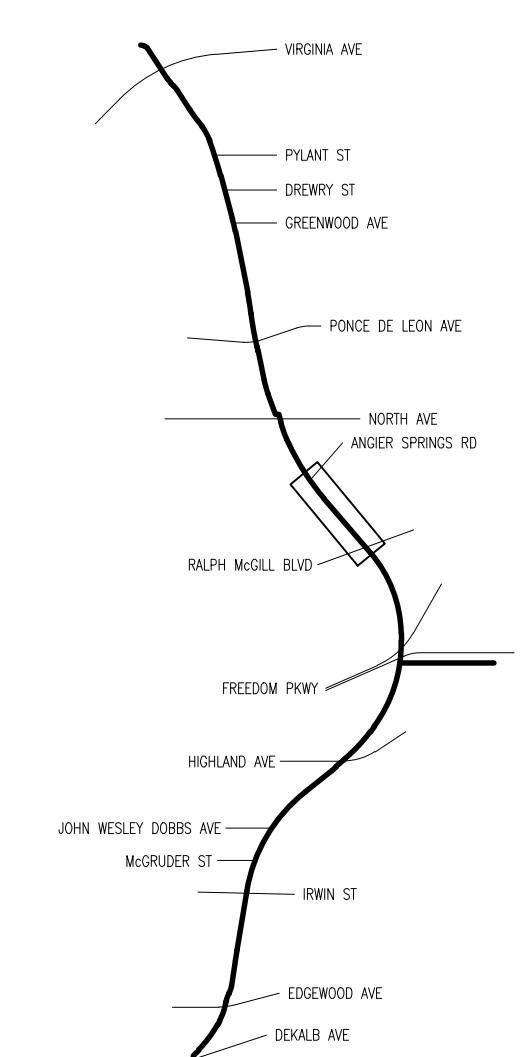
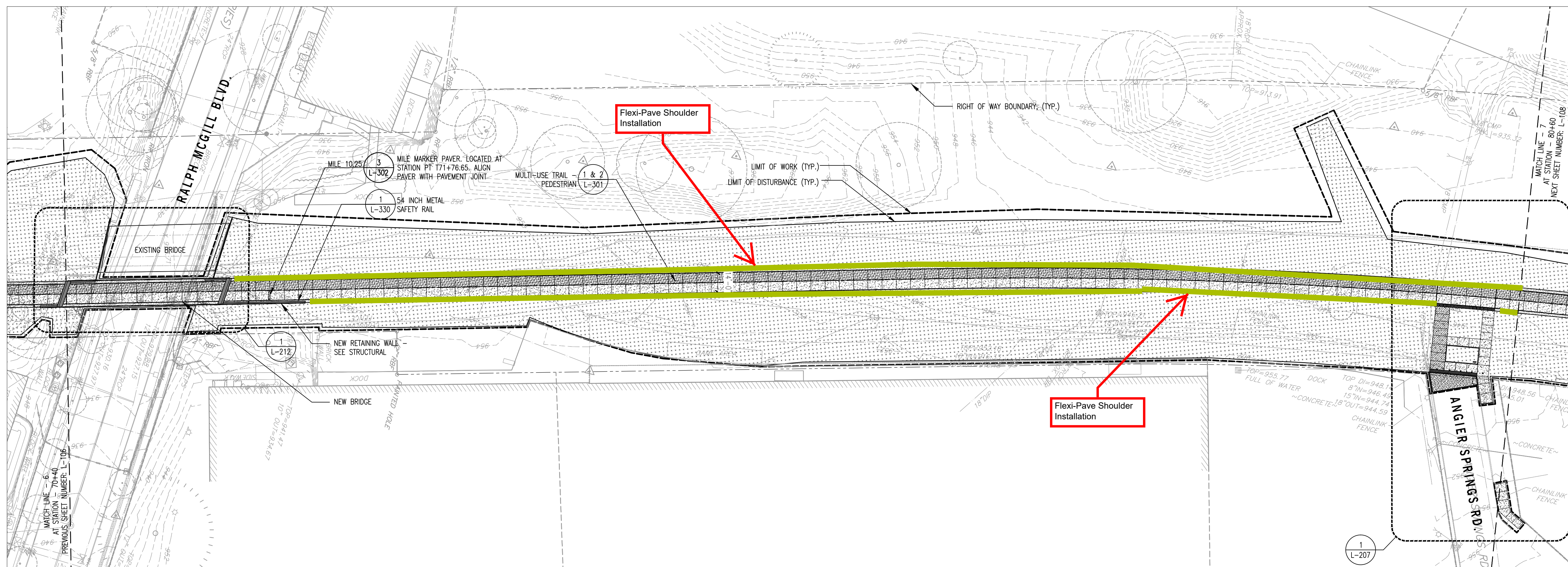

NOTES:
REFER TO SHEET L-101 FOR LAYOUT & MATERIALS NOTES.

- LAYOUT & MATERIALS LEGEND**
- LIMIT OF WORK
 - LIMIT OF DISTURBANCE
 - RIGHT-OF-WAY BOUNDARY
 - MILE MARKER PAVEMENT
 - SIGNAGE
 - BOLLARD
 - WALL
 - METAL SAFETY RAIL
 - CHAIN LINK FENCE
 - METAL FENCE SCREEN
 - LANDSCAPE UPLIGHT
 - MULTI-USE TRAIL - PEDESTRIAN (DECORATIVE CONCRETE PAVING)
 - MULTI-USE TRAIL - VEHICULAR (DECORATIVE CONCRETE PAVING)
 - TACTILE WARNING PAVERS (UNIT PAVING)
 - DETECTABLE WARNING PAVERS
 - ASPHALT PAVING
 - CONCRETE PAVING
 - CRUSHED STONE SURFACING, TYPE A1/A2
 - CRUSHED STONE SURFACING, TYPE B
 - CRUSHED STONE SURFACING, TYPE C
 - GRANITE PAVING
 - PLANTED AREA
 - RIP RAP



Atlanta BeltLine, Inc.
86 Pryor Street, SW, Suite 200
Atlanta, GA 30303
t: 404.880.4100
f: 404.840.0616

Perkins + Will
1315 Peachtree Street, NE
Atlanta, GA 30309
t: 404.873.2300
f: 404.892.5823

James Corner Field Operations
475 Tenth Avenue, 10th Floor
New York, New York 10018
t: 212.433.1450
f: 212.433.1451

Revisions

NO.	ISSUE	DATE	NO.	ISSUE	DATE



Sheet Information

Date	05/06/2011
Job Number	800911.007
Drawn	KB/MM
Checked	VZ
Approved	JT

Title
LAYOUT & MATERIALS PLAN
STA. T70+40 TO T80+60

Sheet
L-107
ISSUED FOR CONSTRUCTION
Copyright © 2011, Atlanta BeltLine, Inc.

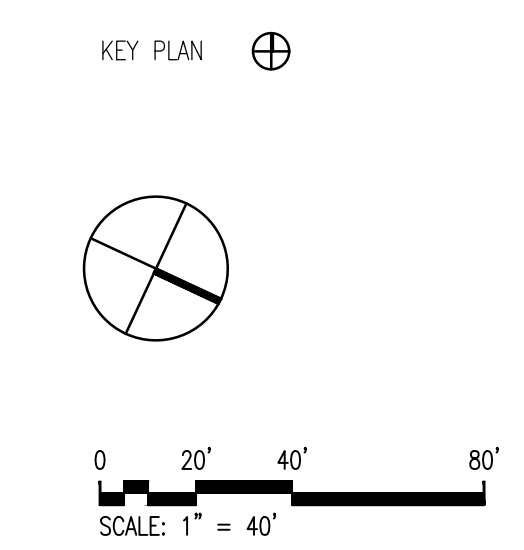
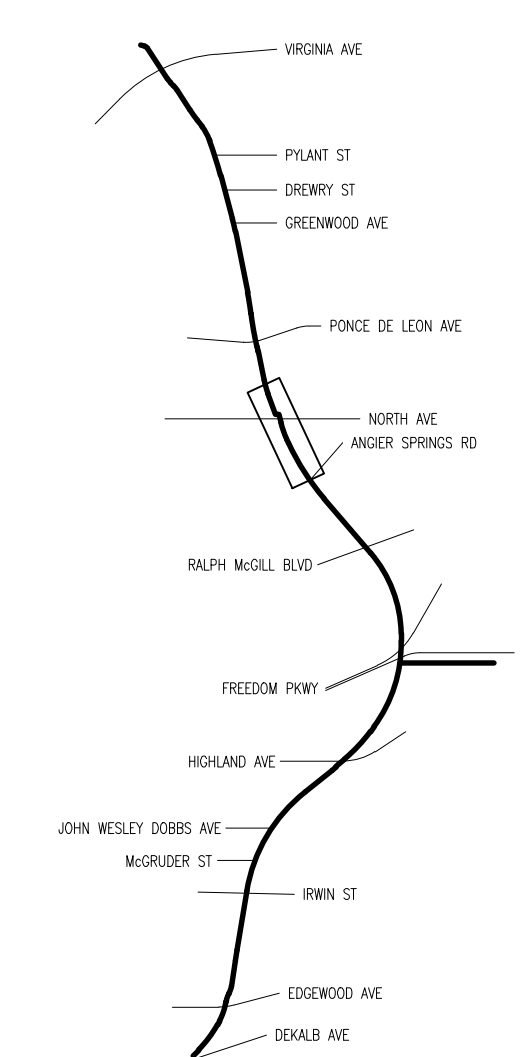
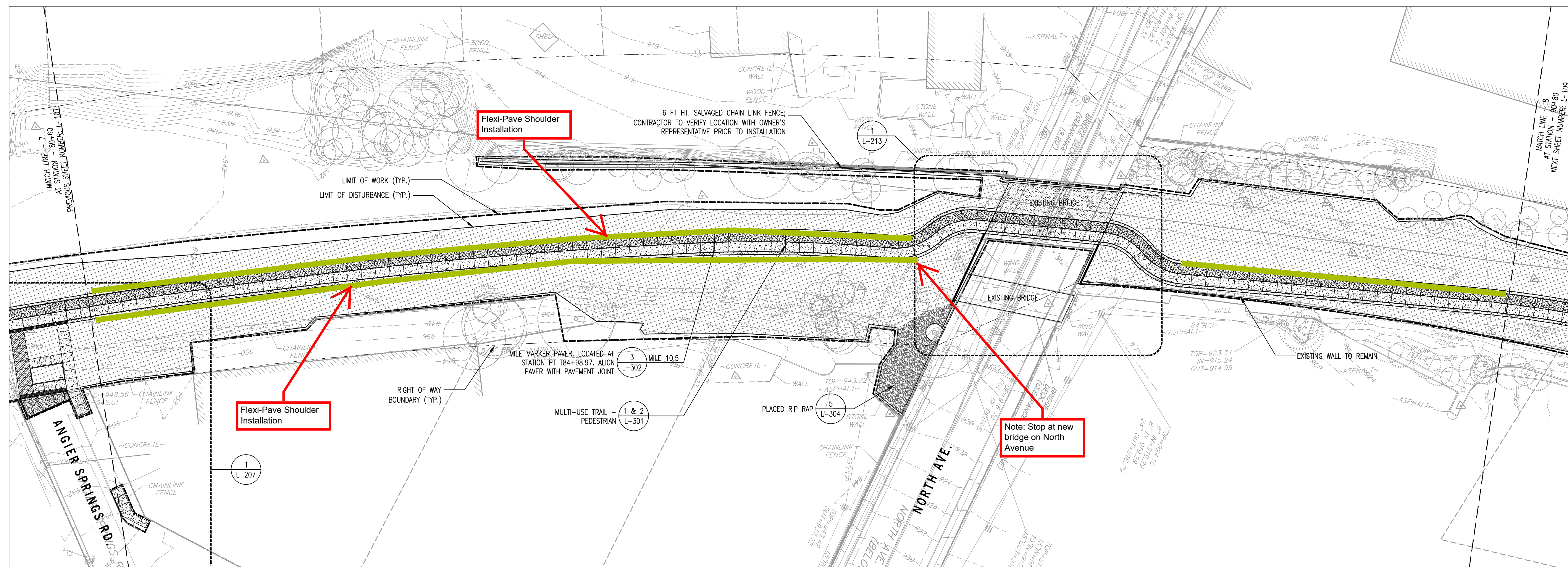

NOTES:
REFER TO SHEET L-101 FOR LAYOUT & MATERIALS NOTES.

LAYOUT & MATERIALS LEGEND

- LIMIT OF WORK
- LIMIT OF DISTURBANCE
- RIGHT-OF-WAY BOUNDARY
- MILE MARKER PAVEMENT
- SIGNAGE
- BOLLARD
- WALL
- METAL SAFETY RAIL
- CHAIN LINK FENCE
- METAL FENCE SCREEN
- LANDSCAPE UPLIGHT
- MULTI-USE TRAIL - PEDESTRIAN (DECORATIVE CONCRETE PAVING)
- MULTI-USE TRAIL - VEHICULAR (DECORATIVE CONCRETE PAVING)
- TACTILE WARNING PAVERS (UNIT PAVING)
- DETECTABLE WARNING PAVERS
- ASPHALT PAVING
- CONCRETE PAVING
- CRUSHED STONE SURFACING, TYPE A1/A2
- CRUSHED STONE SURFACING, TYPE B
- CRUSHED STONE SURFACING, TYPE C
- GRANITE PAVING
- PLANTED AREA
- RIP RAP



Atlanta BeltLine, Inc.
86 Pryor Street, SW, Suite 200
Atlanta, GA 30303
t: 404.880.4100
f: 404.840.0616

Perkins + Will
1315 Peachtree Street, NE
Atlanta, GA 30309
t: 404.873.2300
f: 404.892.5823

James Corner Field Operations
475 Tenth Avenue, 10th Floor
New York, New York 10018
t: 212.433.1450
f: 212.433.1451

Revisions					
NO.	ISSUE	DATE	NO.	ISSUE	DATE



Sheet Information	
Date	05/06/2011
Job Number	800911.007
Drawn	KB
Checked	VZ
Approved	JT

Title
LAYOUT & MATERIALS
PLAN
STA. T80+60 TO
T90+80

Sheet
L-108
ISSUED FOR CONSTRUCTION
Copyright © 2011, Atlanta BeltLine, Inc.

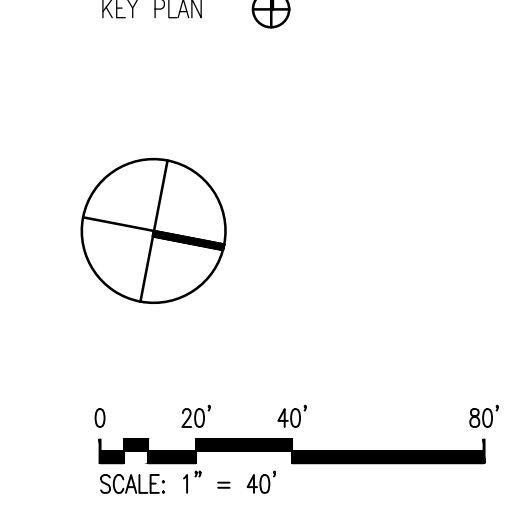
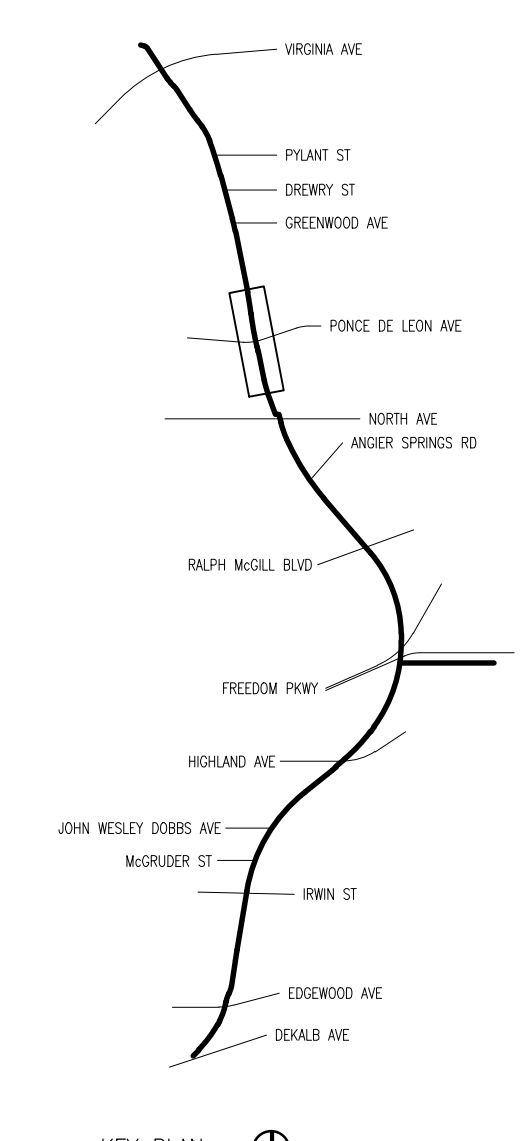
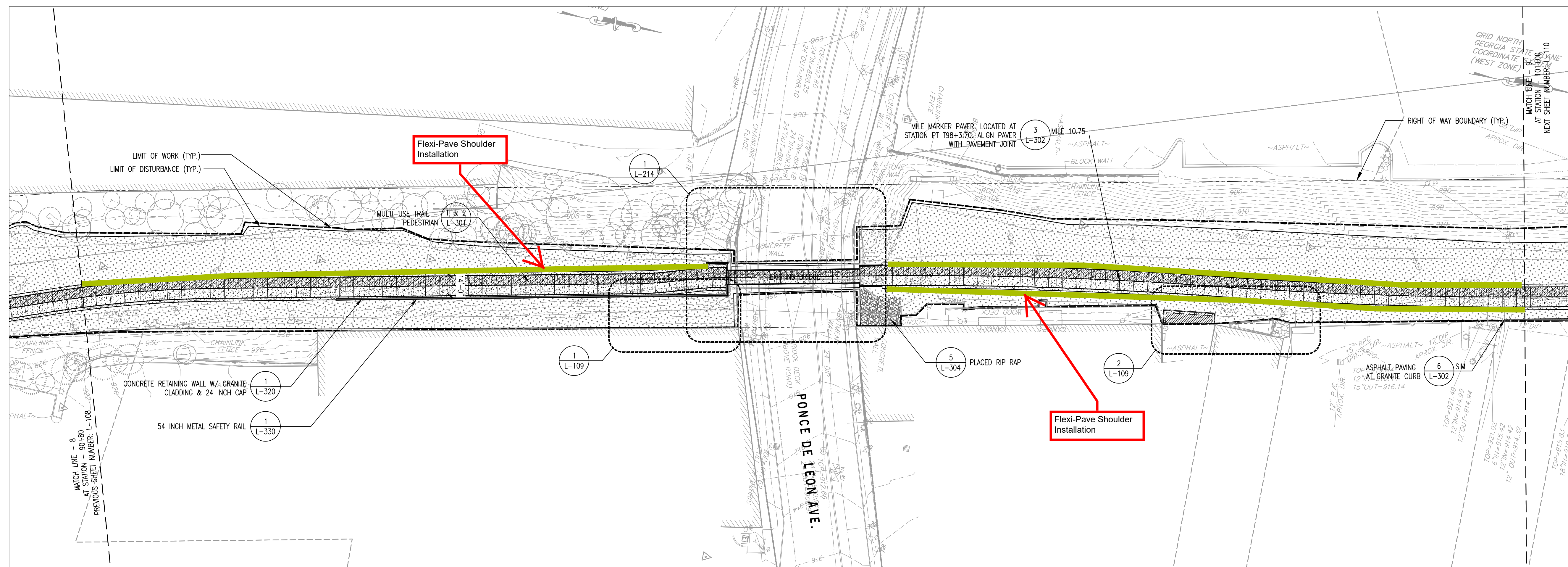

NOTES:
REFER TO SHEET L-101 FOR LAYOUT & MATERIALS NOTES.

LAYOUT & MATERIALS LEGEND

- LIMIT OF WORK
- LIMIT OF DISTURBANCE
- RIGHT-OF-WAY BOUNDARY
- MILE MARKER PAVER
- SIGNAGE
- BOLLARD
- WALL
- METAL SAFETY RAIL
- CHAIN LINK FENCE
- METAL FENCE SCREEN
- LANDSCAPE UPLIGHT
- MULTI-USE TRAIL - PEDESTRIAN (DECORATIVE CONCRETE PAVING)
- MULTI-USE TRAIL - VEHICULAR (DECORATIVE CONCRETE PAVING)
- TACTILE WARNING PAVERS (UNIT PAVING)
- DETECTABLE WARNING PAVERS
- ASPHALT PAVING
- CONCRETE PAVING
- CRUSHED STONE SURFACING, TYPE A1/A2
- CRUSHED STONE SURFACING, TYPE B
- CRUSHED STONE SURFACING, TYPE C
- GRANITE PAVING
- PLANTED AREA
- RIP RAP

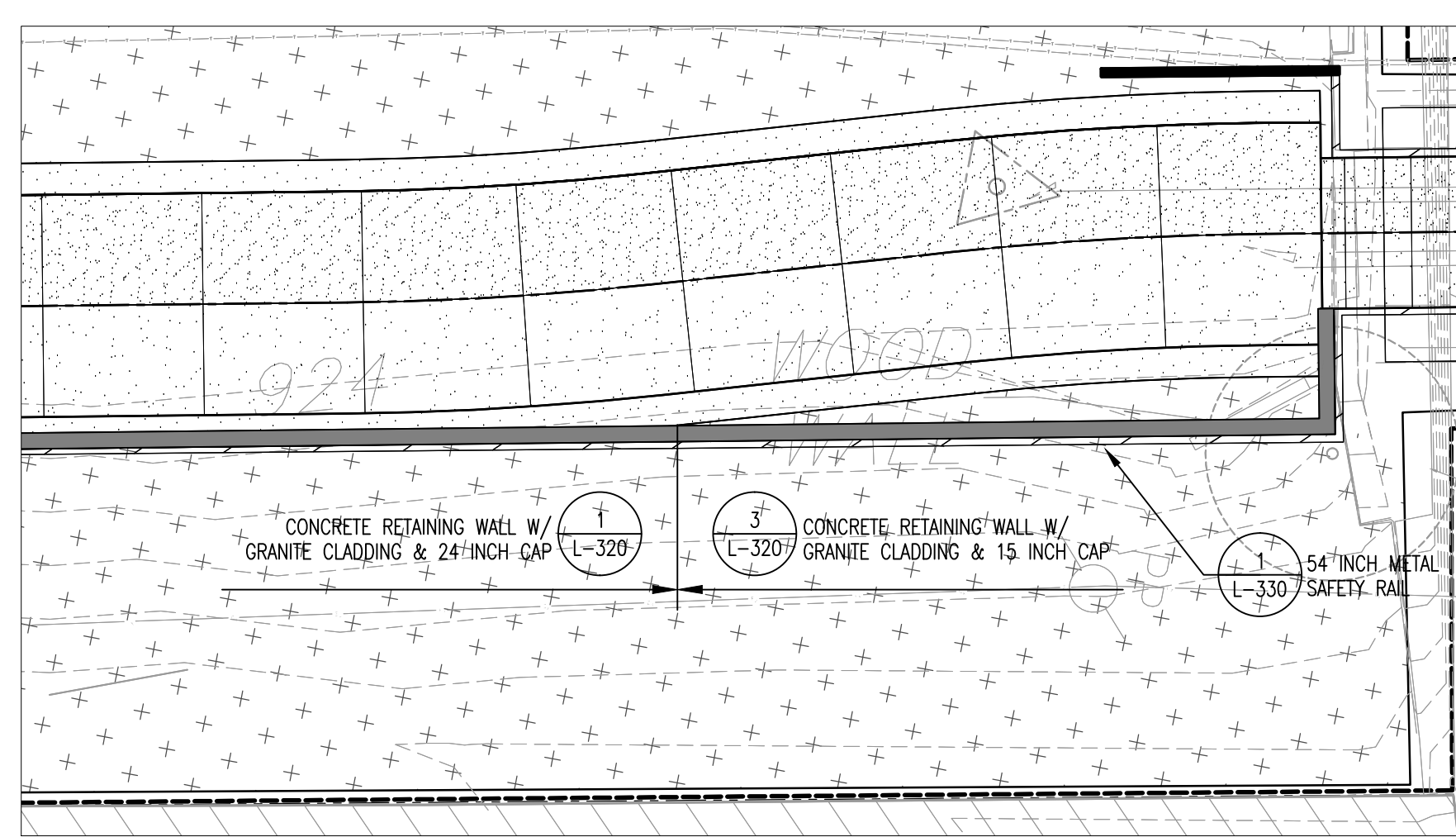

1 PLAN ENLARGEMENT - SHOULDER TRANSITION
1" = 10"

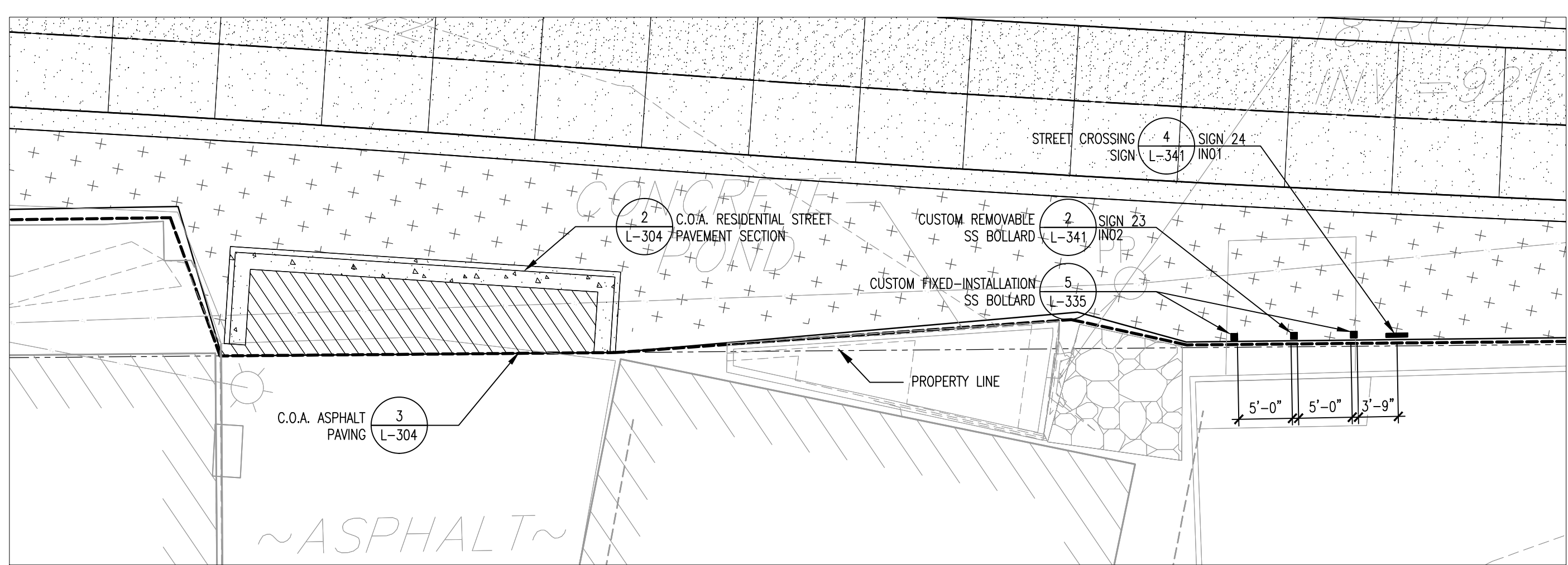

2 PLAN ENLARGEMENT - SIGNAGE LOCATION
1" = 10"



Atlanta BeltLine, Inc.
86 Pryor Street, SW, Suite 200
Atlanta, GA 30303
t: 404.880.4100
f: 404.840.0616

Perkins + Will
1315 Peachtree Street, NE
Atlanta, GA 30309
t: 404.873.2300
f: 404.892.5823

James Corner Field Operations
475 Tenth Avenue, 10th Floor
New York, New York 10018
t: 212.433.1450
f: 212.433.1451

Revisions					
NO.	ISSUE	DATE	NO.	ISSUE	DATE

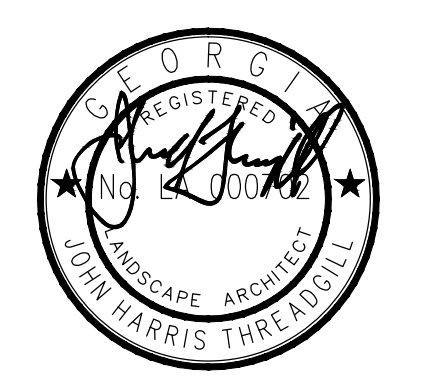

Sheet Information	
Date	05/06/2011
Job Number	800911.007
Drawn	KB
Checked	VZ
Approved	JT

Title
LAYOUT & MATERIALS PLAN
STA. T90+80 TO T101+00

Sheet
L-109
ISSUED FOR CONSTRUCTION
Copyright © 2011, Atlanta BeltLine, Inc.

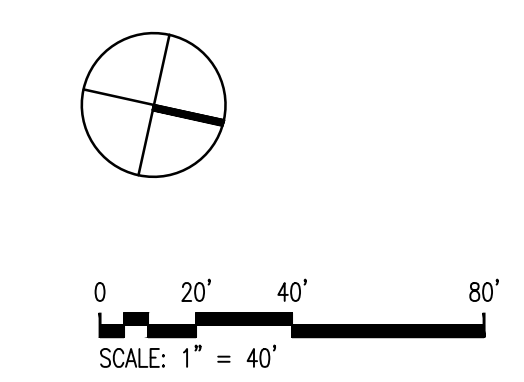
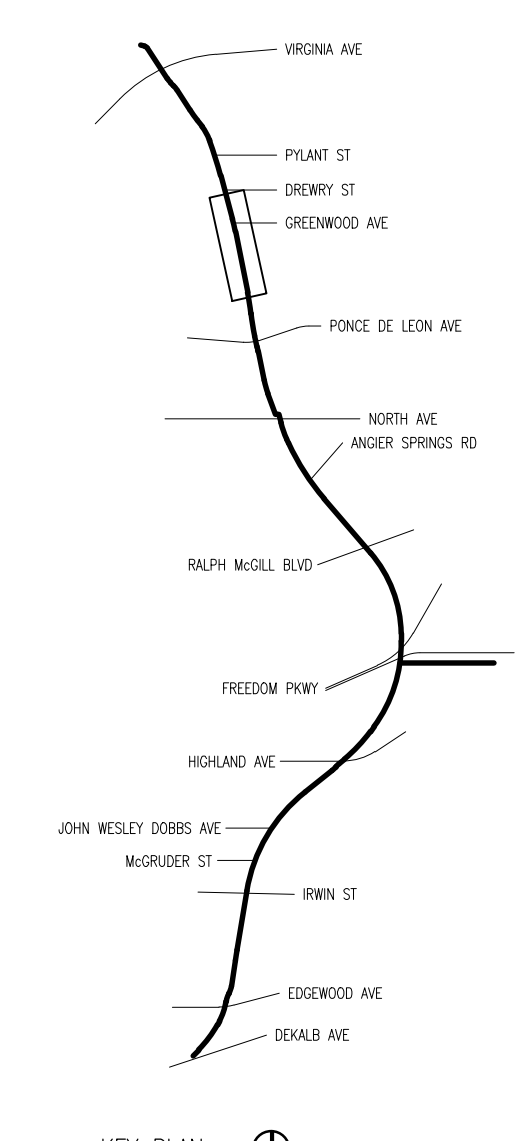
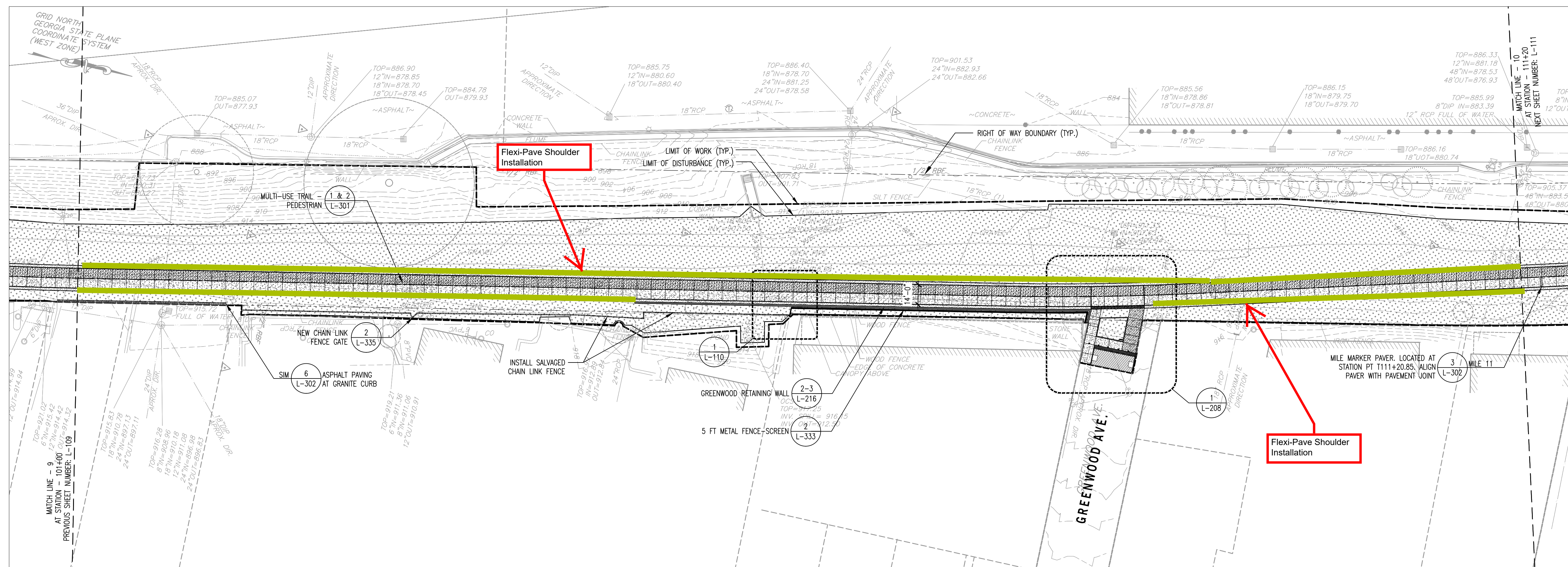

NOTES:
REFER TO SHEET L-101 FOR LAYOUT & MATERIALS NOTES.

LAYOUT & MATERIALS LEGEND

- LIMIT OF WORK
- LIMIT OF DISTURBANCE
- RIGHT-OF-WAY BOUNDARY
- MILE MARKER PAVER
- SIGNAGE
- BOLLARD
- WALL
- METAL SAFETY RAIL
- CHAIN LINK FENCE
- METAL FENCE SCREEN
- LANDSCAPE UPLIGHT
- MULTI-USE TRAIL - PEDESTRIAN (DECORATIVE CONCRETE PAVING)
- MULTI-USE TRAIL - VEHICULAR (DECORATIVE CONCRETE PAVING)
- TACTILE WARNINGS PAVERS (UNIT PAVING)
- DETECTABLE WARNING PAVERS
- ASPHALT PAVING
- CONCRETE PAVING
- CRUSHED STONE SURFACING, TYPE A1/A2
- CRUSHED STONE SURFACING, TYPE B
- CRUSHED STONE SURFACING, TYPE C
- GRANITE PAVING
- PLANTED AREA
- RIP RAP

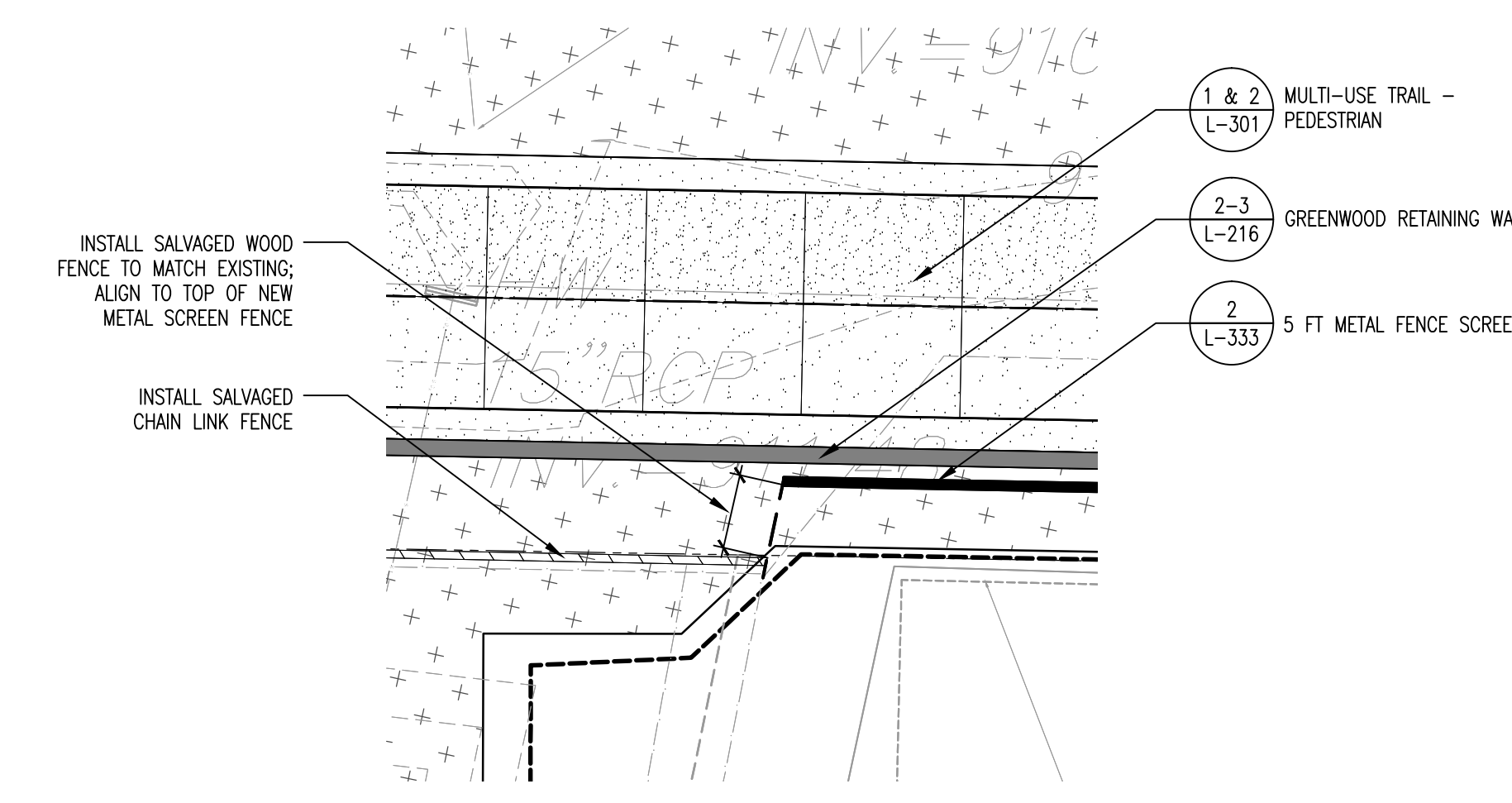

1 PLAN ENLARGEMENT - FENCE LOCATION
1" = 10'



Atlanta BeltLine, Inc.
86 Pryor Street, SW, Suite 200
Atlanta, GA 30303
t: 404.880.4100
f: 404.840.0616

Perkins + Will
1315 Peachtree Street, NE
Atlanta, GA 30309
t: 404.873.2300
f: 404.892.5823

James Corner Field Operations
475 Tenth Avenue, 10th Floor
New York, New York 10018
t: 212.433.1450
f: 212.433.1451

Revisions					
NO.	ISSUE	DATE	NO.	ISSUE	DATE

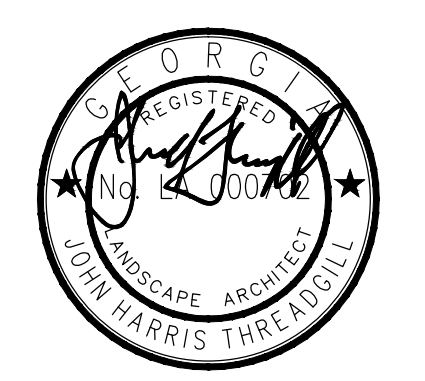

Sheet Information	
Date	05/06/2011
Job Number	800911.007
Drawn	KB
Checked	VZ
Approved	JT

Title
LAYOUT & MATERIALS
PLAN
STA. T101+00 TO
T111+20

Sheet
L-110
ISSUED FOR CONSTRUCTION
Copyright © 2011, Atlanta BeltLine, Inc.

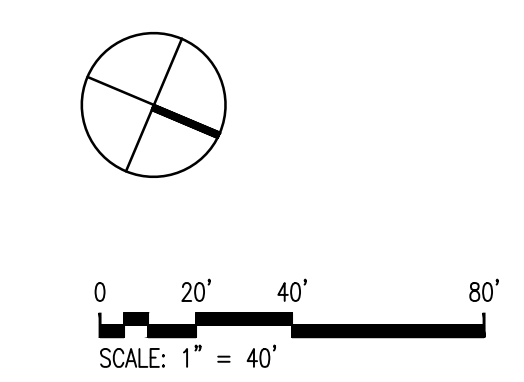
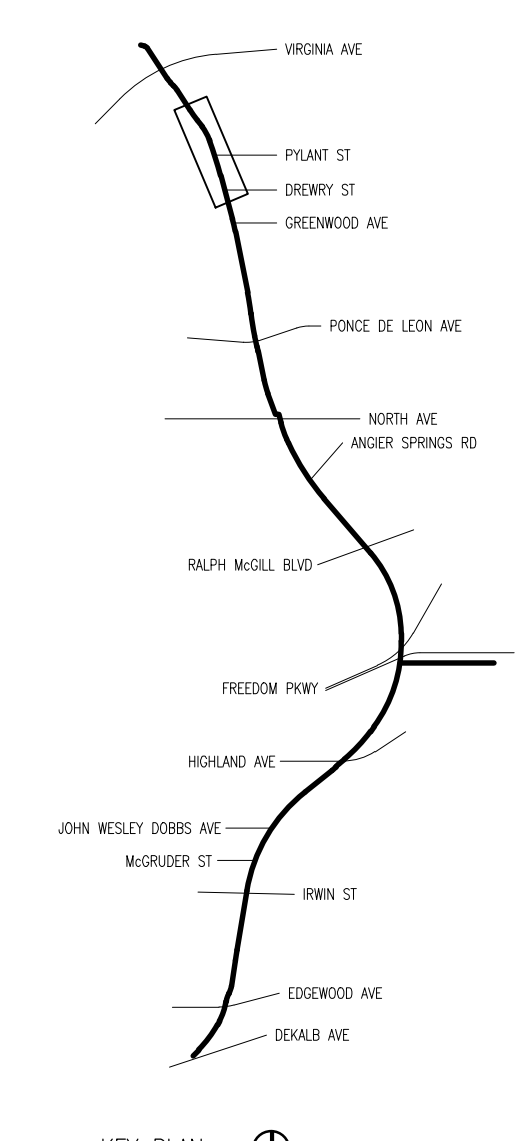
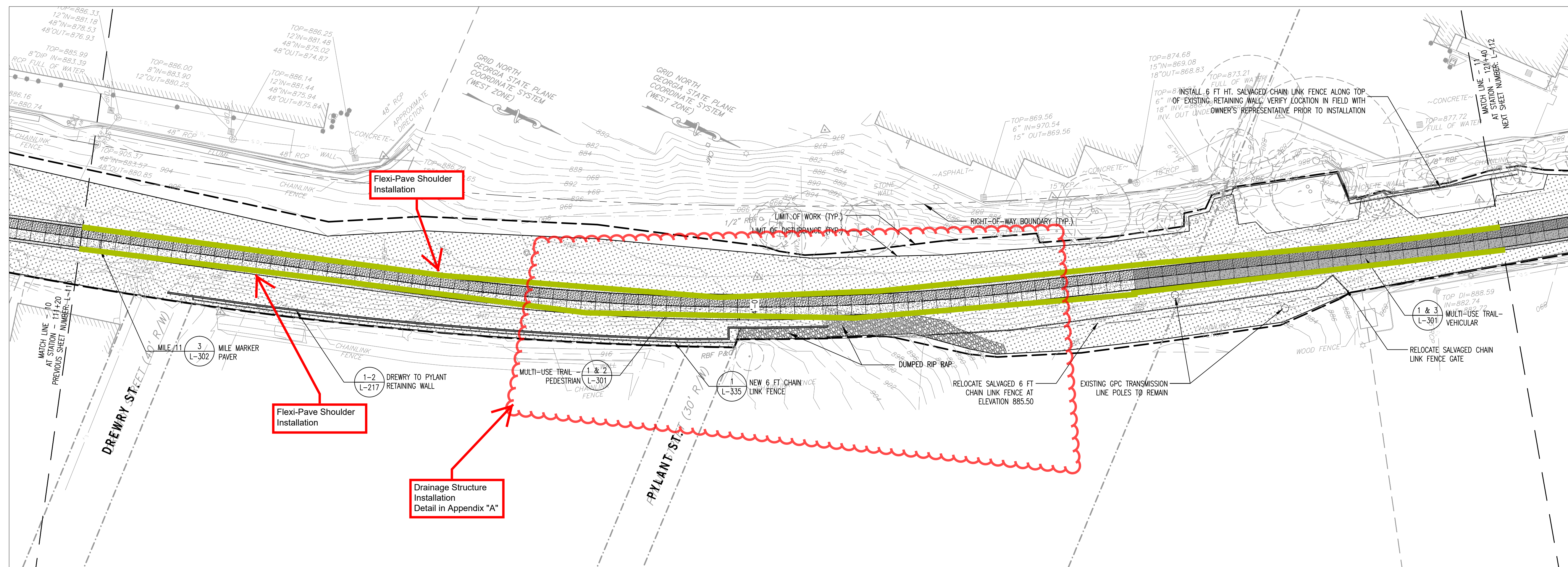

NOTES:
REFER TO SHEET L-101 FOR LAYOUT & MATERIALS NOTES.

LAYOUT & MATERIALS LEGEND

- LIMIT OF WORK
- LIMIT OF DISTURBANCE
- RIGHT-OF-WAY BOUNDARY
- MILE MARKER PAVER
- SIGNAGE
- BOLLARD
- WALL
- METAL SAFETY RAIL
- CHAIN LINK FENCE
- METAL FENCE SCREEN
- LANDSCAPE UPLIGHT
- MULTI-USE TRAIL - PEDESTRIAN (DECORATIVE CONCRETE PAVING)
- MULTI-USE TRAIL - VEHICULAR (DECORATIVE CONCRETE PAVING)
- TACTILE WARNING PAVERS (UNIT PAVING)
- DETECTABLE WARNING PAVERS
- ASPHALT PAVING
- CONCRETE PAVING
- CRUSHED STONE SURFACING, TYPE A1/A2
- CRUSHED STONE SURFACING, TYPE B
- CRUSHED STONE SURFACING, TYPE C
- GRANITE PAVING
- PLANTED AREA
- RIP RAP



Atlanta BeltLine, Inc.
86 Pryor Street, SW, Suite 200
Atlanta, GA 30303
t: 404.880.4100
f: 404.840.0616

Perkins + Will
1315 Peachtree Street, NE
Atlanta, GA 30309
t: 404.873.2300
f: 404.892.5823

James Corner Field Operations
475 Tenth Avenue, 10th Floor
New York, New York 10018
t: 212.433.1450
f: 212.433.1451

Revisions

NO.	ISSUE	DATE	NO.	ISSUE	DATE

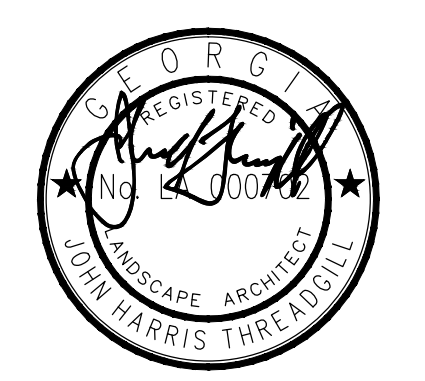

Sheet Information

Date	05/06/2011
Job Number	800911.007
Drawn	KB
Checked	VZ
Approved	JT

Title
LAYOUT & MATERIALS PLAN
STA. T111+20 TO T121+40

Sheet
L-111
ISSUED FOR CONSTRUCTION
Copyright © 2011, Atlanta BeltLine, Inc.

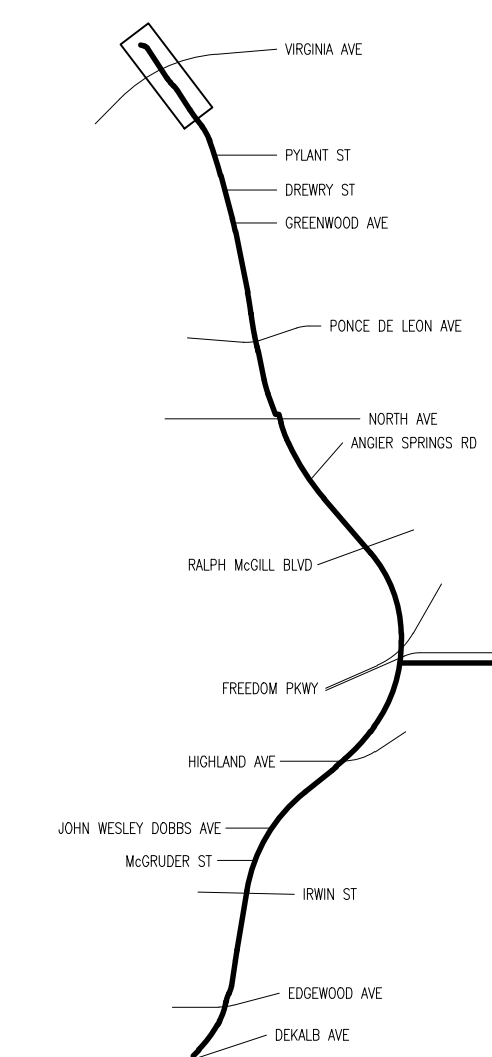
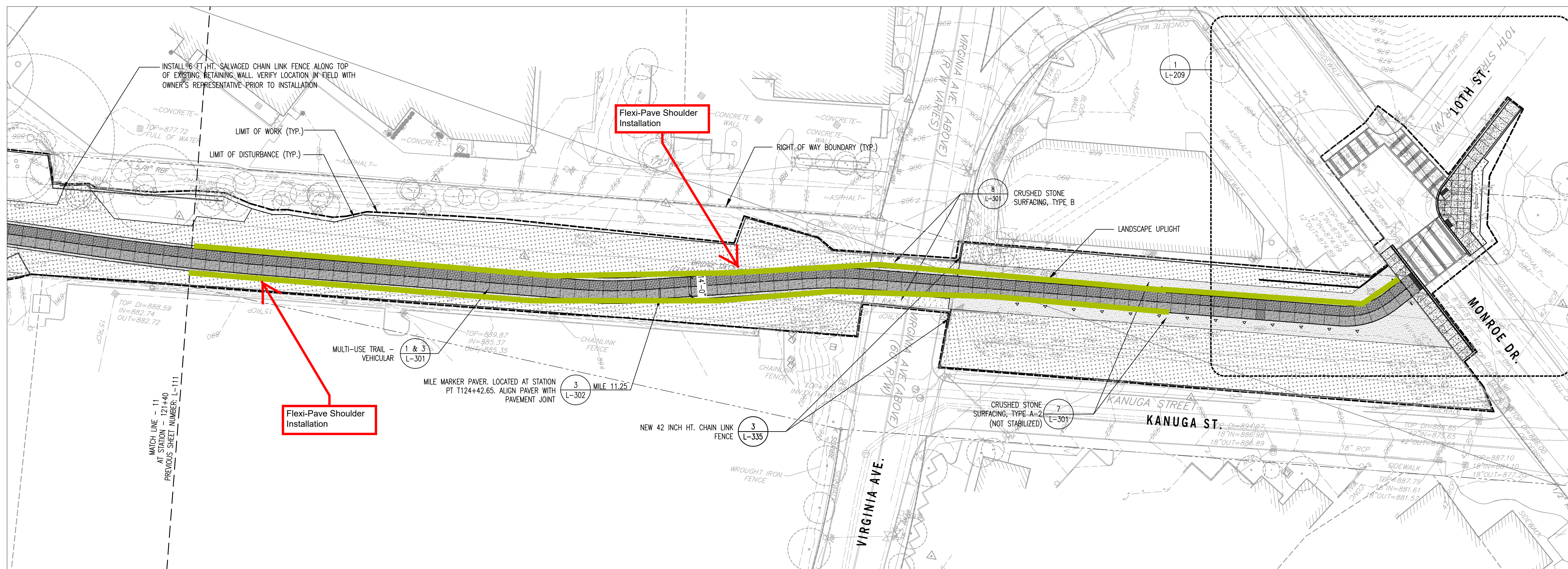

KEY PLAN

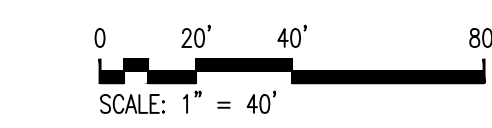
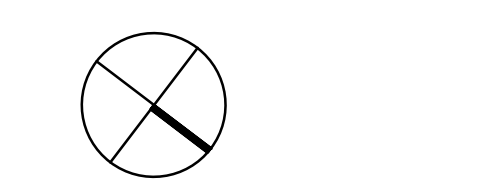

NOTES:
REFER TO SHEET L-101 FOR LAYOUT & MATERIALS NOTES.

LAYOUT & MATERIALS LEGEND

- LIMIT OF WORK
- LIMIT OF DISTURBANCE
- RIGHT-OF-WAY BOUNDARY
- MILE MARKER PAVEMENT
- SIGNAGE
- BOLLARD
- WALL
- METAL SAFETY RAIL
- CHAIN LINK FENCE
- METAL FENCE SCREEN
- LANDSCAPE UPLIGHT
- MULTI-USE TRAIL - PEDESTRIAN (DECORATIVE CONCRETE PAVING)
- MULTI-USE TRAIL - VEHICULAR (DECORATIVE CONCRETE PAVING)
- TACTILE WARNING PAVERS (UNIT PAVING)
- DETECTABLE WARNING PAVERS
- ASPHALT PAVING
- CONCRETE PAVING
- CRUSHED STONE SURFACING, TYPE A1/A2
- CRUSHED STONE SURFACING, TYPE B
- CRUSHED STONE SURFACING, TYPE C
- GRANITE PAVING
- PLANTED AREA
- RIP RAP

Eastside Trail - North Section

Atlanta BeltLine

Atlanta BeltLine, Inc.
86 Pryor Street, SW, Suite 200
Atlanta, GA 30303
t: 404.880.4100
f: 404.840.0616

Perkins + Will
1315 Peachtree Street, NE
Atlanta, GA 30309
t: 404.873.2300
f: 404.892.5823

James Corner Field Operations
475 Tenth Avenue, 10th Floor
New York, New York 10018
t: 212.433.1450
f: 212.433.1451

Revisions

NO.	ISSUE	DATE	NO.	ISSUE	DATE



Sheet Information

Date 05/06/2011
Job Number 800911.007
Drawn KB/MM
Checked VZ
Approved JT

Title
LAYOUT & MATERIALS
PLAN
STA. T121+40 TO
T129+87

Sheet
L-112
ISSUED FOR CONSTRUCTION

Copyright © 2011, Atlanta BeltLine, Inc.