

# ***CITY OF HAVELOCK***

## ***CRAVEN COUNTY, NORTH CAROLINA***

### ***WATER TREATMENT PLANT***

### ***DITCH CLEANING AND CULVERT UPGRADES***

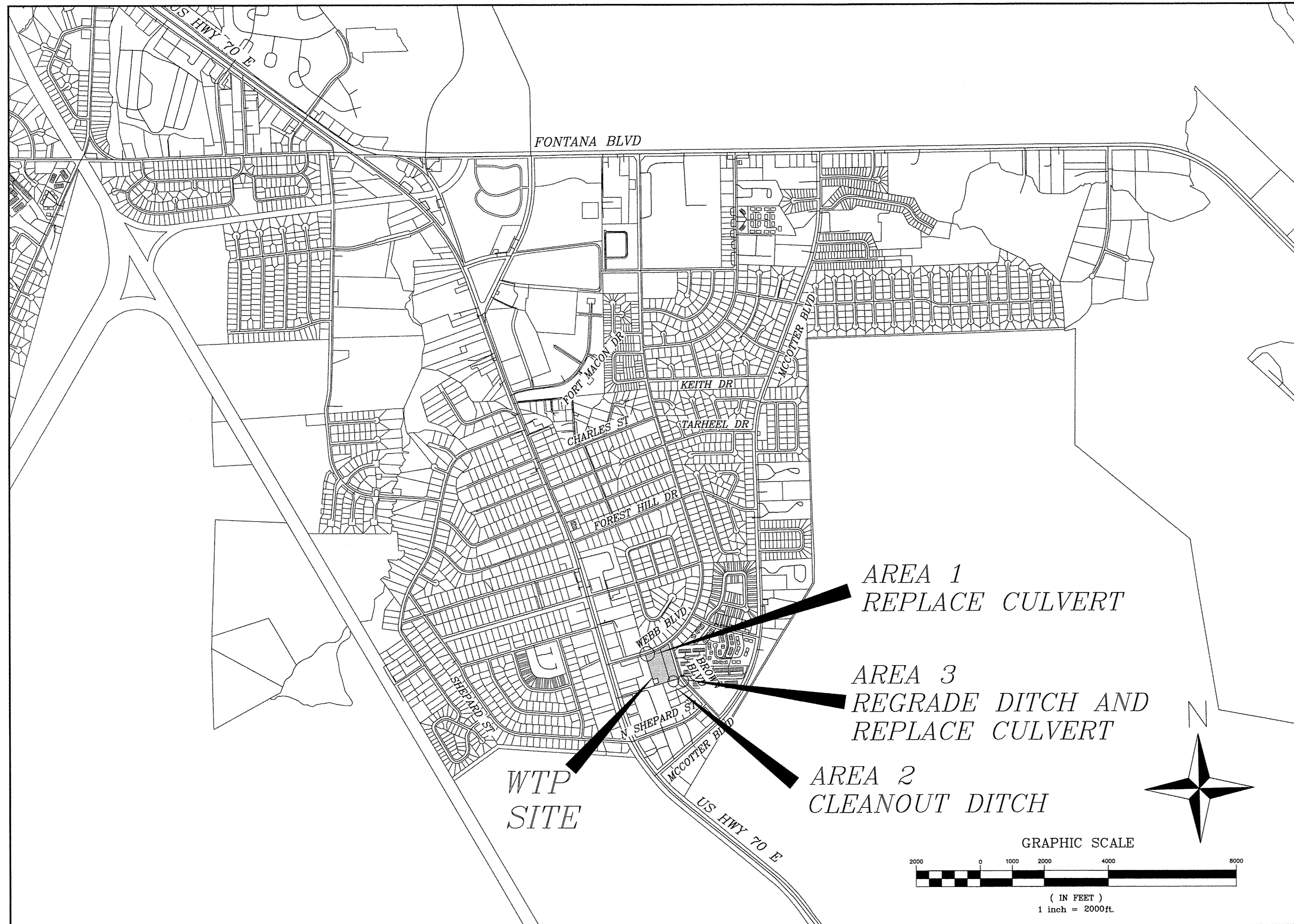

Sheet Number	Sheet Title
G1A	COVER SHEET
CS2A	CULVERT UPGRADES

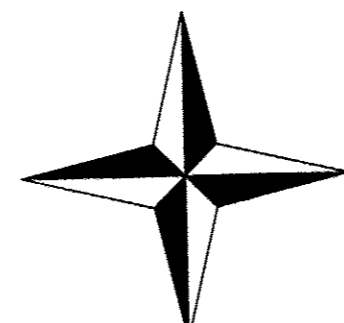
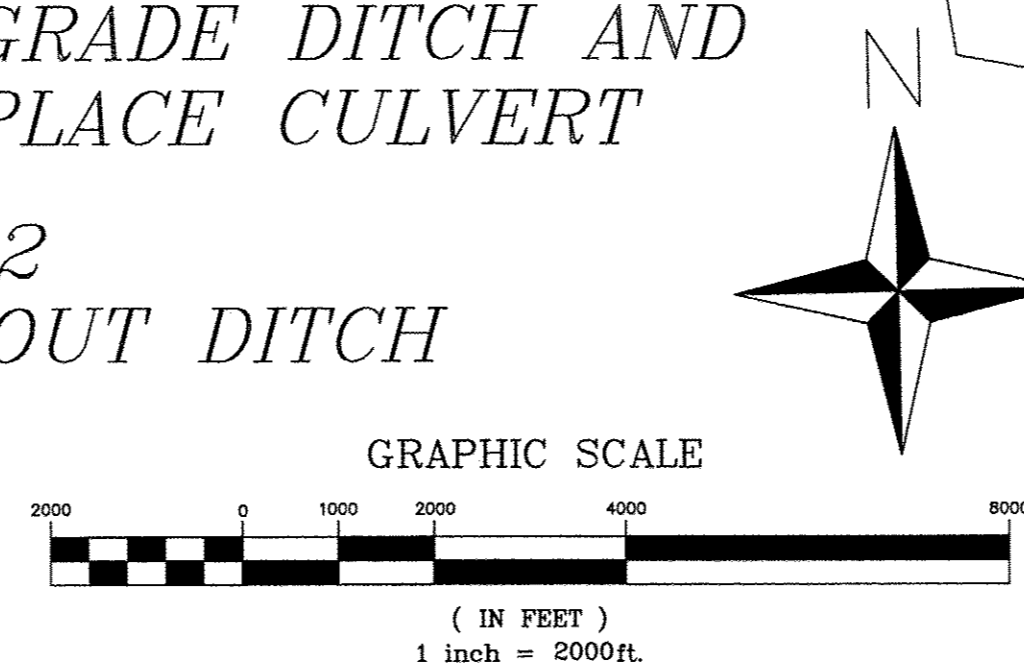

*CRAVEN COUNTY*

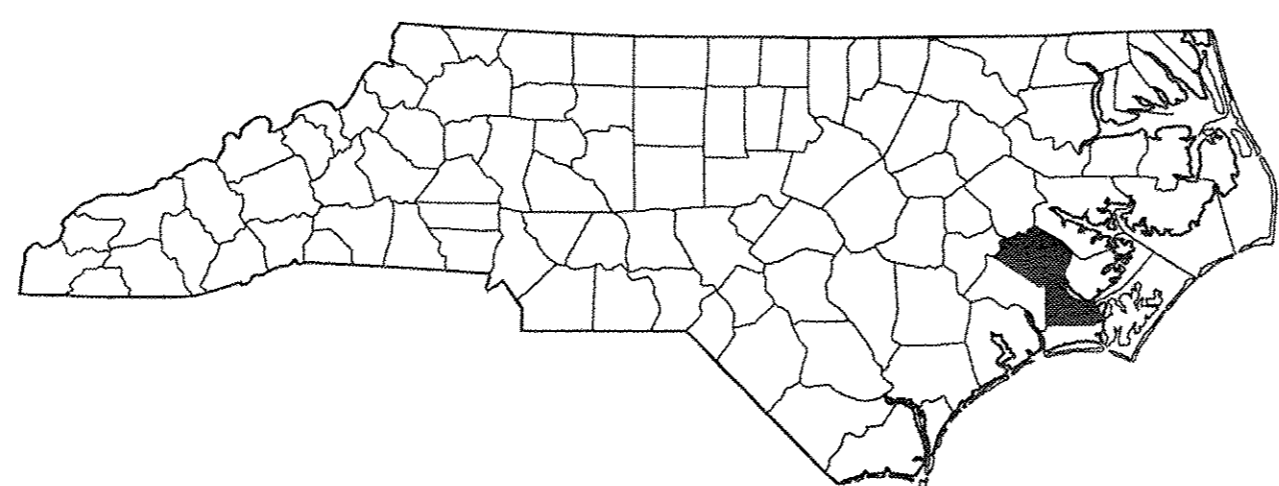

*NORTH CAROLINA*

REV	DATE	DESCRIPTION



COVER SHEET  
 WATER TREATMENT PLANT SITE  
**CITY OF HAVELOCK**  
 CRAVEN COUNTY  
 NORTH CAROLINA

NC License: F4334  
**Rivers**  
 & ASSOCIATES, INC.  
 Since 1978  
 Engineers  
 Planners  
 Surveyors  
 Landscape Architects  
 107 East Second Street  
 Greenville, NC 27838  
 (252) 752-1135

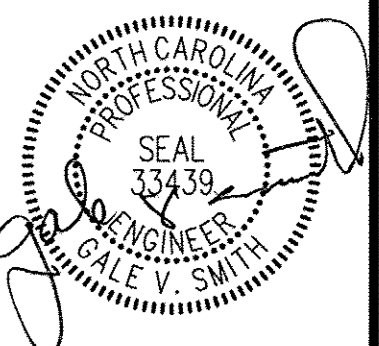

December 12, 2018  
 SURVEY - DRAFT JIM  
 DESIGN GS/GC CHECK GS/GC  
 PROJECT No.  
 DRAWING No. W-3642  
 SCALE: AS NOTED  
 SHEET No. OF  
**G1A**

P:\Juni\Havelock - WTP Plans - 201802\CAD\201802\CoverSheet\_CULVERTS.dwg - E:\C:\Users\jvsmith\OneDrive\Documents\Havelock - WTP Plans - 201802\CAD\201802\CoverSheet\_CULVERTS.dwg - 12/12/2018 10:41:23 AM

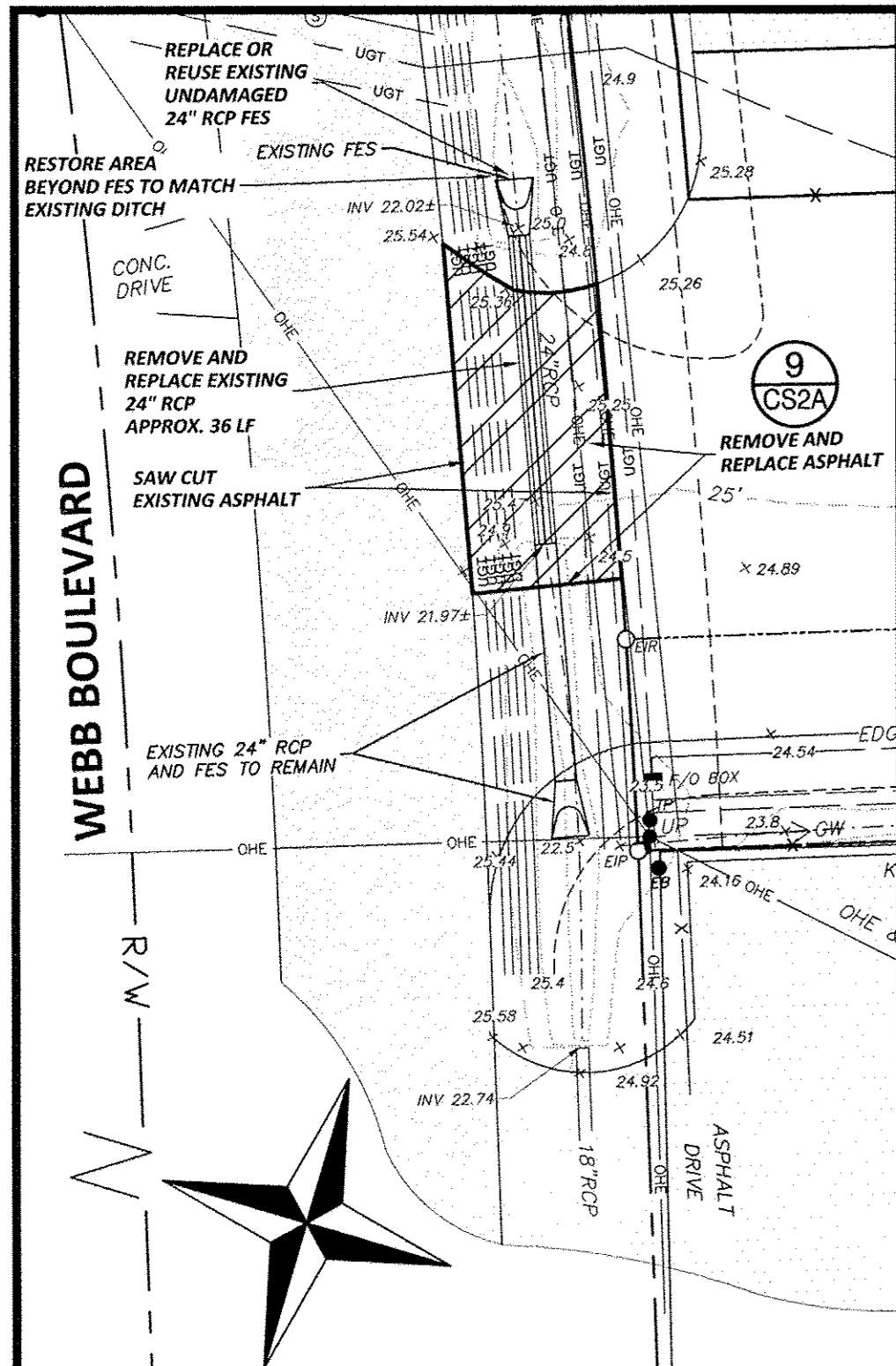

**1 AREA 1**  
**PLAN - CULVERT REPLACEMENT** SCALE: 1" = 20'

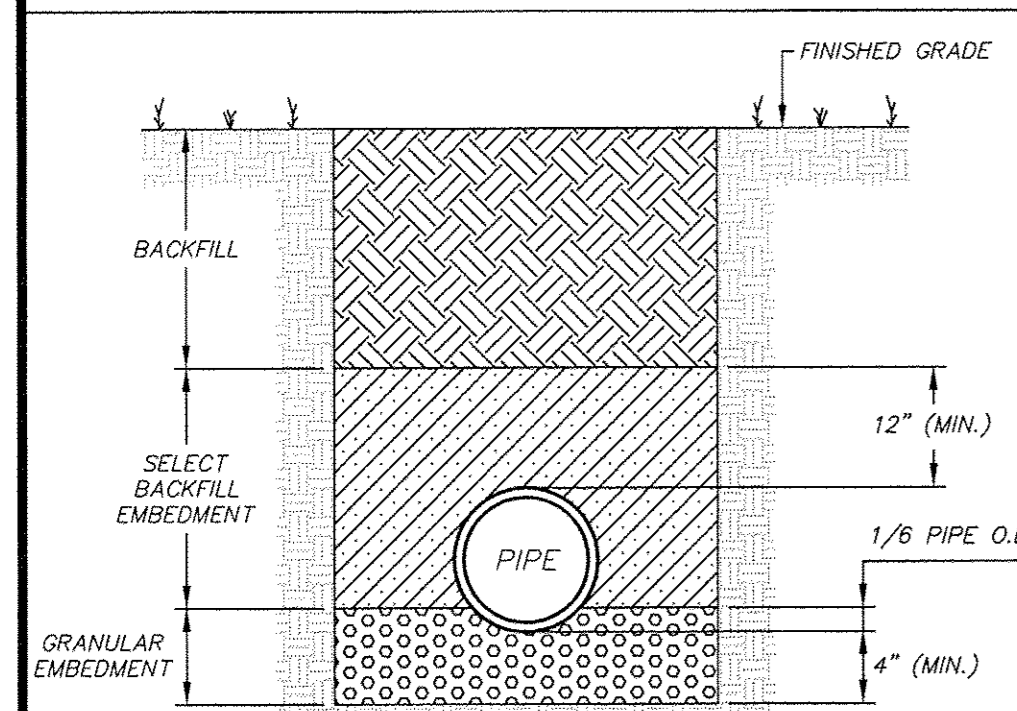

**7 CLASS 'C' BEDDING**  
**CONC. PIPE** N.T.S.

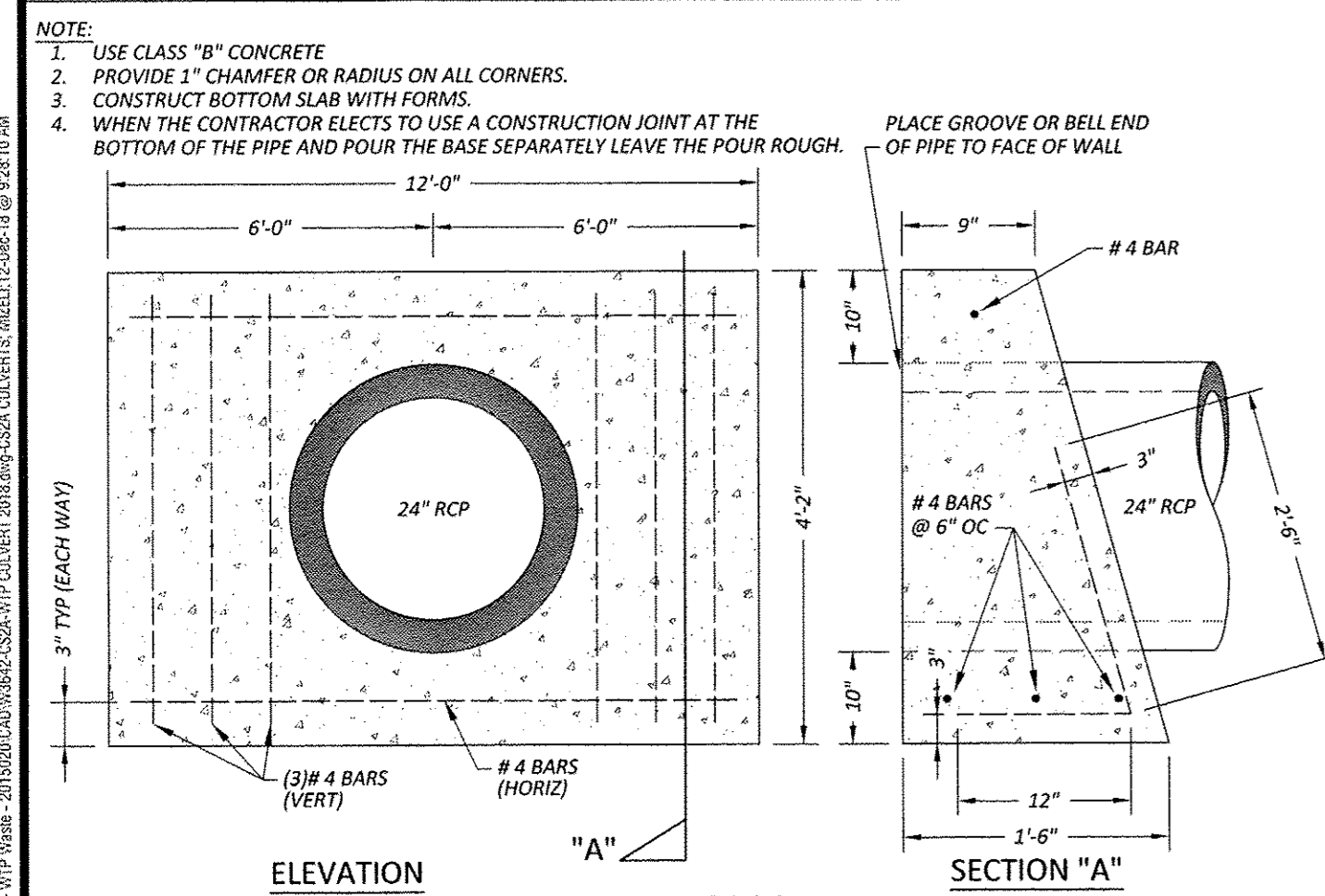

**8 HEADWALL** N.T.S.

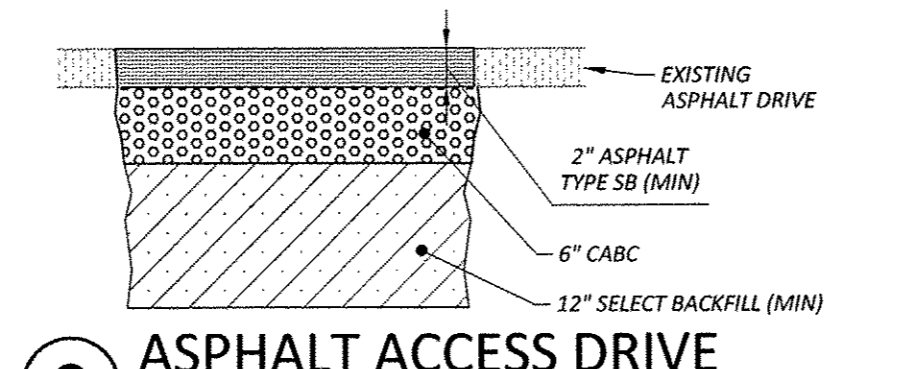

**9 ASPHALT ACCESS DRIVE** N.T.S.

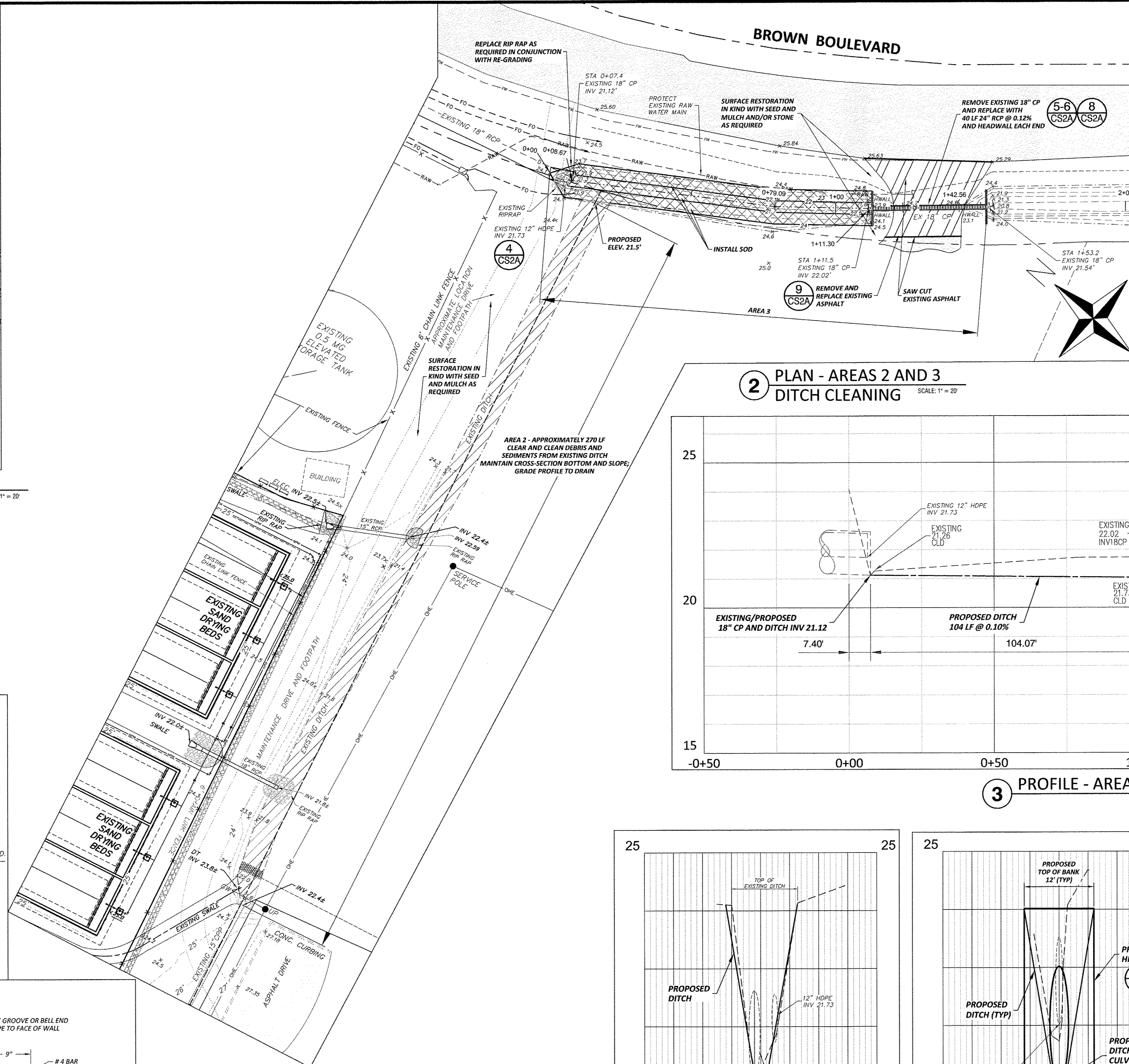

**2 PLAN - AREAS 2 AND 3**  
**DITCH CLEANING** SCALE: 1" = 20'

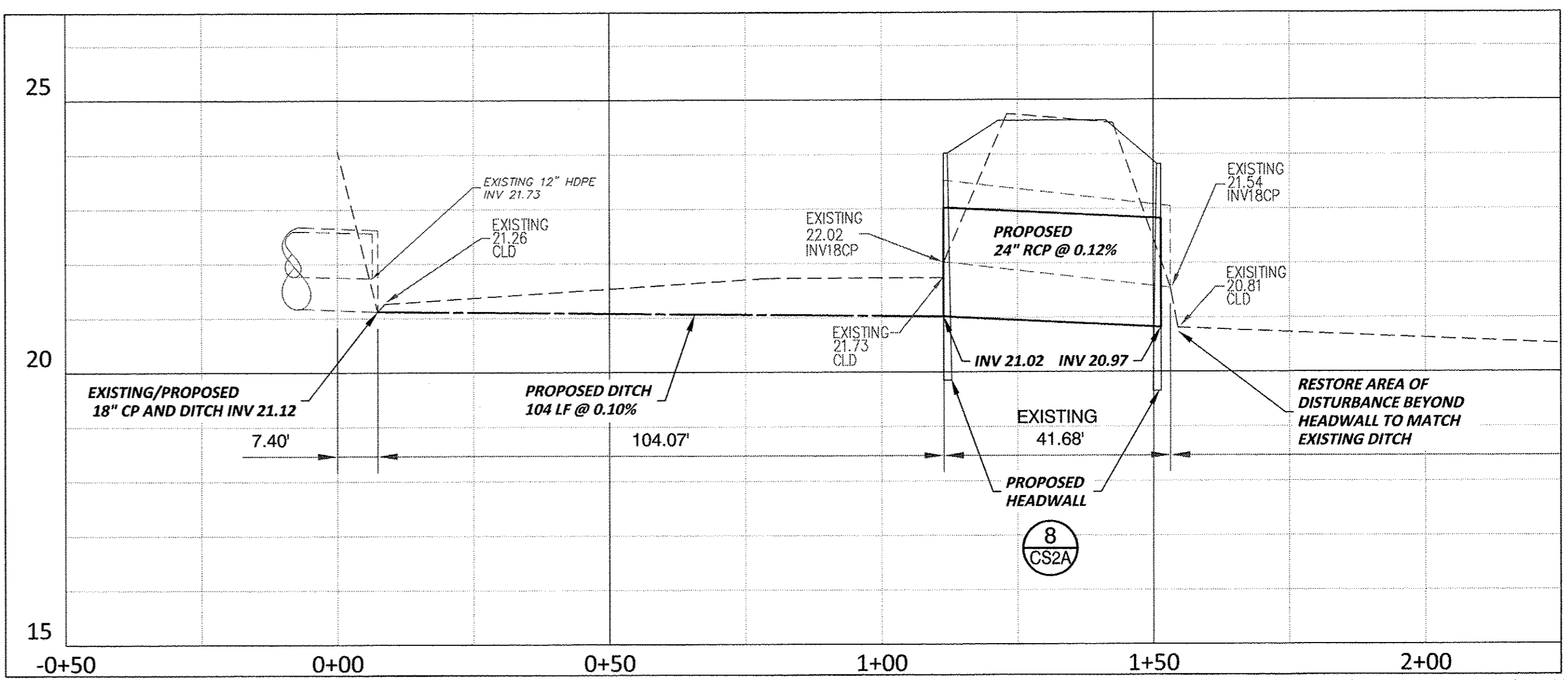

**3 PROFILE - AREA 3** SCALE: 1" = 20'

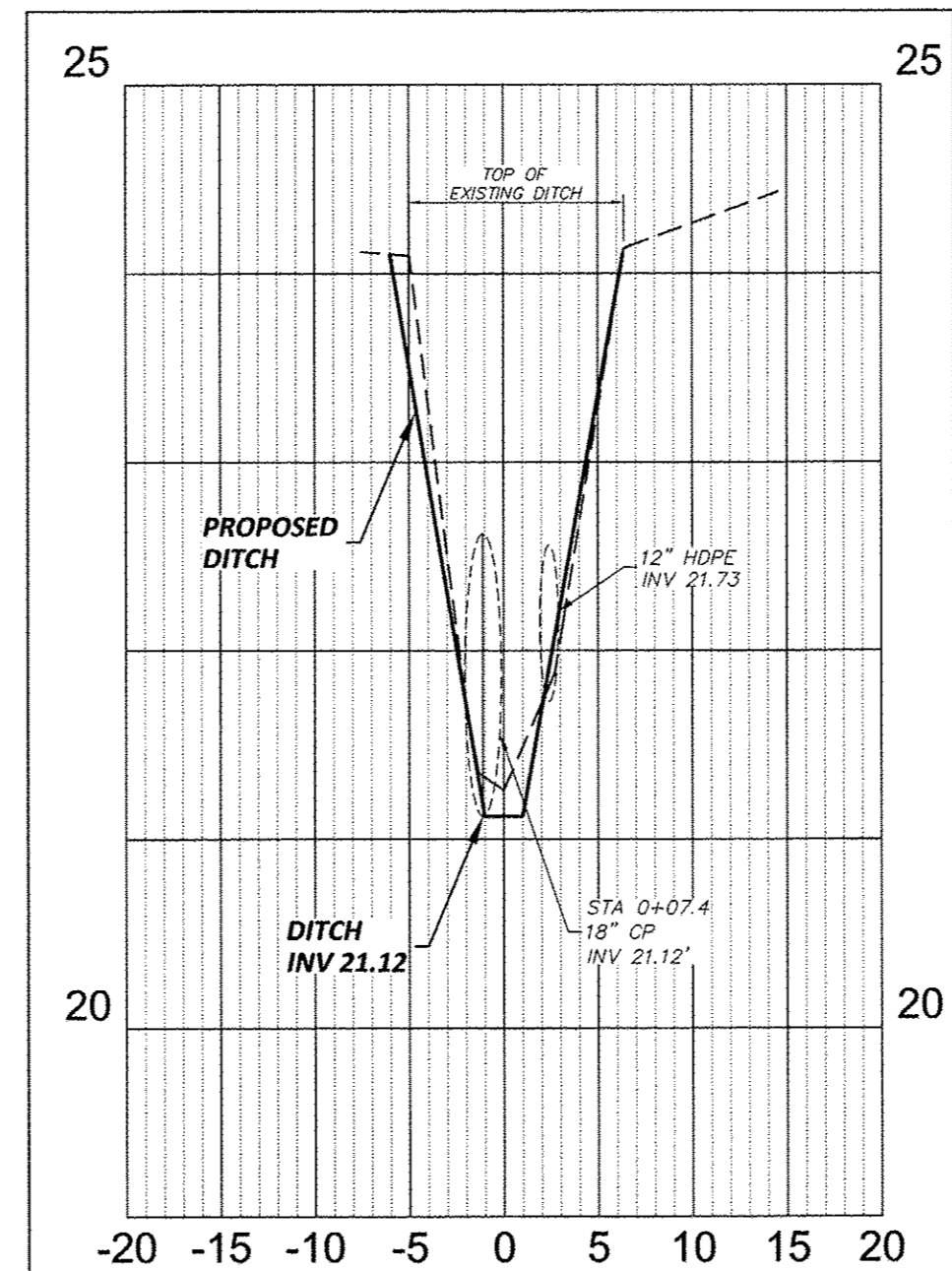

**4 SECTIONS - STA 0+08.67** SCALE: 1" = 10'

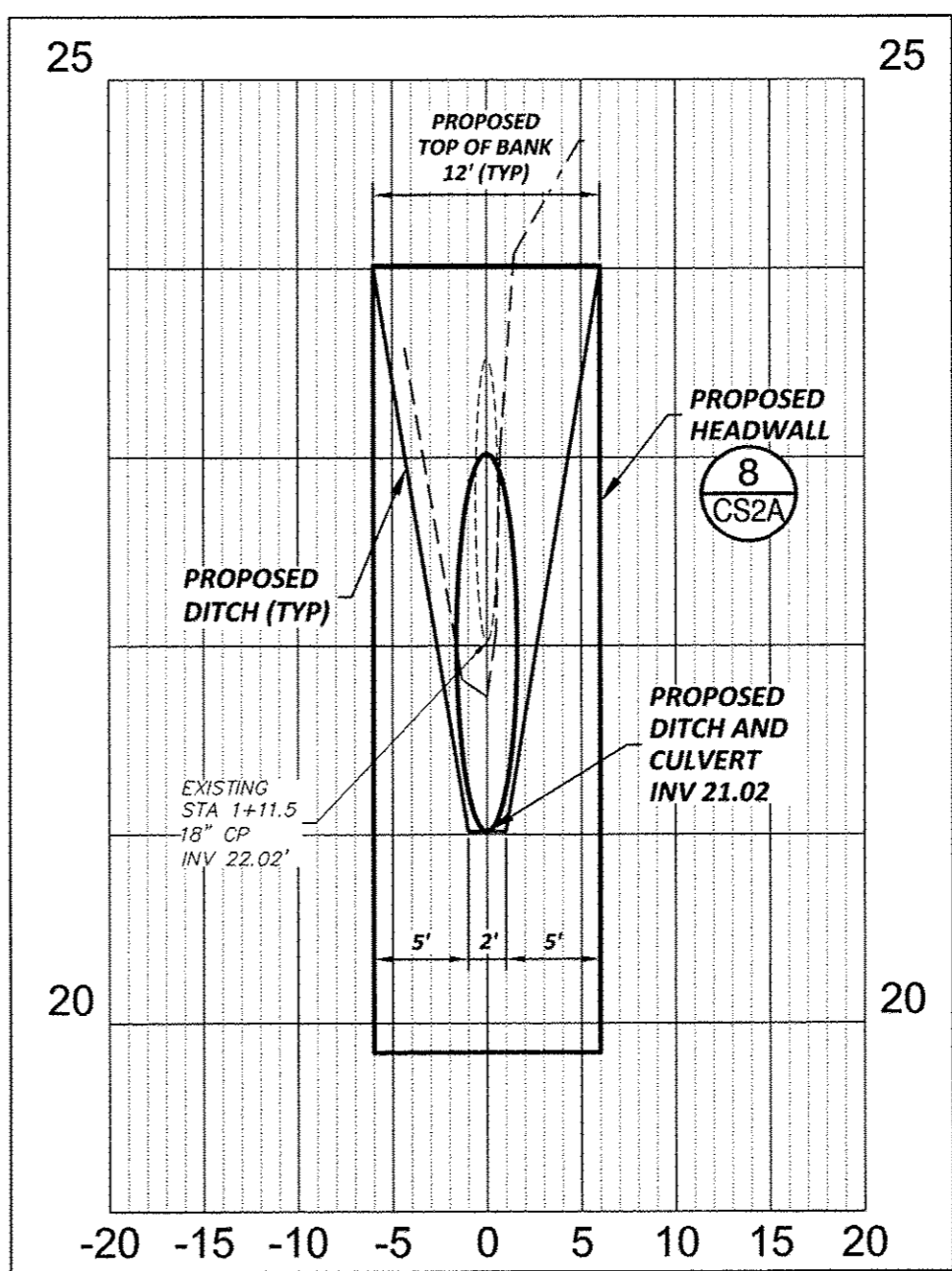

**5 SECTIONS - STA 1+11.3** SCALE: 1" = 10'

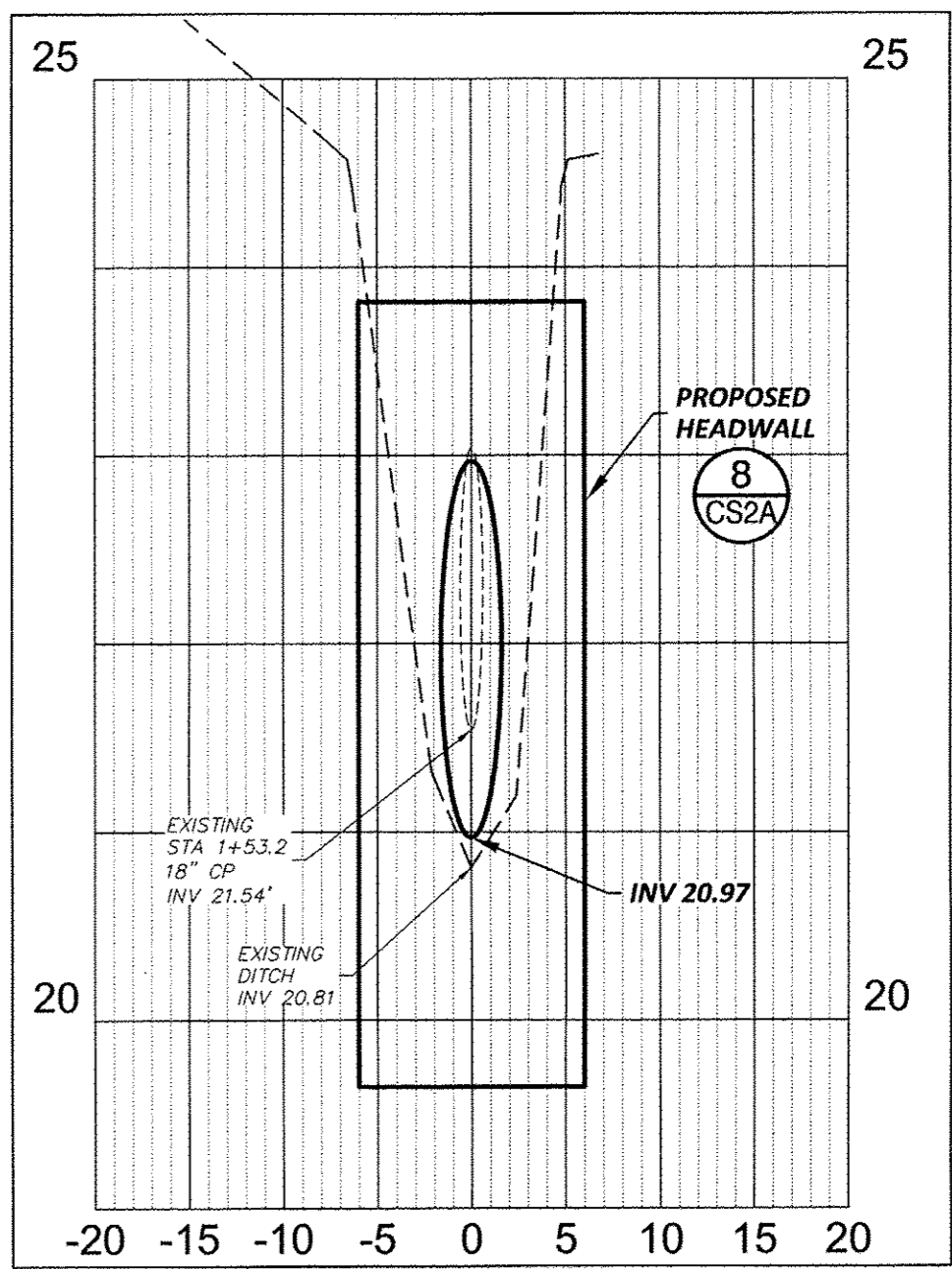

**6 SECTIONS - STA 1+60** SCALE: 1" = 10'

- NOTE:**
1. THE REINFORCED CONCRETE PIPE (RCP) SHALL BE TYPE III MEETING NCDOT STANDARD SPECIFICATION 2012
  2. THE CONTRACTOR SHALL UTILIZE UPSTREAM-END EXISTING ELEVATION 22.4 MSL AND DOWNSTREAM-END PROPOSED ELEVATION 21.5 MSL SHOWN ON THE DRAWING TO ESTABLISH PROFILE SLOPE TO DRAIN.
  3. HEADWALL CAN BE CAST-IN-PLACE, OR PRE-CAST CONCRETE IN ACCORDANCE WITH NCDOT STANDARD SPECIFICATION 2012 AND APPLICABLE NCDOT STANDARD DRAWING 2012.
  4. PRIOR TO PERFORMANCE OF ANY EXCAVATION NOTIFY NORTH CAROLINA ONE-CALL CENTER, INC. (NC-811) FOR LOCATION OF UNDERGROUND UTILITIES.



REVISIONS:

NO.	DATE	DESCRIPTION

CULVERT UPGRADES  
WATER TREATMENT PLANT SITE  
**CITY OF HAVELOCK**  
NORTH CAROLINA  
CRAVEN COUNTY

**Rivers**  
& ASSOCIATES, INC.  
107 EAST SASSWOOD STREET  
GREENVILLE, NC 27608  
(252) 752-4135  
Landscape Architects

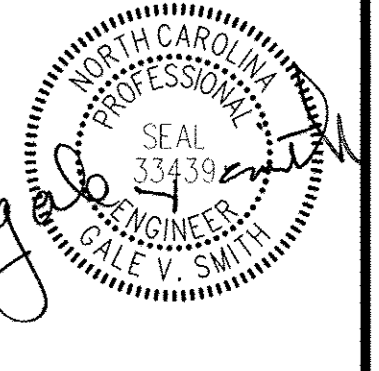

December 12, 2018  
SURVEY - DRAFT JIM  
DESIGN GS/GC CHECK GS/GC  
PROJECT No. W-3642  
DRAWING No. W-3642  
SCALE: AS NOTED  
SHEET No. OF

