

## **Addendum #5**

### **Walnut Plaza and Ed Johnson Memorial**

**CONTRACT NO. R-19-007**

#### **Bid schedule per Addendum #3**

Pre-Bid Meeting            September 17<sup>th</sup> at 10:00 am

Last Day for Questions   October 1<sup>st</sup>, 2019

Bid Opening                October 15<sup>th</sup> at 2:00 pm

#### **Attachments**

- Sheet L1.50- clarified light pole model number and corrected a reference in the key
- Sheet 4.03- corrected a reference in detail 3

#### **Questions Received via email**

1. On sheet L4.03 there is a base detail for the pole and a detail for couplers to mount the fixtures to the poles, but there is no spec for the overall height of the pole.
  - a. The streetlight layout is shown on L1.50- Lighting Plan. Pole heights are specified in the model numbers found in the key. The light poles can be found at [bega-us.com](http://bega-us.com) .

NOTES

- 1. SEE SPECIFICATION 055213 TUBE RAILINGS FOR RAIL LIGHT INFORMATION.
- 2. PROVIDE RAIL LIGHT POWER SUPPLY WITHIN VERTICAL POSTS OR IN REMOTE NEMA RATED ENCLOSURE. INDICATE IN SHOP DRAWINGS.

LIGHT FIXTURE SCHEDULE

KEY	DESCRIPTION	MODEL	MANUFACTURER	QUANTITY	DETAIL
LP2	2-HEAD LIGHT WITH 24'-8" POLE	HEAD: 77704-SLV-K3+70757 POLE: 2408-SF-SLV+MODIFIED WITH 2 WELDED 1/2" NPS TAPPED COUPLER	BEGA	2	2,3 L4.03
LP4	4-HEAD LIGHT WITH 24'-8" POLE	HEAD: 77704-SLV-K3+70757 POLE: 2408-SF-SLV+MODIFIED WITH 4 WELDED 1/2" NPS TAPPED COUPLER	BEGA	4 (8 TOTAL)	2,3 L4.03
LP2A	2-HEAD LIGHT WITH 29'-8" POLE	HEAD: 77704-SLV-K3+70757 POLE: 2908-SF-SLV+MODIFIED WITH 2 WELDED 1/2" NPS TAPPED COUPLER	BEGA	2	2,3 L4.03
LR2	RAIL LIGHT SYMMETRIC DISTRIBUTION	MATCH HOLMBERG BRIDGE		~11.5 LF	2-6 L4.01
LR3	RAIL LIGHT ASYMMETRIC DISTRIBUTION	MATCH HOLMBERG BRIDGE		~107 LF	2-6 L4.01
PB	POLE LIGHT PULL BOX			3	

**W M W**  
landscape architects

1426 Williams Street, Suite 12,  
Chattanooga, Tennessee 37408  
(423) 551-3800  
land@wmwala.com

**Chazen**  
ENGINEERING  
CONSULTANTS  
A Chazen Company

Civil Engineers  
Land Surveyors  
Planners  
Environmental & Safety Professionals  
Landscape Architects  
Transportation Planners & Engineers

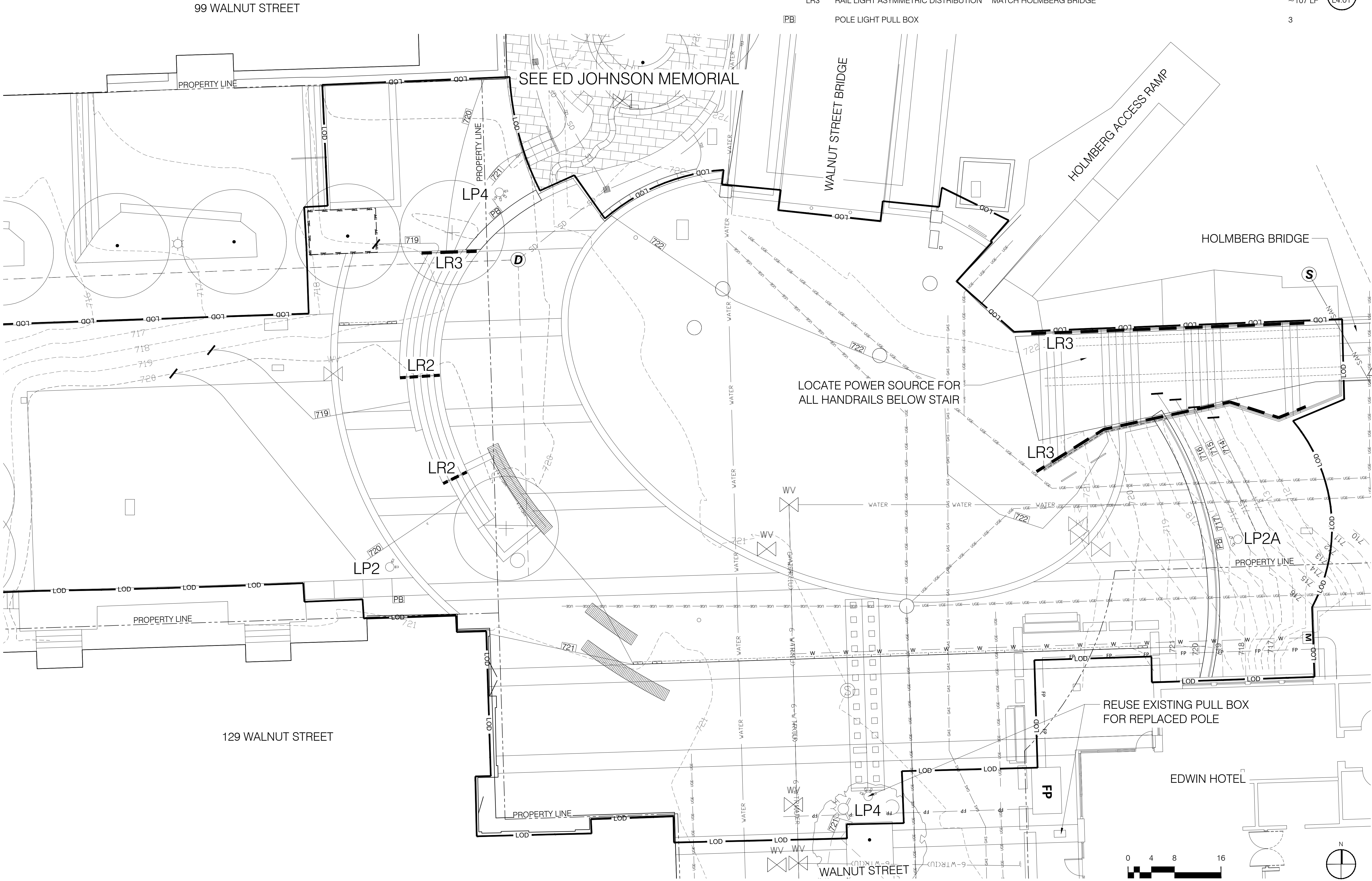

PROJECT:  
**WALNUT STREET PLAZA**  
100 BLOCK WALNUT STREET  
Chattanooga, TN 37403

ISSUE:  
**BID SET**

© 2019 Copyright W.M. Whitaker & Associates. Intellectual Property All Rights Reserved.

SUBMISSIONS/ REVISIONS

DATE	DESCRIPTION
10/14/2019	PC-01 LIGHTING NOMENCLATURE CLARIFICATION

SEAL

PROJECT NUMBER: 1707

DATE: August 9, 2019

SCALE: 1/8" = 1'-0"

DRAWING TITLE:  
**LIGHTING PLAN**

SHEET NUMBER:  
**L1.50**

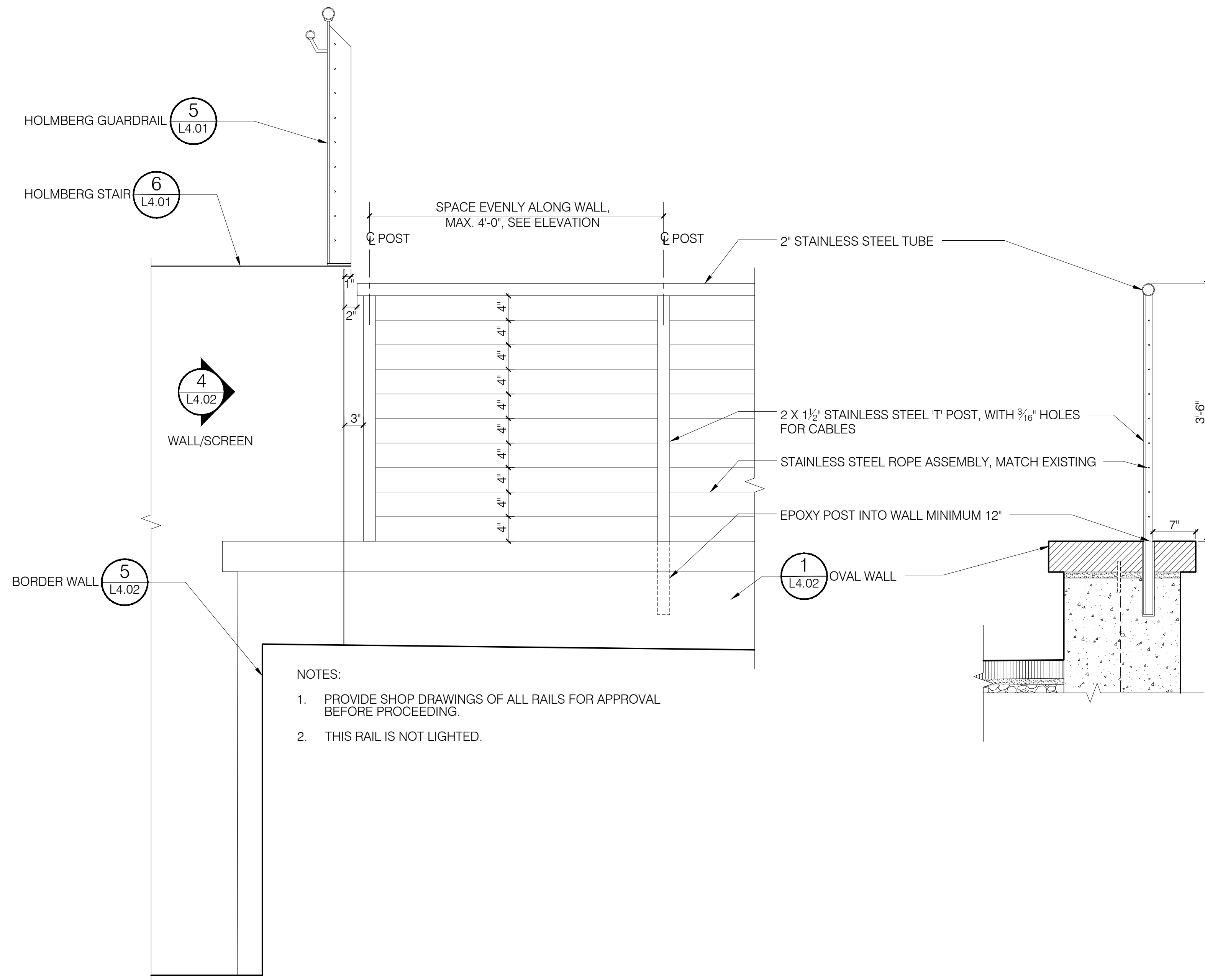

1 OVAL GUARDRAIL - ELEVATION  
L4.03 SCALE: 1" = 1'-0"

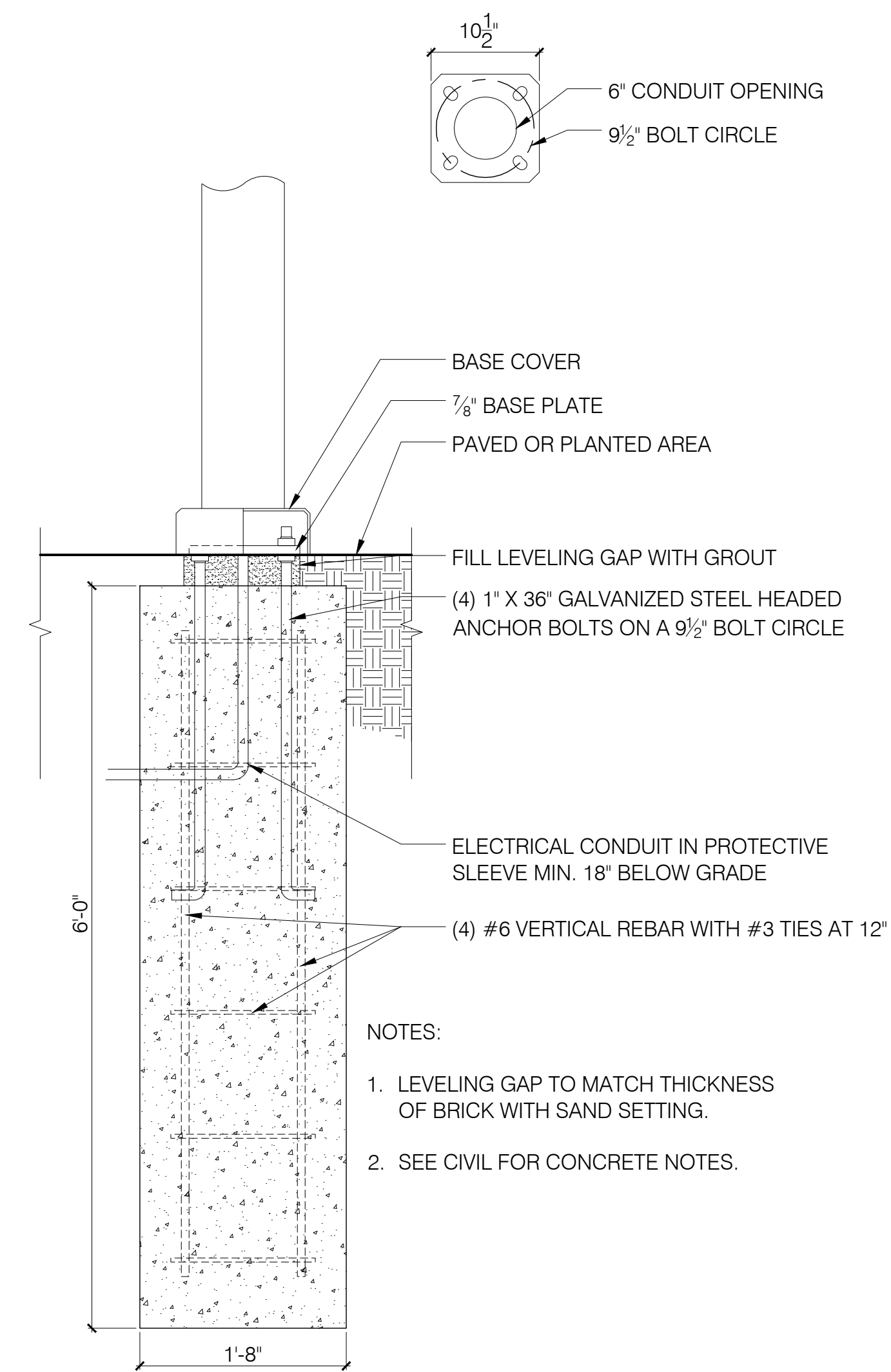

2 LIGHT POLE FOOTING - SECTION  
L4.03 SCALE: 1" = 1'-0"

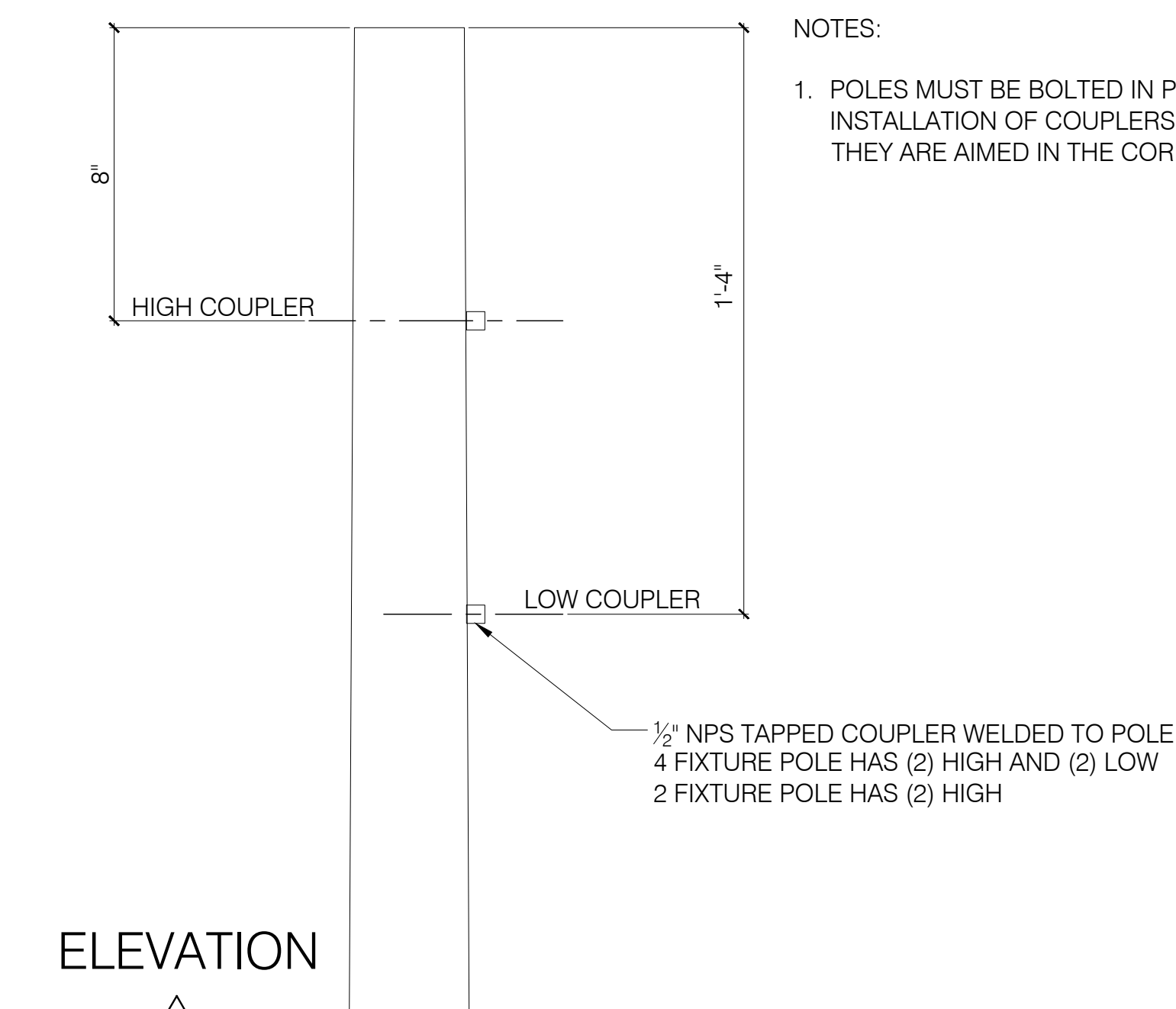

3 LP FIXTURE DETAILS  
L4.03 SCALE: 3" = 1'-0"

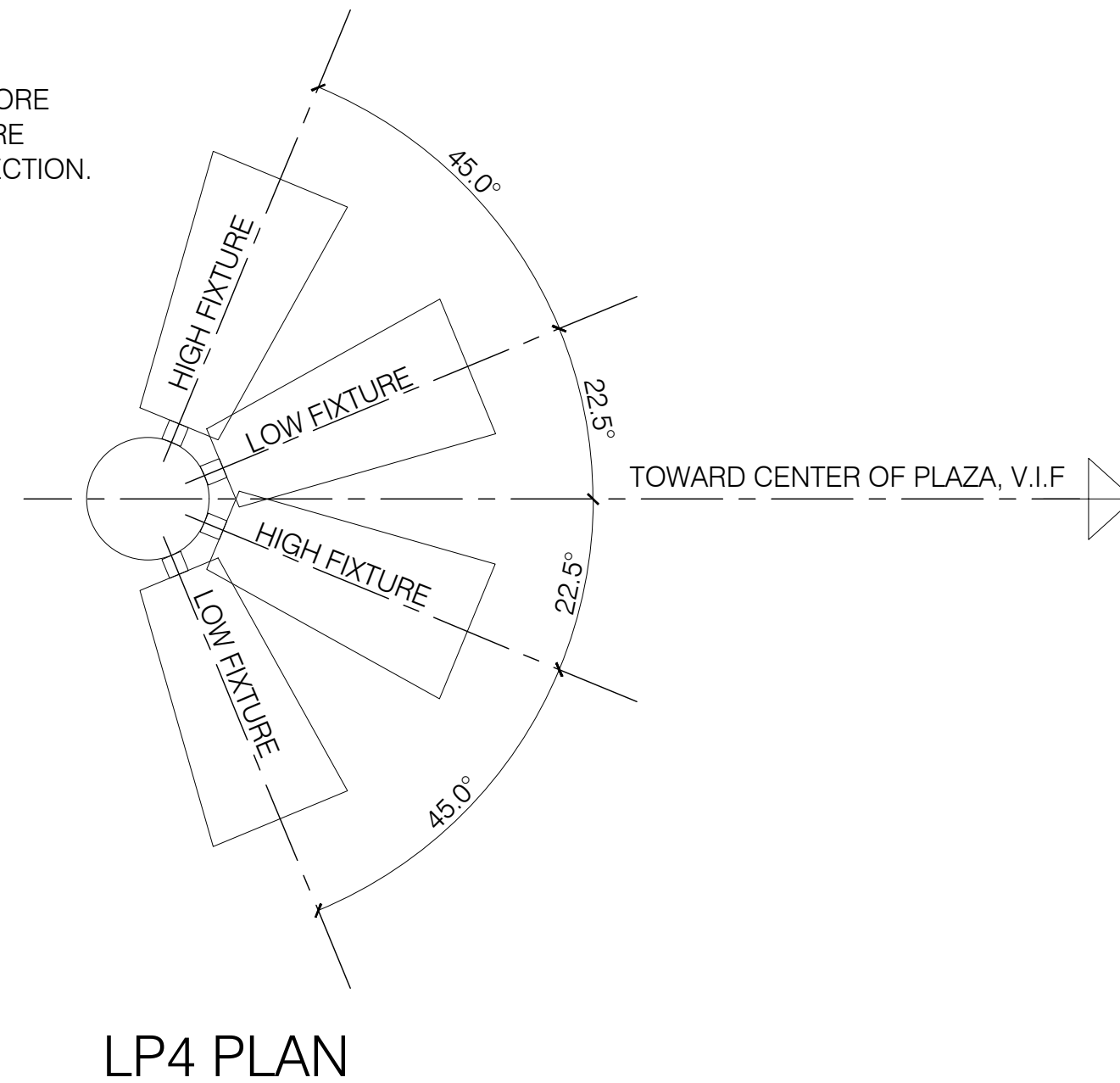

LP4 PLAN

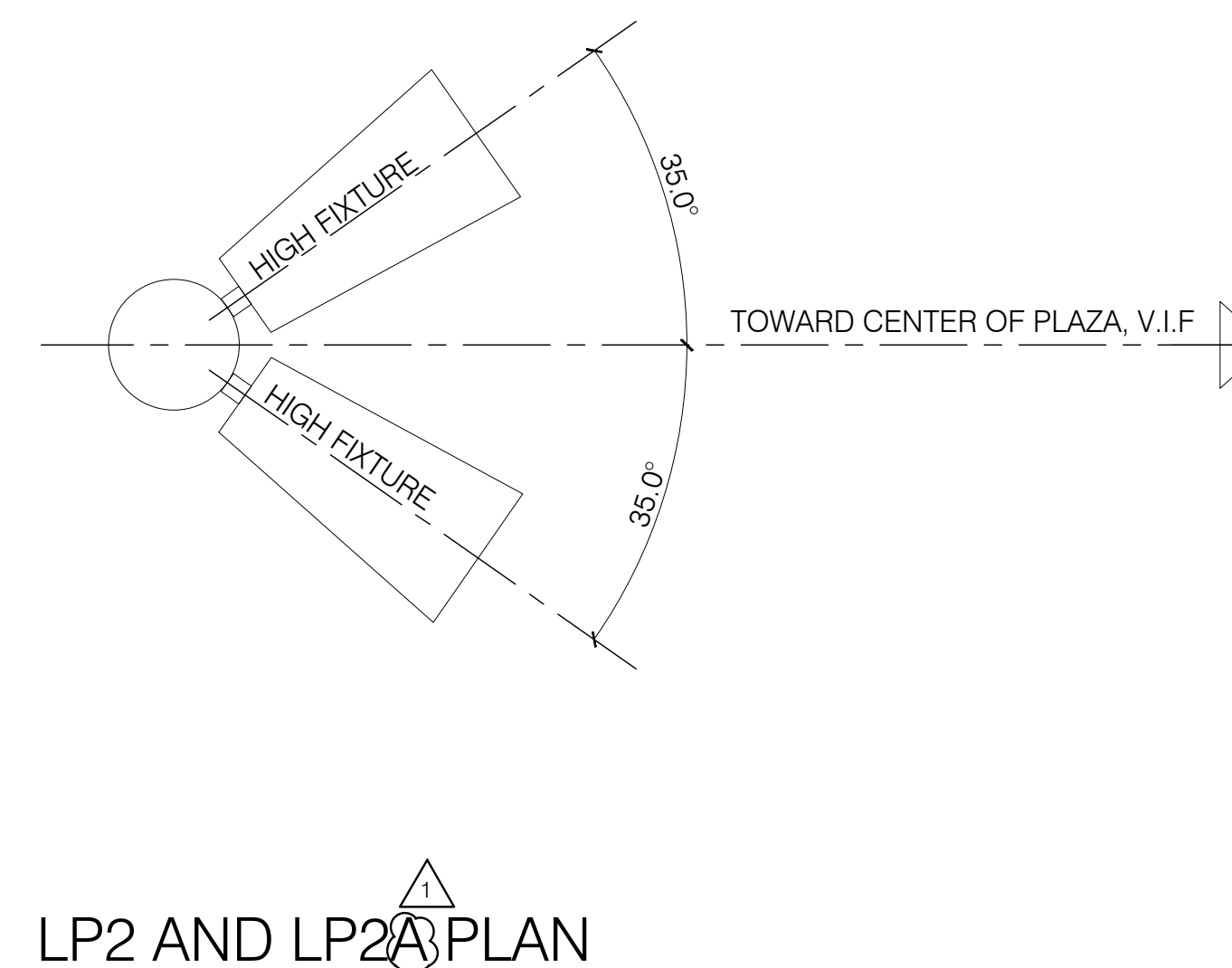

LP2 AND LP2A PLAN

PROJECT:  
**WALNUT STREET PLAZA**  
100 BLOCK WALNUT STREET  
Chattanooga, TN 37403

ISSUE:  
**BID SET**

© 2018 Copyright T.M. Wilshire & Associates. All rights reserved.

SUBMISSIONS/ REVISIONS	
10/14/2019	PC-01 LIGHTING NOMENCLATURE CLARIFICATION

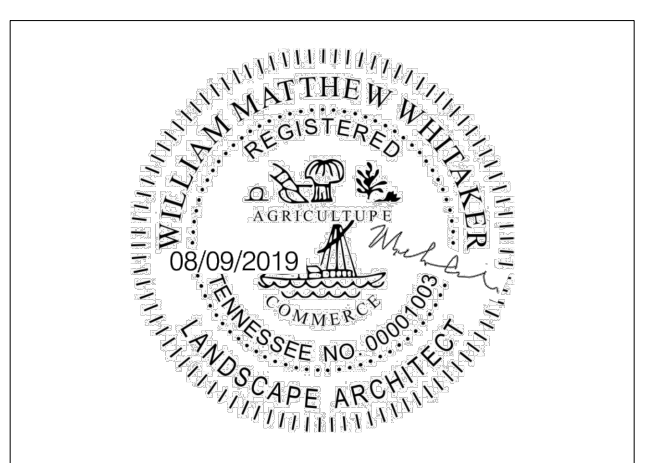

SEAL  
PROJECT NUMBER: 1707  
DATE: August 9, 2019  
SCALE: As Shown  
DRAWING TITLE:  
**SITE DETAILS**

SHEET NUMBER:  
**L4.03**