



St. Johns River Water Management District

Michael A. Register, P.E., Executive Director

525 Community College Parkway S.E. • Palm Bay, FL 32909 • 321-984-4940 • www.sjrwmd.com

DATE: December 17, 2021
TO: Prospective Respondents
FROM: Amy Lucey, Procurement Specialist
SUBJECT: Addendum #1 to Invitation For Bid, # 37489, Refurbish/Upgrade the Unit 2 Pump Station

As a result of the Mandatory Pre-Bid meeting held on December 8, 2021, the following clarifications/changes are provided for your information. Please make all appropriate changes to your bid documents. Note: changes are reflected with original language shown with strike-through and new language is underlined.

- The size of the new service shall be a 1,000 amp service.
- The existing Amarillo drives shall be removed and cleaned and the bearings and seals replaced. The contractor shall check the gear reduction and verify that no problems exist. Any issues will be reported to the District Project Manager; additional repair work shall be considered as a change order.
- The Unit 2 PS is located adjacent to the Apopka Wildlife Drive which is open to the public Friday – Sunday. During this time all traffic enters at Lust Road and exits at Jones Road. If the contractor and or subcontractors are working during this time, they too shall adhere to this traffic pattern.
- The Unit 2 PS is also adjacent to the Apopka Loop Trail which is open to the public seven days a week. However, the trail is only open to hikers and bicyclists, no motorized vehicles are allowed. The trail is located on the west side of the building. This Trail shall be open to the public at all times unless otherwise discussed and approved by the District.
- The contractor shall place orange security fencing from the existing handrail on the pedestrian cross-over (north and south of building) to the east side of the pump station doorways to minimize the public from being within the work zone.
- Because this area is open to the public, it is highly recommended that the contractor take every precaution to secure their equipment and materials.
- Attached is the preliminary Electric Service Proposal and site plan from Duke Energy. The District is currently in the process of signing this Proposal
- The Bailey Bridge weight limit, east of the pump station is 50 tons

As a result of inquiries, the following clarifications/changes are provided for your information.

Q1. For clarification and to know which way we are bidding your project, can we bid as Prime? We are a Florida Electrical Contractor but do not hold a General Contractor's license. Can we bid your projects as Prime?
A1: Yes, the District takes no exception to an Electrical Contractor bidding on the project as the Prime.

Attachments:

Duke Energy Service Proposal
Duke Energy Site Plan

NOTE: The Proposal Due Date **remains** 2:00 p.m., **Thursday, January 13, 2022.**

Please acknowledge receipt of this Addendum on the Bid FORM provided in the proposal package.

If you have any questions, please e-mail me at alucey@sjrwmd.com.



December 10, 2021

ELECTRIC SERVICE PROPOSAL FOR UNDERGROUND COMMERCIAL DEVELOPMENT

Re: Duke Energy Work Request Number: **41079161**
Project Name: **ST. JOHN RIVER WATER MANAGEMENT**
Location: **2771 LUST RD APOPKA FL 32703**
Customer: ST. JOHN RIVER WATER DISTRICT

Our proposed design is based upon load information and building plans submitted to Duke Energy Florida, LLC. ("Duke Energy"). Any changes in building design, project layout, service requirements, or project scheduling must be communicated to your Duke Energy representative immediately. Any such changes initiated after the completion of our design may result in additional charges and/or delays in our construction scheduling.

Service within the project will be provided by a combination of overhead and underground facilities as shown on the enclosed drawing. Service voltage will be 277/480 volts, 3 phase, 4 wire.

Under the terms of Duke Energy's Commercial/Industrial Underground Distribution Policy as approved by the Florida Public Service Commission, there will be a charge of **\$3,250.57**, to be paid by the customer in advance to aid in the construction of this distribution system.

During or after the completion of our construction, the Customer shall be held financially responsible for any damages to Duke Energy's equipment or facilities caused by the Customer, the Customer's employees, agents, subcontractors, or other utility companies.

The Customer shall be held financially responsible for any damages caused by Duke Energy or its subcontractors to any underground facilities or utilities resulting from the Customer's failure to accurately locate and mark all utilities/facilities according to Florida Sunshine locate law requirements prior to the installation of Duke Energy's facilities. It will be the Customer's responsibility to maintain and refresh any such locates in the field throughout our construction process.

The Customer shall be held financially responsible for all costs incurred by Duke Energy due to the Customer's failure to comply with any of the other responsibilities described herein.

The Customer will be responsible for the following requirements:

- All cable/trench routes and transformer locations cleared, with final grade established, prior to the installation of Duke Energy's facilities.

Customer Initials: _____

- All pertinent lot corners, street locations and proposed underground utilities (i.e. switchgear, transformers, pedestals, pull boxes, street light poles) shall be **staked and maintained**.
- Accurately locate and mark private facilities according to Florida Sunshine locate law requirements prior to the installation of our facilities.
- No paving, landscaping, or sodding shall be done on the trench routes until all necessary Duke Energy cables or conduits have been installed.

Duke Energy will not be responsible for any repaving, re-landscaping, or re-sodding, for any reshaping or re-grading of ditches or swales, or for any compaction or testing of its trench route made necessary by the installation of the facilities shown in this proposal, unless such work is a result of the negligence of Duke Energy. Duke Energy's normal mode of operation is to use backhoe's shovel and weight to backfill the trench.

It will also be the Customer's responsibility to obtain and install:

1. Approved Duke Energy meter centers for the type of service indicated.
2. All secondary cable from the building to Duke Energy's designated point of service.

For further information regarding meter requirements, please contact your local Duke Energy Engineering Representative or visit our website:

https://www.duke-energy.com/_/media/pdfs/partner-with-us/construction-toolbox/white-book.pdf

It will be the responsibility of Duke Energy to provide, install and maintain all primary conductors, transformers, and other facilities necessary to provide service to the designated points of delivery as indicated on the drawing. We will also provide all necessary easement documents, invoice work authorization, and contracts for execution by the Customer.

In order for Duke Energy to proceed with the planning and detailed design of our system, it is necessary that the Customer provide Duke Energy with the following:

1. Payment of all charges.
2. Executed Service Proposal document and signed invoice.
3. Executed easement documents.

All terms and charges of this proposal are valid for 30 days from the date of this letter, after which time they are subject to change in accordance with our rates and tariffs as filed with the Florida Public Service Commission. Installation of our system will proceed relative to the scheduled and actual completion of the project. In the event that the installation of our system cannot be completed within 6 months of the date of this letter as a direct result of the progress of the entire project, that portion of our system which has not been installed may be subject to change in accordance with our filed rates and tariffs.

Please initial each page of this electric service proposal letter, sign the Agreement for Electric Service form and return the original forms to this office.

Customer Initials: _____



**AGREEMENT FOR ELECTRIC SERVICE
 BETWEEN
 DUKE ENERGY FLORIDA, INC. (the "UTILITY")
 AND
 ST. JOHN RIVER WATER DISTRICT (the "APPLICANT")**

WHEREAS, the Utility owns and operates an electric distribution system in ORANGE County, Florida, in which the Applicant owns a real property development to be known as ST. JOHN RIVER WATER MANAGEMENT (the "Development"), on which the Applicant has constructed or proposes to construct certain improvements; and

WHEREAS, the Utility desires to cooperate with the Applicant and to install an electric distribution system for the development as described in the Utility's electric service proposal dated December 10, 2021, including the various attachments specified therein, (the "Proposal"), which is incorporated herein and made a part hereof by this reference;

NOW, THEREFORE, in consideration of the premises and of the mutual agreements hereinafter set forth, the parties hereby agree as follows:

1. Upon compliance by the Applicant with all of the provisions of the Proposal, in a manner acceptable to the Utility, the Utility shall install, operate and maintain an electric distribution system consisting of facilities and related equipment for providing electric service in accordance with the Proposal. Facilities will be provided for single phase service only, except as otherwise indicated in the Proposal.
2. The Applicant agrees to the charge set forth in the Proposal to aid in the construction of the distribution system, which amount is to be paid before construction by the Utility commences.
3. In the event the Applicant makes or causes to be made, any changes in the distribution system in the Proposal, the Applicant agrees to pay the Utility all additional costs incurred by it as a result of such changes. The Applicant further agrees to pay the Utility for any damages to its equipment or facilities caused by the Applicant, its employees, agents, or sub-contractors.
4. The Applicant agrees to convey to the Utility, without cost, all easement rights, including ingress and egress, necessary and convenient to the Utility for the purpose of constructing, operating, maintaining, and removing the distribution system.
5. The Applicant shall provide service entrance facilities in accordance with the Proposal and the Rules and Regulations of the Utility, including the current published "Requirements for Electric Service and Meter Installations".
6. Nothing in this Agreement shall be construed to have the effect of vesting in the Applicant any right, title or interest in or to any distribution facilities, all of which shall be and remain the exclusive property of the Utility.
7. This Agreement is subject to the regulatory jurisdiction of the Florida Public Service Commission and the terms and charges hereof are contingent upon any applicable changes approved or directed by the Commission to the Rules and Regulations or the Rate Schedules contained in the Utility's tariff. No other changes to this agreement shall be effective unless agreed to in writing.
8. This agreement incorporates all prior agreements between the Applicant and the Utility concerning the Subject development and all other representations or understandings not set forth herein are superseded and ineffective.

_____ (Applicant)

 By: _____
 Title: _____
 Date: _____

DUKE ENERGY FLORIDA, INC.

 By: LATOYA JAMES
 Title: Engineering Technologist III
 Date: December 10, 2021



USP: Add Up Stream Protection, Facility ID, and Blocking Device Type
 USP: BREAKER M704
 USP:
 USP:
 USP:

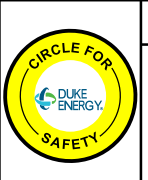

Safety Reminders / Adverse Conditions
 ?: ACTIVE WILD LIFE
 ?: NARROW ROAD
 ?:
 ?:



Work Zone General Comments: Double click to

REMEMBER: Work zone area conditions may have changed for this job! Everyone is responsible for verifying the above safety information is correct prior to any work being performed each day.

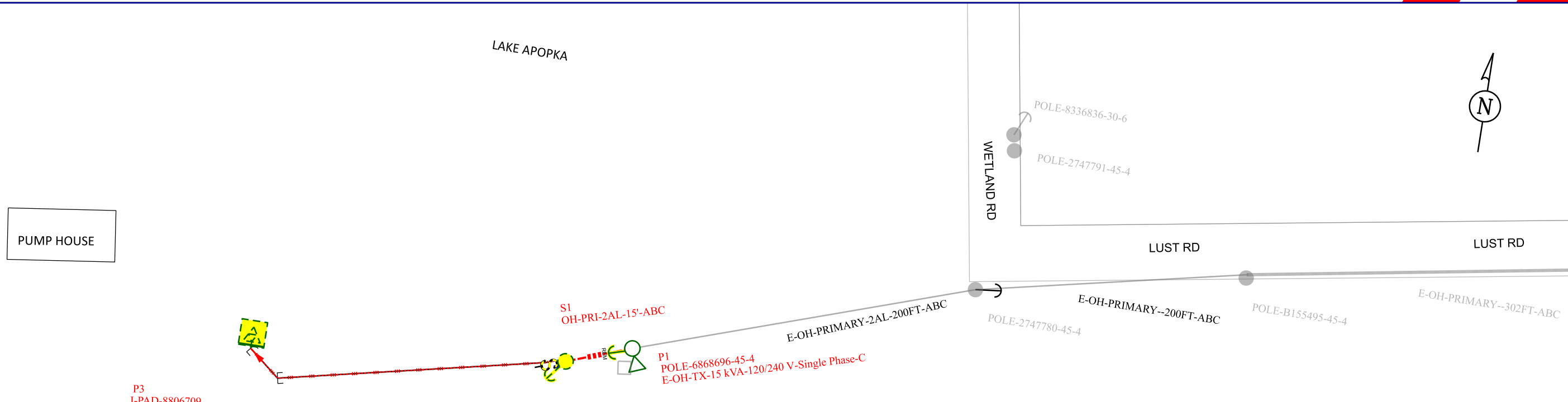

GUY STAMP (P2)

	FL	W	A	LL
A/B	7	3/8"	15	15
B/C	7	3/8"		
N	7	3/8"		

SCOPE:
 EXTEND PRIMARY OH 15FT TO NEW 45/4 POLE.
 FRAME NEW POLE AS TP AND RUN 1/0 PRIMARY
 UNDERGROUND TO 500KVA TRANSFORMER.
 DEVELOPER TO INSTALL 4" CONDUIT AND 3PH PAD

COMMERCIAL LOAD INFORMATION

P3 8806709 - ST JOHN RIVER MANAGEMENT

BUILDING SIZE=	N/A
MDP SIZE =	1000 A
VOLTAGE =	277/480V 3PH
KW DEMAND =	350
LARGEST MOTOR =	3 PUMPS AT 200HP
CT SIZE=	
BUSHING MOUNT =	TRANSFORMER

SERVICE CONDUCTORS: 1 SETS OF 3/0

Work Order Number	41079161
Customer/Contact	FLINT MCCAIN
Contact Phone	321-212-9329
Job Site Address	2771 LUST RD LIFT STATN DEAD END
City	APOPKA
County	ORANGE
State, Zip	FL, 32703
Designer	Latoya James
Designer Phone	407-236-3241
Circuit ID	M704
Primary Voltage	12.74/7.2
Permit Required	Yes _ No_ X
Permit Type/No.	
Permit Type/No. 2	
Permit Type/No. 3	
Permit Type/No. 4	