

**ADDENDUM ONE  
AGAWELA DRIVE INVASIVE PLANT MANAGEMENT  
CONTRACT NO. S-16-017  
CITY OF CHATTANOOGA, TENNESSEE**

The following changes shall be made to the Contract Documents, Specifications, and Drawings:

**I. Questions & Answers:**

1. **Question:** Since there are no aquatic plants on the list, will an aquatic herbicide license be needed?
  - i. **Answer:** No
2. **Question:** The RFP does not have Appendix A – Standard Agreement for Consulting Services and Appendix B – Site Maps. Can I have at least a copy of the site maps?
  - i. **Answer:** Reference to the Standard Agreement will be removed from the RFP document. The agreement will be sent to and filled out by the winning bidder. The two site maps that were left out of the RFP will be made available at the pre-bid meeting and then attached to the RFP.

**II. Pre-Bid Meeting Notes:**

1. **Question:** Section B (Methods) of the RFP states that plant material of any kind from an invasive species shall be hauled off site and disposed of at an approved location. Some of the allowed methods of treatment would leave the species to die standing in place. Would the contractor be responsible for eventually removing these?
  - i. **Answer:** Yes, unless the contractor can provide justification that leaving the trees standing would aid in the overall management of the site (e.g., carbon source after break down, shading out unwanted understory plants, etc.).
2. **Question:** Is *Microstegium* present?
  - i. **Answer:** We cannot say definitively, but it was not seen during previous City visits nor during the pre-bid walkthrough.
3. **Question:** How will the barrier between the Conservation Easement (treatment area for year 1) be differentiated from the Limits of Disturbance (LOD)?
  - i. **Answer:** The LOD is currently marked by the construction silt fencing that will be removed before beginning the project. However, due to the nature of the construction activity, the demarcation line between the LOD and CE is easily distinguished in the field, especially for year one of the project.
4. **Question:** What will be planted in the riparian area (i.e., LOD)?
  - i. **Answer:** The stream restoration landscape plans are attached to this addendum.

February 17, 2017

---

/s/ Justin Holland, Administrator  
City of Chattanooga  
Department of Public Works

## SIGN-IN SHEET

PROJECT: AGAWELA S-16-017 INVASIVE PLANT MGMT 2/15/17 10AM

NAME	COMPANY	PHONE	EMAIL
1 BENNIE MUMFORD	COC	643 6031	BENNIE@CHATTANOOGA.GOV
2 Lyn Rutherford	Water Quality CoC	<del>643</del> 643 5852	lrutherford@chattanooga.gov
3 JOSHUA ROGERS	CITY OF CHATT. - WQ	643-5813	jrogers@chattanooga.gov
4 JUSTIN BOLANDER	HOR	423-414-3559	justin.bolander@chattanooga.gov
5 LEE PATRICK	WR	615-812-5313	lee@ipc-inc.org
6 MO MUMFORD	WR	615, 643-5867	mumf@chattanooga.gov
7 Debbie Talley	COC	423-643-7230	dtalley@chattanooga.gov
8			
9			
10			
11			
12			
13			
14			
15			
16			
17			
18			
19			
20			
21			
22			



Substantial Improvement Line

### Legend

Bankfull\_Elevations

LOD\_CE\_Boundary

RefName

CE Limits

LOD

50' Buffer (from Bankfull)

Additional\_Management\_Areas



## Legend

Bankfull\_Elevations

**LOD\_CE\_Boundary**

**RefName**

CE Limits

LOD

50' Buffer (from Bankfull)

## FOUND INVASIVES - area

Bradford Pear - 1

Privet - 1,4

Honeysuckle Bush - 1,2

Honeysuckle Vine - 1

English Ivy - 1,4

Euonymous furtunii - 1,4

Multiflora Rose - 1

Mimosa - 1,2

Ailanthus (SMALL) - 4

Clematis - 1,2,3,4

Wisteria - 2,4

Kudzu - 3

Lespedeza - 2,3

Autumn Olive - 3

Oriental Bittersweet - 2,3

The black line roughly indicates the beginning of an older forest when facing downstream. The purple line is the "substantial improvement line" and is the northern project boundary.

Additional 1.75 acres outside of LOD that need to be managed. Some of this is also outside of the CE, but is intended to lessen the competition for the new natives. The managed area is to include invasive removal and additional plantings as needed.



CREATED: 2/1/2016 LAST SAVED: 2/5/2016 BY: SWALZ PLOT DATE: 01/08/2014

NOTES:

- 1.) ZONE 4 VEGETATION TO COMPLY WITH SEEDING SCHEDULE AS DETAILED BELOW UNLESS OTHERWISE NOTED. CONTRACTOR TO MATCH PERMANENT SEEDING WITH EXISTING VEGETATION WHERE POSSIBLE. DISTURBED PUBLIC RIGHT-OF-WAYS TO BE SEEDED AS ZONE 4.
- 2.) APPLY GROUND LIMESTONE AT THE RATE OF 75 LB./1000 SF. OR AS REQUIRED BY SOIL TEST AS SPECIFIED IN SPECIAL PROVISIONS.
- 3.) APPLY 10-10-10 (N-P-K) COMMERCIAL FERTILIZER AT THE RATE OF 20 LB./1000 SF. OR AS REQUIRED BY SOIL TEST AS SPECIFIED IN SPECIAL PROVISIONS.
- 4.) MULCH WITH STRAW APPLIED AT THE RATE OF 75-100 LB./1000 SF.
- 5.) HEAVILY MULCHED DURING JANUARY - MARCH PERIOD.
- 6.) RESEED & MULCH AREAS WHERE SEED EMERGENCE IS POOR OR WHERE EROSION OCCURS.

TEMPORARY SEEDING SCHEDULE		
DATE	SEEDING	PLANTING RATE
FEB. 1 - MAY 1	RYE	120 LB./AC
MAY 1 - AUG. 15	OATS BROWN TOP MILLET	60 LB./AC 30 LB./AC
AUG. 15 - FEB. 1	OATS WINTER WHEAT	30 LB./AC 30 LB./AC

Zone 1 -Stream Banks - Edge of Water to Top of Bank

Botanical Name	Common Name	Indicator Status	Form	Spacing	Quantity	Total
<i>Alnus serrulata</i>	Tag alder	FACW	live stake	2.0' O.C, triangular	1,200	4,800
<i>Cornus amomum</i>	Silky dogwood	FACW	live stake	2.0' O.C, triangular	1,200	
<i>Salix sericea</i>	Silky willow	OBL	live stake	2.0' O.C, triangular	1,200	
<i>Sambucus canadensis</i>	Elderberry	OBL	live stake	2.0' O.C, triangular	1,200	

\* Also apply riparian seed mix to this Zone prior to installing erosion control material

Planting Zones

Zone	Description	Total Area (Acres)
1	Stream Bank	0.44
2	Riparian Area	0.59
3	Riparian Area - Uplands	1.61
4	Sanitary Sewer Easement	0.31

Zone 2 - Riparian Area

Botanical Name	Common Name	Indicator Status	Form	Spacing	Quantity	Total
Trees/Overstory						
<i>Acer rubrum</i>	Red maple	FACW	ball and burlap	30' O.C., random	5	175
<i>Betula nigra</i>	River birch	FACW	ball and burlap	30' O.C., random	5	
<i>Betula nigra</i>	River birch	FACW	3 gallon container	12' O.C., random	30	
<i>Fraxinus pennsylvanica</i>	Green ash	FACW	ball and burlap	30' O.C., random	5	
<i>Fraxinus pennsylvanica</i>	Green ash	FACW	3 gallon container	12' O.C., random	30	
<i>Juglans nigra</i>	Black walnut	FACU	ball and burlap	30' O.C., random	5	
<i>Juglans nigra</i>	Black walnut	FACU	3 gallon container	12' O.C., random	30	
<i>Platanus occidentalis</i>	Sycamore	FACW	ball and burlap	30' O.C., random	5	
<i>Platanus occidentalis</i>	Sycamore	FACW	3 gallon container	12' O.C., random	30	
<i>Ulmus americana</i>	American elm	FACW	3 gallon container	12' O.C., random	30	
Shrubs/Understory						
<i>Alnus serrulata</i>	Tag alder	FACW	3 gallon container	8' O.C., random	70	420
<i>Cephalanthus occidentalis</i>	Buttonbush	FACW	3 gallon container	8' O.C., random	70	
<i>Cornus amomum</i>	Silky dogwood	FACW	3 gallon container	8' O.C., random	70	
<i>Ilex decidua</i>	Possumhaw	FACW	3 gallon container	8' O.C., random	70	
<i>Lindera benzoin</i>	Spicebush	FAC	3 gallon container	8' O.C., random	70	
<i>Viburnum dentatum</i>	Southern arrowwood	FAC	3 gallon container	8' O.C., random	70	

\* Also apply riparian seed mix to this Zone prior to installing erosion control material

Zone 3 - Riparian Area

Botanical Name	Common Name	Indicator Status	Form	Spacing	Quantity	Total
Trees/Overstory						
<i>Acer saccharinum</i>	Silver maple	FACW	ball and burlap	30' O.C., random	10	550
<i>Acer saccharinum</i>	Silver maple	FACW	3 gallon container	12' O.C., random	100	
<i>Fraxinus pennsylvanica</i>	Green ash	FACW	ball and burlap	30' O.C., random	10	
<i>Fraxinus pennsylvanica</i>	Green ash	FACW	3 gallon container	12' O.C., random	100	
<i>Juglans nigra</i>	Black walnut	FACU	ball and burlap	30' O.C., random	10	
<i>Juglans nigra</i>	Black walnut	FACU	3 gallon container	12' O.C., random	100	
<i>Quercus nigra</i>	Water oak	FAC	ball and burlap	30' O.C., random	10	
<i>Quercus nigra</i>	Water oak	FAC	3 gallon container	12' O.C., random	100	
<i>Quercus phellos</i>	Willow oak	FACW	ball and burlap	30' O.C., random	10	
<i>Quercus phellos</i>	Willow oak	FACW	3 gallon container	12' O.C., random	100	
Shrubs/Understory						
<i>Callicarpa ammericana</i>	American beautyberry	FACU	3 gallon container	8' O.C., random	300	1200
<i>Carpinus caroliniana</i>	Ironwood	FAC	3 gallon container	8' O.C., random	300	
<i>Cornus florida</i>	Flowering dogwood	FACU	3 gallon container	8' O.C., random	300	
<i>Hamamelis virginiana</i>	Witch hazel	FACU	3 gallon container	8' O.C., random	300	

\* Also apply riparian seed mix to disturbed areas within Zone 3

Zone 2 & 3 - Riparian Seed Mix (Ernst GA Ridge & Valley Mix (ERNMX-511) (20 lbs/acre)

Botanical Name	Common Name	Indicator Status	Form	% of mix
<i>Chasmanthium latifolium</i>	River Oats	FACU	seed	23
<i>Panicum anceps</i>	Beaked Panicgrass	FACW	seed	20
<i>Elymus virginicus</i>	Virginia Wildrye	FACW	seed	20
<i>Panicum rigidulum</i>	Redtop Panicgrass	FACW	seed	20
<i>Panicum virgatum</i>	Switchgrass	FAC	seed	15
<i>Agrostis hyemalis</i>	Winter Bentgrass	FAC	seed	2

\* Ideal seeding period is January through March

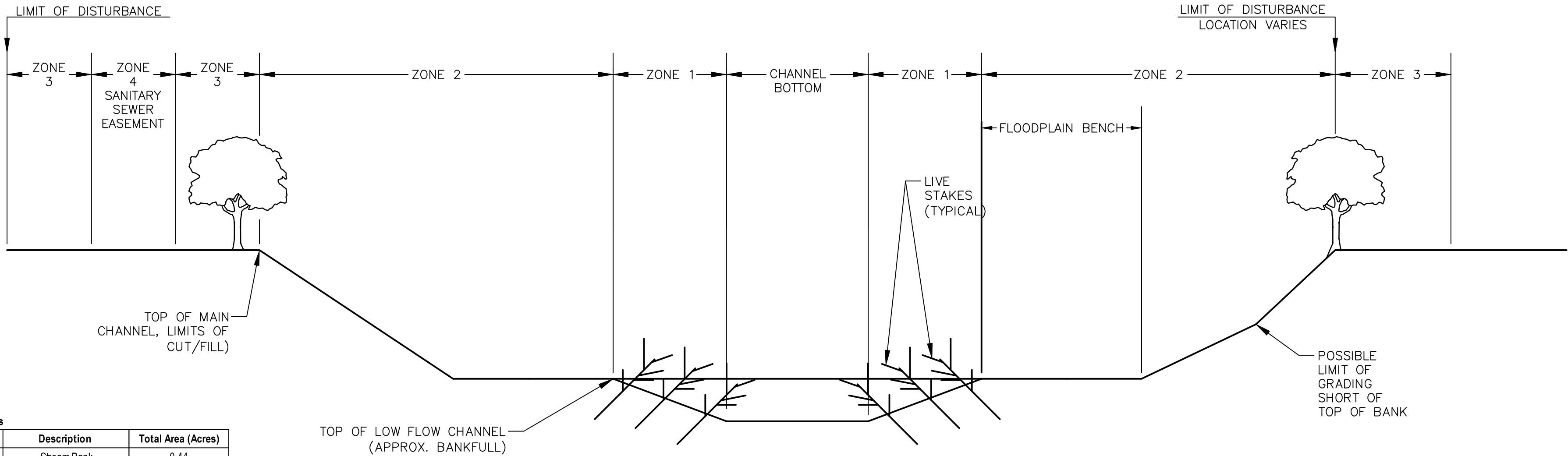

TYPICAL PLANTING DETAIL

NOT TO SCALE

FOR

1201 MARKET STREET  
CHATTANOOGA, TN 37402  
(423)-414-3551



AGAWELA DRIVE  
STREAM RESTORATION PROJECT  
CITY OF CHATTANOOGA, TN  
CONSENT DECREE PROGRAM

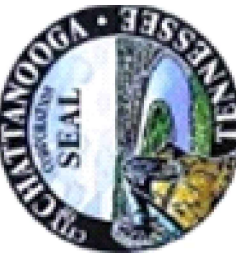

REV	DATE	REVISION DESCRIPTION
A	02/05/2016	ISSUED FOR EID

THIS LINE IS ONE INCH LONG WHEN PLOTTED FULL SCALE

THIS DRAWING MUST BE USED IN CONJUNCTION WITH THE APPLICABLE OR GOVERNING TECHNICAL SPECIFICATIONS AND OTHER CONTRACT DOCUMENTS.

PROJ #: COC-W-12-018-201 HDR:202729-0214

DATE: FEBRUARY 5, 2016

DISC. LEAD: JB DESIGNER: JR CHECKER: RG

SHEET TITLE

CIVIL

PLANTING DETAILS AND NOTES

SHEET 00L-101



CREATED: 1/8/2014 LAST SAVED: 2/5/2016 BY: SWALZ PLOT DATE: 01/08/2014

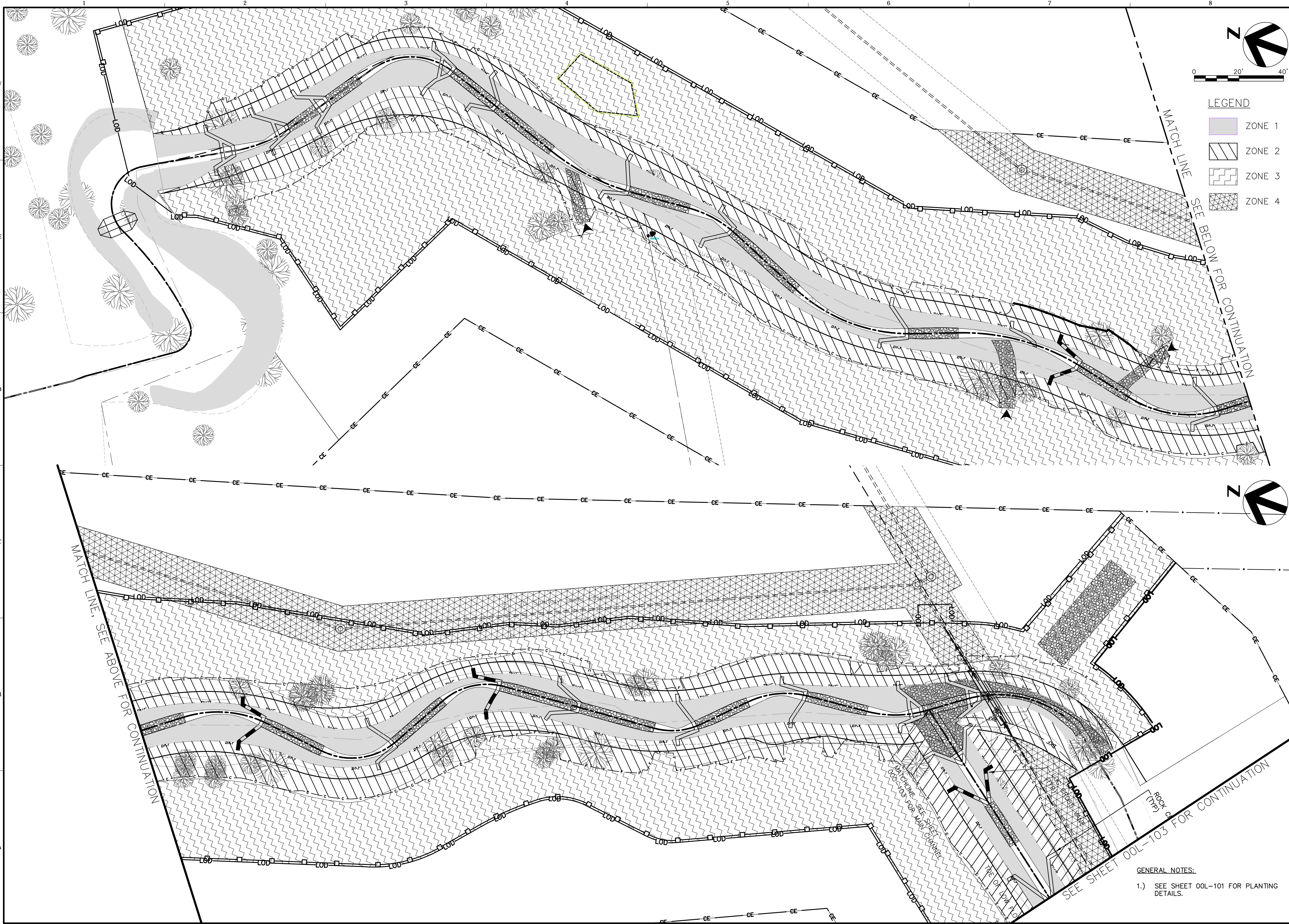

LEGEND

- ZONE 1
- ZONE 2
- ZONE 3
- ZONE 4

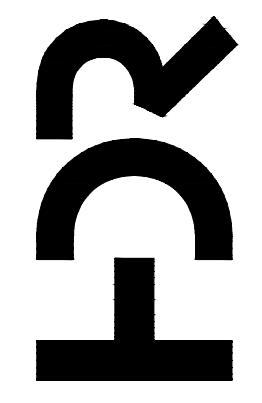

1201 MARKET STREET  
CHATTANOOGA, TN 37402  
(423) 414-3551



AGAWELA DRIVE  
STREAM RESTORATION PROJECT  
CITY OF CHATTANOOGA, TN  
CONSENT DECREE PROGRAM

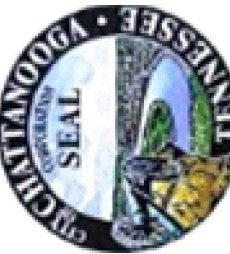

REV	DATE	REVISION DESCRIPTION
A	02/05/2016	ISSUED FOR BID

THIS LINE IS ONE INCH LONG WHEN PLOTTED FULL SCALE.		
THIS DRAWING MUST BE USED IN CONJUNCTION WITH THE APPLICABLE OR GOVERNING TECHNICAL SPECIFICATIONS AND OTHER CONTRACT DOCUMENTS.		
PROJ #:	COC-W-12-018-201 HDR:202729-0214	
DATE:	FEBRUARY 5, 2016	
DISC. LEAD:	DESIGNER:	CHECKER:
JB	JR	RG
SHEET TITLE		
CIVIL		
PLANTING PLAN		
SHEET	00L-102	

GENERAL NOTES:

- SEE SHEET 00L-101 FOR PLANTING DETAILS.



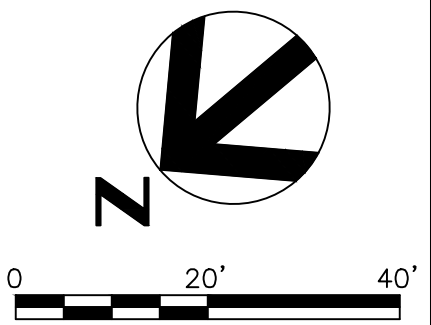
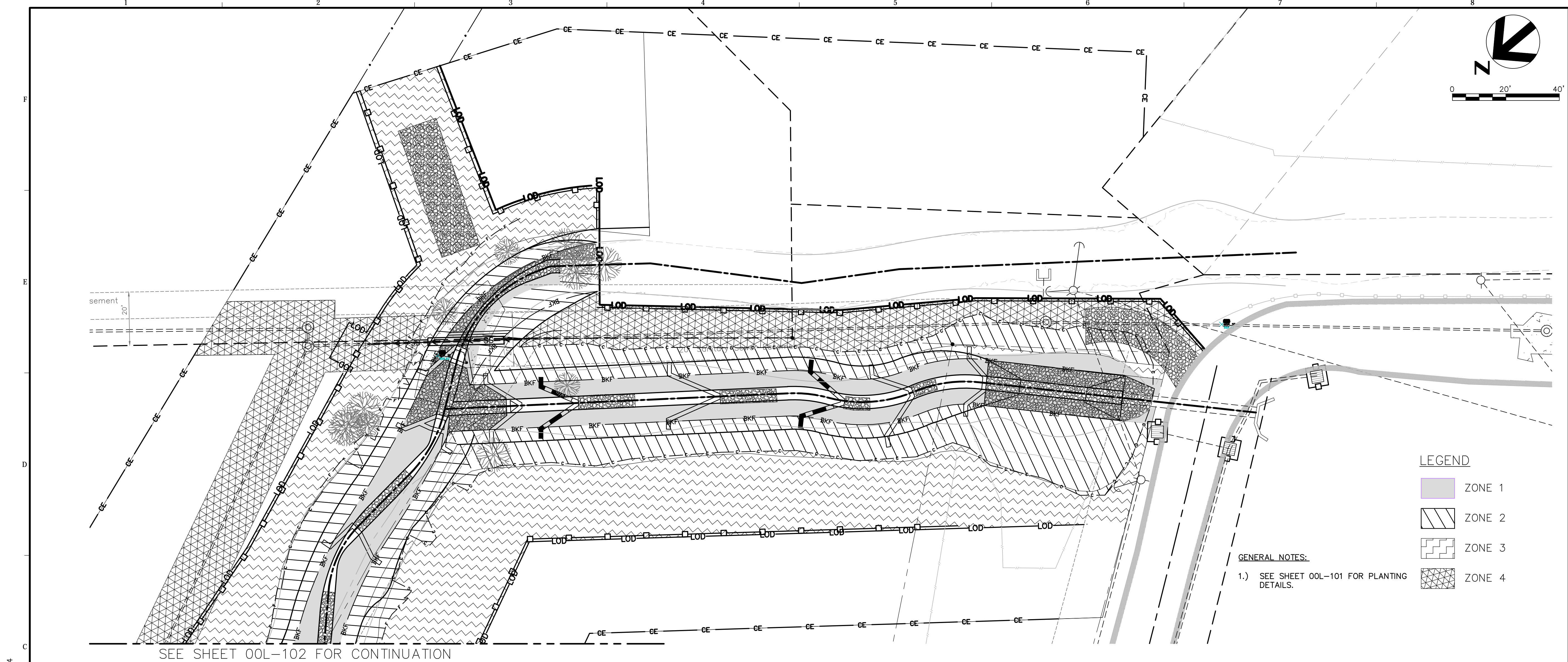

- LEGEND
- ZONE 1
  - ZONE 2
  - ZONE 3
  - ZONE 4

GENERAL NOTES:  
1.) SEE SHEET 00L-101 FOR PLANTING DETAILS.

HDR

1201 MARKET STREET  
CHATTANOOGA, TN 37402  
(423) 414-3551



AGAWELA DRIVE  
STREAM RESTORATION PROJECT  
CITY OF CHATTANOOGA, TN  
CONSENT DECREE PROGRAM

REV	DATE	REVISION DESCRIPTION
A	02/05/2016	ISSUED FOR BID

THIS LINE IS ONE INCH LONG WHEN PLOTTED FULL SCALE

THIS DRAWING MUST BE USED IN CONJUNCTION WITH THE APPLICABLE OR GOVERNING TECHNICAL SPECIFICATIONS AND OTHER CONTRACT DOCUMENTS.

PROJ #:COC-W-12-018-201HDR:202729-0214

DATE:FEBRUARY 5, 2016

DISC. LEAD:JBDESIGNER:JRCHECKER:RG

SHEET TITLE

CIVIL

PLANTING PLAN

SHEET00L-103