



MARCH ADAMS & ASSOCIATES, INC.

P.O. Box 3689 · Chattanooga, TN 37404
Ph: (423) 698-6675
Fax: (423) 698-3638
marchadams@marchadams.com

PROJECT: 23-26- Sequoyah Bus Parking
Bid Date 3-28-2023 at 3pm

PROJECT NO. 21330

Narrative For Addendum #2

PREPARED BY: Joseph
Parks & Gary Ellis

DATE: 3-23-2023

The following amendments to the specifications and/or revisions to the drawing shall be considered part of the contract, and shall replace documents by the same name.

General Documents

See attached response to bidder questions.

Question: *there is a 400 amp panel on the addendum; however, the plans are calling for a 3" conduit and 250 aluminum wire, and this will not work for a 400 amp service. How should contractors price?*

Response: *See revised electrical drawings below.*

Question: *Is it the responsibility of the electrical contractor to provide Panel "A" and "B" that are mounted on the trailer? There are no panel schedules or size indication for these panels. Or will this come with the trailer and only need to be terminated*

Response: The electrical panel A and B will be provided by owner. See revised electrical key notes.

The following documents have been revised to address bidder questions:

SHEET ES101

1. Revised electrical key notes

SHEET ES102

1. Revised panel diagram

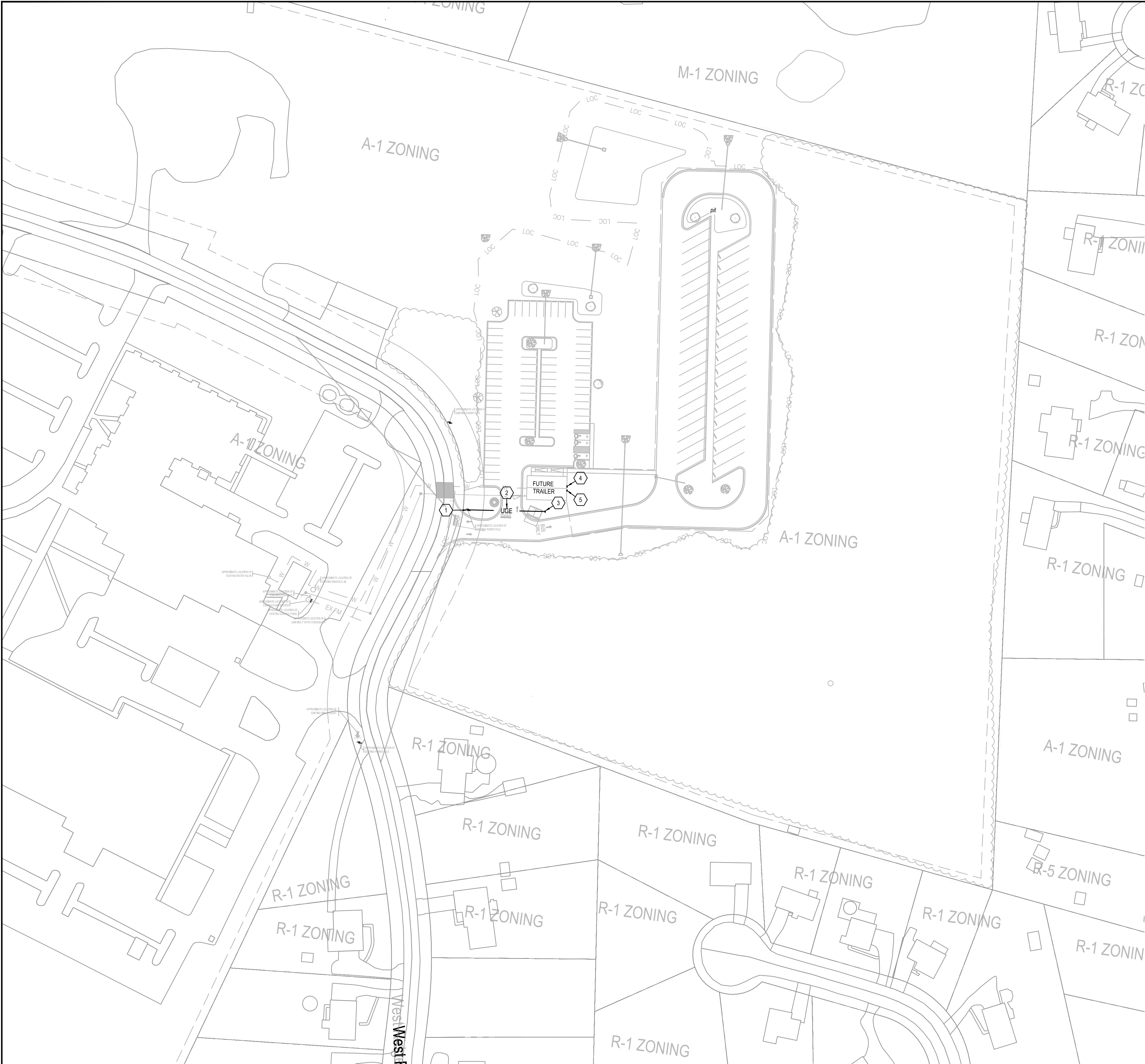

1
ES1.1
ELECTRICAL SITE PLAN
SCALE: 1"=60'-0"

GENERAL SITE NOTES

- ALL CONDUCTOR SIZES SHOWN ARE BASED ON THE NEC AMPACITIES OF COPPER CONDUCTORS, TYPE THW UNLESS OTHERWISE NOTED. SECONDARY CONDUCTORS TO MAIN ARE ALUMINUM.
- ALL UNDERGROUND WIRING IS TO BE INSTALLED IN SCHEDULE 40 PVC CONDUIT PER THE WRITTEN SPECIFICATIONS. RIGID STEEL ELBOWS ARE TO BE USED ON THE CONDUIT WHEREVER IT TURNS UP AND EXITS THE GROUND.
- THE CONTRACTOR SHALL SUPPLY A SEPARATE GREEN INSULATED GROUND WIRE IN ALL RUNS OF PVC CONDUIT, WHETHER SHOWN ON THE DRAWINGS OR NOT.
- THE ELECTRICAL CONTRACTOR IS RESPONSIBLE FOR SUPPLYING ALL CONCRETE AND RELATED WORK FOR ALL POLE BASES, TRANSFORMER PADS, ETC., WHICH ARE IN HIS SCOPE OF WORK.
- THE ELECTRICAL CONTRACTOR IS RESPONSIBLE FOR PROVISION OF ELECTRICAL WIRING AND ASSOCIATED EQUIPMENT REQUIRED TO PROVIDE SERVICE TO ALL PYLON SIGNS.
- ALL WORK IS TO COMPLY WITH THE LATEST VERSION OF THE NEC AND ALL APPLICABLE STATE, LOCAL, AND MUNICIPAL CODES.
- THE ELECTRICAL CONTRACTOR IS TO COORDINATE ALL OF HIS WORK WITH ALL OF THE OTHER DISCIPLINES AND TRADES. WATER, SEWER, STORM DRAINAGE, ETC., ROUTING TAKE PRECEDENCE OVER THE ELECTRICAL WIRE AND CONDUIT ROUTING. THE ELECTRICAL CONTRACTOR IS TO RELOCATE OR REROUTE AS REQUIRED TO CLEAR SUCH.
- COORDINATE ALL SITE WORK WITH CIVIL DRAWINGS.

UTILITY SUPPLY NOTES

- ALL UTILITY SERVICES SHOWN ARE FOR SCHEMATIC REPRESENTATION ONLY. NO EXPRESSED OR IMPLIED GUARANTEE IS GIVEN AS TO THE EXACT LOCATION, GRADE OR ELEVATION OF THE ABOVE MENTIONED ITEMS. ACTUAL LOCATIONS ARE TO BE BASED ON UTILITY COMPANY AND OWNER INSTRUCTIONS.
- THE CONTRACTOR IS RESPONSIBLE FOR ALL COST ASSOCIATED WITH THE SECONDARY SERVICES AND METER INSTALLATION FEES. ANY POWER CO. AID TO CONSTRUCTION COST TO BE PAID BY THE OWNER.
- BECAUSE OF ALL OF THE ABOVE REASONS, ALL ELECTRICAL CONTRACTORS DESIRING TO BID ON THIS PROJECT ARE REQUIRED TO VISIT THE JOB SITE PRIOR TO BIDDING SO THAT THEY MAY BECOME FAMILIAR WITH ALL CIRCUMSTANCES WHICH WILL AFFECT THE ELECTRICAL WORK.
- CONTRACTOR SHALL INCLUDE OVERTIME AND AFTER HOURS PREMIUM LABOR CHANGES IN HIS BID AS REQUIRED TO COMPLETE THE INSTALLATION OF THIS PROJECT IN ACCORDANCE PROJECT IN ACCORDANCE WITH THE ARCHITECTS SCHEDULE.
- ALL ELECTRICAL CONTRACTORS ARE REQUIRED TO VISIT THE JOB SITE PRIOR TO BID AND TO INCLUDE ALL REQUIRED COST TO PROVIDE A COMPLETE, FUNCTIONAL AND CODE COMPLIANT ELECTRICAL INSTALLATION.
- COORDINATE SERVICE PROVISIONS FOR TELEPHONE, CATV AND POWER FOR UNDERGROUND SERVICE TO BUILDING.
- OWNER WILL BE RESPONSIBLE FOR AID TO CONSTRUCTION UTILITY COST FOR PROVISION OF SERVICE TO THIS BUILDING.
- ALL REQUIRED 90° ELBOWS OF UTILITY CONDUITS TO BE OF SWEEPING TYPE.
- THE CONTRACTOR IS RESPONSIBLE FOR ALL COST ASSOCIATED WITH TEMPORARY POWER, BE IT 10 OR 30, AS REQUIRED FOR THIS PROJECT.

ELECTRICAL KEYED NOTES

- EXISTING POWER POLE. POWER CO. TO SET NEW AERIAL TRANSFORMER BANK FOR NEW ELECTRICAL SERVICE. POWER CO. TO REPLACE POLE AS REQUIRED.
- UNDERGROUND ELECTRICAL SECONDARY FROM POLE TO METER & PANEL. INCLUDE AN EMPTY 2" (WITH PULL ROPE) FROM POWER POLE TO STUB NEAR FUTURE TRAILER FOR COMMUNICATIONS.
- METER & PANEL "M" ON PIPE & STRUT RACK. SEE RISER DIAGRAM.
- PANEL "A" LOCATED ON FUTURE BUILDING. FIELD LOCATE PANEL AFTER BUILDING IS INSTALLED. LAND WIRING ON LUGS IN PANEL. REFER TO RISER FOR WIRE SIZE. PANEL IS PROVIDED WITH THE BUILDING. THE ELECTRICAL CONTRACTOR IS TO WIRE TO PANEL.
- PANEL "B" LOCATED ON FUTURE BUILDING. FIELD LOCATE PANEL AFTER BUILDING IS INSTALLED. LAND WIRING ON LUGS IN PANEL. REFER TO RISER FOR WIRE SIZE. PANEL IS PROVIDED WITH THE BUILDING. THE ELECTRICAL CONTRACTOR IS TO WIRE TO PANEL.

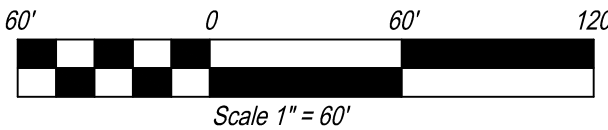
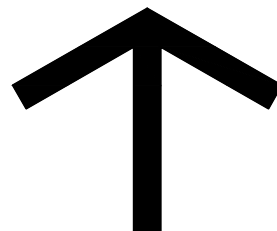

REVISIONS		03/17/23	03/24/23
1	ADDENDUM #1		
2	ADDENDUM #2		
3			
4			
5			
6			
7			
8			
9			
10			
11			

HCDE Bus Barn

at
9517 W Ridge Trail Road

for

HAMILTON CO
DEPT. EDUCATION

3074 Hickory Valley Rd
Chattanooga, TN 37421
423-498-7020



March Adams &
Associates
Consulting Engineers

310 Dodds Ave.
P.O. Box 3689
Chattanooga, Tennessee 37404
PH: (423)698-6675

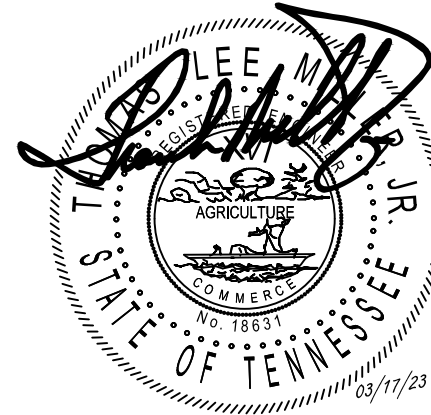

DRAWN:	AE
CHECKED:	JP
JOB No.	21330
DATE:	03/03/2023

ES101

ELECTRICAL SITE
PLAN

