

STATE	COUNTY	FILE NO.	PROJECT NO.	ROUTE NO.	SHEET NO.
SC	BEAUFORT			SC-170	1

SHEET INDEX

SHEET NO.	DESCRIPTION	SHEET TOTALS
1	TITLE SHEET	1
2	SUMMARY OF ESTIMATED QUANTITIES	1
3	TYPICAL SECTION	1
3A	DETAIL SHEET	1
4	RIGHT OF WAY DATA SHEET	1
5	GENERAL NOTES	1
5A	REFERENCE DATA SHEET	1
6	PLAN SHEET	1
EC1	EROSION CONTROL DATA SHEET	1
D1	DRAINAGE & EROSION CONTROL SHEET	1
LL1-LL6	LIGHTING SHEET	6
LA1	LANDSCAPING SHEET	1
X1-X2	CROSS SECTIONS	2
TOTAL		19

CITY OF BEAUFORT



PLAN AND PROFILE OF SC-170 SIDEWALK EXTENSION

FROM: ROBERT SMALLS PKWY (SC-170)
TO: SPANISH MOSS TRAIL

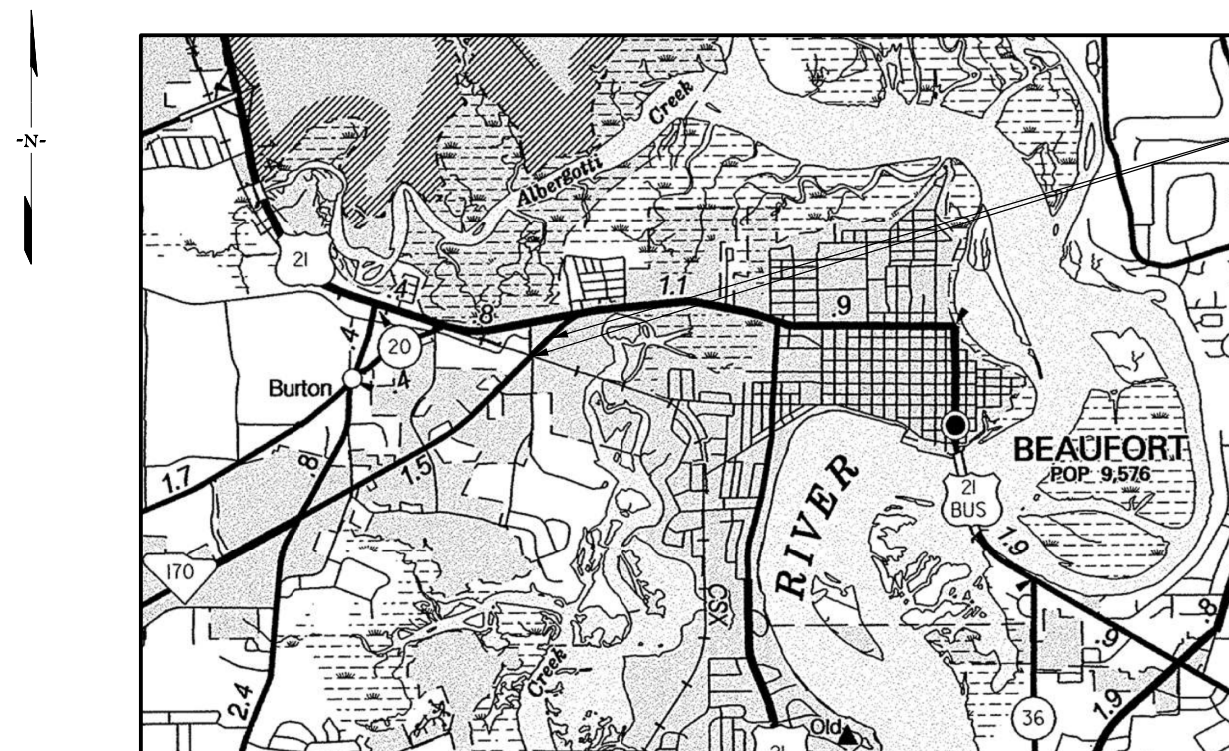

ROBERT SMALLS PKWY (SC-170)
BEGIN CONSTRUCTION
STA. 10+33.13
END CONSTRUCTION
STA. 16+26.39

NPDES PERMIT INFORMATION	
Disturbed Area = <u>0.125</u> Acre(s)	
Approximate Location of Roadway is	
Begin	
Latitude	<u>32°26'15" N</u>
Longitude	<u>80°42'27" W</u>
End	
Latitude	<u>32°26'19" N</u>
Longitude	<u>80°42'23" W</u>
Hydraulic and NPDES Design provided by:	
<u>I.C.E.</u>	
Designs may be obtained from the SCDOT Regional Production Group	

THE INITIALS ABOVE DO NOT RELIEVE THE ENGINEER OF RECORD OF THE RESPONSIBILITY TO DESIGN THIS PROJECT IN ACCORDANCE WITH ALL APPLICABLE CRITERIA.

	SCDOT REVIEW		RIGHT-OF-WAY		CONSTRUCTION	
	INITIAL	DATE	INITIAL	DATE	INITIAL	DATE
PRECONSTRUCTION SUPPORT - ROAD						
PRECONSTRUCTION SUPPORT - STRUCTURES						
RPG - DESIGN MANAGER						
RPG - PROGRAM MANAGER						

THE INITIALS ABOVE DO NOT RELIEVE THE ENGINEER OF RECORD OF THE RESPONSIBILITY TO DESIGN THIS PROJECT IN ACCORDANCE WITH ALL APPLICABLE CRITERIA.

For Right Of Way Acquisition:

Date
Consultant Engineer of Record

Hydraulic Design Reference for these plans is the:
2009
Edition of SCDOT's "Requirements for Hydraulic Design Studies"

Design Reference for these plans is the:
2011
AASHTO "A Policy on Geometric Design of Highways and Streets"

**3 DAYS BEFORE DIGGING IN
SOUTH CAROLINA**
CALL 811
SOUTH CAROLINA 811 (SC811)
WWW.SC811.COM
ALL UTILITIES MAY NOT BE A MEMBER OF SC811

RAILROAD INVOLVEMENT?
YES NO

	SC - 170	TOTAL (MILES)
NET LENGTH OF ROADWAY	0.11	0.11
NET LENGTH OF BRIDGES	-	-
NET LENGTH OF PROJECT	0.11	0.11
LENGTH OF EXCEPTIONS	-	-
GROSS LENGTH OF PROJECT	0.11	0.11

EQUALITIES IN STATIONING:
NONE

NOTE: EXCEPT AS MAY OTHERWISE BE SPECIFIED ON THE PLANS OR IN THE SPECIAL PROVISIONS, ALL MATERIALS AND WORKMANSHIP ON THIS PROJECT SHALL TO CONFORM WITH SOUTH CAROLINA DEPARTMENT OF TRANSPORTATION STANDARD SPECIFICATIONS FOR HIGHWAY CONSTRUCTION (2007 EDITION) AND STANDARD DRAWINGS FOR ROAD CONSTRUCTION IN EFFECT AT THE TIME OF LETTING.

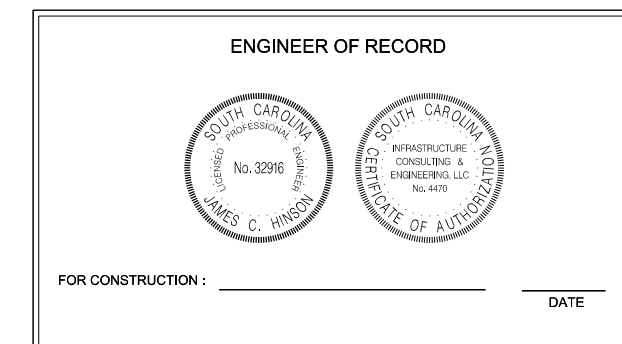
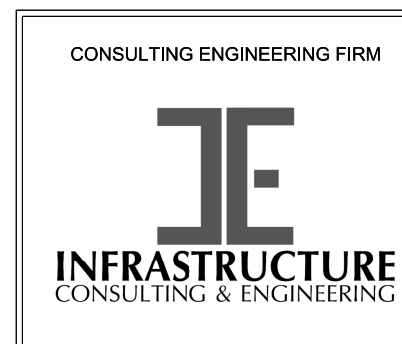

FOR CONSTRUCTION : _____ DATE _____

SUMMARY OF ESTIMATED QUANTITIES

PAYITEM	DESCRIPTION	QUANTITY	UNIT
1031000	MOBILIZATION	1.00	LS
1032010	BONDS AND INSURANCE	1.00	LS
1050800	CONSTRUCTION STAKES, LINES & GRADES	1.00	EA
1071000	TRAFFIC CONTROL	1.00	LS
2012000	CLEARING & GRUBBING WITHIN ROADWAY	1.00	LS
2021010	REMOVAL & DISPOSAL OF EXISTING DROP INLET	1.00	EA
2024100	REMOVAL & DISPOSAL OF EXISTING CURB	265.00	LF
2027000	REMOVAL & DISPOSAL OF EXISTING CONCRETE	360.00	SY
2031000	UNCLASSIFIED EXCAVATION	20.00	CY
2033000	BORROW EXCAVATION	90.00	CY
3100320	HOT MIX ASPHALT BASE COURSE - TYPE B	40.00	TN
4011004	LIQUID ASPHALT BINDER PG 64-22	5.90	TN
4030340	HOT MIX ASPHALT SURFACE COURSE - TYPE C	65.00	TN
6271015	8" WHITE SOLID LINES THERMOPLASTIC - 125 MIL.	236.00	LF
6271025	24" WHITE SOLID LINES THERMOPLASTIC - 125 MIL.	46.00	LF
6271074	4" YELLOW SOLID LINES(PVT.EDGE LINES) THERMO-90 MIL.	32.00	LF
6020005	PERMANENT CONSTRUCTION SIGNS (GROUND MOUNTED) SCHEME D	100.00	SF
6651091	SINGLE DECORATIVE LIGHT POLE WITH SINGLE LIGHT	3.00	EA
675027Y	FURNISH & INSTALL 4.0" SCHD 80 PVC CONDUIT(DIRECTION BORED)	120.00	LF
6760020	2" SCHEDULE 80 PVC CONDUIT	540.00	LF
6770319	#8Cu,1,600V,RHH,RHW,USE	1690.00	LF
6800530	17X30X28D.ELEC.UNGRD.ENCLOS/HD	2.00	EA
6888110	INSTALL STREET LIGHT LUMINAIRE	4.00	EA
7191605	CATCH BASIN -TYPE 16	1.00	EA
7198320	JUNCTION BOX - CONVERT DROP INLET 24" X 36"	2.00	EA
7198392	JUNCTION BOX - CONVERT CB T-16	1.00	EA
7203110	CONCRETE CURB AND GUTTER(1'-6") VERTICAL FACE	190.00	LF
7204100	CONCRETE SIDEWALK(4" UNIFORM)	358.00	SY
7209000	PEDESTRIAN RAMP CONSTRUCTION	43.00	SY
8100100	PERMANENT COVER	0.08	ACRE
8100200	TEMPORARY COVER	0.08	ACRE
8104005	FERTILIZER (NITROGEN)	8.00	LB
8104010	FERTILIZER (PHOSPHORIC ACID)	8.00	LB
8104015	FERTILIZER (POTASH)	8.00	LB
8105005	AGRICULTURAL GRANULAR LIME	160.00	LB
8110001	LANDSCAPING	1.00	LS
8151203	HYDRAULIC EROSION CONTROL PRODUCT (HECP) - TYPE 3	0.05	ACRE
8153000	SILT FENCE	400.00	LF
8153090	REPLACE/REPAIR SILT FENCE	40.00	LF
8154050	REMOVAL OF SILT RETAINED BY SILT FENCE	100.00	LF

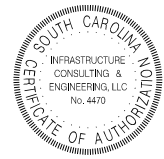
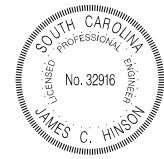

4			
3			
2			
1			
REV. NO.	BY	DATE	DESCRIPTION OF REVISION
DESIGNED BY:	TKC	DATE	
DRAWN BY:	TKC	DATE	
CHECKED BY:	JCH	DATE	

BEAUFORT COUNTY
CITY OF BEAUFORT

ROBERT SMALLS PKWY (SC-170)
SUMMARY OF ESTIMATED QUANTITIES

SHEET 2 SCALE: NTS

TYPICAL SECTIONS

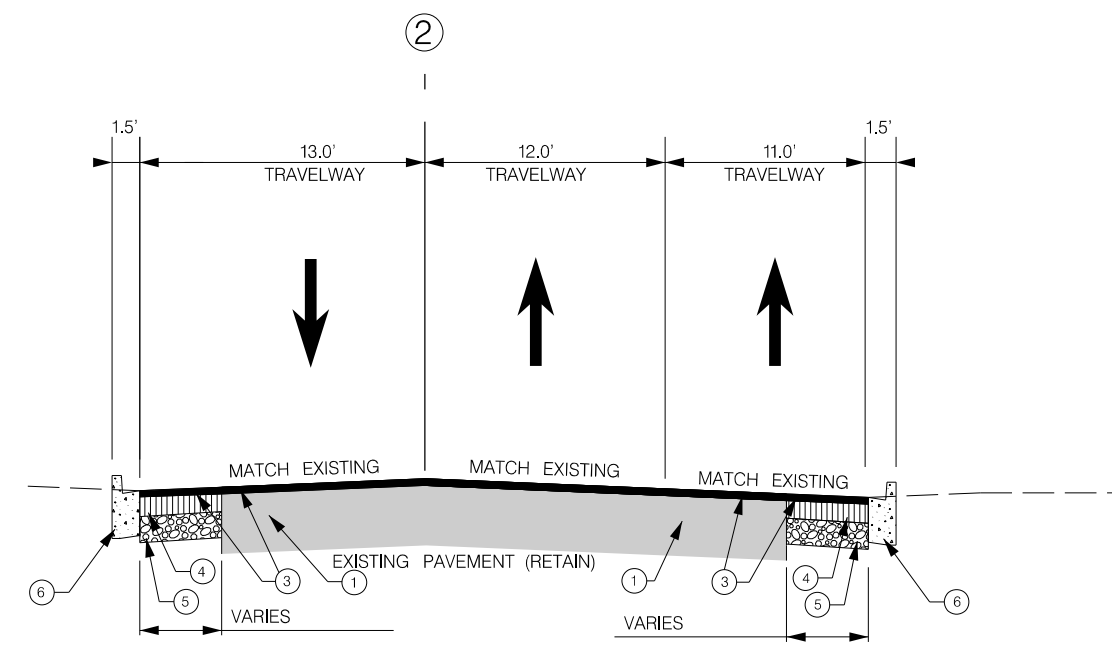
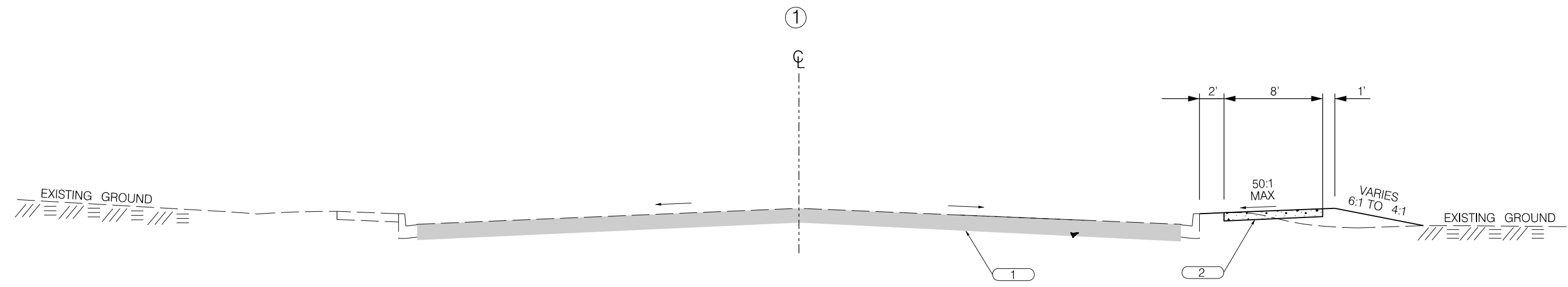

USE THIS SECTION ON EXISTING DRIVEWAYS

- | | | |
|---|--|---|
| 1 | | EXISTING PAVEMENT - RETAIN |
| 2 | | CONCRETE SIDEWALK (4" UNIFORM) |
| 3 | | HOT MIX ASPHALT SURFACE COURSE - TYPE C (175 PSY) |
| 4 | | HOT MIX ASPHALT SURFACE COURSE - TYPE C (175 PSY) |
| 5 | | HOT MIX ASPHALT BASE COURSE - TYPE B (450 PSY) |
| 6 | | CONCRETE CURB & GUTTER 1'-6" |

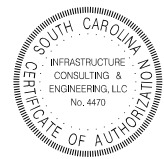
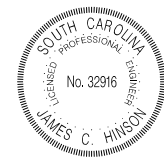

4			
3			
2			
1			
REV. NO.	BY	DATE	DESCRIPTION OF REVISION
DESIGNED BY:	TKC	DATE	
DRAWN BY:	TKC	DATE	
CHECKED BY:	JCH	DATE	

BEAUFORT COUNTY
CITY OF BEAUFORT

ROBERT SMALLS PARKWAY (SC-170)
TYPICAL SECTIONS

SHEET 3 SCALE:

REFERENCES

NATIONAL DOCUMENTS
 REVISED DRAFT GUIDELINES FOR ACCESSIBLE PUBLIC RIGHTS-OF-WAY NOVEMBER, 2005.
 MUTCD 2009

SCDOT DOCUMENTS
 SCDOT TRANSITION PLAN
 QPL 61

RELATED DRAWINGS & KEYWORDS

THIS DRAWING IS ONLY VALID FOR CONSTRUCTION WHEN SEALED AND SIGNED BY A PROFESSIONAL ENGINEER REGISTERED IN THE STATE OF SOUTH CAROLINA. CHECK WWW.SCDOT.ORG FOR LATEST UPDATE.

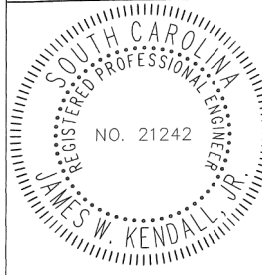

James W. Kendall
 SIGNATURE
 10/30/2015
 DATE

6	---	---	---
5	---	---	---
4	---	---	---
3	1/16	HJC	REM DET 2, GENERAL
2	1/15	JMG	BLEND NOTES
1	10/14	JMG	REMOVED PAY ITEMS
0	1/13	DSO	NEW DRAWING
#	DATE	CHK	DESCRIPTION



DESIGN STANDARDS OFFICE
 955 PARK STREET
 ROOM 405
 COLUMBIA, SC 29201

STANDARD DRAWING
 PEDESTRIAN RAMP
 CONDENSED
 TERMINAL
 (PARALLEL RAMP)

720-952-11
 EFFECTIVE LETTING DATE | JANUARY 2016

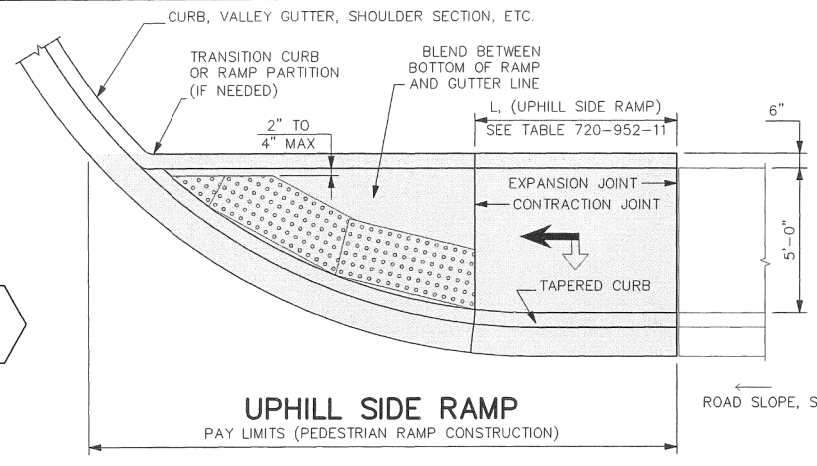
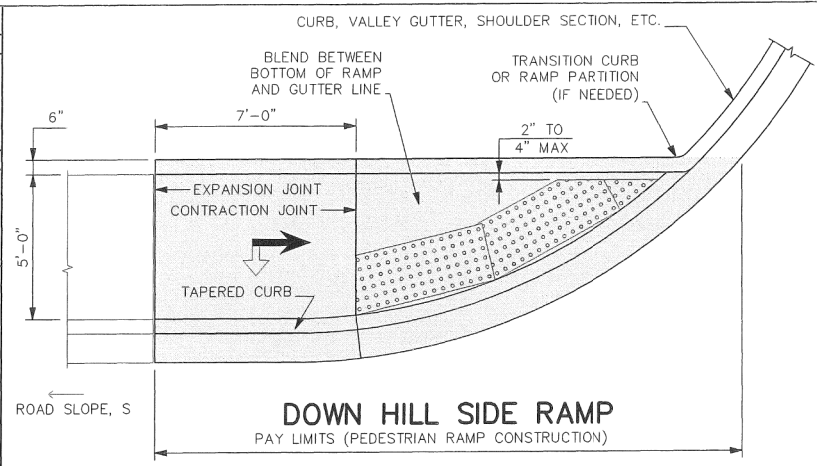

DETAIL 1
 SCALE: 3/16" = 1'-0"
 PLAN
 NO GRASS STRIP
 SEE 720-901-03 FOR SYMBOLS
 SINGLE CROSSWALK

- NOTES:**
- SEE STANDARD DRAWINGS 720-901-XX FOR GENERAL NOTES AND 720-901-03 FOR SYMBOLS.
 - SEE STANDARD DRAWINGS 720-91X-XX FOR INSTALLATION PROCEDURES FOR DETECTABLE WARNING SURFACE MATERIALS.
 - SEE STANDARD DRAWINGS 720-929-XX FOR VARIANTS TO THIS STANDARD.
 - QUANTITIES IN TABLE 720-952-11 ASSUME THAT DOWN HILL SIDE RAMP IS ALWAYS AT LEAST 7'-0" LONG.
 - CONSTRUCT RAMP PARTITION AT ALL LOCATIONS WHERE ROADWAY DRAINAGE COULD DISCHARGE ONTO ADJACENT PROPERTY. CONSTRUCT RAMP PARTITION IF NEEDED TO RETAIN EXISTING GROUND ELEVATION ON ADJACENT PROPERTY.

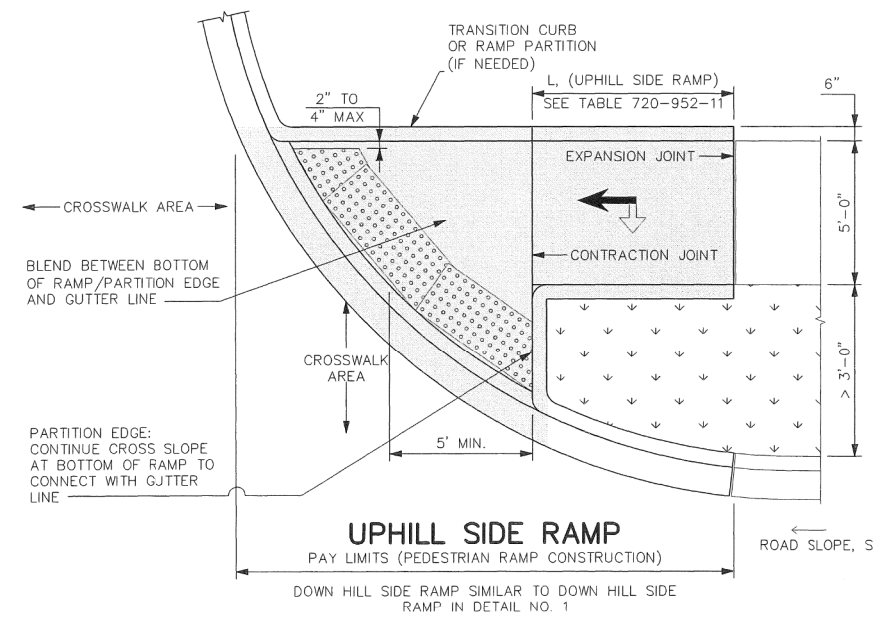

DETAIL 2
 SCALE: 3/16" = 1'-0"
 PLAN
 > 3'-0" GRASS STRIP
 SEE 720-901-03 FOR SYMBOLS
 CONSIDER USING PERPENDICULAR RAMP TO CROSS MAIN LINE
 DUAL CROSSWALK

TABLE: 720-952-11 (SEE 720-929-01, X=10')

ROAD SLOPE, S (%)	L, (UPHILL SIDE RAMP), [FT]
S ≤ 1%	7'-0"
1% > S ≤ 3%	10'-0"
S > 3%	15'-0"



4				
3				
2				
1				
REV. NO.	BY	DATE	DESCRIPTION OF REVISION	
DESIGNED BY:		DATE		
DRAWN BY:		DATE		
CHECKED BY:		DATE		

BEAUFORT COUNTY
 CITY OF BEAUFORT

ROBERT SMALLS PKWY (SC-170)
 DETAIL SHEET

STATE	COUNTY	FILE NO.	PROJECT NO.	ROUTE NO.	SHEET NO.
SC	BEAUFORT			SC-170	5

GENERAL NOTES

GENERAL CONSTRUCTION NOTES:

THE CITY ENGINEER MUST SPECIFICALLY AUTHORIZE CHANGES INVOLVING INCREASED COST OF THE PROJECT OR CHANGES IN ALIGNMENT.

WATER VALVES, GAS VALVES, AND SEWER MANHOLES SHALL BE ADJUSTED BY THE CONTRACTOR (RAISED OR LOWERED) TO MATCH THE SIDEWALK PROFILE AND SHALL NOT BE PARTIALLY LOCATED WITHIN THE SIDEWALK. NO ADDITIONAL PAYMENT WILL BE MADE FOR ADJUSTING THESE VALVES OR MANHOLES. THIS WORK SHALL BE CONSIDERED INCIDENTAL IN THE UNIT COST OF CLEARING AND GRUBBING AND SHALL INCLUDE ALL WORKMANSHIP AND MATERIALS NECESSARY TO COMPLETE THIS ITEM.

THE LOCATIONS OF EXISTING UTILITIES SHOWN ON THE PLANS HAVE BEEN DETERMINED FROM AVAILABLE INFORMATION AND ARE PROVIDED FOR THE CONVENIENCE OF THE CONTRACTOR. THE ENGINEER ASSUMES NO RESPONSIBILITY FOR THE ACCURACY OR COMPLETENESS OF THE UTILITIES INFORMATION SHOWN ON THE DRAWINGS. IT IS THEREFORE THE CONTRACTOR'S RESPONSIBILITY TO CONFIRM THAT THE PROPER COORDINATION WITH THE VARIOUS UTILITY OWNERS HAS BEEN PERFORMED.

THE CONTRACTOR SHALL COOPERATE WITH THE UTILITY OWNERS DURING RELOCATION OPERATIONS. THE CONTRACTOR SHALL EXERCISE CAUTION WHEN CROSSING AN UNDERGROUND UTILITY WHETHER SHOWN ON THE DRAWINGS OR LOCATED BY THE UTILITY COMPANY. COST OF DAMAGES TO ANY UTILITIES AS A RESULT OF CONSTRUCTION SHALL BE THE RESPONSIBILITY OF THE CONTRACTOR.

ALL WORKMANSHIP AND MATERIALS USED ON THIS PROJECT SHALL CONFORM TO THE SCDOT STANDARD SPECIFICATIONS FOR HIGHWAY CONSTRUCTION (2007 EDITION), SCDOT 2007 SUPPLEMENTAL SPECIFICATIONS, SCDOT SUPPLEMENTAL TECHNICAL SPECIFICATIONS IN EFFECT AT THE TIME OF LETTING, AND SCDOT 2009 STANDARD DRAWINGS EXCEPT WHERE OTHERWISE NOTED IN THE PLANS.

ALL EXISTING ROAD SIGNS AFFECTED BY CONSTRUCTION ACTIVITIES SHALL BE RETAINED, RELOCATED, OR REMOVED AS DIRECTED BY ENGINEER. PAYMENT FOR THIS WORK SHALL BE INCLUDED IN THE LUMP SUM COST FOR CLEARING AND GRUBBING.

ALL NEW SIGNS SHALL BE PLACED IN ACCORDANCE WITH THE MANUAL ON UNIFORM TRAFFIC CONTROL DEVICES AND SCDOT STANDARD DRAWINGS, NEW 2P & 3P SIGN SUPPORTS REQUIRED FOR RELOCATED SIGNS WILL BE PAID PER LINEAR FOOT INSTALLED AND ACCEPTED.

THE CONTRACTOR SHALL FURNISH, INSTALL, AND MAINTAIN ALL NECESSARY PROVISIONS FOR TRAFFIC CONTROL FOR THE DURATION OF THE PROJECT. THESE PROVISIONS, AS IN EACH CASE IS APPLICABLE, WILL CONFORM TO THE REQUIREMENTS CONTAINED IN THE SCDOT STANDARD SPECIFICATIONS, STANDARD DRAWINGS, SUPPLEMENTAL SPECIFICATIONS, SPECIAL PROVISIONS, THE FEDERAL HIGHWAY ADMINISTRATION MANUAL ON UNIFORM TRAFFIC CONTROL DEVICES, AND AS DIRECTED BY THE ENGINEER. THE CONTRACTOR SHALL SUBMIT THE TRAFFIC CONTROL PLAN TO THE COUNTY FOR APPROVAL BEFORE BEGINNING CONSTRUCTION.

THE LUMP SUM COST FOR TRAFFIC CONTROL SHALL INCLUDE ALL WORK AS DIRECTED ABOVE. THIS LUMP SUM COST SHALL INCLUDE TEMPORARY CONSTRUCTION SIGNS, BARRICADES, DRUMS, CONES, LIGHTS, AND OTHER ITEMS AS REQUIRED TO COMPLETE THIS WORK.

CONTRACTOR SHALL REFER TO SCDOT STD. DWG. 605-010-02 FOR PLACEMENT OF PERMANENT CONSTRUCTION SIGNS. THIS PROJECT REQUIRES ONE (1) SCHEME C AND ONE (1) SCHEME E. SIGNS SHALL BE PAID FOR PER SQUARE FOOT INSTALLED AND ACCEPTED UNDER THE BID ITEM FOR PERMANENT CONSTRUCTION SIGNS.

NARRATIVE DESCRIPTION:

THE STORMWATER MANAGEMENT FOR THESE SIDEWALK IMPROVEMENTS INCLUDE MAINTAINING THE EXISTING STORM DRAINAGE COLLECTION AND CONVEYANCE SYSTEM DESIGNED TO ACCEPT STORM WATER RUNOFF FROM THE ROADWAY AND ADJACENT PROPERTIES ON A NETWORK OF INLETS AND CATCH BASINS AND CONVEY IT IN A CLOSED PIPE SYSTEM AND DISCHARGE IT INTO A MAINTAINED OUTFALL DITCH PERPENDICULAR TO SC-170.

THE TOPOGRAPHY OF THE SITE IS VERY FLAT AND PRIMARILY COMMERCIAL DEVELOPMENT WITH GRASSY LANDSCAPED AREAS. THIS PROJECT WILL NOT AFFECT THE EXISTING BUILDINGS BUT WILL ENCROACH ON THE LANDSCAPING. WEB SOIL SURVEY WAS USED TO DETERMINE THE SOIL CONDITIONS AT THIS SITE. THE SOILS ARE PREDOMINANTLY SANDY SOILS.

THE SEDIMENT CONTROL PLAN INCLUDES FOLLOWING THE EROSION CONTROL NOTES AND SEQUENCE OF CONSTRUCTION BY PLACING SILT FENCE AROUND THE PERIMETER, AND BY PLACING A COMBINATION OF TYPE A AND TYPE F INLET TUBES AT ADJACENT INLETS.

SEQUENCE OF CONSTRUCTION

1. OBTAIN NPDES COVERAGE FROM DHEC AND FINAL MS4 APPROVAL FROM THE CITY OF BEAUFORT DEPARTMENT OF PUBLIC WORKS.
2. NOTIFY SC DHEC REGIONAL OFFICE AND THE CITY OF BEAUFORT DEPARTMENT OF PUBLIC WORKS 48 HOURS PRIOR TO ANY LAND DISTURBING ACTIVITIES.
3. INSTALL TREE PROTECTION AND DELINEATE CLEARING LIMITS.
4. CLEARING & GRUBBING ONLY AS NECESSARY FOR INSTALLATION OF PERIMETER CONTROLS (E.G. SILT FENCE).
5. INSTALL PERIMETER CONTROLS (E.G. SILT FENCE).
6. PROVIDE SITE DRAINAGE WITH DIVERSION DITCHES, SWALES AND DRAINS.
7. CLEARING AND GRUBBING OF SITE (SEDIMENT & EROSION CONTROL MEASURES FOR THESE AREAS MUST ALREADY BE INSTALLED).
8. STRIP TOP SOIL AND STOCKPILE FOR LATER USE ON SHOULDERS AND SLOPES PER SECTION 209 OF THE STANDARD SPECIFICATIONS. "ALL DISTURBED AREA [ANY AREA OF LAND THAT WILL BE DISTURBED DURING CONSTRUCTION, THAT INCLUDES CLEARING, GRUBBING, STOCK PILING AND INSTALLATION OF ANY BMPS (SILT FENCE, SWALES, CHECK DAMS, ETC)] MUST BE INCLUDED WITHIN THE LIMITS OF DISTURBANCE."
9. ROUGH GRADING.
10. INSTALL STORM DRAINAGE.
11. FINE GRADING.
12. CONSTRUCT CURB & GUTTER.
13. ASPHALT PAVING.
14. CONSTRUCT SIDEWALK.
15. FINISH GRADING AND FINAL GRASSING AND LANDSCAPING.
16. MAINTAIN ALL SEDIMENT AND EROSION CONTROL DEVICES FOR THE EXTENT OF THE PROJECT.
17. REMOVAL OF SEDIMENT CONTROLS AFTER SITE HAS BEEN STABILIZED.
18. CONTACT THE BEAUFORT COUNTY CAPITAL PROJECTS DIRECTOR FOR FINAL PROJECT INSPECTION.
19. FILE NOTICE OF TERMINATION.

IE INFRASTRUCTURE
CONSULTING & ENGINEERING



4			
3			
2			
1			
REV. NO.	BY	DATE	DESCRIPTION OF REVISION
DESIGNED BY:	TKC	DATE	
DRAWN BY:	TKC	DATE	
CHECKED BY:	JCH	DATE	

BEAUFORT COUNTY
CITY OF BEAUFORT

ROBERT SMALLS PKWY (SC-170)
GENERAL CONSTRUCTION NOTES

SHEET 5

SCALE:

GENERAL INFORMATION	
CONTROL SURVEY SUMMARY	
VERTICAL	- NORTH AMERICAN VERTICAL DATUM 1988 (NAVD 88)
HORIZONTAL	- NORTH AMERICAN DATUM 1983 (NAD 83)
COORDINATES	- SOUTH CAROLINA STATE PLANE COORDINATE SYSTEM

ALIGNMENT CONTROL POINTS		
CONTROL	NORTHING (Y)	EASTING (X)
PI = 10+00.00	220,006.826	2,090,194.824
PI = 16+00.00	220,428.124	2,090,622.033

SURVEY CONTROL POINTS				
CONTROL	NORTHING (Y)	EASTING (X)	ELEVATION	DESCRIPTION
BM 1	220,288.1904	2,090,426.214	15.117	X ON CROSS WALK CONC PAD VRS
BM 2	220,502.5017	2,090,588.869	15.977	RR SPIKE IN 11" OAK
BM 3	220,011.5551	2,090,152.624	14.337	X IN TOP OF CONC CURB

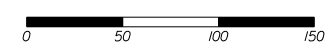
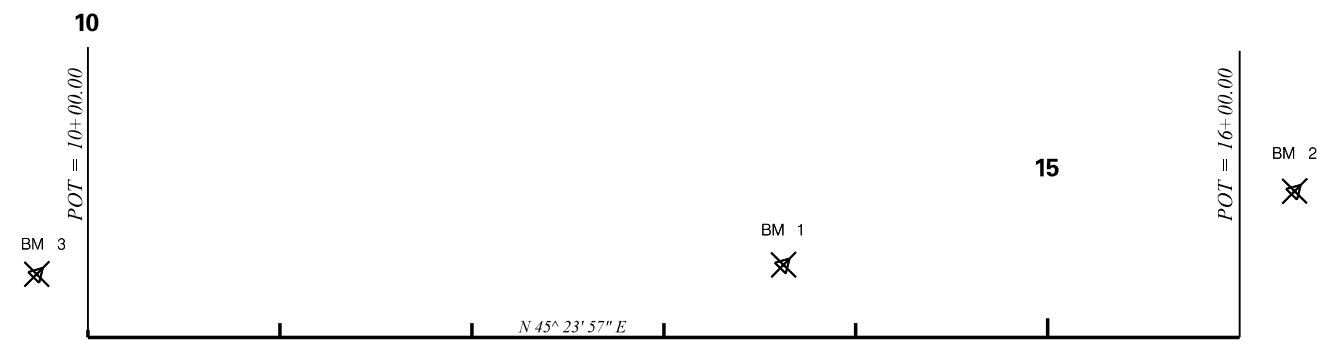
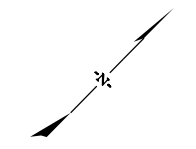

IE INFRASTRUCTURE
CONSULTING & ENGINEERING

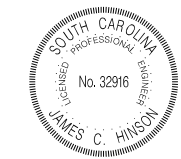

4			
3			
2			
1			
REV. NO.	BY	DATE	DESCRIPTION OF REVISION
DESIGNED BY:	TKC	DATE	
DRAWN BY:	TKC	DATE	
CHECKED BY:	JCH	DATE	

BEAUFORT COUNTY
CITY OF BEAUFORT

ROBERT SMALLS PKWY (SC-170)
REFERENCE DATA SHEET

SHEET 5A SCALE: 1" = 50'

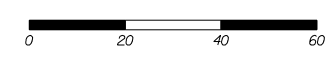
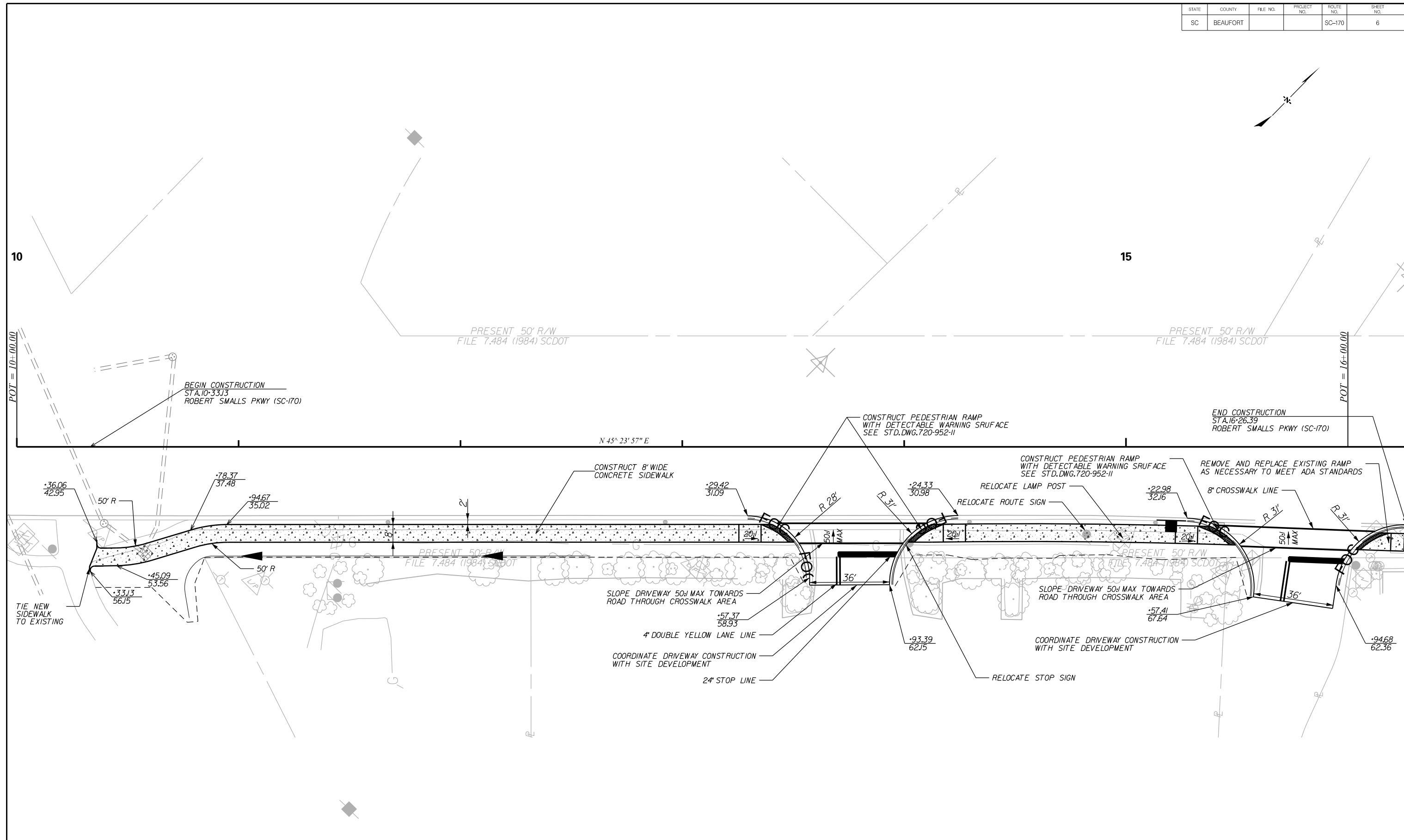

IE INFRASTRUCTURE
CONSULTING & ENGINEERING

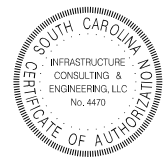

4			
3			
2			
1			
REV. NO.	BY	DATE	DESCRIPTION OF REVISION
DESIGNED BY:	TKC	DATE	
DRAWN BY:	TKC	DATE	
CHECKED BY:	JCH	DATE	

BEAUFORT COUNTY
CITY OF BEAUFORT

ROBERT SMALLS PKWY (SC-170)
PLAN SHEET

SHEET SCALE: 1" = 20'

EROSION CONTROL DATA SHEET



EROSION CONTROL DATA SHEET

FED. DIV. NO.	STATE	COUNTY	PROJECT ID	ROUTE ROAD NO.	SHEET NO.
3	S.C.	BEAUFORT		S-170	EC1

RECEIVING WATERS			
ROAD / ROUTE	OUTFALL DITCH		NAME OF ULTIMATE RECEIVING WATERS
	STATION	SIDE	
SC-170		RT	BATTERY CREEK ATLANTIC

SOIL TYPES				
ROAD / ROUTE	STATION TO STATION		SOIL PARTICLE SIZE (COARSE / FINE)	ZONE
	START	END		
SC-170	10+00	16+00	FINE	COASTAL

TEMPORARY EROSION CONTROL BLANKET							
ROAD / ROUTE	STATION TO STATION	SIDE	DEPTH OF BLANKET (FT)	DITCH BOTTOM WIDTH (FT)	SLOPES x : 1		MSY
					FRONT	BACK	
TOTAL							

TURF REINFORCED MATTING (TRM)										
ROAD / ROUTE	STATION TO STATION	SIDE	DEPTH OF MAT (FT)	SLOPES (x : 1)		DITCH BOTTOM WIDTH (FT)	TYPE	TYPE 1 (MSY)	TYPE 2 (MSY)	TYPE 3 (MSY)
				FRONT	BACK					
TOTALS										

SEDIMENT TUBES IN DITCHES						
ROAD / ROUTE	STATION TO STATION	SIDE	AVERAGE LENGTH	SPACING (FT)	TOTAL	COMMENTS

SEDIMENT DAM																
NO	ROAD / ROUTE	STATION	SIDE	DRAINED OR NOT DRAINED	LENGTH OF SILT BASIN	WIDTH OF SILT BASIN	DAM HEIGHT	SIDE SLOPE OF SILT BASIN	SPILLWAY BOTTOM WIDTH	DAM BOTTOM WIDTH	RIP RAP CLASS	TOTAL STORAGE VOLUME	SEDIMENT STORAGE HEIGHT	OUTFALL CHANNEL WIDTH	OUTFALL CHANNEL DEPTH	OUTFALL CHANNEL LENGTH
TOTALS																

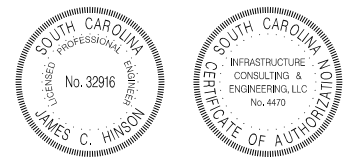

4				
3				
2				
1				
REV. NO.	BY	DATE	DESCRIPTION OF REVISION	
DESIGNED BY:	_____	DATE _____		
DRAWN BY:	_____	DATE _____		
CHECKED BY:	_____	DATE _____		

BEAUFORT COUNTY CITY OF BEAUFORT	
ROBERT SMALLS PKWY (SC-170) EROSION CONTROL DATA SHEET	
SHEET EC1	SCALE: NTS

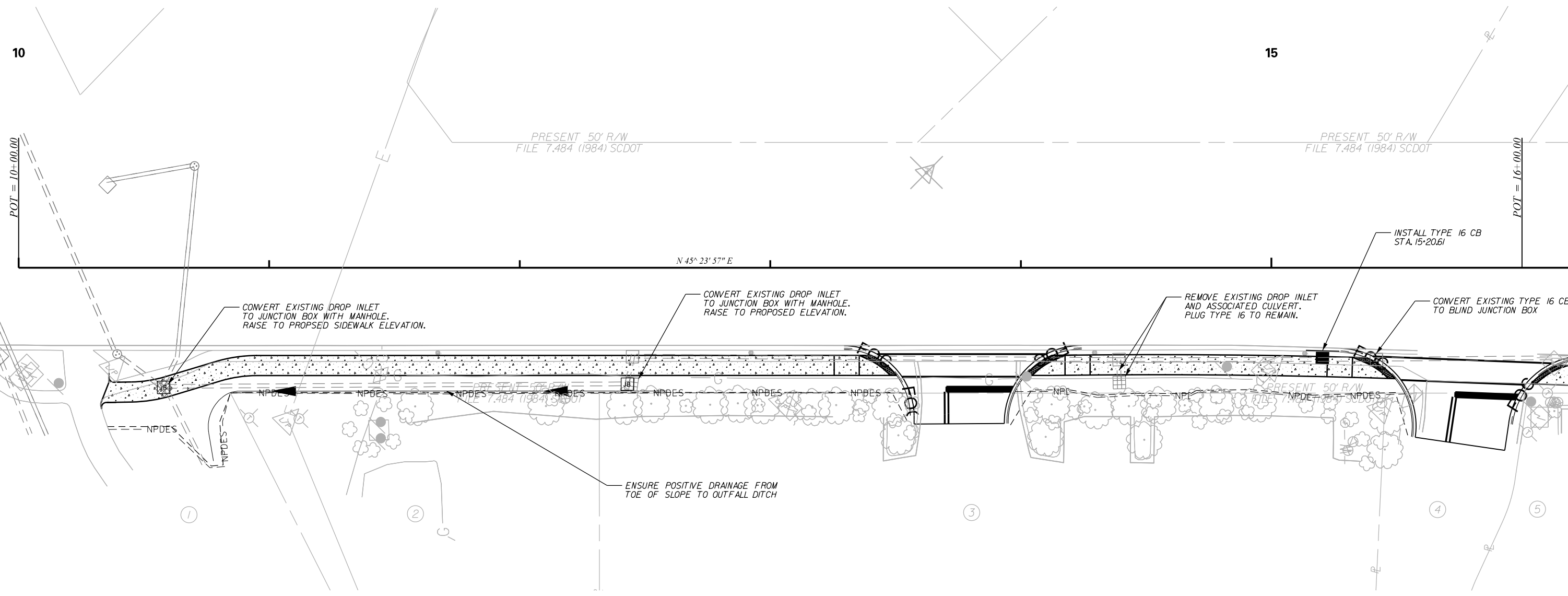
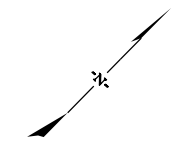

LEGEND	
— NPDES —	SILT FENCE

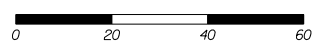

IE INFRASTRUCTURE
CONSULTING & ENGINEERING

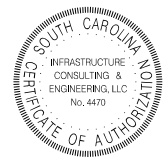

4			
3			
2			
1			
REV. NO.	BY	DATE	DESCRIPTION OF REVISION
DESIGNED BY:	TKC	DATE	
DRAWN BY:	TKC	DATE	
CHECKED BY:	JCH	DATE	

BEAUFORT COUNTY
CITY OF BEAUFORT







ROBERT SMALLS PKWY (SC-170)
DRAINAGE & EROSION CONTROL

SHEET D1 SCALE: 1" = 20'

NOTES:

- ALL WORK AND MATERIALS SHALL BE DONE IN ACCORDANCE WITH THE 2007 SOUTH CAROLINA DOT STANDARD SPECIFICATIONS FOR HIGHWAY CONSTRUCTION, SCDOT SUPPLEMENTAL SPECIFICATIONS – ROADWAY LIGHTING, NATIONAL ELECTRICAL CODE AND NATIONAL ELECTRIC SAFETY CODE.
- CONTACT TERRANCE HARRIS WITH DOMINION ENERGY FOR SERVICE POINT COORDINATION: TERRANCE.HARRIS@DOMINIONENERGY.COM: (843) 592-6728.
- CONTRACTOR SHALL BE AWARE OF OVERHEAD POWER LINES DURING CONSTRUCTION.
- CONDUIT ACCESSORIES SUCH AS EXPANSION JOINTS, ELBOWS, LB'S, FLEXIBLE CONDUIT, ETC SHALL BE INCLUDED IN THE PRICE BID FOR CONDUIT.
- LUMINAIRE MANUFACTURER SHALL PROVIDE A TEN YEAR WRITTEN WARRANTY FOR PARTS AND DEFECTIVE WORKMANSHIP ON LUMINAIRES.
- ALL PITS USED FOR INSTALLED PUSHED (JACKED) CASINGS UNDER EXISTING ROADWAYS SHALL HAVE A MINIMUM OF FIVE FEET BETWEEN EDGE OF SHOULDER. LOCATIONS AS SHOWN ARE APPROXIMATE AND MAY BE SHIFTED AS NECESSARY TO MEET CLEARANCE REQUIREMENTS. CONTRACTOR SHALL FOLLOW MUTCD, SCDOT STANDARD DRAWINGS, AND SCDOT REQUIREMENTS FOR ALL TRAFFIC CONTROL RELATED WORK.
- ALL ELECTRICAL CONNECTIONS SHALL BE MADE ABOVE GRADE INSIDE POLE BASES OR JUNCTION BOXES. NO UNDERGROUND SPlicing ALLOWED.
- CONTRACTOR SHALL VERIFY THE LOCATION OF ALL UTILITIES PRIOR TO INSTALLATION. ANY DAMAGE TO EXISTING UTILITIES SHALL BE REPAIRED BY THE CONTRACTOR AT NO ADDITIONAL COST.
- THE CONTRACTOR SHALL PROVIDE THE SERVICE POLE UNLESS OTHERWISE NOTED. THE SERVICE RISER AND LATERAL, WEATHERHEAD, WATERPROOF ENCLOSURES, CIRCUIT BREAKERS, LIGHTNING ARRESTER, AND THE NECESSARY WIRING FOR CONNECTING TO THE POWER SOURCE, SHALL BE INCLUDED UNDER THE "ELECTRICAL SERVICE CONNECTIONS" PAY ITEM.

LEGEND:

-  PROPOSED DECORATIVE POLE, 14' POLE, 16' MOUNTING HEIGHT. WITH LED LUMINAIRE. LUMINAIRES SHALL BE (OR APPROVED EQUAL) – HOLOPHANE MDLE2 P40 40K AS 3 BK RBK CH FBK PR12 (7280 LUMENS, 77 W, 4000K) POLE SHALL BE (OR APPROVED EQUAL) – HOLOPHANE CHA14F4J16P07ABGBK CH16 BRKWAY KIT FGIUS BK
-  RELOCATED LIGHT POLE
-  EXIST LIGHT POLE TO REMAIN
-  EXIST LIGHT POLE TO BE RELOCATED
-  PROPOSED PULL BOX. SEE CONSTRUCTION DETAILS ON SHEET LL6.
-  DIRECTIONAL BORE, SIZE AND TYPE AS SHOWN.

POLE DATA TABLE

Pole	Sta. No.	Offset	Center / Base Line	Sheet No.	Fixture Mounting Height	No. of Lum's	Arm Length	Circuit	Installation Notes
P1	11+67.32	33.96' RT	ROBERT SMALLS PKWY	LL2	16'	1	N/A	EXISTING	
P2	12+92.33	33.98' RT	ROBERT SMALLS PKWY	LL2	16'	1	N/A	EXISTING	
P3	14+29.45	33.97' RT	ROBERT SMALLS PKWY	LL2	16'	1	N/A	EXISTING	
P4	15+13.21	34.32' RT	ROBERT SMALLS PKWY	LL2	EXISTING	1	N/A	EXISTING	RELOCATED LIGHT POLE

CONDUIT AND CABLE SCHEDULE

- Ⓐ 2" SCH 80 PVC CONDUIT WITH 2 #8 AND 1 #8 GND, INSTALLED IN TRENCH.
- Ⓑ 2" SCH 80 PVC CONDUIT WITH 2 #8 AND 1 #8 GND, PULLED IN 4" CASING (STEEL OR HDPE), DIRECTIONALLY BORED.

ELECTRICAL ITEMS			
6651091	SINGLE DECORATIVE LIGHT POLE	3	EA
6888110	INSTALL STREET LIGHT LUMINAIRE	4	EA
675027Y	4.0" SCHED80 PVC COND-DIR.BORED	120	LF
6760020	2.0" SCHEDULE 80 PVC CONDUIT	540	LF
6770319	#8Cu, 1,600V, RHH, RHW, USE	1690	LF
6800530	17X30X28D. ELEC. UNGRD. ENCLOS/HD	2	EA



4			
3			
2			
1			
REV. NO.	BY	DATE	DESCRIPTION OF REVISION
DESIGNED BY:	_____	DATE _____	
DRAWN BY:	_____	DATE _____	
CHECKED BY:	_____	DATE _____	

BEAUFORT COUNTY
CITY OF BEAUFORT

ROBERT SMALLS PKWY (SC-170)
LIGHTING PLAN SHEET

SHEET LL1 NO SCALE

STATE	COUNTY	FILE NO.	PROJECT NO.	ROUTE NO.	SHEET NO.
SC	BEAUFORT			SC-170	LL2

15

POT = 16+00.00

N 45° 23' 57" E

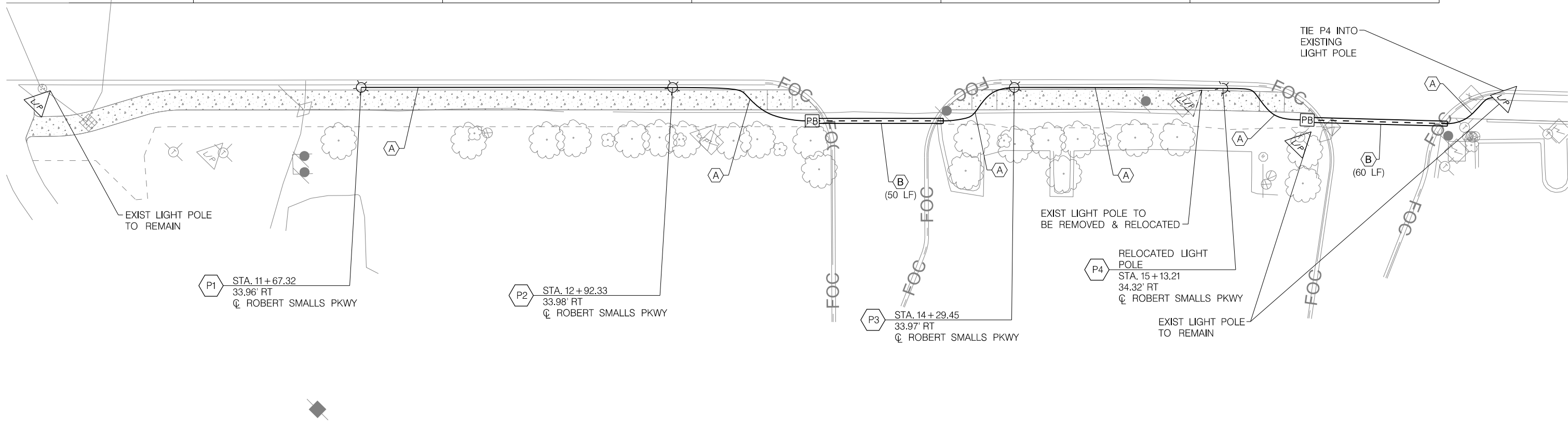

JE INFRASTRUCTURE
CONSULTING & ENGINEERING

4			
3			
2			
1			
REV. NO.	BY	DATE	DESCRIPTION OF REVISION
DESIGNED BY:		DATE	
DRAWN BY:		DATE	
CHECKED BY:		DATE	

BEAUFORT COUNTY
CITY OF BEAUFORT

ROBERT SMALLS PKWY (SC-170)
LIGHTING PLAN SHEET

SHEET LL2 SCALE: 1" = 20'

NOTES

1. CONTRACTOR SHALL UTILIZE EXISTING CIRCUIT BREAKER TO POWER RELOCATED AND NEW FIXTURES.
2. CONTRACTOR TO VERIFY AND NOTE ON DRAWINGS ALL CIRCUIT INFORMATION PRIOR TO BEGINNING WORK. THIS INCLUDES BUT NOT LIMITED TO, PANEL NAME, CIRCUIT NUMBER, CABLE SIZE AND NUMBER OF POLES.

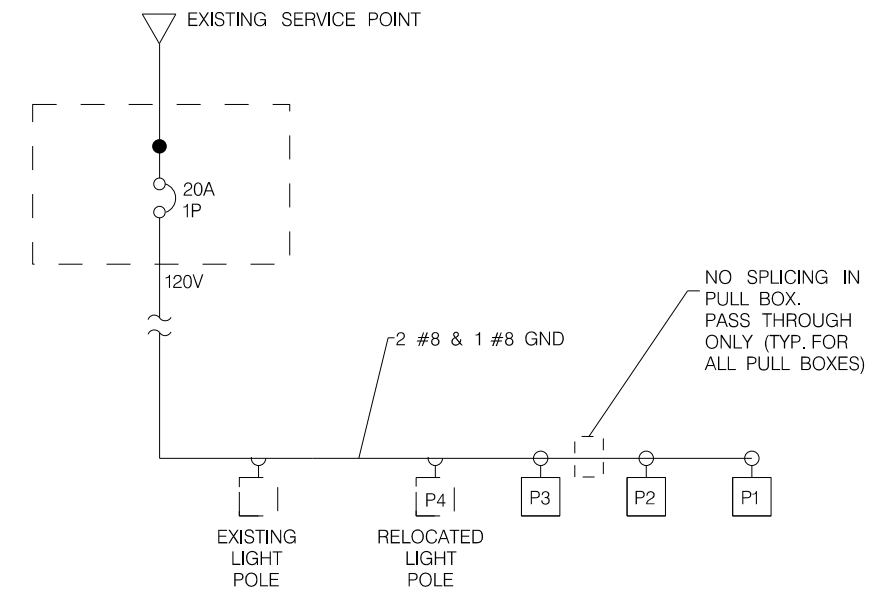

SYSTEM SINGLE LINE DIAGRAM



Wi-Skies, LLC

JE INFRASTRUCTURE
CONSULTING & ENGINEERING

4			
3			
2			
1			
REV. NO.	BY	DATE	DESCRIPTION OF REVISION
DESIGNED BY:	_____	DATE _____	
DRAWN BY:	_____	DATE _____	
CHECKED BY:	_____	DATE _____	

BEAUFORT COUNTY
CITY OF BEAUFORT

ROBERT SMALLS PKWY (SC-170)
LIGHTING PLAN SHEET
SERVICE POINT DETAILS

STATE	COUNTY	FILE NO.	PROJECT NO.	ROUTE NO.	SHEET NO.
SC	BEAUFORT			SC-170	LL4

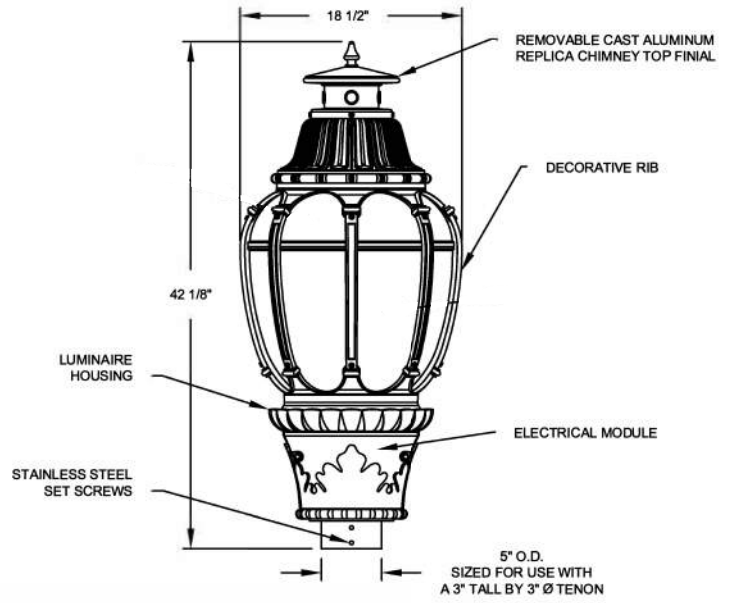

LUMINAIRE DETAIL

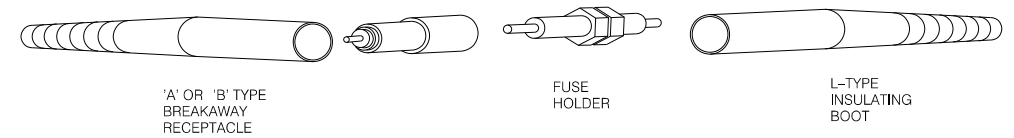

IN-LINE FUSE HOLDER WITH BREAKAWAY FEATURE DETAIL

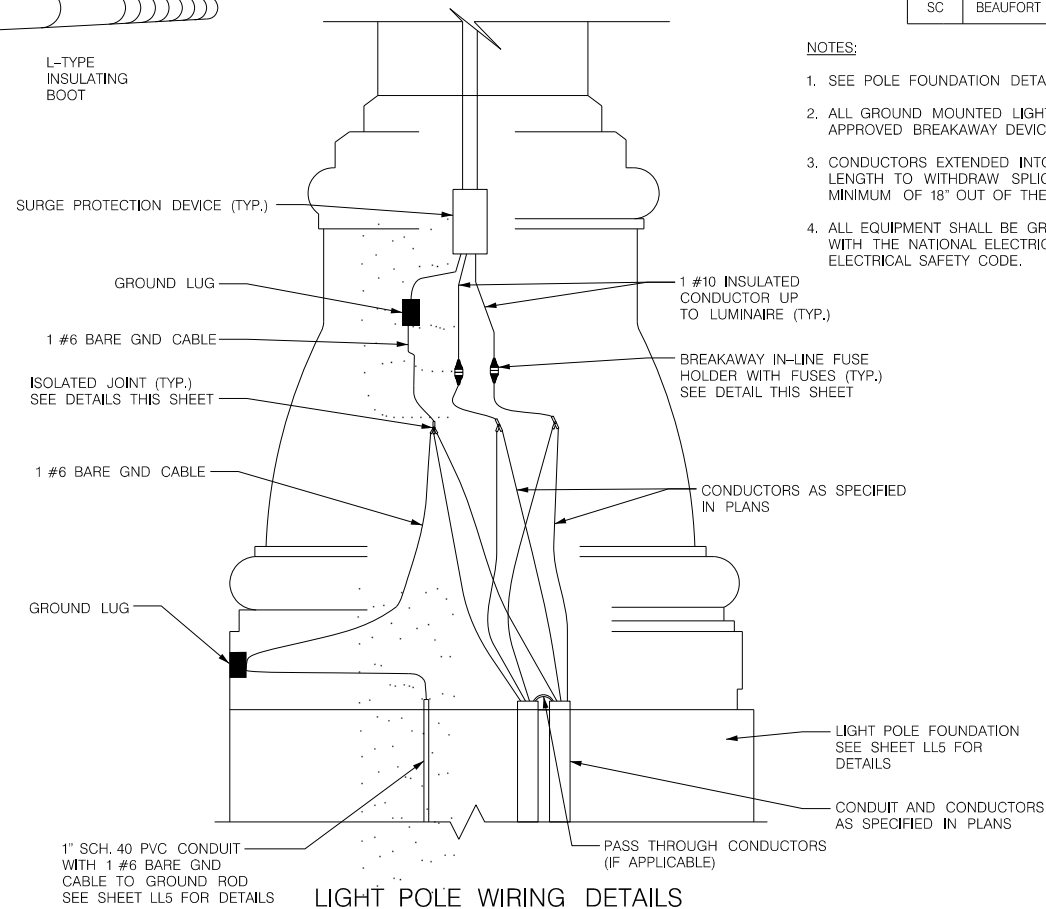

LIGHT POLE WIRING DETAILS

- NOTES:
- SEE POLE FOUNDATION DETAILS ON SHEET LL5.
 - ALL GROUND MOUNTED LIGHT POLES ARE TO BE MOUNTED ON FHWA APPROVED BREAKAWAY DEVICE.
 - CONDUCTORS EXTENDED INTO POLE BASE SHALL BE OF SUFFICIENT LENGTH TO WITHDRAW SPLICES AND/OR ISOLATED JOINTS A MINIMUM OF 18\"/>

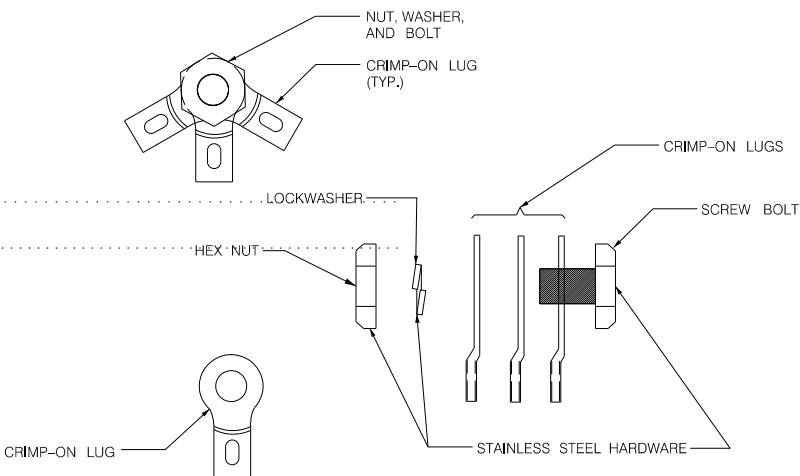

ISOLATED JOINT DETAIL

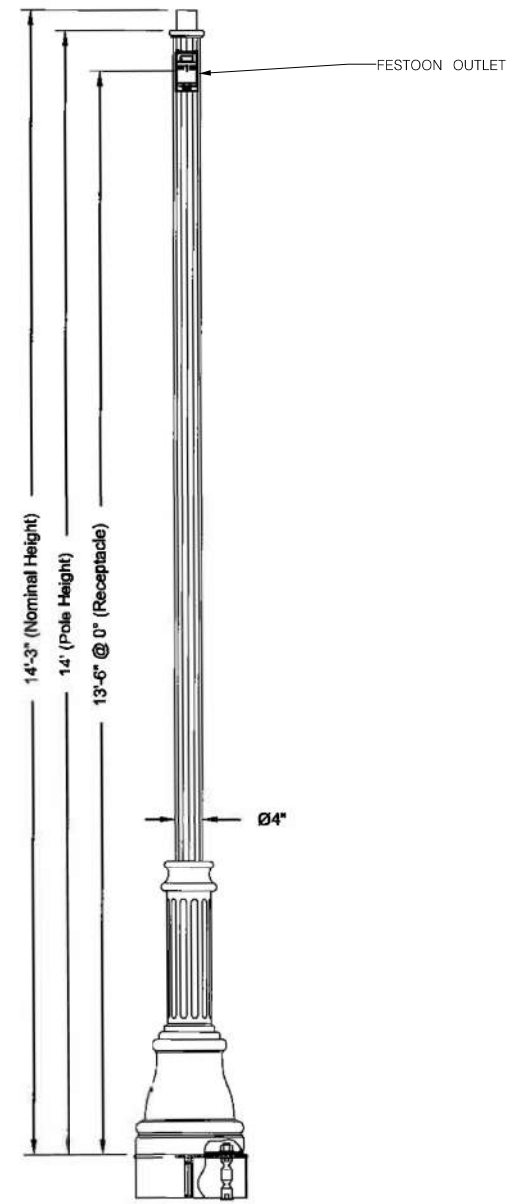

POLE DETAIL

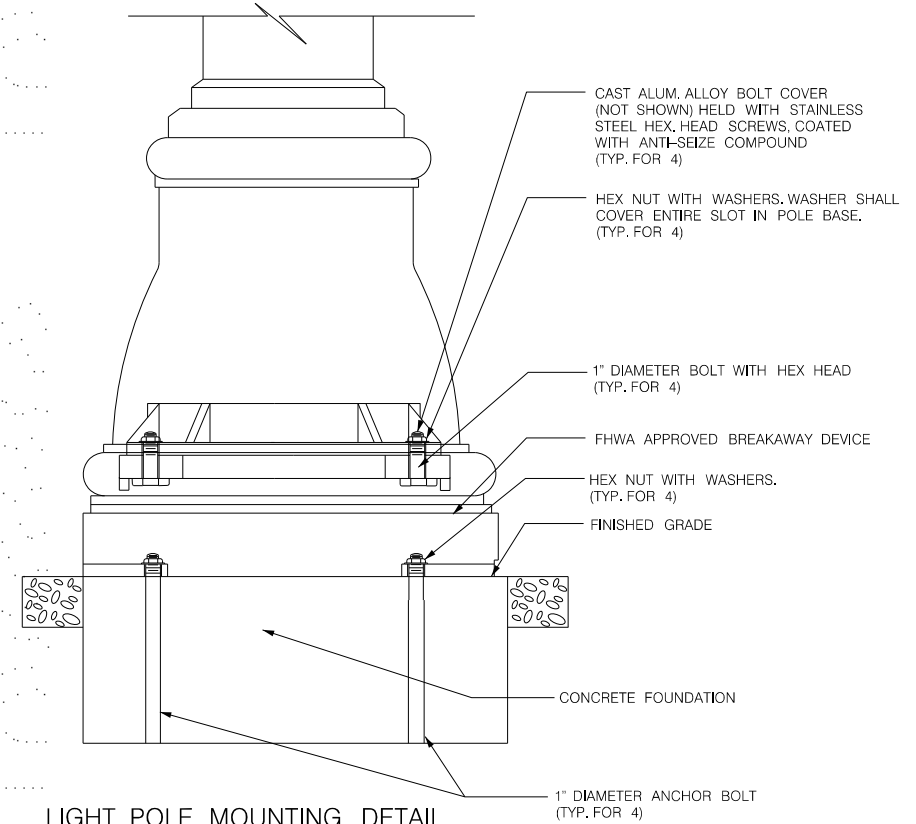

LIGHT POLE MOUNTING DETAIL



JE INFRASTRUCTURE
CONSULTING & ENGINEERING

4				
3				
2				
1				
REV. NO.	BY	DATE	DESCRIPTION OF REVISION	
DESIGNED BY:		DATE		
DRAWN BY:		DATE		
CHECKED BY:		DATE		

BEAUFORT COUNTY
CITY OF BEAUFORT

ROBERT SMALLS PKWY (SC-170)
LIGHTING PLAN SHEET
LIGHTING POLE DETAILS

SHEET LL4 NO SCALE

STATE	COUNTY	FILE NO.	PROJECT NO.	ROUTE NO.	SHEET NO.
SC	BEAUFORT			SC-170	LL5

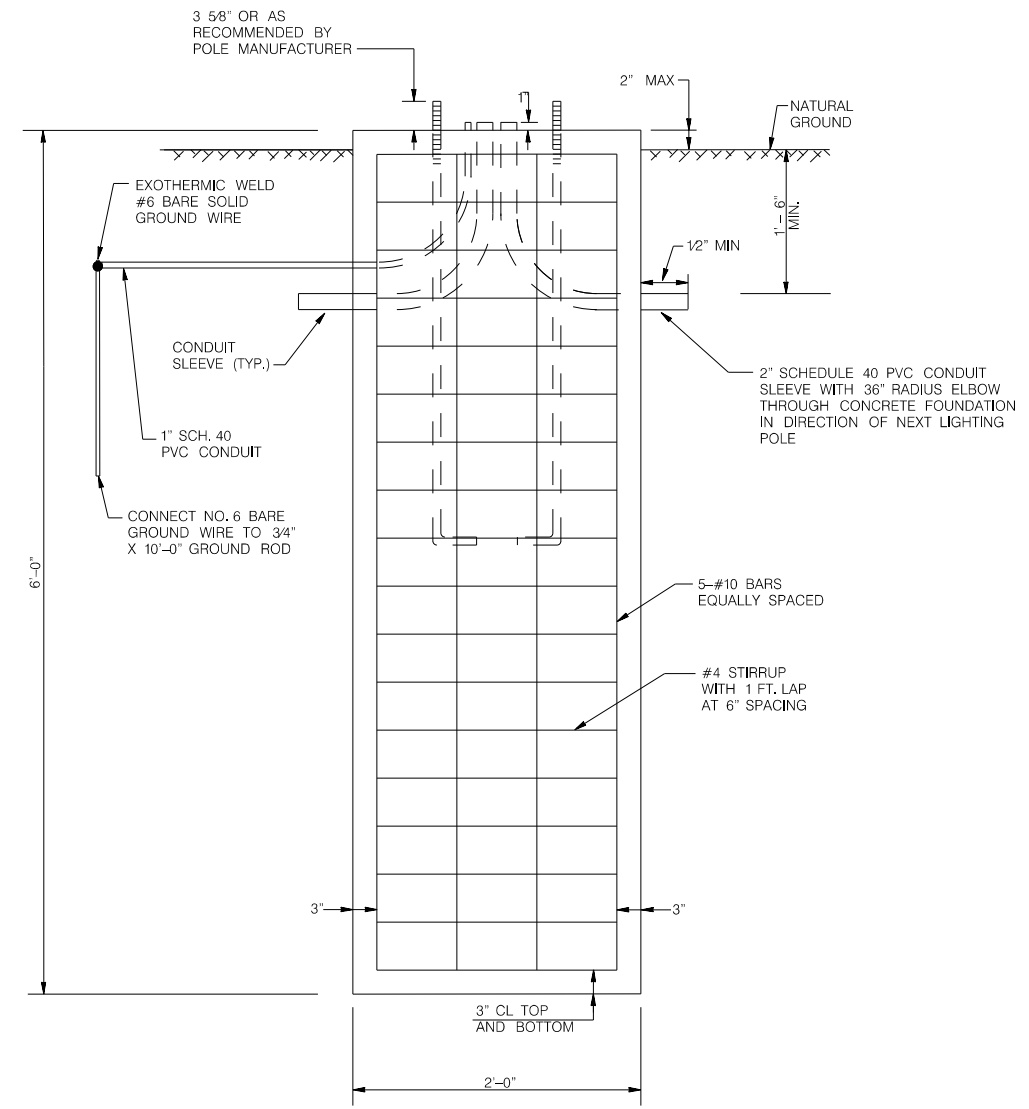

ELEVATION

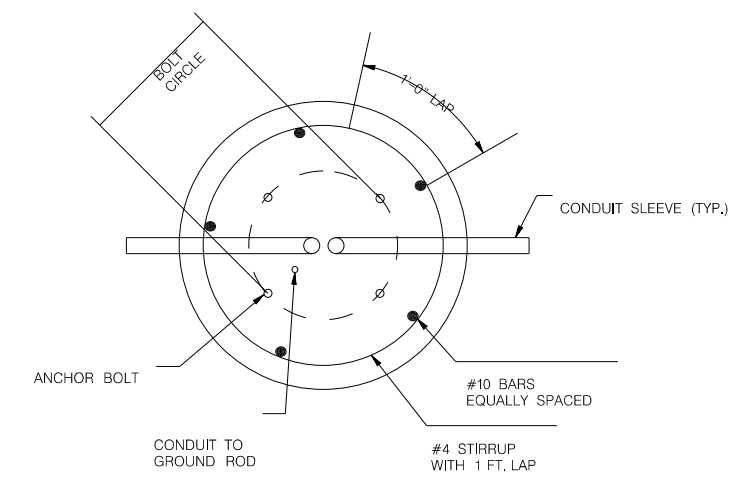

PLAN

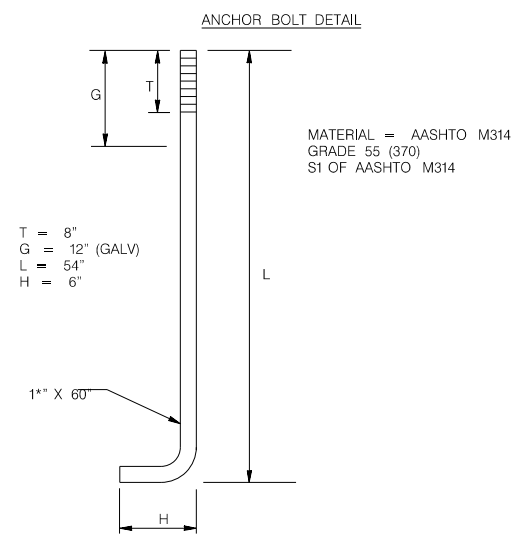

NOTE:
EACH 2' X 6' FOUNDATION REQUIRES:
0.70 CU. YDS. CLASS A CONCRETE AND
114 LBS OF BAR REINFORCING STEEL.
THESE ARE CONSIDERED INCIDENTAL TO
COST OF FOUNDATION.



JE INFRASTRUCTURE
CONSULTING & ENGINEERING

4			
3			
2			
1			
REV. NO.	BY	DATE	DESCRIPTION OF REVISION
DESIGNED BY:		DATE	
DRAWN BY:		DATE	
CHECKED BY:		DATE	

BEAUFORT COUNTY
CITY OF BEAUFORT

ROBERT SMALLS PKWY (SC-170)
LIGHTING PLAN SHEET
POLE FOUNDATION DETAILS

SHEET LL5 NO SCALE

STATE	COUNTY	FILE NO.	PROJECT NO.	ROUTE NO.	SHEET NO.
SC	BEAUFORT			SC-170	LL6

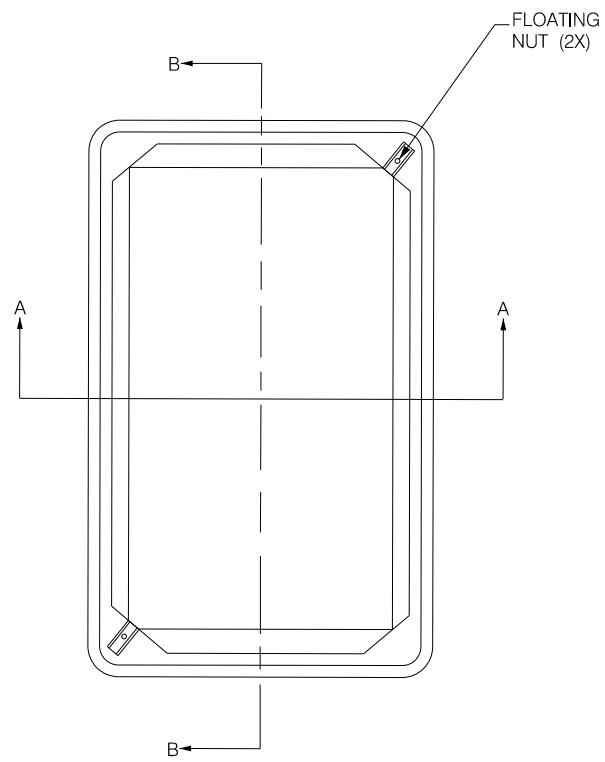

PLAN VIEW

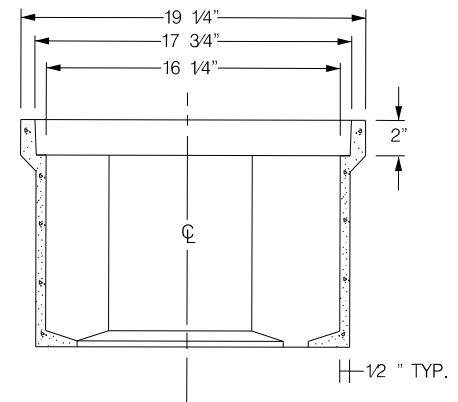

SECTION A-A

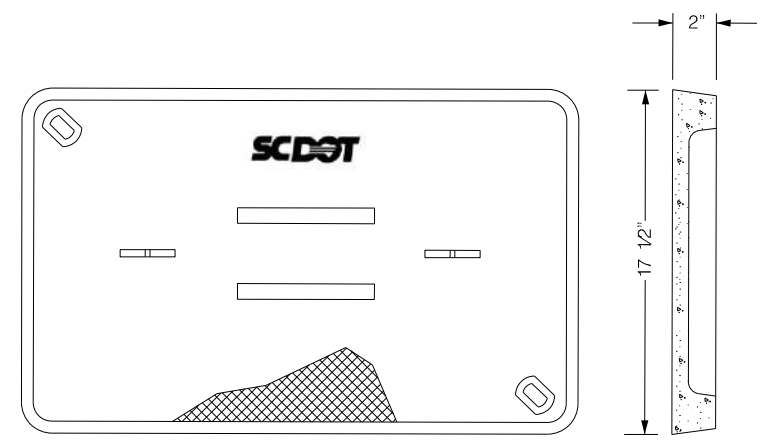

POLYMER CONCRETE COVER

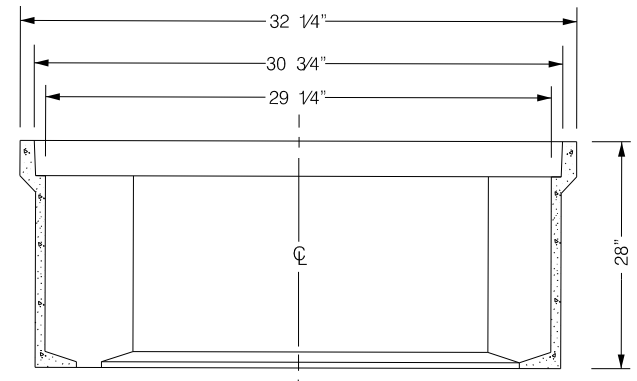
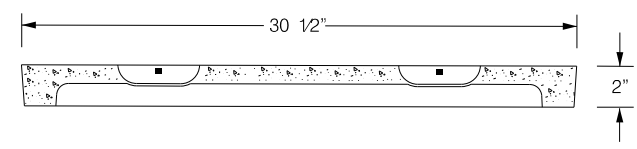

SECTION B-B

NOTES:

- 1) POLYMER BOX TOP AND FRAME MAY HAVE A DIFFERENT CROSS SECTION THAN WHAT IS SHOWN.
- 2) THERE SHALL BE NO CABLE SPLICING WITHIN PULL BOX. PULL BOX SHALL BE USED ONLY AS A CABLE PASS THROUGH.
- 3) ALL PULL BOXES SHALL HAVE SCDOT ELECTRIC LOGO CAST ON THE LID.



4			
3			
2			
1			
REV. NO.	BY	DATE	DESCRIPTION OF REVISION
DESIGNED BY:		DATE	
DRAWN BY:		DATE	
CHECKED BY:		DATE	

BEAUFORT COUNTY CITY OF BEAUFORT	
ROBERT SMALLS PKWY (SC-170) LIGHTING PLAN SHEET JUNCTION BOX/PULL BOX DETAILS	
SHEET LL6	NO SCALE

STATE	COUNTY	FILE NO.	PROJECT NO.	ROUTE NO.	SHEET NO.
SC	BEAUFORT			SC-170	LA1

PLANT LIST - THIS SHEET

KEY	SYMBOL	BOTANICAL NAME	COMMON NAME	SIZE	BALL/CONT.	QUANTITY EACH
AJ		TRACHELOSPERMUM ASIATICUM	ASIATIC JASMINE		CONT. 8" X 12"	205

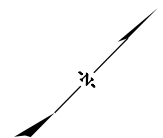

10

15

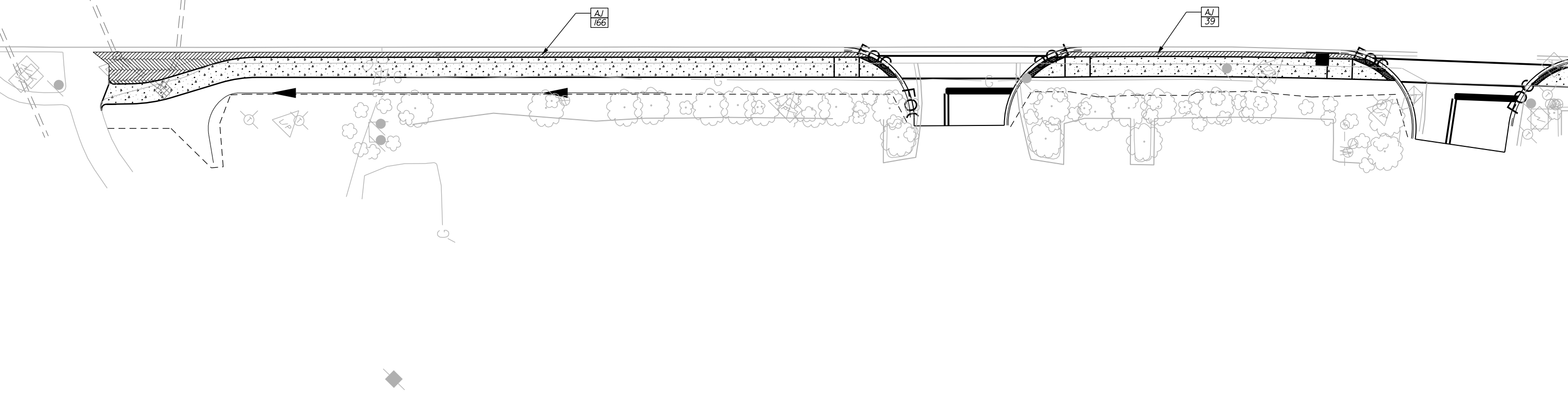
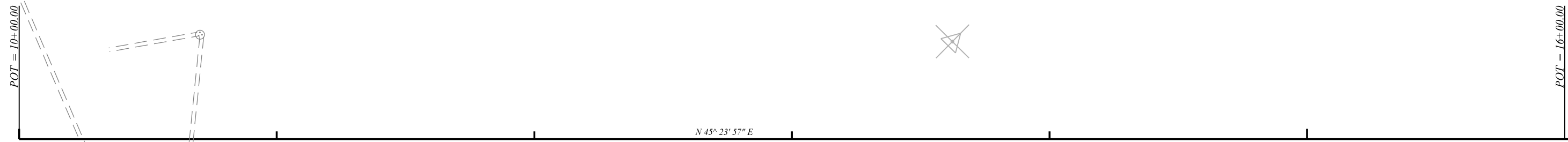

IE INFRASTRUCTURE
CONSULTING & ENGINEERING

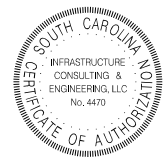

4			
3			
2			
1			
REV. NO.	BY	DATE	DESCRIPTION OF REVISION
DESIGNED BY:	TKC	DATE	
DRAWN BY:	TKC	DATE	
CHECKED BY:	JCH	DATE	

BEAUFORT COUNTY
CITY OF BEAUFORT

ROBERT SMALLS PKWY (SC-170)
LANDSCAPE PLAN SHEET

SHEET LA1

SCALE: 1" = 20'

80

70

60

50

40

30

20

10

0

10

20

30

40

50

STATE	COUNTY	FILE NO.	PROJECT NO.	ROUTE NO.	SHEET NO.
SC	BEAUFORT			SC-170	X1



15

10

15

10

15

10

15

10

15

10

15

10

80

70

60

50

40

30

20

10

0

10

20

30

40

50

60

70

80

12+50.00

12+00.00

11+50.00

11+00.00

10+50.00

10+00.00

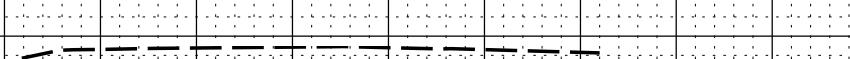
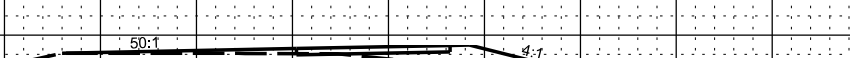
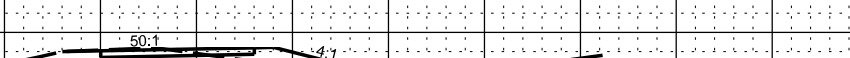
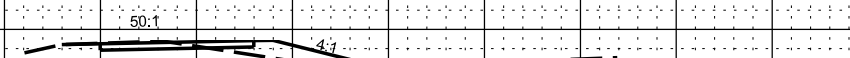
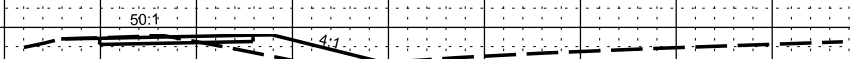
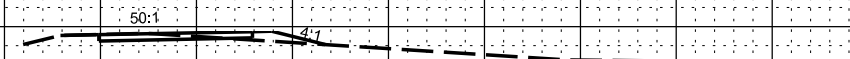

80

70

60

50

40

30

20

10

0

10

20

30

40

50

STATE	COUNTY	FILE NO.	PROJECT NO.	ROUTE NO.	SHEET NO.
SC	BEAUFORT			SC-170	X2

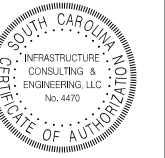
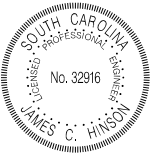

15

10

15

10

15

10

15

10

15

10

15

10

80

70

60

50

40

30

20

10

0

10

20

30

40

50

60

70

80

15 + 50.00

15 + 00.00

14 + 50.00

14 + 00.00

13 + 50.00

13 + 00.00

