

Notes

1. Wall to be 2" x 4" stud walls with 5/8" Type X drywall.
2. Walls will extend to just below the ceiling grid with a closure trim at top.
3. Walls shall be laterially tied off to roof steel framing every 5 feet.
4. There are two (2) counter tops for reception area and Computer Lab area.
5. Counter and trim to be constructed with 3/4" 5 ply B/C plywood with Wilsonart Laminate, color to be Antique Topaz
6. Ceiling grid shall be place around lateral bracing.
7. Owner shall provide existing doors. Contractor will trim with casing.
8. Contractor to replace damaged rear door A-106 and B-106 with same guage door and simular hardware.
9. Counter A will have a height of 3'0". Counter C will be 3'0" from floor.
10. Counters to be supported by blocking in walls and knee bracing on both counter. Counters support will be primed and painted same a trim.

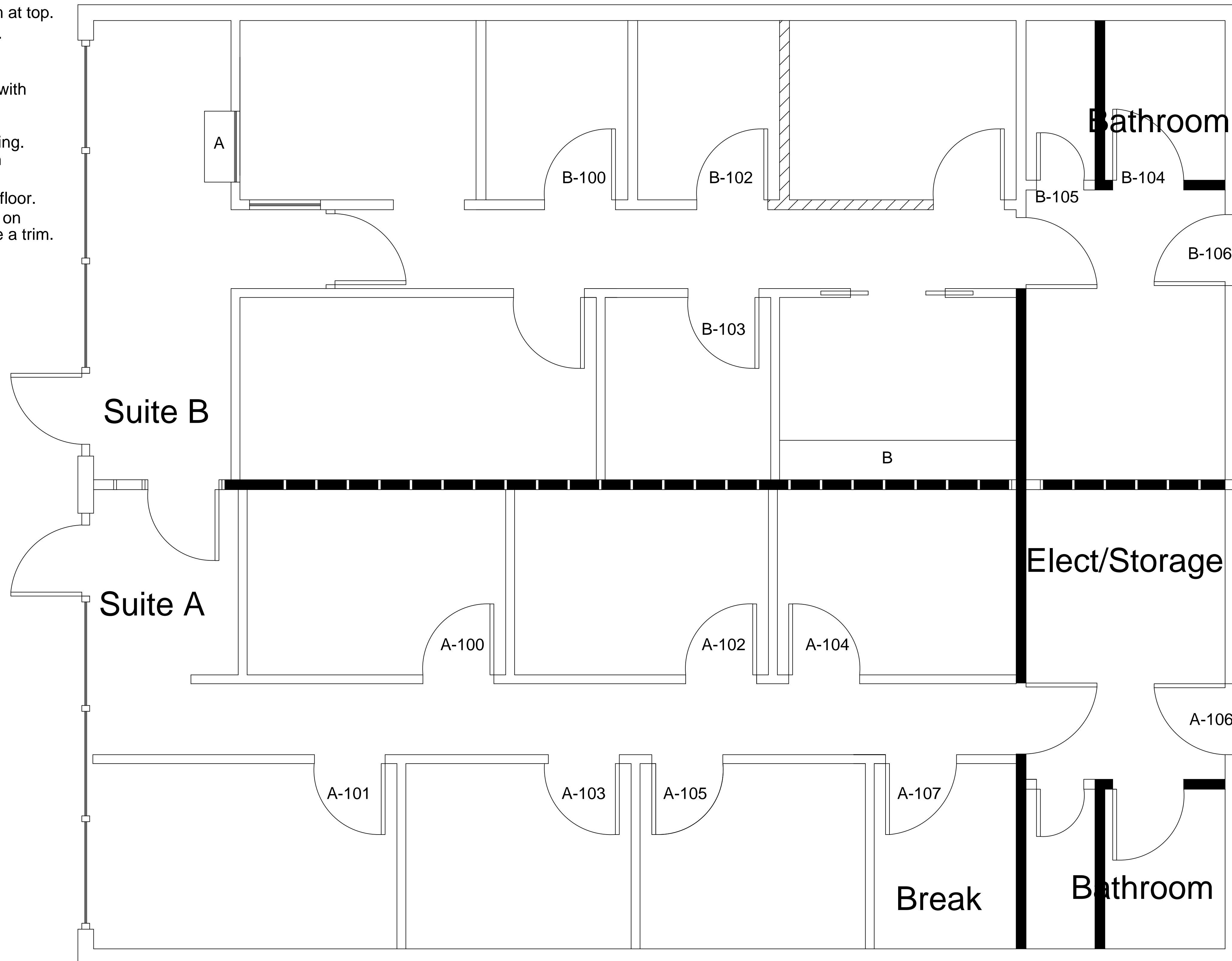

Existing Wall

Existing 3/4 Height Wall

Drawn By	DC	REV.	DESCRIPTION	DATE	BY
Checked By	DC		PLAN-VIEW		
App'd By	APPDBY				
Date	NOV30/2016				

**CITY OF SPARTANBURG**  
**CONSTRUCTION MANAGEMENT**

PIEDMONT COMMUNITY ACTION  
OFFICE RENOVATION  
601 JOHN B WHITE BLVD.

Project No.	Dwg. No.
Scale :	1/6
SCALE	of