

Notes

1. Wall to be 2" x 4" stud walls with 5/8" Type X drywall.
2. All walls will receive egg shell paint. Trim with primer and SemiGlos.
3. Doors shall be prepared to receive semigloss.
4. Owner to select paint color. All walls will be the same color.
5. All areas will be carpet except "Area A" shown in Suite B.
Carpet will be PATCraft -Big Splash Modular. Color will be Belly Flop. Base will be 4" Brown Rubber/vinyl Base.
6. Contractor will clean, strip and wax existing VCT in "Area A".
7. Wall in Area B do not extend to the ceiling. Contractor shall rebuild wall or extent existing wall to the ceiling.
8. Bathrooms shall install all necessary items for ADA compliance.
Toilets now meet these standards. Contractor to add remaining.
9. Door shall be solid birch stain grade with schlage lever handle hardware.
10. Flooring in Break area will be Shaw Luxury Vinyl Plank floor
11. Contractor shall adjust ceiling grid as need to fill in gap or damage tiles.
12. Door B106 is a 4' pocket door.
13. Door B105 and A 106 will be 2'0" doors.

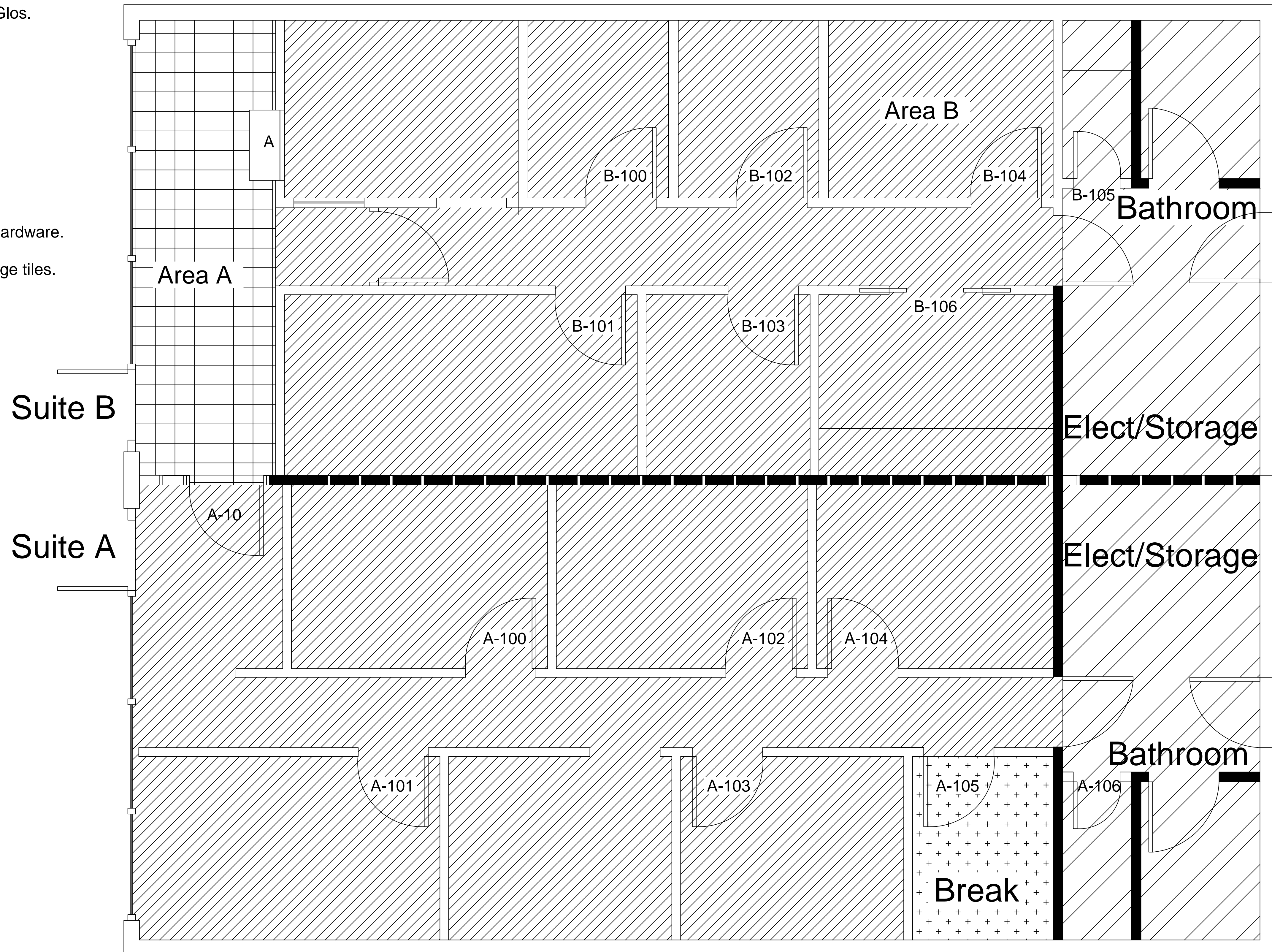

FINISH LEGEND

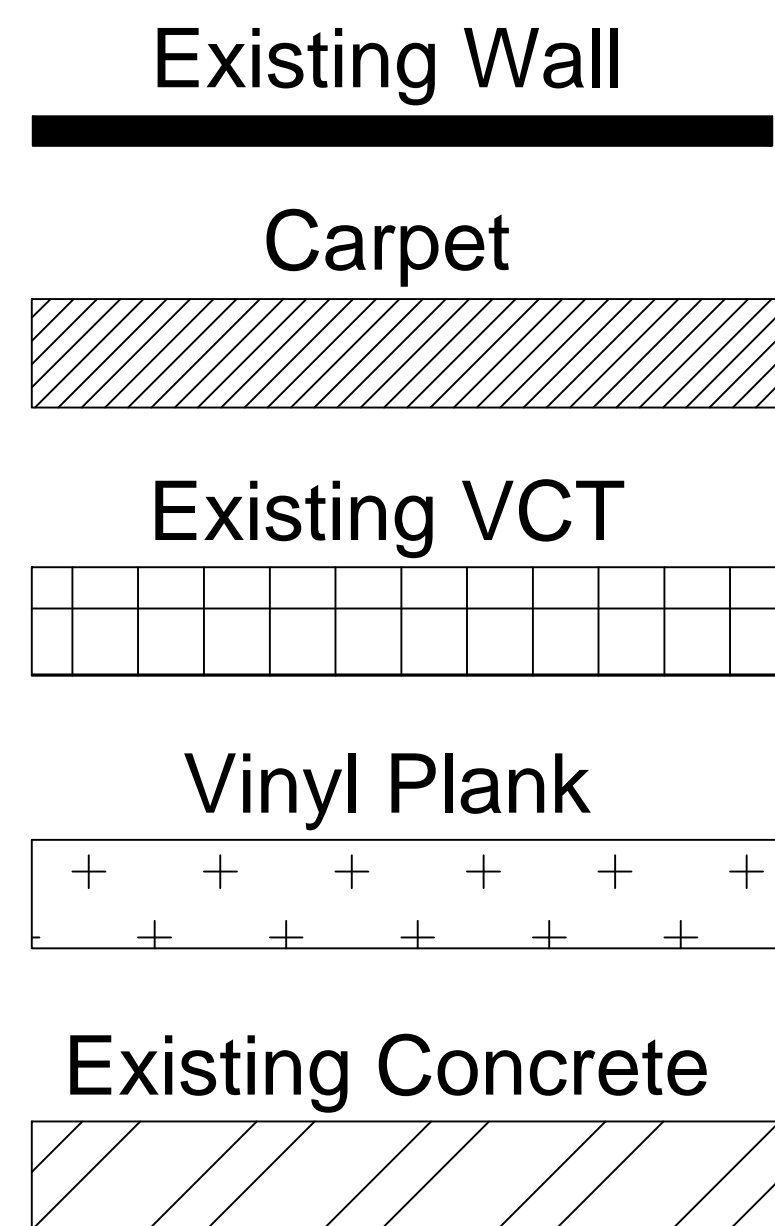

Drawn By	DC	REV.	DESCRIPTION	DATE	BY
Checked By	DC		FINISH-PLAN		
App'd By	APPDBY				
Date	NOV30/2016				

CITY OF SPARTANBURG
CONSTRUCTION MANAGEMENT

PIEDMONT COMMUNITY ACTION
OFFICE RENOVATION
601 JOHN B WHITE BLVD.

Project No.	Dwg. No.
	3
Scale :	6
SCALE	of