



ADDENDUM NO. 3

Issue Date: April 27, 2021

Project Name: Moorhen Marsh Low Energy Aquatic Plant System (Leaps™)

Bid Number: 2021038

Bid Opening Date: May 4, 2021

This addendum is being released to answer questions received to date and to modify bid documents.

The information and documents contained in this addendum are hereby incorporated in the invitation to bid. **This addendum must be acknowledged where indicated on the bid form, or the bid may be declared non-responsive.**

Modifications to Bid Documents:

Spacing has been revised on sheet L2 to 1'6"

Attachments:

L2

Questions and Answers

1. Bid sheet L2 lists several color coded areas (3.22, 3.23, 3.24 and 3.25) for landscape installation. The spacing is listed as either 2' or 3' offset centers but there is a note about spacing the plants in rows 1'-8". For plant calculation purposes can you please provide an equal spacing requirement such as 1.5' O.C or 2' O.C.? This will also help with determining unit prices if any additional areas are added during the construction process. **The note regarding the area for the 1'-8" spacing has been revised to 1'-6" spacing and the area specific to the note has been clarified on Sheet L2.**
2. The Wax Myrtle specification is shown as 2" diameter but this species grows in a multi-stem fashion with several smaller caliper stems rising from the root ball. Can this specification be revised to just a 6' height or the total of all stems from the root ball must equal 2" or greater?
No. The County landscaping code requires 2" diameter.
3. The Southern Red Cedar specification list a diameter of 2" at .5' above grade. Would the plant be accepted if the height requirement of 6' is achieved but lacks the 2" diameter?
No. The County landscaping code requires 2" diameter.
4. Please confirm the size of the shrubs for bid items 3.10-3.18 are 3 gallon containers?
The minimum shrub heights must be as shown on the Bid Drawings and the container size must be

Addendum 3

appropriate for the required height. Where minimum container size is called out, that minimum size must be provided and the plant must meet the minimum height (if a minimum height is noted).

5. Can you provide a total square footage for the netless erosion blanket?

The County has not calculated this quantity.

6. Please confirm the netless erosion blankets will be installed 1' below the water line as a flat measurement below the control elevation level and not 1' in elevation below the control elevation mark.

The netless erosion blankets shall be installed to a 1' vertical depth below the control water line (i.e. 1' in elevation below the control elevation mark).

7. Please confirm the one year maintenance period does not include mowing.

Mowing is not included.

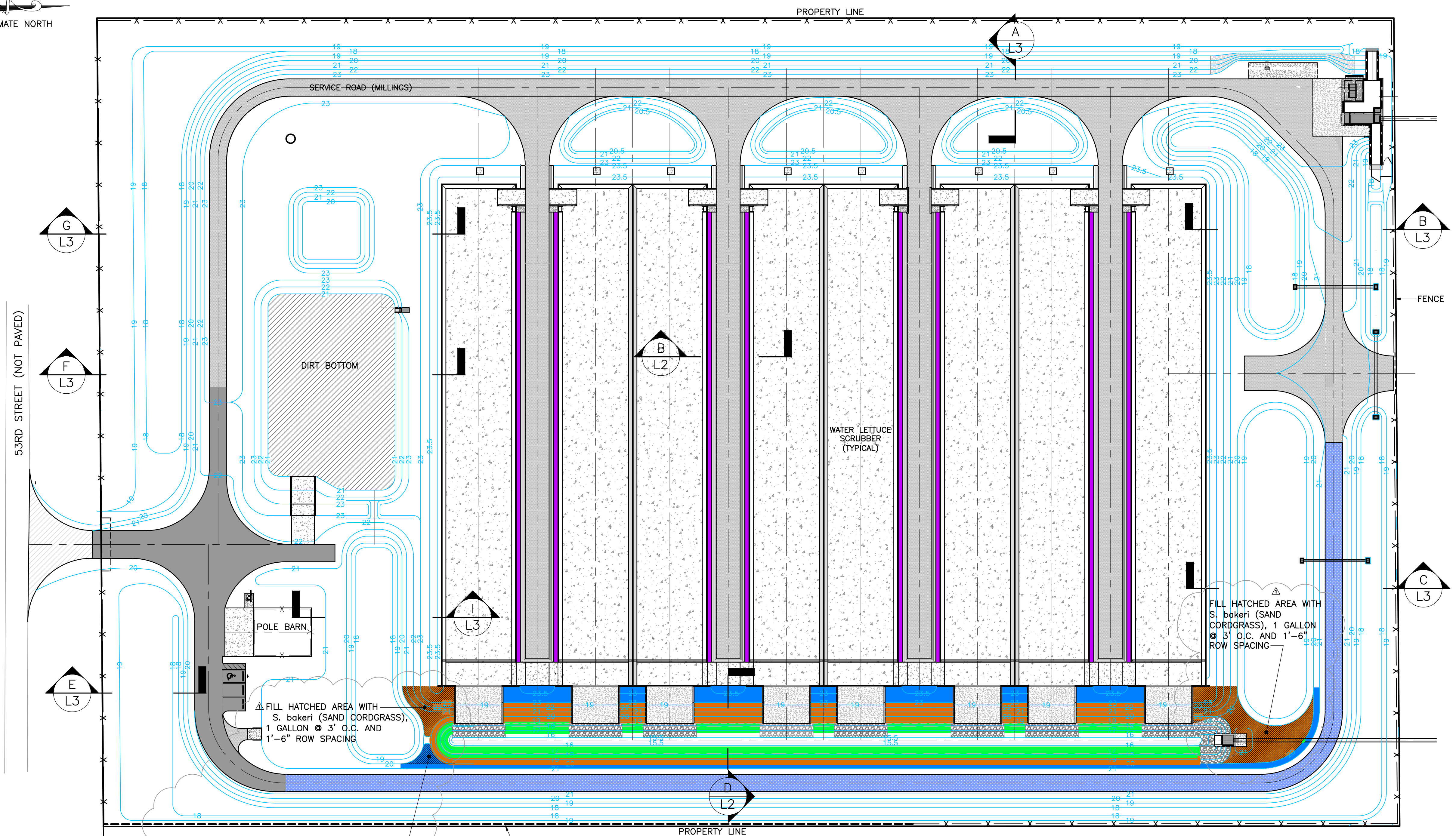

PLAN VIEW: GROUND COVER AND LITTORAL PLANTINGS
SCALE: 1" = 40'-0"

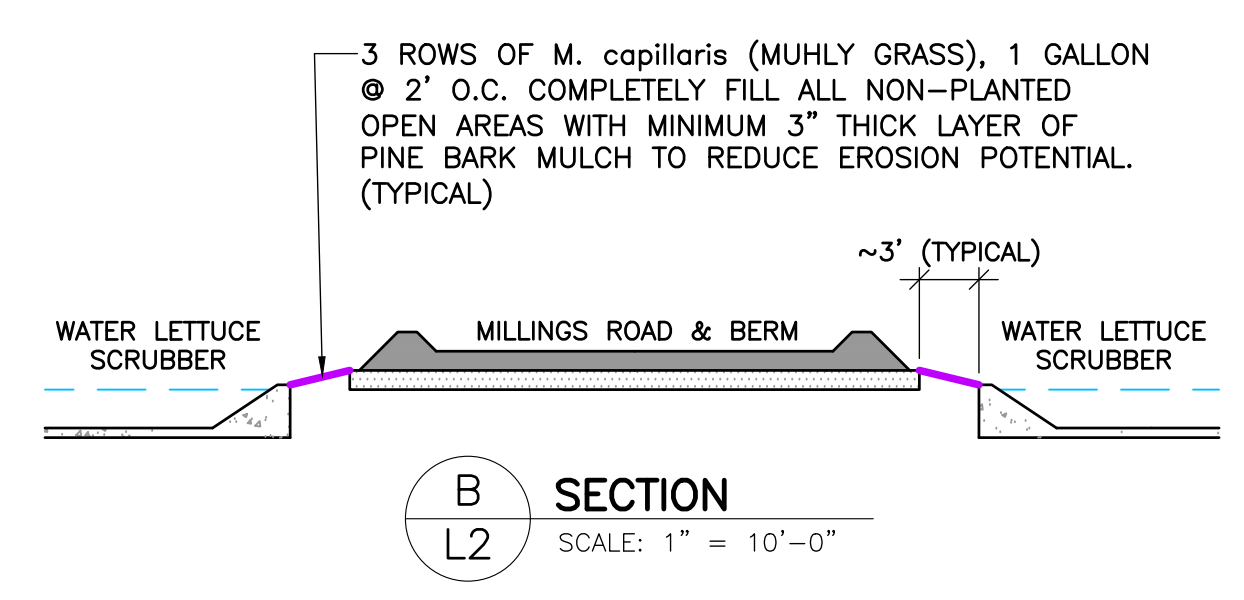

SECTION B (L2)
SCALE: 1" = 10'-0"

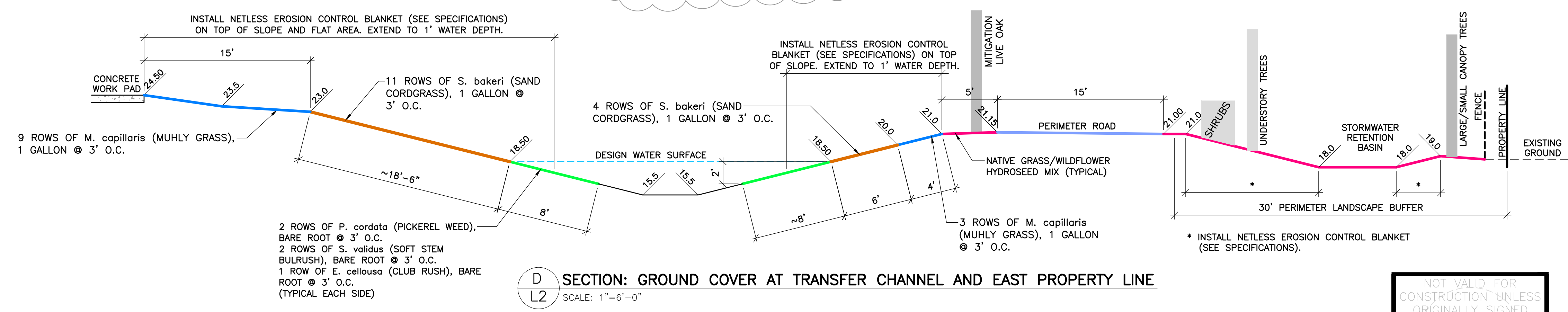

SECTION D (L2)
SCALE: 1" = 6'-0"

- LANDSCAPING LEGEND**
- = 14,119 SF PLANTED AREA - S. bakeri (SAND CORDGRASS), 1 GALLON
 - = 7,603 SF LITTORAL ZONE PLANTS - SEE SECTION "D" FOR PLANT TYPES
 - = 7,994 SF M. capillaris (MUHLY GRASS), 1 GALLON AT 3' O.C.
 - = 11,432 SF M. capillaris (MUHLY GRASS), 1 GALLON AT 2' O.C.
 - = NATIVE GRASS/WILDFLOWER HYDROSEED MIX (AS SHOWN IN SECTION "D")
 - = 17,611 SF - NATIVE GRASS HYDROSEED MIX FOR 15' WIDE SERVICE ROAD
- ALL REMAINING AREAS WITHIN THE FENCED PROPERTY NOT SPECIFICALLY SHOWN IN THE LANDSCAPE DRAWINGS TO OTHERWISE RECEIVE A SPECIFIC GROUND COVER SHALL RECEIVE THE NATIVE GRASS/WILDFLOWER HYDROSEED MIX = 430,808 SF (9.89 ACRES) AS SPECIFIED.

- NOTES**
1. AFTER TREES ARE ESTABLISHED, TREE WELLS TO BE KNOCKED DOWN SMOOTH AND THE DISTURBED AREAS TO BE HYDROSEED PER SPECIFICATIONS. (THIS WORK SHALL BE PERFORMED AT NO ADDITIONAL COST TO THE OWNER.)

NOT FOR CONSTRUCTION:
BIDDING PURPOSES ONLY

NUMBER	REVISIONS	REVISED BY	CHECKED BY

INDIAN RIVER COUNTY
STORMWATER DIVISION
1801 27TH STREET
VERO BEACH, FLORIDA 32960
(772) 226-1562

MOORHEN MARSH LEAPS™

NOT VALID FOR
CONSTRUCTION UNLESS
ORIGINALLY SIGNED
AND SEALED

W. KEITH McCULLY, P.E.
FLORIDA P.E. NO. 32007
DATE:

GROUND COVER AND
LITTORAL PLANTINGS

PROJECT NO.
DATE 4/27/2021
SCALE 1" = 50'
SHEET L2