

THIS DOCUMENT, TOGETHER WITH THE CONCEPTS AND DESIGN PRESENTED HEREIN, AS AN INSTRUMENT OF SERVICES, IS INTENDED ONLY FOR THE SPECIFIC PURPOSE AND CLIENT FOR WHICH IT WAS PREPARED. REUSE OF AND IMPROPER RELIANCE ON THIS DOCUMENT WITHOUT WRITTEN AUTHORIZATION BY LAND ENGINEERING, INC. SHALL BE WITHOUT LIABILITY TO LAND ENGINEERING, INC. COPYRIGHT LAND ENGINEERING, INC. 2023

Professional Seal:



Notes:

Project Number: 2055-015
 Drawn By: DAM
 Date: 01/24/2023

Submittals:

No.	Date	Description

Revisions:

No.	Date	Description

Client / Prepared for:

WALKER COUNTY SCHOOLS

Project Name:
CHATTANOOGA VALLEY - ATHLETIC FIELDS

Project Location:
 ALLGOOD RD & JOHN THOMPSON RD
 Land Lot: 143
 District: 9th
 Section: 4th
 City: -
 County: WALKER
 State: GEORGIA

Drawing Scale:

 1" = 30'

Sheet Title:
TOPOGRAPHIC SURVEY

Sheet Number: 2 Total Sheets: 2 Revision: 0

THIS BLOCK RESERVED FOR THE CLERK OF THE SUPERIOR COURT.

- LEGEND**
- IRON PIN FOUND (DESCRIPTION)
 - SANITARY SEWER MANHOLE
 - DROP INLET
 - YARD DRAIN (1'x1')
 - IRRIGATION CONTROL VALVE
 - ⊕ ELECTRIC HANDHOLE
 - ⊙ PHOTOGRAPH MARKER

- ABBREVIATIONS**
- BLDG BUILDING
 - CLF CHAIN LINK FENCE
 - CONC. CONCRETE
 - CPP CONCRETE PRESSURE PIPE
 - DB DEED BOOK
 - DI DROP INLET
 - E.N.L. END NOT LOCATED
 - HW HEADWALL
 - I.I. INVERT IN
 - I.O. INVERT OUT
 - L.L. LAND LOT
 - N/F NOW OR FORMERLY
 - N.T.S. NOT TO SCALE
 - O/H OVERHANG
 - PB PLAT BOOK
 - PG PAGE
 - P.I.N. PARCEL IDENTIFICATION NUMBER
 - P/L PROPERTY LINE
 - RB REBAR
 - R/W RIGHT OF WAY
 - SSMH SANITARY SEWER MANHOLE
 - TW TOP OF WALL

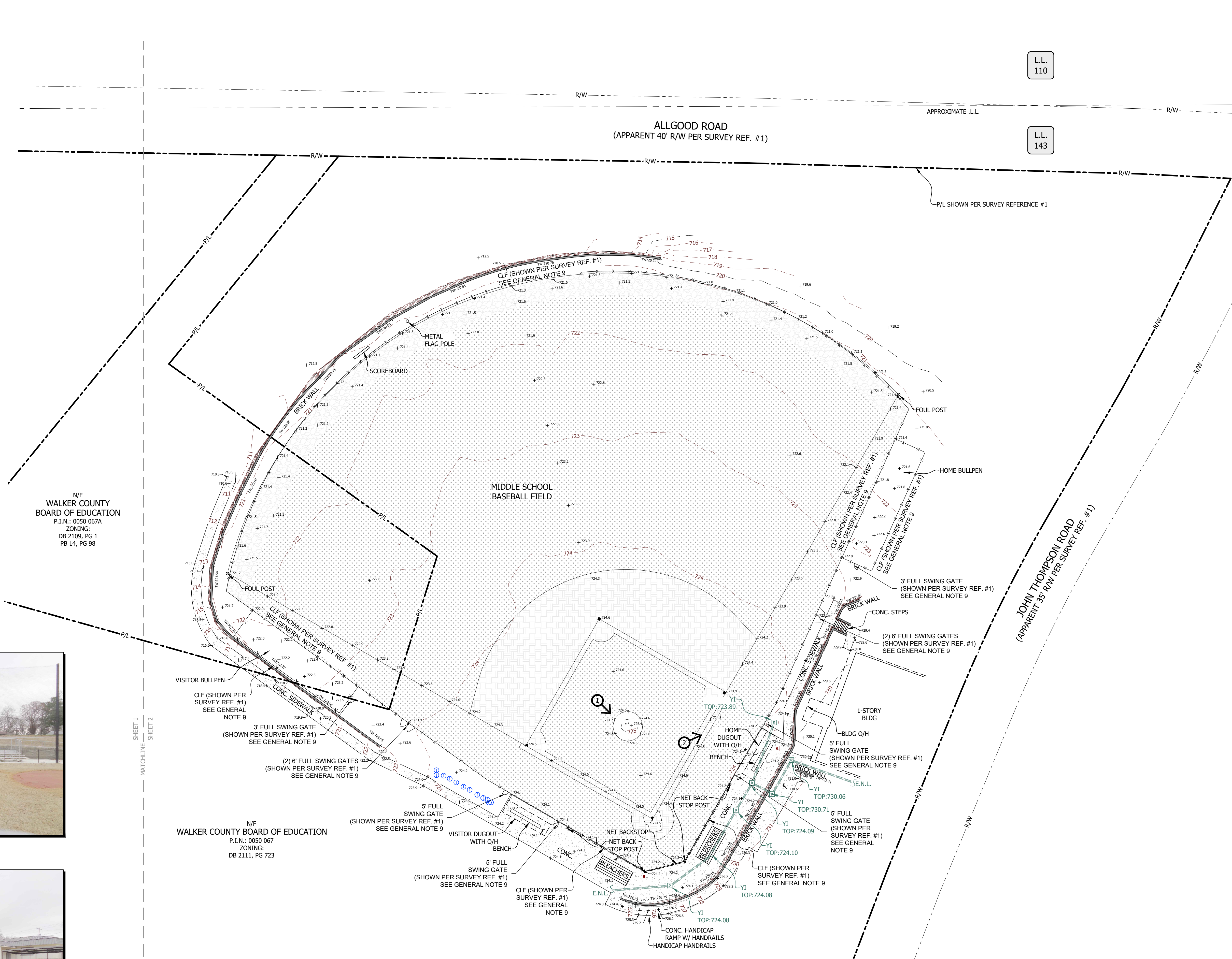

1 → BLEACHERS ON CONCRETE



2 → BUILDING LOCATION