



ADDENDUM

SOLICITATION NO.: ITB 2019-07 Terramar Park Playground Improvement

ADDENDUM NO. 4

DATE: 03/29/2019

To All Prospective Bidders:

This addendum is issued to modify the previously issued solicitation documents and/or given for informational purposes, and is hereby made a part of the solicitation documents. Please attach this addendum to the documents in your possession. ***Per the ITB, the proposer shall acknowledge receipt of any and all addenda, if any, listing the Addenda by number(s) and date(s) in their ITB documents.***

Deadline for Bids:

The deadline for bid submittals has been changed from:

March 28, 2019 at 2:00 p.m.
to
April 11, 2019 at 2:00 p.m.

All bid submittals are due by the new opening date.

Specification Changes/Corrections:

Please refer to the attached revised bid tabulation form that updates page 49 of the bid document for only Sections: **EARTHWORK, CLEARING AND GRUBBING, EROSION CONTROL, AND SURFACE COURSES AND CONCRETE.**

Drawing Changes:

Please refer to the attached revised drawing sheets:

- Sheet D-1, Demolition Plan, Rev. 1
- Sheet C-2, Paving and Grading Plan, Rev. 1
- Sheet LA-3, Site Amenities Plan/Pour-in-Place Layout, Rev. 1

Questions/Clarifications and Answers:

The following question(s) (shown in italicized text) were submitted by prospective bidder(s). The City's responses are presented here (shown in bold text). The submitters' names and email addresses have been removed due to privacy requirements.

1. *Please provide clarification on the following with regards to the bid tabulation for the Terramar Playground Park Improvements:*

- a) *Earthwork:* *Please confirm that they want 850 Cubic Yards excavated. At 12" depth that would be about 22,750 square feet which is more than the playground area.*

The Contractor is to excavate 7.5" depth (2-5 Age Group Area) and 8" depth (5-12 Age Group Area). Quantity is revised to +/-215 CY in lieu of 850 CY.

- b) *Clearing and Grubbing:*

Item #1: Confirm they want unit in SY. Square Yards is a measurement of Area, whereas the curb would be more accurately bid as LF (650 if we go by the Bid Tab)

Bid Item #1 – Removal of Existing Header Curb should be 665 LF in lieu of 28 SY.

- c) *Surface Course And Concrete:*

Item #1 & #2: Please confirm that SY is the unit of measurement they would like bid. Again, SY is a unit of area whereas the curb would be more accurately bid as LF (linear feet.) If we go by SY the QTY 20 for the 4" and QTY 8 for the 6" doesn't cover the length that is referenced in the Bid Tab.

Bid Item #1 – F&I 4" Concrete Header Curb (12" Depth) should be 540 LF in lieu of 20 SY.

Bid Item #2 – F&I 6" Concrete Header Curb (12" Depth) should be 125 LF in lieu of 8 SY.

Item #3: Confirm they would like the more expensive Lime rock bid for the base. I can't find any reference to Lime rock in the bid, specifically in Earthwork section Div. 31 or on the drawings with the exception of a drawing note stating that density and LBR test results must be provided to the engineer.

Bid Item #3 – F&I 4" Limerock Base (98% Max. Density per AASHTO T-180).

Item #4: Confirm they would like 12" Type B Stabilization Subgrade. 12" seems excessively deep as we'll have to excavate over 20" deep to accommodate all the sub-base and surfacing. Also confirm they would like the unit in SY. Again, this is a unit of Area. If so, I will figure it to be 850 SY at 12" depth.

After 7.5" (2-5 Age Group Area) and 8" (5-12 Age Group Area) of excavation, stabilize the existing material to 80% Max. Density per AASHTO T-99.

2. *Am I allowed to submit and possibly be approved as an equal as long as the project does not bid within 10 days of my submission so that I would meet the 10 day window?*

The City is unable to review all requests for "approved or equal" consideration. There are simply too many options available that it is not cost effective to have our consultant reviewing all requests. Consequently, prospective vendors are invited to bid any alternates that they have deemed or equal; however, the City reserves the right to review the proposed alternates prior to award. Therefore, if your submittal is the lowest responsive bid, your proposal including any alternates will be sent to our consultant for review and approval prior to award.

NAME OF COMPANY: _____

| TERRAMAR PLAYGROUND PARK IMPROVEMENTS - CITY OF PARKLAND BID TAB | | | | | |
|---|---|----------|------|--------------|-------------|
| Item # | Item Description | Quantity | Unit | Unit Cost \$ | Subtotal \$ |
| EARTHWORK | | | | | |
| 1 | Regular Excavation | 850 | CY | | |
| Subtotal | | | | | |
| CLEARING AND GRUBBING | | | | | |
| 1 | Remove Existing Header Curb (650 FT) | 28 | SY | | |
| 2 | Remove Existing Wood Chip Mulch in Both Areas and Rubberized Surface (base to remain) | 8,711 | SF | | |
| 3 | Remove Existing Play Equipment (including footers) Relocate per City direction | 1 | LS | | |
| 4 | Remove Existing Concrete Pad (where indicated on plans) | 5 | CY | | |
| EROSION CONTROL | | | | | |
| 1 | Furnish and Install Silt Fence | 700 | LF | | |
| Subtotal | | | | | |
| SURFACE COURSES AND CONCRETE | | | | | |
| 1 | Furnish and Install Concrete Curb (4 inch @ 540 FT) | 20 | SY | | |
| 2 | Furnish and Install Concrete Curb (6 inch @ 125 FT) | 8 | SY | | |
| 3 | Furnish and Install 4 inch Limerock base (Existing Rubberized Surface Limerock base to remain) | 31 | CY | | |
| 4 | Furnish and Install 12 inch TYPE B Stabilization Subgrade (Existing Rubberized Surface Limerock base to remain) | 850 | SY | | |
| Subtotal | | | | | |
| POURED IN PLACE SAFETY SURFACE | | | | | |
| 1 | EPDM Poured in Place Safety Surfacing. 50% Black/50% Standard Color Blend at 8 CFH with 3.5" thickness. Ages 2-5 play area. | 4,000 | SF | | |
| 2 | EPDM Poured in Place Safety Surfacing. 50% Black/50% Standard Color Blend at 9 CFH with 4" thickness. Ages 5-12 play area. | 4,600 | SF | | |
| Subtotal | | | | | |
| PLAYGROUND INSTALLATION | | | | | |
| Engineering Drawings | | | | | |
| 1 | Playground Equipment | 1 | LS | | |
| 2 | Shade Structure | 1 | LS | | |
| Installation | | | | | |
| 1 | Playground Equipment | 1 | LS | | |
| 2 | Shade Structure | 1 | LS | | |
| Freight & Tax | | | | | |
| 1 | Playground Equipment | 1 | LS | | |
| 2 | Shade Structure | 1 | LS | | |
| Subtotal | | | | | |

Please replace this section with the Bid Tab Revision included in this addendum.

TERRAMAR PARK PLAYGROUND PROJECT

ADDENDUM NO.4

BID TAB REVISION

| No | Description | Quantity | Unit | Estimated Cost | Sub-Total |
|----|---|----------|------|----------------|-----------|
| | EARTHWORK | | | | |
| 1 | REGULAR EXCAVATION (8" DEPTH) | 215 | CY | | |
| | CLEARING AND GRUBBING | | | | |
| 1 | REMOVE EXISTING HEADER CURB | 665 | LF | | |
| 2 | REMOVE EXISTING WOOD CHIP MULCH IN BOTH AREAS AND RUBBERIZED SURFACE | 8,660 | SF | | |
| 3 | REMOVE EXISTING PLAY EQUIPMENT (INCLUDING FOOTERS) RELOCATE PER CITY DIRECTIONS | 1 | LS | | |
| 4 | REMOVE EXISTING CONCRETE PAD (WHERE INDICATED ON PLANS) | 5 | SY | | |
| | EROSION CONTROL | | | | |
| 1 | FURNISH & INSTALL SILT FENCE | 700 | LF | | |
| | SURFACE COURSES AND CONCRETE | | | | |
| 1 | FURNISH & INSTALL 4" CONCRETE HEADER CURB (12" DEPTH) | 540 | LF | | |
| 2 | FURNISH & INSTALL 6" CONCRETE HEADER CURB (12" DEPTH) | 125 | LF | | |
| 3 | FURNISH & INSTALL 4" LIMEROCK BASE | 963 | SY | | |
| 4 | STABILIZE EXISTING SOIL (TO 80% MAX DENSITY PER AASHTO T-99) | 963 | SY | | |



Subtotal: \$

Project Number : 18245.03

Prepared by: YMD

Checked by: BZ

3/27/2019

3/27/2019 2:45 PM; Scale: 1"=10'; Layout Tab: PLAN; Pen Table: -----; Plot Created by: YARITZA DAVILA

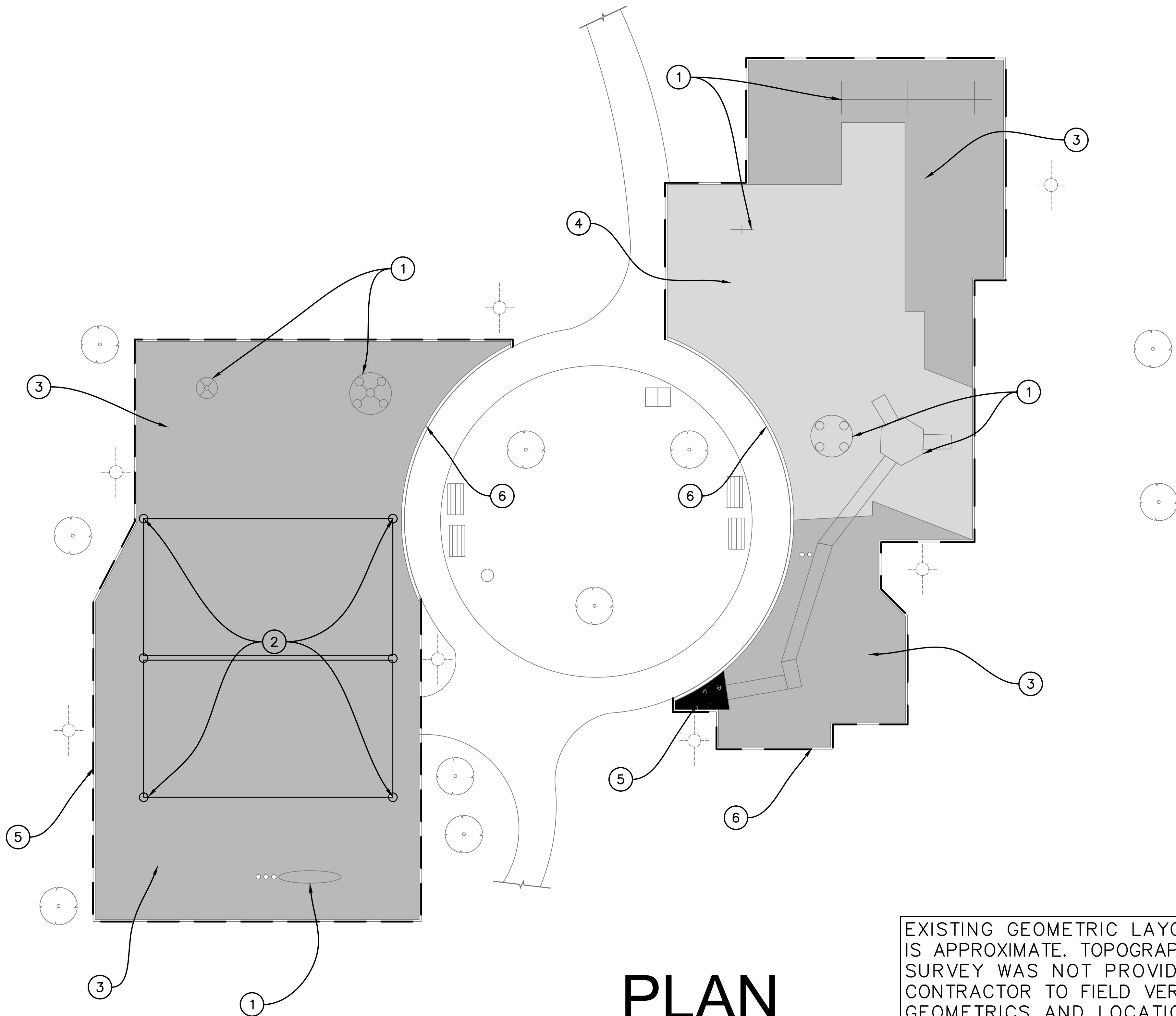

PLAN

SCALE: 1"=10'

EXISTING GEOMETRIC LAYOUT IS APPROXIMATE. TOPOGRAPHIC SURVEY WAS NOT PROVIDED. CONTRACTOR TO FIELD VERIFY GEOMETRICS AND LOCATIONS OF PLAYGROUND EQUIPMENT AND COORDINATE WITH THE CITY PRIOR TO BIDDING.

DEMOLITION PLAN LEGEND:

#

KEY NOTE (SEE DESIGNATED # FOR MORE INFORMATION)

--- LIMITS OF DEMOLITION

DEMOLITION PLAN SPECIFIC NOTES:

- 1 REMOVE ALL EXISTING PLAY EQUIPMENT (INCLUDING FOOTERS). (TO BE STORED AT AREA DESIGNATED BY PARK MANAGER).
- 2 EXISTING SHADE STRUCTURE TO REMAIN. (CANOPY FABRIC CAN BE REMOVED TEMPORARILY FOR ACCESS PURPOSES).
- 3 EXISTING WOOD CHIP MULCH TO BE REMOVED (±6,615 SF).
- 4 EXISTING RUBBERIZED SURFACE TO BE REMOVED (±2,000 SF).
- 5 EXISTING CONCRETE PAD TO BE REMOVED (±5 SY).
- 6 EXISTING 6" WIDE CONC. HEADER CURB ADJACENT TO ASPHALT WALKWAY AND 4" WIDE CONC. HEADER CURB LOCATED ELSEWHERE ALONG PLAYGROUND TO BE REMOVED.

3

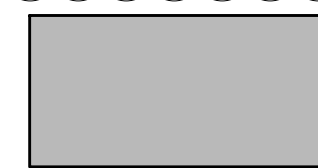

EXISTING WOOD CHIP MULCH (TO BE REMOVED)

4



EXISTING RUBBERIZED SURFACE (TO BE REMOVED)

5



EXISTING CONCRETE PAD (TO BE REMOVED)

DEMOLITION GENERAL NOTES:

UNLESS OTHERWISE NOTED, THE "LIMITS OF DEMOLITION" SHOWN ON PLANS DELINEATES THE LIMITS WITHIN WHICH DEMOLITION IS TO BE PERFORMED. TYPICAL DEMOLITION INCLUDES, BUT NOT LIMITED TO, THE REMOVAL OF ASPHALT, CURBING, DRAINAGE STRUCTURES, CONCRETE, VEGETATION AND DEBRIS (SURFACE AND SUBSURFACE), AND ALL OTHER FEATURES UNLESS OTHERWISE NOTED TO REMAIN.

1. PROPER SAFETY PRECAUTIONS SHALL BE TAKEN TO SEPARATE AREA OF DEMOLITION FROM SURROUNDING PROPERTY.
2. ALL DEMOLITION TO BE PERFORMED IN A MANNER TO ELIMINATE HAZARDS TO PERSONS AND PROPERTY, MINIMIZE INTERFERENCE WITH USE OF ADJACENT AREAS, PROVIDE NON-DISRUPTION OF SERVICES PROVIDED BY EXISTING UTILITIES TO ADJACENT AREAS, AND TO PROVIDE FREE PASSAGE TO AND FROM ADJACENT AREAS OR STRUCTURES.
3. PRIOR TO AND DURING DEMOLITION, CONTRACTOR SHALL TAKE NECESSARY PRECAUTIONS TO AVOID DAMAGE TO EXISTING ITEMS TO REMAIN.
4. DEBRIS RESULTING FROM DEMOLITION SHALL BECOME THE PROPERTY OF CONTRACTOR AND SHALL BE PROPERLY DISPOSED OF ON A DAILY BASIS. DISPOSAL OF DEBRIS SHALL BE IN COMPLIANCE WITH APPLICABLE FEDERAL, STATE AND LOCAL PERMITS, RULES AND/OR REGULATIONS.
5. HAZARDOUS MATERIALS IF PRESENT, SHALL BE DEALT WITH IN A MANNER CONSISTENT WITH FEDERAL, STATE AND LOCAL REGULATIONS.
6. UPON COMPLETION OF DEMOLITION, SITE IS TO BE LEFT IN CLEAN CONDITION FREE OF DEBRIS.
7. CONTRACTOR TO PROVIDE PROPER SEDIMENT CONTROL AND PROTECTION OF STORM WATER STRUCTURES, BOTH WITHIN AND OUTSIDE THE LIMITS OF DEMOLITION AND P/L. TO PREVENT DEPOSIT OF SEDIMENTS CONVEYED THROUGH RUNOFF. CONTRACTOR TO CLEAN AND REMOVE SEDIMENTS FROM ALL STRUCTURES AS NEEDED.
8. EXISTING UTILITIES INFORMATION IS CURRENTLY NOT AVAILABLE. CONTRACTOR IS RESPONSIBLE FOR IDENTIFYING ALL UTILITIES, SHOWN OR NOT SHOWN, PRIOR TO DEMOLITION. CONTRACTOR SHALL HAVE ALL UTILITIES PROPERLY LOCATED PRIOR TO COMMENCEMENT OF DEMOLITION.
9. UNSUITABLE MATERIAL REMOVAL AND DISPOSAL. CONTRACTOR IS RESPONSIBLE FOR DETERMINATION/INVESTIGATION OF SUBSURFACE CONDITIONS. ALL UNSUITABLE MATERIAL SURFACE AND SUBSURFACE WITHIN AREAS OF CONSTRUCTION IS TO BE REMOVED AND DISPOSED OF IN ACCORDANCE WITH ALL APPLICABLE REGULATIONS. UNSUITABLE MATERIAL INCLUDES BUT IS NOT LIMITED TO: DEBRIS, ORGANICS/MUCK, AND PLASTIC MATERIAL. ALL UNSUITABLE MATERIAL REMOVED SHALL BE REPLACED WITH SUITABLE FILL MATERIALS.

ALL EXISTING UTILITIES SHOWN ON THESE PLANS ARE TO BE CONSIDERED APPROXIMATE AND SHOULD BE VERIFIED BY THE CONTRACTOR PRIOR TO THE START OF WORK OPERATIONS.



KNOW WHAT'S BELOW
ALWAYS CALL 811
BEFORE YOU DIG
It's fast. It's free. It's the law.

www.callsunshine.com

KS KEITH & SCHNARS
LB 1337

6500 NORTH ANDREWS AVENUE, FORT LAUDERDALE, FL 33309-2132 (954) 776-1616

| REV | DATE | DESCRIPTION |
|-----|----------|----------------|
| 1 | 03/27/19 | ADDENDUM NO. 4 |

DATE MARCH 26, 2018
SCALE 1" = 10'
DESIGNED BY B.Z.
DRAWN BY C.A.J.
CHECKED BY B.Z.

TERRAMAR PARK
PLAYGROUND IMPROVEMENTS
PARKLAND
FLORIDA

DEMOLITION PLAN

SHEET NO. D-1
PROJECT NO. 18245.03

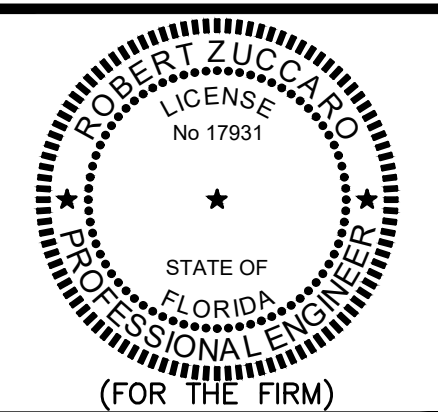

POUR-IN-PLACE SURFACING LAYOUT

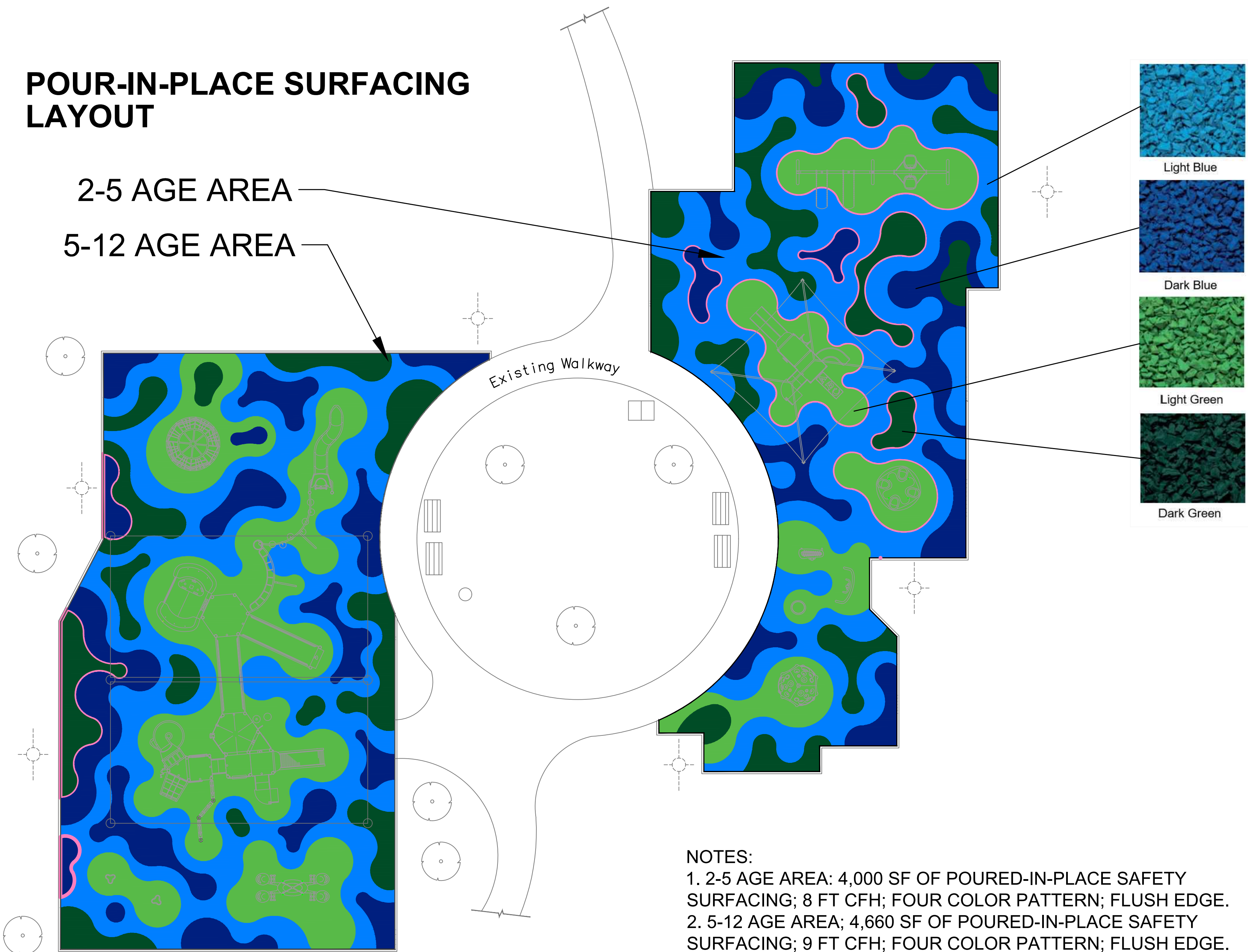

- NOTES:
- 1. 2-5 AGE AREA: 4,000 SF OF POURED-IN-PLACE SAFETY SURFACING; 8 FT CFH; FOUR COLOR PATTERN; FLUSH EDGE.
 - 2. 5-12 AGE AREA: 4,660 SF OF POURED-IN-PLACE SAFETY SURFACING; 9 FT CFH; FOUR COLOR PATTERN; FLUSH EDGE.

OR APPROVED EQUAL

CONTACT INFORMATION:
REP SERVICES, INC.
581 TECHNOLOGY PARK
STE 1009
LAKE MARY, FL 32746
DEBBIE LEVINE
561-353-0980

POUR-IN-PLACE SURFACING DETAILS

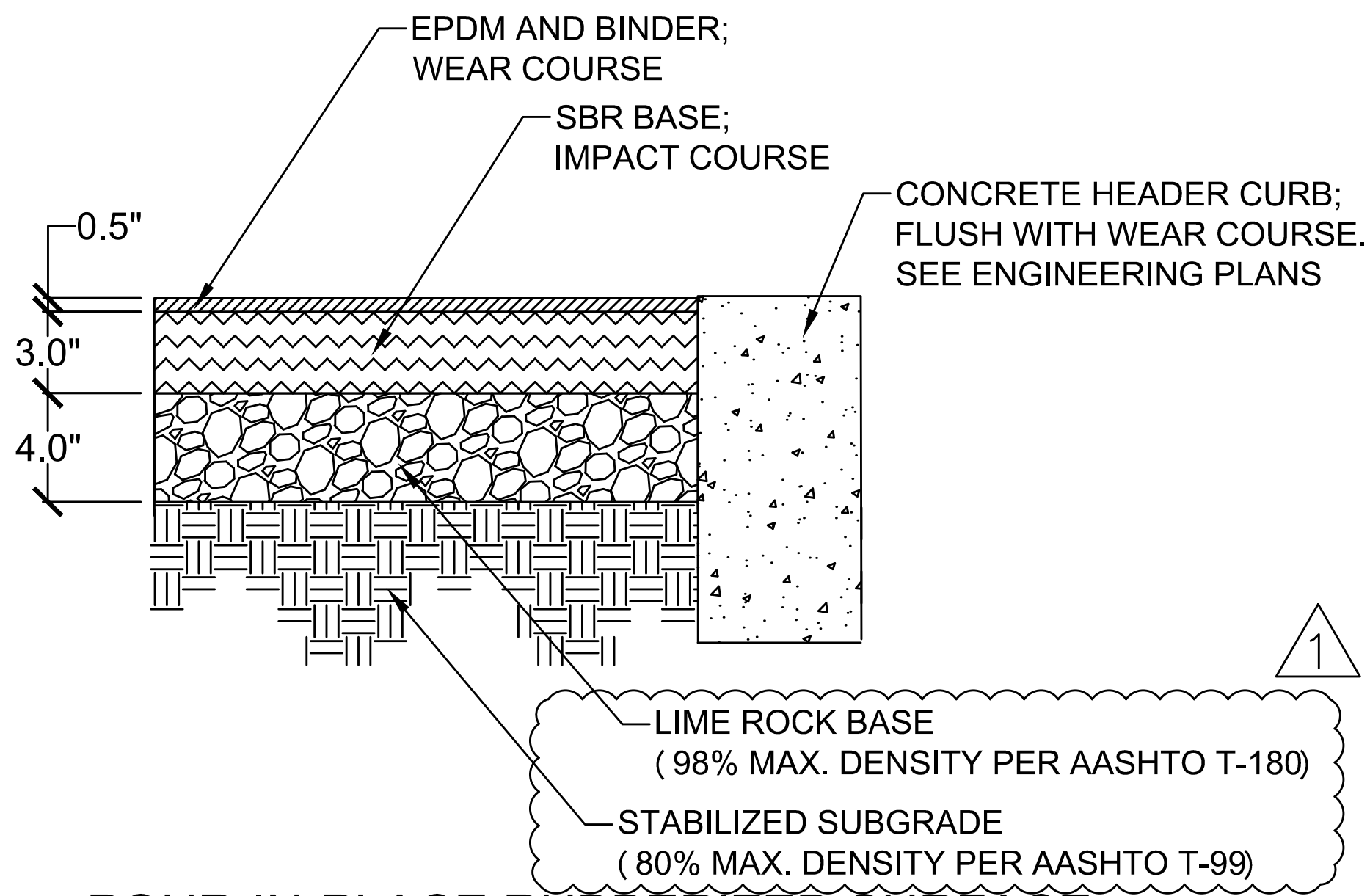

POUR-IN-PLACE RUBBERIZED SURFACE
2 TO 5 YR OLD AREA

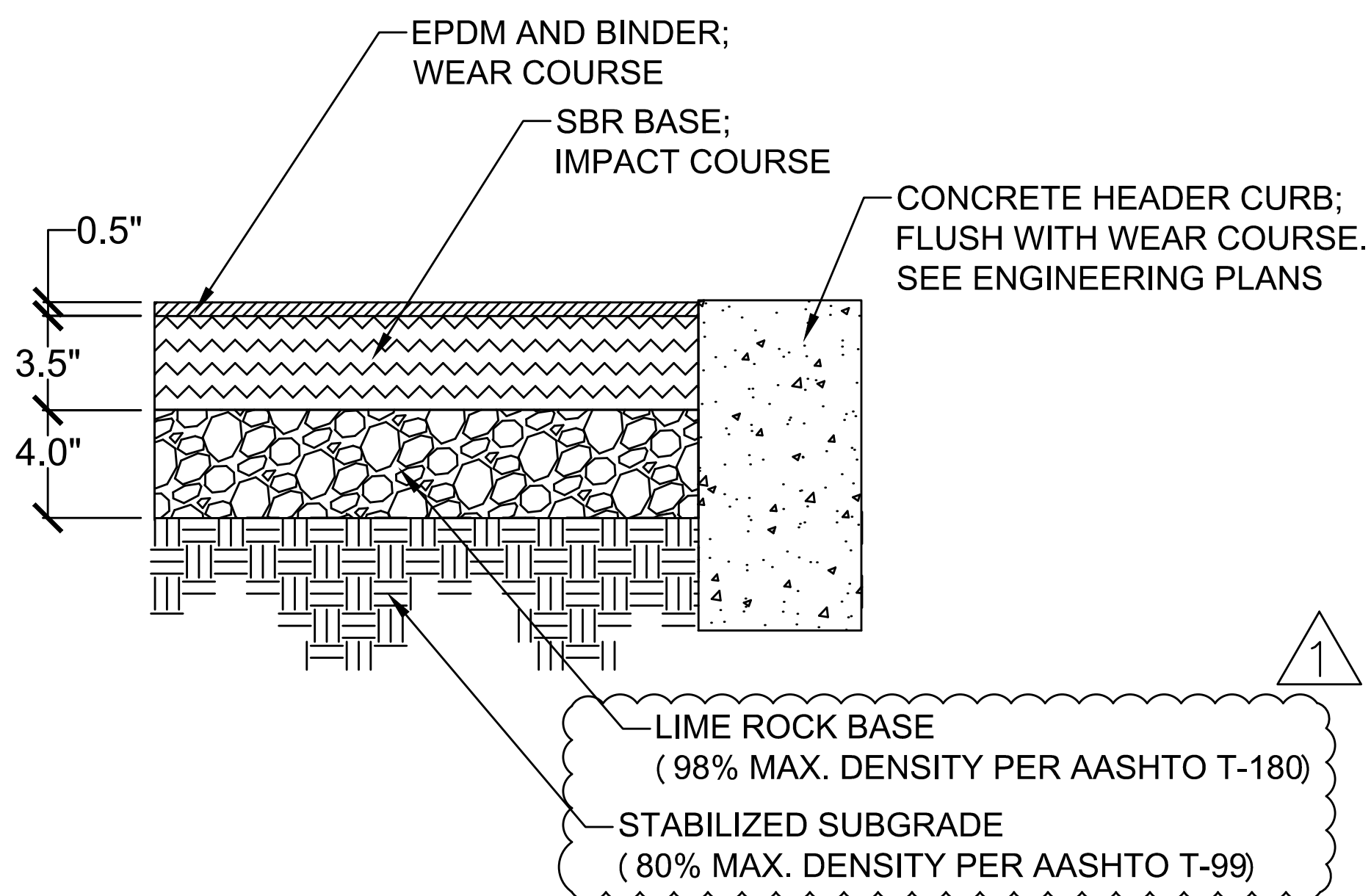

POUR-IN-PLACE RUBBERIZED SURFACE
5 TO 12 YR OLD AREA

BID SET

ALL EXISTING UTILITIES SHOWN ON THESE PLANS ARE TO BE CONSIDERED APPROXIMATE AND SHOULD BE VERIFIED BY THE CONTRACTOR PRIOR TO THE START OF WORK OPERATIONS.

811
KNOW WHAT'S BELOW
ALWAYS CALL 811
BEFORE YOU DIG
It's fast. It's free. It's the law.
www.callsunshine.com

KS KEITH & SCHNARS
LB 1337
6500 NORTH ANDREWS AVENUE, FORT LAUDERDALE, FL 33309-2132 (954) 776-1616

| REV | DATE | DESCRIPTION |
|-----|----------|----------------|
| 1 | 03/27/19 | ADDENDUM NO. 4 |

DATE: MARCH 26, 2018
SCALE: 1" = 10'
DESIGNED BY: A.N.
DRAWN BY: A.N.
CHECKED BY: C.M.

TERRAMAR PARK
PLAYGROUND IMPROVEMENTS
PARKLAND
FLORIDA

SITE AMENITIES PLAN
POUR-IN-PLACE LAYOUT

SHEET NO. LA-3
PROJECT NO. 18245.03

STATE OF FLORIDA
(FOR THE FIRM)

NOTES:

- ① PROPOSED 6" WIDE HEADER CURB TO MATCH EXISTING GRADE OF ASPHALT AT OUTER EDGE OF EXISTING WALKWAY, AND BE INSTALLED ONLY ADJACENT TO EXISTING ASPHALT WALKWAY.
- ①A ALL OTHER HEADER CURB TO BE 4" WIDE.
- ② THE ELEVATION OF THE EDGE OF THE EXISTING ASPHALT CIRCULAR WALKWAY WAS OBTAINED FROM PAUL E. BREWER & ASSOCIATES, INC. SURVEY DATED 1992 BASED ON NGVD 1929. ADJUSTMENTS HAVE BEEN MADE TO CONVERT PROPOSED ELEVATIONS TO NAVD 1988.
- ③ CONTRACTOR TO CONFIRM ELEVATIONS OF THE PROPOSED 4" AND 6" HEADER CURB PRIOR TO CONSTRUCTION. (FOR CONSTRUCTIBILITY)
- ④ CONTRACTOR TO GRADE THE PROPOSED RUBBERIZED SURFACE TO ACHIEVE A MIN. $\frac{1}{4}$ "/FT SLOPE TO DRAIN VIA SHEET FLOW IN THE EAST/WEST DIRECTION TO EXISTING OPEN AREAS AND OVERLAND FLOW INTO THE EXISTING DRAINAGE COLLECTION SYSTEM.
- ⑤ HEADER CURB ALONG CIRCULAR WALKWAY IS 6" AND HEADER CURB AROUND REMAINING PLAYGROUND AREA IS 4".
- ⑥ GEOMETRIC LAYOUT OF THE PROPOSED PLAYGROUND PERIMETER HEADER CURB TO MATCH THAT OF THE EXISTING HEADER CURB TO BE REMOVED.

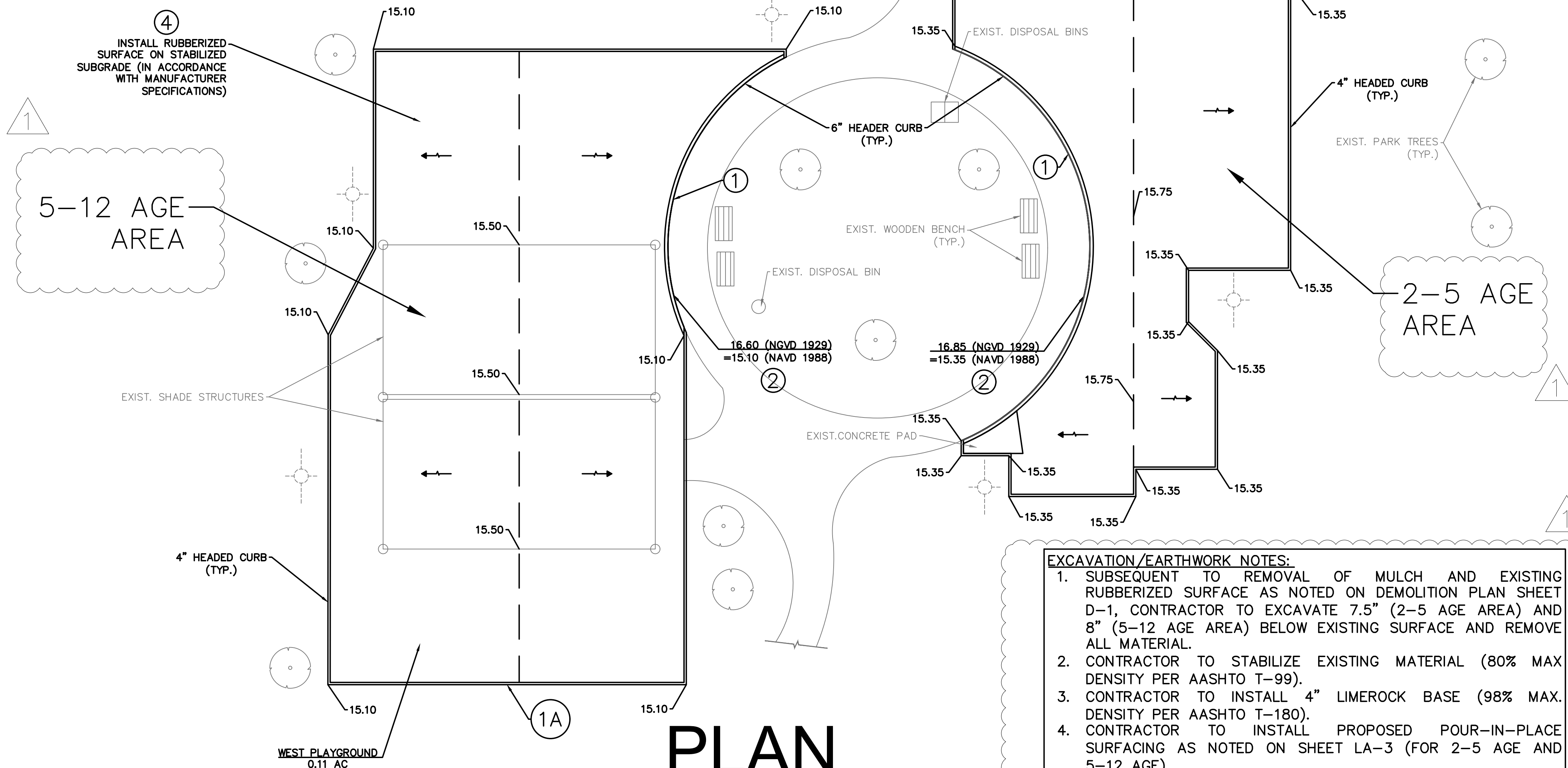

PLAN

SCALE: 1"=10'

- EXCAVATION/EARTHWORK NOTES:
- SUBSEQUENT TO REMOVAL OF MULCH AND EXISTING RUBBERIZED SURFACE AS NOTED ON DEMOLITION PLAN SHEET D-1, CONTRACTOR TO EXCAVATE 7.5" (2-5 AGE AREA) AND 8" (5-12 AGE AREA) BELOW EXISTING SURFACE AND REMOVE ALL MATERIAL.
 - CONTRACTOR TO STABILIZE EXISTING MATERIAL (80% MAX DENSITY PER AASHTO T-99).
 - CONTRACTOR TO INSTALL 4" LIMEROCK BASE (98% MAX. DENSITY PER AASHTO T-180).
 - CONTRACTOR TO INSTALL PROPOSED POUR-IN-PLACE SURFACING AS NOTED ON SHEET LA-3 (FOR 2-5 AGE AND 5-12 AGE).

ALL PLAN ELEVATIONS REFERENCED IN NAVD '88 (NGVD '29 = NAVD '88 + 1.545)

DRAINAGE ANALYSIS

| * PRE-CONSTRUCTION (ORIGINAL SWM PERMIT) | | | | |
|--|--------------------|------|------|-------|
| PLAYGROUND AREA (AC) | | WEST | EAST | TOTAL |
| IMPERVIOUS | RUBBERIZED SURFACE | 0.11 | 0.09 | |
| IMPERVIOUS TOTAL (AC) | | | | 0.20 |
| PERVIOUS | OPEN SPACE | 0.00 | 0.00 | |
| PERVIOUS TOTAL (AC) | | | | 0.00 |
| TOTAL AREA (AC) | | | | 0.20 |

* THE ENTIRE SURFACE AREA OF THE TWO (2) PLAYGROUND AREAS IN THE ORIGINAL SWM PERMIT HAD RUBBERIZED SURFACE. SFWM PERMIT #06-00622-S-10

| POST-CONSTRUCTION | | | | |
|-----------------------|--------------------|------|------|-------|
| PLAYGROUND AREA (AC) | | WEST | EAST | TOTAL |
| IMPERVIOUS | RUBBERIZED SURFACE | 0.11 | 0.09 | |
| IMPERVIOUS TOTAL (AC) | | | | 0.20 |
| PERVIOUS | OPEN SPACE | 0.00 | 0.00 | |
| PERVIOUS TOTAL (AC) | | | | 0.00 |
| TOTAL AREA (AC) | | | | 0.20 |

NOTE: THE RE-INSTALLATION OF RUBBERIZED SURFACE AND REPLACEMENT OF HEADER CURB WITH THE SAME GEOMETRIC CONFIGURATION IS CONSIDERED "MAINTENANCE CORRECTIVE MEASURES" AND DOES NOT REQUIRE SWM PERMITTING WITH ANY OF THE JURISDICTIONAL AGENCIES.

EXISTING GEOMETRIC LAYOUT IS APPROXIMATE. TOPOGRAPHIC SURVEY WAS NOT PROVIDED. CONTRACTOR TO FIELD VERIFY GEOMETRICS AND LOCATIONS OF PLAYGROUND EQUIPMENT AND COORDINATE WITH THE CITY PRIOR TO BIDDING.

BID SET

ALL EXISTING UTILITIES SHOWN ON THESE PLANS ARE TO BE CONSIDERED APPROXIMATE AND SHOULD BE VERIFIED BY THE CONTRACTOR PRIOR TO THE START OF WORK OPERATIONS.

811 KNOW WHAT'S BELOW ALWAYS CALL 811 BEFORE YOU DIG It's fast. It's free. It's the law. www.callsunshine.com

KS KEITH & SCHNARS LB 1337

6500 NORTH ANDREWS AVENUE, FORT LAUDERDALE, FL 33309-2132 (954)776-1616

| REV | DATE | DESCRIPTION |
|-----|----------|---------------|
| 1 | 03/27/19 | ADDENDUM NO.4 |

TERRAMAR PARK PLAYGROUND IMPROVEMENTS PARKLAND FLORIDA

PAVING AND GRADING PLAN

SHEET NO. C-2

PROJECT NO. 18245.03

ROBERT ZUCCARO LICENSE No 17931

STATE OF FLORIDA PROFESSIONAL ENGINEER (FOR THE FIRM)