

**SUPPLEMENTAL INFORMATION
ADDENDUM NO. 3**

PROJECT: ITB No. 19-008 - Fort Howard & Old Augusta Road Roundabout

CONTACT: Fiona Charleton, Purchasing Agent
912-754-2159 fcharleton@effinghamcounty.org

DATE ISSUED: July 3, 2019

ITB No. 19-008 dated June, 2019 is hereby amended as noted herein : BIDDER TO ACKNOWLEDGE RECEIPT OF ADDENDUM BY SIGNING ON THE SIGNATURE LINE BELOW AND INCLUDING A COPY WITH SUBMITTED BID. FAILURE TO DO SO MAY, AT THE OWNER'S DISCRETION, SUBJECT THE BIDDER TO DISQUALIFICATION

- 1) **QUESTION:** In the bid documents for this project under SCOPE OF WORK GENERAL INFORMATION ROAD PATCHING 5.a states that the patching operations will be paid at the unit price for Asphalt Concrete Patching, 12.5mm and shall cover all work required.
- a. Will the patching asphalt material truly be 12.5mm asphalt mix?
 - b. Since there is an established patching pay item, would the county please clarify if the note listed above is incorrect?

ANSWER:

- a. No. Shall be 8" Portland cement concrete; topped with bituminous tack coat and then overlain w/ 12.5 MM surface course like the rest of the intersection.
- b. Note above is incorrect.

- 2) **QUESTION:** In the plans general note number 2 states that drives shall be constructed with 165 lb/sy of 12.5mm asphalt. The summary of quantities page shows 60 tons of 19.0mm to be placed on drives.
- a. Would the county please clarify if the drives will only require 12.5mm asphalt over GAB or both 12.5mm and 19.0mm asphalt over GAB?
 - b. If the 19.0mm is not required on the drives, would the county please adjust the 19.0mm asphalt to reflect this deduct?

ANSWER:

- a. See note on sheet 5-01. Only 12.5 MM superpave (1.5") is required for drives only to be overlain. Full depth pavement drives shall mirror cross section thickness for typical section #1.
- b. See item 2a.

- 3) **QUESTION:** In the plans all three typical sections for this project do not reference placing any 25.0mm asphalt (D, E). The summary of quantities page shows 630 tons of 25.0mm to be placed on the project. Would the county please clarify if the typical sections are correct in stating that no 25.0mm is required, however if this mix is required would the county please revise the typicals to reflect as such?

ANSWER: For typical sections 2 and 3, the bottom asphalt layer letter should be "D" (25 MM asphalt), not "C" (more 19 MM asphalt). Typical section can be found at the end of the Addendum.

- 4) **QUESTION:** Is the County requiring two (2) originals/signed bid documents, or 1 original and 1 copy?

ANSWER: One (1) original and one (1) copy.

- 5) QUESTION: Do we submit the Bid Documents/Checklist/Attachments only or do we need to include the contract documents as well with our bid?
ANSWER: The county requires the bid, the contract documents, and all requested forms and attachments.
- 6) QUESTION: On Attachment H – List of Subcontractor (page 01150-13), it calls for DBE identification. Are there any DBE requirements for this project? I did not locate any in the Bidding Documents.
ANSWER: No there are no DBE requirements for this project.
- 7) QUESTION: Is there certified payroll on this project?
ANSWER: No.
- 8) QUESTION: Is the Drug Free –Attachment A form required at the time of the Bid from our Subcontractors quoting us?
ANSWER: No, Attachment A – Drug Free Affidavit can be requested from subcontractors upon award of contract. Awarded contractor MUST have all necessary forms from subcontractors before commencing work.
- 9) QUESTION: There is a Bid Item for the relocation of UGT. On sheet 9-01 it is indicated that this work will be performed by others. This is typically work that the utility owner will perform. If that is the case, can this item be removed from the Bid Form
ANSWER: The intent is to allow for costs for coordinative efforts with these utility contractors. The word “coordination” will be added to these line items.
- 10) QUESTION: Please review the storm pipe schedule and revise quantities as needed. Sheet 6-01 lists 32’ of 18” RCP at station 23+00, but I cannot locate this pipe. Also seems that the 24” RCP has been left off the Bid Form.
ANSWER: The 32’ of 18” RCP is a driveway pipe that is shown as approximately located on sheet 15-02, though it was not labeled. The pipe will be labeled on this sheet. You are correct about the 24” RCP; it and the corresponding FES will be added to the bid form.
- 11) QUESTION: Do you know the size of the existing water line that will have to be adjusted? I don’t see it labeled anywhere on the plans.
ANSWER: The Engineer who designed the water line believes it to be 10” in size.
- 12) QUESTION: Is the water line relocation bid item simply for lowering the line so that it doesn’t interfere with the new storm and road construction?
ANSWER: That is correct; primarily that it doesn’t interfere with storm construction.
- 13) QUESTION: Is the existing pavement section for Ft Howard and Old Augusta the same as the proposed sections? Trying to figure out how much asphalt and stone we will have to demo out.
ANSWER: Existing Fort Howard Road should have the same binder and surface course but GAB is only 8” thick (per Moreland Altobelli design plans). Old Augusta Road should have the same pavement thickness (per Moreland Altobelli design plans).
- 14) QUESTION: Can the stone removed from the existing section be used for the new construction, or do we need to plan on hauling in new stone?
ANSWER: Removed stone may be used only if gradation complies with GDOT standard.

- 15) **QUESTION:** There is a Bid Item for Unsuitable Materials. Should the unit price for this item include the backfill material, or should that cost go in the Grading Complete item? Is this item for only the removal of unsuitables?
ANSWER: This line item may or may not be used in the project, depending on actual conditions. The following is a more accurate description of how payment is to be rendered for this item: No payment will be made for unsuitable soils unless the measurement is made by the Engineer or his representative. Payment for excavation of unsuitable materials and replacement with suitable soil under these specifications shall be made for the quantities determined in the manner specified herein at the unit price per cubic yard as stated in the Bid Schedule. The amount so paid shall be full compensation for furnishing all labor, materials, tools, and equipment and other work in connection with or incidental to the construction of the bid item. Payment shall include removal costs, hauling costs, disposal costs, purchase of soil, loading of soil, placement of soil and the compaction of the soil and any other costs associated with removing and replacing the soil.
- 16) **QUESTION:** The intersection can be closed down for 45 days, but can temp lane closures be installed during Phase 1 of construction?
ANSWER: Single lane closure will be acceptable based upon prior approval of traffic control plans submitted by the contractor. Number of occurrences and duration of closure shall be included with traffic plan submittal.
- 17) **QUESTION:** Pay items 652 call for paint, but the Supplemental Conditions call for 653 items which are thermo. Can you please verify which will be required? .
ANSWER: Thermo
- 18) **QUESTION:** Have there been recent utility installations that would impact the project?
ANSWER: Windstream has apparently recently installed a fiber optics line and accompanying utility boxes that will impact the project. The line and amenities and how this impacts the project is now shown on the plans. The contractor should figure the coordination required for these items into his UGT coordination line item price.
- 19) **QUESTION:** What type of Traffic Delineators need to be priced.
ANSWER: Please price for Type 2.
- 20) **QUESTION:** Is any clearing required?
ANSWER: No. The ROW corridor is completely cleared of trees.
- 21) **QUESTION:** In stage 2 and 3, can the whole intersection be closed for 45 days, day and night?
ANSWER: Yes – a **MAXIMUM** of 45 days.
- 22) **QUESTION:** Regarding item # 656-9999 for Highway Rumble Strips and note #4 on detail T-19, can ReflectORIZED Thermoplastic be used in lieu of asphalt?
ANSWER: Yes
- 23) **QUESTION:** Please clarify the pricing for Item No. 999-9999 Relocate Existing UGT. We do not perform any work for the telephone, gas, or power companies. Typically the general contractor will just coordinate any needed work with the telephone company (or with the power or gas companies) that is in conflict with the new work to be done and the local municipality will work directly with the utility company for any payment that may or may not be required.
ANSWER: Please see question 9 or 18.

Per Addendum 1, GENERAL CONSTRUCTION GUIDELINES on page 01210-2 was amended to read:

GENERAL CONSTRUCTION GUIDELINES

1. The General Contractor *or Sub-Contractor* shall be required to perform 100% of the actual resurfacing paving work, and will not be allowed to sublet this item. Contractor must demonstrate successful experience in placing at least 25,000 tons of surface mix using their own labor and equipment over the past 5 years, with at least 5,000 tons being on a single project. Subletting of the additional items (milling, surface treatment, structure adjustment, crack filling, surface treatment, etc.) shall be in accordance with Section 108.01 of the Standard Specifications of the Georgia Department of Transportation.

Please amend to read:

GENERAL CONSTRUCTION GUIDELINES

1. The General Contractor *or Sub-Contractor* shall be required to perform 100% of the actual resurfacing paving work, and will not be allowed to sublet this item. Contractor *or Sub-Contractor* must demonstrate successful experience in placing at least 25,000 tons of surface mix using their own labor and equipment over the past 5 years, with at least 5,000 tons being on a single project. Subletting of the additional items (milling, surface treatment, structure adjustment, crack filling, surface treatment, etc.) shall be in accordance with Section 108.01 of the Standard Specifications of the Georgia Department of Transportation.

THIS SECTION INTENTIONALLY LEFT BLANK

Please replace bid form pages 01250-3 to 01250-4 and Agreement between owner and contractor pages 01350-2 to 01350-3 with those attached below:

ARTICLE 5 – CONTRACT PRICE

5.01 Owner shall pay Contractor for completion of the Work in accordance with the Contract Documents an amount in current funds equal to the sum of the amounts determined pursuant to Paragraphs 5.01.A, below:

For all Unit Price Work, an amount equal to the sum of the established unit price for each separately identified item of Unit Price Work times the actual quantity of that item:

ITEM NO.	DESCRIPTION - ROADWAY	UNITS	ESTIMATED QUANTITY	BID UNIT PRICE	BID PRICE
149-1000	CONSTRUCTION LAYOUT	LUMP	LUMP	\$	\$
150-1000	TRAFFIC CONTROL	LUMP	LUMP	\$	\$
163-0550	INLET SEDIMENT TRAP	EA	4	\$	\$
210-0100	GRADING COMPLETE	LUMP	LUMP	\$	\$
210-9998	ASPHALT MILLING	LUMP	LUMP	\$	\$
210-9999	UNSUITABLE MATERIALS	CY	500	\$	\$
310-5080	GR AGGR BASE CRS 10 IN., INCL MATL	SY	5,550	\$	\$
402-1801	RECYCLED ASPH CONC PATCHING, INCL BITUM MATL	TN	50	\$	\$
402-1812	RECYCLED ASPH CONC LEVELING, INCL BITUM MATL & H LIME	TN	250	\$	\$
402-3121	RECYCLED ASPH CONC 25 MM SUPERPAVE, GP 1 OR 2, INCL BITUM MATL & H LIME	TN	630	\$	\$
402-3190	RECYCLED ASPH CONC 19 MM SUPERPAVE, GP 1 OR 2, INCL BITUM MATL & H LIME	TN	550	\$	\$
402-3130	RECYCLED ASPH CONC 12.5 MM SUPERPAVE, GP 2 ONLY, INCL BITUM MATL & H LIME	TN	550	\$	\$
413-1000	BITUM TACK COAT	GL	555	\$	\$
441-5002	HEADER CURB TP 7	LF	1320	\$	\$
441-5002	HEADER CURB TP 9	LF	345	\$	\$
441-0748	CONCRETE MEDIAN, 6 IN	SY	400	\$	\$
550-1180	STORM DRAIN PIPE, 18 IN, H 1-10	LF	477	\$	\$
550-4218	FLARED END SECTION 18 IN, STORM DRAIN	EA	8	\$	\$
550-1240	STORM DRAIN PIPE, 24 IN, H 1-10	LF	56	\$	\$
550-4224	FLARED END SECTION 24 IN, STORM DRAIN	EA	2	\$	\$
609-1000	PAVEMENT DEMOLITION	SY	4700	\$	\$
668-2110	DROP INLET	EA	5	\$	\$
439-0052	TRUCK APRON 10 IN THK SY	SY	345	\$	\$
441-6222	CONCRETE CURB AND GUTTER 6X30 IN	LF	1270	\$	\$
TOTAL OF ROADWAY BID PRICES					\$

ITEM NO.	DESCRIPTION – EROSION CONTROL	UNITS	ESTIMATED QUANTITY	BID UNIT PRICE	BID PRICE
603-2181	STN DUMPED RIP RAP, TP 3, 18 IN	SY	20	\$	\$
603-7000	PLASTIC FILTER FABRIC	SY	20	\$	\$
700-6910	GRASSING AC	AC	1	\$	\$
700-7000	AGRICULTURAL LIME	TN	2	\$	\$
700-8000	FERTILIZER MIXED GRADE	TN	2	\$	\$
TOTAL OF EROSION CONTROL BID PRICES					\$

ITB No. 19-008 – Fort Howard & Old Augusta Road Roundabout

ITEM NO.	DESCRIPTION – TEMPORARY EROSION CONTROL	UNITS	ESTIMATED QUANTITY	BID UNIT PRICE	BID PRICE
160-1000	EROSION CONTROL	LS	LUMP	\$	\$
167-1000	WATER QUALITY MONITORING AND SAMPLING	EA	6	\$	\$
167-1500	WATER QUALITY INSPECTIONS	MO	6	\$	\$
171-0300	TEMPORARY SILT FENCE, TYPE A	LF	1750	\$	\$
TOTAL OF TEMPORARY EROSION CONTROL BID PRICES					\$

ITEM NO.	DESCRIPTION – SIGNING AND STRIPING	UNITS	ESTIMATED QUANTITY	BID UNIT PRICE	BID PRICE
636-1033	HIGHWAY SIGNS, TP 1 MATL, REFL SHEETING, TP 9	SF	300	\$	\$
636-2080	GALV STEEL POSTS, TP 8	LF	400	\$	\$
652-5451	SOLID TRAFFIC STRIPE, 5 IN, WHITE	LF	2600	\$	\$
652-5452	SOLID TRAFFIC STRIPE, 5 IN, YELLOW	LF	4200	\$	\$
652-6505	SKIP TRAFFIC STRIPE, 18 IN, WHITE	GLF	110	\$	\$
653-1804	SOLID TRAFFIC STRIPE, 8 IN, WHITE	LF	1850	\$	\$
653-6004	THERMO PLAST TRAF STRIPING, WHITE	SY	1900	\$	\$
653-6006	THERMO PLAST TRAF STRIPING, YELLOW	SY	40	\$	\$
654-1001	RAISED PVMT MARKERS, TP 1	EA	80	\$	\$
656-5000	REMOVE EXIST TRAF MARKINGS	LUMP	LUMP	\$	\$
656-9999	HIGHWAY RUMBLE STRIPS	EA	8	\$	\$
656-9998	TRAFFIC DELINEATORS, TYPE 2	EA	500		
653-0400	THERMOPLASTIC PAVEMENT MARKING, WORD, TP 15 (YIELD)	EA	4	\$	\$
TOTAL OF SIGNING AND STRIPING BID PRICES					\$

ITEM NO.	DESCRIPTION – UTILITY RELOCATION	UNITS	ESTIMATED QUANTITY	BID UNIT PRICE	BID PRICE
999-9998	RELOCATE EX WATER MAIN	EA	1	\$	\$
999-9999	RELOCATE EX. UGT - COORDINATION	EA	1	\$	\$
TOTAL OF UTILITY BID PRICES					\$

ITEM NO.	DESCRIPTION – GENERAL	UNITS	ESTIMATED QUANTITY	BID UNIT PRICE	BID PRICE
100-9999	MOBILIZATION/DEMobilIZATION	LUMP	LUMP	\$	\$
1000-9998	TESTING	LUMP	LUMP	\$	\$
TOTAL OF GENERAL PRICES					\$
TOTAL OF ALL BID PRICES					\$

Bidder acknowledges that estimated quantities are not guaranteed, and are solely for the purpose of comparison of Bids, and final payment for all unit price Bid items will be based on actual quantities, determined as provided in the Contract Documents.

ARTICLE 5 – CONTRACT PRICE

5.01 Owner shall pay Contractor for completion of the Work in accordance with the Contract Documents an amount in current funds equal to the sum of the amounts determined pursuant to Paragraphs 5.01.A, below *For all Unit Price Work, an amount equal to the sum of the established unit price for each separately identified item of Unit Price Work times the actual quantity of that item:*

ITEM NO.	DESCRIPTION - ROADWAY	UNITS	ESTIMATED QUANTITY	BID UNIT PRICE	BID PRICE
149-1000	CONSTRUCTION LAYOUT	LUMP	LUMP	\$	\$
150-1000	TRAFFIC CONTROL	LUMP	LUMP	\$	\$
163-0550	INLET SEDIMENT TRAP	EA	4	\$	\$
210-0100	GRADING COMPLETE	LUMP	LUMP	\$	\$
210-9998	ASPHALT MILLING	LUMP	LUMP	\$	\$
210-9999	UNSUITABLE MATERIALS	CY	500	\$	\$
310-5080	GR AGGR BASE CRS 10 IN., INCL MATL	SY	5,550	\$	\$
402-1801	RECYCLED ASPH CONC PATCHING, INCL BITUM MATL	TN	50	\$	\$
402-1812	RECYCLED ASPH CONC LEVELING, INCL BITUM MATL & H LIME	TN	250	\$	\$
402-3121	RECYCLED ASPH CONC 25 MM SUPERPAVE, GP 1 OR 2, INCL BITUM MATL & H LIME	TN	630	\$	\$
402-3190	RECYCLED ASPH CONC 19 MM SUPERPAVE, GP 1 OR 2, INCL BITUM MATL & H LIME	TN	550	\$	\$
402-3130	RECYCLED ASPH CONC 12.5 MM SUPERPAVE, GP 2 ONLY, INCL BITUM MATL & H LIME	TN	550	\$	\$
413-1000	BITUM TACK COAT	GL	555	\$	\$
441-5002	HEADER CURB TP 7	LF	1320	\$	\$
441-5002	HEADER CURB TP 9	LF	345	\$	\$
441-0748	CONCRETE MEDIAN, 6 IN	SY	400	\$	\$
550-1180	STORM DRAIN PIPE, 18 IN, H 1-10	LF	477	\$	\$
550-4218	FLARED END SECTION 18 IN, STORM DRAIN	EA	8	\$	\$
550-1240	STORM DRAIN PIPE, 24 IN, H 1-10	LF	56	\$	\$
550-4224	FLARED END SECTION 24 IN, STORM DRAIN	EA	2	\$	\$
609-1000	PAVEMENT DEMOLITION	SY	4700	\$	\$
668-2110	DROP INLET	EA	5	\$	\$
439-0052	TRUCK APRON 10 IN THK SY	SY	345	\$	\$
441-6222	CONCRETE CURB AND GUTTER 6X30 IN	LF	1270	\$	\$
TOTAL OF ROADWAY BID PRICES					\$

ITEM NO.	DESCRIPTION – EROSION CONTROL	UNITS	ESTIMATED QUANTITY	BID UNIT PRICE	BID PRICE
603-2181	STN DUMPED RIP RAP, TP 3, 18 IN	SY	20	\$	\$
603-7000	PLASTIC FILTER FABRIC	SY	20	\$	\$
700-6910	GRASSING AC	AC	1	\$	\$
700-7000	AGRICULTURAL LIME	TN	2	\$	\$
700-8000	FERTILIZER MIXED GRADE	TN	2	\$	\$
TOTAL OF EROSION CONTROL BID PRICES					\$

ITEM NO.	DESCRIPTION – TEMPORARY EROSION CONTROL	UNITS	ESTIMATED QUANTITY	BID UNIT PRICE	BID PRICE
160-1000	EROSION CONTROL	LS	LUMP	\$	\$
167-1000	WATER QUALITY MONITORING AND SAMPLING	EA	6	\$	\$
167-1500	WATER QUALITY INSPECTIONS	MO	6	\$	\$
171-0300	TEMPORARY SILT FENCE, TYPE A	LF	1750	\$	\$
TOTAL OF TEMPORARY EROSION CONTROL BID PRICES					\$

ITEM NO.	DESCRIPTION – SIGNING AND STRIPING	UNITS	ESTIMATED QUANTITY	BID UNIT PRICE	BID PRICE
636-1033	HIGHWAY SIGNS, TP 1 MATL, REFL SHEETING, TP 9	SF	300	\$	\$
636-2080	GALV STEEL POSTS, TP 8	LF	400	\$	\$
652-5451	SOLID TRAFFIC STRIPE, 5 IN, WHITE	LF	2600	\$	\$
652-5452	SOLID TRAFFIC STRIPE, 5 IN, YELLOW	LF	4200	\$	\$
652-6505	SKIP TRAFFIC STRIPE, 18 IN, WHITE	GLF	110	\$	\$
653-1804	SOLID TRAFFIC STRIPE, 8 IN, WHITE	LF	1850	\$	\$
653-6004	THERMO PLAST TRAF STRIPING, WHITE	SY	1900	\$	\$
653-6006	THERMO PLAST TRAF STRIPING, YELLOW	SY	40	\$	\$
654-1001	RAISED PVMT MARKERS, TP 1	EA	80	\$	\$
656-5000	REMOVE EXIST TRAF MARKINGS	LUMP	LUMP	\$	\$
656-9999	HIGHWAY RUMBLE STRIPS	EA	8	\$	\$
656-9998	TRAFFIC DELINEATORS, TYPE 2	EA	500		
653-0400	THERMOPLASTIC PAVEMENT MARKING, WORD, TP 15 (YIELD)	EA	4	\$	\$
TOTAL OF SIGNING AND STRIPING BID PRICES					\$

ITEM NO.	DESCRIPTION – UTILITY RELOCATION	UNITS	ESTIMATED QUANTITY	BID UNIT PRICE	BID PRICE
999-9998	RELOCATE EX WATER MAIN	EA	1	\$	\$
999-9999	RELOCATE EX. UGT - COORDINATION	EA	1	\$	\$
TOTAL OF UTILITY BID PRICES					\$

ITEM NO.	DESCRIPTION – GENERAL	UNITS	ESTIMATED QUANTITY	BID UNIT PRICE	BID PRICE
100-9999	MOBILIZATION/DEMObILIZATION	LUMP	LUMP	\$	\$
1000-9998	TESTING	LUMP	LUMP	\$	\$
TOTAL OF GENERAL PRICES					\$
TOTAL OF ALL BID PRICES					\$

Bidder acknowledges that estimated quantities are not guaranteed, and are solely for the purpose of comparison of Bids, and final payment for all unit price Bid items will be based on actual quantities, determined as provided in the Contract Documents.

Addendum No.3
ITB No. 19-008 - Fort Howard & Old Augusta Road Roundabout

All other terms and conditions in ITB 19-008 remain unchanged.

Effingham County reserves the right to reject any and all proposals, to waive any technicalities or irregularities and to award the offer based upon the most responsive, responsible submission.

Please sign receipt of this Addendum No. 3 below:

Print Name	Signature	Date
------------	-----------	------

END OF ADDENDUM NO. 3

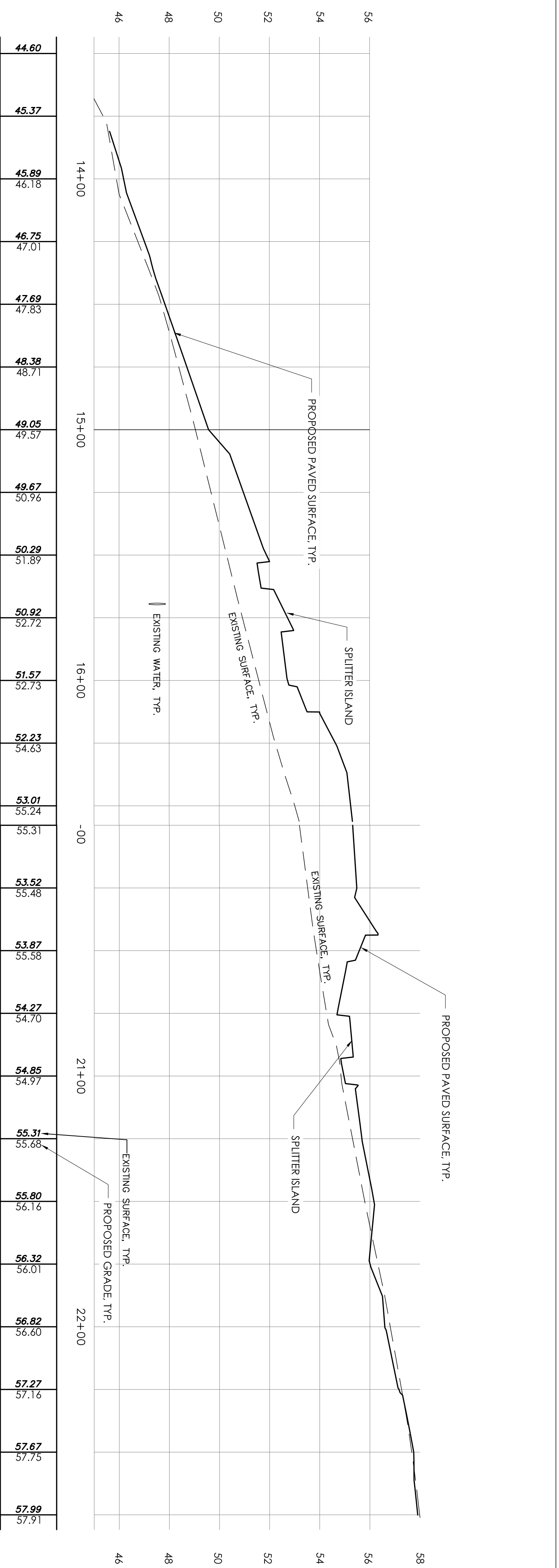
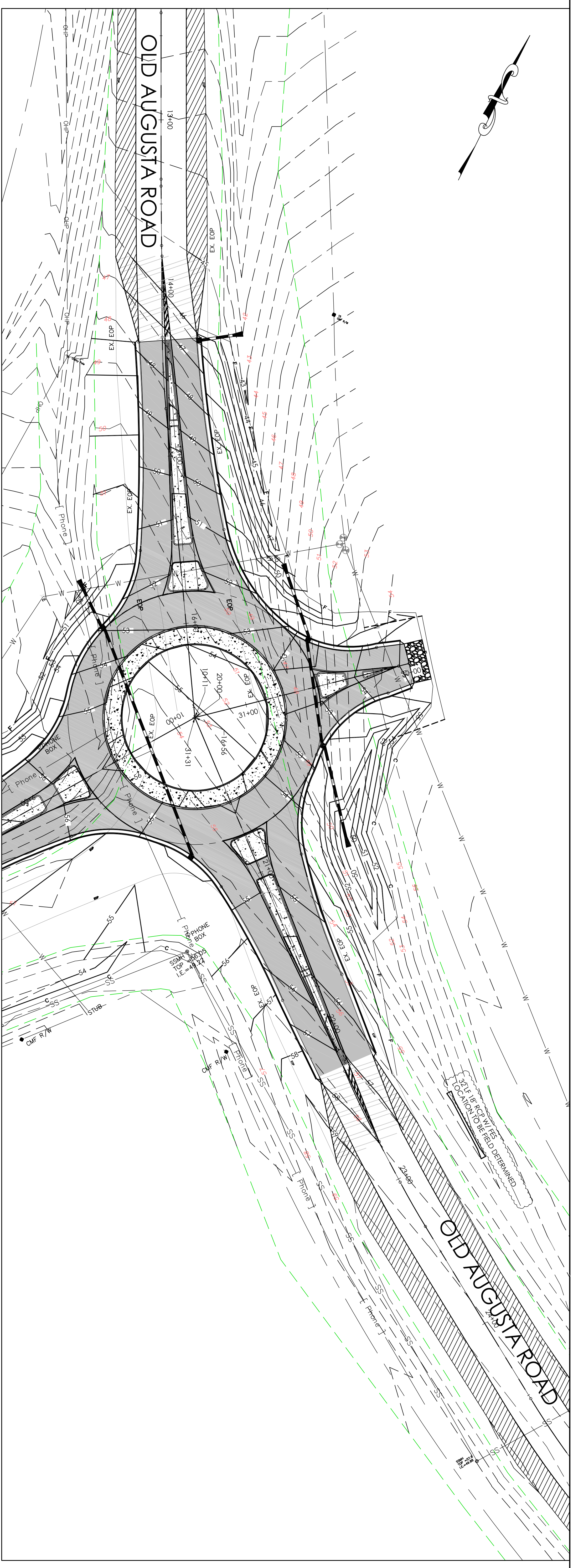

OLD AUGUSTA ROAD PROFILE

SCALE (HORIZ): 1" = 30'
SCALE (VERT): 1" = 3'

REQUIRED R/W LINE
CONSTRUCTION LIMITS
EASEMENT FOR CONSTRUCTION
& MAINTENANCE OF SLOPES
EASEMENT FOR CONSTR. OF SLOPES
EASEMENT FOR CONSTR. OF DRIVES

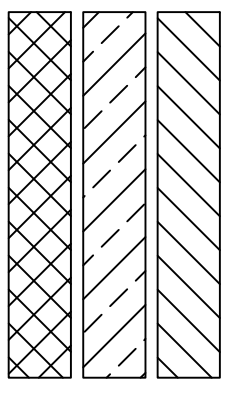

36 COURTLAND STREET, SUITE B
STATESBORO, GEORGIA 30458
PHONE: 912-764-7722



EFFINGHAM COUNTY
BOARD OF COMMISSIONERS
309 HIGHLAND 115 SOUTH
SPRINGFIELD, GA 31329
PH: (912) 754-2141
FX: (912) 754-9959



REVISION	DATE	DESCRIPTION

CONSTRUCTION PLAN AND PROFILE
FORT HOWARD ROAD/OLD
AUGUSTA ROAD ROUNDABOUT

SHEET NO. 9 / 47
DRAWING NO. 15-02

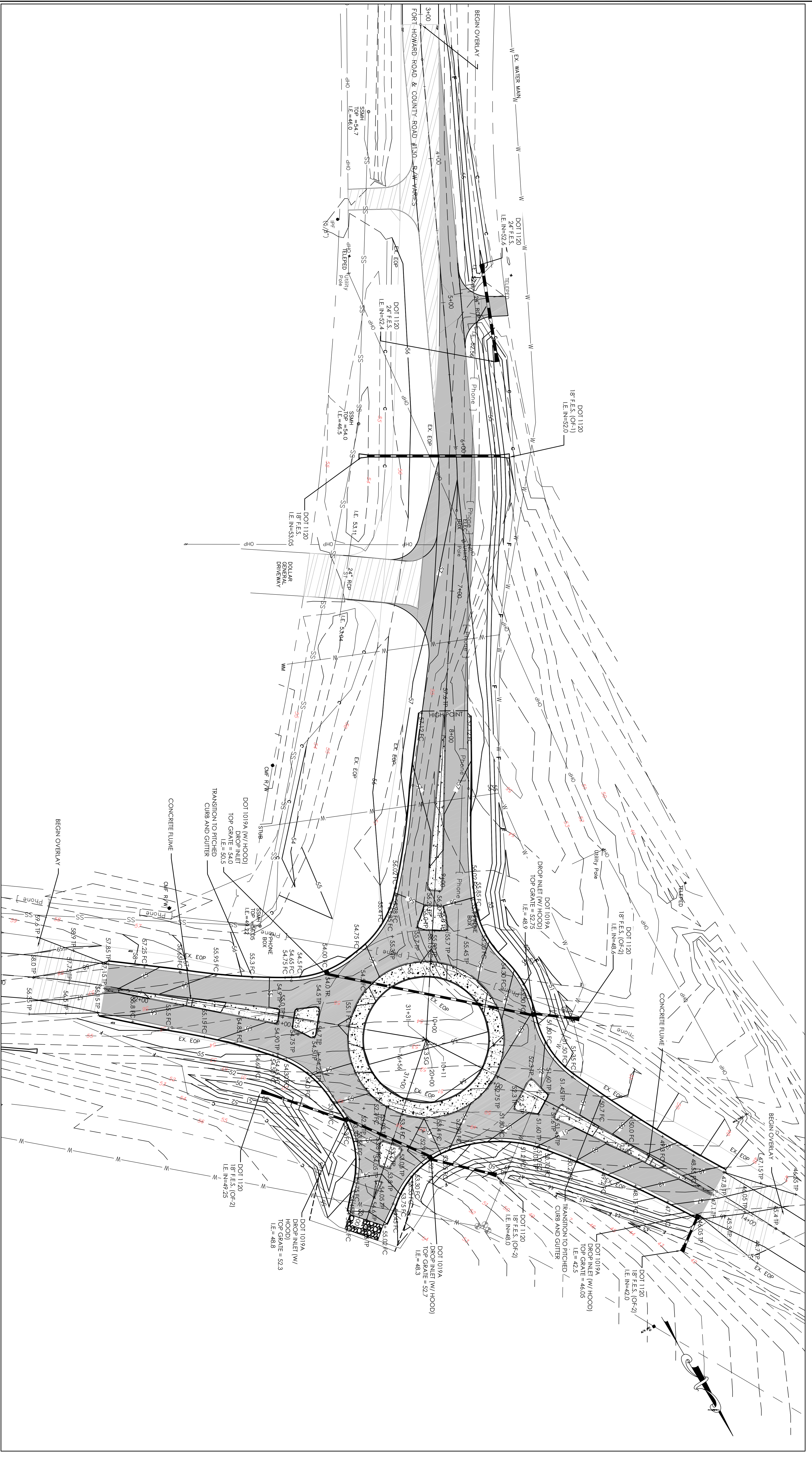

POINTS LEGEND

FC	FRONT OF CURB
TP	TOP OF PAVEMENT
SG	SPOT GRADE

REQUIRED R/W LINE
 CONSTRUCTION LIMITS
 EASEMENT FOR CONSTRUCTION
 & MAINTENANCE OF SLOPES
 EASEMENT FOR CONSTR. OF SLOPES
 EASEMENT FOR CONSTR. OF DRIVES

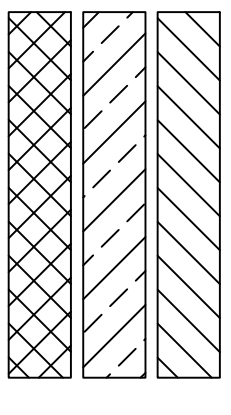

36 COURTLAND STREET, SUITE B
 STATESBORO, GEORGIA 30458
 PHONE: 912-764-7722



EFFINGHAM COUNTY
 BOARD OF COMMISSIONERS
 309 HIGHLAND 115 SOUTH
 SPRINGFIELD, GA 31292
 PH: (912) 754-2141
 FX: (912) 754-9959

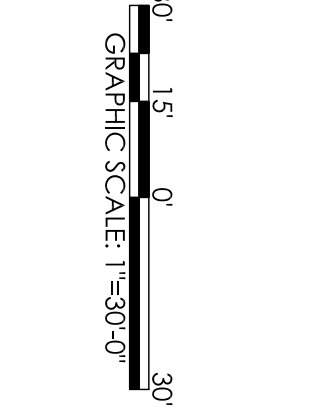

REVISION DATES

SPECIAL GRADING PLAN
 FORT HOWARD ROAD/OLD
 AUGUSTA ROAD ROUNDABOUT

SHEET NO. 11 / 47
 DRAWING NO. 18-01

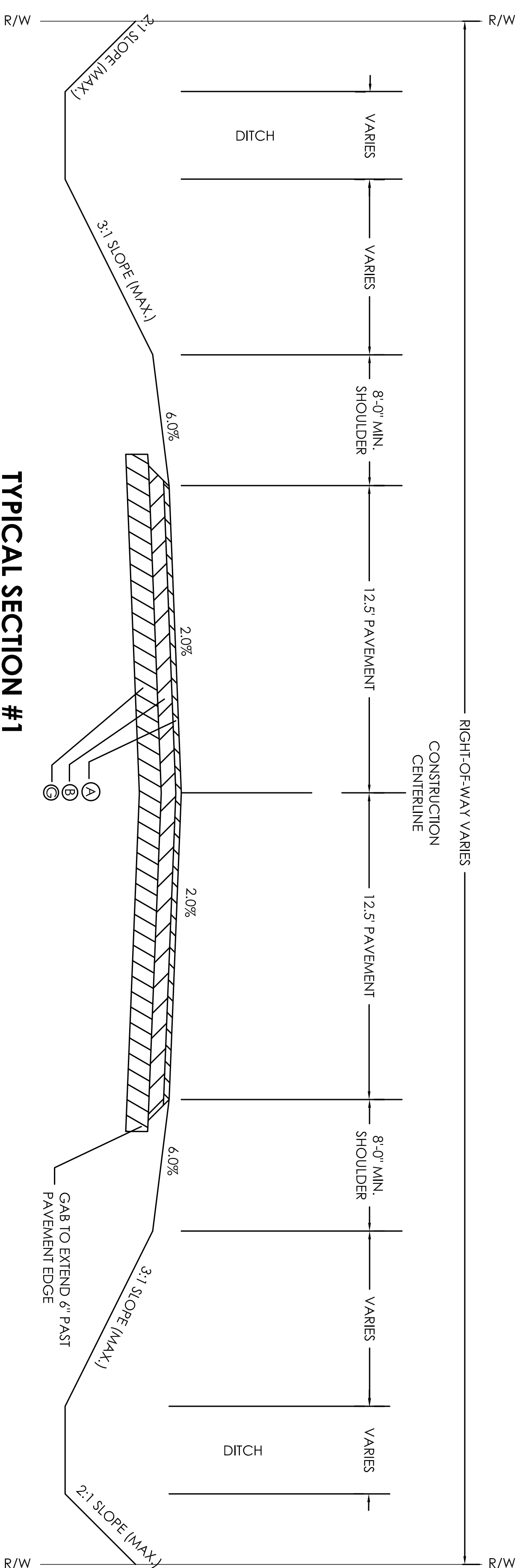

TYPICAL SECTION #1

THIS SECTION APPLIES FROM STA. 3+07 TO STA. 7+36 FORT HOWARD ROAD

NOTE: THE FULL DEPTH PAVEMENT DRIVEWAYS SHALL HAVE THE SAME CROSS SECTION THICKNESSES SHOWN ABOVE. OVERLAIN DRIVEWAYS SHALL UTILIZE 12.5 MM SUPERPAVE (1.5").

A	165 LBS./SQ. YD. RECYCLED ASPH. CONC. 12.5 MM SUPERPAVE GP 2 ONLY, INCL BITUM MATL & H LIME
B	220 LBS./SQ. YD. RECYCLED ASPH. CONC. 19 MM SUPERPAVE GP 1 OR 2, INCL BITUM MATL & H LIME
C	440 LBS./SQ. YD. RECYCLED ASPH. CONC. 19 MM SUPERPAVE GP 1 OR 2, INCL BITUM MATL & H LIME
D	440 LBS./SQ. YD. RECYCLED ASPH. CONC. 25 MM SUPERPAVE GP 1 OR 2, INCL BITUM MATL & H LIME
E	660 LBS./SQ. YD. RECYCLED ASPH. CONC. 25 MM SUPERPAVE GP 1 OR 2, INCL BITUM MATL & H LIME
F	8" GAB, INCL MATL
G	10" GAB, INCL MATL
H	MINI, 100 LBS./SQ. YD. LEVELING, AS REQUIRED
J	660 LBS./SQ. YD. OF PATCHING, AS REQUIRED

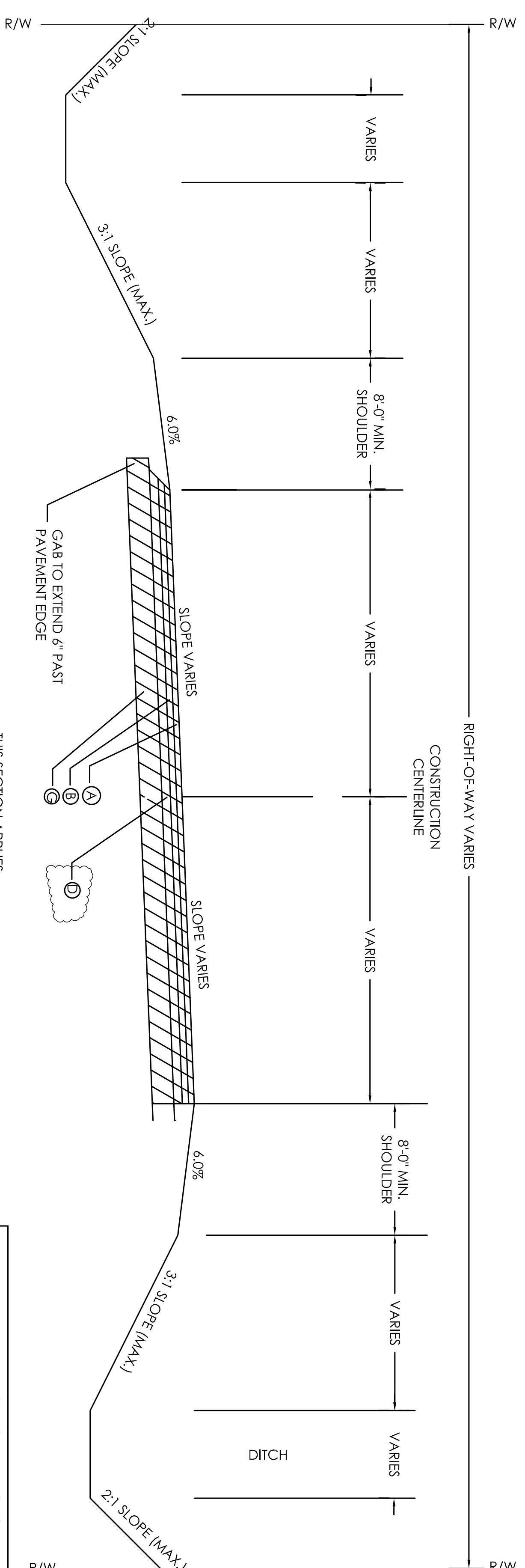

TYPICAL SECTION #2

THIS SECTION APPLIES TO OLD AUGUSTA ROAD

SLOPE CONTROLS	
SLOPE	CUT
3:1	0-10'
2:1	OVER 10'

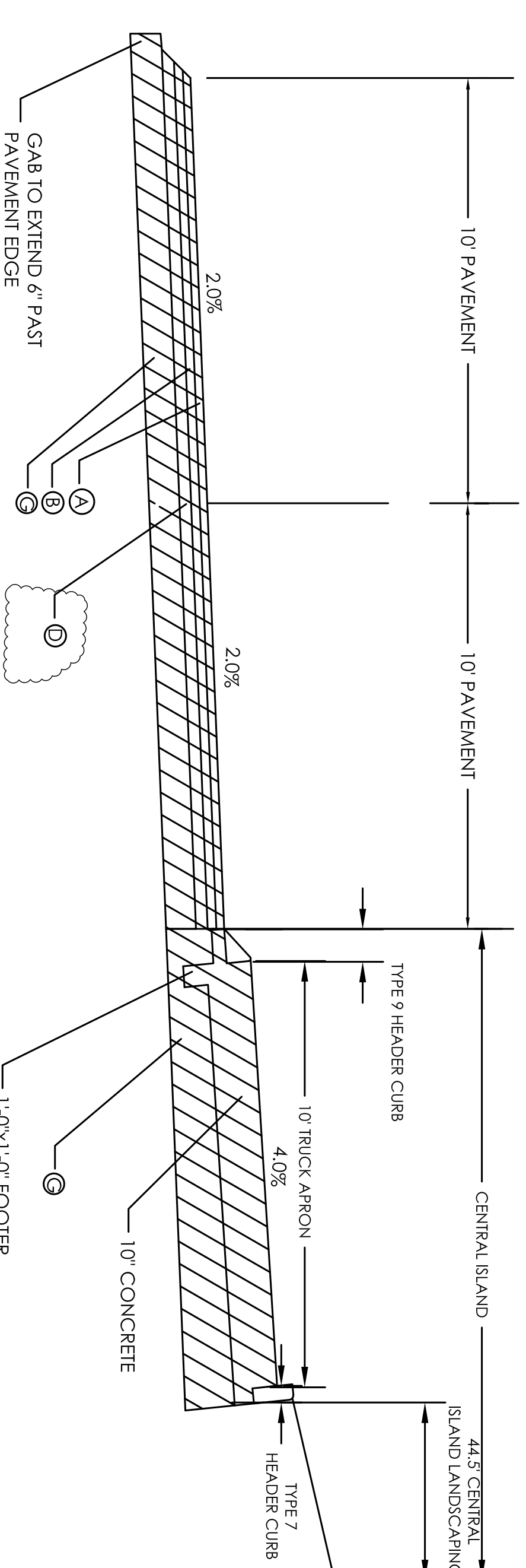
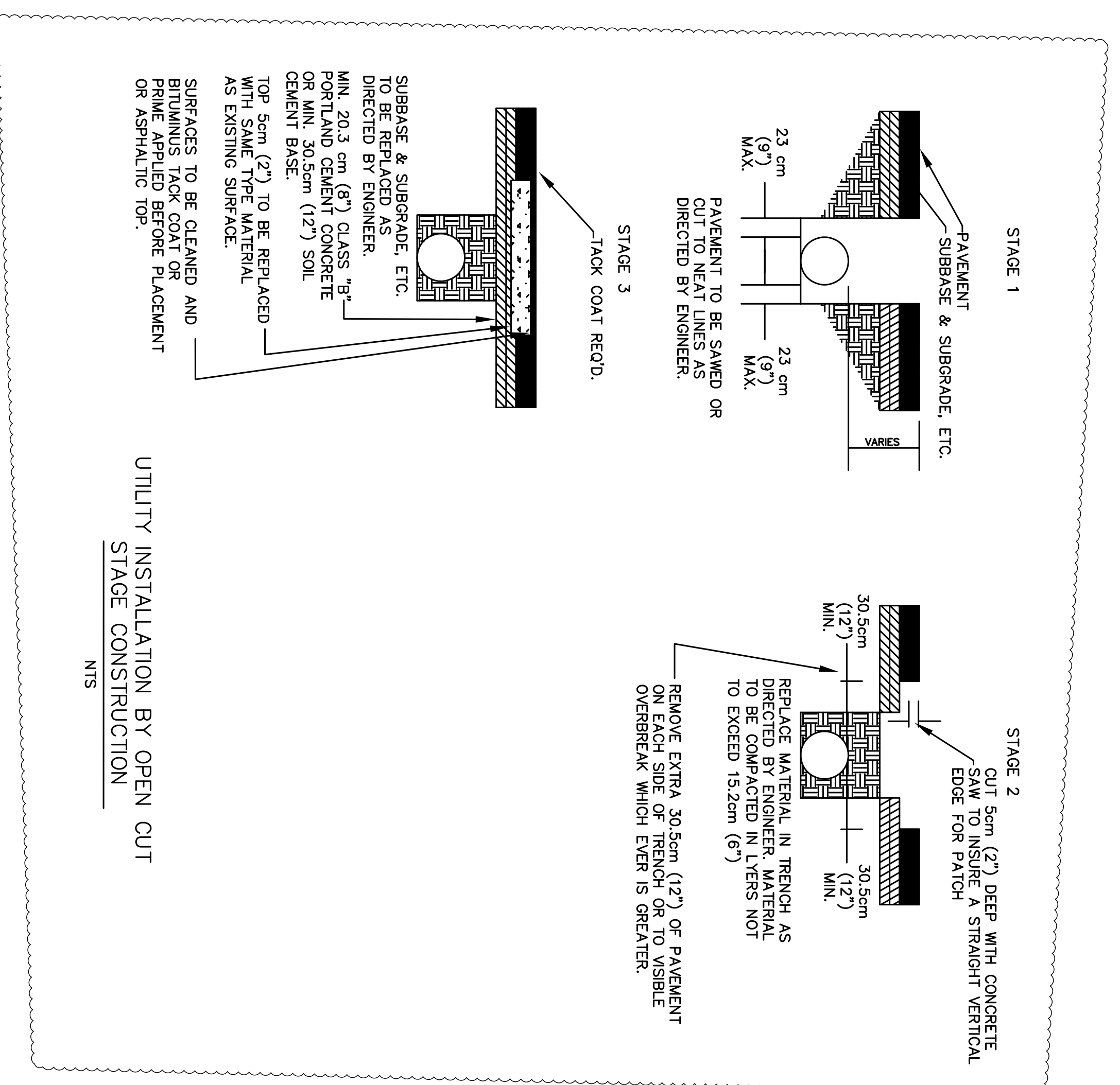

TYPICAL SECTION #3



36 COURTLAND STREET, SUITE B
STATESBORO, GEORGIA 30458
PHONE: 912-764-7722



EFFINGHAM COUNTY
BOARD OF COMMISSIONERS
PUBLIC WORKS DEPARTMENT
309 HIGHWAY 119 SOUTH
SPRINGFIELD, GA 31329
PH: (912) 754-2141
FX: (912) 754-9959



REVISION DATES

TYPICAL SECTIONS

FORT HOWARD ROAD/OLD AUGUSTA ROAD ROUNDABOUT

SHEET NO. 5 / 47

DRAWING NO. 5-01

PRE-BID MEETING SIGN IN SHEET

PROJECT : ITB No. 19-008 - Fort Howard Old Augusta Road Roundabout
 MEETING DATE : Tuesday 06-25-19 @ 1400

Name - PLEASE PRINT	Arrival Time	Company - Name and Address	Phone	Email - PLEASE PRINT
Fiona Charleton		Effingham County Board of Commissioners, 601 N Laurel Street, Springfield, GA 31329	912-754-2159	fcharleton@effinghamcounty.org
Michael Wiloughby		Baker Constructors, Inc.	912-667-1098	michael.w@bakerconstructors.com
Trey Evans		Preferred Materials, Inc.	912-443-3400	trej.evans@preferredmaterials.com
Jason Hampton		R.B. Baker	912-675-9084	jhampton@rbaker.com
Matthew Dotsell		McLendon Enterprises Inc.	912-245-6088	matt@mcclendonenterprises.com
Chris Davis		Griffin Contracting, Inc.	912-965-0111	chrisd@griffincontracting.com
Rebekah Shepard		EAD Contracting	912-663-4861	rshepard@edcompanies.com
WES SHERRAD		Parker Engineering		
WILBERTO GILSON		EOM Engineering		