

ADDENDUM ONE
HIGHLAND PARK (ANDERSON AVENUE) GI DEMONSTRATION PROJECT
CONTRACT NO. S-11-001-201
CITY OF CHATTANOOGA, TENNESSEE

The following changes shall be made to the Contract Documents, Specifications, and Drawings:

I. Pre-Bid Meeting Notes and Sign In Sheet

From the pre-bid meeting. Questions from attendees:

- 1 - as-builts of sewer, attached (includes south alley, Holly and Hickory)
- 2 - Remove Item 15e "Cold Milling" as redundant to item 75 "Milling"
- 3 - Bid Tab Item 830 Construction Trailer - see attached TDOT Section 722 Field Office

II. Q&A

Q? There is no detail provide for the modified Handicap Ramp. Can you please provide a detail?

A. Modified Handicap Ramp detail added to OOC-115.

Q? For item GI C Flow thru Planter Box, can you provide a detail for the precast structure?

A. No detail available, we are providing Filterra with information (drainage area and so on).

Q? There are two items for Sewer Services, Item 5A and Item 15064d, I am assuming that item 5A are for repair of any existing sewer services that are in conflict, and item 15064d is for the new sewer services shown on plan sheet OOC-127, is this correct?

A. Item 5A are for repair of any existing sewer services that are in conflict, and Item 15064d is for the new sewer services shown on plan sheet OOC-127 as it is grouped with new sewer installation items.

Q? Can you supply a detail for item 2452b Public Outreach Signage Identifying BMP's and Green Infrastructure?

A. Delete this item from the bid schedule, contractor not responsible for this item.

Q? For the pipe demo on South Holly Street we will have to do a trench width Asphalt patch, with base stone after the pipe is removed. Does this work need to be included in item 23a?

A. The pipe demo in Holly is included in the bid schedule for demolition item 15.

Q? Once the storm drain pipe and structures that is to be removed, is removed, are we to backfill the trench with stone?

- A. The new SD alignment in Holly is within this trench, the stone included complete in place.

III. Updates to Drawings

Sht 00C-102 Traffic Control Plan and demolition has been updated

Sht 00C-107 Curb cuts added

Sht 00C-115 Observation Well Detail updated, modified HC ramp detail added

Sht 00C-127 Note added to abandon existing sanitary sewer in-place and install anti-seep collar/concrete dam as directed by city inspector

Shts 00L-101 and 102 Alt A revised, bid tab revised to reflect changes

January 4, 2017

/s/ Justin C. Holland, Administrator
City of Chattanooga
Department of Public Works

BID SCHEDULE
Contract Number S-11-001
Highland Park (Anderson Avenue) Demonstration Project
City of Chattanooga

Item	Description	Approx. Quantity	Unit of Measure	Unit Price	Amount
1	<u>Common Excavation</u>				
	a) Cut-Excavation	3,615	CY	_____	_____
	b) Trench Rock Excavation	980	CY	_____	_____
	c) Removal of Foundry Sand (if encountered) Including Special Waste permitting, haul, and disposal.	750	CY	_____	_____
2	<u>Rock Excavation</u>				
	a) Rock Excavation	1,200	CY	_____	_____
3	<u>Concrete</u>				
	a) Class A Concrete - 4000 PSI includes furnishing all labor, materials, equipment, tools, plant services, etc. as incidental and as directed by the Engineer.	17	CY	_____	_____
	b) Class A Hi-Early - includes furnishing all labor, materials, equipment, tools, plant services, etc. as incidental and as directed by the Engineer.	9	CY	_____	_____
	c) Concrete Encasement City Std. SD-308.02, Placement at Existing Sanitary Sewer Lines intersecting Storm Drain Crossings where clearance is less than 18"	9	CY	_____	_____
4	<u>Concrete Reinforcement</u>				
	a) Concrete Reinforcement - Includes Furnishing, Bending, Placing, Tying, etc. as directed by the Engineer.	2,000	LB	_____	_____
5	<u>Pipe Sewers And Service Lines</u>				
	a) Sewer Line Lateral Relocation/Replacement - Includes furnishing all pipes, fittings, bedding, stone, backfill, excavation (regardless of depth), tools, labor, plant services, equipment, etc. As needed, complete-in-place.	555	LF	_____	_____
6	<u>Manholes - Sanitary Sewer</u>				
	a) 4' Diameter Manholes - Includes Excavation, Bedding, Backfill, Brick, Frame and Grate (SD-608.02), 0'-6' in Depth, Labor, and other Incidentals, etc. (Complete-in-Place).	2	EA	_____	_____
	b) Standard 4-ft Diameter Manhole Riser Sections - extra depth over 6'	8	VF	_____	_____
	c) Core & Boot existing MH connections	2	EA	_____	_____
7	<u>Ductile Iron Piping and Ductile Iron and Cast Iron Fittings</u>				

BID SCHEDULE
Contract Number S-11-001
Highland Park (Anderson Avenue) Demonstration Project
City of Chattanooga

Item	Description	Approx. Quantity	Unit of Measure	Unit Price	Amount
	a) 8" Diameter Epoxy Coated - all labor, equipment, and materials required to furnish, install, and test ductile iron piping, including all fittings, wall pipe and sleeves, couplings, toppings, anchor blocks, and accessories.	26	LF		
14	<u>Mineral Aggregate Base</u>				
	a) Mineral Aggregate Base , 100% Compaction Std. Proctor, Type 'A', Grading "D"(Complete-in-place)	667	TONS		
	b) Mineral Aggregate Backfill, #57's , washed stone, roller compacted (Complete-in-Place)	1,430	TONS		
	c) Mineral Aggregate Backfill, #3's , 2"-3" washed stone placed in roadway base infiltration storage (Complete-in-Place)	211	TONS		
15	<u>Concrete and/or Pavement Removal</u>				
	a) Unclassified demolition of existing pavement, curbs, sidewalks, pipes, walls, fences, conc. slabs, etc, incl. removal, disposal, and sawcutting where necessary - also including plugging pipes where required, and pipe removal within the Construction Limits.	89,294	SF		
16	<u>Cement Concrete (Sidewalks, Driveways, Handicap Ramps)</u>				
	a) Sidewalks 4-inch thick Concrete Sidewalk (SD-202.01) - Includes Concrete portion of Handicap Ramps, Excavation up to 6" in Depth, Base stone, Expansion Joints, Caulk, etc. (Complete-in-Place).	10,976	SF		
	b) Handicap Accessible Ramp - City Standard SD-205.01-02, 4-inch Concrete Ramp including Excavation, Base Stone, taper curbs, Class 'A' Concrete, with truncated domes composite inlay, Armor-Tile (or approved equivalent) red color (Complete-in-place)	8	EA		
	c) Handicap Accessible Ramp - Modified Ramp per detail, 4-inch Concrete Ramp including Excavation, Base Stone, taper curbs, Class 'A' Concrete, with truncated domes composite inlay, Armor-Tile (or approved equivalent) red color (Complete-in-place)	6	EA		
	d) Driveway Apron - 6-inch thick Concrete Driveway Apron and/or Sidewalk (SD-202.02) - Includes Excavation up to 8" in Depth, Base Stone, Reinforcing Steel, etc. (Complete-in-Place).	888	SF		
17	<u>Cement Concrete Curb, Gutter, or Combined Curb and Gutter</u>				

BID SCHEDULE
Contract Number S-11-001
Highland Park (Anderson Avenue) Demonstration Project
City of Chattanooga

Item	Description	Approx. Quantity	Unit of Measure	Unit Price	Amount
	a) Detached Concrete Curb 6" x 18" City Standard (SD-201.01) - Includes excavation, backfill, stone, concrete, Exp. Joints, etc., (Complete-in-Place).	4,371	LF	_____	_____
	b) Detached Concrete "Flush" Curb 6" x 12" - City Standard (SD-201.01) - Includes excavation, backfill, stone, concrete, Exp. Joints, etc., (Complete-in-Place).	1,050	LF	_____	_____
18	<u>Asphalt / Concrete Driveway Repair</u>				
	a) Asphalt Residential Driveway Replacement / Repair (SD-703.01) - Includes 6" Mineral aggregate base, 98% Compaction 303-01, Type 'A', Grading 'D', 2" 'E' Topping, (Complete-in-place).	1,500	SF	_____	_____
	b) Concrete Residential Driveway Replacement / Repair (SD-703.01) - Includes 6" Class 'A' Concrete, and 6" Mineral aggregate base, 98% Compaction 303-01, Type 'A', Grading 'D' (Complete-in-place).	500	SF	_____	_____
19	<u>Tree and/or Stump Removal</u>				
	a) 4-inch - 12-inch Diameter (Complete-in-place).	1	EA	_____	_____
	b) 12.01-inch - 24-inch Diameter (Complete-in-place).	2	EA	_____	_____
	c) 24.01-inch - 36-inch Diameter (Complete-in-place).	2	EA	_____	_____
	d) Shrub and/or ground cover replacement as directed by the Engineer (Complete-in-place).	1	Allowance	\$5,000.00	\$5,000.00
23	<u>Removal of Structures/Obstructions</u>				
	a) Removal of existing stormdrain system: piping and structures	1	LS	_____	_____
26	<u>Bituminous Plant Mix Binder (HOT MIX)</u>				
	a) 2.5" in depth Asphaltic concrete binder, Grading "B", for Intersections and Resurfacing Existing Lanes (Holly Street) includes prime coat (Complete-in-place).	208	TONS	_____	_____
	b) 5" A.S. base pervious asphalt - Anderson Avenue, (Complete-in-place).	575	TONS	_____	_____
27	<u>Asphaltic Concrete Surface (HOT MIX)</u>				
	a) 1.5" in depth Asphaltic concrete surface, Grading "E" for Intersections and Resurfacing Existing Lanes (Holly Street), includes tack coat (Complete-in-place).	227	TONS	_____	_____
	b) 1 inch depth Open Graded Friction Course (OGFC) - Porous Asphalt Mix - Anderson Avenue, (Complete-in-place).	115	TONS	_____	_____

BID SCHEDULE
Contract Number S-11-001
Highland Park (Anderson Avenue) Demonstration Project
City of Chattanooga

Item	Description	Approx. Quantity	Unit of Measure	Unit Price	Amount
31	<u>Concrete Pipe / Storm Sewer</u>				
	a) 12" RCP Class III. Including excavation, bedding, backfill, connections to Structures, etc. (complete-in-place)	74	LF	_____	_____
	b) 15" RCP Class III. Including excavation, bedding, backfill, connections to Structures, etc. (complete-in-place)	229	LF	_____	_____
	c) 18" RCP Class III. Including excavation, bedding, backfill, connections to Structures, etc. (complete-in-place)	105	LF	_____	_____
	d) 24" RCP Class III. Including excavation, bedding, backfill, connections to Structures, etc. (complete-in-place)	553	LF	_____	_____
	e) 30" RCP Class III. Including excavation, bedding, backfill, connections to Structures, etc. (complete-in-place)	459	LF	_____	_____
	f) 36" RCP Class III. Including excavation, bedding, backfill, connections to Structures, etc. (complete-in-place)	52	LF	_____	_____
33	<u>Adjusting Manhole Frames</u>				
	a) Manhole Adjustment to Finished Grade - Includes Excavation, Backfill, Riser, Concrete, Brick, or any other Incidentals, etc., (Complete-in-place).	8	EA	_____	_____
34	<u>Catch Basins, Curb Inlets, Miscellaneous</u>				
	a) Catch Basin with Back - Standard Precast (SD-608.02 Notes 3-6) - Includes Excavation, Bedding, Backfill, Precast Structures, Openings for Reinforced Concrete Pipe, Frame and Grate, 0'-6' in Depth, Labor, and other Incidentals, etc. (Complete-in-Place).	7	EA	_____	_____
	b) Drop Inlets - Precast/Brick - Includes Excavation, Bedding, Backfill, Concrete or Brick or Precast Structure, Frame and Lid, 0'-6' in Depth, Labor, and other Incidentals, etc. (Complete-in-Place).	6	EA	_____	_____
	c) Manhole 4' Diameter - Precast/Brick (SD-601.01) - Includes Excavation, Bedding, Backfill, Concrete or Brick or Precast Structure, Frame and Lid, 0'-6' in Depth, Labor, and other Incidentals, etc. (Complete-in-Place).	3	EA	_____	_____
	d) Manhole 5' Diameter - Precast/Brick (SD-601.01) - Includes Excavation, Bedding, Backfill, Concrete or Brick or Precast Structure, Frame and Lid, 0'-6' in Depth, Labor, and other Incidentals, etc. (Complete-in-Place).	1	EA	_____	_____

BID SCHEDULE
Contract Number S-11-001
Highland Park (Anderson Avenue) Demonstration Project
City of Chattanooga

Item	Description	Approx. Quantity	Unit of Measure	Unit Price	Amount
	e) Manhole 6' Diameter - Precast/Brick (SD-601.01) - Includes Excavation, Bedding, Backfill, Concrete or Brick or Precast Structure, Frame and Lid, 0'-6' in Depth, Labor, and other Incidentals, etc. (Complete-in-Place).	1	EA	_____	_____
	f) Junction Box - Precast, Includes Excavation, Bedding, Backfill, Concrete Precast Structure, Reinforcing Steel, Frame and Lid, 0'-6' in Depth, Labor, and other Incidentals, etc. (Complete-in-Place).	2	EA	_____	_____
	g) Yard Drain - Nyloplast 18" Diameter - Includes Excavation, Bedding, Backfill, Structure, Frame and Lockable Lid, Labor, and other Incidentals, etc. (Complete-in-Place).	3	EA	_____	_____
	h) Concrete Headwall - Includes Excavation, Bedding, Backfill, Precast Structure, Reinforcing Steel, Labor, and other Incidentals, etc. (Complete-in-Place).	4	EA	_____	_____
35	<u>Sodding and/or Seeding</u>				
	a) Bermuda Sod ; Fertilizer - Includes all Labor, rolling, and other incidentals, etc. (Complete-in-place).	10,236	SF	_____	_____
	b) Fescue seeding - Includes prepared seed bed, all fertilizer, straw, watering, Complete-in-Place)	18,286	SF	_____	_____
36	<u>Topsoil</u>				
	a) Topsoil (3-inch depth), Includes Labor and other incidentals, etc. (Complete-in-place).	264	CY	_____	_____
40	<u>Fence</u>				
	a) In-Kind Restoration - 4' high chain link, including all hardware, line posts, corner posts, incidentals, labor (Complete-in-Place)	565	LF	_____	_____
72	<u>Adjust Water Service Lines and Move Existing Water Meters and Boxes</u>				
	a) Adjust Water Service Lines and Meters and Boxes - Includes Labor and other incidentals, etc. (Complete-in-place).	20	EA	_____	_____
74	<u>Miscellaneous Materials</u>				
	Miscellaneous Materials (not included in other items such as add-mixtures, calcium chloride, etc.)	1	Allow	\$20,000.00	\$20,000.00
75	<u>Milling</u>				

BID SCHEDULE
Contract Number S-11-001
Highland Park (Anderson Avenue) Demonstration Project
City of Chattanooga

Item	Description	Approx. Quantity	Unit of Measure	Unit Price	Amount
	a) Cold Mill Depth of 1-1/2" Bituminous Plant Mix Pavements	11,134	SF		
98	<u>Slope Protection and Erosion Control</u>				
	a) Inlet Protection - Silt-Saver, Siltsack, Gutterbuddy, or as directed by Engineer, (Complete-in-Place)	25	EA		
	b) Filter socks Silt Soxx or approved equal (Complete-in-place)	1,710	LF		
	c) Check Dams - Temporary Rip-Rap (Complete-in-Place)	8	EA.		
	d) Dewatering Device - Filter Bag / Filter Pit (15 x 10) 10 oz. non-woven New Pig, or approved equal (Complete-in-place)	3	EA.		
	e) Silt Fence - To define Work Zone as shown by Construction Limits - Includes installation, maintenance, and removal upon stabilization (Complete-in-Place)	500	LF		
	f) Construction Exit - Includes Stone, Fabric, Maintenance (Complete-in-Place)	4	EA		
	g) Tree Protection & Construction Limits Orange Construction Barricade	3,100	LF		
100	<u>Traffic Control Devices (Temporary)</u> <u>http://mutcd.fhwa.dot.gov/pdfs/2009r1r2/mutcd2009r1r2edition.pdf</u>				
	a) Temporary Signage - Per MUTCD and approved Traffic Control Plan (S-2 thru S-5, see plan)	18	EA		
	b) Type 3 Barricades With Lights - Per MUTCD and approved Traffic Control Plan (S-1, see plan)	6	EA		
2810	<u>Landscaping (including one year warranty) ALT B</u>				
	a) Trees - Provide all labor, materials, equipment and services necessary and incidental to the completion of all landscaping where shown or indicated on the drawings. (SEE ALT B PLANTING)	16	EA		
	b) Shrubs - Provide all labor, materials, equipment and services necessary and incidental to the completion of all landscaping where shown or indicated on the drawings. (SEE ALT B PLANTING)	42	EA		
	c) Ornamental Grass - Provide all labor, materials, equipment and services necessary and incidental to the completion of all landscaping where shown or indicated on the drawings. (SEE ALT B PLANTING)	675	EA		

BID SCHEDULE
Contract Number S-11-001
Highland Park (Anderson Avenue) Demonstration Project
City of Chattanooga

Item	Description	Approx. Quantity	Unit of Measure	Unit Price	Amount
d)	Wild Flower Seed Mix - Cone Flower/Black Eyed Susan. Provide all labor, materials, equipment and services necessary to prepare seed beds in a seasonal manner and incidental to the completion of all landscaping where shown or indicated on the drawings. (SEE ALT B PLANTING)	700	SF		
3575	<u>Flowable Controlled Low Strength Material for Abandoned Underground Pipe</u>				
a)	Flowable Fill	36	CY		
15064	<u>Polyvinyl Chloride (PVC) / Sanitary Sewer and Service Pipe</u>				
a)	8" PVC - including all labor, equipment, and materials required to install polyvinyl chloride (PVC) pipe, including accessories 10' to 12.0' depth	456	LF		
b)	BACKFILL - trench excavation 10' to 12.0' depth	456	LF		
c)	4" PVC Cleanouts - regardless of depth, including riser pipes, caps, all labor, equipment, materials and incidentals, Complete-in-Place)	16	EA		
d)	4" PVC Service Lines regardless of depth, including all labor, equipment, and materials required to install polyvinyl chloride (PVC) pipe, including accessories	596	LF		
e)	T.V. INSPECTION of Sewers	456	LF		
f)	DEFLECTION TESTING - PVC pipe	456	LF		
	<u>High Density Polyethylene Pipe (HDPE) / Storm</u>				
a)	4" Perforated Pipe or Solid Pipe - labor, equipment, and materials required to install double wall HDPE, including accessories	1,177	LF		
b)	6" Perforated Pipe or Solid Pipe - labor, equipment, and materials required to install double wall HDPE, including accessories	517	LF		
c)	8" Perforated Pipe or Solid Pipe - labor, equipment, and materials required to install double wall HDPE, including accessories	26	LF		
d)	12" Perforated Pipe or Solid Pipe - labor, equipment, and materials required to install double wall HDPE, including accessories	89	LF		

BID SCHEDULE
Contract Number S-11-001
Highland Park (Anderson Avenue) Demonstration Project
City of Chattanooga

Item	Description	Approx. Quantity	Unit of Measure	Unit Price	Amount
	e) 4" Cleanouts - labor, equipment, and materials required to install, including accessories, fittings, risers, material transitions, and brass caps	23	EA	_____	_____
717	<u>Mobilization</u>				
	a) Mobilization , including bid bond, performance bond, payment bond, project signage, incidentals not included in other pay items, etc.	1	LS	_____	_____
830	<u>Construction Trailer</u>				
	a) On-site Project Office / Construction Trailer - Location to be determined	1	EA	_____	_____
1720	<u>Project Record Documents</u>				
	a) Location of Stormwater Structures installed and/or modified by this contract. As-built drawing development and certification. Digital and Hard Copies	1	LS	_____	_____
2120	<u>Video Taping</u>				
	a) Video Taping - all labor, equipment, and material required to provide a video tape record of all easement areas before construction begins in each area.	1	LS	_____	_____
2452	<u>Traffic Signs and Pavement Markings</u> http://mutcd.fhwa.dot.gov/pdfs/2009r1r2/mutcd2009r1r2edition.pdf				
	a) Signage (STOP, YIELD, SPEED LIMIT, etc, Complete-in-Place)	10	EA	_____	_____
	b) Stop Lines - 24" Wide White Thermo Plastic TDOT Section 716-02.05 (Complete-in-Place)	110	LF	_____	_____
	c) Cross Walk - City Standard (Complete-in-Place)	815	LF	_____	_____
GI	<u>Green Infrastructure Items</u> Reference City of Chattanooga "Resource Rain" Rainwater Management Guide" (RMG) http://www.chattanooga.gov/public-works/water-quality-program 5.3.1 "Pervious Pavement"				
	a) Pervious Pavers in parking areas 3 1/8" thick - Includes 2-inch of No.89 leveling course, compacted, screeded, Manually OR Mechanically placed pavers, No.89 joint filler, includes clean-up of excess No.89 joint filler upon completion, etc. (Complete-in-place)	6,891	SF	_____	_____

BID SCHEDULE
Contract Number S-11-001
Highland Park (Anderson Avenue) Demonstration Project
City of Chattanooga

Item	Description	Approx. Quantity	Unit of Measure	Unit Price	Amount
b)	Infiltration Beds - Includes, Backfill #3 WASHED Stone, Labor, and other Incidentals, etc. (Complete-in-Place) Excavation included in Item #1 - Common Excavation.	375	TONS		
c)	Flow-through Planter Boxes - Cast-in-Place, Includes Excavation, Bedding, Backfill, Precast Structure, Labor, and other Incidentals, etc. (Complete-in-Place)	5	EA		
	1) Bioretention Material - 85% to 88% sand; 8% to 12% soil fines; and 3% to 5% organic matter. maximum particle size of 1," and no debris, pH spec of 6.5 to 7.3, representative soil samples must be submitted for approval prior to delivery.	23	CY		
	2) Detached Concrete Curb 6" x 18" City Standard (SD-201.01) - Includes excavation, backfill, stone, concrete, Exp. Joints, etc., (Complete-in-Place).	230	LF		
d)	Bio-Swale (Median of Anderson Ave - West) Includes Bedding, Backfill, Precast Structure, Labor, and other Incidentals, etc. (Complete-in-Place) Excavation included in Item #1 - Common Excavation.				
	1) Bioretention Material - 85% to 88% sand; 8% to 12% soil fines; and 3% to 5% organic matter. maximum particle size of 1," and no debris, pH spec of 6.5 to 7.3, representative soil samples must be submitted for approval prior to delivery.	350	CY		
	2) Stone backfill - WASHED #57's at 18" depth	486	TONS		
e)	Tree Boxes - Precast concrete by Filterra (or approved equal). Includes Excavation, Bedding, Backfill, Precast Structure, Labor, and other Incidentals, etc. (Complete-in-Place)	2	EA		
f)	Infiltration Trench - Includes Filter Fabric, Labor, and other Incidentals, etc. (Complete-in-Place) Excavation included in Item #1 - Common Excavation.	179	CY		
	1) Stone backfill - WASHED #57's	350	TONS		
	2) Geotextile Non-woven - Geotex 350 or Approved Equal (complete-in-place)	12,000	SF		
SI	<u>Supplemental Items</u>				
a)	Removal and Disposal of Abandoned Trolley Lines (if encountered)	1,000	LF		
b)	GeoGrid Tensar Triax - TX5 13.1' x 246' per roll (complete-in-place)	2,529	LF		

BID SCHEDULE
Contract Number S-11-001
Highland Park (Anderson Avenue) Demonstration Project
City of Chattanooga

Item	Description	Approx. Quantity	Unit of Measure	Unit Price	Amount
c)	Geotextile Non-woven - Geotex 350 or Approved Equal (complete-in-place)	44,292	SF	_____	_____

					Subtotal _____
					Total _____

ADD/DEDUCT ALTERNATE

Landscape Option A

35	Sodding and/or Seeding				
a1)	Bermuda Sod; Fertilizer - Includes all Labor, rolling, and other incidentals, etc. (Complete-in-place). (SEE ALT A PLANTING DETAILS SHEET)	4,550	SF	_____	_____
a2)	Fescue Sod; Fertilizer - Includes all Labor, rolling, and other incidentals, etc. (Complete-in-place). (SEE ALT A PLANTING DETAILS SHEET)	4,700	SF	_____	_____
a3)	Buffalo Grass Sod; Fertilizer - Includes all Labor, rolling, and other incidentals, etc. (Complete-in-place). (SEE ALT A PLANTING DETAILS SHEET)	1,500	SF	_____	_____

SIGN-IN SHEET

PROJECT: S-11-001 PRE BD MTG 12AM 12/14/10 DRC 10AM

	NAME	COMPANY	PHONE	EMAIL
1	BONNIE MUMFORD	CITY-PW ENGR	423 643 6031	BMMUMFORD@CHATTANOOGA.GOV
2	Randy Farris	Adams Contracting	855-629-4948	Randy@AdamsContracting Ky.com
3	Clint Ball	Tower Construction	843-470-7763	clint.ball@towerconstructionco.com
4	Gary Ball	Tower Construction	423-421-4622	gary.ball@towerconstructionco.com
5	Radia Amer	City	423 643 6179	raamser@chattanooga.gov
6	Bo Murphy	Talley Construction	706-866-0556	bo@tallyconstruction.net
7	VAREN PADOEN	City Chattanooga	423-643-	vpadoen@chattanooga.gov
8	Kathy Kuhlman	CITY OF CHATTANOOGA	423.643.5833	kkuhlman@chattanooga.gov
9	DENNIS MALONE	CITY OF CHATT	423-643-6188	dmalone@chattanooga.gov
10	Marty Hawkins	City of Chattanooga	423-402-0696	mhawkins@chattanooga.gov
11				
12				
13				
14				
15				
16				
17				
18				
19				
20				
21				
22				

722.01

SECTION 722 – FIELD OFFICE

722.01	Description	822
722.02	Location	822
722.03	Minimum Spatial Requirements.....	822
722.04	Other Requirements	823
722.05	Outside Utilities	823
722.06	Interior Utility Services.....	824
722.07	Doors and Windows.....	824
722.08	Furnishings and Equipment.....	824
722.09	Concrete Cylinder Storage	826
722.10	Maintenance and Custodial Service	826
722.11	Project Sign.....	827
722.12	Basis of Pavement	827

DESCRIPTION

722.01 Description

This work consists of providing and maintaining an adequate, weatherproof field office for the exclusive use of the Engineer and Department staff during both the Contract period and for a maximum of 60 days thereafter.

GENERAL REQUIREMENTS

722.02 Location

Locate the field office or materials laboratory on a site that is both satisfactory to the Engineer and convenient to the Project site.

722.03 Minimum Spatial Requirements

Unless otherwise specified in the Special Provisions, the Engineer's field office shall meet the minimum floor area and headroom requirements specified Table 722.03-1. It shall contain a sufficient number of windows

to provide at least 27 square feet of natural light. Existing building structures meeting these minimum requirements are acceptable.

Table 722.03-1: Field Office Spatial Requirements

Building Type	Width (feet)	Length (feet)	Headroom (feet)	Windows Required
Type 1	10	30	8	6
Type 2	12	50	8	10

722.04 Other Requirements

Arrange for and comply with all necessary local and State regulatory permits and inspections, including all costs associated therewith.

Fully equip the Engineer's field office and have it ready for occupancy at least 2 days before the start of actual construction operations.

Protect the field office against fire, flooding, and theft throughout the 24 hours of every day the unit is in service. Assume responsibility for Department property housed in the field office that is lost due to theft, fire, or natural causes.

722.05 Outside Utilities

A. Electrical Power

Arrange for electrical service for the field office. The power supply shall be 115-volt, 60-cycle current of sufficient amperage to provide for heat, interior and exterior lighting, operating office equipment, and air conditioning.

B. Sanitary Sewer Outfall

Provide an adequate temporary outfall into either the municipal sanitary sewer system or an approved individual sewage disposal system. Dispose of sanitary wastes in accordance with the applicable requirements of the municipal regulations.

722.06

722.06 Interior Utility Services

A. Lighting

Furnish lighting fixtures as required to provide minimum illumination of 70 foot-candles in all areas.

B. Electrical Receptacles

Provide six duplex convenience electrical receptacles throughout the field office as directed by the Engineer. At least two of these receptacles shall be 20-amp capacity.

C. Heating and Air Conditioning

Provide heating and air conditioning equipment capable of maintaining a year round temperature between 70 °F and 78 °F.

D. Sanitary Facilities

Provide a water closet, lavatory, slop sink, vent fan, and a hot water heater having a minimum 5-gallon capacity.

E. Telephone, Answering Machine, and Facsimile Machine

Provide telephone service with an answering machine, a facsimile machine, and two incoming phone lines.

722.07 Doors and Windows

Provide doors of stock sizes and that have a key-in-knob lock of an approved manufacturer. Key all doors similarly. Provide operative windows except for picture windows. Operative windows shall be either double hung or casement type equipped with adequate locks. Provide all windows with either shades or Venetian blinds. Provide adequate screens for all window openings. Provide frosted glass for windows in sanitary areas.

722.08 Furnishings and Equipment

Provide the field office with the following:

A. Furnishings

1. Three office type desks, minimum top dimensions 32 x 60 inches, with two or more drawers on each side.
2. Three swivel desk chairs.
3. One work table, 30 inches high, with a minimum of 24 square feet of work area.
4. One drafting stool.
5. Two folding-type chairs.
6. One fire resistant drawer-type safe, legal size, with combination or key lock.
7. One four-drawer legal size metal filing cabinet equipped with lock.
8. Two two-drawer (14-1/2 x 16 inches) metal filing cabinets.
9. Two round wastebaskets.
10. One plan rack of an approved design to be equipped with ten rods.

B. Equipment

1. Two fully automatic electronic calculators with tape.
2. One office type copying machine.
3. One pencil sharpener.
4. One 5-pound CO2 fire extinguisher of approved manufacture for each 200 square feet of floor area.
5. One first-aid kit.
6. One electric sanitary water cooler with refrigerated storage compartment, with a continuous supply of paper cups.

722.09

7. Toilet paper holders, paper towel dispensers, and soap dispensers in the toilet rooms, with a continuous supply of each.

722.09 Concrete Cylinder Storage

Provide a storage shed/building for temporary storage of concrete acceptance cylinders. The storage facility shall be of sufficient size and construction to protect the concrete cylinders from the elements and damage. Obtain the Engineer's approval of the storage facility location. Department personnel will control access to the storage shed/building. Equip the storage shed with a concrete curing box or water curing tank with a heating/circulating system of sufficient size to properly cure all acceptance cylinders before transferring for final storage and testing. The curing box or curing tank and heater/circulator shall comply with AASHTO M 201, and proper curing of the cylinders shall be in accordance with AASHTO T 23.

722.10 Maintenance and Custodial Service

Provide the following maintenance and custodial services:

A. Maintenance

Perform all necessary repairs of damaged, defective, or vandalized parts of the field office and associated furnishings and equipment. Continue maintenance operations as long as the Engineer occupies the field office.

B. Custodial

1. Weekly trash removal.
2. A broom and dust pan or bi-monthly floor cleaning service.
3. Cleaning supplies or bi-monthly window and sanitary facility cleaning.
4. Replacement of supplies as required to maintain office equipment and sanitary facilities.

722.11

722.11 Project Sign

Equip the field office with a sign that identifies both the use of the structure and provides notice against trespassing.

COMPENSION

722.12 Basis of Pavement

The Department will pay for accepted quantities, complete in place, at the contract prices as follows:

<i>Item</i>	<i>Pay Unit</i>
Field Office (Type <u>1</u>)	Lump Sum

Such payment is full compensation for providing all that is specified in this Section **722** for the duration of the Project.

VERTICAL SCALE 10'=1" INCH

HOLLY ST. SEWER.

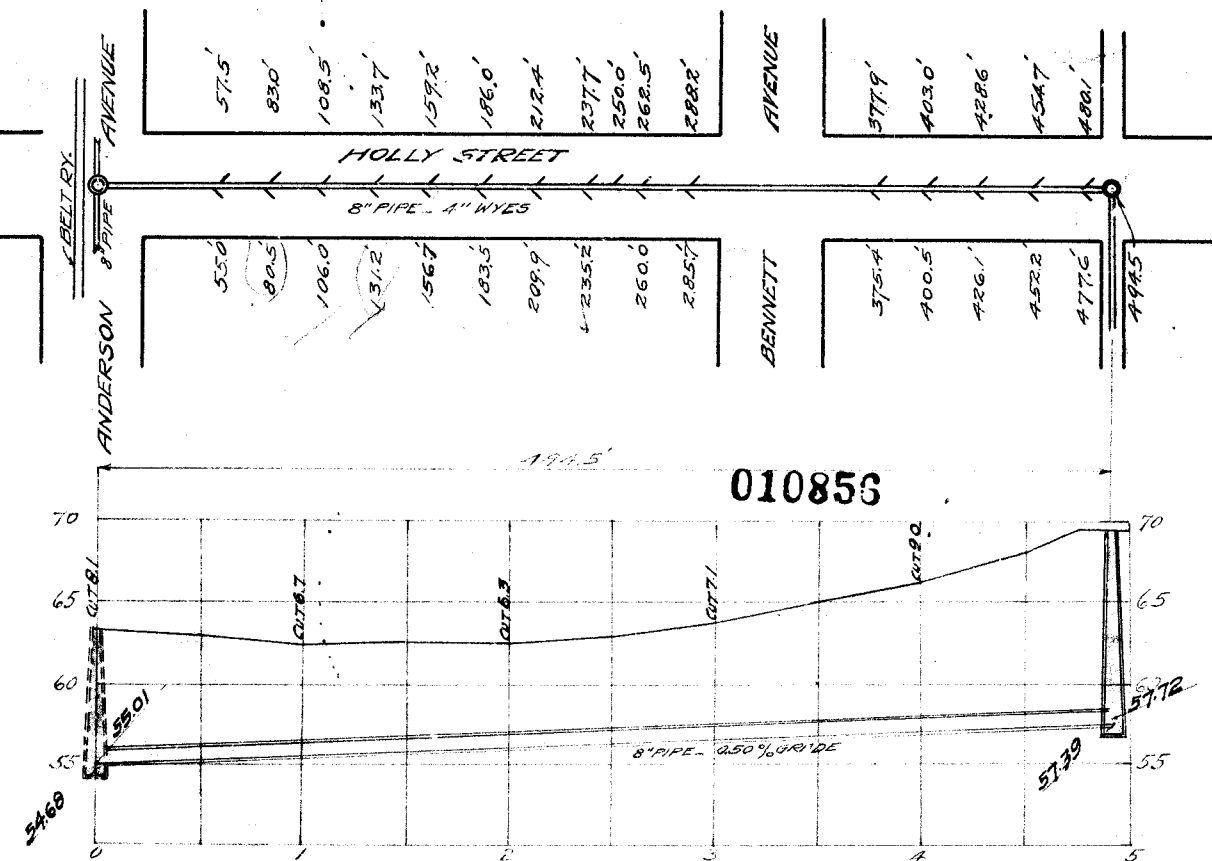

ALLEY BETN BENNETT AND ANDERSON.

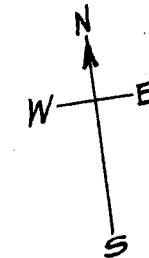

43

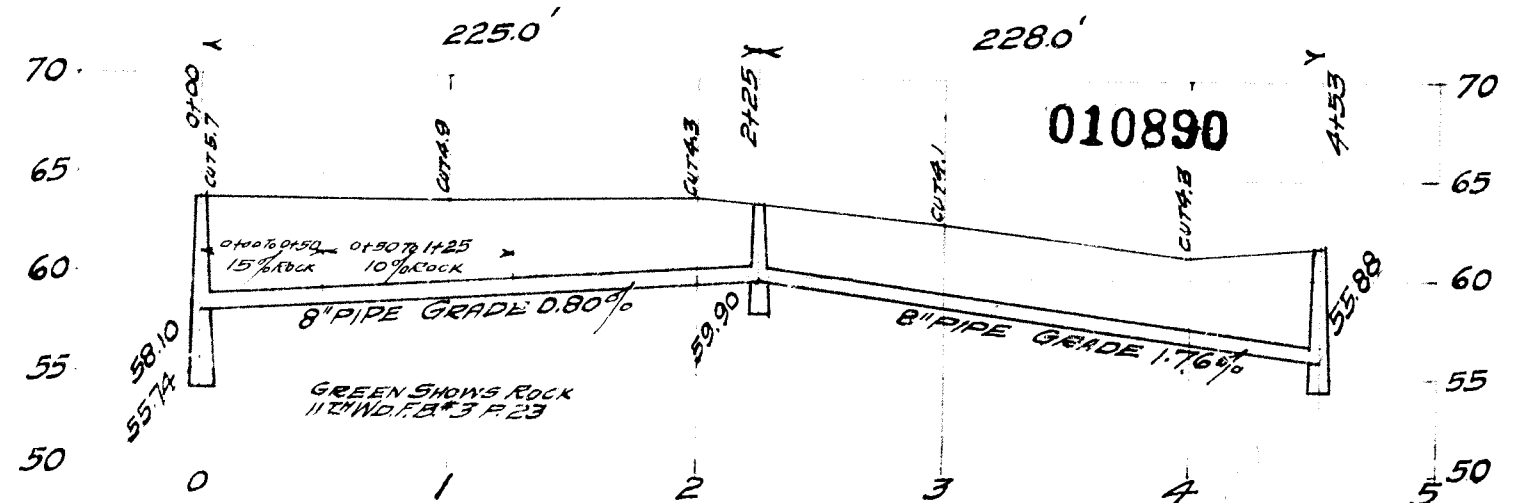
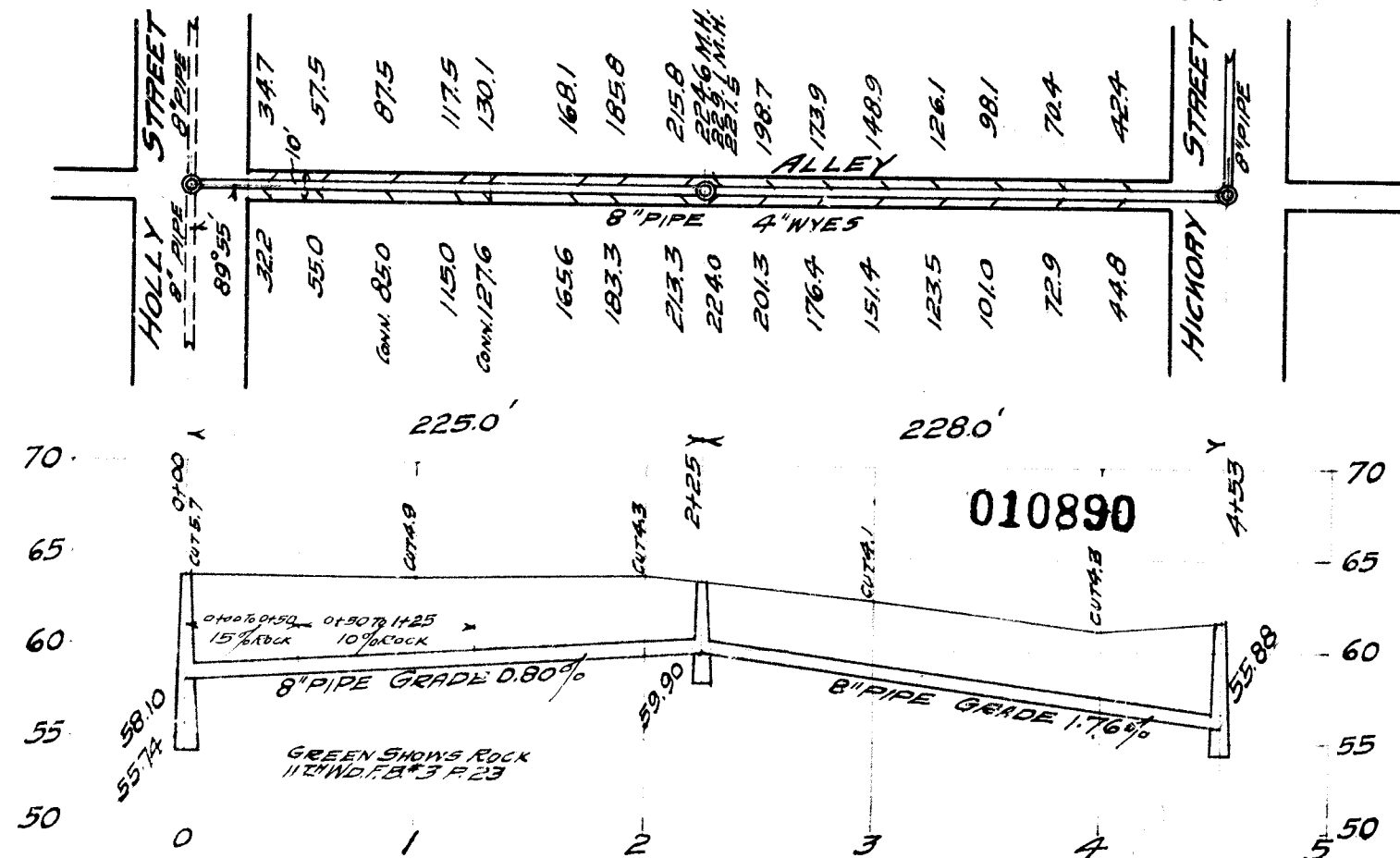

BUILT BY CITY FORCE JAN-1914 F.B. THOMPSON SUPT.
ROBT. HOOKE, CITY ENG'R. RECORDED BY F.C.F. FEB-1914
LEVELS AND TRANSIT NOTES 11 IN W.D. FB #3 P. 1, 4
GRADE NOTES 11 IN W.D. FB #3 P. 23
Y'S MEASURED BY FRENCH AND DYNE INSPT. BK'S #157, 32, 22, 58
HORIZONTAL SCALE 1 IN = 80 FT. VERTICAL SCALE 1 IN = 10 FT.

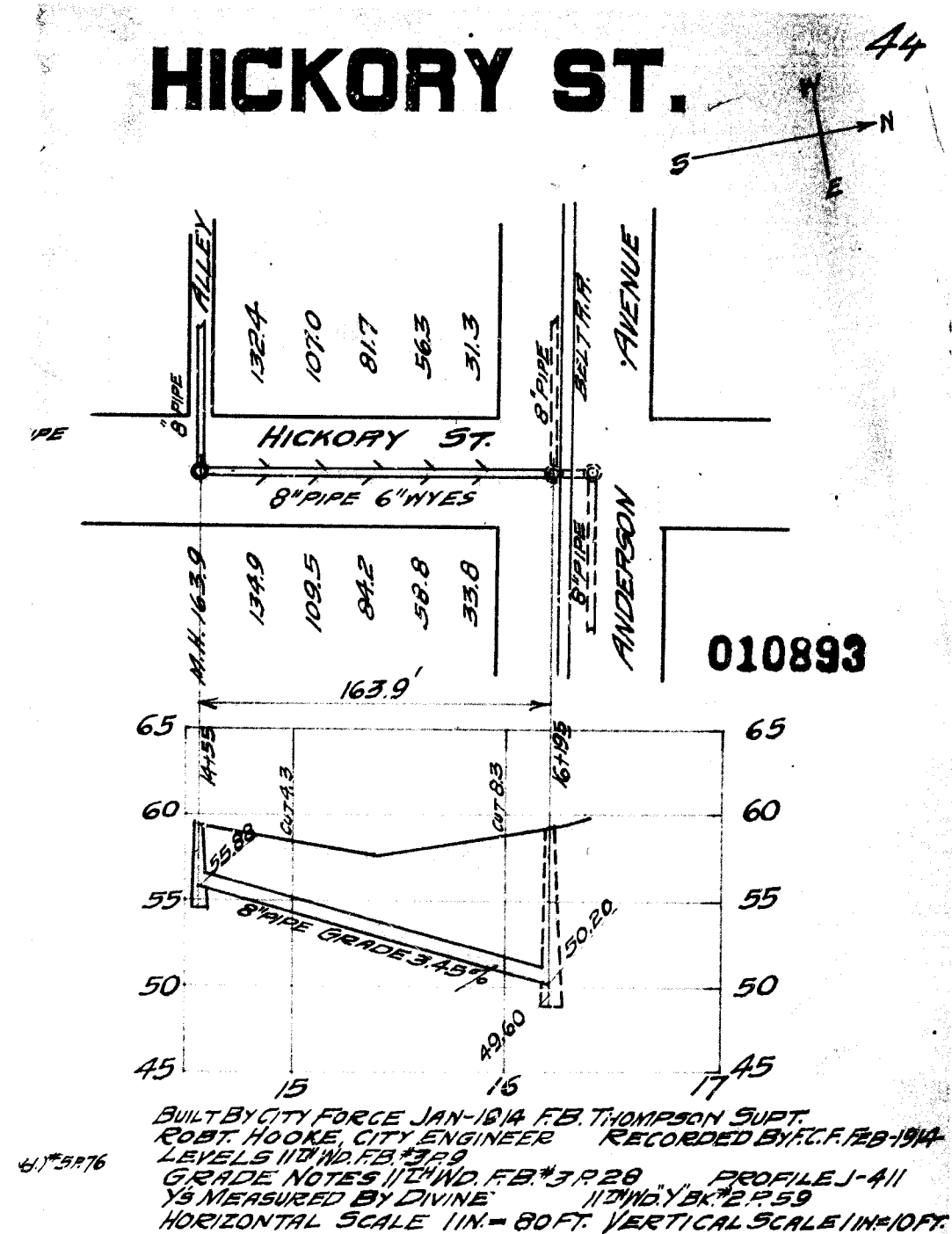

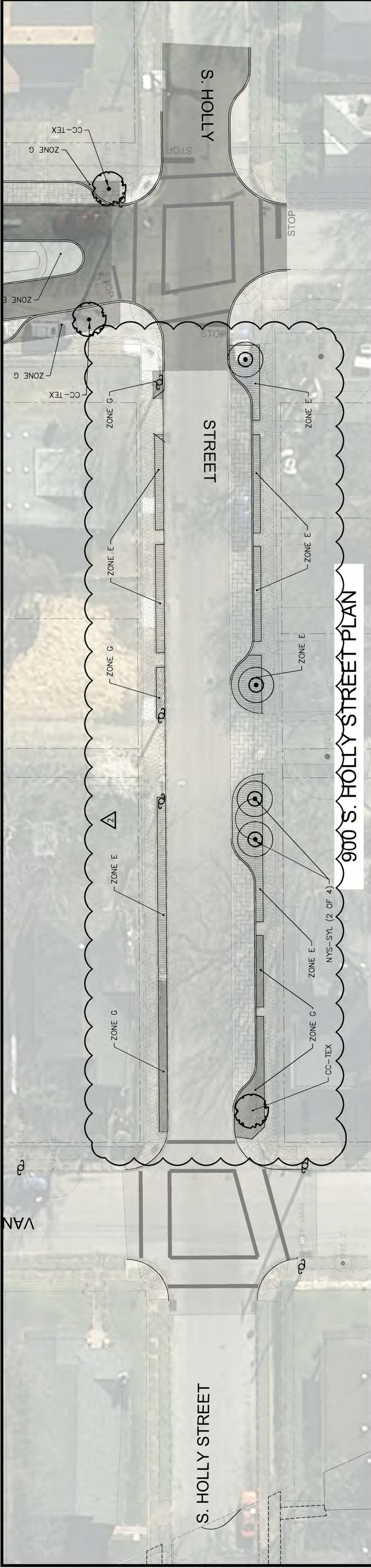
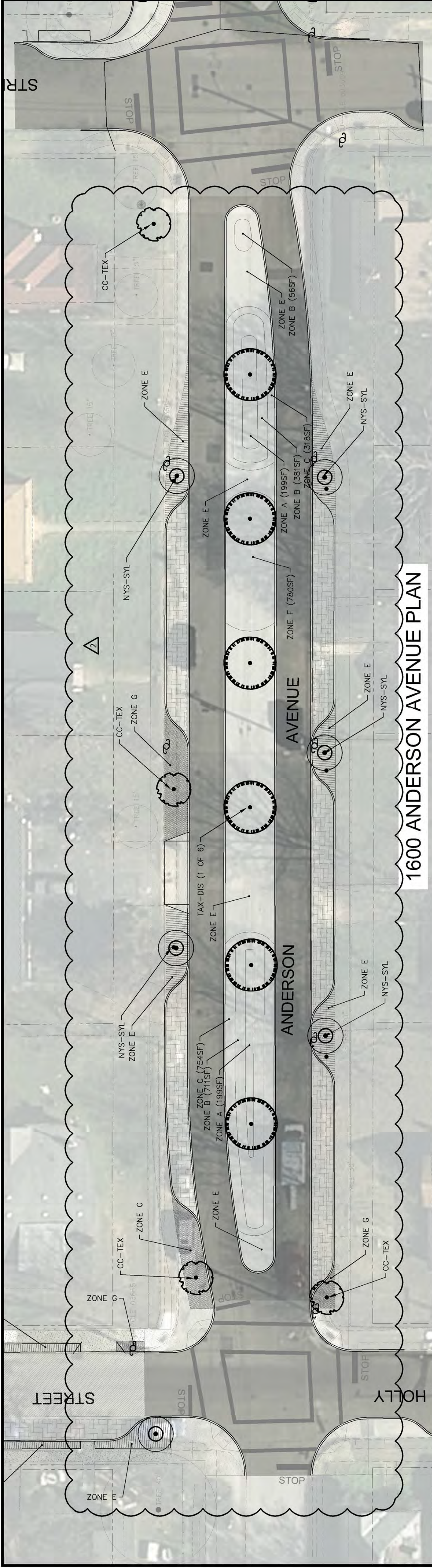
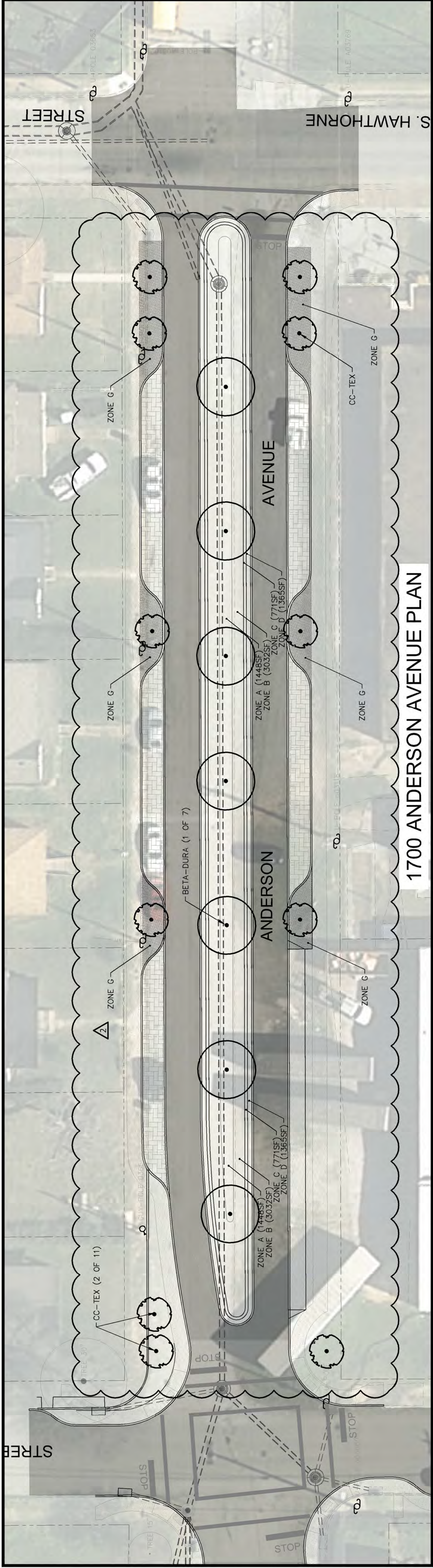

SHEET 00L-101	
ALT A PLANTING PLAN	
SHEET TITLE CIVIL	
DATE: OCTOBER 24, 2014	CHECKER: KL
DISC. LEAD: JTK	DESIGNER: KL/MEM
PROJECT NO: S-11-001	
THIS DRAWING MUST BE USED IN CONJUNCTION WITH THE APPLICABLE OR GOVERNING TECHNICAL SPECIFICATIONS AND OTHER CONTRACT DOCUMENTS.	
THIS LINE IS ONE INCH LONG WHEN PLOTTED FULL SCALE	
REV. 10/24/2014	CONSENT DECREE SUBMITTAL
REV. 12/01/2016	BID SET
REV. 1/5/2017	BID SET ADDENDUM 1
REVISION DESCRIPTION	



HIGHLAND PARK (ANDERSON AVENUE)
GREEN INFRASTRUCTURE DEMONSTRATION PROJECT
CITY OF CHATTANOOGA, TN
CONSENT DECREE PROGRAM

BID SET
ADDENDUM 1



Development Resource Center
1250 Market Street, Suite 2100
Chattanooga, TN 37402 t 423.643.6190

Protection for Existing Trees

1. Protection: Provide protection for designated landscape areas and trees to avoid damage caused by falling building operations, or the removal of materials resulting from either construction or demolition operations. Existing trees and other plantings designated to remain in place, shall be protected from unnecessary cutting, pruning, or removal of any kind within the drip line, from vehicular traffic, or parking of vehicles within the drip line, or from excessive foot traffic. Provide temporary guards to protect trees and plantings to be left standing. Provide fencing protection for any planting areas designated to remain.
2. Tree Protection: Install a shield of 1" x 4" wooden planks completely around each tree trunk to begin where the trunk begins to "flare out" and extend to the top of the trunk. The shield shall be 12' or greater in length and shall be 12' or greater in width at the top, bottom, and middle of the planting.
3. Tree Pit Protection: Protect tree pits and pit vegetation from falling, sliding, or washing building materials by placing bales of straw around the perimeter of each pit or over the top of the pit as directed by the URBAN FORESTER. Straw bales shall remain whole and shall be replaced as needed. The URBAN FORESTER shall be responsible for the replacement of straw bales.

4. Tree Replacement: "Tree replacement" is defined as the complete excavation of an existing tree and its root system and the subsequent planting, back-filling, and adequate fertilization and watering of its replacement tree for a period of one year after planting.
5. The CONTRACTOR shall, at his own expense, replace trees that cannot be repaired and restored to a healthy status, as determined by the URBAN FORESTER. Replacement trees shall be in good health and shall be equal in species, height, shape, and caliper to the tree(s) being replaced.

Installation Notes for New Trees and Shrubs

1. All plant materials shall be inspected and described in general planting notes, and all require a minimum of 12" of soil depth and be subject to rejection by the Landscape Architect.
2. No work may commence without notifying the Landscape Architect.
3. ALL PLANT MATERIALS SHALL BE IN ACCORDANCE WITH THE AMERICAN STANDARDS FOR NURSERY STOCK (ANSI Z60.1-2004), PLANT ACCORDING TO ANSI A300 PART 6, DIG THE PLANTING HOLE TO A MINIMUM OF 2x WIDTH OF ROOTBALL FOR AT LEAST THE FIRST 12 INCHES OF DEPTH, BELOW 12 INCHES, DIG HOLE WIDE ENOUGH TO PERMIT ADJUSTING. DO NOT DIG THE HOLE DEEPER THAN ROOT BALL DEPTH.
5. SCARIFY THE SUBGRADE AND SIDES OF THE PLANTING HOLE WHEN PLANTING IN CLAY SOILS (MORE THAN 15% CLAY).
6. SET AND SETBACK THE TREE BY ROOT BALL ONLY. DO NOT LIFT USING THE TREE TRUNK AND DO NOT USE THE TRUNK TO SET THE TREE.
7. SET THE TOP OF THE ROOT BALL LEVEL WITH THE SOIL SURFACE OR SLIGHTLY HIGHER IF THE SOIL IS PRONE TO SETTLING.
8. AFTER THE TREE IS SET IN PLACE, REMOVE BURLAP, WIRE AND STRAPS FROM AT LEAST THE UPPER 1/3 OF THE ROOTBALL.
9. BACKFILL WITH EXISTING SOIL THAT HAS BEEN WELL-TILLED OR BROKEN UP. DO NOT ADD AMENDMENTS TO THE BACKFILL SOIL. AMEND THE SURFACE WITH MULCH.
10. USE THREE 2" X 2" WOOD STAKES DRIVEN INTO UNDISTURBED SOIL A MINIMUM OF 16 INCHES. SPACE STAKES EQUALLY AROUND THE TREE.
11. ATTACH 3/4" NYLON WEBBING TO CONNECT THE TREE TO STAKES. ATTACH WEBBING AT 1/3 THE TREE HEIGHT.
12. AT A 1/3 DEPTH OF PINE STRAW OR BARK MULCH TO THE PLANTING SURFACE.
13. LEAVE A 5' X 5' AREA AROUND THE TRUNK FOR AIR CIRCULATION.
13. PRUNING SHALL BE LIMITED TO DEAD, DISEASED, OR BROKEN LIMBS ONLY AND SHALL BE IN ACCORDANCE WITH ANSI A300 SPECIFICATIONS.
14. REMOVE ANY TRUNK WRAP REMAINING AT TIME OF PLANTING. NO WRAPS SHALL BE PLACED ON TRUNK.
15. Staking for trees and shrubs planted into boreation or infiltration areas should take into account the texture of the sandy soils and should be long enough, or placed strategically enough, to secure the tree into the more firm soil beneath the sandy boreation mix. Any trees or shrubs that fall or lean in the ROW shall be promptly corrected so as to avoid any safety hazards. Contractor shall be accountable for any damage done to trees or shrubs that fall due to improper staking.
16. Tree Installation: Trees within the boreation areas shall not receive any fertilizer during or after installation, without approval by the Landscape Architect.
17. Trees planted in boreation soil media shall have 2 cubic feet of soil conditioner per one inch caliper added to planting pit during installation and blended thoroughly. Soil conditioner consist of a naturally occurring source of organic matter such as pine bark fines, or similar. Soil conditioner must be composted or aged, and have a carbon to nitrogen ratio of roughly 30:1. Soil conditioner may not contain synthetic fertilizer or any organic fertilizer beyond the natural N, P, and K concentrations in the organic material itself. Manure shall not be used as soil conditioner.

Planting Notes

1. Contractor required to schedule a preconstruction meeting with Landscape Architect.
2. Landscape Contractor hold an active Contractor's License in the state this work is to be performed. Contractor shall be responsible for this complete landscape installation must not exceed the amount of material specified in the drawings.
3. No work shall commence without notifying Landscape Architect.
4. Landscape Architect may inspect plant material before installation at the job site or at Contractor's place of business for conditional acceptance. Landscape Architect retains the right to reject plant material after installation or at any time up to the date of acceptance.
5. All plant materials shall be inspected and described in general planting notes, and all require a minimum of 12" of soil depth and be subject to rejection by the Landscape Architect.
6. All plant materials is to conform to the American Standard for Nursery Stock, Association of American Nurserymen, Inc. ANSI Z60.1-2004.
7. Plant names shall conform to Hortus Third, Macmillan Publishing Company, Inc. New York, 11976 Ed.
8. The Contractor shall furnish and plant all plants shown on the drawings of species, size, and quantities as shown on the plant list. All plants shall be nurseries grown, true to name & type and of high quality. Trees shall meet form standards as described in "remarks" section of planting matrix and conformance to these descriptors will be judged by standards set forth by the American Standard for Nursery Stock, Association of American Nurserymen, Inc. ANSI Z60.1-2004. No gouges, nicks or cuts in bark are allowed.
9. The Contractor shall provide the Landscape Architect with at least one nursery tag per species planted and wholesale nursery invoices showing quantity provided.
10. In the event of variation of quantities shown on the planting matrix and the plans, the planting contractor shall control. Improper plant count by the Contractor shall be no cause for additional costs to the owner.
11. No substitutions shall be made without written consent of the owner or landscape architect.
12. The Contractor shall provide the Landscape Architect with at least one nursery tag per species planted and wholesale nursery invoices showing quantity provided.
13. The Contractor shall verify all grades, dimensions, and existing conditions on site before planting begins. Any discrepancies shall be brought to the attention of the Owner.
14. The Contractor shall coordinate his work with lighting, paving, and irrigation contractors as to timing of material installation.
15. The contractor shall verify all grades, dimensions, and existing conditions on site before planting begins. Any discrepancies shall be brought to the attention of the Owner.
16. Every possible safeguard shall be taken to protect building surfaces, equipment and furnishings. The contractor shall be responsible for the protection of the work.
17. The Contractor shall not be responsible to replace or honor any warranty for the loss of materials due to fire, floods, freezing temperatures, lightning, wind above 50 mph, or any other natural disaster, nor shall the Contractor be held responsible for acts of vandalism or negligence on the owner's part.
18. The Owner shall have the right to reject any work and materials at any stage of the operation that in his opinion do not meet these requirements and specifications.
19. The Contractor shall dispose of stumps and major roots of all plants to be removed. Any depressions caused by removal shall be refilled with specified soil compacted to proper grade.

Perennial Seed Mixes and Nurse-crop Notes

1. All seed sowing methods and dates, as well as any use of nurse crops, shall be discussed in a preconstruction meeting with the landscape architect. In case of weather or seasonal restrictions to seedling dates, a revised seedling schedule shall be met through consultation with the Landscape Architect.
2. The Contractor shall be responsible for the protection of the work.
3. Perennial seed mixes shall meet the supplier and codes set out in the seedling and nurse crop matrix. No substitutions shall be made without prior consultation and agreement of the Landscape Architect.
4. Perennial seed mixes shall be sown at the rates indicated in the Seedling and Nurse Crops matrix.
5. Perennial seeded areas shall be lightly tamped to ensure adequate seed-to-soil contact. No excessive tamping should occur which would alter the infiltration ability of the boreation soil.
6. In areas secured with straw matting, perennial seed mixes should be sown 50% above straw matting, and 50% below, unless otherwise directed by the Landscape Architect. The area should then be lightly tamped to provide adequate seed-to-soil contact.
7. Any use of cover crop or nurse crop, or change to seedling methods, mixes, or dates, shall require prior consultation and approval by the Landscape Architect.

A

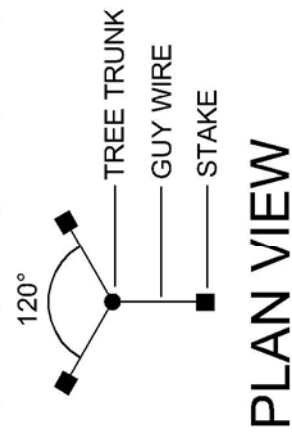

PLAN VIEW

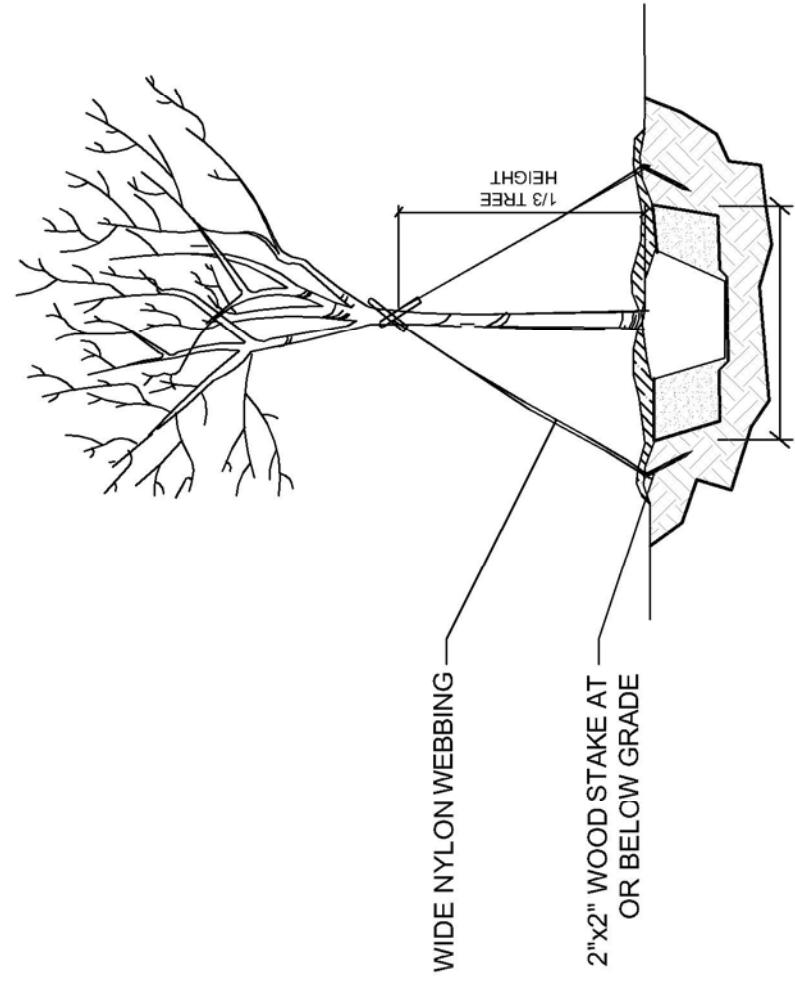

TREE PLANTING (< 2\"/>

N.T.S.

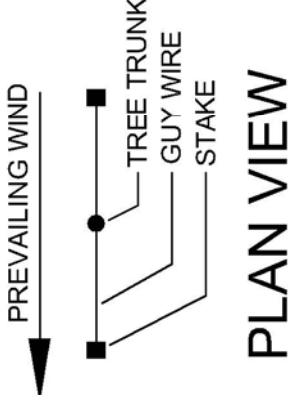

PLAN VIEW

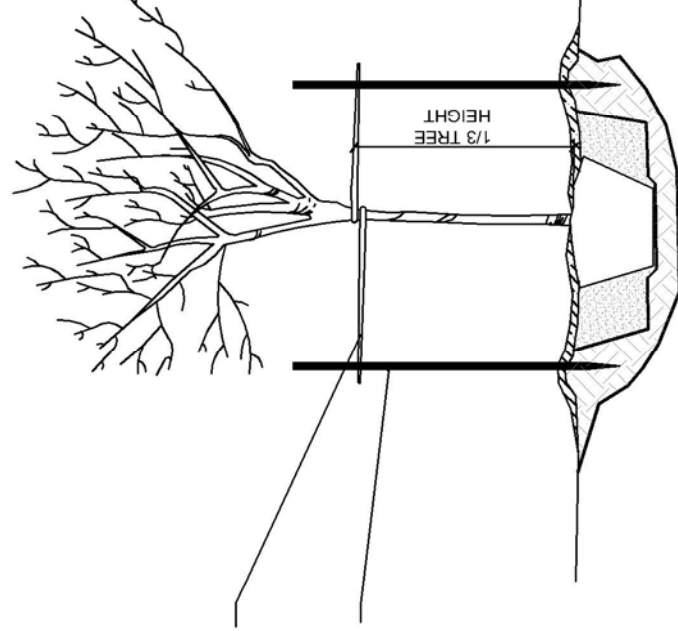

SMALL TREE PLANTING (< 2\"/>

N.T.S.

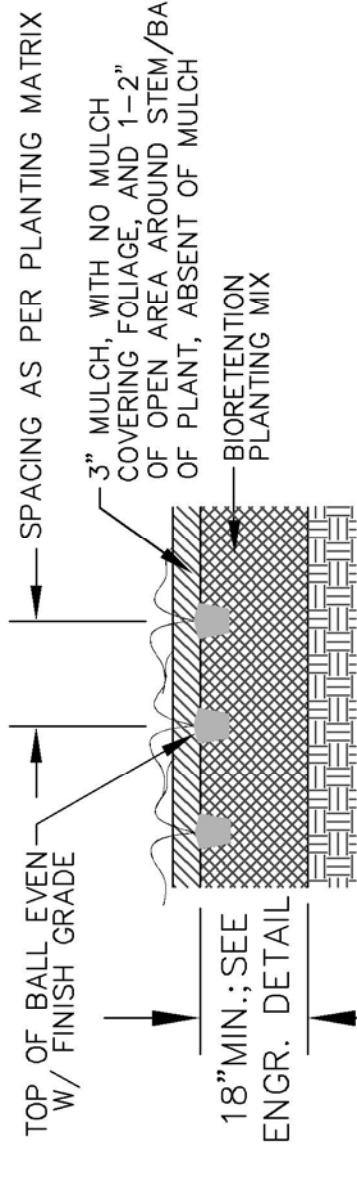

PERENNIAL PLANTING DETAIL

N.T.S.

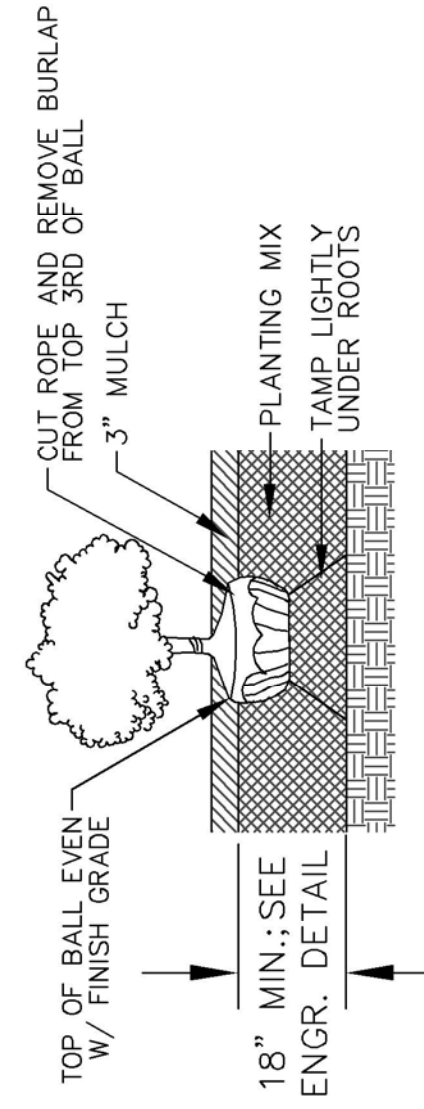

SHRUB PLANTING DETAIL

N.T.S.

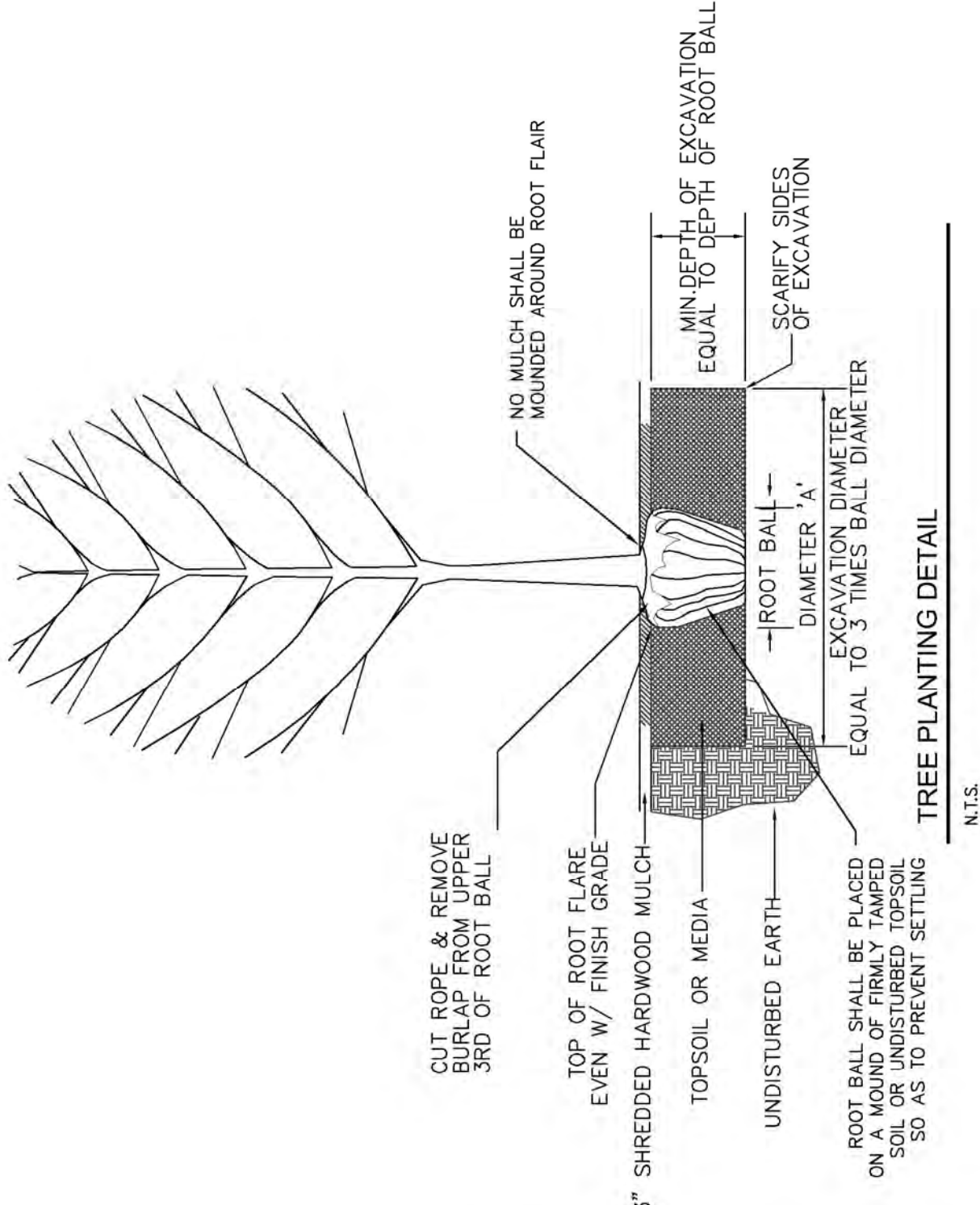

TREE PLANTING DETAIL

N.T.S.

Trees - In All Zones

Symbol Code	Quantity	Scientific Name	Common Name	Type	Spacing	Remarks
Zone A - LEFT CHINA	7	Betula nigra 'Dorchester'	"Dorchester" River Birch	B & B	50' O.C.	* Multi-leader, upright form, with full canopy, matching specimens, paired of lateral branches to 6'.
n/a	16	Cercis canadensis var. 'Yuccifolia'	Texas/Oklahoma Redbud	B & B	n/a	* Upright, symmetrical form with full rounded canopy. Local: no more than 8' to 10' in height.
n/a	9	Myrica pyramidalis var. 'Bicolor'	Savanna Black Gum	B & B	n/a	* Upright, symmetrical form with full rounded canopy. Local: no more than 8' to 10' in height.
Zone A - TAXUS	6	Taxodium distichum	Bald Cypress	B & B	55' O.C.	* Upright, symmetrical form with full, dense foliage.

Zone A - Lowest Portion of Basin

Yamaguchi Architect to Center of Condensed Plans on Site								
Zone	Code	Quantity	Scientific Name	Common Name	Minimum Size	Type	Spacing	Remarks
Zone A	CLETHRA	3	Clethra alnifolia 'Ruby Spice'	"Ruby Spice" Clethra	2 gal	container	6' triangular	* Dense, symmetrical, upright form. Full, dense crown. Not to be planted in a row, as it will spread horizontally in planting pits.
Zone A	HPC-DBERS	25	Hydrangea serrata 'Shamrock'	"Shamrock" Minkery Holly	2 gal	container	4' triangular	* Rounded, low form, full, dense crown. Not to be planted in a row, as it will spread horizontally in planting pits.
Zone A	LEX-GLAB	21	Lexis verticillata 'Berry Poppins'	"Berry Poppins" Winterberry	1 gal	container	36" triangular	* Upright, compact form. Not to be planted in a row, as it will spread horizontally in planting pits.
Zone A	LEX-VISM	6	Lexis verticillata 'Berry Poppins'	"Berry Poppins" Winterberry	2 gal	container	36" triangular	* Upright, compact form. Not to be planted in a row, as it will spread horizontally in planting pits.
Zone A	LEX-VISM	15	Lexis verticillata 'Berry Poppins'	"Berry Poppins" Winterberry	2 gal	container	36" triangular	* Upright, compact form. Not to be planted in a row, as it will spread horizontally in planting pits.

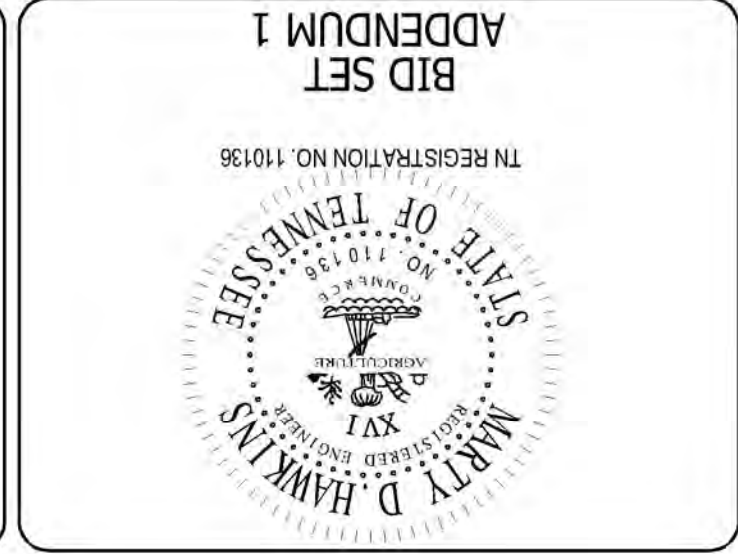
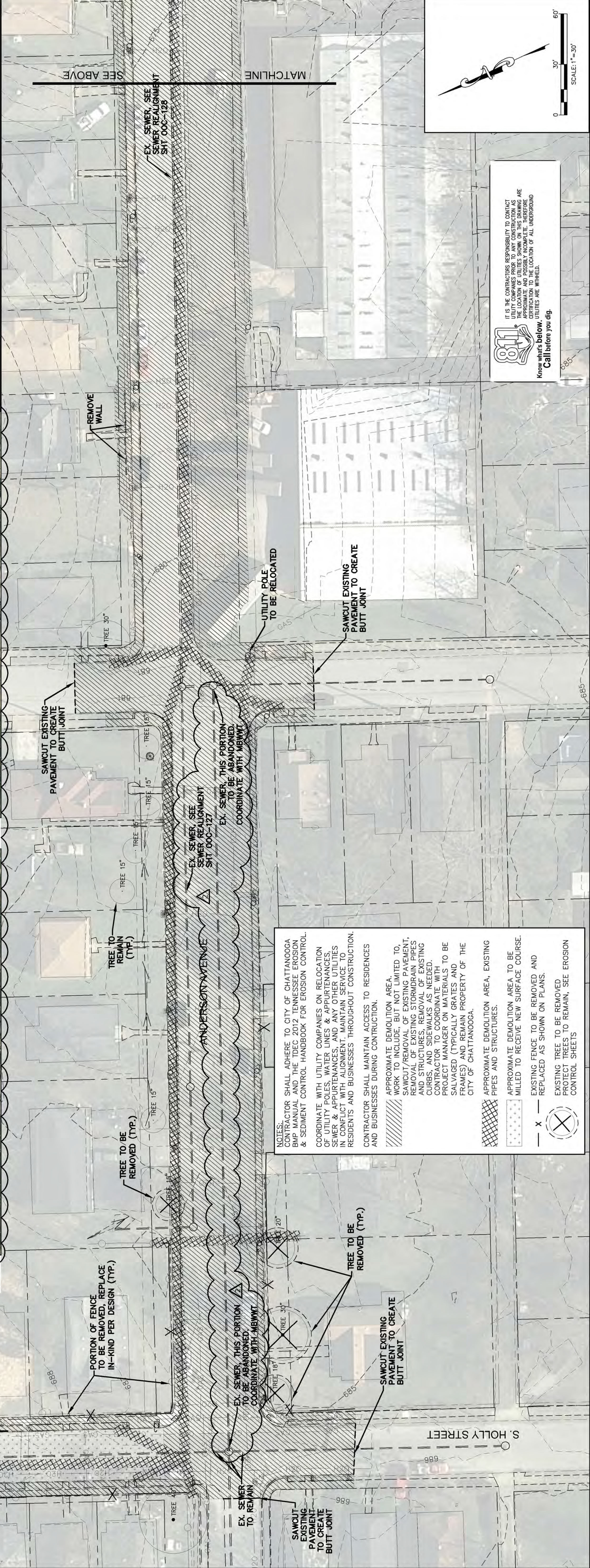
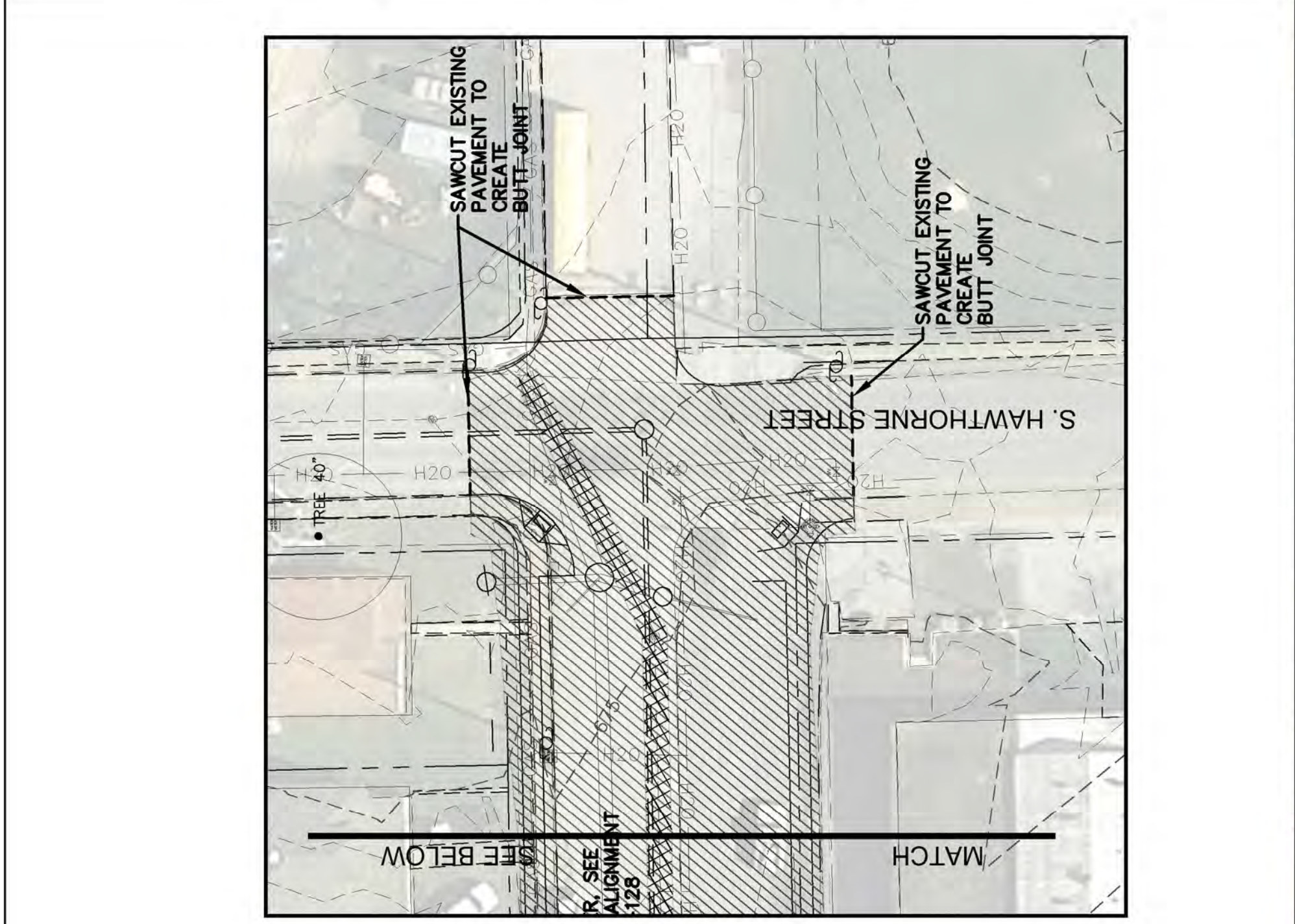
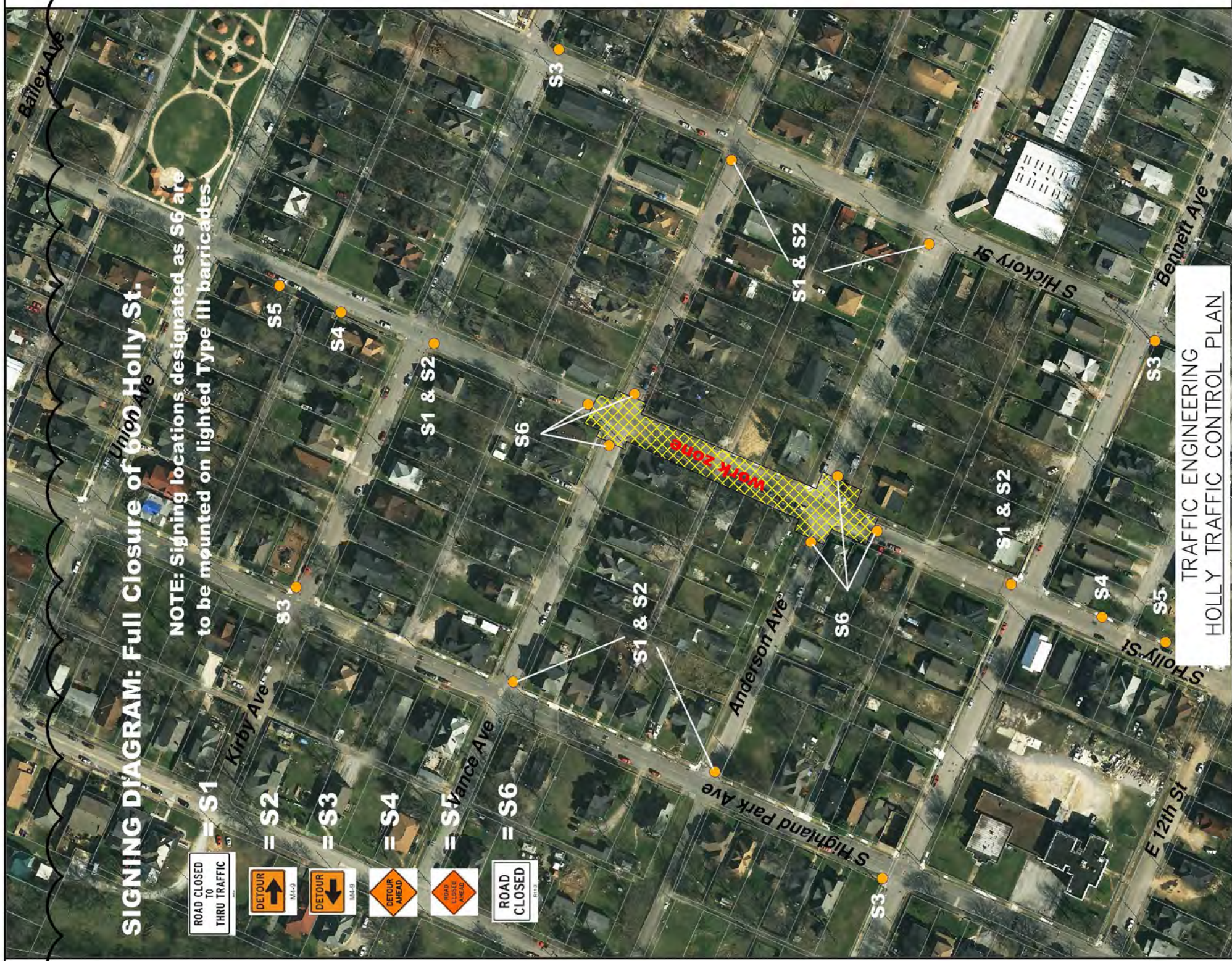
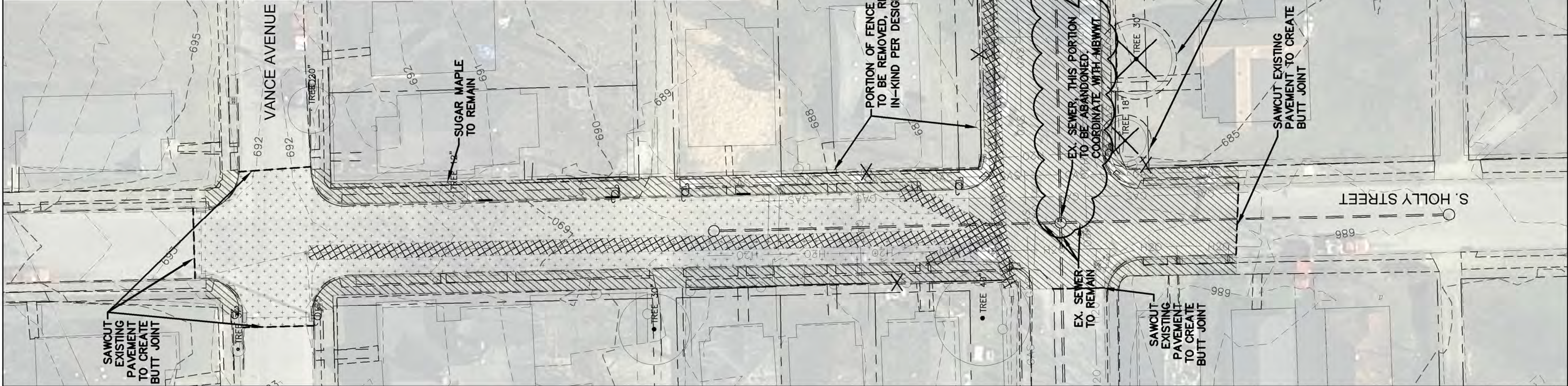

REV	DATE	REVISION DESCRIPTION
REV1	10/24/2014	CONSENT DECREE SUBMITTAL
REV2	12/01/2016	BID SET
REV3	1/5/2017	ADDENDUM 1
REV4		
REV5		
REV6		
REV7		
REV8		
REV9		
REV10		

THIS LINE IS ONE INCH LONG WHEN PLOTTED FULL SCALE
THIS DRAWING MUST BE USED IN CONJUNCTION WITH THE APPLICABLE OR GOVERNING TECHNICAL SPECIFICATIONS AND OTHER CONTRACT DOCUMENTS.
PROJECT NO: 5-11-001
DATE: OCTOBER 24, 2014
DISC LEAD: DESIGNER: MDH
MDH KLP
CHECKER: MDH
SHEET TITLE: CIVIL

TRAFFIC CONTROL AND DEMOLITION PLAN
SHEET: 00C-102

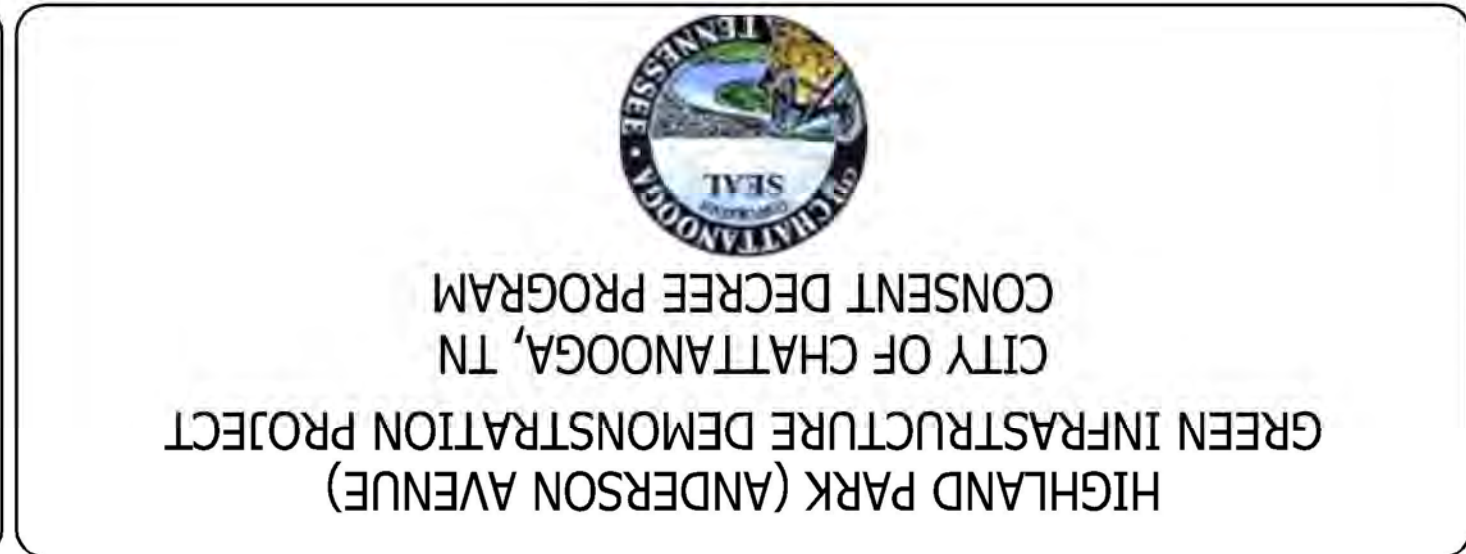
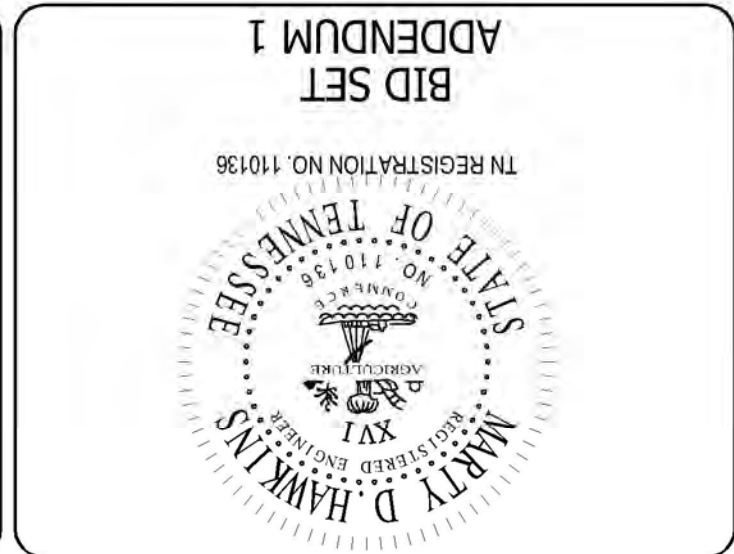
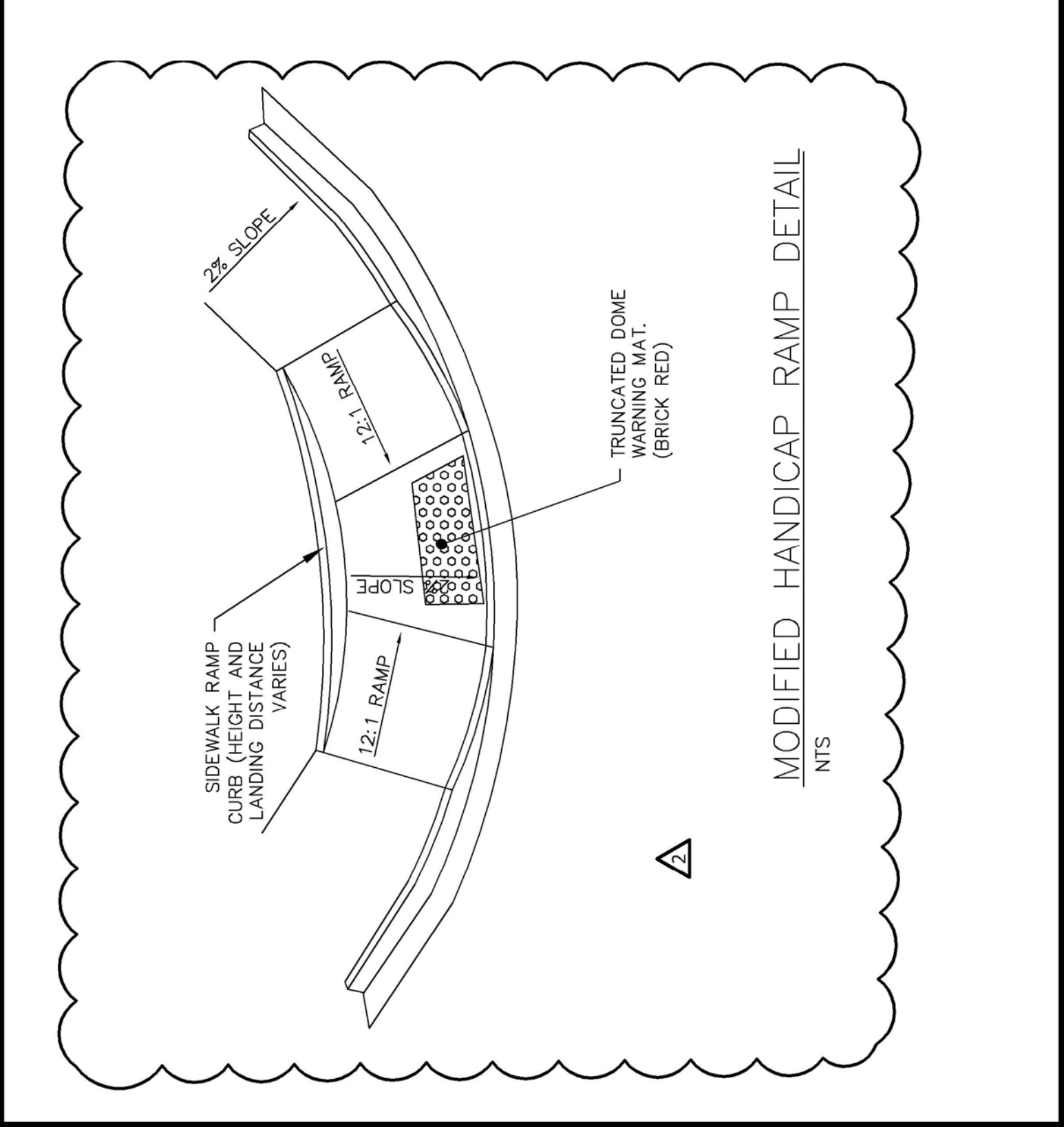
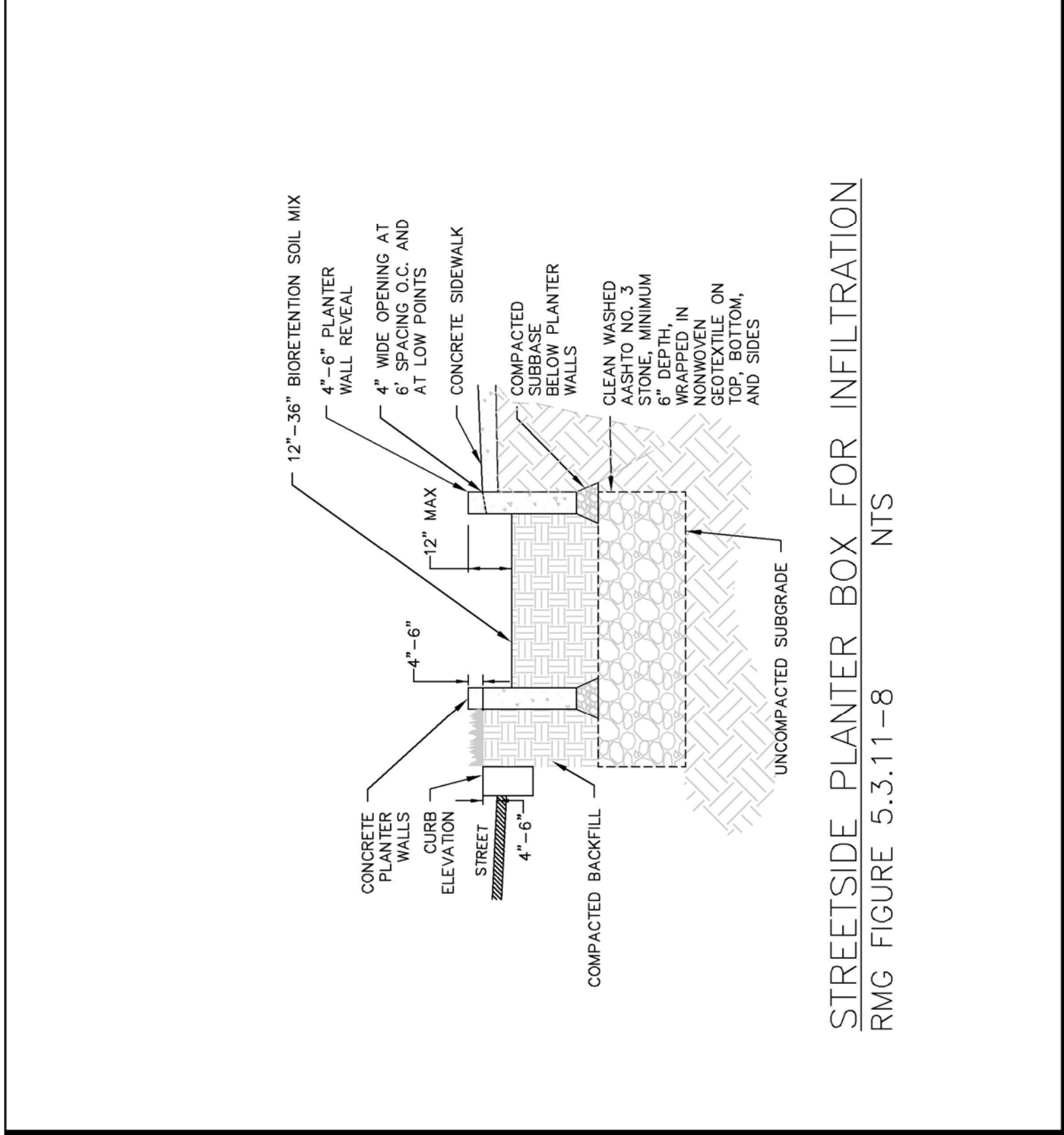
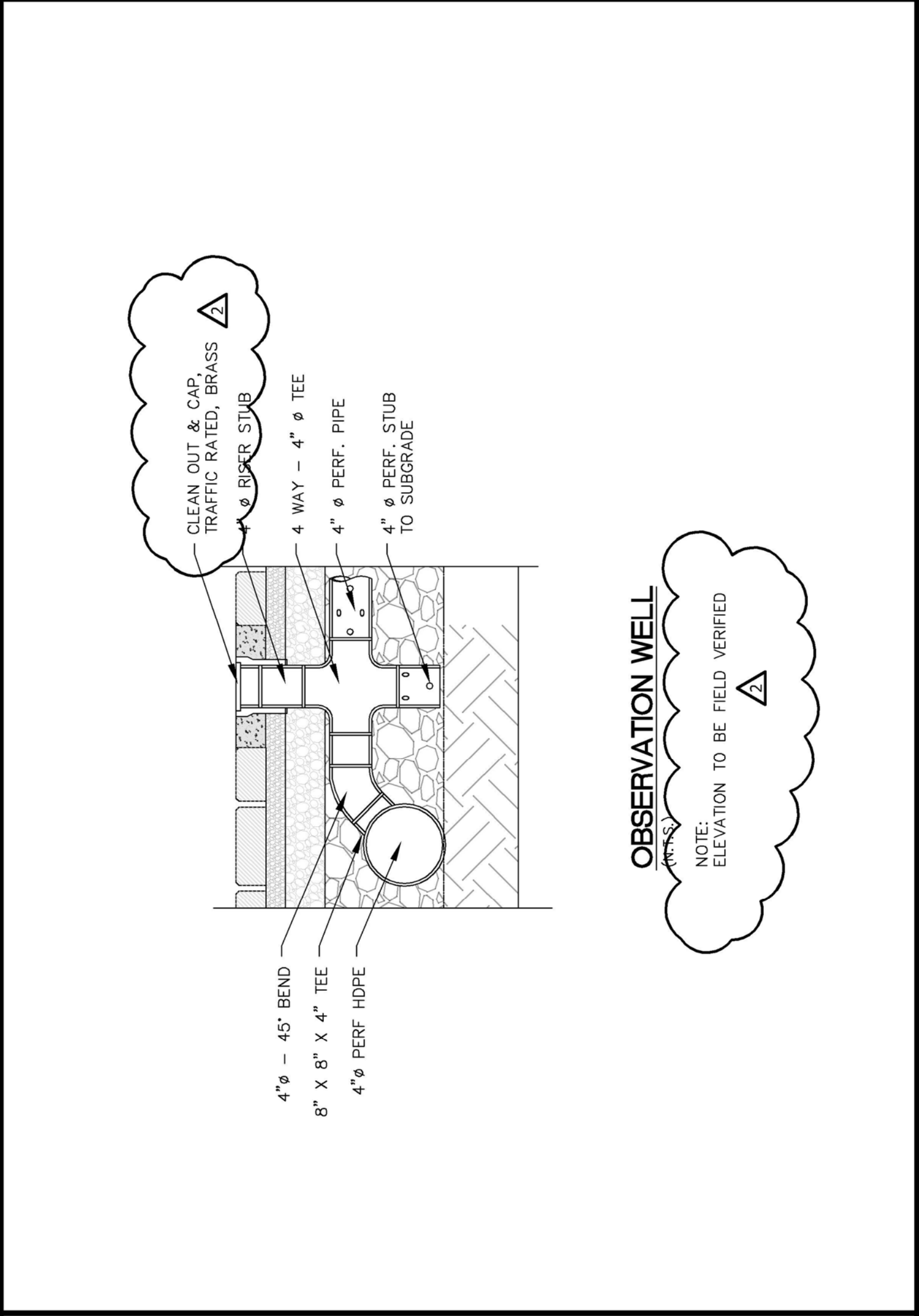
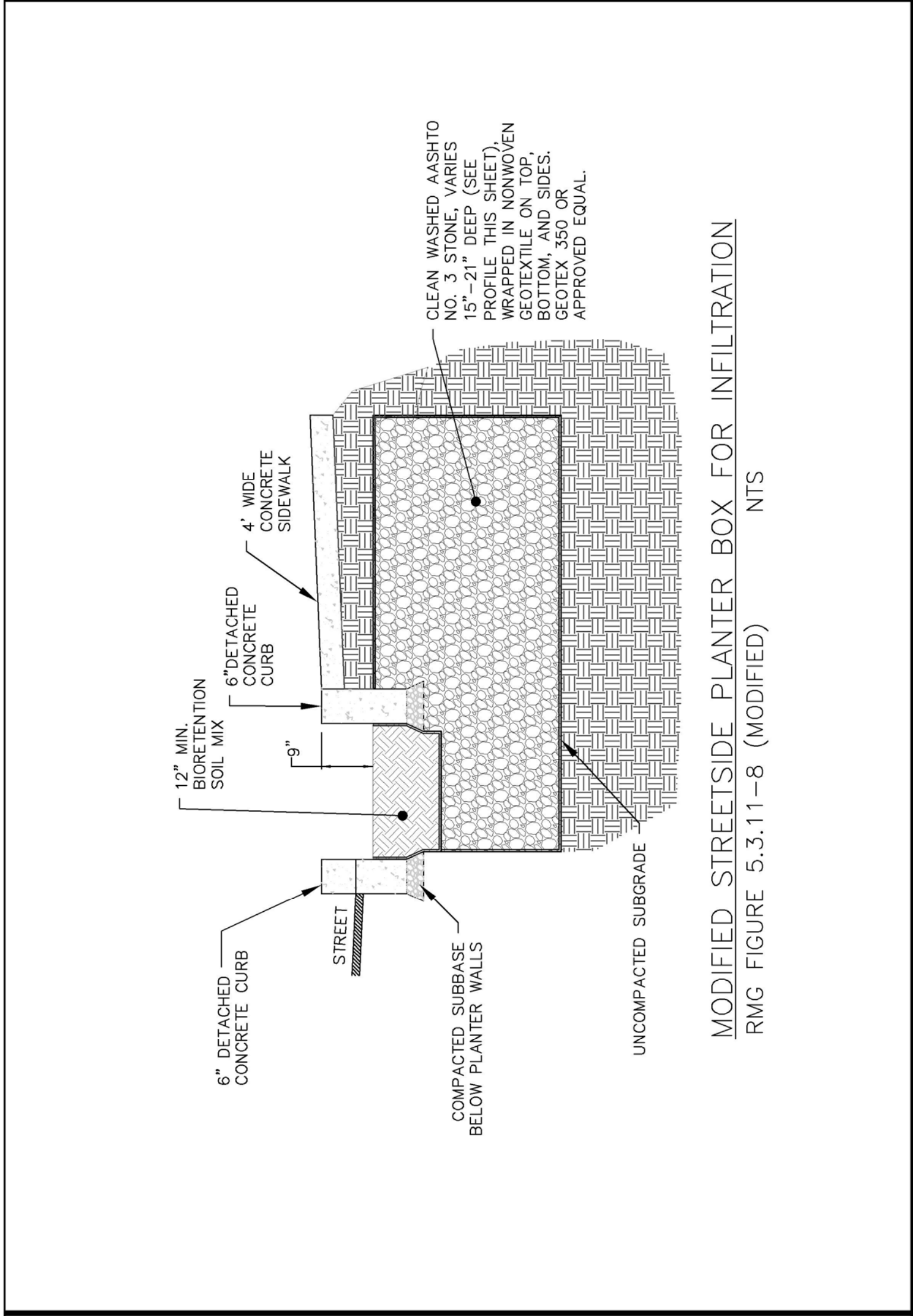
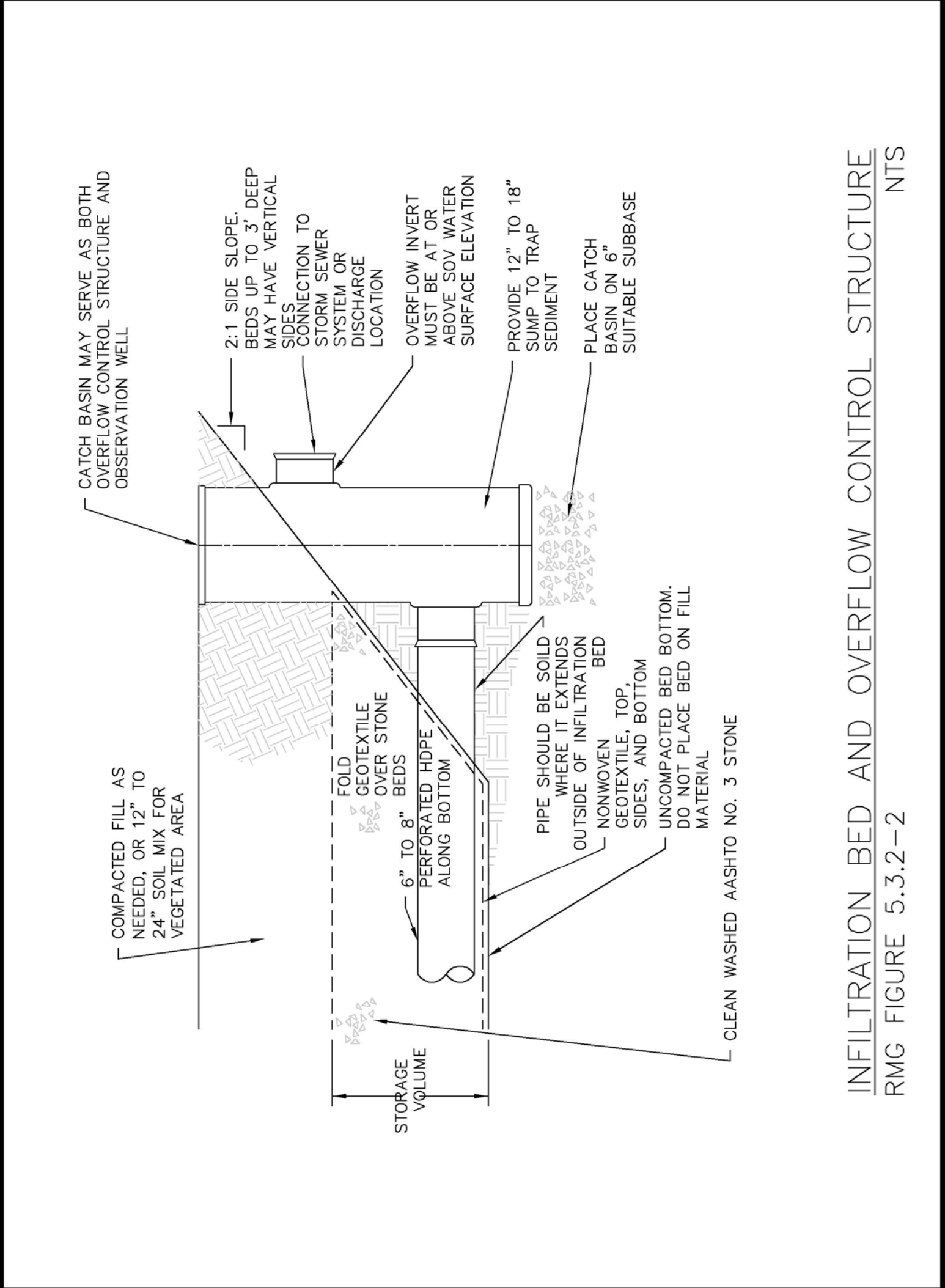
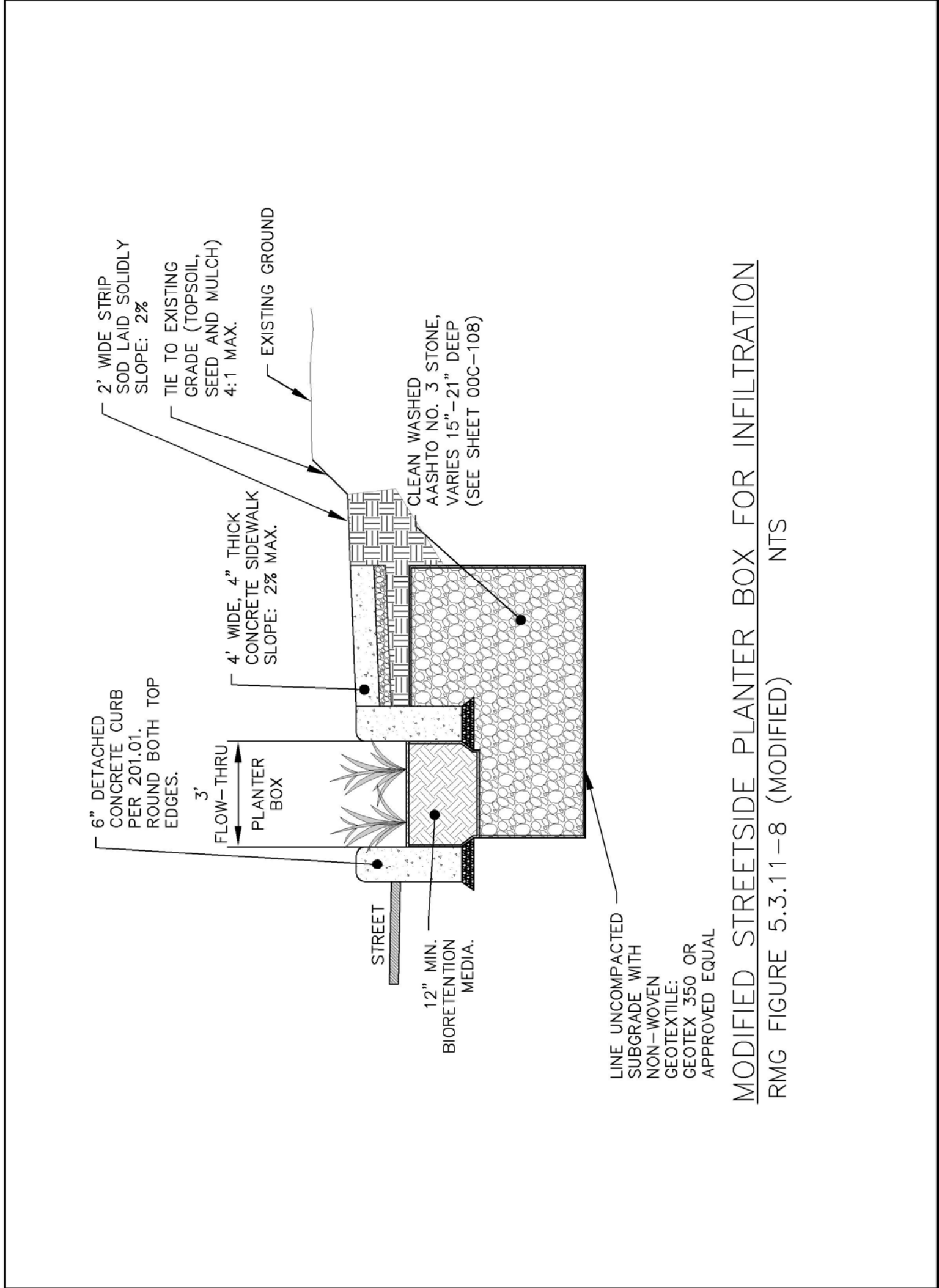

REV	DATE	REVISION DESCRIPTION
REV1	10/24/2014	CONSENT DECREE SUBMITTAL
REV2	12/01/2016	BID SET
REV3	1/5/2017	APPENDUM 1
REV4		
REV5		
REV6		
REV7		
REV8		
REV9		
REV10		

THIS LINE IS ONE INCH LONG WHEN PLOTTED FULL SCALE	
THIS DRAWING MUST BE USED IN CONJUNCTION WITH THE APPLICABLE OR GOVERNING TECHNICAL SPECIFICATIONS AND OTHER CONTRACT DOCUMENTS.	
PROJECT NO: 5-11-001	
DATE: OCTOBER 24, 2014	CHECKER:
DISC. LEAD: MDH	DESIGNER: GH
SHEET TITLE: CIVIL	
DETAILS	
SHEET	00C-115

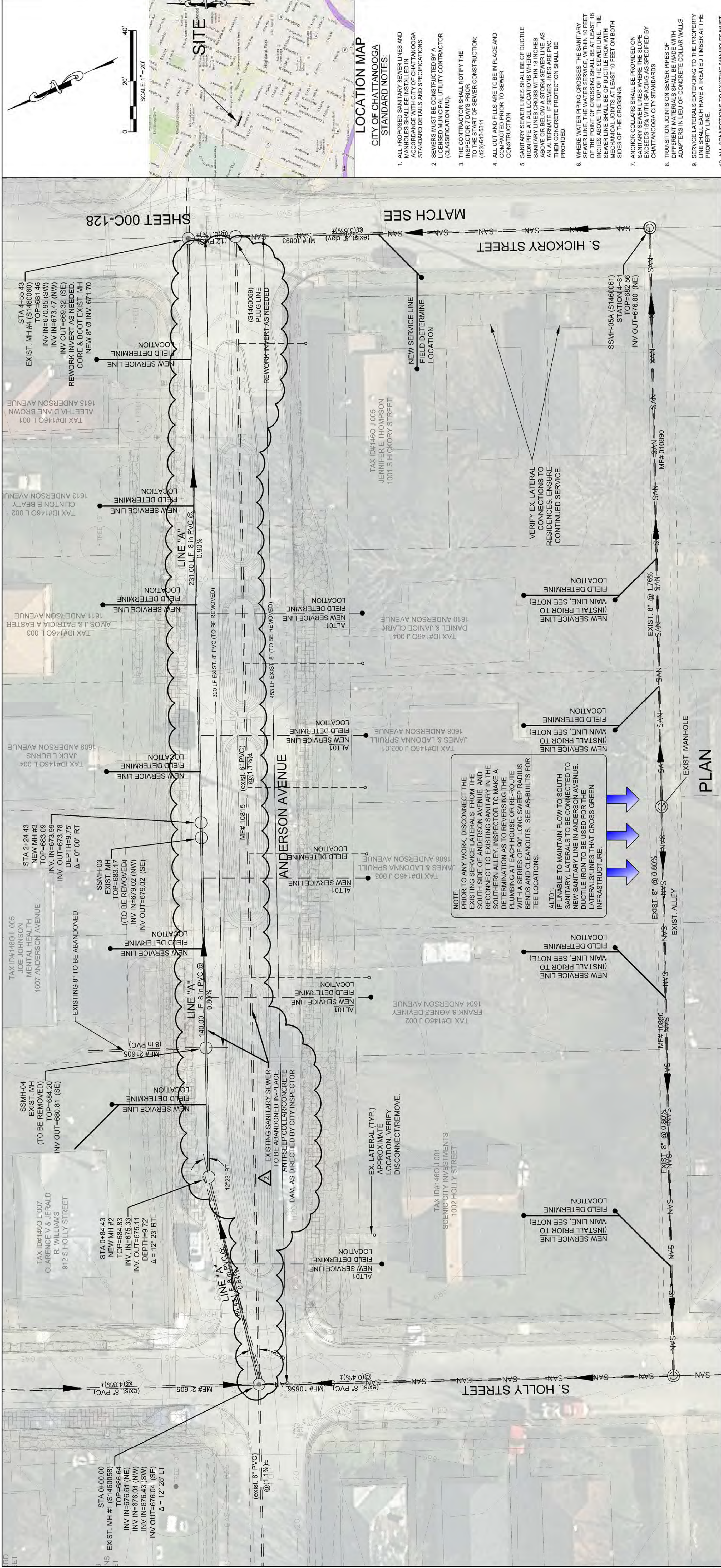
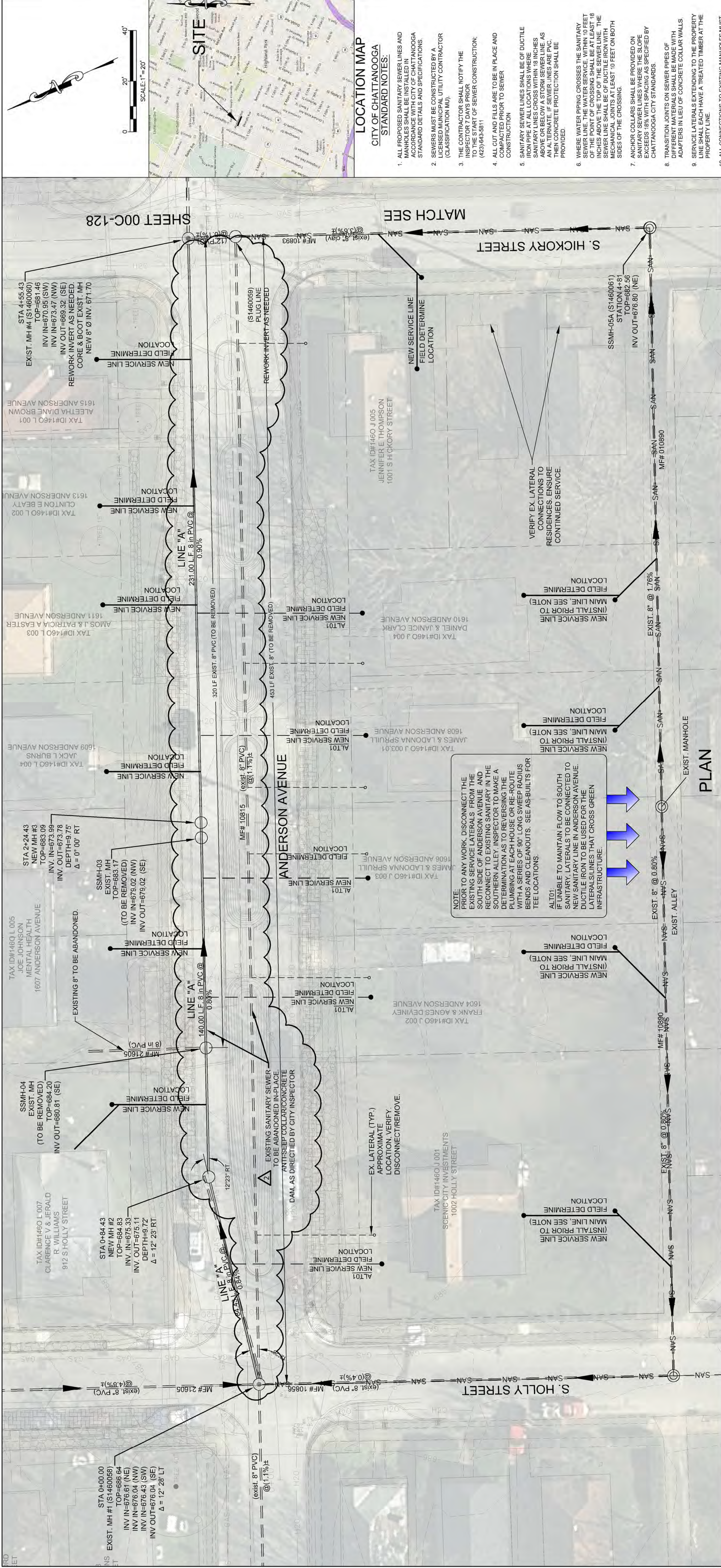
[illegible]