

Construction Plans

for

City of Myrtle Beach Canal Street 24 Inch Force Main Replacement

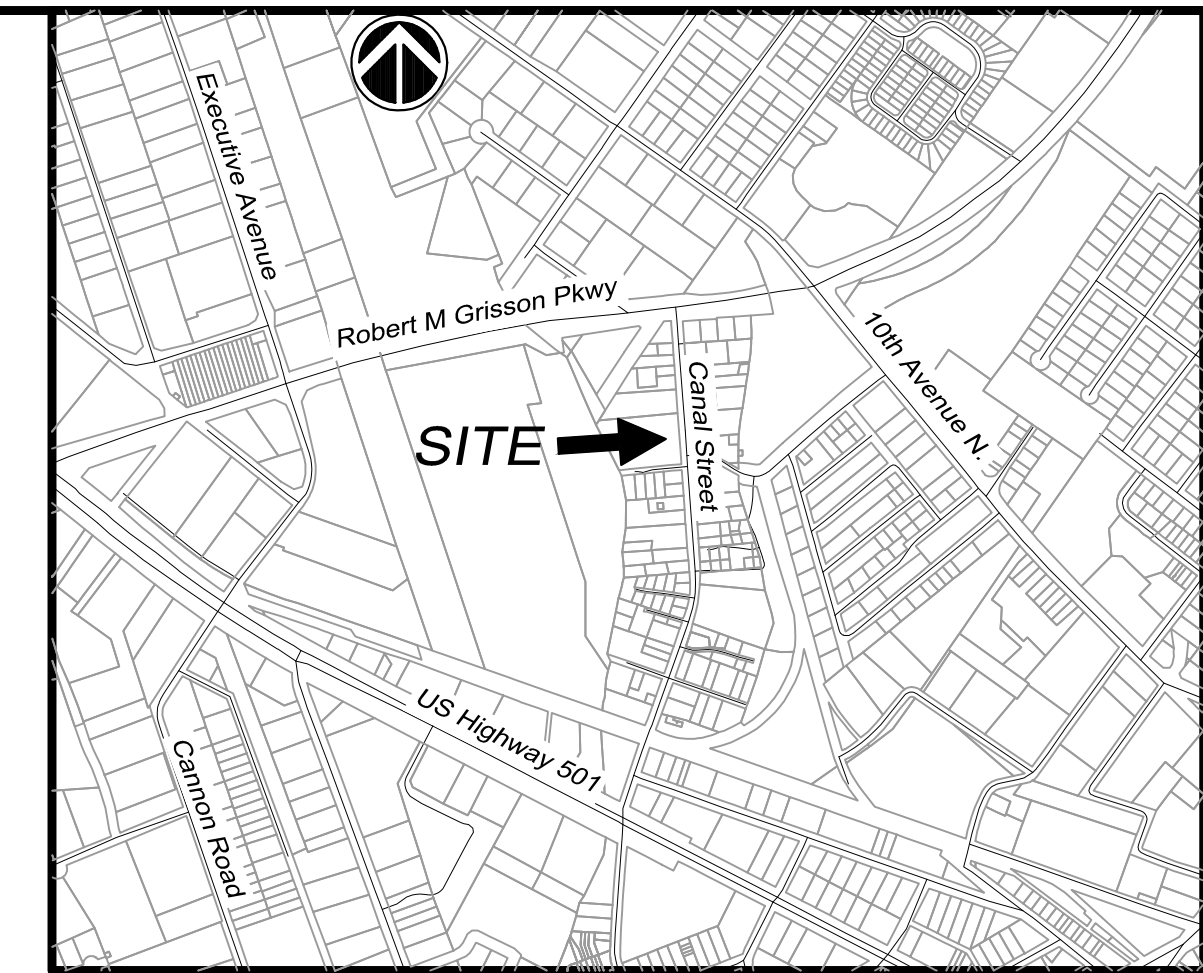

VICINITY MAP
N.T.S.

GENERAL NOTES

- ALL WORK SHALL BE IN ACCORDANCE WITH THE APPLICABLE FEDERAL, SOUTH CAROLINA AND LOCAL ORDINANCES, REGULATIONS, SPECIFICATIONS AND PERMITS.
- WORK WITHIN PUBLIC RIGHT-OF-WAYS OR PRIVATE EASEMENTS SHALL BE ACCOMPLISHED BY THE CONTRACTOR ACCORDING TO THE REQUIREMENTS OR CONDITIONS OF THE ENCROACHMENT PERMIT OR OTHER LEGAL DOCUMENTS AS THOUGH DOCUMENTS WERE ISSUED IN THE CONTRACTORS NAME. THE CONTRACTOR SHALL MAINTAIN COPIES OF THESE DOCUMENTS ON THE SITE AT ALL TIMES.
- WORK WITHIN STATE HIGHWAY RIGHT-OF-WAYS SHALL BE COORDINATED WITH THE SCDOT PRIOR TO AND DURING CONSTRUCTION, AND SHALL COMPLY WITH THE REQUIREMENTS OF THE ENCROACHMENT PERMITS.
- ALL WORK SHALL COMPLY WITH THE FOLLOWING:
"A POLICY FOR ACCOMODATING UTILITIES ON HIGHWAY RIGHT-OF-WAYS" BY THE SCDOT DATED MARCH 1987, A COPY OF WHICH IS AVAILABLE FROM THE STATE UTILITIES ENGINEER'S OFFICE IN COLUMBIA.

"MANUAL ON UNIFORM TRAFFIC CONTROL DEVICES FOR STREETS AND HIGHWAYS" BY THE FHA, DATED 2000 (OR LATEST STANDARDS) AND ALL SUBSEQUENT ADDENDA, SHALL BE USED TO DETERMINE SIGNAGE AND TRAFFIC CONTROL REQUIREMENTS.

"STANDARD SPECIFICATIONS FOR HIGHWAY CONSTRUCTION" BY SCDOT, DATED 2007 (OR LATEST STANDARDS), SHALL BE USED TO DETERMINE MATERIALS AND METHODS OF CONSTRUCTION.
- THE CONTRACTOR SHALL BE RESPONSIBLE FOR LOCATING EXISTING UTILITIES AND FOR REPAIRING ANY DAMAGE TO SAME. UTILITY LOCATIONS AS SHOWN ON THE PLANS ARE APPROXIMATE AND MAY NOT BE COMPLETE. THE CONTRACTOR SHALL CONTACT ALL UTILITY COMPANIES THAT MAY HAVE SERVICE IN THE AREA FOR AN ACCURATE LOCATION PRIOR TO BEGINNING WORK.
- WHEN THE CONTRACTOR IS UNABLE TO COMPLETE HIS WORK AS SHOWN ON THE PLANS BECAUSE OF AN EXISTING UTILITY, CONTRACTOR SHALL STAKE THE LOCATION OF THE UTILITY PRIOR TO PROCEEDING AND CONTACT THE ENGINEER.
- ALL TRENCHES SHALL BE COMPACTED TO 98% STANDARD PROCTOR. TRENCHES LOCATED IN ASPHALT PAVED AREAS SHALL BE BACKFILLED WITH SELECT SAND. EXCESS EXCAVATION MATERIAL SHALL BE REMOVED FROM THE SITE AND DISPOSED OF AT NO ADDITIONAL COST TO THE OWNER.
- PROVISIONS SHALL BE MADE TO PREVENT EROSION AND SILTATION CAUSED BY CONSTRUCTION. TEMPORARY GRASSING, HAY BALES, SILT FENCES OR OTHER METHODS; AS CALLED FOR ON THE PLAN OR THAT MAY BE REQUIRED; SHALL BE USED.
- PROVISIONS SHALL BE MADE TO ENSURE POSITIVE DRAINAGE ON THE SITE AT ALL TIMES. NATURAL DRAINAGE FEATURES DISTURBED BY CONSTRUCTION MUST BE RE-ESTABLISHED. NO PONDING DUE TO SPOILS STOCKPILING OR OTHER ACTIVITIES SHALL BE PERMITTED.
- ALL EXISTING STRUCTURES, UTILITIES, AND PHYSICAL FEATURES SHOWN ON THE PLANS ARE EXISTING UNLESS OTHERWISE LABELLED OR NOTED.
- PROPERTY LINES SHOWN ON THE PLANS ARE BASED ON A RECENT SURVEY OF THE RIGHT-OF-WAY OF CANAL STREET AND THE FRONTAGE OF NUMEROUS PROPERTIES ALONG THIS ROUTE. PROPERTY LINES SHOULD BE CONSIDERED ACCURATE FOR THE PURPOSES OF THIS PROJECT, HOWEVER A COMPLETE BOUNDARY SURVEY OF ALL PROPERTIES ALONG THIS ROUTE WAS NOT COMPLETED FOR THIS PROJECT.
- THREE DAYS BEFORE DIGGING IN SOUTH CAROLINA CALL 811 PALMETTO UTILITY LOCATION SERVICE.
- STABILIZATION MEASURES SHALL BE INITIATED AS SOON AS PRACTICABLE IN PORTIONS OF THE SITE WHERE CONSTRUCTION ACTIVITIES HAVE TEMPORARILY OR PERMANENTLY CEASED, BUT IN NO CASE MORE THAN 14 DAYS AFTER THE CONSTRUCTION ACTIVITY IN THAT PORTION OF THE SITE HAS TEMPORARILY OR PERMANENTLY CEASED, UNLESS ACTIVITY IN THAT PORTION OF THE SITE WILL RESUME WITHIN 21 DAYS.
- CONTRACTOR SHALL NOT LEAVE ANY DITCHES OPEN OVERNIGHT.

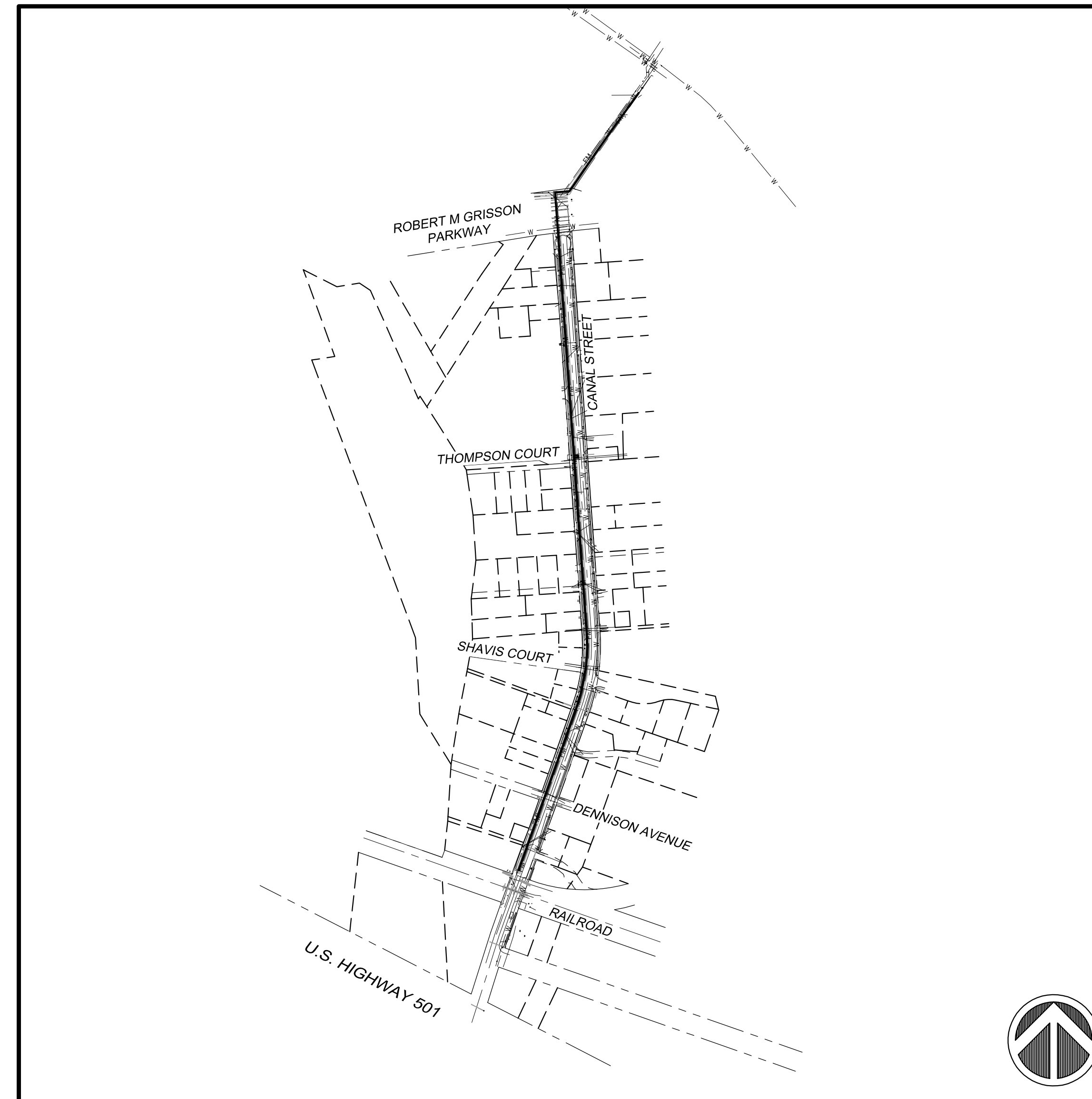

PROJECT LAYOUT
SCALE: 1" = 300'

SHEET SCHEDULE

SHEET NUMBER	SHEET TITLE	ORIGINAL DATE	REVISION DATE
GENERAL			
G0.01	COVER SHEET	7/22/2022	1/19/2023
C2.01	SEDIMENT AND EROSION CONTROL DETAILS	7/22/2022	
C2.02	SEDIMENT AND EROSION CONTROL - PHASE 1	7/22/2022	8/30/2022
C2.03	SEDIMENT AND EROSION CONTROL - PHASE 1	7/22/2022	
C2.04	SEDIMENT AND EROSION CONTROL - PHASE 1	7/22/2022	
C3.01	PROPOSED PLAN AND PROFILE	7/22/2022	8/30/2022
C3.02	PROPOSED PLAN AND PROFILE	7/22/2022	8/30/2022
C3.03	PROPOSED PLAN AND PROFILE	7/22/2022	8/30/2022
C3.04	PROPOSED PLAN AND PROFILE	7/22/2022	1/19/2023
C3.05	PROPOSED PLAN AND PROFILE	7/22/2022	
C5.01	DETAILS	7/22/2022	5/22/2023
C5.02	DETAILS	7/22/2022	8/30/2022

REVISION OCCURRENCE LIST

REVISION NO.	DATE	REVISION DESCRIPTION	BY
3	2/22/2023	REVISED PER CITY OF MYRTLE BEACH REVIEW.	PES
2	1/19/2023	REVISED PER SCDOT REVIEW.	PES
1	8/30/2022	REVISED PER CITY OF MYRTLE BEACH REVIEW.	PES

THIS SET IS CURRENT THROUGH SHEET DATED:

Prepared for:
City of Myrtle Beach
P.O. Drawer 2468
Myrtle Beach, S.C. 29578



1298 PROFESSIONAL DRIVE
MYRTLE BEACH, SOUTH CAROLINA 29577
Phone: (843) 692-3200
Email: bmi@bolton-menk.com
www.bolton-menk.com

DATE	NO.	DATE	REVISION DESCRIPTION	BY
7/22/22				
SCALE	1" = 200'			
DESIGNED	EKS			
DRAWN	PES			
CHECKED	EKS			
CLIENT PROJ. NO.	21104E			

CITY OF MYRTLE BEACH		SHEET
CITY OF MYRTLE BEACH CANAL STREET 24 INCH FORCE MAIN REPLACEMENT		G0.01
HORRY COUNTY, SOUTH CAROLINA		
COVER SHEET		

