



**ITB #2021-003 LITTLE MOUNTAIN RD BRIDGE REMOVAL, CULVERT
REPLACEMENT, GRADING, AND PAVING**

ADDENDUM 1

Return to: Lumpkin County Board of Commissioners
Ryan McDuffie, Purchasing Agent
99 Courthouse Hill, Suite D
Dahlonega, GA 30533

Bid Closing Date: June 22, 2021 at 2:00 PM, EST

Bid Issue Date: May 19, 2021

Addendum Issue Date: June 10, 2021 at 5:00 PM, EST

Pages: 2

By: Ryan McDuffie, Purchasing Agent

Vendor Name: _____
(A copy must be attached to the Addenda Acknowledgement)

-
1. Please make sure to include the bidders' certification and unit pricing sheet as part of your submission. Those two items are not on the checklist but are expected to be included in your submission.
 2. Bridge removal clarification- Disassemble the Bailey bridge to a size that the County can move on a low boy trailer. Bridge parts can be left on site and the County will move the parts offsite.
 3. Does the vendor need to provide a diversion plan?
 - a. There is no diversion plan required.
 4. Who will perform the concrete testing?
 - a. Awarded vendor.
 5. Are there any utilities that need to be moved?
 - a. Vendor will need to perform utility locating to confirm there are none.
 6. Who is doing the NPDES monitoring?
 - a. Disturbed area is less than 1 acre so NPDES monitoring is not required.

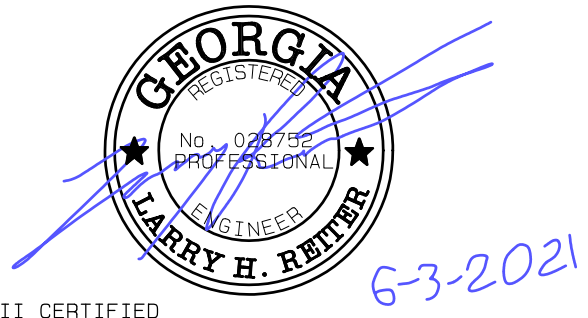
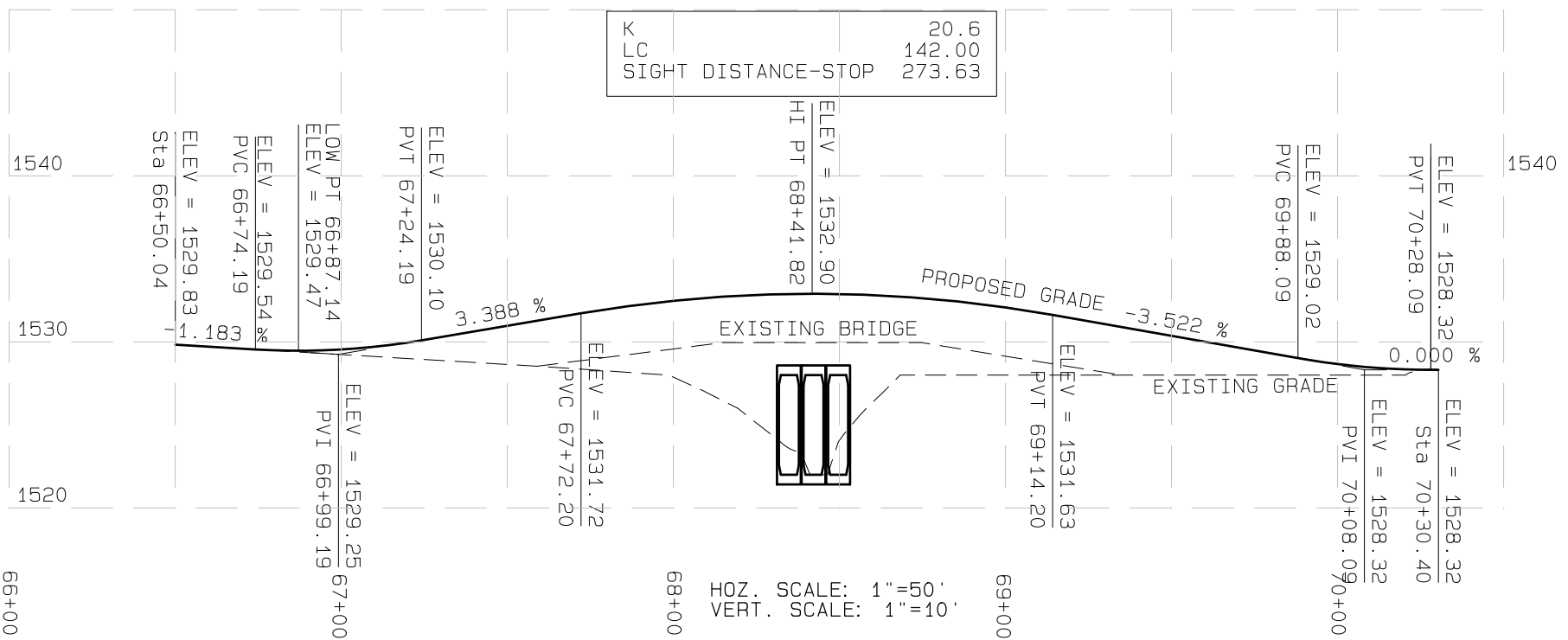
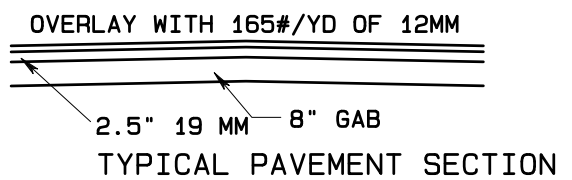
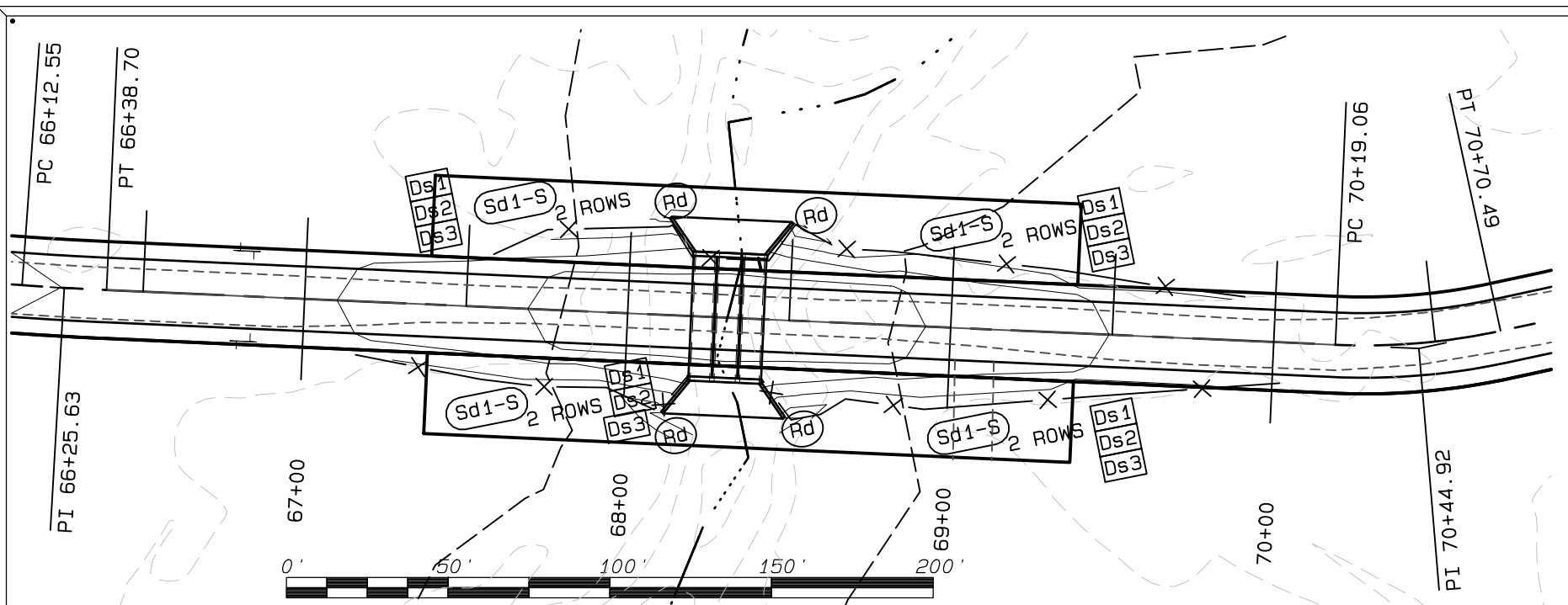

LEVEL II CERTIFIED
DESIGN PROFESSIONAL # 0000008180

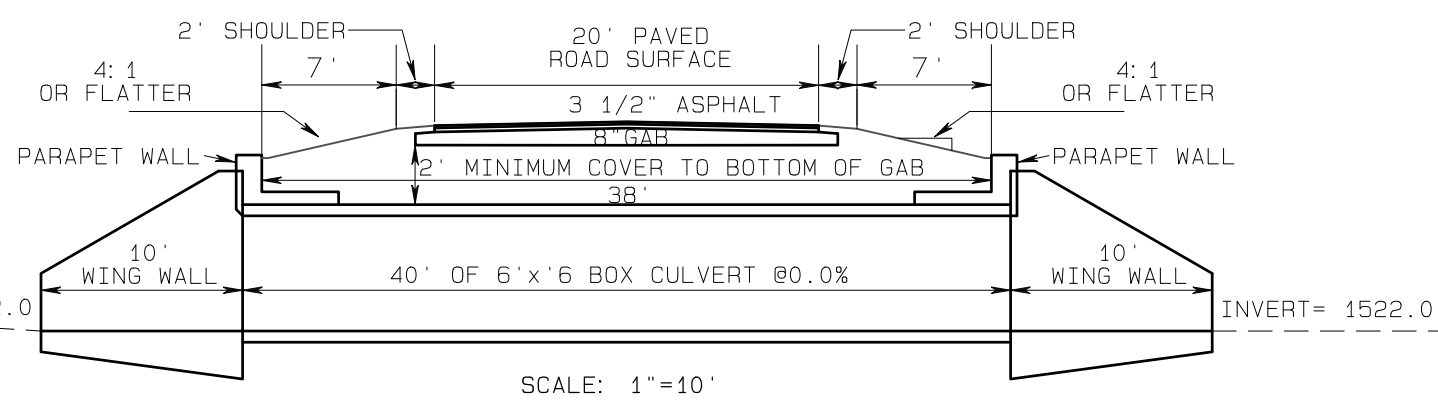

NOTES:
 COMNTRACTOR MAY USE PRECAST OR CAST IN PLACE CULVERTS
 ALL CONSTRUCTION OF BOX CULVERTS WILL BE PER GDOT STANDARDS AND SPECIFICATIONS.
 PRECAST STANDARDS: GDOT 2530P AND 2535P
 CAST IN PLACE STANDARDS: GDOT 2403-1, 2403-2-E, 2403-3, 2404, 2406-1, AND 2406-2
 PAY QUANTITIES WILL BE PER GDOT DETAILS

Lumpkin County Engineering
 1642 RED OAK FLATS RD
 DAHLONEGA, GEORGIA 30533
 PHONE: (706) 864-3122

LITTLE MOUNTAIN RD
 LUMPKIN COUNTY, GEORGIA

DATE: SEPT. 14, 2020
 DRAWN BY: LR
 SCALE: 1"=50'
 SHEET: C-034

DATE:	REVISIONS:	DESCRIPTION:
6-3-21	TURNED ON BMP LAYER	

Ds3 DISTURBED AREA STABILIZATION
PERMANENT VEGETATION

GRASS:
MARCH THRU MAY AND AUGUST THRU OCTOBER: TALL FESCUE 50 LBS PER ACRE
OTHER MONTHS: PLANT TEMPORARY SEEDING ONLY AS PER Ds2.
REPLANT IN MONTHS PERMINENT IN MONTHS LISTED ABOVE

LIME: 2 TONS PER ACRE

FERTILIZER:
FIRST YEAR- 6-12-12 AT 1500 LBS/ AC.
SECOND YEAR- 6-12-12 AT 800 LBS/ AC.

Ds2 DISTURBED AREA STABILIZATION
TEMPORARY VEGETATION

GRASS:
JANUARY- FEBUARY: RYE GRASS @ 40 LBS /AC
MARCH-APRIL: BROWNTOP MILLET @ 40 LBS/SAC
MAY-AUGUST: PEARL MILLET @ 50 LBS/AC
SEPTEMBER- DECEMBER: RYEGRASS @40 LBS/AC

Ds1 DISTURBED AREA STABILIZATION
TEMPORARY

Dry straw or hay shall be applied at a depth of 2 to 4 inches providing complete soil coverage.

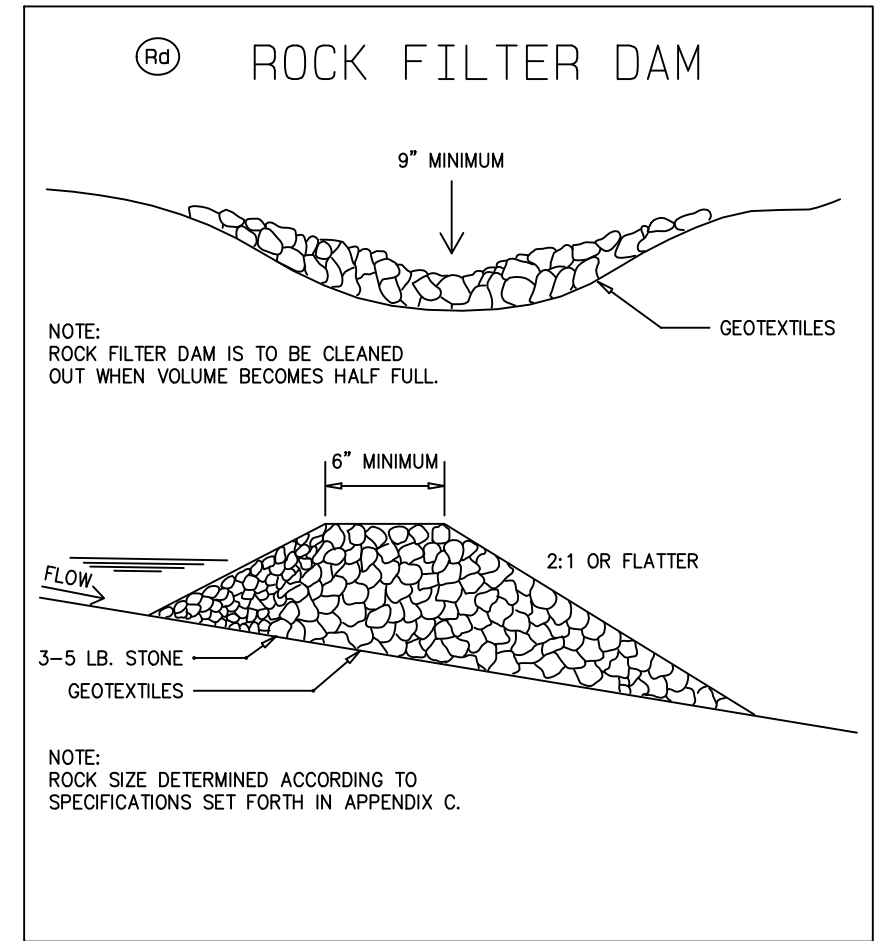
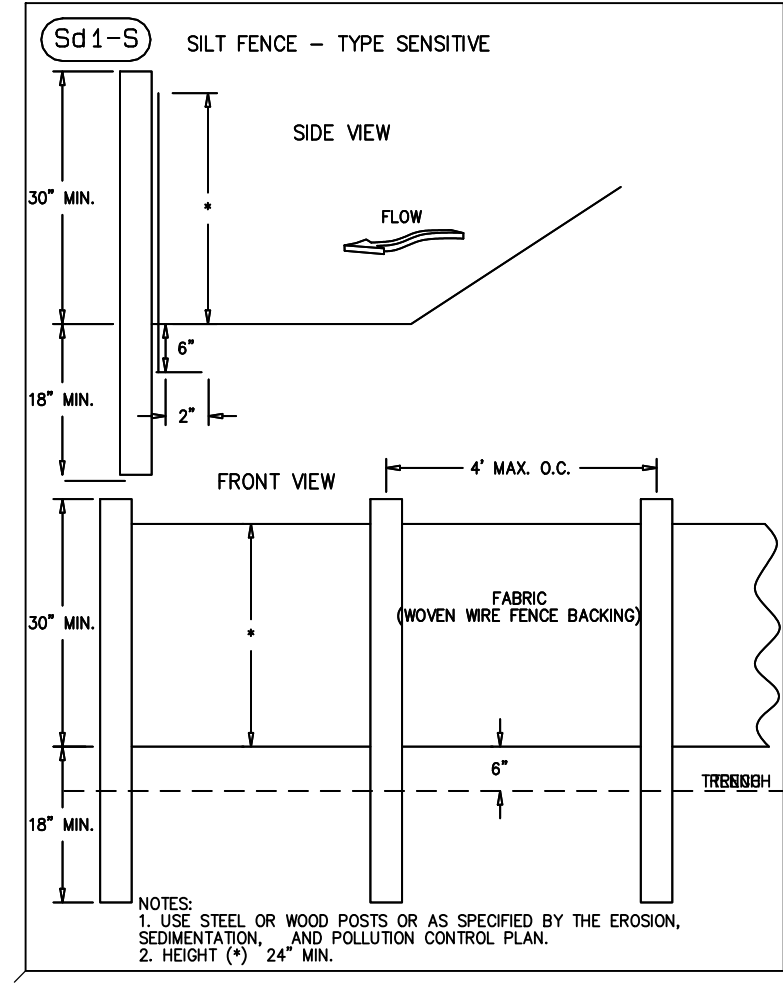

45. RUNOFF COEFFICIENT OR PEAK DISCHARGE

WESTERN TRIB. OF POVERTY CREEK
DRAINAGE AREA= 151 AC
TC= 21 MIN
PRE DEVELOPMENT CN= 58
POST DEVELOPMENT CN=58

Peak Flow by Rainfall Return Period		2-Yr	5-Yr	10-Yr	25-Yr	50-Yr	100-Yr
(cfs)	(cfs)	(cfs)	(cfs)	(cfs)	(cfs)	(cfs)	(cfs)
80.69	138.97	195.13	282.85	356.48	436.53		

POVERTY CREEK
DRAINAGE AREA= 1731 AC
TC= 87 MIN
PRE DEVELOPMENT CN= 65
POST DEVELOPMENT CN=65

Peak Flow by Rainfall Return Period		2-Yr	5-Yr	10-Yr	25-Yr	50-Yr	100-Yr
(cfs)	(cfs)	(cfs)	(cfs)	(cfs)	(cfs)	(cfs)	(cfs)
712.01	1078.06	1421.61	1939.12	2360.43	2819.04		

MILL CREEK
DRAINAGE AREA= 2232 AC
TC= 125 MIN
PRE DEVELOPMENT CN= 65
POST DEVELOPMENT CN=65

Peak Flow by Rainfall Return Period		2-Yr	5-Yr	10-Yr	25-Yr	50-Yr	100-Yr
(cfs)	(cfs)	(cfs)	(cfs)	(cfs)	(cfs)	(cfs)	(cfs)
726.55	1095.48	1438.96	1958.29	2397.70	2857.70		

34. Appendix B rationale for NTU values

Location	Drainage Area	Project Area	Appendix B Value
WESTERN TRIB. OF POVERTY CREEK	0.24 SQMI	3.2 AC	25 NTU
POVERTY CREEK	2.71 SQMI	10.5 AC	25 NTU
MILL CREEK	3.35 SQMI	112.83 AC	25 NTU

EROSION CONTROL CERTIFICATION

I CERTIFY UNDER PENALTY OF LAW THAT THIS PLAN WAS PREPARED AFTER A SITE VISIT TO THE LOCATIONS DESCRIBED HEREIN BY MYSELF OR MY AUTHORIZED AGENT, UNDER MY SUPERVISION.

Larry Reiter
LARRY REITER
LEVEL II CERTIFIED
DESIGN PROFESSIONAL # 0000008180

GEORGIA REGISTERED PROFESSIONAL ENGINEER
No. 028752
LARRY H. REITER
9-23-2020

LEVEL II CERTIFIED
DESIGN PROFESSIONAL # 0000008180

24 HR CONTACT:
LARRY REITER
(706) 973-7805

DATE: SEPT. 14, 2020
DRAWN BY: LR
SCALE: nts
SHEET: ES-003

EROSION CONTROL DETAILS
LITTLE MOUNTAIN RD
LUMPKIN COUNTY, GEORGIA

REVISIONS: DESCRIPTION DATE

Lumpkin County Engineering
1642 RED OAK FLATS RD
DAHLONEGA, GEORGIA 30533
PHONE: (706) 864-3122