

SECTION 009113.02 – ADDENDUM 2

1.1 PROJECT INFORMATION

- A. Project Name: Arlington County Water Pollution Control Plant (WPCP) Preliminary Treatment Upgrades (WPB2) Phase 9B
- B. Owner: Arlington County Department of Environmental Services (DES)
- C. Solicitation Number: 21-DES-ITB-477
- D. Engineer: Peter Loomis, PE
- E. Date of Addendum: June 08, 2021

1.2 NOTICE TO BIDDERS

- A. This Addendum is issued to all registered plan holders pursuant to the INSTRUCTIONS to Bidders. This Addendum serves to clarify, revise, and supersede information in the Project Manual, Drawings, and previously issued Addenda. Portions of the Addendum affecting the Contract Documents will be incorporated into the Contract by enumeration of the Addendum in the Owner/Contractor Agreement.
- B. The Bidder shall acknowledge receipt of this Addendum in the appropriate space on the Bid Form.

1.3 ATTACHMENTS

- A. This Addendum includes the following attached Sheets:
  - 1. Mechanical Sheet M-14, dated June 07, 2021, reissued.
- B. This Addendum includes the attached Addendum Drawings: (NOT USED)

1.4 REVISIONS TO PREVIOUS ADDENDA

- A. In Addendum No. 1, Article 1.7 REVISIONS TO 02-49 SPECIFICATION SECTIONS, following Paragraph B.1.4, ADD Paragraph B.1.5 “New HVAC piping”.
- B. In Addendum No.1, Article 1.10 QUESTIONS AND ANSWERS, Paragraph P, add the following additional response: “There is no specification for HVAC controls. All of the information is included on the drawings. Panel/enclosure construction is included on Drawing E-1 and in Specification Section 260533. See Addendum No. 2, Article 1.9 REVISIONS TO DRAWING SHEETS for clarification on use of Siemens to perform HVAC controls work.”

- 1.5 REVISIONS TO DIVISION 00 PROCUREMENT REQUIREMENTS AND CONTRACTING REQUIREMENTS (NOT USED)
  
- 1.6 REVISIONS TO DIVISION 01 GENERAL REQUIREMENTS
  - A. Specification Section 015000 “Temporary Facilities and Controls” (not reissued)
    - 1. Paragraph 3.2.A, DELETE “Engineer’s trailer shall be set up and ready for occupancy within 30 days of the Notice to Proceed.”
  - B. Specification Section 018100 “Maintenance of Plant Operations” (not reissued)
    - 1. Paragraph 1.9A.1, DELETE “EF-11” and REPLACE with “EF-10”
  
- 1.7 REVISIONS TO DIVISIONS 02 - 49 SPECIFICATION SECTIONS
  - A. Specification Section 051200 “Structural Steel Framing” (not reissued).
    - 1. Paragraph 1.7.B DELETE in its entirety.
  - B. Specification Section 099100 “Painting,” (not reissued).
    - 1. Replace paragraph 3.2A with “Not used.”
  - C. Specification Section 149182 “Debris Chute” (not reissued).
    - 1. Paragraph 2.2,B.4.b, DELETE “36” and REPLACE with “42”
    - 2. Paragraph 2.2,B.7, DELETE “1400” and REPLACE with “1000”
  - D. Specification Section 400506 “Couplings, Adapters, and Specials for Process Piping” (not reissued)
    - 1. Paragraph 1.5.J.4 DELETE in its entirety.
  - E. Specification Section 400519 “Ductile Iron Process Pipe” (not reissued)
    - 1. Paragraph 1.5.I DELETE in its entirety.
  - F. Specification Section 400567.36 “Pressure-regulating valves” (not reissued)
    - 1. Paragraph 1.4.H DELETE in its entirety.
  - G. Specification Section 400557 “Actuators for Process Valves and Gates” (not reissued).
    - 1. Paragraph 1.3,B, DELETE in its entirety
    - 2. Paragraph 2.3,A.4 DELETE “as noted in the valve or gate schedule”
    - 3. Paragraph 2.3,B.4 DELETE “the valve and gate schedule” and REPLACE with “Div 40”.
  - H. Specification Section 404213 “Process Piping Insulation” (not reissued)
    - 1. Paragraph 2.4.C.1, DELETE in its entirety and REPLACE with “Galvanized-steel insulation protection shield.”
  - I. Specification Section 462173.13 “ (not reissued)
    - 1. Paragraph 2.1.F,1 DELETE “1” and REPLACE with “G”.

1.8 REVISIONS TO APPENDICES (NOT USED)

1.9 REVISIONS TO DRAWING SHEETS

A. Sheet A-4 FIRST FLOOR PLAN, (not reissued).

1. Drawing A-4 FIRST FLOOR PLAN; replace note "CLEAN ALL FLOORS, WALLS, CEILINGS, MISCELLANEOUS METALS, AND EQUIPMENT THROUGHOUT FIRST FLOOR" with "CLEAN ALL FLOORS, WALLS, CEILINGS, MISCELLANEOUS METALS, AND EQUIPMENT IN FIRST FLOOR SCREEN ROOM 100."

B. Sheet A-5 SECOND FLOOR PLAN, (not reissued).

1. Drawing A-5 SECOND FLOOR PLAN; replace note "CLEAN ALL FLOORS, WALLS, CEILINGS, MISCELLANEOUS METALS, AND EQUIPMENT THROUGHOUT FIRST FLOOR" with "CLEAN ALL FLOORS, WALLS, CEILINGS, MISCELLANEOUS METALS, AND EQUIPMENT IN SECOND FLOOR SCREEN ROOM 200."

C. Sheet A-6 MEZZANINE PLAN, (not reissued).

1. Drawing A-6 MEZZANINE PLAN; replace note "CLEAN ALL FLOORS, WALLS, CEILINGS, MISCELLANEOUS METALS, AND EQUIPMENT THROUGHOUT MEZZANINE" with "CLEAN ALL FLOORS, WALLS, CEILINGS, MISCELLANEOUS METALS, AND EQUIPMENT IN MEZZANINE SCREEN ROOM 200."

D. Sheet S-9 (Not reissued):

1. Drawing S-9, ELEVATED PLAN B, the 47'-0" +/- long HSS Beam; Delete "HSS 24X24X1/2 (GALV)" and replace with "HSS 24X24X3/8 (GALV)".

E. Sheets H-2, H-3, H-4, and H-5 (Not Reissued):

1. Drawings H-2 FIRST FLOOR HVAC DEMOLITION PLAN, H-3 SECOND FLOOR HVAC DEMOLITION PLAN, H-4, SECOND FLOOR HVAC PIPING DEMOLOTION PLAN, AND H-5 ROOF HVAC DEMOLITION PLAN, in General Demolition Note 1: Delete 024199 and replace with 024119."

F. Sheet H-14 (Not Reissued):

1. Drawing H-14 HVAC SCHEDULES, in the HVAC Piping Material Schedule, add the following new sentences at the end of Note B: "Provide heat tracing on all exterior heating water supply/return piping. Refer to Electrical Drawings E-21 and E-24 (Detail H), and Specification Sections 230719 HVAC PIPING INSULATION and 404113.13 PROCESS PIPING ELECTRICAL RESISTANCE HEAT TRACING for additional details."

G. Sheet H-16 (Not Reissued)

1. Drawing H-16 HVAC DETAILS II, on the PTB SCREEN ROOM – PRIMARY/SECONDARY VENTILATION SYSTEM CONTROL COMPONENT DIAGRAM, DIVISION OF WORK SYMBOLS, add the following notes:

“NOTES:

1. Wiring between new PTB -MAU-02 panel and the existing Siemens DDC control panel and associated programming at the existing Siemens DDC control panel shall be performed by Siemens.
2. All of the remaining ATC wiring and associated programming shall be performed by the Contractor.”

H. Sheet H-17 (Not Reissued):

1. Drawing H-17 HVAC DETAILS III, on the GRAVITY THICKENER DAMPER POSITION SWITCHES HVAC SEQUENCE OF CONTROL diagram, add the following Note 3: “3. Conduit and wiring between PTB-ATC-02 and DCU-PTB shall be provided under Division 26. Work to the existing DCU-PTB panel shall be provided under Division 40.”

END OF DOCUMENT 009113.02

IDENTIFICATION CODES

- |  |   |  |  |
|--|---|--|--|
| 1 10" BLIND FLANGE, TYP EACH SIDE OF BUILDING.                                   | 7 CONCRETE PIPE SUPPORT                       | 12 8 DR-DI/F CLARIFIERS NOS. 5-8 DRAIN PIPE TO DRAIN PUMP AND AUX. DRAIN PUMP.           | 19 4" DI FLG 45° BEND, WYE, & BF, TYP. |
| 2 10"x12" FLANGE REDUCER WITH COLLAR, TYP 4 EACH SIDE OF BUILDING.               | 8 3 COW-DI/F                                  | 13 SANITARY DRAIN  | 20 NOT USED                            |
| 3 12" BLIND FLANGE, TYP EACH SIDE OF BUILDING.                                   | 9 4 PEW-DI/F                                  | 14 8" SCH 40 PVC SLEEVE. CAULK BETWEEN PIPE AND SLEEVE                                   | 21 NOT USED                            |
| 4 8" 22-1/2" DUCTILE IRON FLANGED ELBOW.   | 10 8 SL-DI/F PRL. SLUDGE TO GRAVITY THICKENER | 15 6" SCH 40 PVC SLEEVE. CAULK BETWEEN PIPE AND SLEEVE                                   | 22 NOT USED                            |
| 5 8 DR-DI/F, CL EL TO MATCH EXISTING 8 DR-DI/F AT JUNCTION WITH EXISTING TUNNEL. | 11 EXISTING 8 DR-DI, CL EL VARIES.            | 16 NOT USED  | 27 CONCRETE PIPE SUPPORT               |
| 6 8" RESTRAINED FLANGE ADAPTER ON EXISTING 8 DR-DI                               |   | 17 NOT USED  |  |
|  |   | 18 8" SCH. 40 GS SLEEVE. INSULATE THR. SLEEVE. PIPE CLAMP SUPPORT ON TOP OF SLEEVE, TYP. |  |

NOTES:

1. CODED NOTES ARE EXISTING AND FOR REFERENCE ONLY.
2. SCUM CONCENTRATION INSTRUMENTATION PROVIDED AND LOCATED BY MANUFACTURER. REFER TO INSTRUMENTATION DRAWINGS FOR DETAILS.
3. CONTRACTOR TO COORDINATE PULLEY/WINCH LOCATION TO ALLOW DEBRIS CHUTE RANGE OF MOTION ALONG DUMPSTER LENGTH AND AVOID OBSTRUCTION WITH NEW AND EXISTING INFRASTRUCTURE.



DEPARTMENT OF ENVIRONMENTAL SERVICES  
WATER POLLUTION CONTROL BUREAU  
3402 S. GLEBE ROAD  
ARLINGTON, VA 22202  
PHONE: 703.228.6820

COPYRIGHT © 2016 ARLINGTON COUNTY VIRGINIA - ALL RIGHTS RESERVED

SEAL

APPROVALS DATE

100% BID SET

Revisions Date

ADDENDUM NO. 2 (EMS) 06/07/21

Water Pollution Control Plant  
Preliminary Treatment Upgrades (WPB2)  
Phase 9B  
PRELIMINARY TREATMENT BUILDING  
PROPOSED SECTIONS II

Project Name and Location

Designed: A. LUTHRA  
Drawn: E. JOHNSON  
Checked: E. SPARGIMINO  
Miss Utility Transmittal #:

Filename: M014PTSC.dwg  
Path: C:\pwworking\johnson\1255023  
Plotted: June 7, 2021  
Plotted by: Johnsonec

Scale: AS NOTED



Sht. 44 of 97

M-14

© 2021 CDM SMITH. ALL RIGHTS RESERVED. REUSE OF DOCUMENTS: THESE DOCUMENTS AND DESIGNS PROVIDED BY PROFESSIONAL SERVICE, INCORPORATED HEREIN, ARE THE PROPERTY OF CDM SMITH, AND ARE NOT TO BE USED, IN WHOLE OR PART, FOR ANY OTHER PROJECT WITHOUT THE WRITTEN AUTHORIZATION OF CDM SMITH.

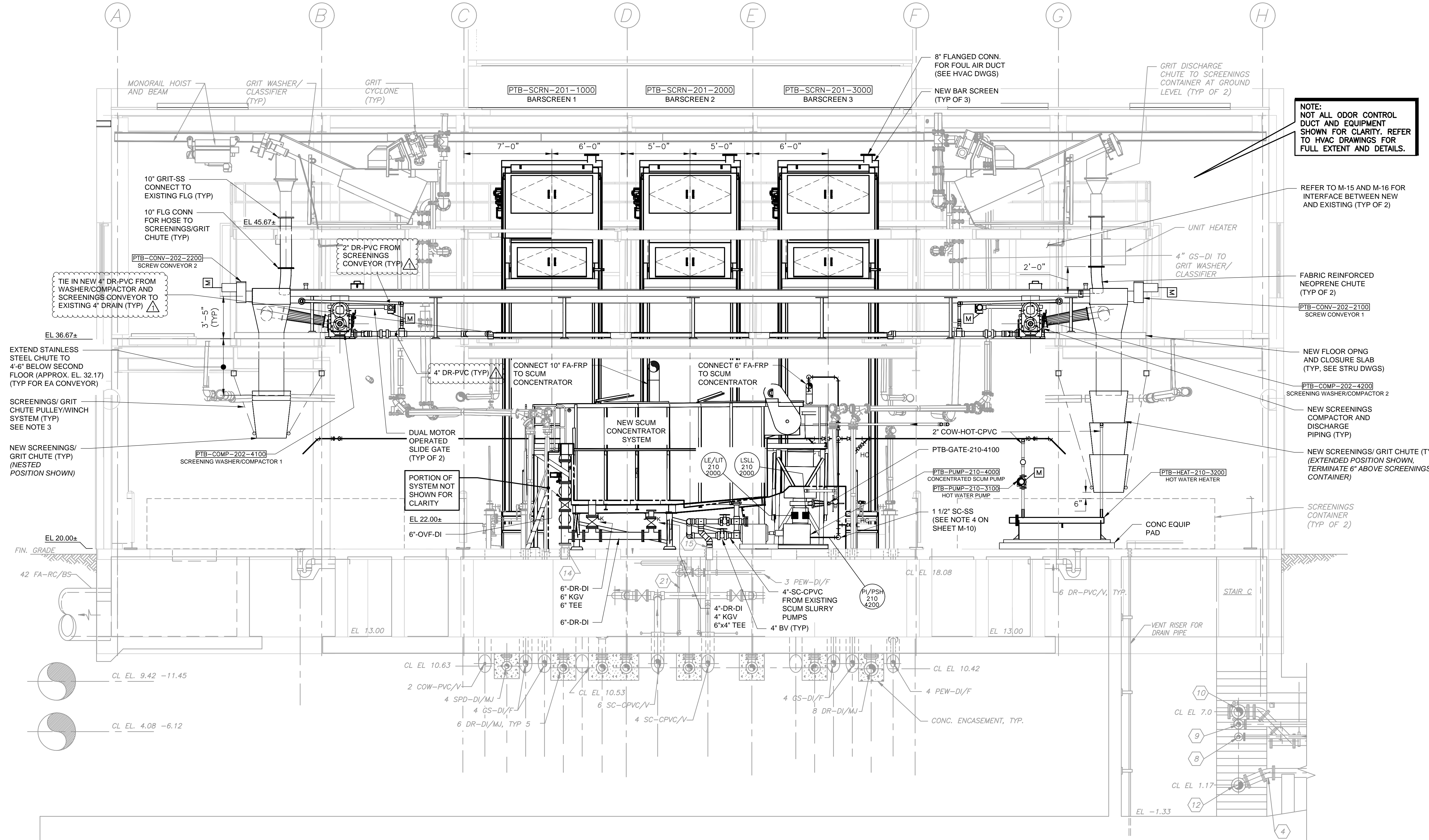

SECTION 2  
1/4" = 1'-0" M-9,10,11,12

