

**SECTION 00 91 01
ADDENDUM NUMBER 1**

DATE: AUGUST 22, 2022
PROJECT: KEN PICKERILL HOUSE RENOVATIONS
6350A MINKLER ROAD
YORKVILLE, ILLINOIS 60560
PROJECT NO: 19-429-1250
OWNER: KENDALL COUNTY FOREST PRESERVE DISTRICT
110 W. MADISON STREET
YORKVILLE, ILLINOIS 60560
TO: PROSPECTIVE BIDDERS / PLANHOLDERS OF RECORD

This Addendum forms a part of the Contract Documents and modifies the Bidding Documents dated 08/03/2022, with amendments and additions noted below. Acknowledge receipt of this Addendum in the space provided in the Bid Form. Failure to do so may subject the Bidder to disqualification.

This Addendum consists of Two (2) pages and Drawings A311 & A910.

CONTRACTOR QUESTIONS & RESPONSES

Question: Can we get additional access to the site and inside the building and what date and time will access be available?

Response: Additional site and interior building access for contractors is available on Wednesday 8/24/2022 from 8:30 am - Noon. There will be no other "interior building access" provided prior to bidding. Exterior access is always available when the park is open for contractor viewing of the perimeter of the Pickerill House structure. Contractors are responsible to bring their own ladders to the site for any roof access (if needed).

CHANGES TO SPECIFICATIONS

2.01 SECTION 09 30 00 - TILING

- A. Under Article 2.02 MATERIALS: (Note: Originally specified porcelain tile has been discontinued. The below tile is an acceptable alternate tile).
1. Revise Paragraph 2.02A2 and associated sub-paragraphs to read:
 - "2. Size and Shape: 2x2 and 12x24 inch.
 - a. Floors: (TF1): 2x2; stack bond pattern.
 - b. Walls: (TW1): 12x24 Horizontal 1/2 Running Bond Pattern.
 - c. Base: Non-Ceramic; Metal covered base as specified.
 - d. Pattern Layout: As indicated on drawings."
 2. Revise Paragraph 2.02A5 and associated sub-paragraphs to read:
 - "5. Products:
 - a. Crossville, Inc. - Portugal Porcelain Stone.
 - 1) Colors:
 - a) Floors: (TF1): PTG04.10202UMOS - Tinta Negra.

b) Walls: (TW1): PTG01.10202UMOS - Velho White."

2.02 SECTION 32 14 13 - PRECAST CONCRETE UNIT PAVING

A. Under Article 2.02 MATERIALS:

1. Revise Subparagraph 2.02A1 to denote that the Beacon Hill Flagstone product is for (Field Pavers) as follows:

"1. **Product: Unilock: Beacon Hill Flagstone. (Field Pavers).**

2. Add Soldier Border Edging pavers; Subparagraph 2.02A1a to read:

"a. **Soldier Border Edging: (Perimeter of all pavement patio and paver sidewalk areas): Product: Unilock: Holland Premier. Color: Sierra. Size: 3-7/8" x 7-7/8" x 2-3/8".**

CHANGES TO THE DRAWINGS

3.01 DRAWING A311 - CANOPY AND PATIO PLAN

A. Indicated the extent of Precast Concrete Unit Pavers: 8" wide Soldier Border Edging pavers per Keynote 32.017 at the perimeter of the new paver sidewalks, patio and canopy column locations.

B. Revised Keynote 32.014 to note "Field Pavers" in keynote description.

3.02 DRAWING A910 - FIRST FLOOR FINISH PLAN

A. Revised FINISHES SCHEDULE for revised Porcelain Tile Flooring (TF1) and Walls (TW1).

END OF DOCUMENT

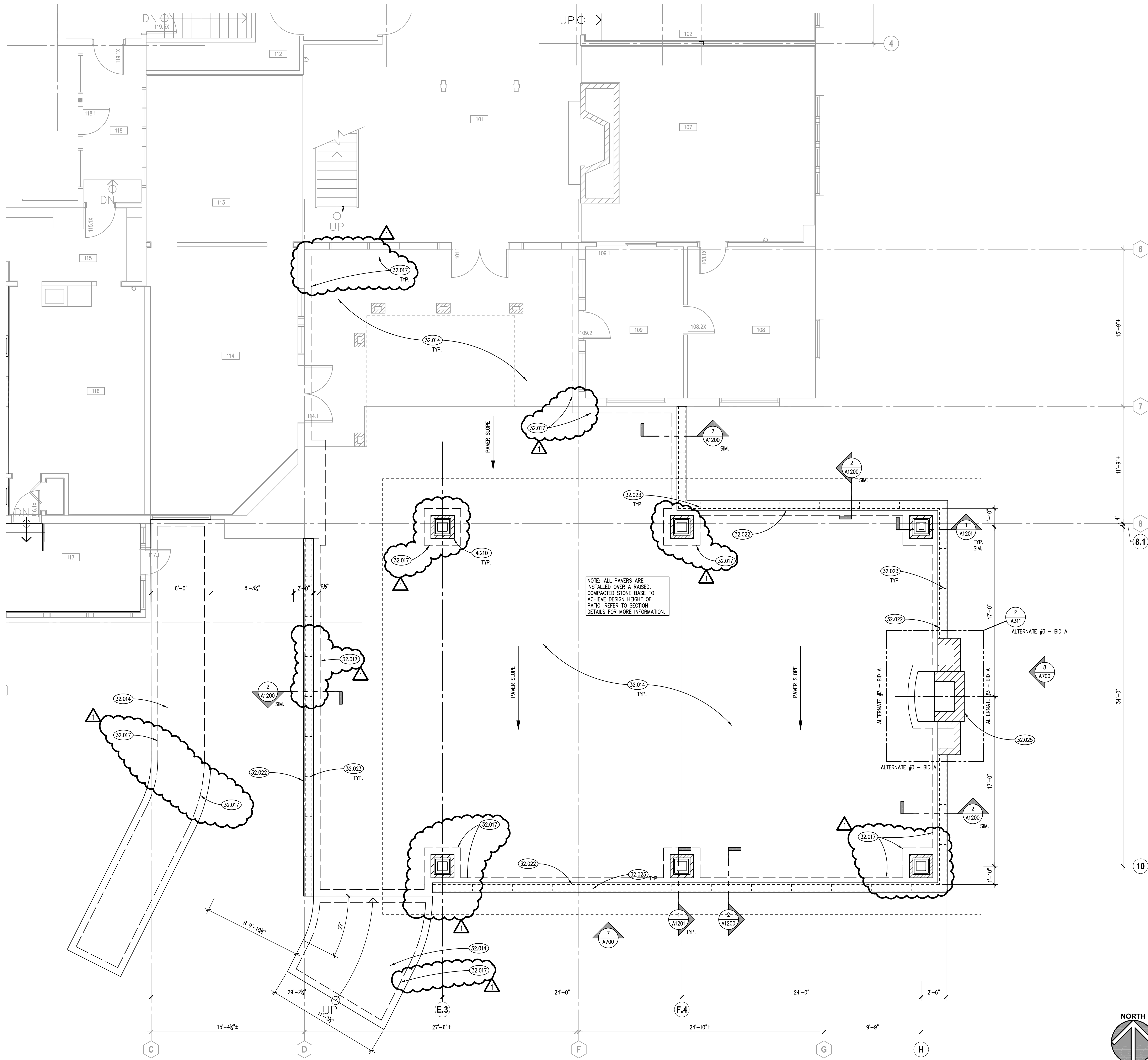

KEYNOTES

KEYNOTES ARE TYPICALLY NOT DUPLICATED WITHIN A GIVEN DETAIL. AN UN-KEYNOTED ITEM IN A DETAIL IS THE SAME AS A KEYNOTED ITEM HAVING THE SAME APPEARANCE WITHIN THE SAME DETAIL.

- 4.210 BRICK MASONRY: MODULAR TYPE; REFER TO SPECIFICATIONS.
- 32.014 PRECAST CONCRETE UNIT PAVERS: FIELD PAVERS: PATTERN OF PAVERS AS SPECIFIED. REFER TO SPECIFICATIONS.
- 32.017 PRECAST CONCRETE UNIT PAVERS: SOLDIER BORDER EDGING PAVERS: 8 INCHES WIDE-SINGLE PAVER SIZE. INSTALL AT PERIMETER OF ALL SIDEWALKS AND PATIO AREAS AND AROUND COLUMNS AS SHOWN. REFER TO SPECIFICATIONS.
- 32.022 PRECAST CONCRETE DIMENSIONAL STONE SEAT WALL STONE BASE, MIN. 18 INCHES THICK.
- 32.023 STONE SEAT WALL ACCESSORY: WEEP HOLE @ 48" O.C.
- 32.025 PRE-MANUFACTURED CHIMNEY W/ WOOD BOX: REFER TO SPECIFICATIONS AND ALTERNATES.

ALTERNATE #1 - BID A
DEMOLISH ENTIRETY OF GREENHOUSE STRUCTURE IN LIEU OF RESTORING IT.

ALTERNATE #2 - BID A
IN LIEU OF FIBER CEMENT VERTICAL SIDING AND TRIM INSTALLATION ON EXISTING ESTATE HOUSE, REPAIR AND RESTORE VERTICAL CEDAR SIDING AND TRIM.

ALTERNATE #3 - BID A
DELETE EXTERIOR PATIO FIREPLACE AND TWO FIRE BOXES CONSTRUCTION. INFILL FIREPLACE OPENING WITH EXTENDED GARDEN WALL WITH SEAT CAP.

ALTERNATE #4 - BID B
IN LIEU OF FULL ASPHALT SHINGLE REPLACEMENT ON EXISTING ESTATE HOUSE, LEAVE EXISTING ASPHALT SHINGLES IN PLACE FOR REUSE.

REFER TO SPEC SECTION 01 23 00 FOR ADDITIONAL INFORMATION.

PARTIAL PATIO PLAN - ALTERNATE #3

SCALE: 1/4" = 1'-0" ②

GENERAL NOTES

1. REFER TO DRAWING 0100 FOR PROJECT GENERAL NOTES.
2. REFER TO SPECIFICATION SECTION 01 10 00 - SUMMARY FOR A LIST OF MATERIAL AND/OR LABOR THAT ARE BEING PROVIDED BY OWNER DONOR/CONTRACTORS. DO NOT INCLUDE DONOR SCOPE IN YOUR BASE BID. PROVIDE COORDINATION OF DONOR TRADES ONLY.

CANOPY & PATIO PLAN

SCALE: 1/4" = 1'-0" ①

Klubler, Inc.
Aurora, Illinois 60606
Tel: 630.406.2133
Chicago, Illinois 60606
Tel: 773.607.5070
www.klubertec.com

KEN PICKERILL HOUSE RENOVATIONS

KENDALL COUNTY FOREST PRESERVE DISTRICT
110 W. MADISON STREET
YORKVILLE, IL 60560

ISSUED	
01/01/22	BID DOCUMENTS
1/18/22	ADDENDUM #1

JOB NO.	19-429-1250
DRAWN	PJT
CHECKED	CJH
APPROVED	CJH

SHEET TITLE
CANOPY & PATIO PLAN

SHEET NUMBER
A311

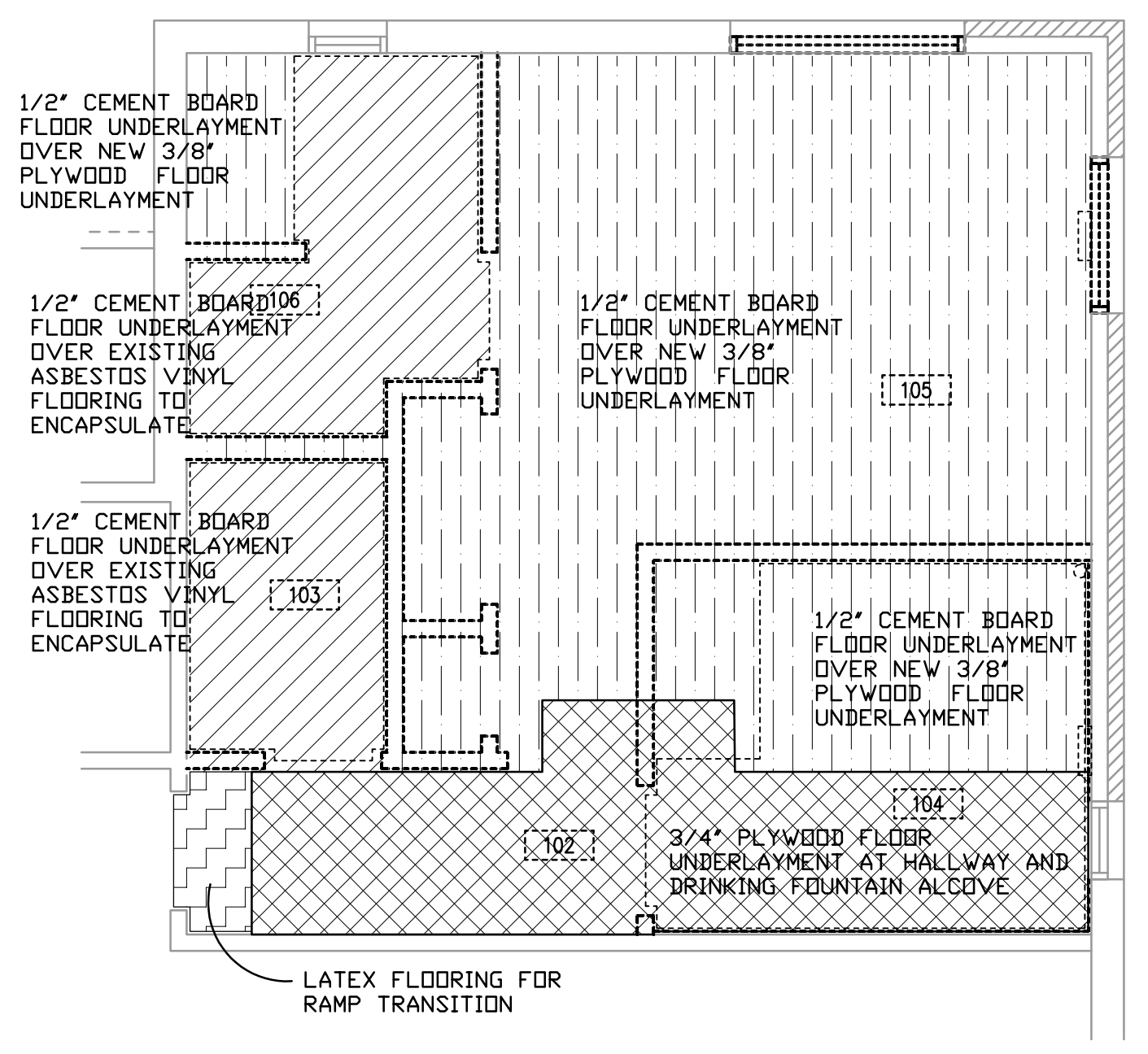

TOILET ROOM UNDERLAYMENT PLAN (2)
SCALE: 1/4" = 1'-0"

STAIR NOTES:
INSTALL NEW LVT RISERS AND STRINGERS TO NEW STAIRS W/ RUBBER NOSINGS.

NOTE: ALL DOORS & WINDOWS, CASINGS AND JAMB EXTENSIONS IN THE ROOM ARE TO BE STAINED AND FINISHED TO MATCH EXISTING COLOR STAIN. TYPICAL WHOLE ROOM.

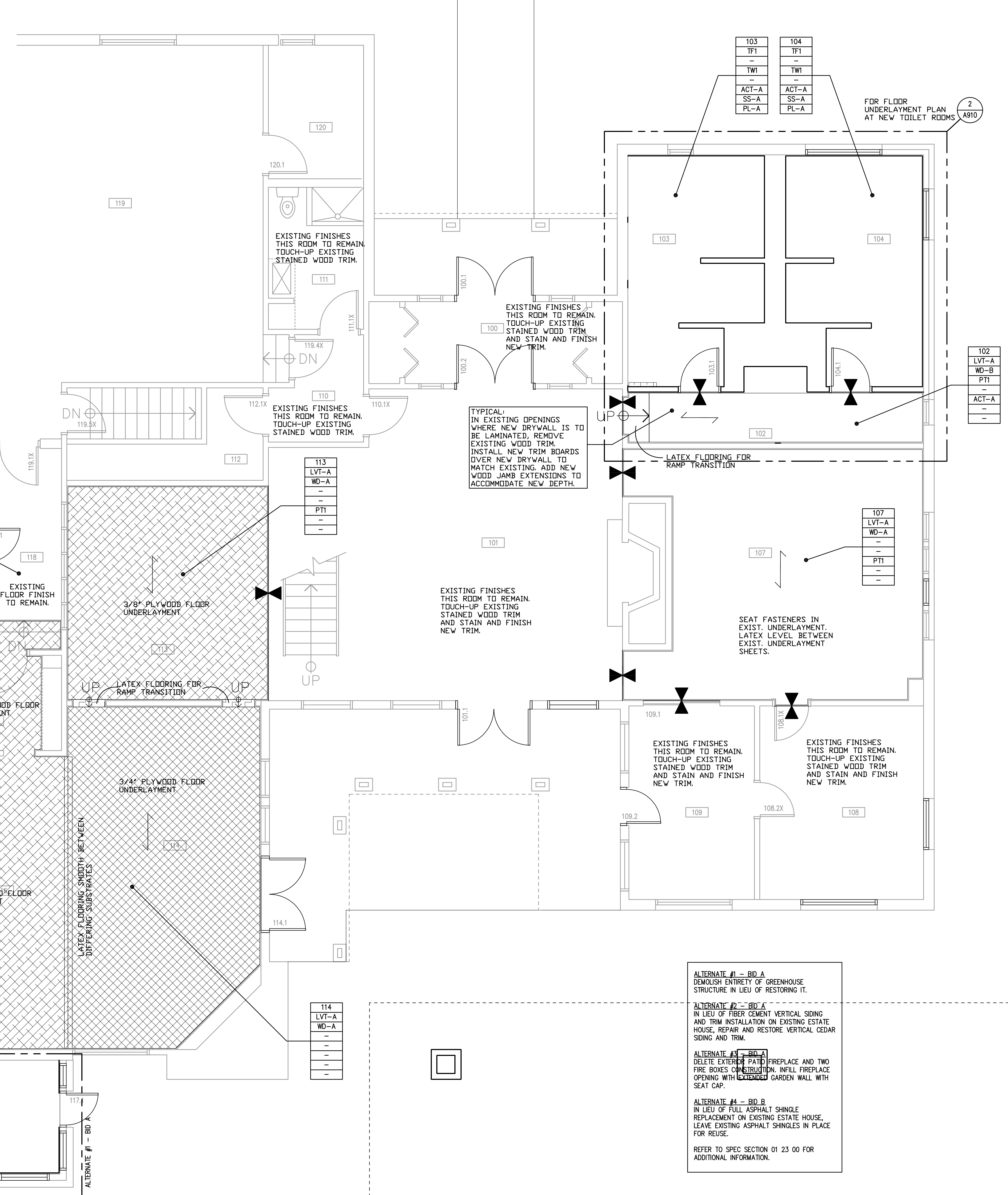

ALTERNATE #1 - BID A
DEMOLISH ENTIRETY OF GREENHOUSE STRUCTURE IN LIEU OF RESTORING IT.

ALTERNATE #2 - BID A
IN LIEU OF FIBER CEMENT VERTICAL SIDING AND TRIM INSTALLATION ON EXISTING ESTATE HOUSE, REPAIR AND RESTORE VERTICAL CEDAR SIDING AND TRIM.

ALTERNATE #3 - BID A
DELETE EXTERIOR PATIO FIREPLACE AND TWO FIRE BOXES CONSTRUCTION. INFILL FIREPLACE OPENING WITH EXISTING GARDEN WALL WITH SEAT CAP.

ALTERNATE #4 - BID B
IN LIEU OF FULL ASPHALT SHINGLE REPLACEMENT ON EXISTING ESTATE HOUSE, LEAVE EXISTING ASPHALT SHINGLES IN PLACE FOR REUSE.

REFER TO SPEC SECTION 01 23 00 FOR ADDITIONAL INFORMATION.

KEYNOTES

KEYNOTES ARE NOT ALWAYS REPEATED ACROSS ALL DRAWINGS ON THIS SHEET. AN UN-KEYNOTED ITEM ON THIS SHEET IS THE SAME AS A KEYNOTED ITEM ON THIS SHEET HAVING THE SAME GRAPHIC APPEARANCE.

FLOOR PLAN LEGEND

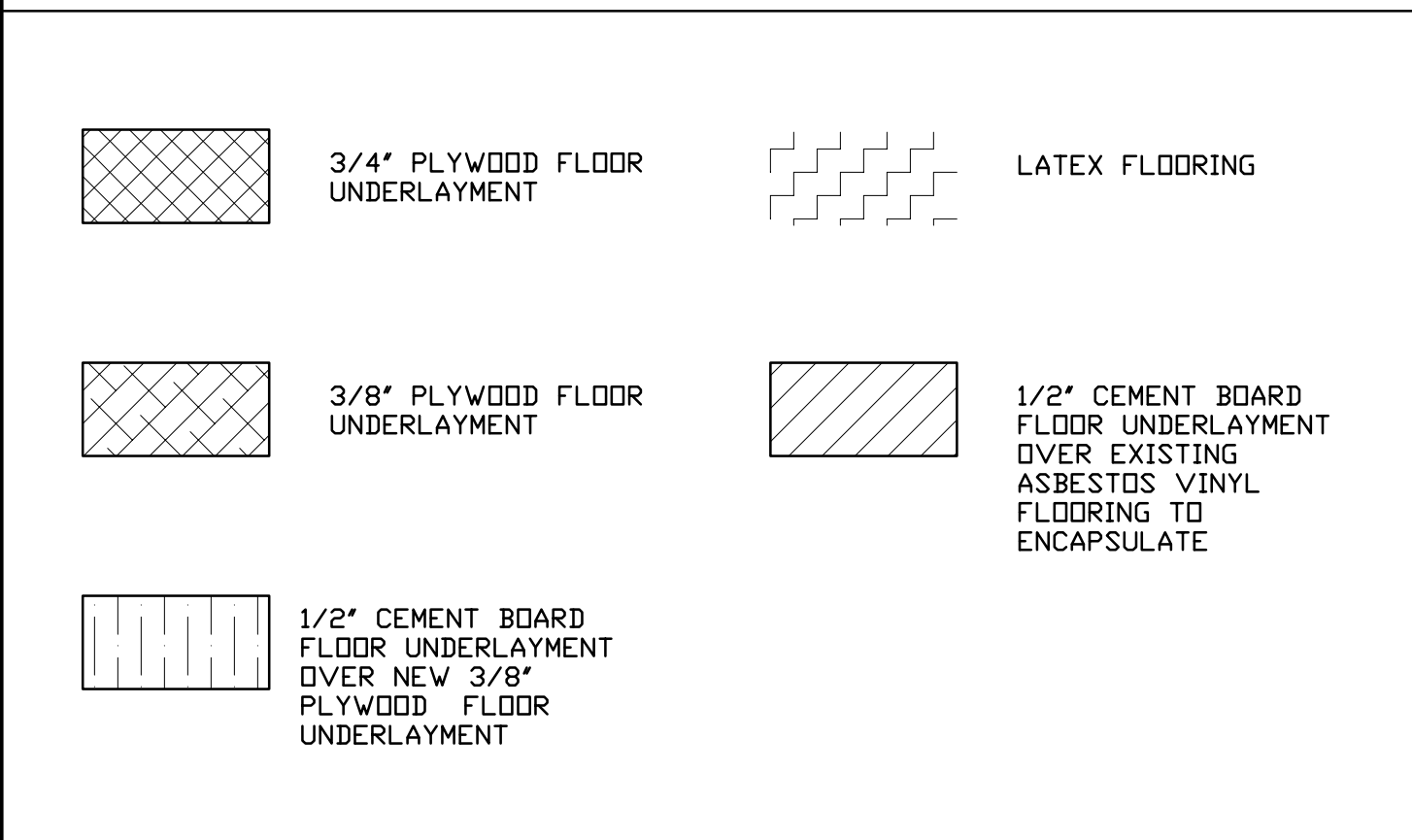

FINISHES SCHEDULE

AREA	FINISH CODE	MATERIAL	MANUFACTURER	DESCRIPTION
FLOORING	PT1	PORCELAIN TILE	CROSSVILLE	PRODUCT: PORTUGAL COLOR: PT604.10202UMOS - TINTA NEGRA SIZE: 2" X 2" MOSAIC GROUT-B: #35 MOCHA
	LVT-A	LUXURY VINYL TILE	J+J FLOORING	PRODUCT: LVT CLASSICS COLOR: #1008 PARADIGM PRODUCT: STAND. EXCELON IMPERIAL TEXTURE COLOR: 51810 WASHED LINEN SIZE: 12" X 12" X 1/8"
	VCT-A	VINYL COMPOSITION TILE	ARMSTRONG FLOORING	PRODUCT: ULTIMA COLOR: #1008 PARADIGM PRODUCT: STAND. EXCELON IMPERIAL TEXTURE COLOR: 51810 WASHED LINEN SIZE: 12" X 12" X 1/8"
	WB-A	RUBBER BASE	JOHNSONITE	SERIES: TRADITIONAL TYPE: COVE COLOR: #47 BROWN
WALLS	PT1	PAINT	BENJAMIN MOORE	
	PT2	PAINT	BENJAMIN MOORE	
	PT3	PAINT	BENJAMIN MOORE	
	PT4	PAINT	BENJAMIN MOORE	
CEILING	ACT-A	ACOUSTICAL CEILING TILE	ARMSTRONG	SYSTEM: ULTIMA SIZE: 24" X 24" X 3/4" COLOR: WHITE EDGE: ULTIMA 1911 BEVELED TEGULAR 15/16" GRID: PRELUDE 15/16"
	FC1	FIBER CEMENT SIDING	JAMES HARDIE	COLOR: RICH ESPRESSO
	FC2	FIBER CEMENT SIDING	JAMES HARDIE	COLOR: HEATHERED MOSS
	NC	NO CEILING FINISH		
COUNTERTOP MATERIAL	SS-A	SOLID SURFACE	WILSONART	COLOR: MYSTIQUE 9200CS
	PL-A	PLASTIC LAMINATE	WILSONART	COLOR: STICKLEY OAK 17003K-57
MILLWORK	ST-1	WOOD CASEWORK	CUSTOM	COLOR: STAINED & FINISHED TO MATCH EXIST.

LEGEND

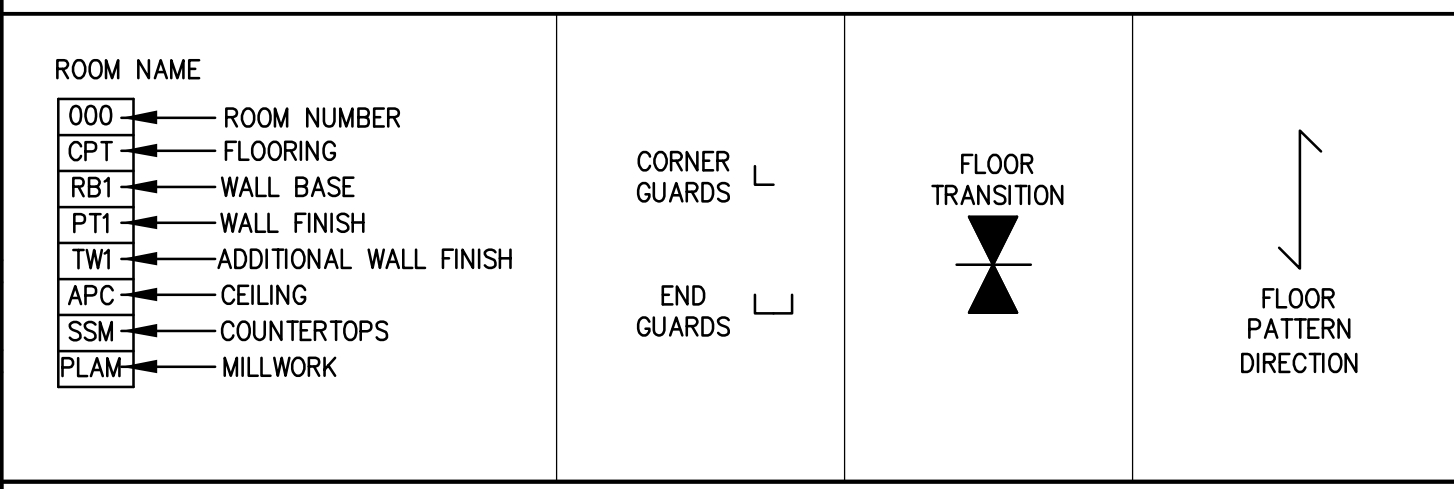

GENERAL NOTES

- REFER TO DRAWING G100 FOR PROJECT GENERAL NOTES.
- REFER TO A400 SERIES REFLECTED CEILING PLAN DRAWINGS FOR CEILING HEIGHTS.
- COORDINATE CEILING HEIGHTS WITH SECTIONS AND DETAILS.
- COORDINATE LOCATIONS OF WALL-MOUNTED ELECTRICAL ITEMS WITH ARCHITECTURAL ITEMS TO ENSURE NO OVERLAP.
- ALL EXPOSED ELECTRICAL WIREMOLD FOR NEW ELECTRICAL AND FIRE ALARM DEVICES SHALL BE FIELD PAINTED AFTER INSTALLATION IN A COLOR TO BLEND WITH ADJACENT SURFACE AS DIRECTED BY ARCHITECT. TYPICAL IN ALL ROOMS ON THE FIRST AND SECOND FLOORS.
- ALL FIRST AND SECOND FLOOR SPACES AFFECTED BY CONSTRUCTION WORK SHALL HAVE THE EXISTING WOOD TRIM, PANELING AND CEILING TOUCHED UP WITH STAIN AND FINISH TO BLEND WITH ADJACENT SURFACES.
- REFER TO SPECIFICATION SECTION 01 10 00 - SUMMARY FOR A LIST OF MATERIAL AND/OR LABOR THAT ARE BEING PROVIDED BY OWNER DONOR/CONTRACTORS. DO NOT INCLUDE DONOR SCOPE IN YOUR BASE BID. PROVIDE COORDINATION OF DONOR TRADES ONLY.
- AT ALL NEW LVT AREAS, LATEX LEVEL BETWEEN UNDERLAYMENT SEAMS AND SAND SMOOTH PRIOR TO LVT INSTALLATION. TYPICAL.

FIRST FLOOR FINISH PLAN (1)
SCALE: 1/4" = 1'-0"

ISSUED

1	19-429-1250
2	
3	
4	
5	
6	
7	
8	
9	
10	

JOB NO. 19-429-1250
DRAWN SKF
CHECKED CJH
APPROVED CJH

SHEET TITLE
FIRST FLOOR FINISH PLAN

SHEET NUMBER
A910