



City of Myrtle Beach
SOUTH CAROLINA

PURCHASING AND
MATERIALS MANAGEMENT

(843) 918-2170
FAX: (843) 918-2182

Addendum 002

19-B0048

ECT 3rd – 9th Avenue South

October 30, 2018

The engineer has made the following revisions to the project:

1. Sheets SC-4 & CC-4 have the Santee Cooper enclosure on the Ole Shillelagh property rotated 180 degrees.
2. Sheets SC-5 & CC-5 have added two Santee Cooper pull boxes (enclosures) on the Wings Beachwear Store property to facilitate pulling their primary power wires through this area.
3. Sheet CCD-2 has the conduit installation detail changed to show gaps between the conduits installed in the trench to assist backfill compaction around the conduit bank.

Attachments are provided on each change.

Thank you,

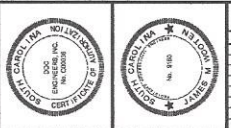

Ruth Burleson/Buyer
City of Myrtle Beach



NO.	DATE	REVISION DESCRIPTION

PREPARED FOR: THE CITY OF MYRTLE BEACH
 HORRA COUNTY, SOUTH CAROLINA
CONDUIT CONSTRUCTION PLAN #4
E/C/T CONVERSION PROJECT
 KINGS HIGHWAY 3rd Ave. S. to 9th Ave. S.

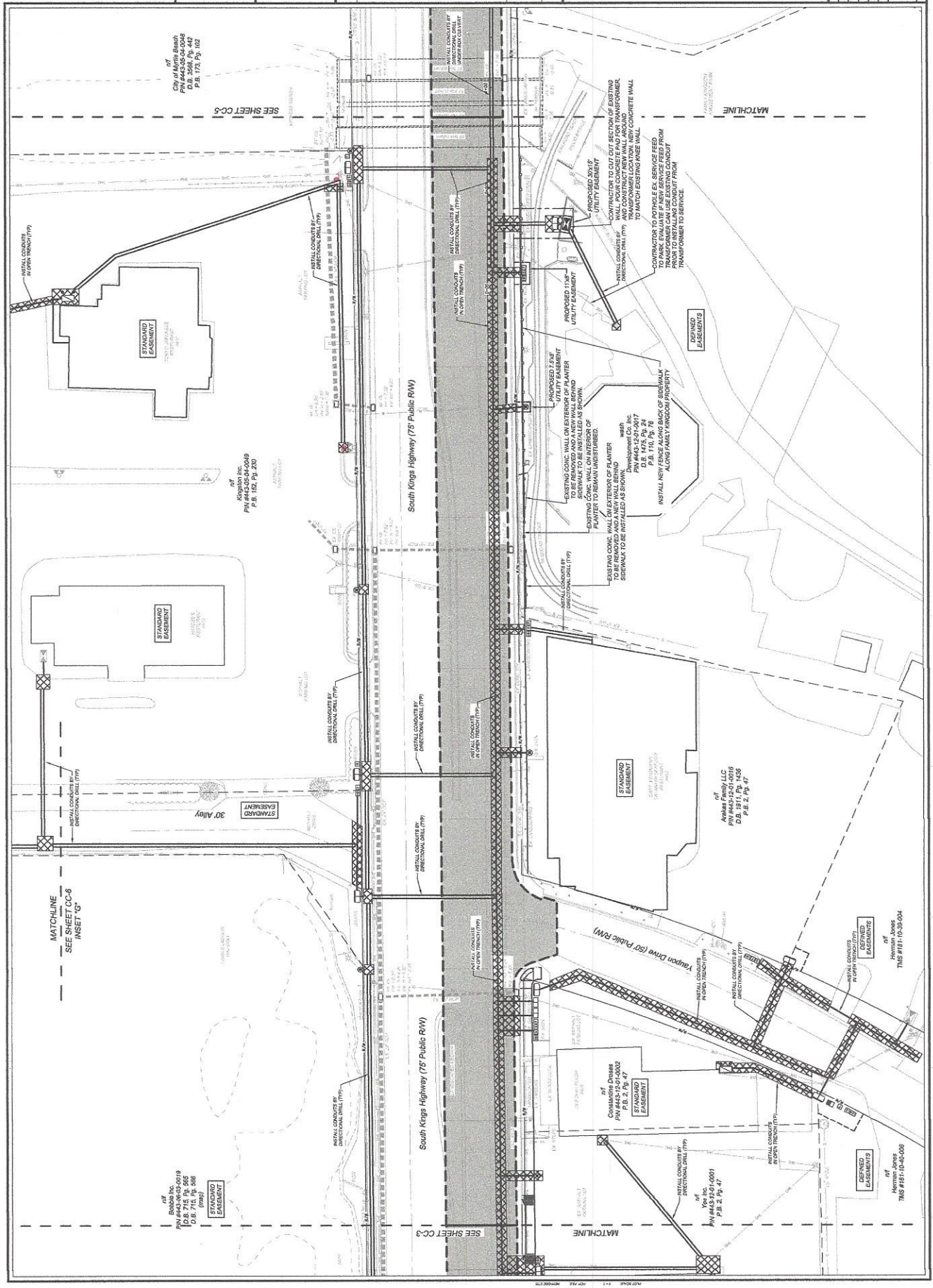
SCALE: 1" = 20'
 DATE: 08/19/19
 DRAWING NO.: 000
 PROJECT NO.: 11008
CC-4
 P.F. 02



UNLESS OTHERWISE NOTED, ALL DIMENSIONS ARE IN FEET AND INCHES. DIMENSIONS ARE TO FACE UNLESS OTHERWISE NOTED.

