



ANDERSON COUNTY DEPARTMENT OF EDUCATION
101 SOUTH MAIN STREET SUITE 500 CLINTON, TN 37716

PARTIAL ROOF REPLACEMENTS FOR GRAND OAKS ELEMENTARY SCHOOL 1033 OLIVER SPRINGS HWY. CLINTON, TN 37716

OFFICE OF TECHNOLOGY 141 EAST BROAD STREET CLINTON, TN 37716

NET ZERO BUILDING 425 DRAGON DRIVE CLINTON, TN 37716

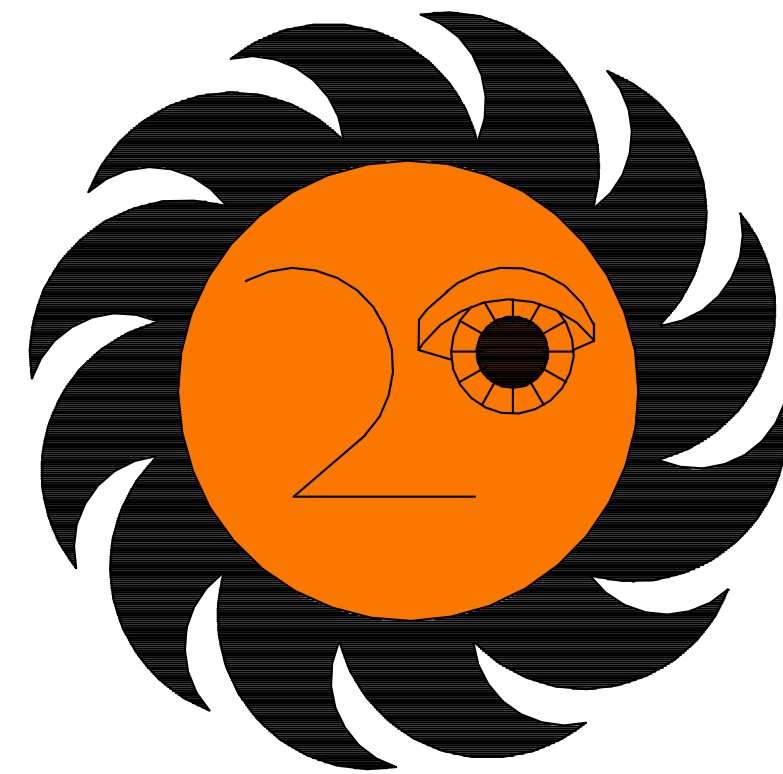

ROOF DESIGN WORKS INC.

P.O. BOX 12716 Knoxville, TN. 37912 / (865) 584-6682
Email: mail@rdwi.net / Website: www.rdwi.net

DRAWING INDEX

- R1.0 TITLE SHEET
- R1.1 ROOF PLAN & DETAILS - GRAND OAKS ELEMENTARY
- R1.2 ROOF PLAN & DETAILS - OFFICE OF TECHNOLOGY
- R1.3 ROOF PLAN & DETAILS - NET ZERO BUILDING

These drawings and the design are the property of Roof Design Works, Inc. and are not to be copied, published or used in whole or part without written consent. They are to be used for the project and site identified and shall be returned upon request.
COPYRIGHT 2024

CODE INFORMATION

2018 INTERNATIONAL BUILDING CODE



ARCHITECTS
WEEKS
AMBROSE
McDONALD
INC

30 MARKET SQUARE
KNOXVILLE TENNESSEE 37902
TELEPHONE 865-546-8232
FAX 865-546-8252
architects@awaminc.com

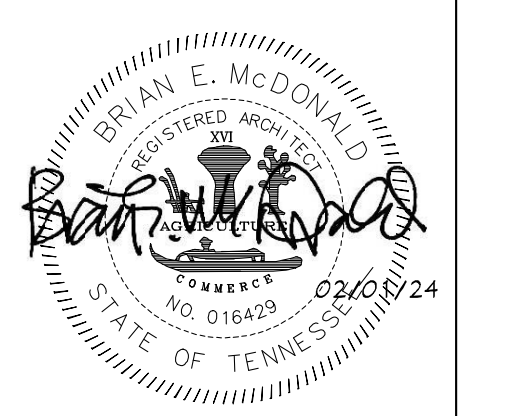

DATE	02-01-24
PROJECT NO.	23019
REFERENCE SHEET	R1.0 TITLE SHEET
DRAWN	BEM
CHECKED	WLA
REVISION	

TITLE SHEET
R1.0

LEGEND

- VTR ○ VENT THRU ROOF
- G — GAS LINE
- GAS PIPE SUPPORT
- RTU □ ROOF TOP UNIT
- A1 R1.1 ○ DETAIL REFERENCE
- A1 R1.2 ○ DETAIL SECTION
- OF — OVERFLOW SCUPPER (FROM ADJACENT ROOF AREA)
- - - REGLET
- WALK PAD
- EF □ EXHAUST FAN

AERIAL PHOTOGRAPHS

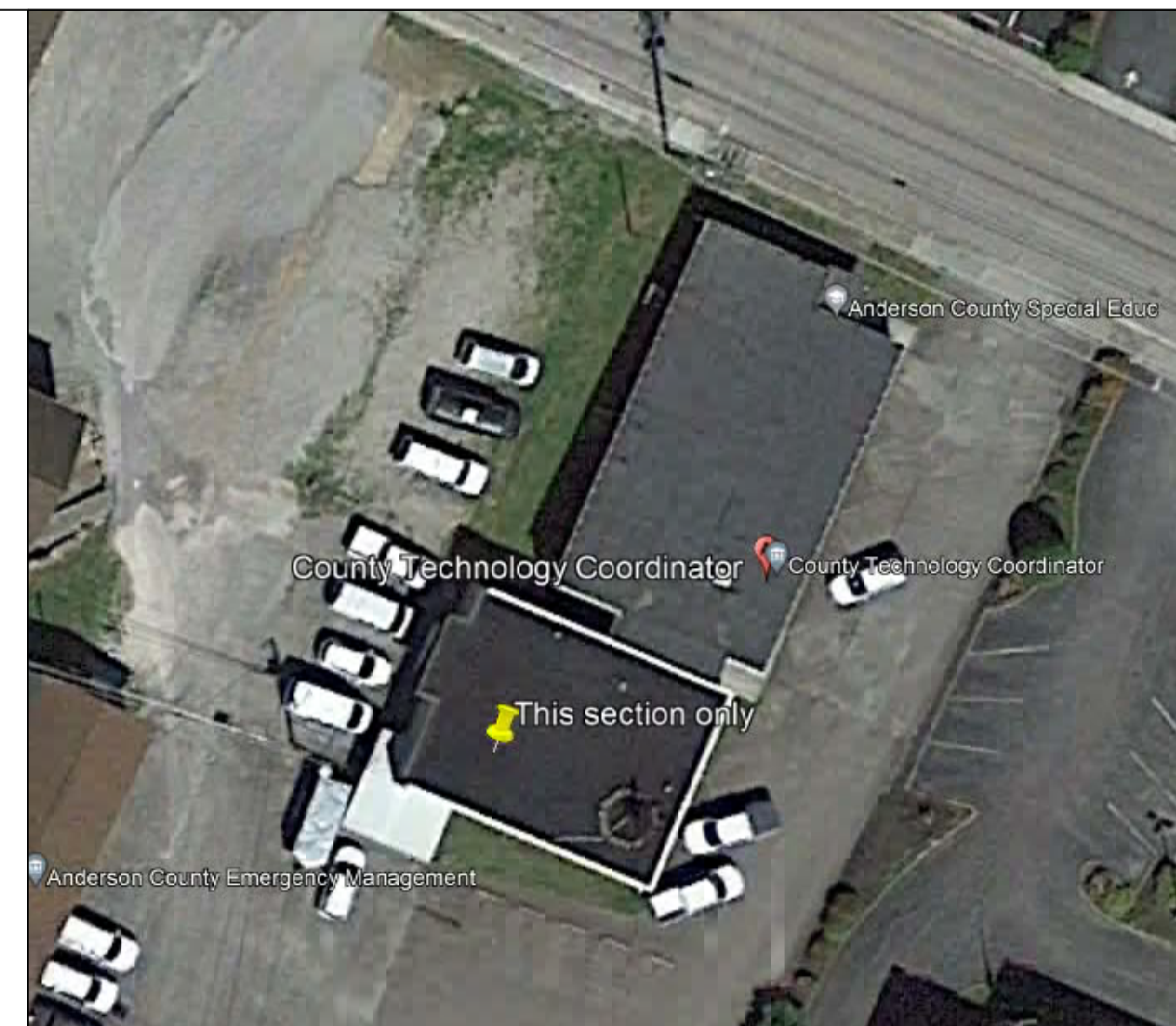
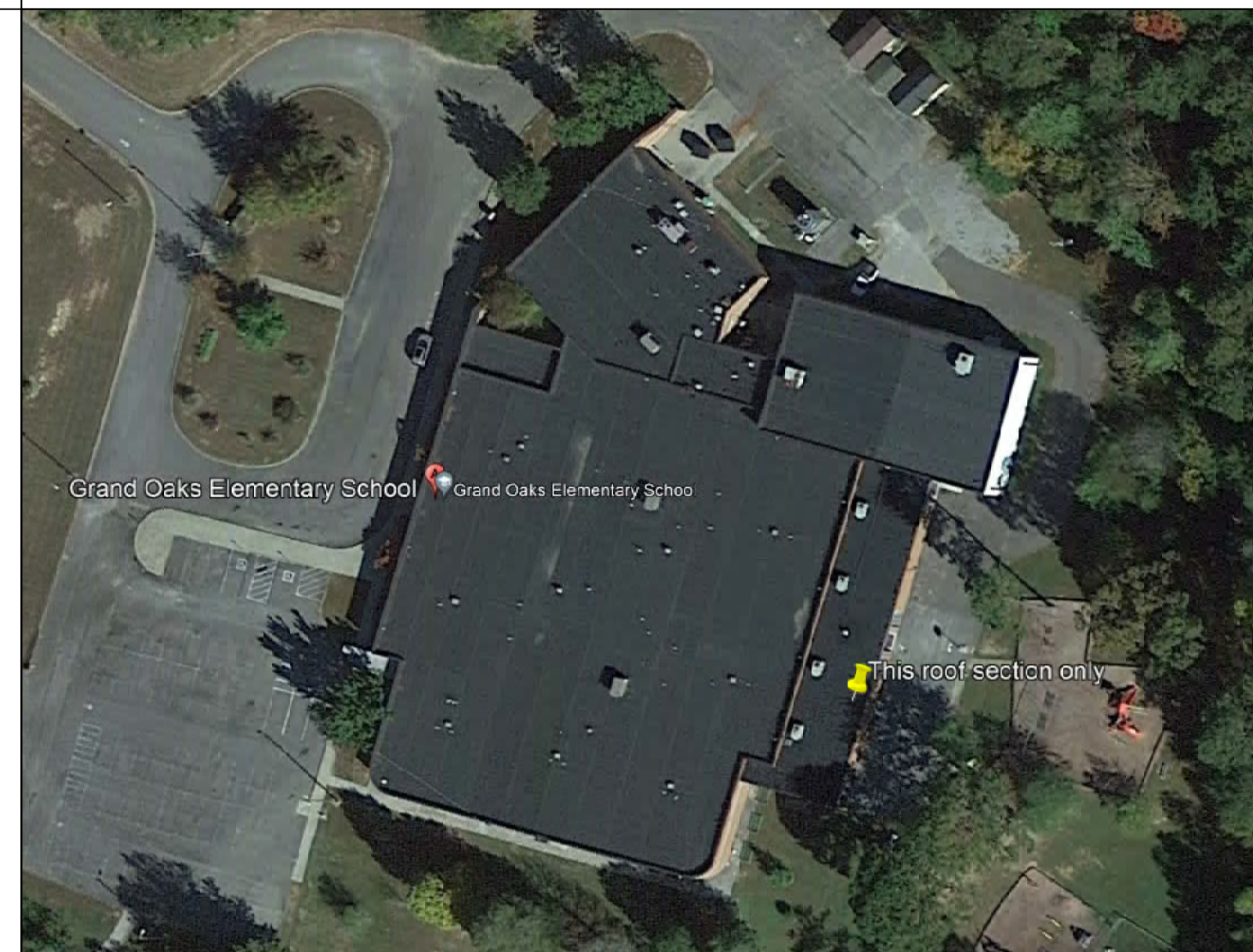

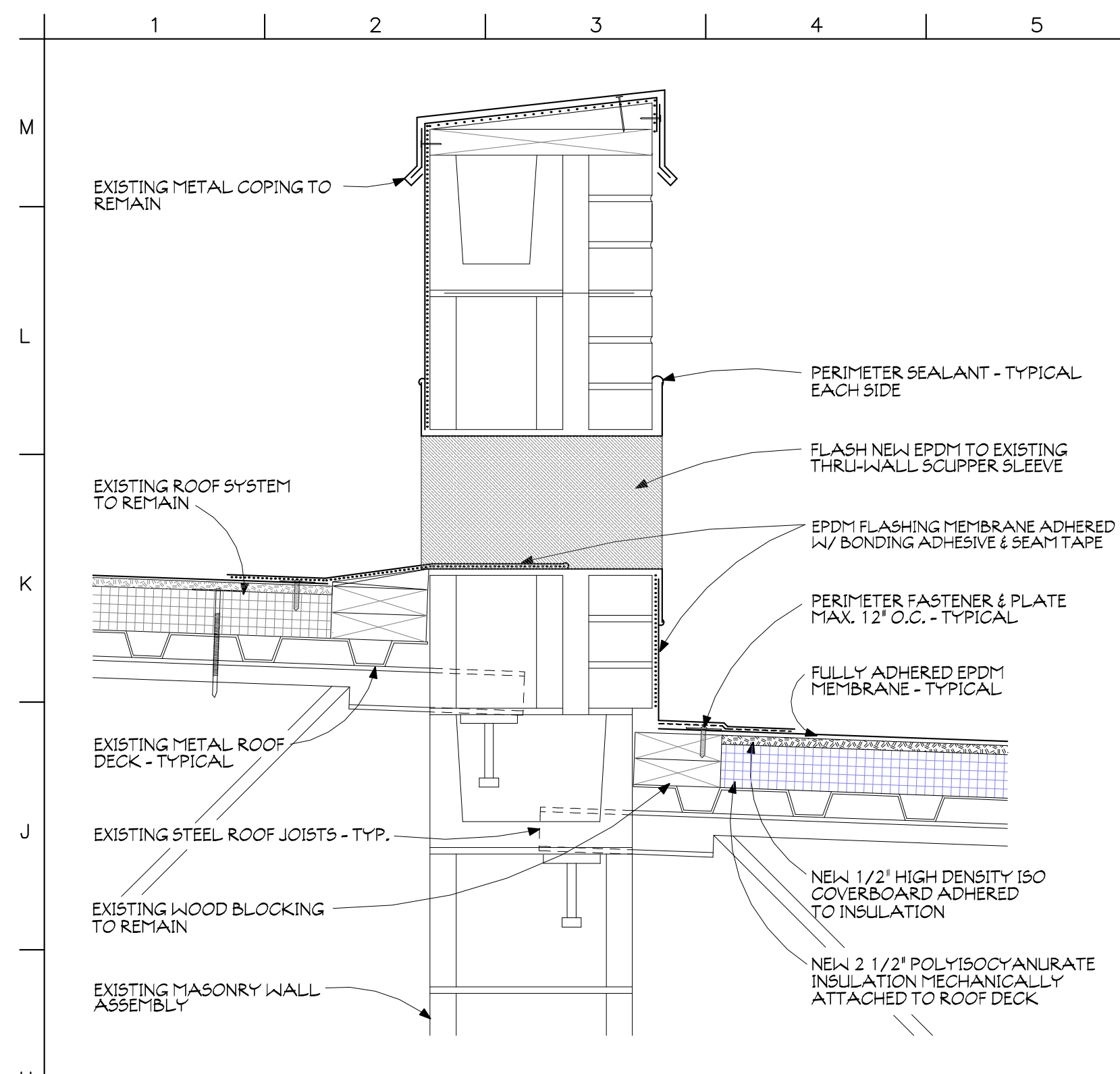

H1 TRANSITION BETWEEN AREAS A & F
SCALE: 1 1/2" = 1'-0" R1.1

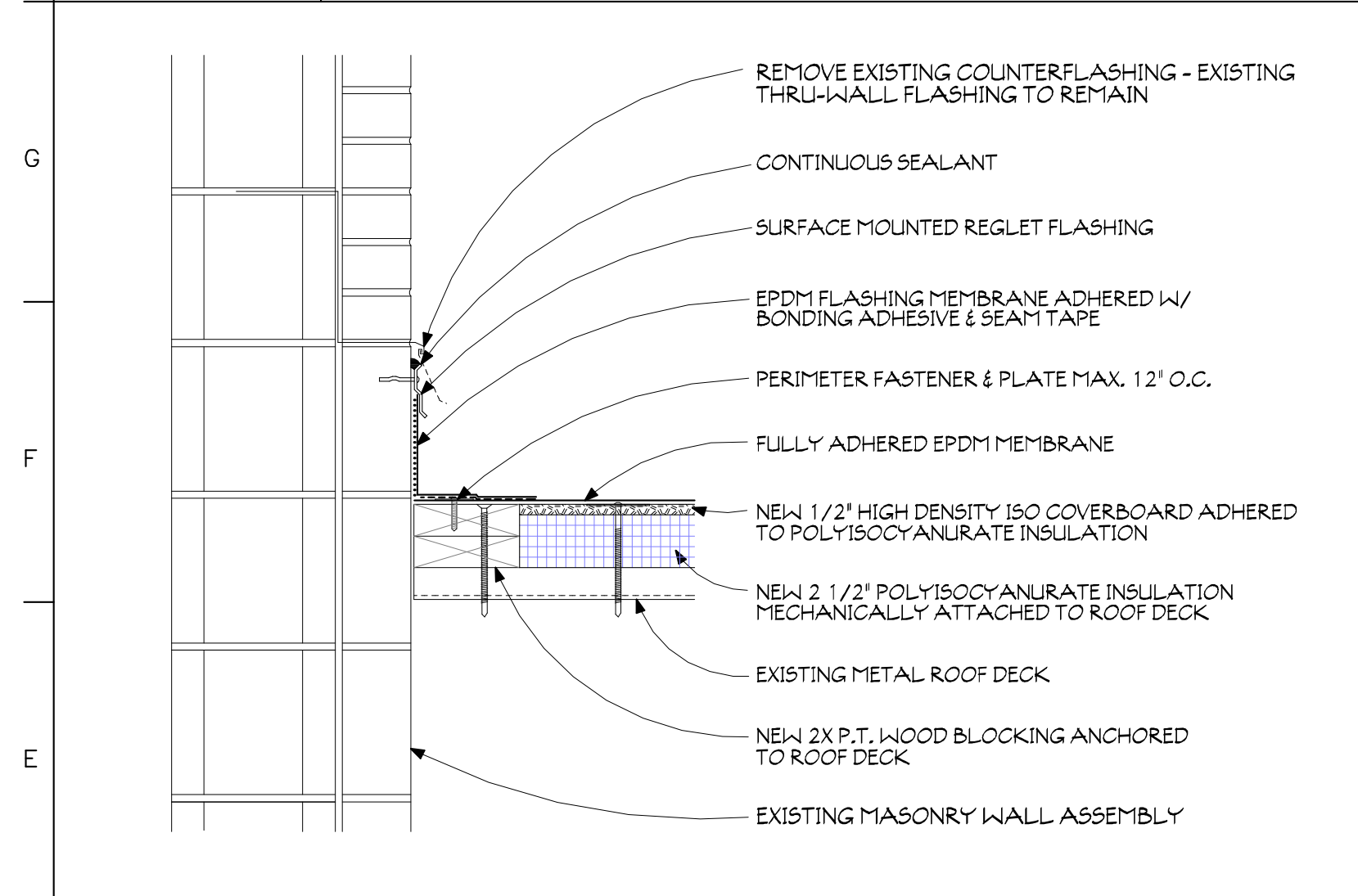

D1 SURFACE MOUNTED REGLET FLASHING
SCALE: 1 1/2" = 1'-0" R1.1

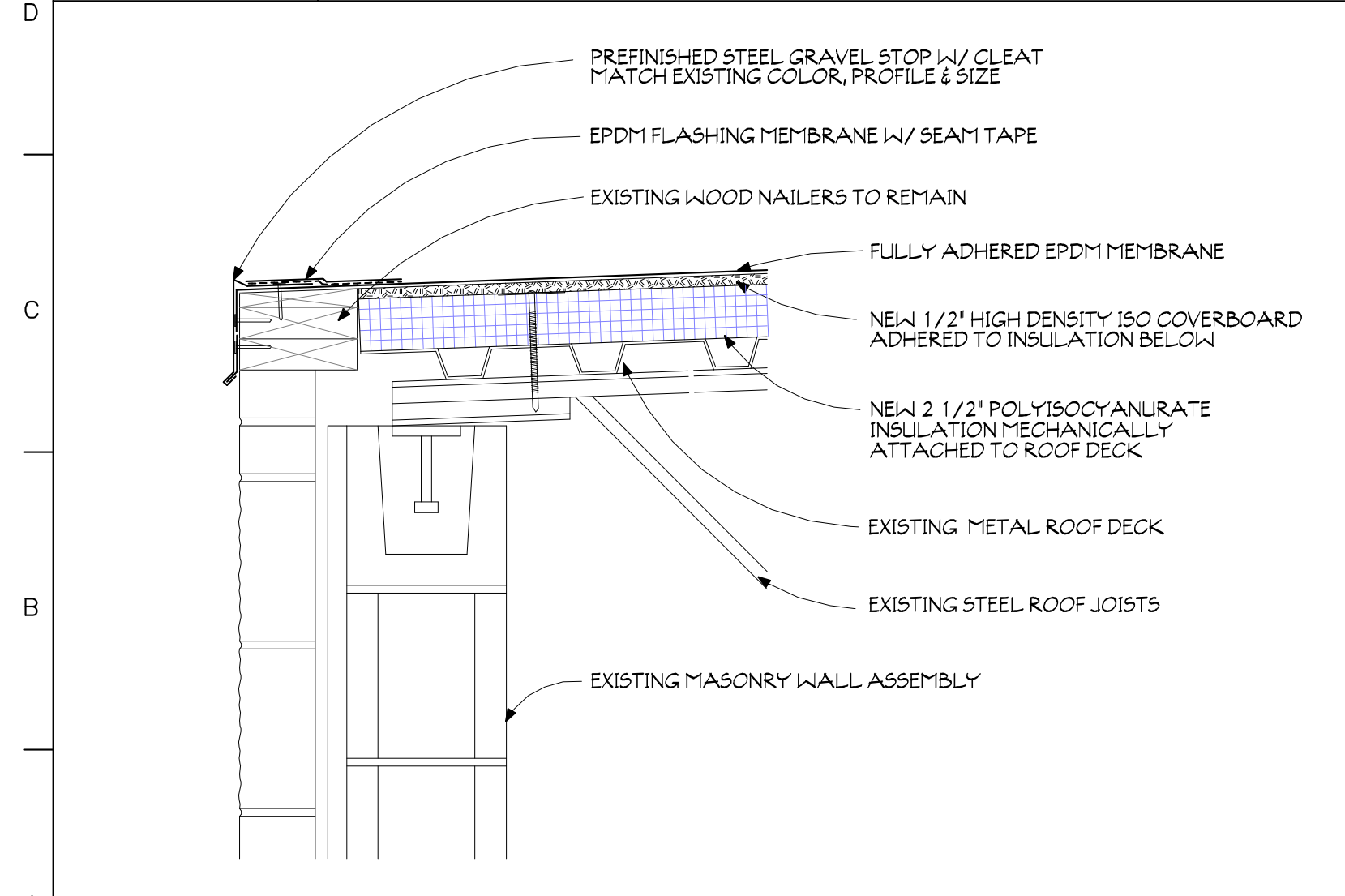

A1 ROOF EDGE W/ METAL
SCALE: 1 1/2" = 1'-0" R1.1

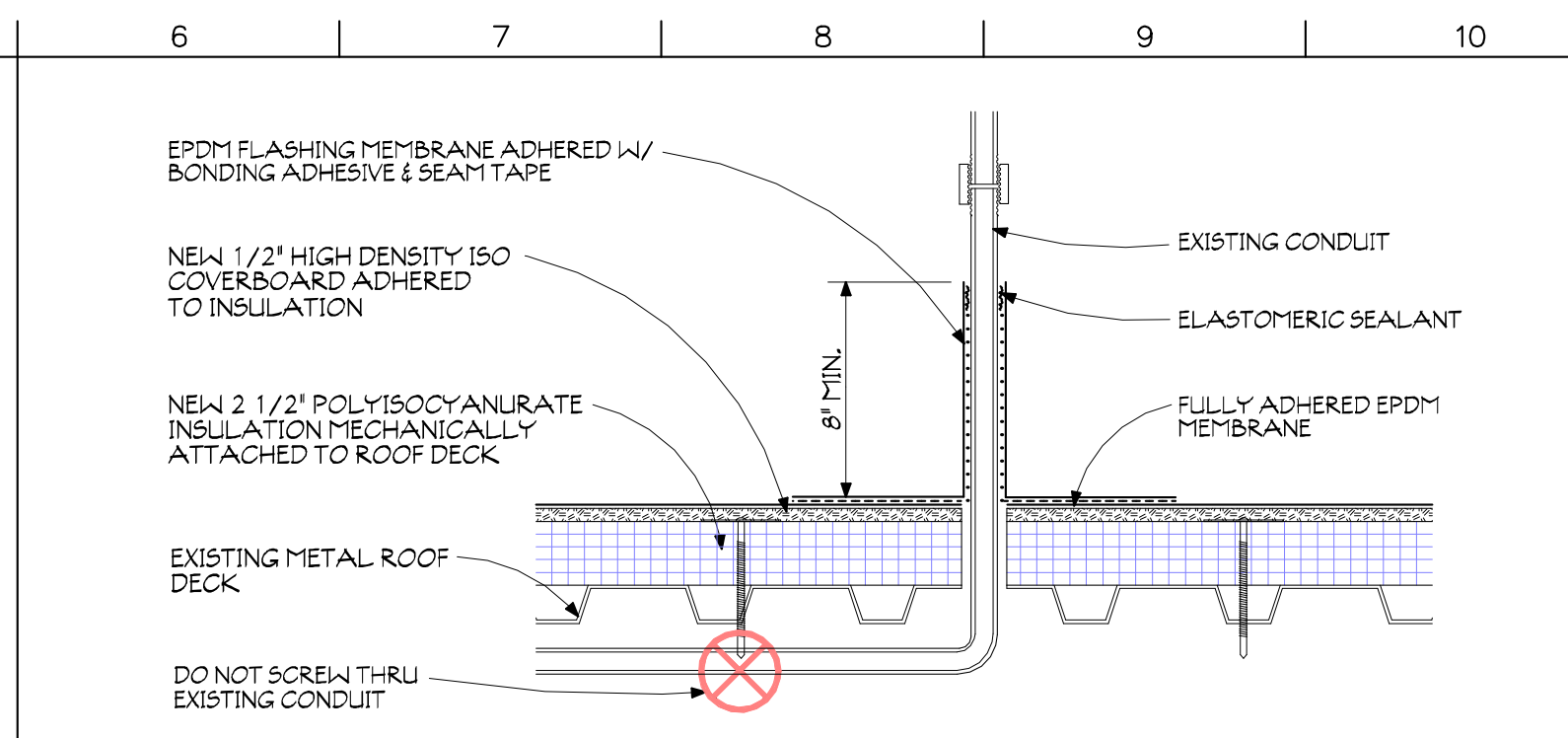

K6 CONDUIT PENETRATION
SCALE: 1 1/2" = 1'-0" R1.1

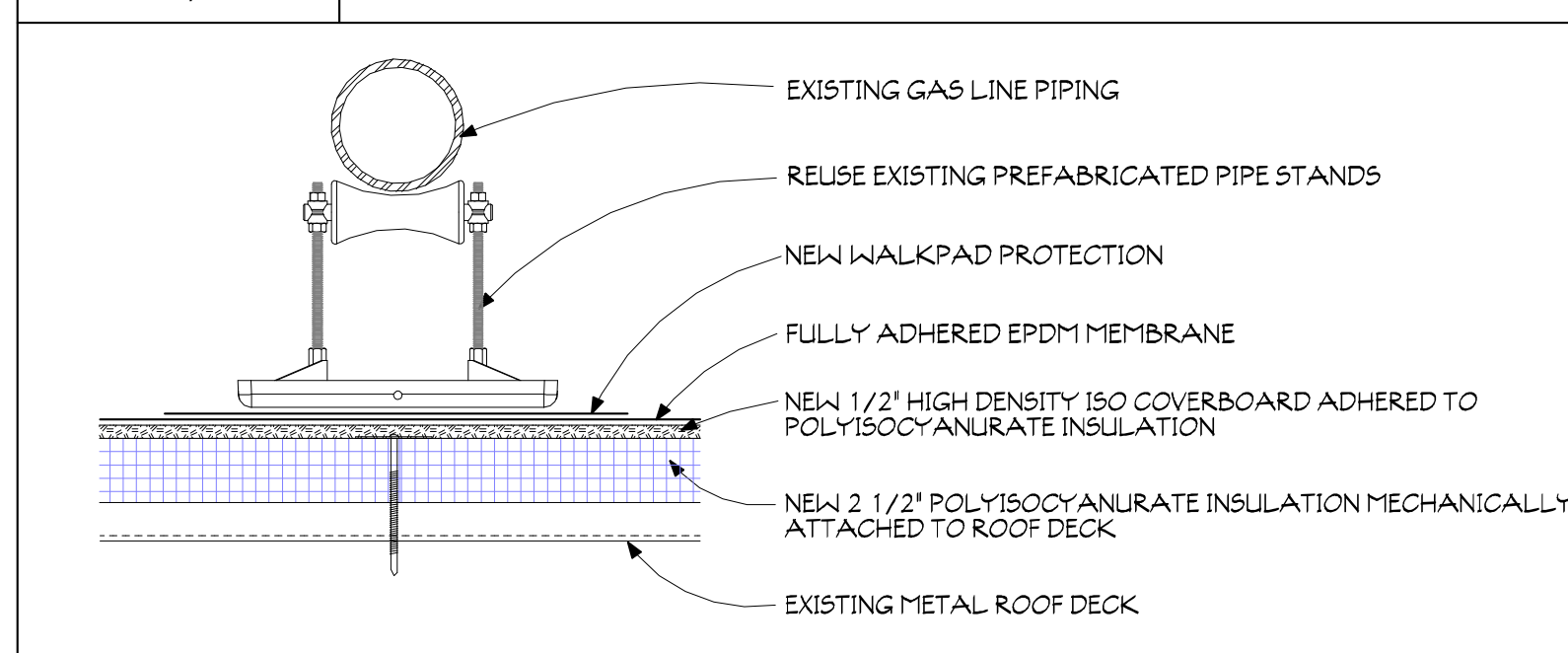

H6 GAS PIPE SUPPORT
SCALE: 1 1/2" = 1'-0" R1.1

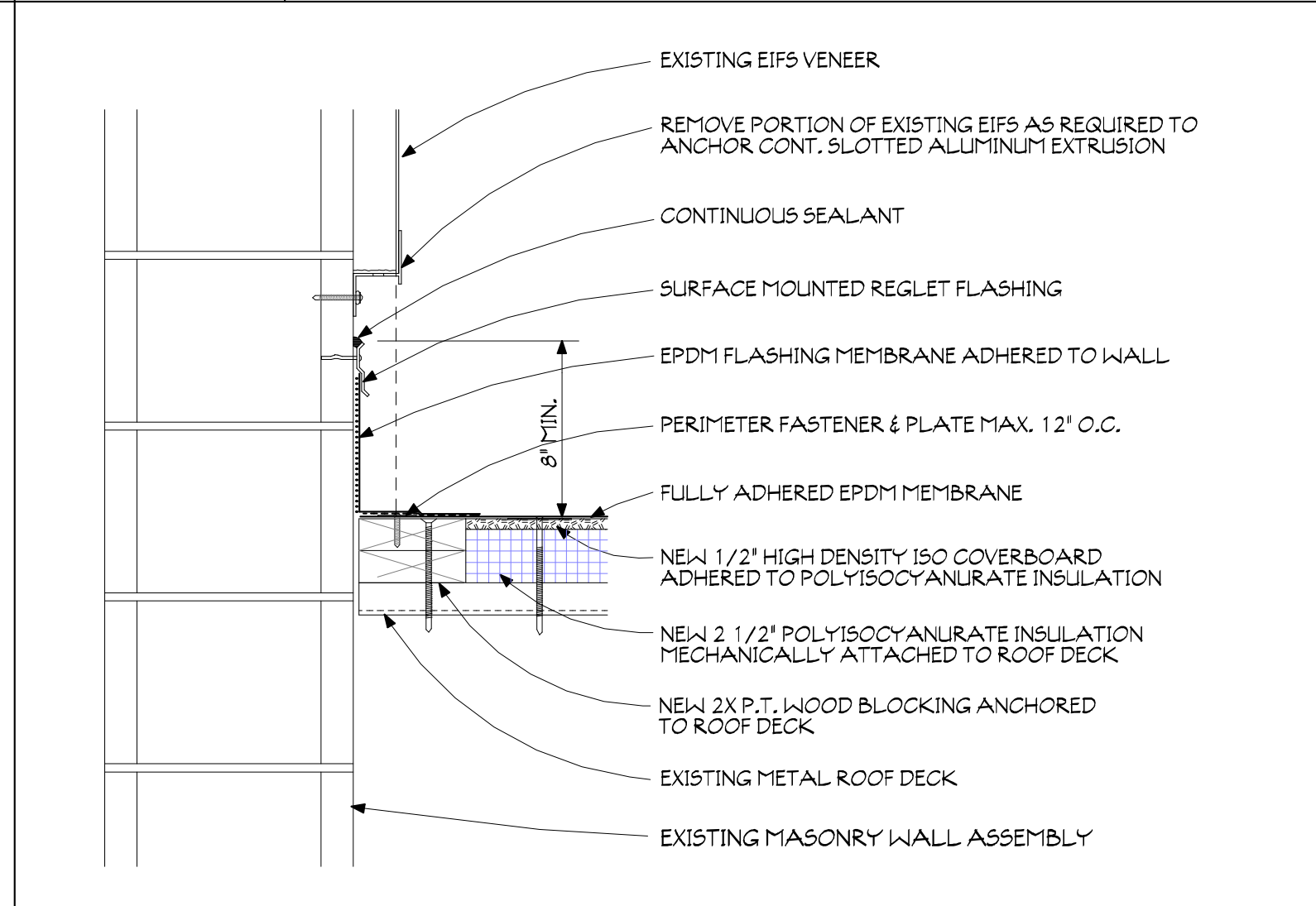

D6 TRANSITION @ GYM WALL
SCALE: 1 1/2" = 1'-0" R1.1

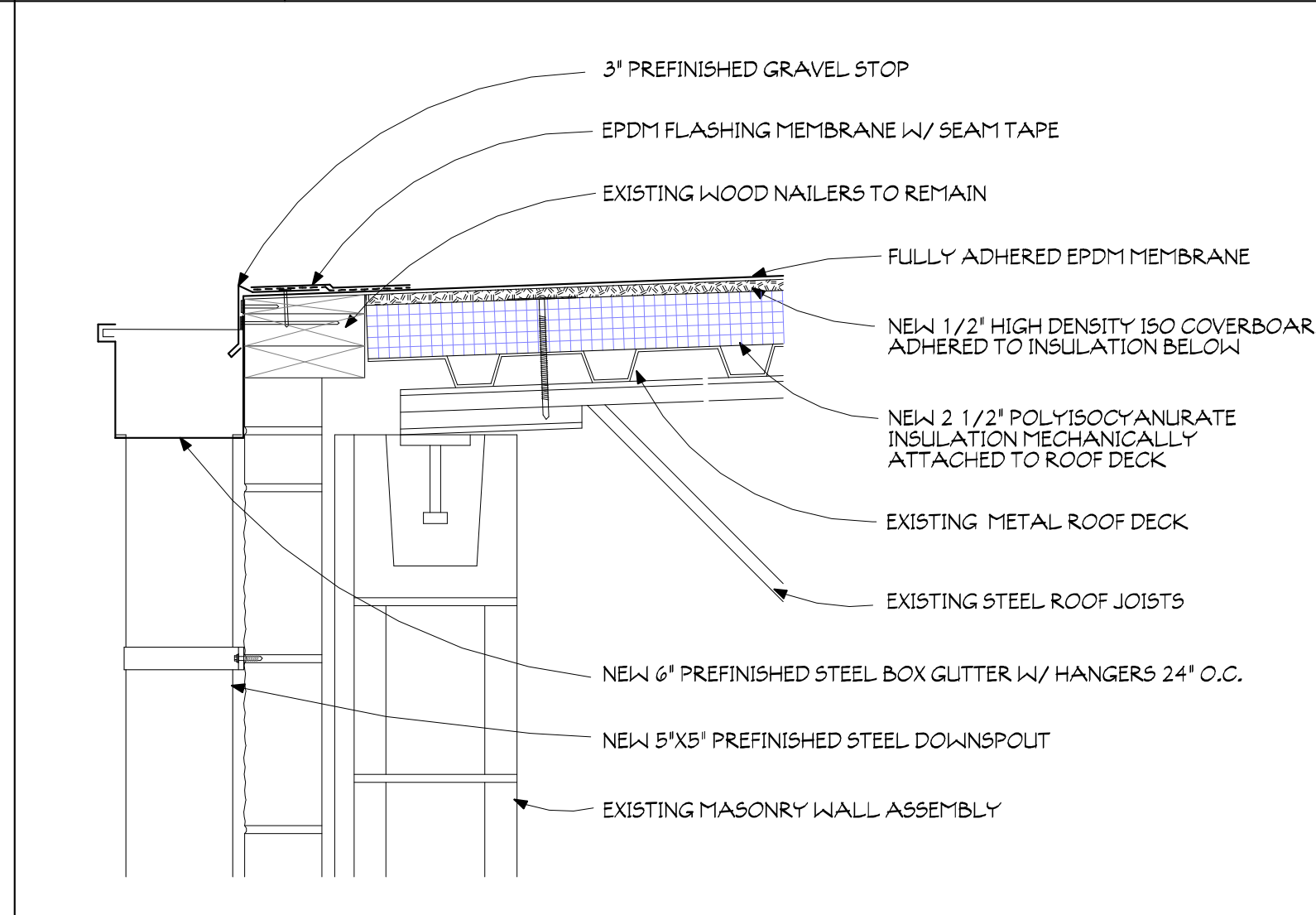

A6 ROOF EDGE W/ GUTTER
SCALE: 1 1/2" = 1'-0" R1.1

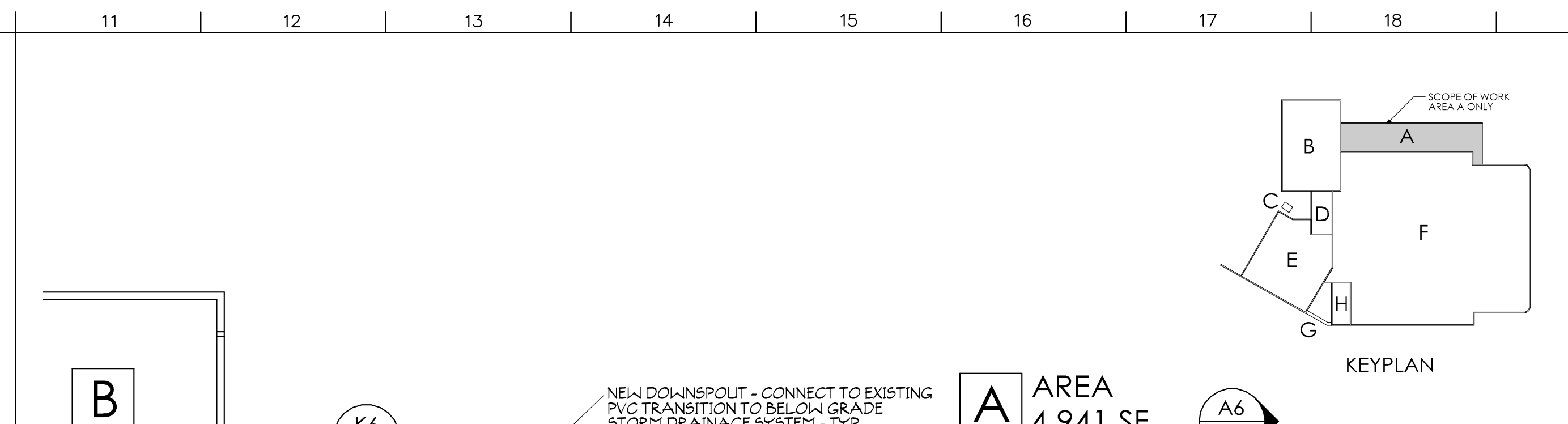

H11 PARTIAL ROOF PLAN AREA A - GRAND OAKS ELEMENTARY
SCALE: 1/4" = 1'-0" R1.1

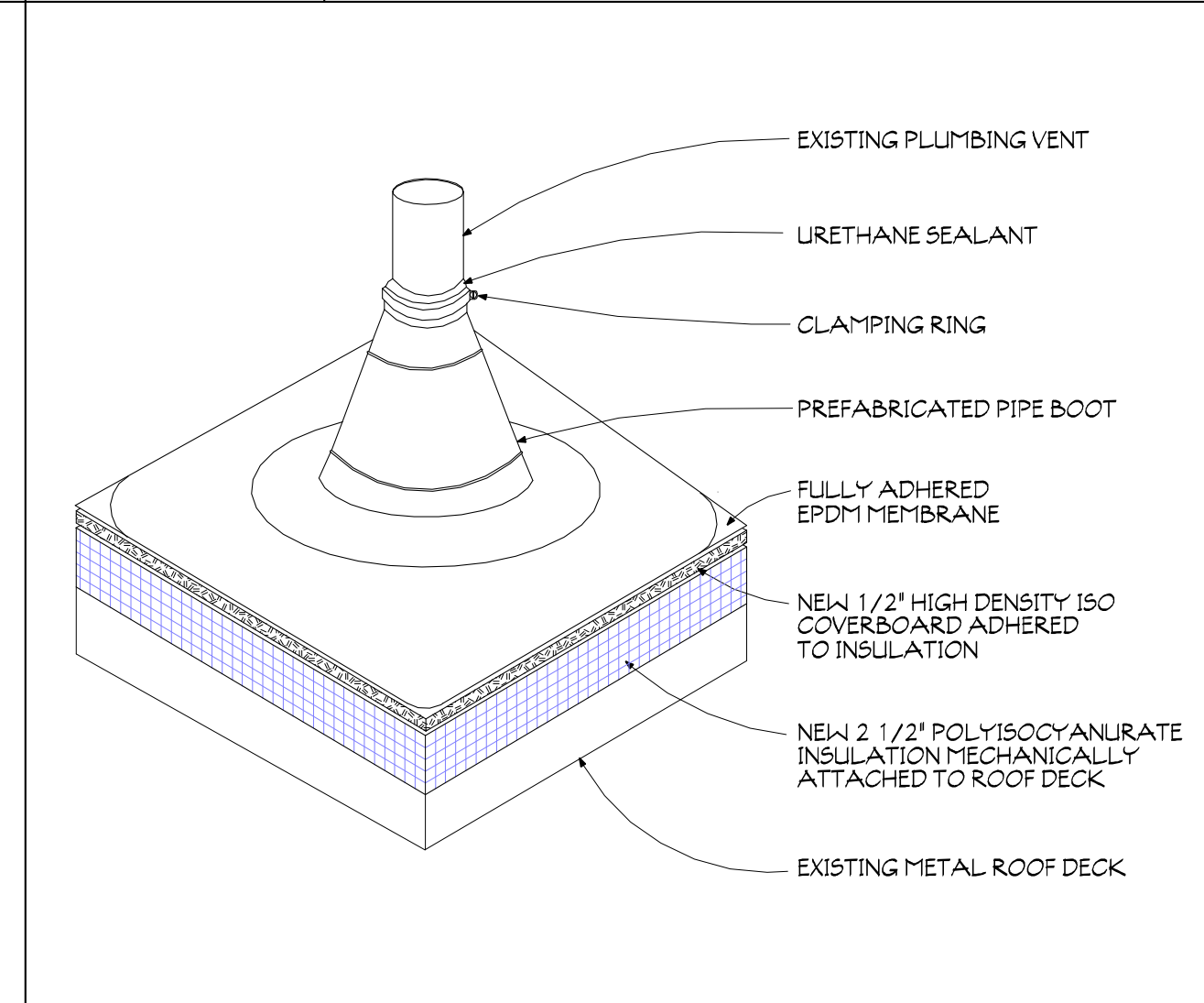

D11 VENT THRU ROOF
SCALE: 1 1/2" = 1'-0" R1.1

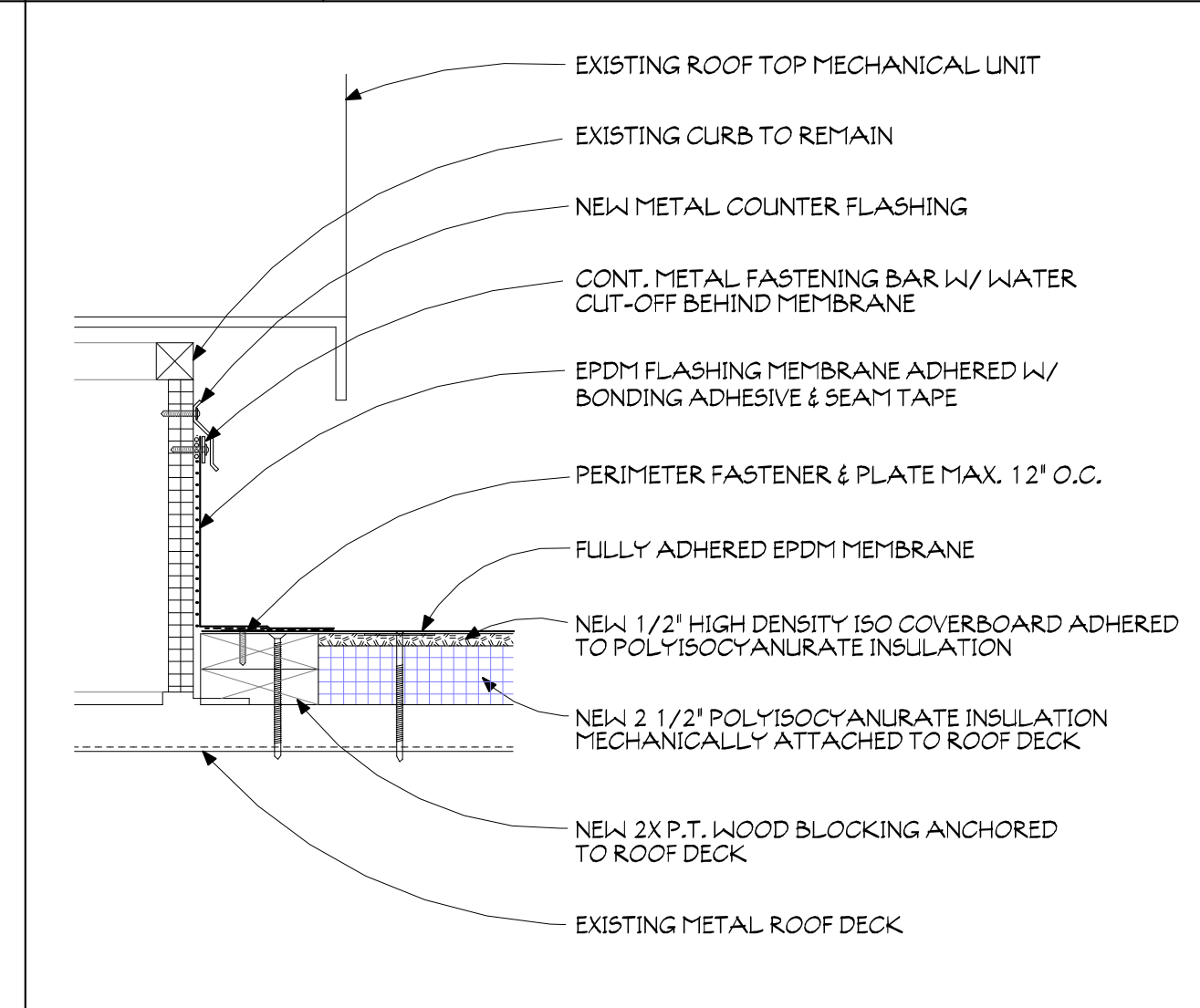

A11 HVAC CURB FLASHING
SCALE: 1 1/2" = 1'-0" R1.1

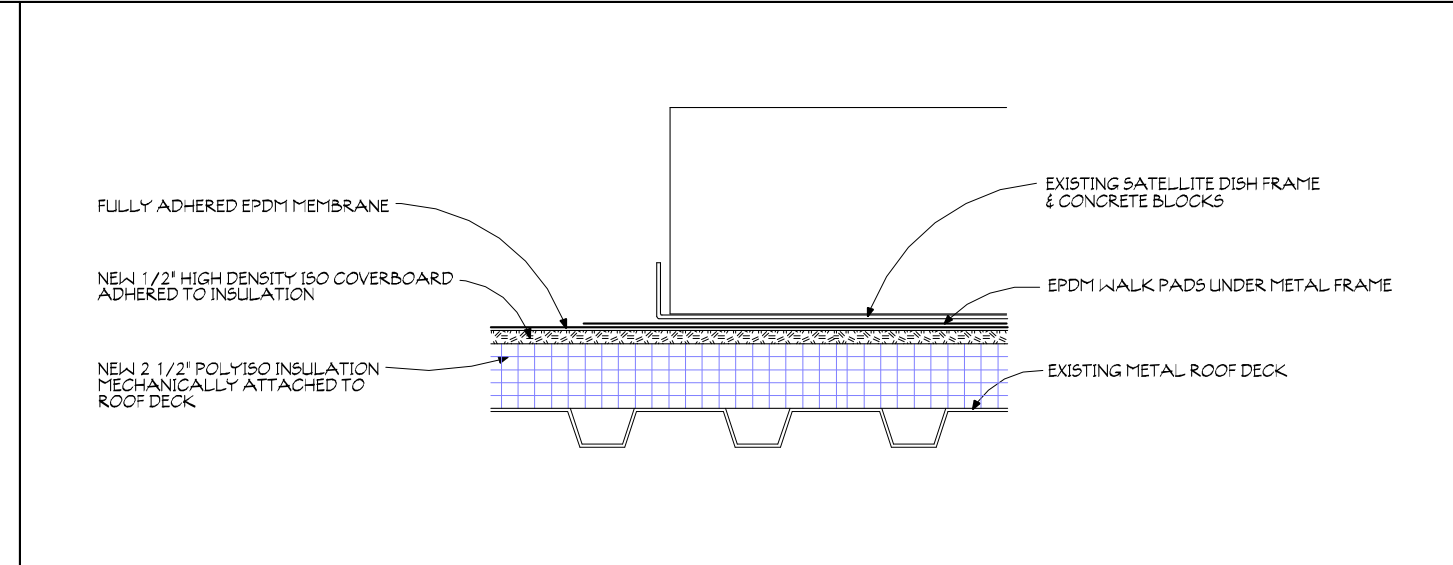

F15 SATELLITE DISH FLASHING
NO SCALE R1.1

- CONTRACTOR SHALL VERIFY ALL INFORMATION INCLUDING DIMENSIONS AND ROOF PENETRATIONS PRIOR TO BIDDING.
- SPECIAL PRECAUTIONS SHOULD BE TAKEN TO AVOID OVERLOADING OF THE ROOF STRUCTURE. DO NOT STACK MATERIALS WHICH WOULD ADD CONCENTRATED LOADS TO THE STRUCTURE.
- ALL CURBS, VENTS, AND REGLET FLASHINGS SHALL MEET THE 8" MIN. REQUIREMENT ABOVE THE NEW ROOF SYSTEM UNLESS OTHERWISE NOTED OR APPROVED BY THE ROOF CONSULTANT. CONTRACTOR SHALL EXTEND ALL STACKS, PIPES, WIRES, DUCTWORK, ETC. AS NECESSARY FOR NEW ROOF ELEVATION & 8" MIN. FLASHING HEIGHT.
- CONTRACTOR SHALL INSTALL NEW WOOD NAILERS AND BLOCKING AS REQ'D. CONTRACTOR SHALL INSTALL NEW PRESSURE TREATED NAILERS AT CURBS AS NEEDED TO MEET MINIMUM FLASHING HEIGHT. VERIFY THAT THE ATTACHMENT OF EXISTING NAILERS TO REMAIN MEETS FM REQUIREMENTS.
- ADJUST EXISTING GAS LINES AS REQUIRED FOR THE NEW ROOF SYSTEM & PAINT YELLOW. REUSE EXISTING GAS LINE SUPPORTS.
- INSPECT EXISTING VENT STACKS TO VERIFY THAT ALL JOINTS AND CONNECTIONS ARE TIGHT AND INTACT. NOTIFY ROOFING CONSULTANT IF ANY DEFICIENCIES ARE FOUND.
- CONTRACTOR MUST VERIFY PROPER DRAINAGE HAS BEEN ACHIEVED. NOTIFY ROOF CONSULTANT OF ANY AREAS WHICH WILL NOT DRAIN PROPERLY PRIOR TO INSTALLING ROOF MEMBRANE. IT IS THE INTENT OF THE DESIGN TO ELIMINATE PONDING WATER.

C15 GENERAL NOTES
NO SCALE R1.1

- EXISTING ROOFING SYSTEM CONSISTS OF A FULLY ADHERED EPDM MEMBRANE OVER 3" POLYISOCYANURATE INSULATION ON METAL DECK.
- REMOVE THE EXISTING EPDM MEMBRANE & ROOF INSULATION DOWN TO THE EXISTING METAL DECK & PROPERLY DISPOSE OFF SITE.
- IF ANY AREAS HAVE DETERIORATED DECK, DETERMINE UNSUITABLE FOR THE NEW ROOFING SYSTEM. NOTIFY ROOF CONSULTANT IMMEDIATELY AND REPLACE ANY UNSUITABLE DECK AS DIRECTED BY THE ROOF CONSULTANT.
- MECHANICALLY ATTACH 2 1/2" OF NEW POLYISOCYANURATE INSULATION TO THE EXISTING METAL ROOF DECK. REVIEW INTERIOR & AVOID PENETRATING ANY CONDUIT, ETC. BELOW DECK.
- FULLY ADHERE NEW 1/2" HIGH DENSITY ISO COVERBOARD TO THE POLYISOCYANURATE INSULATION.
- INSTALL A FULLY ADHERED 60 MIL EPDM MEMBRANE OVER THE NEW HIGH DENSITY ISO COVERBOARD FOR A 20-YEAR WEATHER TIGHTNESS WARRANTY.
- REPLACE ALL EXISTING METAL COPINGS, FLASHINGS, THRU WALL SCUPPERS, GUTTERS & DOWNSPOUTS WITH NEW AS SHOWN ON THE DRAWINGS.
- INSTALL WALKPADS AROUND ALL ROOFTOP UNITS & SATELLITE DISH.

A15 ROOFING NOTES
NO SCALE R1.1

ROOF DESIGN WORKS INC.
P.O. Box 12716 Knoxville, TN. 37912
Telephone (865) 584-6682
Email: mcd@rdw.net
www.rdwnet

ARCHITECTS WEEKS AMBROSE McDONALD INC.
30 MARKET SQUARE
KNOXVILLE, TENNESSEE 37902
TELEPHONE 865-546-8232
FAX 865-546-8252
architects@awainc.com

PARTIAL ROOF REPLACEMENTS FOR
ANDERSON COUNTY BOARD OF EDUCATION
GRAND OAKS ELEMENTARY

ARCHITECTS WEEKS AMBROSE McDONALD, INC.
DATE 02-01-24
PROJECT NO. 23019
REFERENCE R1.1-GOE
DRAWN BEM
CHECKED VW/BEM
REVISION

ROOF PLAN & DETAILS
R1.1

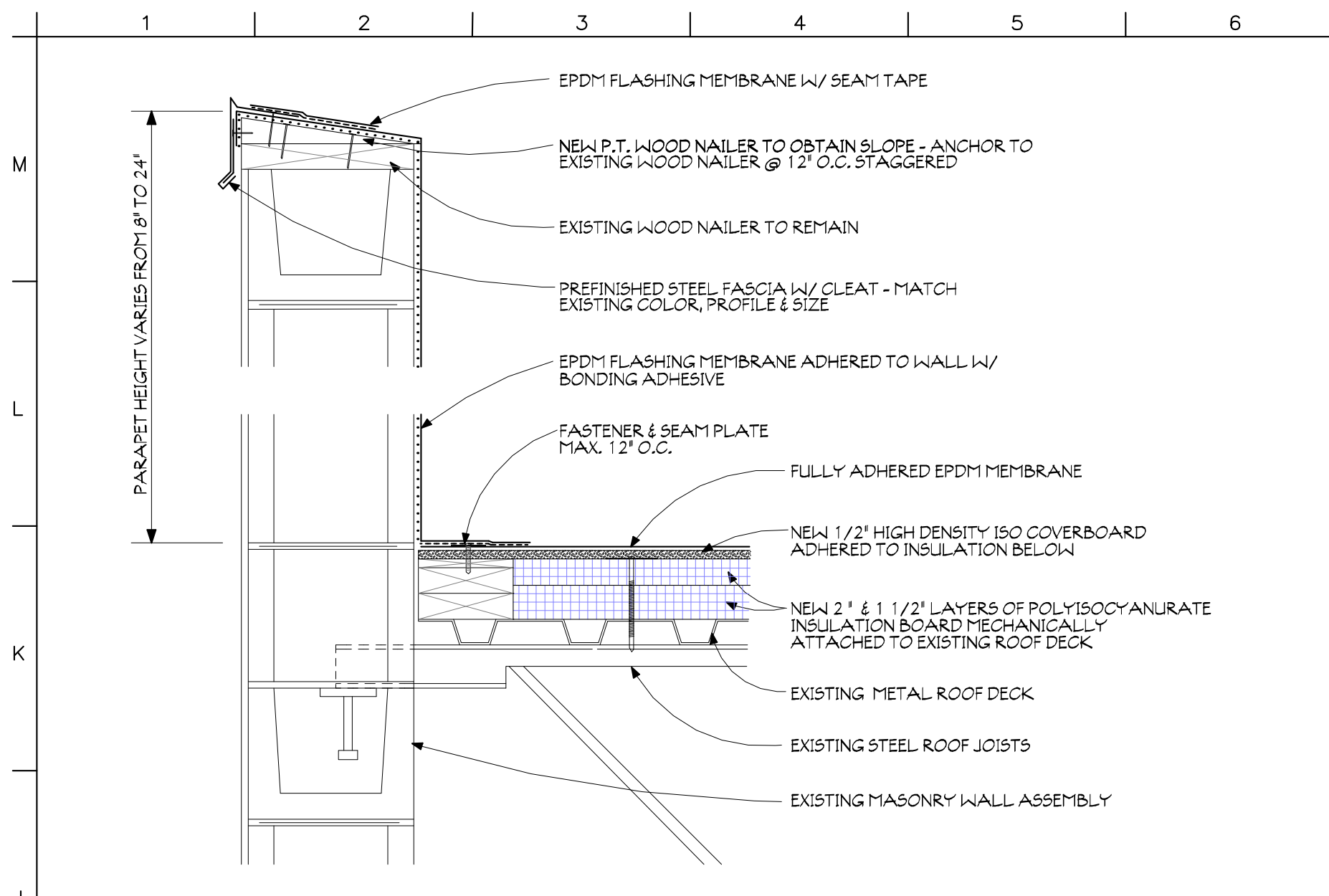

J1 **PARAPET**
SCALE: 1 1/2" = 1'-0"

- | | |
|--|---|
| <p>1 CONTRACTOR SHALL VERIFY ALL INFORMATION INCLUDING DIMENSIONS AND ROOF PENETRATIONS PRIOR TO BIDDING.</p> <p>2 SPECIAL PRECAUTIONS SHOULD BE TAKEN TO AVOID OVERLOADING OF THE ROOF STRUCTURE. DO NOT STACK MATERIALS WHICH WOULD ADD CONCENTRATED LOADS TO THE STRUCTURE.</p> <p>3 ALL CURBS, VENTS, AND REGLET FLASHINGS SHALL MEET THE 8" MIN. REQUIREMENT ABOVE THE NEW ROOF SYSTEM UNLESS OTHERWISE NOTED OR APPROVED BY THE ROOF CONSULTANT. CONTRACTOR SHALL EXTEND ALL STACKS, PIPES, WIRES, DUCTWORK, ETC. AS NECESSARY FOR NEW ROOF ELEVATION & 8" MIN. FLASHING HEIGHT.</p> | <p>4 CONTRACTOR SHALL INSTALL NEW WOOD NAILERS AND BLOCKING AS REQD. CONTRACTOR SHALL INSTALL NEW PRESSURE TREATED NAILERS AT CURBS AS NEEDED TO MEET MIN. FLASHING HEIGHT. VERIFY THAT THE ATTACHMENT OF EXISTING NAILERS TO REMAIN MEETS F1 REQUIREMENTS.</p> <p>5 INSPECT EXISTING VENT STACKS TO VERIFY THAT ALL JOINTS AND CONNECTIONS ARE TIGHT AND INTACT. NOTIFY ROOFING CONSULTANT IF ANY DEFICIENCIES ARE FOUND.</p> <p>6 CONTRACTOR MUST VERIFY PROPER DRAINAGE HAS BEEN ACHIEVED. NOTIFY ROOF CONSULTANT PRIOR TO ANY AREAS WHICH WILL NOT DRAIN PROPERLY PRIOR TO INSTALLING ROOF MEMBRANE. IT IS THE INTENT OF THE DESIGN TO ELIMINATE PONDING WATER.</p> |
|--|---|

F1 **GENERAL NOTES**
NO SCALE R1.2

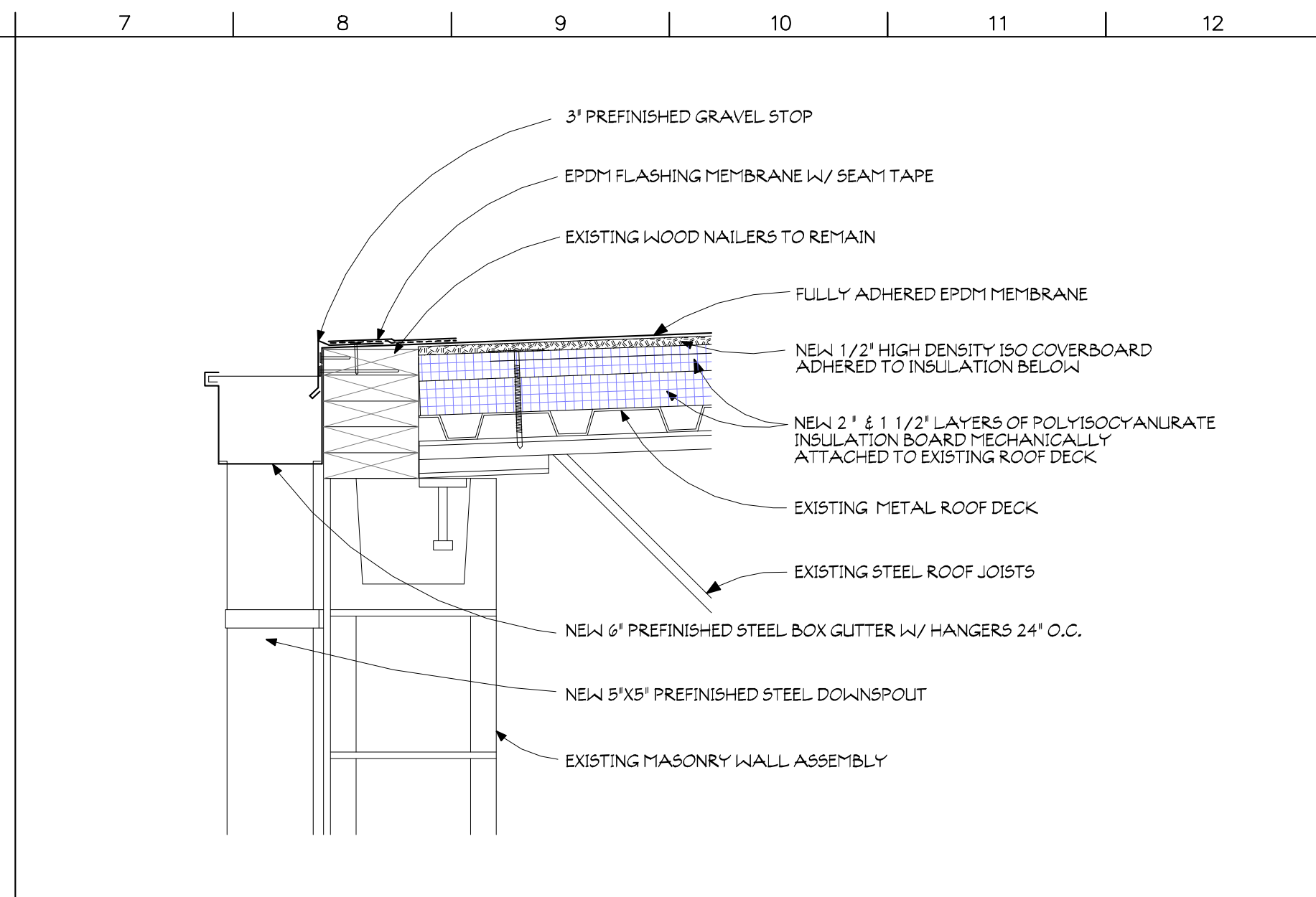

J7 **ROOF EDGE W/ GUTTER**
SCALE: 1 1/2" = 1'-0"

- | | |
|--|--|
| <p>1 EXISTING ROOFING SYSTEM CONSISTS OF A FULLY ADHERED EPDM MEMBRANE OVER 1/2" WOOD FIBERBOARD & 3 1/2" EPS INSULATION ON METAL DECK.</p> <p>2 REMOVE THE EXISTING EPDM MEMBRANE & ROOF INSULATION DOWN TO THE EXISTING METAL DECK & PROPERLY DISPOSED OFF SITE.</p> <p>3 IF ANY AREAS HAVE DETERIORATED DECK, DEEMED UNSUITABLE FOR THE NEW ROOFING SYSTEM, NOTIFY ROOF CONSULTANT IMMEDIATELY AND REPLACE ANY UNSUITABLE DECK AS DIRECTED BY THE ROOF CONSULTANT.</p> <p>4 MECHANICALLY ATTACH 3 1/2" OF NEW POLYISOCYANURATE INSULATION TO THE EXISTING METAL ROOF DECK. REVIEW INTERIOR TO AVOID PENETRATING EXISTING CONDUIT, ETC. BELOW ROOF DECK.</p> | <p>5 FULLY ADHERE NEW 1/2" HIGH DENSITY ISO COVERBOARD TO THE POLYISOCYANURATE INSULATION.</p> <p>6 INSTALL A FULLY ADHERED 60 MIL EPDM MEMBRANE OVER THE NEW HIGH DENSITY ISO COVERBOARD FOR A 20-YEAR WEATHERTIGHTNESS WARRANTY.</p> <p>7 REPLACE ALL EXISTING METAL COPINGS, FLASHINGS, THRU WALL SCUPPERS, GUTTERS & DOWNSPOUTS WITH NEW AS SHOWN ON THE DRAWINGS.</p> |
|--|--|

F7 **ROOFING NOTES**
NO SCALE R1.2

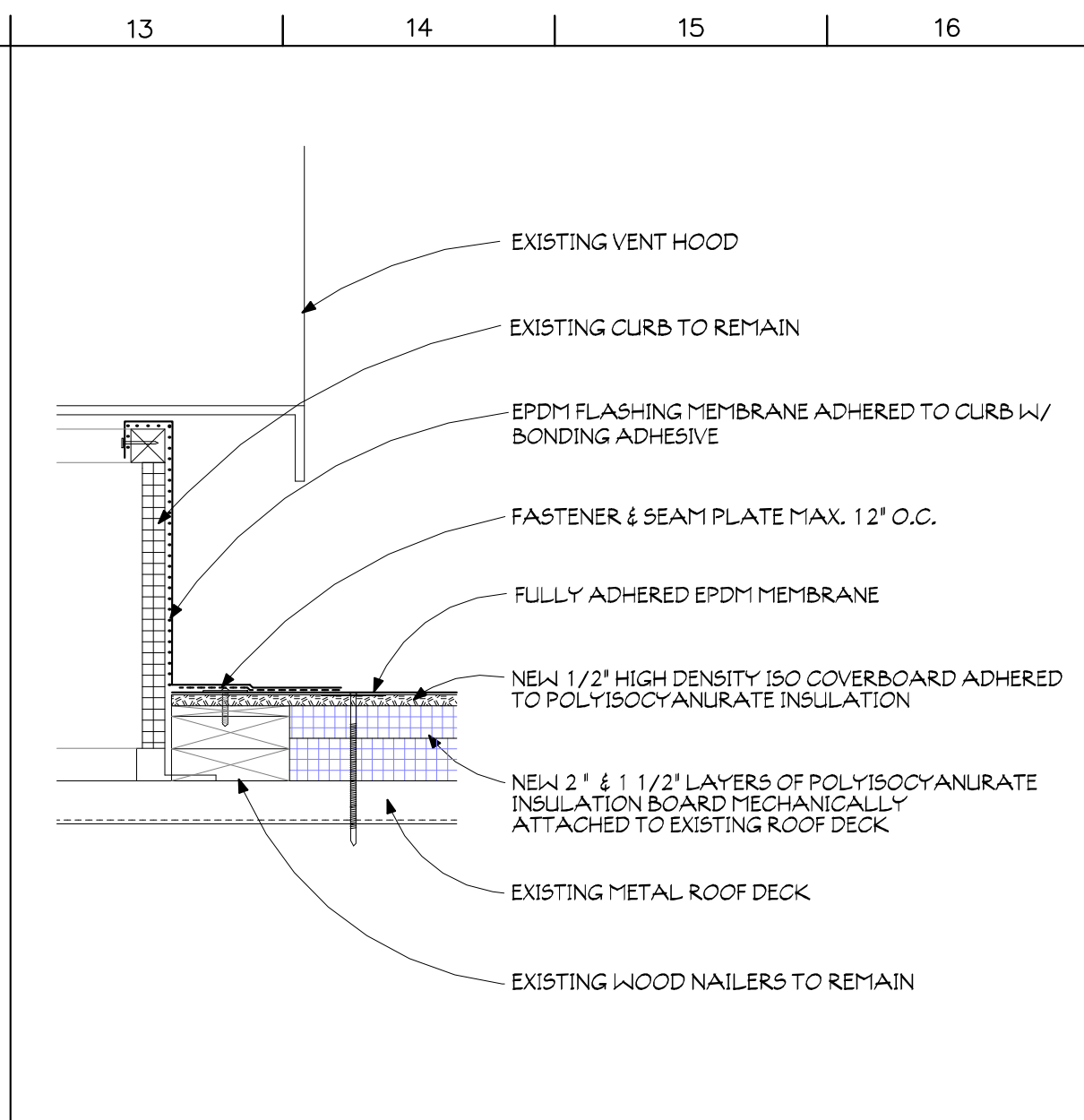

J13 **CURB FLASHING**
SCALE: 1 1/2" = 1'-0"

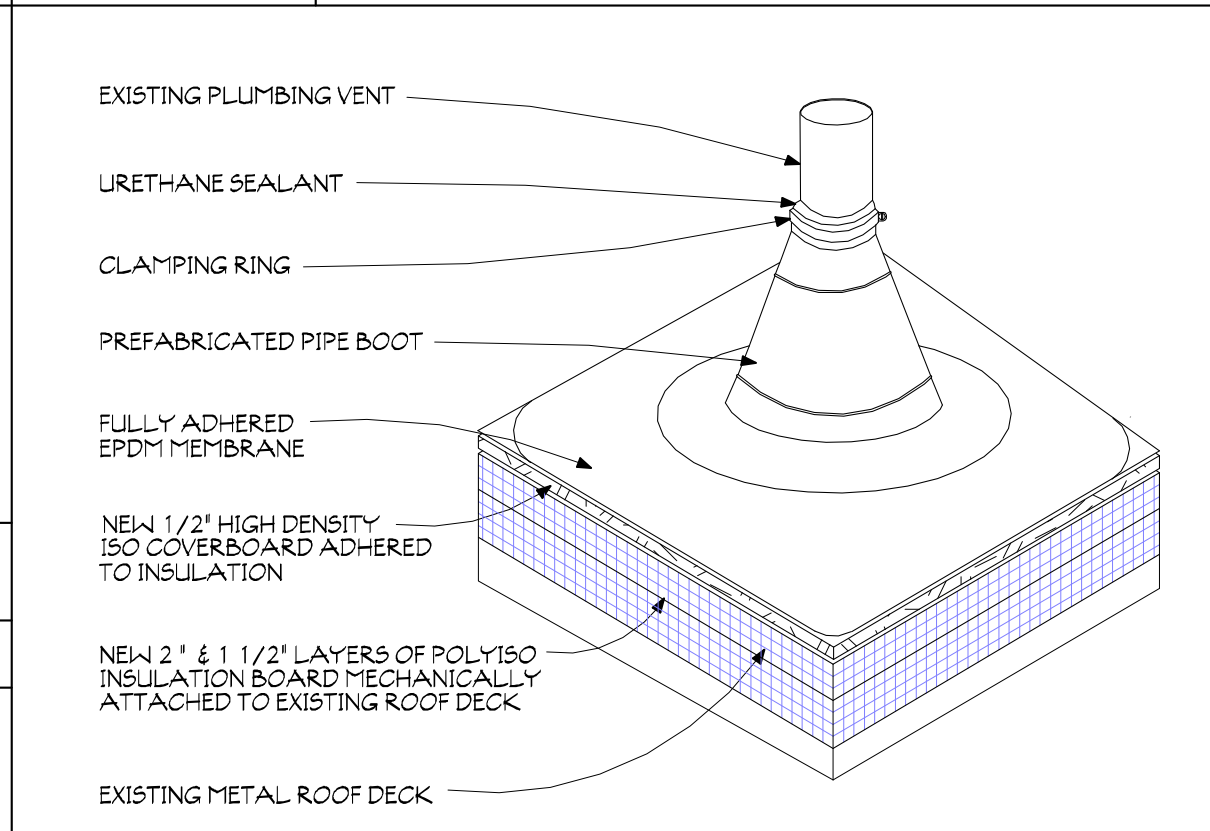

F13 **VENT THRU ROOF**
SCALE: 1 1/2" = 1'-0"

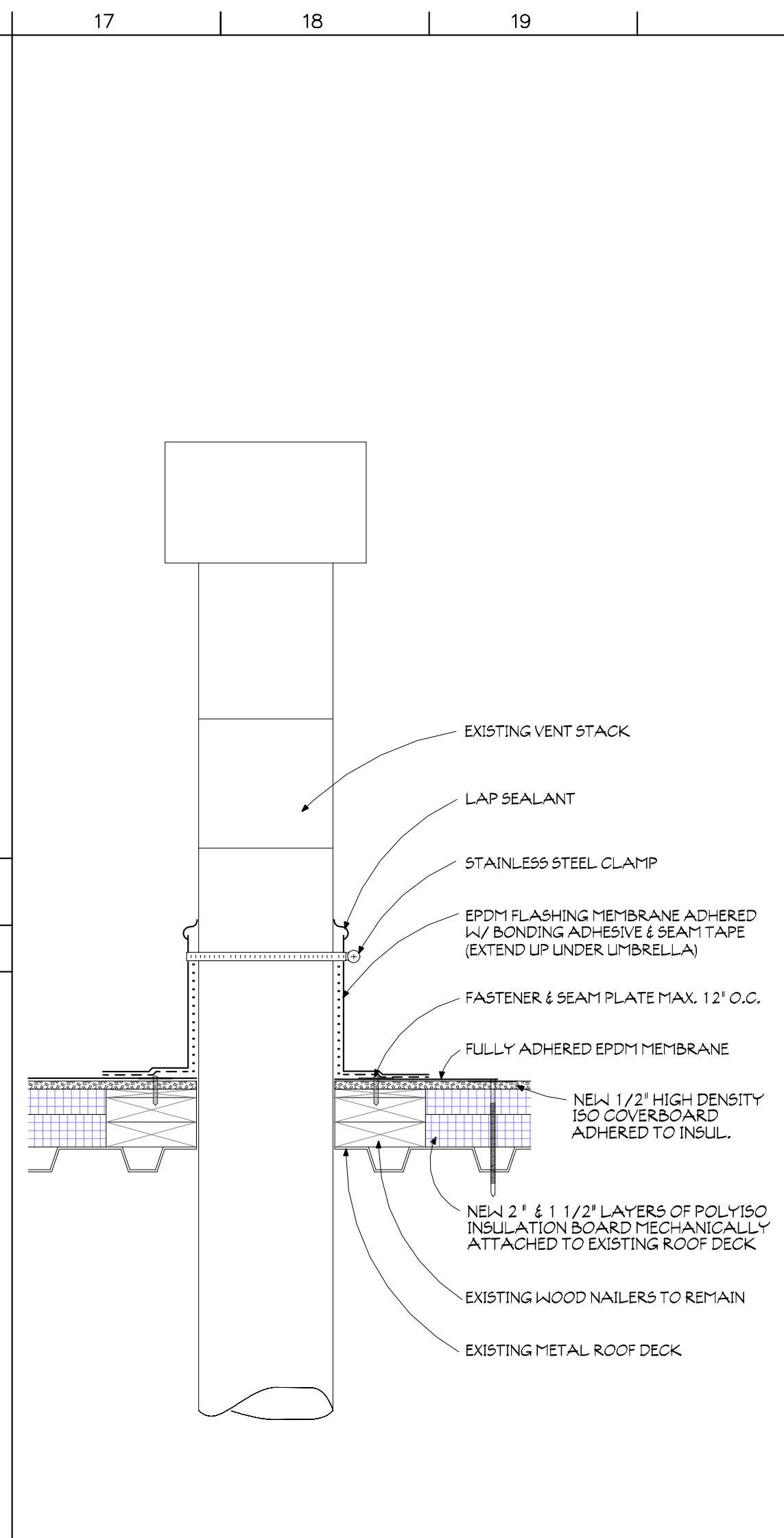

F17 **HOT STACK**
SCALE: 1 1/2" = 1'-0"

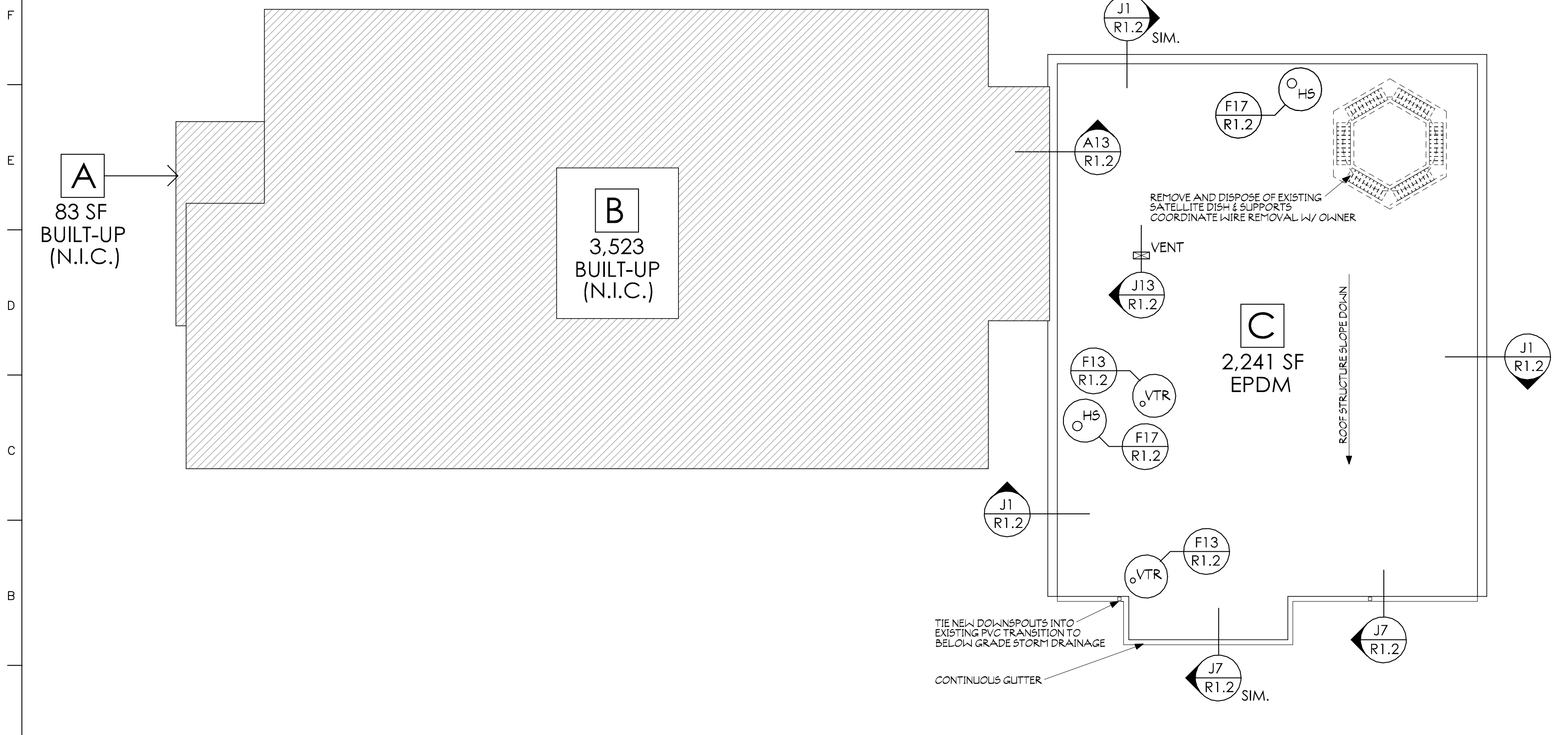

A1 **ROOF PLAN - OFFICE OF TECHNOLOGY**
SCALE: 1/8" = 1'-0"

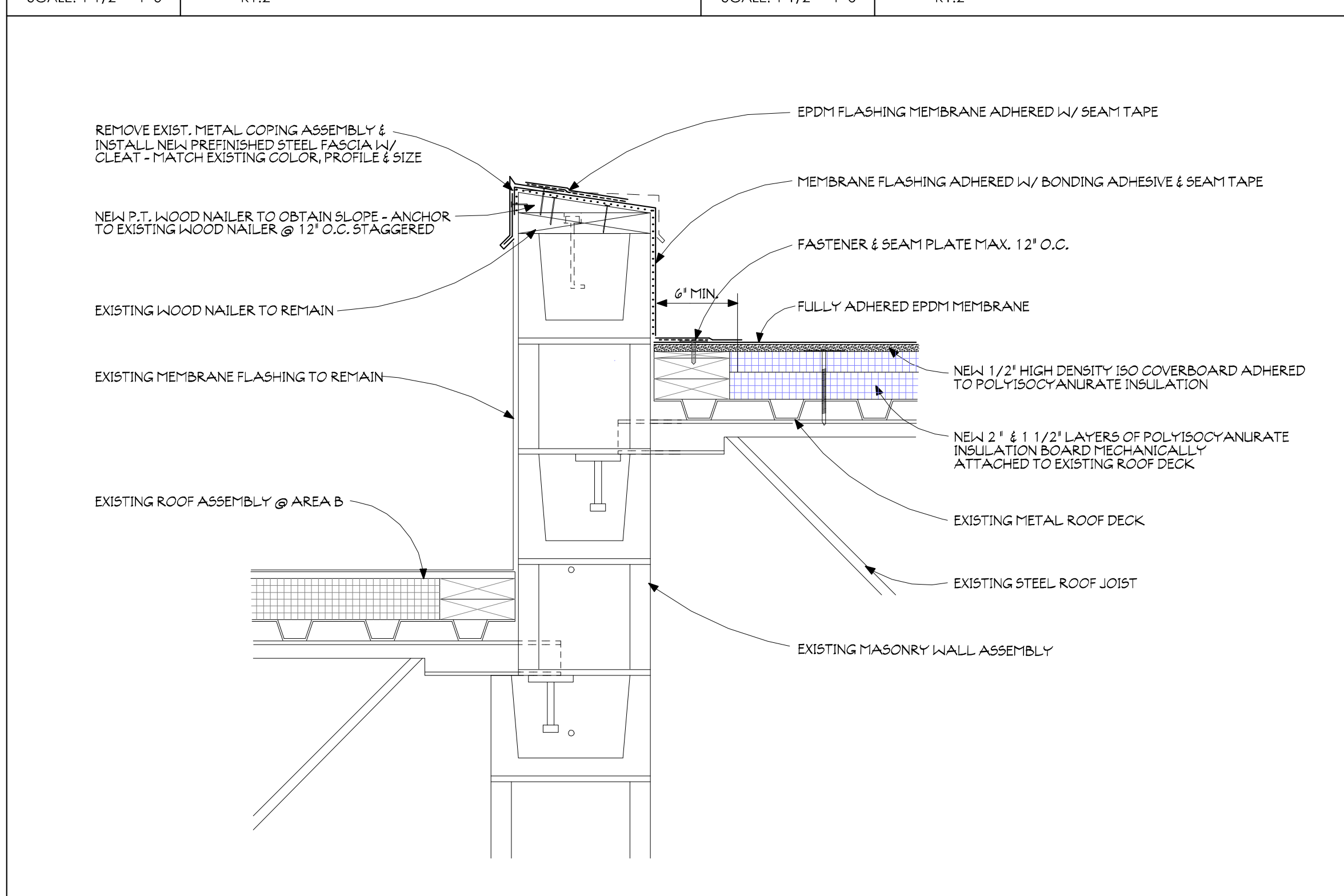

A13 **PARAPET @ TIE-IN BETWEEN ROOF AREAS B & C**
SCALE: 1 1/2" = 1'-0"

ROOF DESIGN WORKS INC.
P.O. Box 12716 Knoxville, TN 37912
Telephone (865) 584-6682
Email: mtd@rdw.net
www.rdw.net

ARCHITECTS WEEKS AMBROSE McDONALD INC.
30 MARKET SQUARE
KNOXVILLE, TENNESSEE 37902
TELEPHONE: 865-546-8232
FAX: 865-546-8255
architects@waminc.com

PARTIAL ROOF REPLACEMENTS FOR
ANDERSON COUNTY BOARD OF EDUCATION
OFFICE OF TECHNOLOGY

© ARCHITECTS WEEKS AMBROSE McDONALD, INC.

DATE	02-01-24
PROJECT NO.	23019
REFERENCE	R1.2-00T
DRAWN	BEM
CHECKED	VW/BEM
REVISION	

ROOF PLAN & DETAILS
R1.2

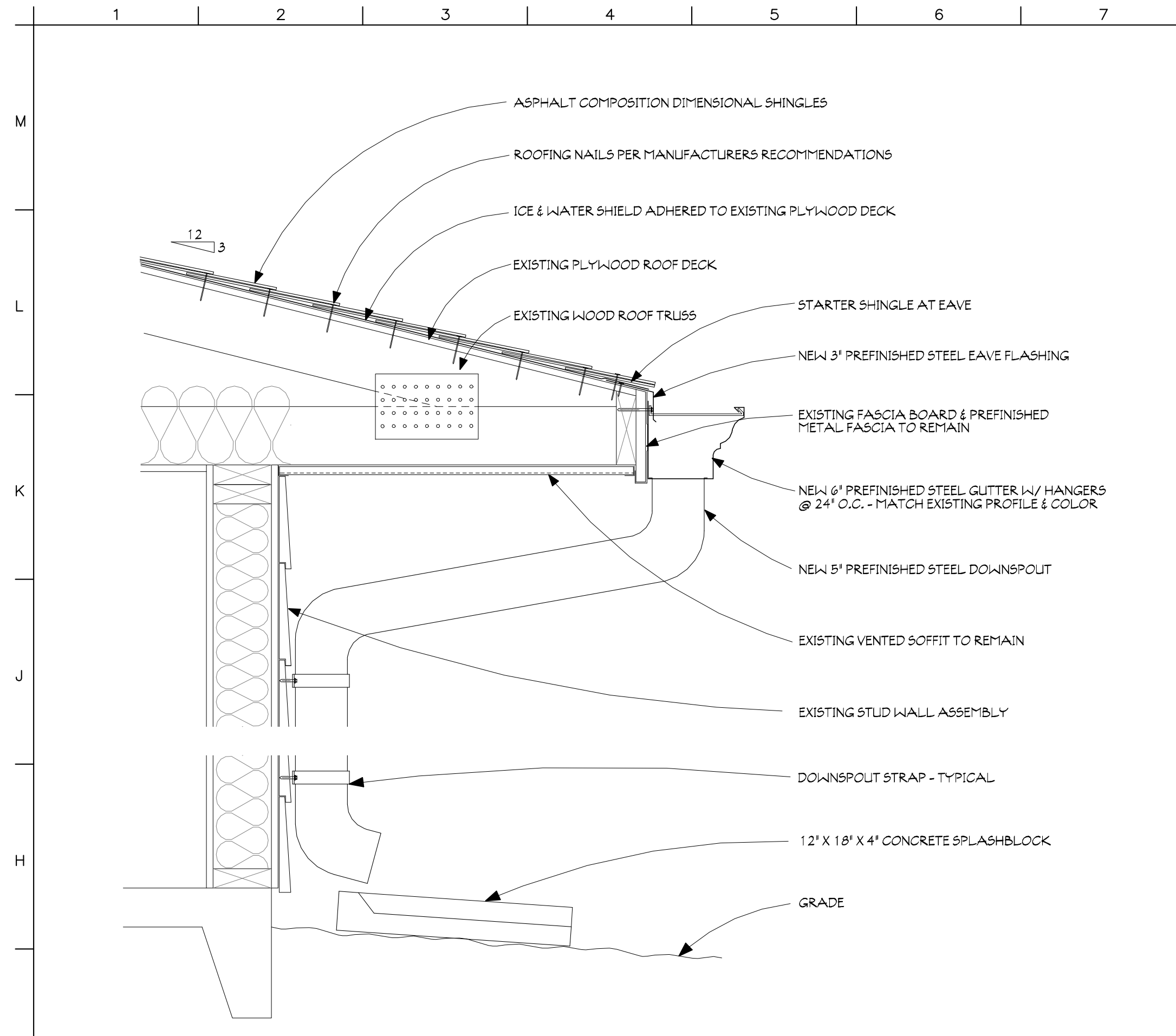

G1 EAVE W/ GUTTER & DOWNSPOUT

SCALE: 1 1/2" = 1'-0" R1.3

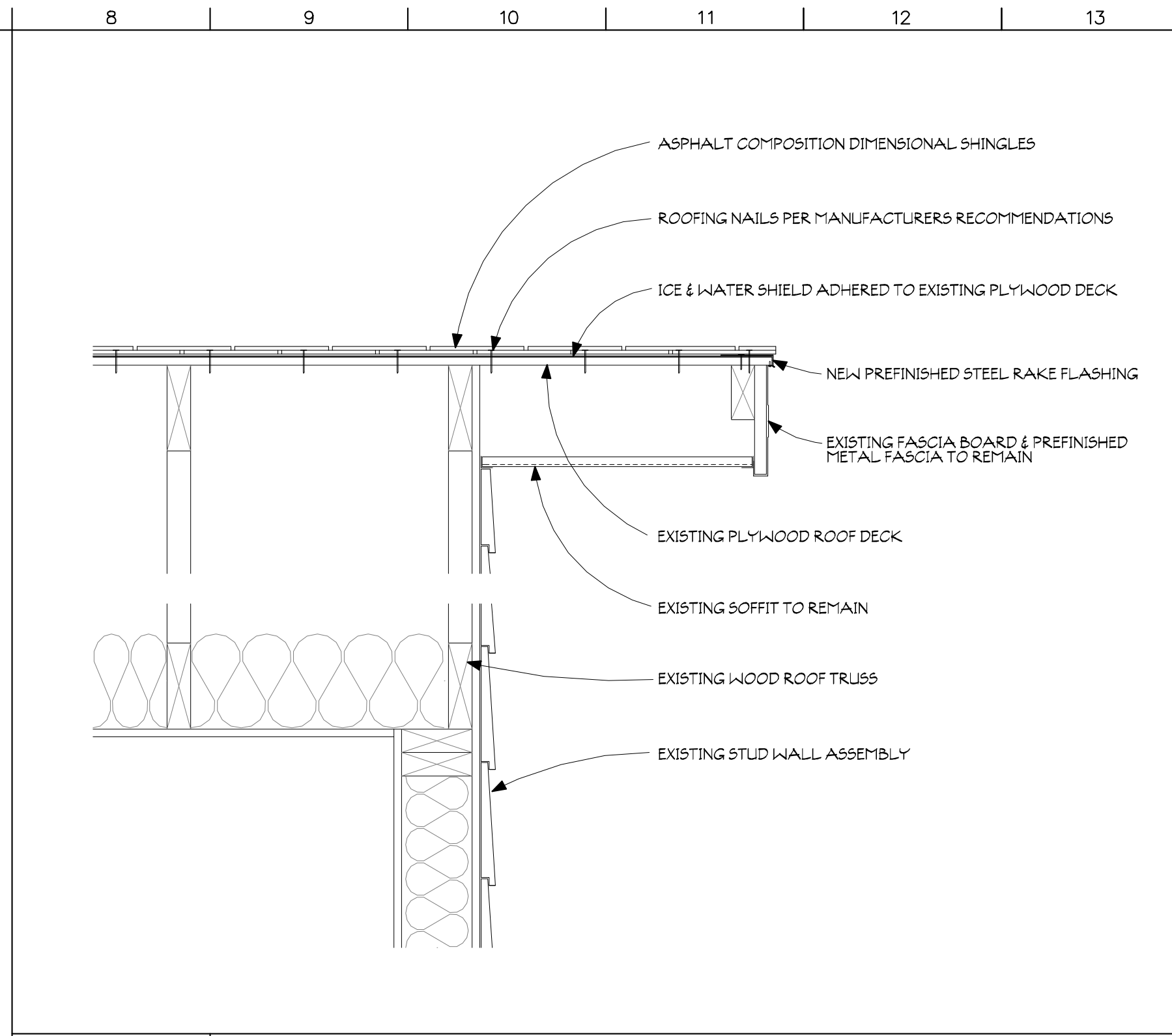

H8 RAKE

SCALE: 1 1/2" = 1'-0" R1.3

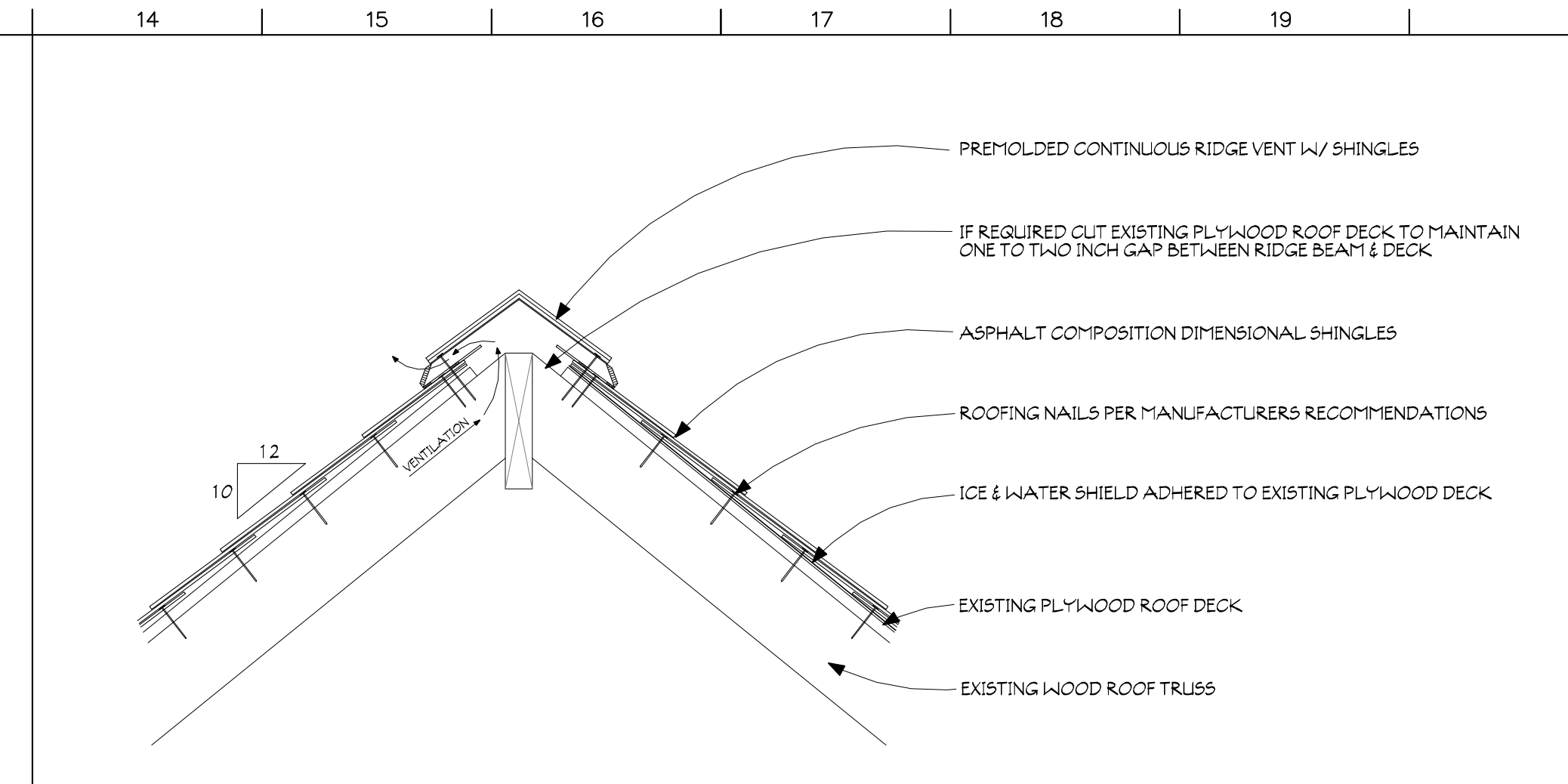

J14 RIDGE VENT

SCALE: 1 1/2" = 1'-0" R1.3

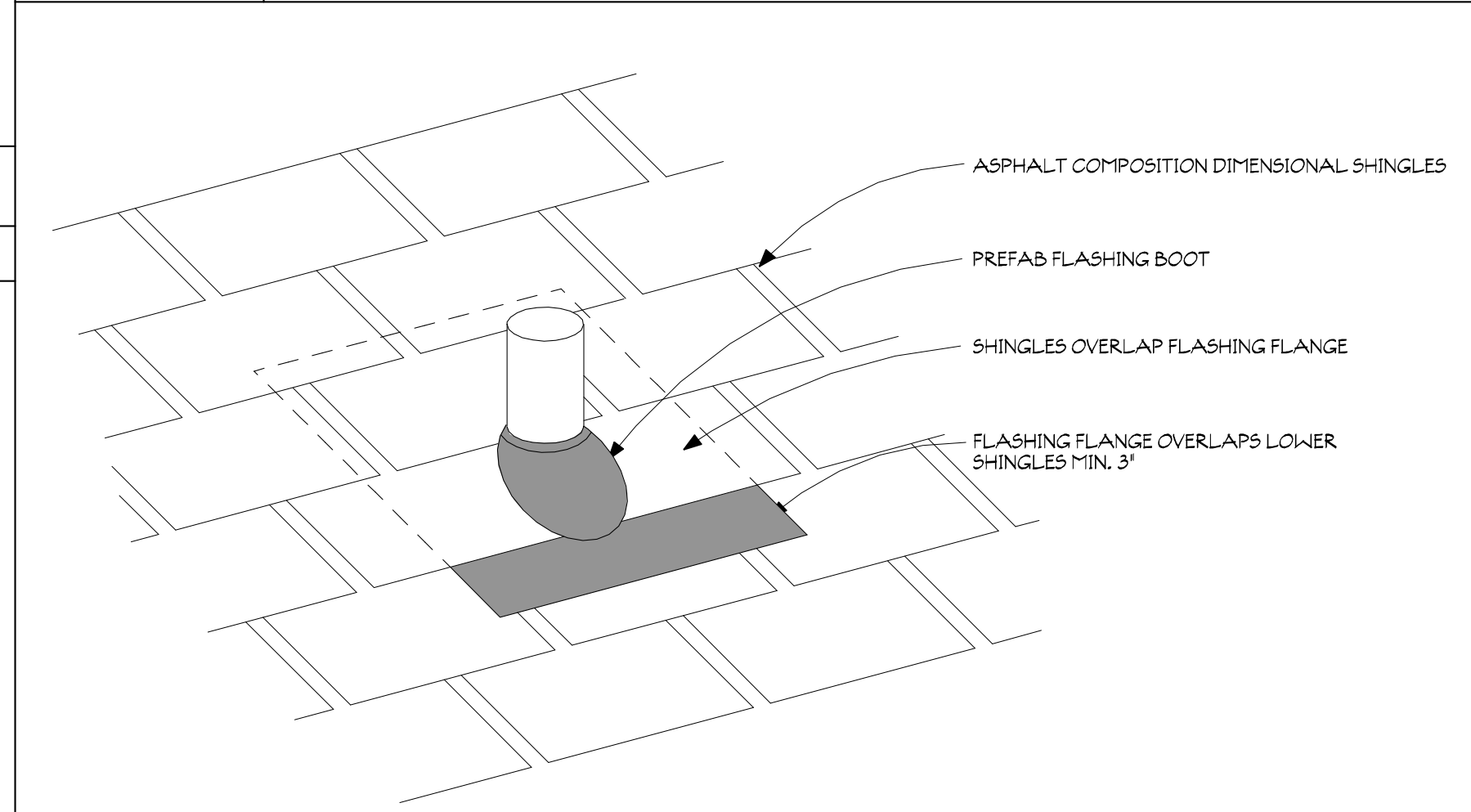

D8 VENT THRU ROOF

SCALE: 1 1/2" = 1'-0" R1.3

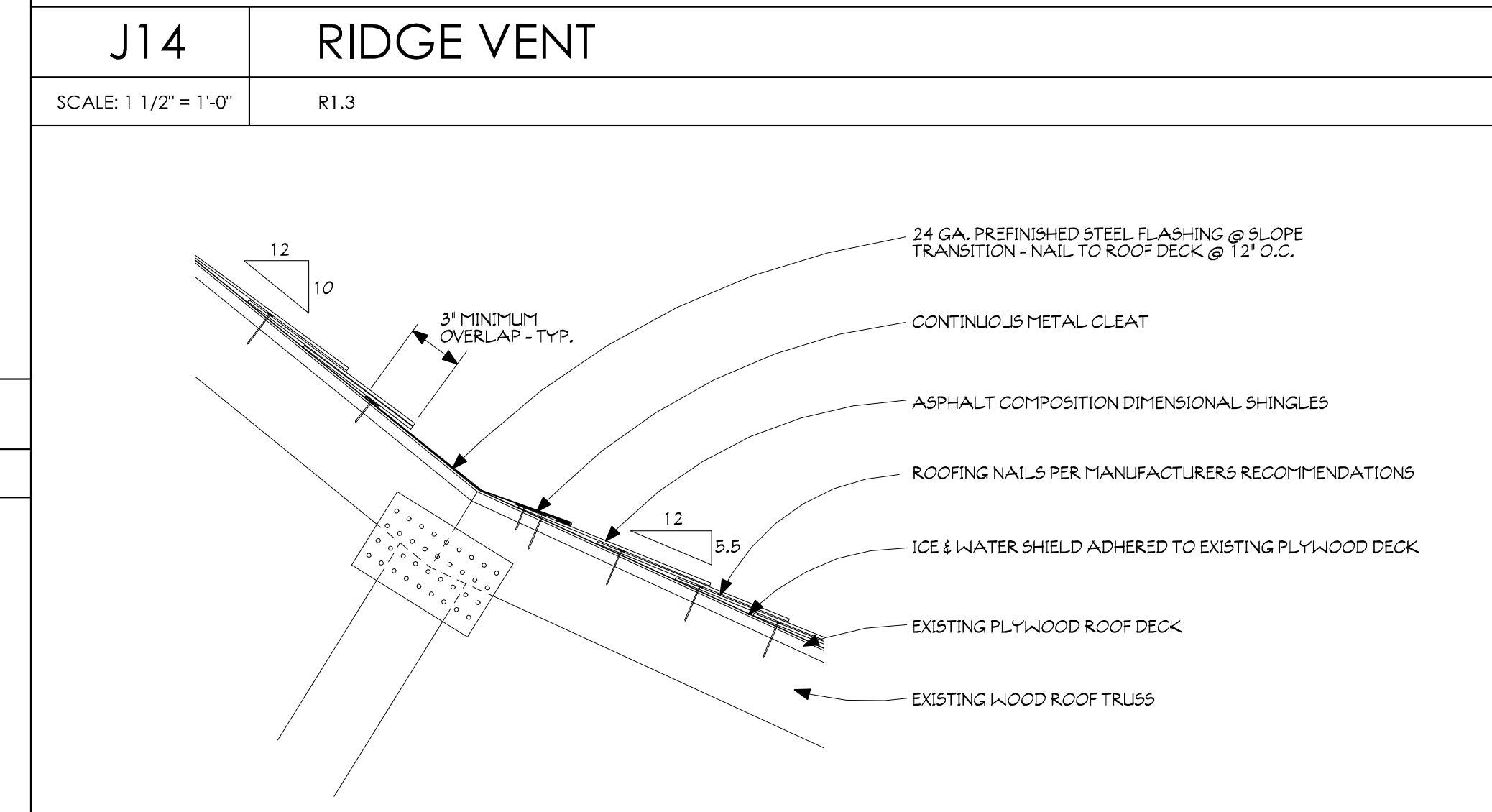

F14 SLOPE CHANGE FLASHING

SCALE: 1 1/2" = 1'-0" R1.3

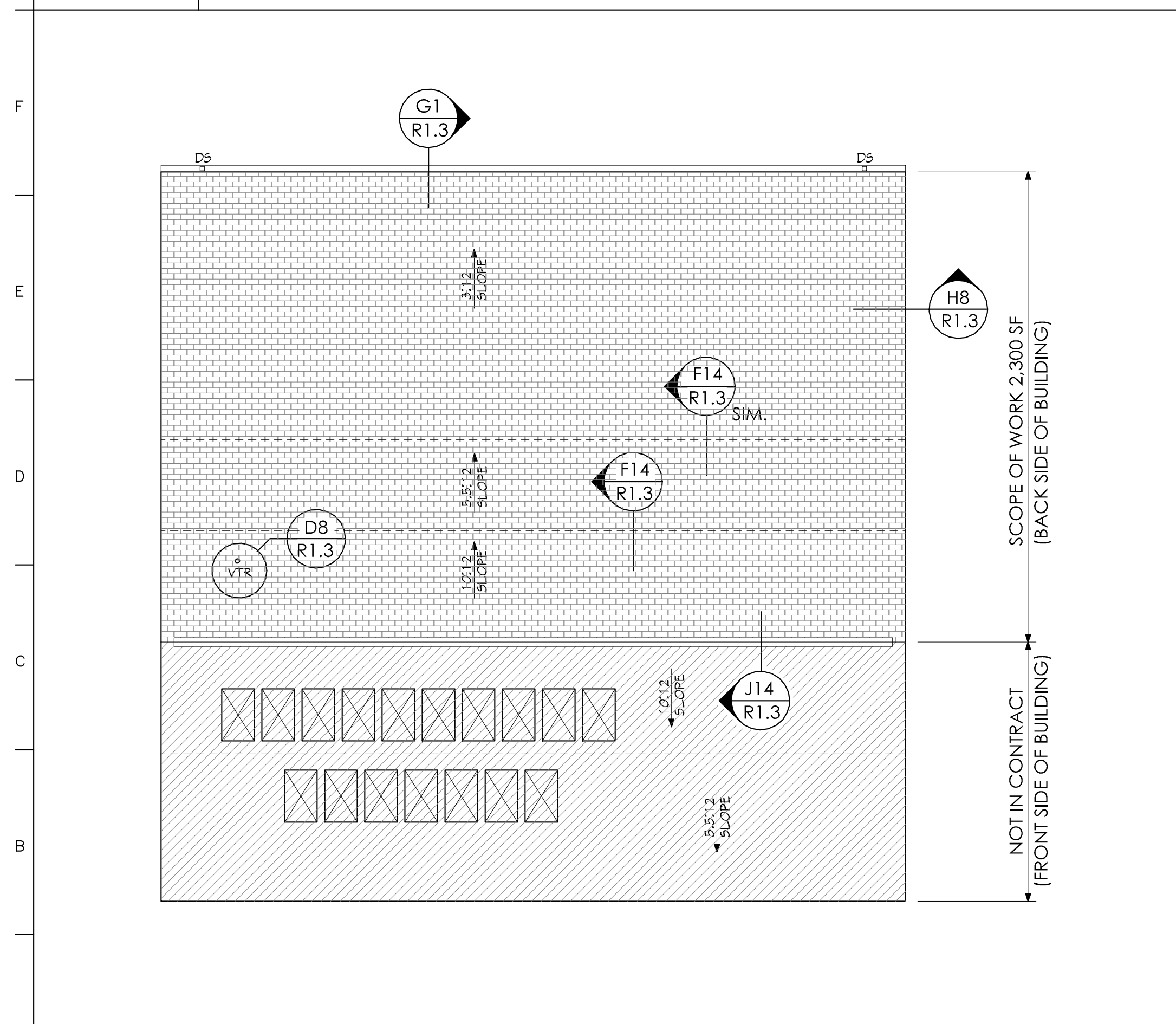

A1 ROOF PLAN

SCALE: 1/8" = 1'-0"

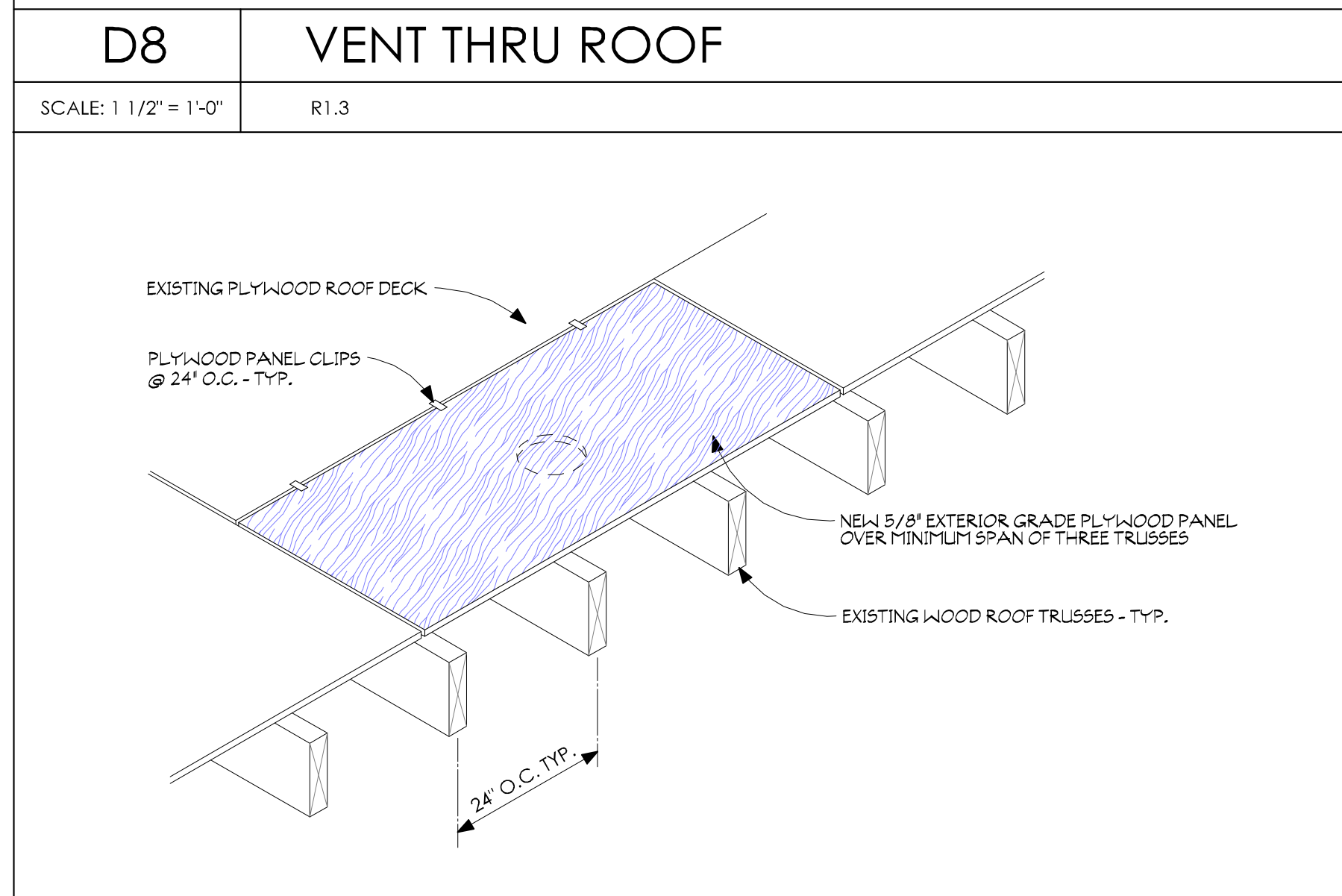

A8 PLYWOOD ROOF DECK REPAIR

SCALE: 1 1/2" = 1'-0" R1.3

- F14** SLOPE CHANGE FLASHING
- CONTRACTOR SHALL VERIFY ALL INFORMATION INCLUDING DIMENSIONS AND ROOF PENETRATIONS PRIOR TO BIDDING.
 - SPECIAL PRECAUTIONS SHOULD BE TAKEN TO AVOID OVERLOADING OF THE ROOF STRUCTURE. DO NOT STACK MATERIALS WHICH WOULD ADD CONCENTRATED LOADS TO THE STRUCTURE.
 - INSPECT EXISTING VENT STACKS TO VERIFY THAT ALL JOINTS AND CONNECTIONS ARE TIGHT AND INTACT. NOTIFY ROOFING CONSULTANT IF ANY DEFICIENCIES ARE FOUND.
 - REVIEW INTERIOR TO AVOID PENETRATING EXISTING CONDUIT, ETC., BENEATH THE ROOF DECK.

C18 GENERAL NOTES

NO SCALE R1.3

- EXISTING ROOFING SYSTEM CONSISTS OF DIMENSIONAL ASPHALT SHINGLE ROOFING OVER UNDERLAYMENT NAILED TO A PLYWOOD ROOF DECK.
- REMOVE THE EXISTING ASPHALT SHINGLES & UNDERLAYMENT DOWN TO THE EXISTING PLYWOOD DECK & PROPERLY DISPOSE OFF SITE.
- IF ANY AREAS HAVE DETERIORATED DECK, DEEMED UNSUITABLE FOR THE NEW ROOFING SYSTEM, NOTIFY ROOF CONSULTANT IMMEDIATELY AND REPLACE ANY UNSUITABLE DECK AS DIRECTED BY THE ROOF CONSULTANT. SEE DETAIL A8/R1.3.
- NAIL NEW ICE & WATER SHIELD TO THE EXISTING PLYWOOD ROOF DECK.
- NAIL NEW DIMENSIONAL SHINGLES TO EXISTING PLYWOOD ROOF DECK TO MEET MINIMUM WIND UPLIFT REQUIREMENTS & 30-YEAR WARRANTY.
- REPLACE ALL EXISTING FLASHINGS & RIDGE VENT. INSTALL GUTTERS & DOWNSPOUTS AS SHOWN ON THE DRAWINGS. INSTALL NEW CONCRETE SPLASHBLOCKS AT GRADE.

A18 ROOFING NOTES

NO SCALE R1.3

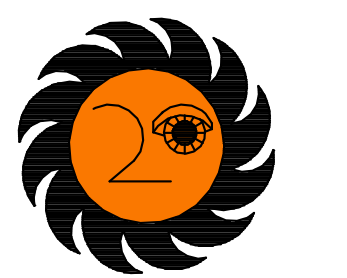

ROOF DESIGN WORKS INC.

P.O. Box 12716 Knoxville, TN 37912
Telephone (865) 584-6682
Email: mail@rdwi.net
www.rdwi.net



ARCHITECTS WEEKS AMBROSE McDONALD INC.

30 MARKET SQUARE
KNOXVILLE, TENNESSEE 37902
TELEPHONE: 865-546-8932
FAX: 865-546-8252
architects@waminc.com

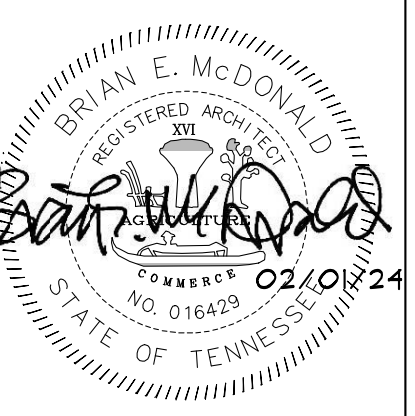

PARTIAL ROOF REPLACEMENTS FOR
ANDERSON COUNTY BOARD OF EDUCATION NET ZERO BUILDING

DATE	02-01-24
PROJECT NO.	23019
REFERENCE	R1.3-NZB
DRAWN	BEM
CHECKED	VW/BEM
REVISION	

ROOF PLAN & DETAILS R1.3