

ADDENDUM NO. 2

**Hamilton County Department of Education
Dalewood Middle School Re-Roofing (Phase 1)
Derthick Henley & Wilkerson Architects**

**Date: January 19, 2023
HCDE Bid No. 23-15
DHW Project No. 82211-B**

The following amendments to the specifications and/or revisions to the drawings shall be a part of the contract documents. Bidders, therefore, shall consider them when preparing cost estimates, and the contractors shall be bound by them.

DRAWINGS:

A100 ~ Roof Plan

- Delete all references to 'Torch Applied' from detail A7/A100.
- Replace all references to detail 'A9/A304' with detail 'A9/A302'.
- Sheet with clouded revisions is attached to this Addendum.

End of Addendum No. 2

Existing Roof Core Schedule

- RC-1:** Modified Bitumen
1" Perlite
2 1/2" Wood Fiber Board
Vapor Barrier
Concrete Deck (Sloped)
- RC-2:** Modified Bitumen
1" Perlite
2" Expanded Polystyrene
Vapor Barrier
2 1/2" Lightweight Concrete (No Slope)
Metal Deck (No Slope)
- RC-3:** Modified Bitumen
1" Perlite
2" Expanded Polystyrene
Vapor Barrier
2 1/2" Lightweight Concrete (No Slope)
Metal Deck (No Slope)
- RC-4:** Modified Bitumen
1 1/2" Perlite
Vapor Barrier
2 1/2" Lightweight Concrete (No Slope)
Metal Deck (No Slope)
- RC-5:** Modified Bitumen
1" Perlite
2" Expanded Polystyrene
Vapor Barrier
2 1/2" Lightweight Concrete (No Slope)
Metal Deck (No Slope)
- RC-6:** Modified Bitumen
2" Perlite
3/4" Wood Fiber Board
Vapor Barrier
6" Metal Deck (No Slope)
- RC-7:** Modified Bitumen
2" Perlite
2" Expanded Polystyrene
2 1/2" Wood Fiber Board
Vapor Barrier
6" Metal Deck (No Slope)
- RC-8:** Modified Bitumen
1" Perlite
1/4" Expanded Polystyrene
2 1/2" Wood Fiber Board
Vapor Barrier
6" Metal Deck (No Slope)
- RC-9:** Modified Bitumen
1" Perlite
2 1/2" Expanded Polystyrene
2 1/2" Wood Fiber Board
Vapor Barrier
6" Metal Deck (No Slope)
- RC-10:** Modified Bitumen
1" Perlite
2 1/2" Expanded Polystyrene
1 3/4" Perlite
Vapor Barrier
6" Metal Deck (No Slope)
- RC-11:** Modified Bitumen
1" Perlite
2" Expanded Polystyrene
2" Wood Fiber Board
Vapor Barrier
6" Metal Deck (No Slope)
- RC-12:** Modified Bitumen
1" Perlite
4" Expanded Polystyrene
Vapor Barrier
6" Metal Deck (No Slope)
- RC-13:** Modified Bitumen
3/4" Wood Fiber Board
2 1/2" Lightweight Concrete
1 1/2" Metal Deck (1:12 Slope)

Roof Plan Legend

- Existing roof transition detail callouts (see sheet A300)
- Existing roof core callout
- Approximate core location
- 4"x4" target sump (1:12 slope) roof sump area with liquid-applied flashing membrane system, typical (Liquid-applied flashing membrane system is not required for roof drains at Roof Areas G & F3)
- Roof drain (See detail H18/A300)
- New 3/4" gas piping to replace existing (See detail L13/A300)
- Elbow
- Vertical transition
- Roof penetration (See detail E18/A300)
- Abandoned gas piping to be demolished. Cut piping flush with top of roof deck at existing roof penetrations. Cap supply side at existing valve.
- Plumbing vent pipe penetration (See detail A18/A300)
- Curb mounted mechanical equipment to remain (See Roof Top Equipment Schedule for callouts & requirements) (See detail H13/A300)
- Abandoned curb mounted mechanical equipment & roof curb to be removed (See detail A13/A300 for deck repair)
- Slope of new roof assembly
- Extent of PVC roof system (See Roof Area G & F3)
- 14" x 10" x 10" Conductor head with 5x5 downspout (See SMACNA Figure 1-25F)
- Metal splash pan adhered to walkway pad (See SMACNA Figure 1-36) (Direct towards closest drain and adhere walkway pad to roof.)
- Factory mitered, welded, & finished coping corner
- 7" gutter with straps at 36" o.c. & brackets at 36" o.c. centered between straps (See SMACNA Figure 1-2 Style D)
- Gutter expansion joint (See SMACNA Figure 1-7)
- 5"x5" Downspout (See SMACNA Figure 1-32B)

ROOF TOP EQUIPMENT SCHEDULE

Callout	Description	Existing Length (inches)	Existing Width (inches)	Existing Height (inches above existing roof surface)	Field Verify	Equipment & Curb to be Demolished	Existing Equipment to be Installed on New Curb	New Curb Height (inches above roof deck)	Typical Roof Detail
GV-1	Gravity Vent	30	30	8	X		X	NA	A13/A300
GV-2	Gravity Vent	30	30	8	X		X	NA	A13/A300
GV-3	Gravity Vent	30	30	8	X		X	NA	A13/A300
GV-4	Gravity Vent	30	30	8	X		X	NA	A13/A300
GV-5	Gravity Vent	30	30	8	X		X	NA	A13/A300
GV-6	Gravity Vent	30	30	8	X		X	NA	A13/A300
GV-7	Gravity Vent	30	30	8	X		X	NA	A13/A300
GV-8	Gravity Vent	30	30	8	X		X	NA	A13/A300
GV-9	Gravity Vent	30	30	8	X		X	NA	A13/A300
GV-10	Gravity Vent	30	30	8	X		X	NA	A13/A300
GV-11	Gravity Vent	30	30	8	X		X	NA	A13/A300
GV-12	Gravity Vent	30	30	8	X		X	NA	A13/A300
GV-13	Gravity Vent	30	30	8	X		X	NA	A13/A300
GV-14	Gravity Vent	30	30	8	X		X	NA	A13/A300
GV-15	Gravity Vent	30	30	8	X		X	NA	A13/A300
GV-16	Gravity Vent	30	30	8	X		X	NA	A13/A300
GV-17	Gravity Vent	30	30	8	X		X	NA	A13/A300
EF-1	Exhaust Fan	18	18	8			X	19	H13/A300
EF-2	Exhaust Fan	18	18	10			X	19	H13/A300
EF-3	Exhaust Fan	18	18	8			X	19	H13/A300
EF-4	Exhaust Fan	18	18	8			X	19	H13/A300
EF-5	Exhaust Fan	18	18	8			X	19	H13/A300
EF-6	Exhaust Fan	14	14	8			X	19	H13/A300
EF-7	Exhaust Fan	24	24	8			X	19	H13/A300
EF-8	Exhaust Fan	30	30	6			X	19	H13/A300
EF-9	Exhaust Fan	30	30	4			X	19	H13/A300
C-1	Roof Curb	28	28	8			X	NA	A13/A300
C-2	Roof Curb	28	28	8			X	NA	A13/A300
C-3	Roof Curb	28	28	8			X	NA	A13/A300
C-4	Roof Curb	14	46	8			X	NA	A13/A300
C-5	Roof Curb	14	42	8			X	NA	A13/A300
KVA-1	Kitchen Make-up Air	32	81	8			X	19	H13/A300
KEH-1	Kitchen Exhaust Hood	41	50	7			X	19	H13/A300
ER-1	Equipment Rail	34	48	NA		X		NA	A7/100
SAT-1	Satellite	36	72	NA		X		NA	A7/100
PP-1	Pitch Pocket	8	8	8			X	NA	E18/A300
CU-1	Condenser Unit	25	25	10			X	19	N18/A300

NOTE: ALL CURB SIZES ARE TO BE FIELD VERIFIED

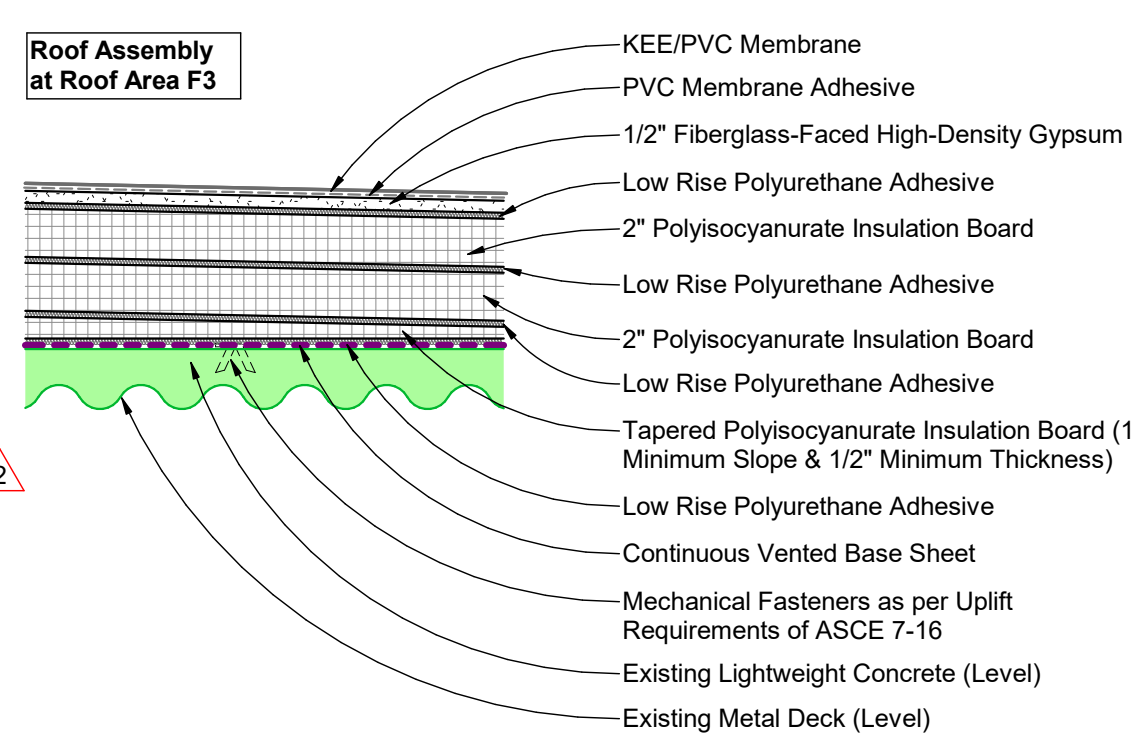
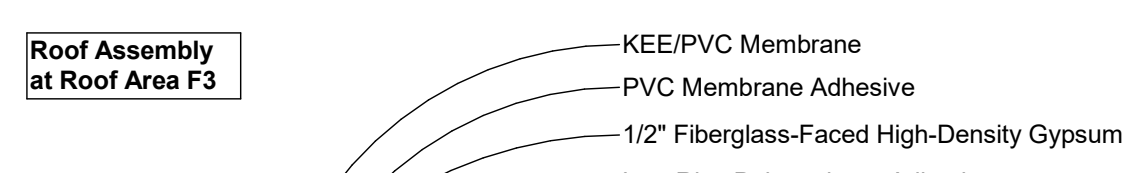
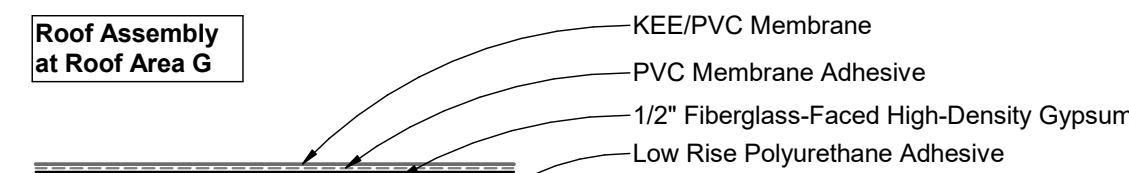
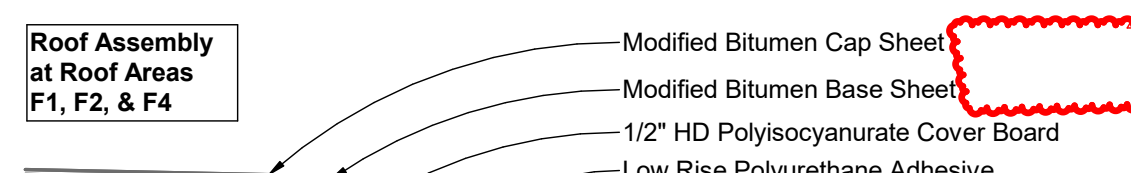

A7 Typical Roof Assemblies
A100 1:12" = 1'-0"

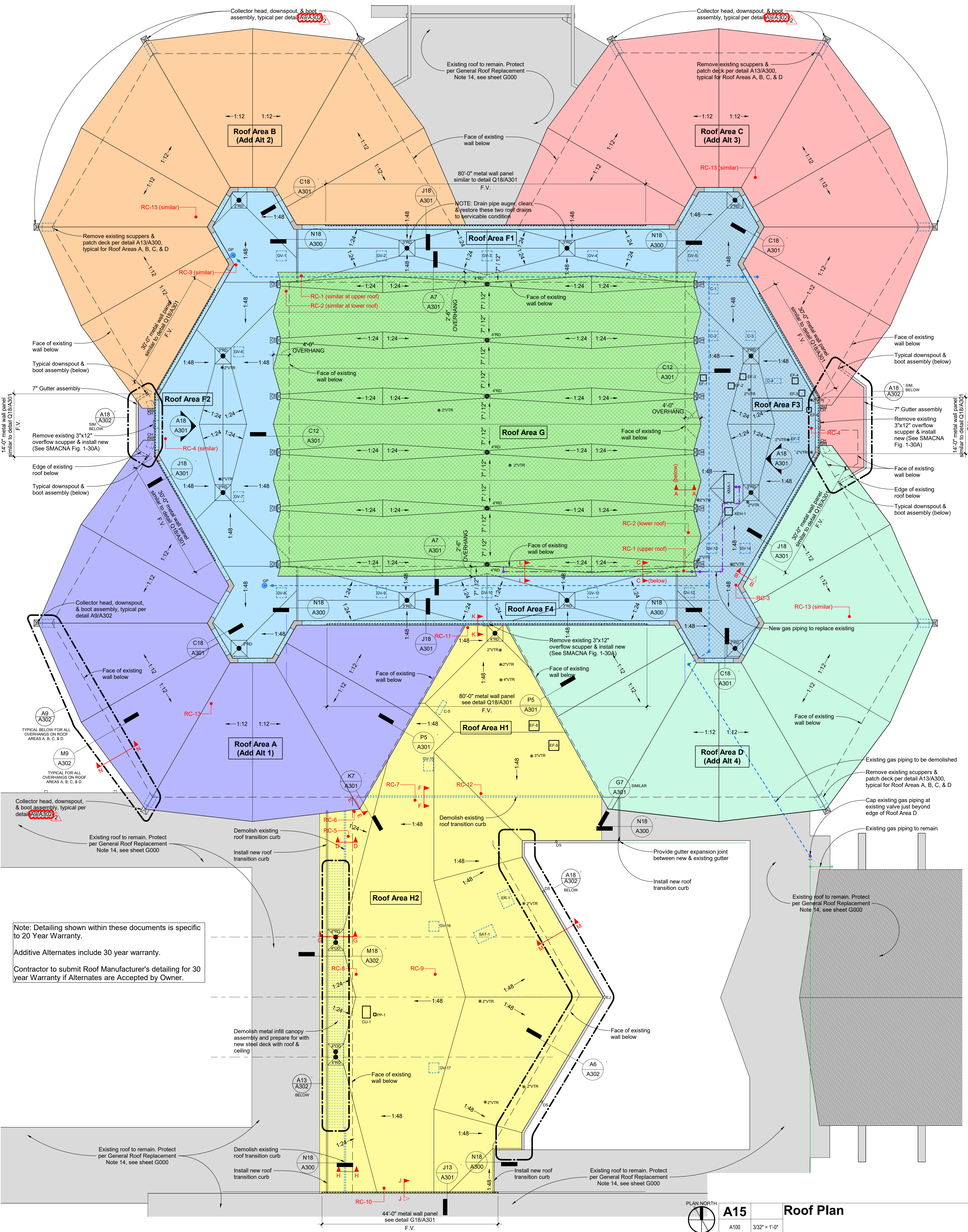

Note: Detailing shown within these documents is specific to 20 Year Warranty.
Additive Alternates include 30 year warranty.
Contractor to submit Roof Manufacturer's detailing for 30 year Warranty if Alternates are Accepted by Owner.



ALL DRAWINGS AND WRITTEN MATERIAL CONSTITUTE ORIGINAL WORK OF THE ARCHITECT AND MAY NOT BE REPRODUCED, COPIED, OR DISCLOSED WITHOUT CONSENT OF THE ARCHITECT. © 2022 DH&W ARCHITECTS. ALL RIGHTS RESERVED. NOTE: THESE DRAWINGS ARE PRODUCED IN COLOR AND ARE TO BE USED IN COLOR.

BID ISSUE

Title: **Roof Plan**

Scale:
Sheet No. **A100**