

**ADDENDUM NO. 1  
INVITATION FOR BID  
RATON FILTER PLANT IMPROVEMENTS**

**Date:** September 18, 2018

**Contracting Agency:** Raton Water Works  
224 Savage Avenue  
Raton, New Mexico 87740  
(575) 445-3861

**Issued By:** Karen Stearns, P.E.

Solicitors are instructed to incorporate the following clarifications/revisions into their bid for the above referenced Invitation for Bid. Answers to bidder questions are denoted below by **Q** and **A**.

<b>No.</b>	<b>Bid Document</b>	<b>Page</b>	<b>Section</b>	<b>Clarification / Revision</b>
1	Advertisement for Bid	1	EJCDC C-111	Replace the first sentence with: Sealed Bids for the construction of the Raton Filter Plant Improvements will be received by Raton Water Works, at the office of the General Manager, until 3:00 pm local time on <b>October 2, 2018</b> , at which time the Bids received will be publicly opened and read.
2	Drawings	P1-04	N/A	See Revision "A" dated 9/11/18.
3	Drawings	S4-02, P1-04, P1-05	Containment Curb Detail	The height of the containment curbs varies per location (see P1-04 and P1-05). The width of the containment curbs is all 6" wide. See attached revised detail for containment curb.
4	Historic Drawings	N/A	N/A	<p><b>Q:</b> Are record drawings of the facility available?</p> <p><b>A:</b> Yes, the following historic drawing sets are available for download on the Q&amp;A Link for QuestCDN.com Project No. 5612928:</p> <ul style="list-style-type: none"> <li>• 2003 Molzen-Corbin Drawings (Partial Set)</li> <li>• 1995 Molzen-Corbin Drawings</li> <li>• 1985 Leedshill-Herkenhoff Drawings</li> <li>• 1948 Crocker &amp; Ryan Drawings</li> </ul>

<b>No.</b>	<b>Bid Document</b>	<b>Page</b>	<b>Section</b>	<b>Clarification / Revision</b>
5	Instruction to Bidders	3	Section 4.03	<p><b>Q:</b> Can prospective bidders schedule to visit the site?</p> <p><b>A:</b> Yes. Please contact Raton Water Works at (575) 445-3861 to schedule a visit so that the facility can be made fully accessible. Please refer to Section 4.03 of the Instruction to Bidders.</p>
6	Specifications	7	Section 08100 Door and Window Schedule	<p><b>Q:</b> Is it possible to get a room finish and door schedules? We need to know exactly the rooms that need to be refinished? Do the entire walls, ceilings and floors get coated? What are the substrates and what are the current conditions. Ceiling heights are also needed. The actual number and dimensions of the doors and frames.</p> <p><b>A:</b> See 1995 Molzen-Corbin Drawings for existing finishes, coatings, and dimensions. The door and window schedule is in the Technical Specifications p. 08100-7. Also, please refer to Spec. Section 09900 Protective Coatings and the Drawings.</p>
7	Specifications	9	Section 09900	<p><b>Q:</b> Rooms where there are containment curbs, does the entire floor get coated?</p> <p><b>A:</b> No. Only the new containment curb and floor within the secondary containment area shall be coated. See Spec. Section 09900, Protective Coatings.</p>
8	Specifications	N/A	Section 09900	<p><b>Q:</b> Concrete coatings in water containing structures, i.e., flocculation basin and flow splitter box?</p> <p><b>A:</b> No, existing and proposed water containing structures are not being coated.</p>
9	Specifications	N/A	Section 09900	<p><b>Q:</b> Concrete coatings in manholes?</p> <p><b>A:</b> No</p>
10	Specifications	5	Section 09900	<p><b>Q:</b> In the valve vault, does the pipe get coated?</p> <p><b>A:</b> Yes, refer to Spec. Section 09900, Protective Coatings.</p>
11	Specifications	4	Section 01270 Add. Alt. No. A	<p><b>Q:</b> Bid Form: Alternate A – Painting of the main building exterior. Are there exterior elevation drawings? What is the current condition of the walls and what are the walls made of?</p> <p><b>A:</b> See 1995 Molzen-Corbin Drawings for existing finishes, coatings, and dimensions.</p>

<b>No.</b>	<b>Bid Document</b>	<b>Page</b>	<b>Section</b>	<b>Clarification / Revision</b>
12	Drawings	I0-05	Keyed Note 5	<p><b>Q:</b> Is the cabinet in the Control Room staying in the same spot or being relocated?</p> <p><b>A:</b> See Sheet I0-05, Keyed Note 5: "Existing control cabinet to be dismantled and converted to new PLC cabinet".</p>
13	N/A	N/A	N/A	<p><b>Q:</b> Is there any work being performed upstairs (2nd level)?</p> <p><b>A:</b> No, there is no proposed work on the 2nd level. All the interior building work is on the main/ground and basement levels. The 2nd level is much smaller than the main/ground level, so the contractor needs to exercise caution to vent to the roof above the main/ground level.</p>
14	Drawings	I0-15	N/A	<p><b>Q:</b> On Sheet I0-15, where is the valve and meter located? (FCV-110 and FE-110)</p> <p><b>A:</b> These components are located in the basement, but are shown on this sheet because they tie into the PLC cabinet on the main level.</p>
15	Drawings	G0-06, PI-05	Pipe Gallery	<p><b>Q:</b> Do all concrete pedestals and tanks get removed from the pipe gallery?</p> <p><b>A:</b> Yes. See Sheets G0-06 and PI-05 for removal of existing concrete pedestals and hydropneumatic tanks.</p>
16	Drawings	P1-05	Coagulant Tanks	<p><b>Q:</b> Do the three existing coagulant tanks get removed?</p> <p><b>A:</b> Yes, see Sheet P1-05 keyed notes 1, 2, and 3.</p>
17	N/A	N/A	N/A	<p><b>Q:</b> Where do the coagulant transfer pumps tie into the electrical system?</p> <p><b>A:</b> The coagulant pumps are powered from the chemical lighting panel "B", circuits 13 &amp; 15. These circuits will become available after other work has been completed. Signal wiring goes into the main PLC panel.</p>
18	N/A	N/A	N/A	<p><b>Q:</b> Is the floor between the basement and main level concrete?</p> <p><b>A:</b> Yes.</p>
19	Drawings	I0-04	N/A	<p><b>Q:</b> On Sheet I0-04, where are valves PV-523 and PV-533? Are they to be replaced or are they new?</p> <p><b>A:</b> PV-523 and PV533 are new valves (with limit switches), to be installed inside the collection basin.</p>

No.	Bid Document	Page	Section	Clarification / Revision
20	N/A	N/A	N/A	<p><b>Q:</b> Do all VFD's get tied into local panels only or do they connect to the PLC cabinet?</p> <p><b>A:</b> All VFD's connect to the PLC cabinet.</p>
21	Drawings	C4-03	Water Reclaim. Basin Overflow Pipe	<p><b>Q:</b> Do you want to re-use the existing concrete headwall in the canyon?</p> <p><b>A:</b> Yes, the existing concrete headwall and attached pipe is in good condition and can be salvaged and re-used. See Sheet C4-03.</p>
22	Drawings	I0-15	PLC Cabinet	<p><b>Q:</b> Is the existing PLC cabinet being replaced or is a new one being installed?</p> <p><b>A:</b> The existing PLC cabinet will remain. The PLC cards are to be replaced as specified and an Ethernet card added to provide communications between the existing PLC cabinet and the new PLC cabinet. An OIC will be added to this cabinet to give the operators the ability to perform backwash operations from the filter room. The PLC itself will be housed in the new PLC cabinet in the control room.</p>
23	N/A	N/A	N/A	<p><b>Q:</b> Are contractors allowed to choose their own integrator, or does one need to be selected with certain experience criteria?</p> <p><b>A:</b> Contractors can select their own integrator. RWW would prefer to use AB RSLogix software so the integrator would need to be competent programming in that software. Proprietary software will not be accepted.</p>
24	N/A	N/A	N/A	<p><b>Q:</b> Will Owner remove existing furnishings and "stuff" in the Chlorine Dioxide Room prior to construction?</p> <p><b>A:</b> Yes, the Owner will continue to remove the small contents and furnishings (i.e., bench) from the Chlorine Dioxide Room prior to construction start.</p>
25	Drawings	S3-02	Detail B	<p><b>Q:</b> What type of structure is the exterior platform extension near the Chlorine and Chlorine Dioxide Rooms? Concrete or other?</p> <p><b>A:</b> The new platform extension shall be galvanized steel. See Sheet S3-02.</p>

No.	Bid Document	Page	Section	Clarification / Revision
26	Project Manual	N/A	Tube Settlers	<p><b>Q:</b> Are the existing tube settler supports being reused? If so, provide the layout of the existing supports.</p> <p><b>A:</b> Assume the supports require replacement. Refer to Drawings W-12 and W-12B in 2003 Molzen-Corbin Plan Set.</p>
27	Project Manual	N/A	Tube Settlers	<p><b>Q:</b> I do not see any drawing showing elevations to determine if there is enough space or not for tubes with vertical height greater than 21". Is there any way to obtain this info?</p> <p><b>A:</b> Refer to Drawing W-12 (2003 Molzen-Corbin). The tube settler vertical height shall be a minimum of 21 inches and maximum of 24 inches.</p>
28	Specifications	5	Section 01110 Summary of Work	<p><b>Q:</b> No mention of NSF requirements for this project. Unless I am mistaken NSF-61 certification is a requirement for drinking water components in the state of New Mexico.</p> <p><b>A:</b> Per Section 01110 Summer of Work, Page 5, 1.13, D The water system components shall comply with NSF / ANSI 61 ("Drinking Water System Components - Health Effects").</p>
29	Project Manual	N/A	Effluent Troughs	<p><b>Q:</b> Regarding the Effluent Troughs, the Tube Settler section does not have any reference to them. I don't see a separate section for them either.</p> <p><b>A:</b> The effluent troughs shall match the existing troughs shown on Drawing W-12 (2003 Molzen-Corbin).</p>
30	Project Manual	N/A	Effluent Troughs	<p><b>Q:</b> The only pertinent drawing I see is P1-01 which states "Existing tube settlers and troughs to remain". I cannot find any details on the size/shape of the existing troughs. No reference is made to the material type for the troughs. Are there v-notch weirs or orifices? How are the troughs to be supported? How does the open end of the trough tie into the effluent wall? Face-mount or grout in-place water stop flange?</p> <p><b>A:</b> Match the Drawings W-12 and W-12B (2003 Molzen-Corbin). The troughs, support structures, and appurtenances shall be stainless steel.</p>

No.	Bid Document	Page	Section	Clarification / Revision
31	Specifications	4	Section 01270 Add. Alt. No. A	<p><b>Q:</b> Alternate Bid Item "A" calls for painting the exterior of the building. Please provide full building plans so we can determine the required square footage of paint.</p> <p><b>A:</b> All historic plan sets are on the Q&amp;A Link for QuestCDN.com Project No. 5612928.</p>
32	Drawings	C1-03	Hot Mix Asphalt Patch	<p><b>Q:</b> Alternate Bid Item "D" calls for patching deteriorated asphalt surfaces. Please provide the square yardage of asphalt to be patched.</p> <p><b>A:</b> The asphalt patch is approx. 25 SY.</p>
33	Drawings	C4-03	Water Reclaim. Basin Overflow Pipe	<p><b>Q:</b> Sheet C4-03 calls for fixing the erosion at the overflow line. Please provide existing and proposed contours so that we can calculate the amount of fill that will be needed.</p> <p><b>A:</b> The survey AutoCAD file can be downloaded from the Q&amp;A Link for QuestCDN.com Project No. 5612928.</p>
34	Drawings	C1-02	Water Reclaim. Basin Overflow Pipe	<p><b>Q:</b> The erosion gorge was basically a 20' deep trench without any shoring for the trench walls. Workers and equipment cannot safely work in the area as it is today. It would be an OSHA violation to put people and equipment in there. Please describe how you envision this work being done.</p> <p><b>A:</b> Contractor is allowed to remove loose material, clear vegetation along the gorge as needed, and cut back any unsafe slopes (e.g., widening the gorge) in order to access the work area. Alternative access paths could also be considered from the south side of the gorge. The Contractor is allowed to propose alternative means for a stable slope and can utilize their own means and methods to achieve final construction.</p>
35	N/A	N/A	N/A	<p><b>Q:</b> Please provide the quantity of sludge that needs to be removed from the Settling Basins.</p> <p><b>A:</b> The Settling Basins will be cleaned and emptied by the Owner prior to construction starting on them. However, at least one basin will need to remain in operation during construction and Contractor will need to coordinate with Owner for basin cleaning.</p>

No.	Bid Document	Page	Section	Clarification / Revision
36	N/A	N/A	N/A	<p><b>Q:</b> Where can the sludge be taken after it is removed?</p> <p><b>A:</b> The Owner will remove and dispose of sludge prior to construction. Additional sludge removal or cleaning shall be coordinated with the Owner by the Contractor.</p>
37	Drawings	S3-02	Detail C	<p><b>Q:</b> Detail C on Sheet S3-02 shows the loading dock extension. The anchor rods extend to the back side of the existing concrete wall. Is this back side accessible? Are we to access the back side of the wall through the manholes in the loading dock slab?</p> <p><b>A:</b> The back side is accessible from the lower level.</p>
38	Drawings	S3-02	Detail B	<p><b>Q:</b> Detail B on Sheet S3-02 calls for FRP composite strengthening of the loading dock slab/wall. Please provide the extents of the area to be strengthened. How will the manholes and the angle iron nosing in the slab affect the strengthening?</p> <p><b>A:</b> The FRP strengthening is required where the existing wall is removed for the new door opening. The FRP must extend a minimum of 5 feet into the room. This is on the main building slab and not on the loading dock where the manholes and angle iron nosing exist so they will not affect the strengthening.</p>
39	Qualifications Statement	8	EJCDC C-451	<p><b>Q:</b> Qualifications Statement #4 of Required Attachments is looking for an audited balance sheet for each of the last 3 years. Is inserting the financial records sufficient or do you have an example that we can follow?</p> <p><b>A:</b> You can provide the financial records for the prime contractor in a standard accounting report with a statement from a CPA regarding the records, if available.</p>
40	Project Manual	WRD-1	Wage Rate Decision	<p><b>Q:</b> Are union bids required?</p> <p><b>A:</b> No, union bids are not required. Bids only need to meet the Prevailing Wage Rates required by the New Mexico Division of Workforce Solutions.</p>

No.	Bid Document	Page	Section	Clarification / Revision
41	Specifications	4	11290 Gates, Part 2, Section 2.2	<p><b>Q:</b> Can Fontaine-Aquanox be considered as an “or equal” gate supplier in Section 11290 (Section 2.2 A-C)?</p> <p><b>A:</b> Section 11290 Gates, Page 4, Part 2, Section 2.2 Acceptable Manufacturers, A, B, and C Add</p> <p>4. Fontaine Aquanox</p> <p>5. No Substitutions</p>
42	Agreement Between Owner and Contractor	1	Contract Times	<p><b>Q:</b> Would Raton Water Works consider extending the completion period for this project by 90-120 days so that construction does not start in the winter?</p> <p><b>A:</b> Raton Water Works would allow extending the substantial completion deadline to 12/31/2019.</p>
43	Drawings	S1-04	Spec Section 08100	<p><b>Q:</b> Sheet S1-04 calls for doors to be removed and replaced with CMU and a viewing window. Please provide details of the viewing window.</p> <p><b>A:</b> Spec Section 08100 includes specs and a window schedule for the viewing windows. Also, see P1-04 Equipment Note 6.</p>
44	Specification	N/A	09260	<p><b>Q:</b> Specification 09260 is for Gypsum Board Assemblies. I don’t see any Gypsum Board called out on the drawings. Please provide details of the Gypsum Board Assemblies.</p> <p><b>A:</b> The current plans do not require gypsum board.</p>
45	Drawing	C1-02	Crane/winch at the Backwash Water Recovery Open Basin	<p><b>Q:</b> Sheet C1-02 calls for the Pump Winch to be relocated to the side of the basin. Please provide details for the steel bracket that is required.</p> <p><b>A:</b> Delete from scope the removal of concrete pedestal, installation of vertical-mount bracket and re-mounting of existing crane. Rather, protect existing concrete pedestal and crane in place and sawcut existing concrete sidewalk around concrete pedestal for sidewalk removal.</p>
46	Drawing	S1-03	N/A	<p><b>Q:</b> Sheet S1-03 calls for insulated checkered plate. The details given for the checkered plate (S4-01) do not provide any kind of insulation details. Please clarify.</p> <p><b>A:</b> See Note 7 on checkered plate detail on S4-01</p>



No.	Bid Document	Page	Section	Clarification / Revision
47	Drawing	P3-02	N/A	<p><b>Q:</b> Are concrete pads required under new blowers, or any other equipment or tanks? If so, please provide details.</p> <p><b>A:</b> Please see P3-02: Equipment pads are not required for the blowers. Equipment pads are required for the coagulant tanks (see attached drawing).</p>
48	Specifications	Static Mixers	11302	Add Westfall as an approved static mixer supplier.
49	Specifications	1	16750	On page 1 of Section 16750, add to section 2.1 Manufacturers – Add the following: “5. Robbins Lightning, Inc.”
50	Bid Form	3	Lump Sum Bid Items	Add Base Bid Lump Sum Work Item No. 2A for Extension of Overflow Lines
51	Specifications	1	01270	<p>Delete from 1.2.B.1: “, and replacement of the 24” outlet pipe and slope repair at the water reclamation basin”.</p> <p>Add following Subsection to 1.2 after 1.2.B:</p> <p>“B1. Section No. 2A – Extension of Overflow Lines</p> <ol style="list-style-type: none"> <li>1. This bid item consists of all Work related to extension of the two (2) 24” overflow pipes and slope repair at the water reclamation basin, including but not limited to clearing and grubbing; temporary/ construction slope stabilization; earthwork; installation of pipe, fittings, manhole, concrete collars, headwall and wingwalls, riprap; backfill and compaction; and seeding.</li> <li>2. Payment will be made on a lump sum basis.”</li> </ol>

Attachments: Drawing P1-04 Rev. “A” dated 9/11/18  
Equipment Pad Detail  
Containment Curb Detail  
Revised Bid Form dated 9/18/18

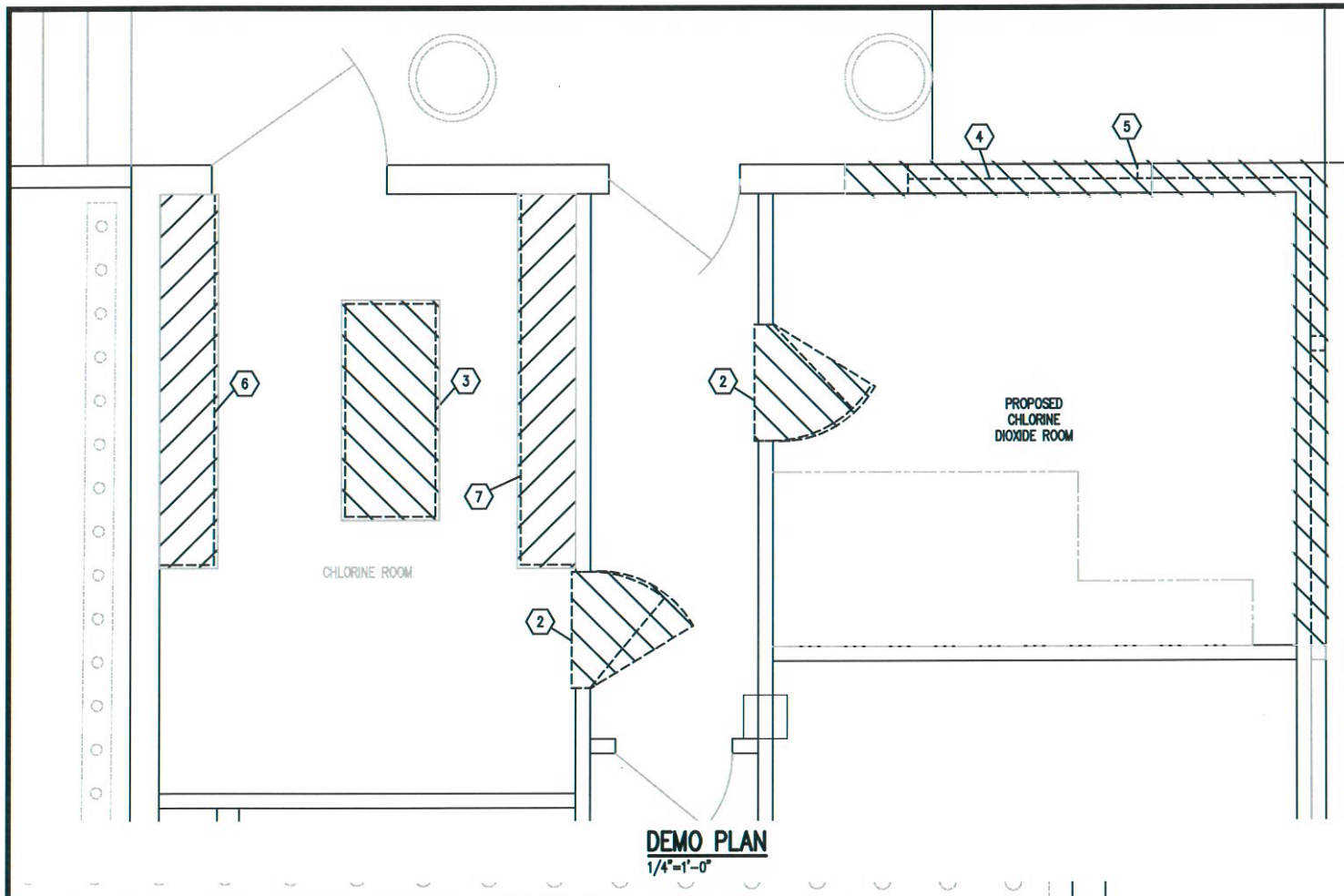

**DEMO PLAN**  
1/4"=1'-0"

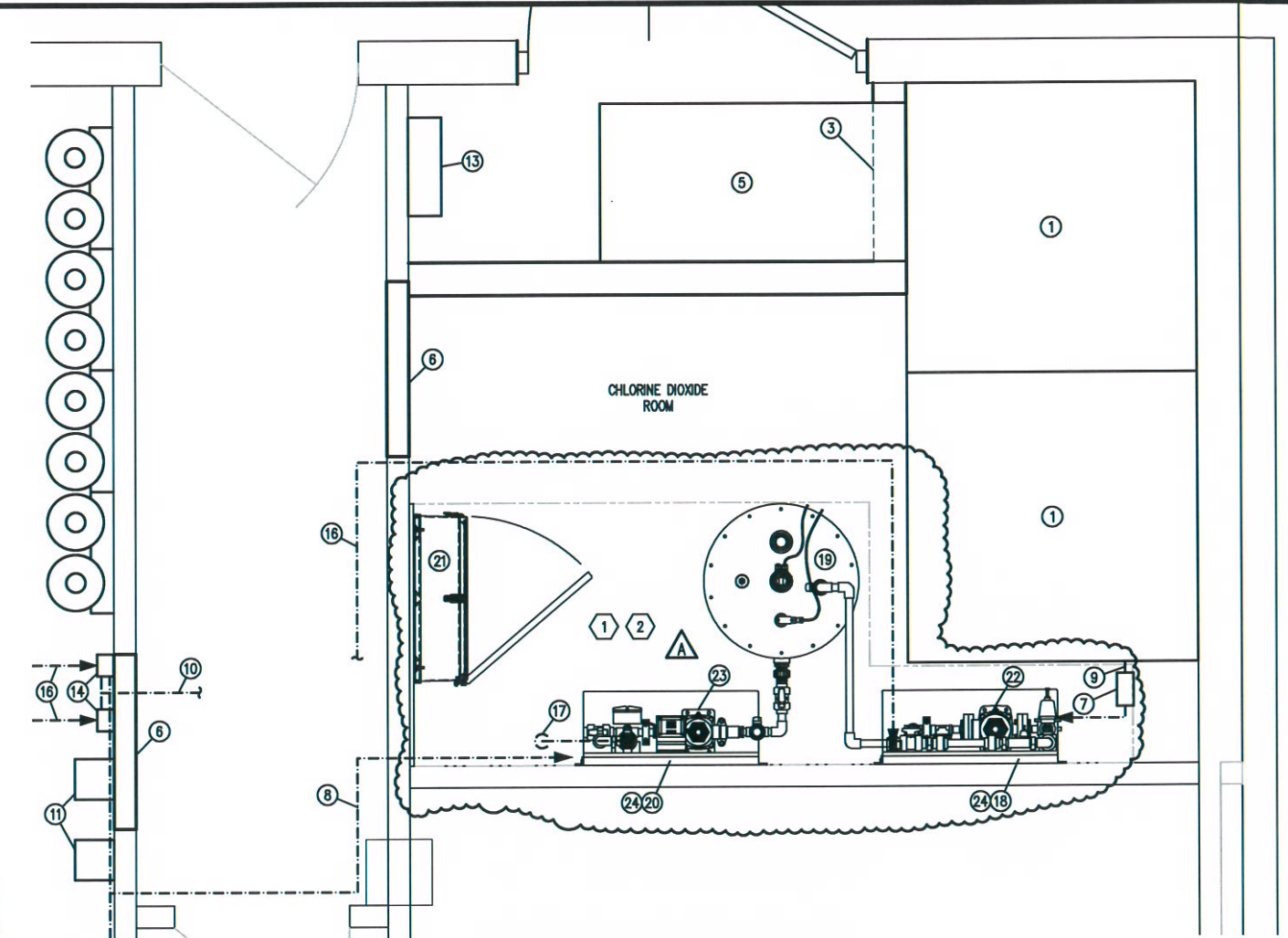

**CHLORINE DIOXIDE SYSTEM PLAN**  
3/8"=1'-0"

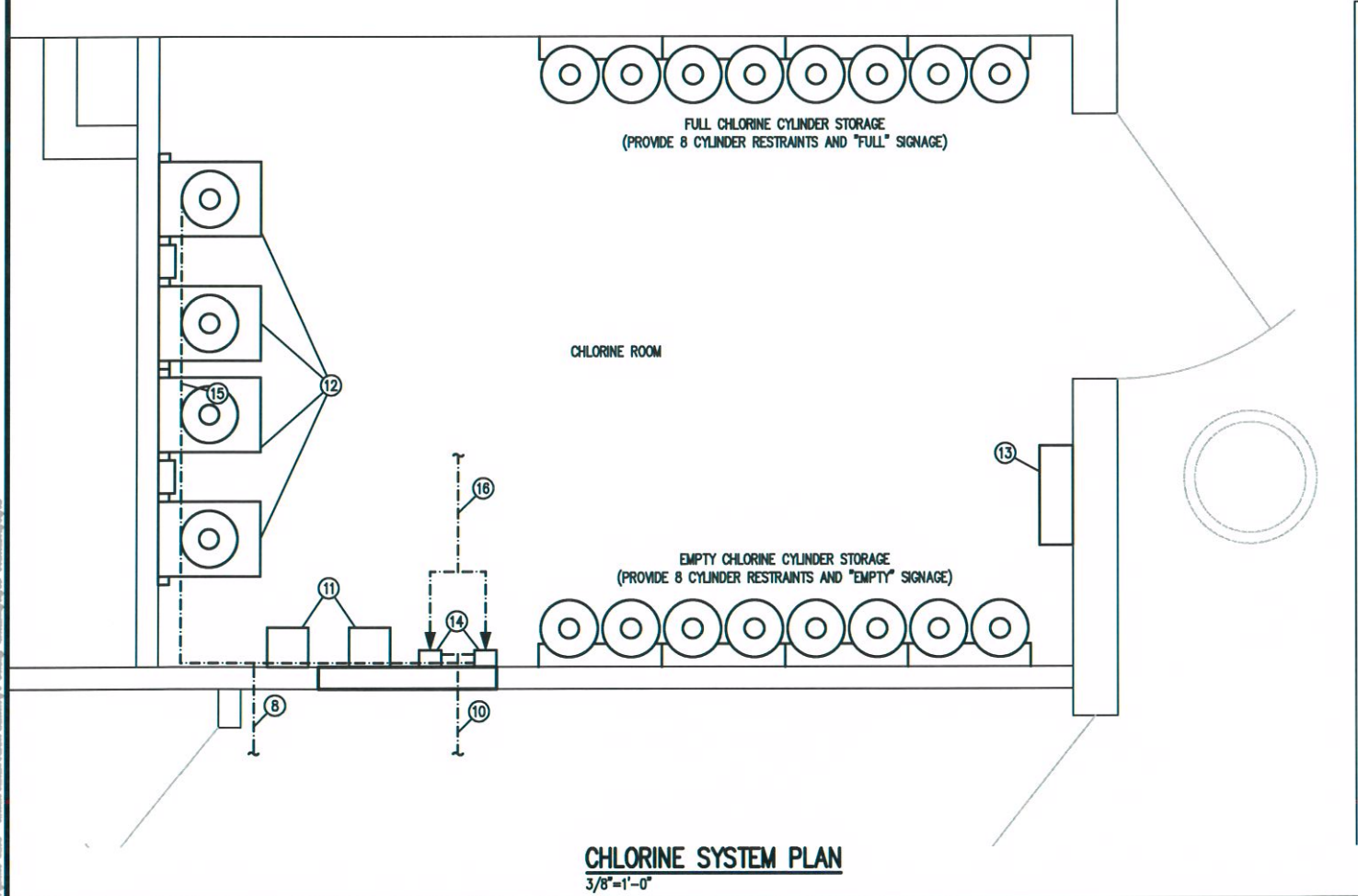

**CHLORINE SYSTEM PLAN**  
3/8"=1'-0"

**DEMOLITION KEY NOTES:**

- ① NOT USED
- ② REMOVE DOOR AND FRAME, RE: STRUCTURAL
- ③ DEMO CHLORINATORS
- ④ DEMO WINDOWS FOR NEW DOOR, RE: STRUCTURAL
- ⑤ DEMO WINDOWS, RE: STRUCTURAL
- ⑥ DEMO CHLORINE CYLINDER RESTRAINTS & SCALE
- ⑦ DEMO CHLORINE CYLINDER RESTRAINTS

**EQUIPMENT NOTES:**

- ① ULTRATECH ULTRA-SPILL PALLET P4 OR EQUAL
- ② NOT USED
- ③ 6" WIDE x 6" HIGH CONTAINMENT CURB
- ④ NOT USED
- ⑤ ULTRATECH ULTRA-SPILL PALLET MOVEABLE RAMP OR EQUAL
- ⑥ REPLACE DOOR W/ CMU AND SHATTER-RESISTANT VIEWING WINDOW CENTERED AT A HEIGHT OF 5' AND 24" SQUARE
- ⑦ SODIUM CHLORITE FILTER (GRANGER MODEL 2P802 HOUSING W/ 2P809 STRAINER. NO SUBSTITUTIONS)
- ⑧ CHLORINE GAS SUPPLY TO CHLORINE DIOXIDE GENERATOR, PE TUBING
- ⑨ SODIUM CHLORITE SUPPLY TO CHLORINE DIOXIDE GENERATOR
- ⑩ CHLORINE SOLUTION TO CHLORINE INJECTION POINT
- ⑪ CHLORINATOR
- ⑫ CHLORINE CYLINDER SCALE AND VACUUM REGULATOR
- ⑬ CHLORINE GAS DETECTOR
- ⑭ CHLORINE EJECTOR
- ⑮ CHLORINE GAS TO CHLORINATORS & EJECTORS
- ⑯ NON-POTABLE WATER
- ⑰ CHLORINE DIOXIDE SOLUTION TO INJECTION POINT
- ⑱ CLO2 GENERATOR ASSEMBLY
- ⑲ CLO2 50 GAL FRP BATCH TANK
- ⑳ CLO2 DISTRIBUTION ASSEMBLY
- ㉑ CONTROL PANEL
- ㉒ WATER BOOSTER PUMP
- ㉓ CLO2 OUTPUT PUMP
- ㉔ CWS WALL MOUNT SKID

**CHLORINE DIOXIDE SYSTEM PLAN KEY NOTES:**

- ① ALL CONNECTION TO CHLORINE DIOXIDE GENERATOR SHALL BE MADE WITH NSF 60/61 APPROVED TUBE OR PIPE. COORDINATE WITH MANUFACTURE FOR SELECTION OF MATERIAL.
- ② THE CHLORINE DIOXIDE SKID REFERENCED IN SECTION 11262 SHALL MATCH THE LAYOUT IN THE CONTRACT DRAWINGS.



Revision	Date	Description
A	9/11/2018	Bld Phase Addendum No. 1

Designed by:  
**Engineering Analytics, Inc.**  
 219 S. 2nd Street  
 Phoenix, AZ 85004  
 (602) 442-7152

**RATON WATER WORKS  
 FILTER PLANT**

**CHLORINE SYSTEM &  
 CHLORINE DIOXIDE PLANS**

Drawn by: KPR  
 Designed by: REL  
 Checked by: MAD  
 Scale: As Shown  
 Project No: 140536  
 Date: July 13, 2018



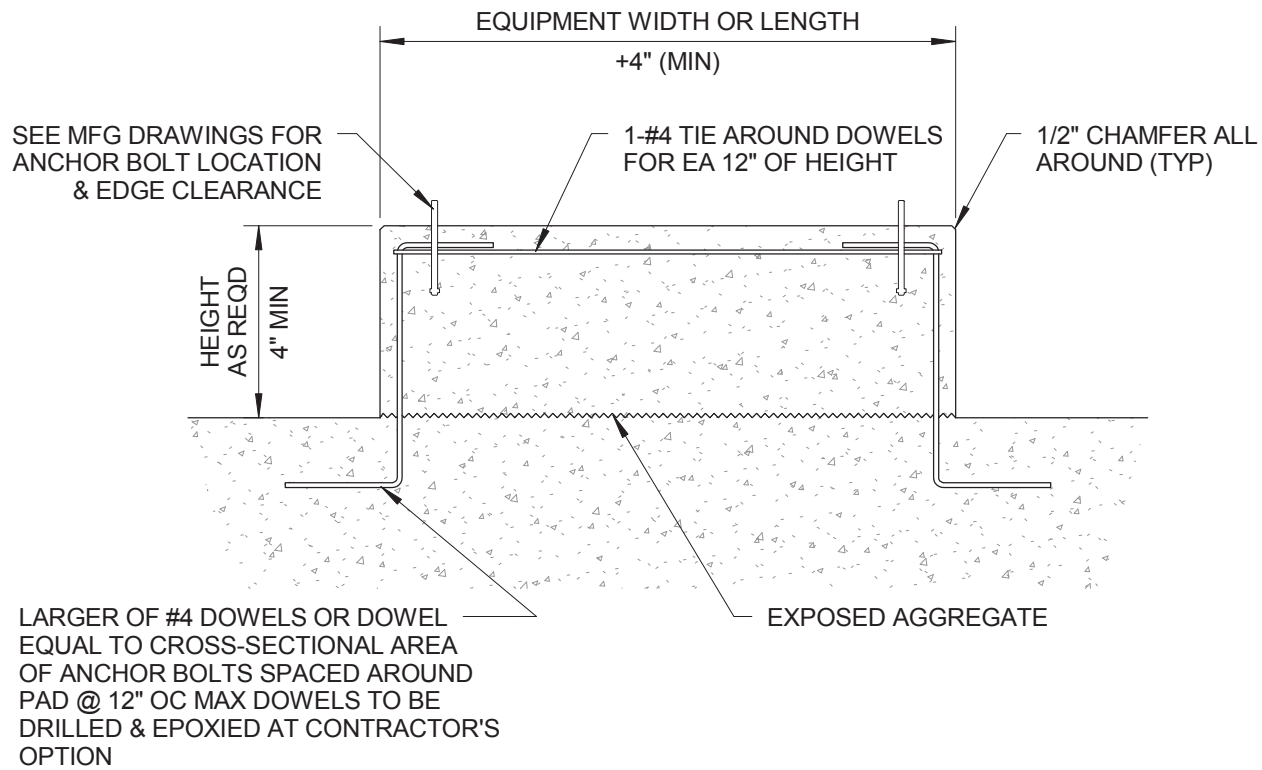

## EQUIPMENT PAD DETAIL

Scale: No Scale

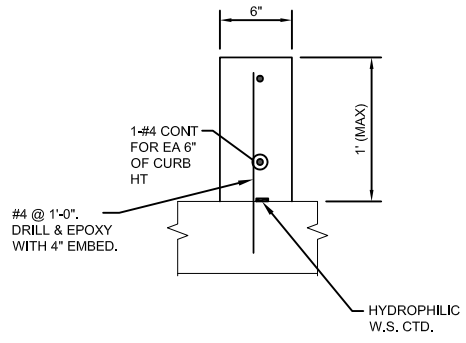

**CONTAINMENT CURB DETAIL**

SCALE: 1/2" = 1'-0"

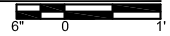

**BID FORM**

**RATON WATER WORKS  
FILTER PLANT IMPROVEMENTS**

**ARTICLE 1 – BID RECIPIENT**

1.01 This Bid is submitted to:

***Raton Water Works  
224 Savage Ave  
P.O. Box 99  
Raton, NM 87740  
Dan Campbell  
Work: (575) 445-3861***

1.02 The undersigned Bidder proposes and agrees, if this Bid is accepted, to enter into an Agreement with Owner in the form included in the Bidding Documents to perform all Work as specified or indicated in the Bidding Documents for the prices and within the times indicated in this Bid and in accordance with the other terms and conditions of the Bidding Documents.

**ARTICLE 2 – BIDDER’S ACKNOWLEDGEMENTS**

2.01 Bidder accepts all of the terms and conditions of the Instructions to Bidders, including without limitation those dealing with the disposition of Bid security. This Bid will remain subject to acceptance for 60 days after the Bid opening, or for such longer period of time that Bidder may agree to in writing upon request of Owner.

**ARTICLE 3 – BIDDER’S REPRESENTATIONS**

3.01 In submitting this Bid, Bidder represents that:

A. Bidder has examined and carefully studied the Bidding Documents, and any data and reference items identified in the Bidding Documents, and hereby acknowledges receipt of the following Addenda:

<u>Addendum No.</u>	<u>Addendum, Date</u>
_____	_____
_____	_____
_____	_____
_____	_____

B. Bidder has visited the Site, conducted a thorough, alert visual examination of the Site and adjacent areas, and become familiar with and satisfied itself as to the general, local, and Site conditions that may affect cost, progress, and performance of the Work.

C. Bidder is familiar with and has satisfied itself as to all Laws and Regulations that may affect cost, progress, and performance of the Work.

D. Bidder has carefully studied all: (1) reports of explorations and tests of subsurface conditions at or adjacent to the Site and all drawings of physical conditions relating to

existing surface or subsurface structures at the Site that have been identified in the Supplementary Conditions, especially with respect to Technical Data in such reports and drawings, and (2) reports and drawings relating to Hazardous Environmental Conditions, if any, at or adjacent to the Site that have been identified in the Supplementary Conditions, especially with respect to Technical Data in such reports and drawings.

- E. Bidder has considered the information known to Bidder itself; information commonly known to contractors doing business in the locality of the Site; information and observations obtained from visits to the Site; the Bidding Documents; and any Site-related reports and drawings identified in the Bidding Documents, with respect to the effect of such information, observations, and documents on (1) the cost, progress, and performance of the Work; (2) the means, methods, techniques, sequences, and procedures of construction to be employed by Bidder; and (3) Bidder's safety precautions and programs.
- F. Bidder agrees, based on the information and observations referred to in the preceding paragraph, that no further examinations, investigations, explorations, tests, studies, or data are necessary for the determination of this Bid for performance of the Work at the price bid and within the times required, and in accordance with the other terms and conditions of the Bidding Documents.
- G. Bidder is aware of the general nature of work to be performed by Owner and others at the Site that relates to the Work as indicated in the Bidding Documents.
- H. Bidder has given Engineer written notice of all conflicts, errors, ambiguities, or discrepancies that Bidder has discovered in the Bidding Documents, and confirms that the written resolution thereof by Engineer is acceptable to Bidder.
- I. The Bidding Documents are generally sufficient to indicate and convey understanding of all terms and conditions for the performance and furnishing of the Work.
- J. The submission of this Bid constitutes an incontrovertible representation by Bidder that Bidder has complied with every requirement of this Article, and that without exception the Bid and all prices in the Bid are premised upon performing and furnishing the Work required by the Bidding Documents.

#### **ARTICLE 4 – BIDDER'S CERTIFICATION**

4.01 Bidder certifies that:

- A. This Bid is genuine and not made in the interest of or on behalf of any undisclosed individual or entity and is not submitted in conformity with any collusive agreement or rules of any group, association, organization, or corporation;
- B. Bidder has not directly or indirectly induced or solicited any other Bidder to submit a false or sham Bid;
- C. Bidder has not solicited or induced any individual or entity to refrain from bidding; and
- D. Bidder has not engaged in corrupt, fraudulent, collusive, or coercive practices in competing for the Contract. For the purposes of this Paragraph 4.01.D:
  - 1. "corrupt practice" means the offering, giving, receiving, or soliciting of anything of value likely to influence the action of a public official in the bidding process;
  - 2. "fraudulent practice" means an intentional misrepresentation of facts made (a) to influence the bidding process to the detriment of Owner, (b) to establish bid prices at

artificial non-competitive levels, or (c) to deprive Owner of the benefits of free and open competition;

3. "collusive practice" means a scheme or arrangement between two or more Bidders, with or without the knowledge of Owner, a purpose of which is to establish bid prices at artificial, non-competitive levels; and
4. "coercive practice" means harming or threatening to harm, directly or indirectly, persons or their property to influence their participation in the bidding process or affect the execution of the Contract.

**ARTICLE 5 – BASIS OF BID**

5.01 Bidder will complete the Work in accordance with the Contract Documents for the following price(s):

**LUMP SUM BID ITEMS**

Item No.	Lump Sum Work Item	Lump Sum Bid
<b>BASE BID ITEMS</b>		
1	Bonding, Mobilization, and Insurance	\$
2	Site Work	\$
2A	Extension of Overflow Lines	\$
3	Mix and Flow Split	\$
4	Flocculation Basin	\$
5	Sludge Collection	\$
6	Chlorine Dioxide System	\$
7	Chlorine System	\$
8	Coagulation System	\$
9	Floc Aid Polymer System	\$
10	Solids Drying Polymer System	\$
11	Sodium Hydroxide System	\$
12	House Water System	\$
13	Filter System Air Scour Blowers	\$
14	Flow Meters and Flow Control Valve	\$
15	HVAC Systems	\$
16	Architectural and Structural	\$
17	Electrical / Instrumentation and Controls (EI&C) Systems	\$
	<b>TOTAL OF ALL LUMP SUM BASE BID ITEMS</b>	<b>\$</b>

Item No.	Lump Sum Work Item		Lump Sum Bid
<b>ALTERNATE BID ITEMS</b>			
A	Painting of the Main Building Exterior	Add	\$
B	Backwash Pump VFDs	Add	\$
C	Replacement-in-kind of Existing Tube Settlers and Effluent Troughs	Add	\$
D	Patching Deteriorated Asphalt Surfaces	Add	\$
E	Abandonment of Clearwell Bypass Line	Add	\$
	<b>TOTAL OF ALL LUMP SUM ADD ALTERNATE BID ITEMS</b>		\$
<b>TOTAL BASE BID AND ADD ALTERNATE BID ITEMS</b>			\$

#### **ARTICLE 6 – TIME OF COMPLETION**

- 6.01 Bidder agrees that the Work will be substantially complete and will be completed and ready for final payment in accordance with Paragraph 15.06 of the General Conditions on or before the dates or within the number of calendar days indicated in the Agreement.
- 6.02 Bidder accepts the provisions of the Agreement as to liquidated damages.

#### **ARTICLE 7 – ATTACHMENTS TO THIS BID**

- 7.01 The following documents are submitted with and made a condition of this Bid:
- A. Required Bid security;
  - B. Bidder's List of Subcontractors;
  - C. List of Proposed Suppliers;
  - D. List of Project References;
  - E. Evidence of authority to do business in the state of New Mexico; or a written covenant to obtain such license within the time for acceptance of Bids;
  - F. Contractor's License No.:                      or Evidence of Bidder's ability to obtain a State Contractor's License and a covenant by Bidder to obtain said license within the time for acceptance of Bids;
  - G. Required Bidder Qualification Statement with supporting data;
  - H. If Bid amount exceeds \$10,000, signed Compliance Statement (RD 400-6). Refer to specific equal opportunity requirements set forth in the Supplemental General Conditions;
  - I. If Bid amount exceeds \$25,000, signed Certification Regarding Debarment, Suspension, Ineligibility and Voluntary Exclusion – Lower Tier Covered Transactions (AD-1048);
  - J. If Bid amount exceeds \$100,000, signed RD Instruction 1940-Q, Exhibit A-1, Certification for Contracts, Grants, and Loans;



- K. A completed Campaign Contribution Disclosure Form; and
- L. New Mexico Labor Dept. Labor Enforcement Registration No.: \_\_\_\_\_.

**ARTICLE 8 – DEFINED TERMS**

8.01 The terms used in this Bid with initial capital letters have the meanings stated in the Instructions to Bidders, the General Conditions, and the Supplementary Conditions.

**ARTICLE 9 – BID SUBMITTAL**

BIDDER: *[Indicate correct name of bidding entity]*

\_\_\_\_\_  
By:  
*[Signature]* \_\_\_\_\_

*[Printed name]* \_\_\_\_\_  
*(If Bidder is a corporation, a limited liability company, a partnership, or a joint venture, attach evidence of authority to sign.)*

Attest:  
*[Signature]* \_\_\_\_\_

*[Printed name]* \_\_\_\_\_

Title: \_\_\_\_\_

Submittal Date: \_\_\_\_\_

Address for giving notices:  
\_\_\_\_\_  
\_\_\_\_\_  
\_\_\_\_\_

Telephone Number: \_\_\_\_\_

Fax Number: \_\_\_\_\_

Contact Name and e-mail address: \_\_\_\_\_  
\_\_\_\_\_

Bidder's License No.: \_\_\_\_\_