



05/28/2021

ADDENDUM #02

INTERIOR RENOVATIONS & CLASSROOM ADDITION FOR: LAKE RIDGE ELEMENTARY SCHOOL

1001 Lake Ridge Square | Johnson City, Tennessee 37601

TFM # 09665

TFM Project No. 2021-03-24-03

ITB# 6498

May 28, 2021

This Addendum forms a part of the Contract Documents and modifies the original Procurement Documents dated March 25, 2021 and Addendum 1 dated May 18, 2021. Bidders shall acknowledge receipt of this Addendum in the space provided on the Bid Form. Failure to do so may subject Bidder to disqualification.

This **30** page Addendum is issued *VIA Email* to the Owner, All Known Plan Holders of Record, and All Known Plan Rooms of Record on May 28, 2021.

CHANGES TO PROJECT MANUAL:

1. Insert revised **FE 1700 State Contractors Licensing Information Bid Envelope Form**
2. Refer to **00 1113 Advertisements for Bids**
 - a. The bid date found in the first paragraph should be modified as follows:
"Thursday, June 17, 2021 at 2:00 PM local time"
3. Refer to **00 2113 Instructions to Bidders**
 - a. Modify paragraph 3.2.2 as follows:
"Submit questions in electronic format via email to: katie@thomasweemsarchitect no later than Friday, June 11, 2021 at 12:00 PM local time"
4. Refer to **00 2113.1 Supplementary Instructions to Bidders**
 - a. Modify paragraph 1.6 Questions as follows:
"DATE: Friday, June 11, 2021 at 12:00 PM local time"
5. Insert revised **00 4100 Bid Form**
6. Refer to **01 2100 Allowances**
 - a. Delete paragraph 3.1.E Allowance No. 5 in its entirety.
7. Insert revised **01 2200 Unit Prices**
8. Refer to **07 4110 / 07 4113 / 07 7713, Section 2.1 Manufacturers**
 - a. Add ***Metal Roofing Systems*** as an acceptable manufacturer of a comparable product.

- b. Insert approved Substitution Request.
9. Refer to **10 7301 / 10 7302, Section 2.1 Acceptable Manufacturers**
 - a. Add ***Peachtree Protective Covers, Inc.*** as an acceptable manufacturer of a comparable product.
 - b. Insert approved Substitution Request.

CHANGES TO CONSTRUCTION DRAWINGS:

1. Refer to **A612 Window Details, Detail 6/A612:**
 - a. Revise depth of "Secure Transaction Window Shelf" to a minimum of 14". Shelf to extend out on lobby side of window to allow rated overhead shutter to operate correctly.

GENERAL ITEMS:

1. Insert attached **General Decision Number: TN20210111 01/01/2021**

RESPONSE TO QUESTIONS:

Refer to the following responses to questions received by the Architect:

1. *Sheet A601 shows Window Type 1 – the secure transaction window – shows the window to be a HM frame with tempered glass. However, specifications call for this window and glazing to be bullet resistant. Can you clarify which is correct?*
 - a. **The transaction window itself is a premanufactured unit noted in the specifications. The two side lites on either side to be hollow metal frames with tempered glass and film. Shown on the drawings as unit in the Window Type 1. Refer to the detail 2/A612**

CLARIFICATIONS AND ADDITIONAL INFORMATION:

1. **Refer to Electrical Drawings and Project Manual, Division 27 and Division 28:** Attention is called to the fact that Building Systems Technology (BST) is the owner's preferred vendor for all work specified in Division 27 and Division 28. In order to be consistent with Division 27 and Division 28 installations in other facilities owned by Johnson City Schools, electrical contractors who are bidding Division 27 and Division 28 work shall utilize BST as their subcontractor for all Division 27 and Division 28 work on this project.
2. Davis Bacon requirements will apply for HVAC labor only. Refer to attached "General Decision Number: TN20210111 01/01/2021"

Davis-Bacon and Copeland Anti-Kickback Act Requirements

For all prime construction, alteration or repair contracts in excess of \$2,000 awarded with federal funds, the Contractor shall comply with the Davis-Bacon Act and the Copeland "Anti-Kickback" Act. Under 49 U.S.C. § 5333(a), prevailing wage protections apply to laborers and mechanics employed on federally assisted construction, alteration, or repair projects. The Contractor will comply with the Davis-Bacon Act, 40 U.S.C. §§ 3141-3144, and 3146-3148 as supplemented by DOL regulations at 29 C.F.R. part 5, "Labor Standards Provisions Applicable to Contracts Governing Federally Financed and Assisted Construction." In accordance with the statute, the

Contractor shall pay wages to laborers and mechanics at a rate not less than the prevailing wages specified in a wage determination made by the Secretary of Labor. In addition, the Contractor agrees to pay wages not less than once a week. The Contractor shall also comply with the Copeland "Anti-Kickback" Act (40 U.S.C. § 3145), as supplemented by DOL regulations at 29 C.F.R. part 3, "Contractors and Subcontractors on Public Building or Public Work Financed in Whole or in part by Loans or Grants from the United States." The Contractor is prohibited from inducing, by any means, any person employed in the construction, completion, or repair of public work, to give up any part of the compensation to which he or she is otherwise entitled.

ATTACHMENTS:

1. Project Manual (3 sections – 6 pages – 8 ½" x 11")
2. General Decision Number: TN20210111 01/01/2021 (6 pages – 8 ½" x 11")
3. Substitution Requests (3 requests – 15 pages – 8 ½" x 11")

END OF ADDENDUM NO. 2

Cc: Randy Trivette – City of Johnson City
Dennis Rhodes, Plans Examiner 2, TN State Fire Marshal's Office
All Known Plan Holders of Record
All Known Plan Rooms



**STATE CONTRACTORS LICENSING INFORMATION
 BID ENVELOPE FORM**

THIS FORM MUST BE FIRMLY ATTACHED TO THE OUTSIDE OF THE ENVELOPE CONTAINING THE BID. NO BID WILL BE CONSIDERED IF THIS FORM IS INCOMPLETE OR NOT ATTACHED TO THE OUTSIDE OF THE BID ENVELOPE. IF TOTAL BID IS LESS THAN \$25,000- ATTACH AND SPECIFY ON THIS FORM

PART 1

ALL BIDDERS MUST COMPLETE

TO:	City of Johnson City, Tennessee ITB # 6498 – LAKE RIDGE ELEMENTARY SCHOOL ADDITION
DUE DATE & TIME:	JUNE 17, 2021 AT 2:00 LOCAL TIME
LOCATION:	OFFICE OF PURCHASING DIRECTOR, 209 WATER STREET JOHNSON CITY, TN 37601
NAME OF BIDDER:	
ADDRESS OF BIDDER:	
FEDERAL ID # OF BIDDER:	
LICENSE NO.:	#
LICENSE CLASSIFICATION OF BIDDER:	
EXPIRATION DATE:	
MONETARY LIMITS:	

PART 2

BIDDER MUST COMPLETE THIS SECTION IF BELOW IS \$25,000+ OR \$100,000+ MASONRY

(1) ELECTRICAL	(2) PLUMBING	(3) HVAC	(4) GEOTHERMAL	(5) MASONRY
A) Name of licensed Electrical contractor:	A) Name of licensed Plumbing contractor:	A) Name of licensed HVAC contractor:	A) Name of licensed Geothermal contractor:	A) Name of licensed Masonry contractor:
B) License #:	B) License #:	B) License #:	B) License #:	B) License #:
C) License Classification and Limits:	C) License Classification and Limits:	C) License Classification and Limits:	C) License Classification and Limits:	C) License Classification and Limits:
D) License expiration date:	D) License expiration date:	D) License expiration date:	D) License expiration date:	D) License expiration date:

DOCUMENT 00 4100

BID FORM

TO: City of Johnson City Tennessee
Debbie Dillon, Director of Purchasing
209 Water Street
Johnson City, Tennessee 37605
(Mailing Address: 2150, Zip: 37605)

PROJECT: Addition and Alterations to Existing Building
Lake Ridge Elementary School
1001 Lake Ridge Square
Johnson City, Tennessee 37601
ITB# 6489

DESIGNER: Thomas Weems Architect
3203 Hanover Road
Johnson City, Tennessee 37601
Project # 019-030

A. THE BIDDER ACKNOWLEDGES IN SUBMITTING THIS BID THAT:

1. Bidder has received, read, and understands the Bidding Documents, has visited the site and become familiar with local conditions under which work is to be performed, has correlated observations with requirements of Bidding Documents, and makes this bid in accordance therewith.
2. Bidder understands the requirements for maintaining nearby vehicular and pedestrian traffic, and make this bid in accordance therewith, including provisions for maintaining all necessary precautions and safety measures to protect the public from the construction process.
3. The required Bid Security, in the amount of Five Percent (5%) of the total amount bid, is attached hereto.
4. Failure to complete Bid Form, provide required attachments, or comply otherwise with the Instructions to Bidders, may be cause for rejection of bid.
5. This Bidder has received the following addenda:

Addendum No. _____ Dated: _____, 2021
 Addendum No. _____ Dated: _____, 2021
 Addendum No. _____ Dated: _____, 2021
 Addendum No. _____ Dated: _____, 2021
 Addendum No. _____ Dated: _____, 2021

6. The person who signs this bid on behalf of the Bidder is required to be legally empowered to bind the Bidder to a Contract.
7. Bidder has included in the Base Bid all project Contingencies and Allowances as stipulated in the Schedule of Allowances in Section 01 2100 – Allowances, totaling One Million Six Hundred Eighty Three Thousand One Hundred Twenty Nine Dollars (\$1,683,129.00).

B. THIS BIDDER AGREES TO:

1. Honor this bid for a period of sixty [60] days following the date of the scheduled opening of the bids.
2. Enter into and execute a contract, if presented on the basis of this bid, and furnish bond(s) and certificate(s) of insurance as required.
3. Accomplish the Work in accordance with the Contract Documents.
4. Bidder will achieve Substantial Completion of the Work within the following calendar days after a Notice to Proceed is issued:

_____ Days (_____).

5. Accept the Conditions for Liquidated Damages in the amount of Five Hundred Dollars (\$500.00) per calendar day.
6. Davis Bacon Act requirements for HVAC labor.

C. BID AMOUNT:

1. Base Bid Amount: This Bidder agrees to complete the Work of the Base Bid for this project for the lump sum of (show amount in both words and figures):

_____ Dollars: \$ _____

2. Owners Contingency: Specified in Section 01 2100 – Allowance 3.1-A:
Three Hundred Fifty Thousand Dollars and No Cents.

_____ Dollars: \$ 350,000.00

3. Allowances: Specified in Section 01 2100 – Allowances 3.1-B – 3.1-H:
One Million Three Hundred Thirty Three Thousand One Hundred Twenty Nine Dollars and No Cents.

_____ Dollars: \$ 1,333,129.00

4. Unit Prices: The unit prices listed below and described in Section 01 2200 - Unit Prices, will apply throughout the project for changing work upon written instructions of the Architect:

Description	Unit of Measure	Quantity	Amount
Unit Price #1: Acoustical Ceiling Removal and Replacement.	Square Foot	25,000 SF	\$ _____
Unit Price #2: Unsuitable Material Below Specified Subgrade Elevation.	Cubic Yard	100 CY	\$ _____
Unit Price #3: Rock Below Specified Subgrade Elevation.	Cubic Yard	100 CY	\$ _____

4. Total Base Bid: Total of Lines 1, 2, 3 and 4:

_____ Dollars: \$ _____

THIS BID SUBMITTED BY:

Authorized Signature: _____ Date: _____

Type or Print Name & Title: _____

On Behalf Of: (Name of Bidder): _____

Bidders Address: _____

(Mailing Address if Different): _____

Bidders Telephone #: _____

Bidders Contact Email: _____

Required Attachments:

- Bid Form (00 4100) – [3] pages.
- 5% Bid Security.
- General Contract Form (FE 1400) – [4] pages.
- Insurance Checklist (FE 1600) – 1 page.
- Compliance with Public Acts 587 and 844 (02 2425) – 1 page.
- Criminal History Affidavit (02 2426) – 1 page.
- Drug Free Workplace Affidavit (FE 1900) – 1 page.
- Bidder Acknowledgment of Forms (FE 1200) – 1 page.
- Copy of Bidders State Contractor’s License.

Bid Form 00 4100 must be signed by authorized representative of ‘Bidder’ to be considered valid.

END OF DOCUMENT

SECTION 01 2200

UNIT PRICES

PART 1 GENERAL

1.1 RELATED DOCUMENTS

- A. Drawings and general provisions of the Contract, including General and Supplementary Conditions and other Division 01 Specification Sections, apply to this Section.

1.2 SUMMARY

- A. Section Includes: Administrative and procedural requirements for unit prices.
- B. Related Requirements:
 - 1. Section 01 2600 - Contract Modification Procedures for procedures for submitting and handling Change Orders.
 - 2. Section 01 4000 - Quality Requirements for general testing and inspecting requirements.

1.3 DEFINITIONS

- A. Unit price is an amount incorporated in the Agreement, applicable during the duration of the Work as a price per unit of measurement for materials, equipment, or services, or a portion of the Work, added to or deducted from the Contract Sum by appropriate modification, if the scope of Work or estimated quantities of Work required by the Contract Documents are increased or decreased.

1.4 PROCEDURES

- A. Unit prices include all necessary material, plus cost for delivery, installation, insurance, applicable taxes, overhead, and profit.
- B. Measurement and Payment: See individual Specification Sections for work that requires establishment of unit prices. Methods of measurement and payment for unit prices are specified in those Sections.
- C. Owner reserves the right to reject Contractor's measurement of work-in-place that involves use of established unit prices and to have this work measured, at Owner's expense, by an independent surveyor acceptable to Contractor.
- D. List of Unit Prices: A schedule of unit prices is included in Part 3. Specification Sections referenced in the schedule contain requirements for materials described under each unit price.

PART 2 PRODUCTS

Not used.

PART 3 EXECUTION

3.1 SCHEDULE OF UNIT PRICE

- A. Unit Price No. 1 – Acoustical Ceiling Removal and Replacement.
 - 1. Description: Removal and replacement of acoustical ceiling tile and grid, light fixtures, sprinkler heads, diffusers, grilles or other devices not depicted in 'Yellow' on Architectural Ceiling Plans but required to install specified HVAC upgrades. Measurement and payment will be made for quantities actually removed and replaced.
 - a. Allow Twenty Five Thousand [25,000] SF of removal and replacement of acoustical ceiling tile and grid, light fixtures, sprinkler heads, diffusers, grilles or other devices in Base Bid.

- b. Payment for measured and verified quantiles above or below the Twenty Five Thousand [25,000] SF included in the Base Bid will be by Unit Price.
 - 2. Unit of Measure: Square foot of acoustical ceiling removed and replaced.
- B. Unit Price No. 2 – Unsuitable Material **Below Specified Subgrade Elevation.**
 - 1. Description: Excavation and removal of unsuitable material from site with furnishing and placing select backfill including compaction and all other incidental work. Measurement and payment will be made for quantities actually excavated, removed, furnished and placed. Unsuitable soil will be defined by the testing agency as specified in Section 31 2000 - Grading.
 - a. Unsuitable material encountered above specified subgrade is UNCLASSIFIED and part of Base Bid.
 - b. Allow One Hundred [100] CY of removal of unsuitable materials and replacement with select backfill in Base Bid.
 - c. Payment for measured and verified quantiles above or below the One Hundred [100] CY included in the Base Bid will be by Unit Price.
 - 2. Unit of Measure: Cubic yard of engineered fill compacted in place.
- C. Unit Price No. 3 – Rock **Below Specified Subgrade Elevation.**
 - 1. Description: Excavation and removal of rock from site with furnishing and placing select backfill including compaction and all other incidental work. Measurement and payment will be made for quantities actually excavated, removed, furnished and placed. Unsuitable soil will be defined by the testing agency as specified in Section 31 2000 - Grading.
 - a. Rock encountered above specified subgrade is UNCLASSIFIED and part of Base Bid.
 - b. Allow One Hundred [100] CY of removal of rock and replacement with select backfill in Base Bid.
 - c. Payment for measured and verified quantiles above or below the One Hundred [100] CY included in the Base Bid will be by Unit Price.
 - 2. Unit of Measure: Cubic yard of engineered fill compacted in place.

END OF SECTION

* BRTN0005-006 05/01/2020

	Rates	Fringes
BRICKLAYER.....	\$ 29.04	2.65

ENGI0917-020 05/01/2017

	Rates	Fringes
OPERATOR: Power Equipment		
Bulldozer.....	\$ 28.26	10.10
Crane.....	\$ 28.26	10.10
Forklift.....	\$ 25.97	10.10
Grader/Blade.....	\$ 25.97	10.10

* IRON0384-005 05/01/2020

	Rates	Fringes
IRONWORKER, STRUCTURAL AND REINFORCING.....	\$ 28.73	15.36

PLAS0647-001 05/01/2009

	Rates	Fringes
CEMENT MASON/CONCRETE FINISHER...	\$ 28.52	0.40

PLUM0538-005 03/01/2017

	Rates	Fringes
PIPEFITTER		
Plumbing/mechanical combined on a project totals \$1,000,000 and over..	\$ 30.54	11.92
Plumbing/mechanical combined on a project totals less than \$1,000,000.	\$ 25.25	10.61

SUTN2009-110 09/21/2009

	Rates	Fringes
CARPENTER, Including Drywall Hanging.....	\$ 13.81	0.00
ELECTRICIAN.....	\$ 13.50	1.77

LABORER: Common or General.....	\$ 10.63	0.00
LABORER: Mason Tender - Brick...	\$ 12.87	0.00
LABORER: Roof Tearoff.....	\$ 9.75	0.49
OPERATOR: Backhoe/Excavator/Trackhoe.....	\$ 14.64	5.50
OPERATOR: Bobcat/Skid Steer/Skid Loader.....	\$ 17.05	0.00
OPERATOR: Mechanic.....	\$ 18.33	3.67
OPERATOR: Paver (Asphalt, Aggregate, and Concrete).....	\$ 13.50	0.00
OPERATOR: Roller.....	\$ 13.98	0.00
PLUMBER.....	\$ 18.73	4.23
ROOFER: Built up Roof.....	\$ 12.74	0.00
ROOFER: Rubber Roof.....	\$ 16.82	4.77
ROOFER: Single Ply Roof.....	\$ 16.50	0.32
SHEET METAL WORKER, Includes HVAC Duct and Metal Roof Installation.....	\$ 14.72	1.48
TILE FINISHER.....	\$ 10.00	0.74
TRUCK DRIVER: Dump Truck.....	\$ 12.56	0.00
TRUCK DRIVER: Material Truck....	\$ 10.68	1.53

WELDERS - Receive rate prescribed for craft performing operation to which welding is incidental.

=====

Note: Executive Order (EO) 13706, Establishing Paid Sick Leave for Federal Contractors applies to all contracts subject to the Davis-Bacon Act for which the contract is awarded (and any solicitation was issued) on or after January 1, 2017. If this contract is covered by the EO, the contractor must provide employees with 1 hour of paid sick leave for every 30 hours they work, up to 56 hours of paid sick leave each year.

Employees must be permitted to use paid sick leave for their own illness, injury or other health-related needs, including preventive care; to assist a family member (or person who is like family to the employee) who is ill, injured, or has other health-related needs, including preventive care; or for reasons resulting from, or to assist a family member (or person who is like family to the employee) who is a victim of, domestic violence, sexual assault, or stalking. Additional information on contractor requirements and worker protections under the EO is available at www.dol.gov/whd/govcontracts.

Unlisted classifications needed for work not included within the scope of the classifications listed may be added after award only as provided in the labor standards contract clauses (29CFR 5.5 (a) (1) (ii)).

The body of each wage determination lists the classification and wage rates that have been found to be prevailing for the cited type(s) of construction in the area covered by the wage determination. The classifications are listed in alphabetical order of ""identifiers"" that indicate whether the particular rate is a union rate (current union negotiated rate for local), a survey rate (weighted average rate) or a union average rate (weighted union average rate).

Union Rate Identifiers

A four letter classification abbreviation identifier enclosed in dotted lines beginning with characters other than ""SU"" or ""UAVG"" denotes that the union classification and rate were prevailing for that classification in the survey. Example: PLUM0198-005 07/01/2014. PLUM is an abbreviation identifier of the union which prevailed in the survey for this classification, which in this example would be Plumbers. 0198 indicates the local union number or district council number where applicable, i.e., Plumbers Local 0198. The next number, 005 in the example, is an internal number used in processing the wage determination. 07/01/2014 is the effective date of the most current negotiated rate, which in this example is July 1, 2014.

Union prevailing wage rates are updated to reflect all rate changes in the collective bargaining agreement (CBA) governing this classification and rate.

Survey Rate Identifiers

Classifications listed under the ""SU"" identifier indicate that no one rate prevailed for this classification in the survey and the published rate is derived by computing a weighted average rate based on all the rates reported in the survey for that classification. As this weighted average rate includes all rates reported in the survey, it may include both union and non-union rates. Example: SULA2012-007 5/13/2014. SU indicates the rates are survey rates based on a weighted average calculation of rates and are not majority rates. LA indicates the State of Louisiana. 2012 is the year of survey on which these classifications and rates are based. The next number, 007 in the example, is an internal number used in producing the wage determination. 5/13/2014 indicates the survey completion date for the classifications and rates under that identifier.

Survey wage rates are not updated and remain in effect until a new survey is conducted.

Union Average Rate Identifiers

Classification(s) listed under the UAVG identifier indicate that no single majority rate prevailed for those classifications; however, 100% of the data reported for the classifications was union data. EXAMPLE: UAVG-OH-0010 08/29/2014. UAVG indicates that the rate is a weighted union average rate. OH indicates the state. The next number, 0010 in the example, is an internal number used in producing the wage determination. 08/29/2014 indicates the survey completion date for the classifications and rates under that identifier.

A UAVG rate will be updated once a year, usually in January of each year, to reflect a weighted average of the current negotiated/CBA rate of the union locals from which the rate is based.

WAGE DETERMINATION APPEALS PROCESS

1.) Has there been an initial decision in the matter? This can be:

- * an existing published wage determination
- * a survey underlying a wage determination
- * a Wage and Hour Division letter setting forth a position on a wage determination matter
- * a conformance (additional classification and rate) ruling

On survey related matters, initial contact, including requests for summaries of surveys, should be with the Wage and Hour Regional Office for the area in which the survey was conducted because those Regional Offices have responsibility for the Davis-Bacon survey program. If the response from this initial contact is not satisfactory, then the process described in 2.) and 3.) should be followed.

With regard to any other matter not yet ripe for the formal process described here, initial contact should be with the Branch of Construction Wage Determinations. Write to:

Branch of Construction Wage Determinations
Wage and Hour Division
U.S. Department of Labor
200 Constitution Avenue, N.W.
Washington, DC 20210

2.) If the answer to the question in 1.) is yes, then an interested party (those affected by the action) can request review and reconsideration from the Wage and Hour Administrator (See 29 CFR Part 1.8 and 29 CFR Part 7). Write to:

Wage and Hour Administrator
U.S. Department of Labor
200 Constitution Avenue, N.W.
Washington, DC 20210

The request should be accompanied by a full statement of the interested party's position and by any information (wage payment data, project description, area practice material, etc.) that the requestor considers relevant to the issue.

3.) If the decision of the Administrator is not favorable, an interested party may appeal directly to the Administrative Review Board (formerly the Wage Appeals Board). Write to:

Administrative Review Board
U.S. Department of Labor
200 Constitution Avenue, N.W.
Washington, DC 20210

4.) All decisions by the Administrative Review Board are final.

=====

END OF GENERAL DECISION

"



7687 Mikron Drive
Stanley, NC 28164
P: 704.820.3110
F: 704.820.0113

370-C Allied Drive
Conway, SC 29526
P: 843.347.6673
F: 843.347.6693

3214 Hanover Drive
Johnson City, TN 37604
P: 423.434.0535
F: 423.434.0537

8131 Virginia Pine Court
Richmond, VA 23237
P: 804.912.1851
F: 804.918.4988

345 Maple St.
Gallatin, TN
P: 615.989.7600
F: 615.989.1927

May 24, 2021

Thomas Weems Architect and Engineer

Project: Lake Ridge Elementary School - Additions (Johnson City, TN)

We know that the **Lake Ridge Elementary School - Additions (Johnson City, TN) Project** needs a permanent roof solution with a competitive price to keep the project within the owner's budget. Metal Roofing Systems (MRS) has been requested by some of the better roofers to provide them with a quote for our quality roofing products for this project. As a local manufacturer of top-quality metal panels and edge metal products, our competitive pricing will help keep the project within your owner's budget.

You may recall that your firm has used our material on your projects in the past such as:

- Model Mill - Additions & Alterations
- Johnson City - Police Training Center (Johnson City, TN)
- Model Mill Phase 2 (Johnson City, TN)
- Holston Medical Group - HMG Johnson City Outpatient Diagnostic Center
- Indian Trail Intermediate School - Additions and Alterations (Johnson City, TN)

Your design for this project reflects your interest in looking after the owner's best interest. MRS likewise tries to look after the owner's best interest by offering the best quality products on the market today at competitive pricing and these products are installed by our network of trained, certified roofing contractors.

Having performed a detailed review of the contact documents, we want to assure you that we have the same products as you have specified and that they meet or exceed your relevant performance requirements.

Since a number of roofing contractors have asked for our pricing on this project, we ask for you to please review and approve the attached CSI Substitution Request Form and let us know if you have any questions. Also, please let us know if you need for us to make the substitution request with some other form.

Please feel free to call me on my cell phone (804) 385-5798 if you should have any additional questions on the MRS product's compliance to the specified requirements.

Sincerely,

Peter Ryan
Metal Roofing Systems, Inc.

SUBSTITUTION REQUEST

Project: Lake Ridge Elementary School - Additions (Johnson City, TN)	Substitution Request Number:
To: Thomas Weems Architect and Engineer	From: Peter Ryan, Metal Roofing Systems
Re:	Date: May 24, 2021
	A/E project Number:
	Contract For:

Specification Title: Division 7		Description: Metal Soffit Panels
Section: 07 41 10	Page: 3	Article/Paragraph: 2.2.,D. Part 2 - System Description

Specification Title: Division 7		Description: Metal Roof Panels
Section: 07 41 13	Page: 3	Article/Paragraph: 2.3.,A. Part 2 - Panels

Specification Title: Division 7		Description: Manufactured Coping
Section: 07 77 13	Page: 2	Article/Paragraph: 2.2.,A. Part 2 - Coping System

Proposed Substitution: MRS Flush-Seam, MRS System 2000 & MRS Rapid-Lock Coping
Manufacturer: 7670 Mikron Drive, Stanley, NC 28164 Phone: 704-820-3110 Fax: 704-820-0113
Trade Name: Metal Roofing Systems Inc.

Attached data includes product description, specifications, drawings, photographs, and performance and test data adequate for evaluation of the request; applicable portions of the data are clearly identified

Attached data also includes a description of changes to the Contract Documents that the proposed substitution will require for its proper installation.

The Undersigned certifies:

- Proposed substitution has been fully investigated and determined to be equal or superior in all respects to specified product.
 - Same warranty will be furnished for proposed substitution as for specified product
 - Same maintenance service and source of replacement parts, as applicable, is available
 - Proposed substitution will have no adverse effect on other trades and will not affect or delay progress schedule
 - Proposed substitution does not affect dimensions and functional clearances.
 - Payment will be made for changes to building design, including A/E design, detailing, and construction costs caused by the substitution.
-

Submitted by: Peter Ryan

Firm: Metal Roofing Systems Inc.

Address: 7670 Mikron Drive, Stanley, NC 28164

Telephone: 704-820-3110

A/E's REVIEW AND ACTION

- Substitution approved - Make submittals in accordance with Specification Section.
- Substitution approved as noted - Make submittals in accordance with Specification Section
- Substitution rejected - Use specified materials.
- Substitution Request received too late - Use specified materials.

Signed by

Supporting Data Attached: Drawings Product Data Samples Tests Reports _____

SUBSTITUTION REQUEST FORM

To: **Thomas Weems Architect and Engineer**

Project: **Lake Ridge Elementary School - Additions (Johnson City, TN)**

We hereby submit for your consideration the following product instead of the specified item for the above project:

DRAWING: SPEC. SECT. NO: **07 41 10 – METAL SOFFIT PANELS**

PARAGRAPH: **2.2.,D. - SYSTEM DESCRIPTION**

Proposed Substitution: **MRS SYSTEM 2000**

DRAWING: SPEC. SECT. NO: **07 41 13 – METAL ROOF PANELS**

PARAGRAPH: **2.3.,A. - PANELS**

Proposed Substitution: **MRS SYSTEM 2000**

DRAWING: SPEC. SECT. NO: **07 77 13 – MANUFACTURED COPING**

PARAGRAPH: **2.2.,A. – COPING SYSTEM**

Proposed Substitution: **MRS RAPID-LOCK COPING**

Attach complete information on changes to Drawings and/or Specifications which proposed substitution will require for its proper installation.

Submit with request all necessary samples and substantiating data to prove equal quality and performance to that which is specified. Clearly mark manufacturer's literature to indicate equality in performance.

Fill in blanks below:

- A. Does the substitution affect dimensions shown on the Drawings? **No**
If yes, clearly indicate the changes:

- B. Will the undersigned pay for changes to the building design, including engineering and detailing costs caused by the requested substitution? **No**
If no, fully explain: **MRS product is exact same as the specified product and thus will not affect the building design.**

- C. What effect does substitution have on other Contracts or other Trades? **None**

- D. What effect does substitution have on construction schedule?
None. Possible shorter lead time because MRS is a local Manufacturer.

- E. Manufacturer's warranties of the proposed and specified items are: **Superior. Proposed substitution includes 35-yr Finish Warranty (vs. 20-yr specified).**
- F. Reason for request: **MRS product is the exact same as the specified profile but with better warranties (see above) and MRS is a local manufacturer.**
- G. Itemized comparison of specified item(s) with the proposed substitution; list significant variations: **See attached document**
- H. Accurate cost data comparing proposed substitution with product specified:
- I. Designation of maintenance services and sources:

(Attach additional sheets if required.)

**Certification of Equal Performance And
Assumption Of Liability For Equal
Performance**

For Use By Architect:

The undersigned states that the function, appearance and quality are equivalent or superior to the specified item. Submitted By:

Accepted Not Accepted as Noted Received



Accepted

Too Late

Signature: Peter Ryan *Title:* Architectural Manager

APPROVED

By Katie Hill at 10:04 am, May 28, 2021

Firm: Metal Roofing Systems, Inc.

Date:

Address: 7687 Mikron Drive, Stanley, NC 28164

Remarks:

Telephone: 704-820-3110

Date: 10/17/2017

Signature shall be by person having authority to legally bind his firm to the above terms. Failure to provide legally binding signature will result in rejection of proposed substitution

MRS FLUSH SEAM

12" - 20" Width

24 gauge steel
.032 Aluminum

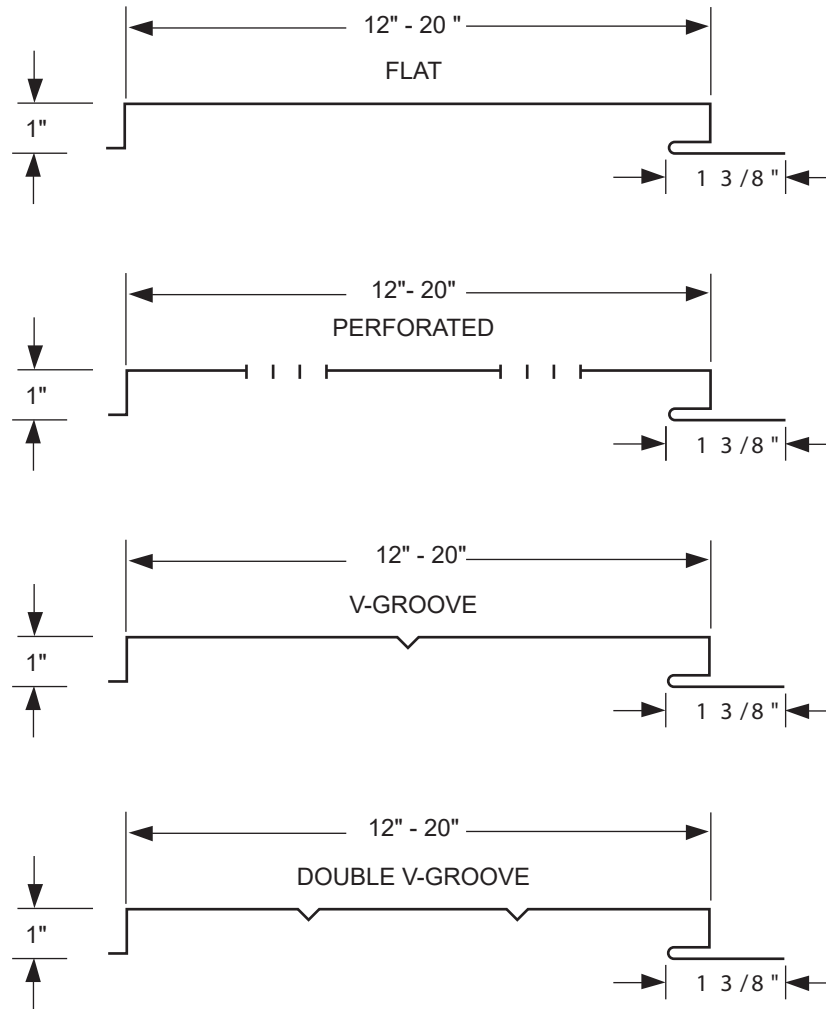

Versatility accomodates a variety of commercial or residential installations. Can be used as a wall or soffit panel system.

Material: 24 gauge Steel, .032 Aluminum
12" - 20" width
1 1/2", 1/2", 1", or 3/8" "slim-line" depth

Features: Vented or Solid Profiles
Vent placement and widths can vary within panel limits
With or Without Stiffening Beads

Requirements: Open Framing, Solid Substrate
Solid Substrate requires Ice & Water Shield or Synthetic Underlayment

Finish: Kynar 500

Locations:

7670 Mikron Drive
Stanley, NC 28164
Tel: 704-820-3110
Fax: 704-820-0113

2451 Bulk Plant Road
Conway, SC 29526
Tel: 843-365-6673
Fax: 843-365-6683

5512 Fort Henry Drive
Kingsport, TN 37663
Tel: 423-239-0013
Fax: 423-447-7150



METAL ROOFING
Systems, Inc

Website: www.metalroofingsystems.biz

Comparison sheet for equal

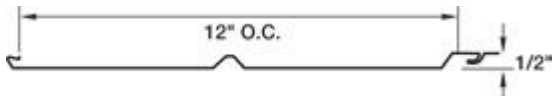

PAC-850

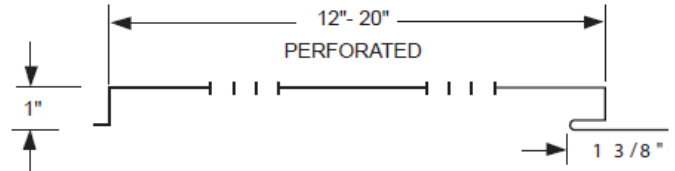

MRS FLUSH SEAM

<u>Feature</u>	<u>Specified</u>	<u>Metal Roofing Systems</u>
Manufacturer	PETERSEN	MRS
Model	PAC-850	MRS Flush Panel
Panel Width	12"	12"
Seam Height	1"	1"
Panel Finish	V-groove/Vented/Smooth	V-groove/Vented/Smooth
Fastener Type	Concealed	Concealed
Panel Sealant	Yes	Yes
Created Location	Factory	Factory
Material	Steel	Steel
Material Finish Name	Fluoropolymer	Fluoropolymer
Material Finish	Kynar 500/Hylar 5000	Kynar 500/Hylar 5000
Material Color	As selected	As selected
Material Thickness	24 Ga.	24 Ga.
Finish Warranty	20 yrs	35 yrs

MRS System 2000

12" - 18"
1 3/4" high
Snap-lock

.032 or .040 Aluminum
22, 24 ga Galvalume
16 oz Copper

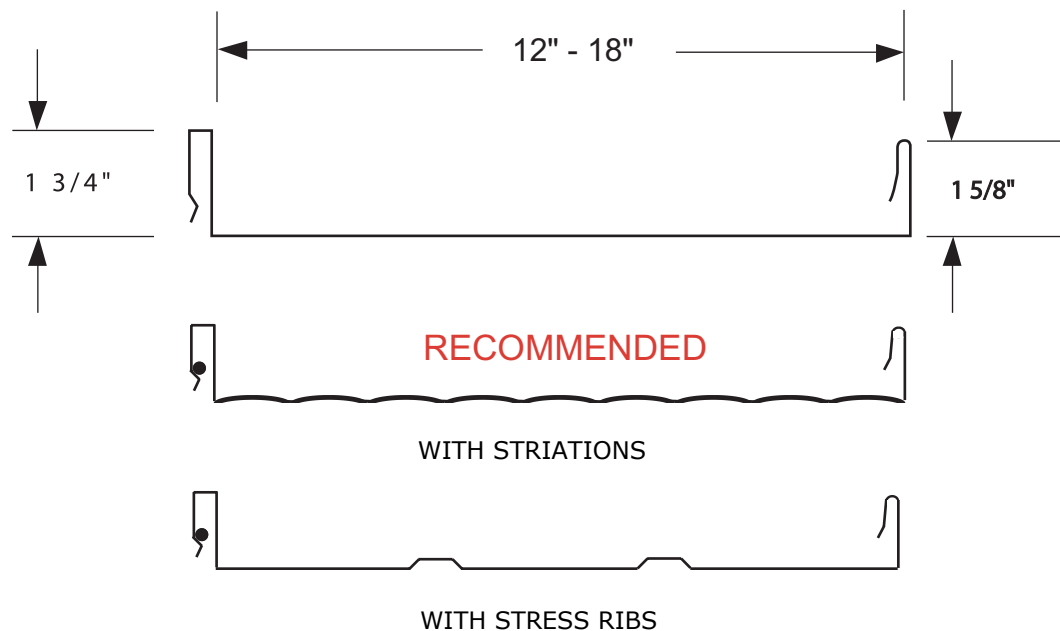

U.L. Construction No. 254, 255, 261, 303, 342, 343, 414, 436, 445, 446, 447, 448, 486, 508A, 543, 544

ASTM E1680-95, E1646-95, E1592-95

Ideal for large commercial installations

Material: .032 or .040 Aluminum, 22 or 24 ga Galvalume, 16 oz Copper
12" - 18" o.c.

Features: Flat
* Striations (MRS Recommended)
Stress Ribs
Optional Sealant in Female leg of panel

Requirements: Solid substrate, Open Framing
30# Felt or Ice & Water Shield
Clips spaced at 30" o.c. max (2 Fasteners per Clip)
Clips spaced at 48" o.c. max for 18" panel on Open Framing (2 Fasteners per Clip)
Clips spaced at 60" o.c. max for 16" panel on Open Framing (2 Fasteners per Clip)

Finish: Hylar 5000[®] or Kynar 500[®]



METAL ROOFING
Systems, Inc

Locations:

7687 Mikron Drive
Stanley, NC 28164
Tel: 704-820-3110
Fax: 704-820-0113

370-C Allied Drive
Conway, SC 29526
Tel: 843-365-6673
Fax: 843-365-6683

3214 Hanover Road
Johnson City, TN 37604
Tel: 423-239-0013
Fax: 423-447-7150

Website: www.metalroofingsystems.biz

Comparison sheet for equal

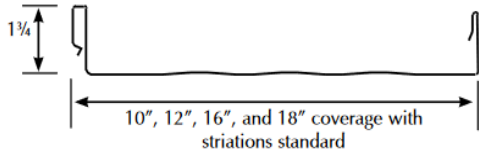

AEP-Span Snap Seam



MRS System 2000

<u>Feature</u>	<u>Specified</u>	<u>Metal Roofing Systems</u>
Manufacturer	AEP-SPAN	MRS
Model	Snap Seam	MRS System 2000
Panel Width	12"	12"-18"
Seam Height	1.75"	1.75"
Panel Finish	Smooth	Smooth, Striations, Ribbed
Fastener Type	Blind, Self Drilling	Blind, Self Drilling
Created Location	Factory	Factory
UL Testing	UL 90	UL 90
Material	Galvanized	Galvalume
Material Finish Name	Fluoropolymer	Fluoropolymer
Material Finish	Kynar 500	Kynar 500
Material Color	As Selected	As Selected
Material Thickness	24 Ga.	24 or 22 Ga. Galv. .032, .040, .050 Alum. 16 or 20 Oz. Copper
Finish Warranty	20 yrs	35 yrs
Watertight Warranty	20 yrs	20 yrs
Material Warranty		25 yrs

Will meet LEED requirements for SS7.2 and MR4.1

Rapid-Lock Coping

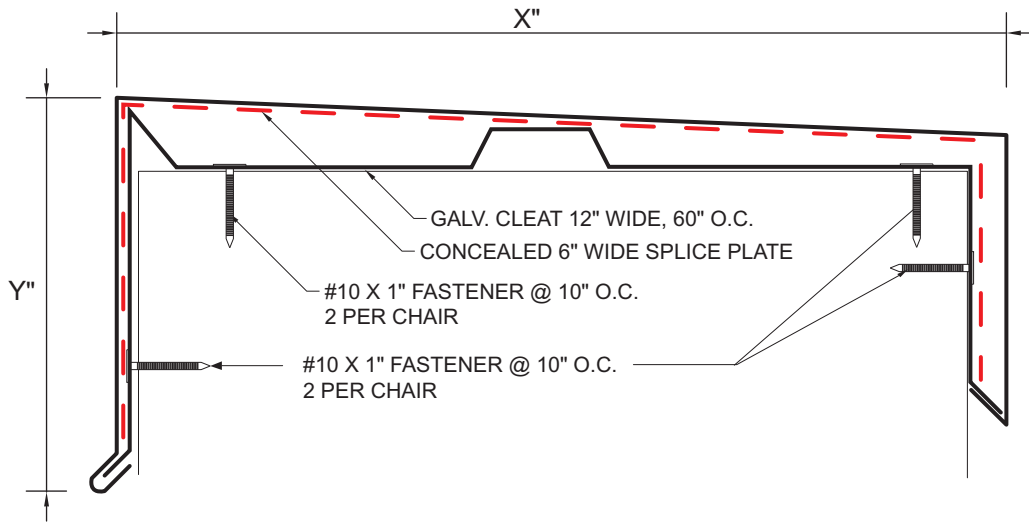

ANSI/SPRI ES-1 Tested and Approved

Material: Aluminum: .063, .050, .040, .032
Galvalume: 22 GA, 24 GA

Features: Radius Profile Available

Finish: Kynar 500

Locations:

7687 Mikron Drive
Stanley, NC 28164
Tel: 704-820-3110
Fax: 704-820-0113

370-C Allied Drive
Conway, SC 29526
Tel: 843-365-6673
Fax: 843-365-6683

3214 Hanover Road
Johnson City, TN 37604
Tel: 423-239-0013
Fax: 423-447-7150



METAL ROOFING
Systems, Inc

Website: www.metalroofingsystems.biz

Comparison sheet for equal

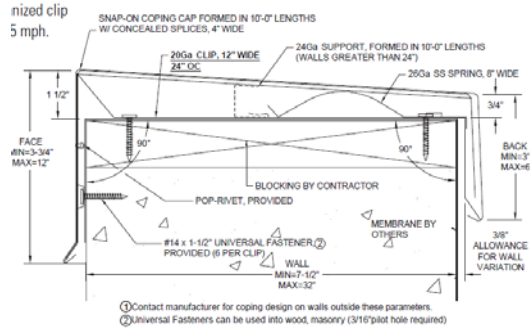

Hickman PermaSnap 2

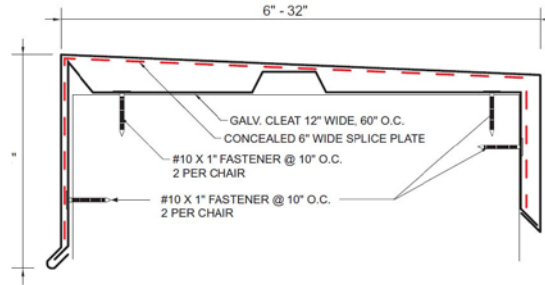

MRS Rapid-Lock Coping

Feature	Specified	Metal Roofing Systems
Manufacturer	W.P. Hickman	MRS
Model	PermaSnap 2	MRS Rapid-Lock Coping
Coping Lock	Double	Double
Coping Width	7.5"-32"	6"-32"
Coping Face	3.75"-12"	4"-12"
Joint System	Splice-Plate	Splice-Plate
Cleat System	Chair/Cont. Cleat	Chair/Cont. Cleat
Corners	Mitered & Welded	Mitered & Welded
Test Procedure	ANSI/SPRI ES-1	ANSI/SPRI ES-1
Material Finish	Kynar 500	Kynar 500/Hylar 5000
Material Finish Name	Fluorocarbon	Fluorocarbon
Material	Aluminum/Galvanized	Aluminum/Galvalume
Material Color	As Selected	As Selected
Material Thickness	Alum: .040, .050, .063, .080 Galvanized: 22ga, 24ga	Alum: .032, .040, .050, .063, .080 Galvalume: 22ga, 24ga
Finish Warranty	20 yrs	35 yrs
Wind Warranty	20 yrs – 110 mph	20 yrs – 110 mph



35 -Year Limited COOLR "Paint " Warranty AZ50 Galvalume®, G90 Galvanized, or Aluminum

EXCLUSIVE WARRANTY

This Warranty (collectively, the "Warranty") is issued by Metal Roofing Systems Inc. (hereinafter referred to as MRS"), to the customer identified in this Certificate (hereinafter referred to as "Customer") and applies to the finish on AZ50 Galvalume®, G90 Galvanized, or Aluminum flat sheet and coil products (hereinafter referred to as the "Product") with PVDF based coating consisting of KYNAR 500® or Hylar 5000® resin (hereinafter referred to as the "Coating") if erected anywhere within the Continental United States including Alaska, Hawaii and Canada.

1. Subject to the provisions contained herein, MRS warrants that during the Thirty-Five (35) Year Warranty Period, MRS' COOLR stock Coatings will not chip, crack, peel, flake or check (except for such slight crazing or cracking as may occur on tightly roll-formed edges or break bends at the time of roll forming or other fabrication of pre-painted sheet or coil and which is accepted in the industry as standard). Subject to the provisions contained herein, MRS warrants that for Thirty (30) years from the date of installation of panels, the Coating will not chalk in excess of ASTM D-4214-89 method D659 number eight (8) rating, or change color more than Five (5.0) Hunter E units as determined by ASTM method D-2244-2. Color change will be measured on an exposed painted surface that has been cleaned of surface soils and chalk, and the corresponding values measured on the original or unexposed surface. It is understood that fading or color change may not be uniform, if the surfaces are not equally exposed to the sun and elements.

2. This Warranty does not apply to circumstances beyond MRS' control, including:

- a. Fire or other casualty or physical damage;
- b. Unusual harmful fumes, foreign substances in the atmosphere or standing water. No warranty is provided for the coating on any substrate that is subjected to sea spray or installed on a property located 1500 or fewer feet from a coastline, salt or brackish water, or any salt water environment;
- c. Improper treatment of or defects in the metal or in the fabrication or areas where items such as snow guards or solar panels are attached / adhered to the product.
- d. Intermittent or continual submersion in water or any other liquid or solid material;
- e. Damage from wind, deliberate damage, improper handling by erectors, from abrasive or chemical cleaners.
- f. Mishandled Products, e.g., ANY PRODUCT WHICH HAS BEEN ABUSED, ALTERED, MODIFIED, USED IN A MANNER NOT ORIGINALLY INTENDED, OR STORED CONTRARY TO OUR INSTRUCTIONS.
- g. Stored or installed in a way that allows for poor air circulation, contact with animals or animal waste.
- h. Embossing that fractures or severely stretches the film (i.e. film is diminished at the point of emboss by greater than 0.2 mils.

3. This Warranty does not cover damage or deterioration resulting from moisture contamination or entrapment or any other contamination detrimental to the coating, which occurs prior to installation of the Products, including, without limitation, contamination occurring during shipment of the Product to the jobsite or during storage at the jobsite. This Warranty does not cover failure due to corrosion of substrate.

4. EXCLUDED ATMOSPHERIC CONDITIONS

This Warranty does not apply to sheet exposed at any time to corrosive, aggressive, harmful or other abnormal atmospheric conditions, including but not limited to:

- A. Areas subject to fallout exposure to corrosive chemicals, ash, fumes, cement dust, animal waste, or it's decomposition by-products, fallout from copper, lead, nickel or silver mining or refining operations and carbon black;
- B. Conditions/circumstances where corrosive fumes or condensation are generated or released inside the building;
- C. Areas subject to water run-off from lead or copper flashing or piping or areas in contact with lead or copper or lumber containing same;

5. All Warranty work will be performed by MRS, or any company, dealer, contractor, applicator, or distributor selected by MRS. Since there may be a color

variance between the replacement or repainted Product and the originally installed Product due to normal weathering (i.e. exposure to sunlight and extremes of temperature and weather) of the originally installed Products, this condition shall not be indicative of a defect.

6. NOT WITHSTANDING ANYTHING TO THE CONTRARY CONTAINED HEREIN, MRS' LIABILITY SHALL NOT EXCEED THE LESSER OF THE FOLLOWING: (I) THE CUSTOMER'S LIABILITY DIRECTLY ATTRIBUTABLE TO A BREACH OF THIS WARRANTY, OR (II) THE REFINISHING OR REPLACEMENT OF THE FAILED COATED MATERIAL, OR AT MRS' OPTION, REFUND OF THE PURCHASE PRICE WHICH SHALL NOT EXCEED AN AMOUNT EQUAL TO ONE HUNDRED PERCENT (100%) OF THE AMOUNTS PAID TO MRS BY THE CUSTOMER FOR THE PURCHASE OF THE DEFECTIVE PRODUCT. MRS SHALL NOT BE LIABLE FOR INJURY TO PROPERTY OTHER THAN THE FLAT SHEET AND/OR COIL PRODUCTS COATED WITH FLUOROCARBON PAINT SYSTEMS, IN THE CONDITION AND AS PURCHASED BY CUSTOMER FROM MRS. MRS, IN ALL INSTANCES, SHALL HAVE THE SOLE AND EXCLUSIVE RIGHT TO DETERMINE WHETHER OR NOT REFINISHING OR REPLACEMENT OF THE FAILED AREAS IS REQUIRED, AND TO FULFILL ITS OBLIGATION UNDER THE WARRANTY. MRS RESERVES THE RIGHT TO NEGOTIATE AND APPROVE ANY FINAL CONTRACT LET FOR REFINISHING AND REPLACEMENT AS THE CASE MAY BE.

7. This Warranty applies only to products manufactured by the customer within six (6) months from shipment thereof by Metal Roofing Systems Inc.

8. Claims under this Warranty must be presented by the customer to MRS in writing during the warranty period and within thirty (30) days after Customer becomes aware that any warranted condition has occurred. Time is of the essence and failure to give notice within the specified time shall discharge MRS from any obligations under this Warranty. MRS must be given a reasonable opportunity to do an on-site inspection to determine if there is a coating failure.

9. The laws of the State of Ohio shall exclusively govern the rights and duties of the parties to this Warranty. Any controversy or claim arising out of or related to this Warranty, or the breach thereof shall be brought before a court of competent jurisdiction in Cleveland, Ohio under the substantive and procedural laws of the State of Ohio.

10. Customer acknowledges that MRS is not the manufacturer or applicator of the coating warranted herein and agrees that all issues arising from or related to the exceptions set forth herein shall be determined finally and conclusively as to Customer, by the original manufacturer.

11. Due to pigment limitations, Regal Red, Matte Black and L/S Antique Black are covered by a number eight (8) rating for chalk, and five (5) E units for fade for a period of ten (10) years from installation. Copper and other metallic colors have no rating available for color change.

12. This Warranty applies solely to MRS "inventoried stock" colors. Custom matched colors and non-inventoried items may have different Warranty terms, or not be warranted.

13. For this Warranty to apply, the Customer must retain certain records. In order for MRS to process a claim, we will need to be told the original coil or skid tag number.

14. THIS WARRANTY IS GIVEN AS THE SOLE AND EXCLUSIVE WARRANTY AND EXCLUSIVE REMEDY BY OR AGAINST MRS, AND NO OTHER WARRANTIES, EITHER EXPRESS OR IMPLIED, INCLUDING BUT NOT LIMITED TO WARRANTIES OF MERCHANTABILITY OR FITNESS FOR A PARTICULAR PURPOSE OR PURPOSES, ARE MADE, AND ANY SUCH OTHER WARRANTIES ARE EXPRESSLY DISCLAIMED. THERE ARE NO WARRANTIES THAT EXTEND BEYOND THE DESCRIPTION CONTAINED IN THIS INSTRUMENT. CUSTOMER WAIVES THE BENEFIT OF ANY RULE THAT THE DISCLAIMERS OF WARRANTY SHALL BE CONSTRUED AGAINST THE SELLER, AND AGREES THAT THE DISCLAIMERS IN THIS INSTRUMENT SHALL BE CONSTRUED LIBERALLY IN FAVOR OF MRS. MRS SHALL NOT BE LIABLE FOR ANY SPECIAL, INCIDENTAL OR CONSEQUENTIAL DAMAGES. MRS HEREBY DISCLAIMS ALL LIABILITIES FOR DAMAGES BASED ON THEORIES OF NEGLIGENCE AND STRICT PRODUCT LIABILITY. THIS WARRANTY IS EXTENDED TO CUSTOMER ALONE

AND NO OTHERS, IS NON-TRANSFERABLE AND NON-ASSIGNABLE, AND MAY NOT BE ENLARGED IN ITS SCOPE BY ANY REPRESENTATIVE, SALES PERSON, AGENT OR OTHER EMPLOYEE OF MRS. THE CUSTOMER SHALL NOT PERMIT ANYONE TO CLAIM OR IMPLY THAT THIS WARRANTY EXTENDS OR CAN BE "PASSED THROUGH" TO ANYONE OTHER THAN THE CUSTOMER. THIS PROVISION IS A MATERIAL TERM OF THIS WARRANTY AND ITS VIOLATION OR BREACH BY CUSTOMER OR ANY OF CUSTOMER'S AGENTS OR REPRESENTATIVES, SHALL VOID AND CANCEL THIS WARRANTY FOR ALL PURPOSES.

THE LIABILITY OF SELLER MRS SHALL NOT EXTEND TO PERSONAL INJURY, PROPERTY DAMAGE, LOSS OF PROFIT, DELAY OR ANY INCIDENTAL OR CONSEQUENTIAL DAMAGES RESULTING FROM THE FAILURE OF ANY PRODUCT OR COATING TO CONFORM WITH THE PROVISIONS OF THIS LIMITED WARRANTY.

MRS SHALL NOT IN ANY EVENT BE LIABLE TO THE CUSTOMER OR ANY OTHER PERSON OR ENTITY FOR ANY ACTIONS, CLAIMS, CAUSES OF ACTION, DAMAGES, EXPENSES AND/OR LIABILITIES ARISING FROM OR RELATED TO THE DESIGN, USE OR FAILURE OF THE PRODUCT OR COATING, FOR THE INTERRUPTION OF THE CUSTOMER'S OPERATIONS OR BUSINESS, FOR THE COST OF LABOR EXPENDED BY OTHERS ON ANY DEFECTIVE PRODUCT OR COATING OR FOR ANY SPECIAL, INDIRECT OR CONSEQUENTIAL DAMAGES WHATSOEVER OR LOSS OF PROFIT OR OTHER FINANCIAL LOSS ARISING OUT OF THE USE OR FAILURE OF THE PRODUCT OR COATING, EVEN IF MRS HAS BEEN ADVISED OF THE POSSIBILITY OF SUCH ACTIONS, CLAIMS, CAUSES OF ACTION, DAMAGES, EXPENSE, LOSS AND/OR LIABILITIES, WHETHER ARISING FROM BREACH OF CONTRACT, BREACH OF WARRANTY, TORT, INCLUDING NEGLIGENCE, STRICT LIABILITY OR OTHERWISE TO ANYONE BY REASON OF THE FACT THAT SUCH PRODUCT OR COATING SHALL HAVE BEEN DEFECTIVE.

SIGNATURE:

This Warranty is not valid unless signed by an authorized employee or agent of Metal Roofing Systems Inc.

METAL ROOFING SYSTEMS INC.

By: _____

Name Printed:

Title: President

Date: "Metal Roofing Systems"

Issued To:

For:

Job:

Color:

Completion Date:



METAL ROOFING
Systems, Inc

35
YEAR
WARRANTY

SEE REVERSE SIDE FOR MATERIAL AVAILABILITY



ENVIRONMENTALLY SMART COLORS - DESIGNED ENERGY EFFICIENT



TERRA COTTA



AGED COPPER

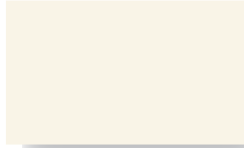

BONE WHITE

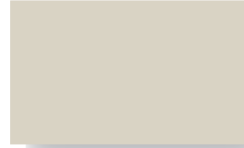

SANDSTONE



SURREY BEIGE



COLONIAL RED



PATINA GREEN

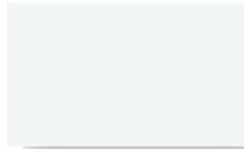

REGAL WHITE



ASH GRAY



SIERRA TAN



REGAL RED



HEMLOCK GREEN

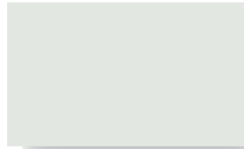

STONE WHITE



DOVE GRAY



MEDIUM BRONZE



BURGUNDY



HARTFORD GREEN



SLATE BLUE

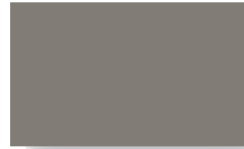

SLATE GRAY



MANSARD BROWN



MATTE BLACK



EVERGREEN



REGAL BLUE



CHARCOAL GRAY

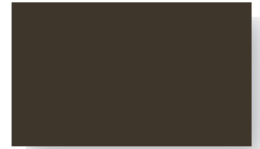

DARK BRONZE

METALLIC COLORS

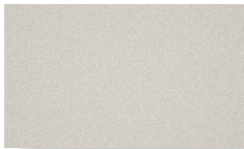

*SILVER



*COPPER



*CHAMPAGNE



*PRE-WEATHERED GALVALUME®

NON-PAINTED



ACRYLIC COATED GALVALUME®

* CONTACT YOUR REPRESENTATIVE FOR EXACT COLOR CHIP SAMPLE



LOCATIONS

7687 Mikron Drive
Stanley, NC 28164
P: 704.820.3110
F: 704.820.0113

370-C Allied Drive
Conway, SC 29526
P: 843.347.6673
F: 843.347.6693

3214 Hanover Drive
Johnson City, TN 37604
P: 423.434.0535
F: 423.434.0537



www.metalroofingsystems.biz

Faster. Smarter. Better. Period.

*Available at a slight price premium.

Colors shown are matched as accurately as possible, but may vary slightly from finished product. These rich and vibrant colors are produced with either Kynar 500® or Hylar 5000® resins, which provide superior color retention, and allow us to offer non-prorated coating warranties for most applications. Coating warranty varies for Regal Red, Matte Black, Copper, Silver, Champagne, and Pre-Weathered Galvalume. Metallics are warranted for chip, crack, and peel only. Please contact your representative for more information.

STOCK AVAILABILITY MATRIX

							GALVALUME		ALUMINUM			
			ISR	EMI	3yr.	SRI	24 ga.	22 ga.	.032	.040	.050	.063
Aged Copper	★	L	0.47	0.85	0.46	53	●		●			
Ash Gray	★	L	0.39	0.84	0.39	41	●	●	●	●		
Bone White	★	L	0.47	0.83	N/A	58	●		●	●	●	●
Burgundy	★		0.25	0.85	0.23	23	●					
Champagne Metallic	★	L	0.37	0.80	0.35	37	●					
Charcoal Gray	★		0.29	0.84	0.28	28	●	●	●	●		
Colonial Red	★	L	0.30	0.85	0.29	30	●		●	●	●	
Copper Metallic	★	L	0.49	0.86	0.47	56	●		●			
Dark Bronze	★		0.26	0.84	0.25	24	●	●	●	●	●	●
Dove Gray	★	L	0.49	0.86	N/A	56	●	●	●	●		
Evergreen	★		0.27	0.86	0.26	26	●		●	●	●	
Hartford Green	★		0.26	0.85	0.25	24	●		●	●	●	
Hemlock Green	★	L	0.29	0.86	0.29	29	●					
Mansard Brown	★		0.27	0.86	0.25	26	●	●	●	●	●	
Matte Black	★		0.29	0.83	0.27	27	●	●	●	●	●	
Medium Bronze	★	L	0.30	0.87	0.28	31	●	●	●	●	●	●
Patina Green	★		0.28	0.87	0.28	28	●					
Pre-weathered Galvalume*	★		0.30	0.79	0.28	27	●		●			
Regal Blue	★		0.26	0.85	0.25	24	●		●			
Regal Red	★	L	0.42	0.83	0.41	45	●		●		●	
Regal White	★	L	0.67	0.86	0.67	81	●	●	●	●	●	●
Sandstone	★	L	0.54	0.86	0.53	63	●		●	●	●	
Sierra Tan	★	L	0.35	0.86	0.34	37	●	●	●	●	●	
Silver Metallic	★	L	0.59	0.79	0.60	67	●		●	●	●	
Slate Blue	★		0.29	0.85	0.28	28	●		●			
Slate Gray	★	L	0.33	0.84	0.33	33	●	●	●	●	●	
Stone White	★	L	0.60	0.86	0.56	71	●		●	●	●	●
Surrey Beige	★	L	0.42	0.85	0.41	46	●					
Terra Cotta	★	L	0.35	0.86	0.35	37	●		●	●		
Acrylic Coated Galvalume*	★	L	0.67	0.14	0.55	56	●	●				

*** IF DESIRED COLOR IS NOT LISTED ON MATRIX PLEASE CONTACT METAL ROOFING SYSTEMS FOR AVAILABILITY**

NOTES
<ul style="list-style-type: none"> All metal is painted with a .20 mil primer and .70 -.90 mil Top Coat of 70% Kynar 500 or Hylar 5000. The reverse side has a .20 primer and .30 - .40 backer coating. 22 gauge steel available upon request. For low slope roofing to meet Energy Star requirements the ISR must be ≥ 0.65. After 3 years, the solar reflectance must be ≥ 0.50. For steep slope roofing to meet Energy Star requirements the ISR must be ≥ 0.25. After 3 years, the solar reflectance must be ≥ 0.15. For low slope roofing to meet LEED 2009 requirements the SRI must be ≥ 78. For steep slope roofing to meet LEED 2009 requirements the SRI for 100% of the roof must be ≥ 29. Low slope is defined as $\leq 2:12$. Steep slope is defined as $>2:12$.

KEY	
●	Stocked Item
★	Energy Star Compliant
L	LEED 2009 Compliant
ISR	Initial Solar Reflectance
EMI	Emissivity
SRI	Solar Reflectance Index



METAL ROOFING
Systems, Inc



Oil canning is an aesthetic issue and is an inherent part of light gauge cold formed metal products. By using coil that has been processed properly, designing for thermal movement, following stringent specifications for installation and proper handling most oil canning can be eliminated. Oil canning is not grounds for coil/panel rejection.

Galvalume® is a registered trademark of BIEC. Hylar 5000 is a registered trademark of Solvay Solexis, Inc. Kynar 500 is a registered trademark of Atofina, Inc.



**SUBSTITUTION
REQUEST**

(During the Bidding/Negotiating Phase)

Project: Lake Ridge Elementary School Substitution Request Number: _____
Johnson City, TN From: Peachtree Protective Covers, Inc.
 To: Thomas Weems Architect Date: May 18, 2021
 A/E Project Number: _____
 Re: Substitution Request - Cantilever Walkway Cover Contract For: Cantilever Walkway Cover

Specification Title: Cantilever Walkway Cover Description: Manufacturers
 Section: 10 7301 Page: 2 Article/Paragraph: 2.1

Proposed Substitution: Peachtree Protective Covers, Inc.
 Manufacturer: PPC Address: 3255 S. Sweetwater Rd., Lithia Springs, GA 30122 Phone: (770) 439-2120
 Trade Name: Extruded Aluminum Walkway Covers Model No: N/A

Attached data includes product description, specifications, drawings, photographs, and performance and test data adequate for evaluation of the request: applicable portions of the data are clearly identified.

Attached data also includes a description of changes to the Contract Documents that the proposed substitution will require for its proper installation.

The Undersigned certifies:

- Proposed substitution has been fully investigated and determined to be equal or superior in all respects to specified product.
- Same warranty will be furnished for proposed substitution as for specified product.
- Same maintenance service and source of replacement parts, as applicable, is available
- Proposed substitution will have no adverse effect on other trades and will not affect or delay progress schedule.
- Proposed substitution does not affect dimensions and functional clearances.
- Payment will be made for changes to building design, including A/E design, detailing, and construction costs caused by the substitution.

Submitted by: Clyde Miller
 Signed by: *Clyde Miller*
 Firm: Peachtree Protective Covers, Inc.
 Address: 3255 S. Sweetwater Rd.
Lithia Springs, GA 30122
 Telephone: (770) 439-2120

A/E's REVIEW AND ACTION

- Substitution approved – Make submittals in accordance with Specification Section 01330.
 Substitution approved as noted – Make submittals in accordance with Specification Section 01330.
 Substitution rejected – Use specified materials.
 Substitution Request received too late – Use specified materials.

APPROVED
 By *Katie Hill* at 10:01 am, May 28, 2021
Date:

Signed by: _____

Supporting Data Attached: Drawings Product Data Samples Tests Reports _____



SUBSTITUTION REQUEST

(During the Bidding/Negotiating Phase)

Project: Lake Ridge Elementary School Substitution Request Number: _____
Johnson City, TN From: Peachtree Protective Covers, Inc.
To: Thomas Weems Architect Date: May 18, 2021
A/E Project Number: _____
Re: Substitution Request - Architectural Walkway Cover Contract For: Architectural Walkway Cover

Specification Title: Architectural Walkway Cover Description: Manufacturers
Section: 10 7302 Page: 2 Article/Paragraph: 2.1

Proposed Substitution: Peachtree Protective Covers, Inc.
Manufacturer: PPC Address: 3255 S. Sweetwater Rd., Lithia Springs, GA 30122 Phone: (770) 439-2120
Trade Name: Extruded Aluminum Walkway Covers Model No: N/A

Attached data includes product description, specifications, drawings, photographs, and performance and test data adequate for evaluation of the request: applicable portions of the data are clearly identified.

Attached data also includes a description of changes to the Contract Documents that the proposed substitution will require for its proper installation.

The Undersigned certifies:

- Proposed substitution has been fully investigated and determined to be equal or superior in all respects to specified product.
- Same warranty will be furnished for proposed substitution as for specified product.
- Same maintenance service and source of replacement parts, as applicable, is available
- Proposed substitution will have no adverse effect on other trades and will not affect or delay progress schedule.
- Proposed substitution does not affect dimensions and functional clearances.
- Payment will be made for changes to building design, including A/E design, detailing, and construction costs caused by the substitution.

Submitted by: Clyde Miller
Signed by: *Clyde Miller*
Firm: Peachtree Protective Covers, Inc.
Address: 3255 S. Sweetwater Rd.
Lithia Springs, GA 30122
Telephone: (770) 439-2120

A/E's REVIEW AND ACTION

- Substitution approved – Make submittals in accordance with Specification Section 01330.
- Substitution approved as noted – Make submittals in accordance with Specification Section 01330.
- Substitution rejected – Use specified materials.
- Substitution Request received too late – Use specified materials.

APPROVED
By Katie Hill at 10:02 am, May 28, 2021

Signed by:

Supporting Data Attached: Drawings Product Data Samples Tests Reports _____