



ADDENDUM NO. 1

Date: 10 Dec 2020

Project No.: 20-22

Project Name: LaFayette Court Square Enhancements (Northeast corner of LaFayette Court Square)

The Bidding Documents are modified as follows:

PART 1.00 DRAWINGS

1.01 SHEET G-2

- A. Scope of work of General Contractor note: Refer to this addendum for changes to the General Contractor and their electrical and plumbing subcontractor's scope of work.

1.02 SHEET SG-1

- A. Contractor is to provide all gas lanterns, gas piping, and all connections to City provided gas meter. All gas lantern to be mounted on powder coated 3" steel round post without decorative base. The two gas lanterns and post on the southside of the site are to be constructed on brick pier with a decorative base similar to existing gas lanterns in front of City Hall. See details 1, 2, 3 on Sheet SD-16.

1.03 SHEET E-1

- A. All "TL" and "CL" fixtures as well as all weatherproof duplex outlets are to be provided and installed by electrical contractor is also to provide a 200 amp exterior panel and lockable disconnect as well as all conduits and wiring for electrical devices and fixtures. Also a weatherproof lighting control panel to be provided and installed by electrical contractor. All panels to be located on the northeast corner of existing building near the new exterior steps. Panel to be feed from the city's street lighting circuit at the curb. Electrical subcontractor to verify exact power feed locations with City of LaGrange electrical department.
- B. The (3) three "WA-3" electrical post lights are to be provided and installed by the City of LaGrange.
- C. Provide weatherproof outlet for irrigation box to be located near new electrical panels.
- D. Similar manufacturers of the "TL" and "CL" fixtures are acceptable provided they meet or exceed specifications of fixtures specified.

PART 2.00 PROJECT MANUAL

2.01 SECTION 01101 - ALTERNATES

- A. Part 2.01, B, 2.2.2 - Omit Add. Alt. No. 2 - Flagpole and flagpole lighting.
- B. Part 2.01, B, 2.2.2 - Omit cash allowances for light fixtures. Provide light fixtures specified in this addendum.

PART 3.00 ADDENDA

NO ITEMS INCLUDED

PART 4.00 APPROVED MANUFACTURERS

NO ITEMS INCLUDED

PART 5.00 ATTACHMENTS

5.01 Bonds and Government Addendum: See the following attached documents that will need to be executed and submitted by successful bidder when construction contract is executed:

- A. Performance Bond - (2) pages
- B. Payment Bond - (2) pages
- C. Governmental Addendum - (2) pages

5.02 Pre-Bid Sign-in Sheet

5.03 Sheets LS-1 and LS-2, Landscape Plans

- A. To assist in pricing of irrigation system; landscape plants and installation by City.

PART 6.00 GENERAL CLARIFICATIONS

6.01 Base Bid

- A. In the Base Bid the City is responsible for finish grade , GAB, and providing and installing concrete pavers as called for on the drawings. In the Base Bid, the General Contractor will provide mortar and install the City provided concrete pavers set in mortar on the ramp and elevated patio.
- B. The City will demo all existing pavers. All curb & gutter, concrete sidewalk, asphalt cutting, and demo to be provided by General Contractor.
- C. Membrane waterproofing to wrap corner of building by 3'-0".
- D. General Contractor to provide all demo as required and install new roof drainage piping and planter bed drainage.
- E. Project duration to be (100) consecutive calendar days from Notice to Proceed.
- F. Successful bidder to be determined by Base Bid only.
- G. General Contractor to provide irrigation system, irrigation meter, and water supply (no tap fee required). General Contractor to provide weatherproof outlet for irrigation controller.
- H. General Contractor responsible for demo, saw-cutting, and asphalt patching & striping. Striping paint to be GDOT specified thermoplastic is to be provided and installed by the City.
- I. The existing concrete landing and steps at the side door is to be removed in its entirety from the site in order to allow for new patio and steps.
- J. Refer to attached landscape plans LS-1 and LS-2 for plant layout to be used for irrigation design. All landscaping and installation by City. All irrigation design, materials, installation by General Contractor.
- K. All handrails, guardrails, gas lantern posts are to be powder coated black.
- L. General Contractor is to provide and install 3'-0" deep of top soil in all landscape area.

END OF ADDENDUM NO. 1

PERFORMANCE BOND

STATE OF GEORGIA
COUNTY OF TROUP
CITY OF LAGRANGE

KNOW BY ALL MEN THESE PRESENTS, that we, _____
_____ as Principal,
and _____
as Surety, are held and firmly bound unto the City of LaGrange, Georgia, in the full sum of _____ Dollars (\$ _____)
for payment of which well and truly to be made, we bind ourselves, our heirs, executors, administrators, successors and assigns, jointly and severally, by these presents.

WHEREAS, the above bound Principal has entered into a contract with the City of LaGrange, Georgia dated the _____ day of _____, 20____, which contract is made a part of this agreement for the construction of:

NOW THEREFORE, the conditions of this obligation are such that if the Principal shall in all respects perform the terms and conditions of said contract (and such alterations or additions as may be made therein or in the plans and specifications) and shall indemnify and save the City of LaGrange, Georgia harmless against any claims for using any form of material, process, composition or anything which is patented, and likewise indemnify and save the owner or the City, if the City is not the owner, harmless against all claims or damages by reason of any default or negligence, want of skill or care on part of said Principal or Agents in and about the performance of said contract, and shall comply with all laws pertaining to said work, and shall comply with and shall well, truly, fully and faithfully perform any guarantee provided for in said contract, then this obligation shall be void, otherwise of full force and effect.

And the surety of this bond, for value received, agrees that no change, extensions of time, alterations or additions to the terms of the contract or to the work to be performed thereunder or the specifications accompanying the same shall in any wise affect its obligations on this bond, and it does hereby waive notice of such change, extension of time, alterations or additions to the terms of the contract or the work or to the plans and specifications.

IN WITNESS WHEREOF, the Principal and the Surety have caused these presents to be duly signed and sealed this _____ day of _____, 20____.

PRINCIPAL:

_____ (SEAL)

BY: _____
Title: _____

ATTEST: _____
Title: _____

Signed, sealed and delivered this _____
day of _____, 20____,
in the presence of:

Witness

Address of Witness

SURETY:

_____ (SEAL)

BY: _____
Title: _____

ATTEST: _____
Title: _____

Signed, sealed and delivered this _____
day of _____, 20____,
in the presence of:

Witness

Address of Witness

APPROVED AS TO FORM:

CITY ATTORNEY

PAYMENT BOND

STATE OF GEORGIA
COUNTY OF TROUP
CITY OF LAGRANGE

KNOW BY ALL MEN THESE PRESENTS, that we, _____
_____ as Principal,
and _____
as Surety, are held and firmly bound unto the City of LaGrange, Georgia, in the full sum of
_____ Dollars (\$ _____)
for the use and protection of said owner or City if the City is not the owner, and all subcontractors
and all persons supplying labor, services, skill, tools, materials, machinery and equipment for the
performance of the work provided for in the contract hereinafter referred to, for the payment of
which sum well and truly to be made we bind ourselves, our heirs, executors, administrators,
successors and assigns, jointly and severally, firmly by these presents.

WHEREAS, the above bound Principal has entered into a contract with the City of
LaGrange, Georgia dated the _____ day of _____, 20____, for the construction
of:

NOW THEREFORE, the conditions of this obligation are such that if the above bound
Principal shall well, truly and promptly pay all subcontractors and all other persons supplying labor,
services, skill, tools, materials, machinery and equipment furnished for the performance of the work
provided for by said contract and such alterations or additions as may be made therein or in the plans
and specifications, then this bond to be void; otherwise, it shall remain in full force and effect.

And the surety of this bond, for value received, agrees that no change, extensions of time,
alterations or additions to the terms of this contract or to the work to be performed thereunder or the
specifications accompanying the same shall in any way affect its obligation on this bond, and it does
hereby waive notice of any such change, extension of time, alterations or additions to the terms of
the contract or the work or to the plans and specifications or to the work to be performed thereunder.

It is agreed that this bond is executed pursuant to and in accordance with the provisions of
O.C.G.A. § 36-91-40 et seq., as amended, and is intended to be and shall be construed to be a bond
in compliance with the requirements thereof.

IN WITNESS WHEREOF, the Principal and the Surety have caused these presents to be duly signed and sealed this _____ day of _____, 20__.

PRINCIPAL:

_____ (SEAL)

BY: _____

Title: _____

ATTEST: _____

Title: _____

Signed, sealed and delivered this _____ day of _____, 20__, in the presence of:

Witness

Address of Witness

SURETY:

_____ (SEAL)

BY: _____

Title: _____

ATTEST: _____

Title: _____

Signed, sealed and delivered this _____ day of _____, 20__, in the presence of:

Witness

Address of Witness

APPROVED AS TO FORM:

CITY ATTORNEY

GOVERNMENTAL ADDENDUM

This Addendum is made a part of, is incorporated into and shall control with respect to any and all contracts between the undersigned and the City of LaGrange (“LaGrange”) concerning and with respect to goods or services contracted for by LaGrange.

NOW THEREFORE, the undersigned parties agree as follows:

1. Any portion of an agreement between the undersigned and LaGrange regarding indemnification shall apply only to the extent permitted by law, and any applicable case law, including under CSX Transportation, Inc. v. City of Garden City, 277 Ga. 248, 588 S.E.2d 688.

2. Any agreement between the undersigned and the LaGrange shall be interpreted, construed and enforced in all respects in accordance with the laws of the State of Georgia, excluding its conflicts of law principles. Each party irrevocably consents to the exclusive jurisdiction of the courts of the State of Georgia in connection with any action to enforce the provisions, to recover damages, or for other relief for breach or default under the undersigned’s agreement with LaGrange or otherwise arising under or by reason of such agreement or this Addendum. LaGrange does not waive any rights to venue and does not consent to venue in any court other than the Superior Court of Troup County, Georgia or to the conduct of alternate dispute resolution proceedings anywhere other than the City of LaGrange, Georgia.

3. Confidentiality provision(s) in any agreement between the undersigned and LaGrange (if any) are subject to State Open and Public Records Law.

4. The terms of this Governmental Addendum shall apply notwithstanding anything to the contrary set forth elsewhere in any agreement (including any attachments, specimen forms, exhibits, riders, specifications or modifications to such agreement) between the undersigned and the LaGrange. Except as modified hereby, the terms and provision of any agreement between the undersigned and LaGrange shall remain in full force and effect and, except as modified hereby, the rights and obligations of the parties are not modified or affected in any way.

5. The undersigned acknowledges the requirements of City Code Section 5-1-6(e), and agrees that in the performance of contractual services on behalf of LaGrange the undersigned will not discriminate against employees, applicants for employment, or recipients of services on the basis of such employee’s, applicant’s or recipient’s race, color, religion, national origin, citizenship status, age, sex, disability, veteran’s status, political affiliation, sexual orientation, or gender identity.

ACKNOWLEDGED AND AGREED TO this ____ day of _____, 2020.

FOR INDIVIDUAL SIGNATORS:

SIGNATURES CONTINUED ON FOLLOWING PAGE

FOR ENTITY SIGNATORS:

By: _____
Its: _____

Attest: _____
Its: _____

CITY OF LAGRANGE, GEORGIA

By: _____
Its: _____

Plant List						
QTY.	COMMON NAME	HEIGHT	SPREAD	CALIPER	ROOT	REMARKS
TREES						
1	Japanese Maple 'Seriyu'	8-9'	3-4'	2.5"	B&B	Full, well branched
SHRUBS						
1	Camellia 'Mine No Yuki'	18-24"	30-36"		7 gal	Full, well shaped
1	Jubilation Gardenia	24-30"	18-24"		7 gal	Full, well shaped
9	Soft Touch Holly	12-15"	15-18"		7 gal	Full, well shaped
2	Steed's Holly	24-36"	18-24"		7 gal	Full, well shaped
6	Harbor Dwarf Nandina	9-12"	9-12"		3 gal	Full, well shaped
3	Mojo Pittosporum	12-15"	18-24"		5 gal	Full, well shaped
2	Spring Bouquet Viburnum	42-48"	30-36"		15 gal	Full, well shaped
Groundcover / Seasonal Color						
60	Ajuga 'Caitlin's giant'				4" pot	Full
50	Seasonal Color				sq. ft.	

GENERAL LANDSCAPE NOTES:

- AN IRRIGATION SYSTEM SHALL BE INSTALLED FOR COVERAGE OF ALL PROPOSED TREE, SHRUB, GROUNDCOVER, AND FESCUE GRASSSED AREAS UNLESS OTHERWISE NOTED. PROVIDE SEPERATION OF COVERAGE BETWEEN TURF AND SHRUB AREAS.
- ALL IRRIGATION SYSTEM COMPONENTS SHALL BE COMMERCIAL GRADE AND ADEQUATELY SIZED FOR THE SYSTEM. IRRIGATION CONTRACTOR SHALL SUBMIT SHOP DRAWINGS TO THE LANDSCAPE ARCHITECT FOR APPROVAL. UPON COMPLETION, CONTRACTOR SHALL FURNISH AN AS-BUILT PLAN FOR THE IRRIGATION SYSTEM TO THE OWNER.
- CONTRACTOR SHALL VERIFY PLANT COUNT FROM PLAN AND SHALL PROVIDE AND INSTALL ALL PLANT MATERIAL AS SHOWN ON PLAN. PLANT LIST IS PROVIDED FOR ASSISTANCE IN BID PREPARATION ONLY.
- THE CONTRACTOR SHALL REVIEW THE DRAWINGS AND NOTATIONS PRIOR TO COMMENCING WORK. VERIFY ANY DISCREPANCIES BETWEEN NOTES, DRAWINGS, AND FIELD CONDITIONS WITH THE LANDSCAPE ARCHITECT FOR CLARIFICATION.
- CONTRACTOR IS RESPONSIBLE FOR THE LOCATION OF ALL UTILITIES. DAMAGE TO UTILITIES SHALL BE REPAIRED EXPEDITIOUSLY AND AT THE EXPENSE OF THE CONTRACTOR.
- CARE SHALL BE TAKEN TO MINIMIZE DISTURBANCE TO EXISTING TREES.
- SHREDDED BROWN HARDWOOD MULCH TO BE USED IN ALL PLANTING AREAS

LANDSCAPE ARCHITECT STAMP



SIGNATURE REQUIRED

BARCLIFF ASSOCIATES
 LANDSCAPE ARCHITECTURE
 LAND PLANNING

3524 SUNDERLAND WAY NE
 ATLANTA, GEORGIA 30319
 404.375.8609

General Contractor to include a completely functioning Irrigation system based on the landscape plan provided. General Contractor to provide 3 feet of suitable topsoil in all landscape areas. City will provide all landscaping and Landscaping installation.

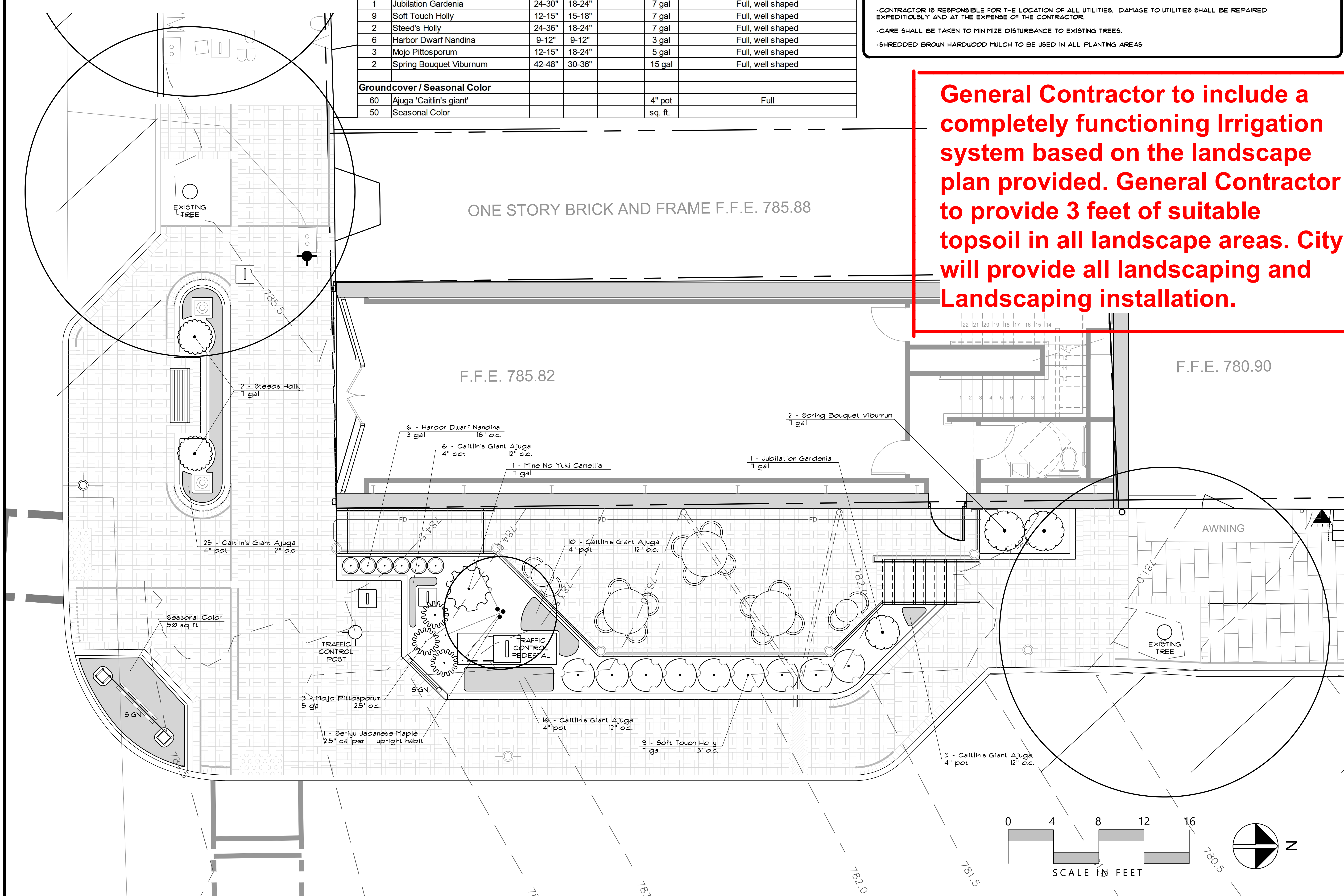

REVISIONS	
DATE	DESCRIPTION

PROJECT:
PLAZA ENHANCEMENTS
 LAFAYETTE SQUARE
 RIDLEY AVENUE
 LAGRANGE, GEORGIA

TITLE:
LANDSCAPE PLAN

MODIFIED DATE:	JOB NO: 20-22
ISSUED DATE: 5 NOV 2020	SHEET: LS-1

PART I - GENERAL

11 DESCRIPTION

- A. Extent of planting is shown on the drawings and in the schedules.
- B. Provide all labor, materials and equipment required by or referenced from the drawings and specifications to complete the work of this section.
- C. Contractor shall verify plant count from plan, and shall provide and install all plant material as shown on plan. Plant List is provided for assistance in bid preparation only.
- D. Grades to within one inch of final grade throughout site shall be provided by others and is not in landscape contract.

12 QUALITY ASSURANCE

- A. All plants shall conform to or surpass minimum quality standards as defined by the American Association of Nurserymen, current edition of American Standard for Nursery Stock, published by American Association of Nurserymen, Inc. and in addition shall conform to sizes and descriptions in the plant list.

- B. Substitution from the specified plant list will be accepted only when satisfactory evidence in writing is submitted to the Landscape Architect, showing that the specified plant material is not available. Requests for approval of substitute plant material shall include common and botanical names and the size of substitute material. Only those substitutions of at least equivalent size and having essential characteristics similar to the originally specified material will be approved. Acceptance or rejection of substitute plant material will be issued in writing by the Landscape Architect or Owner's representative.

- C. The selection of all materials and the execution of all operations required under the Drawings and Specifications is subject to the approval of the Owner and Landscape Architect. They have the right to reject any and all materials, and any work and all work which, in their opinion, does not meet the requirements of the Contract Documents at any stage of the operations. Remove rejected work or materials from the project site and replace promptly at no additional cost to the Owner.

- D. Install all plant materials in a neat and professional manner.
- E. Make minor adjustments to layout, as may be required and requested at no additional cost to the Owner.

13 DELIVERY, STORAGE AND HANDLING

- A. Deliver materials in such a manner as to not damage or decrease the health and vigor of the plant materials.
- B. Store materials away from detrimental elements. Coordinate with general Contractor to secure a safe staging area.
- C. Handle, load, unload, and transport materials carefully to avoid damage.
- D. Maintain and protect plant materials as necessary to insure health and vigor.

14 GUARANTEE

- A. Guarantee plant materials and lawn areas for one year from the date of substantial completion. Contractor shall replace plants and lawns, that fail to grow properly with plants as originally specified at the earliest practical date following plant failure, without additional charges to the Owner. Replacement materials will be guaranteed for one year from the date of replacement. The Contractor shall not be responsible for replacing plants which are damaged by abuse or improper maintenance by Owner as reported by the Contractor as outlined in Section 15 below, or by acts of God occurring after acceptance.

15 CONTRACTOR'S PERIODIC INSPECTION

- A. During the guarantee period, Contractor shall make periodic inspections of the project to satisfy himself that maintenance by the Owner is adequate. Any methods or products which he deems not normal or detrimental to good plant growth shall be reported to the Owner in writing. Failure to inspect and report shall be interpreted as approval and the Contractor shall be held responsible for any and all necessary replacements.

PART 2 - MATERIALS

21 TOP SOIL

- A. Topsoil shall be fertile, friable, sandy loam, and shall be a natural surface soil obtained from well drained areas. Topsoil shall be characteristic of representative soils in the project vicinity that produce heavy growths of crops, grass, or other vegetation. Topsoil shall be free of debris, stones, concrete, rubble, stumps, roots or other material harmful to plant growth or hindrance to planting or maintenance operations. Should regenerative materials be present in the soil, Contractor shall eradicate and remove such growth, both surface and root, which may appear in the imported material within one year following acceptance of the work. Topsoil shall not be handled in a frozen or muddy condition. The acidity range shall be between 5.0 and 7.0 inclusive. The mechanical analysis of the soil shall be as follows:

Sieve Size	Percent Passing
1 inch mesh	95 - 100 percent
7/8 inch mesh	91 - 99 percent
No. 100 mesh	40 - 60 percent
No. 200 mesh	20 - 40 percent

22 PLANTING SOIL MIXTURE

- A. Provide planting soil mix amended as per laboratory recommendations. Basic planting soil mix consists of:

- 50% topsoil (as described above)
- 50% prepared additives (by volume as follows)
 - 3 parts humus (forest or peat)
 - 1 part sterilized cow manure, commercial fertilizer and lime as recommended in soil analysis

- B. The components shall be thoroughly mixed to a uniform consistency by hand or machine methods.

C. Seasonal color beds shall be prepared with a mixture consisting of:

1. Lime at 50 lb/1000 square feet.
2. Fertilizer at 30 lb/1000 square feet.
3. Two inches of river sand.
4. Two inches of old humus bark and tilling material.
5. Tilled to depth of 12".
6. Bed raised 3" - 5" above existing grade.

The bed shall then be covered with two inches of pinebark mini-nuggets.

23 FERTILIZER

- A. Fertilizer for all trees, shrubs and groundcovers shall be Sta-Green Nursery Special or equal delivered to the site in unopened containers.

- B. Fertilizer for grass shall be Sta-Green fertilizer containing the following percentages by weight:

- 18% nitrogen
- 24% phosphorus
- 10% potash

or approved equal. Fertilizer shall be uniform in composition, dry and free flowing, and shall be delivered to the site in the original, unopened container, bearing the manufacturer's guaranteed analysis. Fertilizer shall not have been exposed to weather prior to delivery to the site. After delivery until used, it shall be completely protected at all times. It shall not be stored in direct contact with the ground.

24 PLANTS

- A. All plants shall conform to or surpass minimum quality standards as defined by the American Association of Nurserymen (AAN), current edition of American Standard for Nursery Stock, published by the AAN, Inc. and in addition shall conform to sizes and descriptions in the plant list.

- B. All necessary inspection certificates shall be supplied to the Owner's representative for each shipment of plant material, as required by law.
- C. All plant materials shall be subject to inspection and approval. The Landscape Architect reserves the right to reject any and all plants which fail to meet this specification at any point during the installation of the job. All rejected materials shall be promptly removed from the site by the Contractor at no additional cost to the Owner.

- D. All plant materials furnished shall be well branched, proportioned with to height, of normal habit, sound healthy and vigorous in growth. The minimum acceptable sizes of plants shall be measured before pruning with branches in normal position and shall conform to measurements specified. Plants used where symmetry is required shall be matched as closely as possible. Plants shall meet all requirements as listed in the plant list.

- E. Plants shall be field nursery, container grown or collected material subject to the requirements of the specification.

- F. All plants shall be of healthy stock, free from disease, insects, eggs, larvae, and parasites of an objectionable or damaging nature.

- G. Balled and burlapped plant materials are to be wrapped with organic wrapping burlap only. Synthetic material will not be accepted. Remove all nursery labeling strips once plant material is placed in the pit.

25 MATERIAL FOR GUYING AND STAKING

- A. Stakes for supporting trees shall be sound timber, straight, sized as shown in planting details and of sufficient length to adequately support the plant. All visible surfaces shall be painted dark green or brown, but not black.

- B. Deadmen or stakes for anchoring guy wires in the ground shall be of size, material, and strength adequate to hold guy taut and maintain tree firmly in an upright position.

- C. Wire shall be #12 gauge galvanized wire in double twisted strand to adjust tension.

- D. Hose for encasing guy wires shall be new or suitable used 3/4 inch diameter rubber or plastic garden hose, black in color.

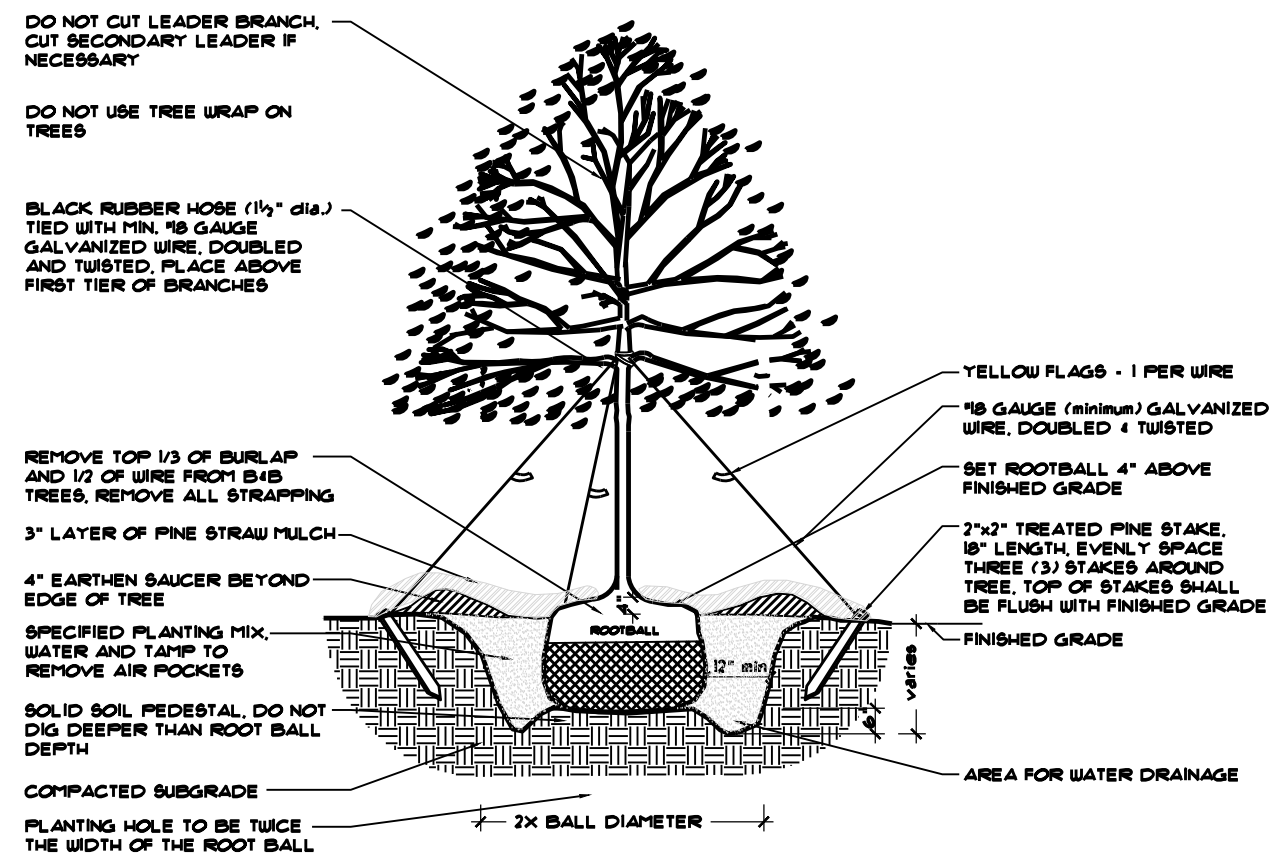

TREE PLANTING & GUYING DETAIL

NOT TO SCALE

TREE GUYING & STAKING PLAN

NOT TO SCALE

GENERAL LANDSCAPE NOTES:

- AN IRRIGATION SYSTEM SHALL BE INSTALLED FOR COVERAGE OF ALL PROPOSED TREE, SHRUB, GROUNDCOVER, AND RESCUE GRASSED AREAS UNLESS OTHERWISE NOTED. PROVIDE SEPERATION OF COVERAGE BETWEEN TURF AND SHRUB AREAS.
- ALL IRRIGATION SYSTEM COMPONENTS SHALL BE COMMERCIAL GRADE AND ADEQUATELY SIZED FOR THE SYSTEM. IRRIGATION CONTRACTOR SHALL SUBMIT SHOP DRAWINGS TO THE LANDSCAPE ARCHITECT FOR APPROVAL. UPON COMPLETION, CONTRACTOR SHALL FURNISH AN AS-BUILT PLAN FOR THE IRRIGATION SYSTEM TO THE OWNER.
- CONTRACTOR SHALL VERIFY PLANT COUNT FROM PLAN AND SHALL PROVIDE AND INSTALL ALL PLANT MATERIAL AS SHOWN ON PLAN. PLANT LIST IS PROVIDED FOR ASSISTANCE IN BID PREPARATION ONLY.
- THE CONTRACTOR SHALL REVIEW THE DRAWINGS AND NOTATIONS PRIOR TO COMMENCING WORK. VERIFY ANY DISCREPANCIES BETWEEN NOTES, DRAWINGS, AND FIELD CONDITIONS WITH THE LANDSCAPE ARCHITECT FOR CLARIFICATION.
- CONTRACTOR IS RESPONSIBLE FOR THE LOCATION OF ALL UTILITIES. DAMAGE TO UTILITIES SHALL BE REPAIRED EXPEDITIOUSLY AND AT THE EXPENSE OF THE CONTRACTOR.
- CARE SHALL BE TAKEN TO MINIMIZE DISTURBANCE TO EXISTING TREES.
- SHREDDED BROWN HARDWOOD MULCH TO BE USED IN ALL PLANTING AREAS

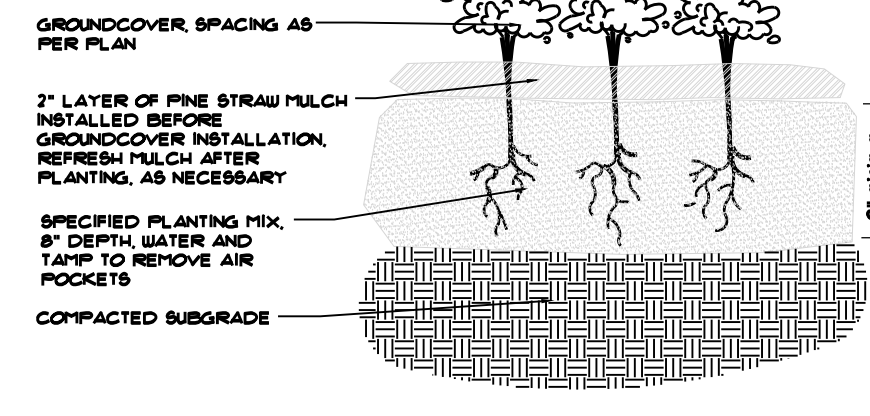
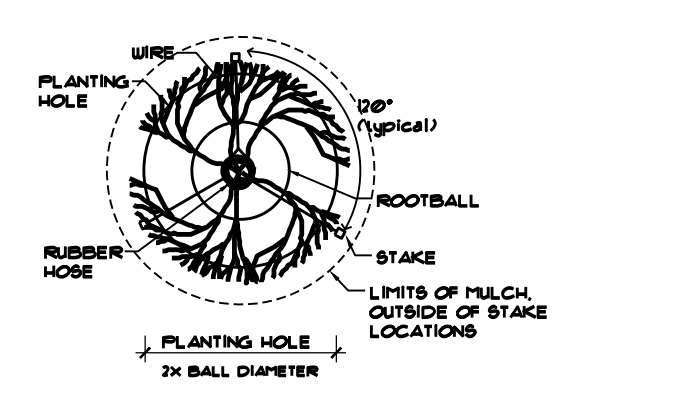

GROUNDCOVER DETAIL

NOT TO SCALE

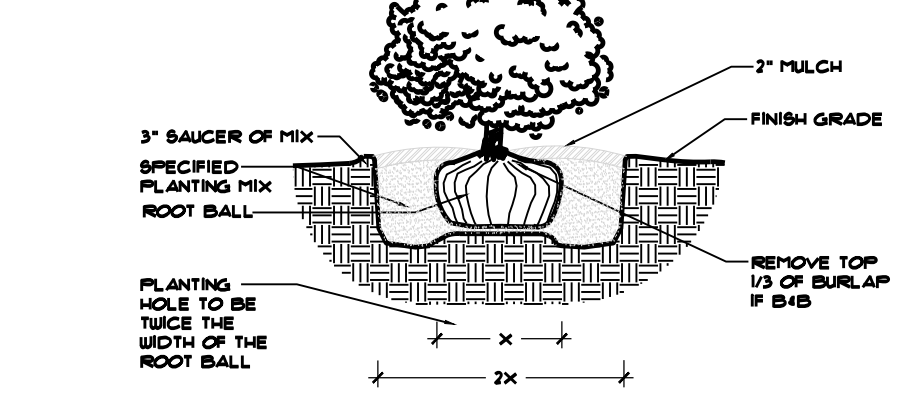

SHRUB PLANTING DETAIL

NOT TO SCALE

26 MULCH

- A. Brown Hardwood mulch shall be clean, fresh, free of noxious weeds, seed, fire ants, Japanese beetles and/or fringed beetles.

PART 3 - EXECUTION

31 TIME AND PLANTING

- A. Planting operations shall be during favorable weather in which conditions are neither extremely cold or hot, nor to the point that the risk of loss is too great. The Contractor shall inform the Landscape Architect of high risks due to weather.

32 EXCAVATION FOR PLANTING TREES AND SHRUBS

- A. Circular plant pits with vertical sides shall be dug by hand or machine methods for planting of trees and shrubs.
- B. Tree pit diameters shall be a minimum of two feet greater than the spread of the root mass.
- C. Shrub pit diameter shall be a minimum of one foot greater than the spread of the root mass.
- D. Contractor shall test excavated plant pits to satisfy himself that sufficient drainage is present for proper plant survival.

33 EXCAVATION FOR PLANTING GROUNDCOVERS

- A. Groundcover beds shall be scarified by hand or machine method to a minimum depth of eight inches. Three inches of peat humus additive and 20 pounds per 1000 square feet of Sta-Green Nursery Special fertilizer shall be uniformly incorporated into the soil to the full eight inch minimum depth.

34 DRAINAGE TEST

- A. Representative tree pits from each planting area shall be filled with water. If percolation is less than 100% within a period of 12 hours, drill a twelve-inch auger to a depth of four feet below the bottom of the pit. Retest the pit. In case drainage is still unsatisfactory notify Landscape Architect in writing of the condition before planting trees in the questionable areas. Contractor is fully responsible for warranty of the trees.

35 SETTING TREES, SHRUBS, GROUNDCOVERS

- A. Balled and container plants shall be placed firmly upon scarified sub-grade and backfilled with planting soil mixture. Remove all wire, cords, and burlap from top of root ball. Hand tamp carefully around and under ball to fill all voids. Water during backfilling. Form saucer from planting soil mixture in order to retain water.
- B. Shrub and groundcover beds shall be spot tested. C. Dispose of subsoil removed from landscape excavations. Do not mix with the planting soil. Do not use as backfill or use to construct saucers around pits.

36 TREE TRANSPORTATION

- A. The Contractor shall be responsible not only for the safe transportation of the plants to the site but also their condition upon arrival. Trees with abrasions of the bark, sunscalds, fresh cuts, or breaks of limbs which have not completely calloused will be rejected. Trees which have been damaged during transit will be replaced by the Contractor at no additional cost. All plant unit costs will reflect all the above listed specifications.

37 TREE TAGS

- A. All plants accepted at the nursery by the Landscape Architect shall be tagged with serialized self locking tags. Trees delivered to the site without these tags or with broken tags will be rejected. The tags shall remain on the trees until the Contractor has been given instructions by the Landscape Architect for their removal.

38 PRUNING

- A. Deciduous trees and shrubs shall have dead, broken, and crowded wood pruned to compensate for the loss of roots in transplanting. Requested and required additional pruning may be necessary at the direction of the Landscape Architect.
- B. Evergreen trees and shrubs shall be pruned only to thin out heavy growth.
- C. Cuts over 3/4 inch in diameter shall be painted with tree dressing paint. No paint containing lead shall be permitted.

39 GUYING, STAKING AND MULCHING

- A. Guy trees two-inch caliper and over. Space three guys equally about each tree, attached at approximately two-fifths up the trunk. Guys should be at a 45-degree angle and anchored in the ground with stakes. Guy to trunks with wire loops and black rubber hose drain snug in all directions. These guys shall be equally taut.
- B. Stake trees less than two inches caliper with two or three wood stakes driven two feet into the ground with the portion extending above the ground approximately one-half of the trunk height. Stake one foot from trunk, fastened at approximately two-fifths of trunk height with wire run through rubber hose.
- C. Mulch all planting beds and other areas designated to be mulched, with two inches of brown hardwood mulch. Individual plants are to be mulched as detailed. Mulch is to be measured after settlement.

310 UNIT COST

- A. All plant unit costs will reflect all the above listed specifications.

PART 4 - CLEANUP & PROTECTION & GENERAL

- A. During planting operations keep Project Site clean and orderly.
- B. Upon completion of work, clear grounds of debris, superfluous materials and all equipment. Remove from site to the satisfaction of the Landscape Architect and Owner.
- C. Protect all work and materials from damage due to irrigation operations, and operations by other contractors, trades, and trespassers. Maintain protection until Date of Substantial Completion.
- D. Contractor is responsible for theft of equipment and material at the job site before, during and after installation, until Date of Substantial Completion of the work in total.

PART 5 - ACCEPTANCE AND GUARANTEE

51 SUBSTANTIAL COMPLETION

- A. Submit written requests for inspection for Substantial Completion to the Landscape Architect at least seven calendar days prior to anticipated date of inspection and testing. At this time a "Punch List" will be written by the Landscape Architect for the Contractor to respond to in order to be granted Substantial Completion.

- B. Submit Record Drawings and Maintenance manuals to the Owner's Representative.

- C. Review the work, jointly with the Owner and Landscape Architect for Substantial Completion.

- D. Upon completion of repairs and replacements found necessary at the time of review, the Owner and Landscape Architect will confirm the date of Substantial Completion. If all items on the punch list have been taken care of. If necessary another punch list will be written to itemize any deficiencies still existing.

- E. The date of Substantial Completion will constitute the beginning date of the one-Year Guarantee.

52 GUARANTEE

- A. Guarantee all work, products, equipment and materials for one year, beginning at the Date of Substantial Completion.

- B. Make good any damage, loss, destruction or failure. Repairs and replacements shall be done promptly and at no additional cost to the Owner.

- C. Repair damage to grade, plants and other work as necessary.

- D. If the replacement is not acceptable during or at the end of the Guarantee Period, the Owner may elect either subsequent replacement or credit. Replacement products shall have a similar one-year guarantee from the time of replacement.

- E. Guarantee applies to all losses with the exception of those due to Acts of God, vandalism, or Owner neglect, as determined by the Landscape Architect.

53 FINAL INSPECTION AND ACCEPTANCE

- A. At the end of the Guarantee Period and upon request for inspection, jointly review all guaranteed work for Final Acceptance.

- B. Submit written request for inspection for Final Acceptance to the Landscape Architect at least two weeks prior to anticipated date of inspection. Include list of work substantially complete and a list of work replaced during Guarantee Period.

- C. Upon completion by the Contractor of all required replacements, the Owner and the Landscape Architect will confirm the date of Final Acceptance of the work.

END OF LANDSCAPE PLANTING SECTION

General Contractor to include a completely functioning Irrigation system based on the landscape plan provided. General Contractor to provide 3 feet of suitable topsoil in all landscape areas. City will provide all landscaping and Landscaping installation.



BARCLIFT ASSOCIATES
LANDSCAPE ARCHITECTURE
LAND PLANNING

3524 SUNDERLAND WAY NE
ATLANTA, GEORGIA 30319
404.375.8609

REVISIONS

DATE	DESCRIPTION

PROJECT:

PLAZA ENHANCEMENTS
LAFAYETTE SQUARE
RIDLEY AVENUE
LAGRANGE, GEORGIA

TITLE:

PLANTING DETAILS
AND SPECIFICATIONS

MODIFIED DATE:	JOB NO: 20-22
ISSUED DATE:	SHEET: LS-2
5 NOV 2020	



PRE-BID MEETING SIGN-IN

20-22 10 N LAFAYETTE SQUARE STREETScape ENHANCEMENTS

03 DEC 2020 @ 2 PM CITY HALL

COMPANY NAME	ATTENDEE NAME	PHONE NUMBER	EMAIL
City of LaGrange	Jeremy Andrews	706.594.8407	jandrews@lagrangega.org
Smith Design Group	Skip Smith	706.412.0226	skip@sdgarch.net
City of LaGrange	Bill Bulloch	912.486.0021	bbulloch@lagrangega.org
City of LaGrange	Mark C. Kostial	706.883.2088	mkostial@lagrangega.org
Principle Construction	Brent Conrad	706.616.7898	bconrad@principleco.com
Daniel Hamilton Assoc.	Cari Close	706.882.9980	ddaniel@daniel-hamilton.com
JHC Corp	Josh Fox	770.487.3258	jim@jhc-corp.com
JHC Corp	Caleb Cook	770.487.3258	jim@jhc-corp.com
Sesco Lighting	Tyler Coley	706.338.8402	tcoley@sescolighting.com