

## **Addendum #14**

### **East Lake Community Center Renovations**

**CONTRACT NO. Y-17-005**

#### **Bid schedule per this Addendum**

Pre-Bid Meeting            January 9<sup>th</sup>, 2020 at 10:00am  
Pre-Bid Meeting #2        February 18<sup>th</sup>, 2020 at 10:am  
Last Day for Questions    March 12th, 2020  
Bid Opening                March 17th, 2020 at 2:00 pm

#### **Attachments:**

#### **DRAWINGS**

##### **Architectural**

#### **Sheet A1.1D FIRST FLOOR DEMOLITION PLAN (Revision 1 dated March 5, 2020)**

- DEMOLITION-1<sup>ST</sup> FLOOR PLAN: modified to:
  - Change beginning “existing building, including...” to the following:
    - “existing building to be removed under separate “building demolition package”.
  - Delete the note beginning “existing basement foundation walls...”.
  - Added the following note:
    - “provide openings in existing construction as required for new doors, windows, etc. See architectural sheet A1.1 for exact opening locations”.

##### **Clarifications**

- The bid date will be extended to March 17<sup>th</sup> at 2PM to allow adjustments for this scope reduction.

END OF ADDENDUM #14

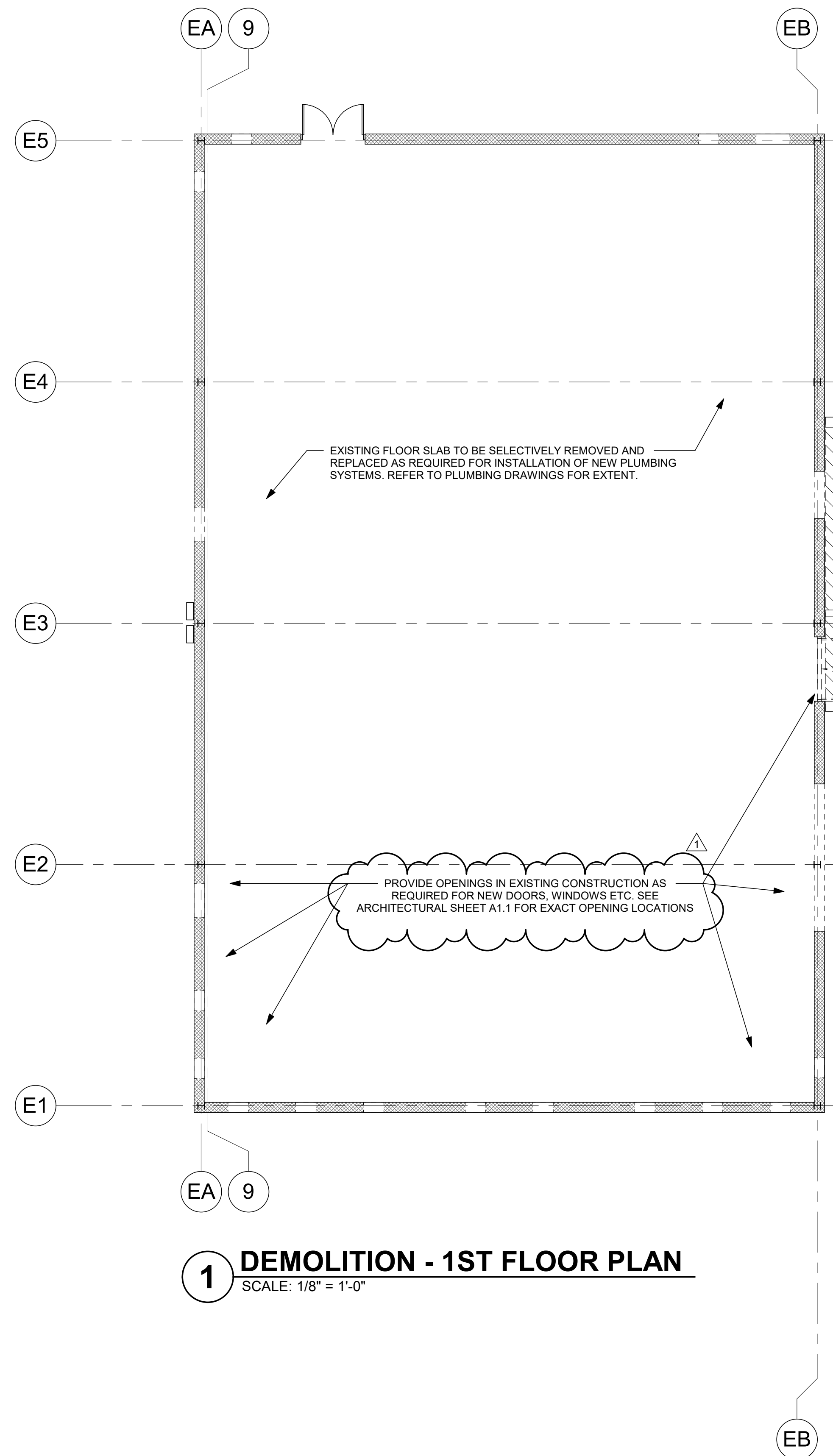

**1 DEMOLITION - 1ST FLOOR PLAN**  
SCALE: 1/8" = 1'-0"

← REFER TO SITE DEMOLITION DRAWINGS FOR ADDITIONAL REQUIREMENTS →

EXISTING BUILDING TO BE REMOVED UNDER SEPARATE 'BUILDING DEMOLITION PACKAGE'

EXISTING BUILDING TO BE REMOVED UNDER SEPARATE 'BUILDING DEMOLITION PACKAGE'

**GENERAL DEMOLITION NOTES**

- REFER TO SPECIFICATION SECTION SELECTIVE DEMOLITION FOR ADDITIONAL REQUIREMENTS.
- REFER TO FINISH SCHEDULE FOR ROOMS TO RECEIVE NEW FLOOR FINISH. CLEAN AND PROVIDE LEVELLING MATERIAL, OR WHERE HARD TILES HAVE BEEN REMOVED PROVIDE UNDERLAYMENT, PRIOR TO INSTALLATION OF NEW FLOOR FINISH.
- PROTECT ALL EXISTING FLOORS TO REMAIN IN ADJOINING UNAFFECTED AREAS OR OTHERWISE LEAVE FLOORS IN SAME CONDITION AS FOUND.
- SEE FINISH SCHEDULE AND REFLECTED CEILING PLANS FOR ROOMS TO RECEIVE NEW CEILINGS. CONTRACTOR SHALL TAKE INTO CONSIDERATION THAT EXISTING CEILINGS, THOUGH NOT INDICATED TO BE REPLACED, MUST BE REMOVED AND REINSTALLED TO ACCOMPLISH THE WORK, AND THAT THEY SHALL BE CAREFULLY REMOVED BEFORE THE WORK ABOVE THEM IS BEGUN AND SHALL BE STORED AND REINSTALLED AFTER THE WORK ABOVE THEM IS COMPLETED. ANY TILE OR GRID SYSTEMS WHICH ARE DAMAGED AS A RESULT OF THIS PROCESS SHALL BE REPLACED AT NO COST TO THE OWNER.
- WHERE EXISTING WALLS, CABINETS, COUNTERTOPS, DOOR FRAMES, CEILINGS, DUCTWORK, ELECTRICAL DEVICES AND EQUIPMENT, AND PLUMBING FIXTURES AND RELATED PIPING HAVE BEEN REMOVED, PATCH DAMAGED SURFACES TO MATCH ADJOINING SURFACES THAT WILL REMAIN EXPOSED. PATCH EXISTING SURFACES DISTURBED IN THE PROCESS OF INSTALLING THE AFOREMENTIONED ITEMS. PATCH EXISTING HOLES AND DEPRESSIONS IN THE EXISTING WALLS AND FLOOR SLABS. PATCHING MATERIAL SHALL BE SAME AS OR COMPATIBLE TO MATERIALS OF SURFACES TO BE PATCHED.
- WHERE RECESSED WALL DEVICES AND OTHER ACCESSORIES HAVE BEEN REMOVED FROM WALLS THAT REMAIN, PATCH OPENINGS AS REQUIRED TO MATCH EXISTING CONSTRUCTION.
- WHERE EXISTING WALLS HAVE BEEN REMOVED, PATCH DAMAGE TO ADJOINING WALLS WHICH ARE TO REMAIN.
- WHERE AN EXISTING OPENING IS CLOSED, OR AN EXISTING PARTITION IS EXTENDED WITH NEW WORK, FINISH FACE OF NEW WORK FLUSH WITH EXISTING FINISH.
- WHERE AN EXISTING PARTITION HAS BEEN REMOVED BETWEEN ROOMS AND THE ADJOINING FLOOR SURFACES ARE UNEVEN, THE FLOOR SURFACES SHALL BE LEVELLED TO EACH OTHER.
- SEE MECHANICAL, PLUMBING, AND ELECTRICAL DRAWINGS FOR ADDITIONAL WORK ABOVE AND BELOW EACH FLOOR STRUCTURE.
- REFER TO GENERAL NOTES, GENERAL PARTITION NOTES, AND PLAN NOTES FOR ADDITIONAL REQUIREMENTS.

**DEMOLITION OF UTILITIES**

- DEMOLITION OF ELECTRICAL SYSTEMS: REMOVE ONLY THOSE ELECTRICAL AND COMMUNICATIONS SYSTEMS SPECIFICALLY NOTED IN ELECTRICAL OR COMMUNICATIONS DRAWINGS TO BE REMOVED IN AFFECTED AREAS (I.E. REMOVE ALL CONDUIT, WIRING, FIXTURES, BOXES, RECEPTACLES, DEVICES, ETC.) SYSTEMS IN AFFECTED AREAS WHICH SERVE UNAFFECTED AREAS SHALL REMAIN INTACT. FOR EXISTING SYSTEMS TO REMAIN IN AFFECTED AREAS PROVIDE EXTENSIONS AS REQUIRED TO ALIGN DEVICES FLUSH WITH FACE OF NEW PARTITIONS.
- DEMOLITION OF PLUMBING SYSTEMS: REMOVE ALL FIXTURES AND RELATED PIPING IN AFFECTED AREAS UNLESS SPECIFICALLY NOTED ON PLUMBING DRAWINGS TO REMAIN. SYSTEMS IN AFFECTED AREAS THAT SERVE UNAFFECTED AREAS SHALL REMAIN INTACT.
- DEMOLITION OF MECHANICAL SYSTEMS: REMOVE ALL WINDOW UNITS, RADIATORS, GRILLES, DIFFUSERS, DUCTWORK, EQUIPMENT, ETC. NOT SPECIFICALLY NOTED IN MECHANICAL DRAWINGS TO REMAIN IN AFFECTED AREAS. SYSTEMS IN AFFECTED AREAS WHICH SERVE UNAFFECTED AREAS SHALL REMAIN INTACT.
- DEMOLITION OF ALL UTILITIES (PLUMBING, MECHANICAL, ELECTRICAL, COMMUNICATIONS): WHERE SYSTEMS ARE ABANDONED, REMOVE TO BEHIND WALLS, 2" BELOW FLOORS, OR 2" BELOW STRUCTURE ABOVE. CAP AND/OR SEAL ANY REMOVED SYSTEM WHICH REMAINS IN SERVICE CONSISTENT WITH BEST PRACTICES OF TRADE INVOLVED.
- ALL ELECTRICAL, COMMUNICATIONS, PLUMBING, OR MECHANICAL SYSTEMS IN AREAS NOT AFFECTED BY THIS WORK MUST REMAIN IN FULL SERVICE AT ALL TIMES. THE CONTRACTOR IS RESPONSIBLE FOR REPAIRING AND MAINTAINING SAME IF INTERRUPTED AS PART OF THIS WORK.
- REFER TO PLUMBING, MECHANICAL, ELECTRICAL, AND COMMUNICATIONS DRAWINGS FOR ADDITIONAL DEMOLITION REQUIREMENTS.

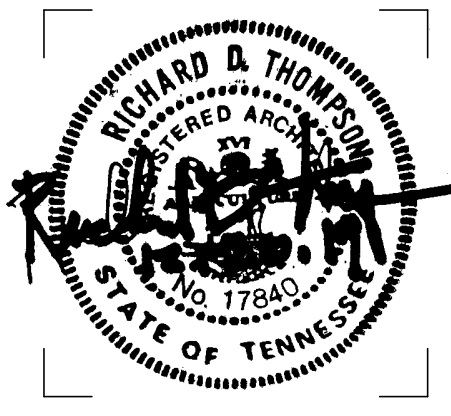

ISSUE DATES	
INITIAL ISSUE	12-20-19
1 Add 14	03-05-20

JOB NO. 18-072	D'WN Author	CK'D Checker
-------------------	----------------	-----------------