



Addendum No. 1

District Instructional Support Center Building Demolition

**McMillan Pazdan Smith Project No. 021264.00
September 27, 2021**

The following clarifications, amendments, additions, deletions, revisions, and/or modifications are hereby made a part of the Contract Documents, and change the original documents only in the manner and to the extent stated below:

Item No. 1: Include the attached Comprehensive Asbestos Inspection Report for the District Instructional Support Center Building into the contract documents.

This addendum contains

<u> 1 </u>	Summary Pages
<u> </u>	Pre-Bid Sign In Sheets
<u> </u>	Specification Sections
<u> </u>	30x42 Drawings
<u> 1 </u>	Inspection Report

End of Addendum No. 1



COMPREHENSIVE ASBESTOS INSPECTION REPORT

FOR

SPARTANBURG COUNTY SCHOOL DISTRICT #7

**717 Union Street
Spartanburg, SC 29306**

LOCATION

**DISC Building
698 Howard Street
Spartanburg, SC 29303**

INSPECTION DATE(S): April 15 & 22, 2020 & May 7, 2020

REPORT DATE: May 19, 2020

INSPECTOR(S)

**Evans Harris – SC-DHEC License #BI-01224
(864) 680-1233**

**Haley Jones – SC-DHEC License #BI-01733
(864) 541-8736**

For

**Crossroads Environmental, LLC
1258 Boiling Springs Road
Spartanburg, South Carolina 29303
(864) 541-8736
CRE Project # 17799-IN**

TABLE OF CONTENTS

INSPECTION REPORT/LETTER

- BACKGROUND INFORMATION
- BUILDING/AREA DESCRIPTION
- INSPECTION STRATEGY/SAMPLING PROTOCOL
- RESULTS
- RELEVANT REGULATORY REQUIREMENTS/RECOMMENDATIONS
- CLOSING STATEMENTS AND LIMITATIONS

ATTACHMENTS

- ATTACHMENT I: ASBESTOS SUMMARY TABLE
- ATTACHMENT II: LABORATORY REPORT(S)
- ATTACHMENT III: SAMPLE LOCATION SKETCH
- ATTACHMENT IV: INSPECTOR'S LICENSE/ACCREDITATION



May 19, 2020

Mr. Terry Gilmer
Spartanburg County School District #7
717 Union Street
Spartanburg, SC 29306

Re: Comprehensive Asbestos Inspection Report
DISC Building
698 Howard Street, Spartanburg, SC 29303
CRE Project Number: 17799-IN

Dear Mr. Gilmer:

Crossroads Environmental, LLC (CRE) completed a comprehensive asbestos inspection of the DISC Building, located at 698 Howard Street in Spartanburg, South Carolina on April 15 & 22, and May 7, 2020. The inspection was scheduled prior to proposed demolition of the structure, and was performed by SC-DHEC Licensed Asbestos Inspectors, in accordance with South Carolina Department of Health and Environmental Control (SC-DHEC) and Environmental Protection Agency (EPA) Requirements. **A detailed summary table of the sampling is included in Attachment I; however, this report should be read in its entirety.**

Building Description

The DISC Building is a single-story, brick veneer structure on a slab foundation. It features CMU wall construction and a flat, built-up roof system over metal decking. Interior finishes include various vinyl floor tile types, vinyl cove base, a drop ceiling grid with cellulose ceiling tile, limited carpet, and limited drywall accents.

Inspection Strategy/Sampling Protocol

The inspection consisted of grouping suspect asbestos containing materials into homogeneous areas based on the color and texture of the material, and then performing representative sampling of the materials included in those homogeneous areas. SC-DHEC has requirements for the minimum number of samples that can be collected from each homogeneous area (three samples of each miscellaneous material, three samples of each type of thermal system insulation, and the sample requirements

for surfacing are based on square footage). Following completion of the on-site inspection/sampling, samples were submitted to an accredited laboratory for analysis.

Stop positive analysis was requested on all materials except for surfacing (sprayed-on or troweled-on materials such as joint compound and fireproofing). Stop positive analysis means that if one sample of a material in a homogeneous area is found to contain asbestos, then the other samples of that material are not analyzed, but are assumed to contain asbestos based on the results from the first sample analyzed.

As of June 27, 2008, SC-DHEC requires that any non-friable organically bound (NOB) material that is suspect to contain asbestos, such as floor tile, mastics, roofing material, and caulking must be analyzed by transmission electron microscopy (TEM) if polarized light microscopy (PLM) analyses of that material indicate that no asbestos was detected.

Results

EPA recognizes a material as Asbestos Containing Material (ACM) if an asbestos content of greater than one percent asbestos is detected in a representative sample analyzed by polarized light microscopy. It should be noted that items containing <1% asbestos are covered to some extent by the OSHA's Asbestos Standard for the Construction Industry (29 CFR 1926.1101).

Results indicated that greater than one percent asbestos was detected in the roof system(s) perimeter and equipment flashing(s).

Relevant Regulatory Requirements/Recommendations

Friability-Friable materials are defined as materials that can be reduced to powder by hand pressure. It should be noted that non-friable materials may become friable depending on the method of removal. All non-friable materials must be removed by properly accredited asbestos personnel. If the non-friable materials are removed in a friable manner, then all regulations in regards to friable abatement will apply, and the abatement must be performed by a SC-DHEC Licensed Asbestos Contractor, and in accordance with all state and federal regulations.

Closing Statements and Limitations

Every effort was made to identify all materials in accessible areas. There is the possibility that suspect materials were not identified in inaccessible areas. If any suspect material is discovered that is not included within this report, it should be sampled before it is physically disturbed.

This document has been prepared by Crossroads Environmental, LLC at the request of and for the exclusive use of Spartanburg County School District #7. This report represents the findings from the date that it was inspected, and is limited in scope to that indicated above.

Crossroads Environmental, LLC appreciates the opportunity to provide Spartanburg County School District #7 with our consultative services. Should you have any questions or need additional information, please do not hesitate to contact us.

Sincerely,



Haley Jones
Licensed Inspector



Evans Harris
Licensed Inspector



Kay H. Horton
President

HJ

Attachments – (4)

ATTACHMENT I
ASBESTOS SUMMARY TABLE

CROSSROADS ENVIRONMENTAL, LLC ASBESTOS INSPECTION REPORT								CRE JOB #: 17799-IN	
Location:		DISC Building, 698 Howard Street, Spartanburg, SC 29303							
Client:		SCSD#7						DATE: April 15 & 22 and May 7, 2020	
Key: A=Amosite, C=Chrysotile, Cr=Crocidolite, Tr=Tremolite, Ac=Actinolite Asbestos, Misc.=Miscellaneous, HA#=Homogeneous Area #, PLM=Polarized Light Microscopy, TEM=Transmission Electron Microscopy, /=PLM and/or TEM Analysis Not Required sq.ft.=Square Feet, cu.ft.=Cubic Feet, In.ft.=Linear Feet, HJI=Hard Joint Insulation, TSI=Thermal System Insulation, BUR=Built-up Roofing, Surf=Surfacing NAD=No Asbestos Detected, SP=Stop Positive									
HA#	Type of Material TSI, Surf, Misc.	Material Type	Sample Number	Asbestos Content (PLM)	Asbestos Content (TEM)	Location of Sample	Approx. Quantity	Physical Condition	Location/ Comments
01	Misc.	Gray Cove Base w/ Tan Glue	001-Cove Base 001-Glue	NAD NAD	/ /	Psych Storage (2)	N/A	N/A	Located in Psych Storage (2) and Photo Room.
			002-Cove Base 002-Glue	NAD NAD	/ /	Photo Room			
			003-Cove Base 003-Glue	/ /	NAD NAD	Photo Room			
02	Misc.	12"x12" Dark Blue Vinyl Floor Tile w/ Blue Streaks	004-Tile 004-Mastic 004-Leveling Compound	NAD NAD NAD	/ / /	Conference Room Restroom	N/A	N/A	Located in the Conference Room at the sink and associated restroom.
			005-Tile 005-Mastic 005-Leveling Compound	NAD NAD NAD	/ / /	Conference Room Restroom			
			006-Tile 006-Mastic 006-Leveling Compound	/ / NAD	NAD NAD /	Conference Room Restroom			
03	Surf.	Wall Texture	007	NAD	/	Conference Room	N/A	N/A	Located in the Conference Room Restroom; Christmas Tree Storage; Photo Room; IMC (1); Reading Room (1) Office; and Break Room.
			008	NAD	/	IMC (1)			
			009	NAD	/	Reading Room (2)			

CROSSROADS ENVIRONMENTAL, LLC ASBESTOS INSPECTION REPORT							CRE JOB #: 17799-IN		
Location:		DISC Building, 698 Howard Street, Spartanburg, SC 29303							
Client:		SCSD#7					DATE: April 15 & 22 and May 7, 2020		
Key: A=Amosite, C=Chrysotile, Cr=Crocidolite, Tr=Tremolite, Ac=Actinolite Asbestos, Misc.=Miscellaneous, HA#=Homogeneous Area #, PLM=Polarized Light Microscopy, TEM=Transmission Electron Microscopy, /=PLM and/or TEM Analysis Not Required sq.ft.=Square Feet, cu.ft.=Cubic Feet, ln.ft.=Linear Feet, HJI=Hard Joint Insulation, TSI=Thermal System Insulation, BUR=Built-up Roofing, Surf=Surfacing NAD=No Asbestos Detected, SP=Stop Positive									
HA#	Type of Material TSI, Surf, Misc.	Material Type	Sample Number	Asbestos Content (PLM)	Asbestos Content (TEM)	Location of Sample	Approx. Quantity	Physical Condition	Location/ Comments
04	Misc.	12"x12" Tan Vinyl Floor Tile w/ Brown Streaks	010-Tile	NAD	/	IMC Restroom	N/A	N/A	Located in the hallway; IMC (1) Restroom; and IMC Storage.
			010-Yellow Mastic	NAD	NAD				
			010-Leveling Compound	NAD	/				
			010-Black Mastic	NAD	/	Hallway @ Entrance			
			011-Tile	NAD	/	Hallway @ File Box			
012-Tile	/	NAD							
012-Black Mastic	/	NAD							
05	Misc.	Brown Cove Base	013	NAD	/	IMC Storage	N/A	N/A	Located throughout the hallway; IMC (1) Restroom; IMC (1); and IMC Storage.
			014	NAD	/	IMC (1) Restroom			
			015	/	NAD	Hallway @ Entrance			

CROSSROADS ENVIRONMENTAL, LLC ASBESTOS INSPECTION REPORT							CRE JOB #: 17799-IN		
Location:		DISC Building, 698 Howard Street, Spartanburg, SC 29303							
Client:		SCSD#7					DATE: April 15 & 22 and May 7, 2020		
<p>Key: A=Amosite, C=Chrysotile, Cr=Crocidolite, Tr=Tremolite, Ac=Actinolite Asbestos, Misc.=Miscellaneous, HA#=Homogeneous Area #, PLM=Polarized Light Microscopy, TEM=Transmission Electron Microscopy, /=PLM and/or TEM Analysis Not Required sq.ft.=Square Feet, cu.ft.=Cubic Feet, ln.ft.=Linear Feet, HJI=Hard Joint Insulation, TSI=Thermal System Insulation, BUR=Built-up Roofing, Surf=Surfacing NAD=No Asbestos Detected, SP=Stop Positive</p>									
HA#	Type of Material TSI, Surf, Misc.	Material Type	Sample Number	Asbestos Content (PLM)	Asbestos Content (TEM)	Location of Sample	Approx. Quantity	Physical Condition	Location/ Comments
06	Misc.	12"x12" Turquoise Vinyl Floor Tile	016-Tile 016-Mastic	NAD NAD	/ /	Psych Storage (1)	N/A	N/A	Located in psych storage (1); test storage; Christmas storage; psych storage (2) office; loose pile in IMC Storage; reading room (1); reading room (1) office and associated electrical room; technology room; reading room (2); and file/box storage; curriculum library; main office work area; file storage; outside main office restroom; hallway to alternative services office and associated storage; dining room; break room; parent liason hallway; hallwayhallway to all psych rooms; speech offic (2), and waiting.
			017-Tile 017-Mastic	NAD NAD	/ /	Reading Room (2)			
			018-Tile 018-Mastic	/ /	NAD NAD	Outside Psych. #5			

CROSSROADS ENVIRONMENTAL, LLC ASBESTOS INSPECTION REPORT								CRE JOB #: 17799-IN	
Location:		DISC Building, 698 Howard Street, Spartanburg, SC 29303							
Client:		SCSD#7						DATE: April 15 & 22 and May 7, 2020	
Key: A=Amosite, C=Chrysotile, Cr=Crocidolite, Tr=Tremolite, Ac=Actinolite Asbestos, Misc.=Miscellaneous, HA#=Homogeneous Area #, PLM=Polarized Light Microscopy, TEM=Transmission Electron Microscopy, /=PLM and/or TEM Analysis Not Required sq.ft.=Square Feet, cu.ft.=Cubic Feet, In.ft.=Linear Feet, HJI=Hard Joint Insulation, TSI=Thermal System Insulation, BUR=Built-up Roofing, Surf=Surfacing NAD=No Asbestos Detected, SP=Stop Positive									
HA#	Type of Material TSI, Surf, Misc.	Material Type	Sample Number	Asbestos Content (PLM)	Asbestos Content (TEM)	Location of Sample	Approx. Quantity	Physical Condition	Location/ Comments
07	Misc.	6" Turquoise Cove Base	019	NAD	/	Psych Storage (1)	N/A	N/A	Located in psych stoage (1); test storage; and Christmas Storage.
			020	NAD	/	Psych Storage (1)			
			021	/	NAD	Christmas Storage			
08	Misc.	3" Turquoise Cove Base	022	NAD	/	Psych Storage (2) Office	N/A	N/A	Located in psych storage (2) office; IMC (2); reading room (1); technology room; reading room (2) and associated offices; file/box storage; curriculum library; main office; work area; file storage; alternative services office and associated storage; dining room; break room; vestibule; alternative services; psych (1); parent liason; parent liason hallway; special ed coordinator; psych (2); psych (3); psych (1) office; psych (6); psych (5); psych (4); hallway to all psych rooms; speech; speech office; speech office (2); waiting area.
			023	NAD	/	Curriculum Library			
			024	/	NAD	Psych (1) Office			

CROSSROADS ENVIRONMENTAL, LLC ASBESTOS INSPECTION REPORT								CRE JOB #: 17799-IN	
Location:		DISC Building, 698 Howard Street, Spartanburg, SC 29303							
Client:		SCSD#7						DATE: April 15 & 22 and May 7, 2020	
<p>Key: A=Amosite, C=Chrysotile, Cr=Crocidolite, Tr=Tremolite, Ac=Actinolite Asbestos, Misc.=Miscellaneous, HA#=Homogeneous Area #, PLM=Polarized Light Microscopy, TEM=Transmission Electron Microscopy, /=PLM and/or TEM Analysis Not Required sq.ft.=Square Feet, cu.ft.=Cubic Feet, In.ft.=Linear Feet, HJI=Hard Joint Insulation, TSI=Thermal System Insulation, BUR=Built-up Roofing, Surf=Surfacing NAD=No Asbestos Detected, SP=Stop Positive</p>									
HA#	Type of Material TSI, Surf, Misc.	Material Type	Sample Number	Asbestos Content (PLM)	Asbestos Content (TEM)	Location of Sample	Approx. Quantity	Physical Condition	Location/ Comments
09	Misc.	12"x12" Gray Vinyl Floor Tile w/ White & Gray Streaks	025-Tile	NAD	/	Photo Room	N/A	N/A	Located in the photo room.
			025-Yellow Mastic	NAD	/				
			025-Black Mastic	NAD	/				
			026-Tile	NAD	/	Photo Room			
			026-Yellow Mastic	NAD	/				
			026-Black Mastic	NAD	/				
027-Tile	/	NAD	Photo Room						
027-Yellow Mastic	/	NAD							
027-Black Mastic	/	NAD							
10	Misc.	2'x2' Ceiling Tile w/ Pinholes & Large Holes	028	NAD	/	Reading (1) Office	N/A	N/A	Located in speech room; speech room office; speech room office (2); waiting area; psych storage (2) office; photo room; reading (1) office; reading (2) offices; file/box storage; curriculum library; file storage; main office; alternative services office; dining; break room; vestibule; parent liason hallway; parent liason; alternative services; psych (1); special ed coordinator; psych rooms hallway; psych (1) office; psych (2); psych (3); psych (4); psych (6); psych (7).
			029	NAD	/	Curriculum Library			
			030	NAD	/	Alternative Services Office			

CROSSROADS ENVIRONMENTAL, LLC ASBESTOS INSPECTION REPORT								CRE JOB #: 17799-IN	
Location:		DISC Building, 698 Howard Street, Spartanburg, SC 29303							
Client:		SCSD#7						DATE: April 15 & 22 and May 7, 2020	
Key: A=Amosite, C=Chrysotile, Cr=Crocidolite, Tr=Tremolite, Ac=Actinolite Asbestos, Misc.=Miscellaneous, HA#=Homogeneous Area #, PLM=Polarized Light Microscopy, TEM=Transmission Electron Microscopy, /=PLM and/or TEM Analysis Not Required sq.ft.=Square Feet, cu.ft.=Cubic Feet, In.ft.=Linear Feet, HJI=Hard Joint Insulation, TSI=Thermal System Insulation, BUR=Built-up Roofing, Surf=Surfacing NAD=No Asbestos Detected, SP=Stop Positive									
HA#	Type of Material TSI, Surf, Misc.	Material Type	Sample Number	Asbestos Content (PLM)	Asbestos Content (TEM)	Location of Sample	Approx. Quantity	Physical Condition	Location/ Comments
11	Misc.	2'x4' Ceiling Tile w./ Pinholes & Large Holes	031	NAD	/	Hallway @ Psych Storage (2)	N/A	N/A	Located throughout hallway; psych storage rooms; test storage; Christmas storage; IMC storage; reading (1); technology room; reading (2).
			032	NAD	/	Reading Room (2)			
			033	NAD	/	Psych Storage (1)			
12	Misc.	2'x4' Ceiling Tile w/ Pinholes & Gashes	034	NAD	/	Conference Room	N/A	N/A	Located in the conference room and associated restroom; psych storage (1); test storage; psych storage (2) office; IMC (1); IMC (1) restroom; IMC storage; IMC (2); reading (1); technology room; file/box storage; curriculum library; main office; special ed coordinator; psych (4); psych rooms hallway.
			035	NAD	/	IMC (1)			
			036	NAD	/	Curriculum Library			

CROSSROADS ENVIRONMENTAL, LLC ASBESTOS INSPECTION REPORT							CRE JOB #: 17799-IN		
Location:	DISC Building, 698 Howard Street, Spartanburg, SC 29303								
Client:	SCSD#7						DATE: April 15 & 22 and May 7, 2020		
Key: A=Amosite, C=Chrysotile, Cr=Crocidolite, Tr=Tremolite, Ac=Actinolite Asbestos, Misc.=Miscellaneous, HA#=Homogeneous Area #, PLM=Polarized Light Microscopy, TEM=Transmission Electron Microscopy, /=PLM and/or TEM Analysis Not Required sq.ft.=Square Feet, cu.ft.=Cubic Feet, In.ft.=Linear Feet, HJI=Hard Joint Insulation, TSI=Thermal System Insulation, BUR=Built-up Roofing, Surf=Surfacing NAD=No Asbestos Detected, SP=Stop Positive									
HA#	Type of Material TSI, Surf, Misc.	Material Type	Sample Number	Asbestos Content (PLM)	Asbestos Content (TEM)	Location of Sample	Approx. Quantity	Physical Condition	Location/ Comments
13	Misc.	2'x4' Ceiling Tile w/ Pinholes & Squiggles	037	NAD	/	Conference Room	N/A	N/A	Located as replacement tiles in the conference room and hallway.
			038	NAD	/	Conference Room			
			039	NAD	/	Hallway @ Entrance			
14	Misc.	Dark Gray Cove Base	040	NAD	/	Conference Room	N/A	N/A	Located in the conference room and associated restroom.
			041	NAD	/	Conference Room			
			042	/	NAD	Conference Room Restroom			

CROSSROADS ENVIRONMENTAL, LLC ASBESTOS INSPECTION REPORT							CRE JOB #: 17799-IN		
Location:		DISC Building, 698 Howard Street, Spartanburg, SC 29303							
Client:		SCSD#7					DATE: April 15 & 22 and May 7, 2020		
<p>Key: A=Amosite, C=Chrysotile, Cr=Crocidolite, Tr=Tremolite, Ac=Actinolite Asbestos, Misc.=Miscellaneous, HA#=Homogeneous Area #, PLM=Polarized Light Microscopy, TEM=Transmission Electron Microscopy, /=PLM and/or TEM Analysis Not Required sq.ft.=Square Feet, cu.ft.=Cubic Feet, In.ft.=Linear Feet, HJI=Hard Joint Insulation, TSI=Thermal System Insulation, BUR=Built-up Roofing, Surf=Surfacing NAD=No Asbestos Detected, SP=Stop Positive</p>									
HA#	Type of Material TSI, Surf, Misc.	Material Type	Sample Number	Asbestos Content (PLM)	Asbestos Content (TEM)	Location of Sample	Approx. Quantity	Physical Condition	Location/ Comments
15	Surf.	Drywall/Joint Compound	043-Joint Compound 043-Drywall	NAD NAD	/ /	Christmas Storage	N/A	N/A	Located on limited dividing walls and ceilings throughout.
			044-Joint Compound 044-Drywall	NAD NAD	/ /	Psych Storage (2) Office			
			045-Joint Compound 045-Drywall	NAD NAD	/ /	Reading (2) Office (2)			
			046-Joint Compound 046-Drywall	NAD NAD	/ /	Special Ed Coordinator			
			047-Joint Compound 047-Drywall	NAD NAD	/ /	Psych (4)			
			047A-Joint Comp. 047A-Drywall	NAD NAD	/ /	Office 113			
			047B-Joint Comp. 047B-Drywall	NAD NAD	/ /	Central, main office area			

CROSSROADS ENVIRONMENTAL, LLC ASBESTOS INSPECTION REPORT							CRE JOB #: 17799-IN		
Location:		DISC Building, 698 Howard Street, Spartanburg, SC 29303							
Client:		SCSD#7					DATE: April 15 & 22 and May 7, 2020		
<p>Key: A=Amosite, C=Chrysotile, Cr=Crocidolite, Tr=Tremolite, Ac=Actinolite Asbestos, Misc.=Miscellaneous, HA#=Homogeneous Area #, PLM=Polarized Light Microscopy, TEM=Transmission Electron Microscopy, /=PLM and/or TEM Analysis Not Required sq.ft.=Square Feet, cu.ft.=Cubic Feet, ln.ft.=Linear Feet, HJI=Hard Joint Insulation, TSI=Thermal System Insulation, BUR=Built-up Roofing, Surf=Surfacing NAD=No Asbestos Detected, SP=Stop Positive</p>									
HA#	Type of Material TSI, Surf, Misc.	Material Type	Sample Number	Asbestos Content (PLM)	Asbestos Content (TEM)	Location of Sample	Approx. Quantity	Physical Condition	Location/ Comments
16	Misc.	Carpet Glue	048	NAD	/	Conference Room	N/A	N/A	Located in the conference room.
			049	NAD	/	Conference Room			
			050	/	NAD	Conference Room			
17	Misc.	Carpet Glue	051	NAD	/	Reading room (2) Office (1)	N/A	N/A	Located in reading room (1) office; reading room (2) offices; main office; alternative services; parent liason; psych (1); special ed coordinator; all psych rooms.
			052	NAD	/	Main Office			
			053	/	NAD	Psych (1) Office			

CROSSROADS ENVIRONMENTAL, LLC ASBESTOS INSPECTION REPORT							CRE JOB #: 17799-IN		
Location:		DISC Building, 698 Howard Street, Spartanburg, SC 29303							
Client:		SCSD#7					DATE: April 15 & 22 and May 7, 2020		
Key: A=Amosite, C=Chrysotile, Cr=Crocidolite, Tr=Tremolite, Ac=Actinolite Asbestos, Misc.=Miscellaneous, HA#=Homogeneous Area #, PLM=Polarized Light Microscopy, TEM=Transmission Electron Microscopy, /=PLM and/or TEM Analysis Not Required sq.ft.=Square Feet, cu.ft.=Cubic Feet, In.ft.=Linear Feet, HJI=Hard Joint Insulation, TSI=Thermal System Insulation, BUR=Built-up Roofing, Surf=Surfacing NAD=No Asbestos Detected, SP=Stop Positive									
HA#	Type of Material TSI, Surf, Misc.	Material Type	Sample Number	Asbestos Content (PLM)	Asbestos Content (TEM)	Location of Sample	Approx. Quantity	Physical Condition	Location/ Comments
18	Misc.	Gray Cove Base w/ Cream Glue	054-Cove Base 054-Glue	NAD NAD	/	Dining Room Restroom	N/A	N/A	Located in the dining room restroom.
			055-Cove Base 055-Glue	NAD NAD	/	Dining Room Restroom			
			056-Cove Base 056-Glue	/	NAD NAD	Dining Room Restroom			
19	Misc.	Red Firestop	057	NAD	/	Above Drop Ceiling in Hallway	N/A	N/A	Located throughout the building at wall penetrations, above the drop ceiling.
			058	NAD	/	Above Drop Ceiling in Hallway			
			059	/	NAD	Above Drop Ceiling in Hallway			

CROSSROADS ENVIRONMENTAL, LLC ASBESTOS INSPECTION REPORT							CRE JOB #: 17799-IN			
Location:		DISC Building, 698 Howard Street, Spartanburg, SC 29303								
Client:		SCSD#7						DATE: April 15 & 22 and May 7, 2020		
<p>Key: A=Amosite, C=Chrysotile, Cr=Crocidolite, Tr=Tremolite, Ac=Actinolite Asbestos, Misc.=Miscellaneous, HA#=Homogeneous Area #, PLM=Polarized Light Microscopy, TEM=Transmission Electron Microscopy, /=PLM and/or TEM Analysis Not Required sq.ft.=Square Feet, cu.ft.=Cubic Feet, In.ft.=Linear Feet, HJI=Hard Joint Insulation, TSI=Thermal System Insulation, BUR=Built-up Roofing, Surf=Surfacing NAD=No Asbestos Detected, SP=Stop Positive</p>										
HA#	Type of Material TSI, Surf, Misc.	Material Type	Sample Number	Asbestos Content (PLM)	Asbestos Content (TEM)	Location of Sample	Approx. Quantity	Physical Condition	Location/ Comments	
20	Surf.	Blown-In Insulation	060	NAD	/	Corridor b/w Special Ed Coordinator & Main Office	N/A	N/A	Located above drop ceiling along concrete walls just below decking in exit corridor between special ed coordinator and main office.	
			061	NAD	/	Corridor b/w Special Ed Coordinator & Main Office				
			062	NAD	/	Corridor b/w Special Ed Coordinator & Main Office				
			063	NAD	/	Corridor b/w Special Ed Coordinator & Main Office				
			064	NAD	/	Corridor b/w Special Ed Coordinator & Main Office				

CROSSROADS ENVIRONMENTAL, LLC ASBESTOS INSPECTION REPORT								CRE JOB #: 17799-IN	
Location:		DISC Building, 698 Howard Street, Spartanburg, SC 29303							
Client:		SCSD#7						DATE: April 15 & 22 and May 7, 2020	
Key: A=Amosite, C=Chrysotile, Cr=Crocidolite, Tr=Tremolite, Ac=Actinolite Asbestos, Misc.=Miscellaneous, HA#=Homogeneous Area #, PLM=Polarized Light Microscopy, TEM=Transmission Electron Microscopy, /=PLM and/or TEM Analysis Not Required sq.ft.=Square Feet, cu.ft.=Cubic Feet, In.ft.=Linear Feet, HJI=Hard Joint Insulation, TSI=Thermal System Insulation, BUR=Built-up Roofing, Surf=Surfacing NAD=No Asbestos Detected, SP=Stop Positive									
HA#	Type of Material TSI, Surf, Misc.	Material Type	Sample Number	Asbestos Content (PLM)	Asbestos Content (TEM)	Location of Sample	Approx. Quantity	Physical Condition	Location/ Comments
21	Misc.	Brown Caulk	065	NAD	/	Southeast Window	N/A	N/A	Loated on the top window of all tall windows around the building.
			066	NAD	/	Southwest Window			
			067	/	NAD	Northwest Window			
22	Misc.	Light Brown Caulk	068-Brown 068-Black	NAD NAD	/ /	Southeast Window	N/A	N/A	Located around all long windows.
			069-Brown 069-Black	NAD NAD	/ /	Southwest Window			
			070-Brown 070-Black	/ /	NAD NAD	Northwest Window			
23	Misc.	Joint Caulk	071	NAD	/	Southwest Side	N/A	N/A	Located as a sealant at exterior joints of the building.
			072	NAD	/	Southwest Side			
			073	/	NAD	Southwest Side			
24	Misc.	Black Caulk over Foam	074	NAD	/	Front	N/A	N/A	Located around all entrance/exit doors.
			075	NAD	/	Side			
			076	/	NAD	Back			

CROSSROADS ENVIRONMENTAL, LLC ASBESTOS INSPECTION REPORT								CRE JOB #: 17799-IN	
Location:		DISC Building, 698 Howard Street, Spartanburg, SC 29303							
Client:		SCSD#7						DATE: April 15 & 22 and May 7, 2020	
<p>Key: A=Amosite, C=Chrysotile, Cr=Crocidolite, Tr=Tremolite, Ac=Actinolite Asbestos, Misc.=Miscellaneous, HA#=Homogeneous Area #, PLM=Polarized Light Microscopy, TEM=Transmission Electron Microscopy, /=PLM and/or TEM Analysis Not Required sq.ft.=Square Feet, cu.ft.=Cubic Feet, In.ft.=Linear Feet, HJI=Hard Joint Insulation, TSI=Thermal System Insulation, BUR=Built-up Roofing, Surf=Surfacing NAD=No Asbestos Detected, SP=Stop Positive</p>									
HA#	Type of Material TSI, Surf, Misc.	Material Type	Sample Number	Asbestos Content (PLM)	Asbestos Content (TEM)	Location of Sample	Approx. Quantity	Physical Condition	Location/ Comments
25	Misc.	Gray Caulk	077	NAD	/	Front	N/A	N/A	Located around all doors/windows at the back of the building.
			078	NAD	/	Side			
			079	/	NAD	Back			
26	Surf.	Stucco Material	080	NAD	/	Front	N/A	N/A	Located above exterior entrance/exit corridors.
			081	NAD	/	Side			
			082	NAD	/	Back			
27	Misc.	Tar & Gravel BUR	R200-BUR R200- Perlite Insulation	NAD NAD	/ /	Main Roof	N/A	N/A	Located as the main roof.
			R201-BUR R201- Perlite Insulation	NAD NAD	/ /	Main Roof			
			R202-BUR R202- Perlite Insulation	/ NAD	NAD /	Main Roof			
28	Misc.	Tar & Gravel BUR	R203-BUR R203-Insulation	NAD NAD	/ /	Roof Over Speech	N/A	N/A	Located as the main roof and roof over Speech.
			R204-BUR R204-Insulation	NAD NAD	/ /	Main Roof			
			R205-BUR R205-Insulation	/ NAD	NAD /	Main Roof			

CROSSROADS ENVIRONMENTAL, LLC ASBESTOS INSPECTION REPORT								CRE JOB #: 17799-IN	
Location:		DISC Building, 698 Howard Street, Spartanburg, SC 29303							
Client:		SCSD#7						DATE: April 15 & 22 and May 7, 2020	
<p>Key: A=Amosite, C=Chrysotile, Cr=Crocidolite, Tr=Tremolite, Ac=Actinolite Asbestos, Misc.=Miscellaneous, HA#=Homogeneous Area #, PLM=Polarized Light Microscopy, TEM=Transmission Electron Microscopy, /=PLM and/or TEM Analysis Not Required sq.ft.=Square Feet, cu.ft.=Cubic Feet, In.ft.=Linear Feet, HJI=Hard Joint Insulation, TSI=Thermal System Insulation, BUR=Built-up Roofing, Surf=Surfacing NAD=No Asbestos Detected, SP=Stop Positive</p>									
HA#	Type of Material TSI, Surf, Misc.	Material Type	Sample Number	Asbestos Content (PLM)	Asbestos Content (TEM)	Location of Sample	Approx. Quantity	Physical Condition	Location/ Comments
29	Misc.	Perimeter Flashing	R206-Silver Paint R206-Flashing R206-Insulation	3% C 5% C NAD	/ / /	Main Roof	760 In. ft.	Good; Non-Friable	Located at perimeter walls of both the main roof, and roof over speech.
			R207-Silver Paint R207-Flashing R207-Insulation	SP	/	Roof Over Speech			
			R208-Silver Paint R208-Flashing R208-Insulation	/	SP	Main Roof			
30	Misc.	Equipment Flashing	R209	10% C	/	Main Roof Equipment	20 In. ft.	Good; Non-Friable	Located on all mechanical equipment on roofs.
			R210	SP	/	Speech Roof Equipment			
			R211	/	SP	Speech Roof Equipment			
31	Misc.	Modified Bitumen Patch	R212-Patch R212-Insulation	NAD NAD	/ /	Main Roof	N/A	Good; Non-Friable	Located as patches on the main roof.
			R213-Patch R213-Insulation	NAD NAD	/ /	Main Roof			
			R214-Patch R214-Insulation	/ NAD	NAD /	Main Roof			
32	Misc.	Ceiling Grid Caulk	083	NAD	/	Conference Room	N/A	Good; Non-Friable	Located where the metal grid frame meets CMU wall(s).
			084	NAD	/	Psych Storage (1)			
			085	/	NAD	IMC (1)			

CROSSROADS ENVIRONMENTAL, LLC ASBESTOS INSPECTION REPORT							CRE JOB #: 17799-IN		
Location:		DISC Building, 698 Howard Street, Spartanburg, SC 29303							
Client:		SCSD#7					DATE: April 15 & 22 and May 7, 2020		
Key: A=Amosite, C=Chrysotile, Cr=Crocidolite, Tr=Tremolite, Ac=Actinolite Asbestos, Misc.=Miscellaneous, HA#=Homogeneous Area #, PLM=Polarized Light Microscopy, TEM=Transmission Electron Microscopy, /=PLM and/or TEM Analysis Not Required sq.ft.=Square Feet, cu.ft.=Cubic Feet, ln.ft.=Linear Feet, HJI=Hard Joint Insulation, TSI=Thermal System Insulation, BUR=Built-up Roofing, Surf=Surfacing NAD=No Asbestos Detected, SP=Stop Positive									
HA#	Type of Material TSI, Surf, Misc.	Material Type	Sample Number	Asbestos Content (PLM)	Asbestos Content (TEM)	Location of Sample	Approx. Quantity	Physical Condition	Location/ Comments
33	Misc.	Tan Duct Mastic	086	NAD	/	Conference Room	N/A	Good; Non-Friable	Located on assorted HVAC duct and equipment.
			087	NAD	/	Psych Storage (1)			
			088	/	NAD	IMC (1)			
34	Surf.	Ceiling Texture	089	NAD	/	Conference Room above wet area	N/A	Good; Friable	Located sparingly on bulkhead(s), Conference Room and Room 100-Storage.
			090	NAD	/	Psych Storage (1) closet			
			091	NAD	/	Room 105			

CROSSROADS ENVIRONMENTAL, LLC ASBESTOS INSPECTION REPORT							CRE JOB #: 17799-IN		
Location:		DISC Building, 698 Howard Street, Spartanburg, SC 29303							
Client:		SCSD#7					DATE: April 15 & 22 and May 7, 2020		
Key: A=Amosite, C=Chrysotile, Cr=Crocidolite, Tr=Tremolite, Ac=Actinolite Asbestos, Misc.=Miscellaneous, HA#=Homogeneous Area #, PLM=Polarized Light Microscopy, TEM=Transmission Electron Microscopy, /=PLM and/or TEM Analysis Not Required sq.ft.=Square Feet, cu.ft.=Cubic Feet, In.ft.=Linear Feet, HJI=Hard Joint Insulation, TSI=Thermal System Insulation, BUR=Built-up Roofing, Surf=Surfacing NAD=No Asbestos Detected, SP=Stop Positive									
HA#	Type of Material TSI, Surf, Misc.	Material Type	Sample Number	Asbestos Content (PLM)	Asbestos Content (TEM)	Location of Sample	Approx. Quantity	Physical Condition	Location/ Comments
35	Surf.	CMU to Roof Decking Cementitious Sealant	092	NAD	/	Psych Storage (1)	N/A	Good; Friable	Located throughout where the CMU walls meet the metal roof decking.
			093	NAD	/	IMC (1)			
			094	NAD	/	Conference Room			
			095	NAD	/	Room 105			
			096	NAD	/	Room 101			
36	Misc.	Sink Base Mastic	097	NAD	/	Room 105	N/A	Good; Non-Friable	Located on 'wet area' sink bases throughout.
			098	NAD	/	Room 105			
			099	/	NAD	Room 105			

ATTACHMENT II
LABORATORY REPORT(S)

April 24, 2020

Crossroads Environmental
1258 Boiling Springs Road
Spartanburg, SC 29303

CLIENT PROJECT: 17799-IN
CEI LAB CODE: A205046

Dear Customer:

Enclosed are asbestos analysis results for PLM Bulk samples received at our laboratory on April 23, 2020. The samples were analyzed for asbestos using polarizing light microscopy (PLM) per the EPA 600 Method.

Sample results containing >1% asbestos are considered asbestos-containing materials (ACMs) per EPA regulatory requirements. The detection limit for the EPA 600 Method is <1% asbestos by weight as determined by visual estimation.

Thank you for your business and we look forward to continuing good relations.

Kind Regards,

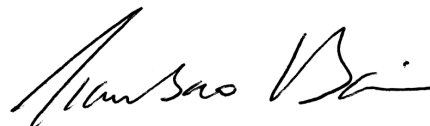

Tianbao Bai, Ph.D., CIH
Laboratory Director



CEI

ASBESTOS ANALYTICAL REPORT

By: Polarized Light Microscopy

Prepared for

Crossroads Environmental

CLIENT PROJECT: 17799-IN

LAB CODE: A205046

TEST METHOD: EPA 600 / R93 / 116 and EPA 600 / M4-82 / 020

REPORT DATE: 04/24/20

TOTAL SAMPLES ANALYZED: 11

SAMPLES >1% ASBESTOS: 3

Asbestos Report Summary

By: POLARIZING LIGHT MICROSCOPY

PROJECT: 17799-IN

LAB CODE: A205046

METHOD: EPA 600 / R93 / 116 and EPA 600 / M4-82 / 020

Client ID	Layer	Lab ID	Color	Sample Description	ASBESTOS %
R200	Layer 1	A81842	Black	Tar Gravel Bur	None Detected
	Layer 2	A81842	Black	Perlite Insulation	None Detected
R201	Layer 1	A81843	Black	Tar Gravel Bur	None Detected
	Layer 2	A81843	Black	Perlite Insulation	None Detected
R202	Layer 1	A81844		Sample Submitted for TEM Analysis	
	Layer 2	A81844	Black	Perlite Insulation	None Detected
R203	Layer 1	A81845	Black	Tar Gravel Bur	None Detected
	Layer 2	A81845	Yellow	Insulation	None Detected
R204	Layer 1	A81846	Black	Tar Gravel Bur	None Detected
	Layer 2	A81846	Yellow	Insulation	None Detected
R205	Layer 1	A81847		Sample Submitted for TEM Analysis	
	Layer 2	A81847	Yellow	Insulation	None Detected
R206	Layer 1	A81848	Silver	Paint	Chrysotile 3%
	Layer 2	A81848	Black	Perimeter Flashing	Chrysotile 5%
	Layer 3	A81848	Brown	Insulation	None Detected
R207		A81849		Sample Not Analyzed per COC	
R208		A81850		Sample Not Analyzed per COC	
R209		A81851	Black	Equipment Flashing	Chrysotile 10%
R210		A81852		Sample Not Analyzed per COC	
R211		A81853		Sample Not Analyzed per COC	
R212	Layer 1	A81854	Black	Mod. Bit. Patch	None Detected
	Layer 2	A81854	Yellow	Insulation	None Detected
R213	Layer 1	A81855	Black	Mod. Bit. Patch	None Detected
	Layer 2	A81855	Yellow	Insulation	None Detected
R214	Layer 1	A81856		Sample Submitted for TEM Analysis	
	Layer 2	A81856	Yellow	Insulation	None Detected



CEI

ASBESTOS BULK ANALYSIS

By: POLARIZING LIGHT MICROSCOPY

Client: Crossroads Environmental
1258 Boiling Springs Road
Spartanburg, SC 29303

Lab Code: A205046
Date Received: 04-23-20
Date Analyzed: 04-24-20
Date Reported: 04-24-20

Project: 17799-IN

ASBESTOS BULK PLM, EPA 600 METHOD

Client ID Lab ID	Lab Description	Lab Attributes	NON-ASBESTOS COMPONENTS				ASBESTOS %
			Fibrous		Non-Fibrous		
R200 Layer 1 A81842	Tar Gravel Bur	Heterogeneous Black Fibrous Bound	45%	Fiberglass	30%	Tar	None Detected
			10%	Cellulose	15%	Silicates	
Layer 2 A81842	Perlite Insulation	Heterogeneous Black Fibrous Bound	65%	Cellulose	35%	Perlite	None Detected
R201 Layer 1 A81843	Tar Gravel Bur	Heterogeneous Black Fibrous Bound	45%	Fiberglass	30%	Tar	None Detected
			10%	Cellulose	15%	Silicates	
Layer 2 A81843	Perlite Insulation	Heterogeneous Black Fibrous Bound	65%	Cellulose	35%	Perlite	None Detected
R202 Layer 1 A81844	Sample Submitted for TEM Analysis						
Layer 2 A81844	Perlite Insulation	Heterogeneous Black Fibrous Bound	65%	Cellulose	35%	Perlite	None Detected
R203 Layer 1 A81845	Tar Gravel Bur	Heterogeneous Black Fibrous Bound	45%	Fiberglass	30%	Tar	None Detected
			10%	Cellulose	15%	Silicates	
Layer 2 A81845	Insulation	Heterogeneous Yellow Fibrous Loose	100%	Fiberglass			None Detected



CEI

ASBESTOS BULK ANALYSIS

By: POLARIZING LIGHT MICROSCOPY

Client: Crossroads Environmental
1258 Boiling Springs Road
Spartanburg, SC 29303

Lab Code: A205046
Date Received: 04-23-20
Date Analyzed: 04-24-20
Date Reported: 04-24-20

Project: 17799-IN

ASBESTOS BULK PLM, EPA 600 METHOD

Client ID Lab ID	Lab Description	Lab Attributes	NON-ASBESTOS COMPONENTS				ASBESTOS %
			Fibrous		Non-Fibrous		
R204 Layer 1 A81846	Tar Gravel Bur	Heterogeneous Black Fibrous Bound	45%	Fiberglass	30%	Tar	None Detected
			10%	Cellulose	15%	Silicates	
Layer 2 A81846	Insulation	Heterogeneous Yellow Fibrous Loose	100%	Fiberglass			None Detected
R205 Layer 1 A81847	Sample Submitted for TEM Analysis						
Layer 2 A81847	Insulation	Heterogeneous Yellow Fibrous Loose	100%	Fiberglass			None Detected
R206 Layer 1 A81848	Paint	Heterogeneous Silver Fibrous Bound			97%	Paint	3% Chrysotile
Layer 2 A81848	Perimeter Flashing	Heterogeneous Black Fibrous Bound	20%	Cellulose	65%	Tar 10% Binder	5% Chrysotile
Layer 3 A81848	Insulation	Heterogeneous Brown Fibrous Bound	100%	Cellulose			None Detected
R207 A81849	Sample Not Analyzed per COC						

ASBESTOS BULK ANALYSIS

By: POLARIZING LIGHT MICROSCOPY

Client: Crossroads Environmental
 1258 Boiling Springs Road
 Spartanburg, SC 29303

Lab Code: A205046
Date Received: 04-23-20
Date Analyzed: 04-24-20
Date Reported: 04-24-20

Project: 17799-IN

ASBESTOS BULK PLM, EPA 600 METHOD

Client ID Lab ID	Lab Description	Lab Attributes	NON-ASBESTOS COMPONENTS				ASBESTOS %
			Fibrous		Non-Fibrous		
R208 A81850	Sample Not Analyzed per COC						
R209 A81851	Equipment Flashing	Heterogeneous Black Fibrous Bound	30%	Fiberglass	45%	Tar 15% Binder	10% Chrysotile
R210 A81852	Sample Not Analyzed per COC						
R211 A81853	Sample Not Analyzed per COC						
R212 Layer 1 A81854	Mod. Bit. Patch	Heterogeneous Black Fibrous Bound	15% 25%	Fiberglass Synthetic Fiber	50% 10%	Tar Binder	None Detected
Layer 2 A81854	Insulation	Heterogeneous Yellow Fibrous Loose	100%	Fiberglass			None Detected
R213 Layer 1 A81855	Mod. Bit. Patch	Heterogeneous Black Fibrous Bound	15% 25%	Fiberglass Synthetic Fiber	50% 10%	Tar Binder	None Detected
Layer 2 A81855	Insulation	Heterogeneous Yellow Fibrous Loose	100%	Fiberglass			None Detected
R214 Layer 1 A81856	Sample Submitted for TEM Analysis						



CEI

ASBESTOS BULK ANALYSIS

By: POLARIZING LIGHT MICROSCOPY

Client: Crossroads Environmental
1258 Boiling Springs Road
Spartanburg, SC 29303

Lab Code: A205046
Date Received: 04-23-20
Date Analyzed: 04-24-20
Date Reported: 04-24-20

Project: 17799-IN

ASBESTOS BULK PLM, EPA 600 METHOD

Client ID Lab ID	Lab Description	Lab Attributes	NON-ASBESTOS COMPONENTS		ASBESTOS %
			Fibrous	Non-Fibrous	
Layer 2 A81856	Insulation	Heterogeneous Yellow Fibrous Loose	100%	Fiberglass	None Detected

LEGEND: Non-Anth = Non-Asbestiform Anthophyllite
 Non-Trem = Non-Asbestiform Tremolite
 Calc Carb = Calcium Carbonate

METHOD: EPA 600 / R93 / 116 and EPA 600 / M4-82 / 020

REPORTING LIMIT: <1% by visual estimation

REPORTING LIMIT FOR POINT COUNTS: 0.25% by 400 Points or 0.1% by 1,000 Points

REGULATORY LIMIT: >1% by weight

Due to the limitations of the EPA 600 method, nonfriable organically bound materials (NOBs) such as vinyl floor tiles can be difficult to analyze via polarized light microscopy (PLM). EPA recommends that all NOBs analyzed by PLM, and found not to contain asbestos, be further analyzed by Transmission Electron Microscopy (TEM). Please note that PLM analysis of dust and soil samples for asbestos is not covered under NVLAP accreditation. *Estimated measurement of uncertainty is available on request.*

This report relates only to the samples tested or analyzed and may not be reproduced, except in full, without written approval by Eurofins CEI. Eurofins CEI makes no warranty representation regarding the accuracy of client submitted information in preparing and presenting analytical results. Interpretation of the analytical results is the sole responsibility of the client. Samples were received in acceptable condition unless otherwise noted. This report may not be used by the client to claim product endorsement by NVLAP or any other agency of the U.S. Government.

Information provided by customer includes customer sample ID and sample description.

ANALYST: _____

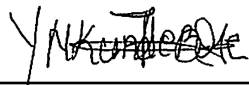
Yvette Nkunde-Bose

APPROVED BY: _____

Tianbao Bai, Ph.D., CIH
Laboratory Director

CROSSROADS ENVIRONMENTAL, LLC
 Sample Chain of Custody
 1258 Boiling Springs Road
 Spartanburg, SC 29303
 Phone (864) 541-8736
 Fax (864) 541-8776
 results@crossroadsenv.net

Date Sent: 4/22/20
 Project ID#: 17799-IN
 Submitted to: CEI
 Number of Samples: 15
 Fax Results: email
 Shipping Info: #

Type of Analysis:

<input type="checkbox"/>	<input checked="" type="checkbox"/>	<input checked="" type="checkbox"/>	<input type="checkbox"/>	<input type="checkbox"/>
PCM	PLM	TEM	AAS	Other
Air	Bulk	Air	Chips/	
		Bulk <input checked="" type="checkbox"/>	Wipes	
			Water	

Turn Around:

<input checked="" type="checkbox"/>	<input type="checkbox"/>	<input type="checkbox"/>	<input type="checkbox"/>
24 HR	48 HR	72 HR	5 Day

Other: PLM/TEM

Special Instructions:

Stop Positive PLM any layers not TEM'd

Sample ID#	DESCRIPTION OF SAMPLE	COMMENTS
R200	Top Gravel Bulk (Perlite)	PLM
R201		PLM
R202		TEM
R203	Top Gravel Bulk (F/G)	PLM
R204		PLM
R205		TEM
R206	Perimeter Flashing	PLM
R207		PLM
R208		TEM
R209	Equipment Flashing	PLM
R210		PLM
R211		TEM
R212	Mod. Bit. Patch	PLM
R213		PLM
R214		TEM

EUROFINS CEI, INC
 SAMPLES ACCEPTED
 JB

Signature & Date of Handlers:

Relinquished By: [Signature] Received By: CP 4/23/20 9:20
 Relinquished By: _____ Received By: _____
 Relinquished By: _____ Received By: _____

May 11, 2020

Crossroads Environmental
1258 Boiling Springs Road
Spartanburg, SC 29303

CLIENT PROJECT: DISC Building, 17799-IN
CEI LAB CODE: A205837

Dear Customer:

Enclosed are asbestos analysis results for PLM Bulk samples received at our laboratory on May 8, 2020. The samples were analyzed for asbestos using polarizing light microscopy (PLM) per the EPA 600 Method.

Sample results containing >1% asbestos are considered asbestos-containing materials (ACMs) per EPA regulatory requirements. The detection limit for the EPA 600 Method is <1% asbestos by weight as determined by visual estimation.

Thank you for your business and we look forward to continuing good relations.

Kind Regards,

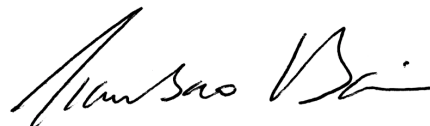

Tianbao Bai, Ph.D., CIH
Laboratory Director



CEI

ASBESTOS ANALYTICAL REPORT

By: Polarized Light Microscopy

Prepared for

Crossroads Environmental

CLIENT PROJECT: DISC Building, 17799-IN

LAB CODE: A205837

TEST METHOD: EPA 600 / R93 / 116 and EPA 600 / M4-82 / 020

REPORT DATE: 05/11/20

TOTAL SAMPLES ANALYZED: 65

SAMPLES >1% ASBESTOS:



CEI

Asbestos Report Summary

By: POLARIZING LIGHT MICROSCOPY

PROJECT: DISC Building, 17799-IN

LAB CODE: A205837

METHOD: EPA 600 / R93 / 116 and EPA 600 / M4-82 / 020

Client ID	Layer	Lab ID	Color	Sample Description	ASBESTOS %
001		A93927A	Gray	Covebase	None Detected
		A93927B	Yellow,Tan	Glue	None Detected
002		A93928A	Gray	Covebase	None Detected
		A93928B	Yellow,Tan	Glue	None Detected
003		A93929		Sample Submitted for TEM Analysis	
004		A93930A	Gray,Blue	Floor Tile	None Detected
	Layer 1	A93930B	Yellow	Mastic	None Detected
	Layer 2	A93930B	Off-white	Leveling Compound	None Detected
005		A93931A	Gray,Blue	Floor Tile	None Detected
	Layer 1	A93931B	Yellow	Mastic	None Detected
	Layer 2	A93931B	Off-white	Leveling Compound	None Detected
006		A93932A		Sample Submitted for TEM Analysis	
	Layer 1	A93932B		Sample Submitted for TEM Analysis	
	Layer 2	A93932B	Off-white	Leveling Compound	None Detected
007		A93933	Off-white	Wall Texture	None Detected
008		A93934	Off-white	Wall Texture	None Detected
009		A93935	Off-white	Wall Texture	None Detected
010		A93936A	Tan,Blue	Floor Tile	None Detected
	Layer 1	A93936B	Yellow	Mastic	None Detected
	Layer 2	A93936B	Off-white	Leveling Compound	None Detected
	Layer 3	A93936B	Black	Mastic	None Detected
011		A93937A	Tan,Blue	Floor Tile	None Detected
		A93937B	Black	Mastic	None Detected
012		A93938		Sample Submitted for TEM Analysis	
013		A93939	Brown	Covebase	None Detected
014		A93940	Brown	Covebase	None Detected
015		A93941		Sample Submitted for TEM Analysis	



CEI

Asbestos Report Summary

By: POLARIZING LIGHT MICROSCOPY

PROJECT: DISC Building, 17799-IN

LAB CODE: A205837

METHOD: EPA 600 / R93 / 116 and EPA 600 / M4-82 / 020

Client ID	Layer	Lab ID	Color	Sample Description	ASBESTOS %
016		A93942A	Turquoise	Floor Tile	None Detected
		A93942B	Yellow	Mastic	None Detected
017		A93943A	Turquoise	Floor Tile	None Detected
		A93943B	Yellow	Mastic	None Detected
018		A93944		Sample Submitted for TEM Analysis	
019		A93945	Turquoise	Covebase	None Detected
020		A93946	Turquoise	Covebase	None Detected
021		A93947		Sample Submitted for TEM Analysis	
022		A93948	Turquoise	Covebase	None Detected
023		A93949	Turquoise	Covebase	None Detected
024		A93950		Sample Submitted for TEM Analysis	
025		A93951A	Gray,Off-white	Floor Tile	None Detected
	Layer 1	A93951B	Yellow	Mastic	None Detected
	Layer 2	A93951B	Black	Mastic	None Detected
026		A93952A	Gray,Off-white	Floor Tile	None Detected
	Layer 1	A93952B	Yellow	Mastic	None Detected
	Layer 2	A93952B	Black	Mastic	None Detected
027		A93953		Sample Submitted for TEM Analysis	
028		A93954	White	Ceiling Tile	None Detected
029		A93955	White	Ceiling Tile	None Detected
030		A93956	White	Ceiling Tile	None Detected
031		A93957	White	Ceiling Tile	None Detected
032		A93958	White	Ceiling Tile	None Detected
033		A93959	White	Ceiling Tile	None Detected
034		A93960	White	Ceiling Tile	None Detected
035		A93961	White	Ceiling Tile	None Detected
036		A93962	White	Ceiling Tile	None Detected
037		A93963	White	Ceiling Tile	None Detected



CEI

Asbestos Report Summary

By: POLARIZING LIGHT MICROSCOPY

PROJECT: DISC Building, 17799-IN

LAB CODE: A205837

METHOD: EPA 600 / R93 / 116 and EPA 600 / M4-82 / 020

Client ID	Layer	Lab ID	Color	Sample Description	ASBESTOS %
038		A93964	White	Ceiling Tile	None Detected
039		A93965	White	Ceiling Tile	None Detected
040		A93966	Gray,Brown	Covebase	None Detected
041		A93967	Gray,Brown	Covebase	None Detected
042		A93968		Sample Submitted for TEM Analysis	
043	Layer 1	A93969	White	Joint Compound	None Detected
	Layer 2	A93969	Off-white	Drywall	None Detected
044	Layer 1	A93970	White	Joint Compound	None Detected
	Layer 2	A93970	Off-white	Drywall	None Detected
045	Layer 1	A93971	White	Joint Compound	None Detected
	Layer 2	A93971	Off-white	Drywall	None Detected
046	Layer 1	A93972	White	Joint Compound	None Detected
	Layer 2	A93972	Off-white	Drywall	None Detected
047	Layer 1	A93973	White	Joint Compound	None Detected
	Layer 2	A93973	Off-white	Drywall	None Detected
048		A93974	Yellow	Carpet Glue	None Detected
049		A93975	Yellow	Carpet Glue	None Detected
050		A93976		Sample Submitted for TEM Analysis	
051		A93977	Yellow	Carpet Glue	None Detected
052		A93978	Yellow	Carpet Glue	None Detected
053		A93979		Sample Submitted for TEM Analysis	
054		A93980A	Gray	Covebase	None Detected
		A93980B	Cream	Glue	None Detected
055		A93981A	Gray	Covebase	None Detected
		A93981B	Cream	Glue	None Detected
056		A93982		Sample Submitted for TEM Analysis	
057		A93983	Red	Firestop	None Detected
058		A93984	Red	Firestop	None Detected

PROJECT: DISC Building, 17799-IN

LAB CODE: A205837

METHOD: EPA 600 / R93 / 116 and EPA 600 / M4-82 / 020

Client ID	Layer	Lab ID	Color	Sample Description	ASBESTOS %
059		A93985		Sample Submitted for TEM Analysis	
060		A93986	Off-white	Blown-in Insulation	None Detected
061		A93987	Off-white	Blown-in Insulation	None Detected
062		A93988	Off-white	Blown-in Insulation	None Detected
063		A93989	Off-white	Blown-in Insulation	None Detected
064		A93990	Off-white	Blown-in Insulation	None Detected
065		A93991	Brown	Caulking	None Detected
066		A93992	Brown	Caulking	None Detected
067		A93993		Sample Submitted for TEM Analysis	
068	Layer 1	A93994	Brown	Caulking	None Detected
	Layer 2	A93994	Black	Caulking	None Detected
069	Layer 1	A93995	Brown	Caulking	None Detected
	Layer 2	A93995	Black	Caulking	None Detected
070		A93996		Sample Submitted for TEM Analysis	
071		A93997	Brown	Joint Caulk	None Detected
072		A93998	Brown	Joint Caulk	None Detected
073		A93999		Sample Submitted for TEM Analysis	
074		A94000	Black	Caulk	None Detected
075		A94001	Black	Caulk	None Detected
076		A94002		Sample Submitted for TEM Analysis	
077		A94003	Gray,Black	Caulk	None Detected
078		A94004	Gray,Black	Caulk	None Detected
079		A94005		Sample Submitted for TEM Analysis	
080		A94006	Off-white	Stucco Material	None Detected
081		A94007	Off-white	Stucco Material	None Detected
082		A94008	Off-white	Stucco Material	None Detected

ASBESTOS BULK ANALYSIS

By: POLARIZING LIGHT MICROSCOPY

Client: Crossroads Environmental
 1258 Boiling Springs Road
 Spartanburg, SC 29303

Lab Code: A205837
Date Received: 05-08-20
Date Analyzed: 05-08-20
Date Reported: 05-11-20

Project: DISC Building, 17799-IN

ASBESTOS BULK PLM, EPA 600 METHOD

Client ID Lab ID	Lab Description	Lab Attributes	NON-ASBESTOS COMPONENTS		ASBESTOS %
			Fibrous	Non-Fibrous	
001 A93927A	Covebase	Homogeneous Gray Non-fibrous Bound	100%	Vinyl	None Detected
A93927B	Glue	Homogeneous Yellow, Tan Non-fibrous Bound	100%	Mastic	None Detected
002 A93928A	Covebase	Homogeneous Gray Non-fibrous Bound	100%	Vinyl	None Detected
A93928B	Glue	Homogeneous Yellow, Tan Non-fibrous Bound	100%	Mastic	None Detected
003 A93929	Sample Submitted for TEM Analysis				
004 A93930A	Floor Tile	Homogeneous Gray, Blue Non-fibrous Bound	100%	Vinyl	None Detected
Layer 1 A93930B	Mastic	Homogeneous Yellow Non-fibrous Bound	100%	Mastic	None Detected
Layer 2 A93930B	Leveling Compound	Homogeneous Off-white Non-fibrous Bound	65% 20% 15%	Binder Silicates Calc Carb	None Detected

ASBESTOS BULK ANALYSIS

By: POLARIZING LIGHT MICROSCOPY

Client: Crossroads Environmental
 1258 Boiling Springs Road
 Spartanburg, SC 29303

Lab Code: A205837
Date Received: 05-08-20
Date Analyzed: 05-08-20
Date Reported: 05-11-20

Project: DISC Building, 17799-IN

ASBESTOS BULK PLM, EPA 600 METHOD

Client ID Lab ID	Lab Description	Lab Attributes	NON-ASBESTOS COMPONENTS		ASBESTOS %
			Fibrous	Non-Fibrous	
005 A93931A	Floor Tile	Homogeneous Gray,Blue Non-fibrous Bound	100%	Vinyl	None Detected
Layer 1 A93931B	Mastic	Homogeneous Yellow Non-fibrous Bound	100%	Mastic	None Detected
Layer 2 A93931B	Leveling Compound	Homogeneous Off-white Non-fibrous Bound	65% 20% 15%	Binder Silicates Calc Carb	None Detected
006 A93932A	Sample Submitted for TEM Analysis				
Layer 1 A93932B	Sample Submitted for TEM Analysis				
Layer 2 A93932B	Leveling Compound	Homogeneous Off-white Non-fibrous Bound	65% 20% 15%	Binder Silicates Calc Carb	None Detected
007 A93933	Wall Texture	Heterogeneous Off-white Non-fibrous Loosely Bound	15% 30% 55%	Paint Vermiculite Calc Carb	None Detected
008 A93934	Wall Texture	Heterogeneous Off-white Non-fibrous Loosely Bound	15% 30% 55%	Paint Vermiculite Calc Carb	None Detected

ASBESTOS BULK ANALYSIS

By: POLARIZING LIGHT MICROSCOPY

Client: Crossroads Environmental
 1258 Boiling Springs Road
 Spartanburg, SC 29303

Lab Code: A205837
Date Received: 05-08-20
Date Analyzed: 05-08-20
Date Reported: 05-11-20

Project: DISC Building, 17799-IN

ASBESTOS BULK PLM, EPA 600 METHOD

Client ID Lab ID	Lab Description	Lab Attributes	NON-ASBESTOS COMPONENTS				ASBESTOS %		
			Fibrous		Non-Fibrous				
009 A93935	Wall Texture	Heterogeneous Off-white Non-fibrous Loosely Bound	15%	Paint	30%	Vermiculite	55%	Calc Carb	None Detected
010 A93936A	Floor Tile	Homogeneous Tan,Blue Non-fibrous Bound	100%	Vinyl					None Detected
Layer 1 A93936B	Mastic	Homogeneous Yellow Non-fibrous Bound	100%	Mastic					None Detected
Layer 2 A93936B	Leveling Compound	Homogeneous Off-white Non-fibrous Bound	65%	Binder	20%	Silicates	15%	Calc Carb	None Detected
Layer 3 A93936B	Mastic	Homogeneous Black Non-fibrous Bound	5%	Cellulose	95%	Mastic			None Detected
011 A93937A	Floor Tile	Homogeneous Tan,Blue Non-fibrous Bound	100%	Vinyl					None Detected
A93937B	Mastic	Homogeneous Black Non-fibrous Bound	5%	Cellulose	95%	Mastic			None Detected
012 A93938	Sample Submitted for TEM Analysis								



CEI

ASBESTOS BULK ANALYSIS

By: POLARIZING LIGHT MICROSCOPY

Client: Crossroads Environmental
1258 Boiling Springs Road
Spartanburg, SC 29303

Lab Code: A205837
Date Received: 05-08-20
Date Analyzed: 05-08-20
Date Reported: 05-11-20

Project: DISC Building, 17799-IN

ASBESTOS BULK PLM, EPA 600 METHOD

Client ID Lab ID	Lab Description	Lab Attributes	NON-ASBESTOS COMPONENTS		ASBESTOS %
			Fibrous	Non-Fibrous	
013 A93939	Covebase	Homogeneous Brown Non-fibrous Bound	100%	Vinyl	None Detected
014 A93940	Covebase	Homogeneous Brown Non-fibrous Bound	100%	Vinyl	None Detected
015 A93941	Sample Submitted for TEM Analysis				
016 A93942A	Floor Tile	Homogeneous Turquoise Non-fibrous Bound	100%	Vinyl	None Detected
A93942B	Mastic	Homogeneous Yellow Non-fibrous Bound	100%	Mastic	None Detected
017 A93943A	Floor Tile	Homogeneous Turquoise Non-fibrous Bound	100%	Vinyl	None Detected
A93943B	Mastic	Homogeneous Yellow Non-fibrous Bound	100%	Mastic	None Detected
018 A93944	Sample Submitted for TEM Analysis				

ASBESTOS BULK ANALYSIS

By: POLARIZING LIGHT MICROSCOPY

Client: Crossroads Environmental
 1258 Boiling Springs Road
 Spartanburg, SC 29303

Lab Code: A205837
Date Received: 05-08-20
Date Analyzed: 05-08-20
Date Reported: 05-11-20

Project: DISC Building, 17799-IN

ASBESTOS BULK PLM, EPA 600 METHOD

Client ID Lab ID	Lab Description	Lab Attributes	NON-ASBESTOS COMPONENTS		ASBESTOS %
			Fibrous	Non-Fibrous	
019 A93945	Covebase	Homogeneous Turquoise Non-fibrous Bound	100%	Vinyl	None Detected
020 A93946	Covebase	Homogeneous Turquoise Non-fibrous Bound	100%	Vinyl	None Detected
021 A93947	Sample Submitted for TEM Analysis				
022 A93948	Covebase	Homogeneous Turquoise Non-fibrous Bound	100%	Vinyl	None Detected
023 A93949	Covebase	Homogeneous Turquoise Non-fibrous Bound	100%	Vinyl	None Detected
024 A93950	Sample Submitted for TEM Analysis				
025 A93951A	Floor Tile	Homogeneous Gray,Off-white Non-fibrous Bound	100%	Vinyl	None Detected
Layer 1 A93951B	Mastic	Homogeneous Yellow Non-fibrous Bound	100%	Mastic	None Detected

ASBESTOS BULK ANALYSIS

By: POLARIZING LIGHT MICROSCOPY

Client: Crossroads Environmental
 1258 Boiling Springs Road
 Spartanburg, SC 29303

Lab Code: A205837
Date Received: 05-08-20
Date Analyzed: 05-08-20
Date Reported: 05-11-20

Project: DISC Building, 17799-IN

ASBESTOS BULK PLM, EPA 600 METHOD

Client ID Lab ID	Lab Description	Lab Attributes	NON-ASBESTOS COMPONENTS			ASBESTOS %	
			Fibrous	Non-Fibrous			
Layer 2 A93951B	Mastic	Homogeneous Black Non-fibrous Bound	100%	Mastic		None Detected	
026 A93952A	Floor Tile	Homogeneous Gray,Off-white Non-fibrous Bound	100%	Vinyl		None Detected	
Layer 1 A93952B	Mastic	Homogeneous Yellow Non-fibrous Bound	100%	Mastic		None Detected	
Layer 2 A93952B	Mastic	Homogeneous Black Non-fibrous Bound	100%	Mastic		None Detected	
027 A93953	Sample Submitted for TEM Analysis						
028 A93954	Ceiling Tile	Heterogeneous White Fibrous Loosely Bound	50% 25%	Cellulose Fiberglass	5% 20%	Paint Perlite	None Detected
029 A93955	Ceiling Tile	Heterogeneous White Fibrous Loosely Bound	50% 25%	Cellulose Fiberglass	5% 20%	Paint Perlite	None Detected
030 A93956	Ceiling Tile	Heterogeneous White Fibrous Loosely Bound	50% 25%	Cellulose Fiberglass	5% 20%	Paint Perlite	None Detected

ASBESTOS BULK ANALYSIS

By: POLARIZING LIGHT MICROSCOPY

Client: Crossroads Environmental
 1258 Boiling Springs Road
 Spartanburg, SC 29303

Lab Code: A205837
Date Received: 05-08-20
Date Analyzed: 05-08-20
Date Reported: 05-11-20

Project: DISC Building, 17799-IN

ASBESTOS BULK PLM, EPA 600 METHOD

Client ID Lab ID	Lab Description	Lab Attributes	NON-ASBESTOS COMPONENTS				ASBESTOS %
			Fibrous		Non-Fibrous		
031 A93957	Ceiling Tile	Heterogeneous	50%	Cellulose	5%	Paint	None Detected
		White	25%	Fiberglass	20%	Perlite	
		Fibrous					
		Loosely Bound					
032 A93958	Ceiling Tile	Heterogeneous	50%	Cellulose	5%	Paint	None Detected
		White	25%	Fiberglass	20%	Perlite	
		Fibrous					
		Loosely Bound					
033 A93959	Ceiling Tile	Heterogeneous	50%	Cellulose	5%	Paint	None Detected
		White	25%	Fiberglass	20%	Perlite	
		Fibrous					
		Loosely Bound					
034 A93960	Ceiling Tile	Heterogeneous	50%	Cellulose	5%	Paint	None Detected
		White	25%	Fiberglass	20%	Perlite	
		Fibrous					
		Loosely Bound					
035 A93961	Ceiling Tile	Heterogeneous	50%	Cellulose	5%	Paint	None Detected
		White	25%	Fiberglass	20%	Perlite	
		Fibrous					
		Loosely Bound					
036 A93962	Ceiling Tile	Heterogeneous	50%	Cellulose	5%	Paint	None Detected
		White	25%	Fiberglass	20%	Perlite	
		Fibrous					
		Loosely Bound					
037 A93963	Ceiling Tile	Heterogeneous	50%	Cellulose	5%	Paint	None Detected
		White	25%	Fiberglass	20%	Perlite	
		Fibrous					
		Loosely Bound					

ASBESTOS BULK ANALYSIS

By: POLARIZING LIGHT MICROSCOPY

Client: Crossroads Environmental
 1258 Boiling Springs Road
 Spartanburg, SC 29303

Lab Code: A205837
Date Received: 05-08-20
Date Analyzed: 05-08-20
Date Reported: 05-11-20

Project: DISC Building, 17799-IN

ASBESTOS BULK PLM, EPA 600 METHOD

Client ID Lab ID	Lab Description	Lab Attributes	NON-ASBESTOS COMPONENTS				ASBESTOS %
			Fibrous		Non-Fibrous		
038 A93964	Ceiling Tile	Heterogeneous	50%	Cellulose	5%	Paint	None Detected
		White Fibrous Loosely Bound	25%	Fiberglass	20%	Perlite	
039 A93965	Ceiling Tile	Heterogeneous	50%	Cellulose	5%	Paint	None Detected
		White Fibrous Loosely Bound	25%	Fiberglass	20%	Perlite	
040 A93966	Covebase	Homogeneous			100%	Vinyl	None Detected
		Gray,Brown Non-fibrous Bound					
041 A93967	Covebase	Homogeneous			100%	Vinyl	None Detected
		Gray,Brown Non-fibrous Bound					
042 A93968	Sample Submitted for TEM Analysis						
043 Layer 1 A93969	Joint Compound	Heterogeneous			10%	Paint	None Detected
		White Non-fibrous Loosely Bound			65%	Calc Carb	
Layer 2 A93969	Drywall	Heterogeneous	15%	Cellulose	85%	Gypsum	None Detected
		Off-white Fibrous Bound					
044 Layer 1 A93970	Joint Compound	Heterogeneous			10%	Paint	None Detected
		White Non-fibrous Loosely Bound			65%	Calc Carb	
					25%	Binder	



CEI

ASBESTOS BULK ANALYSIS

By: POLARIZING LIGHT MICROSCOPY

Client: Crossroads Environmental
1258 Boiling Springs Road
Spartanburg, SC 29303

Lab Code: A205837
Date Received: 05-08-20
Date Analyzed: 05-08-20
Date Reported: 05-11-20

Project: DISC Building, 17799-IN

ASBESTOS BULK PLM, EPA 600 METHOD

Client ID Lab ID	Lab Description	Lab Attributes	NON-ASBESTOS COMPONENTS			ASBESTOS %	
			Fibrous		Non-Fibrous		
Layer 2 A93970	Drywall	Heterogeneous Off-white Fibrous Bound	15%	Cellulose	85%	Gypsum	None Detected
045 Layer 1 A93971	Joint Compound	Heterogeneous White Non-fibrous Loosely Bound			10%	Paint	None Detected
			65%		25%	Calc Carb Binder	
Layer 2 A93971	Drywall	Heterogeneous Off-white Fibrous Bound	15%	Cellulose	85%	Gypsum	None Detected
046 Layer 1 A93972	Joint Compound	Heterogeneous White Non-fibrous Loosely Bound			10%	Paint	None Detected
			65%		25%	Calc Carb Binder	
Layer 2 A93972	Drywall	Heterogeneous Off-white Fibrous Bound	15%	Cellulose	85%	Gypsum	None Detected
047 Layer 1 A93973	Joint Compound	Heterogeneous White Non-fibrous Loosely Bound			10%	Paint	None Detected
			65%		25%	Calc Carb Binder	
Layer 2 A93973	Drywall	Heterogeneous Off-white Fibrous Bound	15%	Cellulose	85%	Gypsum	None Detected

ASBESTOS BULK ANALYSIS

By: POLARIZING LIGHT MICROSCOPY

Client: Crossroads Environmental
 1258 Boiling Springs Road
 Spartanburg, SC 29303

Lab Code: A205837
Date Received: 05-08-20
Date Analyzed: 05-08-20
Date Reported: 05-11-20

Project: DISC Building, 17799-IN

ASBESTOS BULK PLM, EPA 600 METHOD

Client ID Lab ID	Lab Description	Lab Attributes	NON-ASBESTOS COMPONENTS			ASBESTOS %
			Fibrous	Non-Fibrous		
048 A93974	Carpet Glue	Homogeneous Yellow Non-fibrous Bound	<1%	Synthetic Fiber 100%	Mastic	None Detected
049 A93975	Carpet Glue	Homogeneous Yellow Non-fibrous Bound	<1%	Synthetic Fiber 100%	Mastic	None Detected
050 A93976	Sample Submitted for TEM Analysis					
051 A93977	Carpet Glue	Homogeneous Yellow Non-fibrous Bound	<1%	Synthetic Fiber 100%	Mastic	None Detected
052 A93978	Carpet Glue	Homogeneous Yellow Non-fibrous Bound	<1%	Synthetic Fiber 100%	Mastic	None Detected
053 A93979	Sample Submitted for TEM Analysis					
054 A93980A	Covebase	Homogeneous Gray Non-fibrous Bound		100%	Vinyl	None Detected
A93980B	Glue	Homogeneous Cream Non-fibrous Bound		100%	Mastic	None Detected

ASBESTOS BULK ANALYSIS

By: POLARIZING LIGHT MICROSCOPY

Client: Crossroads Environmental
1258 Boiling Springs Road
Spartanburg, SC 29303

Lab Code: A205837
Date Received: 05-08-20
Date Analyzed: 05-08-20
Date Reported: 05-11-20

Project: DISC Building, 17799-IN

ASBESTOS BULK PLM, EPA 600 METHOD

Client ID Lab ID	Lab Description	Lab Attributes	NON-ASBESTOS COMPONENTS				ASBESTOS %
			Fibrous		Non-Fibrous		
055 A93981A	Covebase	Homogeneous Gray Non-fibrous Bound	100%	Vinyl			None Detected
A93981B	Glue	Homogeneous Cream Non-fibrous Bound	100%	Mastic			None Detected
056 A93982	Sample Submitted for TEM Analysis						
057 A93983	Firestop	Homogeneous Red Fibrous Bound	5%	Fiberglass	15%	Binder Caulk	None Detected
058 A93984	Firestop	Homogeneous Red Fibrous Bound	5%	Fiberglass	15%	Binder Caulk	None Detected
059 A93985	Sample Submitted for TEM Analysis						
060 A93986	Blown-in Insulation	Homogeneous Off-white Fibrous Loosely Bound	100%	Fiberglass			None Detected
061 A93987	Blown-in Insulation	Homogeneous Off-white Fibrous Loosely Bound	100%	Fiberglass			None Detected

ASBESTOS BULK ANALYSIS

By: POLARIZING LIGHT MICROSCOPY

Client: Crossroads Environmental
1258 Boiling Springs Road
Spartanburg, SC 29303

Lab Code: A205837
Date Received: 05-08-20
Date Analyzed: 05-08-20
Date Reported: 05-11-20

Project: DISC Building, 17799-IN

ASBESTOS BULK PLM, EPA 600 METHOD

Client ID Lab ID	Lab Description	Lab Attributes	NON-ASBESTOS COMPONENTS		ASBESTOS %
			Fibrous	Non-Fibrous	
062 A93988	Blown-in Insulation	Homogeneous Off-white Fibrous Loosely Bound	100%	Fiberglass	None Detected
063 A93989	Blown-in Insulation	Homogeneous Off-white Fibrous Loosely Bound	100%	Fiberglass	None Detected
064 A93990	Blown-in Insulation	Homogeneous Off-white Fibrous Loosely Bound	100%	Fiberglass	None Detected
065 A93991	Caulking	Homogeneous Brown Non-fibrous Bound	100%	Binder	None Detected
066 A93992	Caulking	Homogeneous Brown Non-fibrous Bound	100%	Binder	None Detected
067 A93993	Sample Submitted for TEM Analysis				
068 Layer 1 A93994	Caulking	Homogeneous Brown Non-fibrous Bound	100%	Caulk	None Detected
Layer 2 A93994	Caulking	Homogeneous Black Non-fibrous Bound	100%	Caulk	None Detected

ASBESTOS BULK ANALYSIS

By: POLARIZING LIGHT MICROSCOPY

Client: Crossroads Environmental
 1258 Boiling Springs Road
 Spartanburg, SC 29303

Lab Code: A205837
Date Received: 05-08-20
Date Analyzed: 05-08-20
Date Reported: 05-11-20

Project: DISC Building, 17799-IN

ASBESTOS BULK PLM, EPA 600 METHOD

Client ID Lab ID	Lab Description	Lab Attributes	NON-ASBESTOS COMPONENTS			ASBESTOS %
			Fibrous	Non-Fibrous		
069 Layer 1 A93995	Caulking	Homogeneous Brown Non-fibrous Bound	100%	Caulk		None Detected
Layer 2 A93995	Caulking	Homogeneous Black Non-fibrous Bound	100%	Caulk		None Detected
070 A93996	Sample Submitted for TEM Analysis					
071 A93997	Joint Caulk	Homogeneous Brown Non-fibrous Bound	<1%	Fiberglass	100%	Caulk None Detected
072 A93998	Joint Caulk	Homogeneous Brown Non-fibrous Bound	<1%	Fiberglass	100%	Caulk None Detected
073 A93999	Sample Submitted for TEM Analysis					
074 A94000	Caulk	Homogeneous Black Non-fibrous Bound	<1%	Fiberglass	100%	Caulk None Detected
075 A94001	Caulk	Homogeneous Black Non-fibrous Bound	<1%	Fiberglass	100%	Caulk None Detected
076 A94002	Sample Submitted for TEM Analysis					

ASBESTOS BULK ANALYSIS

By: POLARIZING LIGHT MICROSCOPY

Client: Crossroads Environmental
1258 Boiling Springs Road
Spartanburg, SC 29303

Lab Code: A205837
Date Received: 05-08-20
Date Analyzed: 05-08-20
Date Reported: 05-11-20

Project: DISC Building, 17799-IN

ASBESTOS BULK PLM, EPA 600 METHOD

Client ID Lab ID	Lab Description	Lab Attributes	NON-ASBESTOS COMPONENTS			ASBESTOS %
			Fibrous	Non-Fibrous		
077 A94003	Caulk	Homogeneous Gray,Black Non-fibrous Bound	<1%	Fiberglass	100%	Caulk None Detected
078 A94004	Caulk	Homogeneous Gray,Black Non-fibrous Bound	<1%	Fiberglass	100%	Caulk None Detected
079 A94005	Sample Submitted for TEM Analysis					
080 A94006	Stucco Material	Homogeneous Off-white Non-fibrous Loose			20% 70% 10%	Binder Silicates Calc Carb None Detected
081 A94007	Stucco Material	Homogeneous Off-white Non-fibrous Loose			20% 70% 10%	Binder Silicates Calc Carb None Detected
082 A94008	Stucco Material	Homogeneous Off-white Non-fibrous Loose			20% 70% 10%	Binder Silicates Calc Carb None Detected

LEGEND: Non-Anth = Non-Asbestiform Anthophyllite
 Non-Trem = Non-Asbestiform Tremolite
 Calc Carb = Calcium Carbonate

METHOD: EPA 600 / R93 / 116 and EPA 600 / M4-82 / 020

REPORTING LIMIT: <1% by visual estimation

REPORTING LIMIT FOR POINT COUNTS: 0.25% by 400 Points or 0.1% by 1,000 Points

REGULATORY LIMIT: >1% by weight

Due to the limitations of the EPA 600 method, nonfriable organically bound materials (NOBs) such as vinyl floor tiles can be difficult to analyze via polarized light microscopy (PLM). EPA recommends that all NOBs analyzed by PLM, and found not to contain asbestos, be further analyzed by Transmission Electron Microscopy (TEM). Please note that PLM analysis of dust and soil samples for asbestos is not covered under NVLAP accreditation. *Estimated measurement of uncertainty is available on request.*

This report relates only to the samples tested or analyzed and may not be reproduced, except in full, without written approval by Eurofins CEI. Eurofins CEI makes no warranty representation regarding the accuracy of client submitted information in preparing and presenting analytical results. Interpretation of the analytical results is the sole responsibility of the client. Samples were received in acceptable condition unless otherwise noted. This report may not be used by the client to claim product endorsement by NVLAP or any other agency of the U.S. Government.

Information provided by customer includes customer sample ID and sample description.

ANALYST:

Danielle Carrier

APPROVED BY:

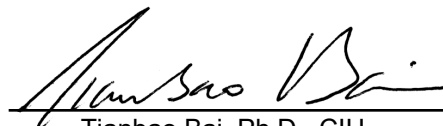
Tianbao Bai, Ph.D., CIH
Laboratory Director



CHAIN OF CUSTODY

730 S.E. Maynard Rd., Cary, NC 27511
 Tel: 919-481-1413; Fax: 919-481-1442

LAB USE ONLY:
CEI Lab Code: <i>AWS837 (82)</i>
CEI Lab I.D. Range: <i>A93927-A94008</i>

COMPANY CONTACT INFORMATION	
Company: CROSSROADS ENVIRONMENTAL, LLC	Client #:
Address: 1258 BOILING SPRINGS RD.	Job Contact: Kay H. Horton
SPARTANBURG, SC 29303	Email: RESULTS@CROSSROADSENV.NET
	Tel: 864-541-8736
Project Name: DISC Building	Fax: 864-541-8776
Project ID #: 17799-IN	P.O. #:

ASBESTOS	METHOD	4 HR*	8 HR*	24 HR	2 DAY	3 DAY	5 DAY
PLM BULK	EPA 600			X			
TEM BULK	CHATFIELD			X			
PLM POINT COUNT (400)	EPA 600						
PLM POINT COUNT (1000)	EPA 600						
PLM GRAVIMETRIC	EPA 600						
PLM GRAV w POINT COUNT	EPA 600						
OTHER:							

POSITIVE STOP ANALYSIS	X
SOUTH CAROLINA SAMPLES	X
NORTH CAROLINA SAMPLES	

TEM INSTRUCTIONS	
BEGIN TEM ANALYSIS AFTER NEGATIVE PLM	X
ANALYZE TEM SAMPLES SIMULTANEOUSLY WITH PLM	

DO NOT STOP POSITIVE SURFACING MATERIAL			
			<input checked="" type="checkbox"/> Accept Samples <input type="checkbox"/> Reject Samples
Relinquished By:	Date/Time	Received By:	Date/Time
<i>Halley</i>	5/7/2020 0:00	<i>CB</i>	5/8 9:40

* Call to confirm RUSH analysis.

Samples will be disposed of 30 days after analysis

A205837



SAMPLING FORM

COMPANY CONTACT INFORMATION

Crossroads Environmental, LLC	Job Contact: Kay H. Horton
Projec: Name: DISC Building	
Projec: ID #: 17799-IN	Tel: 864-541-8736

SAMPLE ID#	HA	DESCRIPTION / LOCATION	TEST			
			PLM	X	TEM	
C01	01	Gray Cove Base w/ Tan Glue	PLM	X	TEM	
C02	01	Gray Cove Base w/ Tan Glue	PLM	X	TEM	
C03	01	Gray Cove Base w/ Tan Glue	PLM		TEM	X
C04	02	12"x12" Dark Blue Vinyl Floor Tile w/ Blue Streaks	PLM	X	TEM	
C05	02	12"x12" Dark Blue Vinyl Floor Tile w/ Blue Streaks	PLM	X	TEM	
C06	02	12"x12" Dark Blue Vinyl Floor Tile w/ Blue Streaks	PLM		TEM	X
C07	03	Wall Texture	PLM	X	TEM	
C08	03	Wall Texture	PLM	X	TEM	
C09	03	Wall Texture	PLM	X	TEM	
C10	04	12"x12" Tan Vinyl Floor Tile w/ Brown Streaks	PLM	X	TEM	
C11	04	12"x12" Tan Vinyl Floor Tile w/ Brown Streaks	PLM	X	TEM	
C12	04	12"x12" Tan Vinyl Floor Tile w/ Brown Streaks	PLM		TEM	X
C13	05	Brown Cove Base	PLM	X	TEM	
C14	05	Brown Cove Base	PLM	X	TEM	
C15	05	Brown Cove Base	PLM		TEM	X
C16	06	12"x12" Turquoise Vinyl Floor Tile	PLM	X	TEM	
C17	06	12"x12" Turquoise Vinyl Floor Tile	PLM	X	TEM	
C18	06	12"x12" Turquoise Vinyl Floor Tile	PLM		TEM	X
C19	07	6" Turquoise Cove Base	PLM	X	TEM	
C20	07	6" Turquoise Cove Base	PLM	X	TEM	
C21	07	6" Turquoise Cove Base	PLM		TEM	X
C22	08	3" Turquoise Cove Base	PLM	X	TEM	
C23	08	3" Turquoise Cove Base	PLM	X	TEM	
C24	08	3" Turquoise Cove Base	PLM		TEM	X
C25	09	12"x12" Gray Vinyl Floor Tile w/ White & Gray Streaks	PLM	X	TEM	
C26	09	12"x12" Gray Vinyl Floor Tile w/ White & Gray Streaks	PLM	X	TEM	
C27	09	12"x12" Gray Vinyl Floor Tile w/ White & Gray Streaks	PLM		TEM	X
C28	10	2'x2' Ceiling Tile w/ Pinholes & Large Holes	PLM	X	TEM	
C29	10	2'x2' Ceiling Tile w/ Pinholes & Large Holes	PLM	X	TEM	
C30	10	2'x2' Ceiling Tile w/ Pinholes & Large Holes	PLM	X	TEM	
C31	11	2'x4' Ceiling Tile w/ Pinholes & Large Holes	PLM	X	TEM	
C32	11	2'x4' Ceiling Tile w/ Pinholes & Large Holes	PLM	X	TEM	
C33	11	2'x4' Ceiling Tile w/ Pinholes & Large Holes	PLM	X	TEM	



SAMPLING FORM

COMPANY CONTACT INFORMATION	
Crossroads Environmental, LLC	Job Contact: Kay H. Horton
Project: Name: DISC Building	
Project: ID #: 17799-IN	Tel: 864-541-8736

SAMPLE ID#	HA	DESCRIPTION / LOCATION	TEST			
			PLM	X	TEM	
C34	12	2'x4' Ceiling Tile w/ Pinholes & Gashes	PLM	X	TEM	
C35	12	2'x4' Ceiling Tile w/ Pinholes & Gashes	PLM	X	TEM	
C36	12	2'x4' Ceiling Tile w/ Pinholes & Gashes	PLM	X	TEM	
C37	13	2'x4' Ceiling Tile w/ Pinholes & Squiggles	PLM	X	TEM	
C38	13	2'x4' Ceiling Tile w/ Pinholes & Squiggles	PLM	X	TEM	
C39	13	2'x4' Ceiling Tile w/ Pinholes & Squiggles	PLM	X	TEM	
C40	14	Dark Gray Cove Base	PLM	X	TEM	
C41	14	Dark Gray Cove Base	PLM	X	TEM	
C42	14	Dark Gray Cove Base	PLM		TEM	X
C43	15	Drywall/Joint Compound	PLM	X	TEM	
C44	15	Drywall/Joint Compound	PLM	X	TEM	
C45	15	Drywall/Joint Compound	PLM	X	TEM	
C46	15	Drywall/Joint Compound	PLM	X	TEM	
C47	15	Drywall/Joint Compound	PLM	X	TEM	
C48	16	Carpet Glue	PLM	X	TEM	
C49	16	Carpet Glue	PLM	X	TEM	
C50	16	Carpet Glue	PLM		TEM	X
C51	17	Carpet Glue	PLM	X	TEM	
C52	17	Carpet Glue	PLM	X	TEM	
C53	17	Carpet Glue	PLM		TEM	X
C54	18	Gray Cove Base w/ Cream Glue	PLM	X	TEM	
C55	18	Gray Cove Base w/ Cream Glue	PLM	X	TEM	
C56	18	Gray Cove Base w/ Cream Glue	PLM		TEM	X
C57	19	Red Firestop	PLM	X	TEM	
C58	19	Red Firestop	PLM	X	TEM	
C59	19	Red Firestop	PLM		TEM	X
C60	20	Blown-In Insulation	PLM	X	TEM	
C61	20	Blown-In Insulation	PLM	X	TEM	
C62	20	Blown-In Insulation	PLM	X	TEM	
C63	20	Blown-In Insulation	PLM	X	TEM	
C64	20	Blown-In Insulation	PLM	X	TEM	
C65	21	Brown Caulk	PLM	X	TEM	
C66	21	Brown Caulk	PLM	X	TEM	
C67	21	Brown Caulk	PLM		TEM	X

10
11
12
13

A205837



SAMPLING FORM

COMPANY CONTACT INFORMATION	
Crossroads Environmental, LLC	Job Contact: Kay H. Horton
Project Name: DISC Building	
Project ID #: 17799-IN	Tel: 864-541-8736

SAMPLE ID#	HA	DESCRIPTION / LOCATION	TEST			
			PLM	X	TEM	
C68	22	Light Brown Caulk	PLM	X	TEM	
C69	22	Light Brown Caulk	PLM	X	TEM	
C70	22	Light Brown Caulk	PLM		TEM	X
C71	23	Joint Caulk	PLM	X	TEM	
C72	23	Joint Caulk	PLM	X	TEM	
C73	23	Joint Caulk	PLM		TEM	X
C74	24	Black Caulk	PLM	X	TEM	
C75	24	Black Caulk	PLM	X	TEM	
C76	24	Black Caulk	PLM		TEM	X
C77	25	Gray Caulk	PLM	X	TEM	
C78	25	Gray Caulk	PLM	X	TEM	
C79	25	Gray Caulk	PLM		TEM	X
C80	26	Stucco Material	PLM	X	TEM	
C81	26	Stucco Material	PLM	X	TEM	
C82	26	Stucco Material	PLM	X	TEM	

May 13, 2020

Crossroads Environmental
1258 Boiling Springs Road
Spartanburg, SC 29303

CLIENT PROJECT: DISC Building, 17799-IN
CEI LAB CODE: A206027

Dear Customer:

Enclosed are asbestos analysis results for PLM Bulk samples received at our laboratory on May 13, 2020. The samples were analyzed for asbestos using polarizing light microscopy (PLM) per the EPA 600 Method.

Sample results containing >1% asbestos are considered asbestos-containing materials (ACMs) per EPA regulatory requirements. The detection limit for the EPA 600 Method is <1% asbestos by weight as determined by visual estimation.

Thank you for your business and we look forward to continuing good relations.

Kind Regards,

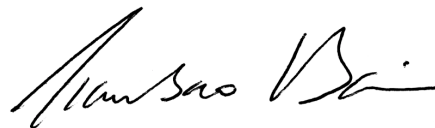

Tianbao Bai, Ph.D., CIH
Laboratory Director



CEI

ASBESTOS ANALYTICAL REPORT

By: Polarized Light Microscopy

Prepared for

Crossroads Environmental

CLIENT PROJECT: DISC Building, 17799-IN

LAB CODE: A206027

TEST METHOD: EPA 600 / R93 / 116 and EPA 600 / M4-82 / 020

REPORT DATE: 05/13/20

TOTAL SAMPLES ANALYZED: 16

SAMPLES >1% ASBESTOS:



CEI

Asbestos Report Summary

By: POLARIZING LIGHT MICROSCOPY

PROJECT: DISC Building, 17799-IN

LAB CODE: A206027

METHOD: EPA 600 / R93 / 116 and EPA 600 / M4-82 / 020

Client ID	Layer	Lab ID	Color	Sample Description	ASBESTOS %
083		A96665	Tan	Ceiling Grid Caulk	None Detected
084		A96666	Tan	Ceiling Grid Caulk	None Detected
085		A96667		Sample Submitted for TEM Analysis	
086		A96668	Tan	Duct Mastic	None Detected
087		A96669	Tan	Duct Mastic	None Detected
088		A96670		Sample Submitted for TEM Analysis	
089		A96671	White,Off-white	Ceiling Texture	None Detected
090		A96672	White,Off-white	Ceiling Texture	None Detected
091		A96673	White,Off-white	Ceiling Texture	None Detected
092		A96674	Off-white	Block Sealer Material	None Detected
093		A96675	Off-white	Block Sealer Material	None Detected
094		A96676	Off-white	Block Sealer Material	None Detected
095		A96677	Off-white	Block Sealer Material	None Detected
096		A96678	Off-white	Block Sealer Material	None Detected
097		A96679	Black	Sink Coating	None Detected
098		A96680	Black	Sink Coating	None Detected
099		A96681		Sample Submitted for TEM Analysis	
047-A	Layer 1	A96682	White,Off-white	Joint Compound	None Detected
	Layer 2	A96682	Off-white	Drywall	None Detected
047-B	Layer 1	A96683	White,Off-white	Joint Compound	None Detected
	Layer 2	A96683	Off-white	Drywall	None Detected

ASBESTOS BULK ANALYSIS

By: POLARIZING LIGHT MICROSCOPY

Client: Crossroads Environmental
 1258 Boiling Springs Road
 Spartanburg, SC 29303

Lab Code: A206027
Date Received: 05-13-20
Date Analyzed: 05-13-20
Date Reported: 05-13-20

Project: DISC Building, 17799-IN

ASBESTOS BULK PLM, EPA 600 METHOD

Client ID Lab ID	Lab Description	Lab Attributes	NON-ASBESTOS COMPONENTS			ASBESTOS %
			Fibrous		Non-Fibrous	
083 A96665	Ceiling Grid Caulk	Homogeneous Tan Non-fibrous Tightly Bound			100% Caulk	None Detected
084 A96666	Ceiling Grid Caulk	Homogeneous Tan Non-fibrous Tightly Bound			100% Caulk	None Detected
085 A96667	Sample Submitted for TEM Analysis					
086 A96668	Duct Mastic	Homogeneous Tan Fibrous Tightly Bound	5% <1%	Cellulose Synthetic Fiber	95% Mastic	None Detected
087 A96669	Duct Mastic	Homogeneous Tan Fibrous Tightly Bound	5% <1%	Cellulose Synthetic Fiber	95% Mastic	None Detected
088 A96670	Sample Submitted for TEM Analysis					
089 A96671	Ceiling Texture	Heterogeneous White, Off-white Non-fibrous Bound			30% Vermiculite 65% Binder 5% Paint	None Detected
090 A96672	Ceiling Texture	Heterogeneous White, Off-white Non-fibrous Bound			30% Vermiculite 65% Binder 5% Paint	None Detected

ASBESTOS BULK ANALYSIS

By: POLARIZING LIGHT MICROSCOPY

Client: Crossroads Environmental
 1258 Boiling Springs Road
 Spartanburg, SC 29303

Lab Code: A206027
Date Received: 05-13-20
Date Analyzed: 05-13-20
Date Reported: 05-13-20

Project: DISC Building, 17799-IN

ASBESTOS BULK PLM, EPA 600 METHOD

Client ID Lab ID	Lab Description	Lab Attributes	NON-ASBESTOS COMPONENTS				ASBESTOS %
			Fibrous		Non-Fibrous		
091 A96673	Ceiling Texture	Heterogeneous	30%	Vermiculite	None Detected		
		White, Off-white	65%	Binder			
		Non-fibrous	5%	Paint			
		Bound					
092 A96674	Block Sealer Material	Homogeneous	<1%	Cellulose	25%	Calc Carb	None Detected
		Off-white			40%	Binder	
		Fibrous			35%	Silicates	
		Bound					
093 A96675	Block Sealer Material	Homogeneous	<1%	Cellulose	25%	Calc Carb	None Detected
		Off-white			40%	Binder	
		Fibrous			35%	Silicates	
		Bound					
094 A96676	Block Sealer Material	Homogeneous	<1%	Cellulose	25%	Calc Carb	None Detected
		Off-white			40%	Binder	
		Fibrous			35%	Silicates	
		Bound					
095 A96677	Block Sealer Material	Homogeneous	<1%	Cellulose	25%	Calc Carb	None Detected
		Off-white			40%	Binder	
		Fibrous			35%	Silicates	
		Bound					
096 A96678	Block Sealer Material	Homogeneous	<1%	Cellulose	25%	Calc Carb	None Detected
		Off-white			40%	Binder	
		Fibrous			35%	Silicates	
		Bound					
097 A96679	Sink Coating	Homogeneous	2%	Cellulose	98%	Tar	None Detected
		Black					
		Non-fibrous					
		Tightly Bound					



CEI

ASBESTOS BULK ANALYSIS

By: POLARIZING LIGHT MICROSCOPY

Client: Crossroads Environmental
1258 Boiling Springs Road
Spartanburg, SC 29303

Lab Code: A206027
Date Received: 05-13-20
Date Analyzed: 05-13-20
Date Reported: 05-13-20

Project: DISC Building, 17799-IN

ASBESTOS BULK PLM, EPA 600 METHOD

Client ID Lab ID	Lab Description	Lab Attributes	NON-ASBESTOS COMPONENTS				ASBESTOS %
			Fibrous		Non-Fibrous		
098 A96680	Sink Coating	Homogeneous Black Non-fibrous Tightly Bound	2%	Cellulose	98%	Tar	None Detected
099 A96681	Sample Submitted for TEM Analysis						
047-A Layer 1 A96682	Joint Compound	Heterogeneous White, Off-white Non-fibrous Bound			35% 62% 3%	Calc Carb Binder Paint	None Detected
Layer 2 A96682	Drywall	Heterogeneous Off-white Fibrous Bound	13% 2%	Cellulose Fiberglass	85%	Gypsum	None Detected
047-B Layer 1 A96683	Joint Compound	Heterogeneous White, Off-white Non-fibrous Bound			35% 62% 3%	Calc Carb Binder Paint	None Detected
Layer 2 A96683	Drywall	Heterogeneous Off-white Fibrous Bound	13% 2%	Cellulose Fiberglass	85%	Gypsum	None Detected

LEGEND: Non-Anth = Non-Asbestiform Anthophyllite
Non-Trem = Non-Asbestiform Tremolite
Calc Carb = Calcium Carbonate

METHOD: EPA 600 / R93 / 116 and EPA 600 / M4-82 / 020

REPORTING LIMIT: <1% by visual estimation

REPORTING LIMIT FOR POINT COUNTS: 0.25% by 400 Points or 0.1% by 1,000 Points

REGULATORY LIMIT: >1% by weight

Due to the limitations of the EPA 600 method, nonfriable organically bound materials (NOBs) such as vinyl floor tiles can be difficult to analyze via polarized light microscopy (PLM). EPA recommends that all NOBs analyzed by PLM, and found not to contain asbestos, be further analyzed by Transmission Electron Microscopy (TEM). Please note that PLM analysis of dust and soil samples for asbestos is not covered under NVLAP accreditation. *Estimated measurement of uncertainty is available on request.*

This report relates only to the samples tested or analyzed and may not be reproduced, except in full, without written approval by Eurofins CEI. Eurofins CEI makes no warranty representation regarding the accuracy of client submitted information in preparing and presenting analytical results. Interpretation of the analytical results is the sole responsibility of the client. Samples were received in acceptable condition unless otherwise noted. This report may not be used by the client to claim product endorsement by NVLAP or any other agency of the U.S. Government.

Information provided by customer includes customer sample ID and sample description.

ANALYST:



McLane Brown

APPROVED BY:



Tianbao Bai, Ph.D., CIH
Laboratory Director



CHAIN OF CUSTODY

730 S.E. Maynard Rd., Cary, NC 27511
 Tel: 919-481-1413; Fax: 919-481-1442

LAB USE ONLY:	(19)
CEI Lab Code:	A206027
CEI Lab I.D. Range:	A96605 - A96683

COMPANY CONTACT INFORMATION	
Company: CROSSROADS ENVIRONMENTAL, LLC	Client #:
Address: 1258 BOILING SPRINGS RD.	Job Contact: Kay H. Horton
SPARTANBURG, SC 29303	Email: RESULTS@CROSSROADSENV.NET
	Tel: 864-541-8736
Project Name: DISC Building	Fax: 864-541-8776
Project ID #: 17799-IN	P.O. #:

ASBESTOS	METHOD	4 HR*	8 HR*	24 HR	2 DAY	3 DAY	5 DAY
PLM BULK	EPA 600			X			
TEM BULK	CHATFIELD			X			
PLM POINT COUNT (400)	EPA 600						
PLM POINT COUNT (1000)	EPA 600						
PLM GRAVIMETRIC	EPA 600						
PLM GRAV w POINT COUNT	EPA 600						
OTHER:							

POSITIVE STOP ANALYSIS	X
SOUTH CAROLINA SAMPLES	X
NORTH CAROLINA SAMPLES	

TEM INSTRUCTIONS	
BEGIN TEM ANALYSIS AFTER NEGATIVE PLM	X
ANALYZE TEM SAMPLES SIMULTANEOUSLY WITH PLM	

No Positive Stop on Surfacing		<input checked="" type="checkbox"/> Accept Samples <input type="checkbox"/> Reject Samples	
Relinquished By:	Date/Time	Received By:	Date/Time
			5/13 9:30

*Call to confirm RUSH analysis.

Samples will be disposed of 30 days after analysis

April 27, 2020

Crossroads Environmental
1258 Boiling Springs Road
Spartanburg, SC 29303

CLIENT PROJECT: 17799-IN
LAB CODE: T200880

Dear Customer:

Enclosed are asbestos analysis results for TEM bulk samples received at our laboratory on April 24, 2020. The samples were analyzed for asbestos using transmission electron microscopy (TEM) per Chatfield/EPA 600/R-93/116 Sec. 2.5.5.1 method.

Sample results containing > 1% asbestos are considered asbestos-containing materials (ACMs) per the EPA regulatory requirements. The detection limit for the TEM Chatfield/EPA 600/R-93/116 Sec. 2.5.5.1 method is <1% depending on the processed weight and constituents of the sample.

Thank you for your business and we look forward to continuing good relations.

Kind Regards,

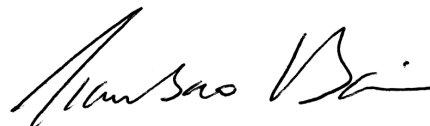

Tianbao Bai, Ph.D., CIH
Laboratory Director



CEI

ASBESTOS ANALYTICAL REPORT
By: Transmission Electron Microscopy

Prepared for

Crossroads Environmental

CLIENT PROJECT: 17799-IN

LAB CODE: T200880

TEST METHOD: Bulk Chatfield
EPA 600 / R93 / 116 Sec. 2.5.5.1

REPORT DATE: 04/27/20



CEI

ASBESTOS BULK ANALYSIS

By: TRANSMISSION ELECTRON MICROSCOPY

Client: Crossroads Environmental
1258 Boiling Springs Road
Spartanburg, SC 29303

Lab Code: T200880
Date Received: 04-24-20
Date Analyzed: 04-27-20
Date Reported: 04-27-20

Project: 17799-IN

TEM BULK CHATFIELD / EPA 600 / R93 / 116 Sec. 2.5.5.1

Client ID Lab ID	Material Description	Sample Weight (g)	Organic Material %	Acid Soluble Material %	Acid Insoluble Material %	Asbestos %
R202 T05616	Tar Gravel Bur	01.405	81.7	2.4	15.9	None Detected
R205 T05617	Tar Gravel Bur	0.74	55.5	22.3	22.2	None Detected
R214 T05618	Mod. Bit. Patch	0.608	81.3	6.9	11.8	None Detected

LEGEND: None

METHOD: CHATFIELD & EPA/600/R-93/116 Sec. 2.5.5.1

LIMIT OF DETECTION: Varies with the weight and constituents of the sample (<1%)

REGULATORY LIMIT: >1% by weight

This report relates only to the samples tested or analyzed and may not be reproduced, except in full, without written approval by Eurofins CEI. Eurofins CEI makes no warranty representation regarding the accuracy of client submitted information in preparing and presenting analytical results. Interpretation of the analytical results is the sole responsibility of the client. *Estimated measurement of uncertainty is available on request.* Samples were received in acceptable condition unless otherwise noted.

Information provided by customer includes customer sample ID, location, volume and area as well as date and time of sampling.

ANALYST:

Emily Morris

APPROVED BY:

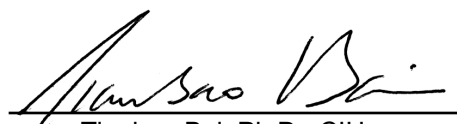
Tianbao Bai, Ph.D., CIH
Laboratory Director

T200880
T05616-18 (3)

A81842-A81856
Page 1 of 15

CROSSROADS ENVIRONMENTAL, LLC
 Sample Chain of Custody
 1258 Boiling Springs Road
 Spartanburg, SC 29303
 Phone: (864) 541-8736
 Fax: (864) 541-8776
 results@crossroadsenv.net

Date Sent: 4/22/20
 Project ID#: 17799-IN
 Submitted to: CEL
 Number of Samples: 15
 Fax Results: email
 Shipping Info: # _____

Type of Analysis:

<input type="checkbox"/>	<input checked="" type="checkbox"/>	<input checked="" type="checkbox"/>	<input type="checkbox"/>	<input type="checkbox"/>
PCM	PLM	TEM	AAS	Other
Air	Bulk	Air	Chips/	_____
		Bulk <input checked="" type="checkbox"/>	Wipes	_____
			Water	_____

Turn Around:

<input checked="" type="checkbox"/>	<input type="checkbox"/>	<input type="checkbox"/>	<input type="checkbox"/>
24 HR	48 HR	72 HR	5 Day

Other: PLM/TEM

Special Instructions:

Stop Positive PLM any layers not TEM'd

Sample ID#	DESCRIPTION OF SAMPLE	COMMENTS
R200	Toro Gravel Bulk (Perlite)	PLM
R201	↓	PLM
R202	↓	TEM
R203	Toro Gravel Bulk (F/G)	PLM
R204	↓	PLM
R205	↓	TEM
R206	Perimeter Flashing	PLM
R207	↓	PLM
R208	↓	TEM
R209	Equipment Flashing	PLM
R210	↓	PLM
R211	↓	TEM
R212	Mod. Bit. Patch	PLM
R213	↓	PLM
R214	↓	TEM

EUROFINS CEL, INC
 SAMPLES ACCEPTED
 [Signature]

Signature & Date of Handlers:

Relinquished By: [Signature] Received By: CP 4/23/20 9:20
 Relinquished By: YAB 4/24/20 10:35 Received By: Em 4/24/20 11:00
 Relinquished By: _____ Received By: _____

May 12, 2020

Crossroads Environmental
1258 Boiling Springs Road
Spartanburg, SC 29303

CLIENT PROJECT: DISC Building, 17799-IN
LAB CODE: T200986

Dear Customer:

Enclosed are asbestos analysis results for TEM bulk samples received at our laboratory on May 11, 2020. The samples were analyzed for asbestos using transmission electron microscopy (TEM) per Chatfield/EPA 600/R-93/116 Sec. 2.5.5.1 method.

Sample results containing > 1% asbestos are considered asbestos-containing materials (ACMs) per the EPA regulatory requirements. The detection limit for the TEM Chatfield/EPA 600/R-93/116 Sec. 2.5.5.1 method is <1% depending on the processed weight and constituents of the sample.

Thank you for your business and we look forward to continuing good relations.

Kind Regards,

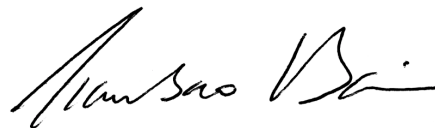

Tianbao Bai, Ph.D., CIH
Laboratory Director



CEI

ASBESTOS ANALYTICAL REPORT
By: Transmission Electron Microscopy

Prepared for

Crossroads Environmental

CLIENT PROJECT: DISC Building, 17799-IN

LAB CODE: T200986

TEST METHOD: Bulk Chatfield
EPA 600 / R93 / 116 Sec. 2.5.5.1

REPORT DATE: 05/12/20



CEI

ASBESTOS BULK ANALYSIS

By: TRANSMISSION ELECTRON MICROSCOPY

Client: Crossroads Environmental
1258 Boiling Springs Road
Spartanburg, SC 29303

Lab Code: T200986
Date Received: 05-11-20
Date Analyzed: 05-12-20
Date Reported: 05-12-20

Project: DISC Building, 17799-IN

TEM BULK CHATFIELD / EPA 600 / R93 / 116 Sec. 2.5.5.1

Client ID Lab ID	Material Description	Sample Weight (g)	Organic Material %	Acid Soluble Material %	Acid Insoluble Material %	Asbestos %
003 T06428	Covebase	0.603	40.6	31.5	27.9	None Detected
003 T06429	Glue	0.706	50.1	24.5	25.4	None Detected
006 T06430	Floor Tile	0.66	15.8	78.9	5.3	None Detected
006 T06431	Mastic	0.787	15.9	36.8	47.3	None Detected
010 T06432	Yellow Mastic	0.263	23.2	58.6	18.2	None Detected
Only present on sample 010						
012 T06433	Floor Tile	0.736	20.4	72.3	7.3	None Detected
012 T06434	Black Mastic	0.179	87.7	10.1	2.2	None Detected
015 T06435	Covebase	0.515	33.2	29.5	37.3	None Detected
018 T06436	Floor Tile	0.717	17	54.3	28.7	None Detected
018 T06437	Mastic	0.608	62.5	16.4	21.1	None Detected
021 T06438	Covebase	0.77	42.2	35.3	22.5	None Detected
024 T06439	Covebase	0.773	53.4	46.4	.2	None Detected



CEI

ASBESTOS BULK ANALYSIS

By: TRANSMISSION ELECTRON MICROSCOPY

Client: Crossroads Environmental
1258 Boiling Springs Road
Spartanburg, SC 29303

Lab Code: T200986
Date Received: 05-11-20
Date Analyzed: 05-12-20
Date Reported: 05-12-20

Project: DISC Building, 17799-IN

TEM BULK CHATFIELD / EPA 600 / R93 / 116 Sec. 2.5.5.1

Client ID Lab ID	Material Description	Sample Weight (g)	Organic Material %	Acid Soluble Material %	Acid Insoluble Material %	Asbestos %
027 T06440	Floor Tile	0.594	16	79	5	None Detected
027 T06441	Yellow Mastic	0.699	58.8	39.5	1.7	None Detected
027 T06442	Black Mastic	0.458	42.6	55.5	1.9	None Detected
042 T06443	Covebase	0.57	51.2	37.9	10.9	None Detected
050 T06444	Carpet Glue	01.156	29.8	58.8	11.4	None Detected
053 T06445	Carpet Glue	0.5	58	7	35	None Detected
056 T06446	Covebase	0.664	57.2	42	.8	None Detected
056 T06447	Glue	0.683	41	31.8	27.2	None Detected
059 T06448	Firestop	0.346	42.8	43.4	13.8	None Detected
067 T06449	Caulking	0.71	28.2	50.8	21	None Detected
070 T06450	Brown Caulking	0.503	54.5	41.2	4.3	None Detected
070 T06451	Black Caulking	0.382	40.3	57.3	2.4	None Detected



CEI

ASBESTOS BULK ANALYSIS

By: TRANSMISSION ELECTRON MICROSCOPY

Client: Crossroads Environmental
1258 Boiling Springs Road
Spartanburg, SC 29303

Lab Code: T200986
Date Received: 05-11-20
Date Analyzed: 05-12-20
Date Reported: 05-12-20

Project: DISC Building, 17799-IN

TEM BULK CHATFIELD / EPA 600 / R93 / 116 Sec. 2.5.5.1

Client ID Lab ID	Material Description	Sample Weight (g)	Organic Material %	Acid Soluble Material %	Acid Insoluble Material %	Asbestos %
073 T06452	Joint Caulk	0.403	51.6	46.2	2.2	None Detected
076 T06453	Caulk	0.548	53.3	44.3	2.4	None Detected
079 T06454	Caulk	0.438	49.8	46.6	3.6	None Detected

LEGEND: None

METHOD: CHATFIELD & EPA/600/R-93/116 Sec. 2.5.5.1

LIMIT OF DETECTION: Varies with the weight and constituents of the sample (<1%)

REGULATORY LIMIT: >1% by weight

This report relates only to the samples tested or analyzed and may not be reproduced, except in full, without written approval by Eurofins CEI. Eurofins CEI makes no warranty representation regarding the accuracy of client submitted information in preparing and presenting analytical results. Interpretation of the analytical results is the sole responsibility of the client. *Estimated measurement of uncertainty is available on request.* Samples were received in acceptable condition unless otherwise noted.

Information provided by customer includes customer sample ID, location, volume and area as well as date and time of sampling.

ANALYST:

Emily Morris

APPROVED BY:

Tianbao Bai, Ph.D., CIH
Laboratory Director



730 S.E. Maynard Rd., Cary, NC 27511
 Tel: 919-481-1413; Fax: 919-481-1442

27

T06428-54 T200986

CHAIN OF CUSTODY

LAB USE ONLY:	
CEI Lab Code:	A65837 (82)
CEI Lab I.D. Range:	A93927-A94008

COMPANY CONTACT INFORMATION	
Company: CROSSROADS ENVIRONMENTAL, LLC	Client #:
Address: 1258 BOILING SPRINGS RD.	Job Contact: Kay H. Horton
SPARTANBURG, SC 29303	Email: RESULTS@CROSSROADSENV.NET
	Tel: 864-541-8736
Project Name: DISC Building	Fax: 864-541-8776
Project ID #: 17799-IN	P.O. #:

ASBESTOS	METHOD	4 HR*	8 HR*	24 HR	2 DAY	3 DAY	5 DAY
PLM BULK	EPA 600			X			
TEM BULK	CHATFIELD			X			
PLM POINT COUNT (400)	EPA 600						
PLM POINT COUNT (1000)	EPA 600						
PLM GRAVIMETRIC	EPA 600						
PLM GRAV w POINT COUNT	EPA 600						
OTHER:							

POSITIVE STOP ANALYSIS	X
SOUTH CAROLINA SAMPLES	X
NORTH CAROLINA SAMPLES	

TEM INSTRUCTIONS	
BEGIN TEM ANALYSIS AFTER NEGATIVE PLM	X
ANALYZE TEM SAMPLES SIMULTANEOUSLY WITH PLM	

DO NOT STOP POSITIVE SURFACING MATERIAL

Accept Samples
 Reject Samples

Relinquished By:	Date/Time	Received By:	Date/Time
<i>Halley</i>	5/7/2020 0:00	CB	5/8 9:26
<i>YMB</i>	5/11/2020 @ 7:30	EB	05/11 12:05 pm

* Call to confirm RUSH analysis.

Samples will be disposed of 30 days after analysis



14WS831

T200986

SAMPLING FORM

COMPANY CONTACT INFORMATION	
Crossroads Environmental, LLC	Job Contact: Kay H. Horton
Projec: Name: DISC Building	
Projec: ID #: 17799-IN	Tel: 864-541-8736

SAMPLE ID#	HA	DESCRIPTION / LOCATION			TEST	
C34	12	2'x4' Ceiling Tile w/ Pinholes & Gashes	PLM	X	TEM	
C35	12	2'x4' Ceiling Tile w/ Pinholes & Gashes	PLM	X	TEM	
C36	12	2'x4' Ceiling Tile w/ Pinholes & Gashes	PLM	X	TEM	
C37	13	2'x4' Ceiling Tile w/ Pinholes & Squiggles	PLM	X	TEM	
C38	13	2'x4' Ceiling Tile w/ Pinholes & Squiggles	PLM	X	TEM	
C39	13	2'x4' Ceiling Tile w/ Pinholes & Squiggles	PLM	X	TEM	
C40	14	Dark Gray Cove Base	PLM	X	TEM	
C41	14	Dark Gray Cove Base	PLM	X	TEM	
C42	14	Dark Gray Cove Base	PLM		TEM	X
C43	15	Drywall/Joint Compound	PLM	X	TEM	
C44	15	Drywall/Joint Compound	PLM	X	TEM	
C45	15	Drywall/Joint Compound	PLM	X	TEM	
C46	15	Drywall/Joint Compound	PLM	X	TEM	
C47	15	Drywall/Joint Compound	PLM	X	TEM	
C48	16	Carpet Glue	PLM	X	TEM	
C49	16	Carpet Glue	PLM	X	TEM	
C50	16	Carpet Glue	PLM		TEM	X
C51	17	Carpet Glue	PLM	X	TEM	
C52	17	Carpet Glue	PLM	X	TEM	
C53	17	Carpet Glue	PLM		TEM	X
C54	18	Gray Cove Base w/ Cream Glue	PLM	X	TEM	
C55	18	Gray Cove Base w/ Cream Glue	PLM	X	TEM	
C56	18	Gray Cove Base w/ Cream Glue	PLM		TEM	X
C57	19	Red Firestop	PLM	X	TEM	
C58	19	Red Firestop	PLM	X	TEM	
C59	19	Red Firestop	PLM		TEM	X
C60	20	Blown-In Insulation	PLM	X	TEM	
C61	20	Blown-In Insulation	PLM	X	TEM	
C62	20	Blown-In Insulation	PLM	X	TEM	
C63	20	Blown-In Insulation	PLM	X	TEM	
C64	20	Blown-In Insulation	PLM	X	TEM	
C65	21	Brown Caulk	PLM	X	TEM	
C66	21	Brown Caulk	PLM	X	TEM	
C67	21	Brown Caulk	PLM		TEM	X



SAMPLING FORM

COMPANY CONTACT INFORMATION	
Crossroads Environmental, LLC	Job Contact: Kay H. Horton
Projec: Name: DISC Building	
Projec: ID #: 17799-IN	Tel: 864-541-8736

SAMPLE ID#	HA	DESCRIPTION / LOCATION	TEST			
			PLM	X	TEM	
C01	01	Gray Cove Base w/ Tan Glue	PLM	X	TEM	
C02	01	Gray Cove Base w/ Tan Glue	PLM	X	TEM	
C03	01	Gray Cove Base w/ Tan Glue	PLM		TEM	X
C04	02	12"x12" Dark Blue Vinyl Floor Tile w/ Blue Streaks	PLM	X	TEM	
C05	02	12"x12" Dark Blue Vinyl Floor Tile w/ Blue Streaks	PLM	X	TEM	
C06	02	12"x12" Dark Blue Vinyl Floor Tile w/ Blue Streaks	PLM		TEM	X
C07	03	Wall Texture	PLM	X	TEM	
C08	03	Wall Texture	PLM	X	TEM	
C09	03	Wall Texture	PLM	X	TEM	
C10	04	12"x12" Tan Vinyl Floor Tile w/ Brown Streaks	PLM	X	TEM	
C11	04	12"x12" Tan Vinyl Floor Tile w/ Brown Streaks	PLM	X	TEM	
C12	04	12"x12" Tan Vinyl Floor Tile w/ Brown Streaks	PLM		TEM	X
C13	05	Brown Cove Base	PLM	X	TEM	
C14	05	Brown Cove Base	PLM	X	TEM	
C15	05	Brown Cove Base	PLM		TEM	X
C16	06	12"x12" Turquoise Vinyl Floor Tile	PLM	X	TEM	
C17	06	12"x12" Turquoise Vinyl Floor Tile	PLM	X	TEM	
C18	06	12"x12" Turquoise Vinyl Floor Tile	PLM		TEM	X
C19	07	6" Turquoise Cove Base	PLM	X	TEM	
C20	07	6" Turquoise Cove Base	PLM	X	TEM	
C21	07	6" Turquoise Cove Base	PLM		TEM	X
C22	08	3" Turquoise Cove Base	PLM	X	TEM	
C23	08	3" Turquoise Cove Base	PLM	X	TEM	
C24	08	3" Turquoise Cove Base	PLM		TEM	X
C25	09	12"x12" Gray Vinyl Floor Tile w/ White & Gray Streaks	PLM	X	TEM	
C26	09	12"x12" Gray Vinyl Floor Tile w/ White & Gray Streaks	PLM	X	TEM	
C27	09	12"x12" Gray Vinyl Floor Tile w/ White & Gray Streaks	PLM		TEM	X
C28	10	2'x2' Ceiling Tile w/ Pinholes & Large Holes	PLM	X	TEM	
C29	10	2'x2' Ceiling Tile w/ Pinholes & Large Holes	PLM	X	TEM	
C30	10	2'x2' Ceiling Tile w/ Pinholes & Large Holes	PLM	X	TEM	
C31	11	2'x4' Ceiling Tile w/ Pinholes & Large Holes	PLM	X	TEM	
C32	11	2'x4' Ceiling Tile w/ Pinholes & Large Holes	PLM	X	TEM	
C33	11	2'x4' Ceiling Tile w/ Pinholes & Large Holes	PLM	X	TEM	



A203851
T200986

SAMPLING FORM

COMPANY CONTACT INFORMATION	
Crossroads Environmental, LLC	Job Contact: Kay H. Horton
Project Name: DISC Building	
Project ID #: 17799-IN	Tel: 864-541-8736

SAMPLE ID#	HA	DESCRIPTION / LOCATION	TEST			
			PLM	X	TEM	
C68	22	Light Brown Caulk	PLM	X	TEM	
C69	22	Light Brown Caulk	PLM	X	TEM	
C70	22	Light Brown Caulk	PLM		TEM	X
C71	23	Joint Caulk	PLM	X	TEM	
C72	23	Joint Caulk	PLM	X	TEM	
C73	23	Joint Caulk	PLM		TEM	X
C74	24	Black Caulk	PLM	X	TEM	
C75	24	Black Caulk	PLM	X	TEM	
C76	24	Black Caulk	PLM		TEM	X
C77	25	Gray Caulk	PLM	X	TEM	
C78	25	Gray Caulk	PLM	X	TEM	
C79	25	Gray Caulk	PLM		TEM	X
C80	26	Stucco Material	PLM	X	TEM	
C81	26	Stucco Material	PLM	X	TEM	
C82	26	Stucco Material	PLM	X	TEM	

May 14, 2020

Crossroads Environmental
1258 Boiling Springs Road
Spartanburg, SC 29303

CLIENT PROJECT: DISC Building, 17799-IN
LAB CODE: T201012

Dear Customer:

Enclosed are asbestos analysis results for TEM bulk samples received at our laboratory on May 13, 2020. The samples were analyzed for asbestos using transmission electron microscopy (TEM) per Chatfield/EPA 600/R-93/116 Sec. 2.5.5.1 method.

Sample results containing > 1% asbestos are considered asbestos-containing materials (ACMs) per the EPA regulatory requirements. The detection limit for the TEM Chatfield/EPA 600/R-93/116 Sec. 2.5.5.1 method is <1% depending on the processed weight and constituents of the sample.

Thank you for your business and we look forward to continuing good relations.

Kind Regards,

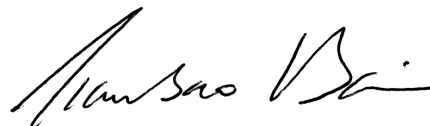

Tianbao Bai, Ph.D., CIH
Laboratory Director



CEI

ASBESTOS ANALYTICAL REPORT
By: Transmission Electron Microscopy

Prepared for

Crossroads Environmental

CLIENT PROJECT: DISC Building, 17799-IN

LAB CODE: T201012

TEST METHOD: Bulk Chatfield
EPA 600 / R93 / 116 Sec. 2.5.5.1

REPORT DATE: 05/14/20



CEI

ASBESTOS BULK ANALYSIS

By: TRANSMISSION ELECTRON MICROSCOPY

Client: Crossroads Environmental
1258 Boiling Springs Road
Spartanburg, SC 29303

Lab Code: T201012
Date Received: 05-13-20
Date Analyzed: 05-14-20
Date Reported: 05-14-20

Project: DISC Building, 17799-IN

TEM BULK CHATFIELD / EPA 600 / R93 / 116 Sec. 2.5.5.1

Client ID Lab ID	Material Description	Sample Weight (g)	Organic Material %	Acid Soluble Material %	Acid Insoluble Material %	Asbestos %
085 T06596	Ceiling Grid Caulk	0.483	50.3	7.7	42	None Detected
088 T06597	Duct Mastic	0.708	53.8	38.1	8.1	None Detected
099 T06598	Sink Coating	0.296	37.2	52	10.8	None Detected

LEGEND: None

METHOD: CHATFIELD & EPA/600/R-93/116 Sec. 2.5.5.1

LIMIT OF DETECTION: Varies with the weight and constituents of the sample (<1%)

REGULATORY LIMIT: >1% by weight

This report relates only to the samples tested or analyzed and may not be reproduced, except in full, without written approval by Eurofins CEI. Eurofins CEI makes no warranty representation regarding the accuracy of client submitted information in preparing and presenting analytical results. Interpretation of the analytical results is the sole responsibility of the client. *Estimated measurement of uncertainty is available on request.* Samples were received in acceptable condition unless otherwise noted.

Information provided by customer includes customer sample ID, location, volume and area as well as date and time of sampling.

ANALYST:

Partima Poudel Acharya

APPROVED BY:

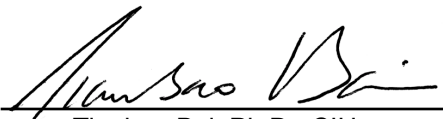
Tianbao Bai, Ph.D., CIH
Laboratory Director



730 S.E. Maynard Rd., Cary, NC 27511
 Tel: 919-481-1413; Fax: 919-481-1442

T06596-8 (3) T201012

CHAIN OF CUSTODY

LAB USE ONLY: (19)	
CEI Lab Code:	A780027
CEI Lab I.D. Range:	A90005-A90083

COMPANY CONTACT INFORMATION	
Company: CROSSROADS ENVIRONMENTAL, LLC	Client #:
Address: 1258 BOILING SPRINGS RD.	Job Contact: Kay H. Horton
SPARTANBURG, SC 29303	Email: RESULTS@CROSSROADSENV.NET
	Tel: 864-541-8736
Project Name: DISC Building	Fax: 864-541-8776
Project ID #: 17799-IN	P.O. #:

ASBESTOS	METHOD	4 HR*	8 HR*	24 HR	2 DAY	3 DAY	5 DAY
PLM BULK	EPA 600			X			
TEM BULK	CHATFIELD			X			
PLM POINT COUNT (400)	EPA 600						
PLM POINT COUNT (1000)	EPA 600						
PLM GRAVIMETRIC	EPA 600						
PLM GRAV w POINT COUNT	EPA 600						
OTHER:							

POSITIVE STOP ANALYSIS	X
SOUTH CAROLINA SAMPLES	X
NORTH CAROINA SAMPLES	

TEM INSTRUCTIONS	
BEGIN TEM ANALYSIS AFTER NEGATIVE PLM	X
ANALYZE TEM SAMPLES SIMULTANEOUSLY WITH PLM	

No Positive Stop on Surfacing

Accept Samples
 Reject Samples

Relinquished By:	Date/Time	Received By:	Date/Time
<i>[Signature]</i> MC	5/13/20 3:45pm	<i>[Signature]</i> EB	5/13 9:30 05/13 3:45pm

*Call to confirm RUSH analysis.

Samples will be disposed of 30 days after analysis

ATTACHMENT III
SAMPLE LOCATION SKETCH AND/OR PHOTOS

Drywall beam
wall texture

-Drywall

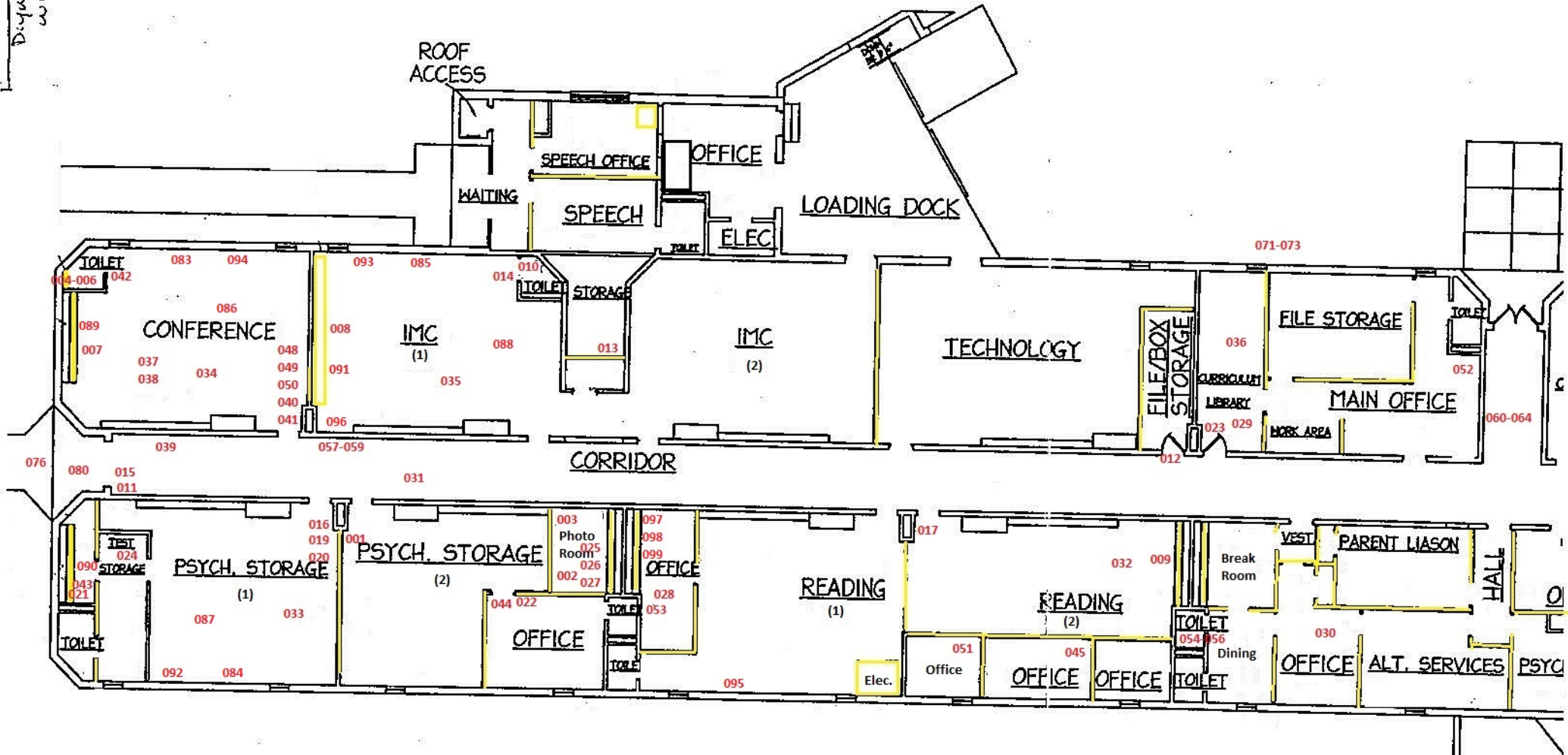

INSTRUCTIONAL SERVICES BUILDING

=Drywall

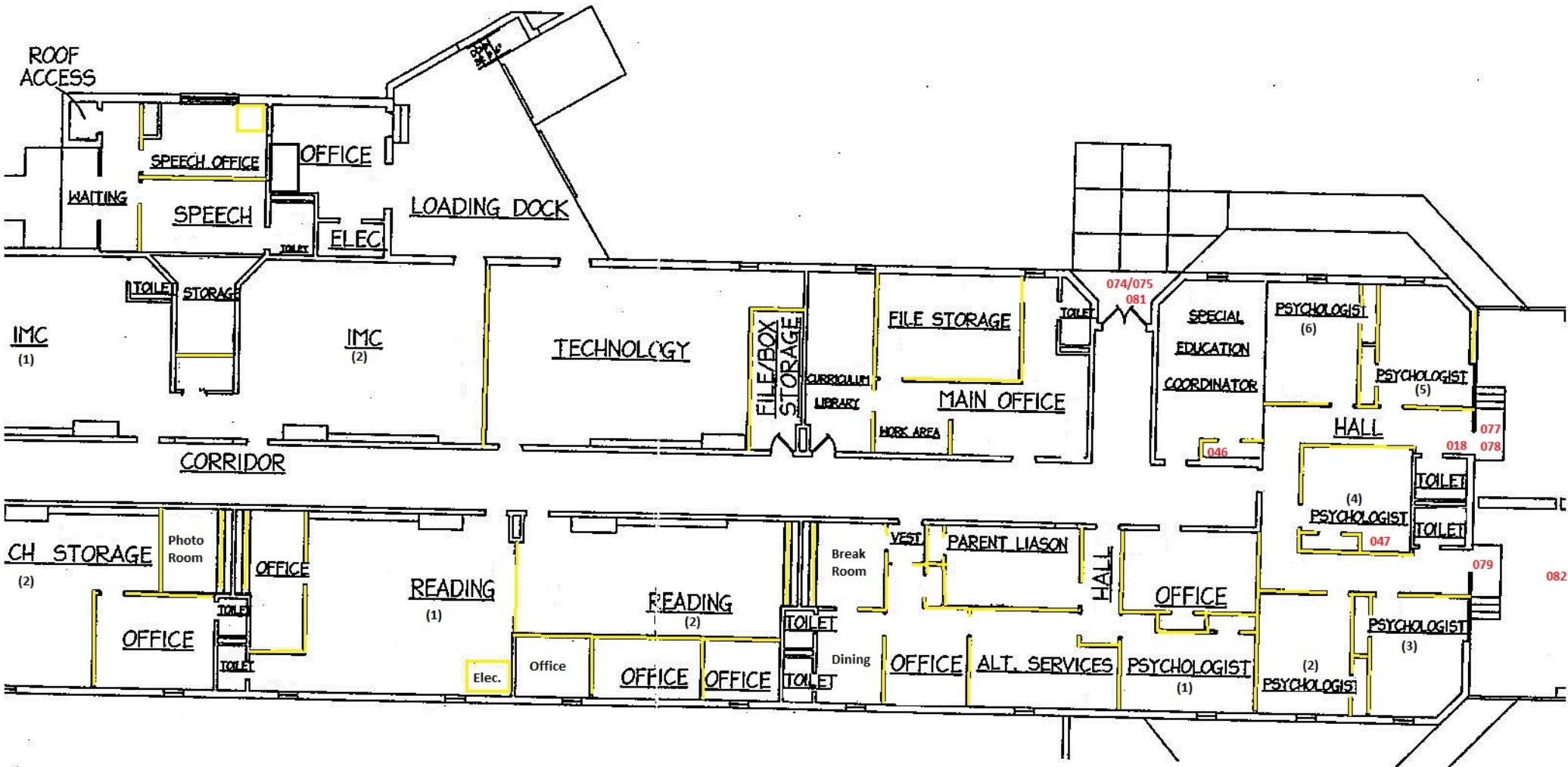

INSTRUCTIONAL SERVICES BUILDING

**ATTACHMENT IV
ACCREDITATION(S)**

SCDHEC ISSUED

Asbestos ID Card

Evans Harris



CONSULTBI

BI-01224

Expiration Date:

09/16/20

CONSULTPD

PD-00149

12/10/20

AIRSAMPLER

AS-00383

09/15/20

SCDHEC ISSUED

Asbestos ID Card

Haley Jones



CONSULTBI

BI-01733

Expiration Date:

07/09/20

AIRSAMPLER

AS-00559

06/30/20

CONSULTMP

MP-00261

12/09/20