

NORTH



THE SOUTHEAST 1/4 OF THE SOUTHEAST 1/4, LESS THE NORTH 25 FEET, THE EAST 40 FEET AND THE SOUTH 40 FEET THEREOF, OF SECTION 22, TOWNSHIP 55 SOUTH, RANGE 40 EAST, MIAMI-DADE COUNTY, FLORIDA. LESS THE C-100 CANAL ACCORDING WITH THE SOUTH FLORIDA WATER MANAGEMENT RIGHT-OF-WAY PLANS.

SURVEYOR'S NOTES:

LEGAL DESCRIPTION PROVIDED BY CLIENT.

NO EASEMENTS PROVIDED FOR (2) WATER LINE PIPES CROSSING
CANAL RIGHT-OF-WAY.

NO INGRESS AND EGRESS EASEMENT PROVIDED FOR ASPHALT PARKING LOT BETWEEN CORAL REEF ELEMENTARY SCHOOL AND CORAL REEF PARK.

NO UNDERGROUND UTILITIES WERE LOCATED.

BEARINGS SHOWN HEREON ARE BASED ON AN ASSUMED MERIDIAN ALONG
THE CENTERLINE OF CORAL REEF DRIVE, WHICH IS EAST.

BENCH MARK=R-602-2 ELEVATION= 11.62

FLOOD_ZONE: AH COMMUNITY: 120635 PANEL: 267
DATE_OF_FIRM: JULY 17, 1995 SUFFIX: J ELEVATION: 10.0

ABBREVIATIONS:



























DATE OF SURVEY: JULY 5 THRU 8, 12 THRU 15, 22, 2004

SURVEYOR'S CERTIFICATE:

NOT VALID WITHOUT THE SIGNATURE AND THE ORIGINAL RAISED SEAL OF A FLORIDA LICENSED SURVEYOR AND MAPPER. ADDITIONS OR DELETIONS TO SURVEY MAPS OR REPORTS BY OTHER THAN THE SIGNING PARTY OR PARTIES IS PROHIBITED WITHOUT WRITTEN CONSENT OF THE SIGNING PARTY OR PARTIES.

THIS CERTIFICATION APPLIES TO ALL SHEETS 1 THRU 10.
SHEETS NOT VALID WITHOUT WITHOUT SHEET 1.
FOR SKETCH OF SURVEY SEE SHEET 2 THRU 10.

SEAL

TREE LEGEND													
	BAY LEAF TREE		FICUS		ORCHID TREE		SLASH PINE		UMBRELLA		UNKNOWN TYPE "D"		WOMAN'S TONGUE (ALBIZIA)
	BLACK OLIVE		GUMBO LIMBO		PONGAM		SAUSAGE TREE		UNKNOWN TYPE "A"		UNKNOWN TYPE "E"		YELLOW POINCIANA
	CHINA BERRY		MAHAGONY		ROYAL PALM		SAW PALMETTO		UNKNOWN TYPE "B"		UNKNOWN TYPE "F"		
	CRAPE MYRTLE		OAK		ROYAL POINCIANA		TABEBUIA		UNKNOWN TYPE "C"		WILD TAMARIND (LYSILOMA)		

NORTH

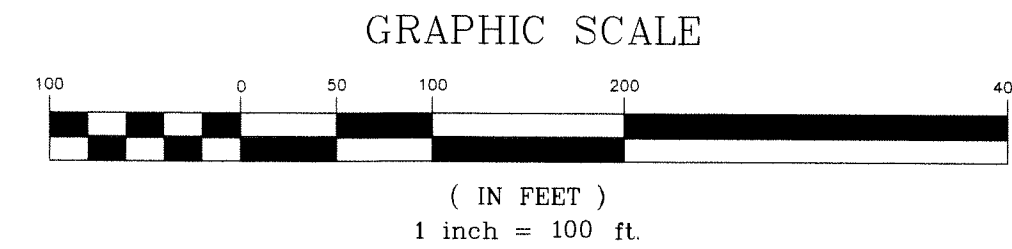
[illegible]

MAP OF SURVEY

"CORAL REEF PARK" FOR VILLAGE OF PALMETTO BAY

GRAPHIC SCALE

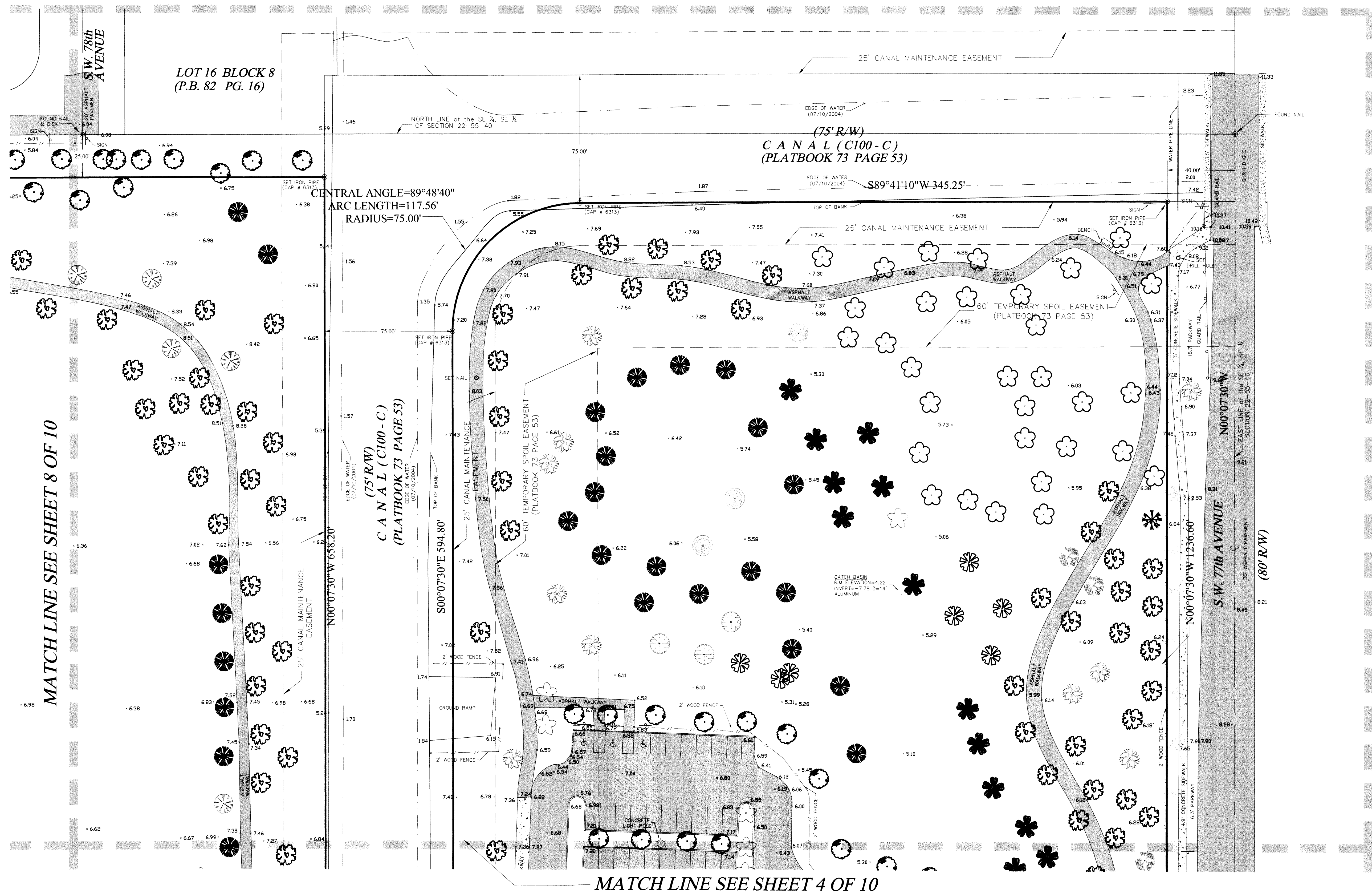
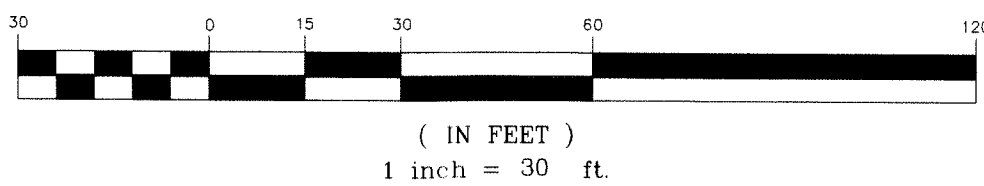

RECORD OF REVISION		DATE	DESCRIPTION	BY	APP.
P(3)SM, L.L.C. - L.B. No. 7335					
PROFESSIONAL SURVEYORS & MAPPERS					
3900 N.W. 79th AVENUE, SUITE #322 MIAMI, FL. 33166 PHONE: (305) 463-0912 FAX: (305) 463-0913					
BOUNDARY SURVEY					
DATE:	SCALE:				
07-28-04	AS SHOWN				
	F.B. / PG.				
	40 / 54 - 67				
	JOB No.				
	04-07-35				
SHEET:					
3 of 10					

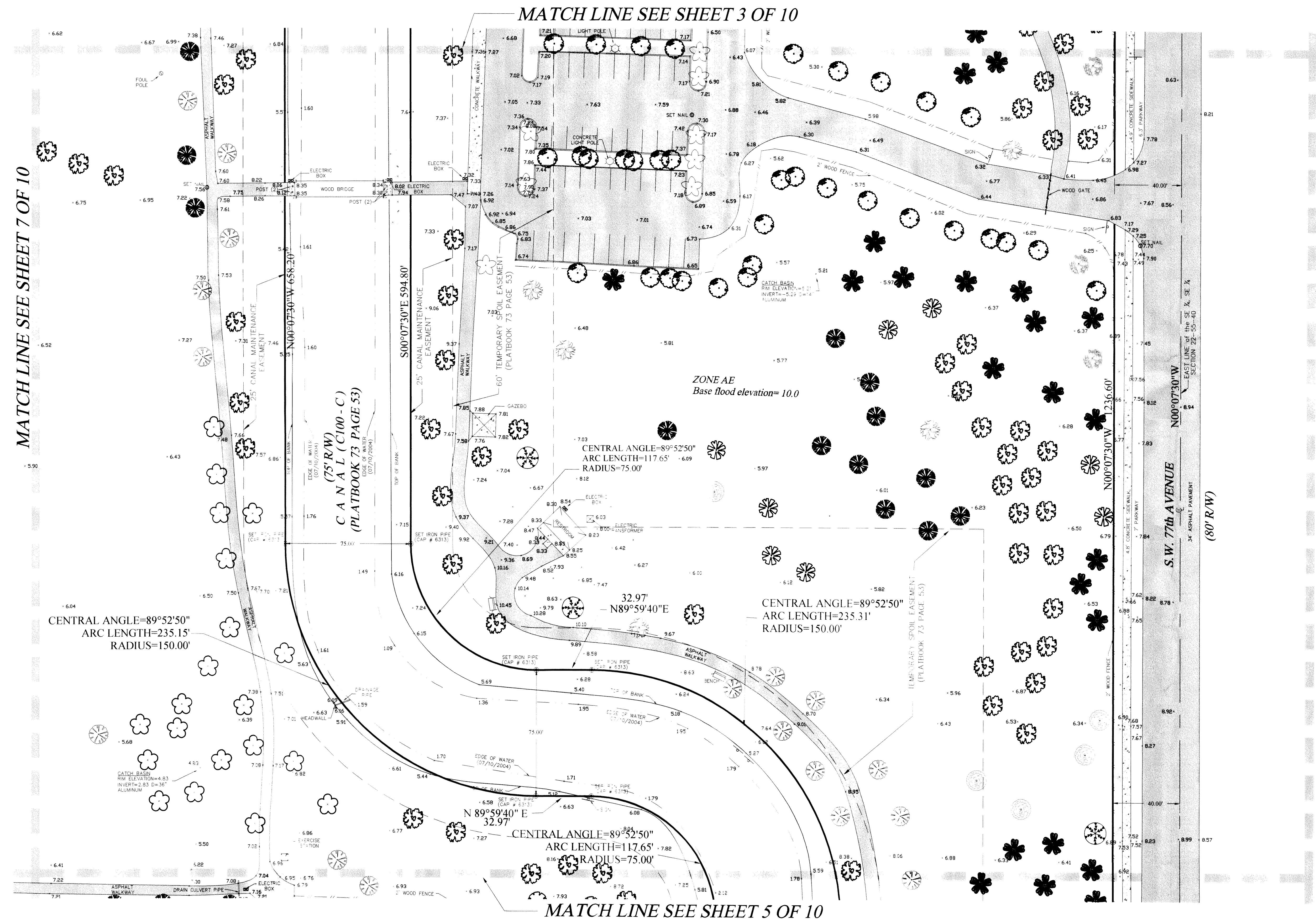
[illegible]

"CORAL REEF PARK" FOR VILLAGE OF PALMETTO BAY

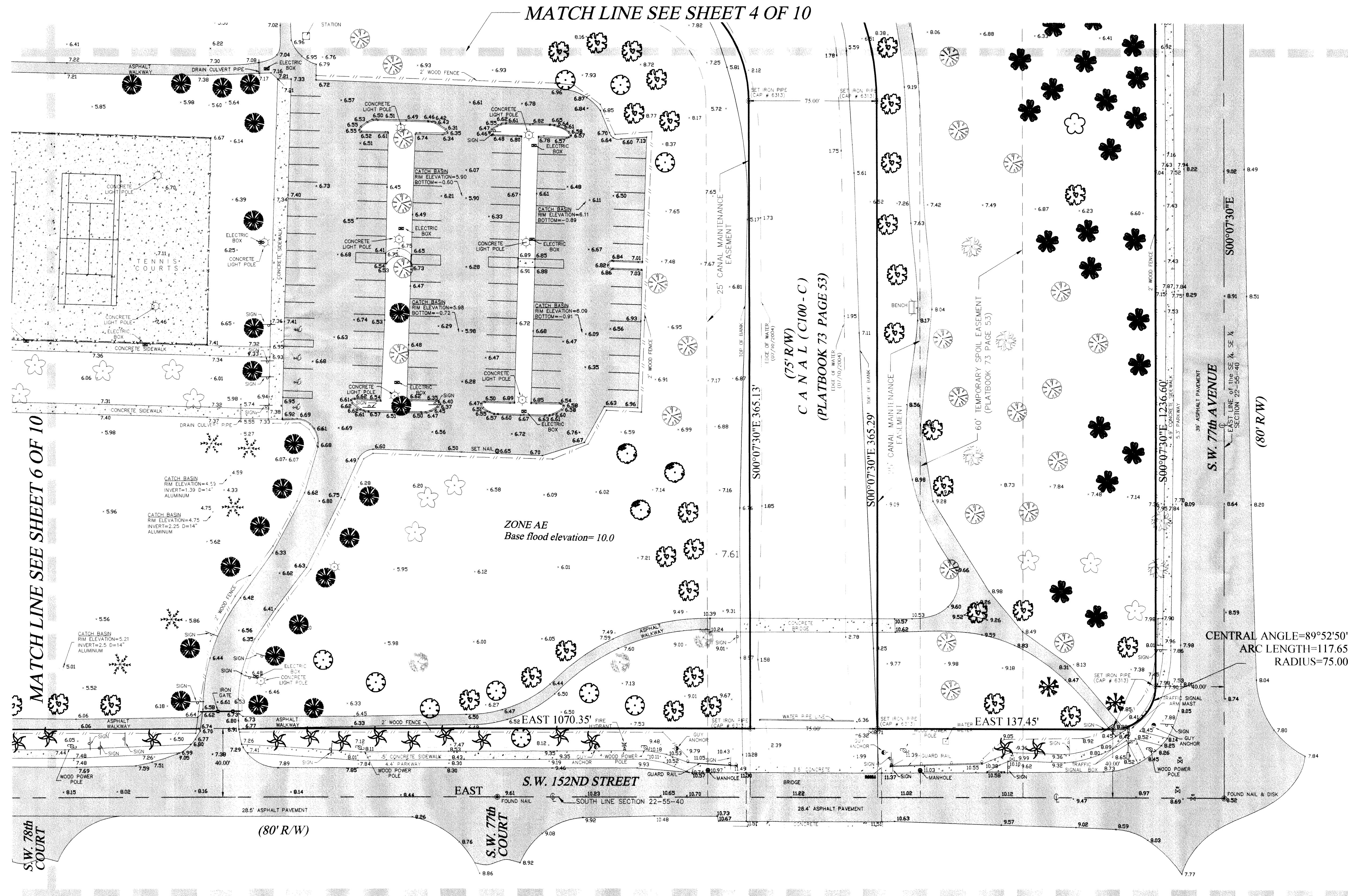

P(3)SM, L.L.C. - L.B. No. 7335						RECORD OF REVISION	
PROFESSIONAL SURVEYORS & MAPPERS						DATE	BY APP.
3900 N.W. 79th AVENUE, SUITE #322 MIAMI, FL. 33166 PHONE:(305) 463-0912 FAX:(305) 463-0913							
BOUNDARY SURVEY							
DATE:		SCALE:		F.B. / PG.	JOB No.		
07-28-04		AS SHOWN		40 / 54 - 67	04-07-35		

NORTH

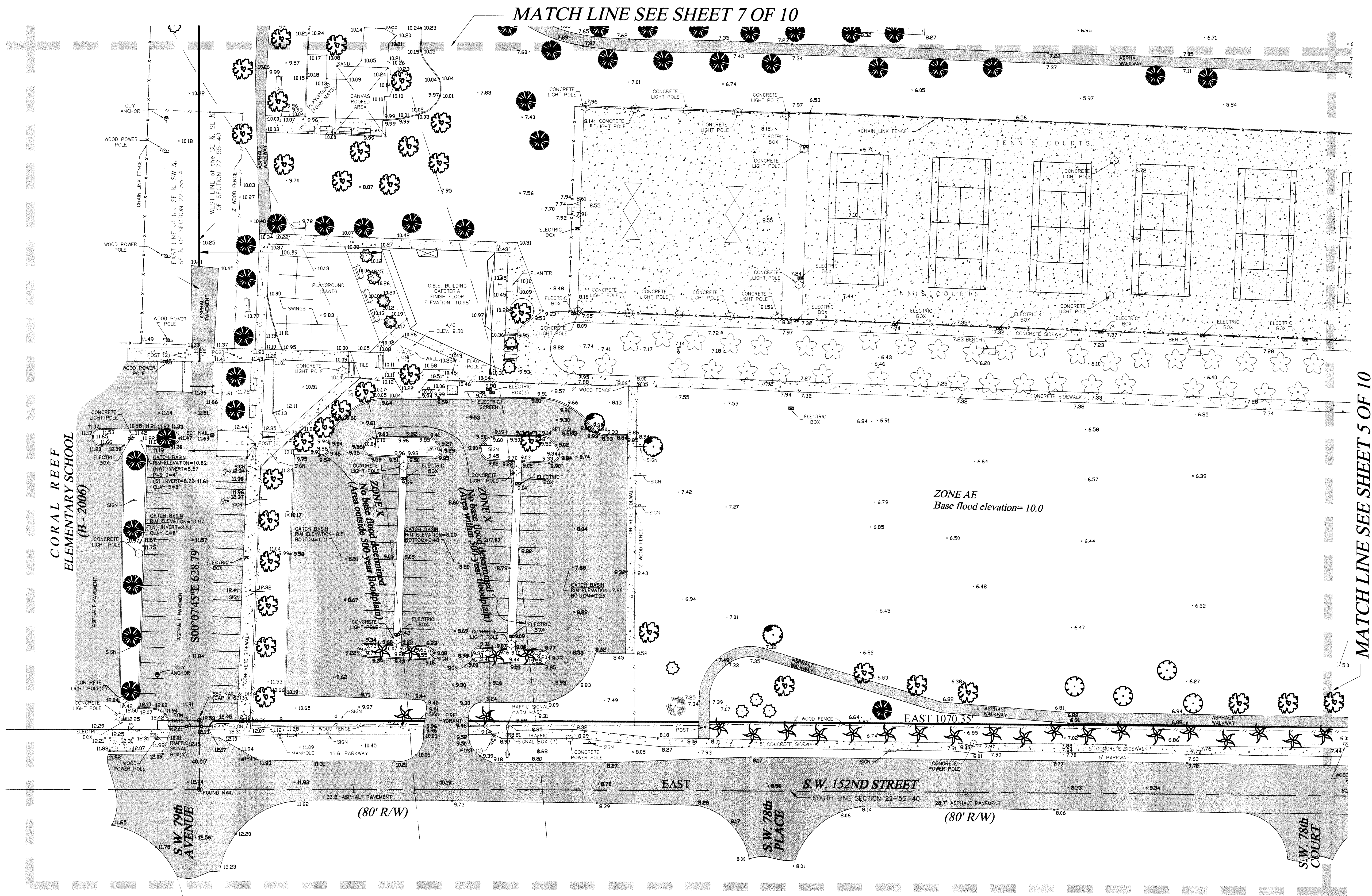

3900 N.W. 79th AVENUE, SUITE #822 MIAMI, FL. 33166 PHONE:(305) 463-0912 FAX:(305) 463-0913 PROFESSIONAL SURVEYORS & MAPPERS BOUNDARY SURVEY			
DATE:	SCALE:	F. B. / PG.	JOB No.
07-28-04	AS SHOWN	40 / 54 - 67	04-07-35

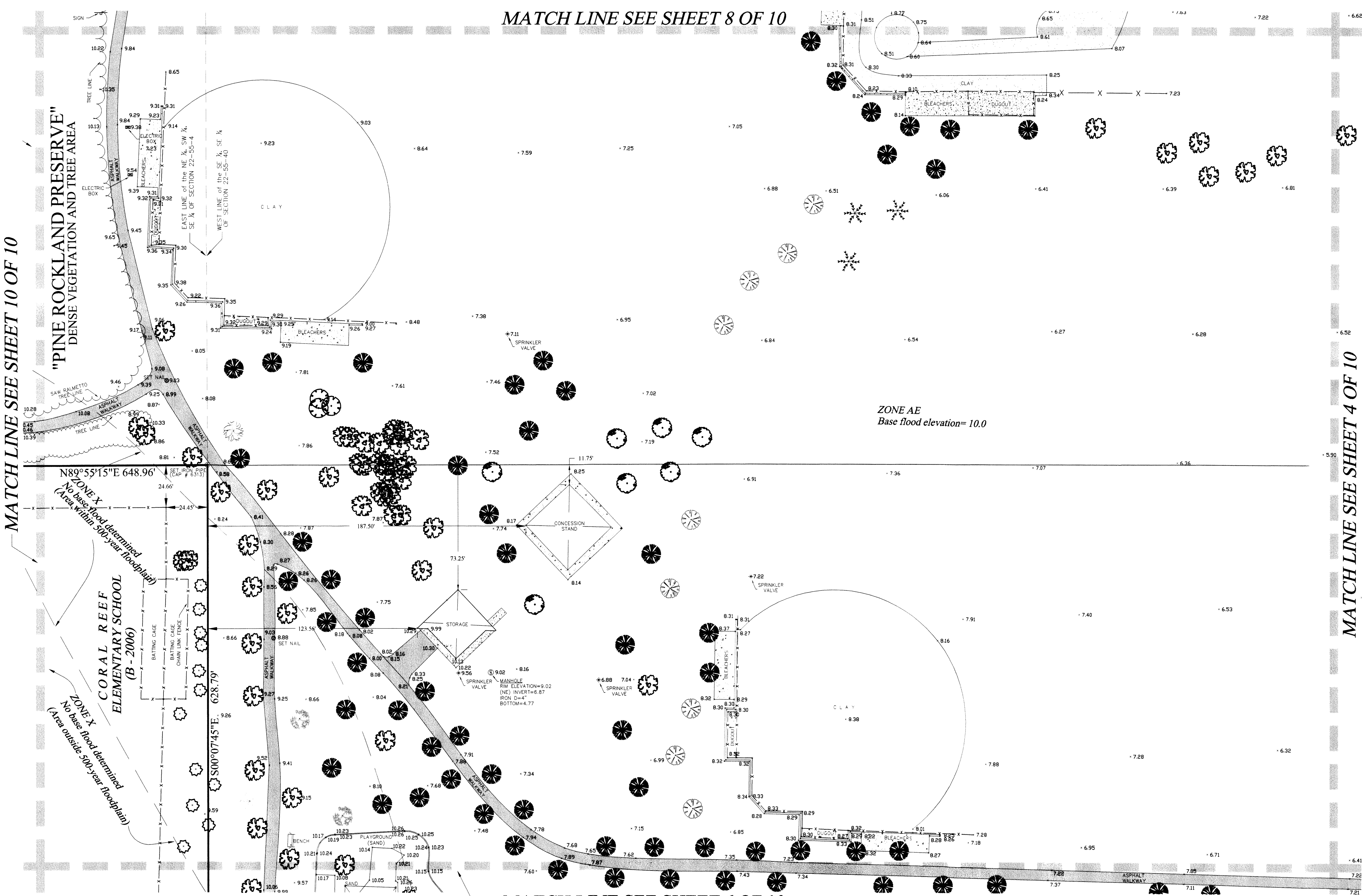

<div>SHEET: 7 of 10</div>	<div>P(3)SM, L.L.C. - L.B. No. 7335 PROFESSIONAL SURVEYORS & MAPPERS 3900 N.W. 79th AVENUE, SUITE #322 MIAMI, FL. 33166 PHONE: (305) 463-0912 FAX: (305) 463-0913</div>			<div>RECORD OF REVISION</div>	
	<div>BOUNDARY SURVEY</div>			DATE	BY
<div>DATE: 07-28-04</div>		<div>SCALE: AS SHOWN</div>	<div>F.B. / PG. 40 / 54 - 67</div>	<div>JOB No. 04-07-35</div>	

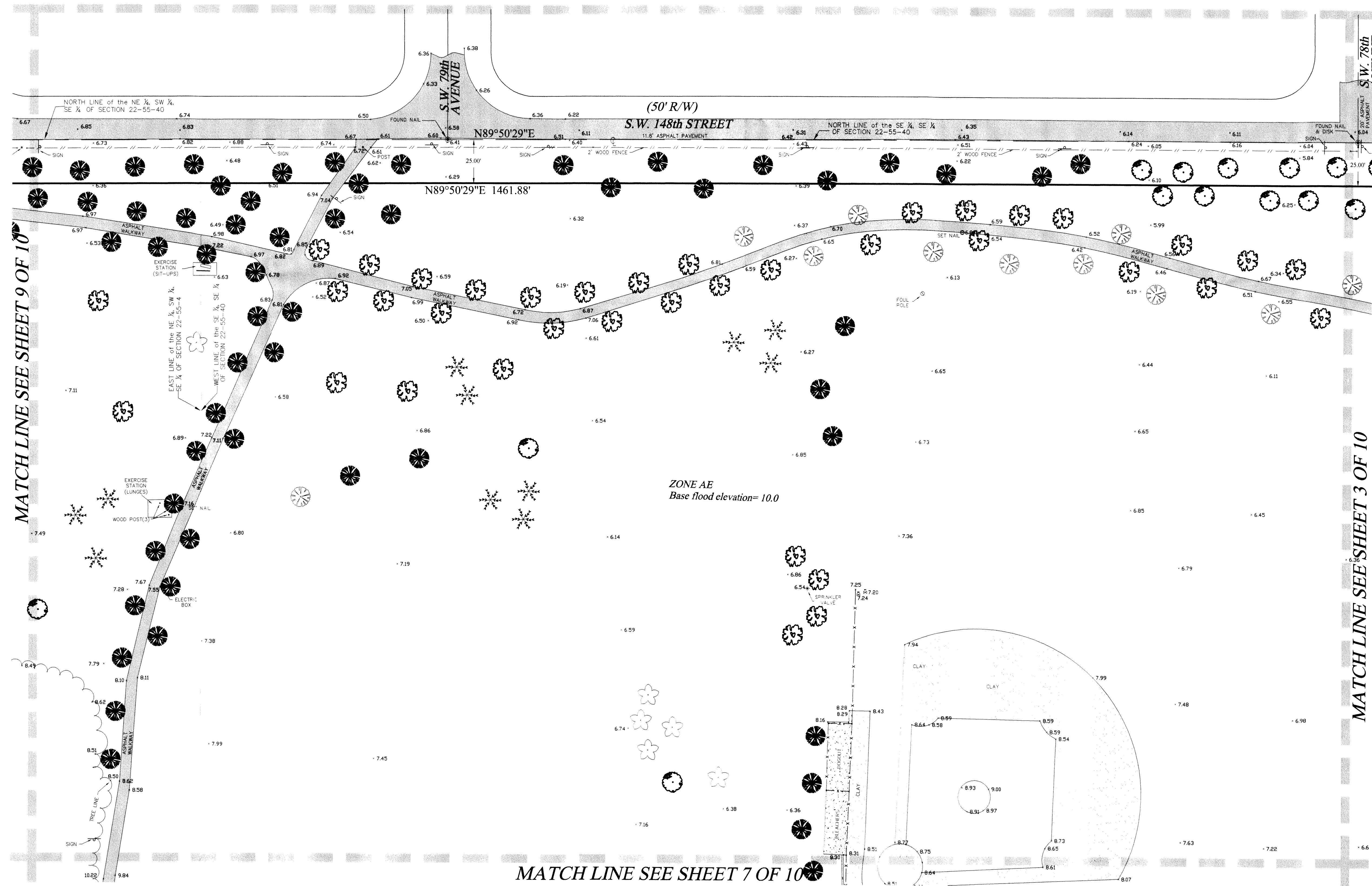

P(3)SMI, L.L.C.	-	L.B. NO. 7335
PROFESSIONAL SURVEYORS & MAPPERS		
3900 N.W. 79TH AVENUE, SUITE #822 MIAMI, FL. 33166 PHONE:(305) 463-0912 FAX:(305) 463-0913		
BOUNDARY SURVEY		
DATE:	SCALE:	F B. / PG.
07-28-04	AS SHOWN	40 / 54 - 67
JOB No.		
04-07-35		

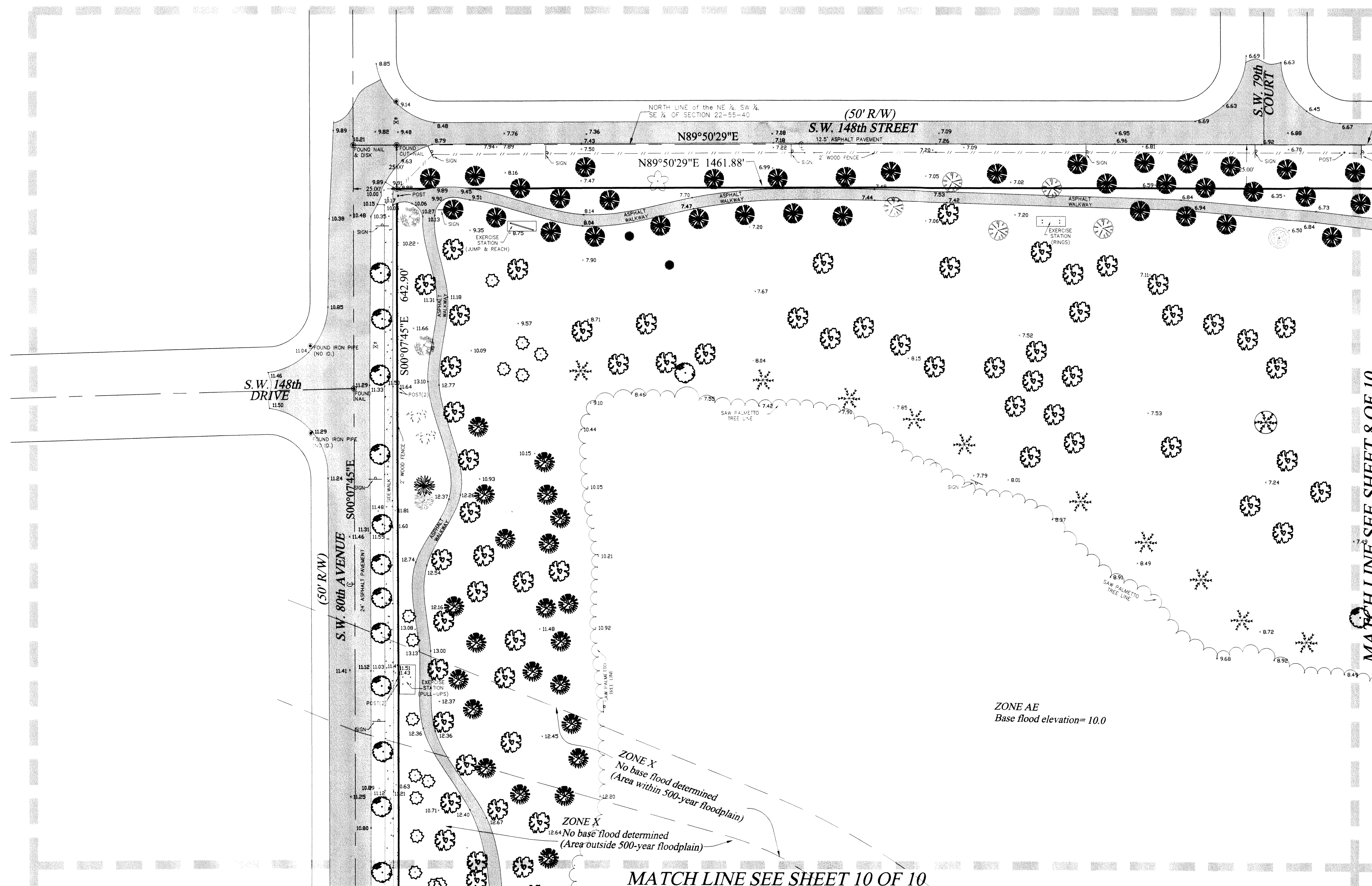

SHEET: 9 of 10	P(3)SM, L.L.C. - L.B. No. 7335 PROFESSIONAL SURVEYORS & MAPPERS 3900 N.W. 79th AVENUE, SUITE #322 MIAMI, FL. 33166 PHONE:(305) 463-0912 FAX:(305) 463-0913				RECORD OF REVISION			
	BOUNDARY SURVEY				DATE	DESCRIPTION		
DATE: 07-28-04		SCALE: AS SHOWN		F. B. / PG. 40 / 54 - 67		JOB No. 04-07-35		

NORTH

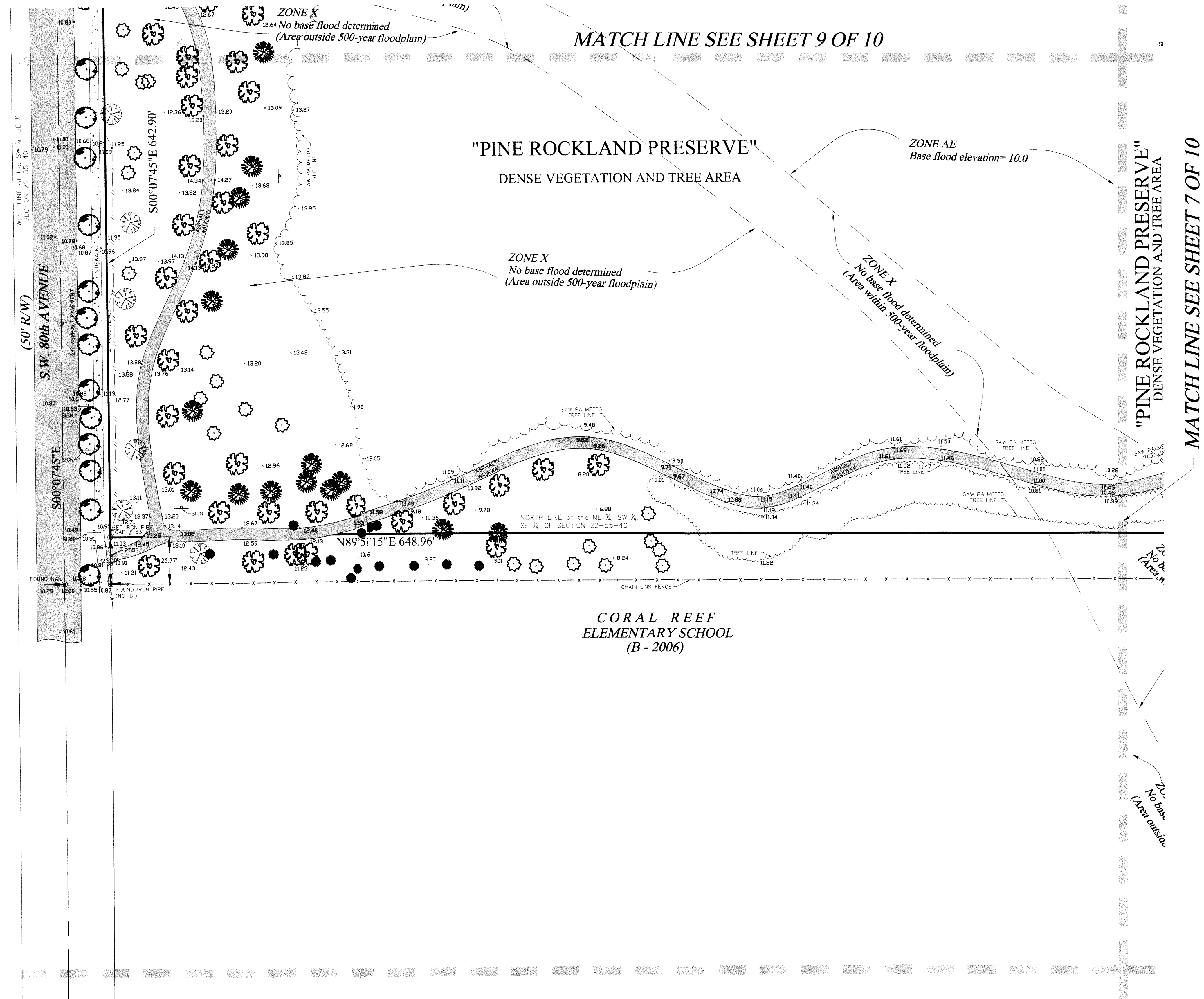
[illegible]