

EXISTING CONDITION, PROPOSED P/W AND PROPOSED UTILITY RELOCATION
PINETREE WAY/MEMORIAL DR ROAD WIDENING
 LAND LOT 998 - 12 TH. DISTRICT
 CITY OF DAHLONEGA, LUMPKIN COUNTY, GEORGIA

DATE:	REVISIONS:
12/14/21	REVISED PER DOT AND CITY COMMENTS
7/12/22	REVISED PER DOT COMMENTS

Lumpkin County Engineering
 1642 RED OAK FLATS RD.
 DAHLONEGA, GEORGIA 30533
 PHONE: (706) 864-3122

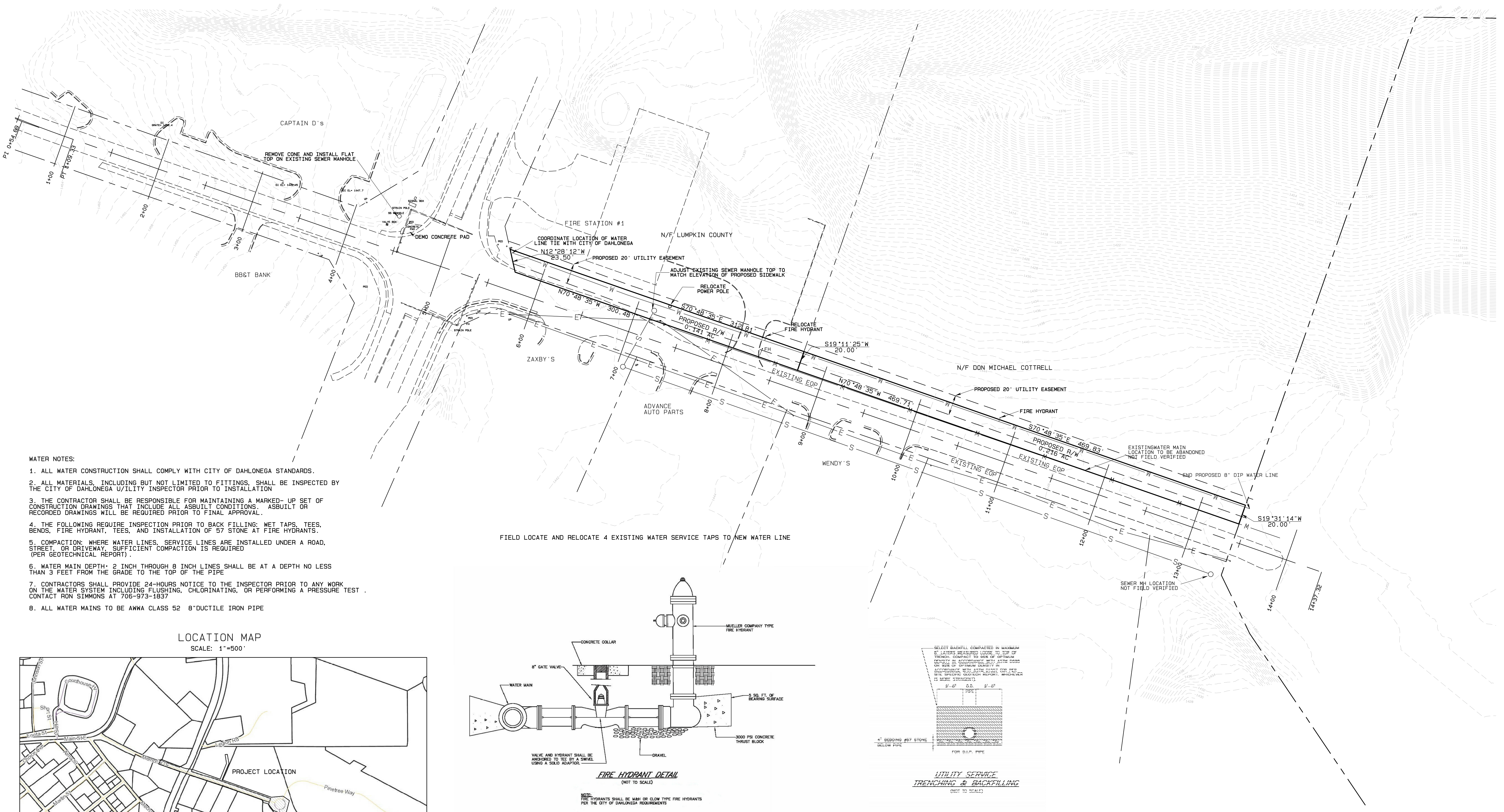
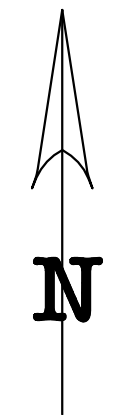

- WATER NOTES:**
1. ALL WATER CONSTRUCTION SHALL COMPLY WITH CITY OF DAHLONEGA STANDARDS.
 2. ALL MATERIALS, INCLUDING BUT NOT LIMITED TO FITTINGS, SHALL BE INSPECTED BY THE CITY OF DAHLONEGA UTILITY INSPECTOR PRIOR TO INSTALLATION
 3. THE CONTRACTOR SHALL BE RESPONSIBLE FOR MAINTAINING A MARKED-UP SET OF CONSTRUCTION DRAWINGS THAT INCLUDE ALL AS-BUILT CONDITIONS. AS-BUILT OR RECORDED DRAWINGS WILL BE REQUIRED PRIOR TO FINAL APPROVAL.
 4. THE FOLLOWING REQUIRE INSPECTION PRIOR TO BACK FILLING, WET TAPS, TEES, BENDS, FIRE HYDRANT, TEES, AND INSTALLATION OF 57 STONE AT FIRE HYDRANTS.
 5. COMPACTION: WHERE WATER LINES, SERVICE LINES ARE INSTALLED UNDER A ROAD, STREET, OR DRIVEWAY, SUFFICIENT COMPACTION IS REQUIRED (PER GEOTECHNICAL REPORT).
 6. WATER MAIN DEPTH: 2 INCH THROUGH 8 INCH LINES SHALL BE AT A DEPTH NO LESS THAN 3 FEET FROM THE GRADE TO THE TOP OF THE PIPE
 7. CONTRACTORS SHALL PROVIDE 24-HOURS NOTICE TO THE INSPECTOR PRIOR TO ANY WORK ON THE WATER SYSTEM INCLUDING FLUSHING, CHLORINATING, OR PERFORMING A PRESSURE TEST. CONTACT RON SIMMONS AT 706-879-1837.
 8. ALL WATER MAINS TO BE AWWA CLASS 52 8" DUCTILE IRON PIPE

FIELD LOCATE AND RELOCATE 4 EXISTING WATER SERVICE TAPS TO NEW WATER LINE

LOCATION MAP
 SCALE: 1"=500'

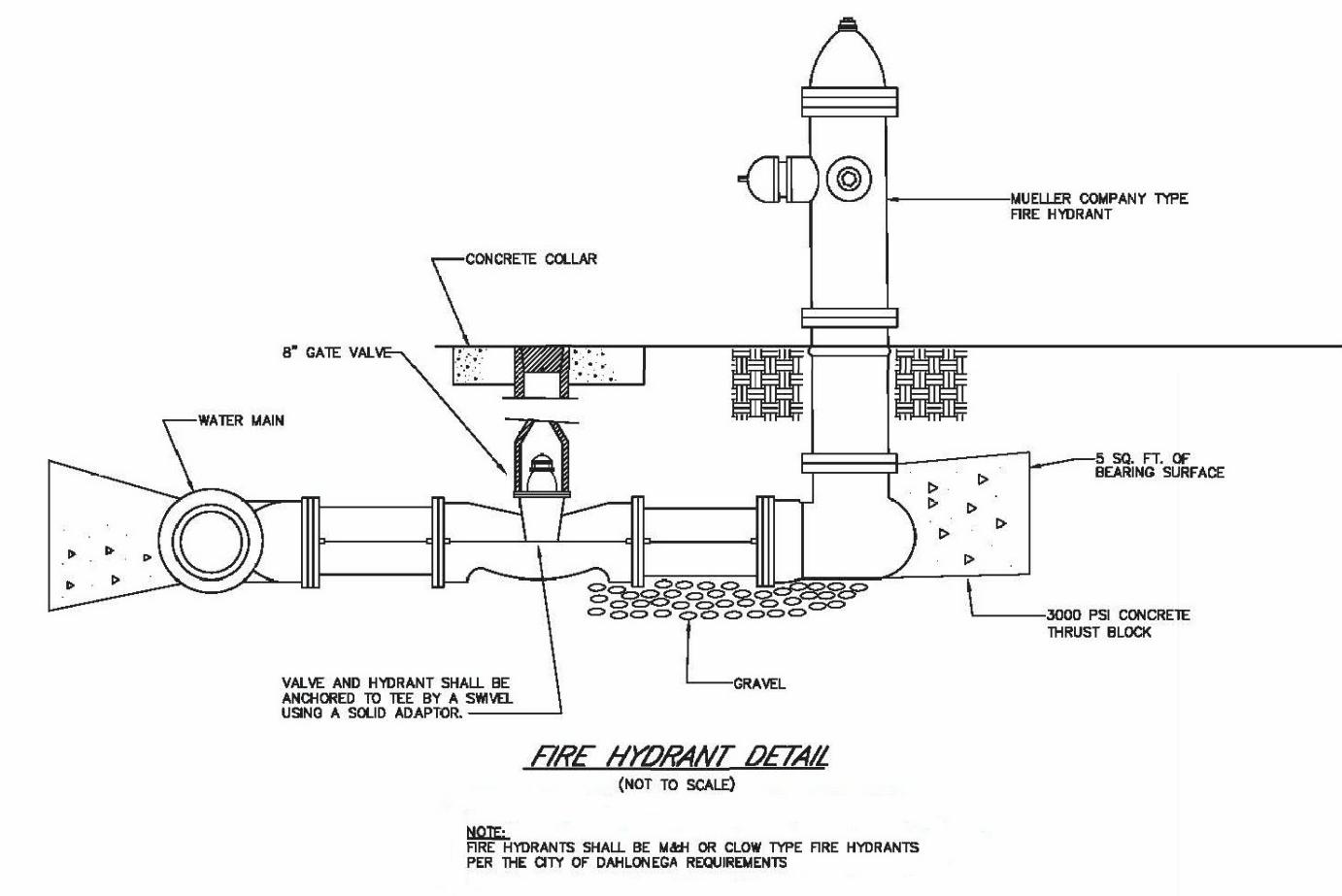

FIRE HYDRANT DETAIL
 (NOT TO SCALE)

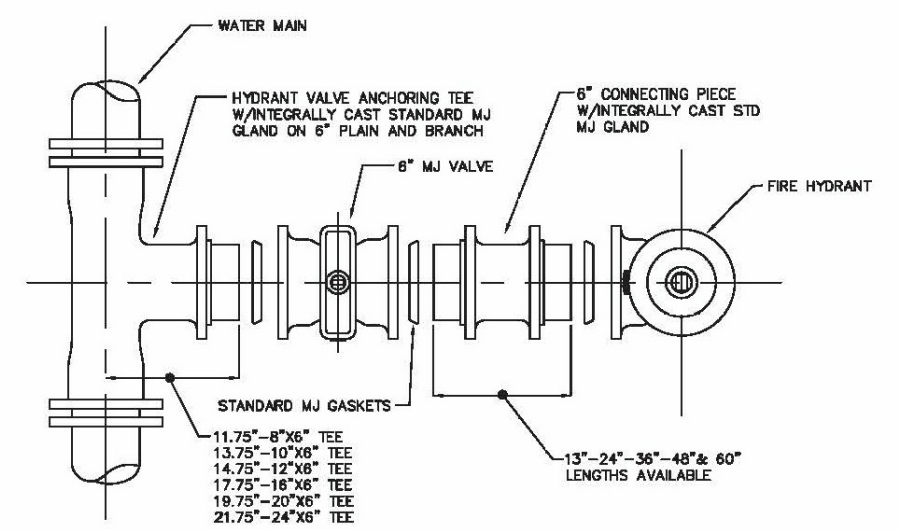

FIRE HYDRANT INSTALLATION DETAIL
 (NOT TO SCALE)

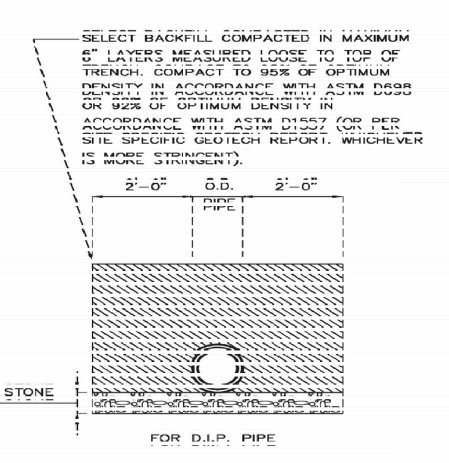

UTILITY SERVICE TRENCHING & BACKFILLING
 (NOT TO SCALE)

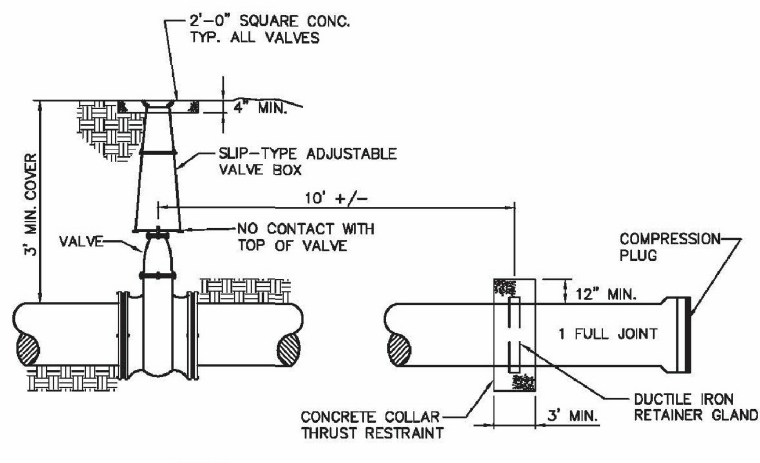

WATER STUB OUT DETAIL
 (NOT TO SCALE)

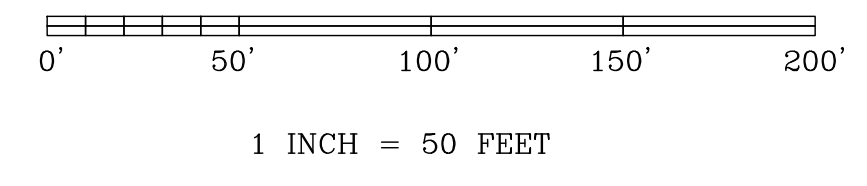

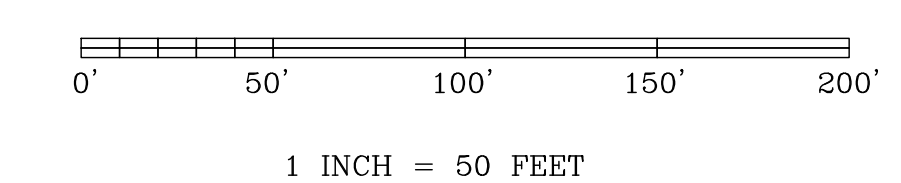
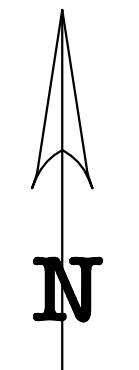
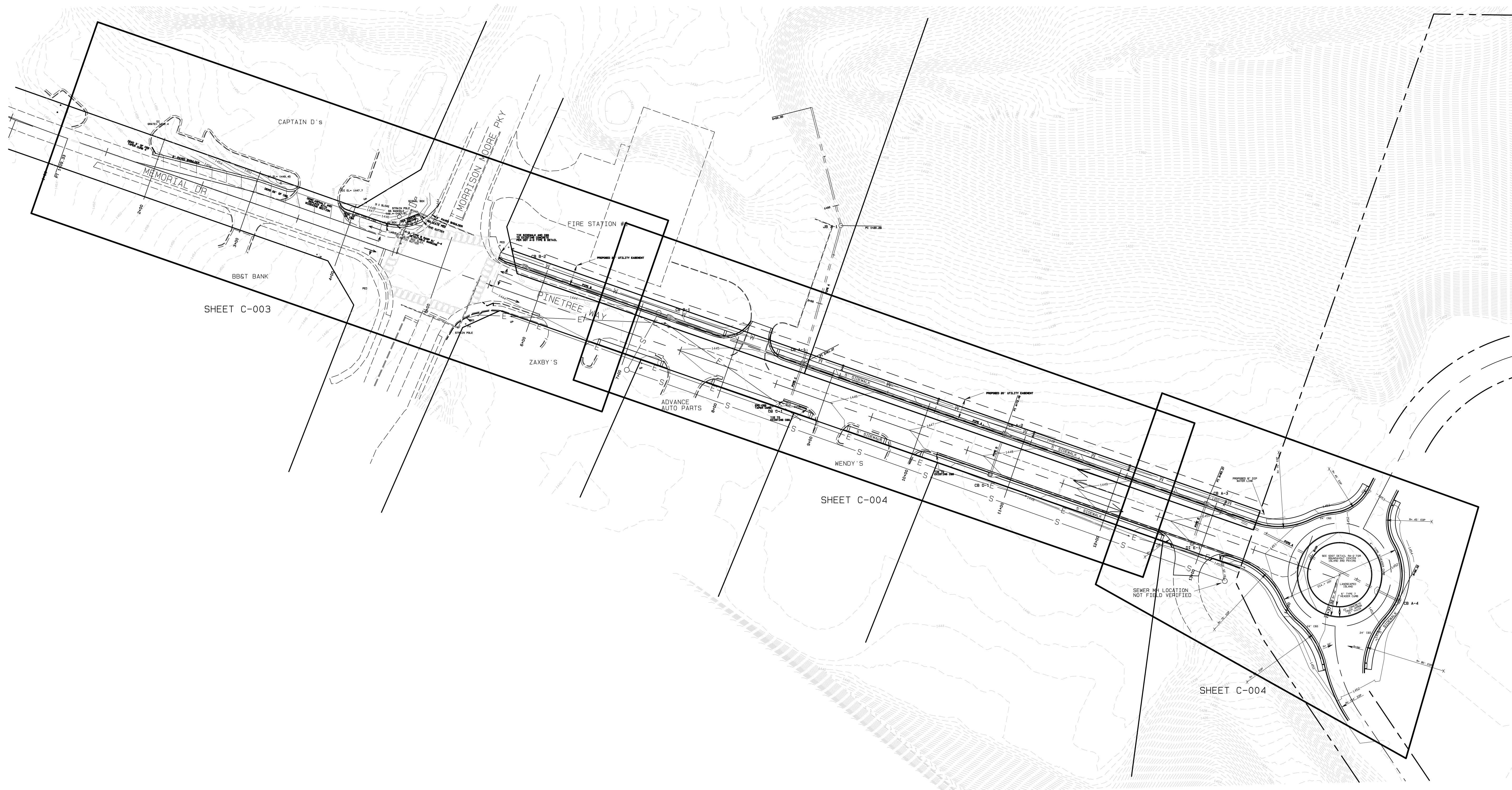

DATE: MAY 10, 2021
 DRAWN BY: LR
 FILE NAME:
 ROAD PLAN
 SCALE: 1"=50'
 SHEET: C-002

SITE PLAN
**PINETREE WAY/MEMORIAL DR
 ROAD WIDENING**
 LAND LOT 998 - 12 TH. DISTRICT
 CITY OF DAHLONEGA, LUMPKIN COUNTY, GEORGIA

DATE:	REVISIONS:
12/14/21	DESCRIPTION REVISED PER DOT AND CITY COMMENTS
7/12/22	REVISED PER DOT COMMENTS

Lumpkin County Engineering
 1642 RED OAK FLATS RD.
 DAHLONEGA, GEORGIA 30533
 PHONE: (706) 864-3122

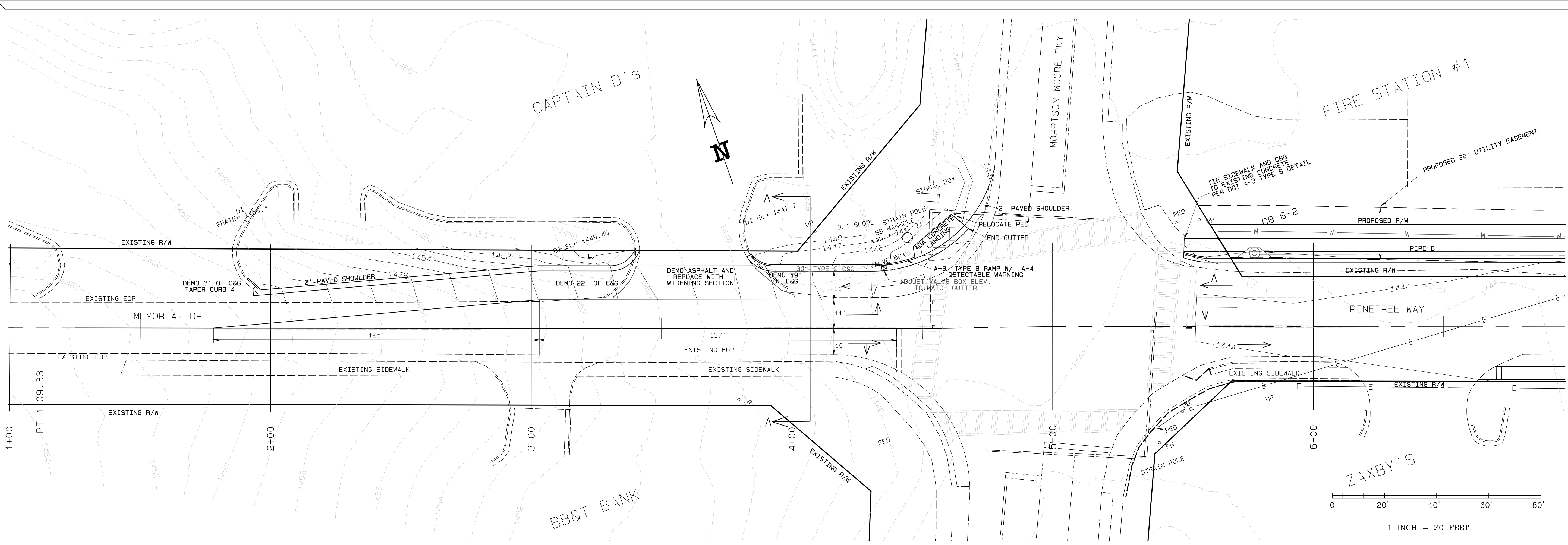

SEE SHEET C-006 FOR PAVEMENT MARKINGS AND SIGNING

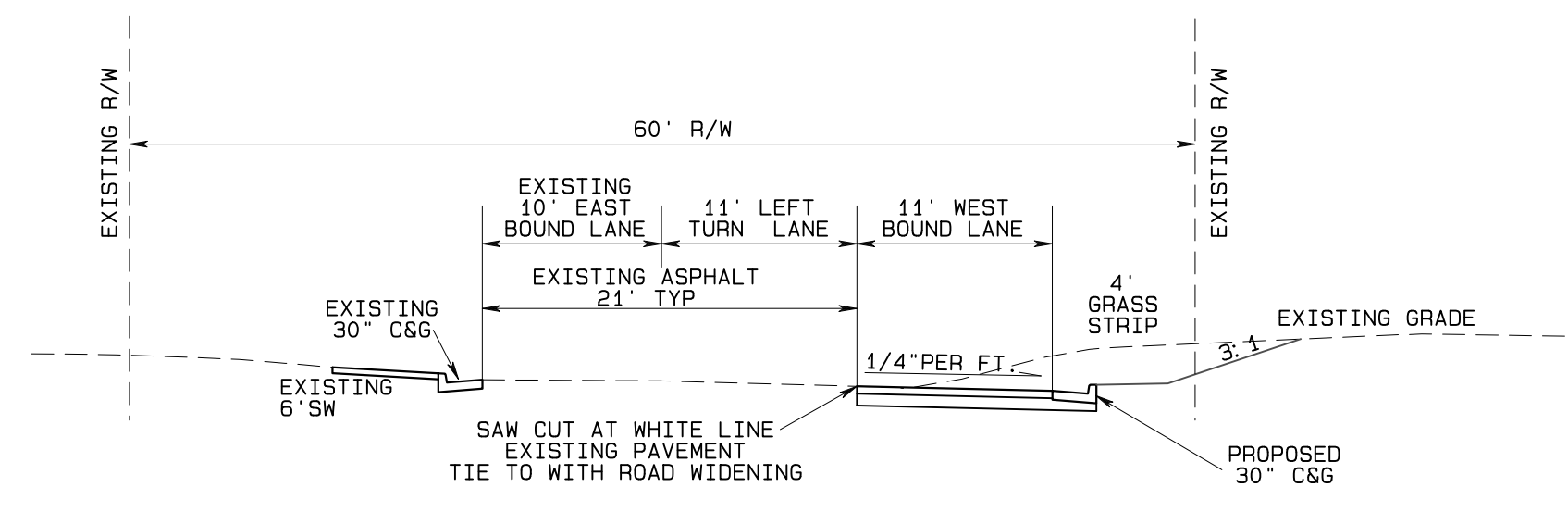
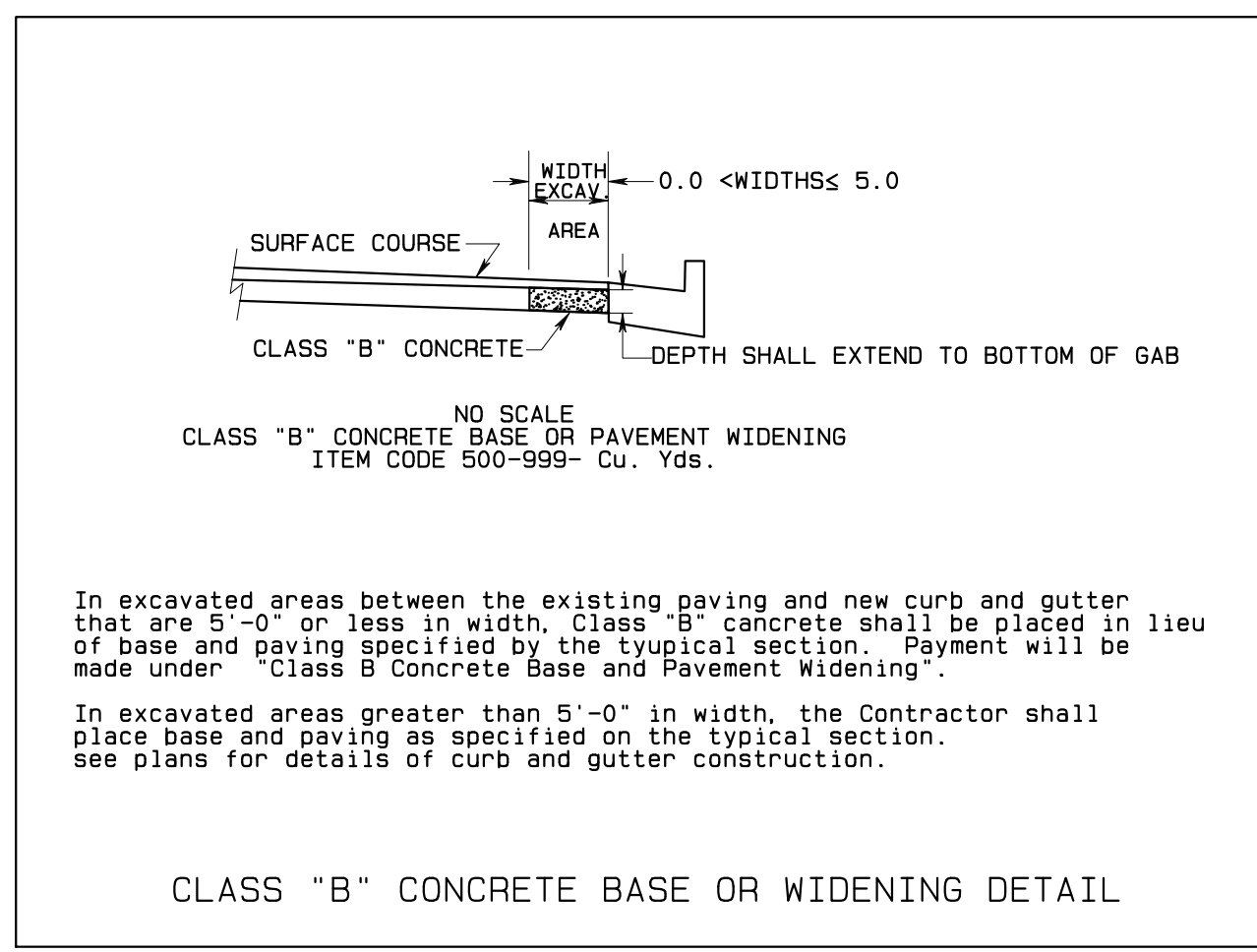

SECTION A-A: TYPICAL ROAD SECTION MEMORIAL DR
SCALE: 1"=10'

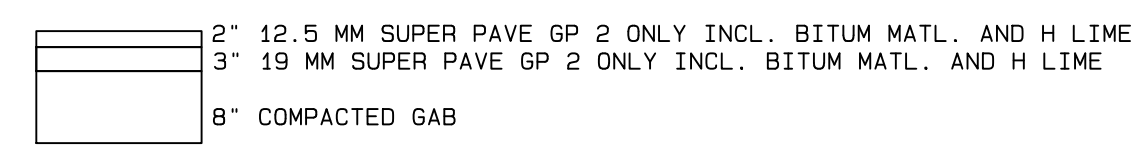

MEMORIAL DRIVE WIDENING PAVEMENT SECTION
(STA 1+78 TO STA 3+90)

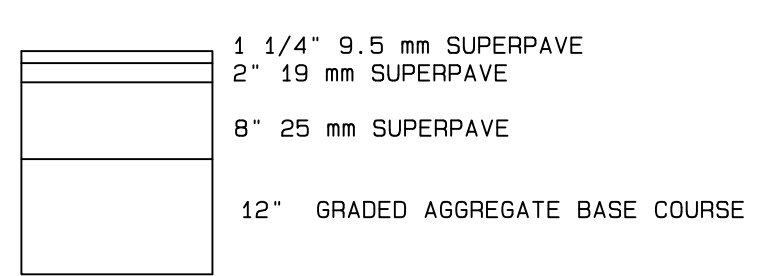

GDOT WIDENING PAVEMENT SECTION
(STA 3+90 TO STA 5+20)

GEORGIA D.O.T. NOTES

THE WORK AUTHORIZED MUST BEGIN WITHIN THREE MONTHS AND BE COMPLETED WITHIN TWELVE MONTHS ON A SCHEDULE SATISFACTORY TO THE DEPARTMENT FROM THE PERMIT APPROVAL DATE AND ALSO, BE COMPLETED BEFORE THIS FACILITY IS OPEN TO THE PUBLIC.

THE FOLLOWING WILL NOT BE ALLOWED ON DOT RIGHT-OF-WAY: (1) DIVERSION OF ADDITIONAL DRAINAGE AREA ONTO THE RIGHT-OF-WAY, OR INCREASE IN THE CFS OF CURRENT VOLUMES OF WATER (2) GRADING EXCEPT AT DRIVEWAY CONSTRUCTION LOCATION, (3) HEADWALLS, (4) SIGNS, DISPLAY DEVICES, AND OTHER STRUCTURES WHICH ARE DESIGNED, INTENDED, OR USED TO ADVERTISE OR INFORM, (5) LANDSCAPING WITHOUT PRIOR APPROVAL OF THE LANDSCAPE PLAN.

ALL EXISTING UTILITIES WHICH WOULD BE UNDER NEW PAVEMENT OR IN ACCELERATION/DECELERATION LANES SHALL BE RELOCATED BEFORE FINAL GRADING OR PAVING AND AT NO COST TO THE DOT, OR AN APPROVED RETENTION LETTER FROM THE UTILITY OWNER.

CONSTRUCTION OF EROSION CONTROL BARRIERS PER GEORGIA DEPARTMENT OF NATURAL RESOURCES CODE 391-3-7 AND SHALL BE MAINTAINED UNTIL PERMANENT VEGETATION IS ESTABLISHED.

APPLICANT SHALL RESTORE ALL EXISTING SIGNS AND REGRESS TO DOT SPECIFICATIONS ALL RIGHT OF WAY THAT IS DISTURBED DURING WORK AUTHORIZED HEREIN.

THE PERMIT APPLICANT IS RESPONSIBLE FOR REPLACEMENT OF ALL EXISTING PAVEMENT MARKINGS DAMAGED BY THE PERMIT CONSTRUCTION AND THE ADDITION OF NEW PAVEMENT MARKINGS AND OR SIGNS AS SHOWN ON THE APPROVED PLAN, OR CURRENT M.U.T.C.D. GUIDELINES.

ALL CURBED ISLANDS SHALL BE FILLED TO THE TOP OF CURB WITH TOP SOIL AND GRASSED. NOTE: THIS APPROVAL DOES NOT ALLOW ANY WORK ON STATE RIGHT-OF-WAY IN CONNECTION WITH UTILITY LINES (SANITARY SEWER, WATER, TELEPHONE, GAS, ETC.)

REQUIRED PAVEMENT SPECIFICATIONS
 1 1/4"----- 9.5 mm SUPERPAVE
 2"----- 19 mm SUPERPAVE
 8"----- 25mm SUPERPAVE
 12"-----GRADED AGGREGATE BASE COURSE

NOTICE

THIS PERMIT IS APPROVED SUBJECT TO THE REVISIONS AND COMMENTS SHOWN IN RED ON THE ATTACHED PLAN COPY AND SHALL REMAIN DEPENDENT UPON COMPLIANCE WITH THESE.

NO WORK WILL BE ACCOMPLISHED UNDER THIS PERMIT WITHIN THE CONSTRUCTION LIMITS OF ANY DOT PROJECT WITHOUT WRITTEN APPROVAL OF THE PRIME CONTRACTOR.

THE MAINTENANCE OF THE DRIVEWAY FROM THE NORMAL EDGE OF PAVEMENT IS THE RESPONSIBILITY OF THE PERMITEE.

OVERLAY SHALL BE AS DIRECTED BY GDOT PERMIT INSPECTOR.

ALL SIDEWALKS, CROSSWALKS AND RAMPS SHALL MEET ADA STANDARDS GDOT DETAILS.

THE APPLICANT IS RESPONSIBLE TO OBTAIN ALL NECESSARY ENVIRONMENTAL APPROVALS PRIOR TO ANY WORK ON STATE R/W.

ALL WORK PERFORMED WITHIN GDOT R/W SHALL CONFORM TO GDOT STANDARDS AND DETAILS.

DATE: MAY 10, 2021		DRAWN BY: LR		FILE NAME:		ROAD PLAN		SCALE: 1"=20'		SHEET: C-003										
ROAD PLAN																				
PINETREE WAY/MEMORIAL DR																				
ROAD WIDENING																				
LAND LOT 998 - 12 TH. DISTRICT																				
CITY OF DAHLONEGA, LUMPKIN COUNTY, GEORGIA																				
<table border="1"> <thead> <tr> <th>REVISIONS:</th> <th>DATE:</th> <th>DESCRIPTION</th> </tr> </thead> <tbody> <tr> <td></td> <td>12/14/21</td> <td>REVISED PER DOT AND CITY COMMENTS</td> </tr> <tr> <td></td> <td>7/12/22</td> <td>REVISED PER DOT COMMENTS</td> </tr> </tbody> </table>												REVISIONS:	DATE:	DESCRIPTION		12/14/21	REVISED PER DOT AND CITY COMMENTS		7/12/22	REVISED PER DOT COMMENTS
REVISIONS:	DATE:	DESCRIPTION																		
	12/14/21	REVISED PER DOT AND CITY COMMENTS																		
	7/12/22	REVISED PER DOT COMMENTS																		
<p>Lumpkin County Engineering</p> <p>1642 RED OAK FLATS RD. DAHLONEGA, GEORGIA 30533 PHONE: (706) 864-3122</p>																				

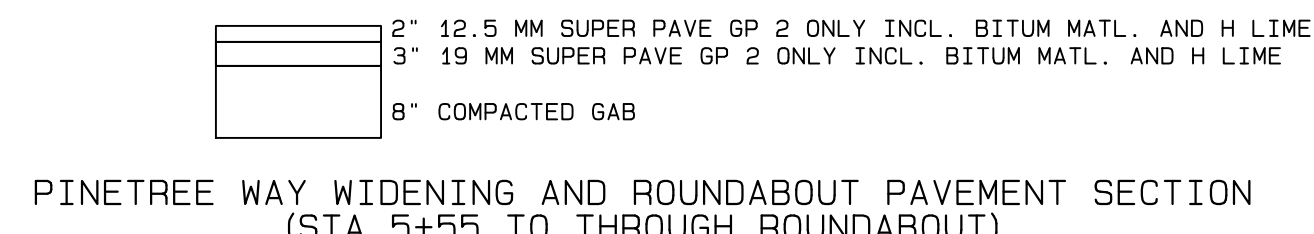
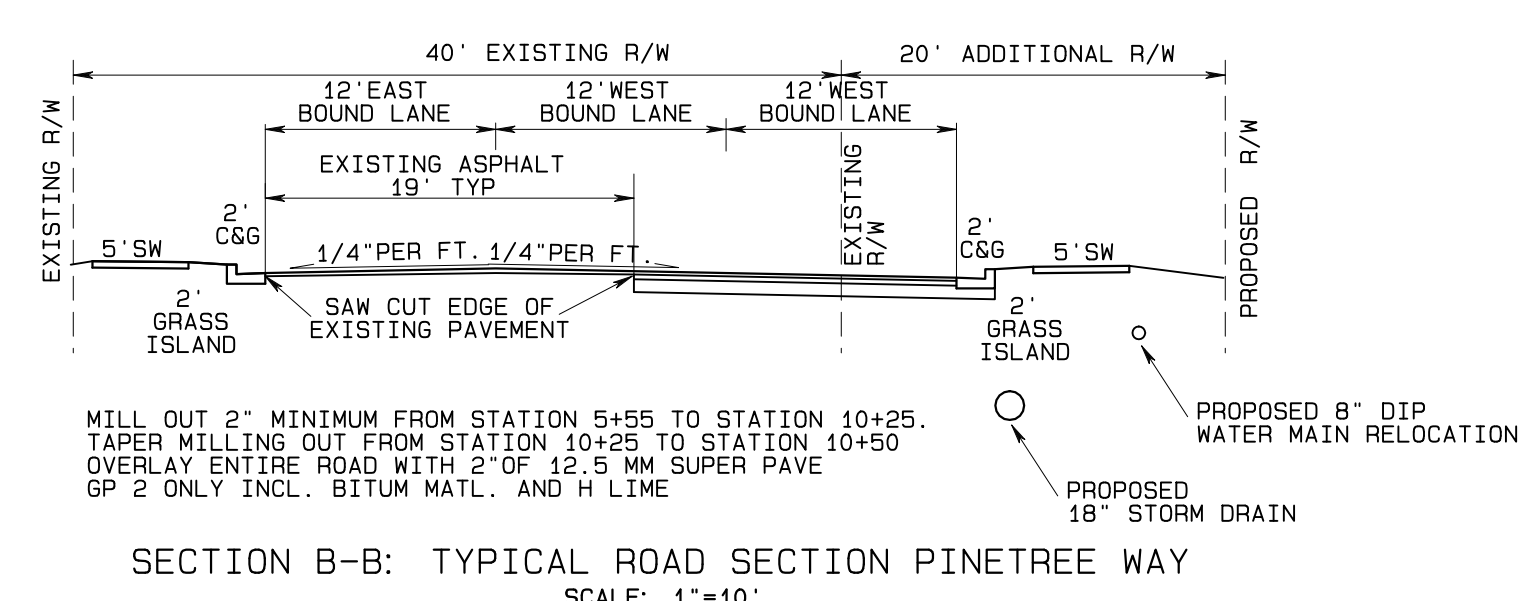
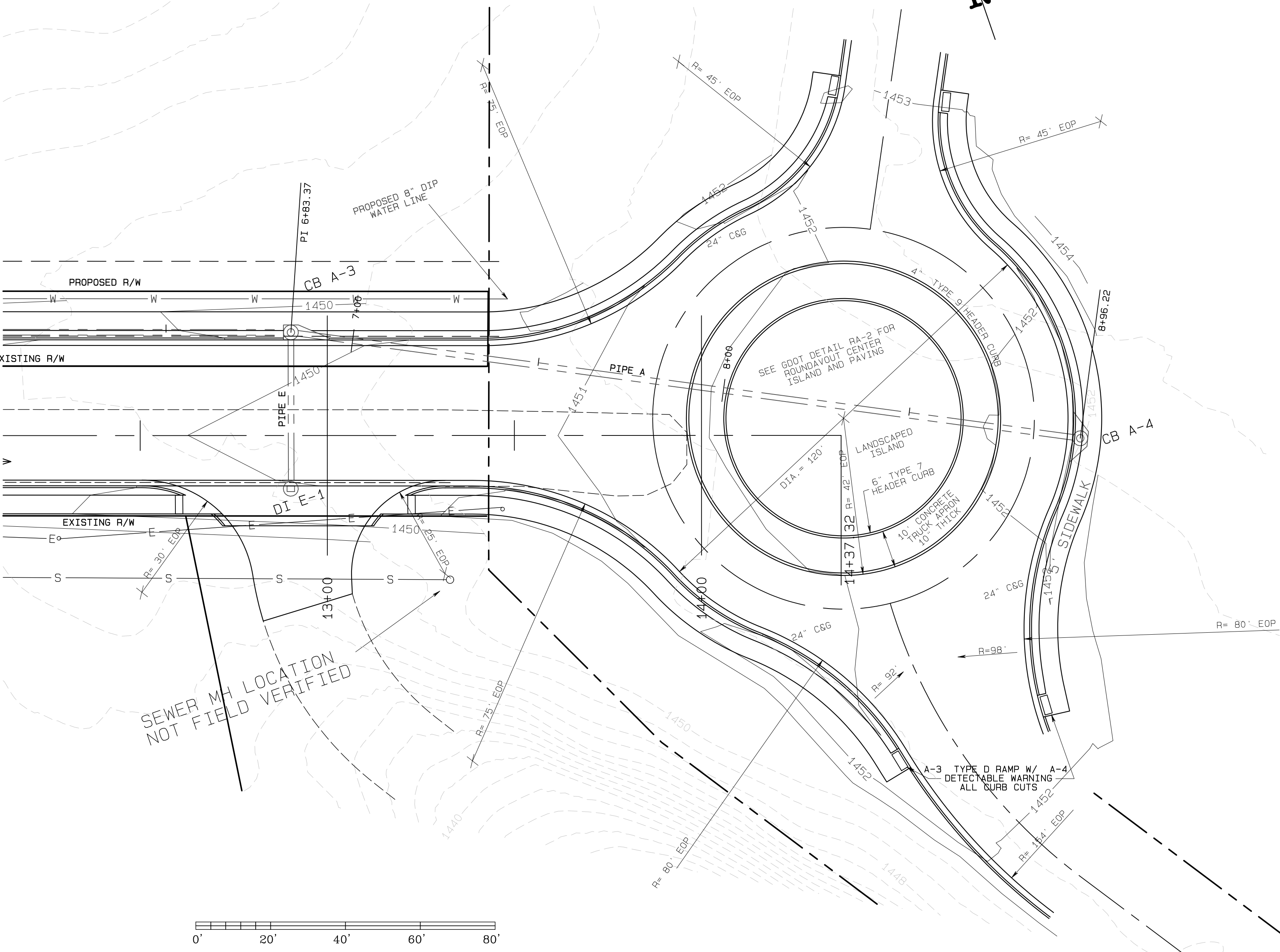
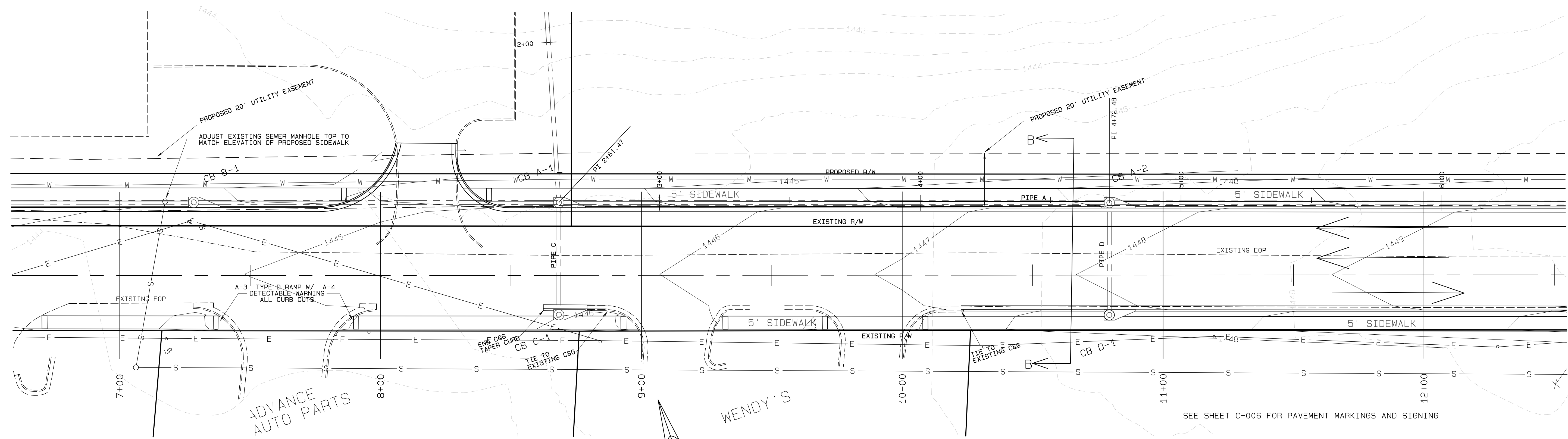

ALL SIDEWALKS TO BE 5' WIDE W/1% CROSS SLOPE CONSTRUCTED AS PER GDOT STANDARD A3 TYPE D CURB CUT RAMP

STORM DRAIN ROAD CROSSINGS TO BE OPEN CUT AS PER GDOT STANDARD 1401. TRENCH BACKFILL TO BE GAB COMPACTED IN 6" LIFTS.

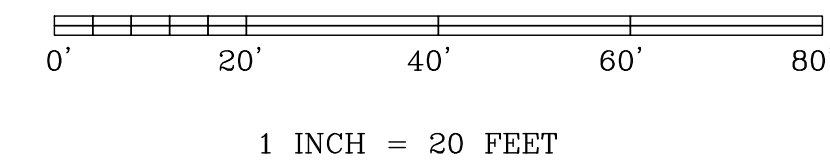

DATE: MAY 10, 2021
 DRAWN BY: LR
 FILE NAME:
 ROAD PLAN
 SCALE: 1"=20'
 SHEET: C-004

ROAD PLAN
**PINETREE WAY/MEMORIAL DR
 ROAD WIDENING**
 LAND LOT 998 - 12 TH. DISTRICT
 CITY OF DAHLONEGA, LUMPKIN COUNTY, GEORGIA

REVISONS:	DESCRIPTION
DATE: 12/14/21	REVISED PER DOT AND CITY COMMENTS
DATE: 7/12/22	REVISED PER DOT COMMENTS

Lumpkin County Engineering
 1642 RED OAK FLATS RD.
 DAHLONEGA, GEORGIA 30533
 PHONE: (706) 864-3122

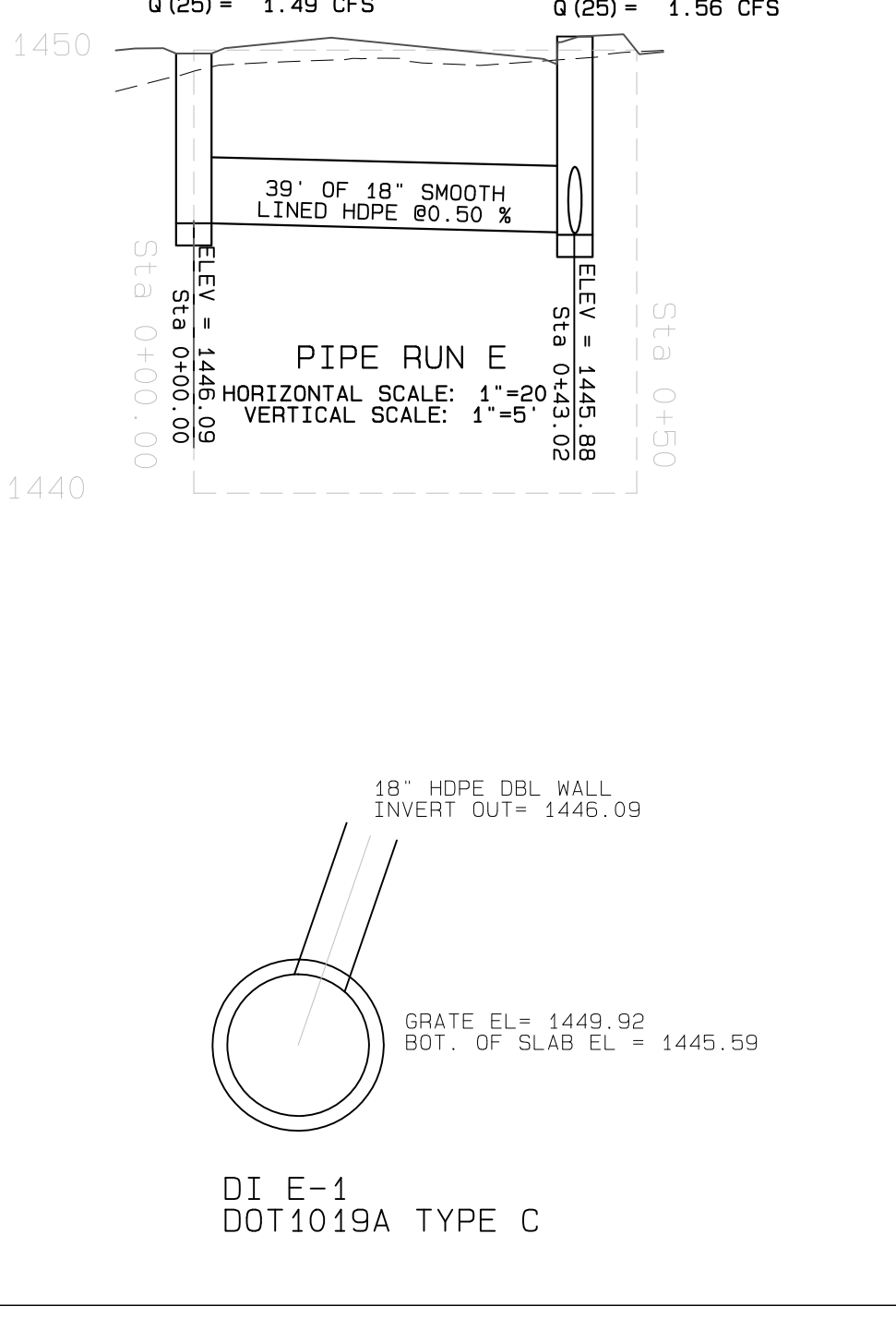
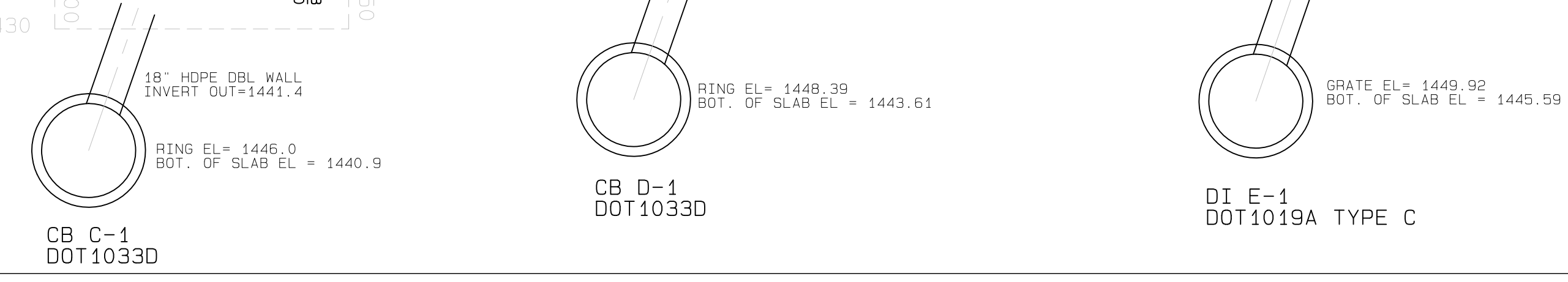
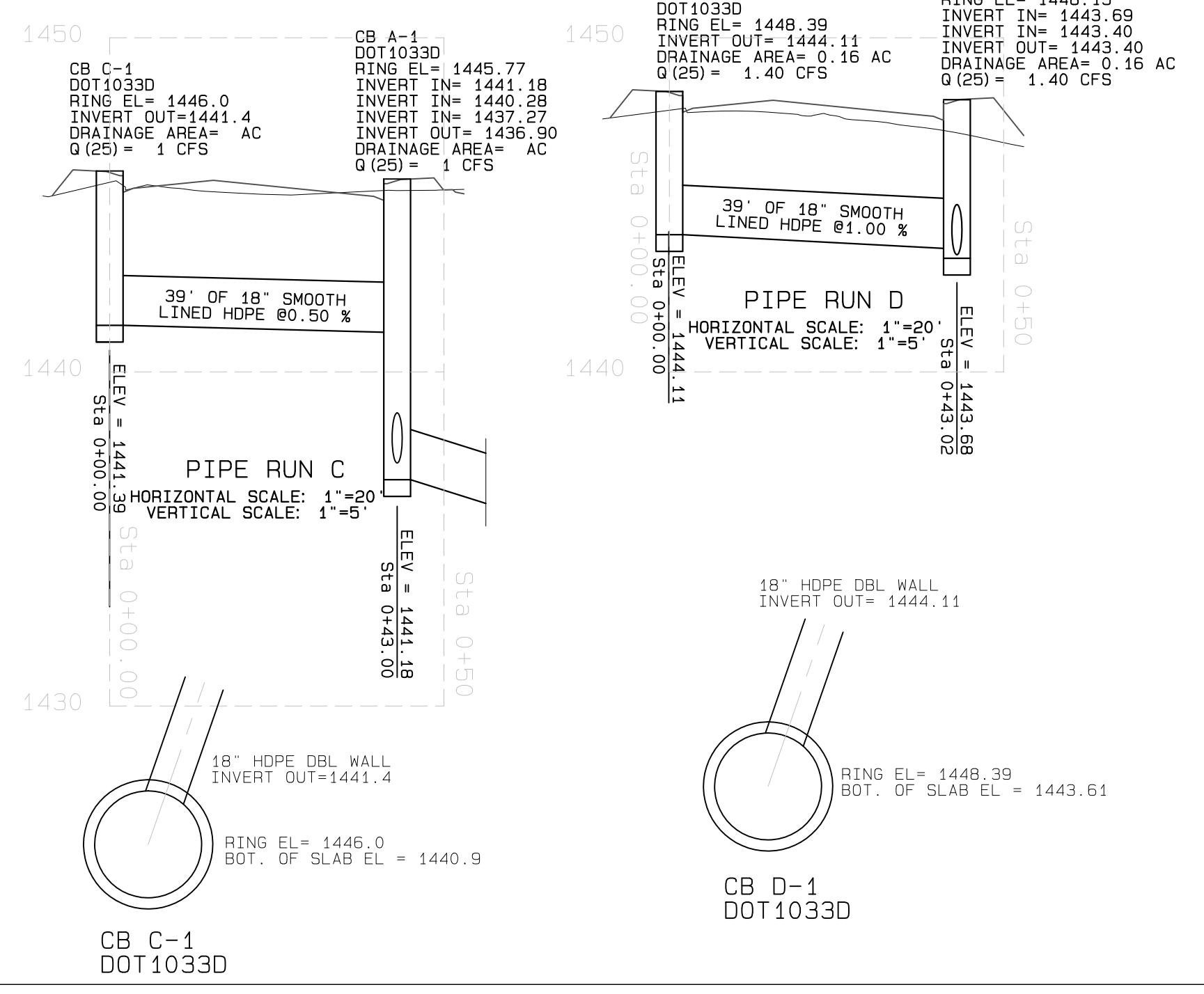
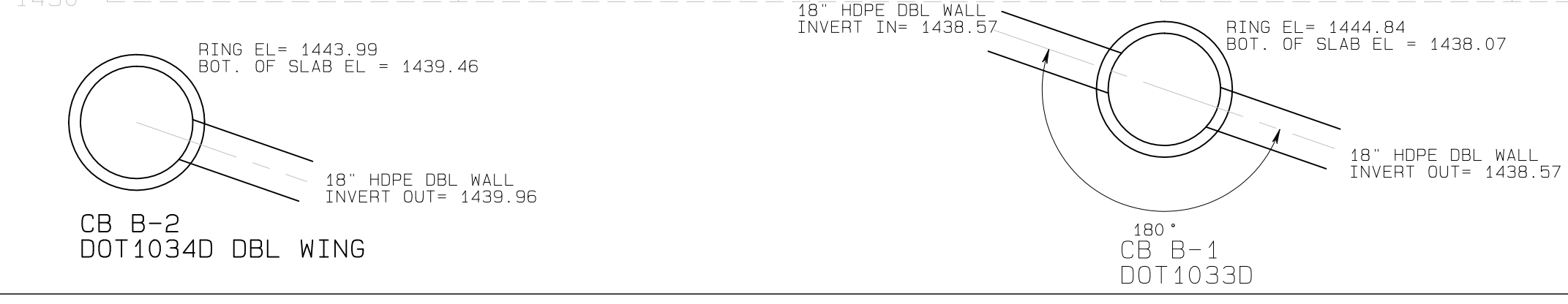
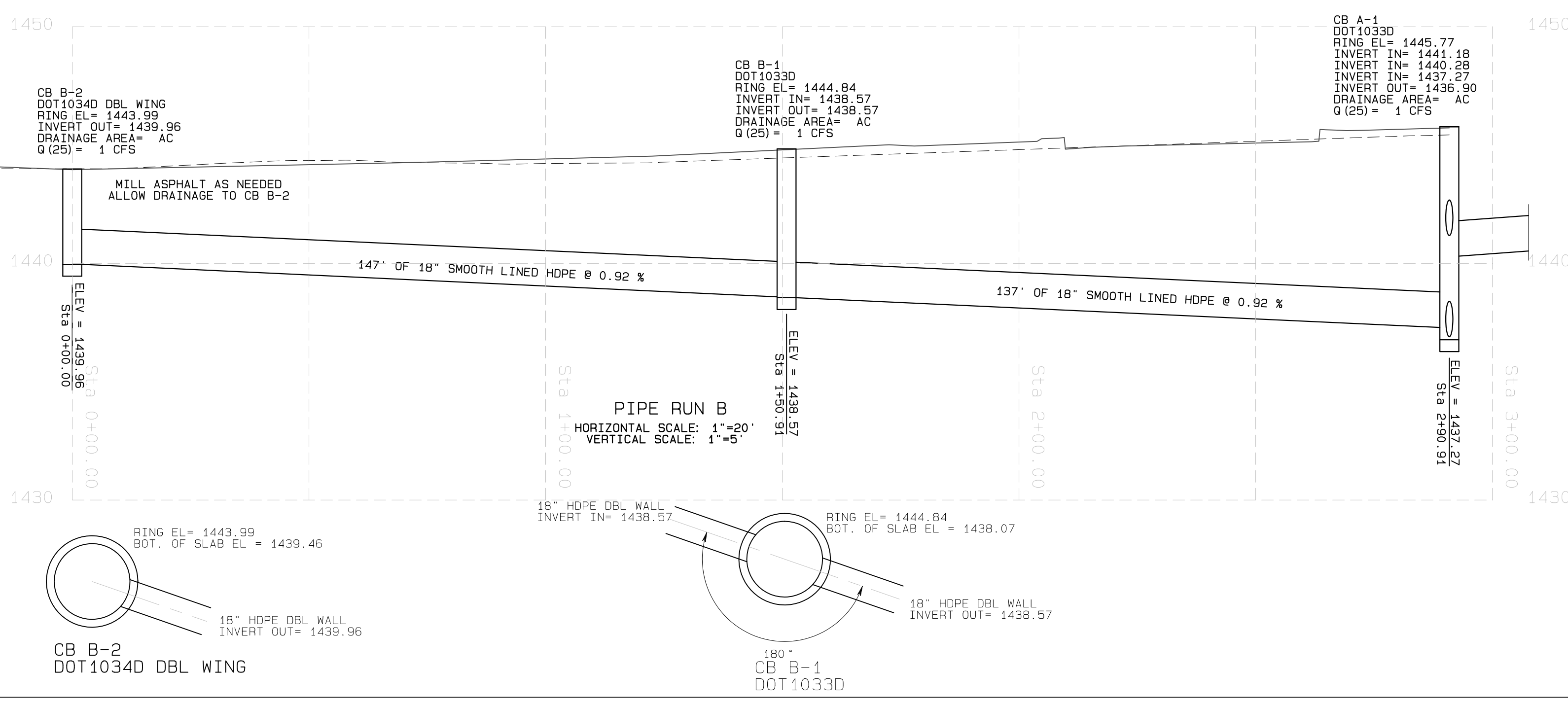
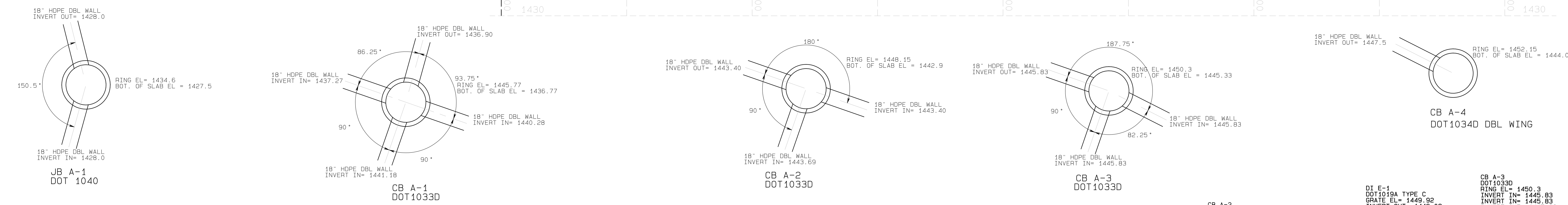
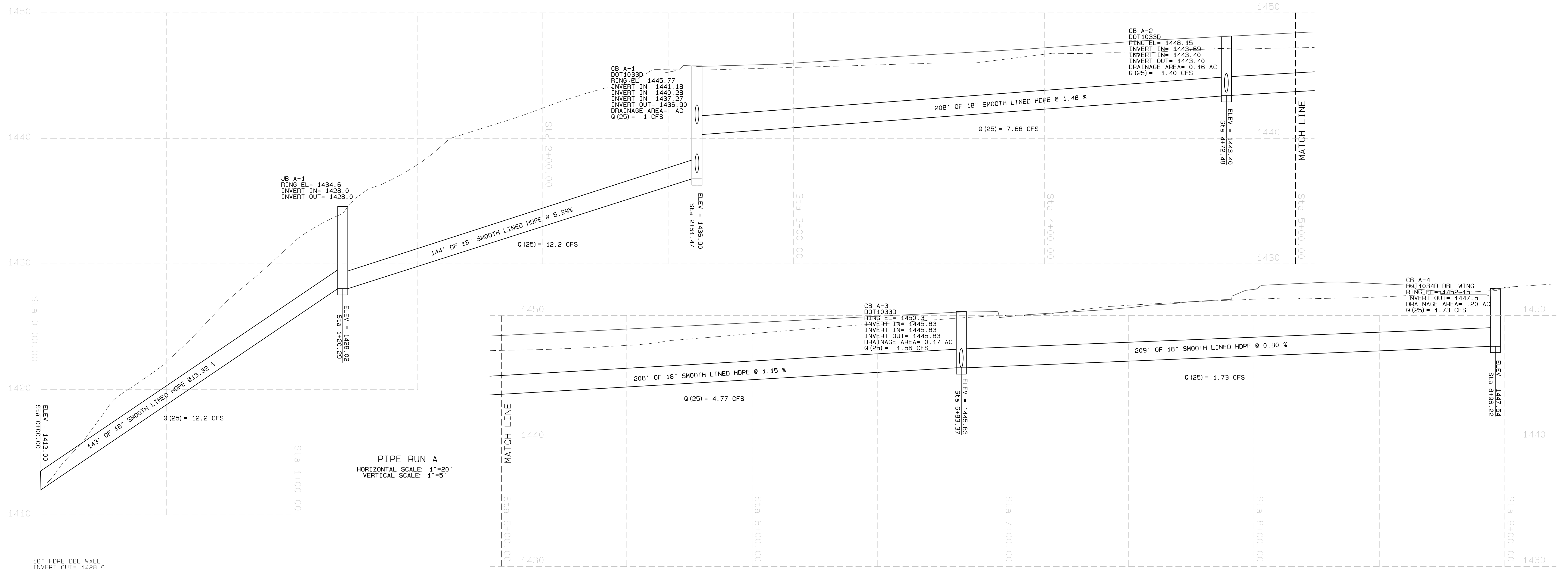

Lumpkin County Engineering
 1642 RED OAK FLATS RD.
 DAHLONEGA, GEORGIA 30533
 PHONE: (706) 864-3122

PINETREE WAY/MEMORIAL DR ROAD WIDENING
 LAND LOT 998 - 12 TH. DISTRICT
 CITY OF DAHLONEGA, LUMPKIN COUNTY, GEORGIA

DRAINAGE PIPE PROFILES AND DETAILS

DATE: MAY 10, 2021
 DRAWN BY: LR
 FILE NAME:
 ROAD PLAN
 SCALE: 1"=20'
 SHEET: C-005

REVISONS:	DESCRIPTION
12/14/21	REVISED PER DOT AND CITY COMMENTS

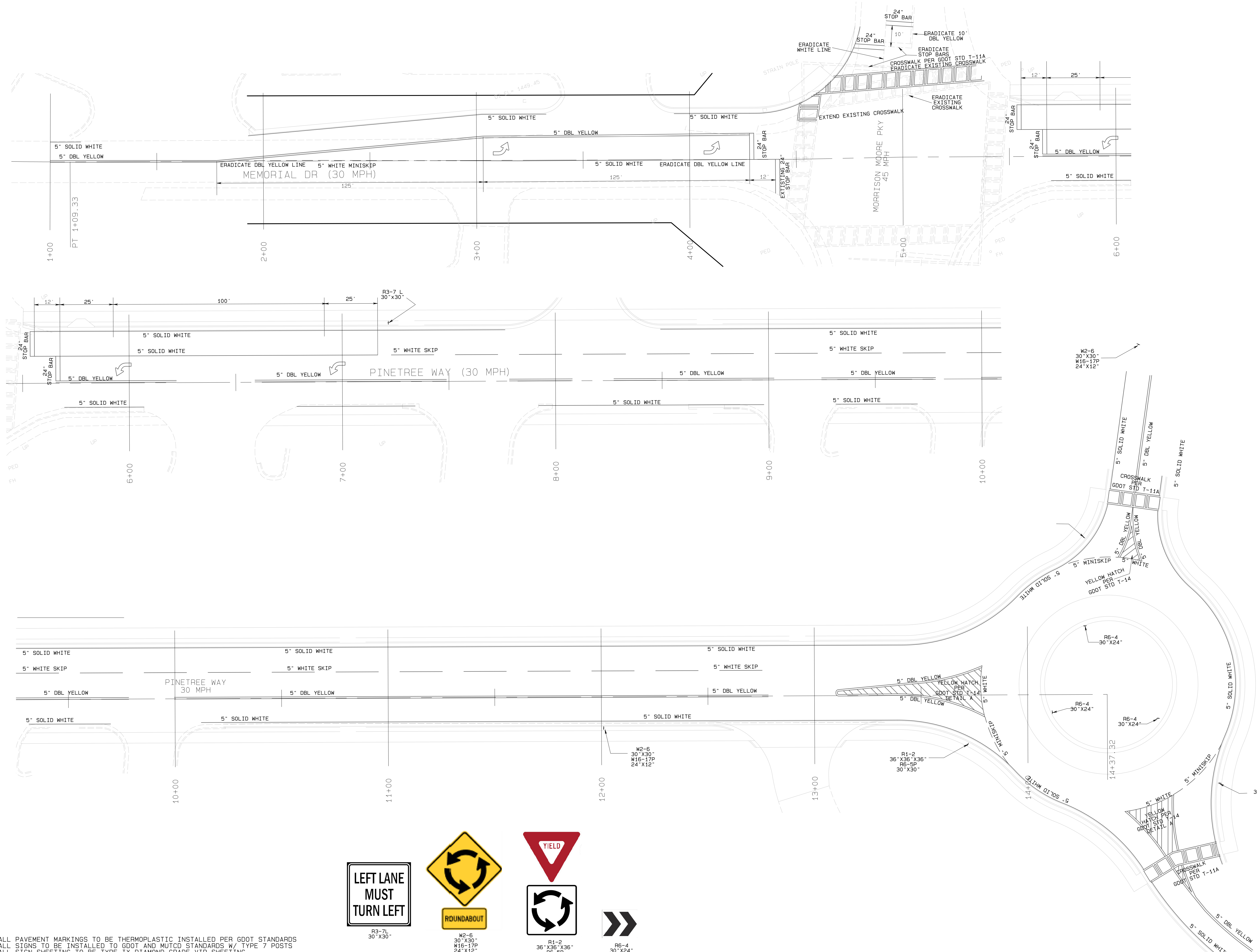

ALL PAVEMENT MARKINGS TO BE THERMOPLASTIC INSTALLED PER GDOT STANDARDS
 ALL SIGNS TO BE INSTALLED TO GDOT AND MUTCD STANDARDS W/ TYPE 7 POSTS
 ALL SIGN SHEETING TO BE TYPE IX DIAMOND GRADE VIP SHEETING

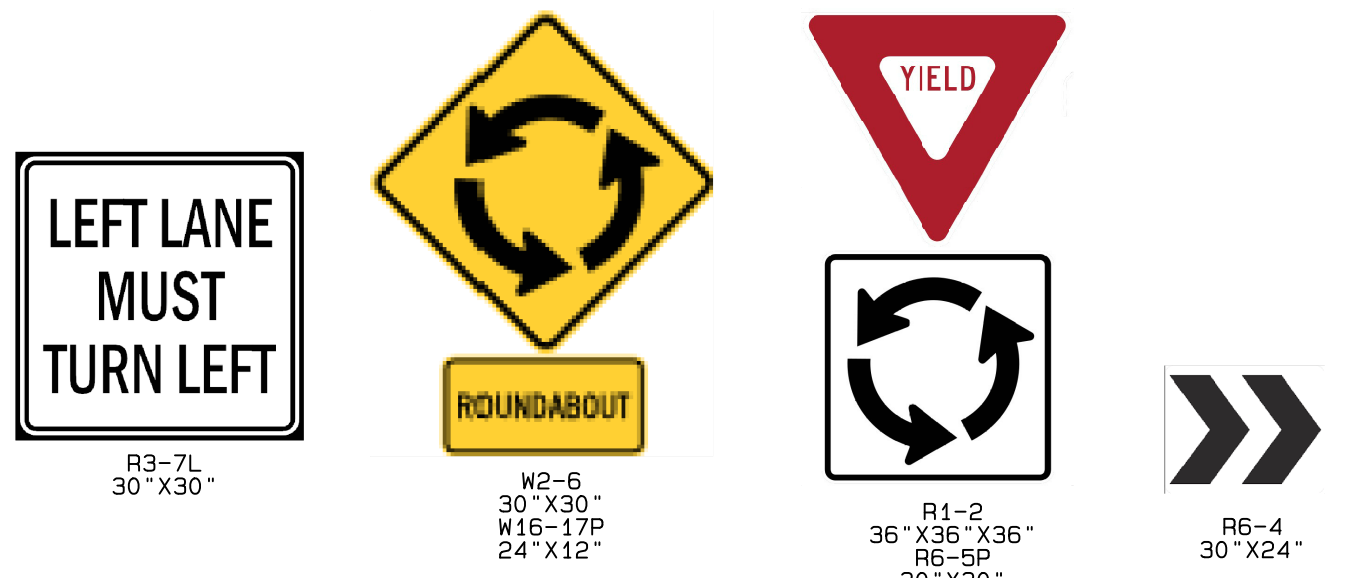

PAVEMENT MARKINGS AND SIGNING	
DATE: MAY 10, 2021 DRAWN BY: LR FILE NAME: ROAD PLAN: SCALE: 1"=20' SHEET: C-006	PINETREE WAY/MEMORIAL DR ROAD WIDENING LAND LOT 998 - 12 TH. DISTRICT CITY OF DAHLONEGA, LUMPKIN COUNTY, GEORGIA
REVISONS: DATE: 12/14/21 DESCRIPTION: REVISED PER DOT AND CITY COMMENTS	DATE: 7/12/22 DESCRIPTION: REVISED PER DOT COMMENTS
Lumpkin County Engineering 1642 RED OAK FLATS RD. DAHLONEGA, GEORGIA 30533 PHONE: (706) 864-3122	