

# CITY OF FOLEY

## FARMER'S MARKET ROAD PAVING IMPROVEMENTS

MAYOR  
JOHN E. KONIAR

COUNCIL  
J. WAYNE TRAWICK  
COUNCIL PRESIDENT  
DISTRICT 1

VERA J. QUAITES  
DISTRICT 2

RALPH G. HELLMICH  
COUNCIL VICE PRESIDENT  
DISTRICT 3

C. RICK BLACKWELL  
DISTRICT 4

CHARLIE J. EBERT III  
DISTRICT 5

CITY ADMINISTRATOR  
MICHAEL L. THOMPSON

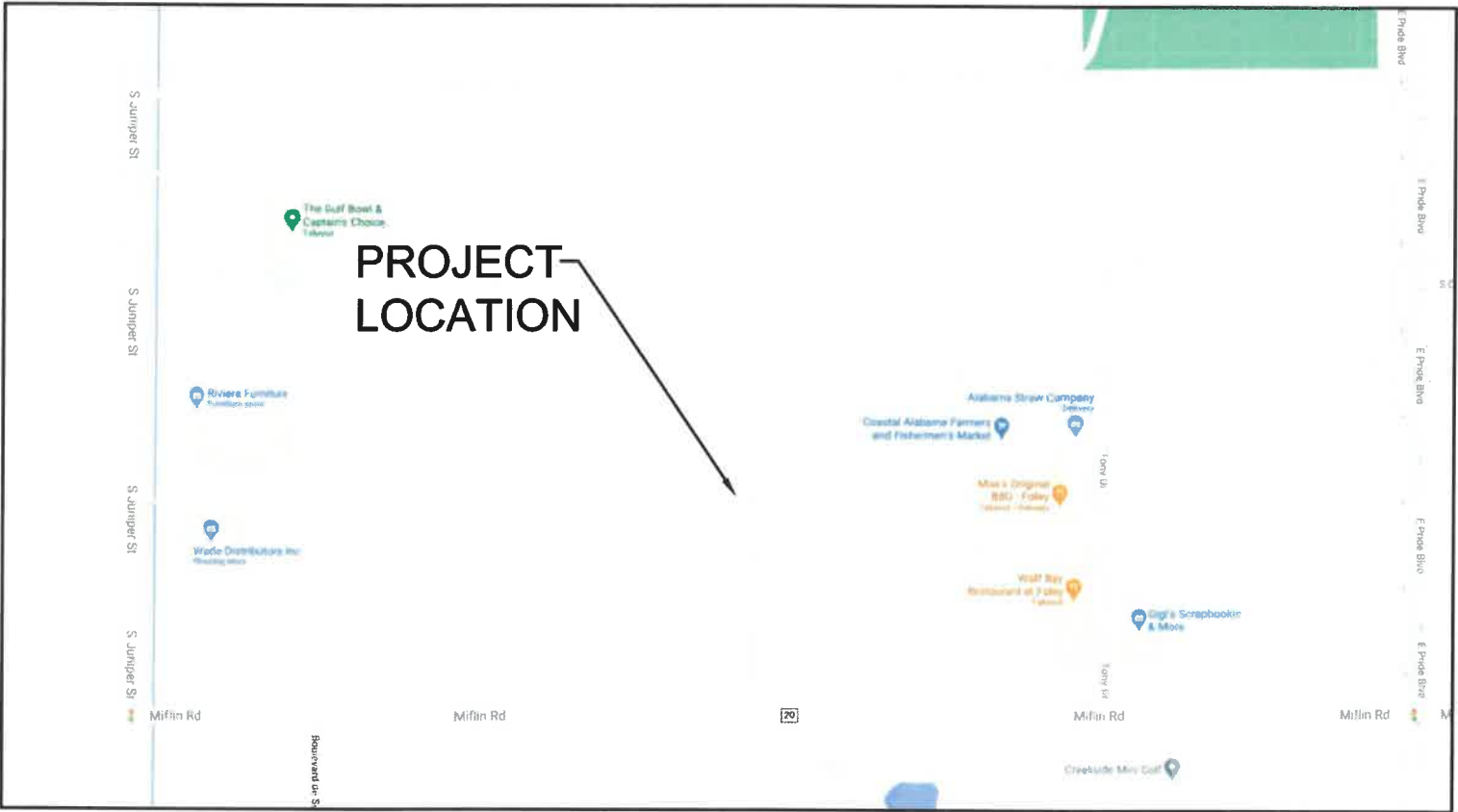

SHEET	DESCRIPTION
	TITLE
	PLAN, TYPICAL SECTION, NOTES
	TRAFFIC CONTROL

OCTOBER 2020

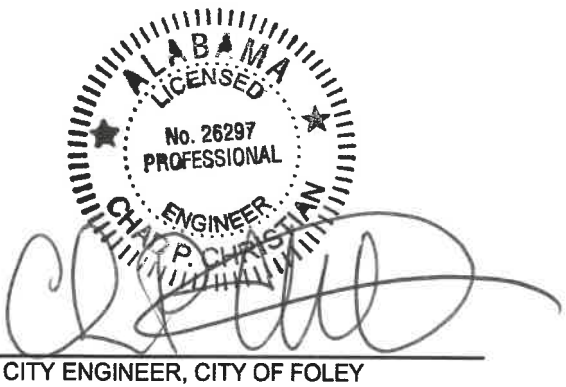

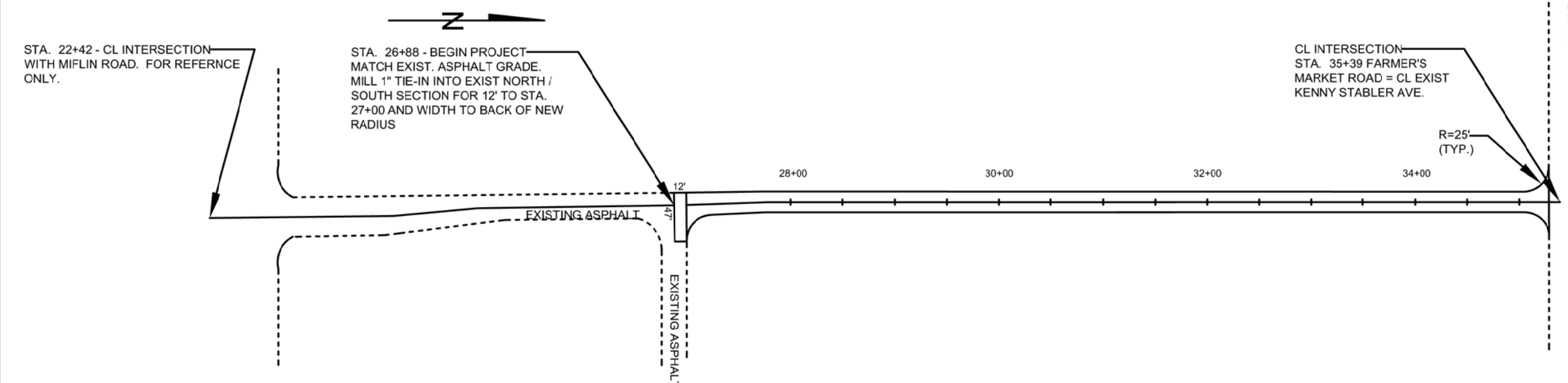

REQ'D. 2 STRIPS SOLID  
SOD (BOTH SIDES OF ROAD)

CL REQ'D. PAVING = CL OF EXIST.  
CRUSHED STONE BASE COURSE

CONTRACTOR SHALL UTILIZE THE ALABAMA 811 UTILITY LOCATOR SERVICE TO ASSIST IN LOCATING UTILITY SERVICES.

THE CONTRACTOR SHALL PROVIDE ALL LABOR, SUPERVISION, RESTROOM FACILITIES, EQUIPMENT, ETC. REQUIRED FOR THIS PROJECT, UNLESS OTHERWISE STATED BELOW. CONTRACTOR SHALL REMOVE ALL NECESSARY CONSTRUCTION ITEMS PRIOR TO PROJECT CLOSEOUT, SUCH AS MATERIALS, FLAGGING, STAKES, ETC.

ALL CONTROLLING ITEMS OF WORK ARE TO BE SCHEDULED WITH THE CITY OF FOLEY ENGINEERING DEPARTMENT 24 HOURS PRIOR TO BEGINNING A NEW PROJECT PHASE.

ALL NECESSARY TRAFFIC CONTROL ITEMS SHALL BE COMPLETED ACCORDING TO REQUIREMENTS OF MANUAL OF UNIFORM OF TRAFFIC CONTROL DEVICES (MUTCD), CURRENT EDITION.

ALL EXCESS MATERIAL SHALL BE DISPOSED OF BY THE CONTRACTOR AT HIS EXPENSE.

THE CONTRACTOR SHALL FURNISH AND MAINTAIN ALL NECESSARY BARRICADES AROUND WORK AND SHALL PROVIDE PROTECTION AGAINST WATER DAMAGE AND SOIL EROSION. ALL TYPE III BARRICADES SHALL CONFORM TO CURRENT MUTCD STANDARDS, INCLUDING CORRECT MESSAGING AND FLASHING BEACONS.

THE CITY HAS OBTAINED A CONSTRUCTION ENGINEERING AND INSPECTION FIRM FOR MATERIALS TESTING. THE CITY WILL PAY FOR THE INITIAL ROUND OF CONSTRUCTION ENGINEERING AND INSPECTION TESTING. ANY SUBSEQUENT TESTING DEEMED NECESSARY BY THE CITY, IN AGREEMENT WITH THE GEOTECHNICAL ENGINEER, WILL BE AT THE CONTRACTOR'S EXPENSE. IN ADDITION, IT IS THE CONTRACTOR'S RESPONSIBILITY TO SCHEDULE THE TESTING WITH THE TESTING FIRM.

BASE MATERIAL, ASPHALT PAVING INCLUDING TACK COAT, AND STRIPING SHALL BE IN COMPLIANCE WITH THE CURRENT EDITION OF THE ALDOT STANDARD SPECIFICATIONS MANUAL.

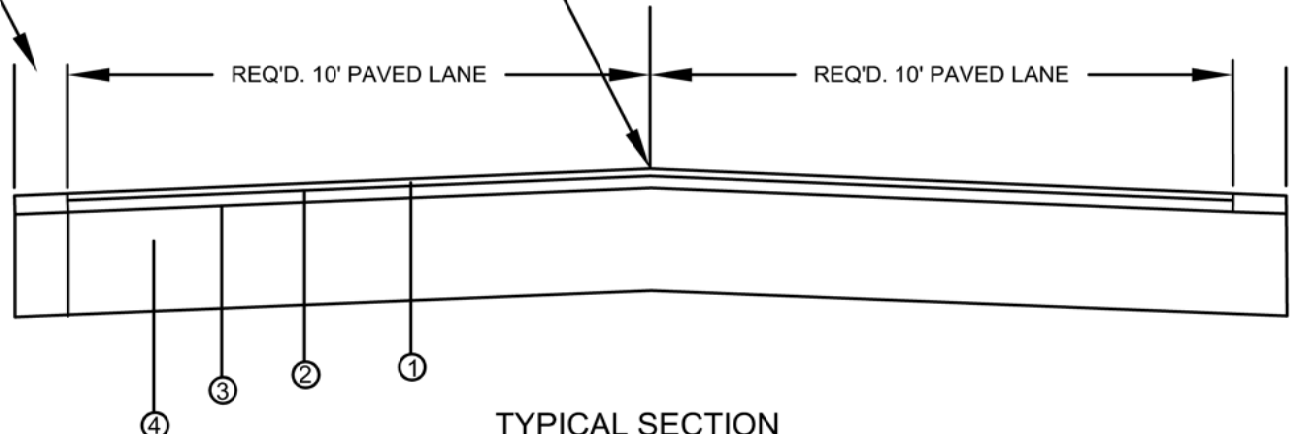

TYPICAL SECTION

FARMER'S MARKET ROAD

N.T.S

- ① 1.25" ALDOT SECTION 424-A, SUPERPAVE BITUMINOUS WEARING SURFACE (140 LB/SY RATE)
- ② ALDOT SECTION 405, TACK COAT
- ③ 1.5" ALDOT SECTION 424-B, SUPERPAVE BITUMINOUS BINDER LAYER (165 LB/SY RATE).  
MILLING TIE-IN COST IS INCIDENTAL TO BINDER LAYER
- ④ EXISTING 6" COMPACTED BASE. GRADING AND SHAPING AS DIRECTED BY THE ENGINEER

CITY OF FOLEY		
FARMER'S MARKET ROAD		
PLAN VIEW AND TYPICAL SECTION		
DATE: 10/02/2020	BY: TD	2

