

LOCATION SKETCH

# PUTNAM COUNTY BOARD OF COMMISSIONERS

## PLAN AND PROFILE OF PROPOSED OLD PHOENIX ROAD AUXILIARY LANE

### FEDERAL AID PROJECT

FEDERAL ROUTE \* N/A  
STATE ROUTE \* SR 44  
P.I. NO. 4619118

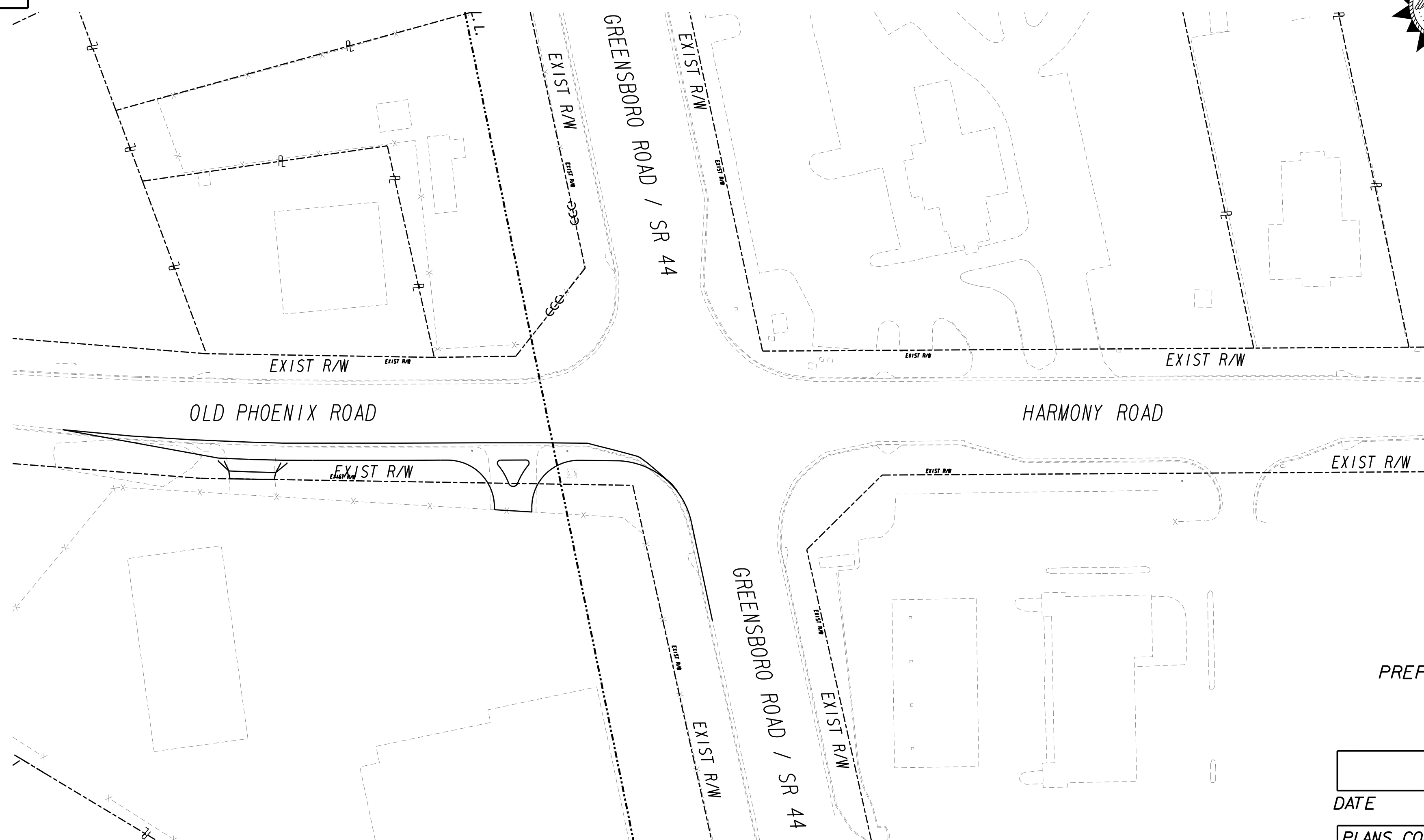
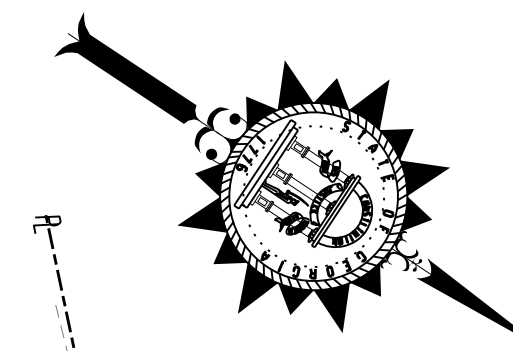

THIS PROJECT HAS BEEN PREPARED USING THE HORIZONTAL GEORGIA COORDINATE SYSTEM OF 1984 (NAD 1983/94 WEST ZONE, AND THE NORTH AMERICAN VERTICAL DATUM (NAVD) OF 1988.

|                          |                     |
|--------------------------|---------------------|
| LENGTH OF PROJECT        | COUNTY No. 237      |
|                          | Project No. 4619118 |
|                          | MILES               |
| NET LENGTH OF ROADWAY    |                     |
| NET LENGTH OF BRIDGES    |                     |
| NET LENGTH OF PROJECT    |                     |
| NET LENGTH OF EXCEPTIONS |                     |
| GROSS LENGTH OF PROJECT  |                     |

THE DATA TOGETHER WITH ALL OTHER INFORMATION SHOWN ON THESE PLANS OR IN ANYWAY INDICATED THEREBY, WHETHER BY DRAWINGS OR NOTES, OR IN ANY OTHER MANNER, ARE BASED UPON FIELD INVESTIGATIONS AND ARE BELIEVED TO BE INDICATIVE OF ACTUAL CONDITIONS. HOWEVER, THE SAME ARE SHOWN AS INFORMATION ONLY, ARE NOT GUARANTEED, AND DO NOT BIND THE DEPARTMENT OF TRANSPORTATION IN ANY WAY. THE ATTENTION OF BIDDER IS SPECIFICALLY DIRECTED TO SUBSECTIONS 102.04, 102.05, AND 104.03 OF THE SPECIFICATIONS.

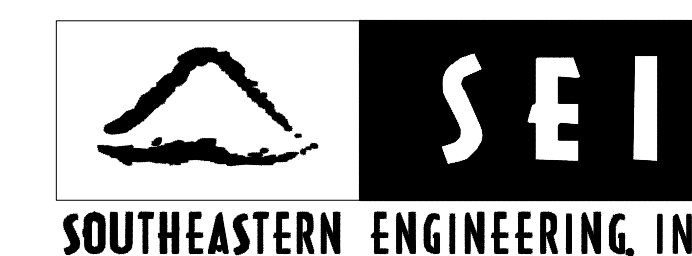
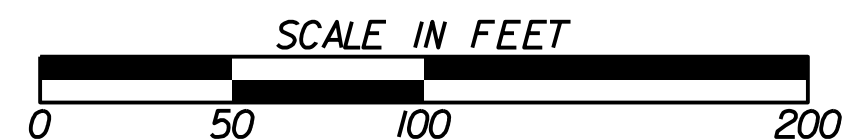

PREPARED BY: \_\_\_\_\_  
DESIGN

|                 |                |
|-----------------|----------------|
| DATE            | CHIEF ENGINEER |
| PLANS COMPLETED | --             |
| REVISIONS       |                |
|                 |                |
|                 |                |
|                 |                |
|                 |                |
|                 |                |

DRAWING No. 01-0001



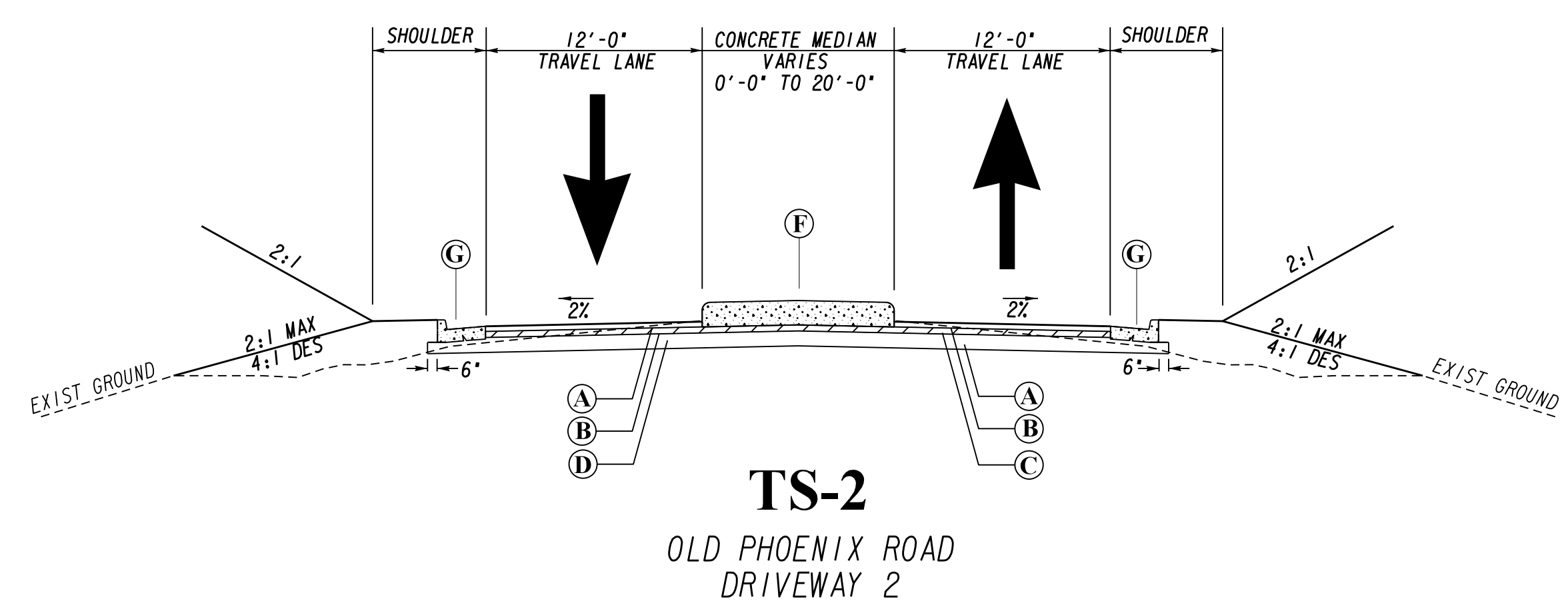
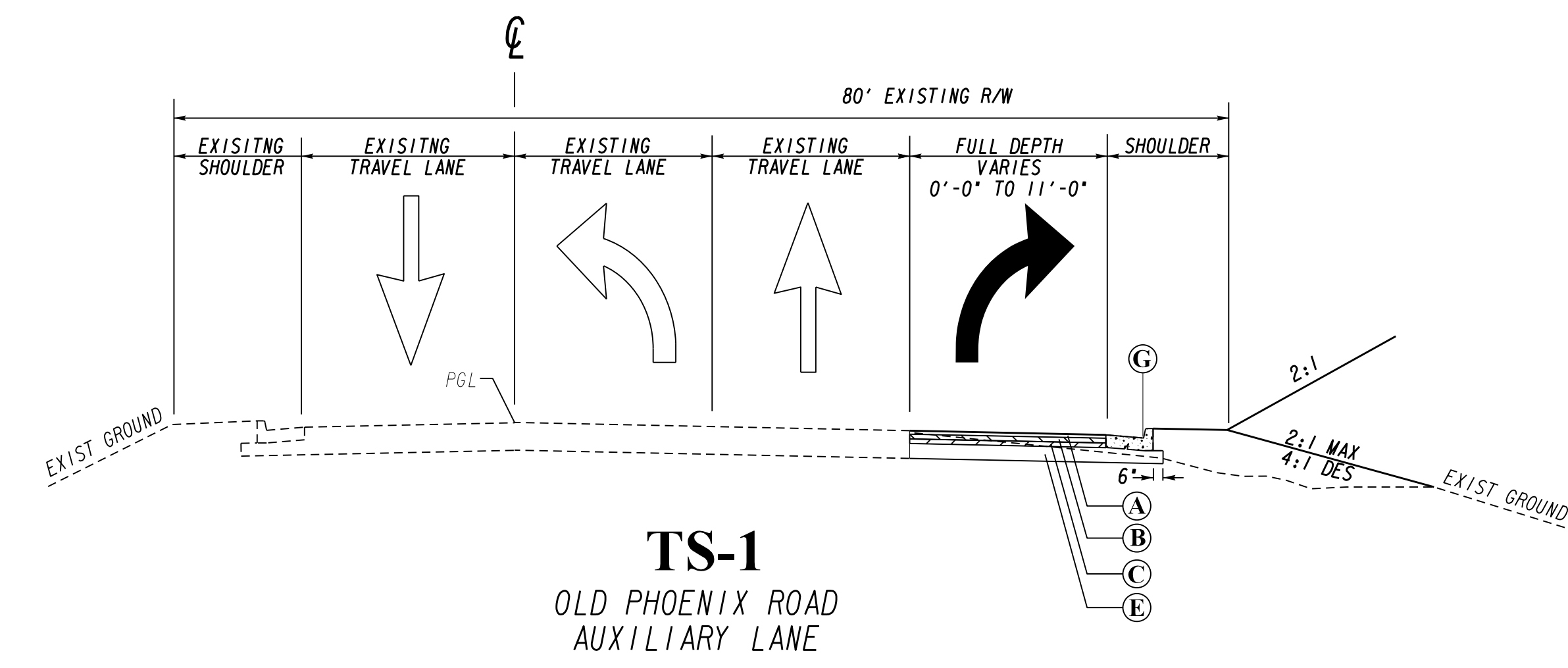

**TYPICAL SECTION LEGEND**

- Ⓐ RECYCLED ASPH CONC 12.5 MM SUPERPAVE, GP 2 ONLY, INCL BITUM MATL & H LIME 165 LBS./SY (402-3130)
- Ⓑ RECYCLED ASPH. CONC. 19 MM SUPERPAVE, GP 1 OR 2, INCL BITUM MATL & H LIME, 220 LBS./SY (402-3190)
- Ⓒ RECYCLED ASPH. CONC. 25 MM SUPERPAVE, GP 1 OR 2, INCL BITUM MATL & H LIME, 440 LBS./SY (402-3121)
- Ⓓ GRADED AGGREGATE BASE COURSE, 6 INCH, INCL MATL (310-5060)
- Ⓔ GRADED AGGREGATE BASE COURSE, 12 INCH, INCL MATL (310-5120)
- Ⓕ CONCRETE MEDIAN, 7½IN (441-0754)
- Ⓖ CONC CURB & GUTTER, 8 IN X 24 IN, TP 2 (441-6216)

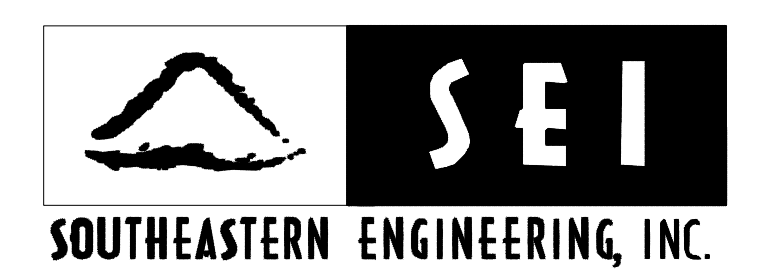

NTS

| REVISION DATES |  |
|----------------|--|
|                |  |
|                |  |
|                |  |
|                |  |
|                |  |
|                |  |
|                |  |

PUTNAM COUNTY  
BOARD OF COMMISSIONERS  
COLLABORATIVE INFRASTRUCTURES SERVICES  
TYPICAL SECTIONS

OLD PHOENIX RD AUXILIARY LANE

|                               |
|-------------------------------|
| DRAWING No.<br><b>05-0001</b> |
|-------------------------------|

# DETAILED ESTIMATE

## OLD PHOENIX ROAD AUXILIARY LANE DETAILED ESTIMATE

| ITEM NO.                               | ITEM DESCRIPTION  | UNIT | QUANTITY |
|--|---|------|----------|
| <b>ROADWAY ITEMS</b>                   |   |      |          |
| 150-1000                               | TRAFFIC CONTROL   | LS   | LS       |
| 210-0100                               | GRADING COMPLETE  | LS   | LS       |
| 310-5060                               | GR AGGR BASE CRS, 6 IN, INCL MATL   | SY   | 133      |
| 310-5120                               | GR AGGR BASE CRS, 12 IN, INCL MATL  | SY   | 506      |
| 402-3121                               | RECYCLED ASPH CONC 25 MM SUPERPAVE, GP 1 OR 2, INCL BITUM MATL & H LIME   | TN   | 82       |
| 402-3130                               | RECYCLED ASPH CONC 12.5 MM SUPERPAVE, GP 1 OR 2, INCL BITUM MATL & H LIME | TN   | 41       |
| 402-3190                               | RECYCLED ASPH CONC 19 MM SUPERPAVE, GP 1 OR 2, INCL BITUM MATL & H LIME   | TN   | 55       |
| 413-0750                               | TACK COAT   | GAL  | 98       |
| 441-0018                               | DRIVEWAY CONCRETE, 8 IN TK  | SY   | 35       |
| 441-0754                               | CONC MEDIAN, 7 1/2 IN   | SY   | 23       |
| 441-4030                               | CONC VALLEY GUTER, 8 IN   | SY   | 35       |
| 441-6216                               | CONC CURB & GUTTER, 8" X 24", TYPE 2                                      | LF   | 504      |
| 446-1100                               | PVMT REINF FABRIC STRIPS, TP 2, 18 INCH WIDTH                             | LF   | 345      |
| 500-9999                               | CLASS B CONCRETE, PVMT WIDENING   | CY   | 15       |
| 641-1200                               | GUARDRAIL, TYPE W   | LF   | 96       |
| 641-5001                               | GUARDRAIL ANCHORAGE, TP 1   | EA   | 2        |
| 641-5015A                              | GUARDRAIL TERMINAL, TP 12A, 31 IN, NON-FLARED, ENERGY-ABSORBING           | EA   | 1        |
| <b>SIGING &amp; MARKING ITEMS</b>      |   |      |          |
| 636-1033                               | HIGHWAY SIGNS, TP 1 MATL, REFL SHEETING, TP 9                             | SF   | 13       |
| 636-2070                               | GALV STEEL POSTS, TP 7  | LF   | 25       |
| 653-0120                               | THERMOPLASTIC PVMT MARKING, ARROW, TP 2                                   | EA   | 3        |
| 653-1501                               | THERMOPLASTIC SOLID TRAFFIC STRIPE, 5 IN, WHITE                           | LF   | 385      |
| 653-1704                               | THERMOPLASTIC SOLID TRAF STRIPE, 24 IN, WHITE                             | LF   | 15       |
| 653-3501                               | THERMOPLASTIC SKIP TRAFFIC STRIPE, 5IN, WHITE                             | GLF  | 80       |
| <b>SIGNAL ITEMS</b>                    |   |      |          |
| 647-2120                               | PULL BOX, PB-2  | EA   | 1        |
| 647-6300                               | LOOP DETECTOR, 6 FT X 40 FT, QUADRUPOLE                                   | EA   | 2        |
| 682-6233                               | CONDUIT, NONMETL, TP 3, 2 IN  | LF   | 20       |
| <b>DRAINAGE ITEMS</b>                  |   |      |          |
| 550-1150                               | STORM DRAIN PIPE, 15 IN, H 1-10   | LF   | 8        |
| 550-1180                               | STORM DRAIN PIPE, 18 IN, H 1-10   | LF   | 8        |
| 550-1240                               | STORM DRAIN PIPE, 24 IN, H 1-10   | LF   | 8        |
| 611-3000                               | RECONSTRUCT CATCH BASIN   | EA   | 1        |
| 611-3100                               | RECONSTRUCT JUNCTION BOX  | EA   | 4        |
| 611-8040                               | ADJUST DROP INLET TO GRADE  | EA   | 1        |
| 668-1100                               | CATCH BASIN, GP 1   | EA   | 1        |
| 668-2100                               | DROP INLET, GP 1  | EA   | 2        |
| <b>TEMPORARY EROSION CONTROL ITEMS</b> |   |      |          |
| 163-0232                               | TEMPORARY GRASSING  | AC   | 0.20     |
| 163-0240                               | MULCH   | TN   | 1.00     |
| 163-0550                               | CONSTRUCT AND REMOVE INLET SEDIMENT TRAP                                  | EA   | 10       |
| 165-0010                               | MAINTENANCE OF TEMPORARY SILT FENCE - TYPE A                              | LF   | 200      |
| 165-0105                               | MAINTENANCE OF INLET SEDIMENT TRAP  | EA   | 10       |
| 171-0010                               | TEMPORARY SILT FENCE, TYPE A  | LF   | 400      |
| <b>PERMANENT EROSION CONTROL ITEMS</b> |   |      |          |
| 700-6910                               | PERMANENT GRASSING  | AC   | 0.20     |
| 700-7000                               | AGRICULTURAL LIME   | TN   | 1.00     |
| 700-8000                               | FERTILIZER MIXED GRADE  | TN   | 1.00     |
| 700-8100                               | FERTILIZER NITROGEN CONTENT   | LB   | 10       |
| 700-9300                               | SOD   | SY   | 500      |

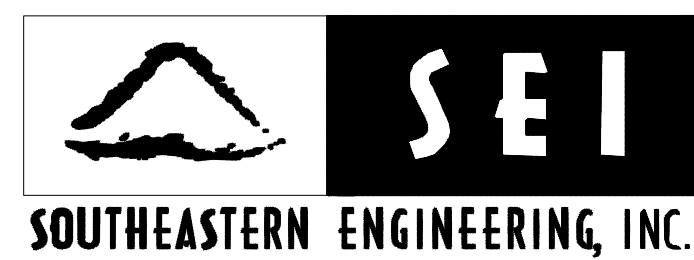

SOUTHEASTERN ENGINEERING, INC.

REVISION DATES

|  |  |  |
|--|--|--|
|  |  |  |
|  |  |  |
|  |  |  |
|  |  |  |
|  |  |  |
|  |  |  |

|  |                               |
|--|-------------------------------|
| PUTNAM COUNTY<br>BOARD OF COMMISSIONERS<br>COLLABORATIVE INFRASTRUCTURES SERVICES<br><b>DETAILED ESTIMATE</b><br>OLD PHOENIX ROAD AUXILIARY LANE | DRAWING No.<br><b>09-0001</b> |
|--|-------------------------------|

**DRAINAGE LEGEND**

- A-1 CATCH BASIN, GP 1, GA STD. 1033D
- A-2 RECONSTRUCT CATCH BASIN TO JUNCTION BOX, GA STD. 9031U
- B-1 DROP INLET, GP 1, GA STD 1019A
- B-2 RECONSTRUCT DROP INLET TO JUNCTION BOX, GA STD. 9031U
- B-3 RECONSTRUCT MANHOLE TO JUNCTION BOX, GA STD. 9031U
- B-4 RECONSTRUCT MANHOLE TO JUNCTION BOX, GA STD. 9031U
- B-5 ADJUST DROP INLET TO GRADE
- B-6 DROP INLET, GP 1, GA STD. 1019A
- B-7 REMOVE DROP INLET
- B-8 RECONSTRUCT CATCH BASIN, GA STD. 1034D

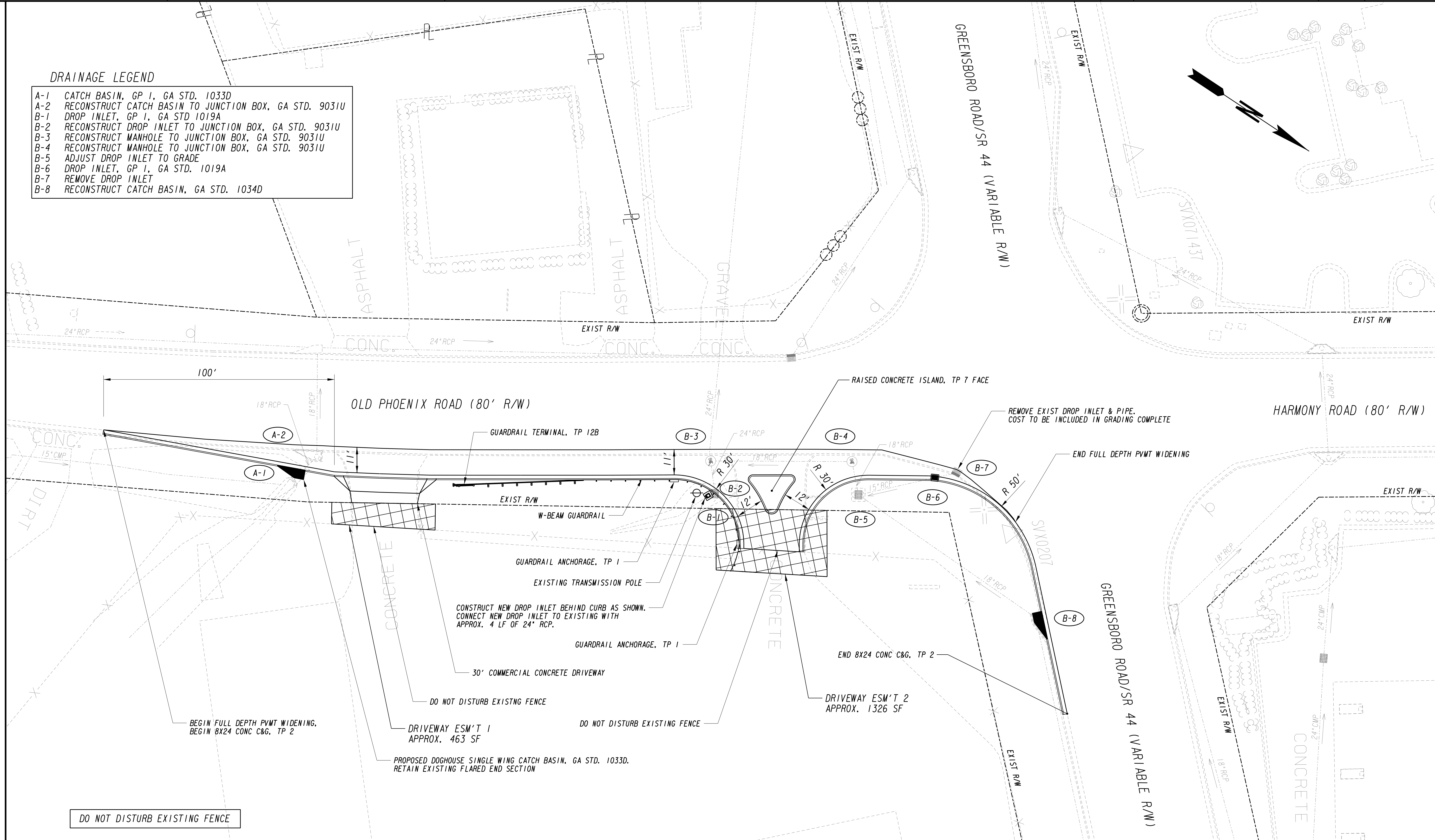

|   |     |
|---|-----|
| PROPERTY AND EXISTING R/W LINE              | --- |
| REQUIRED R/W LINE                           | --- |
| CONSTRUCTION LIMITS                         | --- |
| EASEMENT FOR CONSTR & MAINTENANCE OF SLOPES | --- |
| EASEMENT FOR CONSTR OF SLOPES               | --- |
| EASEMENT FOR CONSTR OF DRIVES               | --- |

|  |     |
|--|-----|
| BEGIN LIMIT OF ACCESS.....BLA              | --- |
| END LIMIT OF ACCESS.....ELA                | --- |
| REQ'D LIMIT OF ACCESS                      | --- |
| REQ'D LIMIT OF ACCESS & R/W                | --- |
| ORANGE BARRIER FENCE                       | --- |
| ESA - ENV. SENSITIVE AREA (SEE ERIT TABLE) | --- |

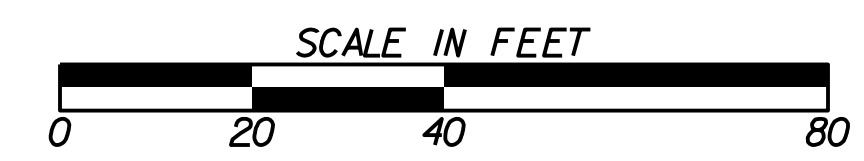
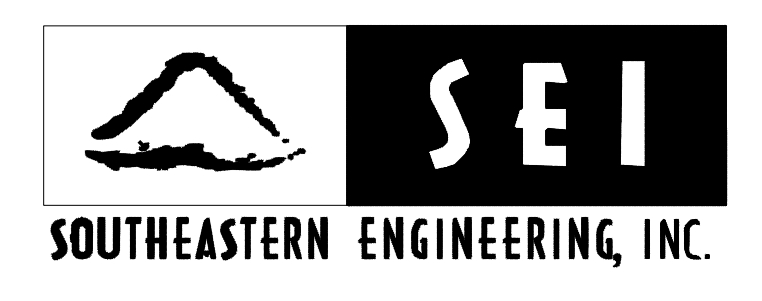

| REVISION DATES |  |  |
|----------------|--|--|
|                |  |  |
|                |  |  |
|                |  |  |
|                |  |  |

**PUTNAM COUNTY BOARD OF COMMISSIONERS**  
**COLLABORATIVE INFRASTRUCTURES SERVICES**  
**MAINLINE PLAN**

OLD PHOENIX ROAD AUXILIARY LANE

DRAWING No. **13-0001**

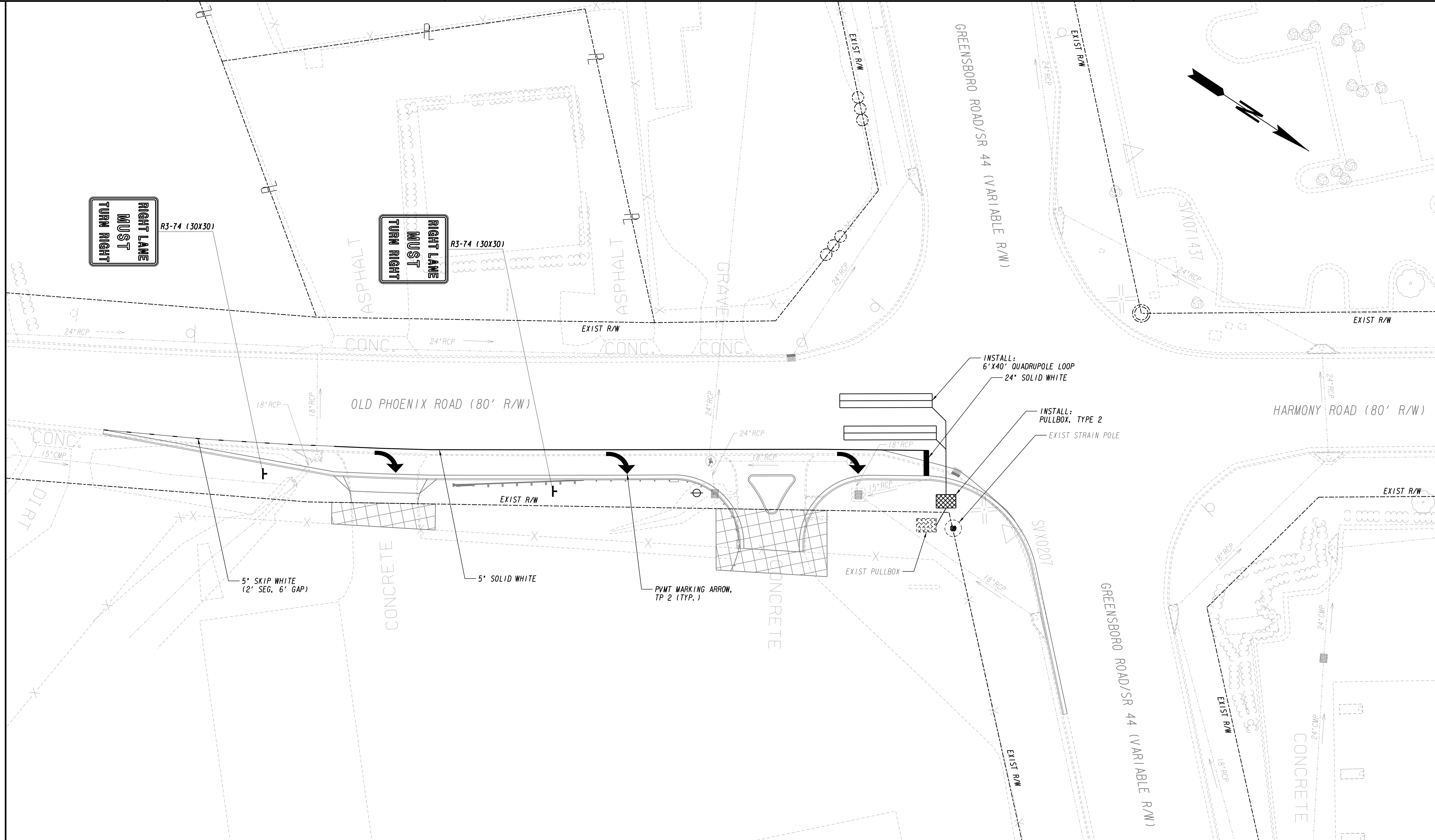

PROPERTY AND EXISTING R/W LINE  
 REQUIRED R/W LINE  
 CONSTRUCTION LIMITS  
 EASEMENT FOR CONSTR  
 & MAINTENANCE OF SLOPES  
 EASEMENT FOR CONSTR OF SLOPES  
 EASEMENT FOR CONSTR OF DRIVES

---@--- BEGIN LIMIT OF ACCESS.....BLA  
 --- END LIMIT OF ACCESS.....ELA  
 ---C---F--- REQ'D LIMIT OF ACCESS  
 --- REQ'D LIMIT OF ACCESS & R/W  
 [Hatched Box] ORANGE BARRIER FENCE  
 [Cross-hatched Box] ESA - ENV. SENSITIVE AREA  
 (SEE ERIT TABLE)

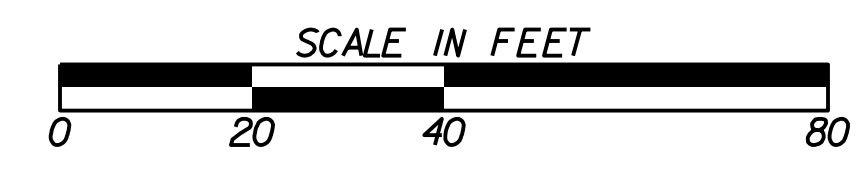
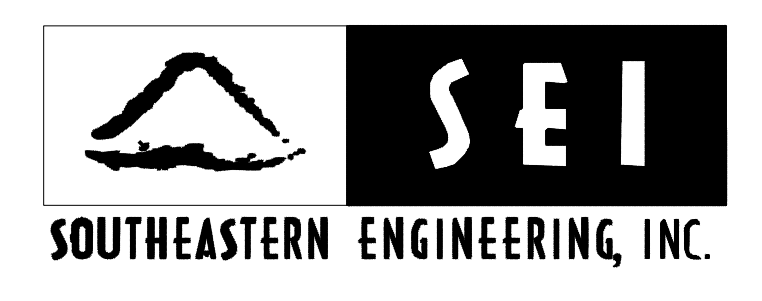

| REVISION DATES |  |  |
|----------------|--|--|
|                |  |  |
|                |  |  |
|                |  |  |
|                |  |  |

PUTNAM COUNTY  
 BOARD OF COMMISSIONERS  
 COLLABORATIVE INFRASTRUCTURES SERVICES  
**SIGNING AND MARKING PLANS**  
 OLD PHOENIX ROAD AUXILIARY LANE  
 DRAWING No. 26-0001